

DATE IN 4/1/97	SUSPENSE 4/21/97	ENGINEER BS	LOGGED KN	TYPE DHC
----------------	------------------	-------------	-----------	----------

ABOVE THIS LINE FOR DIVISION USE ONLY

NEW MEXICO OIL CONSERVATION DIVISION

- Engineering Bureau -

ADMINISTRATIVE APPLICATION COVERSHEET

THIS COVERSHEET IS MANDATORY FOR ALL ADMINISTRATIVE APPLICATIONS FOR EXCEPTIONS TO DIVISION RULES AND REGULATIONS

Application Acronyms:

[NSP-Non-Standard Proration Unit] [NSL-Non-Standard Location]
 [DD-Directional Drilling] [SD-Simultaneous Dedication]
 [DHC-Downhole Commingling] [CTB-Lease Commingling] [PLC-Pool/Lease Commingling]
 [PC-Pool Commingling] [OLS - Off-Lease Storage] [OLM-Off-Lease Measurement]
 [WFX-Waterflood Expansion] [PMX-Pressure Maintenance Expansion]
 [SWD-Salt Water Disposal] [IPI-Injection Pressure Increase]
 [EOR-Qualified Enhanced Oil Recovery Certification] [PPR-Positive Production Response]

[1] TYPE OF APPLICATION - Check Those Which Apply for [A]

[A] Location - Spacing Unit - Directional Drilling
☐ NSL ☐ NSP ☐ DD ☐ SD

Check One Only for [B] and [C]

[B] Commingling - Storage - Measurement
☒ DHC ☐ CTB ☐ PLC ☐ PC ☐ OLS ☐ OLM

[C] Injection - Disposal - Pressure Increase - Enhanced Oil Recovery
☐ WFX ☐ PMX ☐ SWD ☐ IPI ☐ EOR ☐ PPR

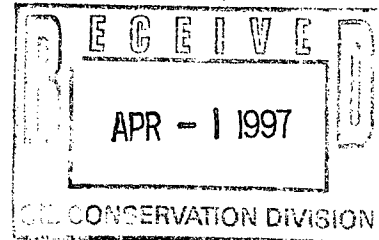

[2] NOTIFICATION REQUIRED TO: - Check Those Which Apply, or ☐ Does Not Apply

- [A] ☐ Working, Royalty or Overriding Royalty Interest Owners
- [B] ☐ Offset Operators, Leaseholders or Surface Owner
- [C] ☐ Application is One Which Requires Published Legal Notice
- [D] ☒ Notification and/or Concurrent Approval by BLM or SLO
 U.S. Bureau of Land Management - Commissioner of Public Lands, State Land Office
- [E] ☐ For all of the above, Proof of Notification or Publication is Attached, and/or,
- [F] ☐ Waivers are Attached

[3] INFORMATION / DATA SUBMITTED IS COMPLETE - Statement of Understanding

I hereby certify that I, or personnel under my supervision, have read and complied with all applicable Rules and Regulations of the Oil Conservation Division. Further, I assert that the attached application for administrative approval is accurate and complete to the best of my knowledge and where applicable, verify that all interest (WI, RI, ORRI) is common. I understand that any omission of data, information or notification is cause to have the application package returned with no action taken.

Note: Statement must be completed by an individual with supervisory capacity.

Peggy Bradfield
 Print or Type Name _____
 Signature _____
 Regulatory/Compliance Administrator
 Title _____

3-31-97
 Date

BURLINGTON RESOURCES

SAN JUAN DIVISION

March 31, 1997

SENT FEDERAL EXPRESS

Mr. William LeMay
New Mexico Oil Conservation Division
2040 South Pacheco Street
Santa Fe, New Mexico 87505

Re: San Juan 28-6 Unit #113M
1190'FNL, 1730'FWL Section 26, T-28-N, R-6-W, Rio Arriba County, NM
API #30-039-25653

Dear Mr. LeMay:

This is a request for administrative approval for downhole commingling the Blanco Mesa Verde and Basin Dakota pools in the subject well. This well is a new Mesa Verde/Dakota well that is being drilled and completed in 1997.

To comply with the New Mexico Oil Conservation Division rules, Burlington Resources Oil & Gas Company is submitting the following for your approval of this commingling:

1. Form C107A - Application for Downhole Commingling;
2. C-102 plat for each zone showing its spacing unit and acreage dedication;
3. Expected production curve for the Mesa Verde and Dakota for at least year;
4. Notification list of offset operators - Burlington is the offset operator;
5. Shut in wellhead pressure and calculated down hole pressure;
6. Nine-section plats for the Mesa Verde and Dakota.

Notification of Mesa Verde and Dakota interest owners is covered under Reference Order #R-10696 issued November 12, 1996 attached.

We will consult with the Supervisor of the Aztec District Office of the New Mexico Oil Conservation Division to establish an allocation formula.

Please let me know if you require additional data.

Sincerely,



Peggy Bradfield
Regulatory/Compliance Administrator

encs.

DISTRICT I
P.O. Box 1980, Hobbs, NM 88241-1980
DISTRICT II
811 South First St., Artesia, NM 88210-2835
DISTRICT III
1000 Rio Brazos Rd, Aztec, NM 87410-1693

State of New Mexico
Energy, Minerals and Natural Resources Department
OIL CONSERVATION DIVISION
2040 S. Pacheco
Santa Fe, New Mexico 87505-6429

Form C-107-A
New 3-12-96

APPROVAL PROCESS :
☒ Administrative ☐ Hearing
EXISTING WELLBORE
☐ YES ☒ NO

APPLICATION FOR DOWNHOLE COMMINGLING

Burlington Resources Oil & Gas Company PO Box 4289, Farmington, NM 87499

Operator	Address		
San Juan 28-6 Unit	113M	F 26-28-6	Rio Arriba
Lease	Well No.	Unit Ltr. - Sec - Twp - Rge	County
Spacing Unit Lease Types: (check 1 or more)			
OGRID NO. 14538	Property Code 7462	API NO. 30-039-25653	Federal <input checked="" type="checkbox"/> , State , (and/or) Fee

The following facts are submitted in support of downhole commingling:	Upper Zone	Intermediate Zone	Lower Zone
1. Pool Name and Pool Code	Blanco Mesaverde - 72319		Basin Dakota - 71599
2. Top and Bottom of Pay Section (Perforations)	will be supplied upon completion		will be supplied upon completion
3. Type of production (Oil or Gas)	gas		gas
4. Method of Production (Flowing or Artificial Lift)	flowing		flowing
5. Bottomhole Pressure Oil Zones - Artificial Lift: Estimated Current Gas & Oil - Flowing: Measured Current All Gas Zones: Estimated or Measured Original	(Current) a. 716 psi (see attachment)	a.	a. 1106 psi (see attachment)
	(Original) b. 1292 psi (see attachment)	b.	b. 3168 psi (see attachment)
6. Oil Gravity (°API) or Gas BTU Content	BTU 1175		BTU 1112
7. Producing or Shut-In?	shut in		shut in
Production Marginal? (yes or no)	no		yes
* If Shut-In and oil/gas/water rates of last production <small>Note: For new zones with no production history, applicant shall be required to attach production estimates and supporting data</small> * If Producing, give data and oil/gas/water water of recent test (within 60 days)	Date: n/a Rates:	Date: Rates:	Date: n/a Rates:
	Date: n/a Rates:	Date: Rates:	Date: n/a Rates:
8. Fixed Percentage Allocation Formula -% for each zone (total of %'s to equal 100%)	Oil: % Gas: % will be supplied upon completion	Oil: % Gas: %	Oil: % Gas: % will be supplied upon completion

9. If allocation formula is based upon something other than current or past production, or is based upon some other method, submit attachments with supporting data and/or explaining method and providing rate projections or other required data.
10. Are all working, overriding, and royalty interests identical in all commingled zones? ☐ Yes ☒ No
If not, have all working, overriding, and royalty interests been notified by certified mail? ☐ Yes ☒ No
Have all offset operators been given written notice of the proposed downhole commingling? ☒ Yes ☐ No
11. Will cross-flow occur? ☒ Yes ☐ No If yes, are fluids compatible, will the formations not be damaged, will any cross-flowed production be recovered, and will the allocation formula be reliable. ☒ Yes ☐ No (If No, attach explanation)
12. Are all produced fluids from all commingled zones compatible with each other? ☒ Yes ☐ No
13. Will the value of production be decreased by commingling? ☐ Yes ☒ No (If Yes, attach explanation)
14. If this well is on, or communitized with, state or federal lands, either the Commissioner of Public Lands or the United States Bureau of Land Management has been notified in writing of this application. ☒ Yes ☐ No
15. NMOC Reference Cases for Rule 303(D) Exceptions: ORDER NO(S). ☐ Reference Order R-10696 attached ☐
16. ATTACHMENTS:
* C-102 for each zone to be commingled showing its spacing unit and acreage dedication.
* Production curve for each zone for at least one year. (If not available, attach explanation.)
* For zones with no production history, estimated production rates and supporting data.
* Data to support allocation method or formula.
* Notification list of all offset operators.
* Notification list of working, overriding, and royalty interests for uncommon interest cases.
* Any additional statements, data, or documents required to support commingling.

I hereby certify that the information above is true and complete to the best of my knowledge and belief.

SIGNATURE James A. Smith TITLE Production Engineer DATE 3/27/97
TYPE OR PRINT NAME James A. Smith TELEPHONE NO. (505) 326-9700

	<p>17 OPERATOR CERTIFICATION</p> <p>I hereby certify that the information contained herein is true and complete to the best of my knowledge and belief.</p> <p style="text-align: center;"><i>Peggy Bradfield</i></p> <hr/> <p>Signature _____</p> <p>Peggy Bradfield _____</p> <p>Printed Name _____</p> <p>Regulatory Administrator _____</p> <p>Title _____</p> <p>Date <u>12-30-96</u></p>
<p style="text-align: center; font-size: 2em;">26</p> <p style="text-align: center;">F-079050-B</p>	<p>18 SURVEYOR CERTIFICATION</p> <p>I hereby certify that the well location shown on this plat was plotted from field notes of actual surveys made by me or under my supervision, and that the same is true and correct to the best of my belief.</p> <p style="text-align: right;">10/17/96</p> <hr/> <p>Date of Survey _____</p> <p>Signature _____</p> <div style="text-align: center;"> </div> <p>Certificate Number _____</p>

Expected Production

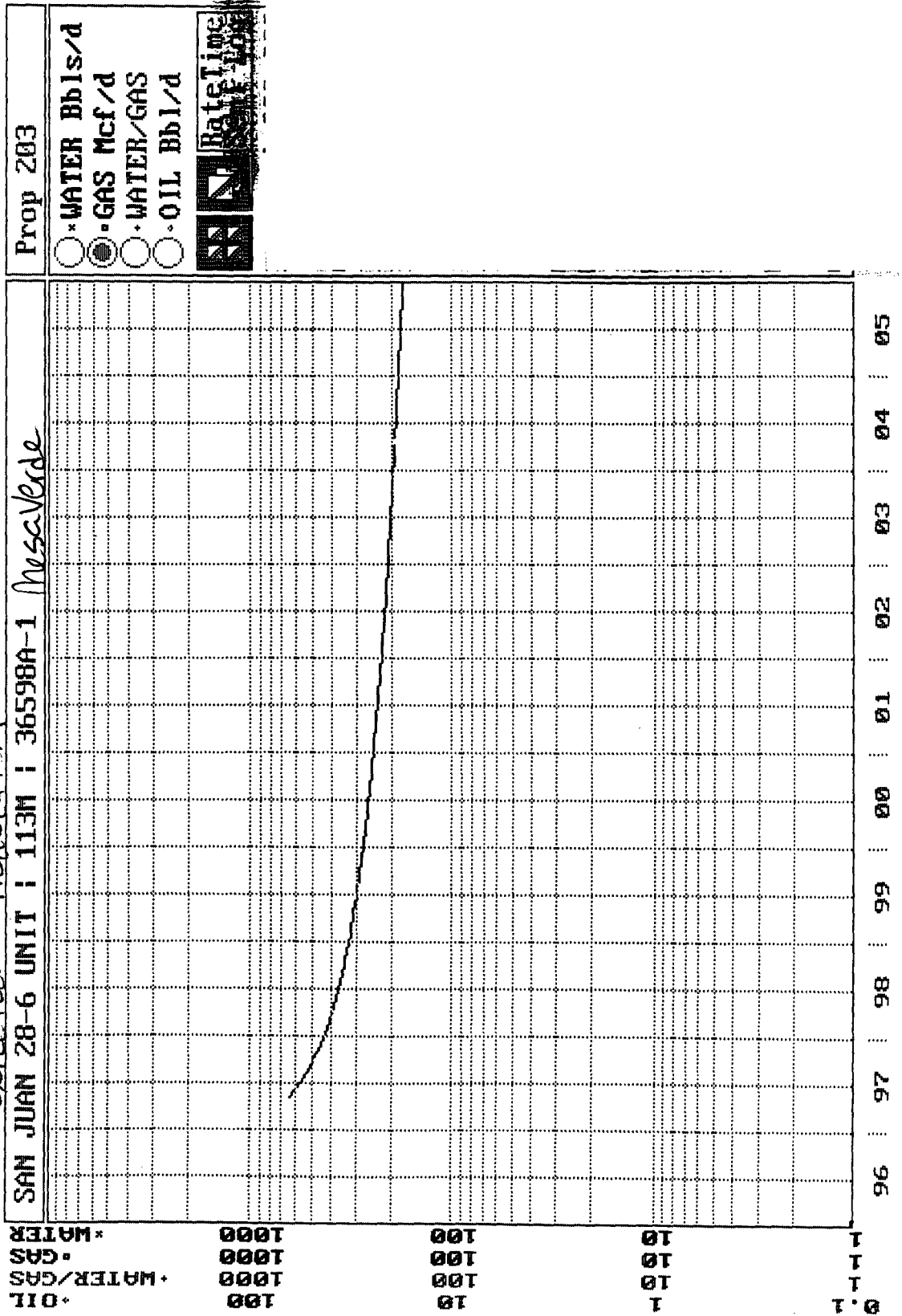

Expected Production

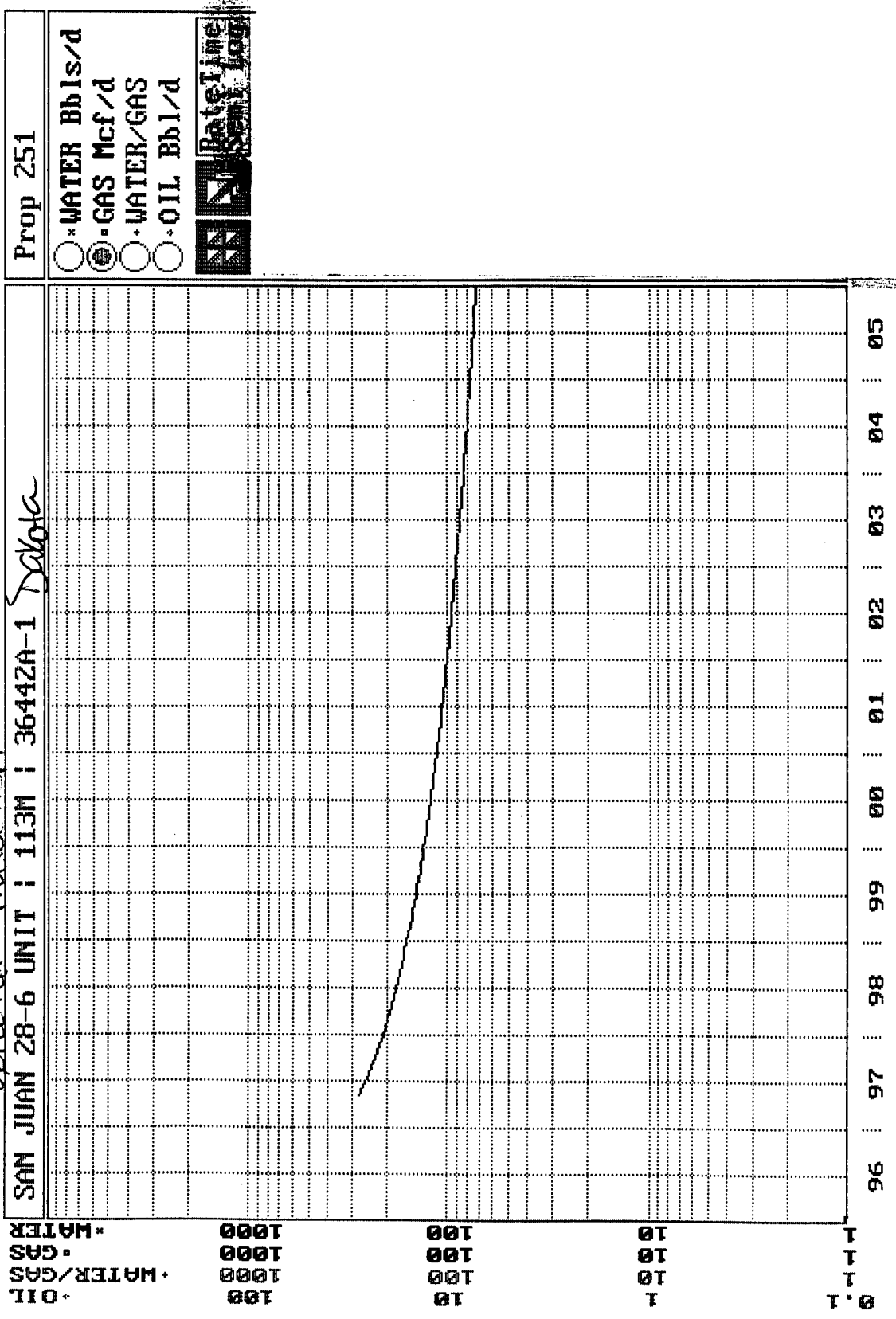

San Juan 28-6 Unit #113M
OFFSET OPERATOR \ OWNER PLAT

Township 28 North, Range 6 West

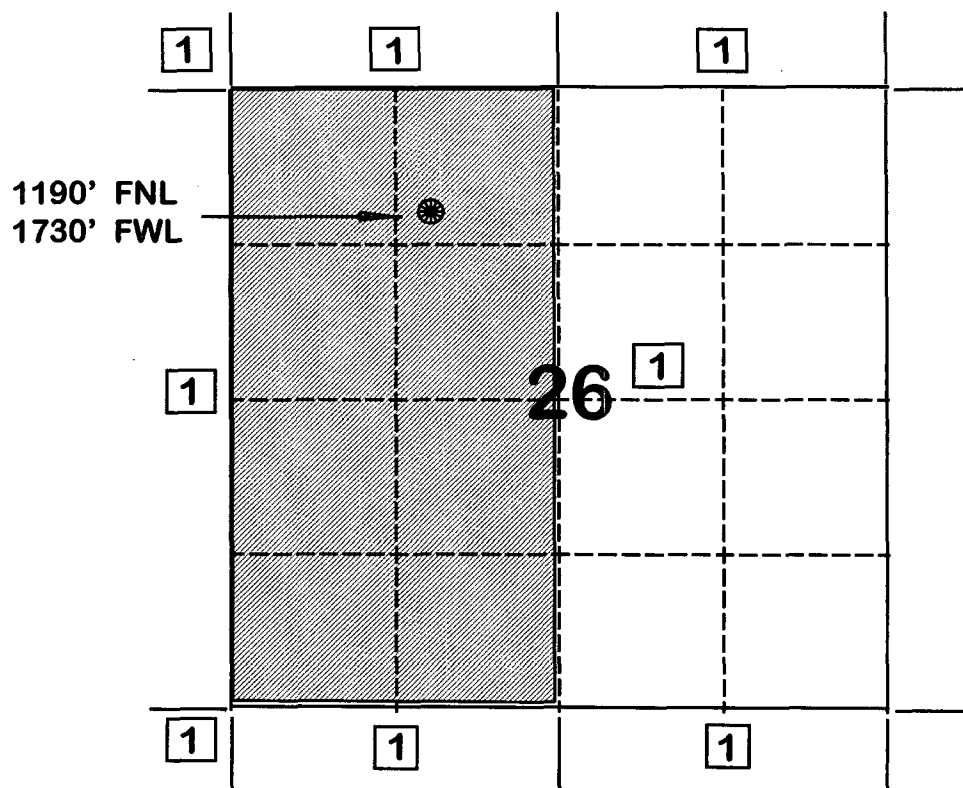

1) Burlington Resources Oil and Gas Company

**FLOWING AND STATIC BHP
CULLENDER AND SMITH METHOD**

VERSION 1.0 3/13/94

GAS GRAVITY	0.686
COND. OR MISC. (C/M)	C
%N2	0.27
%CO2	0.73
%H2S	0
DIAMETER (IN)	2
DEPTH (FT)	5693
SURFACE TEMPERATURE (DEG F)	60
BOTTOMHOLE TEMPERATURE (DEG F)	150
FLOWRATE (MCFPD)	0
SURFACE PRESSURE (PSIA)	620
BOTTOMHOLE PRESSURE (PSIA)	716.3

SAN JUAN 28-6 UNIT #4 MESAVERDE - CURRENT

**FLOWING AND STATIC BHP
CULLENDER AND SMITH METHOD**

VERSION 1.0 3/13/94

GAS GRAVITY	0.686
COND. OR MISC. (C/M)	C
%N2	0.27
%CO2	0.73
%H2S	0
DIAMETER (IN)	2
DEPTH (FT)	5693
SURFACE TEMPERATURE (DEG F)	60
BOTTOMHOLE TEMPERATURE (DEG F)	150
FLOWRATE (MCFPD)	0
SURFACE PRESSURE (PSIA)	1105
BOTTOMHOLE PRESSURE (PSIA)	1292.2

SAN JUAN 28-6 UNIT #4 MESAVERDE - ORIGINAL

**FLOWING AND STATIC BHP
CULLENDER AND SMITH METHOD**

VERSION 1.0 3/13/94

GAS GRAVITY	0.601
COND. OR MISC. (C/M)	C
%N2	0.42
%CO2	1.06
%H2S	0
DIAMETER (IN)	2.375
DEPTH (FT)	7616
SURFACE TEMPERATURE (DEG F)	60
BOTTOMHOLE TEMPERATURE (DEG F)	200
FLOWRATE (MCFPD)	0
SURFACE PRESSURE (PSIA)	940
BOTTOMHOLE PRESSURE (PSIA)	1106.1

SAN JUAN 28-6 UNIT #113 DAKOTA - CURRENT

**FLOWING AND STATIC BHP
CULLENDER AND SMITH METHOD**

VERSION 1.0 3/13/94

GAS GRAVITY	0.601
COND. OR MISC. (C/M)	C
%N2	0.42
%CO2	1.06
%H2S	0
DIAMETER (IN)	2.375
DEPTH (FT)	7616
SURFACE TEMPERATURE (DEG F)	60
BOTTOMHOLE TEMPERATURE (DEG F)	200
FLOWRATE (MCFPD)	0
SURFACE PRESSURE (PSIA)	2667
BOTTOMHOLE PRESSURE (PSIA)	3168.2

SAN JUAN 28-6 UNIT #113 DAKOTA -ORIGINAL

Page No.: 2

Print Time: Thu Mar 27 07:16:40 1997

Property ID: 10537

Property Name: SAN JUAN 28-6 UNIT | 4 | 51855A-1

Table Name: K:\ARIES\RR97PDP\TEST.DBF

SJ 28-6 # 113m
Mesaverde Offset

--DATE-- ---CUM GAS-- M SIWHP
Mcf Psi

10/14/53	0	1105.0	← Original
10/26/53	0	1104.0	
12/30/57	177000	873.0	
11/06/58	232000	897.0	
06/14/59	284000	889.0	
06/14/60	349000	834.0	
06/13/61	405000	787.0	
05/29/62	448000	770.0	
05/16/63	498000	808.0	
05/26/64	547000	759.0	
03/08/65	595000	749.0	
10/21/66	692000	669.0	
11/17/67	759000	641.0	
10/10/68	809000	609.0	
08/18/69	855225	559.0	
05/25/70	899365	576.0	
05/04/71	950479	510.0	
05/22/72	1000628	533.0	
08/21/73	1061228	435.0	
07/31/74	1096721	505.0	
07/12/76	1170506	424.0	
01/07/78	1198538	453.0	
11/07/78	1207460	453.0	
10/20/86	1277003	423.0	
01/24/91	1310044	330.0	
09/04/91	1310044	342.0	
05/09/95	1418701	620.0	← Current

Page No.: 2

Print Time: Thu Mar 27 07:18:28 1997

Property ID: 1832

Property Name: SAN JUAN 28-6 UNIT | 113 | 50754A-1

Table Name: K:\ARIES\RR97PDP\TEST.DBF

SS 28-6# 113m

Dakota Offset

--DATE-- ---CUM GAS-- M SIWHP
-----Mcf-----Psi-----

10/07/63	0	2667.0	← Original
10/30/63	0	2666.0	
10/01/64	93000	1351.0	
09/08/65	178000	1182.0	
04/12/66	247000	1035.0	
03/22/67	319000	1250.0	
04/01/68	382000	1092.0	
08/19/69	494101	867.0	
05/25/70	542382	991.0	
05/04/71	608545	1015.0	
05/22/72	677963	933.0	
08/21/73	757073	911.0	
06/24/75	866668	992.0	
08/08/77	1008401	825.0	
04/24/79	1106719	890.0	
09/29/81	1226002	954.0	
09/22/83	1283949	976.0	
11/07/85	1344595	1004.0	
01/07/86	1361852	920.0	
10/15/88	1431430	1052.0	
06/08/90	1505898	1002.0	
03/29/92	1576332	940.0	← Current

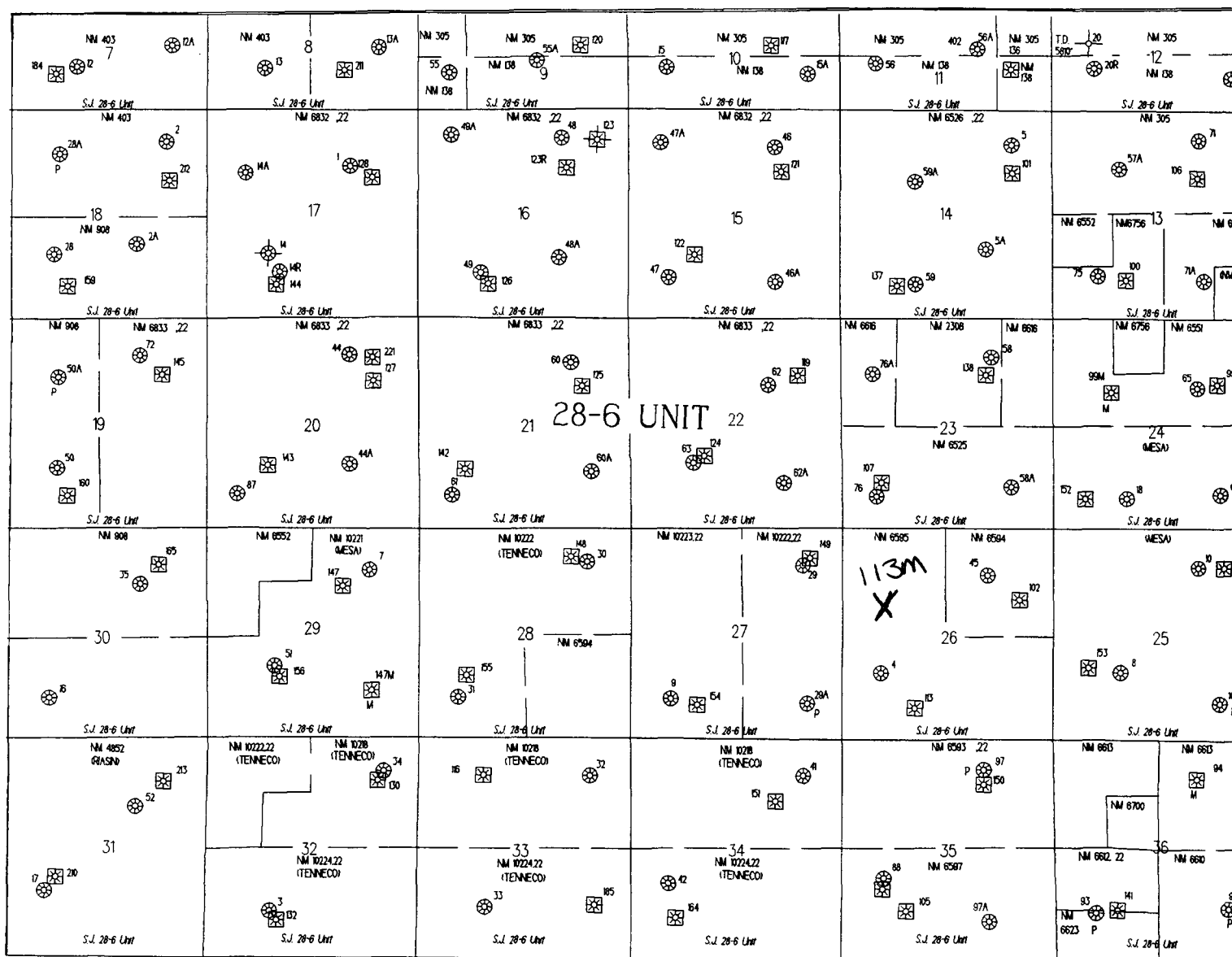

**STATE OF NEW MEXICO
ENERGY, MINERALS AND NATURAL RESOURCES DEPARTMENT
OIL CONSERVATION DIVISION**

**IN THE MATTER OF THE HEARING
CALLED BY THE OIL CONSERVATION
DIVISION FOR THE PURPOSE OF
CONSIDERING:**

**CASE NO. 11628
ORDER NO. R-10696**

**APPLICATION OF BURLINGTON RESOURCES
OIL & GAS COMPANY FOR THE ESTABLISHMENT
OF A DOWNHOLE COMMINGLING "REFERENCE
CASE" FOR ITS SAN JUAN 28-6 UNIT PURSUANT
TO DIVISION RULE 303.E. AND THE ADOPTION
OF SPECIAL ADMINISTRATIVE RULES THEREFOR,
SAN JUAN COUNTY, NEW MEXICO..**

ORDER OF THE DIVISION

BY THE DIVISION:

This cause came on for hearing at 8:15 a.m. on October 17 and November 7, 1996, at Santa Fe, New Mexico, before Examiners David R. Catanach and Michael E. Stogner, respectively.

NOW, on this 12th day of November, 1996, the Division Director, having considered the testimony, the record and the recommendations of the Examiner, and being fully advised in the premises,

FINDS THAT:

(1) Due public notice having been given as required by law, the Division has jurisdiction of this cause and the subject matter thereof.

(2) The applicant, Burlington Resources Oil & Gas Company (Burlington), pursuant to the provisions of Division Rule 303.E., seeks to establish a downhole commingling "reference case" to provide exceptions for (a) marginal economic criteria, (b) pressure criteria, (c) allocation formulas and (d) modification of notification rules on a unit-wide basis for downhole commingling of Dakota, Mesaverde, Fruitland Coal and Pictured Cliffs gas production within existing or future drilled wells within the San Juan 28-6 Unit, San Juan County, New Mexico.

(3) Division Rule No. 303.E., amended by Order No. R-10470-A, currently states:

- c) establish a "reference case" whereby the Division utilizes the data presented in the immediate case to endorse or approve certain methods of allocating production whereby the applicant need not submit additional data or justification when proposing a certain method of allocating production on Form C-107-A's subsequently filed for wells within the San Juan 28-6 Unit; and,
- d) establish a "reference case" or an administrative procedure for authorizing the downhole commingling of existing or future drilled wells within the San Juan 28-6 Unit without additional notice to each affected interest owner as required by Division Rule No. 303.D.

(7) In support of its request to except marginal economic criteria, the applicant presented geologic and engineering evidence and testimony which indicates that within the San Juan 28-6 Unit:

- a) the structure and thickness of the Dakota and Pictured Cliffs formations are very consistent;
- b) the average recoverable Dakota and Pictured Cliffs gas reserves underlying an undeveloped drill block are approximately 449 MMCFG and 186 MMCFG, respectively;
- c) the average initial producing rate for a newly drilled or recompleted Dakota and Pictured Cliffs gas well is approximately 254 MCFGD and 216 MCFGD, respectively; and,
- d) the estimated ultimate gas recoveries and initial producing rates from the Dakota and Pictured Cliffs formations are insufficient to justify drilling stand alone wells and/or dually completed wells to recover such gas reserves.

(8) The evidence and testimony presented by the applicant indicates that the Dakota and Pictured Cliffs formations within the San Juan 28-6 Unit should be properly classified as "marginal".

(9) In support of its request to except pressure criteria within the Dakota and Pictured Cliffs formations within the San Juan 28-6 Unit, the applicant presented engineering evidence and testimony which indicates that:

- c) providing notice to each interest owner within the San Juan 28-6 Unit of subsequent downhole comminglings is unnecessary and is an excessive burden on the applicant;
- d) the downhole commingling of wells within the San Juan 28-6 Unit Area will benefit working, royalty, and overriding royalty interest owners. In addition, the downhole commingling of wells within the San Juan 28-6 Unit should not violate the correlative rights of any interest owner;
- e) no interest owner appeared at the hearing in opposition to the establishment of a "reference case" or administrative procedure for notice.

(14) An administrative procedure should be established within the San Juan 28-6 Unit for obtaining approval for subsequent downhole commingled wells without notice to Unit interest owners, provided however that, all other provisions contained within Division Rule No. 303.C. are complied with.

(15) Approval of the proposed "reference cases" for marginal economic criteria, pressure criteria, allocation formulas and notice will lessen the burden on the applicant insofar as providing the data required pursuant to Division Rule No. 303.D. and Form C-107-A, will provide the applicant a streamlined method for obtaining downhole commingling approvals within the San Juan 28-6 Unit, and will not violate correlative rights.

IT IS THEREFORE ORDERED THAT:

(1) The application of Burlington Resources Oil & Gas Company to establish a "reference case" for (a) marginal economic criteria, (b) pressure criteria, (c) allocation formulas and (d) modification of notification rules on a unit-wide basis for downhole commingling of Dakota, Mesaverde, Fruitland Coal and Pictured Cliffs gas production within existing or future drilled wells within the San Juan 28-6 Unit, San Juan County, New Mexico, is hereby approved.