

DISTRICT I
P.O. Box 1980, Hobbs, NM 88241 1980
DISTRICT II
811 South First St. Artesia NM 88210 2835
DISTRICT III
1000 Rio Brazos Rd. Aztec, NM 87410 1693

State of New Mexico
Energy, Minerals and Natural Resources Department
OIL CONSERVATION DIVISION
2040 S. Pacheco
Santa Fe, New Mexico 87505-6429

Form C-107-A
New 3-12-96

APPROVAL PROCESS:

☒ Administrative ☐ Hearing

EXISTING WELLBORE

☒ YES ☐ NO

APPLICATION FOR DOWNHOLE COMMINGLING

Conoco Inc.

10 Desta Dr. Ste 100W, Midland, Tx. 79705-4500

San Juan 28-7

110

K-19-T27N-R7W

Rio Arriba

Lease

Well No

Unit Ltr Sec Twp Rge

County

OGRID NO. 005073

Property Code 16608

API NO. 30-039-21732

Spacing Unit Lease Types: (check 1 or more)

Federal ☒ , State ☐ (and/or) Fee ☐

The following facts are submitted in support of downhole commingling:	Upper Zone	Intermediate Zone	Lower Zone
1. Pool Name and Pool Code	Mesa Verde 72319		Dakota 71599
2. TOP and Bottom of Pay Section (Perforations)	5199' - 5484' OA		7239' - 7452'
3. Type of production (Oil or Gas)	Gas		Gas
4. Method of Production (Flowing or Artificial Lift)	Expected to be Flowing		Flowing
5. Bottomhole Pressure Oil Zones - Artificial Lift: Gas & Oil - Flowing: All Gas Zones: Estimated Current Measured Current Estimated Or Measured Original	a (Current) 800 psia b(Original) 1192	a. b.	a. 565 psia b. 2925
6. Oil Gravity (*API) or Gas BT Content	1325		1288
7. Producing or Shut-In?	To Be Completed		Producing
Production Marginal? (yes or no)	Yes		Yes
• If Shut-In give date and oil/gas/water rates of last production Note For new zones with no production history applicant shall be required to attach production estimates and supporting data • If Producing, date and oil/gas/water rates of recent test (within 60 days)	Date Rates Incremental Production by Subtraction	Date Rates Date Rates	Date Rates Mid-Year avg. rates - see table
8. Fixed Percentage Allocation Formula - % or each zone	Oil: % Gas %	Oil: % Gas %	Oil: % Gas %

9. If allocation formula is based upon something other than current or past production, or is based upon some other method, submit attachments with supporting data and/or explaining method and providing rate projections or other required data.

10. Are all working, overriding, and royalty interests identical in all commingled zones? Yes ☒ No ☐
If not, have all working, overriding, and royalty interests been notified by certified mail? ☒ Yes ☐ No ☐
Have all offset operators been given written notice of the proposed downhole commingling? ☒ Yes ☐ No ☐
* Conoco is offset operator to all San Juan 28-7 Unit wells.

11. Will cross-flow occur? ☒ Yes ☐ No If yes, are fluids compatible, will the formations not be damaged, will any cross-flowed production be recovered, and will the allocation formula be reliable. ☒ Yes ☐ No (If No, attach explanation)

12. Are all produced fluids from all commingled zones compatible with each others ☒ Yes ☐ No

13. Will the value of production be decreased by commingling? ☐ Yes ☒ No (If Yes, attach explanation)

14. If this well is on, or communitized with, state or federal lands, either the Commissioner of Public Lands or the United States Bureau of Land Management has been notified in writing of this application. ☒ Yes ☐ No

15. NMOCD Reference Cases for Rule 303(D) Exceptions: ORDER NO(S) _____

16. ATTACHMENTS

- * C-102 for each zone to be commingled showing its spacing unit and acreage dedication.
- * Production curve for each zone for at least one year. (If not available, attach explanation.)
- * For zones with no production history, estimated production rates and supporting data.
- * Data to support allocation method or formula.
- * Notification list of all offset operators.
- * Notification list of working, overriding and royalty interests for uncommon interest cases.
- * Any additional statements, data, or documents required to support commingling.

I hereby certify that the information above is true and complete to the best of my knowledge and belief.

SIGNATURE Jerry W. Hoover TITLE Sr. Conservation Coord DATE 1/27/97

TYPE OR PRINT NAME Jerry W. Hoover TELEPHONE NO. (915) 686-6548

DAKOTA HISTORICAL DATA: 1ST PROD: 08/79

OIL YIELD: 0.0214 BBL/MCF

DAKOTA PROJECTED DATA

DECLINE RATE: 4.0% (EXPONENTIAL)

PRODUCTION FORECAST FOR SUBTRACTION METHOD COMMINGLE ALLOCATION

08:05 AM

**MEXICO OIL CONSERVATION COMMISSION
WELL LOCATION AND ACREAGE DEDICATION PLAT**

Form C-102
Supersedes C-128
Effective 1-1-65

All distances must be from the outer boundaries of the Section.

Operator El Paso Natural Gas Company			Lease San Juan 28-7 Unit (SF-078840)		Well No. 110
Unit Letter K	Section 19	Township 27N	Range 7W	County Rio Arriba	
Actual Footage Location of Well: 1450 feet from the South line and 1450 feet from the West line					
Ground Level Elev. 6568	Producing Formation Dakota		Pool Basin Dakota		Dedicated Acreage: 321.15 Acres

1. Outline the acreage dedicated to the subject well by colored pencil or hatchure marks on the plat below.
2. If more than one lease is dedicated to the well, outline each and identify the ownership thereof (both as to working interest and royalty).
3. If more than one lease of different ownership is dedicated to the well, have the interests of all owners been consolidated by communitization, unitization, force-pooling, etc?

☒ Yes ☐ No If answer is "yes," type of consolidation Unitization

If answer is "no," list the owners and tract descriptions which have actually been consolidated. (Use reverse side of this form if necessary.) _____

No allowable will be assigned to the well until all interests have been consolidated (by communitization, unitization, forced-pooling, or otherwise) or until a non-standard unit, eliminating such interests, has been approved by the Commission.

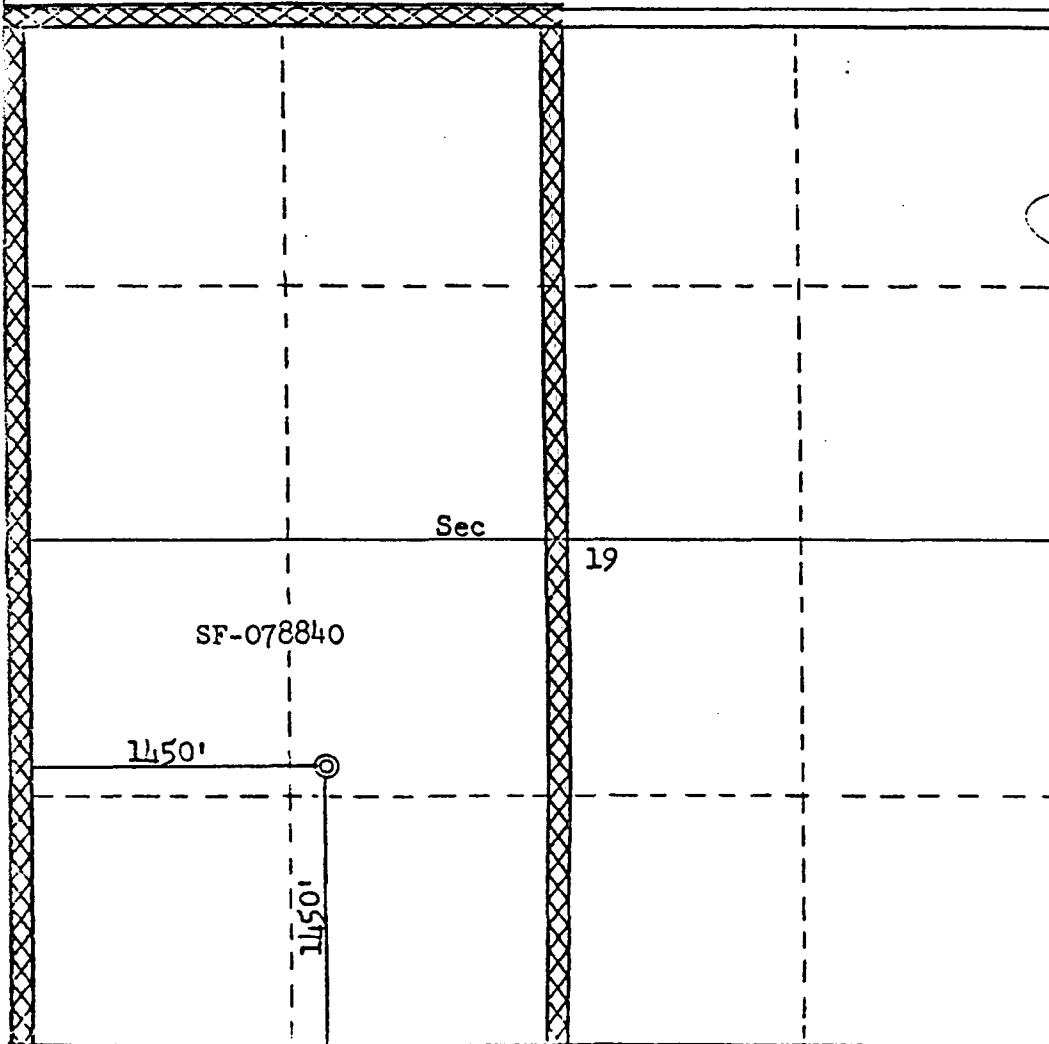

CERTIFICATION

I hereby certify that the information contained herein is true and complete to the best of my knowledge and belief.

Regina Bradfield
Name
Drilling Clerk
Position
El Paso Natural Gas Co.
Company
April 10, 1978
Date

I hereby certify that the well location shown on this plat was plotted from field notes of actual surveys made by me or under my supervision, and that the same is true and correct to the best of my knowledge and belief.

Date Surveyed: **February 23, 1978**
Registered Professional Land Surveyor and/or Licensed Surveyor
Fred B. Kerr Jr.
Fred B. Kerr Jr.
1950

Dwights

Lease: SAN JUAN 28 7 UNIT (110)

12/05/96

Retrieval Code: 251,039,2510392

