

DHC 8/19/97

DISTRICT I
P.O. Box 1980, Hobbs, NM 88241-1980

DISTRICT II
811 South First St., Artesia, NM 88210-2835

DISTRICT III
1000 Rio Brazos Rd., Aztec, NM 87410-1693

State of New Mexico
Energy, Minerals and Natural Resources Department

JUL 30 1997

OIL CONSERVATION DIVISION

2040 S. Pacheco
Santa Fe, New Mexico 87505-6429

Form C-107-A
New 3-12-96

APPROVAL PROCESS:
☒ Administrative ☐ Hearing

EXISTING WELLBORE
☒ YES ☐ NO

Conoco Inc.

10 Desta Dr., Ste 100W, Midland, TX 79705-4500

Operator

Address

Hawk B-1

14

J-8-21S-37E

Lea

Lease

Well No

Unit Ltr Sec Twp Rge

County

Spacing Unit Lease Types: (check 1 or more)

OGRID NO. 005073

Property Code 003022

API NO. 30-025-22859

Federal ☒ State ☐ (and/or) Fee ☐

The following facts are submitted in support of downhole commingling:	Upper Zone	Intermediate Zone	Lower Zone
1. Pool Name and Pool Code	Blinebry Oil and Gas - 06660		Drinkard - 19190
2. TOP and Bottom of Pay Section (Perforations)	5666' - 5876'		6660' - 6700'
3. Type of production (Oil or Gas)	Oil		Oil
4. Method of Production (Flowing or Artificial Lift)	Artificial Lift		Artificial Lift
5. Bottom hole Pressure	a (Current)	a.	a.
Oil Zones - Artificial Lift: Estimated Current	600 psia		700 psia
Gas & Oil - Flowing: Measured Current	b (Original)	b.	b.
All Gas Zones: Estimated Or Measured Original	2400		2650
6. Oil Gravity (*API) or Gas BTU Content	39.4		39.0
7. Producing or Shut-In?	Producing		Shut-in
Production Marginal? (yes or no)	Yes		Yes
• If Shut-In give date and oil/gas/ water rates of last production Note: For new zones with no production history, applicant shall be required to attach production estimates and supporting data. • If Producing, give date and oil/gas/water rates of recent test (within 60 days)	Date Rates	Date Rates:	Date Rates
	1/97 6 BOPD/ 64 BWPD/ 139 MCFD		9/72 11 BOPD/ 0 BWPD/ 164 MCFD
8. Fixed Percentage Allocation Formula -% for each zone	oil: 35 % Gas 46 %	oil: % Gas %	oil: 65 % Gas 54

9. If allocation formula is based upon something other than current or past production, or is based upon some other method, submit attachments with supporting data and/or explaining method and providing rate projections or other required data.

10. Are all working, overriding, and royalty interests identical in all commingled zones?
If not, have all working, overriding, and royalty interests been notified by certified mail?
Have all offset operators been given written notice of the proposed downhole commingling?

☒ Yes ☐ No

☐ Yes ☐ No

☒ Yes ☐ No

11. Will cross-flow occur? ☐ Yes ☒ No If yes, are fluids compatible, will the formations not be damaged, will any cross-flowed production be recovered, and will the allocation formula be reliable. ☐ Yes ☐ No (If No, attach explanation)

12. Are all produced fluids from all commingled zones compatible with each others ☒ Yes ☐ No

13. Will the value of production be decreased by commingling? ☐ Yes ☒ No (If Yes, attach explanation)

14. If this well is on, or communitized with, state or federal lands, either the Commissioner of Public Lands or the United States Bureau of Land Management has been notified in writing of this application. ☒ Yes ☐ No

15. NMOCD Reference Cases for Rule 303(D) Exceptions: ORDER NO(S) _____

16. ATTACHMENTS

- * C-102 for each zone to be commingled showing its spacing unit and acreage dedication.
- * Production curve for each zone for at least one year. (If not available, attach explanation.)
- * For zones with no production history, estimated production rates and supporting data.
- * Data to support allocation method or formula.
- * Notification list of all offset operators.
- * Notification list of working, overriding and royalty interests for uncommon interest cases.
- * Any additional statements, data, or documents required to support commingling.

hereby certify that the information above is true and complete to the best of my knowledge and belief.

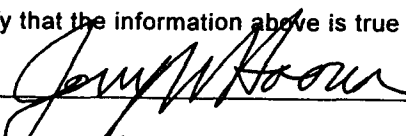
SIGNATURE 

TITLE Sr. Conservation Coord.

DATE 4/15/97

TYPE OR PRINT NAME Jerry W. Hoover

TELEPHONE NO. (915) 686-6548

**NEW MEXICO OIL CONSERVATION COMMISSION
WELL LOCATION AND ACREAGE DEDICATION PLAT**

Form C-102
Supersedes C-123
Effective 1-1-65

All distances must be from the outer boundaries of the Section.

Operator CONTINENTAL OIL CO.			Lease HAWK B 1		Well No. 14
Section Letter J	Section 8	Township 21 SOUTH	Range 37 EAST	County LEA	
Actual Footage Location of Well:					
1980	feet from the	SOUTH	line and	1980	feet from the
				EAST	line
Ground Level Elev.	Producing Formation <i>Draught</i>		Pool <i>F. Sinkland</i>	Dedicated Acreage: <i>4.0</i> Acres	

1. Outline the acreage dedicated to the subject well by colored pencil or hatchure marks on the plat below.
2. If more than one lease is dedicated to the well, outline each and identify the ownership thereof (both as to working interest and royalty).
3. If more than one lease of different ownership is dedicated to the well, have the interests of all owners been consolidated by communitization, unitization, force-pooling, etc?

☐ Yes ☐ No If answer is "yes" type of consolidation _____

If answer is "no," list the owners and tract descriptions which have actually been consolidated. (Use reverse side of this form if necessary). _____

No allowable will be assigned to the well until all interests have been consolidated (by communitization, unitization, forced-pooling, or otherwise) or until a non-standard unit, eliminating such interests, has been approved by the Commission.

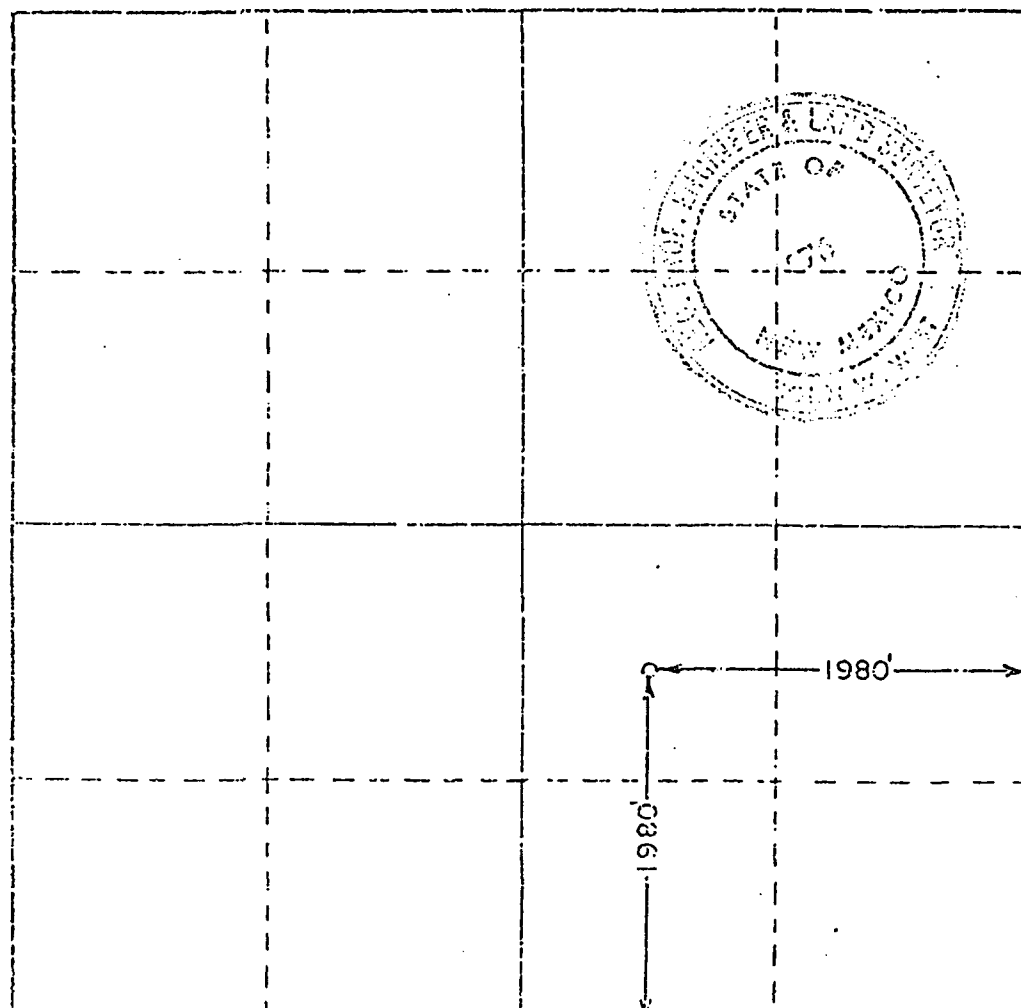

CERTIFICATION

I hereby certify that the information contained herein is true and complete to the best of my knowledge and belief.

Name *M. E. Mackley*
Position *Adm. Section Chief*
Company *Continental Oil Co.*
Date *11-12-68*

I hereby certify that the well location shown on this plat was plotted from field notes of actual surveys made by me or under my supervision, and that the same is true and correct to the best of my knowledge and belief.

Date Surveyed
NOVEMBER 7, 1968
Registered Professional Engineer and/or Land Surveyor
A. L. L. L. L. L.

WELL: HAWK B 1 14:BL

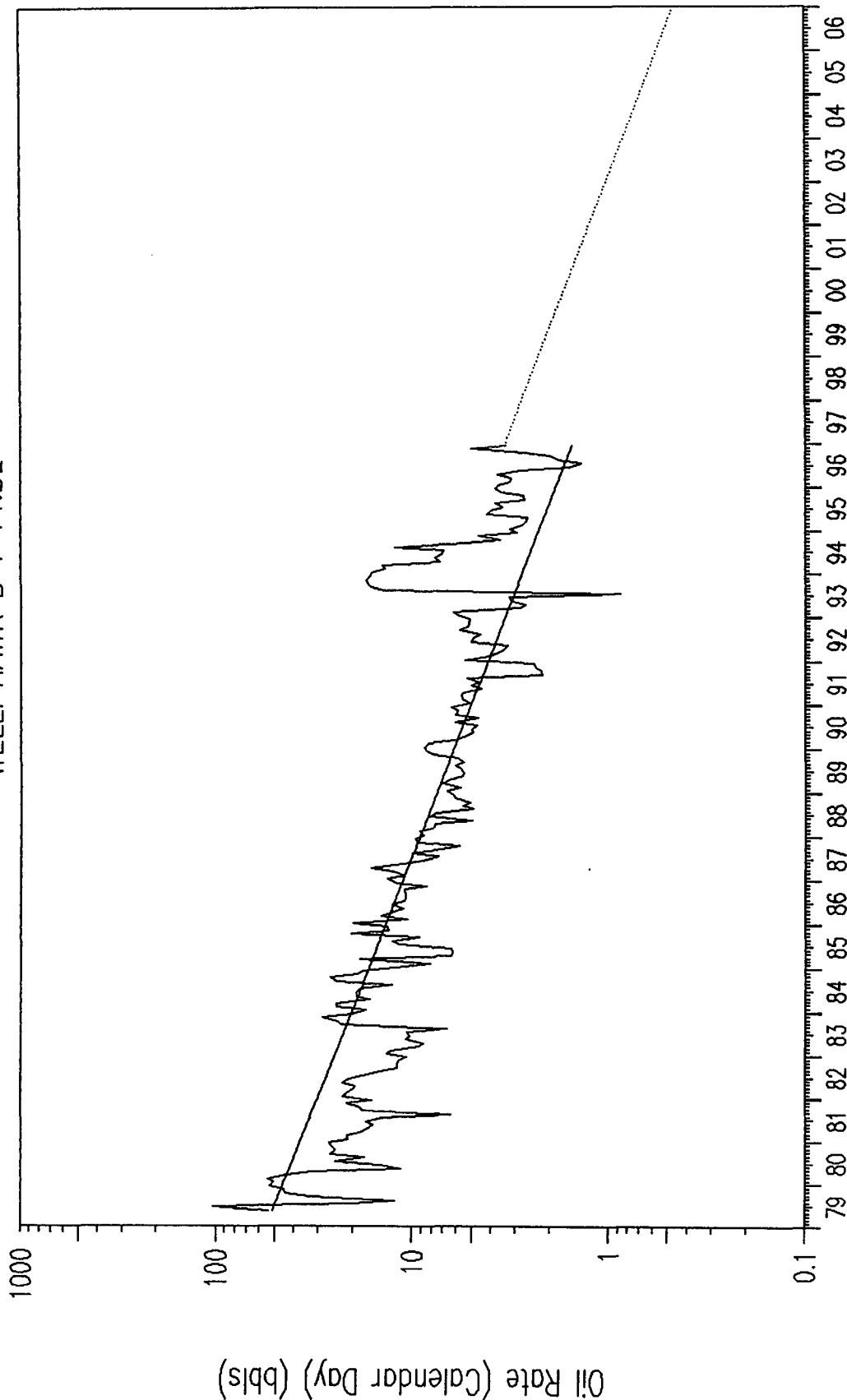

Decline Rate (frac) Nominal: 0.016618 Effective: 0.016480 Annual: 0.180787

Current Oil rate: 3.4 bbls/d

Economic Limit: 0.0 bbls/d

Cumulative Oil Produced: 78.3 Mbbls

Remaining Reserves: 5.4 Mbbls

Total Reserves: 83.6 Mbbls - At End of Forecast

WELL: HAWK B 1 14:BL

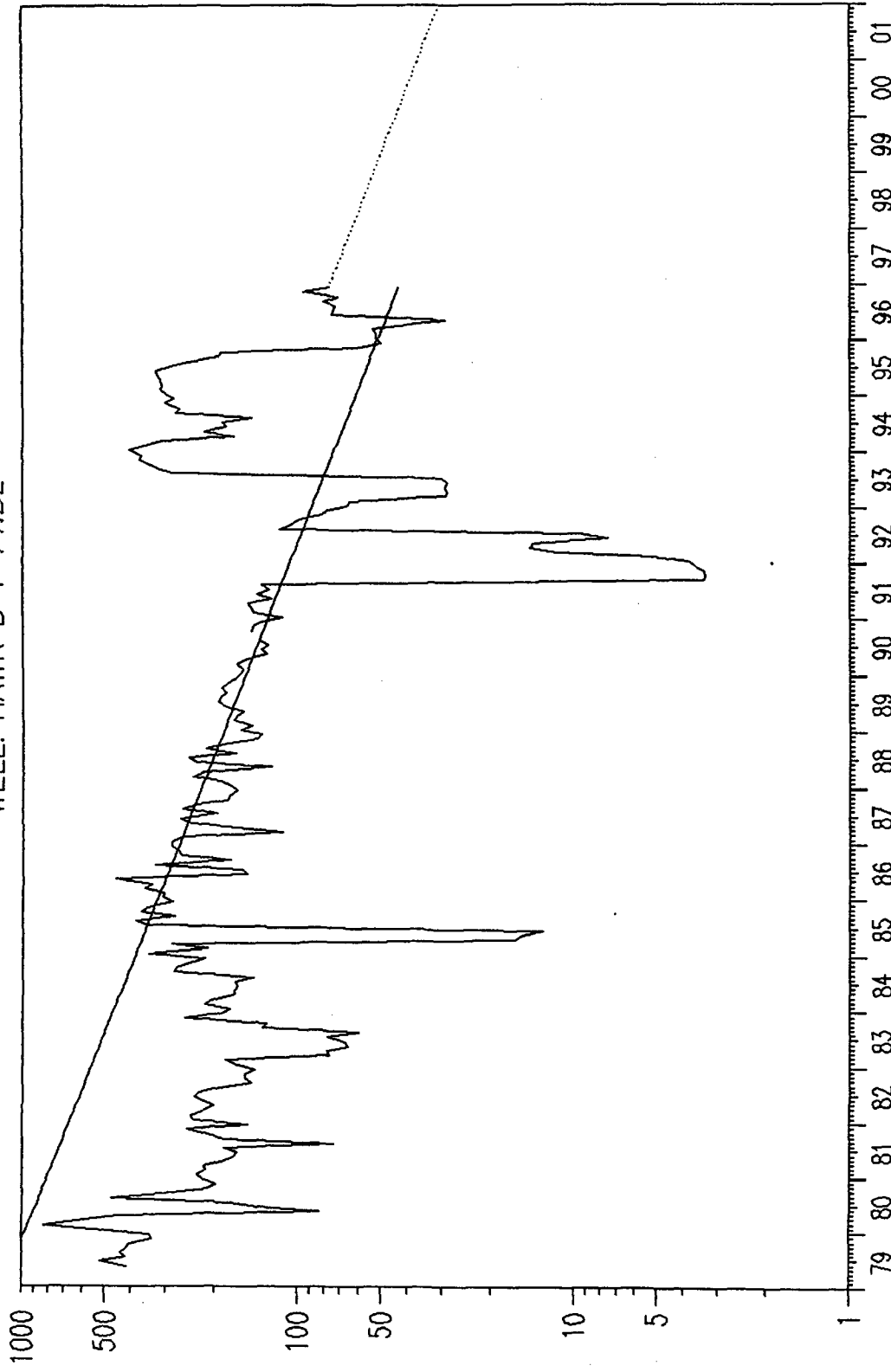

Decline Rate (frac) Nominal: 0.015291 Effective: 0.015175 Annual: 0.167642

Current Gas rate: 76.90 Mscf/d

Economic Limit: 0.769 Mscf/d

Cumulative Gas Produced: 1259.22 MMscf

Remaining Reserves: 91.9 MMscf

Total Reserves: 1351.1 MMscf - At End of Forecast

Dwights

Lease: HAWK B 1 (000014)

02/11/97

Retrieval Code: 150,025,21S37E08JPKDR

10³
10³
10³

10²
10²
10²

10
10

1
1

1970

1972

Oil (bbl/day)

Water (bbl/day)

Gas (mcf/day)

County: LEA, NM

F.P. Date: N/A

Field: DRINKARD (DRINKARD) DR

Oil Cum: 22.62 mmbbl

Reservoir: DRINKARD

Gas Cum: 386.6 mmcf

Operator: CONOCO INC

Location: 8J 21S 37E

Decline = 17%

Decline = 18.2%

Hawk B-1 14 DHC: Offset Operators

Sec 8, T21S, R36E

