



NEW MEXICO ENERGY, MINERALS and NATURAL RESOURCES DEPARTMENT

BILL RICHARDSON

Governor

Joanna Prukop

Cabinet Secretary

Lori Wrotenbery

Director

Oil Conservation Division

PL
1/26/06

February 2, 2003

Mr. Frank Hernandez
EOTT Energy Pipeline, LP
PO Box 1660
Midland, TX 79703

Frank.Hernandez@eott.com

Re: Remediation Plan Approval Request:: Southland Royalty Battery Site 2003-00012
Site Reference UL- G, Sec - 9 T-21S R-37E
Environmental Plus, Inc. (EPI) Letter Date: January 17, 2003

Dear Mr. Hernandez,

The Remediation Work Plan Proposal submitted to the New Mexico Oil Conservation Division (NMOCD) by Environmental Plus, Inc. for EOTT Energy Pipeline is **hereby approved** with the following condition:

- 48 hour notification to OCD prior to all closure sampling events

Please be advised that OCD approval of this plan does not relieve EOTT Energy Pipeline, LP liability should their operations fail to adequately investigate and remediate contaminants that threaten ground water, surface water, human health or the environment. Additionally, OCD approval does not relieve EOTT Energy Pipeline, LP of responsibility for compliance with any other federal, state, or local laws and/or regulations.

If you have any questions or need assistance please feel free to call or e-mail me at (505) 393-6161, x111 or email lwjohnson@state.nm.us

Sincerely,

Larry Johnson - Environmental Engineer

Cc: Roger Anderson - Environmental Bureau Chief
Chris Williams - District I Supervisor
Bill Olson - Hydrologist
Paul Sheeley-Environmental Engineer
John Good - EPI Consultant

OK EMMIC
d J. Good
TO FRANK 2/2/03

Plains - 34053
Facility - #PAC0602639856
Incident - #PAC0602640031

Oil Conservation Division * 1625 N. French Drive * Hobbs, New Mexico 88240
Phone: (505) 393-6161 * Fax (505) 393-0720 * <http://www.emnrd.state.nm.us>

application - #PAC0603052367

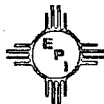

January 17, 2003

Mr. Larry Johnson
New Mexico Oil Conservation Division
1625 North French
Hobbs, New Mexico 88240

Subject: EOTT Energy Pipeline Southland Royalty Battery Site (2003-00012) Initial C-141 and Remediation Plan

Dear Mr. Johnson:

Environmental Plus, Inc. (EPI), on behalf of Mr. Frank Hernandez, EOTT Energy Pipeline L.P., submits the attached New Mexico Oil Conservation Division Form C-141 for the above referenced leak site located on land owned by the Millard Deck Estate. The release volume is estimated to be 200-bbl of crude petroleum with 160-bbl recovered. The site is located in the SW¼ of the NE¼ (Unit Letter G), Section 09, Township 21 South, and Range 37 East. The geographic location is N32°29'48.63", W103°09'52.96". The site is ~3.75 miles north-northwest (bearing 355.4°) from Eunice, Lea County, New Mexico. According to information obtained from the New Mexico Office of the State Engineer (NMOSE) database, ground water level beneath this site should be ~75-ft bgs (however, a water well located 365-ft NNW of the site was determined to be dry at a total well depth of 81-ft bgs). The site matrix ranking for this site is 10 due to the depth to ground water from lower contaminant level being between 50-ft and 100-ft.

The remedial action plan for this site is to delineate and characterize the soil contamination outside of the fenced area of the tank battery, excavate, dispose of and/or blend and attenuate on-site the RCRA non-exempt contaminated soils, and backfill the excavation with clean soil obtained on-site and/or off-site from private or public sources. The contaminated soil within the boundary of the tank battery will be manually removed to a depth of 8-12-inches, and replaced with clean, crushed caliche. Any RCRA non-exempt contaminated soils excavated and removed from the site will be disposed of in EPI's approved land farm located south of Eunice, NM.

The Constituents of Concern (CoC's) and associated NMOCD acceptable remedial levels are as follows:

- BTEX⁸⁶²⁰ (Benzene, Toluene, Ethyl Benzene, and Xylenes): 50 mg/kg
- TPH^{8015m} (Total Petroleum Hydrocarbon): 1000 mg/kg
- Benzene⁸⁶²⁰: 10 mg/kg

It is EPI's standard operating procedure to evaluate crude oil release sites for the presence of elevated levels of SO₄⁼ and Cl⁻ ions. These inorganic contaminants are often present in subsurface soils associated with sour crude releases and/or releases containing a brine component. Chloride and sulfate contamination of the soil will be evaluated relative to NMWQCC Ground Water Standards, 250 mg/ml and 600 mg/ml respectively.

If there are any questions please call Mr. Ben Miller, or myself, at our office or at (505) 390-0288 and (505) 390-9804, respectively or Mr. Frank Hernandez at (915) 638-3799. All official written communications should be addressed to:

Mr. Frank Hernandez
EOTT Energy Pipeline, L.P.
PO Box 1660
Midland, TX 79701

Sincerely,

John Good
EPI Environmental Consultant

cc: Frank Hernandez, EOTT – District Environmental Supervisor, w/enclosure
Bill Von Drehle – EOTT-Environmental Director, w/enclosure
Ben Miller, EPI Vice President and General Manager
Sherry Miller, EPI President
file

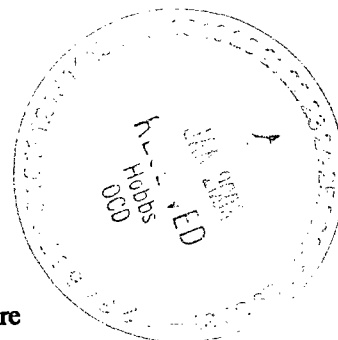

District I

1625 N. French Dr., Hobbs, NM 88240

District II

1301 W. Grand Avenue, Artesia, NM 88210

District III

1000 Rio Brazos Road, Aztec, NM 87410

District IV

1220 S. St. Francis Dr., Santa Fe, NM 87505

State of New Mexico
Energy Minerals and Natural Resources

Form C-141

Revised March 17, 1999

Oil Conservation Division
1220 South St. Francis Dr.
Santa Fe, NM 87505

Submit 2 Copies to appropriate
 District Office in accordance
 with Rule 116 on back
 side of form

Release Notification and Corrective Action

OPERATOR

☒ Initial Report ☐ Final Report

| | |
|--|---|
| Name of Company EOTT Energy Pipeline, LP | Contact Frank Hernandez |
| Address 5805 East Hwy 80 | Telephone No. 915-638-3799 |
| Facility Name Southland Royalty Battery | Facility Type 6" Crude Oil Pipeline |

| | | |
|---|----------------------------|------------------------|
| Surface Owner Millard Deck Estate | Mineral Owner NA | Lease No. NA |
|---|----------------------------|------------------------|

LOCATION OF RELEASE

| | | | | | | | | |
|-------------------------|---------------------|------------------------|---------------------|--|---------------------------------------|-----------------------------------|---------------------------------|-----------------------|
| Unit Letter G | Section 9 | Township 21S | Range 37E | Feet from South Line 3882 | Feet from West Line 3670 | Longitude W103:09:52.96 | Latitude N32:29:48.63 | County: Lea |
|-------------------------|---------------------|------------------------|---------------------|--|---------------------------------------|-----------------------------------|---------------------------------|-----------------------|

NATURE OF RELEASE

| | | |
|---|--|--|
| Type of Release Crude Oil | Volume of Release 200 bbl | Volume Recovered 160 bbl |
| Source of Release Steel Pipeline | Date and Hour of Occurrence 1/15/03-8:00 AM | Date and Hour of Discovery 1/15/03-9:00 AM |
| Was Immediate Notice Given? <input checked="" type="checkbox"/> Yes <input type="checkbox"/> No <input type="checkbox"/> Not Required | If YES, To Whom? Larry Johnson - Hobbs NMOCD | |
| By Whom? John Good - EPI | Date and Hour 1/15/03-9:30 AM | |
| Was a Watercourse Reached? <input type="checkbox"/> Yes <input checked="" type="checkbox"/> No | If YES, Volume Impacting the Watercourse. NA | |
| If a Watercourse was Impacted, Describe Fully.* NA | | |
| Describe Cause of Problem and Remedial Action Taken.* Corroded pipeline, repaired with clamp | | |
| Describe Area Affected and Cleanup Action Taken.* ~11600-ft² surface area affected; 200-bbl released; 160-bbl of crude recovered. Removal and disposal of contaminated soil above remedial goals was commenced by EPI. | | |

I hereby certify that the information given above is true and complete to the best of my knowledge and understand that pursuant to NMOCD rules and regulations all operators are required to report and/or file certain release notifications and perform corrective actions for releases which may endanger public health or the environment. The acceptance of a C-141 report by the NMOCD marked as "Final Report" does not relieve the operator of liability should their operations have failed to adequately investigate and remediate contamination that pose a threat to ground water, surface water, human health or the environment. In addition, NMOCD acceptance of a C-141 report does not relieve the operator of responsibility for compliance with any other federal, state, or local laws and/or regulations.

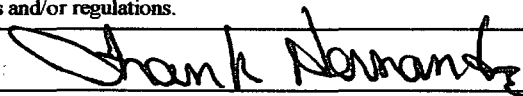
| | | |
|--|----------------------------------|-----------------------------------|
| Signature:  | OIL CONSERVATION DIVISION | |
| Printed Name: Frank Hernandez | Approved by District Supervisor: | |
| Title: District Environmental Supervisor | Approval Date: | Expiration Date: |
| Date: 1/16/03 Phone: 915-638-3799 | Conditions of Approval: | <input type="checkbox"/> Attached |

Attach Additional Sheets If Necessary

EOTT Energy Pipeline, LP**Site Information and Metrics****Incident Date and NMOCD Notified?**

1/15/03-9:00 AM

1/15/03-9:30 AM

| | | | |
|---|-----------------------|--|----------|
| SITE: Southland Royalty Battery | | Assigned Site Reference #: 2003-00012 | |
| Company: EOTT Energy Pipeline, LP | | | |
| Street Address: 5805 East Hwy 80 | | | |
| Mailing Address: PO Box 1660 | | | |
| City, State, Zip: Midland, TX 79701 | | | |
| Representative: Frank Hernandez | | | |
| Representative Telephone: 915-638-3799 | | | |
| Telephone: | | | |
| Fluid volume released (bbls): 200 | Recovered (bbls): 160 | | |
| >25 bbls: Notify NMOCD verbally within 24 hrs and submit form C-141 within 15 days. | | | |
| 5-25 bbls: Submit form C-141 within 15 days (Also applies to unauthorized releases of 50-500 mcf Natural Gas) | | | |
| Leak, Spill, or Pit (LSP) Name: 2003-00012 | | | |
| Source of contamination: Steel Pipeline | | | |
| Land Owner, i.e., BLM, ST, Fee, Other: Millard Deck Estate | | C/O Harding & Carbone, Inc., 3903 Belair Blvd, Houston, TX 77025 | |
| LSP Dimensions: (see attached site diagram) | | | |
| LSP Area: 11630 -ft ² | | | |
| Location of Reference Point (RP): | | | |
| Location distance and direction from RP: | | | |
| Latitude: N32:29:48.63 | | | |
| Longitude: W103:09:52.96 | | | |
| Elevation above mean sea level: 3474 -ft amsl | | | |
| Feet from South Section Line: 3882 | | | |
| Feet from West Section Line: 3670 | | | |
| Location - Unit or 1/4 1/4: UL- G | | SW 1/4 of NE 1/4 | |
| Location - Section: 9 | | | |
| Location - Township: 21S | | | |
| Location - Range: 37E | | | |
| Surface water body within 1000' radius of Site: 0 | | | |
| Surface water body within 1000' radius of Site: 0 | | | |
| Domestic water wells within 1000' radius of Site: 0 | | | |
| Domestic water wells within 1000' radius of Site: 0 | | | |
| Agricultural water wells within 1000' radius of Site: 0 | | | |
| Agricultural water wells within 1000' radius of Site: 0 | | | |
| Public water supply wells within 1000' radius of Site: 0 | | | |
| Public water supply wells within 1000' radius of Site: 0 | | | |
| Depth (ft) from land surface to ground water (DG): 81 | | (greater than) | |
| Depth (ft) of contamination (DC): 10 | | | |
| Depth (ft) to ground water (DG - DC = DtGW): 71 | | | |
| 1. Ground Water | | 2. Wellhead Protection Area | |
| If Depth to GW <50 feet: 20 points | | If <1000' from water source, or, <200' from private domestic water source: 20 points | |
| If Depth to GW 50 to 99 feet: 10 points | | If >1000' from water source, or, >200' from private domestic water source: 0 points | |
| If Depth to GW >100 feet: 0 points | | | |
| Ground water Score: 10 | | Wellhead Protection Area Score: 0 | |
| Site Rank (1+2+3) = 10 | | Surface Water Score: 0 | |
| Total Site Ranking Score and Acceptable Concentrations | | | |
| Parameter | 20 or > | 10 | 0 |
| Benzene ¹ | 10 ppm | 10 ppm | 10 ppm |
| BTEX ¹ | 50 ppm | 50 ppm | 50 ppm |
| TPH | 100 ppm | 1000 ppm | 5000 ppm |

¹100 ppm field VOC headspace measurement may be substituted for lab analysis

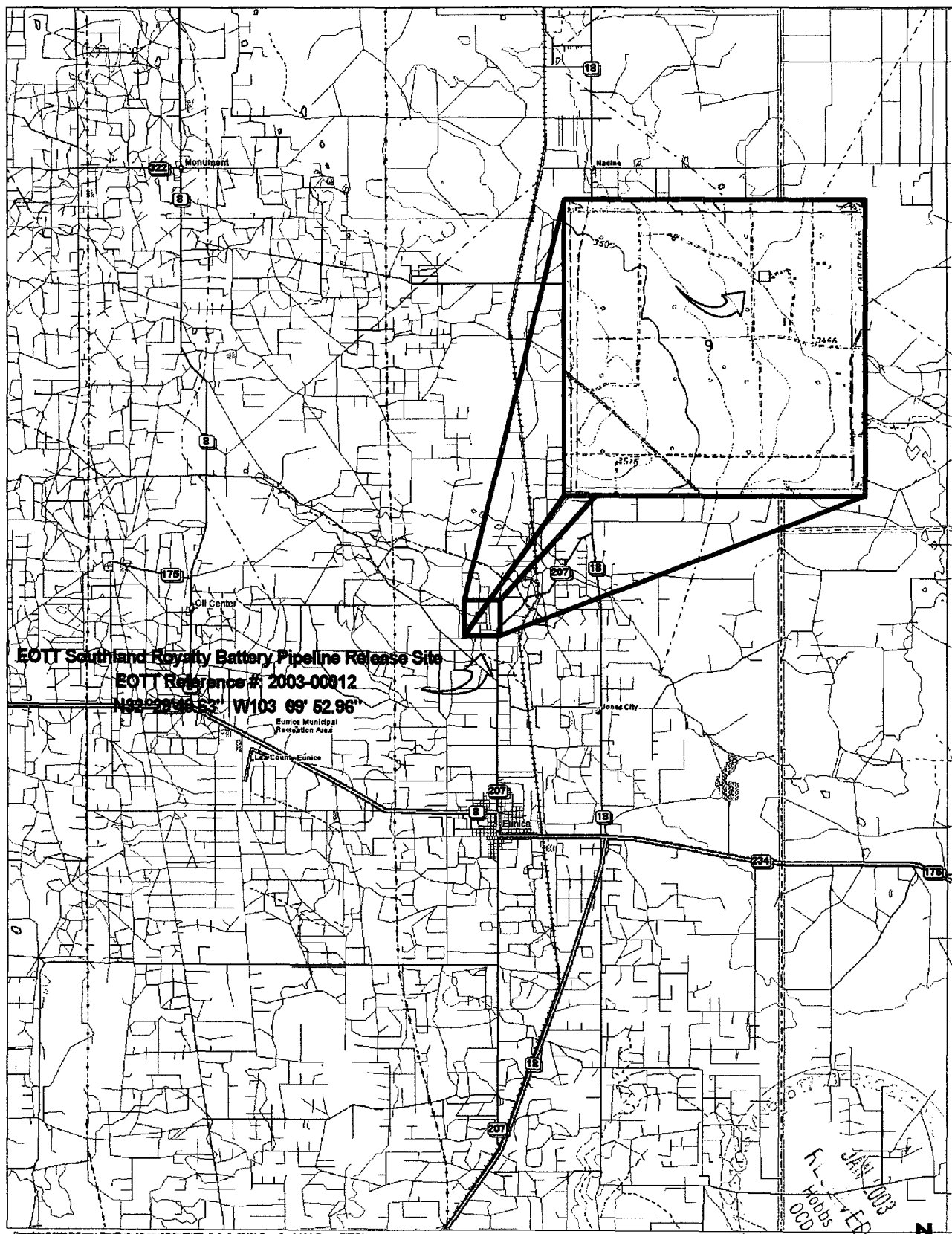
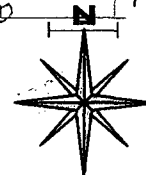

Plate 1: Release Site Location

EOTT Energy Pipeline, LP - Southland Royalty Battery (2003-00012)
Lea County, NM; UL-G Section 09 T21S R37E



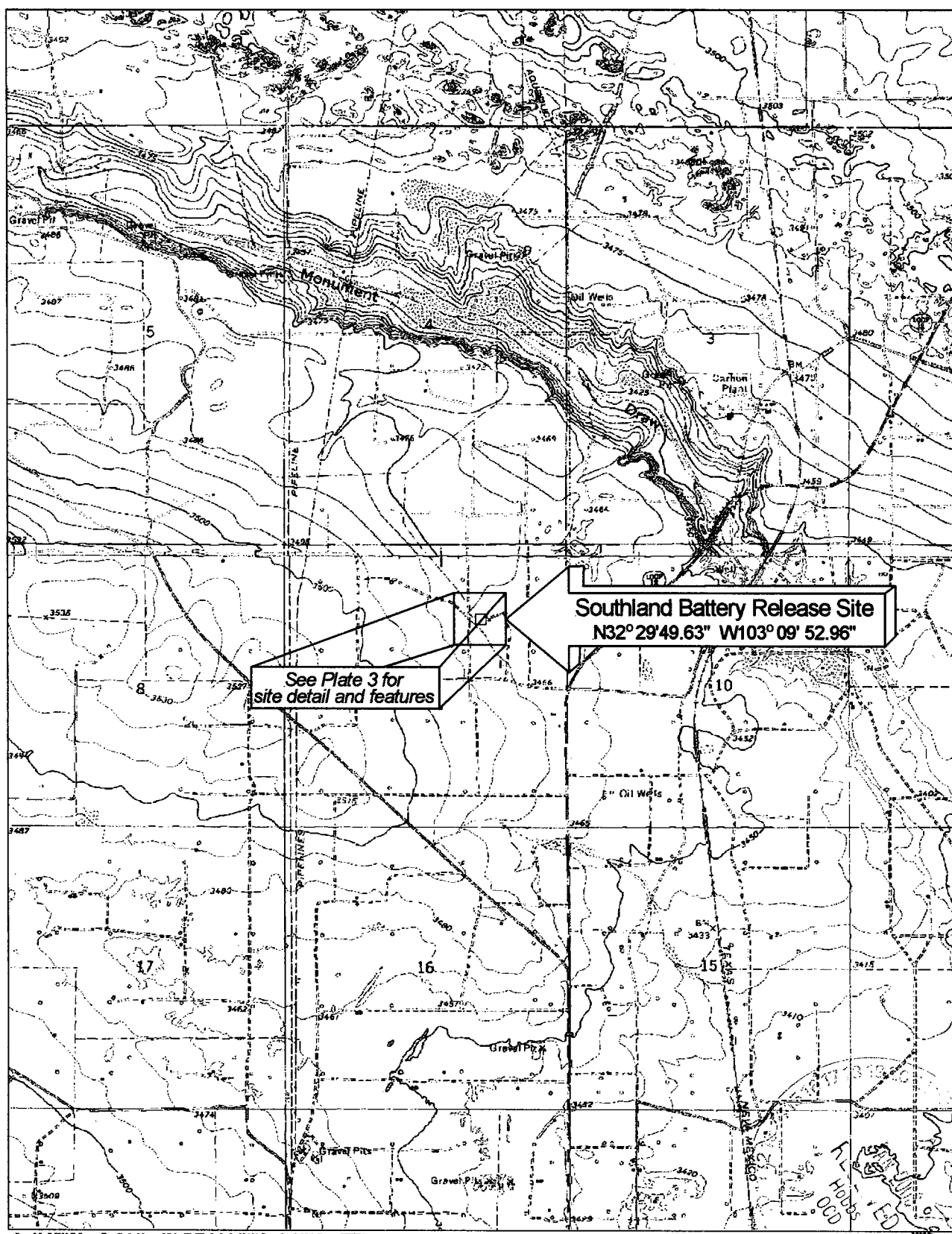
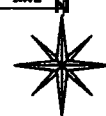

Plate 2: Site Topography and Release Location

EOTT Energy Pipeline, LP - Southland Royalty Battery (2003-00012)
Lea County, NM; UL-G Section 09 T21S R37E



Abandoned Water Well
(dry @ 81' bgs)
365-ft; bearing 296 deg

Water Well and Storage Tank
570-ft; bearing 78.5 deg

Fencing (around battery)

Point of Release (POR)

Spill Affected Area
~ 11,630-ft²

Stock Pond
500-ft; bearing 105 deg

Temporary Fencing (site security)

Scale: 1-inch = 38.66-feet



Plate 3: Initial Response GPS Demarcation
EOTT Energy Pipeline, LP - Southland Royalty Battery 010503; REF: 2003-00012
Lea County, NM; UL-G Section 09 T21S R37E

Drawn By: JCG Date: JAN-03 Revised

