



PC  
1/24/06

FOR INFO ONLY

NOT REPORTABLE QUANTITY

February 24, 2004

Mr. Larry Johnson  
New Mexico Oil Conservation Division  
1625 North French  
Hobbs, New Mexico 88240

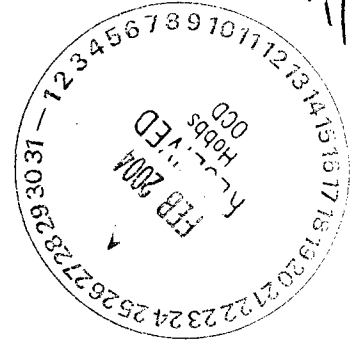

Subject: LINK Energy B.J. Barber 4" Gathering (2004-00069) Initial C-141

Dear Mr. Johnson:

Environmental Plus, Inc. (EPI), on behalf of Mr. Frank Hernandez, LINK Energy LLC, submits the attached New Mexico Oil Conservation Division Form C-141 for the above referenced leak site located on land owned by Mr. Jimmy Cooper. The release volume is estimated to be 4-bbl of crude petroleum with 0-bbl recovered. The release site is located in the SW $\frac{1}{4}$  of the NE $\frac{1}{4}$  (Unit Letter G), Section 8, Township 20 South, and Range 37 East. The geographic location is N32° 35' 28.43"; W103° 16' 19.03". The site is ~2.3 miles south-southwest (bearing 190.1°) from Monument, Lea County, New Mexico. According to information obtained from the New Mexico Bureau of Geology and Mineral Resources (New Mexico Tech University) database, ground water level beneath this site is ~27-ft bgs. The site matrix ranking for this site is 20 due to the depth to ground water from the lower contaminant level being <50-ft.

The remedial action plan for this site is to delineate and characterize the soil contamination within the surface extents of the release, excavate, dispose of and/or blend and attenuate on-site the RCRA non-exempt contaminated soils, and backfill the excavation with clean soil obtained on-site and/or off-site from private or public sources. Any contaminated soils removed from the site will be disposed of in an NMOCD approved surface waste treatment facility.

The Constituents of Concern (CoC's) and associated NMOCD acceptable remedial levels are as follows:

- BTEX<sup>8620</sup> (Benzene, Toluene, Ethyl Benzene, and Xylenes): 50 mg/kg
- TPH<sup>8015m</sup> (Total Petroleum Hydrocarbon): 100 mg/kg
- Benzene<sup>8620</sup>: 10 mg/kg

It is EPI's policy to evaluate crude oil release sites for the potential presence of elevated levels of SO<sub>4</sub><sup>-</sup> and Cl<sup>-</sup> ions. These inorganic constituents are often present

Plains - 34053  
facility - FPAC 0602438780  
incident - FPAC 0602438966  
application - FPAC 0603131422

ENVIRONMENTAL PLUS, INC.



in subsurface soils associated with sour crude releases and/or releases containing a brine component. Chloride and sulfate contamination of the soil will be evaluated relative to NMWQCC Ground Water Standards, 250 mg/ml and 600 mg/ml respectively.

If there are any questions please call Mr. Ben Miller, or myself, at our office or at (505) 390-0288 and (505) 390-9804, respectively or Mr. Frank Hernandez at (505) 631-3095. All official written communications should be addressed to:

Mr. Frank Hernandez  
EOTT Energy Pipeline, L.P.  
PO Box 1660  
Midland, TX 79701

Sincerely,

John Good  
EPI Environmental Consultant

cc: Frank Hernandez, LINK Energy – Dist Environmental Supv., w/enclosure  
Jeff Dann – LINK Energy - Environmental Specialist, w/enclosure  
Ben Miller, EPI Vice President and General Manager  
Pat McCasland, EPI Technical Manager  
Sherry Miller, EPI President  
file

ENVIRONMENTAL PLUS, INC.

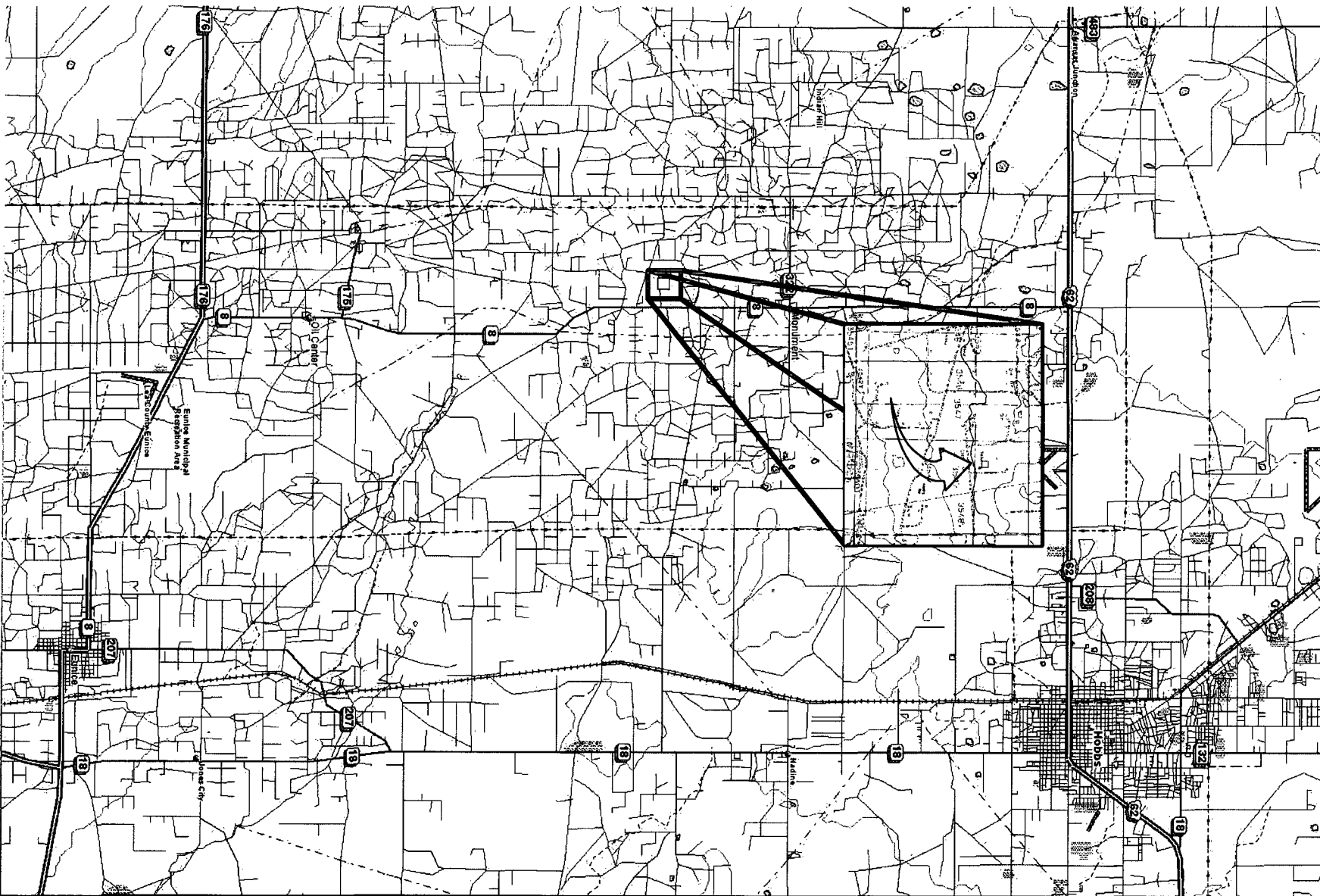

Plate 1: Site Location  
 LINK Energy LLC: 2004-00069  
 BJ Barber 4" Gathering Line

Lea County, New Mexico  
 UL-G Section 8 T20S R37E  
 N32° 35' 28.43" W103° 16' 19.03"  
 Elevation: 3556-ft amsl

DWG BY: John Good  
 Feb - 2004

REVISED:

SCALE:  
 0 Miles 5

SHEET  
 1 of 1



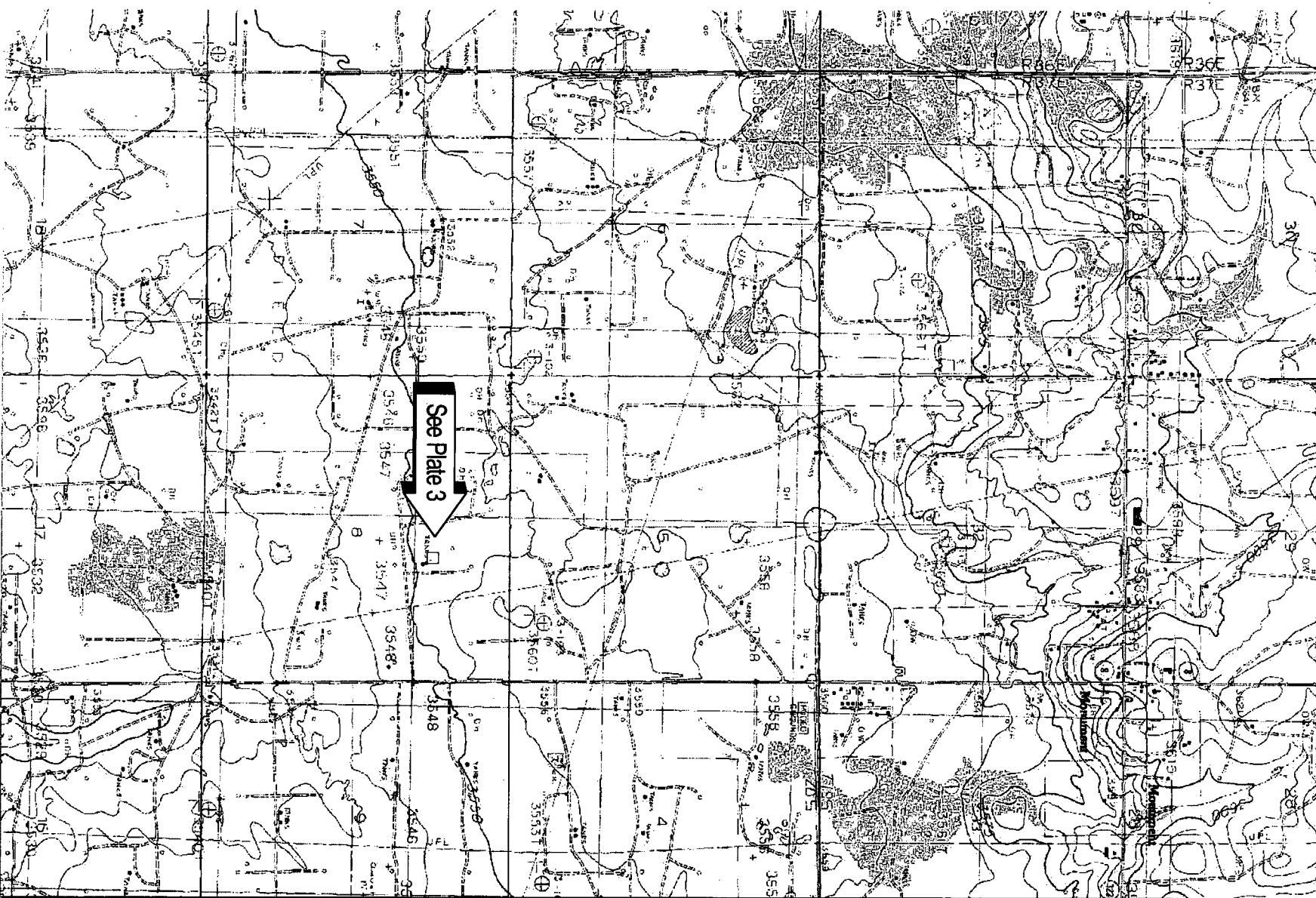

See Plate 3

Plate 2: Site Topography  
LINK Energy LLC: 2004-00069  
BJ Barber 4" Gathering Line

Lea County, New Mexico  
UL-G Section 8 T20S R37E  
N32° 35' 28.42" W103° 16' 19.03"  
Elevation: 3556-ft amsl

DWG BY: John Good  
Feb - 2004

REVISED:

SCALE:  
0 1  
Mile



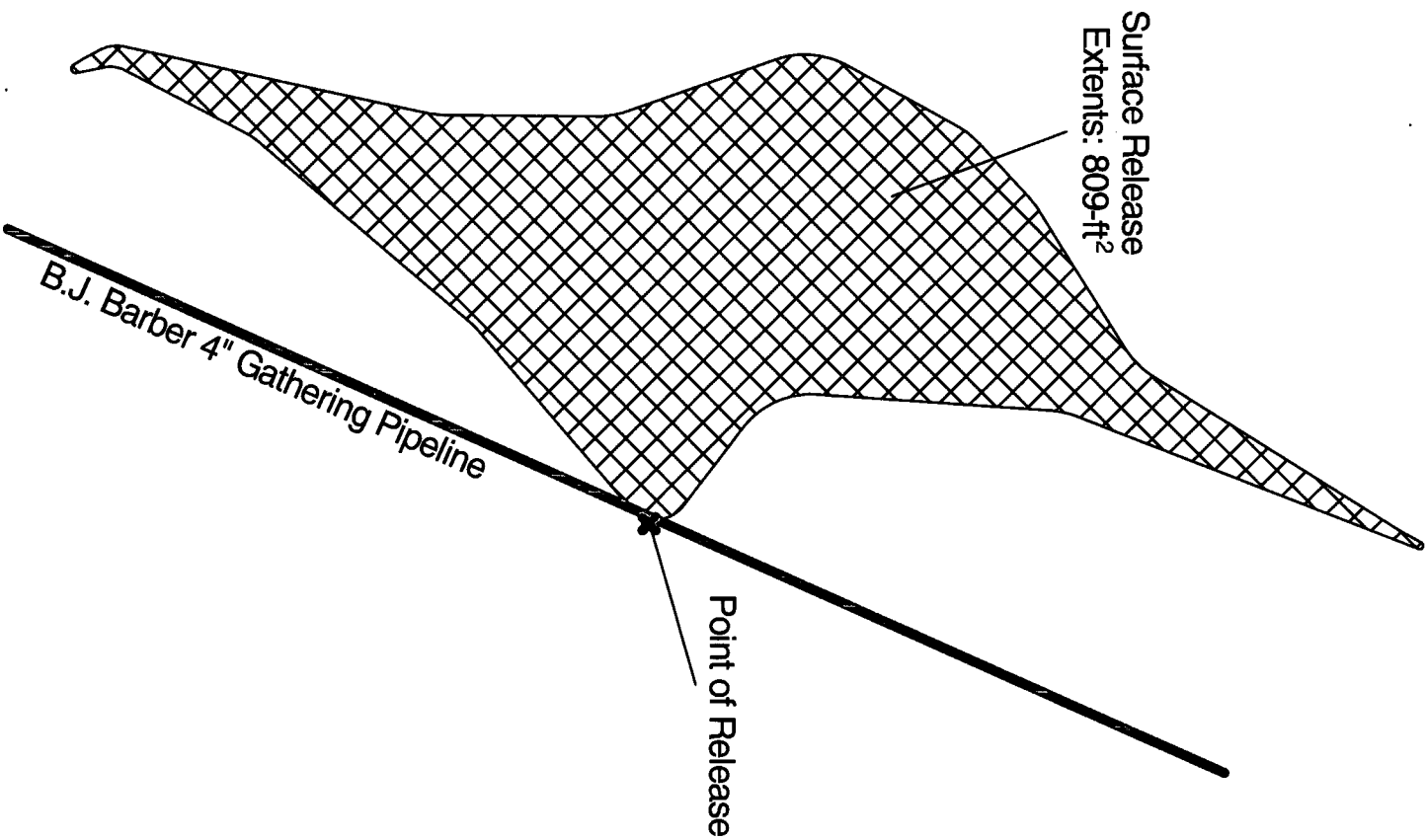

<p>Plate 3 - Initial GPS Demarcation LINK Energy LLC: 2004-00069 BJ Barber 4" Gathering Line</p>	<p>Lea County, New Mexico UL-G Section 8 T20S R37E N32° 35' 28.43" W103° 16' 19.03" Elevation: 3556-ft amsl</p>	<table><tr><td>DWG BY: John Good Feb - 2004</td><td>REVISED:</td></tr><tr><td colspan="2">SCALE: </td></tr></table>	DWG BY: John Good Feb - 2004	REVISED:	SCALE: 		
DWG BY: John Good Feb - 2004	REVISED:						
SCALE: 							

District I

1625 N. French Dr., Hobbs, NM 88240

District II

1301 W. Grand Avenue, Artesia, NM 88210

District III

1000 Rio Brazos Road, Aztec, NM 87410

District IV

1220 S. St. Francis Dr., Santa Fe, NM 87505

**State of New Mexico**  
**Energy Minerals and Natural Resources**

**Oil Conservation Division**  
**1220 South St. Francis Dr.**  
**Santa Fe, NM 87505**

Form C-141

Revised March 17, 1999

Submit 2 Copies to appropriate

District Office in accordance

with Rule 116 on back

side of form

## Release Notification and Corrective Action -- INFORMATION ONLY

**OPERATOR**☒ Initial Report    ☐ Final Report

Name of Company <b>Link Energy LLC</b>	Contact <b>Frank Hernandez</b>
Address <b>P.O. Box 1660                      Midland, TX 79702</b>	Telephone No. <b>(505) 631-3095</b>
Facility Name <b>BJ Barber 4" Gathering Pipeline</b>	Facility Type <b>Crude Oil Gathering Pipeline</b>

Surface Owner <b>Jimmy Cooper</b>	Mineral Owner <b>NA</b>	Lease No. <b>NA</b>
--------------------------------------	----------------------------	------------------------

**LOCATION OF RELEASE**

Unit Letter <b>G</b>	Section <b>8</b>	Township <b>20S</b>	Range <b>37E</b>	Feet from South Line <b>3964</b>	Feet from West Line <b>3150</b>	Longitude <b>W103° 16' 19.03"</b>	Latitude <b>N32° 35' 28.43"</b>	County: <b>Lea</b>
-------------------------	---------------------	------------------------	---------------------	--	---------------------------------------	--------------------------------------	------------------------------------	-----------------------

**NATURE OF RELEASE**

Type of Release <b>Crude Oil Release and associated components</b>	Volume of Release <b>4 bbl</b>	Volume Recovered <b>0 bbl</b>
Source of Release <b>4" Steel Pipeline</b>	Date and Hour of Occurrence <b>2/20/04 4:15 PM</b>	Date and Hour of Discovery <b>2/20/04 4:30 PM</b>
Was Immediate Notice Given? <input checked="" type="checkbox"/> Yes <input type="checkbox"/> No <input checked="" type="checkbox"/> Not Required	If YES, To Whom? <b>NMOCD-Hobbs: Recorded Message</b>	
By Whom? <b>Frank Hernandez - Link</b>	Date and Hour <b>02/20/04</b>	
Was a Watercourse Reached? <input type="checkbox"/> Yes <input checked="" type="checkbox"/> No	If YES, Volume Impacting the Watercourse. <b>NA</b>	
If a Watercourse was Impacted, Describe Fully.* <b>NA</b>		
Describe Cause of Problem and Remedial Action Taken.* <b>Internal Corrosion - repaired with clamp</b>		
Describe Area Affected and Cleanup Action Taken.* <b>809-ft<sup>2</sup> surface area affected; 4-bbl of product released, 0 recovered; RCRA Non-Exempt Non-hazardous saturated surface soil was excavated and disposed of by EPI.</b>		

I hereby certify that the information given above is true and complete to the best of my knowledge and understand that pursuant to NMOCD rules and regulations all operators are required to report and/or file certain release notifications and perform corrective actions for releases which may endanger public health or the environment. The acceptance of a C-141 report by the NMOCD marked as "Final Report" does not relieve the operator of liability should their operations have failed to adequately investigate and remediate contamination that pose a threat to ground water, surface water, human health or the environment. In addition, NMOCD acceptance of a C-141 report does not relieve the operator of responsibility for compliance with any other federal, state, or local laws and/or regulations.

Signature: 	<b><u>OIL CONSERVATION DIVISION</u></b>	
Printed Name: <b>Frank Hernandez</b>	Approved by District Supervisor:	
Title: <b>District Environmental Supv.</b>	Approval Date:	Expiration Date:
E-Mail: <b>frank.hernandez@eott.com</b>	Conditions of Approval: <input type="checkbox"/> Attached.	
Date: <b>2/24/04</b> Phone: <b>(505) 631-3095</b>		



## Incident Date and NMOCD Notified?

2/20/04

02/20/04

SITE: BJ Barber 4" Gathering Pipeline		Assigned Site Reference 2004-00069	
Company: Link Energy LLC			
Street Address: 5805 East Highway 80			
Mailing Address: P.O. Box 1660			
City, State, Zip: Midland, TX 79702			
Representative: Frank Hernandez			
Representative Telephone: (505) 631-3095			
Telephone:			
Fluid volume released (bbls): 4		Recovered (bbls): 0	
>25 bbls: Notify NMOCD verbally within 24 hrs and submit form C-141 within 15 days.			
5-25 bbls: Submit form C-141 within 15 days (Also applies to unauthorized releases of 50-500 mcf Natural Gas)			
Leak, Spill, or Pit (LSP) Name: 2004-00069			
Source of contamination: 4" Steel Pipeline			
Land Owner, i.e., BLM, ST, Fee, Other: Jimmy Cooper		Monument, NM 88230	
LSP Dimensions: 70 x 25 (see Plate 3, Attachments)			
LSP Area: 809 -ft <sup>2</sup>			
Location of Reference Point (RP):			
Location distance and direction from RP:			
Latitude: N32° 35' 28.43"			
Longitude: W103° 16' 19.03"			
Elevation above mean sea level: 3556 -ft amsl			
Feet from South Section Line: 3964			
Feet from West Section Line: 3150			
Location - Unit and 1/4 1/4: UL- G		SW 1/4 of NE 1/4	
Location - Section: 8			
Location - Township: 20S			
Location - Range: 37E			
Surface water body within 1000' radius of Site: 0			
Surface water body within 1000' radius of Site: 0			
Domestic water wells within 1000' radius of Site: 0			
Domestic water wells within 1000' radius of Site: 0			
Agricultural water wells within 1000' radius of Site: 0			
Agricultural water wells within 1000' radius of Site: 0			
Public water supply wells within 1000' radius of Site: 0			
Public water supply wells within 1000' radius of Site: 0			
Depth (ft) from land surface to ground water (DG): 27			
Depth (ft) of contamination (DC): 3			
Depth (ft) to ground water (DG - DC = DtGW): 24			
<b>1. Ground Water</b>		<b>2. Wellhead Protection Area</b>	
If Depth to GW <50 feet: 20 points		If <1000' from water source, or, <200' from private domestic water source: 20 points	
If Depth to GW 50 to 99 feet: 10 points		If >1000' from water source, or, >200' from private domestic water source: 0 points	
If Depth to GW >100 feet: 0 points			
Ground water Score: 20		Wellhead Protection Area Score: 0	
Site Rank (1+2+3) = 20		Surface Water Score: 0	
<b>Total Site Ranking Score and Acceptable Concentrations</b>			
Parameter	20 or >	10	0
Benzene <sup>1</sup>	10 ppm	10 ppm	10 ppm
BTEX <sup>1</sup>	50 ppm	50 ppm	50 ppm
TPH	100 ppm	1000 ppm	5000 ppm

<sup>1</sup>100 ppm field VOC headspace measurement may be substituted for lab analysis

