

ABOVE THIS LINE FOR DIVISION USE ONLY 3637

NEW MEXICO OIL CONSERVATION DIVISION

- Engineering Bureau -

1220 South St. Francis Drive, Santa Fe, NM 87505



ADMINISTRATIVE APPLICATION CHECKLIST

THIS CHECKLIST IS MANDATORY FOR ALL ADMINISTRATIVE APPLICATIONS FOR EXCEPTIONS TO DIVISION RULES AND REGULATIONS WHICH REQUIRE PROCESSING AT THE DIVISION LEVEL IN SANTA FE

Application Acronyms:

- [NSL-Non-Standard Location] [NSP-Non-Standard Proration Unit] [SD-Simultaneous Dedication]
- [DHC-Downhole Commingling] [CTB-Lease Commingling] [PLC-Pool/Lease Commingling]
- [PC-Pool Commingling] [OLS - Off-Lease Storage] [OLM-Off-Lease Measurement]
- [WFX-Waterflood Expansion] [PMX-Pressure Maintenance Expansion]
- [SWD-Salt Water Disposal] [IPI-Injection Pressure Increase]
- [EOR-Qualified Enhanced Oil Recovery Certification] [PPR-Positive Production Response]

[1] TYPE OF APPLICATION - Check Those Which Apply for [A]

- [A] Location - Spacing Unit - Simultaneous Dedication
- ☐ NSL ☐ NSP ☐ SD

Check One Only for [B] or [C]

- [B] Commingling - Storage - Measurement
- ☒ DHC ☐ CTB ☐ PLC ☐ PC ☐ OLS ☐ OLM

- [C] Injection - Disposal - Pressure Increase - Enhanced Oil Recovery
- ☐ WFX ☐ PMX ☐ SWD ☐ IPI ☐ EOR ☐ PPR

- [D] Other: Specify _____

[2] NOTIFICATION REQUIRED TO: - Check Those Which Apply, or ☐ Does Not Apply

- [A] ☐ Working, Royalty or Overriding Royalty Interest Owners
- [B] ☐ Offset Operators, Leaseholders or Surface Owner
- [C] ☐ Application is One Which Requires Published Legal Notice
- [D] ☐ Notification and/or Concurrent Approval by BLM or SLO
U.S. Bureau of Land Management - Commissioner of Public Lands, State Land Office
- [E] ☐ For all of the above, Proof of Notification or Publication is Attached, and/or,
- [F] ☐ Waivers are Attached

[3] SUBMIT ACCURATE AND COMPLETE INFORMATION REQUIRED TO PROCESS THE TYPE OF APPLICATION INDICATED ABOVE.

[4] CERTIFICATION: I hereby certify that the information submitted with this application for administrative approval is accurate and complete to the best of my knowledge. I also understand that no action will be taken on this application until the required information and notifications are submitted to the Division.

Note: Statement must be completed by an individual with managerial and/or supervisory capacity.

Print or Type Name _____ Signature _____ Title _____ Date _____

e-mail Address _____

Federal

District I

1625 N. French Drive, Hobbs, NM 88240

District II

1301 W. Grand Avenue, Artesia, NM 88210

District III

1000 Rio Brazos Road, Aztec, NM 87410

District IV

1220 S. St. Francis Dr., Santa Fe, NM 87505

State of New Mexico
Energy, Minerals and Natural Resources DepartmentForm C-107A
Revised June 10, 2003**Oil Conservation Division**1220 South St. Francis Dr.
Santa Fe, New Mexico 87505

APPLICATION TYPE

☒ Single Well☐ Establish Pre-Approved Pools

EXISTING WELLBORE

☒ Yes ☐ No**APPLICATION FOR DOWNHOLE COMMINGLING**

Burlington Resources Oil & Gas Company LP

P.O.Box 4289 Farmington, NM 87499

Operator

Address

SAN JUAN 29-7 UNIT 102R

Unit K, Sec. 015, 029N, 007W

RIO ARRIBA

Lease

Well No.

Unit Letter-Section-Township-Range

County

OGRID No: 14538 Property Code 7465 API No. 30039205140000 Lease Type: ☒ Federal ☐ State ☐ Fee

| DATA ELEMENT | UPPER ZONE | INTERMEDIATE ZONE | LOWER ZONE |
|--|--|--|--|
| Pool Name | <u>FRUITLAND COAL</u> | <u>PICTURED CLIFFS</u> | <u>MESAVERDE</u> |
| Pool Code | 71629 | 72359 | 72319 |
| Top and Bottom of Pay Section (Perforated or Open-Hole Interval) | WILL BE SUPPLIED UPON COMPLETION | WILL BE SUPPLIED UPON COMPLETION | 3873-5570' |
| Method of Production (Flowing or Artificial Lift) | NEW ZONE | NEW ZONE | FLOWING |
| Bottomhole Pressure (Note: Pressure data will not be required if the bottom perforation in the lower zone is within 150% of the depth of the top perforation in the upper zone) | Original - 1151 psi Current - 1000 psi (Offset SJ 29-7 Unit 176) | Original - 837 psi Current - 550 psi (Offset SJ 29-7 Unit 176) | Original - 1121 psi Current - 553 psi |
| Oil Gravity or Gas BTU (Degree API or Gas BTU) | BTU 1062 | BTU 1062 | BTU 1221 |
| Producing, Shut-In or New Zone | NEW ZONE | NEW ZONE | PRODUCING |
| Date and Oil/Gas/Water Rates of Last Production. (Note: For new zones with no production history, applicant shall be required to attach production estimates and supporting data.) | Date: N/A Rates: see attachment | Date: N/A Rates: see attachment | Date: Jan 2006 Rates: 319 MCFD |
| Fixed Allocation Percentage (Note: If allocation is based upon something other than current or past production, supporting data or explanation will be required.) | Oil Gas Will be supplied upon completion | Oil Gas Will be supplied upon completion | Oil Gas Will be supplied upon completion |

ADDITIONAL DATAAre all working, royalty and overriding royalty interests identical in all commingled zones?
If not, have all working, royalty and overriding royalty interest owners been notified by certified mail?Yes ☐ No ☒
Yes ☒ No ☐

Are all produced fluids from all commingled zones compatible with each other?

Yes ☒ No ☐

Will commingling decrease the value of production?

Yes ☐ No ☒If this well is on, or communitized with, state or federal lands, has either the Commissioner of Public Lands
or the United States Bureau of Land Management been notified in writing of this application?Yes ☒ No ☐NMOCD Reference Case No. applicable to this well: R-10697. no partner notification needed per order

Attachments:

- C-102 for each zone to be commingled showing its spacing unit and acreage dedication.
- Production curve for each zone for at least one year. (If not available, attach explanation.)
- For zones with no production history, estimated production rates and supporting data.
- Data to support allocation method or formula.
- Notification list of working, royalty and overriding royalty interests for uncommon interest cases.
- Any additional statements, data or documents required to support commingling.

PRE-APPROVED POOLS

If application is to establish Pre-Approved Pools, the following additional information will be required:

- List of other orders approving downhole commingling within the proposed Pre-Approved Pools
- List of all operators within the proposed Pre-Approved Pools
- Proof that all operators within the proposed Pre-Approved Pools were provided notice of this application.
- Bottomhole pressure data.

I hereby certify that the information above is true and complete to the best of my knowledge and belief.

SIGNATURE Cory McKee TITLE Engineer DATE 2/3/06TYPE OR PRINT NAME Cory McKee, Engineer TELEPHONE NO. (505) 326-9700E-MAIL ADDRESS cmckee@br-inc.com

San Juan 29-7 Unit 53
Bottom Hole Pressures
Flowing and Static BHP
Cullender and Smith Method
Version 1.0 1/14/98

| FRUITLAND COAL | | PICTURED CLIFFS | |
|--------------------------------|---------|--------------------------------|---------|
| <u>FC-Current</u> | | <u>PC-Current</u> | |
| GAS GRAVITY | 0 | GAS GRAVITY | 0 |
| COND. OR MISC. (C/M) | C | COND. OR MISC. (C/M) | C |
| %N2 | 0 | %N2 | 0.00 |
| %CO2 | 0 | %CO2 | 0 |
| %H2S | 0 | %H2S | 0 |
| DIAMETER (IN) | 0 | DIAMETER (IN) | 0 |
| DEPTH (FT) | 0 | DEPTH (FT) | 0 |
| SURFACE TEMPERATURE (DEG F) | 0 | SURFACE TEMPERATURE (DEG F) | 0 |
| BOTTOMHOLE TEMPERATURE (DEG F) | 0 | BOTTOMHOLE TEMPERATURE (DEG F) | 0 |
| FLOWRATE (MCFPD) | 0 | FLOWRATE (MCFPD) | 0 |
| SURFACE PRESSURE (PSIA) | 0 | SURFACE PRESSURE (PSIA) | 0 |
| BOTTOMHOLE PRESSURE (PSIA) | #DIV/0! | BOTTOMHOLE PRESSURE (PSIA) | #DIV/0! |
| <u>FC-Original</u> | | <u>PC-Original</u> | |
| GAS GRAVITY | 0.633 | GAS GRAVITY | 0.633 |
| COND. OR MISC. (C/M) | C | COND. OR MISC. (C/M) | C |
| %N2 | 0.0339 | %N2 | 0.03 |
| %CO2 | 0.007 | %CO2 | 0.007 |
| %H2S | 0 | %H2S | 0 |
| DIAMETER (IN) | 2.875 | DIAMETER (IN) | 1.25 |
| DEPTH (FT) | 3458.5 | DEPTH (FT) | 3648 |
| SURFACE TEMPERATURE (DEG F) | 60 | SURFACE TEMPERATURE (DEG F) | 60 |
| BOTTOMHOLE TEMPERATURE (DEG F) | 98.58 | BOTTOMHOLE TEMPERATURE (DEG F) | 100.7 |
| FLOWRATE (MCFPD) | 0 | FLOWRATE (MCFPD) | 0 |
| SURFACE PRESSURE (PSIA) | 1050 | SURFACE PRESSURE (PSIA) | 764 |
| BOTTOMHOLE PRESSURE (PSIA) | 1150.5 | BOTTOMHOLE PRESSURE (PSIA) | 837.2 |

San Juan 29-7 Unit 53
Bottom Hole Pressures
Flowing and Static BHP
Cullender and Smith Method
Version 1.0 1/14/98

| MESAVERDE | | | |
|--------------------------------|---------|--------------------------------|------|
| <u>MV-Current</u> | | <u>Current</u> | |
| GAS GRAVITY | 0 | GAS GRAVITY | 0 |
| COND. OR MISC. (C/M) | C | COND. OR MISC. (C/M) | C |
| %N2 | 0 | %N2 | 0.00 |
| %CO2 | 0 | %CO2 | 0 |
| %H2S | 0 | %H2S | 0 |
| DIAMETER (IN) | 0 | DIAMETER (IN) | 0 |
| DEPTH (FT) | 0 | DEPTH (FT) | 0 |
| SURFACE TEMPERATURE (DEG F) | 60 | SURFACE TEMPERATURE (DEG F) | 60 |
| BOTTOMHOLE TEMPERATURE (DEG F) | 0 | BOTTOMHOLE TEMPERATURE (DEG F) | 0 |
| FLOWRATE (MCFPD) | 0 | FLOWRATE (MCFPD) | 0 |
| SURFACE PRESSURE (PSIA) | 0 | SURFACE PRESSURE (PSIA) | 0 |
| BOTTOMHOLE PRESSURE (PSIA) | #DIV/0! | BOTTOMHOLE PRESSURE (PSIA) | 0.0 |

| <u>MV-Original</u> | | <u>Original</u> | |
|--------------------------------|--------|--------------------------------|------|
| GAS GRAVITY | 0.706 | GAS GRAVITY | 0 |
| COND. OR MISC. (C/M) | C | COND. OR MISC. (C/M) | C |
| %N2 | 0.0024 | %N2 | 0.00 |
| %CO2 | 0.0097 | %CO2 | 0 |
| %H2S | 0 | %H2S | 0 |
| DIAMETER (IN) | 2.375 | DIAMETER (IN) | 0 |
| DEPTH (FT) | 5193 | DEPTH (FT) | 0 |
| SURFACE TEMPERATURE (DEG F) | 60 | SURFACE TEMPERATURE (DEG F) | 0 |
| BOTTOMHOLE TEMPERATURE (DEG F) | 144 | BOTTOMHOLE TEMPERATURE (DEG F) | 0 |
| FLOWRATE (MCFPD) | 0 | FLOWRATE (MCFPD) | 0 |
| SURFACE PRESSURE (PSIA) | 968 | SURFACE PRESSURE (PSIA) | 0 |
| BOTTOMHOLE PRESSURE (PSIA) | 1121.1 | BOTTOMHOLE PRESSURE (PSIA) | 0.0 |

District I

1625 N. French Dr., Hobbs, NM 88240
Phone:(505) 393-6161 Fax:(505) 393-0720

District II

1301 W. Grand Ave., Artesia, NM 88210
Phone:(505) 748-1283 Fax:(505) 748-9720

District III

1000 Rio Brazos Rd., Aztec, NM 87410
Phone:(505) 334-6178 Fax:(505) 334-6170

District IV

1220 S. St Francis Dr., Santa Fe, NM 87505
Phone:(505) 476-3470 Fax:(505) 476-3462

State of New Mexico
Energy, Minerals and Natural Resources

Oil Conservation Division

1220 S. St Francis Dr.

Santa Fe, NM 87505

Form C-102
Permit 20537

DEC 28 AM 6 56
RECEIVED
070 FARMINGTON NM

WELL LOCATION AND ACREAGE DEDICATION PLAT

| | | |
|--------------------------|---|--|
| 1. API Number | 2. Pool Code 71629 | 3. Pool Name BASIN FRUITLAND COAL (GAS) |
| 4. Property Code 7465 | 5. Property Name SAN JUAN 29 7 UNIT | 6. Well No. 102R |
| 7. OGRID No. 14538 | 8. Operator Name BURLINGTON RESOURCES OIL & GAS COMPANY LP | 9. Elevation 6261 |

10. Surface Location

| | | | | | | | | | |
|---------------|---------------|-----------------|--------------|---------|-------------------|---------------|-------------------|---------------|----------------------|
| UL - Lot K | Section 15 | Township 29N | Range 07W | Lot Idn | Feet From 1840 | N/S Line S | Feet From 1550 | E/W Line W | County RIO ARriba |
|---------------|---------------|-----------------|--------------|---------|-------------------|---------------|-------------------|---------------|----------------------|

11. Bottom Hole Location If Different From Surface

| | | | | | | | | | |
|-------------------------------|---------|---------------------|-------|------------------------|-----------|---------------|-----------|----------|--------|
| UL - Lot | Section | Township | Range | Lot Idn | Feet From | N/S Line | Feet From | E/W Line | County |
| 12. Dedicated Acres 320.00 | | 13. Joint or Infill | | 14. Consolidation Code | | 15. Order No. | | | |

NO ALLOWABLE WILL BE ASSIGNED TO THIS COMPLETION UNTIL ALL INTERESTS HAVE BEEN CONSOLIDATED OR A NON-STANDARD UNIT HAS BEEN APPROVED BY THE DIVISION

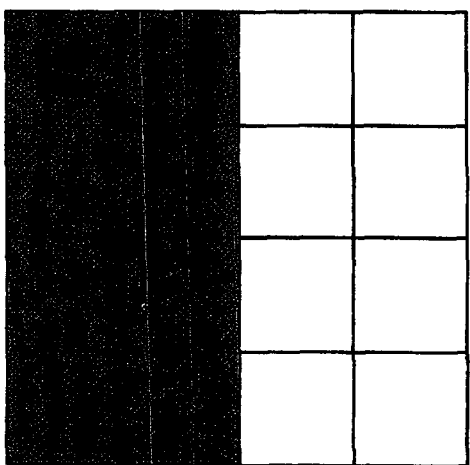
| | | |
|---|---|--|
|  | OPERATOR CERTIFICATION | |
| | <i>I hereby certify that the information contained herein is true and complete to the best of my knowledge and belief, and that this organization either owns a working interest or unleased mineral interest in the land including the proposed bottom hole location(s) or has a right to drill this well at this location pursuant to a contract with an owner of such a mineral or working interest, or to a voluntary pooling agreement or a compulsory pooling order heretofore entered by the division.</i> | |
| | E-Signed By: <i>Patsy Chiswick</i> Title: <i>Sr. Regulatory Specialist</i> Date: <i>12/27/05</i> | |
| | SURVEYOR CERTIFICATION | |
| | <i>I hereby certify that the well location shown on this plat was plotted from field notes of actual surveys made by me or under my supervision, and that the same is true and correct to the best of my belief.</i> Surveyed By: David O. Vilnen Date of Survey: 4/7/1972 Certificate Number: 1760 | |

District I1625 N. French Dr., Hobbs, NM 88240
Phone:(505) 393-6161 Fax:(505) 393-0720District II1301 W. Grand Ave., Artesia, NM 88210
Phone:(505) 748-1283 Fax:(505) 748-9720District III1000 Rio Brazos Rd., Aztec, NM 87410
Phone:(505) 334-6178 Fax:(505) 334-6170District IV1220 S. St Francis Dr., Santa Fe, NM 87505
Phone:(505) 476-3470 Fax:(505) 476-3462**State of New Mexico**
Energy, Minerals and Natural Resources**Oil Conservation Division****1220 S. St Francis Dr.****Santa Fe, NM 87505****WELL LOCATION AND ACREAGE DEDICATION PLAT**

| | | |
|--------------------------|---|--|
| 1. API Number | 2. Pool Code 72359 | 3. Pool Name BLANCO PICTURED CLIFFS (GAS) |
| 4. Property Code 7465 | 5. Property Name SAN JUAN 29 7 UNIT | 6. Well No. 102R |
| 7. OGRID No. 14538 | 8. Operator Name BURLINGTON RESOURCES OIL & GAS COMPANY LP | 9. Elevation 6261 |

10. Surface Location

| UL - Lot | Section | Township | Range | Lot Idn | Feet From | N/S Line | Feet From | E/W Line | County |
|----------|---------|----------|-------|---------|-----------|----------|-----------|----------|------------|
| K | 15 | 29N | 07W | | 1840 | S | 1550 | W | RIO ARriba |

11. Bottom Hole Location If Different From Surface

| UL - Lot | Section | Township | Range | Lot Idn | Feet From | N/S Line | Feet From | E/W Line | County |
|-------------------------------|---------|---------------------|-------|------------------------|-----------|---------------|-----------|----------|--------|
| 12. Dedicated Acres 160.00 | | 13. Joint or Infill | | 14. Consolidation Code | | 15. Order No. | | | |

NO ALLOWABLE WILL BE ASSIGNED TO THIS COMPLETION UNTIL ALL INTERESTS HAVE BEEN CONSOLIDATED OR A NON-STANDARD UNIT HAS BEEN APPROVED BY THE DIVISION

| | | | |
|--|---|--|--|
| | OPERATOR CERTIFICATION | | |
| | <i>I hereby certify that the information contained herein is true and complete to the best of my knowledge and belief, and that this organization either owns a working interest or unleased mineral interest in the land including the proposed bottom hole location(s) or has a right to drill this well at this location pursuant to a contract with an owner of such a mineral or working interest, or to a voluntary pooling agreement or a compulsory pooling order heretofore entered by the division.</i> | | |
| | E-Signed By: <i>Patsy Clugston</i> Title: <i>Sr. Regulatory Specialist</i> Date: <i>12/27/05</i> | | |
| | SURVEYOR CERTIFICATION | | |
| <i>I hereby certify that the well location shown on this plat was plotted from field notes of actual surveys made by me or under my supervision, and that the same is true and correct to the best of my belief.</i> | | | |
| Surveyed By: David O. Vilnen Date of Survey: 4/7/1972 Certificate Number: 1760 | | | |

NEW MEXICO OIL CONSERVATION COMMISSION
WELL LOCATION AND ACREAGE DEDICATION PLAT

EL PASO NATURAL GAS COMPANY

SAN JUAN 29-7 UNIT

(SF-077842)

102-Y

K

15

29-N

7-W

RIO ARRIBA

1840

SOUTH

1550

WEST

6261

MESA VERDE

BLANCO MESA VERDE

320.00

1. Outline the acreage dedicated to the subject well by colored pencil or ink line marks on the plat.
2. If more than one lease is dedicated to the well, outline each and identify the ownership, tract, interest and royalty.
3. If more than one lease of different ownership is dedicated to the well, have the interests of all owners been consolidated by communitization, unitization, forcepooling, etc?

X Yes No If answer is "yes," type of consolidation:

Unitization

If answer is "no," list the owners and tract descriptions which have actually been consolidated. (Use reverse side of this form if necessary.)

No allowable will be assigned to the well until all interests have been consolidated by communitization, unitization, forcepooling, or otherwise or until a non-standard unit, eliminating such interests, has been approved by the Commission.

CERTIFICATION

I hereby certify that the information contained herein is true and complete to the best of my knowledge and belief.

Original Signed E. H. WOOD

Petroleum Engineer

El Paso Natural Gas Co.

June 8, 1972

I hereby certify that the well location and acreage information on this plat were obtained from the records of the El Paso Natural Gas Company and that the same are true and correct to the best of my knowledge and belief.

APRIL 7, 1972

David W. Wood

1760

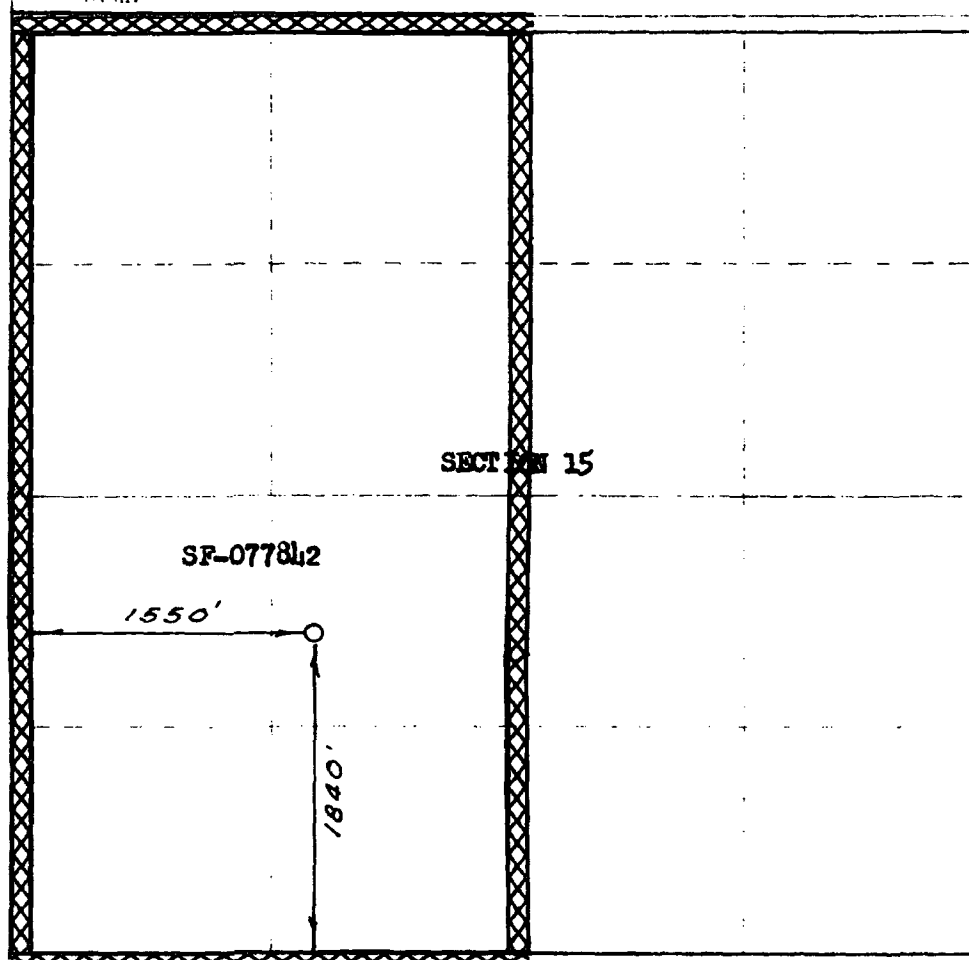

Production Cums
Oil: 0 MSTB
Gas: 0 MMSCF
Water: 0 MSTB
Cond: 0 MSTB

No
Active
Forecast

Operator:
Field:
Zone:
Type:
Group:

Other
None

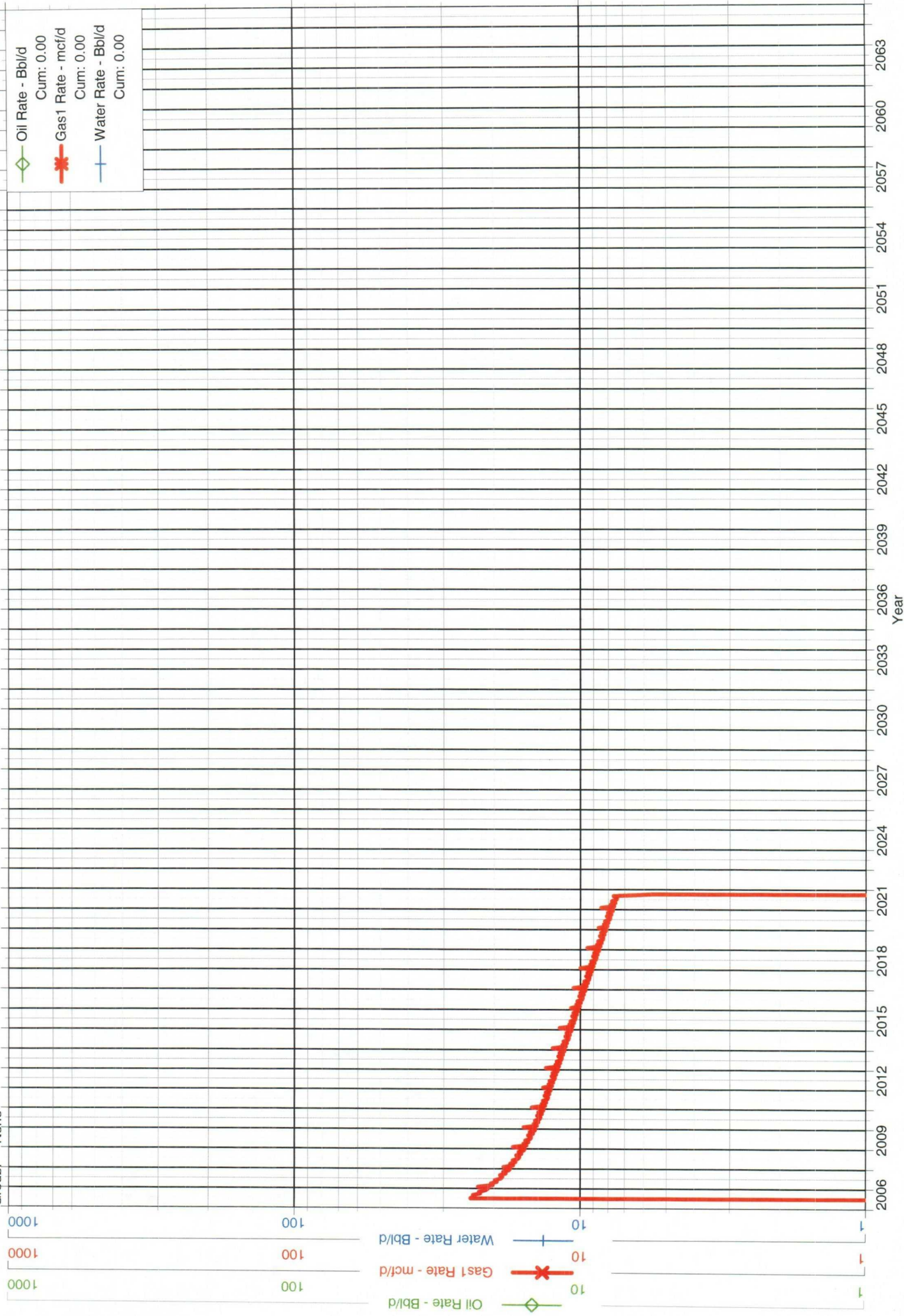

Operator: No
Field: Active
Zone: Forecast
Type: No
Group: Other
 None

Production Cums
Oil: 0 MSTB
Gas: 0 MMSCF
Water: 0 MSTB
Cond: 0 MSTB

Oil Rate - Bbl/d Cum: 0.00
Gas1 Rate - mcf/d Cum: 0.00
Water Rate - Bbl/d Cum: 0.00



SAN JUAN 29-7 UNIT 102R

