

ABOVE THIS LINE FOR DIVISION USE ONLY

NEW MEXICO OIL CONSERVATION DIVISION
- Engineering Bureau -
1220 South St. Francis Drive, Santa Fe, NM 87505



ADMINISTRATIVE APPLICATION CHECKLIST

THIS CHECKLIST IS MANDATORY FOR ALL ADMINISTRATIVE APPLICATIONS FOR EXCEPTIONS TO DIVISION RULES AND REGULATIONS WHICH REQUIRE PROCESSING AT THE DIVISION LEVEL IN SANTA FE

Application Acronyms:

[NSL-Non-Standard Location] [NSP-Non-Standard Proration Unit] [SD-Simultaneous Dedication]
[DHC-Downhole Commingling] [CTB-Lease Commingling] [PLC-Pool/Lease Commingling]
[PC-Pool Commingling] [OLS - Off-Lease Storage] [OLM-Off-Lease Measurement]
[WFX-Waterflood Expansion] [PMX-Pressure Maintenance Expansion]
[SWD-Salt Water Disposal] [IPI-Injection Pressure Increase]
[EOR-Qualified Enhanced Oil Recovery Certification] [PPR-Positive Production Response]

[1] **TYPE OF APPLICATION** - Check Those Which Apply for [A]

[A] Location - Spacing Unit - Simultaneous Dedication
☐ NSL ☐ NSP ☐ SD

Check One Only for [B] or [C]

[B] Commingling - Storage - Measurement
☒ DHC ☐ CTB ☐ PLC ☐ PC ☐ OLS ☐ OLM

[C] Injection - Disposal - Pressure Increase - Enhanced Oil Recovery
☐ WFX ☐ PMX ☐ SWD ☐ IPI ☐ EOR ☐ PPR

[D] Other: Specify _____

[2] **NOTIFICATION REQUIRED TO:** - Check Those Which Apply, or ☐ Does Not Apply

[A] ☐ Working, Royalty or Overriding Royalty Interest Owners

[B] ☐ Offset Operators, Leaseholders or Surface Owner

[C] ☐ Application is One Which Requires Published Legal Notice

[D] ☐ Notification and/or Concurrent Approval by BLM or SLO
U.S. Bureau of Land Management - Commissioner of Public Lands, State Land Office

[E] ☐ For all of the above, Proof of Notification or Publication is Attached, and/or,

[F] ☐ Waivers are Attached

[3] **SUBMIT ACCURATE AND COMPLETE INFORMATION REQUIRED TO PROCESS THE TYPE OF APPLICATION INDICATED ABOVE.**

[4] **CERTIFICATION:** I hereby certify that the information submitted with this application for administrative approval is accurate and complete to the best of my knowledge. I also understand that no action will be taken on this application until the required information and notifications are submitted to the Division.

Note: Statement must be completed by an individual with managerial and/or supervisory capacity.

Print or Type Name

Signature

Title

Date

e-mail Address

District I
1625 N. French Drive, Hobbs, NM 88240

District II
1301 W. Grand Avenue, Artesia, NM 88210

District III
1000 Rio Brazos Road, Aztec, NM 87410

District IV
1220 S. St. Francis Dr., Santa Fe, NM 87505

State of New Mexico
Energy, Minerals and Natural Resources Department

Form C-107A
Revised June 10, 2003

Oil Conservation Division

1220 South St. Francis Dr.
Santa Fe, New Mexico 87505

APPLICATION TYPE

☒ Single Well

☐ Establish Pre-Approved Pools

EXISTING WELLBORE

☒ Yes ☐ No

APPLICATION FOR DOWNHOLE COMMINGLING

Burlington Resources Oil & Gas Company LP
Operator

P.O. Box 4289 Farmington, NM 87499
Address

SAN JUAN 29-7 UNIT 53

Lease

Well No.

Unit H, Sec. 027, 029N, 007W

Unit Letter-Section-Township-Range

RIO ARRIBA

County

OGRID No: 14538 Property Code 7465 API No. 30039075440000 Lease Type: ☒ Federal ☐ State ☐ Fee

DATA ELEMENT	UPPER ZONE	INTERMEDIATE ZONE	LOWER ZONE
Pool Name	FRUITLAND COAL	BLANCO PICTURED CLIFFS	MESAVERDE
Pool Code	71629	72359	72319
Top and Bottom of Pay Section (Perforated or Open-Hole Interval)	2906-3105' (Estimated)	3180-3270' (Estimated)	3907-4523'
Method of Production (Flowing or Artificial Lift)	NEW ZONE	NEW ZONE	FLOWING
Bottomhole Pressure (Note: Pressure data will not be required if the bottom perforation in the lower zone is within 150% of the depth of the top perforation in the upper zone)	Original - 1151 psi Current - 1000 psi (Offset SJ 29-7 Unit 176)	Original - 837 psi Current - 550 psi (Offset SJ 29-7 Unit 176)	Original - 1249 psi Current - 557 psi
Oil Gravity or Gas BTU (Degree API or Gas BTU)	BTU 1062	BTU 1062	BTU 1217
Producing, Shut-In or New Zone	NEW ZONE	NEW ZONE	PRODUCING
Date and Oil/Gas/Water Rates of Last Production. (Note: For new zones with no production history, applicant shall be required to attach production estimates and supporting data.)	Date: N/A Rates: see attachment	Date: N/A Rates: see attachment	Date: Jan 2006 Rates: 207 MCFD
Fixed Allocation Percentage (Note: If allocation is based upon something other than current or past production, supporting data or explanation will be required.)	Oil Gas Will be supplied upon completion	Oil Gas Will be supplied upon completion	Oil Gas Will be supplied upon completion

ADDITIONAL DATA

Are all working, royalty and overriding royalty interests identical in all commingled zones?
If not, have all working, royalty and overriding royalty interest owners been notified by certified mail?

Yes ☐ No ☒
Yes ☒ No ☐

Are all produced fluids from all commingled zones compatible with each other?

Yes ☒ No ☐

Will commingling decrease the value of production?

Yes ☐ No ☒

If this well is on, or communitized with, state or federal lands, has either the Commissioner of Public Lands or the United States Bureau of Land Management been notified in writing of this application?

Yes ☒ No ☐

NMOCD Reference Case No. applicable to this well: R-10697 - No partner notification needed per Order.

Attachments:

- C-102 for each zone to be commingled showing its spacing unit and acreage dedication.
- Production curve for each zone for at least one year. (If not available, attach explanation.)
- For zones with no production history, estimated production rates and supporting data.
- Data to support allocation method or formula.
- Notification list of working, royalty and overriding royalty interests for uncommon interest cases.
- Any additional statements, data or documents required to support commingling.

PRE-APPROVED POOLS

If application is to establish Pre-Approved Pools, the following additional information will be required:

- List of other orders approving downhole commingling within the proposed Pre-Approved Pools
- List of all operators within the proposed Pre-Approved Pools
- Proof that all operators within the proposed Pre-Approved Pools were provided notice of this application.
- Bottomhole pressure data.

I hereby certify that the information above is true and complete to the best of my knowledge and belief.

SIGNATURE Cory McKee TITLE Engineer DATE 2/3/06

TYPE OR PRINT NAME Cory McKee, Engineer TELEPHONE NO. (505) 326-9700

E-MAIL ADDRESS cmckee@br-inc.com

San Juan 29-7 Unit 53
Bottom Hole Pressures
Flowing and Static BHP
Cullender and Smith Method
Version 1.0 1/14/98

FRUITLAND COAL		PICTURED CLIFFS	
<u>FC-Current</u>		<u>PC-Current</u>	
GAS GRAVITY	0	GAS GRAVITY	0
COND. OR MISC. (C/M)	C	COND. OR MISC. (C/M)	C
%N2	0	%N2	0.00
%CO2	0	%CO2	0
%H2S	0	%H2S	0
DIAMETER (IN)	0	DIAMETER (IN)	0
DEPTH (FT)	0	DEPTH (FT)	0
SURFACE TEMPERATURE (DEG F)	0	SURFACE TEMPERATURE (DEG F)	0
BOTTOMHOLE TEMPERATURE (DEG F)	0	BOTTOMHOLE TEMPERATURE (DEG F)	0
FLOWRATE (MCFPD)	0	FLOWRATE (MCFPD)	0
SURFACE PRESSURE (PSIA)	0	SURFACE PRESSURE (PSIA)	0
BOTTOMHOLE PRESSURE (PSIA)	#DIV/0!	BOTTOMHOLE PRESSURE (PSIA)	#DIV/0!
<u>FC-Original</u>		<u>PC-Original</u>	
GAS GRAVITY	0.633	GAS GRAVITY	0.633
COND. OR MISC. (C/M)	C	COND. OR MISC. (C/M)	C
%N2	0.0339	%N2	0.03
%CO2	0.007	%CO2	0.007
%H2S	0	%H2S	0
DIAMETER (IN)	2.875	DIAMETER (IN)	1.25
DEPTH (FT)	3458.5	DEPTH (FT)	3648
SURFACE TEMPERATURE (DEG F)	60	SURFACE TEMPERATURE (DEG F)	60
BOTTOMHOLE TEMPERATURE (DEG F)	98.58	BOTTOMHOLE TEMPERATURE (DEG F)	100.7
FLOWRATE (MCFPD)	0	FLOWRATE (MCFPD)	0
SURFACE PRESSURE (PSIA)	1050	SURFACE PRESSURE (PSIA)	764
BOTTOMHOLE PRESSURE (PSIA)	1150.5	BOTTOMHOLE PRESSURE (PSIA)	837.2

San Juan 29-7 Unit 53
Bottom Hole Pressures
Flowing and Static BHP
Cullender and Smith Method
Version 1.0 1/14/98

MESAVERDE			
<u>MV-Current</u>		<u>Current</u>	
GAS GRAVITY	0	GAS GRAVITY	0
COND. OR MISC. (C/M)	C	COND. OR MISC. (C/M)	C
%N2	0	%N2	0.00
%CO2	0	%CO2	0
%H2S	0	%H2S	0
DIAMETER (IN)	0	DIAMETER (IN)	0
DEPTH (FT)	0	DEPTH (FT)	0
SURFACE TEMPERATURE (DEG F)	60	SURFACE TEMPERATURE (DEG F)	60
BOTTOMHOLE TEMPERATURE (DEG F)	0	BOTTOMHOLE TEMPERATURE (DEG F)	0
FLOWRATE (MCFPD)	0	FLOWRATE (MCFPD)	0
SURFACE PRESSURE (PSIA)	0	SURFACE PRESSURE (PSIA)	0
BOTTOMHOLE PRESSURE (PSIA)	#DIV/0!	BOTTOMHOLE PRESSURE (PSIA)	0.0
<u>MV-Original</u>		<u>Original</u>	
GAS GRAVITY	0.701	GAS GRAVITY	0
COND. OR MISC. (C/M)	C	COND. OR MISC. (C/M)	C
%N2	0.0017	%N2	0.00
%CO2	0.0091	%CO2	0
%H2S	0	%H2S	0
DIAMETER (IN)	2.375	DIAMETER (IN)	0
DEPTH (FT)	5207.5	DEPTH (FT)	0
SURFACE TEMPERATURE (DEG F)	60	SURFACE TEMPERATURE (DEG F)	0
BOTTOMHOLE TEMPERATURE (DEG F)	142.33	BOTTOMHOLE TEMPERATURE (DEG F)	0
FLOWRATE (MCFPD)	0	FLOWRATE (MCFPD)	0
SURFACE PRESSURE (PSIA)	1076	SURFACE PRESSURE (PSIA)	0
BOTTOMHOLE PRESSURE (PSIA)	1248.9	BOTTOMHOLE PRESSURE (PSIA)	0.0

District I

1625 N. French Dr., Hobbs, NM 88240
Phone:(505) 393-6161 Fax:(505) 393-0720

District II

1301 W. Grand Ave., Artesia, NM 88210
Phone:(505) 748-1283 Fax:(505) 748-9720

District III

1000 Rio Brazos Rd., Aztec, NM 87410
Phone:(505) 334-6178 Fax:(505) 334-6170

District IV

1220 S. St Francis Dr., Santa Fe, NM 87505
Phone:(505) 476-3470 Fax:(505) 476-3462

State of New Mexico
Energy, Minerals and Natural Resources

Oil Conservation Division

1220 S. St Francis Dr.
Santa Fe, NM 87505

Form C-102
Permit 20532

2005 DEC 28 AM 6 58

RECEIVED
070 FARMINGTON NM

WELL LOCATION AND ACREAGE DEDICATION PLAT

1. API Number	2. Pool Code 71629	3. Pool Name BASIN FRUITLAND COAL (GAS)
4. Property Code 7465	5. Property Name SAN JUAN 29 7 UNIT	6. Well No. 053
7. OGRID No. 14538	8. Operator Name BURLINGTON RESOURCES OIL & GAS COMPANY LP	9. Elevation 6374

10. Surface Location

UL - Lot H	Section 27	Township 29N	Range 07W	Lot Idn	Feet From 1550	N/S Line N	Feet From 800	E/W Line E	County RIO ARriba
---------------	---------------	-----------------	--------------	---------	-------------------	---------------	------------------	---------------	----------------------

11. Bottom Hole Location If Different From Surface

UL - Lot	Section	Township	Range	Lot Idn	Feet From	N/S Line	Feet From	E/W Line	County
12. Dedicated Acres 320.00		13. Joint or Infill		14. Consolidation Code		15. Order No.			

NO ALLOWABLE WILL BE ASSIGNED TO THIS COMPLETION UNTIL ALL INTERESTS HAVE BEEN CONSOLIDATED OR A NON-STANDARD UNIT HAS BEEN APPROVED BY THE DIVISION

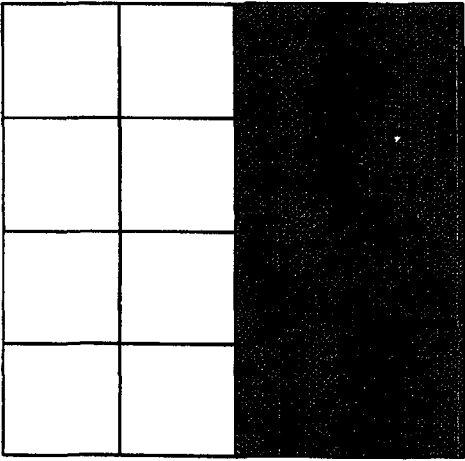
	OPERATOR CERTIFICATION
	<p><i>I hereby certify that the information contained herein is true and complete to the best of my knowledge and belief, and that this organization either owns a working interest or unleased mineral interest in the land including the proposed bottom hole location(s) or has a right to drill this well at this location pursuant to a contract with an owner of such a mineral or working interest, or to a voluntary pooling agreement or a compulsory pooling order heretofore entered by the division.</i></p> <p>E-Signed By: <i>Patay Clug</i> Title: <i>Sr. Regulatory Specialist</i> Date: <i>12/27/05</i></p>
	SURVEYOR CERTIFICATION
	<p><i>I hereby certify that the well location shown on this plat was plotted from field notes of actual surveys made by me or under my supervision, and that the same is true and correct to the best of my belief.</i></p> <p>Surveyed By: C. O. Walker Date of Survey: 6/25/1956 Certificate Number:</p>

District I

1625 N. French Dr., Hobbs, NM 88240
Phone:(505) 393-6161 Fax:(505) 393-0720

District II

1301 W. Grand Ave., Artesia, NM 88210
Phone:(505) 748-1283 Fax:(505) 748-9720

District III

1000 Rio Brazos Rd., Aztec, NM 87410
Phone:(505) 334-6178 Fax:(505) 334-6170

District IV

1220 S. St Francis Dr., Santa Fe, NM 87505
Phone:(505) 476-3470 Fax:(505) 476-3462

State of New Mexico

Energy, Minerals and Natural Resources

Oil Conservation Division

1220 S. St Francis Dr.

Santa Fe, NM 87505

Form C-102
Permit 20532

2005 DEC 28 AM 6 57

RECEIVED

070 FARMINGTON NM

WELL LOCATION AND ACREAGE DEDICATION PLAT

1. API Number	2. Pool Code 72359	3. Pool Name BLANCO PICTURED CLIFFS (GAS)
4. Property Code 7465	5. Property Name SAN JUAN 29 7 UNIT	6. Well No. 053
7. OGRID No. 14538	8. Operator Name BURLINGTON RESOURCES OIL & GAS COMPANY LP	9. Elevation 6374

10. Surface Location

UL - Lot H	Section 27	Township 29N	Range 07W	Lot Idn	Feet From 1550	N/S Line N	Feet From 800	E/W Line E	County RIO ARriba
---------------	---------------	-----------------	--------------	---------	-------------------	---------------	------------------	---------------	----------------------

11. Bottom Hole Location If Different From Surface

UL - Lot	Section	Township	Range	Lot Idn	Feet From	N/S Line	Feet From	E/W Line	County
12. Dedicated Acres 160.00	13. Joint or Infill	14. Consolidation Code	15. Order No.						

NO ALLOWABLE WILL BE ASSIGNED TO THIS COMPLETION UNTIL ALL INTERESTS HAVE BEEN CONSOLIDATED OR A NON-STANDARD UNIT HAS BEEN APPROVED BY THE DIVISION

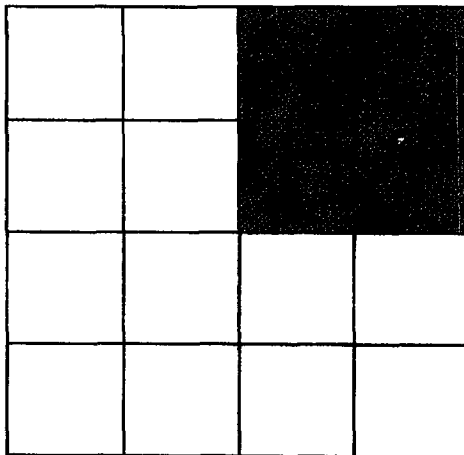

OPERATOR CERTIFICATION

I hereby certify that the information contained herein is true and complete to the best of my knowledge and belief, and that this organization either owns a working interest or unleased mineral interest in the land including the proposed bottom hole location(s) or has a right to drill this well at this location pursuant to a contract with an owner of such a mineral or working interest, or to a voluntary pooling agreement or a compulsory pooling order heretofore entered by the division.

E-Signed By:

Title:

Date:

SURVEYOR CERTIFICATION

I hereby certify that the well location shown on this plat was plotted from field notes of actual surveys made by me or under my supervision, and that the same is true and correct to the best of my belief.

Surveyed By: C. O. Walker

Date of Survey: 6/25/1956

Certificate Number:

NEW MEXICO
OIL CONSERVATION COMMISSION

WELL LOCATION AND/OR GAS PRODUCTION PLAT

JULY 5, 1956

EL PASO NATURAL GAS COMPANY

SAN JUAN 29-7 UNIT

SF 078424

48

27

29-N

7-W

1550

NORTH

800

EAST

RIO ARriba

6374

MESA VERDE

BLANCO

320 ACRES
(1913 PLAT)

Note: All dimensions are in feet unless otherwise noted.

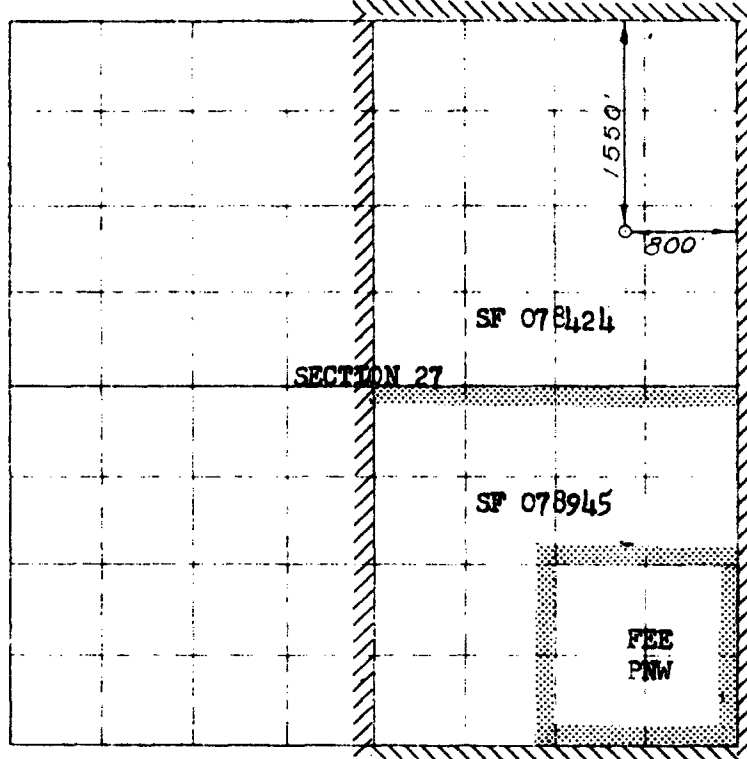

Scale 1 in. = 2 equal 1 mile

NOTE:
This section of
form is to be used
for gas wells only.

I hereby certify that the above plat was prepared from
first hands of actual surveys made by me or under my
supervision and that the same are true and correct to the
best of my knowledge and belief.

Date Surveyed: JUNE 25, 1956

E. O. Walker
Registered Professional Engineer and/or Land Surveyor



1. Is this well a Dual Comp. ☒ Yes ☐ No
2. If the answer to Question 1 is Yes, are there any other locally completed wells within the dedicated acreage.

Yes ☐ No ☒
Name: *Emell Walker*
Position: **Petroleum Engineer**
Representing: **El Paso Natural Gas Co.**
Address: **Box 997, Farmington, N.M.**

SAN JUAN 29-7 UNIT 53 (FTC) Data: Feb.2006-Feb.2006

Operator: No
 Field: Active
 Zone: Forecast
 Type: Other
 Group: None

Production Cums
 Oil: 0 MSTB
 Gas: 0 MMSCF
 Water: 0 MSTB
 Cond: 0 MSTB

Oil Rate - Bbl/d
 Cum: 0.00
 Gas1 Rate - mcf/d
 Cum: 0.00
 Water Rate - Bbl/d
 Cum: 0.00

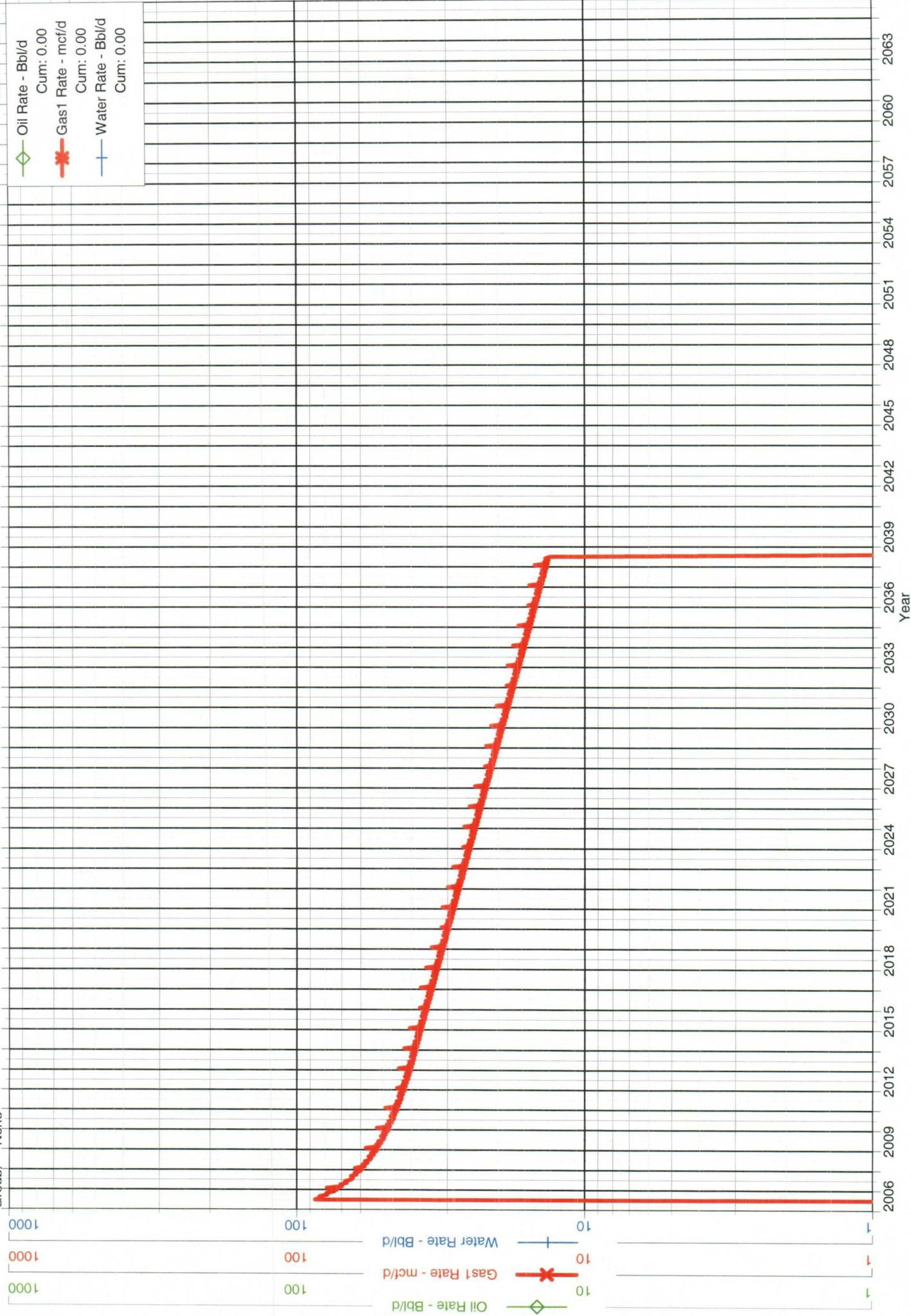

Operator:
Field:
Zone:
Type:
Group:

No
Active
Forecast

Other
None

Production Cums
Oil: 0 MSTB
Gas: 0 MMSCF
Water: 0 MSTB
Cond: 0 MSTB

Oil Rate - Bbl/d
Cum: 0.00
Gas Rate - mcf/d
Cum: 0.00
Water Rate - Bbl/d
Cum: 0.00

Oil Rate - Bbl/d
Gas Rate - mcf/d
Water Rate - Bbl/d

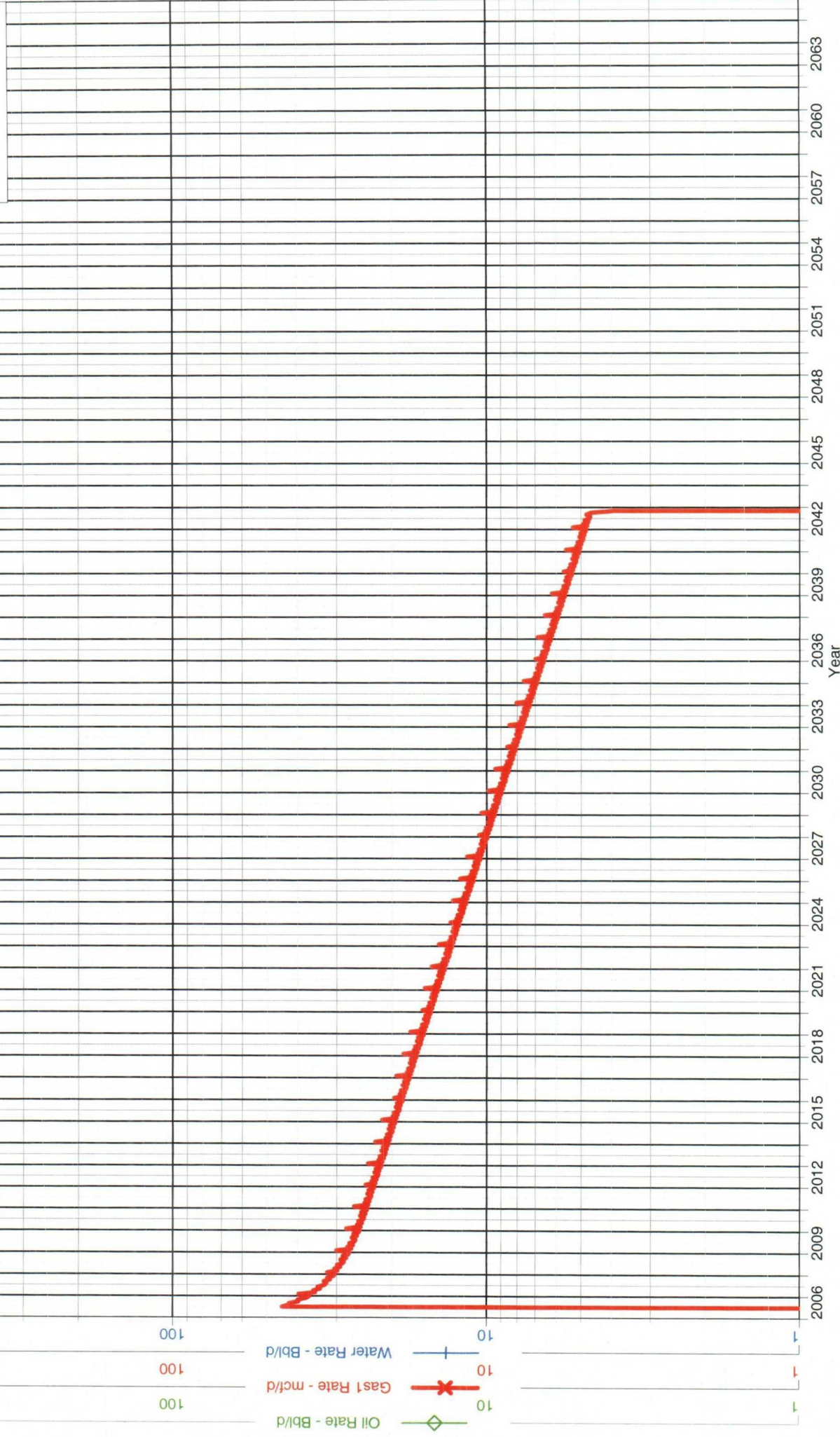

SAN JUAN 29-7 UNIT 53

