

7049

OCD-ARTESIA

FORM APPROVED
OMB No. 1004-0136
Expires November 30, 2000UNITED STATES
DEPARTMENT OF THE INTERIOR
BUREAU OF LAND MANAGEMENT

EC

APPLICATION FOR PERMIT TO DRILL OR REENTER

1a. Type of Work: ☒ DRILL ☐ REENTER

CONFIDENTIAL

5. Lease Serial No.
NMNM04228

6. If Indian, Allottee or Tribe Name

7. If Unit or CA Agreement, Name and No.
NMNM68294X8. Lease Name and Well No.
BIG EDDY UNIT 153

9. API Well No.

30-015-34012

10. Field and Pool, or Exploratory
GOLDEN LANE-MORROW1b. Type of Well: ☐ Oil Well ☒ Gas Well ☐ Other ☒ Single Zone ☐ Multiple Zone2. Name of Operator
BASS ENTERPRISES PRODUCTION CO
Contact: CINDI GOODMAN
E-Mail: CDGOODMAN@BASSPET.COM3a. Address
P O BOX 2760
MIDLAND, TX 797023b. Phone No. (include area code)
Ph: 432-683-2277

4. Location of Well (Report location clearly and in accordance with any State requirements. *)

At surface SWSE 660FSL 1980FEL 32.27341 N Lat, 104.00164 W Lon

At proposed prod. zone SWSE 660FSL 1980FEL 32.27341 N Lat, 104.00164 W Lon

11. Sec., T., R., M., or Blk. and Survey or Area

Sec 20 T21S R29E Mer NMP
SME: BLM14. Distance in miles and direction from nearest town or post office*
15 MILES EAST OF CARLSBAD, NM.12. County or Parish
EDDY13. State
NM15. Distance from proposed location to nearest property or
lease line, ft. (Also to nearest drig. unit line, if any)
660'16. No. of Acres in Lease
160.00

RECEIVED

MAR 17 2005

17. Spacing Unit dedicated to this well
320.0018. Distance from proposed location to nearest well, drilling,
completed, applied for, on this lease, ft.
N/A19. Proposed Depth
13100 MD
13100 TVD

20. BLM/BIA Bond No. on file

21. Elevations (Show whether DF, KB, RT, GL, etc.)
3313 GL22. Approximate date work will start
08/15/200523. Estimated duration
47 DAYS

24. Attachments

CAPITAN CONTROLLED WATER BASIN

The following, completed in accordance with the requirements of Onshore Oil and Gas Order No. 1, shall be attached to this form:

1. Well plat certified by a registered surveyor.
2. A Drilling Plan.
3. A Surface Use Plan (if the location is on National Forest System Lands, the SUPO shall be filed with the appropriate Forest Service Office).

4. Bond to cover the operations unless covered by an existing bond on file (see Item 20 above).
5. Operator certification
6. Such other site specific information and/or plans as may be required by the authorized officer.

25. Signature
(Electronic Submission)Name (Printed/Typed)
CINDI GOODMAN Ph: 432-683-2277Date
02/14/2005Title
AUTHORIZED REPRESENTATIVEApproved by (Signature)
/s/ James StovallName (Printed/Typed)
/s/ James StovallDate
MAR 16 2005Title
FOR FIELD MANAGEROffice
CARLSBAD FIELD OFFICEApplication approval does not warrant or certify the applicant holds legal or equitable title to those rights in the subject lease which would entitle the applicant to conduct operations thereon.
Conditions of approval, if any, are attached.

APPROVAL FOR 1 YEAR

Title 18 U.S.C. Section 1001 and Title 43 U.S.C. Section 1212, make it a crime for any person knowingly and willfully to make to any department or agency of the United States any false, fictitious or fraudulent statements or representations as to any matter within its jurisdiction.

Additional Operator Remarks (see next page)

Electronic Submission #54071 verified by the BLM Well Information System
For BASS ENTERPRISES PRODUCTION CO, sent to the Carlsbad
Committed to AFMSS for processing by LINDA ASKWIG on 02/14/2005 (05LA0388AE)APPROVAL SUBJECT TO
GENERAL REQUIREMENTS
AND SPECIAL STIPULATIONS
ATTACHEDWITNESS 13^{3/8}" Cement Job

** BLM REVISED ** BLM REVISED ** BLM REVISED ** BLM REVISED ** BLM REVISED **

Additional Operator Remarks:

Surface casing to be set into Rustler below all fresh water sands.
Production casing will be cemented using Zone Seal Cement.
Drilling Procedure, BOP Diagram, Anticipated tops and surface plans attached.

This well is located outside the Secretary's Potash area and outside the R-111 Potash area. There are no potash leases within 1 mile of the location.

DISTRICT I

1635 N. French Dr., Hobbs, NM 88240

DISTRICT II

811 South First, Artesia, NM 88210

DISTRICT III

1800 Rio Brazos Rd., Aztec, NM 87410

DISTRICT IV

2040 South Pacheco, Santa Fe, NM 87505

State of New Mexico

Energy, Minerals and Natural Resources Department

Form C-102

Revised March 17, 1999

Submit to Appropriate District Office

State Lease - 4 Copies

Fee Lease - 3 Copies

OIL CONSERVATION DIVISION

2040 South Pacheco

Santa Fe, New Mexico 87504-2088

AMENDED REPORT

WELL LOCATION AND ACREAGE DEDICATION PLAT

API Number	Pool Code 77560	Pool Name GOLDEN LANE MORROW
Property Code 001776	Property Name BIG EDDY UNIT	Well Number 153
OGED No. 001801	Operator Name BASS ENTERPRISES PRODUCTION COMPANY	Elevation 3313'

Surface Location

UL or lot No.	Section	Township	Range	Lot Idn	Feet from the	North/South Line	Feet from the	East/West Line	County
0	20	21 S	29 E		660	SOUTH	1980	EAST	EDDY

Bottom Hole Location If Different From Surface

UL or lot No.	Section	Township	Range	Lot Idn	Feet from the	North/South Line	Feet from the	East/West Line	County

Dedicated Acres 320	Joint or Infill I	Consolidation Code	Order No.
------------------------	----------------------	--------------------	-----------

NO ALLOWABLE WILL BE ASSIGNED TO THIS COMPLETION UNTIL ALL INTERESTS HAVE BEEN CONSOLIDATED
OR A NON-STANDARD UNIT HAS BEEN APPROVED BY THE DIVISION

	OPERATOR CERTIFICATION I hereby certify that the information contained herein is true and complete to the best of my knowledge and belief. <u>William R. Dannels</u> Signature W.R. DANNELS Printed Name DIVISION DRILLING SUPT. Title 2-11-05 Date	
	SURVEYOR CERTIFICATION I hereby certify that the well location shown on this plat was plotted from field notes of actual surveys made by me or under my supervision and that the same is true and correct to the best of my belief. JANUARY 21, 2005 Date Surveyed Signature of Surveyor W.O. No. 4906 Certified No. Gary Jones 7977 REGISTERED PROFESSIONAL LAND SURVEYOR STATE OF NEW MEXICO	
	LAT ~ N32°27'34.1" LONG ~ W104°00'16.4"	
	3309.0' 3323.4' 3312.1' 3320.0' 1980'	

SECTION 20, TOWNSHIP 21 SOUTH, RANGE 29 EAST, N.M.P.M., EDDY COUNTY, NEW MEXICO.

BEU #95

Proposed Lease Rd.

3309.0'

3332'

600'

3323.4'

Old Fence

150' NORTH
OFF SET
3314.5'

BASS ENTERPRISES PROD. CO.
BIG EDDY UNIT #153

ELEV. - 3313'
O

Lat.-N 32°27'34.1"
Long-W 104°00'16.4"

150' WEST
OFF SET
3311.4'

150' EAST
OFF SET
3318.3'

150' SOUTH
OFF SET
3314.0'

600'

600'

3312.1'

600'

3320.0'

DIRECTIONS TO LOCATION:

FROM THE JUNCTION OF US HWY 62/180 AND CO.
RD. 699(LANDFILL ROAD), GO SOUTHEAST ON
LANDFILL ROAD FOR 1.0 MILE TO LANDFILL; THENCE
SOUTHEAST PAST LANDFILL FOR 1.0 MILE TO A "Y".
GO LEFT(EAST) FOR 0.5 MILE TO DUKE B-3
BOOSTER; THENCE GO SOUTHEAST FOR 1.3 MILE;
THENCE SOUTHEAST 1.3 MILE ALONG FENCE LINE TO
THE BIG EDDY UNIT #95 AND PROPOSED LEASE ROAD.

BASIN SURVEYS P.O. BOX 1786-HOBBS, NEW MEXICO

W.O. Number: 4996

Drawn By: K. GOAD

Date: 01-26-2005

Disk: KJG CD#7 - 4996A.DWG

100 0 100 200 FEET

SCALE: 1" = 100'

BASS ENTERPRISES PRODUCTION CO.

REF: BIG EDDY UNIT No. 153 / Well Pad Topo

THE BIG EDDY UNIT No. 153 LOCATED 660' FROM
THE SOUTH LINE AND 1980' FROM THE EAST LINE OF
SECTION 20, TOWNSHIP 21 SOUTH, RANGE 29 EAST,
N.M.P.M., EDDY COUNTY, NEW MEXICO.

Survey Date: 01-21-2005

Sheet 1 of 1 Sheets

**EIGHT POINT DRILLING PROGRAM
BASS ENTERPRISES PRODUCTION CO.****NAME OF WELL: BIG EDDY UNIT #153****LEGAL DESCRIPTION - SURFACE: 660' FSL & 1980' FEL, Section 20, T21S, R29E, Eddy County, New Mexico.****POINT 1: ESTIMATED FORMATION TOPS**

(See No. 2 Below)

POINT 2: WATER, OIL, GAS AND/OR MINERAL BEARING FORMATIONS**Anticipated Formation Tops: KB 3335' (est)
GL 3313'**

<u>FORMATION</u>	<u>ESTIMATED TOP FROM KB</u>	<u>ESTIMATED SUBSEA TOP</u>	<u>BEARING</u>
T/Rustler	135'	+ 3,200'	Barren
T/Salt	435'	+ 2,900'	Barren
T/Delaware Mtn Group	2,960'	+ 375'	Oil/Gas
T/Bone Spring	6,635'	- 3,300'	Oil/Gas
T/Atoka	11,475'	- 8,140'	Oil/Gas
T/UPR Morrow	12,035'	- 8,700'	Oil/Gas
T/Lower Morrow	12,745'	- 9,410'	Oil/Gas
TD	13,100'	- 9,765'	

POINT 3: CASING PROGRAM

<u>TYPE</u>	<u>INTERVALS</u>	<u>PURPOSE</u>	<u>CONDITION</u>
20"	0' - 40'	Conductor	Contractor Discretion
13-3/8", 48#, H40, STC	0' - 390'	Surface	New
9-5/8", 36#, K-55, LTC	0' - 2,850'	Intermediate	New
7", 26#, HCP-110, LTC	0' - 13,100'	Production Casing	New

POINT 4: PRESSURE CONTROL EQUIPMENT (SEE ATTACHED DIAGRAM)

A rotating head will be nipped up on the surface casing. The rotating head will not be hydro-tested.

A BOP equivalent to Diagram 1 will be nipped up on the intermediate casing. The BOP stack, choke, kill lines, kelly cocks, inside BOP, etc. will be hydro-tested to 5,000 psi. The annular will be tested to 2500 psi. In addition to the rated working pressure test, a low pressure (250 psi) test will be required. These tests will be performed:

- a) Upon installation
- b) After any component changes
- c) Twenty-one days after a previous test
- d) As required by well conditions

A function test to insure that the preventers are operating correctly will be performed on each trip. See the attached Diagram 1 for the minimum criteria for the choke manifold.

POINT 5: MUD PROGRAM

<u>DEPTH</u>	<u>MUD TYPE</u>	<u>WEIGHT</u>	<u>FV</u>	<u>PV</u>	<u>YP</u>	<u>FL</u>	<u>Ph</u>
0' - 390'	FW	8.5 - 9.2	45-35	NC	NC	NC	9.5
390' - 2,850'	SBW	9.8 - 10.2	28-30	NC	NC	NC	9.5
2,850' - 9,800'	FW	8.6 - 8.9	28-30	4	2	NC	9.5
9,800' - 11,300'	SBW	9.8 - 10.2	28-30	6	4	<20	9.5
11,300' - TD	BW/Polymer	10.0 - 11.5	32-55	12-20	12-22	10-15	9.5-10.0

POINT 6: TECHNICAL STAGES OF OPERATION**A) TESTING**

Drill stem tests may be performed on significant shows in zones of interest, but none are anticipated.

B) LOGGING

One run at 13,100' PTD.

Run #1:

GR-CNL-LDT-LLD run from TD to ICP, GR-CNL to surface. May run logging suite across Delaware prior to drilling below 6000' if mud log shows warrant.

C) CORING

Several cores may be cut in the Morrow formation to determine shale stability and drilling fluid compatibility.

D) CEMENT

<u>SURFACE</u> <u>INTERVAL</u>	<u>AMOUNT SX</u>	<u>FT OF</u> <u>FILL</u>	<u>TYPE</u>	<u>GALS/SX</u>	<u>PPG</u>	<u>FT³/SX</u>
Lead 0' - 390' (100% Excess)	450	390	Premium Plus + 2% CaCl ₂ + 1/2#/sx Pol-e-flake	6.32	14.80	1.34

INTERMEDIATE

<u>INTERVAL</u>	<u>AMOUNT SXS</u>	<u>FT OF</u> <u>FILL</u>	<u>TYPE</u>	<u>GALS/SX</u>	<u>PPG</u>	<u>FT³/SX</u>
Lead 0' - 2350' (100% Excess)	700	2350	Interfill C + 1/2#/sx Pol-e-flake	14.10	11.90	2.45
Tail 2350' - 2850' (100% Excess)	270	500	Premium Plus + 2% CaCl ₂	6.34	14.80	1.34

PRODUCTION (Two stage w/DV tool @ 8000' and circulate cement to 2500')

<u>INTERVAL</u>	<u>AMOUNT SXS</u>	<u>FILL</u>	<u>TYPE</u>	<u>GALS/SX</u>	<u>PPG</u>	<u>FT³/SX</u>
1st Stage						
LEAD 8000' - 11,000' (50% excess)	275	3000	Interfill H + 5pps Gilsontite + 0.5% Halad 9 + 1/8 pps Pol-e-flake	13.61	11.90	2.46
TAIL 11,000' - 13,100' (50% excess)	300	2100	Super H + 0.5% Halad 344 + 0.4% CFR3 + 5 pps Gilsontite + 1 pps Salt + 0.2% HRT	8.20	13.00	1.67
2nd Stage						
LEAD 2500' - 7,300' (50% excess)	450	4800	Interfill H + 1/8 pps Pol-e-flake + 0.5% Halad 9	14.00	11.90	2.45
TAIL 7,300' - 8,000' (50% excess)	100	700	Super H + 0.5% Halad 344 + 0.4% CFR3 + 5 pps Gilsontite + 1 pps Salt + 0.2% HRT	8.20	13.00	1.67

E) DIRECTIONAL DRILLING

No directional services anticipated. A straight hole will be drilled to 13,100' TD.

POINT 7: ANTICIPATED RESERVOIR CONDITIONS

Normal pressures are anticipated throughout the Delaware, Bone Spring & Wolfcamp sections. The Atoka expected BHP is 6578 (max) or an equivalent mud weight of 11.0 ppg. The Morrow will be normally pressured. The expected BHT at TD is 200°F. No H₂S is anticipated.

POINT 8: OTHER PERTINENT INFORMATION

A) Auxiliary Equipment

Upper and lower kelly cocks. Full opening stab in valve on the rig floor.

B) Anticipated Starting Date

Upon approval

47 days drilling operations

20 days completion operations

2-11-05
Date

WCH/cdg

William R. Dannels
William R. Dannels

MULTI-POINT SURFACE USE PLAN**NAME OF WELL: BIG EDDY UNIT #153****LEGAL DESCRIPTION – SURFACE:** 660' FSL & 1980' FEL, Section 20, T21S-R29E, Eddy County, NM**POINT 1: EXISTING ROADS****A) Proposed Well Site Location**

See Exhibit "A".

B) Existing Roads:

Turn South off Hwy 62-180 between mile markers 46 and 47 (road to Sandpoint Landfill) and go 0.9 miles. Turn right and follow road around landfill 0.5 miles, then veer right and go 0.6 miles. Turn left and go 2.0 miles then turn right and go 1.4 miles. Turn left and go through cattle guard to Big Eddy Unit #94 location. New lease road goes 0.6 miles southeast to location.

C) Existing Road Maintenance or Improve Plan:

See Exhibit "A"

POINT 2: NEW PLANNED ACCESS ROUTE**A) Route Location:**

See Exhibit "A". The new road will be 12' wide and approximately 3300' long from existing lease road. The road will be constructed of watered and compacted caliche.

B) Width

12' Wide.

C) Maximum Grade

Not Applicable.

D) Turnouts

As required by BLM stipulations

E) Culverts, Cattle Guards, and Surfacing Equipment

None

POINT 3: LOCATION OF EXISTING WELLS

Exhibits "A" and "B" indicates existing wells within the surrounding area.

POINT 4: LOCATION OF EXSITING OR PROPOSED FACILITIES**A) Existing facilities within one mile owned or controlled by lessee/operator:**

Bass production facilities are located at Bass Big Eddy Unit #94 wellsite.

I) Archeological Resources

An archeological survey will be obtained for this area. The survey area will be a 750' x 750' square with its center on the wellhead stake. Before any construction begins, a full and complete archeological survey will be submitted to the BLM. Any location or construction conflicts will be resolved before construction begins.

J) Surface Ownership

The well site and access road are both on federally owned land.

K) Well signs will be posted at the drilling site.**L) Open Pits**

All pits containing liquid or mud will be fenced and bird-netted.

POINT 12: OPERATOR'S FIELD REPRESENTATIVE

(Field personnel responsible for compliance with development plan for surface use).

DRILLING
William R. Dannels
Box 2760
Midland, Texas 79702
(432) 683-2277

PRODUCTION
Mike Waygood
3104 East Green Street
Carlsbad, New Mexico 88220
(505) 887-7329

Kent A. Adams
Box 2760
Midland, Texas 79702
(432) 683-2277

POINT 13: CERTIFICATION

I hereby certify that I, or persons under my direct supervision have inspected the proposed drill site and access route; that I am familiar with the conditions which currently exist; that the statements made in the plan are, to the best of my knowledge, true and correct; and that the work associated with operations proposed herein will be performed by Bass Enterprises Production Co. and its contractors and subcontractors in conformity with this plan and the terms and conditions under which it is approved. This statement is subject to the provisions of 18 U.S.C. 1001 for the filing of a false statement.

2-11-05
Date

William R. Dannels
William R. Dannels

WCH/cdg

UNITED STATES
DEPARTMENT OF THE INTERIOR
BUREAU OF LAND MANAGEMENTFORM APPROVED
OMB No. 1004-0137
Expires: March 31, 2007

SUNDRY NOTICES AND REPORTS ON WELLS

Do not use this form for proposals to drill or to re-enter an abandoned well. Use Form 3160-3 (APD) for such proposals.

SUBMIT IN TRIPLICATE - Other instructions on reverse side

1. Type of Well
☒ Oil Well ☐ Gas Well ☐ Other2. Name of Operator
Bass Enterprises Production Co.3a. Address
P. O. Box 2760 Midland TX 797023b. Phone No. (include area code)
(432) 683-2277

4. Location of Well (Footage, Sec., T., R., M., or Survey Description)

SWSW 660' FWL & 1980' FEL
Section 20, T21S, R29E
Lat - 32.459472 deg, Long 104.004556 deg

5. Lease Serial No.

NMNM04228

6. If Indian, Allottee or Tribe Name

7. If Unit or CA/Agreement, Name and/or No.

NMNM68294X

8. Well Name and No.

Big Eddy Unit #153

9. API Well No.

30-015-34012

10. Field and Pool, or Exploratory Area

Golden Lane - Morrow

11. County or Parish, State

Eddy
New Mexico

12. CHECK APPROPRIATE BOX(ES) TO INDICATE NATURE OF NOTICE, REPORT, OR OTHER DATA

TYPE OF SUBMISSION	TYPE OF ACTION			
<input type="checkbox"/> Notice of Intent	<input type="checkbox"/> Acidize	<input type="checkbox"/> Deepen	<input type="checkbox"/> Production (Start/Resume)	<input type="checkbox"/> Water Shut-Off
<input checked="" type="checkbox"/> Subsequent Report	<input type="checkbox"/> Alter Casing	<input type="checkbox"/> Fracture Treat	<input type="checkbox"/> Reclamation	<input type="checkbox"/> Well Integrity
<input type="checkbox"/> Final Abandonment Notice	<input type="checkbox"/> Casing Repair	<input type="checkbox"/> New Construction	<input type="checkbox"/> Recomplete	<input checked="" type="checkbox"/> Other Drilling Operations
	<input type="checkbox"/> Change Plans	<input type="checkbox"/> Plug and Abandon	<input type="checkbox"/> Temporarily Abandon	
	<input type="checkbox"/> Convert to Injection	<input type="checkbox"/> Plug Back	<input type="checkbox"/> Water Disposal	

13. Describe Proposed or Completed Operation (clearly state all pertinent details, including estimated starting date of any proposed work and approximate duration thereof. If the proposal is to deepen directionally or recompleat horizontally, give subsurface locations and measured and true vertical depths of all pertinent markers and zones. Attach the Bond under which the work will be performed or provide the Bond No. on file with BLM/BIA. Required subsequent reports shall be filed within 30 days following completion of the involved operations. If the operation results in a multiple completion or recompletion in a new interval, a Form 3160-4 shall be filed once testing has been completed. Final Abandonment Notices shall be filed only after all requirements, including reclamation, have been completed, and the operator has determined that the site is ready for final inspection.)

Spud well at 11:00 pm on 9/17/05. Drilled 17-1/2" hole to 508'. Ran 2 jts 13-5/8", 54.5#, J55 and 10 jts 48#, WC-40 & H-40 STC casing and set at 508'. Cemented with Halliburton Lite Premium Plus + 2.7# Salt lead and 340 sx Premium Plus + 2% CaCl tail. Circ 125 sx to surface. WOC 32 hrs. Test casing to 650 psi/30 min. Drill 12-1/4" hole to 2973'. Ran 67 jts 9-5/8", 36#, J55, BTC casing and set at 2971.50'. Cemented with 750 sx Interfill C + 0.25 pps Flocele lead and 230 sx Premium Plus + 2% CaCl tail. Circ 55 sx to surface. Test casing to 2500 psi/ 1 hr, held ok. Drill 8-3/4" hole to 13,060'. Cemented in 2 stages: 1st stage - 435 sx Premium Interfill + 5 pps Ginsonite + 0.5% Halad-9 + 0.25% Flocele tailed w/ 330 sx Super H + 5 pps Gilonite + 1 pps Salt + 0.5% Halad-344 + 0.4% CRF-3 + 0.4% HR-7. Circ 113 sx to surface after 1st stage. 2nd stage - 915 sx Premium Interfill + 0.5% Halad-9 + 0.25% Flocele tailed with 215 sx Premium H + 0.5% HR-5. TOC by temperature survey 2220'.

Rig released at 6:00 pm on 11/15/05.

ACCEPTED FOR RECORD

DEC 14 2005

LES BABYAK
PETROLEUM ENGINEER14. I hereby certify that the foregoing is true and correct
Name (Printed/Typed)

Annette Childers

Title Administrative Assistant

Signature

Annette Childers

Date 12/08/2005

THIS SPACE FOR FEDERAL OR STATE OFFICE USE

Approved by

Conditions of approval, if any, are attached. Approval of this notice does not warrant or certify that the applicant holds legal or equitable title to those rights in the subject lease which would entitle the applicant to conduct operations thereon.

Title

Date

Office

Title 18 U.S.C. Section 1001 and Title 43 U.S.C. Section 1212, make it a crime for any person knowingly and willfully to make to any department or agency of the United States any false, fictitious or fraudulent statements or representations as to any matter within its jurisdiction.

(Instructions on page 2)

N.M. Oil Cons. DIV-Dist. 2
UNITED STATES
DEPARTMENT OF THE INTERIOR
BUREAU OF LAND MANAGEMENT
301 W. Grand Avenue
Alamogordo, NM 88210FORM APPROVED
OMB No. 1004-0137
Expires: March 31, 2007

SUNDRY NOTICES AND REPORTS ON WELLS

Do not use this form for proposals to drill or to re-enter an abandoned well. Use Form 3160-3 (APD) for such proposals.

SUBMIT IN TRIPLICATE - Other instructions on reverse side.

1. Type of Well
☒ Oil Well ☐ Gas Well ☐ Other

RECEIVED

2. Name of Operator
Bass Enterprises Production Co.

JAN 04 2006

3a. Address
P. O. Box 2760 Midland TX 797023b. Phone No. (Area Code)
(432) 683-2277

4. Location of Well (Footage, Sec., T., R., M., or Survey Description)

SWSW 660' FWL & 1980' FEL
Section 20, T21S, R29E
Lat - 32.459472 deg, Long 104.004556 deg

5. Lease Serial No.

NMNM04228

6. If Indian, Allottee or Tribe Name

7. If Unit or CA/Agreement, Name and/or No.
NMNM68294X

8. Well Name and No.

Big Eddy Unit #153

9. API Well No.

30-015-34012

10. Field and Pool, or Exploratory Area

Golden Lane - Morrow

11. County or Parish, State

Eddy
New Mexico

12. CHECK APPROPRIATE BOX(ES) TO INDICATE NATURE OF NOTICE, REPORT, OR OTHER DATA

TYPE OF SUBMISSION	TYPE OF ACTION			
<input checked="" type="checkbox"/> Notice of Intent	<input type="checkbox"/> Acidize	<input type="checkbox"/> Deepen	<input type="checkbox"/> Production (Start/Resume)	<input type="checkbox"/> Water Shut-Off
<input checked="" type="checkbox"/> Subsequent Report	<input type="checkbox"/> Alter Casing	<input type="checkbox"/> Fracture Treat	<input type="checkbox"/> Reclamation	<input type="checkbox"/> Well Integrity
<input type="checkbox"/> Final Abandonment Notice	<input type="checkbox"/> Casing Repair	<input type="checkbox"/> New Construction	<input type="checkbox"/> Recomplete	<input checked="" type="checkbox"/> Other Planned
	<input type="checkbox"/> Change Plans	<input type="checkbox"/> Plug and Abandon	<input type="checkbox"/> Temporarily Abandon	Lateral Drig
	<input type="checkbox"/> Convert to Injection	<input type="checkbox"/> Plug Back	<input type="checkbox"/> Water Disposal	

13. Describe Proposed or Completed Operation (clearly state all pertinent details, including estimated starting date of any proposed work and approximate duration thereof. If the proposal is to deepen directionally or recomplete horizontally, give subsurface locations and measured and true vertical depths of all pertinent markers and zones. Attach the Bond under which the work will be performed or provide the Bond No. on file with BLM/BIA. Required subsequent reports shall be filed within 30 days following completion of the involved operations. If the operation results in a multiple completion or recompletion in a new interval, a Form 3160-4 shall be filed once testing has been completed. Final Abandonment Notices shall be filed only after all requirements, including reclamation, have been completed, and the operator has determined that the site is ready for final inspection.)

Bass Enterprises Production Co. is planning to lateral drill of the subject well.
Planned lateral: KOP 12,263' MD, 12,259' TVD and EOL 14,706' MD, 12,673' TVD.
BHL will be located at 2383' FSL & 567' FEL, Sec 20, T21S, R29E.
Total displacement will be 2,272' at an azimuth at N 40 deg E.

14. I hereby certify that the foregoing is true and correct	
Name (Printed/Typed) Annette Childers	Title Administrative Assistant
Signature <i>Annette Childers</i>	Date 12/21/2005

THIS SPACE FOR FEDERAL OR STATE OFFICE USE

Approved by (ORIG. SGD.) ALEXIS C. SWOBODA	PETROLEUM ENGINEER	Date DEC 27 2005
Conditions of approval, if any, are attached. Approval of this notice does not warrant or certify that the applicant holds legal or equitable title to those rights in the subject lease which would entitle the applicant to conduct operations thereon.		Office

Title 18 U.S.C. Section 1001 and Title 43 U.S.C. Section 1212, make it a crime for any person knowingly and willfully to make to any department or agency of the United States any false, fictitious or fraudulent statements or representations as to any matter within its jurisdiction.

(Instructions on page 2)

DISTRICT I
1825 N. French Dr., Hobbs, NM 88240

DISTRICT II
511 South First, Artesia, NM 88210

DISTRICT III
1000 Rio Brazos Rd., Artec, NM 87410

DISTRICT IV
2040 South Pacheco, Santa Fe, NM 87505

State of New Mexico
Energy, Minerals and Natural Resources Department

Form C-102
Revised March 17, 1989

Submit to Appropriate District Office
State Lease - 4 Copies
Fee Lease - 3 Copies

OIL CONSERVATION DIVISION

2040 South Pacheco
Santa Fe, New Mexico 87504-2088

☐ AMENDED REPORT

WELL LOCATION AND ACREAGE DEDICATION PLAT

API Number	Pool Code	Pool Name
Property Code	Property Name BIG EDDY UNIT	Well Number 153
OGRID No.	Operator Name BASS ENTERPRISES PRODUCTION COMPANY	Elevation 3313'

Surface Location

UL or lot No.	Section	Township	Range	Lot Idn	Feet from the	North/South line	Feet from the	East/West line	County
0	20	21 S	29 E		660	SOUTH	1980	EAST	EDDY

Bottom Hole Location If Different From Surface

UL or lot No.	Section	Township	Range	Lot Idn	Feet from the	North/South line	Feet from the	East/West line	County
---------------	---------	----------	-------	---------	---------------	------------------	---------------	----------------	--------

Dedicated Acres	Joint or Infill	Consolidation Code	Order No.
-----------------	-----------------	--------------------	-----------

NO ALLOWABLE WILL BE ASSIGNED TO THIS COMPLETION UNTIL ALL INTERESTS HAVE BEEN CONSOLIDATED
OR A NON-STANDARD UNIT HAS BEEN APPROVED BY THE DIVISION

		<p>OPERATOR CERTIFICATION</p> <p>I hereby certify the the information contained herein is true and complete to the best of my knowledge and belief.</p> <p>Signature W.R. DANNELS</p> <p>Printed Name DIVISION DRILLING SUPT.</p> <p>Title</p> <p>Date</p> <p>SURVEYOR CERTIFICATION</p> <p>I hereby certify that the well location shown on this plat was plotted from field notes of actual surveys made by me or under my supervision, and that the same is true and correct to the best of my belief.</p> <p>Date Surveyed JANUARY 21, 2005</p> <p>Signature of Professional Surveyor 7977</p> <p>Certificate No. Gary L. Jones 7977</p> <p>BASIN SURVEYS</p>
--	--	---

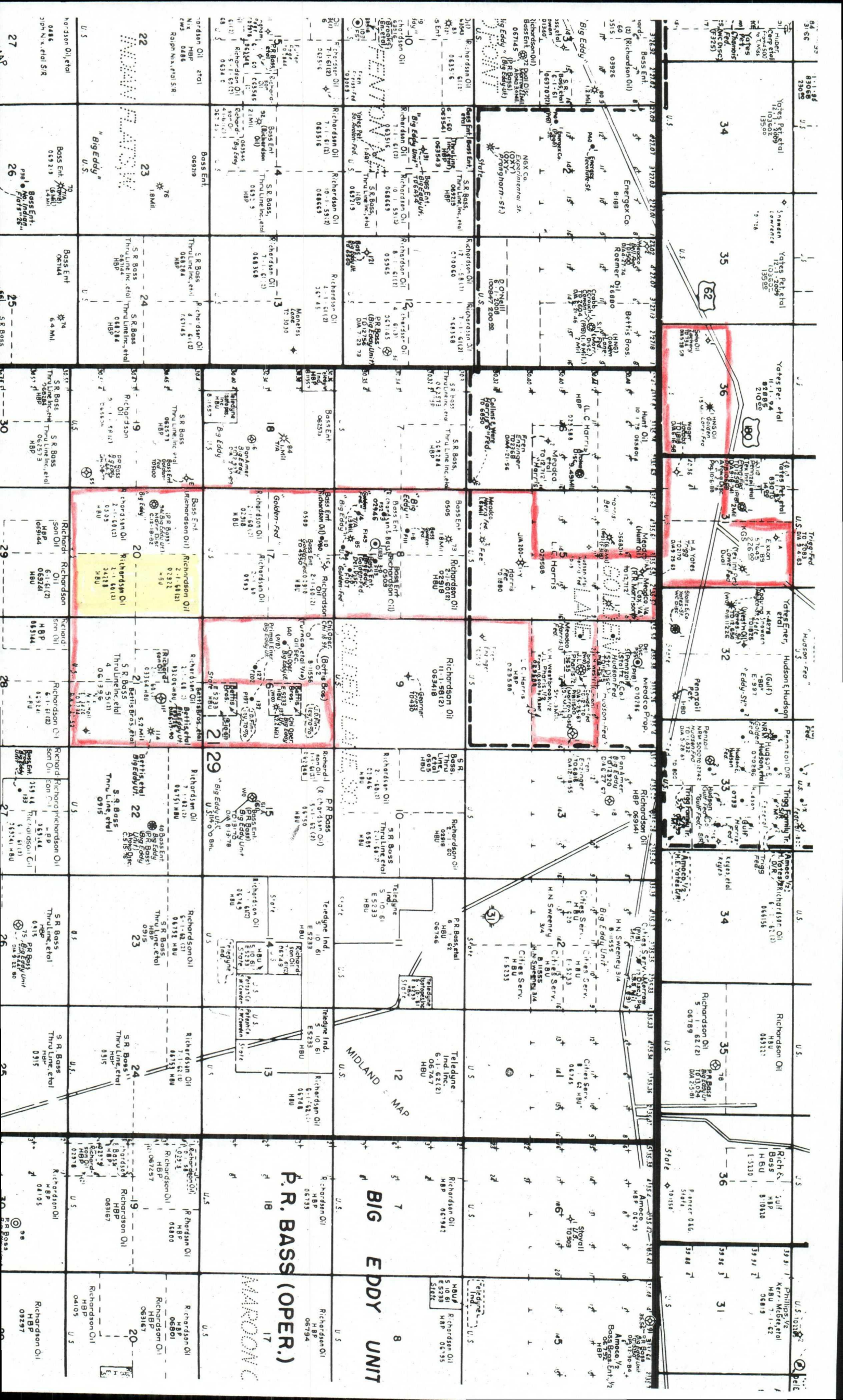

BEFORE THE OIL CONSERVATION COMMISSION
OF THE STATE OF NEW MEXICO

IN THE MATTER OF THE HEARING
CALLED BY THE OIL CONSERVATION
COMMISSION OF NEW MEXICO FOR
THE PURPOSE OF CONSIDERING:

CASE NO. 365
ORDER NO. R-152

THE MATTER OF THE APPLICATION
OF RICHARDSON & BASS, A CO-PARTNER-
SHIP, FOR APPROVAL OF THE BIG EDDY
UNIT AGREEMENT, EMBRACING 133,444.29
ACRES IN EDDY AND LEA COUNTIES, NEW
MEXICO, WITHIN TOWNSHIPS 19, 20, 21, 22
AND 23 S., RANGES 28, 29, 30, 31 AND 32E.,
NMPM.

ORDER OF THE COMMISSION

BY THE COMMISSION:

This cause came on for hearing at 9 o'clock a.m. on April 28, 1952, at Santa Fe, New Mexico, before the Oil Conservation Commission of New Mexico, hereinafter referred to as the "Commission."

NOW, on this 1st day of May, 1952, the Commission, a quorum being present, having considered said application and the evidence introduced in support thereof, and being fully advised in the premises,

FINDS:

- (1) That due public notice having been given as required by law, the Commission has jurisdiction of this cause and the subject matter thereof.
- (2) That the proposed unit plan will in principle tend to promote the conservation of oil and gas and the prevention of waste.

IT IS THEREFORE ORDERED:

SECTION 1. That this order shall be known as the

BIG EDDY UNIT AGREEMENT ORDER

SECTION 2. (a) That the project herein referred to shall be known as the Big Eddy Unit Agreement, and shall hereafter be referred to as the "Project".

(b) That the plan by which the Project shall be operated shall be embraced in the form of a unit agreement for the development and operation of the Big Eddy Unit Area referred to in the Petitioner's petition and filed with said petition, and such plan shall be known as the Big Eddy Unit Agreement Plan.

SECTION 3. That the Big Eddy Unit Agreement Plan shall be, and hereby is, approved in principle as a proper conservation measure; provided, however, that notwithstanding any of the provisions contained in said unit agreement this approval shall not be considered as waiving or relinquishing in any manner any right, duties or obligations which are now, or may hereafter, be vested in the New Mexico Oil Conservation Commission by law relative to the supervision and control of operations for exploration and development of any lands committed to said Big Eddy Unit Agreement, or relative to the production of oil or gas therefrom.

SECTION 4. (a) That the Unit Area shall be:

NEW MEXICO PRINCIPAL MERIDIAN

Twp. 19 S., Rge. 31 E.

Sec. 27: S 1/2

Sec. 33: E 1/2

Sec. 34: All

Sec. 35: All

Twp. 20 S., Rge. 30 E.

Secs. 25 to 27, both inclusive: All

Secs. 34 to 36, both inclusive: All

Twp. 20 S., Rge. 31 E.

Secs. 2 to 36, both inclusive: All

Twp. 20 S., Rge. 32 E.

Sec. 7: All

Sec. 8: W 1/2 W 1/2

Secs. 17 to 21, both inclusive: All

Sec. 27: S 1/2 S 1/2

Secs. 28 to 34, both inclusive: All

Twp. 21 S., Rge. 28 E.

Secs. 3 to 36, both inclusive: All

Twp. 21 S., Rge. 29 E.

Secs. 1 to 3, both inclusive: All

Secs. 7 to 36, both inclusive: All

Twp. 21 S., Rge. 30 E.

Secs. 1 to 12, both inclusive: All
Secs. 14 to 22, both inclusive: All
Sec. 23: All
Sec. 27: N 1/2
Secs. 28 to 30, both inclusive: All

Twp. 21 S., Rge. 31 E.

Sec. 3: Lots 1 to 16, inclusive.
Secs. 4 to 6, both inclusive: All
Secs. 7 to 9, both inclusive: All

Twp. 22 S., Rge. 28 E.

Secs. 1 to 5, both inclusive: All
Sec. 6: Lots, 1, 2, 3, 4, 5, SE 1/4 NW 1/4, S 1/2 NE 1/4, SE 1/4
Sec. 8: E 1/2, E 1/2 W 1/2
Secs. 9 to 14, both inclusive: All
Sec. 15: NE 1/4, E 1/2 SE 1/4
Sec. 17: N 1/2 N 1/2
Sec. 22: E 1/2 NE 1/4
Secs. 23 to 25, both inclusive: All

Twp. 22 S., Rge. 29 E.

Secs. 2 to 10, both inclusive: All
Secs. 15 to 22, both inclusive: All
Secs. 27 to 30, both inclusive: All
Sec. 31: E 1/2
Secs. 32 to 34, both inclusive: All
Sec. 35: W 1/2, W 1/2 SE 1/4

Twp. 23 S., Rge. 29 E.

Sec. 2: All
Sec. 3: Lots 1, 2, 3, 4, S 1/2 N 1/2, N 1/2 S 1/2, S 1/2 SE 1/4 SE 1/4 SW 1/4
Sec. 4: Lots 1, 2, 3, 4, S 1/2 N 1/2, N 1/2 SE 1/4

Total unit area: 133,444.29 acres, more or less.

(b) The unit area may be enlarged or contracted as provided in said Plan.

SECTION 5. That the unit operator shall file with the Commission an executed original or executed counterpart of the Big Eddy Unit Agreement within 30 days after the effective date thereof.

CASE No. 365
Order No. R-152

SECTION 6. That any party owning rights in the unitized substances who does not commit such rights to said unit agreement before the effective date thereof may thereafter become a party thereto by subscribing to such agreement or counterpart thereof, or by ratifying the same. The unit operator shall file with the Commission within 30 days an original of any such counterpart or ratification.

SECTION 7. That this order shall become effective upon approval of said unit agreement by the Commissioner of Public Lands of the State of New Mexico and the Director of the United States Geological Survey, and shall terminate ipso facto upon the termination of said unit agreement. The last unit operator shall immediately notify the Commissioner in writing of such termination.

DONE at Santa Fe, New Mexico, on the day and year hereinabove designated.

STATE OF NEW MEXICO
OIL CONSERVATION COMMISSION

EDWIN L. MECHEM, Chairman

GUY SHEPARD, Member

R. R. SPURRIER, SECRETARY

S E A L

DAUGHERITY-GRAYBURG-SAN ANDRES POOL
(Formerly Daugherty-San Andres Pool)
Eddy County, New Mexico

Order No. 850, January 1, 1950, Redefining Pool, as Amended by Order No. R-5456, July 1, 1977; Order No. R-5667, April 1, 1978.

T-17-S, R-27-E NW/4 SW/4 Sec. 2; Sec. 3; N/2 NE/4 Sec. 10.

DAYTON-ABO POOL
Eddy County, New Mexico

Order No. R-1312, December 24, 1958, Establishing Pool, as Amended by Order No. R-1355, March 20, 1959; Order No. R-1441, July 21, 1959; Order No. R-1532, November 23, 1959.

T-18-S, R-26-E W/2 Sec. 25; S/2 Sec. 26; S/2 SE/4 Sec. 27; NE/4 Sec. 34; NW/4 NW/4 Sec. 35; NW/4 Sec. 36.

EAST DAYTON-GRAYBURG POOL
Eddy County, New Mexico

Order No. 850, January 1, 1950, Redefining Pool, as Amended by Order No. R-1652, April 19, 1960; Order No. R-1720, July 15, 1960; Order No. R-1772, September 16, 1960.

T-18-S, R-27-E N/2 SW/4, NW/4 Sec. 28; N/2, N/2 SE/4 Sec. 29.

DEAN-DEVONIAN POOL
Lea County, New Mexico

Order No. R-707, October 13, 1955, Establishing Pool, as Amended by Order No. R-892, October 4, 1956.

T-15-S, R-36-E Sec. 26; SE/4, E/2 NE/4 Sec. 34; Sec. 35.

T-16-S, R-37-E Lots 1 through 8 Sec. 5; Lots 1, 2, 7, 8 Sec. 6.

DEAN PERMO-PENNSYLVANIAN POOL
Lea County, New Mexico

Order No. R-757, March 14, 1956, Establishing Pool, as Amended by Order No. R-892, October 4, 1956; Order No. R-928, December 13, 1956; Order No. R-948, January 30, 1957; Order No. R-1397, May 18, 1959; Order No. R-10556, March 1, 1996.

T-15-S, R-36-E S/2 SE/4 Sec. 23; S/2 SW/4 Sec. 25; Sec. 26; SE/4, E/2 NE/4 Sec. 34; Sec. 35; NW/4, W/2 SW/4 Sec. 36.

T-16-S, R-37-E Lots 1 through 8 Sec. 4; Lots 1 through 8 Sec. 5; Lot 1 Sec. 6.

EAGLE CREEK-ATOKA GAS POOL
Eddy County, New Mexico

Order No. R-4279, April 1, 1972, Establishing Pool.

T-17-S, R-25-E W/2 Sec. 11.

GOLDEN LANE-MORROW GAS POOL
Eddy County, New Mexico

Order No. R-4279, April 1, 1972, Establishing Pool, as Amended by Order No. R-4861, November 1, 1974; Order No. R-6274, March 1, 1980; Order No. R-6838, December 1, 1981; Order No. R-7307, July 1, 1983; Order No. R-9326, November 1, 1990; Order No. R-11005, August 1, 1998; Order No. R-12288, March 1, 2005.

T-20-S, R-29-E S/2 Sec. 36.

T-20-S, R-30-E E/2, SW/4 Sec. 31.

T-21-S, R-29-E Lots 9 through 16 Sec. 4; Lots 1, 2, 7, 8, 9, 10, 15, 16, S/2 Sec. 5; Sec. 8; E/2 Sec. 16; Secs. 17, 20, 21.

HARE-GLORIETA POOL
Lea County, New Mexico

Order No. R-4279, April 1, 1972, Establishing Pool.

T-21-S, R-37-E SW/4 Sec. 12.

OSUDO-DEVONIAN GAS POOL
Lea County, New Mexico

Order No. R-4279, April 1, 1972, Establishing Pool, as Amended by Order No. R-4304, June 1, 1972.

T-20-S, R-36-E E/2 Sec. 31; W/2 Sec. 32.

WASHINGTON RANCH-MORROW GAS POOL
Eddy County, New Mexico

Order No. R-4279, April 1, 1972, Establishing Pool, as Amended by Order No. R-4377, September 1, 1972; Order No. R-4437, December 1, 1972; Order No. R-4734, March 1, 1974; Order No. R-4782, June 1, 1974.

T-25-S, R-24-E Sec. 27; S/2 Sec. 28; E/2 Sec. 33; Sec. 34; W/2 Sec. 35.

T-26-S, R-24-E W/2 Sec. 2; Sec. 3; E/2 Sec. 4; Sec. 11; N/2 Sec. 12.

County Eddy

Pool Golden Lane-Morrow Gas

TOWNSHIP

20 South

Range

29 East

NMPM

6	5	4	3	2	1
7	8	9	10	11	12
18	17	16	15	14	13
19	20	21	22	23	24
30	29	28	27	26	25
31	32	33	34	35	36

Ext: 5/2 Sec. 36 (K-12288, 2-23-05)

COUNTY *Eddy*POOL *Golden Lane - Morrow Gas*TOWNSHIP *20 South*RANGE *30 East*

NMPM

6	5	4	3	2	1
7	8	9	10	11	12
18	17	16	15	14	13
19	20	21	22	23	24
30	29	28	27	26	25
31	32	33	34	35	36

Ext: $\frac{E}{2}$ Sec 31 (R-4861, 11-1-74) Ext: $\frac{SW}{4}$ Sec. 31 (R-12288, 2-23-05)

COUNTY Eddy

POOL Golden Lane - Morrow Gas

(77560)

TOWNSHIP 21 South

RANGE 29 East

NMPM

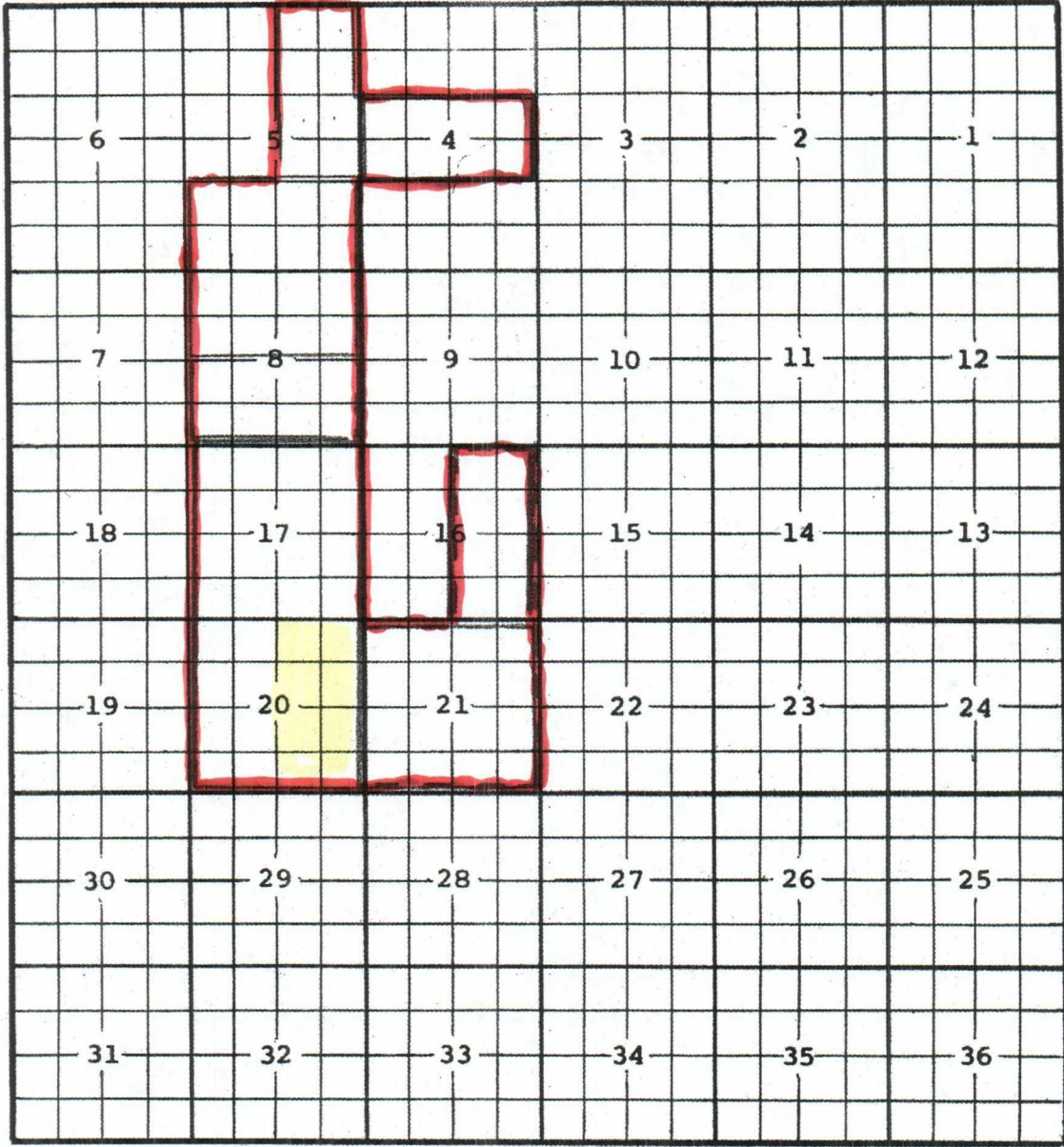

Description: Lots 9 thru 16 Sec. 4 (R-4279, 4-1-72)

Ext: Lots 1, 2, 7, 8, 9, 10, 15 & 16 Sec. 5 (R-4861, 11-1-74)

Ext: $\frac{3}{4}$ Sec. 5, $\frac{1}{4}$ Sec. 2 (R-6274, 3-1-80)

Ext: $\frac{5}{8}$ Sec. 8 (R-6838, 11-8-81) Ext: All Sec. 17, All Sec. 20 (R-7303, 6-14-83)

Ext: All Sec. 21 (R-9326, 11-7-90) Ext: $\frac{1}{2}$ Sec. 16 (R-11005, 7-24-98)