

ABOVE THIS LINE FOR DIVISION USE ONLY

NEW MEXICO OIL CONSERVATION DIVISION
 - Engineering Bureau -
 1220 South St. Francis Drive, Santa Fe, NM 87505



ADMINISTRATIVE APPLICATION CHECKLIST

THIS CHECKLIST IS MANDATORY FOR ALL ADMINISTRATIVE APPLICATIONS FOR EXCEPTIONS TO DIVISION RULES AND REGULATIONS WHICH REQUIRE PROCESSING AT THE DIVISION LEVEL IN SANTA FE

Application Acronyms:

[NSL-Non-Standard Location] [NSP-Non-Standard Proration Unit] [SD-Simultaneous Dedication]
[DHC-Downhole Commingling] [CTB-Lease Commingling] [PLC-Pool/Lease Commingling]
[PC-Pool Commingling] [OLS - Off-Lease Storage] [OLM-Off-Lease Measurement]
[WFX-Waterflood Expansion] [PMX-Pressure Maintenance Expansion]
[SWD-Salt Water Disposal] [IPI-Injection Pressure Increase]
[EOR-Qualified Enhanced Oil Recovery Certification] [PPR-Positive Production Response]

[1] TYPE OF APPLICATION - Check Those Which Apply for [A]

[A] Location - Spacing Unit - Simultaneous Dedication
☐ NSL ☐ NSP ☐ SD

Check One Only for [B] or [C]

[B] Commingling - Storage - Measurement
☐ DHC ☐ CTB ☐ PLC ☐ PC ☐ OLS ☐ OLM

[C] Injection - Disposal - Pressure Increase - Enhanced Oil Recovery
☐ WFX ☐ PMX ☒ SWD ☐ IPI ☐ EOR ☐ PPR

[D] Other: Specify _____

- SWD 1593
 - Owl SWD Operating, LLC
 30833,
 well
 - Ms CLOY SWD well #2
 30-025-Pending
 Pool
 - SWD, Devonian
 26101

[2] NOTIFICATION REQUIRED TO: - Check Those Which Apply, or ☐ Does Not Apply

- [A]** ☐ Working, Royalty or Overriding Royalty Interest Owners
- [B]** ☒ Offset Operators, Leaseholders or Surface Owner
- [C]** ☒ Application is One Which Requires Published Legal Notice
- [D]** ☒ Notification and/or Concurrent Approval by BLM or SLO
 U.S. Bureau of Land Management - Commissioner of Public Lands, State Land Office
- [E]** ☒ For all of the above, Proof of Notification or Publication is Attached, and/or,
- [F]** ☐ Waivers are Attached

RECEIVED OGD
 2015 OCT 19 A 11:11

[3] SUBMIT ACCURATE AND COMPLETE INFORMATION REQUIRED TO PROCESS THE TYPE OF APPLICATION INDICATED ABOVE.

[4] CERTIFICATION: I hereby certify that the information submitted with this application for administrative approval is **accurate** and **complete** to the best of my knowledge. I also understand that **no action** will be taken on this application until the required information and notifications are submitted to the Division.

Note: Statement must be completed by an individual with managerial and/or supervisory capacity.

Ben Stone		Agent for Owl SWD Operating, LLC	10/17/15
Print or Type Name	Signature	Title	Date
		ben@sosconsulting.us	
		e-mail Address	



October 15, 2015

New Mexico Oil Conservation Division
1220 South St. Francis Drive
Santa Fe, New Mexico 87505

Attn: Mr. David Catanach, Director

Re: Application of Owl SWD Operating, LLC to permit for salt water disposal the proposed well McCloy SWD No.2 well, to be located in Section 15, Township 24 South, Range 32 East, NMPM, Lea County, New Mexico.

Dear Mr. Catanach,

Please find enclosed form C-108 Application for Authority to Inject, supporting the above-referenced request to for disposal in the undrilled McCloy SWD Well No.2.

Owl SWD Operating seeks to create additional solutions for disposal in various locations in southeast New Mexico. Approval of this application is consistent with that goal as well as the NMOCD's mission of preventing waste and protection of correlative rights.

Published legal notice ran in the September 27, 2015 edition of the Hobbs News-Sun and all offset operators and other interested parties have been notified individually. The legal notice affidavit is included in this application. The application also includes wellbore schematics, area of review maps, leaseholder plats and other required information for a complete Form C-108. The well is located on private land and state minerals; the C-101 APD is in process at the Hobbs District Office of OCD.

I respectfully request that the approval of this salt water disposal well proceed swiftly and if you or your staff requires additional information or has any questions, please do not hesitate to call or email me.

Best regards,

Ben Stone, Partner
SOS Consulting, LLC
Agent for Owl SWD Operating, LLC

Cc: Application attachment and file

APPLICATION FOR AUTHORIZATION TO INJECT

- I. PURPOSE: ***Salt Water Disposal*** and the application *qualifies* for administrative approval.
- II. OPERATOR: ***Owl SWD Operating, LLC***
ADDRESS: ***8214 Westchester Dr., Ste. 850, Dallas, TX 75255***
- CONTACT PARTY: ***Agent: SOS Consulting, LLC – Ben Stone (903) 488-9850***
- III. WELL DATA: ***To be Drilled (BLM APD in Process). All well data and applicable wellbore diagrams are ATTACHED.***
- IV. ***This is not an expansion of an existing project.***
- V. ***A map is attached*** that identifies all wells and leases within two miles of any proposed injection well with a one-half mile radius circle drawn around each proposed injection well. This circle identifies the well's area of review.
- *VI. A tabulation is attached of data on all wells of public record within the area of review which penetrate the proposed injection zone. ***There is one well in the AOR, P&A'd but this well does not penetrate the proposed Devonian interval.*** The data includes a description of each well's type, construction, date drilled, location, depth, and a schematic of any plugged well illustrating all plugging detail.
- VII. ***The following data is ATTACHED*** on the proposed operation, including:
1. Proposed average and maximum daily rate and volume of fluids to be injected;
 2. Whether the system is open or closed;
 3. Proposed average and maximum injection pressure;
 4. Sources and an appropriate analysis of injection fluid and compatibility with the receiving formation if other than reinjected produced water; and,
 5. If injection is for disposal purposes into a zone not productive of oil or gas at or within one mile of the proposed well, attach a chemical analysis of the disposal zone formation water (may be measured or inferred from existing literature, studies, nearby wells, etc.).
- *VIII. ***Appropriate geologic data on the injection zone is ATTACHED*** including appropriate lithologic detail, geologic name, thickness, and depth. Give the geologic name, and depth to bottom of all underground sources of drinking water (aquifers containing waters with total dissolved solids concentrations of 10,000 mg/l or less) overlying the proposed injection zone as well as any such sources known to be immediately underlying the injection interval.
- IX. ***No stimulation program is proposed at this time.***
- *X. ***There is no applicable logging and test data on the well. After drilling, logs will be run from TD to approximately 16,000' and will be submitted to the OCD.***
- *XI. ***There are 3 domestic water wells within one mile of the proposed salt water disposal well. Analysis will be forwarded upon receipt.***
- XII. ***An affirmative statement is ATTACHED that available geologic and engineering data has been examined and no evidence was found*** of open faults or any other hydrologic connection between the disposal zone and any underground sources of drinking water.
- XIII. ***"Proof of Notice" section on the next page of this form has been completed. ATTACHED***
There are 11 offset lessees and/or operators within ½ mile and State & BLM - all have been noticed. ATTACHED
- XIV. Certification: I hereby certify that the information submitted with this application is true and correct to the best of my knowledge and belief.

NAME: ***Ben Stone*** TITLE: ***SOS Consulting, LLC agent for Owl SWD Operating, LLC***

SIGNATURE:  DATE: ***10/17/2015***

E-MAIL ADDRESS: ***ben@sosconsulting.us***

- * If the information required under Sections VI, VIII, X, and XI above has been previously submitted, it need not be resubmitted. Please show the date and circumstances of the earlier submittal:

III. WELL DATA – *The following information and data is included (See ATTACHED Wellbore Schematic):*

A. The following well data must be submitted for each injection well covered by this application. The data must be both in tabular and schematic form and shall include:

- (1) Lease name; Well No., Location by Section, Township and Range; and footage location within the section.
- (2) Each casing string used with its size, setting depth, sacks of cement used, hole size, top of cement, and how such top was determined.
- (3) A description of the tubing to be used including its size, lining material, and setting depth.
- (4) The name, model, and setting depth of the packer used or a description of any other seal system or assembly used.

Division District Offices have supplies of Well Data Sheets which may be used or which may be used as models for this purpose. Applicants for several identical wells may submit a "typical data sheet" rather than submitting the data for each well.

B. The following must be submitted for each injection well covered by this application. All items must be addressed for the initial well. Responses for additional wells need be shown only when different. Information shown on schematics need not be repeated.

- (1) The name of the injection formation and, if applicable, the field or pool name.
- (2) The injection interval and whether it is perforated or open-hole.
- (3) State if the well was drilled for injection or, if not, the original purpose of the well.
- (4) Give the depths of any other perforated intervals and detail on the sacks of cement or bridge plugs used to seal off such perforations.
- (5) Give the depth to and the name of the next higher and next lower oil or gas zone in the area of the well, if any.

XIV. PROOF OF NOTICE *pursuant to the following criteria is ATTACHED.*

All applicants must furnish proof that a copy of the application has been furnished, by certified or registered mail, to the owner of the surface of the land on which the well is to be located and to each leasehold operator within one-half mile of the well location.

Where an application is subject to administrative approval, a proof of publication must be submitted. Such proof shall consist of a copy of the legal advertisement which was published in the county in which the well is located. The contents of such advertisement must include:

- (1) The name, address, phone number, and contact party for the applicant;
- (2) The intended purpose of the injection well; with the exact location of single wells or the Section, Township, and Range location of multiple wells;
- (3) The formation name and depth with expected maximum injection rates and pressures; and,
- (4) A notation that interested parties must file objections or requests for hearing with the Oil Conservation Division, 1220 South St. Francis Dr., Santa Fe, New Mexico 87505, within 15 days.

NO ACTION WILL BE TAKEN ON THE APPLICATION UNTIL PROPER PROOF OF NOTICE HAS BEEN SUBMITTED.

NOTICE: Surface owners or offset operators must file any objections or requests for hearing of administrative applications within 15 days from the date this application was mailed to them.

C-108 - Item III

Subject Well Data

WELL SCHEMATIC

Proposed

With Construction Data Detail

(Approved C-101 attached.)

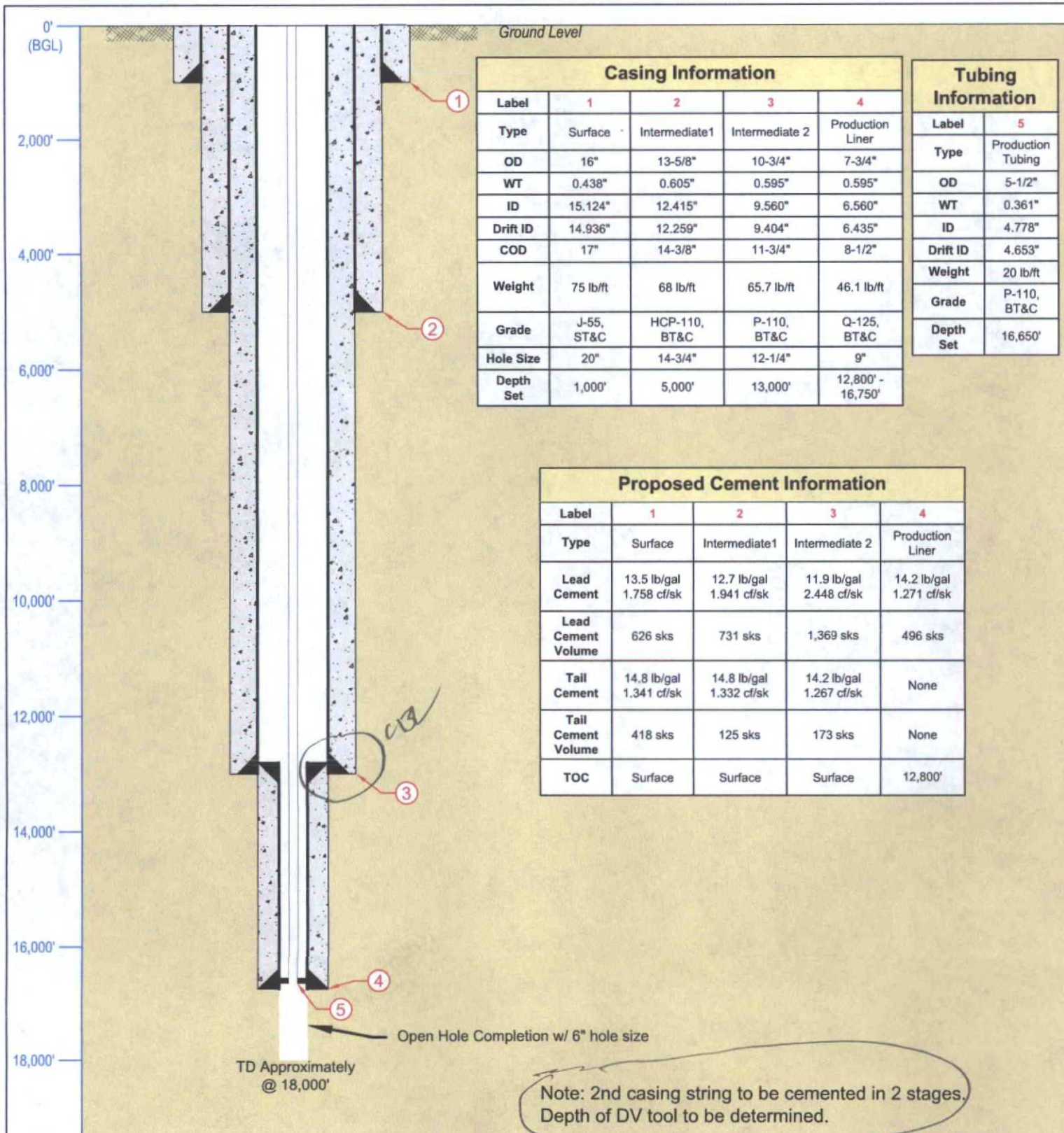

LONQUIST

FIELD SERVICE

AUSTIN HOUSTON WICHITA CALGARY

Texas License F-8652

3345 Bee Cave Road, Suite 201
Austin, Texas 78746
Tel: 512.732.9812
Fax: 512.732.9816

OWL SWD Operating, Inc.

Country: USA

Survey/STR:

API No.:

State ID No.:

Drawn: MMC

Rev No: 4

McCloy - Devonian SWD

State/Province: New Mexico

Site:

Field:

Project No: 1116

Reviewed: SLP

Notes:

County/Parish:

Status: To Be Drilled

Ground Elevation:

Date: 3/29/2015

Approved: SLP

McCloy SWD Well No.1 - Area of Review / 2 Miles

(Attachment to NMOCD Form C-108 - Item V)

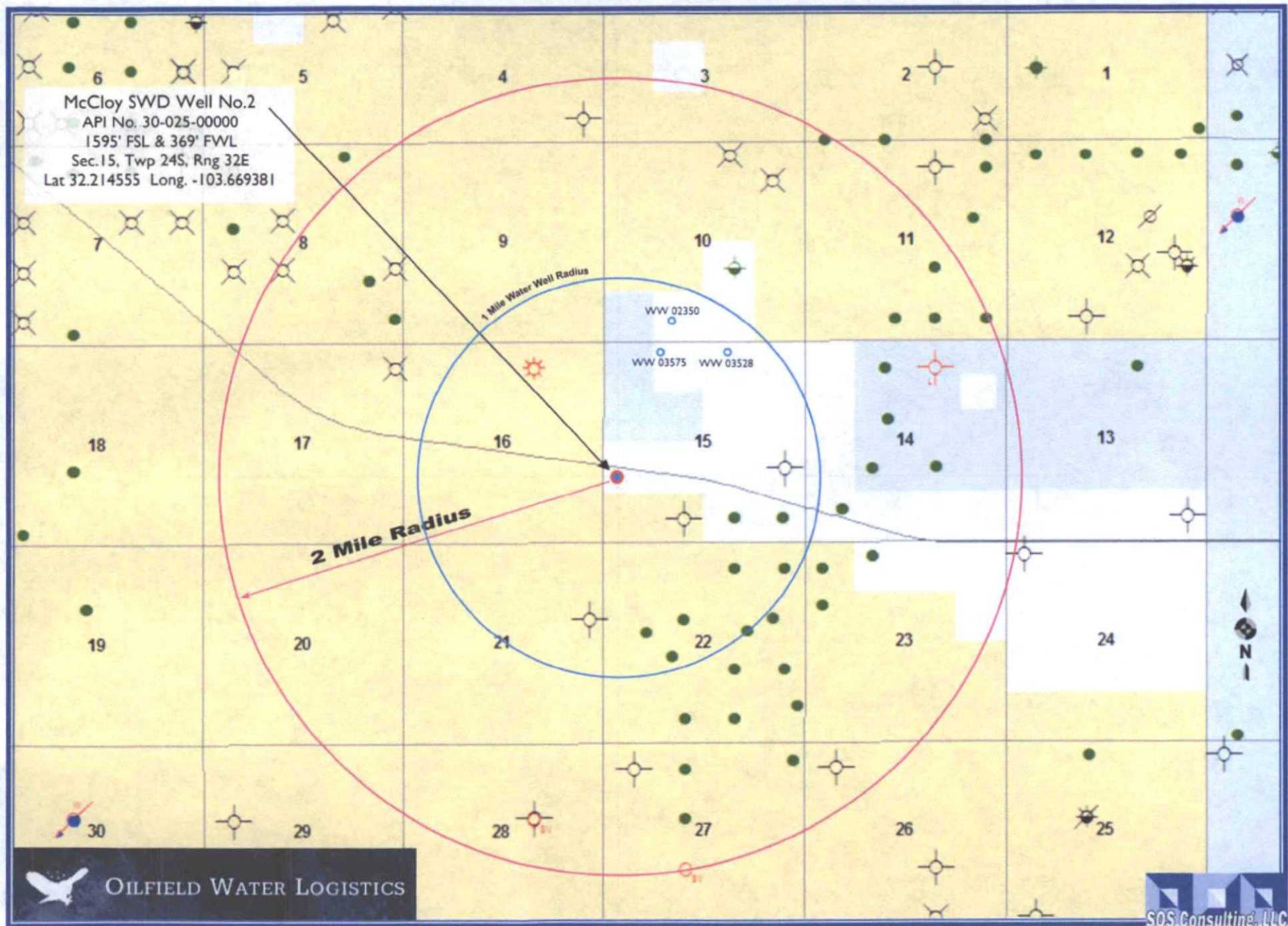

McCloy SWD Well No.2 - Area of Review / Overview Map

(Attachment to NMOCD Form C-108 - Item V)

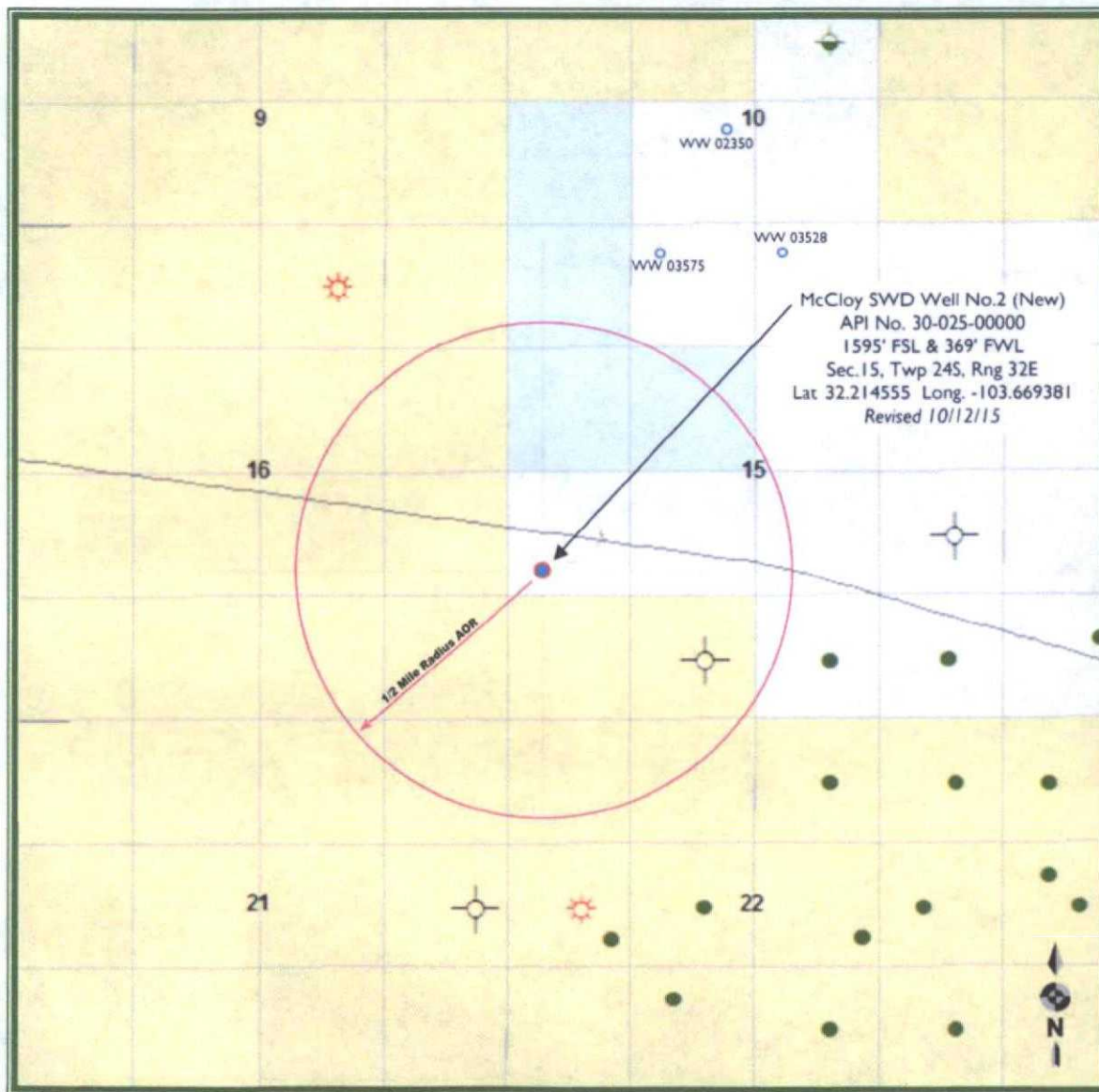

~27.7 miles East of Malaga, NM



Lea County, New Mexico



OILFIELD WATER LOGISTICS



C-108 ITEM VII – PROPOSED OPERATION

McCloy SWD Well No.2

Commercial SWD Facility

Upon approval of all permits for SWD, operations would begin within 30 days. Completion of the well operations will take six to seven weeks. Facility construction including installation of the tank battery, berms, plumbing and other and associated equipment would be occurring during the same interval but at a different location from the well. In any event, it is not expected for the construction phase of the project to last more than 60 days, depending on availability of contractors and equipment. At the time of this submittal, and subject to the availability of the drilling contractor, the anticipated start date is November 15, 2015.

Configure for Salt Water Disposal

Prior to commencing any work, an NOI sundry(ies) will be submitted to configure the well for SWD and will detail the completion workover including all work otherwise described above, any change to the procedure noted herein and to perform mechanical integrity pressure test per OCD test procedures. (Notify NMOCD 24 hours prior.) The casing/tubing annulus will be monitored for communication with injection fluid or loss of casing integrity.

Operational Summary

The SWD facility will be fenced with only the offloading station located outside so that trucks may access for load disposal 24/7.

The well and injection equipment will be a closed system and equipped with pressure limiting devices and volume meters. The annulus, loaded with an inert, anti-corrosion packer fluid, will be monitored for pressure.

The tanks will be equipped with telemetry devices and visual alarms to alert the operator and customers of full tanks or an overflow situation.

Anticipated daily maximum volume is 20,000 bpd and an average of 15,000 bpd at a maximum surface injection pressure of 3350 psi (.2 psi/ft gradient) with an average pressure of approximately 2200 psi.

Potential releases will be contained and cleaned up immediately. The operator shall repair or otherwise correct the situation within 48 hours before resuming operations. OCD will be notified within 24 hours of any release greater than 5 bbls. If required, remediation will start as soon as practicable. Operator shall comply with 19.15.29 NMAC and 19.15.30 NMAC, as necessary and appropriate.

C-108 - Item VII.5

Water Analysis - Disposal Zone - DEVONIAN

NM WAIDS DATA				
S-T-R	FIELD	FORMATION	TDS	CHLRD
24-23S-29E	REMUDA	DEVONIAN	64582	37500
24-23S-29E	REMUDA	DEVONIAN	56922	29000
06-23S-34E	BELL LAKE NORTH	DEVONIAN	71078	42200
34-23S-34E	ANTELOPE RIDGE	DEVONIAN	80187	47900

Water Analysis - Source Zone - BONE SPRING

Biotech Inc. Laboratory Analysis
 Endurance
 Jazzmaster 17 State #4H
 Sample Date: 1/31/2014
 Requested by: T. Ratliff
 Lea Co. NM

Water Analysis Measurements		Cations (+)		Anions (-)	
	mg/L		mg/L		mg/L
Oxygen (mg/L)	1.00	Barium (Ba)	0	Carbonate (CO ₃)	0
Carbon Dioxide (mg/L)	0.00	Calcium (Ca)	18.440	Bicarbonate (HCO ₃)	10.00
Hydrogen Sulfide (mg/L)	0.0	Magnesium (Mg)	3.00	Chloride (mg/L)	118.520
pH	5.7	Sodium (Na) (meq)	54.270	Sulfate (SO ₄)	319
Temperature °F	73	Iron (Fe)	1.00		
		Manganese (Mn)	0.00		
Oil in Water (ppm)	n/a				
Specific Gravity	1.150				
Total Dissolved Solids (TDS)	180,500 (mg/L) (meq)				
Total Hardness (mg/L)	18,000				

Water Analysis - Source Zone - DELAWARE

P. O. BOX 1400
 WILMINGTON, TEXAS 79796
 PH. 817.323.5411 FAX 817.323.5412

Martin Water Laboratories, Inc.

700 N. 1700th
 WILMINGTON, TEXAS 79796
 PHONE 817.323.5412

RESULT OF WATER ANALYSES

LABORATORY NO. 99293
 SAMPLE RECEIVED 9-16-92
 RESULTS REPORTED 9-18-92

TO Mr. Jon Small
 P. O. BOX 11810, Midland, TX 79710

COMPANY Meridian Oil Company LEASE Dagger Lake #1
 FIELD OR POOL Wildcat
 SECTION BLOCK SURVEY COUNTY Lea STATE NM
 SOURCE OF SAMPLE AND DATE TAKEN:
 NO 1 Recovered water - taken from Dagger Lake #1, 9-9-92
 NO 2
 NO 3
 NO 4

REMARKS Delaware

CHEMICAL AND PHYSICAL PROPERTIES				
	NO. 1	NO. 2	NO. 3	NO. 4
Specific Gravity at 60°F	1.1462			
pH at 25°C	6.26			
Barium as Ba	1.46			
Total Hardness as CaCO ₃	180,500			
Calcium as Ca	18,000			
Magnesium as Mg	1,335			
Sodium and Potassium	68,483			
Sulfate as SO ₄	967			
Chloride as Cl	140,618			
Iron as Fe	90.0			
Barium as Ba				
Calcium as Ca				
Total Solids, Computed	229,531			
Temperature °F				
Carbon Dioxide, Computed				
Dissolved Oxygen				
Hydrogen Sulfide	0.0			
Residual Alkalinity at 25°C	0.053			
Suspended Solids				
Total Solids, as mg/L				
Total Dissolved Solids at 180°C	184,361			

C-108 – Item VIII

Geologic Information

The rocks immediately underlying the Upper Devonian Woodford shale and the pre-Woodford unconformity in Lea County have been commonly labelled "Devonian." However, recent biostratigraphic work has revealed these rocks are actually comprised of the Lower Devonian Thirtyone formation in southeastern Lea County and, where the Thirtyone has been removed by pre-Woodford erosion, the subjacent Upper Silurian Wristen group,.

The Thirtyone consists of siliceous carbonates and calcareous chert. It was deposited contemporaneous-ly with the famous Caballos Novaculite of the Marathon region.

The Wristen group is divided into a basal Wink member, the Frame member, and the uppermost Faskin formation. The Wink is a gray limestone with some terrigenous clay and silt. It is characteristically more radioactive on gamma ray logs than the underlying Fusselman formation. The Wink grades upwards into the siltier and more argillaceous Frame member. The uppermost member of the Wristen group, the Faskin formation, contains most of the hydrocarbon reservoirs. The Faskin is made up of wackestones, grainstones, and boundstones, and forms platform-margin buildups in Texas. Karst-related features and dolomite are common.

The McCloy SWD No.2 is expected to encounter the top of the Devonian at a measured depth of 16,750 feet. The injection interval will extend from this point to the top of the Fusselman, which is expected to be encountered at a measured depth of 18,085 feet.

Fresh water in the area is generally available from the Santa Rosa formation at a depth of 380 feet.

There are 3 water wells located within one mile of the proposed SWD. Samples will be gathered and analysis forwarded to OCD when received.

McCloy SWD Well No.2 – Pool Maps

(Attachment to NMOCD Form C-108, Application for Authority to Inject.)

Nearest Pools ABOVE Devonian Interval: Morrow (Gas)

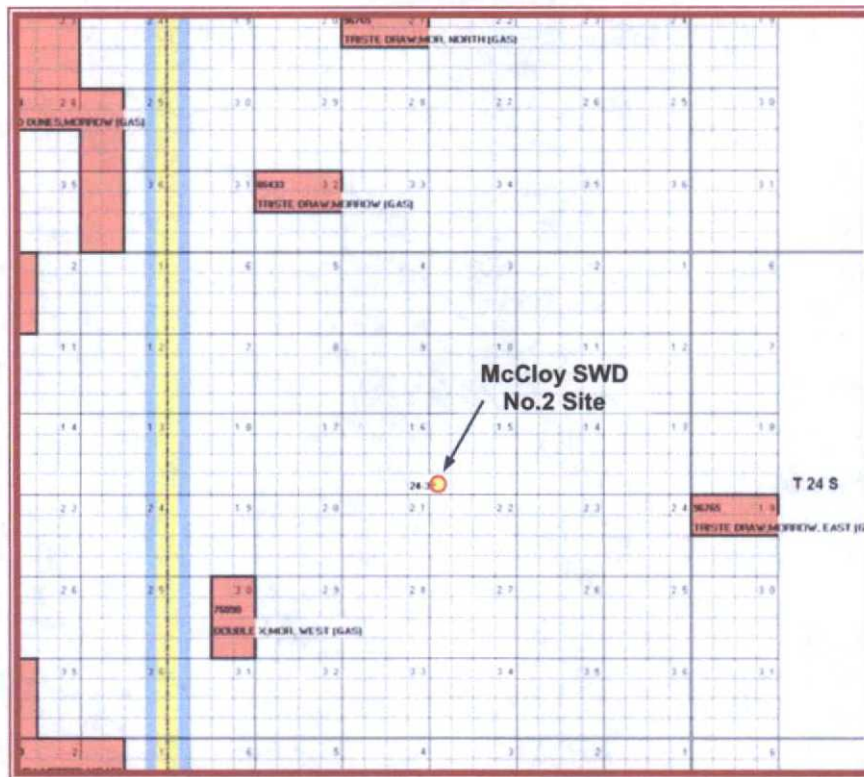

Nearest Devonian Pools to Proposed SWD

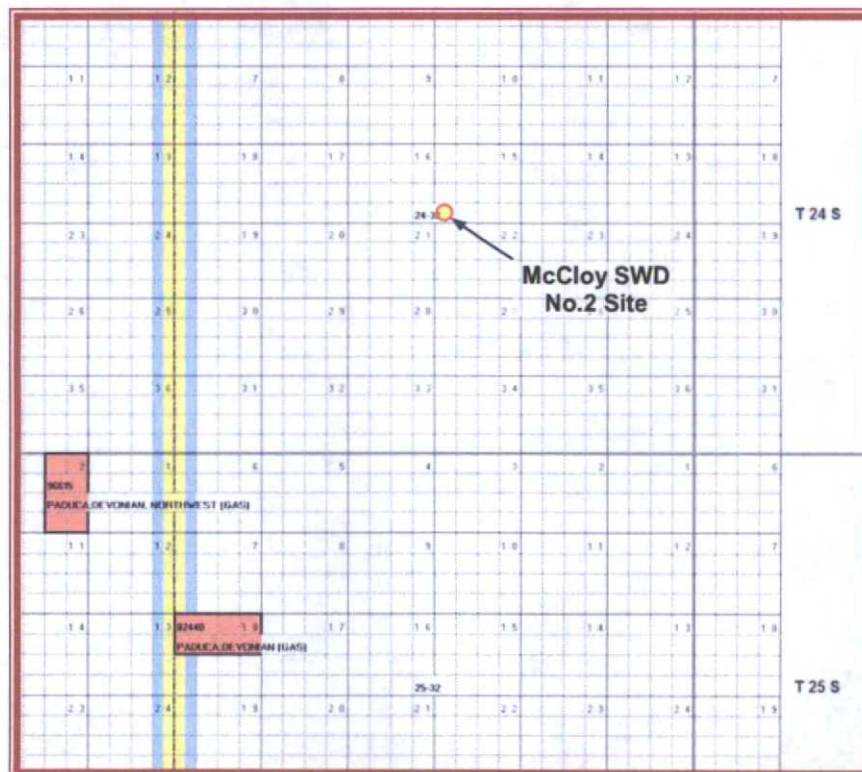

C-108 ITEM XI – WATER WELLS IN AOR

A search of the State Engineer's database indicates there are 3 water wells within one mile of the proposed salt water disposal well. The well locations are indicated on the 2 Mile AOR Map. Samples will be taken and the analysis will be forwarded to OCD upon receipt.



New Mexico Office of the State Engineer Active & Inactive Points of Diversion (with Ownership Information)

(acre ft per annum)						(R=POD has been replaced and no longer serves this file, C=the file is closed)										(quarters are 1=NW 2=NE 3=SW 4=SE) (quarters are smallest to largest) (NAD83 UTM in meters)									
WR File Nbr	Sub basin	Use	Diversion	Owner	County	POD Number	Code Grant	Source	6416 4	Sec	Tws	Rng	X	Y											
C 02350	STK	3		LIMESTONE LIVESTOCK LLC	ED	C 02350	32.226581 -103.664637		4	3	10	24S 32E	625826	3566333*											
C 03528	C STK	3		MARK MCCLOY	LE	C 03528 POD1	32.224722 -103.662389	Shallow	1	2	15	24S 32E	626040	3566129											
C 03575	C STK	D		MARK MCCLOY	LE	C 03575 POD1	32.224528 -103.666667		1	2	1	15 24S 32E	625637	3566103											

Record Count: 3

PLSS Search:

Section(s): 9, 10, 15, 16, Township: 24S Range: 32E
21, 22

Sorted by: File Number

*UTM location was derived from PLSS - see Help

The data is furnished by the NMOSE/ISC and is accepted by the recipient with the expressed understanding that the OSE/ISC make no warranties, expressed or implied, concerning the accuracy, completeness, reliability, usability, or suitability for any particular purpose of the data.

10/15/15 2:45 PM

Page 1 of 1

ACTIVE & INACTIVE POINTS OF DIVERSION



New Mexico Office of the State Engineer Water Column/Average Depth to Water

(A CLW##### in the POD suffix indicates the POD has been replaced & no longer serves a water right file.)

(R=POD has been replaced, O=orphaned, C=the file is closed)

(quarters are 1=NW 2=NE 3=SW 4=SE)
(quarters are smallest to largest)

(NAD83 UTM in meters) (In feet)

POD Number	POD Sub-Code	basin	County	64	16	4	Sec	Tws	Rng	X	Y	Depth Well	Depth Water	Water Column
C 01932	C	ED		3	1	12	24S	32E		628633	3567188*	492		
C 02350		ED		4	3	10	24S	32E		625826	3566333*	60		
C 03527 POD1	C	LE		1	2	3	03	24S	32E	625770	3568487	500		
C 03528 POD1	C	LE		1	1	2	15	24S	32E	626040	3566129	541		
C 03530 POD1	C	LE		3	4	3	07	24S	32E	620886	3566156	550		
C 03555 POD1	C	LE		2	2	1	05	24S	32E	622709	3569231	600	380	220

Average Depth to Water: 380 feet

Minimum Depth: 380 feet

Maximum Depth: 380 feet

Record Count: 6

PLSS Search:

Township: 24S Range: 32E



New Mexico Office of the State Engineer

Water Column/Average Depth to Water

(A CLW##### in the
POD suffix indicates the
POD has been replaced
& no longer serves a
water right file.)

(R=POD has
been replaced,
O=orphaned,
C=the file is
closed)

(quarters are 1=NW 2=NE 3=SW 4=SE)

(quarters are smallest to largest) (NAD83 UTM in meters)

(In feet)

POD Number	POD Sub-Code	basin	County	Q 64	Q 16	Q 4	Sec	Tws	Rng	X	Y	Depth Well	Depth Water	Water Column
C 01932	C	ED		3	1	12	24S	32E		628633	3567188*	492		
C 02350		ED		4	3	10	24S	32E		625826	3566333*	60		
C 03527 POD1	C	LE		1	2	3	03	24S	32E	625770	3568487	500		
C 03528 POD1	C	LE		1	1	2	15	24S	32E	626040	3566129	541		
C 03530 POD1	C	LE		3	4	3	07	24S	32E	620886	3566156	550		
C 03555 POD1	C	LE		2	2	1	05	24S	32E	622709	3569231	600	380	220

Average Depth to Water: **380 feet**

Minimum Depth: **380 feet**

Maximum Depth: **380 feet**

Record Count: 6

PLSS Search:

Township: 24S

Range: 32E

*UTM location was derived from PLSS - see Help

The data is furnished by the NMOSE/ISC and is accepted by the recipient with the expressed understanding that the OSE/ISC make no warranties, expressed or implied, concerning the accuracy, completeness, reliability, usability, or suitability for any particular purpose of the data.

C-108 ITEM XII – GEOLOGIC AFFIRMATION

We have examined available geologic and engineering data and have found no evidence of open faults or other hydrologic connection between the disposal interval and any underground sources of drinking water.



Ben Stone, Partner
SOS Consulting, LLC

Project: Owl SWD Operating, LLC
McCloy SWD No.2
Reviewed 9/28/2015

McCloy SWD Well No.2 - Leasehold Plat

(Attachment to NMOCD Form C-108, Application for Authority to Inject.)

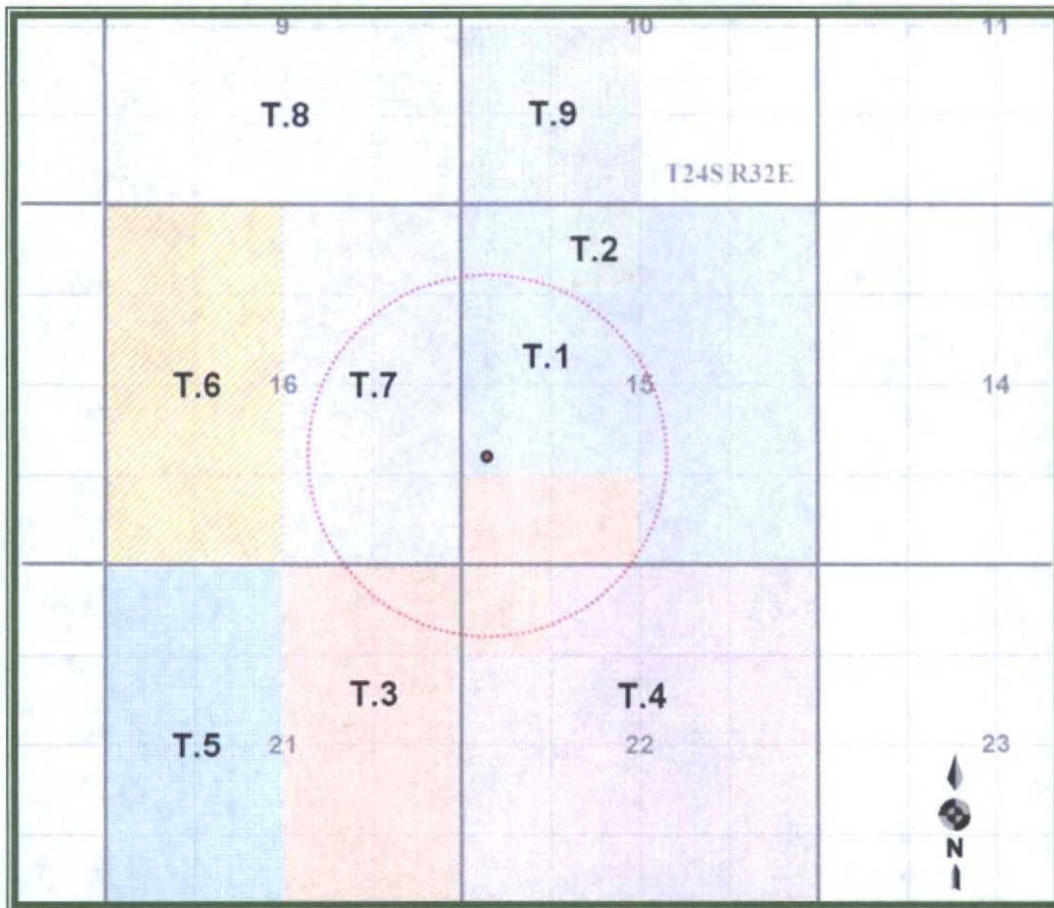

LEGEND

- T.1 – NMNM-0039880 – Chevron USA, Inc.
- T.2 – NMNM-113964 – Devon Energy Production Company, LP
- T.3 – NMNM-029694 – ExxonMobil Corporation
- T.4 – NMLC-0062269A - Apache Corporation, Chisos LTD, others
- T.5 – NMNM-016353 - ExxonMobil Corporation
- T.6 – V0-4095-0000 – Yates Petroleum Corporation
- T.7 – V0-4095-0002 – Devon Energy Production Company, LP
- T.8 – NMNM-055953 – EOG Resources, Inc.
- T.9 – NMNM-119276 – Devon Energy Production Company, LP

**C-108 ITEM XIII – PROOF OF NOTIFICATION
INTERESTED PARTIES LIST**

SURFACE OWNER

- 1 McCLOY RANCH (USPS Certified Mail)
Attn: Mark McCloy
P.O. Box 1076
Jal, NM 88252-1076

OFFSET MINERALS LESSEES and OPERATORS (All Notified via USPS Certified Mail)

BLM Lease NMNM-0039880

Lessee

- 2 CHEVRON USA, INC.
P.O. Box 1635
Houston, TX 77251-1635

BLM LeaseS NMNM-113964; NMNM-119276

Lessee

- 3 DEVON ENERGY PRODUCTION CO., LP
333 W. Sheridan Avenue
OKC, OK 73102-5010

BLM Leases NMNM-029694; NMNM-016353

Lessee

- 4 EXXONMOBIL CORPORATION
P.O. Box 4358
Houston, TX 77210-4358

BLM Lease NMLC-0062269A

Lessees

- 5 APACHE CORPORATION
303 Veterans Airpark Lane, Ste.3000
Midland, TX 79705
- 6 CHISOS, LTD
670 Dona Ana Road SW
Deming, NM 88030
- 7 CROSS BORDER RESOURCES, INC.
2515 McKinney Ave.,Ste.900
Dallas, TX 75201-1945
- Operators**
- 8 MCI OPERATING OF NM, LLC
P.O. Box 471
Denver City, TX 79323

**C-108 ITEM XIII – PROOF OF NOTIFICATION
INTERESTED PARTIES LIST (cont.)**

BLM Lease NMLC-0062269A (cont.)

Operators

- 9 ROBERT H. FORREST JR, OIL LLC
609 Elora Drive
Carlsbad, NM 88220

State Lease V0-4095-0000

Lessee

- 10 YATES PETROLEUM CORPORATION
105 S. 4th Street
Artesia, NM 88210

State Lease V0-4095-0002

Lessee

DEVON ENERGY PRODUCTION CO., LP
333 W. Sheridan Avenue
OKC, OK 73102-5010

BLM Lease NMNM-055953

Lessee

- 11 EOG RESOURCES, INC.
P.O. Box 2267
Midland, TX 79702-2267

OFFSET MINERALS OWNERS (All Notified via USPS Certified Mail)

- 12 U.S. DEPARTMENT OF INTERIOR
Bureau of Land Management
Oil & Gas Division
620 E. Greene St.
Carlsbad, NM 88220
- 13 NEW MEXICO STATE LAND OFFICE
Commissioner of Public Lands
310 Old Santa Fe Trail
Santa Fe, NM

REGULATORY

NEW MEXICO OIL CONSERVATION DIVISION (FedEx'ed original and copy)
1220 S. St. Francis Dr.
Santa Fe, NM 87505

**C-108 ITEM XIII – PROOF OF NOTIFICATION
INTERESTED PARTIES LIST (cont.)**

REGULATORY (cont.)

NEW MEXICO OIL CONSERVATION DIVISION (FedEx'ed copy)
811 S. First St.
Artesia, NM 88210

U.S. DEPARTMENT OF INTERIOR
Bureau of Land Management
Oil & Gas Division
620 E. Greene St.
Carlsbad, NM 88220



October 13, 2015

NOTIFICATION TO INTERESTED PARTIES
via U.S. Certified Mail

To Whom It May Concern:

Owl SWD Operating, LLC, Dallas, Texas, has made application to the New Mexico Oil Conservation Division to drill and complete for salt water disposal the McCloy SWD Well No.2. The proposed SWD will be for commercial use. As indicated in the notice below, the well will be located in Section 15, Township 24 South, Range 32 East in Lea County, New Mexico.

The disposal interval will be through openhole from a maximum of 16,500 feet to 18,250 feet in the Devonian formation.

Following is the legal notice published in the Hobbs News-Sun, Hobbs, New Mexico on or about September 27, 2015.

LEGAL NOTICE

Owl SWD Operating, LLC, 8214 Westchester Dr., Ste.850, Dallas, TX 75255 is filing Form C-108 (Application for Authority to Inject) with the New Mexico Oil Conservation Division for administrative approval to complete for salt water disposal its McCloy SWD Well No.2. The well will be drilled 1595' FSL & 369' FWL in Section 15, Township 24 South, Range 32 East in Lea County, New Mexico. The commercial SWD well will be used dispose of produced water from area operations into the Devonian formation through an openhole completion from a top of 16,500 feet to a maximum depth of 18,250 feet. Maximum injection pressure will be 3350 psi with a maximum rate limited only by such pressure. The operator may conduct a step rate test in the future if it is determined that higher pressures are necessary.

Interested parties wishing to object to the proposed application must file with the New Mexico Oil Conservation Division, 1220 St. Francis Dr., Santa Fe, NM 87505, (505)476-3460 within 15 days of the date of this notice. Additional information may be obtained from the applicant's agent, SOS Consulting, LLC, (903)488-9850 or, email info@sosconsulting.us.

You have been identified as a party who may be interested as an offset lessee or operator.

You are entitled to a full copy of the application. A full copy in PDF format on a mini-CD will be arriving within a few days of this notice. If you do not receive it, please call or email SOS Consulting, LLC at 903-488-9850, info@sosconsulting.us, and a copy will be expedited to you and may also be sent via email if preferred.

Thank you for your attention in this matter.

Best regards,

A handwritten signature in black ink, appearing to read "Ben Stone", with a stylized, cursive script.

Ben Stone, SOS Consulting, LLC
Agent for Owl SWD Operating, LLC

Cc: Application File

C-108 - Item XIV

Proof of Notice (Certified Mail Receipts)

7015 0640 0007 9482 6926
7015 0640 0007 9482 69
7015 0640 0007 9482 69
7015 0640 0007 9482 69

U.S. Postal Service™
CERTIFIED MAIL® RECEIPT
Domestic Mail Only

For delivery information, visit our website at www.usps.com®.

OFFICIAL USE

Certified Mail Fee
\$ 3.45

Extra Services & Fees (check box, add fee as appropriate)

<input type="checkbox"/> Return Receipt (hardcopy)	\$ <u>2.80</u>
<input type="checkbox"/> Return Receipt (electronic)	\$
<input type="checkbox"/> Certified Mail Restricted Delivery	\$
<input type="checkbox"/> Adult Signature Required	\$
<input type="checkbox"/> Adult Signature Restricted Delivery	\$

Postage
\$.49

Total Postage and Fees
\$ 6.74

Sent To

Street and Apt. McCloy 2 Dev RANCH
City, State, Zip Attn: Mark McCloy 2 Dev
P.O. Box 1076
Jal, NM 88252-1076

PS Form 3800

For delivery information, visit our website at www.usps.com®.

OFFICIAL USE

Certified Mail Fee
\$ 3.45

Extra Services & Fees (check box, add fee as appropriate)

<input type="checkbox"/> Return Receipt (hardcopy)	\$ <u>2.80</u>
<input type="checkbox"/> Return Receipt (electronic)	\$
<input type="checkbox"/> Certified Mail Restricted Delivery	\$
<input type="checkbox"/> Adult Signature Required	\$
<input type="checkbox"/> Adult Signature Restricted Delivery	\$

Postage
\$.49

Total Postage and Fees
\$ 6.74

Sent To

Street and Apt. DEVON ENERGY PRODUCTION
City, State, Zip COMPANY, LP
333 W. Sheridan Ave.
OKC, OK 73102

PS Form 3800

For delivery information, visit our website at www.usps.com®.

OFFICIAL USE

Certified Mail Fee
\$ 3.45

Extra Services & Fees (check box, add fee as appropriate)

<input type="checkbox"/> Return Receipt (hardcopy)	\$ <u>2.80</u>
<input type="checkbox"/> Return Receipt (electronic)	\$
<input type="checkbox"/> Certified Mail Restricted Delivery	\$
<input type="checkbox"/> Adult Signature Required	\$
<input type="checkbox"/> Adult Signature Restricted Delivery	\$

Postage
\$.49

Total Postage and Fees
\$ 6.74

Sent To

Street and Apt. APACHE CORPORATION
City, State, Zip 303 Veterans Airpark Lane, Ste.3000
Midland, TX 79705

PS Form 3800

7015 0640 0007 9482 693E
7015 0640 0007 9482 69
7015 0640 0007 9482 69
7015 0640 0007 9482 69

U.S. Postal Service™
CERTIFIED MAIL® RECEIPT
Domestic Mail Only

For delivery information, visit our website at www.usps.com®.

OFFICIAL USE

Certified Mail Fee
\$ 3.45

Extra Services & Fees (check box, add fee as appropriate)

<input type="checkbox"/> Return Receipt (hardcopy)	\$ <u>2.80</u>
<input type="checkbox"/> Return Receipt (electronic)	\$
<input type="checkbox"/> Certified Mail Restricted Delivery	\$
<input type="checkbox"/> Adult Signature Required	\$
<input type="checkbox"/> Adult Signature Restricted Delivery	\$

Postage
\$.49

Total Postage and Fees
\$ 6.74

Sent To

Street and Apt. CHEVRON USA, INC.
City, State, Zip 1400 Smith Street
Houston, TX 77002-7327

PS Form 3800

For delivery information, visit our website at www.usps.com®.

OFFICIAL USE

Certified Mail Fee
\$ 3.45

Extra Services & Fees (check box, add fee as appropriate)

<input type="checkbox"/> Return Receipt (hardcopy)	\$ <u>2.80</u>
<input type="checkbox"/> Return Receipt (electronic)	\$
<input type="checkbox"/> Certified Mail Restricted Delivery	\$
<input type="checkbox"/> Adult Signature Required	\$
<input type="checkbox"/> Adult Signature Restricted Delivery	\$

Postage
\$.49

Total Postage and Fees
\$ 6.74

Sent To

Street and Apt. EXXONMOBIL CORPORATION
City, State, Zip P.O. Box 4358
Houston, TX 77210-4358

PS Form 3800

For delivery information, visit our website at www.usps.com®.

OFFICIAL USE

Certified Mail Fee
\$ 3.45

Extra Services & Fees (check box, add fee as appropriate)

<input type="checkbox"/> Return Receipt (hardcopy)	\$ <u>2.80</u>
<input type="checkbox"/> Return Receipt (electronic)	\$
<input type="checkbox"/> Certified Mail Restricted Delivery	\$
<input type="checkbox"/> Adult Signature Required	\$
<input type="checkbox"/> Adult Signature Restricted Delivery	\$

Postage
\$.49

Total Postage and Fees
\$ 6.74

Sent To

Street and Apt. CHISOS, LTD
City, State, Zip 670 Dona Ana Road SW
Deming, NM 88030

PS Form 3800

C-108 - Item XIV

Proof of Notice (Certified Mail Receipts - cont.)

U.S. Postal Service™
CERTIFIED MAIL® RECEIPT
Domestic Mail Only

For delivery information, visit our website at www.usps.com®.

OFFICIAL USE

Certified Mail Fee \$ 3.45

Extra Services & Fees (check box, add fee as appropriate)

<input type="checkbox"/> Return Receipt (hardcopy)	\$ <u>2.80</u>
<input type="checkbox"/> Return Receipt (electronic)	\$
<input type="checkbox"/> Certified Mail Restricted Delivery	\$
<input type="checkbox"/> Adult Signature Required	\$
<input type="checkbox"/> Adult Signature Restricted Delivery	\$

Postage \$.49

Total Postage and Fees \$ 6.74

Sent To

Street: CROSS BORDER RESOURCES, INC.
City, State: 2515 McKinney Ave., Ste. 900
Dallas, TX 75201-1945

PS Form 380

Extra Services & Fees (check box, add fee as appropriate)

<input type="checkbox"/> Return Receipt (hardcopy)	\$ <u>2.80</u>
<input type="checkbox"/> Return Receipt (electronic)	\$
<input type="checkbox"/> Certified Mail Restricted Delivery	\$
<input type="checkbox"/> Adult Signature Required	\$
<input type="checkbox"/> Adult Signature Restricted Delivery	\$

Postage \$.49

Total Postage and Fees \$ 6.74

Sent To

Street and A: ROBERT H. FORREST JR, OIL LLC
City, State: 609 Elora Drive
Carlsbad, NM 88220

PS Form 3

Extra Services & Fees (check box, add fee as appropriate)

<input type="checkbox"/> Return Receipt (hardcopy)	\$ <u>2.80</u>
<input type="checkbox"/> Return Receipt (electronic)	\$
<input type="checkbox"/> Certified Mail Restricted Delivery	\$
<input type="checkbox"/> Adult Signature Required	\$
<input type="checkbox"/> Adult Signature Restricted Delivery	\$

Postage \$.49

Total Postage and Fees \$ 6.74

Sent To

Street and A: EOG RESOURCES, INC.
City, State: P.O. Box 2267
Midland, TX 79702-2267

PS Form 3

Extra Services & Fees (check box, add fee as appropriate)

<input type="checkbox"/> Return Receipt (hardcopy)	\$ <u>2.80</u>
<input type="checkbox"/> Return Receipt (electronic)	\$
<input type="checkbox"/> Certified Mail Restricted Delivery	\$
<input type="checkbox"/> Adult Signature Required	\$
<input type="checkbox"/> Adult Signature Restricted Delivery	\$

Postage \$.49

Total Postage and Fees \$ 6.74

Sent To

Street and A: NEW MEXICO STATE LAND OFFICE
City, State: Oil & Gas Division
310 Old Santa Fe Trail
Santa Fe, NM

U.S. Postal Service™
CERTIFIED MAIL® RECEIPT
Domestic Mail Only

For delivery information, visit our website at www.usps.com®.

OFFICIAL USE

Certified Mail Fee \$ 3.45

Extra Services & Fees (check box, add fee as appropriate)

<input type="checkbox"/> Return Receipt (hardcopy)	\$ <u>2.80</u>
<input type="checkbox"/> Return Receipt (electronic)	\$
<input type="checkbox"/> Certified Mail Restricted Delivery	\$
<input type="checkbox"/> Adult Signature Required	\$
<input type="checkbox"/> Adult Signature Restricted Delivery	\$

Postage \$.49

Total Postage and Fees \$ 6.74

Sent To

Street and Apt: MCI OPERATING OF NM, LLC
City, State, Zip: P.O. Box 471
Denver City, TX 79323

PS Form 380

Extra Services & Fees (check box, add fee as appropriate)

<input type="checkbox"/> Return Receipt (hardcopy)	\$ <u>2.80</u>
<input type="checkbox"/> Return Receipt (electronic)	\$
<input type="checkbox"/> Certified Mail Restricted Delivery	\$
<input type="checkbox"/> Adult Signature Required	\$
<input type="checkbox"/> Adult Signature Restricted Delivery	\$

Postage \$.49

Total Postage and Fees \$ 6.74

Sent To

Street and A: YATES PETROLEUM CORPORATION
City, State: 105 S. 4th Street
Artesia, NM 88210

PS Form 3

Extra Services & Fees (check box, add fee as appropriate)

<input type="checkbox"/> Return Receipt (hardcopy)	\$ <u>2.80</u>
<input type="checkbox"/> Return Receipt (electronic)	\$
<input type="checkbox"/> Certified Mail Restricted Delivery	\$
<input type="checkbox"/> Adult Signature Required	\$
<input type="checkbox"/> Adult Signature Restricted Delivery	\$

Postage \$.49

Total Postage and Fees \$ 6.74

Sent To

Street and A: Bureau of Land Management
City, State: Carlsbad Field Office - O&G Division
620 E. Greene St.
Carlsbad, NM 88220

PS Form 3

Extra Services & Fees (check box, add fee as appropriate)

<input type="checkbox"/> Return Receipt (hardcopy)	\$ <u>2.80</u>
<input type="checkbox"/> Return Receipt (electronic)	\$
<input type="checkbox"/> Certified Mail Restricted Delivery	\$
<input type="checkbox"/> Adult Signature Required	\$
<input type="checkbox"/> Adult Signature Restricted Delivery	\$

Postage \$.49

Total Postage and Fees \$ 6.74

Sent To

Street and A: NEW MEXICO STATE LAND OFFICE
City, State: Oil & Gas Division
310 Old Santa Fe Trail
Santa Fe, NM

**C-108 ITEM XIII – PROOF OF NOTIFICATION
Regulatory Filings**

Owl SWD Operating, LLC

McCloy SWD No.2

C-108 sent 10/16/15

FedEx Tracking Nos.

OCD SF – 7747 5554 2945

OCD Hobbs – 7747 5555 5040

SLO – 7747 5556 8500

I hereby certify that a full copy of the subject C-108 application was sent to the applicable regulatory agencies as indicated above.

A handwritten signature in black ink, appearing to read "Ben Stone", written in a cursive style.

Ben Stone, Partner
SOS Consulting, LLC
Agent for Owl SWD Operating, LLC

Affidavit of Publication

STATE OF NEW MEXICO
COUNTY OF LEA

I, Gussie Black, Business Manager of the Hobbs News-Sun, a newspaper published at Hobbs, New Mexico, solemnly swear that the clipping attached hereto was published in the regular and entire issue of said newspaper, and not a supplement thereof for a period of 1 issue(s).

Beginning with the issue dated
September 27, 2015
and ending with the issue dated
September 27, 2015.

Gussie Black
Business Manager

Sworn and subscribed to before me this
27th day of September 2015.

Yezenia Calderon
Circulation Coordinator

My commission expires
February 28, 2016

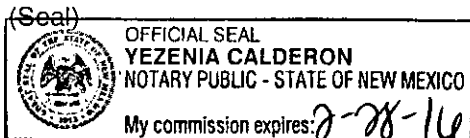

This newspaper is duly qualified to publish legal notices or advertisements within the meaning of Section 3, Chapter 167, Laws of 1937 and payment of fees for said

LEGALS

LEGAL NOTICE September 27, 2015

Owl SWD Operating, LLC, 8214 Westchester Dr., Ste. 850, Dallas, TX 75255 is filing Form C-108 (Application for Authority to Inject) with the New Mexico Oil Conservation Division for administrative approval to complete for salt water disposal its McCloy SWD Well No.2. The well will be drilled 1595' FSL & 369' FWL in Section 15, Township 24 South, Range 32 East in Lea County, New Mexico. The commercial SWD well will be used dispose of produced water from area operations into the Devonian formation through an openhole completion from a top of 16,500 feet to a maximum depth of 18,250 feet. Maximum injection pressure will be 3350 psi with a maximum rate limited only by such pressure. The operator may conduct a step rate test in the future if it is determined that higher pressures are necessary.

Interested parties wishing to object to the proposed application must file with the New Mexico Oil Conservation Division, 1220 St. Francis Dr., Santa Fe, NM 87505, (505)476-3460 within 15 days of the date of this notice. Additional information may be obtained from the applicant's agent, SOS Consulting, LLC, (903)488-9850 or, email info@sosconsulting.us. #30348

67104420

00163776

BEN STONE
SOS CONSULTING, LLC.
P.O. BOX 300
COMO, TX 75431



New Mexico Office of the State Engineer

Point of Diversion Summary

(quarters are 1=NW 2=NE 3=SW 4=SE)

(quarters are smallest to largest)

(NAD83 UTM in meters)

POD Number

C 03528 POD1

Q64 Q16 Q4 Sec Tws Rng

1 1 2 15 24S 32E

X

Y

626040 3566129

Driller License: 1682

Driller Name: NORRIS, JOHN D. (LD)

Drill Start Date: 02/20/2012

Drill Finish Date: 03/12/2012

Plug Date:

Log File Date: 04/30/2012

PCW Rcv Date:

Source: Shallow

Pump Type: SUBMER

Pipe Discharge Size:

Estimated Yield:

Casing Size: 6.38

Depth Well: 541 feet

Depth Water:

Water Bearing Stratifications:

Top Bottom Description

133 152 Sandstone/Gravel/Conglomerate

Casing Perforations:

Top Bottom

133 152

The data is furnished by the NMOSE/ISC and is accepted by the recipient with the expressed understanding that the OSE/ISC make no warranties, expressed or implied, concerning the accuracy, completeness, reliability, usability, or suitability for any particular purpose of the data.



C-108 Review Checklist: Received 10/14 Add. Request: W2 Reply Date: _____ Suspended: _____ (Ver 15)

ORDER TYPE: WFX / PMX SWD Number: _____ Order Date: _____ Legacy Permits/Orders: _____

Well No. 2 Well Name(s): McCLOY RANCH

API: 30-02 Pending Spud Date: TBD New or Old: N (UIC Class II Primacy 03/07/1982)

Footages 1545 FSC 369 FWC Lot _____ or Unit L Sec 15 Tsp 24S Rge 32E County Lea

General Location: 2 3/4 miles W of JAI Pool: SAN DEVONIAN Pool No.: 96101

BLM 100K Map: JAI Operator: SWD operating, LLC OGRID: 308339 Contact: BEN STONE, agent

COMPLIANCE RULE 5.9: Total Wells: 16 Inactive: 2 Fincl Assur: 2 Compl. Order? N/A IS 5.9 OK? _____ Date: _____

WELL FILE REVIEWED ☐ Current Status: Proposed

WELL DIAGRAMS: NEW: Proposed ☒ or RE-ENTER: Before Conv. ☐ After Conv. ☐ Logs in Imaging: N/A

Planned Rehab Work to Well: * CBL b/w Liner & Surface through 1074 to surface

Well Construction Details		Sizes (in) Borehole / Pipe	Setting Depths (ft)	Cement Sx or Cf	Cement Top and Determination Method
Planned ___ or Existing ___ Surface		<u>20 1/4" / 16"</u>	<u>1000</u>	<u>1044</u>	<u>Surface / Visual</u>
Planned ___ or Existing ___ Interm/Prod		<u>12 1/8" / 13 1/8"</u>	<u>500</u>	<u>856</u>	<u>Surface / Visual</u>
Planned ___ or Existing ___ Interm/Prod		<u>12 1/4" / 10 1/4"</u>	<u>1300</u>	<u>TBD</u>	<u>Surface / Visual</u>
Planned ___ or Existing ___ Prod/Liner					
Planned ___ or Existing ___ Liner		<u>9 1/2" / 7 1/2"</u>	<u>16750</u>	<u>496</u>	<u>12800</u>
Planned ___ or Existing ___ <u>OH</u> PERF		<u>16 5/8" / 14 1/8"</u>	<u>16750 / 14000</u>	<u>12350</u>	

Injection Lithostratigraphic Units	Depths (ft)	Injection or Confining Units	Tops	Completion/Operation Details:
Adjacent Unit: Litho. Struc. Por.		<u>DEV</u>	<u>16750</u>	Drilled TD <u>18250</u> PBTD _____
Confining Unit: Litho. Struc. Por.				NEW TD _____ NEW PBTD _____
Proposed Inj Interval TOP:	<u>16500</u>			NEW Open Hole <input checked="" type="radio"/> or NEW Perfs <input type="radio"/>
Proposed Inj Interval BOTTOM:	<u>18250</u>			Tubing Size <u>5 1/2</u> in. Inter Coated? <input checked="" type="checkbox"/>
Confining Unit: Litho. Struc. Por.				Proposed Packer Depth <u>16400</u> ft
Adjacent Unit: Litho. Struc. Por.				Min. Packer Depth <u>16400</u> (100-ft limit)
				Proposed Max. Surface Press. <u>3350</u> psi
				Admin. Inj. Press. <u>3350</u> (0.2 psi per ft)

AOR: Hydrologic and Geologic Information

POTASH: R-111-P MA Noticed? ☒ BLM Sec Ord ☐ WIPP ☐ Noticed? ☐ Salt/Salado T: _____ B: _____ NW: Cliff House fm _____

FRESH WATER: Aquifer Delaware / Devon Max Depth 1539500 HYDRO AFFIRM STATEMENT By Qualified Person ☒

NMOSE Basin: LAUREL CAPITAN REEF: thru adj NA No. Wells within 1-Mile Radius? _____ FW Analysis _____

Disposal Fluid: Formation Source(s) Base Springs Analysis? ☒ On Lease ☐ Operator Only ☐ or Commercial ☒

Disposal Int: Inject Rate (Avg/Max BWPD): 15,000 / 20,000 Protectable Waters? _____ Source: _____ System: Closed or Open

HC Potential: Producing Interval? _____ Formerly Producing? _____ Method: Logs/DST/P&A/Other Modlog 2-Mile Radius Pool Map ☒

AOR Wells: 1/2-M Radius Map? ☒ Well List? _____ Total No. Wells Penetrating Interval: 0 Horizontals? N/A

Penetrating Wells: No. Active Wells MA Num Repairs? _____ on which well(s)? _____ Diagrams? _____

Penetrating Wells: No. P&A Wells MA Num Repairs? _____ on which well(s)? _____ Diagrams? _____

NOTICE: Newspaper Date 9-27 Mineral Owner NMSLO Surface Owner MARK McCLOY N. Date 10-13-2015

RULE 26.7(A): Identified Tracts? ☒ Affected Persons: CHEVRON, EXXON, DEVON N. Date 10-13-2015

Order Conditions: Issues: _____

Add Order Cond: _____



WELL RECORD & LOG

OFFICE OF THE STATE ENGINEER

www.ose.state.nm.us

4-23-12

Corrected well log

1. GENERAL AND WELL LOCATION	POD NUMBER (WELL NUMBER) C-03528-POD1		OSE FILE NUMBER(S) C-03528-POD1					
	WELL OWNER NAME(S) MARK & ANNETTE MCCLOY		PHONE (OPTIONAL) 432-940-4459					
	WELL OWNER MAILING ADDRESS PO BOX 1076		CITY JAL	STATE NM				
			ZIP 88252					
	WELL LOCATION (FROM GPS)	DEGREES LATITUDE 32	MINUTES 13	SECONDS 29.00 N	* ACCURACY REQUIRED: ONE TENTH OF A SECOND			
		LONGITUDE 103	39	44.60 W	* DATUM REQUIRED: WGS 84			
DESCRIPTION RELATING WELL LOCATION TO STREET ADDRESS AND COMMON LANDMARKS Coordinates Based on map (Non-GPS)								
2. OPTIONAL	(2.5 ACRE) NW 1/4	(10 ACRE) NW 1/4	(40 ACRE) NW 1/4	(160 ACRE) NE 1/4	SECTION 25	TOWNSHIP 24		
	SUBDIVISION NAME Located on				LOT NUMBER	BLOCK NUMBER		
	HYDROGRAPHIC SURVEY				MAP NUMBER	TRACT NUMBER		
3. DRILLING INFORMATION	LICENSE NUMBER WD1682		NAME OF LICENSED DRILLER JOHN NORRIS		NAME OF WELL DRILLING COMPANY HUNGRY HORSE, LLC			
	DRILLING STARTED 2-20-12		DRILLING ENDED 3-12-12		DEPTH OF COMPLETED WELL (FT) 541	BORE HOLE DEPTH (FT) 541		
					DEPTH WATER FIRST ENCOUNTERED (FT) 133			
	COMPLETED WELL IS: <input type="checkbox"/> ARTESIAN <input type="checkbox"/> DRY HOLE <input checked="" type="checkbox"/> SHALLOW (UNCONFINED)					STATIC WATER LEVEL IN COMPLETED WELL (FT)		
	DRILLING FLUID: <input type="checkbox"/> AIR <input checked="" type="checkbox"/> MUD <input type="checkbox"/> ADDITIVES - SPECIFY:							
	DRILLING METHOD: <input checked="" type="checkbox"/> ROTARY <input type="checkbox"/> HAMMER <input type="checkbox"/> CABLE TOOL <input type="checkbox"/> OTHER - SPECIFY:							
	DEPTH (FT) FROM TO		BORE HOLE DIA. (IN)	CASING MATERIAL	CONNECTION TYPE (CASING)	INSIDE DIA. CASING (IN)	CASING WALL THICKNESS (IN)	SLOT SIZE (IN)
	0 541		8 3/4	PVC	GLUED	6"	3/8	1/8
4. WATER BEARING STRATA	DEPTH (FT) FROM TO		THICKNESS (FT)	FORMATION DESCRIPTION OF PRINCIPAL WATER-BEARING STRATA (INCLUDE WATER-BEARING CAVITIES OR FRACTURE ZONES)		YIELD (GPM)		
	133 152		19	SAND		UK		
METHOD USED TO ESTIMATE YIELD OF WATER-BEARING STRATA N/A						TOTAL ESTIMATED WELL YIELD (GPM)		

FOR OSE INTERNAL USE

FILE NUMBER C-3528

POD NUMBER C-03528-POD1

WELL RECORD & LOG (Version 6/9/08)

TRN NUMBER 491386

LOCATION 24.32.15.211

PAGE 1 OF 2

5. SEAL AND PUMP	TYPE OF PUMP: <input type="checkbox"/> SUBMERSIBLE <input type="checkbox"/> JET <input type="checkbox"/> NO PUMP - WELL NOT EQUIPPED <input type="checkbox"/> TURBINE <input type="checkbox"/> CYLINDER <input type="checkbox"/> OTHER - SPECIFY: UNKNOWN						
	ANNULAR SEAL AND GRAVEL PACK	DEPTH (FT)		BORE HOLE DIA. (IN)	MATERIAL TYPE AND SIZE	AMOUNT (CUBIC FT)	METHOD OF PLACEMENT
		FROM	TO				
		0	20				

6. GEOLOGIC LOG OF WELL	DEPTH (FT)		THICKNESS (FT)	COLOR AND TYPE OF MATERIAL ENCOUNTERED (INCLUDE WATER-BEARING CAVITIES OR FRACTURE ZONES)	WATER BEARING?
	FROM	TO			
	0	3	3	TOPSOIL	<input type="checkbox"/> YES <input checked="" type="checkbox"/> NO
	3	18	15	CALICHE	<input type="checkbox"/> YES <input checked="" type="checkbox"/> NO
	18	26	8	SAND	<input checked="" type="checkbox"/> YES <input type="checkbox"/> NO
	26	133	107	RED CLAY	<input type="checkbox"/> YES <input checked="" type="checkbox"/> NO
	133	152	19	SAND	<input checked="" type="checkbox"/> YES <input type="checkbox"/> NO
	152	318	166	RED CLAY	<input type="checkbox"/> YES <input checked="" type="checkbox"/> NO
	318	345	27	SAND	<input checked="" type="checkbox"/> YES <input type="checkbox"/> NO
	345	384	39	RED CLAY AND ROCK	<input type="checkbox"/> YES <input checked="" type="checkbox"/> NO
	384	418	34	SAND	<input checked="" type="checkbox"/> YES <input type="checkbox"/> NO
	418	444	26	RED CLAY AND ROCK	<input type="checkbox"/> YES <input checked="" type="checkbox"/> NO
	444	468	24	SAND	<input checked="" type="checkbox"/> YES <input type="checkbox"/> NO
	468	500	32	RED CLAY	<input type="checkbox"/> YES <input checked="" type="checkbox"/> NO
	500	508	8	SAND	<input checked="" type="checkbox"/> YES <input type="checkbox"/> NO
	508	541	33	RED CLAY AND ROCK	<input type="checkbox"/> YES <input checked="" type="checkbox"/> NO
					<input type="checkbox"/> YES <input type="checkbox"/> NO
					<input type="checkbox"/> YES <input type="checkbox"/> NO
				<input type="checkbox"/> YES <input type="checkbox"/> NO	
ATTACH ADDITIONAL PAGES AS NEEDED TO FULLY DESCRIBE THE GEOLOGIC LOG OF THE WELL.					

7. TEST & ADDITIONAL INFO	WELL TEST	METHOD: <input type="checkbox"/> BAILER <input type="checkbox"/> PUMP <input type="checkbox"/> AIR LIFT <input type="checkbox"/> OTHER - SPECIFY: N/A TEST RESULTS - ATTACH A COPY OF DATA COLLECTED DURING WELL TESTING, INCLUDING START TIME, END TIME, AND A TABLE SHOWING DISCHARGE AND DRAWDOWN OVER THE TESTING PERIOD.
	ADDITIONAL STATEMENTS OR EXPLANATIONS:	

8. SIGNATURE	THE UNDERSIGNED HEREBY CERTIFIES THAT, TO THE BEST OF HIS OR HER KNOWLEDGE AND BELIEF, THE FOREGOING IS A TRUE AND CORRECT RECORD OF THE ABOVE DESCRIBED HOLE AND THAT HE OR SHE WILL FILE THIS WELL RECORD WITH THE STATE ENGINEER AND THE PERMIT HOLDER WITHIN 20 DAYS AFTER COMPLETION OF WELL DRILLING:	
	 SIGNATURE OF DRILLER	4-23-12 DATE

FOR USE INTERNAL USE

WELL RECORD & LOG (Version 6/9/08)

FILE NUMBER C-3528

POD NUMBER C-03528-Pod1

TRN NUMBER 491386

LOCATION 24-32.15-2111

PAGE 2 OF 2