

DATE IN 9/17/2015	SUSPENSE	ENGINEER	LOGGED IN 9/17/2015	TYPE SWD	APP NO. PMAWIS2065849
----------------------	----------	----------	------------------------	-------------	--------------------------

ABOVE THIS LINE FOR DIVISION USE ONLY

NEW MEXICO OIL CONSERVATION DIVISION

- Engineering Bureau -

1220 South St. Francis Drive, Santa Fe, NM 87505



ADMINISTRATIVE APPLICATION CHECKLIST

THIS CHECKLIST IS MANDATORY FOR ALL ADMINISTRATIVE APPLICATIONS FOR EXCEPTIONS TO DIVISION RULES AND REGULATIONS WHICH REQUIRE PROCESSING AT THE DIVISION LEVEL IN SANTA FE

Application Acronyms:

[NSL-Non-Standard Location] **[NSP-Non-Standard Proration Unit]** **[SD-Simultaneous Dedication]**
[DHC-Downhole Commingling] **[CTB-Lease Commingling]** **[PLC-Pool/Lease Commingling]**
[PC-Pool Commingling] **[OLS - Off-Lease Storage]** **[OLM-Off-Lease Measurement]**
[WFX-Waterflood Expansion] **[PMX-Pressure Maintenance Expansion]**
[SWD-Salt Water Disposal] **[IPI-Injection Pressure Increase]**
[EOR-Qualified Enhanced Oil Recovery Certification] **[PPR-Positive Production Response]**

[1] TYPE OF APPLICATION - Check Those Which Apply for [A]

[A] Location - Spacing Unit - Simultaneous Dedication
☐ NSL ☐ NSP ☐ SD

Check One Only for [B] or [C]

[B] Commingling - Storage - Measurement
☐ DHC ☐ CTB ☐ PLC ☐ PC ☐ OLS ☐ OLM

[C] Injection - Disposal - Pressure Increase - Enhanced Oil Recovery
☐ WFX ☐ PMX ☒ SWD ☐ IPI ☐ EOR ☐ PPR

[D] Other: Specify _____

[2] NOTIFICATION REQUIRED TO: - Check Those Which Apply, or ☐ Does Not Apply

[A] ☐ Working, Royalty or Overriding Royalty Interest Owners

[B] ☐ Offset Operators, Leaseholders or Surface Owner

[C] ☐ Application is One Which Requires Published Legal Notice

[D] ☐ Notification and/or Concurrent Approval by BLM or SLO
 U.S. Bureau of Land Management - Commissioner of Public Lands, State Land Office

[E] ☒ For all of the above, Proof of Notification or Publication is Attached, and/or,

[F] ☐ Waivers are Attached

[3] SUBMIT ACCURATE AND COMPLETE INFORMATION REQUIRED TO PROCESS THE TYPE OF APPLICATION INDICATED ABOVE.

[4] **CERTIFICATION:** I hereby certify that the information submitted with this application for administrative approval is **accurate** and **complete** to the best of my knowledge. I also understand that **no action** will be taken on this application until the required information and notifications are submitted to the Division.

Note: Statement must be completed by an individual with managerial and/or supervisory capacity.

Billy E. Prichard

Print or Type Name

Signature

Agent for TLT SWD, LLC

Title

Date

billy@pwllc.net
 e-mail Address

- SWD-1140-B
 - TLT SWD, LLC
 287481
 - well
 - Sweet Pea SWD #1
 30-015-35749
 Pool
 - SWD, Bell Canyon
 Cherry Canyon
 96802

Inactive Wells
 Compliance (ACOI)

9/4/15

APPLICATION FOR AUTHORIZATION TO INJECT

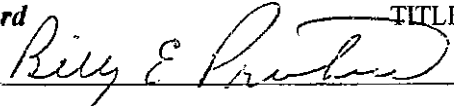
- I. PURPOSE: _____ Secondary Recovery _____ Pressure Maintenance _____ ☒ Disposal _____ Storage
Application qualifies for administrative approval? _____ ☒ Yes _____ No
- II. OPERATOR: **TLT SWD, L.L.C.** Ogrid # **287481**
ADDRESS: **PO Box 1906 Hobbs, New Mexico 88241**
CONTACT PARTY: **Billy E. Prichard** PHONE: **432-934-7680**
- III. WELL DATA: Complete the data required on the reverse side of this form for each well proposed for injection.
Additional sheets may be attached if necessary.
- IV. Is this an expansion of an existing project? _____ ☒ Yes _____ No
If yes, give the Division order number authorizing the project: **SWD 1140-A**
- V. Attach a map that identifies all wells and leases within two miles of any proposed injection well with a one-half mile radius circle drawn around each proposed injection well. This circle identifies the well's area of review.
- VI. Attach a tabulation of data on all wells of public record within the area of review which penetrate the proposed injection zone. Such data shall include a description of each well's type, construction, date drilled, location, depth, record of completion, and a schematic of any plugged well illustrating all plugging detail.
- VII. Attach data on the proposed operation, including:
1. Proposed average and maximum daily rate and volume of fluids to be injected;
 2. Whether the system is open or closed;
 3. Proposed average and maximum injection pressure;
 4. Sources and an appropriate analysis of injection fluid and compatibility with the receiving formation if other than reinjected produced water; and,
 5. If injection is for disposal purposes into a zone not productive of oil or gas at or within one mile of the proposed well, attach a chemical analysis of the disposal zone formation water (may be measured or inferred from existing literature, studies, nearby wells, etc.).
- *VIII. Attach appropriate geologic data on the injection zone including appropriate lithologic detail, geologic name, thickness, and depth. Give the geologic name, and depth to bottom of all underground sources of drinking water (aquifers containing waters with total dissolved solids concentrations of 10,000 mg/l or less) overlying the proposed injection zone as well as any such sources known to be immediately underlying the injection interval.
- IX. Describe the proposed stimulation program, if any.
- *X. Attach appropriate logging and test data on the well. (If well logs have been filed with the Division, they need not be resubmitted).
- *XI. Attach a chemical analysis of fresh water from two or more fresh water wells (if available and producing) within one mile of any injection or disposal well showing location of wells and dates samples were taken.
- XII. Applicants for disposal wells must make an affirmative statement that they have examined available geologic and engineering data and find no evidence of open faults or any other hydrologic connection between the disposal zone and any underground sources of drinking water.
- XIII. Applicants must complete the "Proof of Notice" section on the reverse side of this form.
- XIV. Certification: I hereby certify that the information submitted with this application is true and correct to the best of my knowledge and belief.
- NAME: **Billy E. Prichard** TITLE: **Agent for TLT SWD, L.L.C.**
SIGNATURE:  DATE: 9/4/15
E-MAIL ADDRESS: **billy@pwillc.net**
- * If the information required under Sections VI, VIII, X, and XI above has been previously submitted, it need not be resubmitted. Please show the date and circumstances of the earlier submittal: _____

DISTRIBUTION: Original and one copy to Santa Fe with one copy to the appropriate District Office

**TLT SWD, L.L.C
Sweet Pea SWD # 1
API # 30-015-35749
1980 FSL X 660 FWL
Unit Letter "L", Section 2, T23S, R31E
Eddy County, New Mexico
C108 (Application for Authorization to Inject)**

I.

The purpose of this application is for administrative approval of the conversion of the Sweet Pea SWD #1 from lease disposal to commercial salt water disposal well through amending SWD 1140-A

II.

Operator; TLT SWD,L.L.C. Ogrid # 287481
Address; PO Box 1906 Hobbs, New Mexico 88241
Contract Party; Billy E. Prichard Phone; 432-934-7680

III.

Please see Exhibit "A" for well data

IV.

This is an expansion of an existing project.

V.

Please see Exhibit "B" for map of area of review (AOR)

VI.

Please see Exhibit "C" for offset well data

VII.

Anticipated daily injection rate of 2200 BWPD with a maximum daily injection rate of 3500 BWPD.

This will be an open system.

Anticipated average injection press of 1100 psi with Maximum disposal pressure determined by NMOCD approved Step Rate Test, anticipated pressure of 1400 psi.
Please see Exhibit "D" for analysis of Delaware produced water and possible disposed fluid in the Sweet Pea SWD # 1

VIII.

The proposed disposal interval is sandstone of the Bell Canyon, Cherry Canyon the upper portion of the Delaware Mountain Group 4600'-5880'.

TLT SWD, L.L.C
Sweet Pea SWD # 1
API # 30-015-35749
1980 FSL X 660 FWL
Unit Letter "L", Section 2, T23S, R31E
Eddy County, New Mexico
C108 (Application for Authorization to Inject)

IX.

No stimulation is planned at this time.

X.

Well logs and completion data will be filed with NMOCD.

XI.

Fresh water is contained in the Alluvial fill and the Aeolian fill from surface to the top of the Magenta and Forty Niner members of the Rustler formation. Surface casing on several permitted oil and gas wells in the area average setting depth is 700 feet.

No fresh water wells were identified in the 1 mile area of review.

XII.

Available geological data has been examined and shows no evidence of open faults or any hydrological connection between the disposal zone and any underground sources of drinking water.

XIII.

Please see Exhibit "E" for Proof of Notice and Proof of Publication

Billy E. Prichard 
Agent for TLT SWD, L.L.C.

Date 9/4/15

TLT SWD, L.L.C.
Sweet Pea SWD # 1
API # 30-015-35749
1980 FSL X 660 FWL
Unit Letter "L", Section 2, T23S, R31E
Eddy County, New Mexico

Well Data
Spud 11/17/2007 as Delaware Oil Well

<u>Casing</u>	<u>Depth</u>	<u>Hole</u>	<u>SKS Cement</u>	<u>TOC</u>
13 3/8"	701'	17 1/2"	555	Surf
8 5/8"	4380'	11"	1000	Surf
5 1/2"	8510'	7 7/8"	1200	2320' CBL

Perforations 7234' - 8183'

Cast Iron Bridge Plug capped with 35' Cement at 6080' ⁵

Perforations 4600'-5880'

2573'
See CBL results
on file

Converted to SWD well per SWD - 1140-A August 17, 2010



Exhibit "A"

CURRENT WELLBORE DIAGRAM

TLT SWD, L.L.C.
Sweet Pea SWD # 1
API # 30-15-35749
1980 FSL x 660' FWL, UL 'L' Sec 2, T23S, R31E, Eddy County, NM
EXHIBIT "A"

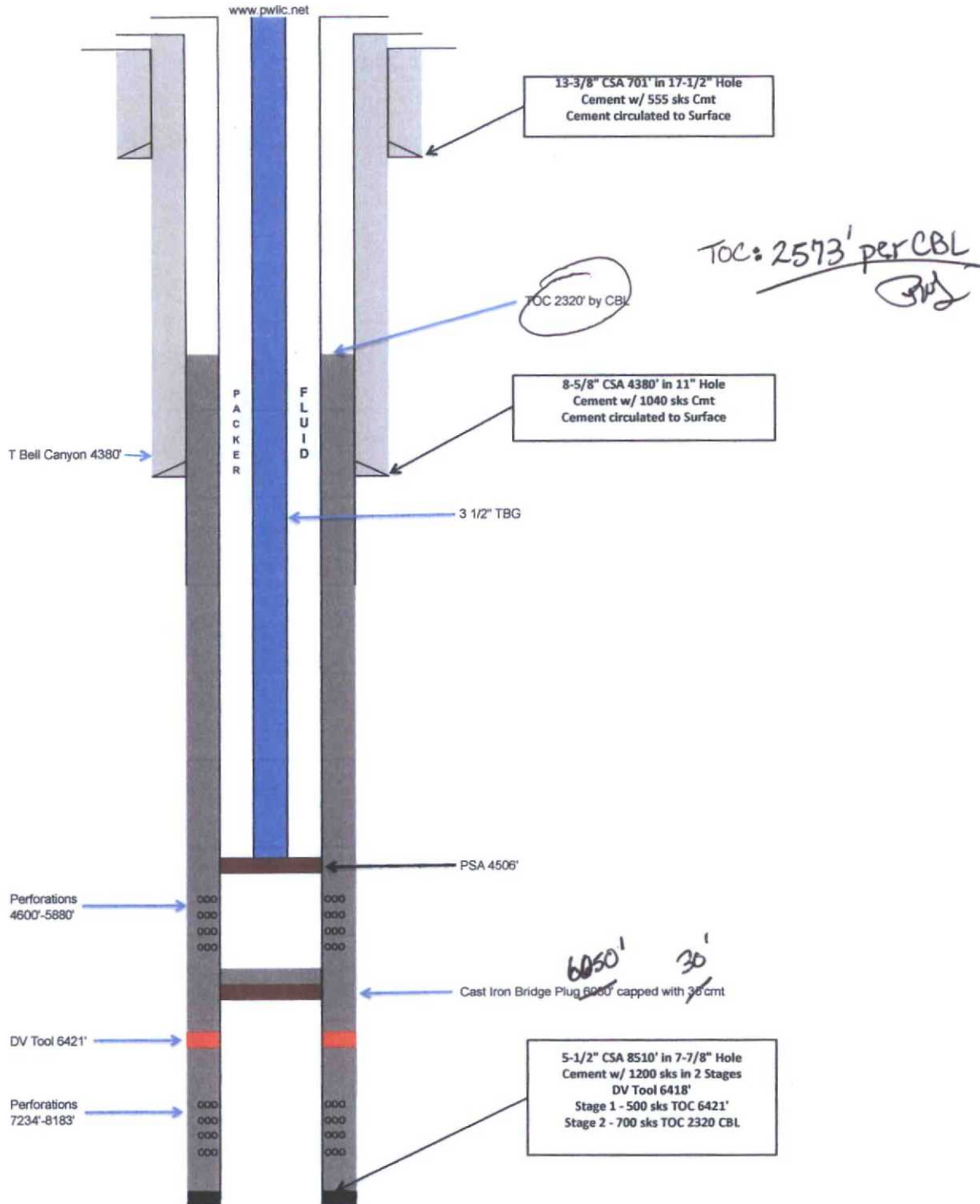

TLT SWD, LLC
Sweet Pea SWD #1
API # 30-025-35749
0.5 Mile AOR

Exhibit "C"

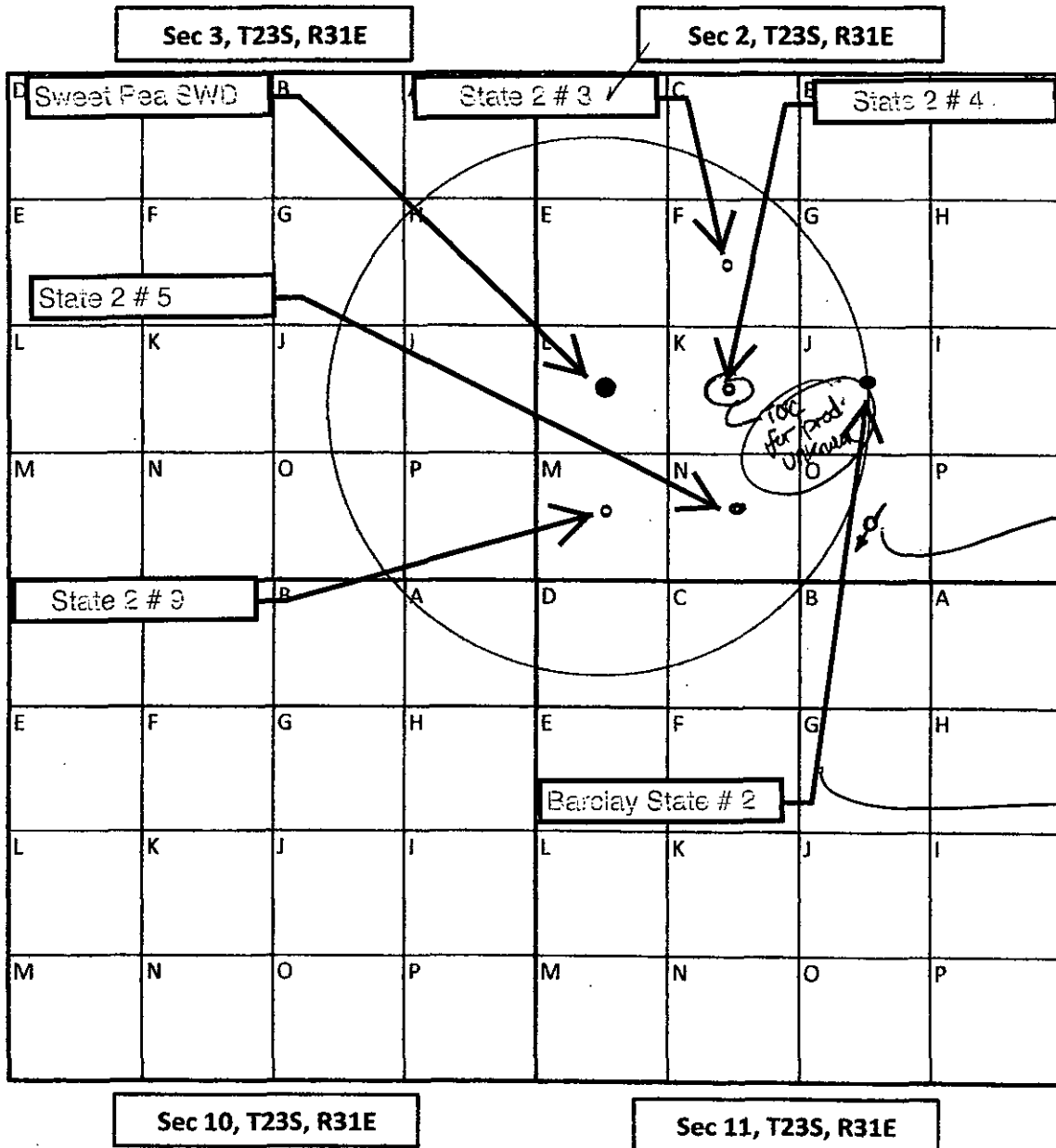

This location 1980 FSL X 660 FWL
Surface Owner
State of New Mexico
Drawing not to scale

TLT SWD, LLC
Sweet Pea SWD #1
API # 30-025-35749
0.5 Mile AOR

Exhibit "C"

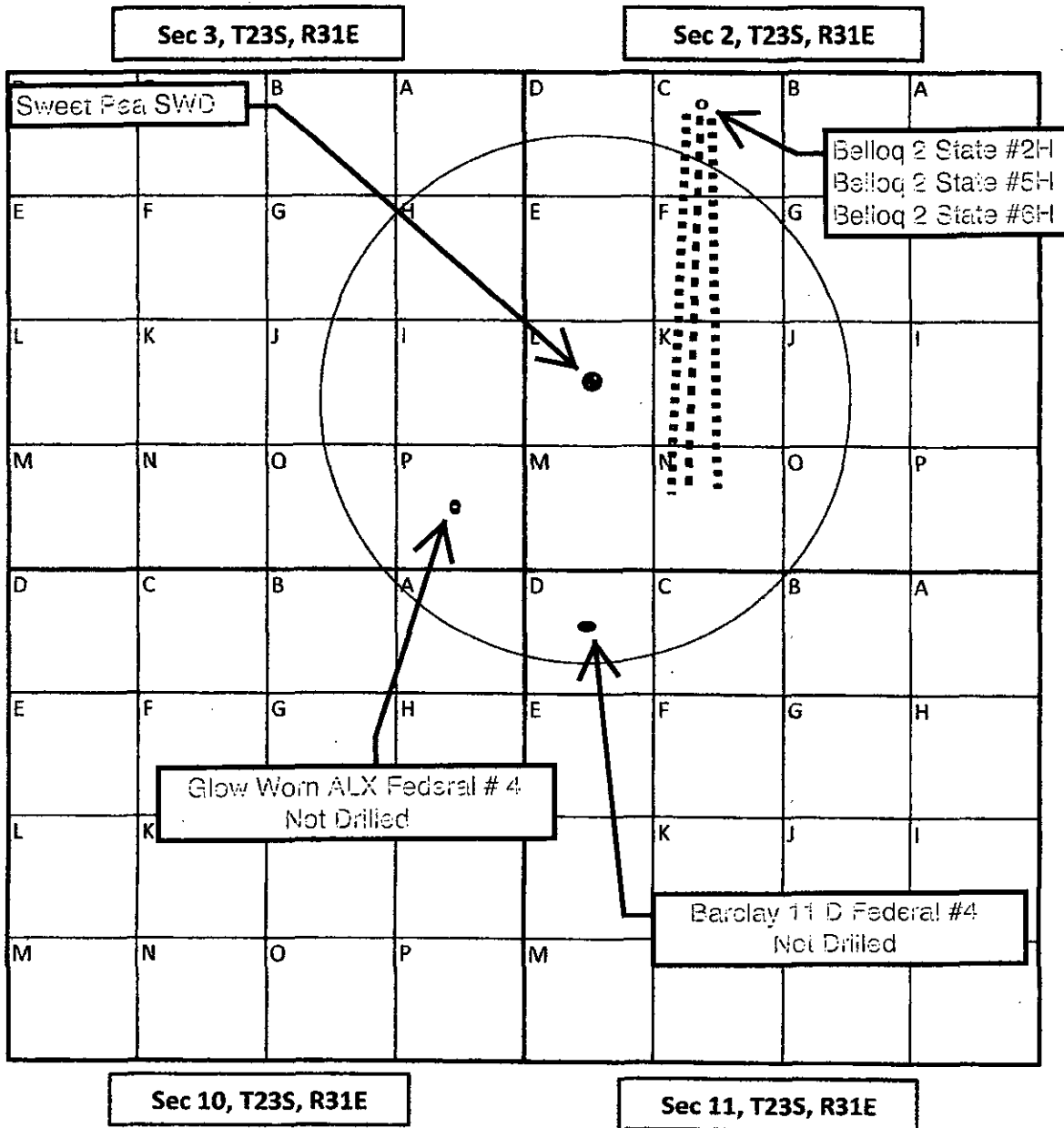

This location 1980 FSL X 660 FWL
Surface Owner
State of New Mexico
Drawing not to scale

TLT SWD, L.L.C.
Sweet Pea SWD # 1
API 30-025-35749
Offset Well Data
Exhibit "C"

	Operator	Well API	Well Name & Number	Perforations	TD	WBD
1	TLT SWD	3001535675	State 2 # 3	8021'-8204'	8500	Yes / -A
2	TLT SWD	3001535676	State 2 # 4	6970'-8224'	8468	Yes / -P/ate not released
3	TLT SWD	3001535677	State 2 # 5	8024'-8232'	8550	Yes / -A
4	TLT SWD	301535750	State 2 # 9	7568'-8206'	8422	Yes / -A (CTH)
5	Linn Energy	3001529590	Barckay State#2	6039'-6745'	8474	Yes / -P
6	Devon Energy	3001542895	Belloq 2 State # 2H	Bone Sping Horizontals		No /
7	Devon Energy	3001542895	Belloq 2 State # 2H	Bone Sping Horizontals		No /
8	Devon Energy	3001542895	Belloq 2 State # 2H	Bone Sping Horizontals		No /
9	Yates Petroleum		Glow Worm ALX Federal # 4	Never Drilled		No /
10	BP Petroleum		Barclay 11 D Federal # 4	Never Drilled		No /

Well # 6-8 surface location outside 0.5 mile AOR, Horizontal Laterals below disposal zone

Wells 9-10 never drilled

CURRENT WELLBORE DIAGRAM

TLT SWD, L.L.C.

State 2 # 4

API # 30-15-35676

1980 FSL x 1980' FWL, UL 'K' Sec 2, T23S, R31E, Eddy County, NM
Active Oil Producer

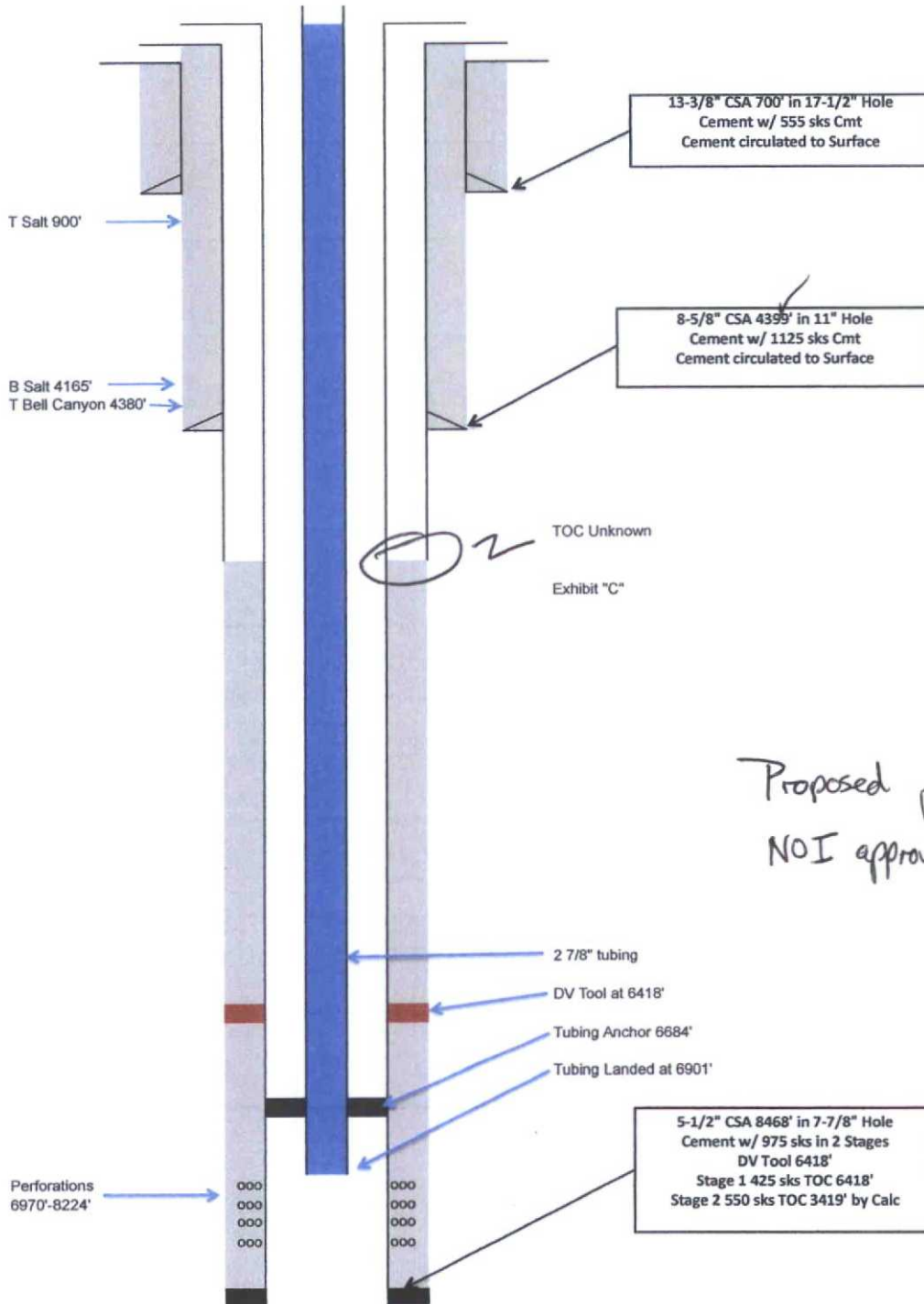

Proposed for P&A'd
NOI approved 9/8/15

TLT SWD, L.L.C.

State 2 # 3

API # 3001535675

Unit Letter "F", Section 2, T23S, R31E

Eddy County, New Mexico

1980 FNL x 1980 FWL

Prior to Conversion to SWD

Drawing not to scale

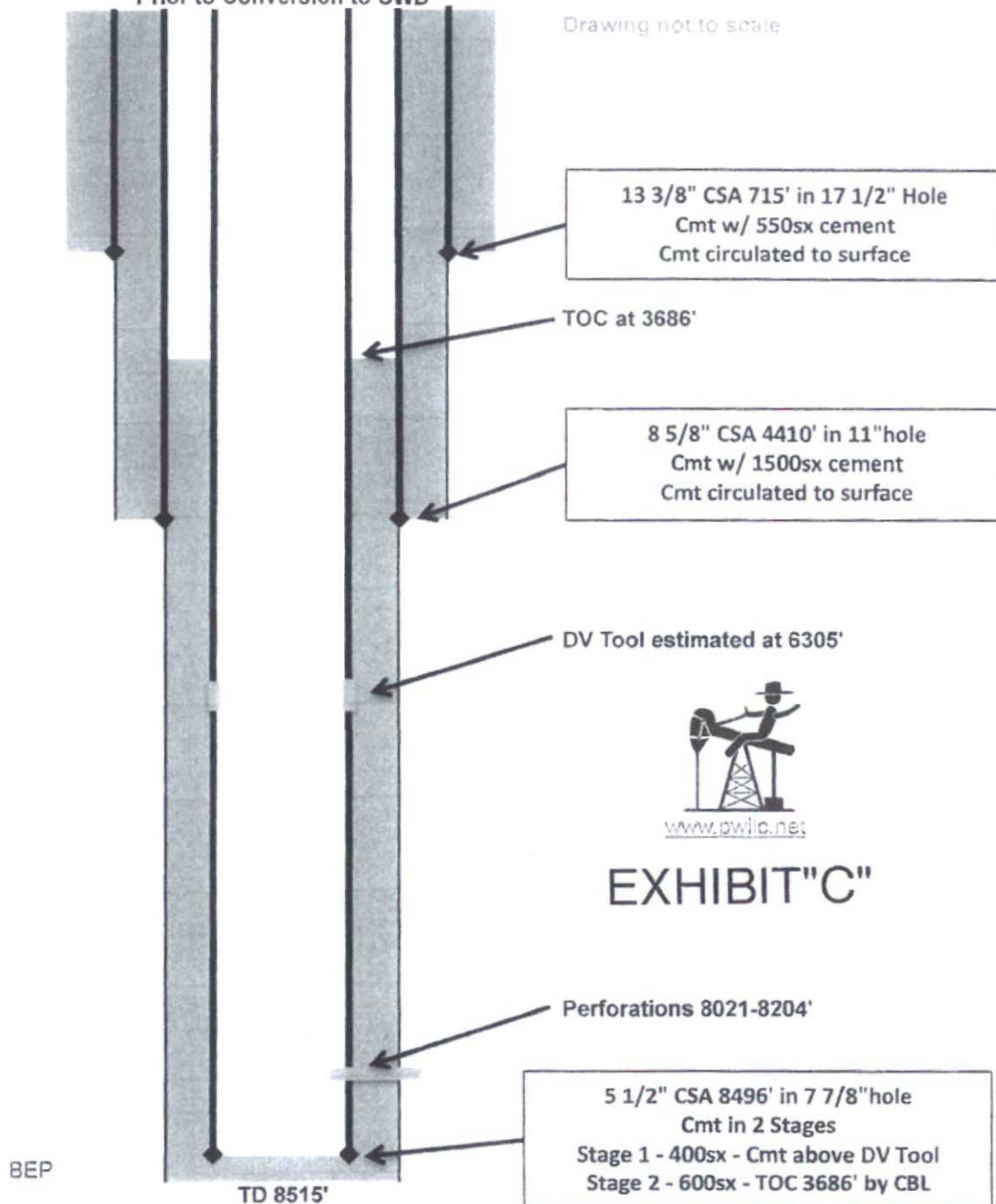

CURRENT WELLBORE DIAGRAM

TLT SWD, L.L.C.
State 2 # 5
API # 30-15-35677
660 FSL x 1980' FWL, UL 'N' Sec 2, T23S, R31E, Eddy County, NM
Active Oil Producer

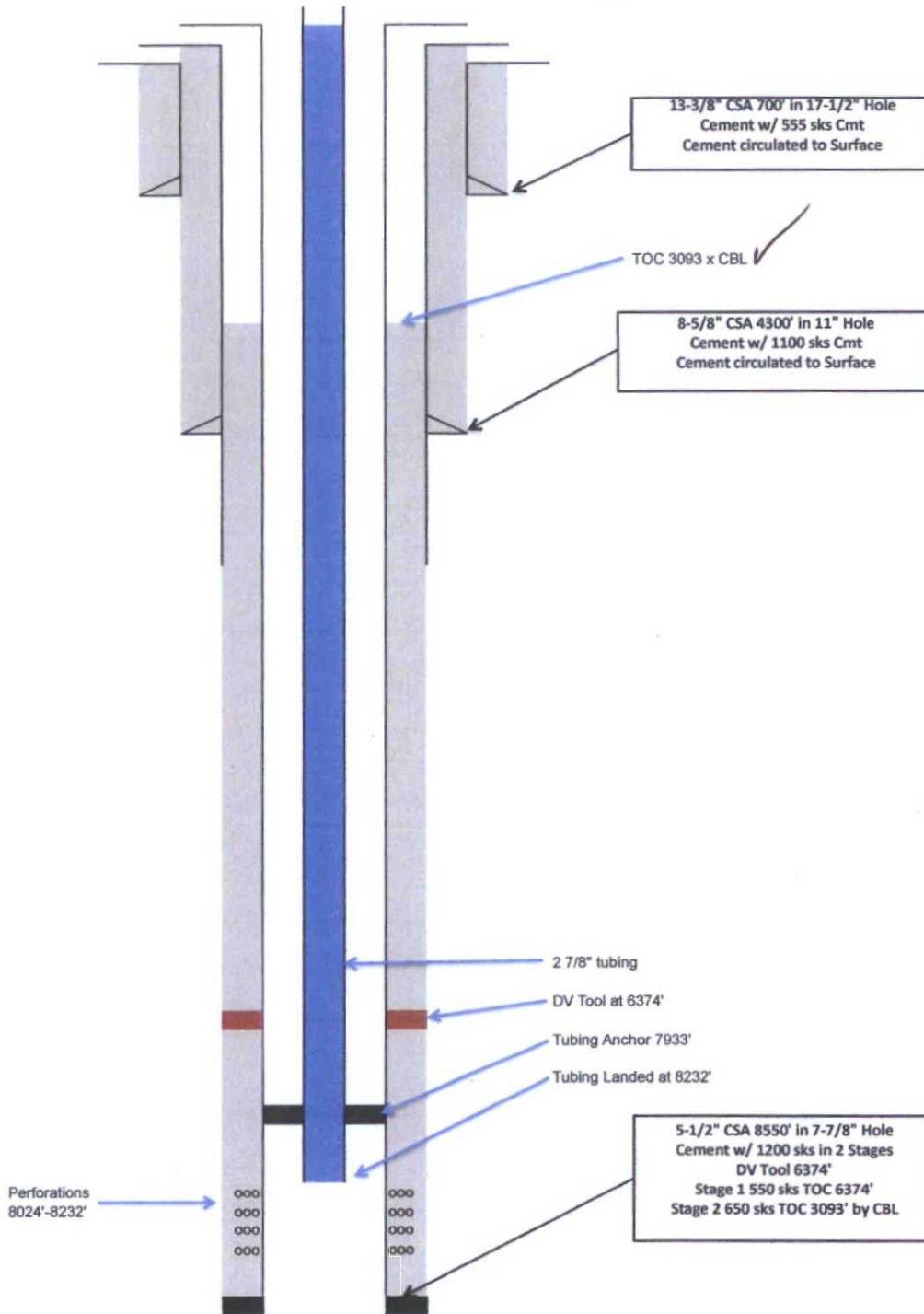

TLT SWD, L.L.C.

State 2 # 9

API # 3001535750

Unit Letter "M", Section 2, T23S, R31E

Eddy County, New Mexico

660 FSL x 660 FWL

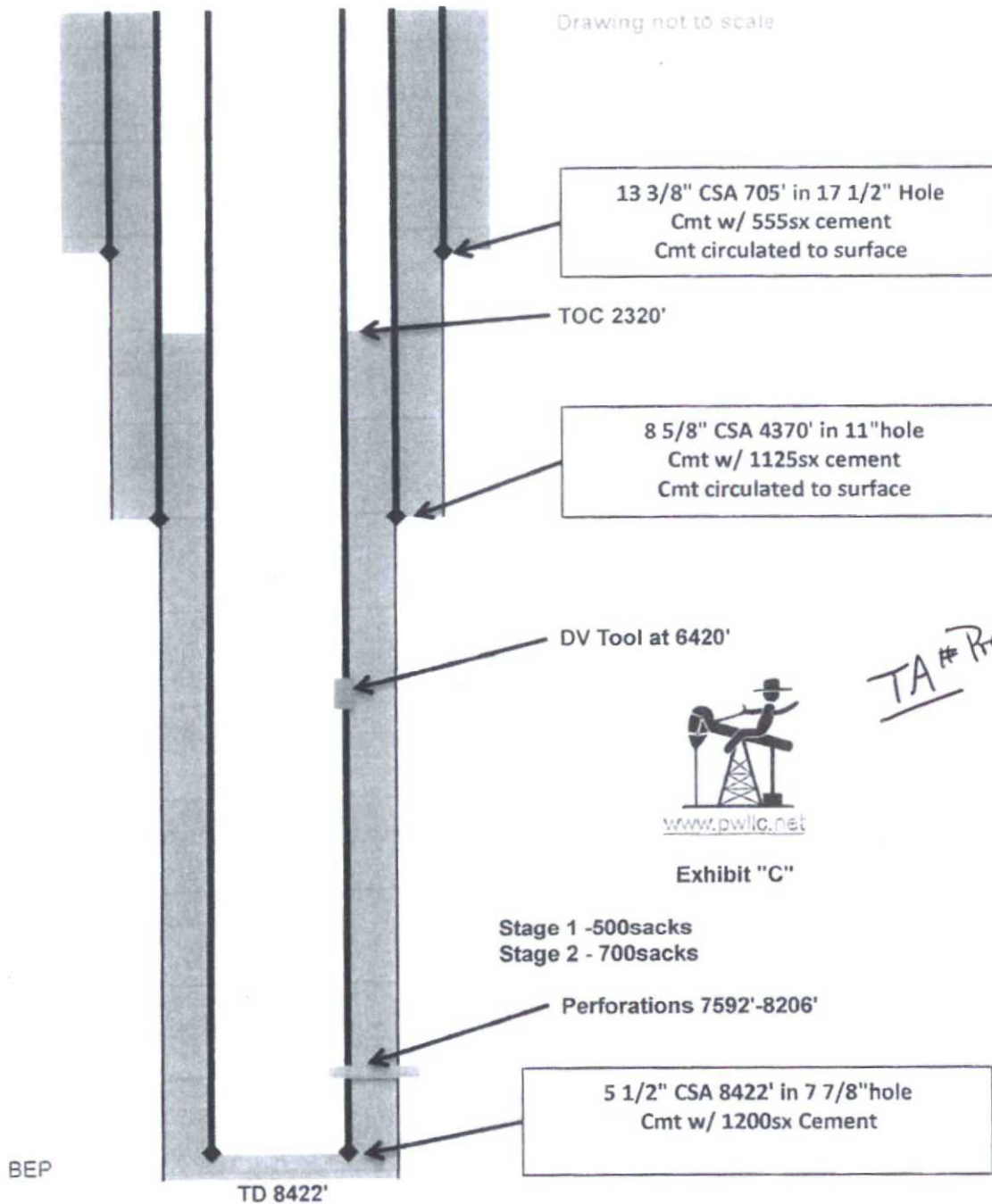

CURRENT WELLBORE SCHEMATIC

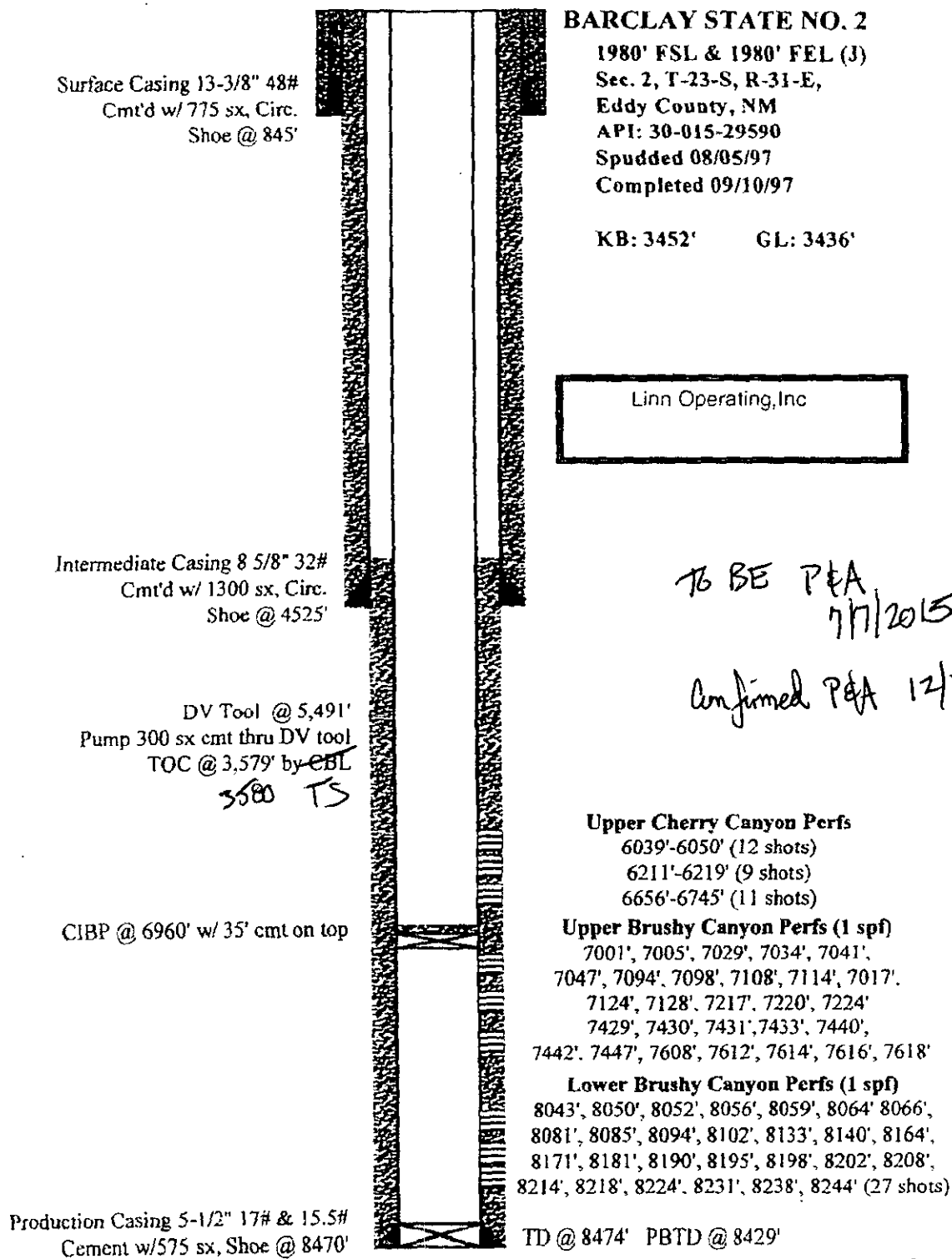

EXHIBIT "C"

HALLIBURTON

PERMAIN BASIN OPERATIONS LABORATORY
WATER ANALYSIS REPORT
HOBBS, NEW MEXICO

COMPANY Reef Exploration

REPORT W08-030
DATE March 3, 2008
DISTRICT Artesia

SUBMITTED BY _____

WELL St. 2 Leases DEPTH FORMATION
COUNTY FIELD SOURCE

SAMPLE	#001	#3	#004	#005
Sample Temp.	65 °F	65 °F	65 °F	65 °F
RESISTIVITY	0.058	0.055	0.055	0.057
SPECIFIC GR.	1.137	1.148	1.148	1.141
pH	6.49	6.33	6.44	6.32
CALCIUM	25,000 mpl	21,500 mpl	23,000 mpl	23,500 mpl
MAGNESIUM	13,500 mpl	12,600 mpl	13,200 mpl	12,000 mpl
CHLORIDE	121,446 mpl	133,380 mpl	133,380 mpl	128,115 mpl
SULFATES	heavy mpl	heavy mpl	heavy mpl	heavy mpl
BICARBONATES	153 mpl	140 mpl	171 mpl	153 mpl
SOLUBLE IRON	10 mpl	10 mpl	10 mpl	10 mpl
KCL	Negative	Negative	Negative	Negative
Sodium	mpl	mpl	mpl	mpl
TDS	mpl	mpl	mpl	mpl
OIL GRAVITY	@ °F	@ °F	@ °F	@ °F

REMARKS _____

MPL = Milligrams per liter
Resistivity measured in: Ohm/m2/m

This report is the property of Halliburton Company and neither it nor any part thereof nor a copy thereof is to be published or disclosed without first securing the express written approval of laboratory management; it may however, be used in the course of regular business operations by any person or concern and employees thereof receiving such report from Halliburton Co.

ANALYST: MB/MA

Exhibit "D"
Delaware produced water analysis
T.L.T. SWD, L.L.C.

Lease	Location	Chlorides, mg/l	Operator
David Ross SWD	35-22S-31E	178,068	Yates Petroleum
9-1	9-23S-31E	179,772	Santa Fe Energy
9-7	9-23S-31E	161,028	Santa Fe Energy
Medano A	16-23S-31E	164,010	Yates Petroleum
Medano B	16-23S-31E	182,754	Yates Petroleum
17-3	17-23S-31E	181,050	Santa Fe Energy
17-4	17-23S-31E	175,938	Santa Fe Energy
Pauline	32-23S-31E	168,292	Yates Petroleum
Sterling Silver 33	33-23S-31E	179,346	Santa Fe Energy
Sterling Silver 34	34-23S-31E	172,104	Santa Fe Energy
Saffron	2-23S-32E	166,992	Yates Petroleum
Amanda	11-23S-32E	172,530	Yates Petroleum
Continental	28-23S-32E	19,383	Yates Petroleum
Pronghorn AHO	8-23S-33E	95,860	Yates Petroleum
Pronghorn AAP	8-23S-33E	171,678	Yates Petroleum
Lily ALY	3-24S-31E	169,122	Yates Petroleum
Adeline	8-24S-31E	188,292	Yates Petroleum
Palladium 7-1	7-24S-31E	188,162	Santa Fe Energy
Squires ALR	7-24S-31E	184,458	Yates Petroleum
Cotton Draw	23-24S-31E	178,920	Yates Petroleum
Paduca	23-25S-32E	159,750	Yates Petroleum
Almost Texas	2-28S-31E	158,046	Yates Petroleum
Arapaho AKP	29-28S-33E	164,862	Yates Petroleum

Cinco

*oxy | Sand Dunes
Delaware
Lacey
Diamondtail Del.
ER Resources Plugged*

Exhibit "D"
Possible Sources of Disposed Fluid
TLT SWD, L.L.C.

Legal Notice

TLT SWD, L.L.C., PO Box 1906, Hobbs, New Mexico 88241 has filed form C-108 (Application for Authorization to Inject) with the New Mexico Oil Conservation Division seeking administrative approval to convert the Sweet Pea SWD#1, API # 30-015-35749, 1980 FSL x 660 FWL, Unit Letter "L", Section 2, T23S, R31E, Eddy County, New Mexico from a lease salt water disposal well to a commercial Bell Canyon, Cherry Canyon salt water disposal well through amendment to NMOCD SWD-1140-A. The disposal interval would be the Bell & Cherry Canyon formation through perforations from 4600 feet - 5880 feet. Disposal fluid would be produced water delivered via pipeline and trucked in from numerous producing wells in the area.

Anticipated disposal rate of 2200 BWPD with a maximum disposal rate of 3500 BWPD. Anticipated disposal pressure 1100 psi with a maximum disposal pressure determined by the results of NMOCD approved Step Rate Test. Anticipated maximum pressure of 1400 psi. Well is approximately 20 miles E of Loving, New Mexico.

All interested parties opposing the aforementioned must file objections with the New Mexico Oil Conservation Division, 1220 South St. Francis Drive, Santa Fe, New Mexico 87505 within 15 days. Additional information can be obtained by contacting Billy E. Prichard 432-934-7680

Exhibit "E"

TLT SWD, LLC
Sweet Pea SWD #1
API # 30-025-35749
0.5 Mile AOR

Sec 3, T23S, R31E

Sec 2, T23S, R31E

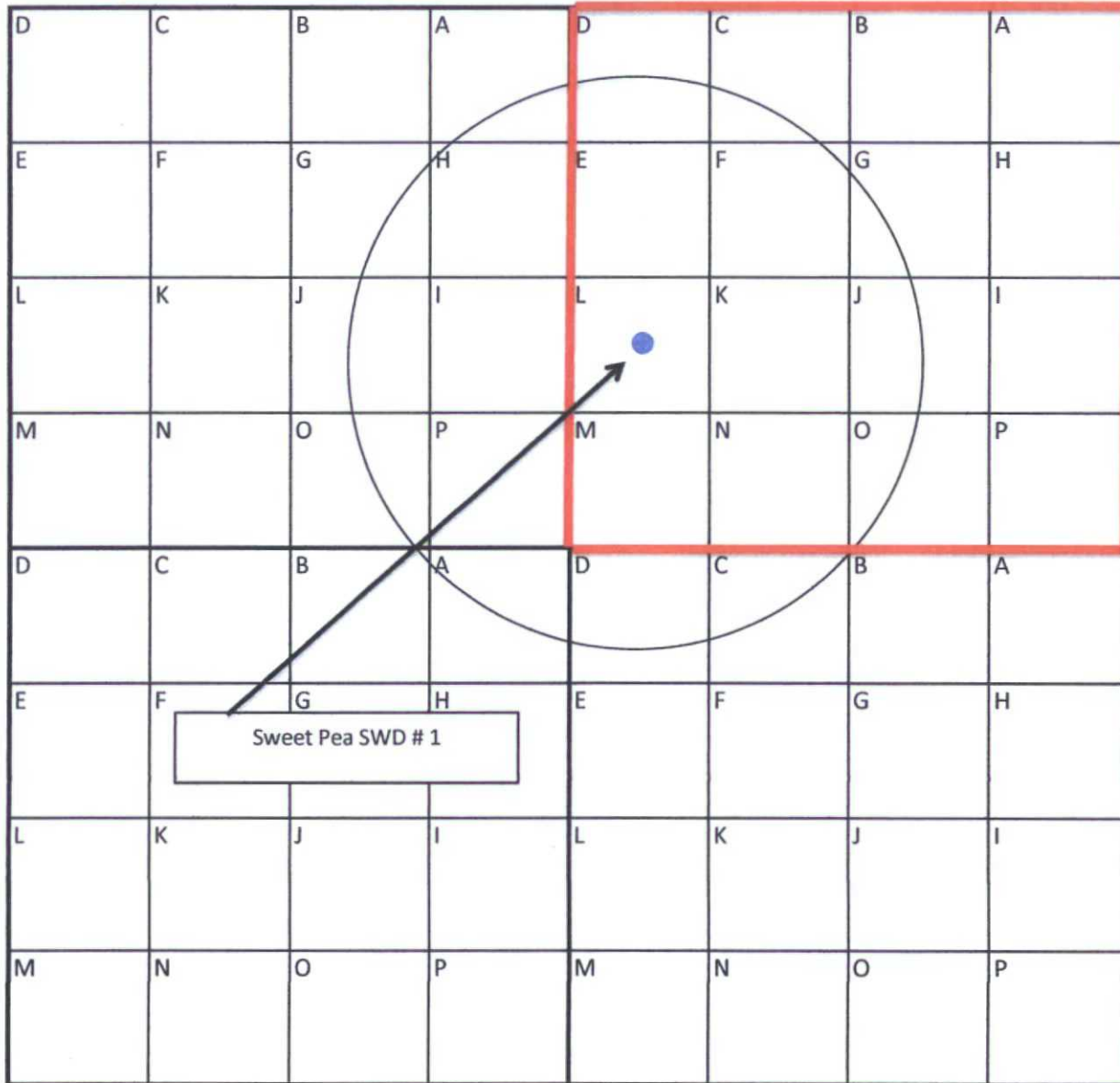

Sec 10, T23S, R31E

Sec 11, T23S, R31E

Exhibit "E"

**TLT SWD, L.L.C.
Sweet Pea SWD # 1
API # 30-015-35749
Exhibit "E"**

Notified Parties

***Section 2, T23S, R31E
Eddy County, New Mexico***
**Surface & Mineral Owner
State of New Mexico
NM State Land Office
PO Box 1148
Santa Fe, NM 87504-1148**

**Grazing Lessee
Jimmy Mills Trust
1602 Ave "J"
Abernathy, TX 79311**

**Lease Holders & Operators
TLT SWD,L.L.C.**

**Linn Energy Holdings
600 Travis Street Suite 5100
Houston, TX 77002**

**Devon Energy Production Company,LP
333 W. Sheridan Ave
OKC, Ok 73102**

**Mosaic Potash Carlsbad Inc
PO Box 71
Carlsbad, NM 88220**

**Additional Notified Parties
NMOCD District 2
811 S. First Street
Artesia, NM 88210**

**Department of Energy
WIPP
PO Box 2078
Carlsbad, NM 88221
Attention; Stewart Jones**

TLT SWD, LLC
Sweet Pea SWD #1
API # 30-025-35749
0.5 Mile AOR

Sec 3, T23S, R31E

Sec 2, T23S, R31E

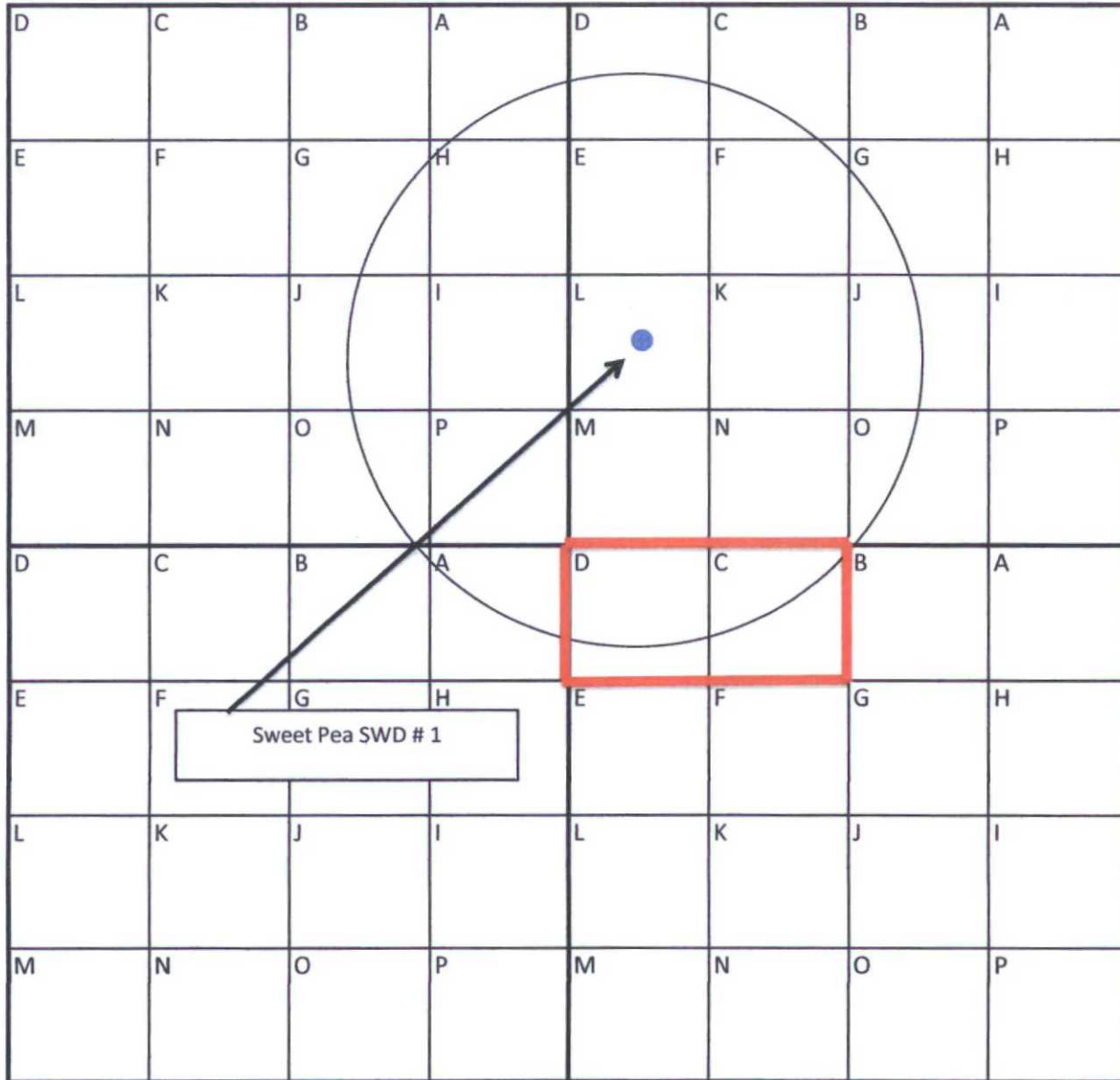

Sec 10, T23S, R31E

Sec 11, T23S, R31E

Exhibit "E"

TLT SWD, L.L.C.
Sweet Pea SWD # 1
API # 30-015-35749
Exhibit "E"
Notified Parties

Unit Letter C & D, Section 11, T23S, R31E

Eddy County, New Mexico

Mineral Owner

United States of America
Bureau of Land Management
620 E Greene Street
Carlsbad, NM

Lease Holder and Operators

Marathon Oil Company
PO Box 3128
Houston, TX 77253

TLT SWD, LLC
Sweet Pea SWD #1
API # 30-025-35749
0.5 Mile AOR

Sec 3, T23S, R31E

Sec 2, T23S, R31E

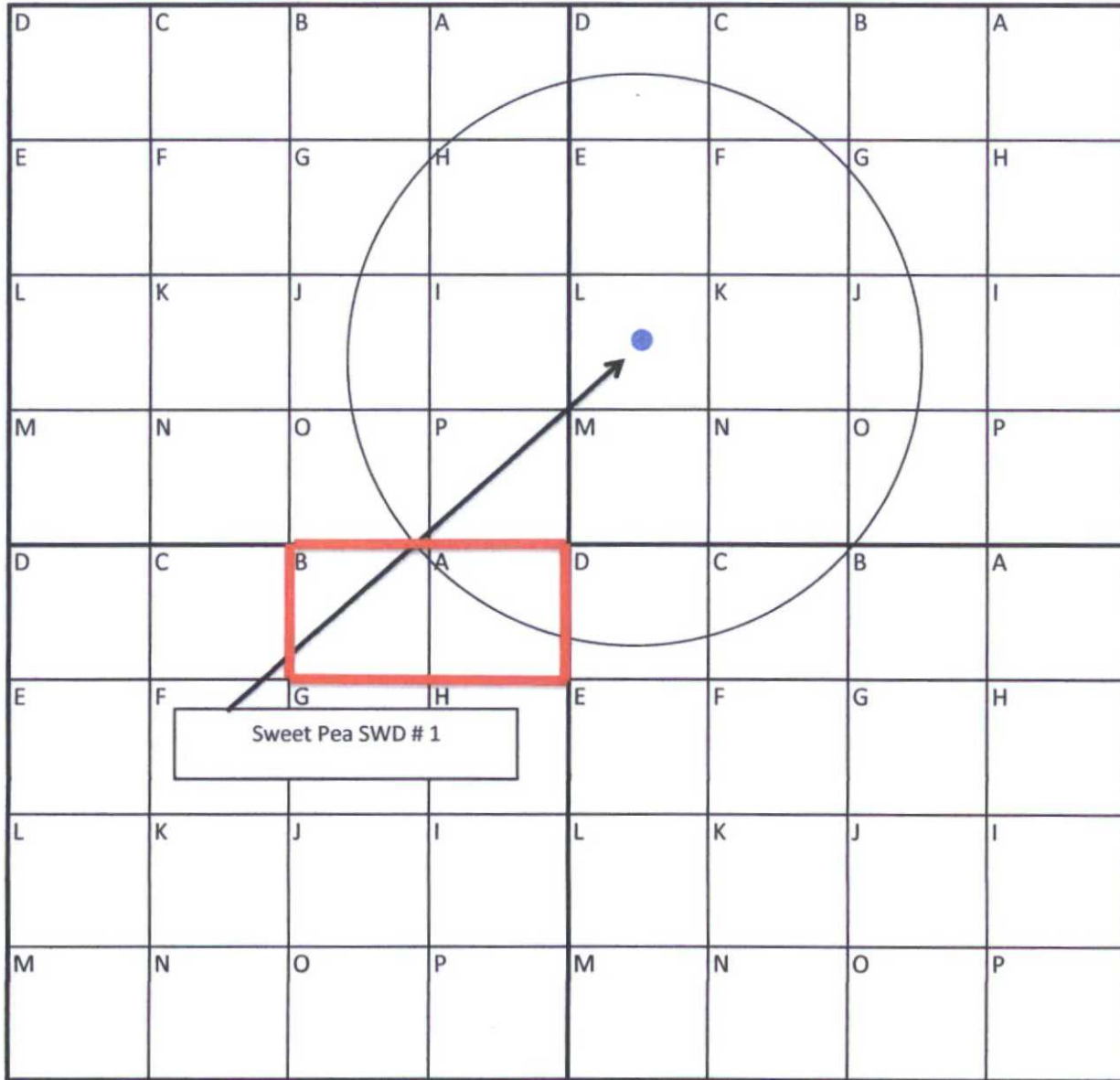

Sweet Pea SWD # 1

Sec 10, T23S, R31E

Sec 11, T23S, R31E

Exhibit "E"

**TLT SWD, L.L.C.
Sweet Pea SWD # 1
API # 30-015-35749
Exhibit "E"**

Notified Parties

***NE4, Section 10, T23S, R31E
Eddy County, New Mexico***

**Mineral Owner
United States of America
Bureau of Land Management
620 E Greene Street
Carlsbad, NM**

***Lease Holder and Operators*
Abo Petroleum Corporation
105 S. 4th Street
Artesia, NM 88210**

**Myco Industries Inc
105 S. 4th Street
Artesia, NM 88210**

**Oxy Y-1 Company
PO Box 27570
Houston, TX 77227**

**Yates Petroleum Corp
105 S. 4th Street
Artesia, NM 88210**

TLT SWD, LLC
Sweet Pea SWD #1
API # 30-025-35749
0.5 Mile AOR

Sec 3, T23S, R31E

Sec 2, T23S, R31E

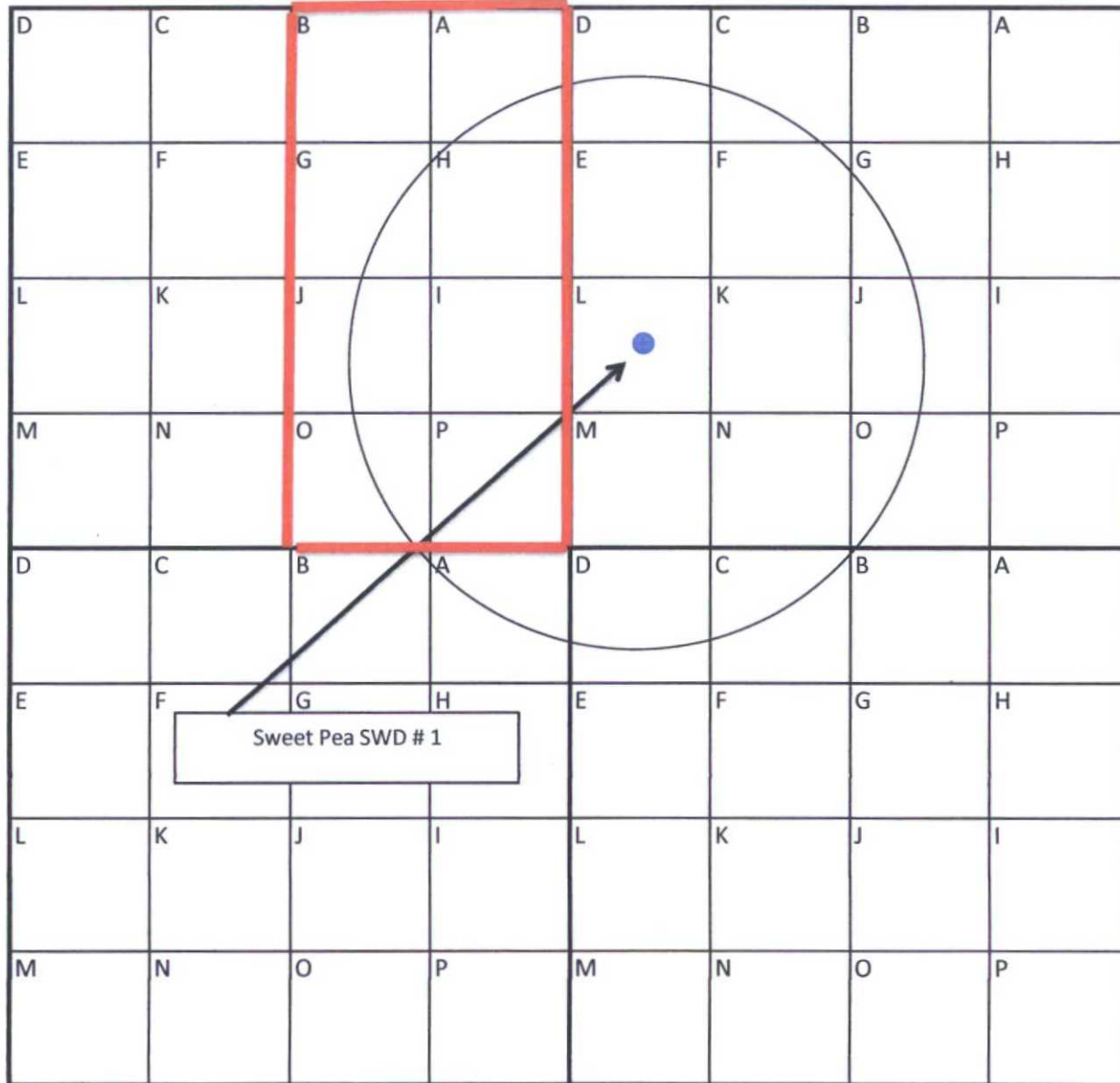

Sec 10, T23S, R31E

Sec 11, T23S, R31E

Exhibit "E"

TLT SWD, L.L.C.
Sweet Pea SWD # 1
API # 30-015-35749
Exhibit "E"
Notified Parties

E2, Section 3, T23S, R31E
Eddy County, New Mexico

Mineral Owner
United States of America
Bureau of Land Management
620 E Greene Street
Carlsbad, NM

Lease Holder and Operators
Yates Petroleum Corporation
105 S 4th Street
Artesia, NM 88210

Camterra Res Partners
2615 E. End Blvd S
Marshall, TX 75670

Devon Energy Production Company LP
333 W. Sheridan Ave
OKC, Ok 73102

U.S. Postal Service
CERTIFIED MAIL® RECEIPT
Domestic Mail Only

For delivery information, visit our website at www.usps.com®.

OFFICIAL USE
CARLSBAD, NM 88220

Certified Mail Fee \$3.45
Extra Services & Fees (check box, add fee as appropriate)
☐ Return Receipt (hardcopy) \$2.80
☐ Return Receipt (electronic) \$0.00
☐ Certified Mail Restricted Delivery \$0.00
☐ Adult Signature Required \$0.00
☐ Adult Signature Restricted Delivery \$0.00
Postage \$2.08
Total Postage and Fees \$8.33

Sent To BLM
Street & 620 E. Greene St
City, State Carlsbad, NM 88221

U.S. Postal Service™
CERTIFIED MAIL® RECEIPT
Domestic Mail Only

For delivery information, visit our website at www.usps.com®.

OFFICIAL USE
HOUSTON, TX 77002

Certified Mail Fee \$3.45
Extra Services & Fees (check box, add fee as appropriate)
☐ Return Receipt (hardcopy) \$2.80
☐ Return Receipt (electronic) \$0.00
☐ Certified Mail Restricted Delivery \$0.00
☐ Adult Signature Required \$0.00
☐ Adult Signature Restricted Delivery \$0.00
Postage \$2.08
Total Postage and Fees \$8.33

Sent To Linn Energy Holdings
Street and 600 Travis Street Ste 5100
City, State Houston, TX 77002

U.S. Postal Service™
CERTIFIED MAIL® RECEIPT
Domestic Mail Only

For delivery information, visit our website at www.usps.com®.

OFFICIAL USE
SANTA FE, NM 87504

Certified Mail Fee \$3.45
Extra Services & Fees (check box, add fee as appropriate)
☐ Return Receipt (hardcopy) \$2.80
☐ Return Receipt (electronic) \$0.00
☐ Certified Mail Restricted Delivery \$0.00
☐ Adult Signature Required \$0.00
☐ Adult Signature Restricted Delivery \$0.00
Postage \$2.08
Total Postage and Fees \$8.33

Sent To NM SLO
Street & PO Box 1148
City, State Santa Fe, NM 87504

U.S. Postal Service
CERTIFIED MAIL® RECEIPT
Domestic Mail Only

For delivery information, visit our website at www.usps.com®.

OFFICIAL USE
ARTESIA, NM 88210

Certified Mail Fee \$3.45
Extra Services & Fees (check box, add fee as appropriate)
☐ Return Receipt (hardcopy) \$2.80
☐ Return Receipt (electronic) \$0.00
☐ Certified Mail Restricted Delivery \$0.00
☐ Adult Signature Required \$0.00
☐ Adult Signature Restricted Delivery \$0.00
Postage \$2.08
Total Postage and Fees \$8.33

Sent To Yates Petroleum Corp
Street & 105 S. 4th Street
City, State Artesia, NM 88210

U.S. Postal Service™
CERTIFIED MAIL® RECEIPT
Domestic Mail Only

For delivery information, visit our website at www.usps.com®.

OFFICIAL USE
ABERNATHY, TX 79311

Certified Mail Fee \$3.45
Extra Services & Fees (check box, add fee as appropriate)
☐ Return Receipt (hardcopy) \$2.80
☐ Return Receipt (electronic) \$0.00
☐ Certified Mail Restricted Delivery \$0.00
☐ Adult Signature Required \$0.00
☐ Adult Signature Restricted Delivery \$0.00
Postage \$2.08
Total Postage and Fees \$8.33

Sent To Jimmy Mills Trust
Street & 1602 Ave J
City, State Abernathy, TX 79311

U.S. Postal Service™
CERTIFIED MAIL® RECEIPT
Domestic Mail Only

For delivery information, visit our website at www.usps.com®.

OFFICIAL USE
CARLSBAD, NM 88221

Certified Mail Fee \$3.45
Extra Services & Fees (check box, add fee as appropriate)
☐ Return Receipt (hardcopy) \$2.80
☐ Return Receipt (electronic) \$0.00
☐ Certified Mail Restricted Delivery \$0.00
☐ Adult Signature Required \$0.00
☐ Adult Signature Restricted Delivery \$0.00
Postage \$2.08
Total Postage and Fees \$8.33

Sent To Mosaic Potash Carlsbad
Street & PO Box 71
City, State Carlsbad, NM 88220

7015 0640 0004 5852 6787

U.S. Postal Service
CERTIFIED MAIL® RECEIPT
Domestic Mail Only

For delivery information, visit our website at www.usps.com®.

OFFICIAL USE
CARLSBAD, NM 88220

Certified Mail Fee	\$3.45
Extra Services & Fees (check box, add fee as appropriate)	
<input type="checkbox"/> Return Receipt (hardcopy)	\$2.80
<input type="checkbox"/> Return Receipt (electronic)	\$0.00
<input type="checkbox"/> Certified Mail Restricted Delivery	\$0.00
<input type="checkbox"/> Adult Signature Required	\$0.00
<input type="checkbox"/> Adult Signature Restricted Delivery	\$0.00
Postage	\$2.08
Total Price	\$8.33

Sent To **BLM**
Street & **620 E. Greene St**
City, State **Carlsbad, NM 88221**

PS Form 3849, June 2010

7015 0640 0004 5852 6787

U.S. Postal Service
CERTIFIED MAIL® RECEIPT
Domestic Mail Only

For delivery information, visit our website at www.usps.com®.

OFFICIAL USE
HOUSTON, TX 77002

Certified Mail Fee	\$3.45
Extra Services & Fees (check box, add fee as appropriate)	
<input type="checkbox"/> Return Receipt (hardcopy)	\$2.80
<input type="checkbox"/> Return Receipt (electronic)	\$0.00
<input type="checkbox"/> Certified Mail Restricted Delivery	\$0.00
<input type="checkbox"/> Adult Signature Required	\$0.00
<input type="checkbox"/> Adult Signature Restricted Delivery	\$0.00
Postage	\$2.08
Total Postage	\$8.33

Sent To **Linn Energy Holdings**
Street and **600 Travis Street Ste 5100**
City, State **Houston, TX 77002**

PS Form 3849, June 2010

7015 0640 0004 5852 6787

U.S. Postal Service
CERTIFIED MAIL® RECEIPT
Domestic Mail Only

For delivery information, visit our website at www.usps.com®.

OFFICIAL USE
SANTA FE, NM 87504

Certified Mail Fee	\$3.45
Extra Services & Fees (check box, add fee as appropriate)	
<input type="checkbox"/> Return Receipt (hardcopy)	\$2.80
<input type="checkbox"/> Return Receipt (electronic)	\$0.00
<input type="checkbox"/> Certified Mail Restricted Delivery	\$0.00
<input type="checkbox"/> Adult Signature Required	\$0.00
<input type="checkbox"/> Adult Signature Restricted Delivery	\$0.00
Postage	\$2.08
Total Postage and Fees	\$8.33

Sent To **NM SLO**
Street & **PO Box 1148**
City, State **Santa Fe, NM 87504**

PS Form 3849, June 2010

7015 0640 0004 5852 6681

U.S. Postal Service
CERTIFIED MAIL® RECEIPT
Domestic Mail Only

For delivery information, visit our website at www.usps.com®.

OFFICIAL USE
ARTESIA, NM 88210

Certified Mail Fee	\$3.45
Extra Services & Fees (check box, add fee as appropriate)	
<input type="checkbox"/> Return Receipt (hardcopy)	\$2.80
<input type="checkbox"/> Return Receipt (electronic)	\$0.00
<input type="checkbox"/> Certified Mail Restricted Delivery	\$0.00
<input type="checkbox"/> Adult Signature Required	\$0.00
<input type="checkbox"/> Adult Signature Restricted Delivery	\$0.00
Postage	\$2.08
Total Price	\$8.33

Sent To **Yates Petroleum Corp**
Street & **105 S. 4th Street**
City, State **Artesia, NM 88210**

PS Form 3849, June 2010

7015 0640 0004 5852 6797

U.S. Postal Service
CERTIFIED MAIL® RECEIPT
Domestic Mail Only

For delivery information, visit our website at www.usps.com®.

OFFICIAL USE
ABERNATHY, TX 79311

Certified Mail Fee	\$3.45
Extra Services & Fees (check box, add fee as appropriate)	
<input type="checkbox"/> Return Receipt (hardcopy)	\$2.80
<input type="checkbox"/> Return Receipt (electronic)	\$0.00
<input type="checkbox"/> Certified Mail Restricted Delivery	\$0.00
<input type="checkbox"/> Adult Signature Required	\$0.00
<input type="checkbox"/> Adult Signature Restricted Delivery	\$0.00
Postage	\$2.08
Total Price	\$8.33

Sent To **Jimmy Mills Trust**
Street & **1602 Ave J**
City, State **Abernathy, TX 79311**

PS Form 3849, June 2010

7015 0640 0004 5852 6759

U.S. Postal Service
CERTIFIED MAIL® RECEIPT
Domestic Mail Only

For delivery information, visit our website at www.usps.com®.

OFFICIAL USE
CARLSBAD, NM 88221

Certified Mail Fee	\$3.45
Extra Services & Fees (check box, add fee as appropriate)	
<input type="checkbox"/> Return Receipt (hardcopy)	\$2.80
<input type="checkbox"/> Return Receipt (electronic)	\$0.00
<input type="checkbox"/> Certified Mail Restricted Delivery	\$0.00
<input type="checkbox"/> Adult Signature Required	\$0.00
<input type="checkbox"/> Adult Signature Restricted Delivery	\$0.00
Postage	\$2.08
Total Postage	\$8.33

Sent To **Mosaic Potash Carlsbad**
Street and **PO Box 71**
City, State **Carlsbad, NM 88220**

PS Form 3849, June 2010

U.S. Postal Service[™]
CERTIFIED MAIL[®] RECEIPT
Domestic Mail Only

For delivery information, visit our website at www.usps.com.

OFFICIAL USE

Certified Mail Fee

\$3.45
Extra Services & Fees (check box, add fee as appropriate)
☐ Return Receipt (hardcopy) \$2.80
☐ Return Receipt (electronic) \$0.00
☐ Certified Mail Restricted Delivery \$0.00
☐ Adult Signature Required \$0.00
☐ Adult Signature Restricted Delivery \$0.00
Postage \$2.08

Total Price

\$8.33
Sent To Myco Industries
Street 105 S. 4th Street
City, State, Zip+4[®] Artesia, NM 88210

PS Form 3849

U.S. Postal Service[™]
CERTIFIED MAIL[®] RECEIPT
Domestic Mail Only

For delivery information, visit our website at www.usps.com.

OFFICIAL USE

Certified Mail Fee

\$3.45
Extra Services & Fees (check box, add fee as appropriate)
☐ Return Receipt (hardcopy) \$2.80
☐ Return Receipt (electronic) \$0.00
☐ Certified Mail Restricted Delivery \$0.00
☐ Adult Signature Required \$0.00
☐ Adult Signature Restricted Delivery \$0.00
Postage \$2.08

Total Postage and Fees

\$8.33
Sent To NMOCD District 2
Street 811 S. First street
City, State, Zip+4[®] Artesia, NM 88210

PS Form 3849

U.S. Postal Service[™]
CERTIFIED MAIL[®] RECEIPT
Domestic Mail Only

For delivery information, visit our website at www.usps.com.

OFFICIAL USE

Certified Mail Fee

\$3.45
Extra Services & Fees (check box, add fee as appropriate)
☐ Return Receipt (hardcopy) \$2.80
☐ Return Receipt (electronic) \$0.00
☐ Certified Mail Restricted Delivery \$0.00
☐ Adult Signature Required \$0.00
☐ Adult Signature Restricted Delivery \$0.00
Postage \$2.08

Total Postage and Fees

\$8.33
Sent To Oxy Y-T Company
Street and PO Box 27570
City, State, Zip+4[®] Houston, TX 77227

PS Form 3849

U.S. Postal Service[™]
CERTIFIED MAIL[®] RECEIPT
Domestic Mail Only

For delivery information, visit our website at www.usps.com.

OFFICIAL USE

Certified Mail Fee

\$3.45
Extra Services & Fees (check box, add fee as appropriate)
☐ Return Receipt (hardcopy) \$2.80
☐ Return Receipt (electronic) \$0.00
☐ Certified Mail Restricted Delivery \$0.00
☐ Adult Signature Required \$0.00
☐ Adult Signature Restricted Delivery \$0.00
Postage \$2.08

Total Price

\$8.33
Sent To Devon Energy Prod Co
Street 333 W Sheridan Ave
City, State, Zip+4[®] OKC, OK 73102

PS Form 3849

U.S. Postal Service[™]
CERTIFIED MAIL[®] RECEIPT
Domestic Mail Only

For delivery information, visit our website at www.usps.com.

OFFICIAL USE

Certified Mail Fee

\$3.45
Extra Services & Fees (check box, add fee as appropriate)
☐ Return Receipt (hardcopy) \$2.80
☐ Return Receipt (electronic) \$0.00
☐ Certified Mail Restricted Delivery \$0.00
☐ Adult Signature Required \$0.00
☐ Adult Signature Restricted Delivery \$0.00
Postage \$2.08

Total Postage and Fees

\$8.33
Sent To Marathon Oil Company
Street and PO Box 3128
City, State, Zip+4[®] Houston, TX 77253

PS Form 3849

U.S. Postal Service[™]
CERTIFIED MAIL[®] RECEIPT
Domestic Mail Only

For delivery information, visit our website at www.usps.com.

OFFICIAL USE

Certified Mail Fee

\$3.45
Extra Services & Fees (check box, add fee as appropriate)
☐ Return Receipt (hardcopy) \$2.80
☐ Return Receipt (electronic) \$0.00
☐ Certified Mail Restricted Delivery \$0.00
☐ Adult Signature Required \$0.00
☐ Adult Signature Restricted Delivery \$0.00
Postage \$2.08

Total Postage and Fees

\$8.33
Sent To Camterra Res Partners
Street 2615 E. End Blvd S
City, State, Zip+4[®] Marshall, TX 75670

PS Form 3849

U.S. Postal Service™
CERTIFIED MAIL® RECEIPT
Domestic Mail Only

For delivery information, visit our website at www.usps.com®.

OFFICIAL USE

Certified Mail Fee

\$3.45
Extra Services & Fees (check box, add fee as appropriate)
☐ Return Receipt (hardcopy) \$2.80
☐ Return Receipt (electronic) \$0.00
☐ Certified Mail Restricted Delivery \$0.00
☐ Adult Signature Required \$0.00
☐ Adult Signature Restricted Delivery \$0.00

Postage \$2.08

Total Price \$8.33

Sent To Myco Industries
Street 105 S. 4th Street
City, State, Zip Artesia, NM 88210

PS Form 3849

U.S. Postal Service™
CERTIFIED MAIL® RECEIPT
Domestic Mail Only

For delivery information, visit our website at www.usps.com®.

OFFICIAL USE

Certified Mail Fee

\$3.45
Extra Services & Fees (check box, add fee as appropriate)
☐ Return Receipt (hardcopy) \$2.80
☐ Return Receipt (electronic) \$0.00
☐ Certified Mail Restricted Delivery \$0.00
☐ Adult Signature Required \$0.00
☐ Adult Signature Restricted Delivery \$0.00

Postage \$2.08

Total Price \$8.33

Sent To NMOCD District 2
Street 811 S. First street
City, State, Zip Artesia, NM 88210

PS Form 3849

U.S. Postal Service™
CERTIFIED MAIL® RECEIPT
Domestic Mail Only

For delivery information, visit our website at www.usps.com®.

OFFICIAL USE

Certified Mail Fee

\$3.45
Extra Services & Fees (check box, add fee as appropriate)
☐ Return Receipt (hardcopy) \$2.80
☐ Return Receipt (electronic) \$0.00
☐ Certified Mail Restricted Delivery \$0.00
☐ Adult Signature Required \$0.00
☐ Adult Signature Restricted Delivery \$0.00

Postage \$2.08

Total Price \$8.33

Sent To Oxy Y-T Company
Street PO Box 27570
City, State, Zip Houston, TX 77227

PS Form 3849

U.S. Postal Service™
CERTIFIED MAIL® RECEIPT
Domestic Mail Only

For delivery information, visit our website at www.usps.com®.

OFFICIAL USE

Certified Mail Fee

\$3.45
Extra Services & Fees (check box, add fee as appropriate)
☐ Return Receipt (hardcopy) \$2.80
☐ Return Receipt (electronic) \$0.00
☐ Certified Mail Restricted Delivery \$0.00
☐ Adult Signature Required \$0.00
☐ Adult Signature Restricted Delivery \$0.00

Postage \$2.08

Total Price \$8.33

Sent To Devon Energy Prod Co
Street 333 W Sheridan Ave
City, State, Zip OKC, OK 73102

PS Form 3849

U.S. Postal Service™
CERTIFIED MAIL® RECEIPT
Domestic Mail Only

For delivery information, visit our website at www.usps.com®.

OFFICIAL USE

Certified Mail Fee

\$3.45
Extra Services & Fees (check box, add fee as appropriate)
☐ Return Receipt (hardcopy) \$2.80
☐ Return Receipt (electronic) \$0.00
☐ Certified Mail Restricted Delivery \$0.00
☐ Adult Signature Required \$0.00
☐ Adult Signature Restricted Delivery \$0.00

Postage \$2.08

Total Price \$8.33

Sent To Marathon Oil Company
Street PO Box 3128
City, State, Zip Houston, TX 77253

PS Form 3849

U.S. Postal Service™
CERTIFIED MAIL® RECEIPT
Domestic Mail Only

For delivery information, visit our website at www.usps.com®.

OFFICIAL USE

Certified Mail Fee

\$3.45
Extra Services & Fees (check box, add fee as appropriate)
☐ Return Receipt (hardcopy) \$2.80
☐ Return Receipt (electronic) \$0.00
☐ Certified Mail Restricted Delivery \$0.00
☐ Adult Signature Required \$0.00
☐ Adult Signature Restricted Delivery \$0.00

Postage \$2.08

Total Price \$8.33

Sent To Camterra Res Partners
Street 2615 E. End Blvd S
City, State, Zip Marshall, TX 75679

PS Form 3849

7479 2525 4000 7479

U.S. Postal Service
CERTIFIED MAIL® RECEIPT
Domestic Mail Only

For delivery information, visit our website at www.usps.com

OFFICIAL USE
CARLSBAD, NM 88221

Certified Mail Fee	\$3.45
Extra Services & Fees (check box, add fee if appropriate)	
<input type="checkbox"/> Return Receipt (hardcopy)	\$2.80
<input type="checkbox"/> Return Receipt (electronic)	\$0.00
<input type="checkbox"/> Certified Mail Restricted Delivery	\$0.00
<input type="checkbox"/> Adult Signature Required	\$0.00
<input type="checkbox"/> Adult Signature Restricted Delivery	\$0.00
Postage	\$2.08
Total Postage and Fees	\$8.33

Sent To: Dept of Energy-Stewart Jones
Street: PO Box 2078
City, St: Carlsbad, NM 88221

PS Form 3800, June 2010

7015 0640 0004 5852 6711

U.S. Postal Service
CERTIFIED MAIL® RECEIPT
Domestic Mail Only

For delivery information, visit our website at www.usps.com

OFFICIAL USE
ARTESIA, NM 88210

Certified Mail Fee	\$3.45
Extra Services & Fees (check box, add fee if appropriate)	
<input type="checkbox"/> Return Receipt (hardcopy)	\$2.80
<input type="checkbox"/> Return Receipt (electronic)	\$0.00
<input type="checkbox"/> Certified Mail Restricted Delivery	\$0.00
<input type="checkbox"/> Adult Signature Required	\$0.00
<input type="checkbox"/> Adult Signature Restricted Delivery	\$0.00
Postage	\$2.08
Total Price	\$8.33

Sent To: Abo Petroleum
Street: 105 S. 4th Street
City, St: Artesia, NM 88210

PS Form 3800, June 2010

742 6744 5552 5897 5777

2015 5 10 11:25 AM 11.7.17



Pueblo West Resources
125 Greathouse Village
Decatur, Texas 76234
432-934-7680

September 8, 2015

RECEIVED OCD

Phillip, Please find enclosed 2 copies of C108 for the Sweet Pea SWD#1. I have filed C103 with District 2 to PA the State 2 #4 (API#30-015-35676). Legal notice to be published on Sept 6 in the Artesia Daily Press. Original Affidavit of Publication will be sent to your attention when received. Please consider approving this application retroactive back to date that well was converted to SWD per SWD-1140-A.

TLT SWD, L.L.C., PO Box 1906, Hobbs, New Mexico 88241 has filed form C-108 (Application for Authorization to Inject) with the New Mexico Oil Conservation Division seeking administrative approval to convert the Sweet Pea SWD#1, API # 30-015-35749, 1980 FSL x 660 FWL, Unit Letter "L", Section 2, T23S, R31E, Eddy County, New Mexico from a lease salt water disposal well to a commercial Bell Canyon, Cherry Canyon salt water disposal well through amendment to NMOCD SWD-1140-A. The disposal interval would be the Bell & Cherry Canyon formation through perforations from 4600 feet - 5880 feet. Disposal fluid would be produced water delivered via pipeline and trucked in from numerous producing wells in the area. Anticipated disposal rate of 2200 BWPD with a maximum disposal rate of 3500 BWPD. Anticipated disposal pressure 1100 psi with a maximum disposal pressure determined by the results of NMOCD approved Step Rate Test. Anticipated maximum pressure of 1400 psi. Well is approximately 20 miles E of Loving, New Mexico.

All interested parties opposing the aforementioned must file objections with the New Mexico Oil Conservation Division, 1220 South St. Francis Drive, Santa Fe, New Mexico 87505 within 15 days. Additional information can be obtained by contacting Billy E. Prichard 432-934-7680

Thanks,

Billy (Bill) E. Prichard
Pueblo West Resources
Agent for TLT SWD, L.L.C.
125 Greathouse Village
Decatur, TX 76234
432-934-7680 cellular



Facebook

email; billy@pwlrc.net



Pueblo West Resources
125 Greathouse Village
Decatur, Texas 76234
432-934-7680

September 4, 2015

Per the rules and regulations of New Mexico Oil Conservation Division.
Please find enclosed a copy of NMOCD form C108.

TLT SWD, L.L.C., PO Box 1906, Hobbs, New Mexico 88241 has filed form C-108 (Application for Authorization to Inject) with the New Mexico Oil Conservation Division seeking administrative approval to convert the Sweet Pea SWD#1, API # 30-015-35749, 1980 FSL x 660 FWL, Unit Letter "L", Section 2, T23S, R31E, Eddy County, New Mexico from a lease salt water disposal well to a commercial Bell Canyon, Cherry Canyon salt water disposal well through amendment to NMOCD SWD-1140-A. The disposal interval would be the Bell & Cherry Canyon formation through perforations from 4600 feet - 5880 feet. Disposal fluid would be produced water delivered via pipeline and trucked in from numerous producing wells in the area. Anticipated disposal rate of 2200 BWPD with a maximum disposal rate of 3500 BWPD. Anticipated disposal pressure 1100 psi with a maximum disposal pressure determined by the results of NMOCD approved Step Rate Test. Anticipated maximum pressure of 1400 psi. Well is approximately 20 miles E of Loving, New Mexico.

All interested parties opposing the aforementioned must file objections with the New Mexico Oil Conservation Division, 1220 South St. Francis Drive, Santa Fe, New Mexico 87505 within 15 days. Additional information can be obtained by contacting Billy E. Prichard 432-934-7680

Thanks,

A handwritten signature in black ink that reads "Billy E. Prichard". The signature is fluid and cursive, with the first name "Billy" being more prominent.

Billy (Bill) E. Prichard
Pueblo West Resources
Agent for TLT SWD, L.L.C.
125 Greathouse Village
Decatur, TX 76234
432-934-7680 cellular



Facebook
email; billy@pwllc.net
www.pwllc.net

Submit 1 Copy To Appropriate District Office
District I – (575) 393-6161
1625 N. French Dr., Hobbs, NM 88240
District II – (575) 748-1283
811 S. First St., Artesia, NM 88210
District III – (505) 334-6178
1000 Rio Brazos Rd., Aztec, NM 87410
District IV – (505) 476-3460
1220 S. St. Francis Dr., Santa Fe, NM 87505

State of New Mexico
Energy, Minerals and Natural Resources

Form C-103
Revised August 1, 2011

OIL CONSERVATION DIVISION
1220 South St. Francis Dr.
Santa Fe, NM 87505

SUNDRY NOTICES AND REPORTS ON WELLS (DO NOT USE THIS FORM FOR PROPOSALS TO DRILL OR TO DEEPEN OR PLUG BACK TO A DIFFERENT RESERVOIR. USE "APPLICATION FOR PERMIT" (FORM C-101) FOR SUCH PROPOSALS.)		WELL API NO. 30-015-35676
1. Type of Well: Oil Well <input checked="" type="checkbox"/> Gas Well <input type="checkbox"/> Other <input type="checkbox"/>		5. Indicate Type of Lease STATE <input checked="" type="checkbox"/> FEE <input type="checkbox"/>
2. Name of Operator TLT SWD, LLC		6. State Oil & Gas Lease No.
3. Address of Operator PO Box 1906 Hobbs, NM 88241		7. Lease Name or Unit Agreement Name State 2
4. Well Location Unit Letter K : 1980 feet from the South line and 1980 feet from the West line Section 2 Township 23S Range 31E NMPM Eddy County		8. Well Number 004
11. Elevation (Show whether DR, RKB, RT, GR, etc.)		9. OGRID Number 287481
		10. Pool name or Wildcat Livingston Ridge: Delaware SE

12. Check Appropriate Box to Indicate Nature of Notice, Report or Other Data

NOTICE OF INTENTION TO:		SUBSEQUENT REPORT OF:	
PERFORM REMEDIAL WORK <input type="checkbox"/>	PLUG AND ABANDON <input checked="" type="checkbox"/>	REMEDIAL WORK <input type="checkbox"/>	ALTERING CASING <input type="checkbox"/>
TEMPORARILY ABANDON <input type="checkbox"/>	CHANGE PLANS <input type="checkbox"/>	COMMENCE DRILLING OPNS. <input type="checkbox"/>	P AND A <input type="checkbox"/>
PULL OR ALTER CASING <input type="checkbox"/>	MULTIPLE COMPL <input type="checkbox"/>	CASING/CEMENT JOB <input type="checkbox"/>	
DOWNHOLE COMMINGLE <input type="checkbox"/>			
OTHER: <input type="checkbox"/>		OTHER: <input type="checkbox"/>	

13. Describe proposed or completed operations. (Clearly state all pertinent details, and give pertinent dates, including estimated date of starting any proposed work). SEE RULE 19.15.7.14 NMAC. For Multiple Completions: Attach wellbore diagram of proposed completion or recompletion.

TLT proposes to PA State 2 # 4 – Please see attachments

Spud Date:

Rig Release Date:

I hereby certify that the information above is true and complete to the best of my knowledge and belief.

SIGNATURE _____ TITLE **Agent for TLT SWD** DATE _____
Type or print name **Billy E. Prichard** E-mail address: **billy@pwillc.net** PHONE: **432-934-7680**
For State Use Only
APPROVED BY: _____ TITLE _____ DATE _____
Conditions of Approval (if any): _____

TLT SWD, L.L.C.
State 2 # 4
API # 30-015-35676
1980 FSL X 1980 FWL
Unit Letter "K", Section 2, T23S, R31E
Eddy County, New Mexico
Plugging Procedure

Spud 10/21/07

13 3/8" 48# CSA in 17 1/2" hole at 700' Cmt w/ 555 sks.

Cmt circulated to surface

8 5/8" 32# CSA in 11" hole at 4399'. Cmt w/ 1125 sks

Cmt circulated to surface

5 1/2" 17# CSA in 7 7/8" hole at 8468'. DV Tool at 6418'

Cmt in 2 Stages

Stage 1 - 425 sks - TOC at DV tool at 6418'

Stage 2 - 550sks - Calculated TOC using 1.35 cuft/sk x 70 % fill = 3419'

Bell Canyon 4380'

Cherry Canyon 5290'

Brushy Canyon 6955'

Top of Salt 900'

Base of Salt 4165'

Perforations 6970'-8224'

Tubing Land at 6901' x Tubing Anchor 6684' x TAC stuck at 6684'

Cut tubing at 6680'

Squeeze perfs with 100 sks cement x WOC x tag cement plug at 6600'

Run cement bond log 6000'-4000'

Displace well with gelled brine water

Perforate at 4450'

Squeeze perfs with 100 sks cement

Bell Canyon, Intermediate casing shoe and base of salt plug

WOC x tag cement plug at 4100' or above

Perforate at 950'

Circulate cement to surface (250 sks)

Top of salt, Surface casing shoe, Surface plug

Leave well full of cement

Cut of well head x install PA marker

Cut of service unit anchors x prepare location for release



New Mexico Energy, Minerals and Natural Resources Department

Bill Richardson
Governor

Joanna Prukop
Cabinet Secretary

Mark Fesmire
Division Director
Oil Conservation Division



Administrative Order SWD-1140-A

November 24, 2009

Mr. Jose Velez
Reef Exploration, L.P.
1901 N. Central Expressway
Suite 300
Richardson, TX 75080

ADMINISTRATIVE ORDER OF THE OIL CONSERVATION DIVISION

Under the provisions of Division Rule 26.8B., Reef Exploration, L.P. seeks an administrative order to utilize its State 2 Well No. 8 (API 30-015-35749) located 660 feet from the West line and 1980 feet from the South line, Unit L of Section 2, Township 23 South, Range 31 East, NMPM, Eddy County, New Mexico, for produced water disposal purposes.

THE DIVISION DIRECTOR FINDS THAT:

The application has been duly filed under the provisions of Division Rule 26.8B. Satisfactory information has been provided that affected parties as defined in Rule 26.8B.(2) have been notified and no objections have been received within the prescribed waiting period. The applicant has presented satisfactory evidence that all requirements prescribed in Rule 26.8 will be met and the operator is in compliance with Division Rule 5.9.

IT IS THEREFORE ORDERED THAT:

The applicant, Reef Exploration, L.P. (OGRID 246083), is hereby authorized to utilize its State 2 Well No. 8 (API 30-015-35749) located 660 feet from the West line and 1980 feet from the South line, Unit L of Section 2, Township 23 South, Range 31 East, NMPM, Eddy County, New Mexico, for disposal of waste water originating only from producing wells operated by the operator of this disposal well into the Delaware Mountain Group from 4600 feet to 5880 feet through plastic-lined tubing set within 100 feet of the disposal interval.

IT IS FURTHER ORDERED THAT:

The operator shall take all steps necessary to ensure that the disposed water enters only the proposed disposal interval and is not permitted to escape to other formations or onto the



surface.

The well shall be equipped with a bottom plug or other interior barrier installed and pressure tested below the maximum permitted disposal depth. This plug shall be set within 200 feet of the permitted disposal interval or as directed by the Division's inspectors.

After installing tubing, the casing-tubing annulus shall be loaded with an inert fluid and equipped with a pressure gauge or an approved leak detection device in order to determine leakage in the casing, tubing, or packer. The casing shall be pressure tested from the surface to the packer setting depth to assure casing integrity.

The wellhead injection pressure on the well shall be limited to **no more than 920 psi**. In addition, the disposal well or system shall be equipped with a pressure limiting device in workable condition which shall, at all times, limit surface tubing pressure to the maximum allowable pressure for this well.

The Director of the Division may administratively authorize an increase in surface tubing pressure up to a surface pressure gradient of 0.5 psi/foot upon a proper showing by the operator of said well that such higher pressure will not result in migration of the disposed fluid from the target formation. Such proper showing shall be demonstrated by an acceptable Step-Rate-Test.

The operator shall notify the supervisor of the Division's district office in Artesia of the date and time of the installation of disposal equipment and of any mechanical integrity test so that the same may be inspected and witnessed. The operator shall provide written notice of the date of commencement of disposal to the Division's district office. The operator shall submit monthly reports of the disposal operations on Division Form C-115, in accordance with Division Rules 26.13 and 7.24.

Without limitation on the duties of the operator as provided in Division Rules 30 and 29, or otherwise, the operator shall immediately notify the Division's district office of any failure of the tubing, casing or packer in the well, or of any leakage or release of water, oil or gas from around any produced or plugged and abandoned well in the area, and shall take such measures as may be timely and necessary to correct such failure or leakage.

The injection authority granted under this order is not transferable except upon division approval. The division may require the operator to demonstrate mechanical integrity of any injection well that will be transferred prior to approving transfer of authority to inject.

The division may revoke this injection permit after notice and hearing if the operator is in violation of 19.15.5.9 NMAC.

In accordance with Division Rule No 26.12.C., the disposal authority granted herein shall terminate one year after the effective date of this order if the operator has not commenced injection operations into the subject well, provided however, the Division, upon written request, mailed by the operator prior to the termination date, may grant an extension thereof for good

cause. One year after disposal into the well has ceased, the authority to dispose will terminate *ipso facto*.

Compliance with this order does not relieve the operator of the obligation to comply with other applicable federal, state or local laws or rules, or to exercise due care for the protection of fresh water, public health and safety and the environment.

Jurisdiction is retained by the Division for the entry of such further orders as may be necessary for the prevention of waste and/or protection of correlative rights or upon failure of the operator to conduct operations (1) to protect fresh or protectable waters or (2) consistent with the requirements in this order, whereupon the Division may, after notice and hearing, terminate the disposal authority granted herein.

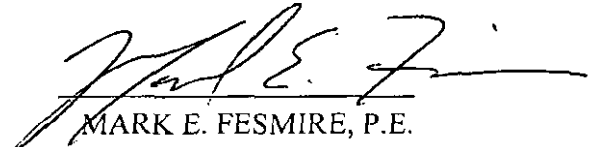
MARK E. FESMIRE, P.E.
Director

MEF/wvjj

cc: Oil Conservation Division – Artesia
State Land Office – Oil, Gas, and Minerals Division

State of New Mexico
Energy, Minerals and Natural Resources Department

Susana Martinez
Governor

David Martin
Cabinet Secretary

Brett F. Woods, Ph.D.
Deputy Cabinet Secretary

David R. Catanach, Division Director
Oil Conservation Division



Notice of Violation (2-01-FY16)

August 13, 2015

Operator
TLT SWD, LLC
P.O. Box 1906
Hobbs, NM 88241

Via Certified Mail Return Receipt No.: 7012-0470-0001-5967-3604

Re: Sweet Pea SWD #001, API No. 30-015-35749

Dear Operator,

Regarding the e-mail from Billy (Bill) E. Prichard of Pueblo West Resources to representatives of the Oil Conservation Division ("OCD") and TLT SWD, LLC ("TLT") subject "LINN Operating: Objection Withdrawal of TLT's C-108 Application" (last reply Tuesday August 4, 2015, 4:25 PM MST), it has come to the OCD's attention that TLT's salt water disposal well Sweet Pea SWD #001, API No. 30-015-35749 ("Sweet Pea" or "subject well") has been operating outside of the conditions set forth in OCD Administrative Order SWD-1140-A ("Order 1140-A") since the reporting month of September of 2013.

Review of the Sweet Pea well file revealed the following information:

1. The authorization to inject was granted on November 24, 2009, pursuant to an application made by the original operator, Reef Exploration, LP. Order 1140-A permitted the Sweet Pea for "disposal of waste water originating only from producing wells operated by the operator of this disposal well[.]"
2. Order 1140-A further conditioned the wellhead injection pressure of the Sweet Pea (at that time named State 2 Well No. 8) to "no more than 920 psi."
3. Based on the record of the current operator, TLT, OCD has identified six (6) active oil wells that would be the source of produced water for injection in the subject well:
 - a. State "2" #1, 1980' FNL & 1980' FEL, Sec 2, T-23S, R 31E, Eddy County, New Mexico, API No. 30-15-35678; last production 4/2014.
 - b. State "2" #2, 660' FNL & 1980' FWL, Sec 2, T-23S, R-31E, Eddy County, New Mexico, API No. 30-15-35674; last production 9/2014.

- c. State "2" #3, 1980' FNL & 1980' FWL, Sec 2, T 23S, R 31E, Eddy County, New Mexico, API No. 30-15-35675; last production 7/2014.
 - d. State "2" #4, 1980' FSL & 1980' FWL, Sec 2, T 23S, R 31E, Eddy County, New Mexico, API No. 30-15-35676; last production 5/2014.
 - e. State "2" #5, 660' FSL & 1980' FWL, Sec 2, T 23S, R 31E, Eddy County, New Mexico, API No. 30-15-35677; last production 10/2014.
 - f. State "2" #9, 660' FSL & 660' FWL, Sec 2, T 23S, R 31E, Eddy County, New Mexico, API No. 30-15-35750; last production 5/2014.
4. Since TLT took over the Sweet Pea on April 1, 2013, the following table shows the annual injection totals to date on the well:

Period of Injection	Injection Volume (bbls)
2013 (Beginning in April with the transfer of ownership)	420,272
2014	1,674,587
2015 (As of the date of this letter)	757,094
Cumulative Total	2,851,953

- 5. Based on production reports since November 2014, the active wells operated by TLT have produced a total of 0 bbls of water, indicating that TLT is out of compliance with the conditions set forth in Order 1140-A. Further review of production is required to determine the full extent of TLT's non-compliance.
- 6. OCD records indicate that the injection pressure has exceeded the allowable 920 psi on five months of reporting data (April 2014 through August 2014).
- 7. An inspection of the well site on 8/6/2015 by an OCD inspector showed the well operating with a surface injection pressure of 1100 psi.

OCD Rule 19.15.5.11 NMAC states, in relevant part, "[a] person who conducts an activity pursuant to a permit, administrative order or other written authorization or approval from the division shall comply with every term, condition and provision of the permit, administrative order, authorization or approval." TLT is currently in violation of OCD Rule 19.15.5.11 NMAC by not complying with the conditions set forth in Order 1140-A.

Immediate action is now required by TLT. You are hereby ordered to cease all violating activities and to return the subject well to compliance with OCD Administrative Order SWD-1140-A and all other relevant OCD rules. If compliance cannot be achieved, the well must be shut-in until compliance can be achieved.

Further, the OCD requires additional information from TLT regarding the operation of the Sweet Pea. OCD requires TLT to provide information regarding the injected fluids including the sources and analytical composition.

August 13, 2015
Page 3

Please contact Daniel Sanchez at (505) 476-3493 Ext 111 within ten (10) days of receipt of this letter to schedule a compliance conference to discuss the outstanding compliance issues.

The goal of the conference will be to negotiate corrective actions for TLT to come into compliance. If you do not respond to this letter, or if we are not able to resolve these issues administratively, the OCD will file an application for hearing seeking an order setting a compliance schedule for TLT.

Sincerely,

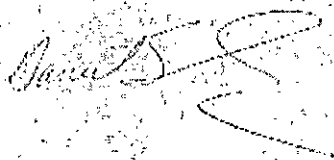

Daniel Sanchez
OCD Compliance and Enforcement Manager, UIC Program Director
Daniel.Sanchez@state.nm.us

EC: Scott Hall, Montgomery and Andrews
Keith Herrmann, ENMRD Assistant General Counsel



Pueblo West Resources
125 Greathouse Village
Decatur, Texas 76234
432-934-7680

RECEIVED OCD

2015 SEP 21 A 3: 22

September 15, 2015

Phillip, Please find enclosed original Affidavit of Publication.

TLT SWD, L.L.C., PO Box 1906, Hobbs, New Mexico 88241 has filed form C-108 (Application for Authorization to Inject) with the New Mexico Oil Conservation Division seeking administrative approval to convert the Sweet Pea SWD#1, API # 30-015-35749, 1980 FSL x 660 FWL, Unit Letter "L", Section 2, T23S, R31E, Eddy County, New Mexico from a lease salt water disposal well to a commercial Bell Canyon, Cherry Canyon salt water disposal well through amendment to NMOCD SWD-1140-A. The disposal interval would be the Bell & Cherry Canyon formation through perforations from 4600 feet - 5880 feet. Disposal fluid would be produced water delivered via pipeline and trucked in from numerous producing wells in the area. Anticipated disposal rate of 2200 BWPD with a maximum disposal rate of 3500 BWPD. Anticipated disposal pressure 1100 psi with a maximum disposal pressure determined by the results of NMOCD approved Step Rate Test. Anticipated maximum pressure of 1400 psi. Well is approximately 20 miles E of Loving, New Mexico.

All interested parties opposing the aforementioned must file objections with the New Mexico Oil Conservation Division, 1220 South St. Francis Drive, Santa Fe, New Mexico 87505 within 15 days. Additional information can be obtained by contacting Billy E. Prichard 432-934-7680

Thanks,

Billy (Bill) E. Prichard
Pueblo West Resources
Agent for TLT SWD, L.L.C.
125 Greathouse Village
Decatur, TX 76234
432-934-7680 cellular



Facebook

email; billy@pwllc.net

www.pwllc.net

Affidavit of Publication

No. 23631

State of New Mexico

County of Eddy:

Danny Scott



being duly sworn says that she is the

Publisher

of the Artesia Daily Press, a daily newspaper of General circulation, published in English at Artesia, said county and state, and that the hereto attached

Legal Notice

was published in a regular and entire issue of the said Artesia Daily Press, a daily newspaper duly qualified for that purpose within the meaning of Chapter 167 of the 1937 Session Laws of the state of New Mexico for 1 Consecutive weeks/day on the same

day as follows:

First Publication September 6, 2015

Second Publication

Third Publication

Fourth Publication

Fifth Publication

Sixth Publication

Subscribed and sworn before me this

9th day of September 2015



OFFICIAL SEAL
Latisha Romine
NOTARY PUBLIC-STATE OF NEW MEXICO

My commission expires: 5/12/2019

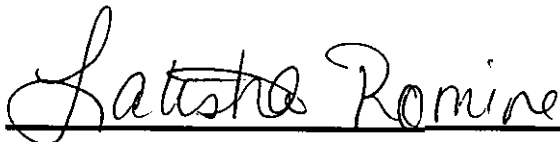

Latisha Romine

Notary Public, Eddy County, New Mexico

Copy of Publication:

LEGAL NOTICE

TLT SWD, L.L.C., PO Box 1906, Hobbs, New Mexico 88241 has filed form C-108 (Application for Authorization to Inject) with the New Mexico Oil Conservation Division seeking administrative approval to convert the Sweet Pea SWD#1, API # 30-015-35749, 1980 FSL x 660 FWL, Unit Letter "L", Section 2, T23S, R31E, Eddy County, New Mexico from a lease salt water disposal well to a commercial Bell Canyon, Cherry Canyon salt water disposal well through amendment to NMOCD SWD-1140-A. The disposal interval would be the Bell & Cherry Canyon formation through perforations from 4600 feet - 5880 feet. Disposal fluid would be produced water delivered via pipeline and trucked in from numerous producing wells in the area.
Anticipated disposal rate of 2200 BWPD with a maximum disposal rate of 3500 BWPD. Anticipated disposal pressure 1100 psi with a maximum disposal pressure determined by the results of NMOCD approved Step Rate Test. Anticipated maximum pressure of 1400 psi. Well is approximately 20 miles E of Loving, New Mexico.

All interested parties opposing the aforementioned must file objections with the New Mexico Oil Conservation Division, 1220 South St. Francis Drive, Santa Fe, New Mexico 87505 within 15 days. Additional information can be obtained by contacting Billy E. Prichard 432-934-7680

Published in the Artesia Daily Press, Artesia, N.M., Sept. 6, 2015 Legal No. 23631.