

District I  
1625 N. French Dr., Hobbs, NM 88240  
District II  
1301 W. Grand Avenue, Artesia, NM 88210  
District III  
1000 Rio Brazos Road, Aztec, NM 87410  
District IV  
1220 S. St. Francis Dr., Santa Fe, NM 87505

State of New Mexico  
Energy Minerals and Natural Resources  
Oil Conservation Division  
1220 South St. Francis Dr.  
Santa Fe, NM 87505

HOBBS OCD

FEB 11 2014

Form C-141  
Revised October 10, 2003

Submit 2 Copies to appropriate  
District Office in accordance  
with Rule 116 on back  
side of form

RECEIVED

Release Notification and Corrective Action

OPERATOR

☐ Initial Report ☒ Final Report

Name of Company Yates Petroleum Corporation	OGRID Number 25575	Contact Chase Settle
Address 104 S. 4 <sup>TH</sup> Street		Telephone No. 575-748-4171
Facility Name Red Raider BKS State #1	API Number 30-025-29141	Facility Type Battery

Surface Owner State	Mineral Owner State	Lease No. VB-0651
------------------------	------------------------	----------------------

LOCATION OF RELEASE

Unit Letter J	Section 25	Township 24S	Range 33E	Feet from the 1980'	North/South Line South	Feet from the 1980'	East/West Line East	County Lea
------------------	---------------	-----------------	--------------	------------------------	---------------------------	------------------------	------------------------	---------------

Latitude 32.18654 Longitude -103.52337

NATURE OF RELEASE

Type of Release Produced Water	Volume of Release 130 B/PW	Volume Recovered 0 B/PW
Source of Release Illegal dumping from unknown company/person.	Date and Hour of Occurrence 01/23/2014; AM	Date and Hour of Discovery 01/23/2014; PM
Was Immediate Notice Given? <input checked="" type="checkbox"/> Yes <input type="checkbox"/> No <input type="checkbox"/> Not Required	If YES, To Whom? Geoffrey Leking	
By Whom? Robert Asher	Date and Hour 01/24/2014; PM	
Was a Watercourse Reached? <input type="checkbox"/> Yes <input checked="" type="checkbox"/> No	If YES, Volume Impacting the Watercourse. N/A	

If a Watercourse was Impacted, Describe Fully.\*  
N/A

Describe Cause of Problem and Remedial Action Taken.\*

An unknown truck illegally dumped a full load of Produced Water off the West side of the battery location.

Describe Area Affected and Cleanup Action Taken.\*

An approximate area of 234' X 56' was affected on the West side of the location, and an area approximately 480' X 15' Southeast of the location. Vertical and horizontal delineation samples will be taken and analysis ran for TPH & BTEX (chlorides for documentation). If initial analytical results for TPH & BTEX are under RRAL's (site ranking is 0) a Final Report, C-141 will be submitted to the OCD requesting closure. If the analytical results are above the RRAL a work plan will be submitted to the OCD. TPH & BTEX analytical results are under RRAL's (site ranking is 0). Depth to Ground Water: >100' (150', Section 25, T24S-R33E, Trend Map), Wellhead Protection Area: No, Distance to Surface Water Body: > 1000', SITE RANKING IS 0. Based on analytical results, depth to groundwater, Yates Petroleum Corporation requests closure.

I hereby certify that the information given above is true and complete to the best of my knowledge and understand that pursuant to NMOC rules and regulations all operators are required to report and/or file certain release notifications and perform corrective actions for releases which may endanger public health or the environment. The acceptance of a C-141 report by the NMOC marked as "Final Report" does not relieve the operator of liability should their operations have failed to adequately investigate and remediate contamination that pose a threat to ground water, surface water, human health or the environment. In addition, NMOC acceptance of a C-141 report does not relieve the operator of responsibility for compliance with any other federal, state, or local laws and/or regulations.

OIL CONSERVATION DIVISION

Signature: 	Approved by District Supervisor:	
Printed Name: Chase Settle	Approval Date:	Expiration Date:
Title: NM Environmental Regulatory Agent	Conditions of Approval:	Attached <input type="checkbox"/>
E-mail Address: csettle@yatespetroleum.com	2RP-	
Date: Tuesday, February 11, 2014 Phone: 575-748-4171		

\* Attach Additional Sheets If Necessary

2/11

DEC 22 2013

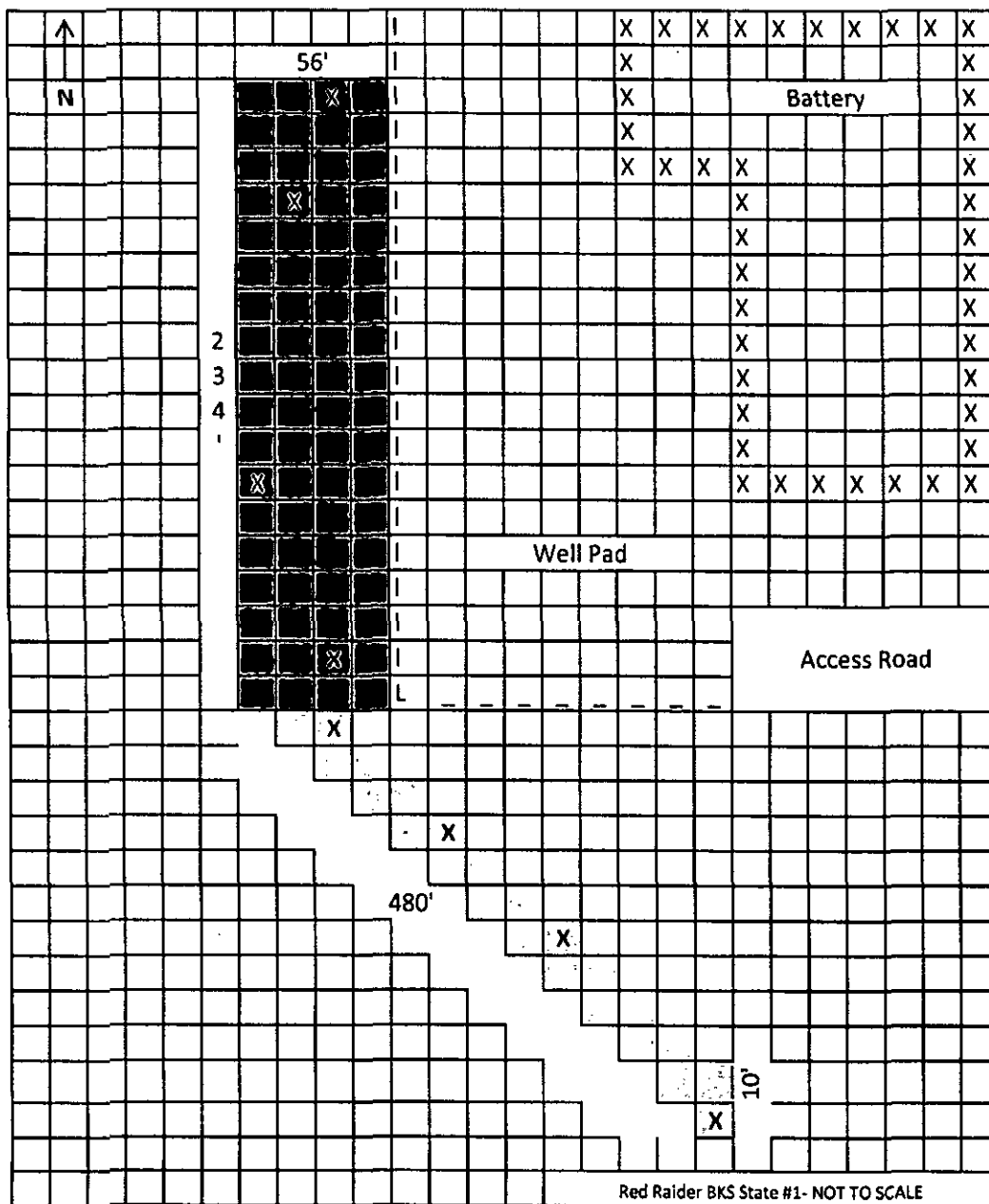

Release Area
  S1 Samples
  Release Area
  S2 Samples

Analytical Report H400295 (Cardinal)	Sample Area	Sample Date	Sample Type	Depth	BTEX	GRO	DRO	Chlorides
S1 1'	Release Area	1/29/2014	Hand Auger	1'	<0.3	<10.0		768
S1 2'	Release Area	1/29/2014	Hand Auger	2'	<0.3	<10.0		128
S1 3'	Release Area	1/29/2014	Hand Auger	3'	<0.3	<10.0		192
S2 1'	Release Area	1/29/2014	Hand Auger	1'	<0.3	<10.0		400
S2 2'	Release Area	1/29/2014	Hand Auger	2'	<0.3	<10.0		336
S2 3'	Release Area	1/29/2014	Hand Auger	3'	<0.3	<10.0		496

Site Ranking is 0. DTGW >100' (approx. 150', Section 25, T24S-R33E, Trend Map). All results ppm, Chloride samples for documentation. Released: 130 B/PW; Recovered: 0 B/PW Date: 1/23/2014



PHONE (575) 393-2326 • 101 E. MARLAND • HOBBS, NM 88240

---

February 07, 2014

CHASE SETTLE

YATES PETROLEUM CORPORATION

105 S 4th Street

Artesia, NM 88210

RE: RED RAIDER BKS STATE #1

Enclosed are the results of analyses for samples received by the laboratory on 01/30/14 11:06.

Cardinal Laboratories is accredited through Texas NELAP under certificate number T104704398-13-5. Accreditation applies to drinking water, non-potable water and solid and chemical materials. All accredited analytes are denoted by an asterisk (\*). For a complete list of accredited analytes and matrices visit the TCEQ website at [www.tceq.texas.gov/field/qa/lab\\_accred\\_certif.html](http://www.tceq.texas.gov/field/qa/lab_accred_certif.html).

Cardinal Laboratories is accredited through the State of Colorado Department of Public Health and Environment for:

Method EPA 552.2	Haloacetic Acids (HAA-5)
Method EPA 524.2	Total Trihalomethanes (TTHM)
Method EPA 524.4	Regulated VOCs (V1, V2, V3)

Accreditation applies to public drinking water matrices.

This report meets NELAP requirements and is made up of a cover page, analytical results, and a copy of the original chain-of-custody. If you have any questions concerning this report, please feel free to contact me.

Sincerely,

Celey D. Keene

Lab Director/Quality Manager

**Analytical Results For:**

 YATES PETROLEUM CORPORATION  
 CHASE SETTLE  
 105 S 4th Street  
 Artesia NM, 88210  
 Fax To: (505) 748-4635

 Received: 01/30/2014  
 Reported: 02/07/2014  
 Project Name: RED RAIDER BKS STATE #1  
 Project Number: NOT GIVEN  
 Project Location: RED RAIDER BKS STATE #1

 Sampling Date: 01/29/2014  
 Sampling Type: Soil  
 Sampling Condition: Cool & Intact  
 Sample Received By: Kathy Perez

**Sample ID: S1 1' (H400295-01)**

BTX 80218			mg/kg		Analyzed By: MS				
Analyte	Result	Reporting Limit	Analyzed	Method Blank	BS	% Recovery	True Value QC	RPD	Qualifier
Benzene*	<0.050	0.050	02/05/2014	ND	2.30	115	2.00	1.86	
Toluene*	<0.050	0.050	02/05/2014	ND	2.23	112	2.00	1.91	
Ethylbenzene*	<0.050	0.050	02/05/2014	ND	2.21	111	2.00	2.01	
Total Xylenes*	<0.150	0.150	02/05/2014	ND	6.38	106	6.00	1.74	
Total BTX	<0.300	0.300	02/05/2014	ND					

Surrogate: 4-Bromofluorobenzene (PIE) 118 % 89.4-126

Chloride, SM4500Cl-B			mg/kg		Analyzed By: AP				
Analyte	Result	Reporting Limit	Analyzed	Method Blank	BS	% Recovery	True Value QC	RPD	Qualifier
Chloride	768	16.0	02/07/2014	ND	400	100	400	3.92	

TPH 8015M			mg/kg		Analyzed By: ms				
Analyte	Result	Reporting Limit	Analyzed	Method Blank	BS	% Recovery	True Value QC	RPD	Qualifier
GRO C6-C10	<10.0	10.0	02/06/2014	ND	205	102	200	8.13	
DRO >C10-C28	63.2	10.0	02/06/2014	ND	197	98.5	200	11.2	

Surrogate: 1-Chlorooctane 93.0 % 65.2-140

Surrogate: 1-Chlorooctadecane 105 % 63.6-154

Cardinal Laboratories

\* = Accredited Analyte

PLEASE NOTE: Liability and Damages. Cardinal's liability and client's exclusive remedy for any claim arising, whether based in contract or tort, shall be limited to the amount paid by client for analytical services. All claims, including those for negligence and any other cause whatsoever shall be deemed waived unless made in writing and received by Cardinal within thirty (30) days after completion of the applicable service. In no event shall Cardinal be liable for incidental or consequential damages, including, without limitation, business interruption, loss of use, or loss of profits incurred by client, its subsidiaries, affiliates or successors arising out of or related to the performance of the services hereunder by Cardinal, regardless of whether such claim is based upon any of the above stated reasons or otherwise. Results relate only to the samples identified above. This report shall not be reproduced except in full with written approval of Cardinal Laboratories.

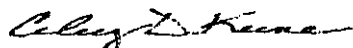

Celey D. Keene, Lab Director/Quality Manager



PHONE (575) 393-2326 • 101 E. MARLAND • HOBBS, NM 88240

**Analytical Results For:**

YATES PETROLEUM CORPORATION  
CHASE SETTLE  
105 S 4th Street  
Artesia NM, 88210  
Fax To: (505) 748-4635

Received: 01/30/2014  
Reported: 02/07/2014  
Project Name: RED RAIDER BKS STATE #1  
Project Number: NOT GIVEN  
Project Location: RED RAIDER BKS STATE #1

Sampling Date: 01/29/2014  
Sampling Type: Soil  
Sampling Condition: Cool & Intact  
Sample Received By: Kathy Perez

**Sample ID: S1 2' (H400295-02)**

BTX 8021B		mg/kg		Analyzed By: MS					
Analyte	Result	Reporting Limit	Analyzed	Method Blank	BS	% Recovery	True Value QC	RPD	Qualifier
Benzene*	<0.050	0.050	02/05/2014	ND	2.30	115	2.00	1.86	
Toluene*	<0.050	0.050	02/05/2014	ND	2.23	112	2.00	1.91	
Ethylbenzene*	<0.050	0.050	02/05/2014	ND	2.21	111	2.00	2.01	
Total Xylenes*	<0.150	0.150	02/05/2014	ND	6.38	106	6.00	1.74	
Total BTX	<0.300	0.300	02/05/2014	ND					

Surrogate: 4-Bromofluorobenzene (PIE) 118 % 89.4-126

Chloride, SM4500Cl-B		mg/kg		Analyzed By: AP					
Analyte	Result	Reporting Limit	Analyzed	Method Blank	BS	% Recovery	True Value QC	RPD	Qualifier
Chloride	128	16.0	02/07/2014	ND	400	100	400	3.92	

TPH 8015M		mg/kg		Analyzed By: ms					
Analyte	Result	Reporting Limit	Analyzed	Method Blank	BS	% Recovery	True Value QC	RPD	Qualifier
GRO C6-C10	<10.0	10.0	02/06/2014	ND	205	102	200	8.13	
DRO >C10-C28	10.8	10.0	02/06/2014	ND	197	98.5	200	11.2	

Surrogate: 1-Chlorooctane 97.6 % 65.2-140

Surrogate: 1-Chlorooctadecane 106 % 63.6-154

Cardinal Laboratories

\* = Accredited Analyte

PLEASE NOTE: Liability and Damages. Cardinal's liability and client's exclusive remedy for any claim arising, whether based in contract or tort, shall be limited to the amount paid by client for analyses. All claims, including those for negligence and any other cause whatsoever shall be deemed waived unless made in writing and received by Cardinal within thirty (30) days after completion of the applicable service. In no event shall Cardinal be liable for incidental or consequential damages, including, without limitation, business interruptions, loss of use, or loss of profits incurred by client, its subsidiaries, affiliates or successors arising out of or related to the performance of the services hereunder by Cardinal, regardless of whether such claim is based upon any of the above stated reasons or otherwise. Results relate only to the samples identified above. This report shall not be reproduced except in full with written approval of Cardinal Laboratories.

Celey D. Keene, Lab Director/Quality Manager

**Analytical Results For:**

 YATES PETROLEUM CORPORATION  
 CHASE SETTLE  
 105 S 4th Street  
 Artesia NM, 88210  
 Fax To: (505) 748-4635

Received:	01/30/2014	Sampling Date:	01/29/2014
Reported:	02/07/2014	Sampling Type:	Soil
Project Name:	RED RAIDER BKS STATE #1	Sampling Condition:	Cool & Intact
Project Number:	NOT GIVEN	Sample Received By:	Kathy Perez
Project Location:	RED RAIDER BKS STATE #1		

**Sample ID: S1 3' (H400295-03)**

BTX 8021B		mg/kg		Analyzed By: MS					
Analyte	Result	Reporting Limit	Analyzed	Method Blank	BS	% Recovery	True Value QC	RPD	Qualifier
Benzene*	<0.050	0.050	02/05/2014	ND	2.30	115	2.00	1.86	
Toluene*	<0.050	0.050	02/05/2014	ND	2.23	112	2.00	1.91	
Ethylbenzene*	<0.050	0.050	02/05/2014	ND	2.21	111	2.00	2.01	
Total Xylenes*	<0.150	0.150	02/05/2014	ND	6.38	106	6.00	1.74	
Total BTX	<0.300	0.300	02/05/2014	ND					

Surrogate: 4-Bromofluorobenzene (PIL) 116 % 89.4-126

Chloride, SM4500Cl-B		mg/kg		Analyzed By: AP					
Analyte	Result	Reporting Limit	Analyzed	Method Blank	BS	% Recovery	True Value QC	RPD	Qualifier
Chloride	192	16.0	02/07/2014	ND	400	100	400	3.92	

TPH 8015M		mg/kg		Analyzed By: ms					
Analyte	Result	Reporting Limit	Analyzed	Method Blank	BS	% Recovery	True Value QC	RPD	Qualifier
GRO C6-C10	<10.0	10.0	02/06/2014	ND	205	102	200	8.13	
DRO >C10-C28	<10.0	10.0	02/06/2014	ND	197	98.5	200	11.2	

Surrogate: 1-Chlorooctane 88.9 % 65.2-140

Surrogate: 1-Chlorooctadecane 95.3 % 63.6-154

Cardinal Laboratories

\* = Accredited Analyte

PLEASE NOTE: Liability and Damages. Cardinal's liability and client's exclusive remedy for any claim arising, whether based in contract or tort, shall be limited to the amount paid by client for analysis. All claims, including those for negligence and any other cause whatsoever shall be deemed waived unless made in writing and received by Cardinal within thirty (30) days after completion of the applicable service. In no event shall Cardinal be liable for incidental or consequential damages, including, without limitation, business interruptions, loss of use, or loss of profits incurred by client, its subsidiaries, affiliates or successors arising out of or related to the performance of the services hereunder by Cardinal, regardless of whether such claim is based upon any of the above stated reasons or otherwise. Results relate only to the samples identified above. This report shall not be reproduced except in full with written approval of Cardinal Laboratories.

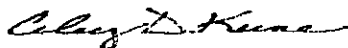

Celey D. Keene, Lab Director/Quality Manager

**Analytical Results For:**

 YATES PETROLEUM CORPORATION  
 CHASE SETTLE  
 105 S 4th Street  
 Artesia NM, 88210  
 Fax To: (505) 748-4635

 Received: 01/30/2014  
 Reported: 02/07/2014  
 Project Name: RED RAIDER BKS STATE #1  
 Project Number: NOT GIVEN  
 Project Location: RED RAIDER BKS STATE #1

 Sampling Date: 01/29/2014  
 Sampling Type: Soil  
 Sampling Condition: Cool & Intact  
 Sample Received By: Kathy Perez

**Sample ID: S2 1' (H400295-04)**

BTEX 8021B		mg/kg		Analyzed By: MS					
Analyte	Result	Reporting Limit	Analyzed	Method Blank	BS	% Recovery	True Value QC	RPD	Qualifier
Benzene*	<0.050	0.050	02/05/2014	ND	2.30	115	2.00	1.86	
Toluene*	<0.050	0.050	02/05/2014	ND	2.23	112	2.00	1.91	
Ethylbenzene*	<0.050	0.050	02/05/2014	ND	2.21	111	2.00	2.01	
Total Xylenes*	<0.150	0.150	02/05/2014	ND	6.38	106	6.00	1.74	
Total BTEX	<0.300	0.300	02/05/2014	ND					

Surrogate: 4-Bromofluorobenzene (PJC) 114 % 89.4-126

Chloride, SM4500Cl-B		mg/kg		Analyzed By: AP					
Analyte	Result	Reporting Limit	Analyzed	Method Blank	BS	% Recovery	True Value QC	RPD	Qualifier
Chloride	400	16.0	02/07/2014	ND	400	100	400	3.92	

TPH 8015M		mg/kg		Analyzed By: ms					
Analyte	Result	Reporting Limit	Analyzed	Method Blank	BS	% Recovery	True Value QC	RPD	Qualifier
GRO C6-C10	<10.0	10.0	02/06/2014	ND	205	102	200	8.13	
DRO >C10-C28	<10.0	10.0	02/06/2014	ND	197	98.5	200	11.2	

Surrogate: 1-Chlorooctane 91.9 % 65.2-140

Surrogate: 1-Chlorooctadecane 95.8 % 63.6-154

Cardinal Laboratories

\* = Accredited Analyte

PLEASE NOTE: Liability and Damages. Cardinal's liability and client's exclusive remedy for any claim arising, whether based in contract or tort, shall be limited to the amount paid by client for analysis. All claims, including those for negligence and any other cause whatsoever shall be deemed waived unless made in writing and received by Cardinal within thirty (30) days after completion of the applicable service. In no event shall Cardinal be liable for incidental or consequential damages, including, without limitation, business interruptions, loss of use, or loss of profits incurred by client, its subsidiaries, affiliates or successors arising out of or related to the performance of the services hereunder by Cardinal, regardless of whether such claim is based upon any of the above stated reasons or otherwise. Results relate only to the samples identified above. This report shall not be reproduced except in full with written approval of Cardinal Laboratories.

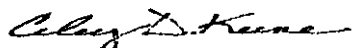

Coley D. Keene, Lab Director/Quality Manager



PHONE (575) 393-2326 • 101 E. MARLAND • HOBBS, NM 88240

**Analytical Results For:**

YATES PETROLEUM CORPORATION  
CHASE SETTLE  
105 S 4th Street  
Artesia NM, 88210  
Fax To: (505) 748-4635

Received: 01/30/2014  
Reported: 02/07/2014  
Project Name: RED RAIDER BKS STATE #1  
Project Number: NOT GIVEN  
Project Location: RED RAIDER BKS STATE #1

Sampling Date: 01/29/2014  
Sampling Type: Soil  
Sampling Condition: Cool & Intact  
Sample Received By: Kathy Perez

**Sample ID: S2 2' (H400295-05)**

BTX 8021B			mg/kg		Analyzed By: MS				
Analyte	Result	Reporting Limit	Analyzed	Method Blank	BS	% Recovery	True Value QC	RPD	Qualifier
Benzene*	<0.050	0.050	02/05/2014	ND	2.30	115	2.00	1.86	
Toluene*	<0.050	0.050	02/05/2014	ND	2.23	112	2.00	1.91	
Ethylbenzene*	<0.050	0.050	02/05/2014	ND	2.21	111	2.00	2.01	
Total Xylenes*	<0.150	0.150	02/05/2014	ND	6.38	106	6.00	1.74	
Total BTX	<0.300	0.300	02/05/2014	ND					

Surrogate: 4-Bromofluorobenzene (PIL) 115 % 89.4-126

Chloride, SM4500Cl-B			mg/kg		Analyzed By: AP				
Analyte	Result	Reporting Limit	Analyzed	Method Blank	BS	% Recovery	True Value QC	RPD	Qualifier
Chloride	336	16.0	02/07/2014	ND	400	100	400	3.92	

TPH 8015M			mg/kg		Analyzed By: ms				
Analyte	Result	Reporting Limit	Analyzed	Method Blank	BS	% Recovery	True Value QC	RPD	Qualifier
GRO C6-C10	<10.0	10.0	02/06/2014	ND	205	102	200	8.13	
DRO >C10-C28	<10.0	10.0	02/06/2014	ND	197	98.5	200	11.2	

Surrogate: 1-Chlorooctane 95.0 % 65.2-140

Surrogate: 1-Chlorooctadecane 98.8 % 63.6-154

Cardinal Laboratories

\*=Accredited Analyte

PLEASE NOTE: Liability and Damages. Cardinal's liability and client's exclusive remedy for any claim arising, whether based in contract or tort, shall be limited to the amount paid by client for analyses. All claims, including those for negligence and any other cause whatsoever shall be deemed waived unless made in writing and received by Cardinal within thirty (30) days after completion of the applicable service. In no event shall Cardinal be liable for incidental or consequential damages, including, without limitation, business interruptions, loss of use, or loss of profits incurred by client, its subsidiaries, affiliates or successors arising out of or related to the performance of the services hereunder by Cardinal, regardless of whether such claim is based upon any of the above stated reasons or otherwise. Results relate only to the samples identified above. This report shall not be reproduced except in full with written approval of Cardinal Laboratories.

Celey D. Keene, Lab Director/Quality Manager

**Analytical Results For:**

YATES PETROLEUM CORPORATION  
 CHASE SETTLE  
 105 S 4th Street  
 Artesia NM, 88210  
 Fax To: (505) 748-4635

Received:	01/30/2014	Sampling Date:	01/29/2014
Reported:	02/07/2014	Sampling Type:	Soil
Project Name:	RED RAIDER BKS STATE #1	Sampling Condition:	Cool & Intact
Project Number:	NOT GIVEN	Sample Received By:	Kathy Perez
Project Location:	RED RAIDER BKS STATE #1		

**Sample ID: S2 3' (H400295-06)**

BTEX 8021B		mg/kg		Analyzed By: MS					
Analyte	Result	Reporting Limit	Analyzed	Method Blank	BS	% Recovery	True Value QC	RPD	Qualifier
Benzene*	<0.050	0.050	02/05/2014	ND	2.30	115	2.00	1.86	
Toluene*	<0.050	0.050	02/05/2014	ND	2.23	112	2.00	1.91	
Ethylbenzene*	<0.050	0.050	02/05/2014	ND	2.21	111	2.00	2.01	
Total Xylenes*	<0.150	0.150	02/05/2014	ND	6.38	106	6.00	1.74	
Total BTEX	<0.300	0.300	02/05/2014	ND					

Surrogate: 4-Bromofluorobenzene (PIL) 114 % 89.4-126

Chloride, SM4500Cl-B		mg/kg		Analyzed By: AP					
Analyte	Result	Reporting Limit	Analyzed	Method Blank	BS	% Recovery	True Value QC	RPD	Qualifier
Chloride	496	16.0	02/05/2014	ND	416	104	400	0.00	

TPH 8015M		mg/kg		Analyzed By: ms					
Analyte	Result	Reporting Limit	Analyzed	Method Blank	BS	% Recovery	True Value QC	RPD	Qualifier
GRO C6-C10	<10.0	10.0	02/06/2014	ND	205	102	200	8.13	
DRO >C10-C28	<10.0	10.0	02/06/2014	ND	197	98.5	200	11.2	

Surrogate: 1-Chlorooctane 98.3 % 65.2-140

Surrogate: 1-Chlorooctadecane 103 % 63.6-154

Cardinal Laboratories

\*=Accredited Analyte

PLEASE NOTE: Liability and Damages. Cardinal's liability and client's exclusive remedy for any claim arising, whether based in contract or tort, shall be limited to the amount paid by client for analyses. All claims, including those for negligence and any other cause whatsoever shall be deemed waived unless made in writing and received by Cardinal within thirty (30) days after completion of the applicable service. In no event shall Cardinal be liable for incidental or consequential damages, including, without limitation, business interruptions, loss of use, or loss of profits incurred by client, its subsidiaries, affiliates or successors arising out of or related to the performance of the services hereunder by Cardinal, regardless of whether such claim is based upon any of the above stated reasons or otherwise. Results relate only to the samples identified above. This report shall not be reproduced except in full with written approval of Cardinal Laboratories.

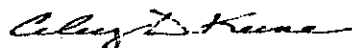

Celey D. Keene, Lab Director/Quality Manager

**Notes and Definitions**

- ND Analyte NOT DETECTED at or above the reporting limit
- RPD Relative Percent Difference
- \*\* Samples not received at proper temperature of 6°C or below.
- \*\*\* Insufficient time to reach temperature.
- Chloride by SM4500Cl-B does not require samples be received at or below 6°C
- Samples reported on an as received basis (wet) unless otherwise noted on report

---

Cardinal Laboratories

\*=Accredited Analyte

PLEASE NOTE: Liability and Damages. Cardinal's liability and client's exclusive remedy for any claim arising, whether based in contract or tort, shall be limited to the amount paid by client for analytes. All claims, including those for negligence and any other cause whatsoever shall be deemed waived unless made in writing and received by Cardinal within thirty (30) days after completion of the applicable service. In no event shall Cardinal be liable for incidental or consequential damages, including, without limitation, business interruptions, loss of time, or loss of profits incurred by client, its subsidiaries, affiliates or successors arising out of or related to the performance of the services hereunder by Cardinal, regardless of whether such claim is based upon any of the above stated reasons or otherwise. Results relate only to the samples identified above. This report shall not be reproduced except in full with written approval of Cardinal Laboratories.

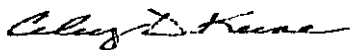

---

Celey D. Keene, Lab Director/Quality Manager

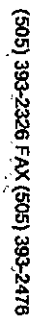

## Page 9 of 9

**NIPDES**

Project Loc: Red Raider BKS State #

**Project Name:**

Red Raider BKS State #

[illegible]