

DATE 12/23/2015	SUSPENSE	ENGINEER MAM	LOGGED IN 12/23/2015	TYPE NSL	APP NO. Pymam1535738977
-----------------	----------	--------------	----------------------	----------	-------------------------

ABOVE THIS LINE FOR DIVISION USE ONLY

NEW MEXICO OIL CONSERVATION DIVISION
 - Engineering Bureau -
 1220 South St. Francis Drive, Santa Fe, NM, 87505



ADMINISTRATIVE APPLICATION CHECKLIST

THIS CHECKLIST IS MANDATORY FOR ALL ADMINISTRATIVE APPLICATIONS FOR EXCEPTIONS TO DIVISION RULES AND REGULATIONS WHICH REQUIRE PROCESSING AT THE DIVISION LEVEL IN SANTA FE

Application Acronyms:

[NSL-Non-Standard Location] [NSP-Non-Standard Proration Unit] [SD-Simultaneous Dedication]
 [DHC-Downhole Commingling] [CTB-Lease Commingling] [PLC-Pool/Lease Commingling]
 [PC-Pool Commingling] [OLS - Off-Lease Storage] [OLM-Off-Lease Measurement]
 [WFX-Waterflood Expansion] [PMX-Pressure Maintenance Expansion]
 [SWD-Salt Water Disposal] [IPI-Injection Pressure Increase]
 [EOR-Qualified Enhanced Oil Recovery Certification] [PPR-Positive Production Response]

[1] TYPE OF APPLICATION - Check Those Which Apply for [A]

- [A] Location - Spacing Unit - Simultaneous Dedication
☒ NSL ☐ NSP ☐ SD

Check One Only for [B] or [C]

- [B] Commingling - Storage - Measurement
☐ DHC ☐ CTB ☐ PLC ☐ PC ☐ OLS ☐ OLM

- [C] Injection - Disposal - Pressure Increase - Enhanced Oil Recovery
☐ WFX ☐ PMX ☐ SWD ☐ IPI ☐ EOR ☐ PPR

- [D] Other: Specify _____

[2] NOTIFICATION REQUIRED TO: - Check Those Which Apply, or ☐ Does Not Apply

- [A] ☐ Working, Royalty or Overriding Royalty Interest Owners
 [B] ☒ Offset Operators, Leaseholders or Surface Owner
 [C] ☐ Application is One Which Requires Published Legal Notice
 [D] ☐ Notification and/or Concurrent Approval by BLM or SLO
U.S. Bureau of Land Management - Commissioner of Public Lands, State Land Office
 [E] ☐ For all of the above, Proof of Notification or Publication is Attached, and/or,
 [F] ☐ Waivers are Attached

[3] SUBMIT ACCURATE AND COMPLETE INFORMATION REQUIRED TO PROCESS THE TYPE OF APPLICATION INDICATED ABOVE.

[4] CERTIFICATION: I hereby certify that the information submitted with this application for administrative approval is **accurate and complete** to the best of my knowledge. I also understand that **no action** will be taken on this application until the required information and notifications are submitted to the Division.

Note: Statement must be completed by an individual with managerial and/or supervisory capacity.

Mayte Reyes
 Print or Type Name

Signature

Regulatory Analyst
 Title

12/23/15
 Date

Eata Fajita State #12H

mreyes1@concho.com
 e-mail Address



December 23, 2015

New Mexico Oil Conservation Division
1220 South Saint Francis Drive
Santa Fe, New Mexico 87505

Attention: Mr. Michael McMillan

Re: Application for Unorthodox Well Location
Eata Fajita State #12H
API No. 30-025-42506
SHL: 174' FSL & 275' FWL (Unit M) Section 8, T24S, R33E
Planned first take point: 330' FSL & 330' FWL Section 8, T24S, R33E
BHL: 230' FNL & 1190' FWL (Unit D) Section 8, T24S, R33E
Planned last take point: 330' FNL & 1189' FWL Section 8, T24S, R33E
Lea County, New Mexico

Dear Mr. McMillan:

Pursuant to Division Rule 19.15.15.13, COG Production LLC (COG) respectfully requests administrative approval of an unorthodox oil well location for its Eata Fajita State #12H well. This well does not meet the 330' from the outer boundary of the producing area requirement. COG Production LLC has drilled and is currently producing Bone Spring wells in this section as described below.

Eata Fajita State #1H	SHL: 190' FSL & 660' FWL	BHL: 360' FNL & 660' FWL
Eata Fajita State #2H	SHL: 420' FSL & 2105' FWL	BHL: 372' FNL & 2056' FWL
Eata Fajita State #3H	SHL: 190' FSL & 2073' FEL	BHL: 348' FNL & 2073' FEL
Eata Fajita State #4H	SHL: 190' FSL & 380' FEL	BHL: 345' FNL & 421' FEL
Eata Fajita State #5H	SHL: 185' FSL & 1315' FEL	BHL: 338' FNL & 1328' FEL
Eata Fajita State #6H	SHL: 195' FSL & 1980' FEL	BHL: 431' FNL & 2278' FEL
Eata Fajita State #9H	SHL: 200' FSL & 900' FEL	BHL: 330' FNL & 1350' FEL
Eata Fajita State #10H	SHL: 200' FSL & 850' FEL	BHL: 431' FNL & 382' FEL

We plan to test infill drilling in the Upper Avalon Shale to enhance hydrocarbon recovery between the existing wellbores.

The affected offset tract is the SESW of Section 5, T24S, R33E, and the NENW of Section 8, T24S, R33E. COG Production LLC is the designated operator of all of Section 8, T24S, R33E.

CORPORATE ADDRESS

One Concho Center | 600 West Illinois Avenue | Midland, Texas 79701
PHONE 432.683.7443 | FAX 432.683.7441

LOCAL ADDRESS

Concho West | 2208 West Main Street | Artesia, New Mexico 88210
PHONE 575.748.6940 | FAX 575.748.6968

Attached is a Form C-102 showing the project area and the producing area of this well.

Thank you for your consideration of this application. Should you have questions or require further information, please contact me at 575-748-6945 or by email at mreyes1@concho.com or Melanie J Wilson at 575-748-6952 or by email at mwilson@concho.com.

Sincerely,

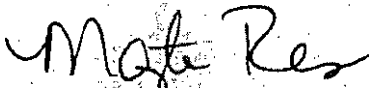
A handwritten signature in black ink, appearing to read "Mayte Reyes". The signature is fluid and cursive, with the first name "Mayte" and last name "Reyes" clearly distinguishable.

Mayte Reyes
Regulatory Analyst

cc: OCD Hobbs

DISTRICT IV
1820 S. ST. FRANCIS DR., SANTA FE, NM 87505
Phone: (505) 476-3460 Fax: (505) 476-3462

Form C-102
Revised August 1, 2011
Submit one copy to appropriate
District Office

☐ AMENDED REPORT

API Number 30-025-42506		Pool Code 96674	Pool Name Triple X; Bone Spring, West
Property Code 39209	Property Name EATA FAJITA STATE		Well Number 12H
OGRID No. 217955	Operator Name COG PRODUCTION, LLC		Elevation 3575.9'

UL or lot No.	Section	Township	Range	Lot Idn	Feet from the	North/South line	Feet from the	East/West line	County
M	8	24-S	33-E		174'	SOUTH	275'	WEST	LEA

UL or lot No.	Section	Township	Range	Lot Idn	Feet from the	North/South line	Feet from the	East/West line	County
D	8	24-S	33-E		230'	NORTH	1190'	WEST	LEA

Dedicated Acres	Joint or Infill	Consolidation Code	Order No.
160			

NO ALLOWABLE WILL BE ASSIGNED TO THIS COMPLETION UNTIL ALL INTERESTS HAVE BEEN CONSOLIDATED
OR A NON-STANDARD UNIT HAS BEEN APPROVED BY THE DIVISION

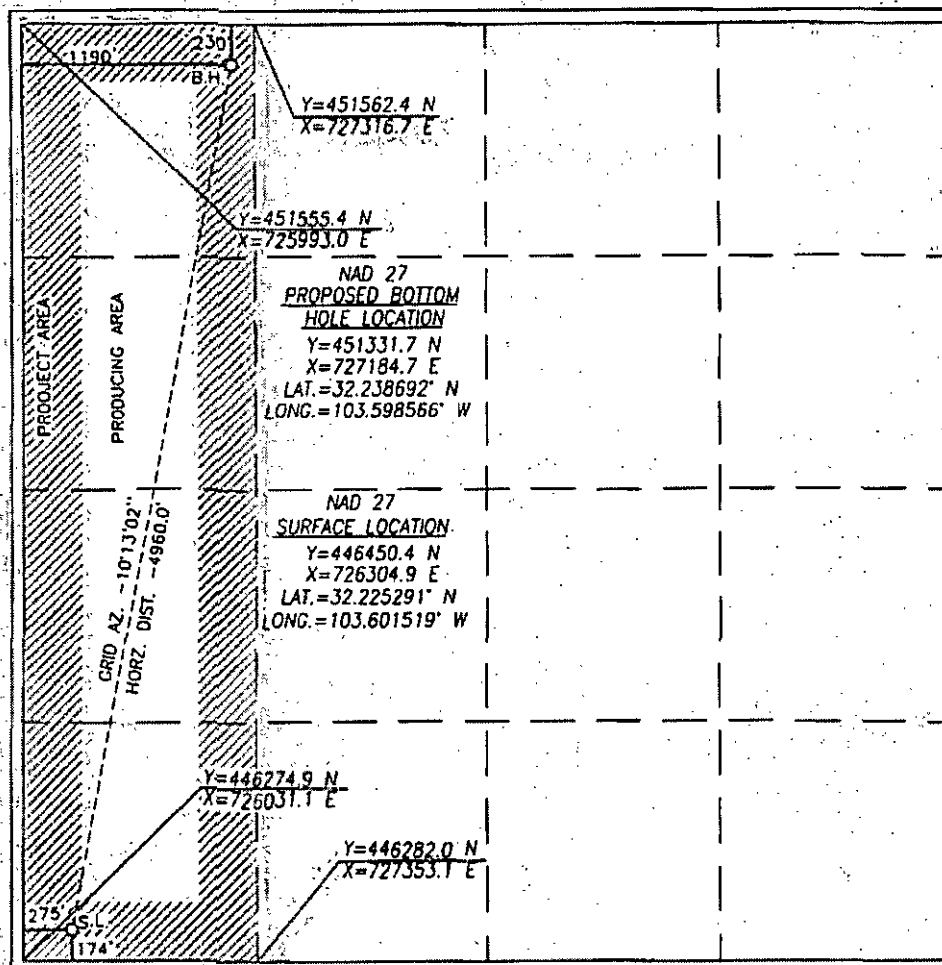

I hereby certify that the information herein is true and complete to the best of my knowledge and belief, and that this organization either has no working interest in the land or mineral interest in the land including the proposed bottom hole location or has no right to drill this well at this location pursuant to a contract with an owner of such mineral or working interest, or to a voluntary pooling agreement or a compulsory pooling order heretofore entered by the division.

Signature Marie Wilson Date 12/23/15

Melanie J Wilson

Printed Name _____

mwilson@concho.com

2-mail Address

I hereby certify that the well location shown on this plat was plotted from field notes of actual surveys made by me or under my supervision, and that the same is true and correct to the best of my belief.

MARCH 2, 2015

Date of Survey

Signature & Seal of Professional Surveyor



Chad Hargrow 3/23/15
Certificate No. CHAD HARGROW 1777
W.O. # 15-154 DRAWN BY: AF



December 23, 2015

Cimarex Energy Co.
600 North Marienfeld Street, Suite 600
Midland, TX 79701

Re: Application for Unorthodox Well Location
Eata Fajita State #12H
API No. 30-025-42506
SHL: 174' FSL & 275' FWL (Unit M) Section 8, T24S, R33E
Planned first take point: 330' FSL & 330' FWL Section 8, T24S, R33E
BHL: 230' FNL & 1190' FWL (Unit D) Section 8, T24S, R33E
Planned last take point: 330' FNL & 1189' FWL Section 8, T24S, R33E
Lea County, New Mexico

Gentlemen:

Attached is a copy of COG's Application for Unorthodox Well Location for the Eata Fajita State #12H well in Section 8, Township 24 South, Range 33 East, Lea County, New Mexico. You are being sent a copy of this Application because the affected offset tract is the SESW of Section 5, T24S, R33E, of which you are the operator. If you have any objection to this Application, notification should be given to OCD within 20 days of receipt of this letter.

If you have any questions regarding this Application, please contact me at 575-748-6945 or Melanie Wilson at 575-748-6952.

Sincerely,

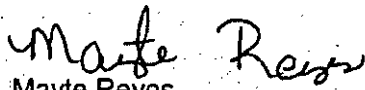
Mayte Reyes
Regulatory Analyst

Enclosure

CERTIFIED MAIL



2208 W. Main Street Artesia, New Mexico 88210

7011 1570 0000 7781 4520

Cimarex Energy Co.
600 North Marienfeld Street, Suite 600
Midland, TX 79701

PLACE STICKER AT TOP OF ENVELOPE TO THE RIGHT
(ON THE RETURN ADDRESS SIDE IF A DOTTED LINE)

SENDER: COMPLETE THIS SECTION

- Complete items 1, 2, and 3. Also complete item 4 if Restricted Delivery is desired.
- Print your name and address on the reverse so that we can return the card to you.
- Attach this card to the back of the mailpiece, or on the front if space permits.

1. Article Addressed to:

Cimarex Energy Co.
600 North Marienfeld Street, Suite 600
Midland, TX 79701

COMPLETE THIS SECTION ON DELIVERY

A. Signature

X

☐ Agent

☐ Addressee

B. Received by (Printed Name)

C. Date of Delivery

D. Is delivery address different from item 1?

☐ Yes

If YES, enter delivery address below:

☐ No

3. Service Type

☒ Certified Mail®

☐ Priority Mail Express®

☐ Registered

☐ Return Receipt for Merchandise

☐ Insured Mail

☐ Collect on Delivery

4. Restricted Delivery? (Extra Fee)

☐ Yes

2. Article Number

(Transfer from service label)

7011 1570 0000 7781 4520

PS Form 3811, July 2013

Domestic Return Receipt