



AE Order Number Banner

Report Description

This report shows an AE Order Number in Barcode format for purposes of scanning. The Barcode format is Code 39.



App Number: pKJ1603954223

1RP - 4172

APACHE CORP

District I
1625 N. French Dr., Hobbs, NM 88240
District II
811 S. First St., Artesia, NM 88210
District III
1000 Rio Brazos Road, Aztec, NM 87410
District IV
1220 S. St. Francis Dr., Santa Fe, NM 87505

State of New Mexico
Energy Minerals and Natural Resources
Oil Conservation Division
1220 South St. Francis Dr.
Santa Fe, NM 87505

HOBBS OCD

Form C-141
Revised August 8, 2011

MAR 13 2014
Submit 1 Copy to appropriate District Office in
accordance with 19.15.29 NMAC.

RECEIVED

Release Notification and Corrective Action

OPERATOR

☒ Initial Report ☒ Final Report

Name of Company Apache Corporation	Contact Bruce Baker
Address 8 Ellison Lane Eunice, NM	Telephone No. 432-631-6982
Facility Name NMGSAU 1815	Facility Type Injection Well

Surface Owner Byrd	Mineral Owner	API No. 30-025-04156
--------------------	---------------	----------------------

LOCATION OF RELEASE

Unit Letter SW/NE	Section 2	Township 20S	Range 36E	Feet from the	North/South Line	Feet from the	East/West Line	County Lea
----------------------	--------------	-----------------	--------------	---------------	------------------	---------------	----------------	---------------

Latitude _____ Longitude _____

NATURE OF RELEASE

Type of Release Produced water	Volume of Release Unknown	Volume Recovered 130 barrels
Source of Release Fiber glass injection line	Date and Hour of Occurrence	Date and Hour of Discovery
Was Immediate Notice Given? <input checked="" type="checkbox"/> Yes <input type="checkbox"/> No <input type="checkbox"/> Not Required	If YES, To Whom? Geoffrey Leking	
By Whom? Bruce Baker	Date and Hour 2-27-14 at 7:40 a.m.	
Was a Watercourse Reached? <input type="checkbox"/> Yes <input checked="" type="checkbox"/> No	If YES, Volume Impacting the Watercourse.	

If a Watercourse was Impacted, Describe Fully.*

Describe Cause of Problem and Remedial Action Taken.*

A contractor for another company was ditching and struck the fiberglass line. The line was shut in and flanged.

Describe Area Affected and Cleanup Action Taken.*

The majority of the release was contained to the ditch line and a small area of spray in the pasture. A vacuum truck was dispatched to pick up fluid. The wet area was excavated to 14.5 feet below ground surface. A vertical was excavated to 20 feet below ground surface in the east side of ditch line. Samples were collected in one foot intervals and were sent to a commercial laboratory for analysis. A composite sample was taken of the bottom at 14.5 feet and was sent to a commercial laboratory for analysis. The laboratory results confirmed a chloride value of less than 250 ppm at 19 feet. The bottom composite at 14.5 feet was 256 chloride and <10 total TPH. A one foot clay barrier was installed at 14.5 feet west of the vertical and site was backfilled to pipeline depth. All excavated soil was placed on plastic and will be hauled to an NMOC approved facility.

I hereby certify that the information given above is true and complete to the best of my knowledge and understand that pursuant to NMOC rules and regulations all operators are required to report and/or file certain release notifications and perform corrective actions for releases which may endanger public health or the environment. The acceptance of a C-141 report by the NMOC marked as "Final Report" does not relieve the operator of liability should their operations have failed to adequately investigate and remediate contamination that pose a threat to ground water, surface water, human health or the environment. In addition, NMOC acceptance of a C-141 report does not relieve the operator of responsibility for compliance with any other federal, state, or local laws and/or regulations.

OIL CONSERVATION DIVISION

Signature: Bruce Baker	APPROVED 2/8/16 188 4172
Printed Name: Bruce Baker	
Title: Environmental Technician	
E-mail Address: larry.baker@apachecorp.com	
Date: 3/13/2014 Phone: (432) 631-6982	

OCD/RECS Meeting

AGENDA/NOTES

September 11, 2013

Hobbs, NM

9:00 am

A. Part 29

1. Apache Bunin #006 API No. 3002539547 July 2nd, 2013.

2. Apache NEDU #220 API No. 3003506358 March 18th, 2011.

3. Apache NEDU Satellite #2 API No. 3002506461 February 15th, 2012.

4. Apache Lockhart B-13A API No. 3002506555.

5. Apache H Corrigan Battery AD

Notes

This image shows a single sheet of white paper with horizontal blue or grey ruling lines. The lines are evenly spaced and run across the width of the page. There are no margins, text, or other markings on the paper.

Leking, Geoffrey R, EMNRD

From: Sarah Edwards <sedwards@rice-ecs.com>
Sent: Friday, September 06, 2013 4:43 PM
To: Leking, Geoffrey R, EMNRD
Cc: 'Hack Conder'; 'Lara Weinheimer'; larry.baker@apachecorp.com
Attachments: Initial C-141 delivered to NMOCD 5.28.13.pdf

Mr. Leking,

Here is the Apache agenda for Wednesdays meeting.

- 1) Bunin #006 API No. 3002539547 July 2nd, 2013
- 2) NEDU #220 API No. 3003506358 March 18th, 2011
- 3) NEDU Satellite #2 API No. 3002506461 February 15th, 2012
- 4) Lockhart B-13A API No. 3002506555
- 5) H. Corrigan Battery

If you have any questions, please feel free to contact me.

Thank you,
Sarah Edwards

HOBBS OCD

SEP 06 2013

RECEIVED

9/6

Soil Laboratory Analytical Results Summary
MLMU #265

		Sample	SP1 @ Surface	SP1 @ 3'	SP1 @ 6'	SP1 @ 9'	SP2 @ Surface	SP2 @ 3'
Analyte	Method	Date	1/15/09	1/15/09	1/16/09	1/16/09	1/15/09	1/15/09
			mg/Kg	mg/Kg	mg/Kg	mg/Kg	mg/Kg	mg/Kg
Benzene	S 8021B		1.38	<0.050	<0.050	<0.050	2.15	<0.050
Toluene	S 8021B		44.5	<0.050	<0.050	<0.050	86.6	<0.050
Ethylbenzene	S 8021B		85.1	<0.050	<0.050	<0.050	169	<0.050
Total Xylenes	S 8021B		144	<0.300	<0.300	<0.300	296	<0.300
Chloride	EPA 300.0		544	976	768	1380	64	1180
GRO	S 8015B		4600	<10.0	<10.0	<10.0	7840	<10.0
DRO	Mod. 8015B		10900	22.7	27.6	29.8	17300	31.3

		Sample	SP2 @ 6'	SP2 @ 9'	SP2 @ 10.5'	SP3 @ Surface	SP3 @ 3'	SP3 @ 6'
Analyte	Method	Date	1/16/09	1/16/09	1/16/09	1/15/09	1/15/09	1/16/09
			mg/Kg	mg/Kg	mg/Kg	mg/Kg	mg/Kg	mg/Kg
Benzene	S 8021B		<0.050	<0.050	<0.050	0.164	<0.050	<0.050
Toluene	S 8021B		<0.050	<0.050	0.074	10.6	<0.050	<0.050
Ethylbenzene	S 8021B		<0.050	<0.050	0.205	37.0	0.089	<0.050
Total Xylenes	S 8021B		<0.300	<0.300	0.520	72.7	<0.300	<0.300
Chloride	EPA 300.0		432	320	176	480	1220	80
GRO	S 8015B		<10.0	<10.0	27.9	8600	<10.0	<10.0
DRO	Mod. 8015B		19.4	30.8	720	2410	34.3	93.3

		Sample	SP3 @ 7.5'	SP4 @ Surface	SP4 @ 3'	SP4 @ 6'	SP4 @ 9'
Analyte	Method	Date	1/16/09	1/15/09	1/15/09	1/16/09	1/16/09
			mg/Kg	mg/Kg	mg/Kg	mg/Kg	mg/Kg
Benzene	S 8021B		<0.050	0.513	<0.050	<0.050	<0.050
Toluene	S 8021B		0.211	28.8	<0.050	<0.050	<0.050
Ethylbenzene	S 8021B		0.636	66.2	<0.050	<0.050	<0.050
Total Xylenes	S 8021B		1.34	120	<0.300	<0.300	<0.300
Chloride	EPA 300.0		192	48	1100	592	480
GRO	S 8015B		33.0	5340	<10.0	<10.0	<10.0
DRO	Mod. 8015B		935	10000	<10.0	<10.0	<10.0

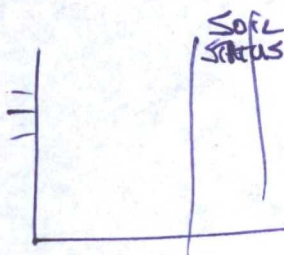

500 PPM

DELINATE
EXCAVATE TO CLEAN +1
@ SP1

EXCAVATE TO 6' @
SP2

EXCAVATE TO 6' @
SP3

EXCAVATE TO 6' @
SP4

Oxy / MLMU # 265

1-15-09

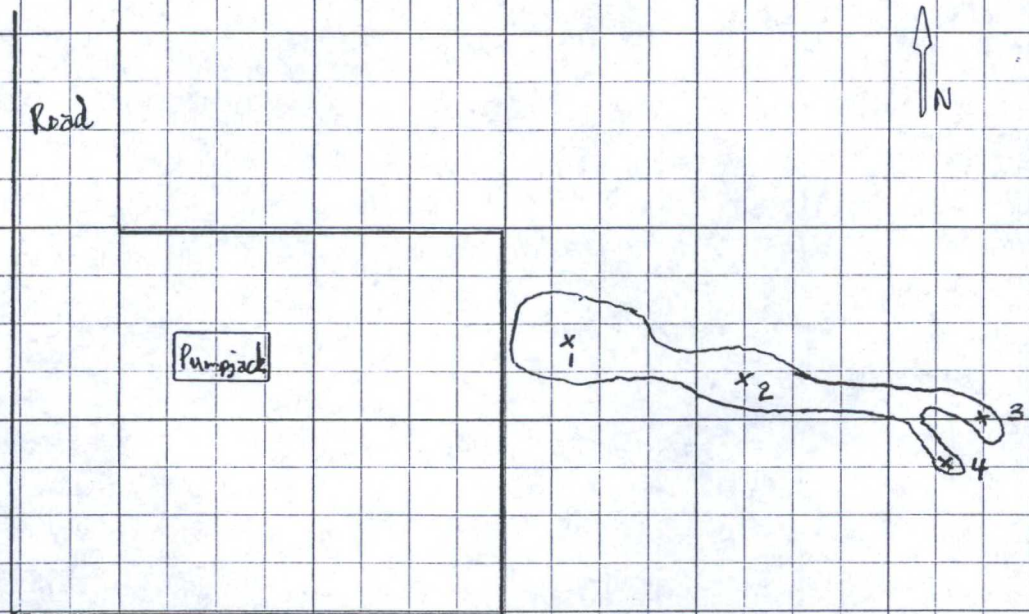

Leking, Geoffrey R, EMNRD

APR 20 2012

From: Bruce Baker [bbaker@rice-ecs.com]
Sent: Friday, April 20, 2012 9:19 AM
To: Leking, Geoffrey R, EMNRD
Cc: 'Gladden, Natalie'; hconder@rice-ecs.com
Subject: Apache SE Lusk 34 Federal #006
Attachments: Apache Southeast Lusk 34 Federal #6 AD - SOUTHEAST AREA - PROPOSED LINER.jpg

RECEIVED

Mr. Leking,

On April 19, 2012 we discussed remediation actions at the Apache SE Lusk 34 Federal #006. The south-west discharge area will be excavated to 3 ft. below ground surface. The center discharge area will be excavated to 1 ft. below ground surface. The south-east discharge area will be excavated to 4.5 ft. below ground surface and place a 20 mil reinforced poly liner at 4 ft. to encompass vertical 3 and vertical 6 (see attachment). The remaining discharge area will be excavated to 2 ft. below ground surface. All excavated soils will be disposed of at an NMOCD approved facility. The excavated area will be backfilled with clean imported soil to facilitate vegetative growth. RECS appreciates the opportunity to work with you on this project. Please call me if you have any questions or wish to discuss the site.

Bruce Baker
Head Foreman
Phone: (575) 393-4411
Cell: (575) 631-5157

SOUTHEAST AREA - PROPOSED LINER

HOBBS OCD

APR 20 2012

RECEIVED

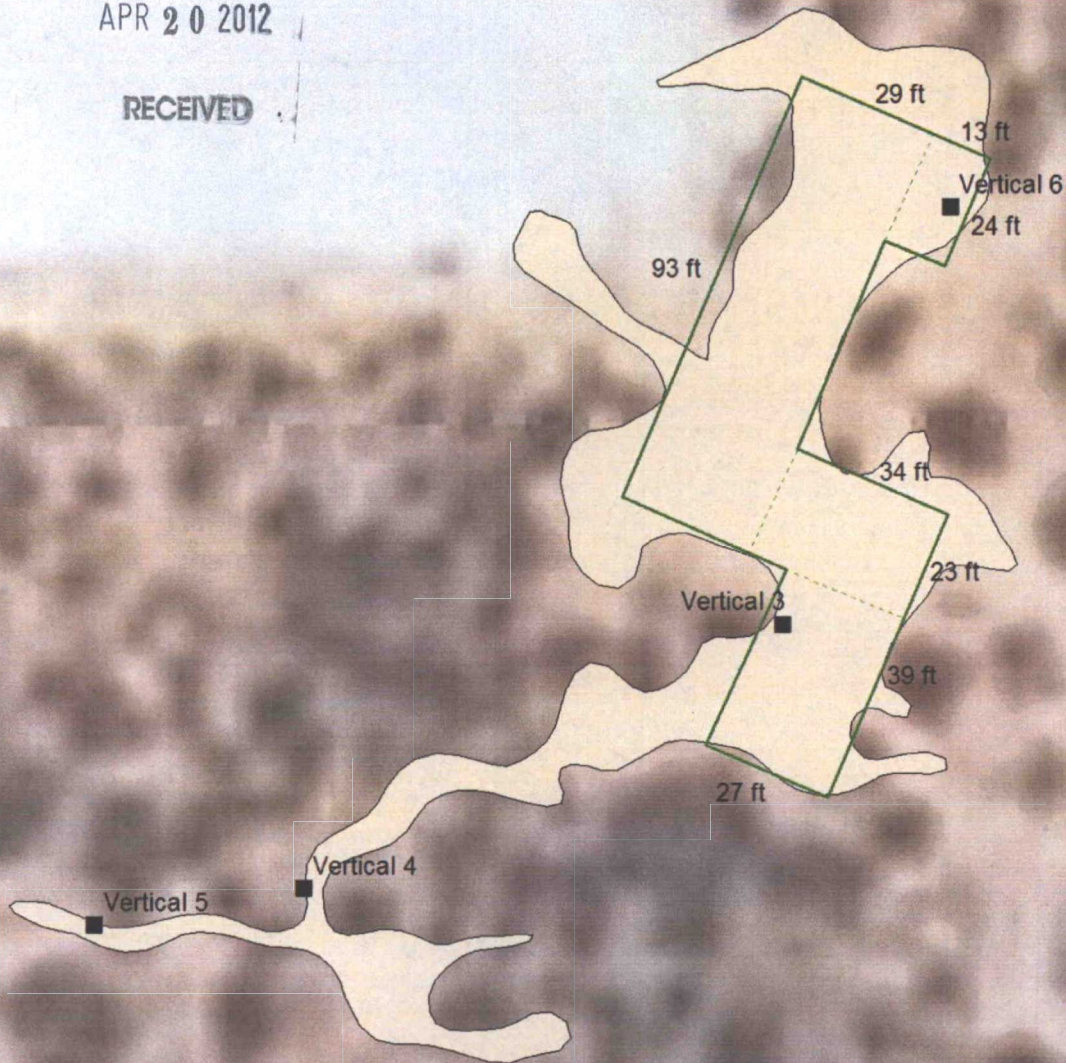

Legend

- VERTICALS
- PROPOSED LINER @ 4 ft (4,870 sq ft)
- STAIN SOUTHEAST AREA

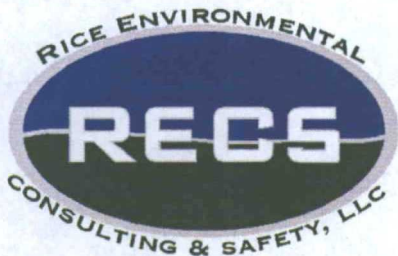

APACHE SE LUSK 34 FEDERAL #6 AD

4/17/12

LEGALS: UL/A sec. 34

T-19-S R-32-E

LEA COUNTY, NM

DGW = NO GROUNDWATER

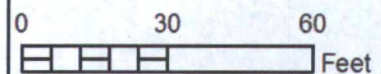

GPS date: 4/11/12 DH
Drawing date: 4/18/12
Drafted by: L. Weinheimer