

DATE IN 4/15/16	SUSPENSE	ENGINEER LRL	LOGGED IN 4/15/16	TYPE NSL	PMAM 1611258875
-----------------	----------	--------------	-------------------	----------	-----------------

ABOVE THIS LINE FOR DIVISION USE ONLY

NEW MEXICO OIL CONSERVATION DIVISION

- Engineering Bureau -

1220 South St. Francis Drive, Santa Fe, NM 87505



R-04/15/16

ADMINISTRATIVE APPLICATION CHECKLIST

THIS CHECKLIST IS MANDATORY FOR ALL ADMINISTRATIVE APPLICATIONS FOR EXCEPTIONS TO DIVISION RULES AND REGULATIONS WHICH REQUIRE PROCESSING AT THE DIVISION LEVEL IN SANTA FE

Application Acronyms:

[NSL-Non-Standard Location] [NSP-Non-Standard Proration Unit] [SD-Simultaneous Dedication]
 [DHC-Downhole Commingling] [CTB-Lease Commingling] [PLC-Pool/Lease Commingling]
 [PC-Pool Commingling] [OLS - Off-Lease Storage] [OLM-Off-Lease Measurement]
 [WFX-Waterflood Expansion] [PMX-Pressure Maintenance Expansion]
 [SWD-Salt Water Disposal] [IPI-Injection Pressure Increase]
 [EOR-Qualified Enhanced Oil Recovery Certification] [PPR-Positive Production Response]

NSL-7409

[1] TYPE OF APPLICATION - Check Those Which Apply for [A]

[A] Location - Spacing Unit - Simultaneous Dedication
☒ NSL ☐ NSP ☐ SD

Matador Prod. Co. (#228937)
 WELL: Janie Connor 13-245-28E
 RB #221H

Check One Only for [B] or [C]

[B] Commingling - Storage - Measurement

☐ DHC ☐ CTB ☐ PLC ☐ PC ☐ OLS ☐ OLM

POOL: NORTHWEST PIERCE CROSSING-
 WOLF CAMP GAS POOL
 (#96712)

[C] Injection - Disposal - Pressure Increase - Enhanced Oil Recovery

☐ WFX ☐ PMX ☐ SWD ☐ IPI ☐ EOR ☐ PPR

API# 30-015-PENDING

[D] Other: Specify _____

[2] NOTIFICATION REQUIRED TO: - Check Those Which Apply, or ☐ Does Not Apply

[A] ☐ Working, Royalty or Overriding Royalty Interest Owners

[B] ☒ Offset Operators, Leaseholders or Surface Owner

[C] ☐ Application is One Which Requires Published Legal Notice

[D] ☐ Notification and/or Concurrent Approval by BLM or SLO
 U.S. Bureau of Land Management - Commissioner of Public Lands, State Land Office

[E] ☐ For all of the above, Proof of Notification or Publication is Attached, and/or,

[F] ☐ Waivers are Attached

[3] SUBMIT ACCURATE AND COMPLETE INFORMATION REQUIRED TO PROCESS THE TYPE OF APPLICATION INDICATED ABOVE.

[4] CERTIFICATION: I hereby certify that the information submitted with this application for administrative approval is accurate and complete to the best of my knowledge. I also understand that no action will be taken on this application until the required information and notifications are submitted to the Division.

Note: Statement must be completed by an individual with managerial and/or supervisory capacity.

Jennifer L. Bradfute
 Print or Type Name

Signature

Attorney
 Title

4/15/2016
 Date

jlb@modrall.com
 e-mail Address



MODRALL SPERLING

L A W Y E R S

April 15, 2016

VIA CERTIFIED MAIL
RETURN RECEIPT REQUESTED

Zoe E. Lees
505.848.1859
Fax: 505.848.9710
Zoe.lees@modrall.com

TO AFFECTED PARTIES

Re: Application of Matador Production Company for administrative approval of unorthodox well location for its Janie Conner 13-24S-28E RB #221H well located in the N/2 of Section 13, Township 24 South, Range 28 East, N.M.P.M., Eddy County, New Mexico.

Ladies and Gentlemen:

Enclosed in this notice is a copy of the above referenced application filed with the New Mexico Conservation Division on this date. Any objections that you have to this application must be filed in writing with the New Mexico Oil Conservation Division, 1220 South St. Francis Drive, Santa Fe, New Mexico 87505, within twenty (20) days from the date the Division receives the above referenced application. If no objections are received within twenty days, this application may be administratively approved by the Division.

If you have any questions concerning this application, please contact:

Trey Goodwin, RPL
Matador Production Company
5400 LBJ Freeway, Suite 1500
Dallas, TX 75240
Phone: 972-371-5430

If you have no objection to this application, please sign the waiver as indicated below and return the original. Your assistance and cooperation in this matter are appreciated.

Sincerely,

Zoe E. Lees
*Attorney for Matador Production
Company*

Modrall Sperling
Roehl Harris & Sisk P.A.

Bank of America Centre
500 Fourth Street NW
Suite 1000
Albuquerque,
New Mexico 87102

PO Box 2168
Albuquerque,
New Mexico 87103-2168

Tel: 505.848.1800
www.modrall.com

WAIVER

_____ hereby waives objection to the above referenced Application for Unorthodox Location for the Janie Conner 13-24S-28E RB #221H well, underlying the N/2 of Section 13, Township 24S, Range, 28E, Eddy County, New Mexico.

Dated: _____

Signature



MODRALL SPERLING

L A W Y E R S

April 15, 2016

David Catanach
Oil Conservation Division
New Mexico Department of Energy,
Minerals and Natural Resources
1220 South Saint Francis Drive
Santa Fe, New Mexico 87505

Zoe E. Lees
505.848.1859
Fax: 505.848.9710
Zoe.lees@modrall.com

Re: Application of Matador Production Company for administrative approval of unorthodox well location for its Janie Conner 13-24S-28E RB #221H well located in the N/2 of Section 13, Township 24 South, Range 28 East, N.M.P.M., Eddy County, New Mexico.

Dear Mr. Catanach:

Matador Production Company (OGRID No. 228937) seeks administrative approval of an unorthodox well location for its Janie Conner 13-24S-28E RB #221H well (API No. forthcoming) to be completed within the Northwest Pierce Crossing-Wolfcamp Gas Pool (Pool Code 96712) underlying the N/2 of Section 13, Township 24S, Range, 28E, Eddy County, New Mexico. Attached as **Exhibit A** is C-102 for the well. This is a horizontal well that will be drilled as follows:

Janie Conner 13-24S-28E RB #221H

- Surface Hole Location: 379 feet from the North line and 330 feet from the East line of Section 14, Township 24 South, Range 28 East;
- First Perforation Point: 330 feet from the North line and 330 feet from the West line of Section 13, Township 24 South, Range 28 East;
- Last Perforation Point: 330 feet from the North line and 330 feet from the East line of Section 13; and
- Bottom Hole Location: 330 feet from the North line and 240 feet from the East line of Section 13.

Matador Production Company is requesting this NSL in order to efficiently produce its interests in Section 13. This well is producing from the Northwest Pierce Crossing-Wolfcamp Gas Pool (Pool Code 96712). There are

Modrall Sperling
Roehl Harris & Sisk P.A.

Bank of America Centre
500 Fourth Street NW
Suite 1000
Albuquerque,
New Mexico 87102

PO Box 2168
Albuquerque,
New Mexico 87103-2168

Tel: 505.848.1800
www.modrall.com

no special pool rules for this pool, and thus the setback requirements under Rule 19.15.15.10(B) of 660' apply. As a result, the completed interval for this well is closer than 660' from the boundary of the project area. The unorthodox location will encroach towards the S/2 and the NE/4 of Section 11, Section 12, the N/2 and SE/4 of Section 14, the S/2 and the NW/4 of Section 7, Township 24 South, Range 29 East, and the N/2 and SW/4 of Section 18, Township 24 South, Range 29 East. **Exhibit B** is map showing the surrounding ownership and the project area for the proposed Janie Conner 13-24S-28E RB #221H well in relation to adjoining units.

Exhibit C is a list of the parties affected by the encroachment. Each of these parties have been provided notice of this application by certified mail, return receipt requested, advising them that if they have any objection to this well, it must be filed with the New Mexico Oil Conservation Division within 20 days of the mailing of this notice. In addition, a copy of this application has also been provided to the New Mexico State Land Office.

Your attention to this matter is appreciated.

Sincerely,

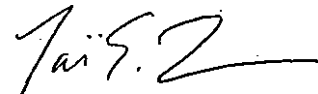
A handwritten signature in black ink, appearing to read "Zoë E. Lees", with a long horizontal flourish extending to the right.

Zoë E. Lees

*Attorney for Matador Production
Company*

c: New Mexico State Land Office
Post Office Box 1148
Santa Fe, New Mexico 87504

District I
1625 N. French Dr., Hobbs, NM 88240
Phone: (575) 393-6161 Fax: (575) 393-0720
District II
811 S. First St., Artesia, NM 88210
Phone: (575) 748-1283 Fax: (575) 748-9720
District III
1000 Rio Brazos Road, Aztec, NM 87410
Phone: (505) 334-6178 Fax: (505) 334-6170
District IV
1220 S. St. Francis Dr., Santa Fe, NM 87505
Phone: (505) 476-3460 Fax: (505) 476-3462

State of New Mexico
Energy, Minerals & Natural Resources
Department
OIL CONSERVATION DIVISION
1220 South St. Francis Dr.
Santa Fe, NM 87505

FORM C-102
Revised August 1, 2011
Submit one copy to appropriate
District Office

☐ AMENDED REPORT

WELL LOCATION AND ACREAGE DEDICATION PLAT

¹ API Number		² Pool Code		³ Pool Name	
⁴ Property Code		⁵ Property Name JANIE CONNER 13-24S-28E RB			⁶ Well Number #221H
⁷ GRID No.		⁸ Operator Name MATADOR PRODUCTION COMPANY			⁹ Elevation 2976'

¹⁰ Surface Location									
UL or lot no.	Section	Township	Range	Lot Idn	Feet from the	North/South line	Feet from the	East/West line	County
A	14	24-S	28-E	-	379'	NORTH	330'	EAST	EDDY

UL or lot no.	Section	Township	Range	Lot Idn	Feet from the	North/South line	Feet from the	East/West line	County
A	13	24-S	28-E	-	330'	NORTH	240'	EAST	EDDY

¹¹ Dedicated Acres 320	¹² Joint or Infill	¹³ Consolidation Code	¹⁴ Order No.
--------------------------------------	-------------------------------	----------------------------------	-------------------------

No allowable will be assigned to this completion until all interests have been consolidated or a non-standard unit has been approved by the division.

				<p>¹⁷OPERATOR CERTIFICATION</p> <p>I hereby certify that the information contained herein is true and complete to the best of my knowledge and belief, and that this organization either owns a working interest or unleased mineral interest in the land including the proposed bottom hole location or has a right to drill this well at this location pursuant to a contract with an owner of such a mineral or working interest, or is a voluntary pooling agreement or a compulsory pooling order heretofore entered by the division.</p> <p>Signature _____ Date _____</p> <p>Printed Name _____</p> <p>E-mail Address _____</p>	
<p>¹⁸SURVEYOR CERTIFICATION</p> <p>I hereby certify that the well location shown on this plat was plotted from field notes of actual surveys made by me or under my supervision, and that the same is true to the best of my belief.</p>				<p>Date of Survey 04/14/2016</p> <p>Signature of Professional Surveyor </p> <p>Certificate Number _____</p>	
<p>SURFACE LOCATION NEW MEXICO EAST NAD 1927 X=587605 Y=445277 LAT.: N 32.2238661 LONG.: W 104.0500431 NAD 1983 X=628788 Y=445336 LAT.: N 32.2239881 LONG.: W 104.0505344</p>	<p>FIRST PERFORATION POINT NEW MEXICO EAST NAD 1927 X=588264 Y=445320 LAT.: N 32.2239793 LONG.: W 104.0479106 NAD 1983 X=629448 Y=445379 LAT.: N 32.2241013 LONG.: W 104.0484019</p>	<p>LAST PERFORATION POINT NEW MEXICO EAST NAD 1927 X=592924 Y=445336 LAT.: N 32.2239895 LONG.: W 104.0328407 NAD 1983 X=634108 Y=445395 LAT.: N 32.2241117 LONG.: W 104.0333313</p>	<p>BOTTOM HOLE LOCATION NEW MEXICO EAST NAD 1927 X=593014 Y=445337 LAT.: N 32.2239897 LONG.: W 104.0325497 NAD 1983 X=634198 Y=445396 LAT.: N 32.2241119 LONG.: W 104.0330403</p>		

Exhibit A

S:\SURVEY\MATADOR_RESOURCES\JANIE CONNER_13-24S-28E_RB_221H\FINAL_PRODUCTS\JANIE CONNER_13-24S-28E_RB_221H_REV1.DWG 4/15/2016 2:59:49 PM ccaston

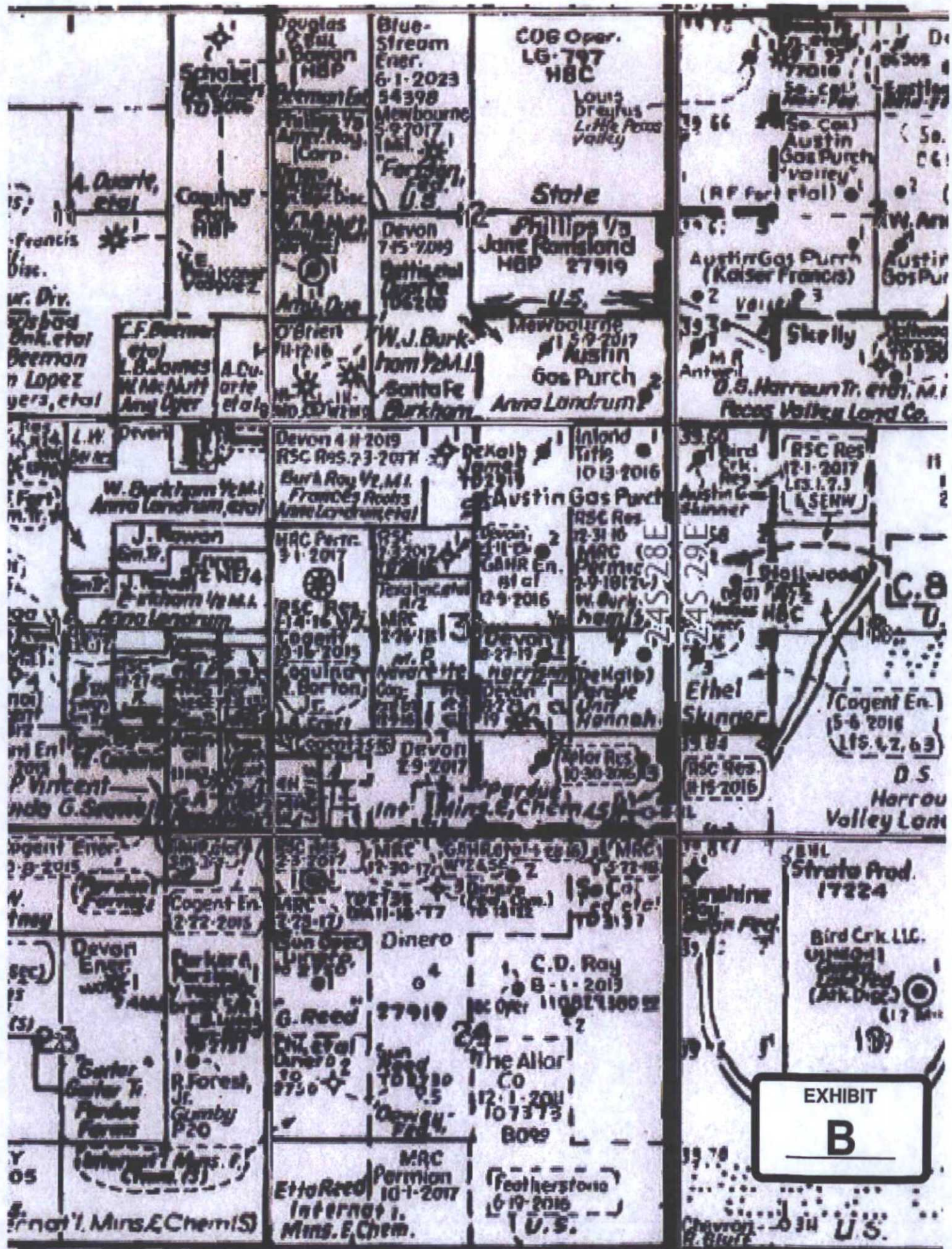



MODRALL SPERLING

L A W Y E R S

EXHIBIT C:

List of Affected Persons for the Application of Matador Production Company for administrative approval of unorthodox well location for its Janie Conner 13-24S-28E RB #221H well located in the N/2 of Section 13, Township 24 South, Range 28 East, N.M.P.M., Eddy County, New Mexico.

Jennifer L. Bradfute
505.848.1845
Fax: 505.848.1882
jlb@modrall.com

Section 11, S/2 & NE/4

COG Operating, LLC
One Concho Center
600 W Illinois Ave.
Midland, TX 79701

RKI Exploration and Production
210 Park Avenue, #900
Oklahoma City, OK 73102

Kaiser Francis Oil Company
P. O. Box 21468
Tulsa, OK 74121

Section 12

Mewbourne Oil Company
P. O. Box 5270
Hobbs, NM 88241

Fortson Oil Company
301 Commerce Street
Fort Worth, TX 76102

COG Operating LLC
One Concho Center
600 West Illinois
Midland, TX 79701

Section 18, Township 24 South, Range 29 East, N/2 & SW/4

RSC Resources
6824 Island Circle
Midland, TX 79707

Section 14, N/2 & SE/4

Matador Production Company
5400 LBJ Freeway, Suite 1500
Dallas, TX 75240

Cogent Energy, Inc.
6824 Island Circle
Midland, TX 79707

Guardian Operating Corp.
6824 Island Circle
Midland, Texas 79707

Chevron
1400 Smith
Houston, TX 77002

Section 7, Township 24 South, Range 29 East, S/2 & NW/4

Magnum Hunter
3500 William D. Tate
Grapevine, TX 76051

USA-BLM – NM-027919
P. O. Box 27115
Santa Fe, NM 87501

UTI
P. O. Box 1416
Snyder, TX 79550

Modrall Sperling
Roehl Harris & Sisk P.A.

Bank of America Centre
500 Fourth Street NW
Suite 1000
Albuquerque,
New Mexico 87102

PO Box 2168
Albuquerque,
New Mexico 87103-2168

Tel: 505.848.1800
www.modrall.com

7010 2780 0002 5895 5519

U.S. Postal ServiceTM
CERTIFIED MAILTM RECEIPT
 (Domestic Mail Only; No Insurance Coverage Provided)

For delivery information visit our website at www.usps.com

OFFICIAL USE

Postage \$
 Certified Fee
 Return Receipt Fee
 (Endorsement Required)
 Restricted Delivery Fee
 (Endorsement Required)
 Total Postage & Fees **7.45**

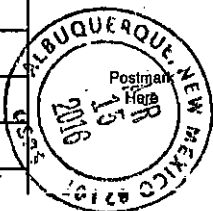

Sent To **MAGNUM HUNTER**
 3500 William D. Tate
 Grapevine, TX 76051

Conner: 221H
 JLB: 85889-0005

PS Form

See Reverse for Instructions

7010 2780 0002 5895 5533

U.S. Postal ServiceTM
CERTIFIED MAILTM RECEIPT
 (Domestic Mail Only; No Insurance Coverage Provided)

For delivery information visit our website at www.usps.com

OFFICIAL USE

Postage \$
 Certified Fee
 Return Receipt Fee
 (Endorsement Required)
 Restricted Delivery Fee
 (Endorsement Required)
 Total Postage **7.45**

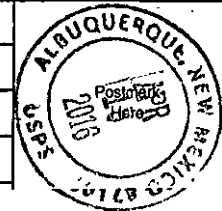

Sent To **COG OPERATING, LLC**
 One Concho Center
 600 West Illinois
 Midland, TX 79701

Conner: 221H
 JLB: 85889-0005

PS Form 3800, August 2006

See Reverse for Instructions

7010 2780 0002 5895 5502

U.S. Postal ServiceTM
CERTIFIED MAILTM RECEIPT
 (Domestic Mail Only; No Insurance Coverage Provided)

For delivery information visit our website at www.usps.com

OFFICIAL USE

Postage \$
 Certified Fee
 Return Receipt Fee
 (Endorsement Required)
 Restricted Delivery Fee
 (Endorsement Required)
 Total **7.45**



Sent To **UTI**
 P. O. Box 1416
 Snyder, TX 79550

Conner: 221H
 JLB: 85889-0005

PS Form 3800, August 2006

See Reverse for Instructions

7010 2780 0002 5895 5540

U.S. Postal ServiceTM
CERTIFIED MAILTM RECEIPT
 (Domestic Mail Only; No Insurance Coverage Provided)

For delivery information visit our website at www.usps.com

OFFICIAL USE

Postage \$
 Certified Fee
 Return Receipt Fee
 (Endorsement Required)
 Restricted Delivery Fee
 (Endorsement Required)
 Total Postage **7.45**



Sent To **MEWBOURNE OIL COMPANY**
 P.O. Box 5270
 Hobbs, New Mexico 88241

Conner: 221H
 JLB: 85889-0005

PS Form 3800, August 2006

See Reverse for Instructions

7010 2780 0002 5895 5496

U.S. Postal ServiceTM
CERTIFIED MAILTM RECEIPT
 (Domestic Mail Only; No Insurance Coverage Provided)

For delivery information visit our website at www.usps.com

OFFICIAL USE

Postage \$
 Certified Fee
 Return Receipt Fee
 (Endorsement Required)
 Restricted Delivery Fee
 (Endorsement Required)
 Total Pos **7.45**

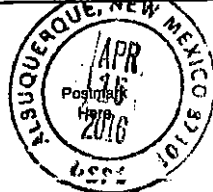

Sent To **RKI EXPLORATION & PRODUCTION**
 210 Park Avenue, Suite 700
 Oklahoma City, OK 73102

Conner: 221H
 JLB: 85889-0005

PS Form 3800, August 2006

See Reverse for Instructions

7010 2780 0002 5895 5526

U.S. Postal ServiceTM
CERTIFIED MAILTM RECEIPT
 (Domestic Mail Only; No Insurance Coverage Provided)

For delivery information visit our website at www.usps.com

OFFICIAL USE

Postage \$
 Certified Fee
 Return Receipt Fee
 (Endorsement Required)
 Restricted Delivery Fee
 (Endorsement Required)
 Total Postage **7.45**



Sent To **GUARDIAN OPERATING CORP.**
 6824 Island Circle
 Midland, TX 79707

Conner: 221H, 207H, 226H
 JLB: 85889-0005

PS Form 3800, August 2006

See Reverse for Instructions

U.S. Postal ServiceTM
CERTIFIED MAILTM RECEIPT
(Domestic Mail Only; No Insurance Coverage Provided)

For delivery information visit our website at www.usps.com

OFFICIAL USE

Postage	\$
Certified Fee	
Return Receipt Fee (Endorsement Required)	
Restricted Delivery Fee (Endorsement Required)	
Total Postage	7.45



Sent To
COGENT ENERGY, INC.
6824 Island Circle
Midland, TX 79707

PS Form 3800, August 2006

Conner: 221H
JLB: 85889-0005

actions

U.S. Postal ServiceTM
CERTIFIED MAILTM RECEIPT
(Domestic Mail Only; No Insurance Coverage Provided)

For delivery information visit our website at www.usps.com

OFFICIAL USE

Postage	\$
Certified Fee	
Return Receipt Fee (Endorsement Required)	
Restricted Delivery Fee (Endorsement Required)	
Total Postage & Fees	7.45

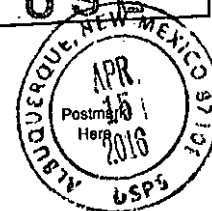

Sent To
CHEVRON
1400 Smith
Houston, TX 77002

PS Form 3800

Conner: 221H
JLB: 85889-0005

actions

U.S. Postal ServiceTM
CERTIFIED MAILTM RECEIPT
(Domestic Mail Only; No Insurance Coverage Provided)

For delivery information visit our website at www.usps.com

OFFICIAL USE

Postage	\$
Certified Fee	
Return Receipt Fee (Endorsement Required)	
Restricted Delivery Fee (Endorsement Required)	
Total Postage	7.45



Sent To
USA-BLM - NM-027919
P. O. Box 27115
Santa Fe, NM 87501

PS Form 3800, August 2006

Conner: 221H
JLB: 85889-0005

actions

U.S. Postal ServiceTM
CERTIFIED MAILTM RECEIPT
(Domestic Mail Only; No Insurance Coverage Provided)

For delivery information visit our website at www.usps.com

OFFICIAL USE

Postage	\$
Certified Fee	
Return Receipt Fee (Endorsement Required)	
Restricted Delivery Fee (Endorsement Required)	
Total Postage	7.45

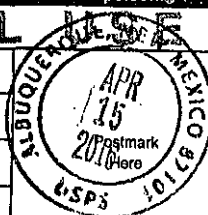

Sent To
KAISER FRANCIS OIL COMPANY
P. O. Box 21468
Tulsa, OK 74121

PS Form 3800, August 2006

Conner: 221H
JLB: 85889-0005

See Reverse for Instructions

U.S. Postal ServiceTM
CERTIFIED MAILTM RECEIPT
(Domestic Mail Only; No Insurance Coverage Provided)

For delivery information visit our website at www.usps.com

OFFICIAL USE

Postage	\$
Certified Fee	
Return Receipt Fee (Endorsement Required)	
Restricted Delivery Fee (Endorsement Required)	
Total Postage & Fees	7.45

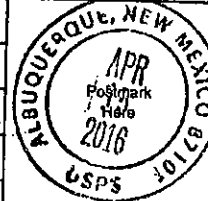

Sent To
FORTSON OIL COMPANY
301 Commerce Street
Fort Worth, TX 76102

PS Form 3800

Conner: 221H
JLB: 85889-0005

actions

U.S. Postal ServiceTM
CERTIFIED MAILTM RECEIPT
(Domestic Mail Only; No Insurance Coverage Provided)

For delivery information visit our website at www.usps.com

OFFICIAL USE

Postage	\$
Certified Fee	
Return Receipt Fee (Endorsement Required)	
Restricted Delivery Fee (Endorsement Required)	
Total Postage	7.45

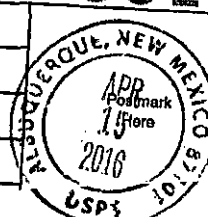

Sent To
RSC RESOURCES
6824 Island Circle
Midland, TX 79707

PS Form 3800

Conner: 221H
JLB: 85889-0005

See Reverse for Instructions

Lowe, Leonard, EMNRD

From: Lowe, Leonard, EMNRD
Sent: Monday, May 09, 2016 10:25 AM
To: 'Jennifer L. Bradfute'
Cc: 'Zoe Lees'; Sharp, Karen, EMNRD; McMillan, Michael, EMNRD; Goetze, Phillip, EMNRD; Jones, William V, EMNRD; lisa@rwbyram.com
Subject: NSL-7409, Janie Conner 13-24S-28E RB # 221H, Eddy County
Importance: High

Ms. Jennifer Bradfute,

The following permit has been issued and will soon be available on the Division's web site:
<http://ocdimage.emnrd.state.nm.us/imaging/WellFileCriteria.aspx>

NSL-7409

Matador Production Company

WELL: Janie Conner 13-24S-28E RB # 221H, Eddy County

Leonard Lowe

Engineering Bureau

Oil Conservation Division

Energy Minerals and Natural Resources Department

1220 South St. Frances

Santa Fe, New Mexico 87004

Office: 505-476-3492

Fax: 505-476-3462

E-mail: leonard.lowe@state.nm.us

Website: <http://www.emnrd.state.nm.us/ocd/>