

HOBBS OCD

District I
1625 N. French Dr., Hobbs, NM 88240
District II
1301 W. Grand Avenue, Artesia, NM 88210
District III
1000 Rio Brazos Road, Aztec, NM 87410
District IV
1220 S. St. Francis Dr., Santa Fe, NM 87505

JAN 06 2012

RECEIVED

State of New Mexico
Energy Minerals and Natural Resources
Oil Conservation Division
1220 South St. Francis Dr.
Santa Fe, NM 87505

Form C-141
Revised October 10, 2003

Submit 2 Copies to appropriate
District Office in accordance
with Rule 116 on back
side of form

Release Notification and Corrective Action

OPERATOR

☒ Initial Report ☐ Final Report

Name of Company ConocoPhillips Company	Contact John W. Gates
Address 3300 North A St. Bldg 6, Midland, TX 79705-5406	Telephone No. 505.391.3158
Facility Name EVGSAU 2658-011	Facility Type Oil and Gas

Surface Owner Giles Lee	Mineral Owner State Of New Mexico	Lease No 300250287500
--------------------------------	--	------------------------------

LOCATION OF RELEASE

Unit Letter K	Section 26	Township 17S	Range 35E	Feet from the	North/South Line	Feet from the	East/West Line	County Lea
-------------------------	----------------------	------------------------	---------------------	---------------	------------------	---------------	----------------	----------------------

Latitude

Longitude

NATURE OF RELEASE

Type of Release Crude Oil	Volume of Release 10bbl (10oil, 0water)	Volume Recovered (3oil, 0water)
Source of Release Well surface casing	Date and Hour of Occurrence 01/04/12 1530	Date and Hour of Discovery 01/04/12 1615
Was Immediate Notice Given? <input type="checkbox"/> Yes <input type="checkbox"/> No <input checked="" type="checkbox"/> Not Required	If YES, To Whom?	
By Whom?	Date and Hour	
Was a Watercourse Reached? <input type="checkbox"/> Yes <input checked="" type="checkbox"/> No	If YES, Volume Impacting the Watercourse.	

If a Watercourse was Impacted, Describe Fully.*

Describe Cause of Problem and Remedial Action Taken.*

Release was caused by well surface casing failure due to suspected internal/external corrosion . Workover rig was summed and rigged up on well to replace failed casing.

Describe Area Affected and Cleanup Action Taken.*

100' X 140' X .5" area of well pad and pasture land. Vacuum truck was called and 3 bbls of crude oil was recovered. Majority of release was in the form of a spray.

I hereby certify that the information given above is true and complete to the best of my knowledge and understand that pursuant to NMOCD rules and regulations all operators are required to report and/or file certain release notifications and perform corrective actions for releases which may endanger public health or the environment. The acceptance of a C-141 report by the NMOCD marked as "Final Report" does not relieve the operator of liability should their operations have failed to adequately investigate and remediate contamination that pose a threat to ground water, surface water, human health or the environment. In addition, NMOCD acceptance of a C-141 report does not relieve the operator of responsibility for compliance with any other federal, state, or local laws and/or regulations.

Signature: 	OIL CONSERVATION DIVISION	
Printed Name: John W. Gates	Approved by District Supervisor:	
Title: HSER Lead	Approval Date:	Expiration Date:
E-mail Address: John.W.Gates@conocophillips.com	Conditions of Approval:	Attached <input type="checkbox"/>
Date: 01/06/12 Phone: 505.391.3158		

• Attach Additional Sheets If Necessary

IRP-4341

EVGSAU 2658-011

(Located in Section-26 Township 17S Range 35E)

Site Remediation Plan

Presented to:

ConocoPhillips
HC 60, Box 66
Lovington, NM 88260

< 50'

Prepared By:



Diamondback Disposal Services, Inc.
PO Box 2491
Hobbs, NM 88241

Introduction

This report presents the results of delineation activities at the EVGSAU 2658-011. The site is located in Section 26, Township 17S, Range 35E in Lea County, New Mexico. Impacted areas are owned by New Mexico State Land Department. Diamondback Disposal Services, Inc. (Diamondback) was contacted January 12, 2012 by Mr. Justin Wright, of Conoco Phillips Inc, to perform the delineation and remediation activities at the spill site. The delineation was performed in general accordance with the New Mexico Oil Conservation Division (NMOCD) rules and regulations. The following sections present: an overview, findings and recommendations of all delineation work performed on site.

Overview

The spill site is located mostly on state lease land consisting of good grass, prairie, or range lands with a little ponding on COPC location. Approximately 10 bbls of crude oil in the form of a spray was lost, with approximately 3 bbls being recovered from the use of a vacuum truck. Approximately 20,000 square feet of pasture land was impacted as well as 600 square feet of caliche pad. The depth to groundwater in the area is estimated to be 55' to 65' below ground surface (BGS) based on the information, reviewed at the New Mexico State Engineer's Office in Roswell, NM. The potential contaminants of concern are mid to high-level concentrations of petroleum-based hydrocarbons that were lost due to well surface casing failure in which a workover rig replaced failed casing..

Findings

On February 15, 2012 Diamondback was dispatched to location to hand auger soil borings on the site to determine vertical depth of impaction. A total of four soil borings were augered to a depth of 18" each. Samples were collected every 6 inches, packaged and sent to Cardinal Laboratory (with COC) for analysis. The samples were tested for TPH, BTEX, and Chlorides (see analytical and attached map).

Work Plan

Diamondback Disposal Services proposes to excavate 18 inches below ground surface in the area of HA 1 and HA 4(see map and analytical), generating approximately 300 cubic yards of impacted material, and dispose of material at an NMOCD approved disposal facility. Import topsoil to backfill and crown excavated area to shed water. The areas around HA 2 and HA 3 we plan to till native vegetation into the existing soil and re-seed with state approved seed. Diamondback feels this method will significantly reduce migration of impacted material through the vadose zone therefore leaving the site in a manner that will pose very little if any future environmental threat.

EXCAVATION PLAN

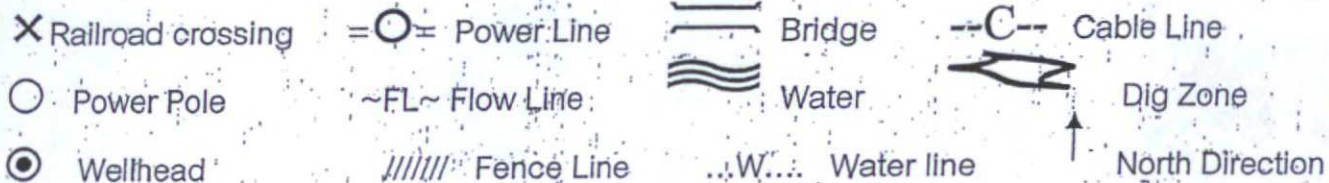

Search Zone Perimeter - White

Electrical - Red

Drainage/Sewers - Green

Temporary Survey Markings - Pink

Gas & Oil - Yellow

Communication - Orange

Potable Water - Blue

SWD - Light Blue

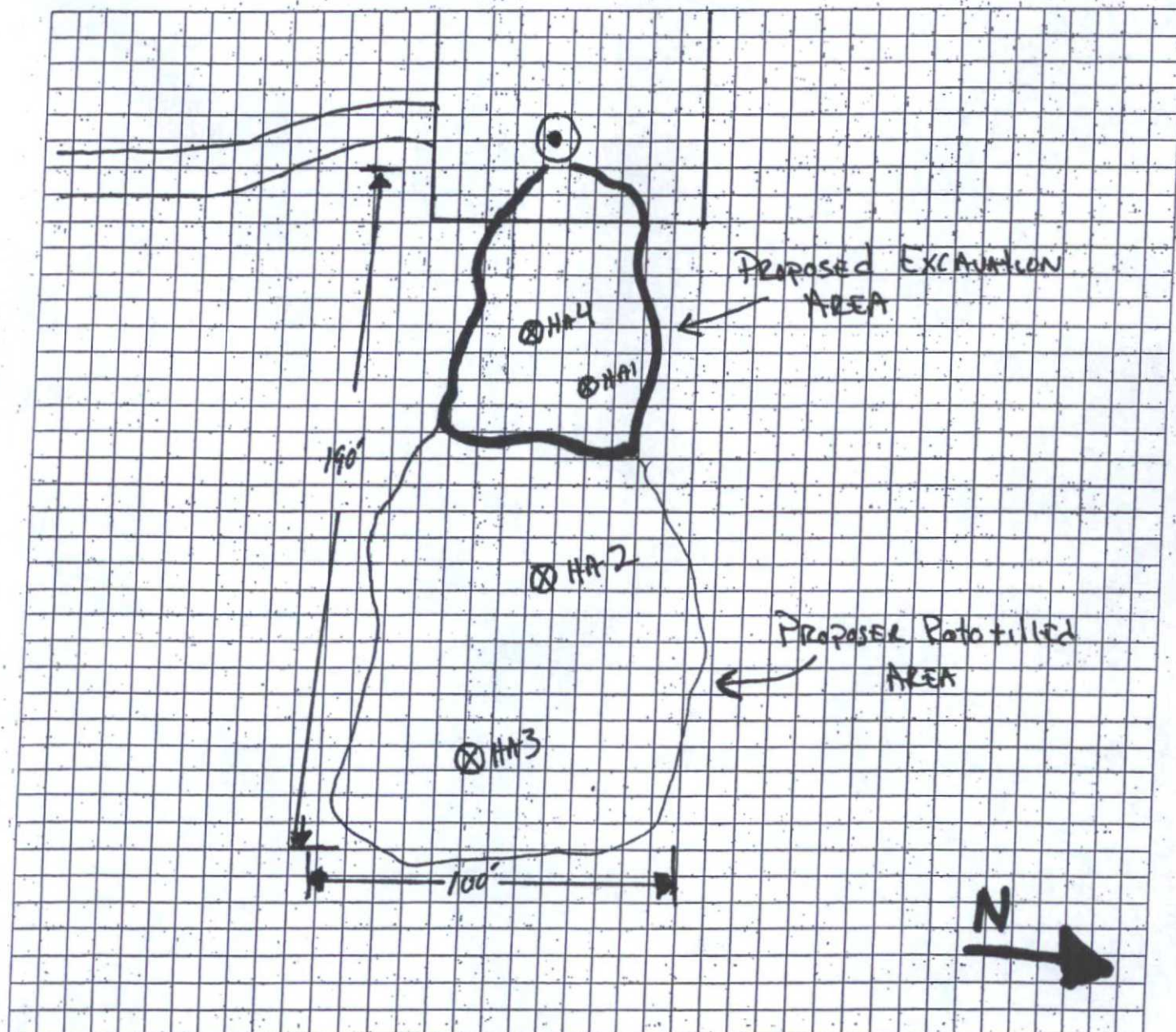

February 24, 2012

JUSTIN ROBERTS

DIAMONDBACK DISPOSAL SERVICE INC.

P. O. BOX 2491

HOBBS, NM 88241

RE: EVGSAU TRACT 2658-011

Enclosed are the results of analyses for samples received by the laboratory on 02/20/12 16:00.

Cardinal Laboratories is accredited through Texas NELAP under certificate number T104704398-11-3. Accreditation applies to drinking water, non-potable water and solid and chemical materials. All accredited analytes are denoted by an asterisk (*). For a complete list of accredited analytes and matrices visit the TCEQ website at www.tceq.texas.gov/field/qa/lab_accred_certif.html.

Cardinal Laboratories is accredited through the State of Colorado Department of Public Health and Environment for:

Method EPA 552.2	Haloacetic Acids (HAA-5)
Method EPA 524.2	Total Trihalomethanes (TTHM)
Method EPA 524.4	Regulated VOCs (V1, V2, V3)

Accreditation applies to public drinking water matrices.

This report meets NELAP requirements and is made up of a cover page, analytical results, and a copy of the original chain-of-custody. If you have any questions concerning this report, please feel free to contact me.

Sincerely,



Celey D. Keene

Lab Director/Quality Manager

Analytical Results For:

 DIAMONDBACK DISPOSAL SERVICE INC.
 JUSTIN ROBERTS
 P. O. BOX 2491
 HOBBS NM, 88241
 Fax To: (575) 392-9376

 Received: 02/20/2012
 Reported: 02/24/2012
 Project Name: EVGSAU TRACT 2658-011
 Project Number: NONE GIVEN
 Project Location: BUCKEYE, NM

 Sampling Date: 02/15/2012
 Sampling Type: Soil
 Sampling Condition: Cool & Intact
 Sample Received By: Jodi Henson

Sample ID: HA 1 SURFACE (H200460-01)

BTEX 8021B		mg/kg	Analyzed By: AP					S-04	
Analyte	Result	Reporting Limit	Analyzed	Method Blank	BS	% Recovery	True Value QC	RPD	Qualifier
Benzene*	<0.500	0.500	02/24/2012	ND	1.89	94.7	2.00	3.34	
Toluene*	19.6	0.500	02/24/2012	ND	2.06	103	2.00	3.91	
Ethylbenzene*	39.0	0.500	02/24/2012	ND	2.09	105	2.00	3.94	
Total Xylenes*	93.7	1.50	02/24/2012	ND	6.53	109	6.00	3.69	

Surrogate: 4-Bromofluorobenzene (PIL) 166 % 64.4-134

Chloride, SM4500Cl-B		mg/kg	Analyzed By: AP						
Analyte	Result	Reporting Limit	Analyzed	Method Blank	BS	% Recovery	True Value QC	RPD	Qualifier
Chloride	112	16.0	02/22/2012	ND	416	104	400	3.77	

TPH 8015M		mg/kg	Analyzed By: MS					S-04	
Analyte	Result	Reporting Limit	Analyzed	Method Blank	BS	% Recovery	True Value QC	RPD	Qualifier
GRO C6-C10	2910	100	02/23/2012	ND	183	91.4	200	8.56	
DRO >C10-C28	14000	100	02/23/2012	ND	175	87.6	200	8.15	

Surrogate: 1-Chlorooctane 215 % 55.5-154

Surrogate: 1-Chlorooctadecane 193 % 57.6-158

Cardinal Laboratories

*=Accredited Analyte

PLEASE NOTE: Liability and Damages. Cardinal's liability and client's exclusive remedy for any claim arising, whether based in contract or tort, shall be limited to the amount paid by client for analyses. All claims, including those for negligence and any other cause whatsoever shall be deemed waived unless made in writing and received by Cardinal within thirty (30) days after completion of the applicable service. In no event shall Cardinal be liable for incidental or consequential damages, including, without limitation, business interruptions, loss of use, or loss of profits incurred by client, its subsidiaries, affiliates or successors arising out of or related to the performance of the services hereunder by Cardinal, regardless of whether such claim is based upon any of the above stated reasons or otherwise. Results relate only to the samples identified above. This report shall not be reproduced except in full with written approval of Cardinal Laboratories.



Celey D. Keene, Lab Director/Quality Manager

Analytical Results For:

DIAMONDBACK DISPOSAL SERVICE INC.
JUSTIN ROBERTS
P. O. BOX 2491
HOBBS NM, 88241
Fax To: (575) 392-9376

Received: 02/20/2012
Reported: 02/24/2012
Project Name: EVGSAU TRACT 2658-011
Project Number: NONE GIVEN
Project Location: BUCKEYE, NM

Sampling Date: 02/15/2012
Sampling Type: Soil
Sampling Condition: Cool & Intact
Sample Received By: Jodi Henson

Sample ID: HA 2 SURFACE (H200460-02)

BTX 80218		mg/kg		Analyzed By: AP					
Analyte	Result	Reporting Limit	Analyzed	Method Blank	BS	% Recovery	True Value QC	RPD	Qualifier
Benzene*	<0.050	0.050	02/23/2012	ND	1.89	94.7	2.00	3.34	
Toluene*	<0.050	0.050	02/23/2012	ND	2.06	103	2.00	3.91	
Ethylbenzene*	<0.050	0.050	02/23/2012	ND	2.09	105	2.00	3.94	
Total Xylenes*	<0.150	0.150	02/23/2012	ND	6.53	109	6.00	3.69	

Surrogate: 4-Bromofluorobenzene (PIL) 113 % 64.4-134

Chloride, SM4500Cl-B		mg/kg		Analyzed By: AP					
Analyte	Result	Reporting Limit	Analyzed	Method Blank	BS	% Recovery	True Value QC	RPD	Qualifier
Chloride	<16.0	16.0	02/22/2012	ND	416	104	400	3.77	

TPH 8015M		mg/kg		Analyzed By: MS					
Analyte	Result	Reporting Limit	Analyzed	Method Blank	BS	% Recovery	True Value QC	RPD	Qualifier
GRO C6-C10	<10.0	10.0	02/23/2012	ND	183	91.4	200	8.56	
DRO >C10-C28	102	10.0	02/23/2012	ND	175	87.6	200	8.15	

Surrogate: 1-Chlorooctane 118 % 55.5-154

Surrogate: 1-Chlorooctadecane 122 % 57.6-158

Cardinal Laboratories

*=Accredited Analyte

PLEASE NOTE: Liability and Damages. Cardinal's liability and client's exclusive remedy for any claim arising, whether based in contract or tort, shall be limited to the amount paid by client for analyses. All claims, including those for negligence and any other cause whatsoever shall be deemed waived unless made in writing and received by Cardinal within thirty (30) days after completion of the applicable service. In no event shall Cardinal be liable for incidental or consequential damages, including, without limitation, business interruptions, loss of use, or loss of profits incurred by client, its subsidiaries, affiliates or successors arising out of or related to the performance of the services hereunder by Cardinal, regardless of whether such claim is based upon any of the above stated reasons or otherwise. Results relate only to the samples identified above. This report shall not be reproduced except in full with written approval of Cardinal Laboratories.



Celey D. Keene, Lab Director/Quality Manager

Analytical Results For:

DIAMONDBACK DISPOSAL SERVICE INC.
JUSTIN ROBERTS
P. O. BOX 2491
HOBBS NM, 88241
Fax To: (575) 392-9376

Received: 02/20/2012
Reported: 02/24/2012
Project Name: EVGSAU TRACT 2658-011
Project Number: NONE GIVEN
Project Location: BUCKEYE, NM

Sampling Date: 02/15/2012
Sampling Type: Soil
Sampling Condition: Cool & Intact
Sample Received By: Jodi Henson

Sample ID: HA 2 6" BGS (H200460-03)

BTEX 8021B		mg/kg	Analyzed By: AP						
Analyte	Result	Reporting Limit	Analyzed	Method Blank	BS	% Recovery	True Value QC	RPD	Qualifier
Benzene*	<0.050	0.050	02/23/2012	ND	1.89	94.7	2.00	3.34	
Toluene*	<0.050	0.050	02/23/2012	ND	2.06	103	2.00	3.91	
Ethylbenzene*	<0.050	0.050	02/23/2012	ND	2.09	105	2.00	3.94	
Total Xylenes*	<0.150	0.150	02/23/2012	ND	6.53	109	6.00	3.69	

Surrogate: 4-Bromofluorobenzene (PIL) 110 % 64.4-134

Chloride, SM4500Cl-B		mg/kg	Analyzed By: AP						
Analyte	Result	Reporting Limit	Analyzed	Method Blank	BS	% Recovery	True Value QC	RPD	Qualifier
Chloride	<16.0	16.0	02/22/2012	ND	416	104	400	3.77	

TPH 8015M		mg/kg	Analyzed By: MS						
Analyte	Result	Reporting Limit	Analyzed	Method Blank	BS	% Recovery	True Value QC	RPD	Qualifier
GRO C6-C10	<10.0	10.0	02/23/2012	ND	183	91.4	200	8.56	
DRO >C10-C28	10.2	10.0	02/23/2012	ND	175	87.6	200	8.15	

Surrogate: 1-Chlorooctane 103 % 55.5-154

Surrogate: 1-Chlorooctadecane 108 % 57.6-158

Cardinal Laboratories

*=Accredited Analyte

PLEASE NOTE: Liability and Damages. Cardinal's liability and client's exclusive remedy for any claim arising, whether based in contract or tort, shall be limited to the amount paid by client for analyses. All claims, including those for negligence and any other cause whatsoever shall be deemed waived unless made in writing and received by Cardinal within thirty (30) days after completion of the applicable service. In no event shall Cardinal be liable for incidental or consequential damages, including, without limitation, business interruptions, loss of use, or loss of profits incurred by client, its subsidiaries, affiliates or successors arising out of or related to the performance of the services hereunder by Cardinal, regardless of whether such claim is based upon any of the above stated reasons or otherwise. Results relate only to the samples identified above. This report shall not be reproduced except in full with written approval of Cardinal Laboratories.



Celey D. Keene, Lab Director/Quality Manager

Analytical Results For:

DIAMONDBACK DISPOSAL SERVICE INC.
JUSTIN ROBERTS
P. O. BOX 2491
HOBBS NM, 88241
Fax To: (575) 392-9376

Received: 02/20/2012
Reported: 02/24/2012
Project Name: EVGSAU TRACT 2658-011
Project Number: NONE GIVEN
Project Location: BUCKEYE, NM

Sampling Date: 02/15/2012
Sampling Type: Soil
Sampling Condition: Cool & Intact
Sample Received By: Jodi Henson

Sample ID: HA 2 12" BGS (H200460-04)

BTEX 8021B			mg/kg		Analyzed By: AP				
Analyte	Result	Reporting Limit	Analyzed	Method Blank	BS	% Recovery	True Value QC	RPD	Qualifier
Benzene*	<0.050	0.050	02/23/2012	ND	1.89	94.7	2.00	3.34	
Toluene*	<0.050	0.050	02/23/2012	ND	2.06	103	2.00	3.91	
Ethylbenzene*	<0.050	0.050	02/23/2012	ND	2.09	105	2.00	3.94	
Total Xylenes*	<0.150	0.150	02/23/2012	ND	6.53	109	6.00	3.69	

Surrogate: 4-Bromofluorobenzene (PIL) 109 % 64.4-134

Chloride, SM4500Cl-B			mg/kg		Analyzed By: AP				
Analyte	Result	Reporting Limit	Analyzed	Method Blank	BS	% Recovery	True Value QC	RPD	Qualifier
Chloride	32.0	16.0	02/22/2012	ND	416	104	400	3.77	

TPH 8015M			mg/kg		Analyzed By: MS				
Analyte	Result	Reporting Limit	Analyzed	Method Blank	BS	% Recovery	True Value QC	RPD	Qualifier
GRO C6-C10	<10.0	10.0	02/23/2012	ND	183	91.4	200	8.56	
DRO >C10-C28	11.6	10.0	02/23/2012	ND	175	87.6	200	8.15	

Surrogate: 1-Chlorooctane 113 % 55.5-154

Surrogate: 1-Chlorooctadecane 121 % 57.6-158

Cardinal Laboratories

*=Accredited Analyte

PLEASE NOTE: Liability and Damages. Cardinal's liability and client's exclusive remedy for any claim arising, whether based in contract or tort, shall be limited to the amount paid by client for analyses. All claims, including those for negligence and any other cause whatsoever shall be deemed waived unless made in writing and received by Cardinal within thirty (30) days after completion of the applicable service. In no event shall Cardinal be liable for incidental or consequential damages, including, without limitation, business interruptions, loss of use, or loss of profits incurred by client, its subsidiaries, affiliates or successors arising out of or related to the performance of the services hereunder by Cardinal, regardless of whether such claim is based upon any of the above stated reasons or otherwise. Results relate only to the samples identified above. This report shall not be reproduced except in full with written approval of Cardinal Laboratories.



Celey D. Keene, Lab Director/Quality Manager

Analytical Results For:

 DIAMONDBACK DISPOSAL SERVICE INC.
 JUSTIN ROBERTS
 P. O. BOX 2491
 HOBBS NM, 88241
 Fax To: (575) 392-9376

 Received: 02/20/2012
 Reported: 02/24/2012
 Project Name: EVGSAU TRACT 2658-011
 Project Number: NONE GIVEN
 Project Location: BUCKEYE, NM

 Sampling Date: 02/15/2012
 Sampling Type: Soil
 Sampling Condition: Cool & Intact
 Sample Received By: Jodi Henson

Sample ID: HA 2 18" BGS (H200460-05)

BTEX 8021B		mg/kg		Analyzed By: AP					
Analyte	Result	Reporting Limit	Analyzed	Method Blank	BS	% Recovery	True Value QC	RPD	Qualifier
Benzene*	<0.050	0.050	02/23/2012	ND	1.89	94.7	2.00	3.34	
Toluene*	<0.050	0.050	02/23/2012	ND	2.06	103	2.00	3.91	
Ethylbenzene*	<0.050	0.050	02/23/2012	ND	2.09	105	2.00	3.94	
Total Xylenes*	<0.150	0.150	02/23/2012	ND	6.53	109	6.00	3.69	

Surrogate: 4-Bromofluorobenzene (PIL) 110 % 64.4-134

Chloride, SM4500Cl-B		mg/kg		Analyzed By: AP					
Analyte	Result	Reporting Limit	Analyzed	Method Blank	BS	% Recovery	True Value QC	RPD	Qualifier
Chloride	80.0	16.0	02/22/2012	ND	416	104	400	3.77	

TPH 8015M		mg/kg		Analyzed By: MS					
Analyte	Result	Reporting Limit	Analyzed	Method Blank	BS	% Recovery	True Value QC	RPD	Qualifier
GRO C6-C10	<10.0	10.0	02/23/2012	ND	183	91.4	200	8.56	
DRO >C10-C28	<10.0	10.0	02/23/2012	ND	175	87.6	200	8.15	

Surrogate: 1-Chlorooctane 121 % 55.5-154

Surrogate: 1-Chlorooctadecane 136 % 57.6-158

Cardinal Laboratories

* = Accredited Analyte

PLEASE NOTE: Liability and Damages. Cardinal's liability and client's exclusive remedy for any claim arising, whether based in contract or tort, shall be limited to the amount paid by client for analyses. All claims, including those for negligence and any other cause whatsoever shall be deemed waived unless made in writing and received by Cardinal within thirty (30) days after completion of the applicable service. In no event shall Cardinal be liable for incidental or consequential damages, including, without limitation, business interruptions, loss of use, or loss of profits incurred by client, its subsidiaries, affiliates or successors arising out of or related to the performance of the services hereunder by Cardinal, regardless of whether such claim is based upon any of the above stated reasons or otherwise. Results relate only to the samples identified above. This report shall not be reproduced except in full with written approval of Cardinal Laboratories.



Celey D. Keene, Lab Director/Quality Manager

Analytical Results For:

DIAMONDBACK DISPOSAL SERVICE INC.
JUSTIN ROBERTS
P. O. BOX 2491
HOBBS NM, 88241
Fax To: (575) 392-9376

Received: 02/20/2012
Reported: 02/24/2012
Project Name: EVGSAU TRACT 2658-011
Project Number: NONE GIVEN
Project Location: BUCKEYE, NM

Sampling Date: 02/15/2012
Sampling Type: Soil
Sampling Condition: Cool & Intact
Sample Received By: Jodi Henson

Sample ID: HA 3 SURFACE (H200460-06)

BTEX 8021B			mg/kg		Analyzed By: AP				
Analyte	Result	Reporting Limit	Analyzed	Method Blank	BS	% Recovery	True Value QC	RPD	Qualifier
Benzene*	<0.050	0.050	02/23/2012	ND	1.89	94.7	2.00	3.34	
Toluene*	<0.050	0.050	02/23/2012	ND	2.06	103	2.00	3.91	
Ethylbenzene*	<0.050	0.050	02/23/2012	ND	2.09	105	2.00	3.94	
Total Xylenes*	<0.150	0.150	02/23/2012	ND	6.53	109	6.00	3.69	

Surrogate: 4-Bromofluorobenzene (PIL) 110 % 64.4-134

Chloride, SM4500Cl-B			mg/kg		Analyzed By: AP				
Analyte	Result	Reporting Limit	Analyzed	Method Blank	BS	% Recovery	True Value QC	RPD	Qualifier
Chloride	<16.0	16.0	02/22/2012	ND	432	108	400	3.77	

TPH 8015M			mg/kg		Analyzed By: MS				
Analyte	Result	Reporting Limit	Analyzed	Method Blank	BS	% Recovery	True Value QC	RPD	Qualifier
GRO C6-C10	<10.0	10.0	02/23/2012	ND	183	91.4	200	8.56	
DRO >C10-C28	45.0	10.0	02/23/2012	ND	175	87.6	200	8.15	

Surrogate: 1-Chlorooctane 109 % 55.5-154

Surrogate: 1-Chlorooctadecane 113 % 57.6-158

Cardinal Laboratories

*=Accredited Analyte

PLEASE NOTE: Liability and Damages. Cardinal's liability and client's exclusive remedy for any claim arising, whether based in contract or tort, shall be limited to the amount paid by client for analyses. All claims, including those for negligence and any other cause whatsoever shall be deemed waived unless made in writing and received by Cardinal within thirty (30) days after completion of the applicable service. In no event shall Cardinal be liable for incidental or consequential damages, including, without limitation, business interruptions, loss of use, or loss of profits incurred by client, its subsidiaries, affiliates or successors arising out of or related to the performance of the services hereunder by Cardinal, regardless of whether such claim is based upon any of the above stated reasons or otherwise. Results relate only to the samples identified above. This report shall not be reproduced except in full with written approval of Cardinal Laboratories.



Celey D. Keene, Lab Director/Quality Manager

Analytical Results For:

 DIAMONDBACK DISPOSAL SERVICE INC.
 JUSTIN ROBERTS
 P. O. BOX 2491
 HOBBS NM, 88241
 Fax To: (575) 392-9376

Received:	02/20/2012	Sampling Date:	02/15/2012
Reported:	02/24/2012	Sampling Type:	Soil
Project Name:	EVGSAU TRACT 2658-011	Sampling Condition:	Cool & Intact
Project Number:	NONE GIVEN	Sample Received By:	Jodi Henson
Project Location:	BUCKEYE, NM		

Sample ID: HA 3 6" BGS (H200460-07)

BTX 8021B		mg/kg		Analyzed By: AP					
Analyte	Result	Reporting Limit	Analyzed	Method Blank	BS	% Recovery	True Value QC	RPD	Qualifier
Benzene*	<0.050	0.050	02/23/2012	ND	1.89	94.7	2.00	3.34	
Toluene*	<0.050	0.050	02/23/2012	ND	2.06	103	2.00	3.91	
Ethylbenzene*	<0.050	0.050	02/23/2012	ND	2.09	105	2.00	3.94	
Total Xylenes*	<0.150	0.150	02/23/2012	ND	6.53	109	6.00	3.69	

Surrogate: 4-Bromofluorobenzene (PIL) 110 % 64.4-134

Chloride, SM4500Cl-B		mg/kg		Analyzed By: AP					
Analyte	Result	Reporting Limit	Analyzed	Method Blank	BS	% Recovery	True Value QC	RPD	Qualifier
Chloride	<16.0	16.0	02/22/2012	ND	432	108	400	3.77	

TPH 8015M		mg/kg		Analyzed By: MS					
Analyte	Result	Reporting Limit	Analyzed	Method Blank	BS	% Recovery	True Value QC	RPD	Qualifier
GRO C6-C10	<10.0	10.0	02/22/2012	ND	220	110	200	3.77	
DRO >C10-C28	<10.0	10.0	02/22/2012	ND	205	102	200	5.78	

Surrogate: 1-Chlorooctane 79.2 % 55.5-154

Surrogate: 1-Chlorooctadecane 78.3 % 57.6-158

Cardinal Laboratories

* = Accredited Analyte

PLEASE NOTE: Liability and Damages. Cardinal's liability and client's exclusive remedy for any claim arising, whether based in contract or tort, shall be limited to the amount paid by client for analyses. All claims, including those for negligence and any other cause whatsoever shall be deemed waived unless made in writing and received by Cardinal within thirty (30) days after completion of the applicable service. In no event shall Cardinal be liable for incidental or consequential damages, including, without limitation, business interruptions, loss of use, or loss of profits incurred by client, its subsidiaries, affiliates or successors arising out of or related to the performance of the services hereunder by Cardinal, regardless of whether such claim is based upon any of the above stated reasons or otherwise. Results relate only to the samples identified above. This report shall not be reproduced except in full with written approval of Cardinal Laboratories.



Celey D. Keene, Lab Director/Quality Manager

Analytical Results For:

 DIAMONDBACK DISPOSAL SERVICE INC.
 JUSTIN ROBERTS
 P. O. BOX 2491
 HOBBS NM, 88241
 Fax To: (575) 392-9376

 Received: 02/20/2012
 Reported: 02/24/2012
 Project Name: EVGSAU TRACT 2658-011
 Project Number: NONE GIVEN
 Project Location: BUCKEYE, NM

 Sampling Date: 02/15/2012
 Sampling Type: Soil
 Sampling Condition: Cool & Intact
 Sample Received By: Jodi Henson

Sample ID: HA 3 12" BGS (H200460-08)

BTX 8021B		mg/kg		Analyzed By: AP					
Analyte	Result	Reporting Limit	Analyzed	Method Blank	BS	% Recovery	True Value QC	RPD	Qualifier
Benzene*	<0.050	0.050	02/23/2012	ND	1.89	94.7	2.00	3.34	
Toluene*	<0.050	0.050	02/23/2012	ND	2.06	103	2.00	3.91	
Ethylbenzene*	<0.050	0.050	02/23/2012	ND	2.09	105	2.00	3.94	
Total Xylenes*	<0.150	0.150	02/23/2012	ND	6.53	109	6.00	3.69	

Surrogate: 4-Bromofluorobenzene (PIL) 110 % 64.4-134

Chloride, SM4500Cl-B		mg/kg		Analyzed By: HM					
Analyte	Result	Reporting Limit	Analyzed	Method Blank	BS	% Recovery	True Value QC	RPD	Qualifier
Chloride	<16.0	16.0	02/22/2012	ND	432	108	400	3.77	

TPH 8015M		mg/kg		Analyzed By: MS					
Analyte	Result	Reporting Limit	Analyzed	Method Blank	BS	% Recovery	True Value QC	RPD	Qualifier
GRO C6-C10	<10.0	10.0	02/23/2012	ND	183	91.4	200	8.56	
DRO >C10-C28	14.8	10.0	02/23/2012	ND	175	87.6	200	8.15	

Surrogate: 1-Chlorooctane 116 % 55.5-154

Surrogate: 1-Chlorooctadecane 119 % 57.6-158

Cardinal Laboratories

* = Accredited Analyte

PLEASE NOTE: Liability and Damages. Cardinal's liability and client's exclusive remedy for any claim arising, whether based in contract or tort, shall be limited to the amount paid by client for analyses. All claims, including those for negligence and any other cause whatsoever shall be deemed waived unless made in writing and received by Cardinal within thirty (30) days after completion of the applicable service. In no event shall Cardinal be liable for incidental or consequential damages, including, without limitation, business interruptions, loss of use, or loss of profits incurred by client, its subsidiaries, affiliates or successors arising out of or related to the performance of the services hereunder by Cardinal, regardless of whether such claim is based upon any of the above stated reasons or otherwise. Results relate only to the samples identified above. This report shall not be reproduced except in full with written approval of Cardinal Laboratories.



Celey D. Keene, Lab Director/Quality Manager

Analytical Results For:

DIAMONDBACK DISPOSAL SERVICE INC.
JUSTIN ROBERTS
P. O. BOX 2491
HOBBS NM, 88241
Fax To: (575) 392-9376

Received: 02/20/2012
Reported: 02/24/2012
Project Name: EVGSAU TRACT 2658-011
Project Number: NONE GIVEN
Project Location: BUCKEYE, NM

Sampling Date: 02/15/2012
Sampling Type: Soil
Sampling Condition: Cool & Intact
Sample Received By: Jodi Henson

Sample ID: HA 3 18" BGS (H200460-09)
BTEX 8021B
mg/kg
Analyzed By: AP

Analyte	Result	Reporting Limit	Analyzed	Method Blank	BS	% Recovery	True Value QC	RPD	Qualifier
Benzene*	<0.050	0.050	02/23/2012	ND	1.89	94.7	2.00	3.34	
Toluene*	<0.050	0.050	02/23/2012	ND	2.06	103	2.00	3.91	
Ethylbenzene*	<0.050	0.050	02/23/2012	ND	2.09	105	2.00	3.94	
Total Xylenes*	<0.150	0.150	02/23/2012	ND	6.53	109	6.00	3.69	

Surrogate: 4-Bromofluorobenzene (PIL) 109 % 64.4-134

Chloride, SM4500Cl-B
mg/kg
Analyzed By: HM

Analyte	Result	Reporting Limit	Analyzed	Method Blank	BS	% Recovery	True Value QC	RPD	Qualifier
Chloride	<16.0	16.0	02/22/2012	ND	432	108	400	3.77	

TPH 8015M
mg/kg
Analyzed By: MS

Analyte	Result	Reporting Limit	Analyzed	Method Blank	BS	% Recovery	True Value QC	RPD	Qualifier
GRO C6-C10	<10.0	10.0	02/23/2012	ND	183	91.4	200	8.56	
DRO >C10-C28	<10.0	10.0	02/23/2012	ND	175	87.6	200	8.15	

Surrogate: 1-Chlorooctane 120 % 55.5-154

Surrogate: 1-Chlorooctadecane 128 % 57.6-158

Cardinal Laboratories

*=Accredited Analyte

PLEASE NOTE: Liability and Damages. Cardinal's liability and client's exclusive remedy for any claim arising, whether based in contract or tort, shall be limited to the amount paid by client for analyses. All claims, including those for negligence and any other cause whatsoever shall be deemed waived unless made in writing and received by Cardinal within thirty (30) days after completion of the applicable service. In no event shall Cardinal be liable for incidental or consequential damages, including, without limitation, business interruptions, loss of use, or loss of profits incurred by client, its subsidiaries, affiliates or successors arising out of or related to the performance of the services hereunder by Cardinal, regardless of whether such claim is based upon any of the above stated reasons or otherwise. Results relate only to the samples identified above. This report shall not be reproduced except in full with written approval of Cardinal Laboratories.



Celey D. Keene, Lab Director/Quality Manager

Analytical Results For:

DIAMONDBACK DISPOSAL SERVICE INC.

JUSTIN ROBERTS

P. O. BOX 2491

HOBBS NM, 88241

Fax To: (575) 392-9376

Received: 02/20/2012
 Reported: 02/24/2012
 Project Name: EVGSAU TRACT 2658-011
 Project Number: NONE GIVEN
 Project Location: BUCKEYE, NM

Sampling Date: 02/15/2012
 Sampling Type: Soil
 Sampling Condition: Cool & Intact
 Sample Received By: Jodi Henson

Sample ID: HA 4 SURFACE (H200460-10)

BTX 8021B		mg/kg	Analyzed By: AP					S-04	
Analyte	Result	Reporting Limit	Analyzed	Method Blank	BS	% Recovery	True Value QC	RPD	Qualifier
Benzene*	<0.500	0.500	02/24/2012	ND	1.89	94.7	2.00	3.34	
Toluene*	11.9	0.500	02/24/2012	ND	2.06	103	2.00	3.91	
Ethylbenzene*	36.3	0.500	02/24/2012	ND	2.09	105	2.00	3.94	
Total Xylenes*	68.9	1.50	02/24/2012	ND	6.53	109	6.00	3.69	

Surrogate: 4-Bromofluorobenzene (PIL) 174 % 64.4-134

Chloride, SM4500Cl-B		mg/kg	Analyzed By: HM						
Analyte	Result	Reporting Limit	Analyzed	Method Blank	BS	% Recovery	True Value QC	RPD	Qualifier
Chloride	<16.0	16.0	02/22/2012	ND	432	108	400	3.77	

TPH 8015M		mg/kg	Analyzed By: MS						
Analyte	Result	Reporting Limit	Analyzed	Method Blank	BS	% Recovery	True Value QC	RPD	Qualifier
GRO C6-C10	1560	50.0	02/22/2012	ND	220	110	200	3.77	
DRO >C10-C28	3320	50.0	02/22/2012	ND	205	102	200	5.78	

Surrogate: 1-Chlorooctane 110 % 55.5-154

Surrogate: 1-Chlorooctadecane 71.4 % 57.6-158

Cardinal Laboratories

* = Accredited Analyte

PLEASE NOTE: Liability and Damages. Cardinal's liability and client's exclusive remedy for any claim arising, whether based in contract or tort, shall be limited to the amount paid by client for analyses. All claims, including those for negligence and any other cause whatsoever shall be deemed waived unless made in writing and received by Cardinal within thirty (30) days after completion of the applicable service. In no event shall Cardinal be liable for incidental or consequential damages, including, without limitation, business interruptions, loss of use, or loss of profits incurred by client, its subsidiaries, affiliates or successors arising out of or related to the performance of the services hereunder by Cardinal, regardless of whether such claim is based upon any of the above stated reasons or otherwise. Results relate only to the samples identified above. This report shall not be reproduced except in full with written approval of Cardinal Laboratories.



Celey D. Keene, Lab Director/Quality Manager

Analytical Results For:

DIAMONDBACK DISPOSAL SERVICE INC.
JUSTIN ROBERTS
P. O. BOX 2491
HOBBS NM, 88241
Fax To: (575) 392-9376

Received: 02/20/2012
Reported: 02/24/2012
Project Name: EVGSAU TRACT 2658-011
Project Number: NONE GIVEN
Project Location: BUCKEYE, NM

Sampling Date: 02/15/2012
Sampling Type: Soil
Sampling Condition: Cool & Intact
Sample Received By: Jodi Henson

Sample ID: HA 4 6" BGS (H200460-11)

BTEX 8021B			mg/kg		Analyzed By: AP				
Analyte	Result	Reporting Limit	Analyzed	Method Blank	BS	% Recovery	True Value QC	RPD	Qualifier
Benzene*	<0.050	0.050	02/23/2012	ND	1.89	94.7	2.00	3.34	
Toluene*	0.326	0.050	02/23/2012	ND	2.06	103	2.00	3.91	
Ethylbenzene*	1.28	0.050	02/23/2012	ND	2.09	105	2.00	3.94	
Total Xylenes*	2.14	0.150	02/23/2012	ND	6.53	109	6.00	3.69	

Surrogate: 4-Bromofluorobenzene (PIL) 133 % 64.4-134

Chloride, SM4500Cl-B			mg/kg		Analyzed By: HM				
Analyte	Result	Reporting Limit	Analyzed	Method Blank	BS	% Recovery	True Value QC	RPD	Qualifier
Chloride	<16.0	16.0	02/22/2012	ND	432	108	400	3.77	

TPH 8015M			mg/kg		Analyzed By: MS				
Analyte	Result	Reporting Limit	Analyzed	Method Blank	BS	% Recovery	True Value QC	RPD	Qualifier
GRO C6-C10	151	50.0	02/22/2012	ND	220	110	200	3.77	
DRO >C10-C28	231	50.0	02/22/2012	ND	205	102	200	5.78	

Surrogate: 1-Chlorooctane 85.0 % 55.5-154

Surrogate: 1-Chlorooctadecane 79.0 % 57.6-158

Cardinal Laboratories

*=Accredited Analyte

PLEASE NOTE: Liability and Damages. Cardinal's liability and client's exclusive remedy for any claim arising, whether based in contract or tort, shall be limited to the amount paid by client for analyses. All claims, including those for negligence and any other cause whatsoever shall be deemed waived unless made in writing and received by Cardinal within thirty (30) days after completion of the applicable service. In no event shall Cardinal be liable for incidental or consequential damages, including, without limitation, business interruptions, loss of use, or loss of profits incurred by client, its subsidiaries, affiliates or successors arising out of or related to the performance of the services hereunder by Cardinal, regardless of whether such claim is based upon any of the above stated reasons or otherwise. Results relate only to the samples identified above. This report shall not be reproduced except in full with written approval of Cardinal Laboratories.



Celey D. Keene, Lab Director/Quality Manager

Analytical Results For:

 DIAMONDBACK DISPOSAL SERVICE INC.
 JUSTIN ROBERTS
 P. O. BOX 2491
 HOBBS NM, 88241
 Fax To: (575) 392-9376

 Received: 02/20/2012
 Reported: 02/24/2012
 Project Name: EVGSAU TRACT 2658-011
 Project Number: NONE GIVEN
 Project Location: BUCKEYE, NM

 Sampling Date: 02/15/2012
 Sampling Type: Soil
 Sampling Condition: Cool & Intact
 Sample Received By: Jodi Henson

Sample ID: HA 4 12" BGS (H200460-12)

BTX 80218			mg/kg		Analyzed By: AP			S-04		
Analyte	Result	Reporting Limit	Analyzed	Method Blank	BS	% Recovery	True Value QC	RPD	Qualifier	
Benzene*	<0.050	0.050	02/23/2012	ND	1.89	94.7	2.00	3.34		
Toluene*	0.217	0.050	02/23/2012	ND	2.06	103	2.00	3.91		
Ethylbenzene*	1.42	0.050	02/23/2012	ND	2.09	105	2.00	3.94		
Total Xylenes*	3.00	0.150	02/23/2012	ND	6.53	109	6.00	3.69		

Surrogate: 4-Bromofluorobenzene (PIL) 154 % 64.4-134

Chloride, SM4500Cl-B			mg/kg					Analyzed By: HM	
Analyte	Result	Reporting Limit	Analyzed	Method Blank	BS	% Recovery	True Value QC	RPD	Qualifier
Chloride	208	16.0	02/22/2012	ND	432	108	400	3.77	

TPH 8015M			mg/kg					Analyzed By: MS	
Analyte	Result	Reporting Limit	Analyzed	Method Blank	BS	% Recovery	True Value QC	RPD	Qualifier
GRO C6-C10	127	50.0	02/22/2012	ND	220	110	200	3.77	
DRO >C10-C28	402	50.0	02/22/2012	ND	205	102	200	5.78	

Surrogate: 1-Chlorooctane 81.1 % 55.5-154

Surrogate: 1-Chlorooctadecane 75.7 % 57.6-158

Cardinal Laboratories

* = Accredited Analyte

PLEASE NOTE: Liability and Damages. Cardinal's liability and client's exclusive remedy for any claim arising, whether based in contract or tort, shall be limited to the amount paid by client for analyses. All claims, including those for negligence and any other cause whatsoever shall be deemed waived unless made in writing and received by Cardinal within thirty (30) days after completion of the applicable service. In no event shall Cardinal be liable for incidental or consequential damages, including, without limitation, business interruptions, loss of use, or loss of profits incurred by client, its subsidiaries, affiliates or successors arising out of or related to the performance of the services hereunder by Cardinal, regardless of whether such claim is based upon any of the above stated reasons or otherwise. Results relate only to the samples identified above. This report shall not be reproduced except in full with written approval of Cardinal Laboratories.



Celey D. Keene, Lab Director/Quality Manager

Analytical Results For:

DIAMONDBACK DISPOSAL SERVICE INC.
JUSTIN ROBERTS
P. O. BOX 2491
HOBBS NM, 88241
Fax To: (575) 392-9376

Received:	02/20/2012	Sampling Date:	02/15/2012
Reported:	02/24/2012	Sampling Type:	Soil
Project Name:	EVGSAU TRACT 2658-011	Sampling Condition:	Cool & Intact
Project Number:	NONE GIVEN	Sample Received By:	Jodi Henson
Project Location:	BUCKEYE, NM		

Sample ID: HA 4 18" BGS (H200460-13)

BTX 8021B		mg/kg		Analyzed By: AP					
Analyte	Result	Reporting Limit	Analyzed	Method Blank	BS	% Recovery	True Value QC	RPD	Qualifier
Benzene*	<0.050	0.050	02/23/2012	ND	1.89	94.7	2.00	3.34	
Toluene*	<0.050	0.050	02/23/2012	ND	2.06	103	2.00	3.91	
Ethylbenzene*	<0.050	0.050	02/23/2012	ND	2.09	105	2.00	3.94	
Total Xylenes*	<0.150	0.150	02/23/2012	ND	6.53	109	6.00	3.69	

Surrogate: 4-Bromofluorobenzene (PIL) 115 % 64.4-134

Chloride, SM4500Cl-B		mg/kg		Analyzed By: HM					
Analyte	Result	Reporting Limit	Analyzed	Method Blank	BS	% Recovery	True Value QC	RPD	Qualifier
Chloride	112	16.0	02/22/2012	ND	432	108	400	3.77	

TPH 8015M		mg/kg		Analyzed By: MS					
Analyte	Result	Reporting Limit	Analyzed	Method Blank	BS	% Recovery	True Value QC	RPD	Qualifier
GRO C6-C10	56.9	50.0	02/22/2012	ND	220	110	200	3.77	
DRO >C10-C28	190	50.0	02/22/2012	ND	205	102	200	5.78	

Surrogate: 1-Chlorooctane 77.5 % 55.5-154

Surrogate: 1-Chlorooctadecane 74.0 % 57.6-158

Cardinal Laboratories

*=Accredited Analyte

PLEASE NOTE: Liability and Damages. Cardinal's liability and client's exclusive remedy for any claim arising, whether based in contract or tort, shall be limited to the amount paid by client for analyses. All claims, including those for negligence and any other cause whatsoever shall be deemed waived unless made in writing and received by Cardinal within thirty (30) days after completion of the applicable service. In no event shall Cardinal be liable for incidental or consequential damages, including, without limitation, business interruptions, loss of use, or loss of profits incurred by client, its subsidiaries, affiliates or successors arising out of or related to the performance of the services hereunder by Cardinal, regardless of whether such claim is based upon any of the above stated reasons or otherwise. Results relate only to the samples identified above. This report shall not be reproduced except in full with written approval of Cardinal Laboratories.



Celey D. Keene, Lab Director/Quality Manager

Notes and Definitions

- S-04 The surrogate recovery for this sample is outside of established control limits due to a sample matrix effect.
- ND Analyte NOT DETECTED at or above the reporting limit
- RPD Relative Percent Difference
- ** Samples not received at proper temperature of 6°C or below.
- *** Insufficient time to reach temperature.
- Chloride by SM4500Cl-B does not require samples be received at or below 6°C
- Samples reported on an as received basis (wet) unless otherwise noted on report

Cardinal Laboratories

* = Accredited Analyte

PLEASE NOTE: Liability and Damages. Cardinal's liability and client's exclusive remedy for any claim arising, whether based in contract or tort, shall be limited to the amount paid by client for analyses. All claims, including those for negligence and any other cause whatsoever shall be deemed waived unless made in writing and received by Cardinal within thirty (30) days after completion of the applicable service. In no event shall Cardinal be liable for incidental or consequential damages, including, without limitation, business interruptions, loss of use, or loss of profits incurred by client, its subsidiaries, affiliates or successors arising out of or related to the performance of the services hereunder by Cardinal, regardless of whether such claim is based upon any of the above stated reasons or otherwise. Results relate only to the samples identified above. This report shall not be reproduced except in full with written approval of Cardinal Laboratories.



Celey D. Keene, Lab Director/Quality Manager

10A 2

CHAIN-OF-CUSTODY AND ANALYSIS REQUEST

101 East Marland, Hobbs, NM 88240
(575) 393-2326 FAX (575) 393-2476

Company Name: <u>Diamondback Disposal Serv. Inc.</u>				BILL TO				ANALYSIS REQUEST																			
Project Manager: <u>Justin Roberts</u>				P.O. #:																							
Address: <u>P.O. Box 2491</u>				Company:																							
City: <u>Hobbs</u> State: <u>NM</u> Zip: <u>88241</u>				Attn:																							
Phone #: <u>575-392-9996</u> Fax #: <u>575-392-9336</u>				Address:																							
Project #: <u>N/A</u> Project Owner: <u>COPC</u>				City:																							
Project Name: <u>EVG SAN Tract 2658-011</u>				State: Zip:																							
Project Location: <u>Buckeye</u>				Phone #:																							
Sampler Name: <u>Justin Roberts</u>				Fax #:																							
FOR LAB USE ONLY						MATRIX		PRESERV.		SAMPLING																	
Lab I.D.	Sample I.D.	(3) RAB OR (C) COMP.	# CONTAINERS	GROUNDWATER	WASTEWATER	SOIL	OIL	SLUDGE	OTHER:	ACID/BASE:	ICE / COOL	OTHER:	DATE	TIME													
<u>H2000460</u>															<u>TPH</u>	<u>BTEX</u>	<u>CL</u>										
1	HA2 SURFACE	1	1			X							2-15-12	12:30	X	X	X										
2	HA2 SURFACE													12:35													
3	HA2 6" BG													12:40													
4	HA2 12" BG													12:45													
5	HA2 18" BG													12:49													
6	HA3 SURFACE													1:00													
7	HA3 6" BG													1:05													
8	HA3 12" BG													1:11													
9	HA3 18" BG													1:15													
10	HA4 SURFACE													1:10													

PLEASE NOTE: Liability and Damages. Cardinal's liability and client's exclusive remedy for any claim arising whether based in contract or tort, shall be limited to the amount paid by the client for the analyses. All claims, including those for negligence and any other cause whatsoever shall be deemed waived unless made in writing and received by Cardinal within 30 days after completion of the applicable service. In no event shall Cardinal be liable for incidental or consequential damages, including without limitation, business interruptions, loss of use, or loss of profits incurred by client, its subsidiaries, affiliates or successors arising out of or related to the performance of services hereunder by Cardinal, regardless of whether such claim is based upon any of the above stated reasons or otherwise.

Relinquished By: <u>[Signature]</u>	Date: <u>2-20-12</u>	Received By: <u>[Signature]</u>	Phone Result: <input type="checkbox"/> Yes <input type="checkbox"/> No	Add'l Phone #:
Relinquished By:	Date:	Received By:	Fax Result: <input type="checkbox"/> Yes <input type="checkbox"/> No	Add'l Fax #:
Delivered By: (Circle One) Sampler - UPS - Bus - Other: <u>50</u>			REMARKS:	
Sample Condition Cool <input type="checkbox"/> Yes <input type="checkbox"/> No Intact <input type="checkbox"/> Yes <input type="checkbox"/> No			CHECKED BY: <u>[Signature]</u>	



2 of 2

CHAIN-OF-CUSTODY AND ANALYSIS REQUEST

101 East Marland, Hobbs, NM 88240
(575) 393-2326 FAX (575) 393-2476

Company Name: <u>Diamondback Disposal Serv. Inc</u>				BILL TO				ANALYSIS REQUEST																																	
Project Manager: <u>Justin Roberts</u>				P.O. #:																																					
Address: <u>P.O. Box 2491</u>				Company:																																					
City: <u>Hobbs</u> State: <u>NM</u> Zip: <u>88241</u>				Attn:																																					
Phone #: <u>575-392-9996</u> Fax #: <u>575-392-9376</u>				Address:																																					
Project #: <u>N/A</u> Project Owner: <u>COPC</u>				City:																																					
Project Name: <u>EVGSAU Tract 2459-011</u>				State: Zip:																																					
Project Location: <u>BookeYE</u>				Phone #:																																					
Sampler Name: <u>Justin Roberts</u>				Fax #:																																					
FOR LAB USE ONLY						MATRIX		PRESERV.		SAMPLING																															
Lab I.D.		Sample I.D.		(G)RAB OR (C)OMP		# CONTAINERS		GROUNDWATER		WASTEWATER		SOIL		OIL		SLUDGE		OTHER		ACID/BASE		ICE / COOL		OTHER		DATE		TIME													
H2004100		11 HAY 6" BGS		G 2		X																				2-15-12		1:14													
		12 HAY 12" BGS		G 2		Y																				2-15-12		1:16													
		13 HAY 18" BGS		G 2		Y																				2-15-12		1:25													

PLEASE NOTE: Liability and Damages. Cardinal's liability and client's exclusive remedy for any claim arising whether based in contract or tort, shall be limited to the amount paid by the client for the analyses. All claims including those for negligence and any other cause whatsoever shall be deemed waived unless made in writing and received by Cardinal within 30 days after completion of the applicable service. In no event shall Cardinal be liable for incidental or consequential damages, including without limitation, business interruptions, loss of use, or loss of profits incurred by client, its subsidiaries, affiliates or successors arising out of or related to the performance of services hereunder by Cardinal, regardless of whether such claim is based upon any of the above stated reasons or otherwise.

Relinquished By: <u>Justin Roberts</u>		Date: <u>2-20-12</u>		Received By: <u>Jodi Benson</u>		Phone Result: <input type="checkbox"/> Yes <input type="checkbox"/> No		Add'l Phone #:	
Relinquished By:		Time: <u>4:00</u>		Received By:		Fax Result: <input type="checkbox"/> Yes <input type="checkbox"/> No		Add'l Fax #:	
Delivered By: (Circle One)		Date:		Time:		REMARKS:			
Sampler - UPS - Bus - Other:		5°C		Sample Condition		CHECKED BY: (Initials)			
		A26		<input checked="" type="checkbox"/> Cool <input type="checkbox"/> Intact		<u>JB</u>			
				<input type="checkbox"/> Yes <input type="checkbox"/> No					

† Cardinal cannot accept verbal changes. Please fax written changes to 505-393-2476

District I
1625 N. French Dr., Hobbs, NM 88240
District II
1301 W. Grand Avenue, Artesia, NM 88210
District III
1000 Rio Brazos Road, Aztec, NM 87410
District IV
1220 S. St. Francis Dr., Santa Fe, NM 87505

State of New Mexico
Energy Minerals and Natural Resources
Oil Conservation Division
1220 South St. Francis Dr.
Santa Fe, NM 87505

Form C-141
Revised October 10, 2003

Submit 2 Copies to appropriate
District Office in accordance
with Rule 116 on back
side of form

Release Notification and Corrective Action

OPERATOR

☒ Initial Report ☐ Final Report

Name of Company	ConocoPhillips Company	Contact	John W. Gates
Address	3300 North A St. Bldg 6, Midland, TX 79705-5406	Telephone No.	505.391.3158
Facility Name	EVGSAU 2658-011	Facility Type	Oil and Gas
Surface Owner	Giles Lee	Mineral Owner	State Of New Mexico
		Lease No	300250287500

LOCATION OF RELEASE

Unit Letter	Section	Township	Range	Feet from the	North/South Line	Feet from the	East/West Line	County
K	26	17S	35E					Lea

Latitude

Longitude

NATURE OF RELEASE

Type of Release	Volume of Release	Volume Recovered
Crude Oil	10bbl (10oil, 0water)	(3oil, 0water)
Source of Release	Date and Hour of Occurrence	Date and Hour of Discovery
Well surface casing	01/04/12 1530	01/04/12 1615
Was Immediate Notice Given?	If YES, To Whom?	
<input type="checkbox"/> Yes <input type="checkbox"/> No <input checked="" type="checkbox"/> Not Required		
By Whom?	Date and Hour	
Was a Watercourse Reached?	If YES, Volume Impacting the Watercourse.	
<input type="checkbox"/> Yes <input checked="" type="checkbox"/> No		

If a Watercourse was Impacted, Describe Fully.*

Describe Cause of Problem and Remedial Action Taken.*

Release was caused by well surface casing failure due to suspected internal/external corrosion . Workover rig was summed and rigged up on well to replace failed casing.

Describe Area Affected and Cleanup Action Taken.*

100' X 140' X .5" area of well pad and pasture land. Vacuum truck was called and 3 bbls of crude oil was recovered. Majority of release was in the form of a spray.

I hereby certify that the information given above is true and complete to the best of my knowledge and understand that pursuant to NMOCD rules and regulations all operators are required to report and/or file certain release notifications and perform corrective actions for releases which may endanger public health or the environment. The acceptance of a C-141 report by the NMOCD marked as "Final Report" does not relieve the operator of liability should their operations have failed to adequately investigate and remediate contamination that pose a threat to ground water, surface water, human health or the environment. In addition, NMOCD acceptance of a C-141 report does not relieve the operator of responsibility for compliance with any other federal, state, or local laws and/or regulations.

Signature:		OIL CONSERVATION DIVISION	
Printed Name: John W. Gates		Approved by District Supervisor:	
Title: HSER Lead		Approval Date:	Expiration Date:
E-mail Address: John.W.Gates@conocophillips.com		Conditions of Approval:	
Date: 01/06/12 Phone: 505.391.3158		Attached <input type="checkbox"/>	

- Attach Additional Sheets If Necessary