

8/17/2016 DATE IN	SUSPENSE	ENGINEER <i>MAAM</i>	8/18/2016 LOGGED IN	CTB TYPE	PMAAM 1623 4485 APP NO.
----------------------	----------	----------------------	------------------------	-------------	----------------------------

ABOVE THIS LINE FOR DIVISION USE ONLY

NEW MEXICO OIL CONSERVATION DIVISION

- Engineering Bureau -

1220 South St. Francis Drive, Santa Fe, NM 87505



ADMINISTRATIVE APPLICATION CHECKLIST

THIS CHECKLIST IS MANDATORY FOR ALL ADMINISTRATIVE APPLICATIONS FOR EXCEPTIONS TO DIVISION RULES AND REGULATIONS WHICH REQUIRE PROCESSING AT THE DIVISION LEVEL IN SANTA FE

Application Acronyms:

[NSL-Non-Standard Location] [NSP-Non-Standard Proration Unit] [SD-Simultaneous Dedication]
[DHC-Downhole Commingling] [CTB-Lease Commingling] [PLC-Pool/Lease Commingling]
[PC-Pool Commingling] [OLS - Off-Lease Storage] [OLM-Off-Lease Measurement]
[WFX-Waterflood Expansion] [PMX-Pressure Maintenance Expansion]
[SWD-Salt Water Disposal] [IPI-Injection Pressure Increase]
[EOR-Qualified Enhanced Oil Recovery Certification] [PPR-Positive Production Response]

[1] TYPE OF APPLICATION - Check Those Which Apply for [A]

- ☐ [A] Location - Spacing Unit - Simultaneous Dedication
☐ NSL ☐ NSP ☐ SD

Check One Only for [B] or [C]

- ☐ [B] Commingling - Storage - Measurement
☐ DHC ☒ CTB ☐ PLC ☐ PC ☐ OLS ☐ OLM

- ☐ [C] Injection - Disposal - Pressure Increase - Enhanced Oil Recovery
☐ WFX ☐ PMX ☐ SWD ☐ IPI ☐ EOR ☐ PPR

- ☐ [D] Other: Specify _____

[2] NOTIFICATION REQUIRED TO: - Check Those Which Apply, or ☐ Does Not Apply

- ☒ [A] Working, Royalty or Overriding Royalty Interest Owners
☒ [B] Offset Operators, Leaseholders or Surface Owner
☐ [C] Application is One Which Requires Published Legal Notice
☒ [D] Notification and/or Concurrent Approval by BLM or SLO
U.S. Bureau of Land Management - Commissioner of Public Lands, State Land Office
☒ [E] For all of the above, Proof of Notification or Publication is Attached, and/or.
☐ [F] Waivers are Attached

[3] SUBMIT ACCURATE AND COMPLETE INFORMATION REQUIRED TO PROCESS THE TYPE OF APPLICATION INDICATED ABOVE.

[4] **CERTIFICATION:** I hereby certify that the information submitted with this application for administrative approval is **accurate** and **complete** to the best of my knowledge. I also understand that **no action** will be taken on this application until the required information and notifications are submitted to the Division.

Note: Statement must be completed by an individual with managerial and/or supervisory capacity.

CARIE STOKER
Print or Type Name

Carie Stoker
Signature

Regulatory Affairs Coordinator
Title

4/15/16
Date

carie@stokeroilfield.com
E-mail Address

*-CTB 800
-Remnant Oil Operatrng
370522*

*WEL
-Finestate
30-015-24973
-Wilsonstate
30-015-24991
Pod*

*-Turkey Track
TRUCKS-GRV-68-5A
61020*

District I
1625 N. French Drive, Hobbs, NM 88240
District II
811 S. First St., Artesia, NM 88210
District III
1000 Rio Brazos Road, Aztec, NM 87410
District IV
1220 S. St Francis Dr, Santa Fe, NM
87505

State of New Mexico
Energy, Minerals and Natural Resources Department

Form C-107-B
Revised August 1, 2011

OIL CONSERVATION DIVISION
1220 S. St Francis Drive
Santa Fe, New Mexico 87505

Submit the original
application to the Santa Fe
office with one copy to the
appropriate District Office.

APPLICATION FOR SURFACE COMMINGLING (DIVERSE OWNERSHIP)

OPERATOR NAME: WS Oil & Gas Operating, LLC
OPERATOR ADDRESS: PO BOX 5375 Midland, TX 79704
APPLICATION TYPE:

☐ Pool Commingling ☒ Lease Commingling ☐ Pool and Lease Commingling ☐ Off-Lease Storage and Measurement (Only if not Surface Commingling)

LEASE TYPE: ☐ Fee ☒ State ☐ Federal

Is this an Amendment to existing Order? ☐ Yes ☒ No If "Yes", please include the appropriate Order No. _____
Have the Bureau of Land Management (BLM) and State Land office (SLO) been notified in writing of the proposed commingling
☒ Yes ☐ No

(A) POOL COMMINGLING
Please attach sheets with the following information

(1) Pool Names and Codes	Gravities / BTU of Non-Commingled Production	Calculated Gravities / BTU of Commingled Production		Calculated Value of Commingled Production	Volumes

- (2) Are any wells producing at top allowables? ☐ Yes ☐ No
(3) Has all interest owners been notified by certified mail of the proposed commingling? ☐ Yes ☐ No
(4) Measurement type: ☐ Metering ☐ Other (Specify) _____
(5) Will commingling decrease the value of production? ☐ Yes ☐ No If "yes", describe why commingling should be approved _____

(B) LEASE COMMINGLING
Please attach sheets with the following information

- (1) Pool Name and Code. 61020- TURKEY TRACK: 7 RVRS-QU-G8-SA
(2) Is all production from same source of supply? ☒ Yes ☐ No
(3) Has all interest owners been notified by certified mail of the proposed commingling? ☒ Yes ☐ No
(4) Measurement type: ☐ Metering ☒ Other (Specify) Well test method (see attached)

(C) POOL and LEASE COMMINGLING
Please attach sheets with the following information

- (1) Complete Sections A and B.

(D) OFF-LEASE STORAGE and MEASUREMENT
Please attached sheets with the following information

- (1) Is all production from same source of supply? ☐ Yes ☐ No
(2) Include proof of notice to all interest owners.

(E) ADDITIONAL INFORMATION (for all application types)
Please attach sheets with the following information

- (1) A schematic diagram of facility, including legal location.
(2) A plat with lease boundaries showing all well and facility locations. Include lease numbers if Federal or State lands are involved.
(3) Lease Names, Lease and Well Numbers, and API Numbers.

I hereby certify that the information above is true and complete to the best of my knowledge and belief.

SIGNATURE: Carie Stoker TITLE: Regulatory Affairs Coordinator DATE: 4/15/16
TYPE OR PRINT NAME Carie Stoker TELEPHONE NO.: 432.664.7659
E-MAIL ADDRESS: carie@stokeroilfield.com

BEFORE

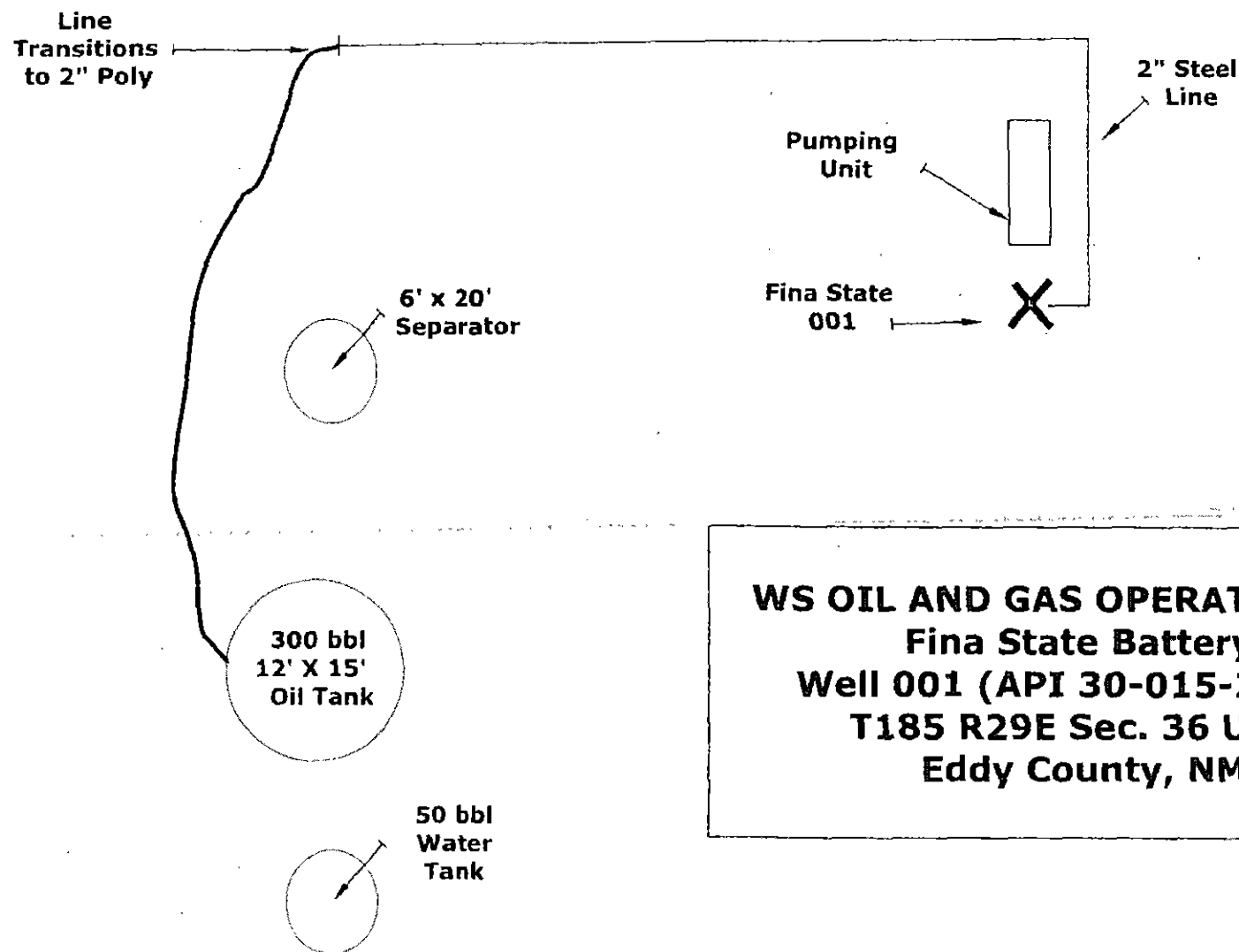

WS OIL AND GAS OPERATING, LLC
Fina State Battery
Well 001 (API 30-015-24973)
T185 R29E Sec. 36 UL: E
Eddy County, NM

BEFORE

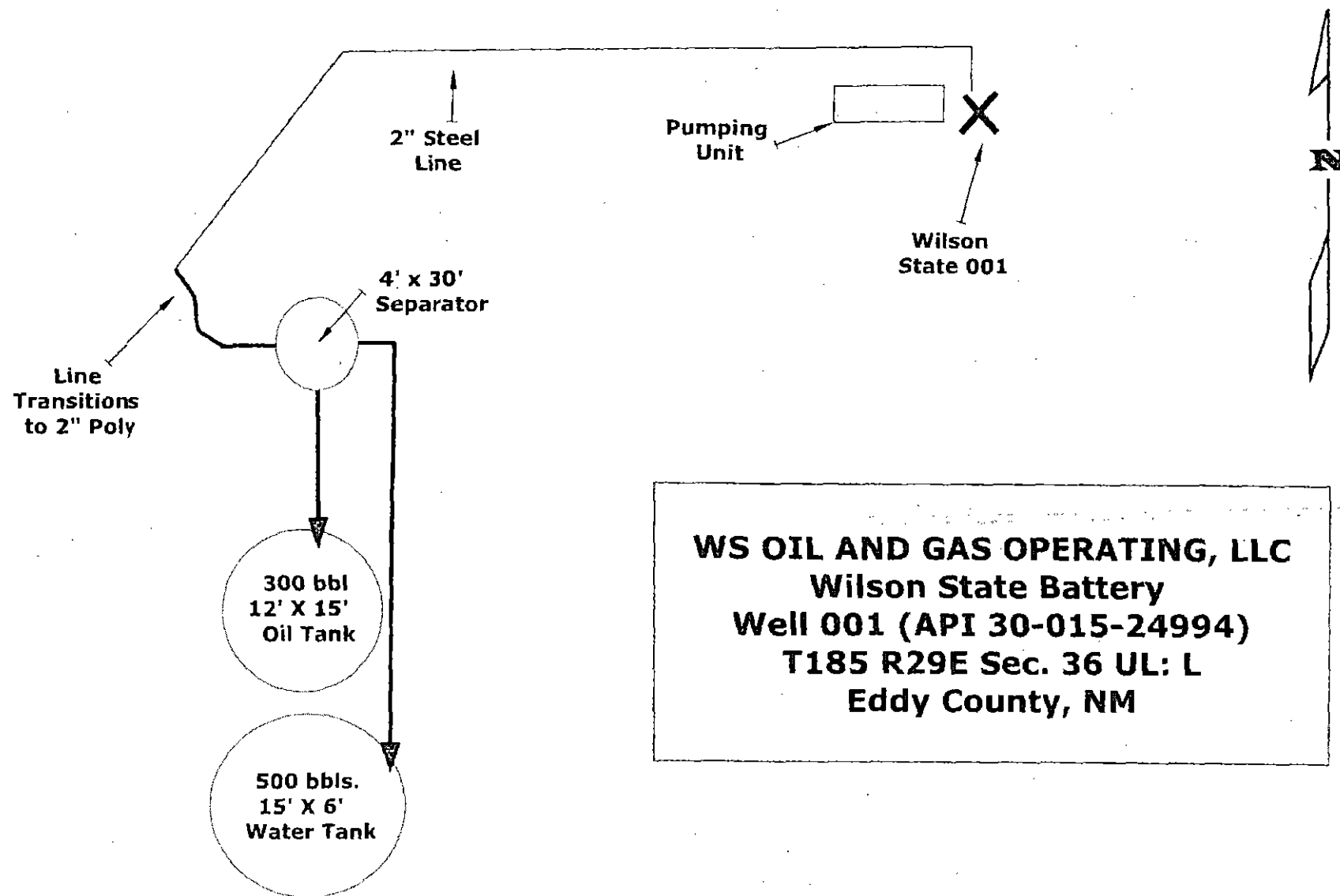

AFTER

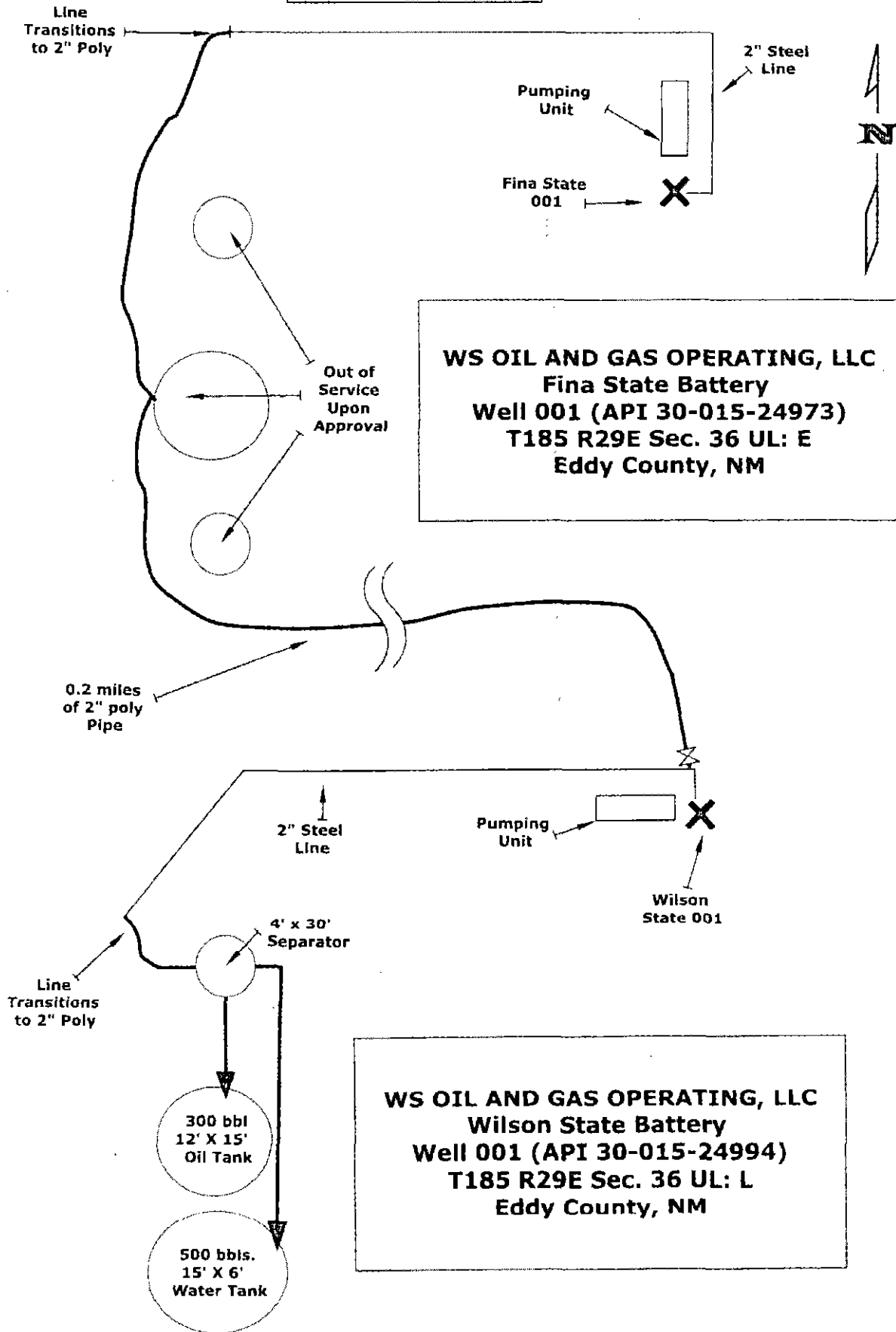

WS OIL & GAS OPERATING, LLC

Commingled Battery Testing & Allocation Procedures

Eddy County, NM

WS Oil & Gas Operating, LLC proposes the surface commingling of its wells on Wilson State Unit and one offset adjacent producing lease, the Fina State into a single Commingled Battery (the "Battery") located on the Wilson State 001 located at the SW/4 NW/4 UL-L, Section 36, Township 18S, Range 29E in Eddy County, New Mexico. The following discussion outlines the basic equipment that will be installed in the Commingled Battery, as well as the basic procedures that will be instituted to test producing wells and equitably allocate monthly oil and water production to each well based on well test results.

Battery Equipment & Vessels

A Commingled Battery permitted and constructed by WS Oil & Gas Operating, LLC with the basic equipment, vessels, and facilities in its design in order to test producing wells on a regular basis and equitably allocate oil and water production between all wells producing into the Battery. This Battery equipment will include:

- Inlet Well Header which allows the switching of each well tied into the battery from production to the portable test vessel individually
- 1 portable test tank
- A primary separator to send all of the commingled oil to the oil tank and all commingled water to the water
- At least 1 steel oil tank where total oil production is gauged and oil is sold
- 1 fiberglass water tank

Tank Gauging

Each day, each oil tank and water tank in the battery will be gauged by the WS Oil & Gas Operating, LLC pumper using a steel tapeline. The amount of oil and water is measured by using water-finding paste ("color-cut") on the steel tape line. The gauge levels of oil and water in the battery tanks are recorded in the daily field gauge report and used to calculate the total daily and monthly oil and water production volumes for the Battery. The daily battery oil and water production are sent to the WS Oil & Gas Operating, LLC – Midland, Texas office each day and are used at the end of each month to determine the total monthly battery production – oil and water production volumes.

Additionally, a record is kept of the number of producing days each month for each well. This information is recorded by the pumper each day on a monthly "Days On and Off Report" form which tracks the days on production and the days off production for each well over the course of the month. This report is sent to the WS Oil & Gas Operating, LLC – Midland, Texas office at the end of each month to be used in the allocation process.

Well Testing

Prior to each Well Test, the portable test tank is emptied using the circulating pump to move contents to the primary battery separator. The remaining volume in the portable Test Tank, if any, is gauged and color-cut to determine the oil and water volumes in the tank at the start of the Well Test.

- At the Well Header at the entry to the Battery, the well selected to be tested is switched from primary Production to the test tank by opening and closing the appropriate valves on the header manifold to route the produced fluids from the well to a portable test tank.
- Each well producing into the Battery is to be tested periodically, but no less than annually.
- The well will be left "on test" until a stabilized daily production rate is established.
- After the well has been on test, the produced fluids in the Test Tank will be gauged and color-cut to determine volumes.
- The Test Volumes of Oil and Water production from the well are recorded
- At the conclusion of each Well Test, the produced oil and water volumes in the portable Test Tank are sent to the primary separator.

Monthly Production Allocations

Each month, the total monthly battery oil and water production volumes are allocated to each producing well producing into the battery based on the well's well tests during the month and its number of producing days during the month. The monthly production allocations methodology is as follows:

- The total monthly battery production (oil and water) is determined from the daily field gauge reports from the pumper.
- The representative well test for each well is selected from the well tests run during the month. If more than one well test is ran on a well during the month and all are determined to be representative, then the arithmetic average of the individual well tests is used as the well test for the well during the month.
- For each well producing into the battery, the well test for the month is multiplied by the well's producing days during the month to calculate the well pseudo-production for the month.
- The well pseudo-production for each well is calculated and then all are summed for the month to calculate the total battery pseudo-production for the month.
- The monthly well allocation factor is then calculated for each well by dividing the well pseudo-production for the month by the total battery pseudo-production for the month. Individual allocation factors are determined for both oil and water production for each well in the Battery by this method.
- The monthly allocated production for each well is then calculated by multiplying the well's monthly well allocation factor by the total monthly battery production. Individual monthly oil and water allocated production volumes for each well in the battery are determined by this method.
- Monthly oil Sales for each well are also determined using the Monthly Well Allocation Factors and the Total Monthly Battery Oil Sales volumes for the Battery.

EXHIBIT A

DATE: Mon Feb 22, 2016
TIME: 08:51:52

HOLLYFRONTIER REFINING & MARKETING LLC
Division of Interest - Exhibit

REPORT: DC2
PAGE: 1 of 1

Lease 00017744 Sub Name FINA STATE #1
G/L Comp 66 Division 48 Period 02-2010 Username irene
Operator 069896 Name WS OIL & GAS OPERATING LLC

Owner	Name	Division Of Interest	Type Interest	Pay Code
000001	COMMISSIONER OF PUBLIC LANDS P O BOX 1148 SANTA FE, NM 87504-1148	0.18750000	RI	GS

069896	WS OIL & GAS OPERATING LLC P O BOX 5375 MIDLAND, TX 79704	0.81250000	WI	AD
--------	---	------------	----	----

Interest Total	1.00000000
----------------	------------

"THIS INFORMATION IS FURNISHED AS A COURTESY.
HOLLYFRONTIER REFINING & MARKETING LLC ASSUMES
NO LIABILITY FOR ACCURACY OR CORRECTNESS OF
THE INFORMATION HEREIN SET OUT."

DATE: Mon Feb 22, 2016
TIME: 08:50:24

HOLLYFRONTIER REFINING & MARKETING LLC
Division of Interest - Exhibit

REPORT: DC3
PAGE: 1 of 1

Lease 00019937 Sub Name WILSON STATE #1
G/L Comp 66 Division 48 Period 02-2016 Username irene
Operator 069896 Name WS OIL & GAS OPERATING LLC

Owner	Name	Division Of Interest	Type Interest	Pay Code
000001	COMMISSIONER OF PUBLIC LANDS P O BOX 1148 SANTA FE, NM 87504-1148	0.12500000	RI	GS
009995	WILSON OIL COMPANY LTD PO BOX 1297 SANTA FE, NM 87504-1297	0.05000000	OR	PA
010606	SUSAN & ELIZABETH CHUMBLEY TR SALLY LAMB CHUMBLEY TRUSTEE 5082 GAZANIA DR SAN JOSE, CA 95111-3915	0.01500000	OR	PA
010607	MILLARD S PEREODY JR PO BOX 1453 SOUTHAMPTON, NY 11969-1453	0.01900000	WI	PA
038432	REBECCA DENETTE SCOTT P O BOX 4835 SANTA FE, NM 87502	0.05000000	OR	PA
058089	ELSIE WILSON 4872 VIEJA DRIVE SANTA BARBARA, CA 93110-2045	0.03800000	WI	AC
069896	WS OIL & GAS OPERATING LLC P O BOX 5375 MIDLAND, TX 79704	0.70300000	WI	AD

Interest Total 1.00000000

"THIS INFORMATION IS FURNISHED AS A COURTESY.
HOLLYFRONTIER REFINING & MARKETING LLC ASSUMES
NO LIABILITY FOR ACCURACY OR CORRECTNESS OF
THE INFORMATION HEREIN SET OUT."

1976 9406 9181
7013 1710 0001 7406 9235

U.S. Postal Service
CERTIFIED MAIL - RECEIPT
(Domestic Mail Only; No Insurance Coverage Provided)

For delivery information visit our website at www.usps.com

SANTA FE, NM 87504

Postage	\$	42.00	Postmark Here
Certified Fee	\$	10.00	
Return Receipt Fee (Endorsement Required)	\$	10.00	
Restricted Delivery Fee (Endorsement Required)	\$	10.00	
Total Postage & Fees	\$	72.00	

03/25/2016

Sent To
WILSON OIL COMPANY LTD
P.O. BOX 1297
SANTA FE, NM 87504-1297

Sheet 1 of 1
or PO Box No.
or Street Address

1976 9406 9181
7013 1710 0001 7406 9235

U.S. Postal Service
CERTIFIED MAIL - RECEIPT
(Domestic Mail Only; No Insurance Coverage Provided)

For delivery information visit our website at www.usps.com

SANTA FE, NM 87504

Postage	\$	42.00	Postmark Here
Certified Fee	\$	10.00	
Return Receipt Fee (Endorsement Required)	\$	10.00	
Restricted Delivery Fee (Endorsement Required)	\$	10.00	
Total Postage & Fees	\$	72.00	

03/25/2016

Sent To
COMMISSION OF PUBLIC LANDS
P.O. BOX 1148
SANTA FE, NM 87504-1148

Sheet 1 of 1
or PO Box No.
or Street Address

1976 9406 9181
7013 1710 0001 7406 9235

U.S. Postal Service
CERTIFIED MAIL - RECEIPT
(Domestic Mail Only; No Insurance Coverage Provided)

For delivery information visit our website at www.usps.com

SANTA FE, NM 87502

Postage	\$	42.00	Postmark Here
Certified Fee	\$	10.00	
Return Receipt Fee (Endorsement Required)	\$	10.00	
Restricted Delivery Fee (Endorsement Required)	\$	10.00	
Total Postage & Fees	\$	72.00	

03/25/2016

Sent To
REBECCA DENETTE SCOTT
P.O. BOX 4835
SANTA FE, NM 87502

Sheet 1 of 1
or PO Box No.
or Street Address

1976 9406 9181
7013 1710 0001 7406 9235

U.S. Postal Service
CERTIFIED MAIL - RECEIPT
(Domestic Mail Only; No Insurance Coverage Provided)

For delivery information visit our website at www.usps.com

MIDLAND, TX 79704

Postage	\$	42.00	Postmark Here
Certified Fee	\$	10.00	
Return Receipt Fee (Endorsement Required)	\$	10.00	
Restricted Delivery Fee (Endorsement Required)	\$	10.00	
Total Postage & Fees	\$	72.00	

03/25/2016

Sent To
WS OIL & GAS OPERATING LLC
P.O. BOX 5375
MIDLAND, TX 79704

Sheet 1 of 1
or PO Box No.
or Street Address

1976 9406 9181
7013 1710 0001 7406 9235

U.S. Postal Service
CERTIFIED MAIL - RECEIPT
(Domestic Mail Only; No Insurance Coverage Provided)

For delivery information visit our website at www.usps.com

SAN JOSE, CA 95111

Postage	\$	42.00	Postmark Here
Certified Fee	\$	10.00	
Return Receipt Fee (Endorsement Required)	\$	10.00	
Restricted Delivery Fee (Endorsement Required)	\$	10.00	
Total Postage & Fees	\$	72.00	

03/25/2016

Sent To
SUSAN & ELIZABETH CRUMBLEY TR
SALLY LAMB CRUMBLEY TRUSTEE
5082 CAZANIA DR
SAN JOSE, CA 95111-3915

Sheet 1 of 1
or PO Box No.
or Street Address

1976 9406 9181
7013 1710 0001 7406 9235

U.S. Postal Service
CERTIFIED MAIL - RECEIPT
(Domestic Mail Only; No Insurance Coverage Provided)

For delivery information visit our website at www.usps.com

SOUTHAMPTON, NY 11969

Postage	\$	42.00	Postmark Here
Certified Fee	\$	10.00	
Return Receipt Fee (Endorsement Required)	\$	10.00	
Restricted Delivery Fee (Endorsement Required)	\$	10.00	
Total Postage & Fees	\$	72.00	

03/25/2016

Sent To
MILLARD S PEABODY JR
P.O. BOX 1453
SOUTHAMPTON, NY 11969-1453

Sheet 1 of 1
or PO Box No.
or Street Address

9226 9062 1000 0121 ETC2

U.S. Postal Service	
CERTIFIED MAIL - RECEIPT	
(Domestic Mail Only; No Insurance Coverage Provided)	
For Delivery Information Visit our Website at www.usps.com	
SANTA BARBARA, CA 93110	
Postage	\$3.75
Contract Fee	\$0.00
Return Receipt Fee (Endorsement Required)	\$0.00
Registered Delivery Fee (Endorsement Required)	\$0.00
Total Postage & Fees	\$3.75
Postmark Date	
05/27/2015	
Sent To	
SANTA BARBARA or PO Box to City State ZIP+4	
EI SIE WILSON 4872 VIEJA DRIVE SANTA BARBARA CA 93110-2045	

PS Form 3800

API	Well Name	Well Number	Type	Lease	Status	Unit Letter	Section	Township	Range	OCD Unit Letter	Current Operator
30-015-24973	FINA STATE	#001	Oil	State	Active	E	36	18S	29E	E	[370922] WS OIL AND GAS OPERATING, LLC
30-015-24994	WILSON ST	#001	Oil	State	Active	L	36	18S	29E	L	[370922] WS OIL AND GAS OPERATING, LLC

Production Summary Report

API: 30-015-24973

FINA STATE #001

Printed On: Tuesday, March 22 2016

Year	Pool	Production					Injection				
		Month	Oil(BBLS)	Gas(MCF)	Water(BBLS)	Days P/I	Water(BBLS)	Co2(MCF)	Gas(MCF)	Other	Pressure
2015	[61020] TURKEY TRACK;7 RVRS-QU-GB-SA	Nov	38	0	13	30	0	0	0	0	0
2015	[61020] TURKEY TRACK;7 RVRS-QU-GB-SA	Dec	42	0	30	31	0	0	0	0	0
2016	[61020] TURKEY TRACK;7 RVRS-QU-GB-SA	Jan	27	0	50	29	0	0	0	0	0

Printed On: Tuesday, March 22 2016

[illegible]

WS Oil & Gas Operating, LLC.

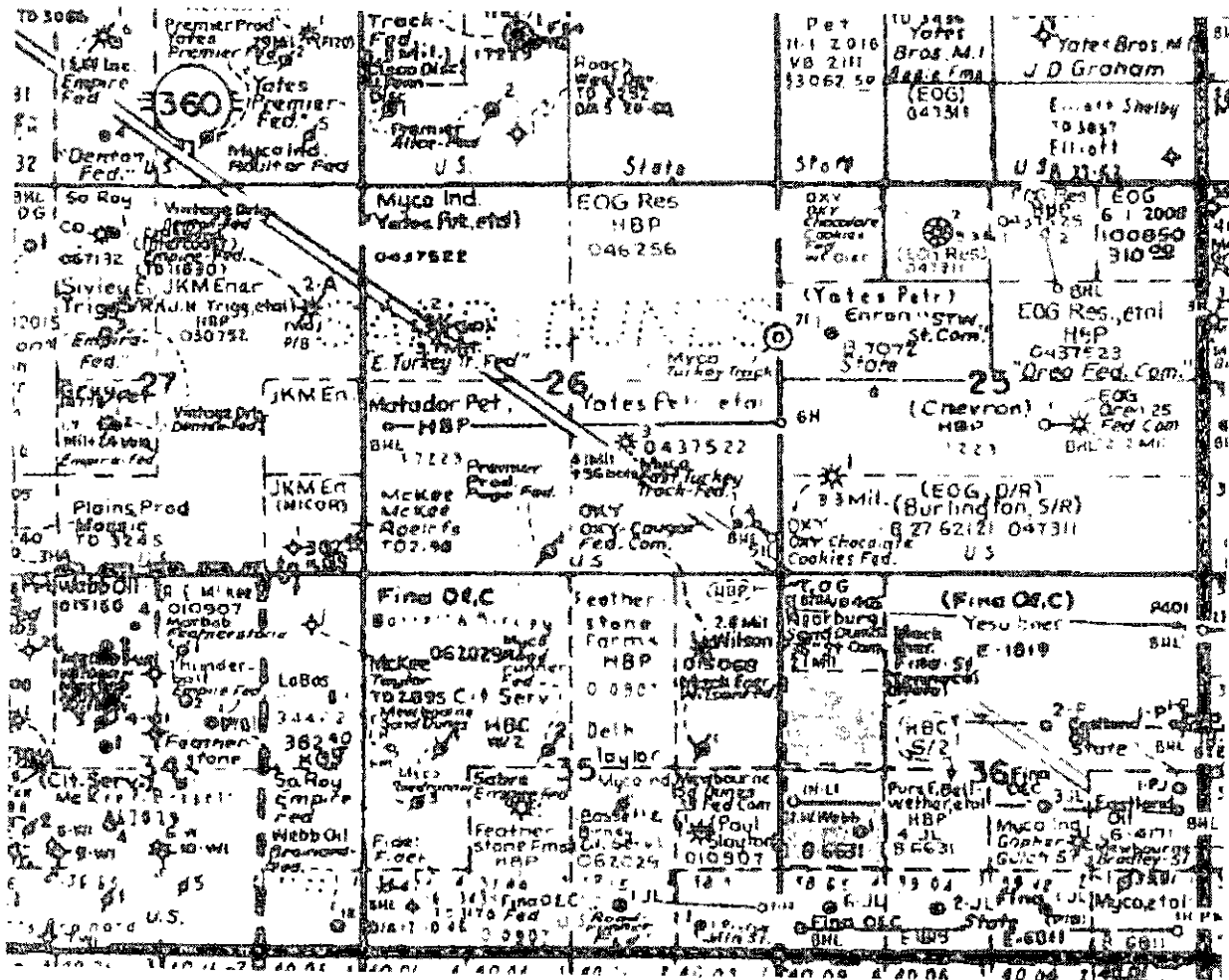
**FINA STATE**

WILSON STATE

COMMINGLING STORAGE FACILITY

LEASE BOUNDARY LINES

LEGAL LOCATION: NW/4 SW/4 UL-L, SEC 36, T18S, R29E, EDDY COUNTY, NM

March 24, 2016

To: Surface & Interest Owners:

Re: WS Oil & Gas Operating, LLC
Application for Approval of Surface Commingling
Part of Section 36, T18S, R29E
Wilson State 001, Fina State 001
Eddy County, New Mexico

Ladies and gentlemen:

Please be advised that WS Oil & Gas Operating, LLC, has requested approval for a surface commingling application. You have been identified as a surface or interest owner in the above referenced lands therefore, requiring notification of this application. Enclosed for your review, is a copy of the submitted application. Please be advised that any objections must be made in writing to the New Mexico Oil Conservation Division, 1220 S. St. Francis Drive, Santa Fe, NM 87504 within twenty (20) days of this applications filing date.

Please do not hesitate to contact us should you have any questions. Thank you for your attention to this matter.

Sincerely,



Carie Stoker
Regulatory Affairs Coordinator

August 17, 2016

State of New Mexico
Energy, Minerals and Natural Resources
Oil Conservation Division
District II
811 S. First St.
Artesia, NM 88210

RE: WS Oil & Gas Operating, LLC.
Application for Approval of Surface Commingling
Part of Section 36, T18S, R29E,
Wilson State 001, Fina State 001
Eddy County, New Mexico

Dear Sirs:

Please be advised that WS Oil & Gas, LLC has notified every individual who has been identified as owning an interest within the above described properties of WS Oil & Gas, LLC's requested approval for surface commingling application for the properties. Attached and labeled Exhibit "A" is the list of notified individuals. Enclosed for your review, is a copy of the correspondence and copies of the certified mail receipts.

Do not hesitate to contact us should you have any questions or need further data. Thank you for your attention in this matter.

Sincerely,



Carie Stoker
Regulatory Affairs Coordinator

CC: State of New Mexico
Energy, Minerals and Natural Resources
Oil Conservation Division
1220 South St. Francis Drive
Santa Fe, NM 87505

Attachment

Enclosures



Aubrey Dunn
COMMISSIONER

State of New Mexico
Commissioner of Public Lands

310 OLD SANTA FE TRAIL
P.O. BOX 1148

SANTA FE, NEW MEXICO 87504-1148

COMMISSIONER'S OFFICE

Phone (505) 827-5760

Fax (505) 827-5766

www.nmstatelands.org

March 31, 2016

WS OIL AND GAS OPERATING, LLC
PO BOX 5375
MIDLAND, TX 79704

Attention: Ms. Carrie Stoker

Re: Request Surface Commingle
Wilson State Central Tank Battery
Sec 36-18S-29E
Fina State #1 API #30-015-24973 (VB-0405-3)
Wilson State #1 API #30-015-24994 (BO-6631-36)
Turkey Track: Seven Rivers Queen Grayburg San Andres Pool #61020
Eddy County, New Mexico

Dear Ms. Stoker:

We are in receipt of your amended application requesting to surface commingle the above captioned wells into a central tank battery at Wilson State Battery located in the NW4SW4 Sec 36-18S-29E Lease BO-6631-36.

Since it appears that all the New Mexico Oil Conservation Division's rules and regulations have been complied with, and there will be no loss of revenue to the State of New Mexico as a result of your proposed operation, your request is hereby approved. Our approval is subject to like approval by the New Mexico Oil Conservation Division. Please submit a copy of the NMOCD's approval to this office.

Our approval does not constitute the granting of any right-of-way or construction rights not granted by the lease instrument. Our approval is subject to WS Oil and Gas Operating, LLC submitting a business lease application for the tank battery site located in the NW4SW4 of Sec 36-18S-29E.

Please submit a \$30.00 dollar filing fee. When you provide a check as payment, you authorize the State of New Mexico to either use information from your check to make a one-time electronic fund transfer from your account or to process the payment as a check transaction.

If you have any questions, or if we may be of further help, please contact Pete Martinez at (505) 827-5791.

Respectfully,

A handwritten signature in black ink, appearing to read "Aubrey Dunn", is written over the word "Respectfully,".

AUBREY DUNN
COMMISSIONER OF PUBLIC LANDS

AD/sk

cc: Reader File

OCD-Mr. Daniel Sanchez

**NEW MEXICO OIL CONSERVATION COMMISSION
WELL LOCATION AND ACREAGE DEDICATION PLAT**

Form C-102
Supersedes C-128
Effective 1-1-83

All distances must be from the outer boundaries of the Section.

Operator METEX PIPE & SUPPLY			Lease WILSON STATE		Well No. 1
Unit Letter L	Section 36	Township 18 SOUTH	Range 29 EAST	County EDDY	
Actual Footage Location of Well: 1650 feet from the SOUTH line and 990 feet from the WEST line					
Ground Level Elev. 3441.9	Producing Formation <i>San Andres</i>	Pool <i>Wildcat San Andres</i>	Dedicated Acreage: 40 Acres		

1. Outline the acreage dedicated to the subject well by colored pencil or hatchure marks on the plat below.
2. If more than one lease is dedicated to the well, outline each and identify the ownership thereof (both as to working interest and royalty).
3. If more than one lease of different ownership is dedicated to the well, have the interests of all owners been consolidated by communitization, unitization, force-pooling, etc?

☐ Yes ☐ No If answer is "yes," type of consolidation _____

If answer is "no," list the owners and tract descriptions which have actually been consolidated. (Use reverse side of this form if necessary.) _____

No allowable will be assigned to the well until all interests have been consolidated (by communitization, unitization, forced-pooling, or otherwise) or until a non-standard unit, eliminating such interests, has been approved by the Commission.

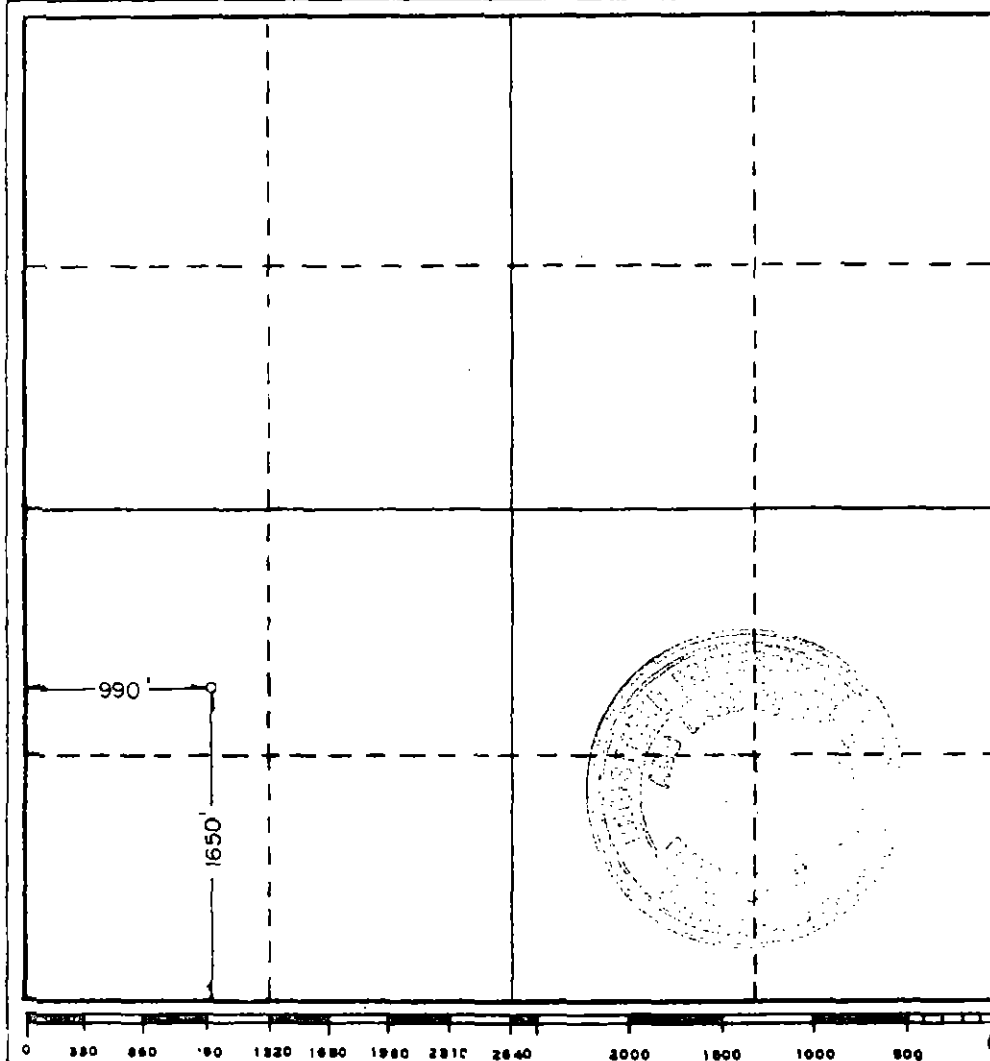

CERTIFICATION

I hereby certify that the information contained herein is true and complete to the best of my knowledge and belief.

Name

Martin Moway
MARTIN MOWAY

Position

Owner
Owner

Company

Metex Pipe & Supply
Metex Pipe & Supply

Date

8/30/84
8/30/84

I hereby certify that the well location shown on this plat was plotted from field notes of actual surveys made by me or under my supervision, and that the same is true and correct to the best of my knowledge and belief.

Date Surveyed

AUGUST 8, 1984

Registered Professional Engineer
and/or Land Surveyor

John W. West
John W. West

Certificate No. **JOHN W. WEST, 676**

RONALD J. EIDSON, 3239

**NEW MEXICO OIL CONSERVATION COMMISSION
WELL LOCATION AND ACREAGE DEDICATION PLAT**

Form C-102
Supersedes C-128
Effective 1-1-65

All distances must be from the outer boundaries of the Section

Operator Tenneco Oil Co.			Lease HL 36			Well No. 5		
Unit Letter E	Section 36	Township 18 South	Range 29 East	County Eddy				
Actual Footage Location of Well: 2310 feet from the north line and 990 feet from the west line								
Ground Level Elev. 3449.4'	Producing Formation Morrow		Pool Unsat. Teo Queen, So (Grayburg)			Dedicated Acreage: 40 Acres		

1. Outline the acreage dedicated to the subject well by colored pencil or hatchure marks on the plat below.
2. If more than one lease is dedicated to the well, outline each and identify the ownership thereof (both as to working interest and royalty).
3. If more than one lease of different ownership is dedicated to the well, have the interests of all owners been consolidated by communitization, unitization, force-pooling, etc?

☐ Yes ☐ No If answer is "yes," type of consolidation _____

If answer is "no," list the owners and tract descriptions which have actually been consolidated. (Use reverse side of this form if necessary.) _____

No allowable will be assigned to the well until all interests have been consolidated (by communitization, unitization, forced-pooling, or otherwise) or until a non-standard unit, eliminating such interests, has been approved by the Commission.

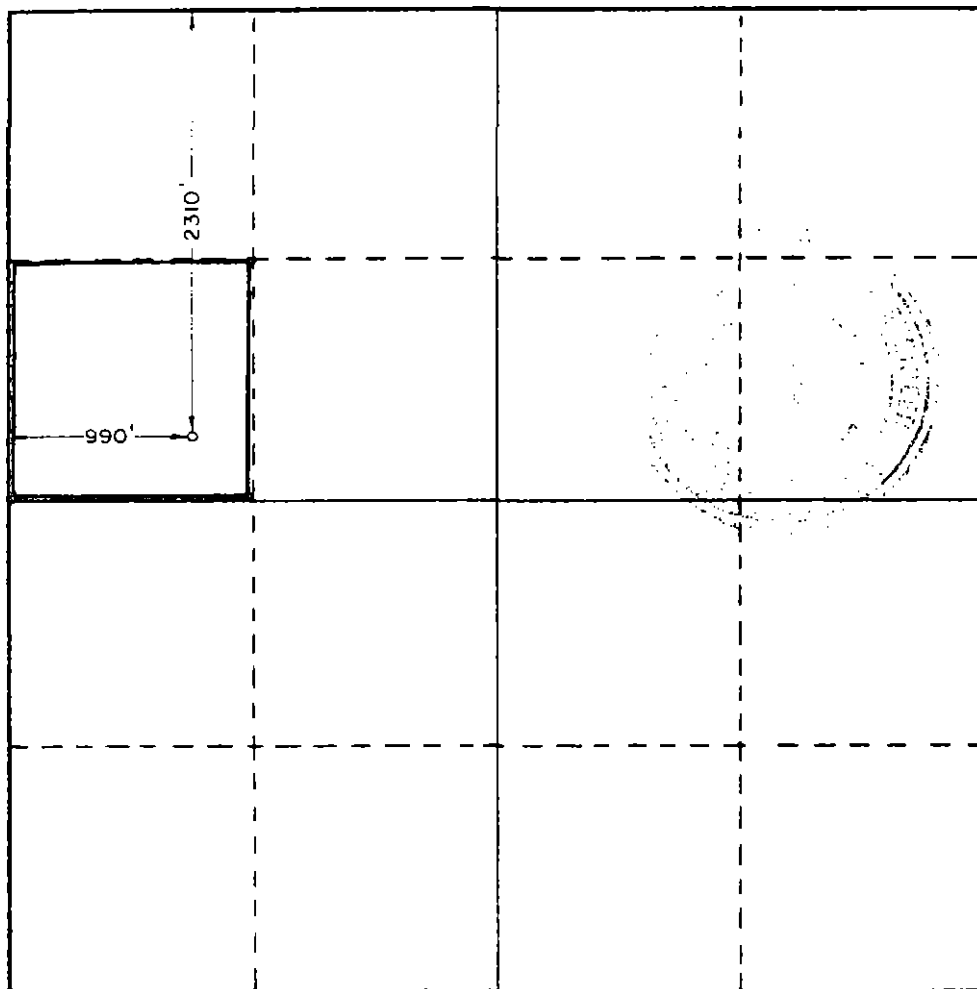

CERTIFICATION

I hereby certify that the information contained herein is true and complete to the best of my knowledge and belief.

Name *David B. Leary*
 Position *Geological Engineer*
 Company *Tenneco Oil Company*
 Date *23 August 1984*

I hereby certify that the well location shown on this plat was plotted from field notes of actual surveys made by me or under my supervision, and that the same is true and correct to the best of my knowledge and belief.

Date Surveyed
August 14, 1984
 Registered Professional Engineer
 and/or Land Surveyor

John W. West
 Certificate No. *JOHN W. WEST, 676*
RONALD J. EIDSON, 3239

Production Summary Report

API: 30-015-24994

WILSON ST #001

Printed On: Tuesday, August 23 2016

		Production				
Year	Pool	Month	Oil(BBLS)	Gas(MCF)	Water(BBLS)	Days P/I
2015	[61020] TURKEY TRACK;7 RVRS-QU-GB-SA	Dec	0	0	0	0
2016	[61020] TURKEY TRACK;7 RVRS-QU-GB-SA	Jan	0	0	0	0
2016	[61020] TURKEY TRACK;7 RVRS-QU-GB-SA	Feb	38	0	312	29
2016	[61020] TURKEY TRACK;7 RVRS-QU-GB-SA	Mar	70	0	520	30
2016	[61020] TURKEY TRACK;7 RVRS-QU-GB-SA	Apr	30	0	446	31
2016	[61020] TURKEY TRACK;7 RVRS-QU-GB-SA	May	76	0	454	30

Production Summary Report**API: 30-015-24973****FINA STATE #001****Printed On: Tuesday, August 23 2016**

		Production				
Year	Pool	Month	Oil(BBLS)	Gas(MCF)	Water(BBLS)	Days P/I
2015	[61020] TURKEY TRACK;7 RVRs-QU-GB-SA	Dec	42	0	30	31
2016	[61020] TURKEY TRACK;7 RVRs-QU-GB-SA	Jan	27	0	50	29
2016	[61020] TURKEY TRACK;7 RVRs-QU-GB-SA	Feb	58	0	48	29
2016	[61020] TURKEY TRACK;7 RVRs-QU-GB-SA	Mar	83	0	48	30
2016	[61020] TURKEY TRACK;7 RVRs-QU-GB-SA	Apr	2	0	39	31
2016	[61020] TURKEY TRACK;7 RVRs-QU-GB-SA	May	1	0	42	30