

DATE IN 3/21/2017	SUSPENSE	ENGINEER MAM	LOGGED IN 3/21/2017	TYPE DLC	APP NO PMAM1706033165
----------------------	----------	-----------------	------------------------	-------------	--------------------------

ABOVE THIS LINE FOR DIVISION USE ONLY

NEW MEXICO OIL CONSERVATION DIVISION

- Engineering Bureau -

1220 South St. Francis Drive, Santa Fe, NM 87505



ADMINISTRATIVE APPLICATION CHECKLIST

THIS CHECKLIST IS MANDATORY FOR ALL ADMINISTRATIVE APPLICATIONS FOR EXCEPTIONS TO DIVISION RULES AND REGULATIONS WHICH REQUIRE PROCESSING AT THE DIVISION LEVEL IN SANTA FE

Application Acronyms:

[NSL-Non-Standard Location] [NSP-Non-Standard Proration Unit] [SD-Simultaneous Dedication]
 [DHC-Downhole Commingling] [CTB-Lease Commingling] [PLC-Pool/Lease Commingling]
 [PC-Pool Commingling] [OLS - Off-Lease Storage] [OLM-Off-Lease Measurement]
 [WFX-Waterflood Expansion] [PMX-Pressure Maintenance Expansion]
 [SWD-Salt Water Disposal] [IPI-Injection Pressure Increase]
 [EOR-Qualified Enhanced Oil Recovery Certification] [PPR-Positive Production Response]

[1] TYPE OF APPLICATION - Check Those Which Apply for [A]

[A] Location - Spacing Unit - Simultaneous Dedication
☐ NSL ☐ NSP ☐ SD

Check One Only for [B] or [C]

[B] Commingling - Storage - Measurement
☐ DHC ☐ CTB ☒ PLC ☐ PC ☐ OLS ☐ OLM

[C] Injection - Disposal - Pressure Increase - Enhanced Oil Recovery
☐ WFX ☐ PMX ☐ SWD ☐ IPI ☐ EOR ☐ PPR

[D] Other: Specify _____

[2] NOTIFICATION REQUIRED TO: - Check Those Which Apply, or Does Not Apply

[A] ☒ Working, Royalty or Overriding Royalty Interest Owners

[B] ☐ Offset Operators, Leaseholders or Surface Owner

[C] ☐ Application is One Which Requires Published Legal Notice

[D] ☒ Notification and/or Concurrent Approval by BLM or SLO
 U.S. Bureau of Land Management - Commissioner of Public Lands, State Land Office

[E] ☒ For all of the above, Proof of Notification or Publication is Attached, and/or,

[F] ☐ Waivers are Attached

[3] SUBMIT ACCURATE AND COMPLETE INFORMATION REQUIRED TO PROCESS THE TYPE OF APPLICATION INDICATED ABOVE.

[4] **CERTIFICATION:** I hereby certify that the information submitted with this application for administrative approval is **accurate and complete** to the best of my knowledge. I also understand that **no action** will be taken on this application until the required information and notifications are submitted to the Division.

Note: Statement must be completed by an individual with managerial and/or supervisory capacity.

Cherylene L. Weston
 Print or Type Name

Cherylene L. Weston
 Signature

Sr. Permitting Analyst
 Title

3-16-17
 Date

cherylene_weston@xtoenergy.com
 e-mail Address

District I
1625 N. French Drive, Hobbs, NM 88240
District II
811 S. First St., Artesia, NM 88210
District III
1000 Rio Brazos Road, Aztec, NM 87410
District IV
1220 S. St Francis Dr, Santa Fe, NM
87505

State of New Mexico
Energy, Minerals and Natural Resources Department

Form C-107-B
Revised August 1, 2011

OIL CONSERVATION DIVISION
1220 S. St Francis Drive
Santa Fe, New Mexico 87505

Submit the original
application to the Santa Fe
office with one copy to the
appropriate District Office.

APPLICATION FOR SURFACE COMMINGLING (DIVERSE OWNERSHIP)

OPERATOR NAME: XTO Energy Inc.
OPERATOR ADDRESS: 382 Road 3100, Aztec, NM 87410
APPLICATION TYPE:

☐ Pool Commingling ☐ Lease Commingling ☒ Pool and Lease Commingling ☐ Off-Lease Storage and Measurement (Only if not Surface Commingling)

LEASE TYPE: ☒ Fee ☐ State ☒ Federal

Is this an Amendment to existing Order? ☐ Yes ☒ No If "Yes", please include the appropriate Order No. _____
Have the Bureau of Land Management (BLM) and State Land office (SLO) been notified in writing of the proposed commingling
☒ Yes ☐ No

(A) POOL COMMINGLING

Please attach sheets with the following information

(1) Pool Names and Codes	Gravities / BTU of Non-Commingled Production	Calculated Gravities / BTU of Commingled Production		Calculated Value of Commingled Production	Volumes
Basin Dakota (71599)					
Basin Fruitland Coal (71629)					

- (2) Are any wells producing at top allowables? ☐ Yes ☒ No
(3) Has all interest owners been notified by certified mail of the proposed commingling? ☒ Yes ☐ No
(4) Measurement type: ☒ Metering ☐ Other (Specify) _____
(5) Will commingling decrease the value of production? ☐ Yes ☒ No If "yes", describe why commingling should be approved _____

(B) LEASE COMMINGLING

Please attach sheets with the following information

- (1) Pool Name and Code.
(2) Is all production from same source of supply? ☐ Yes ☐ No
(3) Has all interest owners been notified by certified mail of the proposed commingling? ☐ Yes ☐ No
(4) Measurement type: ☐ Metering ☐ Other (Specify) _____

(C) POOL and LEASE COMMINGLING

Please attach sheets with the following information

- (1) Complete Sections A and B.

(D) OFF-LEASE STORAGE and MEASUREMENT

Please attached sheets with the following information

- (1) Is all production from same source of supply? ☐ Yes ☐ No
(2) Include proof of notice to all interest owners.

(E) ADDITIONAL INFORMATION (for all application types)

Please attach sheets with the following information

- (1) A schematic diagram of facility, including legal location.
(2) A plat with lease boundaries showing all well and facility locations. Include lease numbers if Federal or State lands are involved.
(3) Lease Names, Lease and Well Numbers, and API Numbers.

I hereby certify that the information above is true and complete to the best of my knowledge and belief.

SIGNATURE Cherylene L. Weston TITLE Sr. Permitting Analyst

DATE 3-16-17

TYPE OR PRINT NAME Cherylene L. Weston

TELEPHONE NO: 505-333-3190

E-MAIL ADDRESS: cherylene_weston@xtoenergy.com

DISTRICT I
1625 N. Fench Dr., Hobbs, N.M. 88240

DISTRICT II
1301 W. Grand Avenue, Artesia, N.M. 88210

DISTRICT III
1000 Rio Brazos Rd., Aztec, N.M. 87410

DISTRICT IV
1220 South St. Francis Dr., Santa Fe, NM 87505

State of New Mexico
Energy, Minerals & Natural Resources Department

OIL CONSERVATION DIVISION

1220 South St. Francis Dr.
Santa Fe, NM 87504-2088

Form C-102
Revised June 10, 2003
Instructions on back
Submit to Appropriate District Office
State Lease - 4 Copies
Fee Lease - 3 Copies

☐ AMENDED REPORT

WELL LOCATION AND ACREAGE DEDICATION PLAT

¹ API Number 30-045-32326	² Pool Code 71629	³ Pool Name BASIN FRUITLAND COAL
⁴ Property Code 22615	⁵ Property Name J.F. BELL	⁶ Well Number 4
⁷ OCRD No. 167067	⁸ Operator Name XTO ENERGY INC.	⁹ Elevation 5755

¹⁰ Surface Location

UL or lot no.	Section	Township	Range	Lot Idn	Feet from the	North/South line	Feet from the	East/West line	County
P.	3	30-N	13-W	.	945	SOUTH	1070	EAST	SAN JUAN

¹¹ Bottom Hole Location If Different From Surface

UL or lot no.	Section	Township	Range	Lot Idn	Feet from the	North/South line	Feet from the	East/West line	County
¹² Dedicated Acres 319.6					¹³ Joint or Infill		¹⁴ Consolidation Code		¹⁵ Order No.

NO ALLOWABLE WILL BE ASSIGNED TO THIS COMPLETION UNTIL ALL INTERESTS HAVE BEEN CONSOLIDATED
OR A NON-STANDARD UNIT HAS BEEN APPROVED BY THE DIVISION

16

NEW MEXICO OIL CONSERVATION COMMISSION
WELL LOCATION AND ACREAGE DEDICATION PLAT

Form C-102
Supersedes C-128
Effective 1-1-85

All distances must be from the outer boundaries of the Section.

Operator M. R. Schalk		Lease J F Bell		Well No. 2B
Unit Letter P	Section 3	Township 30 North	Range 13 West	County San Juan
Actual Footage Location of Well: 940 feet from the South line and 1020 feet from the East line				
Ground Level Elev. 5749	Producing Formation Dakota	Pool Basin	Dedicated Acreage: 300 E 319.60	

1. Outline the acreage dedicated to the subject well by colored pencil or hatchure marks on the plat below.
2. If more than one lease is dedicated to the well, outline each and identify the ownership thereof (both as to working interest and royalty).
3. If more than one lease of different ownership is dedicated to the well, have the interests of all owners been consolidated by communitization, unitization, force-pooling, etc?

☐ Yes ☐ No If answer is "yes," type of consolidation: _____

If answer is "no," list the owners and tract descriptions which have actually been consolidated. (Use reverse side of this form if necessary.) _____

No allowance will be assigned to the well until all interests have been consolidated (by communitization, unitization, forced-pooling, or otherwise) or until a non-standard unit, eliminating such interests, has been approved by the Commission.

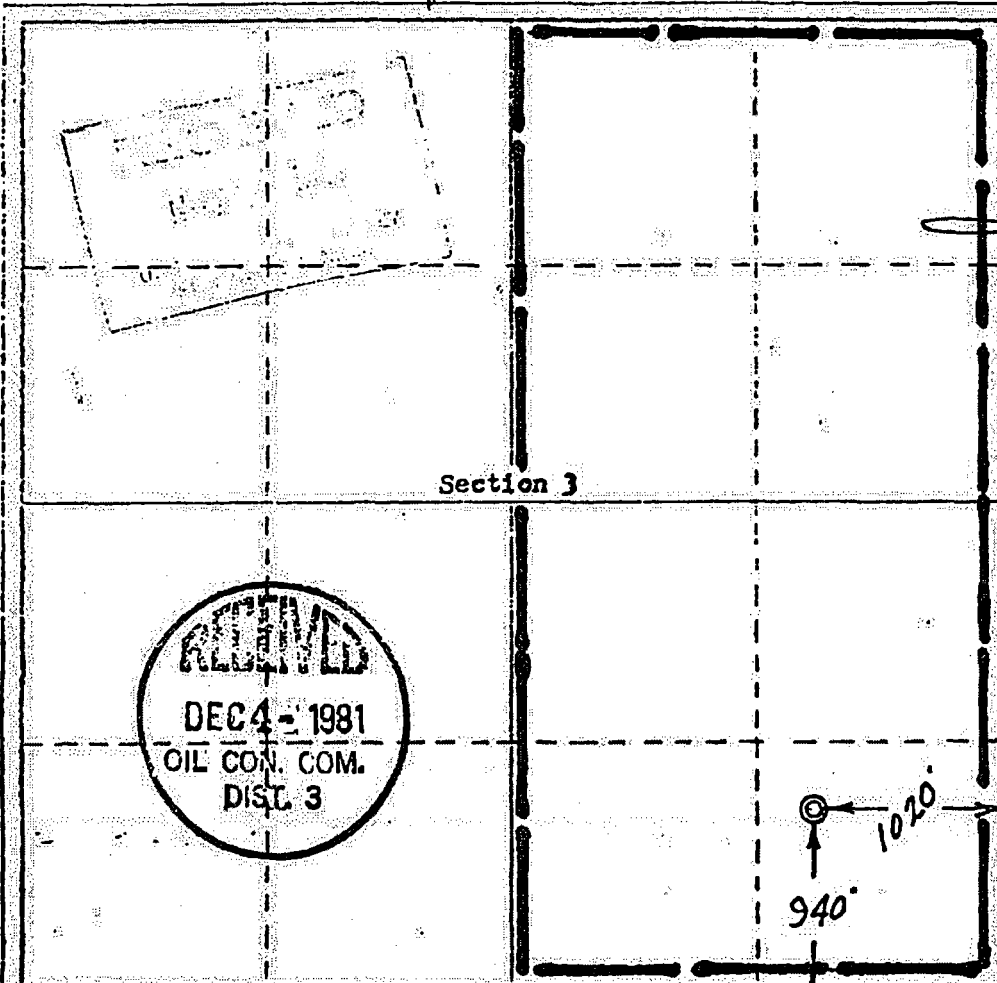

CERTIFICATION

I hereby certify that the information contained herein is true and complete to the best of my knowledge and belief.

Steve Schalk

Position
Agent

Company
M. R. Schalk

Date
Nov. 16, 1981

I hereby certify that the well location shown on this plat was plotted from field notes of actual surveys made by me or under my supervision, and that the same is true and correct to the best of my knowledge and belief.

Date Surveyed
OCTOBER 26, 1981

Registered Professional Engineer and
3084

Certified
STATE OF NEW MEXICO

0 330 660 990 1320 1650 1980 2310 2640 2970 3300 3630 3960 4290 4620 4950 5280 5610 5940 6270 6600 6930 7260 7590 7920 8250 8580 8910 9240 9570 9900 10230 10560 10890 11220 11550 11880 12210 12540 12870 13200 13530 13860 14190 14520 14850 15180 15510 15840 16170 16500 16830 17160 17490 17820 18150 18480 18810 19140 19470 19800 20130 20460 20790 21120 21450 21780 22110 22440 22770 23100 23430 23760 24090 24420 24750 25080 25410 25740 26070 26400 26730 27060 27390 27720 28050 28380 28710 29040 29370 29700 30030 30360 30690 31020 31350 31680 32010 32340 32670 33000 33330 33660 33990 34320 34650 34980 35310 35640 35970 36300 36630 36960 37290 37620 37950 38280 38610 38940 39270 39600 39930 40260 40590 40920 41250 41580 41910 42240 42570 42900 43230 43560 43890 44220 44550 44880 45210 45540 45870 46200 46530 46860 47190 47520 47850 48180 48510 48840 49170 49500 49830 50160 50490 50820 51150 51480 51810 52140 52470 52800 53130 53460 53790 54120 54450 54780 55110 55440 55770 56100 56430 56760 57090 57420 57750 58080 58410 58740 59070 59400 59730 60060 60390 60720 61050 61380 61710 62040 62370 62700 63030 63360 63690 64020 64350 64680 65010 65340 65670 66000 66330 66660 66990 67320 67650 67980 68310 68640 68970 69300 69630 69960 70290 70620 70950 71280 71610 71940 72270 72600 72930 73260 73590 73920 74250 74580 74910 75240 75570 75900 76230 76560 76890 77220 77550 77880 78210 78540 78870 79200 79530 79860 80190 80520 80850 81180 81510 81840 82170 82500 82830 83160 83490 83820 84150 84480 84810 85140 85470 85800 86130 86460 86790 87120 87450 87780 88110 88440 88770 89100 89430 89760 90090 90420 90750 91080 91410 91740 92070 92400 92730 93060 93390 93720 94050 94380 94710 95040 95370 95700 96030 96360 96690 97020 97350 97680 98010 98340 98670 99000 99330 99660 99990 100320 100650 100980 101310 101640 101970 102300 102630 102960 103290 103620 103950 104280 104610 104940 105270 105600 105930 106260 106590 106920 107250 107580 107910 108240 108570 108900 109230 109560 109890 110220 110550 110880 111210 111540 111870 112200 112530 112860 113190 113520 113850 114180 114510 114840 115170 115500 115830 116160 116490 116820 117150 117480 117810 118140 118470 118800 119130 119460 119790 120120 120450 120780 121110 121440 121770 122100 122430 122760 123090 123420 123750 124080 124410 124740 125070 125400 125730 126060 126390 126720 127050 127380 127710 128040 128370 128700 129030 129360 129690 130020 130350 130680 131010 131340 131670 132000 132330 132660 132990 133320 133650 133980 134310 134640 134970 135300 135630 135960 136290 136620 136950 137280 137610 137940 138270 138600 138930 139260 139590 139920 140250 140580 140910 141240 141570 141900 142230 142560 142890 143220 143550 143880 144210 144540 144870 145200 145530 145860 146190 146520 146850 147180 147510 147840 148170 148500 148830 149160 149490 149820 150150 150480 150810 151140 151470 151800 152130 152460 152790 153120 153450 153780 154110 154440 154770 155100 155430 155760 156090 156420 156750 157080 157410 157740 158070 158400 158730 159060 159390 159720 160050 160380 160710 161040 161370 161700 162030 162360 162690 163020 163350 163680 164010 164340 164670 165000 165330 165660 165990 166320 166650 166980 167310 167640 167970 168300 168630 168960 169290 169620 169950 170280 170610 170940 171270 171600 171930 172260 172590 172920 173250 173580 173910 174240 174570 174900 175230 175560 175890 176220 176550 176880 177210 177540 177870 178200 178530 178860 179190 179520 179850 180180 180510 180840 181170 181500 181830 182160 182490 182820 183150 183480 183810 184140 184470 184800 185130 185460 185790 186120 186450 186780 187110 187440 187770 188100 188430 188760 189090 189420 189750 190080 190410 190740 191070 191400 191730 192060 192390 192720 193050 193380 193710 194040 194370 194700 195030 195360 195690 196020 196350 196680 197010 197340 197670 198000 198330 198660 198990 199320 199650 199980 200310 200640 200970 201300 201630 201960 202290 202620 202950 203280 203610 203940 204270 204600 204930 205260 205590 205920 206250 206580 206910 207240 207570 207900 208230 208560 208890 209220 209550 209880 210210 210540 210870 211200 211530 211860 212190 212520 212850 213180 213510 213840 214170 214500 214830 215160 215490 215820 216150 216480 216810 217140 217470 217800 218130 218460 218790 219120 219450 219780 220110 220440 220770 221100 221430 221760 222090 222420 222750 223080 223410 223740 224070 224400 224730 225060 225390 225720 226050 226380 226710 227040 227370 227700 228030 228360 228690 229020 229350 229680 230010 230340 230670 231000 231330 231660 231990 232320 232650 232980 233310 233640 233970 234300 234630 234960 235290 235620 235950 236280 236610 236940 237270 237600 237930 238260 238590 238920 239250 239580 239910 240240 240570 240900 241230 241560 241890 242220 242550 242880 243210 243540 243870 244200 244530 244860 245190 245520 245850 246180 246510 246840 247170 247500 247830 248160 248490 248820 249150 249480 249810 250140 250470 250800 251130 251460 251790 252120 252450 252780 253110 253440 253770 254100 254430 254760 255090 255420 255750 256080 256410 256740 257070 257400 257730 258060 258390 258720 259050 259380 259710 260040 260370 260700 261030 261360 261690 262020 262350 262680 263010 263340 263670 264000 264330 264660 264990 265320 265650 265980 266310 266640 266970 267300 267630 267960 268290 268620 268950 269280 269610 269940 270270 270600 270930 271260 271590 271920 272250 272580 272910 273240 273570 273900 274230 274560 274890 275220 275550 275880 276210 276540 276870 277200 277530 277860 278190 278520 278850 279180 279510 279840 280170 280500 280830 281160 281490 281820 282150 282480 282810 283140 283470 283800 284130 284460 284790 285120 285450 285780 286110 286440 286770 287100 287430 287760 288090 288420 288750 289080 289410 289740 290070 290400 290730 291060 291390 291720 292050 292380 292710 293040 293370 293700 294030 294360 294690 295020 295350 295680 296010 296340 296670 297000 297330 297660 297990 298320 298650 298980 299310 299640 299970 300300 300630 300960 301290 301620 301950 302280 302610 302940 303270 303600 303930 304260 304590 304920 305250 305580 305910 306240 306570 306900 307230 307560 307890 308220 308550 308880 309210 309540 309870 310200 310530 310860 311190 311520 311850 312180 312510 312840 313170 313500 313830 314160 314490 314820 315150 315480 315810 316140 316470 316800 317130 317460 317790 318120 318450 318780 319110 319440 319770 320100 320430 320760 321090 321420 321750 322080 322410 322740 323070 323400 323730 324060 324390 324720 325050 325380 325710 326040 326370 326700 327030 327360 327690 328020 328350 328680 329010 329340 329670 330000 330330 330660 330990 331320 331650 331980 332310 332640 332970 333300 333630 333960 334290 334620 334950 335280 335610 335940 336270 336600 336930 337260 337590 337920 338250 338580 338910 339240 339570 339900 340230 340560 340890 341220 341550 341880 342210 342540 342870 343200 343530 343860 344190 344520 344850 345180 345510 345840 346170 346500 346830 347160 347490 347820 348150 348480 348810 349140 349470 349800 350130 350460 350790 351120 351450 351780 352110 352440 352770 353100 353430 353760 354090 354420 354750 355080 355410 355740 356070 356400 356730 357060 357390 357720 358050 358380 358710 359040 359370 359700 360030 360360 360690 361020 361350 361680 362010 362340 362670 363000 363330 363660 363990 364320 364650 364980 365310 365640 365970 366300 366630 366960 367290 367620 367950 368280 368610 368940 369270 369600 369930 370260 370590 370920 371250 371580 371910 372240 372570 372900 373230 373560 373890 374220 374550 374880 375210 375540 375870 376200 376530 376860 377190 377520 377850 378180 378510 378840 379170 379500 379830 380160 380490 380820 381150 381480 381810 382140 382470 382800 383130 383460 383790 384120 384450 384780 385110 385440 385770 386100 386430 386760 387090 387420 387750 388080 388410 388740 389070 389400 389730 390060 390390 390720 391050 391380 391710 392040 392370 392700 393030 393360 393690 394020 394350 394680 395010 395340 395670 396000 396330 396660 396990 397320 397650 397980 398310 398640 398970 399300 399630 399960 400290 400620 400950 401280 401610 401940 402270 402600 402930 403260 403590 403920 404250 404580 404910 405240 405570 405900 406230 406560 406890 407220 407550 407880 408210 408540 408870 409200 409530 409860 410190 410520 410850 411180 411510 411840 412170 412500 412830 413160 413490 413820 414150 414480 414810 415140 415470 415800 416130 416460 416790 417120 417450 417780 418110 418440 418770 419100 419430 419760 420090 420420 420750 421080 421410 421740 422070 422400 422730 423060 423390 423720 424050 424380 424710 425040 425370 425700 426030 426360 426690 427020 427350 427680 428010 428340 428670 429000 429330 429660 429990 430320 430650 430980 431310 431640 431970 432300 432630 432960 433290 433620 433950 434280 434610 434940 435270 435600 435930 436260 436590 436920 437250 437580 437910 438240 438570 438900 439230 439560 439890 440220 440550 440880 441210 441540 441870 442200 442530 442860 443190 443520 443850 444180 444510 444840 445170 445500 445830 446160 446490 446820 447150 447480 447810 448140 448470 448800 449130 449460 449790 450120 450450 450780 451110 451440 451770 452100 452430 452760 453090 453420 453750 454080 454410 454740 455070 455400 455730 456060 456390 456720 457050 457380 457710 458040 458370 458700 459030 459360 459690 460020 460350 460680 461010 461340 461670 462000 462330 462660 462990 463320 463650 463980 464310 464640 464970 465300 465630 465960 466290 466620 466950 467280 467610 467940 468270 468600 468930 469260 469590 469920 470250 470580 470910 471240 471570 471900 472230 472560 472890 473220 473550 473880 474210 474540 474870 475200 475530 475860 476190 476520 476850 477180 477510 477840 478170 478500 478830 479160 479490 479820 480150 480480 480810 481140 481470 481800 482130 482460 482790 483120 483450 483780 484110 484440 484770 485100 485430 485760 486090 486420 486750 487080 487410 487740 488070 488400 488730 489060 489390 489720 490050 490380 490710 491040 491370 491700 492030 492360 492690 493020 493350 493680 494010 494340 494670 495000 495330 495660 495990 496320 496650 496980 497310 497640 497970 498300 498630 498960 499290 499620 499950 500280 500610 500940 501270 501600 501930 502260 502590 502920 503250 503580 503910 504240 504570 504900 505230 505560 505890 506220 506550 506880 507210 507540 507870 508200 508530 508860 509190 509520 509850 510180 510510 510840 511170 511500 511830 512160 512490 512820 513150 513480 513810 514140 514470 514800 515130 515460 515790 516120 516450 516780 517110 517440 517770 518100 518430 518760 519090 519420 519750 520080 520410 520740 521070 521400 521730 522060 522390 522720 523050 523380 523710 524040 524370 524700 525030 525360 525690 526020 526350 526680 527010 527340 527670 528000 528330 528660 528990 529320 52965

The diagram illustrates the process flow for the Site Facility, including the following components and connections:

- Legend:**
 - Comp. Oil Tank (Circle with a dot)
 - Chem. Tank (Circle with a cross)
 - PU (Pump Unit, rectangle)
 - PU Day Tank (Rectangle)
- Equipment:**
 - COMP:** SN: 2056 SC
 - 2 PH SEP:** SN: 3363-S
 - P/T:** SN: 8150, 120 bbl
 - WH:** JF BELL 4 and JF BELL 2E
 - 3 PH SEP:** SN: HTP 1167
 - P/T:** SN: 8251-B, 120 bbl
 - OIL:** ID: GI 9618, 210 bbl
 - Meters:** GM (Gas Meter), SN: 85495 and SN: 94310
- Flow Streams:**
 - From COMP to 2 PH SEP:** G^{3"}, G^{3"}, G^{2"}, W^{2"}
 - From 2 PH SEP to P/T (SN: 8150):** W^{2"}
 - From 2 PH SEP to 3 PH SEP:** G^{2"}, W^{2"}
 - From 3 PH SEP to P/T (SN: 8251-B):** W^{2"}, W^{2"}
 - From 3 PH SEP to OIL:** O^{2"}
 - From OIL to P/T (SN: 8251-B):** W^{2"}
 - From 3 PH SEP to Gas Pipeline:** G^{3"} (via Meter # 85495) and G^{3"} (via Meter # 94310)
 - From JF BELL 4 to 2 PH SEP:** W^{2"}, G^{2"}
 - From JF BELL 2E to 2 PH SEP:** P^{2"}, G^{2"}
- Other Features:**
 - Entrance:** Indicated by a break symbol at the bottom center.
 - Flow Direction:** Indicated by arrows on the flow lines.

JF BELL 4
SESE SEC 3, T30N, R13W
945 FSL 1070 FEL
API # 30-045-32326
LEASE # NMMNM28226C
SAN JUAN COUNTY, NEW MEXICO

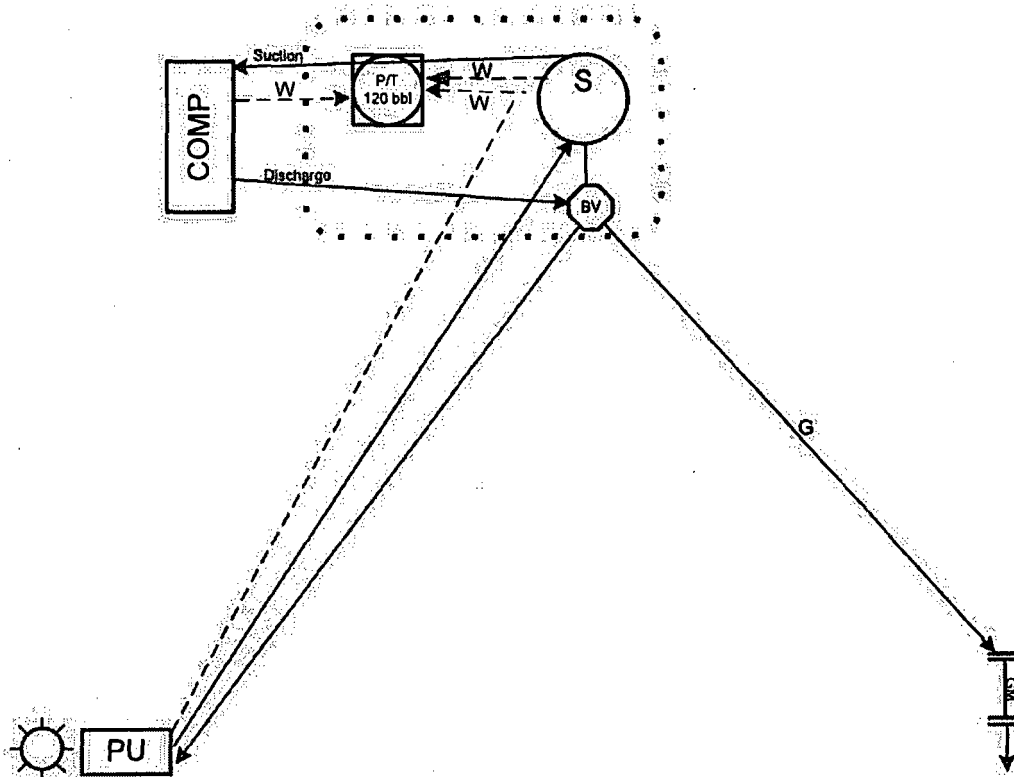

Draining phase: Drain valve D1 open. Sales valve S1 sealed closed.

1/8/2007

Plot Plan/ Facility Diagram

Well Name: J F Bell # 2 E
Field: San Juan County NM
Serial Number: Lease # NM-028226-C, API # 30-045-25266
Section: SE/SE Sec. 03(P), T-30N, R-13W
Updated: 7/26/2012

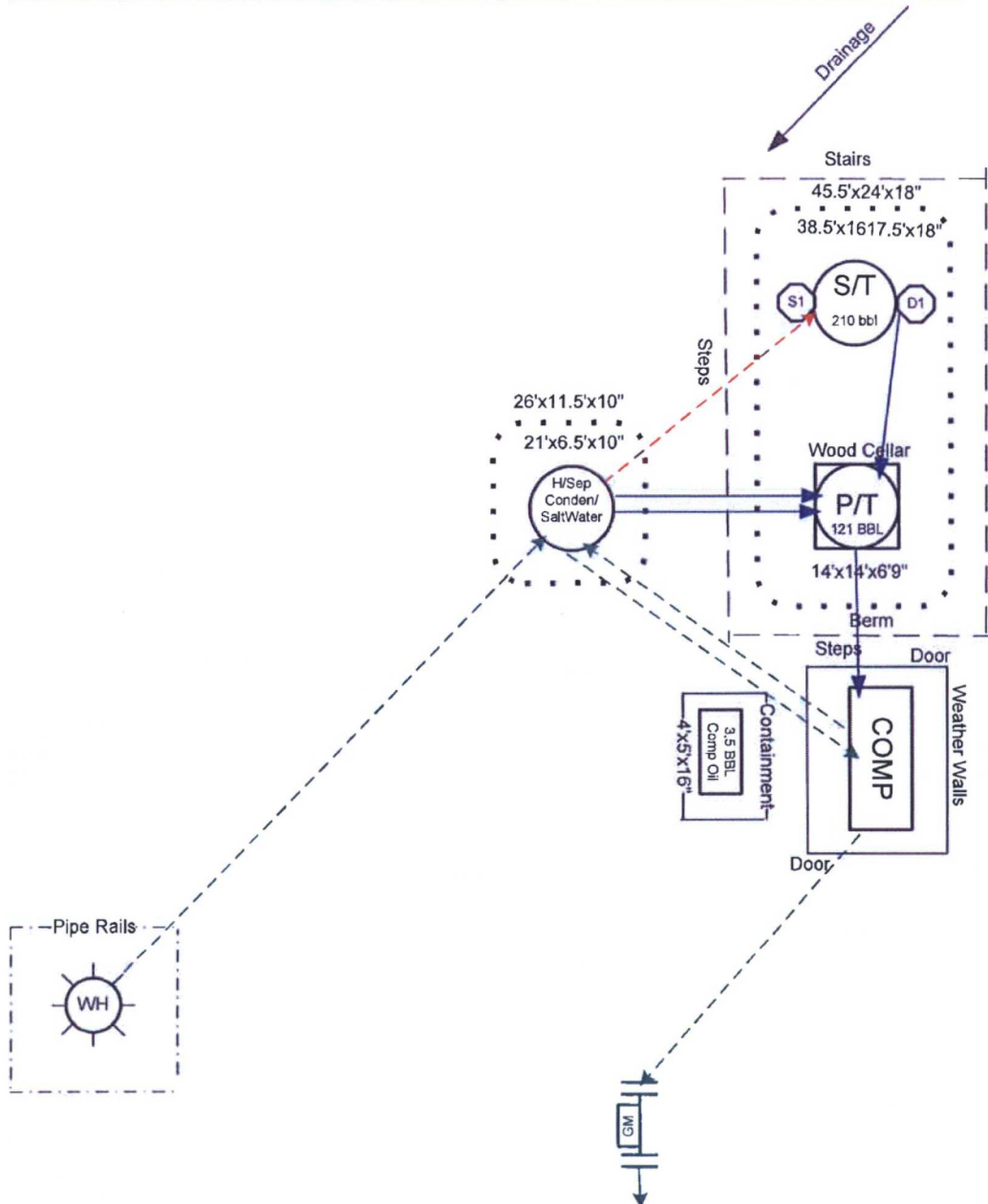

Production

Gas

Oil

Water

Equalizing Line

Catch Basin

Flow Lines

Buried Flow Lines

General sealing of valves, sales by tank gauging
Production phase: Drain valve D1 and sales valve S1 sealed closed.
Sales phase: Drain valve D1 sealed closed. Sales valve S1 open.
Draining phase: Drain valve D1 open. Sales valve S1 closed.

This lease is subject to the site security plan for San Juan Basin Area. The plan is located at:
XTO ENERGY INC.
382 Road 3100
Aztec, NM 87410

WELL INFORMATION

[illegible]

Compressor Information		
Location:	JF Bell 4 CDP	
Property #	68889	
XTO Compressor #	2056SC	
Lat/Long:	36.83729	-108.18637
Manufacturer:	CATERPILLAR	
Engine:	G3306NA	
Horse Power:	145	
Fuel Usage:	21.6	mcf/d
DK	50	mcf/d
FC	120	mcf/d

Well	Pumping Unit		Separator(s)		Vented Gas (mcf/d)
	Engine	Fuel Usage (mcf/d)	Burners (y/n)	Fuel Usage (mcf/d)	
JF Bell 2E	None - Plunger Lift	0	Y	5.7	0.0
JF Bell 4	Arrow C-46	2.6	Y	5.7	0.0

Well	JF Bell 2E	JF Bell 4
Formation	Dakota	Fruitland Coal
Production (mcf/d)		
June	54	109
July	56	179
August	56	170
September	55	191
October	55	181
November	51	150

J F Bell #4 CDP
Proposed Allocation Procedure

Base Data:

W = Gas Volume (Mcf) from allocation meters at individual wells during allocation period

X = Gas Volume (Mcf) from CDP Sales Meter during allocation period

Y = BTU's from CDP Sales Meter during allocation period

Allocation Period is typically a calendar month and will be the same for all wells.

1. Individual Well Gas Production = A + B + C + D + E

A = Allocated Sales Volume, Mcf = $(W / \text{SUM } W) \times X$

(individual well volume divided by the sum of the well volumes; multiplied by total from CDP)

B = On lease fuel usage, Mcf. Determined from equipment specifications and operating conditions.

C = Purged and/or vented gas from well and/or lease equipment, Mcf. Calculated using equipment specifications and pressures.

D = Allocated fuel from gathering system equipment. The total fuel required to operate gathering system equipment will be allocated to the individual wells benefiting from the equipment using allocation factors determined by $W / \text{SUM } W$ for the wells involved.

E = Allocated volume of gas lost and/or vented from the gathering system and/or gathering system equipment, Mcf. The total volume will be determined using industry accepted procedures for the conditions existing at the time of the loss. All volumes corresponding to liquid condensation within the gathering system will also be determined. The total volume lost and/or vented will be allocated to the individual wells affected using factors determined by $W / \text{SUM } W$.

2. Allocated Individual Well BTU's = $((W \times \text{Individual well BTW} / \text{SUM } (@ \times \text{individual well BTU})) \times Y$.
Individual well gas heating values to be determined in accordance with BLM regulations (currently Onshore Order #5).



XTO Energy Inc.
382 Road 3100
Aztec, New Mexico 87410
Office: 505.333.3100
Fax: 505.333.3280

VIA CERTIFIED MAIL – RETURN RECEIPT REQUESTED

March 21, 2017

RE: Amended Notice to Working and Royalty Interest Owners
Application to Surface Commingle Gas Production
SE/4 SE/4 Sec. 3, T30N, R13W
San Juan County, New Mexico

Dear Interest Owner:

XTO Energy Inc. (XTO) is applying to the New Mexico Oil Conservation Division (NMOCD) and Bureau of Land Management (BLM) for approval to surface commingle gas production from the JF Bell 4 (Basin Fruitland Coal) and JF Bell 2E (Basin Dakota) wells. NMOCD requires that all interest owners be notified of plans to surface commingle when ownership is different between wells and formations.

XTO previously notified all affected interest owners by letter dated December 16, 2016. Upon submitting the application to the NMOCD, it was discovered the allocation method was not what was intended.

This letter serves as notification of our intent to clarify the allocation method as follows: XTO will meter gas from the JF Bell 2E well prior to entering the compressor on JF Bell 4 well. The JF Bell 4 gas will be metered after commingling with the JF Bell 2E gas, and we will use the subtraction method to allocate the production volumes for the JF Bell 4. There will be one CDP on the JF Bell 4 well. By surface commingling the wells, it will reduce air emissions, lower compression costs, and reduce the footprint on the location.

If you need additional information, or have any questions, please contact me at (505) 333-3190. If you object to our application, you must file a protest in writing to the NMOCD, Santa Fe office at 1220 South Saint Francis Drive, Santa Fe, NM 87505 within 20 days from the date of this letter.

Sincerely,

A handwritten signature in black ink that reads 'Cherylene L. Weston'.

Cherylene L. Weston, CPLTA
Sr. Permitting Analyst

/clw

xc: Well Files
FTW Land Department
NMOCD, Aztec

J F Bell #4 – Basin Fruitland Coal

J F Bell #2E – Basin Dakota

Interest Owners

DIANE ELEY

BRUCE MACKINNON HOPE

TIMOTHY WILLIAM HOPE

TRACY LEE HOPE BUGG

JEFFERY SCOTT HOPE

CHRISTOPHER JOHN HOPE

JOHN H GILLIAM JR

CAROLE ANN YARBOROUGH

RUTH G CUPPLES

SUSAN GILLIAM NEFF

LLOYD V GILLIAM III

JAMES F & JILL A BELL

LEGACY ROYALTIES LTD

MMS XTO FEDERAL

M R SCHALK LLC

XTO ENERGY INC

JF Bell 4 and 2E Owner List
3-21-17 Surface Commingle Amended Notice Letter

Owner Name	Address 1	Address 2	City	State	Zip Code	Well	Certified Article Number
BRUCE MACKINNON HOPE	308 PRINCE HAVEN CT		KERNERSVILLE	NC	27284	Re: JF Bell 4 & 2E	7011 1150 0000 5129 5840
CAROLE ANN YARBOROUGH	PO BOX 2346		NEW SMYRNA BEACH	FL	32170	Re: JF Bell 4 & 2E	7011 1150 0000 5129 5796
CHRISTOPHER JOHN HOPE	9 STURBRIDGE LN		STAFFORD	VA	22554	Re: JF Bell 4 & 2E	7011 1150 0000 5129 5888
DIANE ELEY	99 DUCK HOLLOW CIR		STROUDSBURG	PA	18360	Re: JF Bell 4 & 2E	7011 1150 0000 5129 5819
JAMES F & JILL A BELL	504 WHITE SURF DR #D		GAITHERSBURG	MD	20878-2937	Re: JF Bell 4 & 2E	7011 1150 0000 5129 5925
JEFFERY SCOTT HOPE	2646 WESTMINSTER DR		WINTERVILLE	NC	28590	Re: JF Bell 4 & 2E	7011 1150 0000 5129 5871
JOHN H GILLIAM JR	PO BOX 467		BALA CYNWYD	PA	19004-0467	Re: JF Bell 4 & 2E	7011 1150 0000 5129 5789
LEGACY ROYALTIES LTD	PO BOX 1360		TYLER	TX	75710-1360	Re: JF Bell 4 & 2E	7011 1150 0000 5129 5833
LLOYD V GILLIAM III	5215 SNOW VALLEY LN		HAMILTON	OH	45011	Re: JF Bell 4 & 2E	7011 1150 0000 5129 5918
M R SCHALK LLC	PO BOX 25825		ALBUQUERQUE	NM	87125-0825	Re: JF Bell 4 & 2E	7011 1150 0000 5129 5802
MMS XTO FEDERAL C/O BLM	ATTN WILLIAM TAMBEKOU	6551 COLLEGE BLVD	FARMINGTON	NM	87402	Re: JF Bell 4 & 2E	7011 1150 0000 5129 5826
RUTH G CUPPLES	658 CLYMER LN		RIDLEY PARK	PA	19078-1303	Re: JF Bell 4 & 2E	7011 1150 0000 5129 5895
SUSAN GILLIAM NEFF	1625 OLD WELSH RD		HUNTINGDON VY	PA	19006-5835	Re: JF Bell 4 & 2E	7011 1150 0000 5129 5901
TIMOTHY WILLIAM HOPE	3500 CORNELL RD		FAIRFAX	VA	22030	Re: JF Bell 4 & 2E	7011 1150 0000 5129 5857
TRACY LEE HOPE BUGG	808 WINDHAM DR		SOUTH HILL	VA	23970	Re: JF Bell 4 & 2E	7011 1150 0000 5129 5864
XTO ENERGY INC	810 HOUSTON		FORT WORTH	TX	76102	Re: JF Bell 4 & 2E	N/A

McMillan, Michael, EMNRD

From: Weston, Cherylene <Cherylene_Weston@xtoenergy.com>
Sent: Tuesday, March 21, 2017 12:02 PM
To: McMillan, Michael, EMNRD
Subject: RE: JF Bell 4 and JF Bell 2E Surface Commingle

I asked the Superintendent for one of our areas and he said he never heard of the Low-volume charges from the P/L companies. Is it something that happens down in the SE part of the State?

From: McMillan, Michael, EMNRD [mailto:Michael.McMillan@state.nm.us]
Sent: Tuesday, March 21, 2017 11:58 AM
To: Weston, Cherylene
Subject: RE: JF Bell 4 and JF Bell 2E Surface Commingle

Yes.
E-mail me the new letter, proof of mailing and the 20-day clock will start then
Mike

From: Weston, Cherylene [mailto:Cherylene_Weston@xtoenergy.com]
Sent: Tuesday, March 21, 2017 11:56 AM
To: McMillan, Michael, EMNRD <Michael.McMillan@state.nm.us>
Subject: RE: JF Bell 4 and JF Bell 2E Surface Commingle

Do I have to wait for the 20-days after I re-send the letters?

From: McMillan, Michael, EMNRD [mailto:Michael.McMillan@state.nm.us]
Sent: Tuesday, March 21, 2017 11:41 AM
To: Weston, Cherylene
Subject: RE: JF Bell 4 and JF Bell 2E Surface Commingle

Cherylene:
Thanks for the quick response
You will have to renote them
Also, are you doing this to reduce low volume charges that pipelines are charging by having one meter?
If so state that in the letter. The OCD will use this for justification for your application
Mike

From: Weston, Cherylene [mailto:Cherylene_Weston@xtoenergy.com]
Sent: Tuesday, March 21, 2017 11:38 AM
To: McMillan, Michael, EMNRD <Michael.McMillan@state.nm.us>
Subject: RE: JF Bell 4 and JF Bell 2E Surface Commingle

I confirmed with the Engineer, Meghan Wilson, that the measurement method is the subtraction method.

From: McMillan, Michael, EMNRD [mailto:Michael.McMillan@state.nm.us]
Sent: Tuesday, March 21, 2017 11:37 AM