

RECEIVED:	REVIEWER: <u>LRL</u>	TYPE: <u>NSL</u>	APP NO: <u>PLEL17</u>
-----------	----------------------	------------------	-----------------------

ABOVE THIS TABLE FOR OCD DIVISION USE ONLY

**NEW MEXICO OIL CONSERVATION DIVISION**  
 - Geological & Engineering Bureau -  
 1220 South St. Francis Drive, Santa Fe, NM 87505



NSL-7571

**ADMINISTRATIVE APPLICATION CHECKLIST**

THIS CHECKLIST IS MANDATORY FOR ALL ADMINISTRATIVE APPLICATIONS FOR EXCEPTIONS TO DIVISION RULES AND  
 REGULATIONS WHICH REQUIRE PROCESSING AT THE DIVISION LEVEL IN SANTA FE

**Applicant:** ~~Chisholm Energy Operating, LLC~~ CHISHOLM ENERGY OPERATING **GRID Number:** 372137  
**Well Name:** Buffalo West 2 State Com 2BS 5H LLC. **API:** 30-25-43832  
**Pool:** Buffalo, Bone Spring, Southwest Southeast **Pool Code:** (8146)

**SUBMIT ACCURATE AND COMPLETE INFORMATION REQUIRED TO PROCESS THE TYPE OF APPLICATION  
 INDICATED BELOW**

**1) TYPE OF APPLICATION:** Check those which apply for [A]

A. Location - Spacing Unit - Simultaneous Dedication

☒ NSL      ☐ NSP (PROJECT AREA)      ☐ NSP (PRORATION UNIT)      ☐ SD

B. Check one only for [I] or [II]

[I] Commingling - Storage - Measurement

☐ DHC    ☐ CTB    ☐ PLC    ☐ PC    ☐ OLS    ☐ OLM

[II] Injection - Disposal - Pressure Increase - Enhanced Oil Recovery

☐ WFX    ☐ PMX    ☐ SWD    ☐ IPI    ☐ EOR    ☐ PPR
**2) NOTIFICATION REQUIRED TO:** Check those which apply.

- A. ☐ Offset operators or lease holders  
 B. ☐ Royalty, overriding royalty owners, revenue owners  
 C. ☐ Application requires published notice  
 D. ☐ Notification and/or concurrent approval by SLO  
 E. ☐ Notification and/or concurrent approval by BLM  
 F. ☐ Surface owner  
 G. ☐ For all of the above, proof of notification or publication is attached, and/or,  
 H. ☒ No notice required

**FOR OCD ONLY**

- ☐ Notice Complete  
☐ Application  
 Content  
 Complete

**3) CERTIFICATION:** I hereby certify that the information submitted with this application for administrative approval is **accurate** and **complete** to the best of my knowledge. I also understand that **no action** will be taken on this application until the required information and notifications are submitted to the Division.

**Note: Statement must be completed by an individual with managerial and/or supervisory capacity.**

Bettie Watson

Print or Type Name

Signature

08/07/2017

Date

817-864-1104

Phone Number

bwatson@chisholmenergy.com

e-mail Address



August 7, 2017

VIA E-mail: Leonard.Lowe@state.nm.us

New Mexico Oil Conservation Commission  
Attn: Leonard Lowe  
1220 South St. Francis Drive  
Santa Fe, New Mexico 87505

Subj.: Buffalo West 2 State Com 2BS #005H  
API # 30-025-43832

Dear Mr. Lowe,

Chisholm Energy Operating, LLC request approval of a non-standard location for the subject well. To support this request, the following information is provided:

- 1) Assigned "Administrative Application Checklist" is attached and signed.
- 2) Statement of reason for NSL is: We are experimenting with well down spacing.
- 3) API: 30-25-43832.
- 4) Well Information: All in Section 2, T19S, R33E, Lea Co. Footages are from Section lines.
  - a. SHL - 125' FNL & 1325' FEL, Lat 32.696539 / Long -103.629430
  - b. FTP - 560' FNL & 1584' FWL, Lat 32.695341 / Long -103.630269
  - c. LTP & BHL - 330' FSL & 1584' FEL, Lat 32.682905 / -103.630251 → 1654' FEL
- 5) Pool Name / Pool Code: Buffalo; Bone Spring, Southeast / Pool Code #8146
- 6) OCD Form C-102 is attached.
- 7) Plat surrounding spacing unit is attached.
- 8) Chisholm Energy Operating, LLC has 100% WI in all of Section 2, T19S, R33E, Lea County, therefore, Notice is not required.

Please let me know if I can be of further assistance.

Sincerely,

Bettie Watson,  
Regulatory Manager

Submit 1 Copy To Appropriate District Office

District I - (575) 393-6161  
1625 N. French Dr., Hobbs, NM 88240  
District II - (575) 748-1283  
811 S. First St., Artesia, NM 88210  
District III - (505) 334-6178  
1000 Rio Brazos Rd., Aztec, NM 87410  
District IV - (505) 476-3460  
1220 S. St. Francis Dr., Santa Fe, NM 87505

State of New Mexico  
Energy, Minerals and Natural Resources

OIL CONSERVATION DIVISION  
1220 South St. Francis Dr.  
Santa Fe, NM 87505

Form C-103  
Revised July 18, 2013

<b>SUNDRY NOTICES AND REPORTS ON WELLS</b> (DO NOT USE THIS FORM FOR PROPOSALS TO DRILL OR TO DEEPEN OR PLUG BACK TO A DIFFERENT RESERVOIR. USE "APPLICATION FOR PERMIT" (FORM C-101) FOR SUCH PROPOSALS.)		WELL API NO. 30-025-43832
1. Type of Well: Oil Well <input checked="" type="checkbox"/> Gas Well <input type="checkbox"/> Other <input type="checkbox"/>		5. Indicate Type of Lease STATE <input checked="" type="checkbox"/> FEE <input type="checkbox"/>
2. Name of Operator CHISHOLM ENERGY OPERATING, LLC		6. State Oil & Gas Lease No.
3. Address of Operator 801 Cherry Street, Suite 1200-Unit 20 - Fort Worth, Texas 76102		7. Lease Name or Unit Agreement Name Buffalo West 2 State Com 2BS
4. Well Location Unit Letter <u>2</u> : <u>125</u> feet from the <u>N</u> line and <u>1325</u> feet from the <u>E</u> line Section <u>2</u> Township <u>19S</u> Range <u>33E</u> NMPM County <u>Lea</u>		8. Well Number <u>005H</u>
11. Elevation (Show whether DR, RKB, RT, GR, etc.) 3777 GR		9. OGRID Number 372137
		10. Pool name or Wildcat: Buffalo; Bone Spring, Southeast

12. Check Appropriate Box to Indicate Nature of Notice, Report or Other Data

NOTICE OF INTENTION TO:		SUBSEQUENT REPORT OF:	
PERFORM REMEDIAL WORK <input type="checkbox"/>	PLUG AND ABANDON <input type="checkbox"/>	REMEDIAL WORK <input type="checkbox"/>	ALTERING CASING <input type="checkbox"/>
TEMPORARILY ABANDON <input type="checkbox"/>	CHANGE PLANS <input checked="" type="checkbox"/>	COMMENCE DRILLING OPNS. <input type="checkbox"/>	P AND A <input type="checkbox"/>
PULL OR ALTER CASING <input type="checkbox"/>	MULTIPLE COMPL <input type="checkbox"/>	CASING/CEMENT JOB <input type="checkbox"/>	
DOWNHOLE COMMINGLE <input type="checkbox"/>			
CLOSED-LOOP SYSTEM <input type="checkbox"/>			
OTHER <input type="checkbox"/>		OTHER: <input type="checkbox"/>	

13. Describe proposed or completed operations. (Clearly state all pertinent details, and give pertinent dates, including estimated date of starting any proposed work). SEE RULE 19.15.7.14 NMAC. For Multiple Completions: Attach wellbore diagram of proposed completion or recompletion.

Request approval for BHL From: 330' FSL & 1584" FEL  
To: 330' FSL & 1654' FEL

Attached is Form C-102 Plat

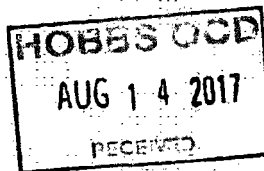

Spud Date:

Rig Release Date:

I hereby certify that the information above is true and complete to the best of my knowledge and belief.

SIGNATURE Bettie Watson TITLE Regulatory Manager DATE 8/14/2017

Type or print name Bettie Watson E-mail address: bwatson@chisholmenet.com PHONE: 817-864-1104  
For State Use Only

APPROVED BY: [Signature] TITLE Petroleum Engineer DATE 08/14/17  
Conditions of Approval (if any):

DISTRICT I  
1625 N. French Dr., Hobbs, NM 88240  
Phone (505) 393-8181 Fax: (505) 393-0720

DISTRICT II  
811 S. First St., Artesia, NM 88210  
Phone (505) 748-1283 Fax: (505) 748-9780

DISTRICT III  
1000 Rio Brazos Rd., Aztec, NM 87410  
Phone (505) 334-6178 Fax: (505) 334-6170

DISTRICT IV  
1226 S. St. Francis Dr., Santa Fe, NM 87505  
Phone (505) 476-3460 Fax: (505) 476-3458

State of New Mexico  
Energy, Minerals and Natural Resources Department

OIL CONSERVATION DIVISION  
1226 South St. Francis Dr.  
Santa Fe, New Mexico 87505

Form C-102  
Revised August 1, 2011

Submit one copy to appropriate  
District Office

WELL LOCATION AND ACREAGE DEDICATION PLAT

AMENDED REPORT

API Number 30-025-43832	Pool Code 8146	Pool Name Buffalo: Bone Spring
Property Code 317783	Property Name BUFFALO WEST 2 STATE COM 2BS	Well Number 5H
OGRID No. 372137	Operator Name CHISHOLM ENERGY OPERATING, LLC	Elevation 3777'

Surface Location

UL or lot No.	Section	Township	Range	Lot Idn	FEET from the	North/South line	FEET from the	East/West line	County
LOT 2	2	19 S	33 E		125	NORTH	1325	EAST	LEA

Bottom Hole Location If Different From Surface

UL or lot No.	Section	Township	Range	Lot Idn	FEET from the	North/South line	FEET from the	East/West line	County
0	2	19 S	33 E		330	SOUTH	1654	EAST	LEA

Dedicated Acres 233.81 / 165.0	Joint or Infill	Consolidation Code	Order No.
-----------------------------------	-----------------	--------------------	-----------

NO ALLOWABLE WILL BE ASSIGNED TO THIS COMPLETION UNTIL ALL INTERESTS HAVE BEEN CONSOLIDATED  
OR A NON-STANDARD UNIT HAS BEEN APPROVED BY THE DIVISION

N: 617302.1 E: 753024.5 (NAD 83)	<b>SURFACE LOCATION</b> Lot - N 32.696539 Long - W 103.629430 NMSPCE- N 617848.6 E 757878.6 (NAD-83)	LOT 4	LOT 3	LOT 2	LOT 1
N: 618171.1 E: 753941.4 (NAD 83)	<b>LANDING POINT</b> 560 FNL & 1584 FEL Lot - N 32.695341 Long - W 103.630269 NMSPCE- N 617411.1 E 757623.2 (NAD-83)	<b>HOBBES OGD</b> AUG 14 2017 RECEIVED			
N: 612531.1 E: 753965.9 (NAD 83)	<b>PROPOSED BOTTOM HOLE LOCATION</b> Lot - N 32.682900' Long - W 103.630471' NMSPCE- N 612886.3 E 757588.5 (NAD-83)	Project Area			
N: 612549.3 E: 756812.4 (NAD 83)	N: 612566.2 E: 758245.1 (NAD 83)	OPERATOR CERTIFICATION I hereby certify that the information contained herein is true and complete to the best of my knowledge and belief, and that this organization either owns a working interest or unleased mineral interest in the land including the proposed bottom hole location or has a right to drill this well at this location pursuant to a contract with an owner of such a mineral or working interest, or to a voluntary pooling agreement or a compulsory pooling order heretofore entered by the division. Bettie Watson 8/14/17 Signature Date Bettie Watson Printed Name bettie@watsonreg.com Email Address			
SURVEYOR CERTIFICATION I hereby certify that the well location shown on this plat was plotted from field notes of actual surveys made by me or under my supervision and that the same is true and correct to the best of my belief. Date Surveyed Signature of Professional Surveyor Certification Number 7977 Scale: 1" = 2000' WO Num.: 32917		NEW MEXICO Professional Surveyor 7977			

## **Lowe, Leonard, EMNRD**

---

**From:** Bettie Watson <bwatson@chisholmenergy.com>  
**Sent:** Friday, August 18, 2017 4:38 PM  
**To:** Lowe, Leonard, EMNRD  
**Subject:** Buffalo West 2 State Com 2BS 5H

Leonard,

The bottom hole and the last take point are the same location for the subject well.

Let me know if additional information is required.

Bettie Watson, Regulatory Manager  
Chisholm Energy Operating, LLC  
817-864-1104 Desk  
972-979-0132 Cell



## **Lowe, Leonard, EMNRD**

---

**From:** Lowe, Leonard, EMNRD  
**Sent:** Friday, August 11, 2017 3:53 PM  
**To:** 'Bettie Watson'  
**Subject:** RE: NSL questions

Ms. Bettie Watson,

OCD references POOL NUMBER 8146 with Buffalo; Bone Spring, Southeast.

Not southwest.

I suspect in your reference, the Pool number will supersede your intended pool name.

I need to have these flaming ducks in line, as I have to defend your application to the Director when approval is sought.

I will contact the OCD district office to try to bring resolution to this Pool Name and number.

Your application is still not complete. Once completed your 20 Public Notice will start.

### **Leonard Lowe**

Engineering Bureau  
Oil Conservation Division  
Energy Minerals and Natural Resources Department  
1220 South St. Frances  
Santa Fe, New Mexico 87004  
Office: 505-476-3492  
Cell: 505-930-6717  
Fax: 505-476-3462  
E-mail: [leonard.lowe@state.nm.us](mailto:leonard.lowe@state.nm.us)  
Website: <http://www.emnrd.state.nm.us/oed/>

---

**From:** Bettie Watson [mailto:[bwatson@chisholmenergy.com](mailto:bwatson@chisholmenergy.com)]  
**Sent:** Thursday, August 10, 2017 10:40 PM  
**To:** Lowe, Leonard, EMNRD <[Leonard.Lowe@state.nm.us](mailto:Leonard.Lowe@state.nm.us)>  
**Subject:** RE: NSL questions

Leonard,

My submittal cover page and letter are a mess for sure. I apologize for this inconvenience. The pool # & name are 8146 - Buffalo; Bone Spring, Southwest. The FTP is 1584' FEL.

Thanks  
Bettie Watson

## **Lowe, Leonard, EMNRD**

---

**From:** Bettie Watson <bwatson@chisholmenergy.com>  
**Sent:** Thursday, August 10, 2017 10:40 PM  
**To:** Lowe, Leonard, EMNRD  
**Subject:** RE: NSL questions

Leonard,

My submittal cover page and letter are a mess for sure. I apologize for this inconvenience. The pool # & name are 8146 - Buffalo; Bone Spring, Southwest. The FTP is 1584' FEL.

Thanks  
Bettie Watson

---

**From:** Lowe, Leonard, EMNRD [mailto:Leonard.Lowe@state.nm.us]  
**Sent:** Thursday, August 10, 2017 5:42 PM  
**To:** Bettie Watson <bwatson@chisholmenergy.com>  
**Subject:** NSL questions  
**Importance:** High

Bettie Watson,

Per your submitted NSL application, I will take the information via the attached C-102 as the correct information.

Your letter and information pertaining to the First and Last Take points are not the same.

Which is right?

FTP = 1584' FEL? OR FWL?

ALSO,

What is the correct name of the pool you are seeking? There is no record of a Buffalo; Bone Spring, Southwest associated with the pool number 8146.

Please clarify.

Thank you Ma'am.

**Leonard Lowe**  
Engineering Bureau  
Oil Conservation Division  
Energy Minerals and Natural Resources Department

**Lowe, Leonard, EMNRD**

---

**From:** Lowe, Leonard, EMNRD  
**Sent:** Thursday, August 10, 2017 4:42 PM  
**To:** 'Bettie Watson'  
**Subject:** NSL questions  
  
**Importance:** High

Bettie Watson,

Per your submitted NSL application, I will take the information via the attached C-102 as the correct information.

Your letter and information pertaining to the First and Last Take points are not the same.

Which is right?

FTP = 1584' FEL? OR FWL?

ALSO,

What is the correct name of the pool you are seeking? There is no record of a Buffalo; Bone Spring, Southwest associated with the pool number 8146.

Please clarify.

Thank you Ma'am.

**Leonard Lowe**  
Engineering Bureau  
Oil Conservation Division  
Energy Minerals and Natural Resources Department  
1220 South St. Frances  
Santa Fe, New Mexico 87004  
Office: 505-476-3492  
Cell: 505-930-6717  
Fax: 505-476-3462  
E-mail: [leonard.lowe@state.nm.us](mailto:leonard.lowe@state.nm.us)  
Website: <http://www.emnrd.state.nm.us/ocd/>



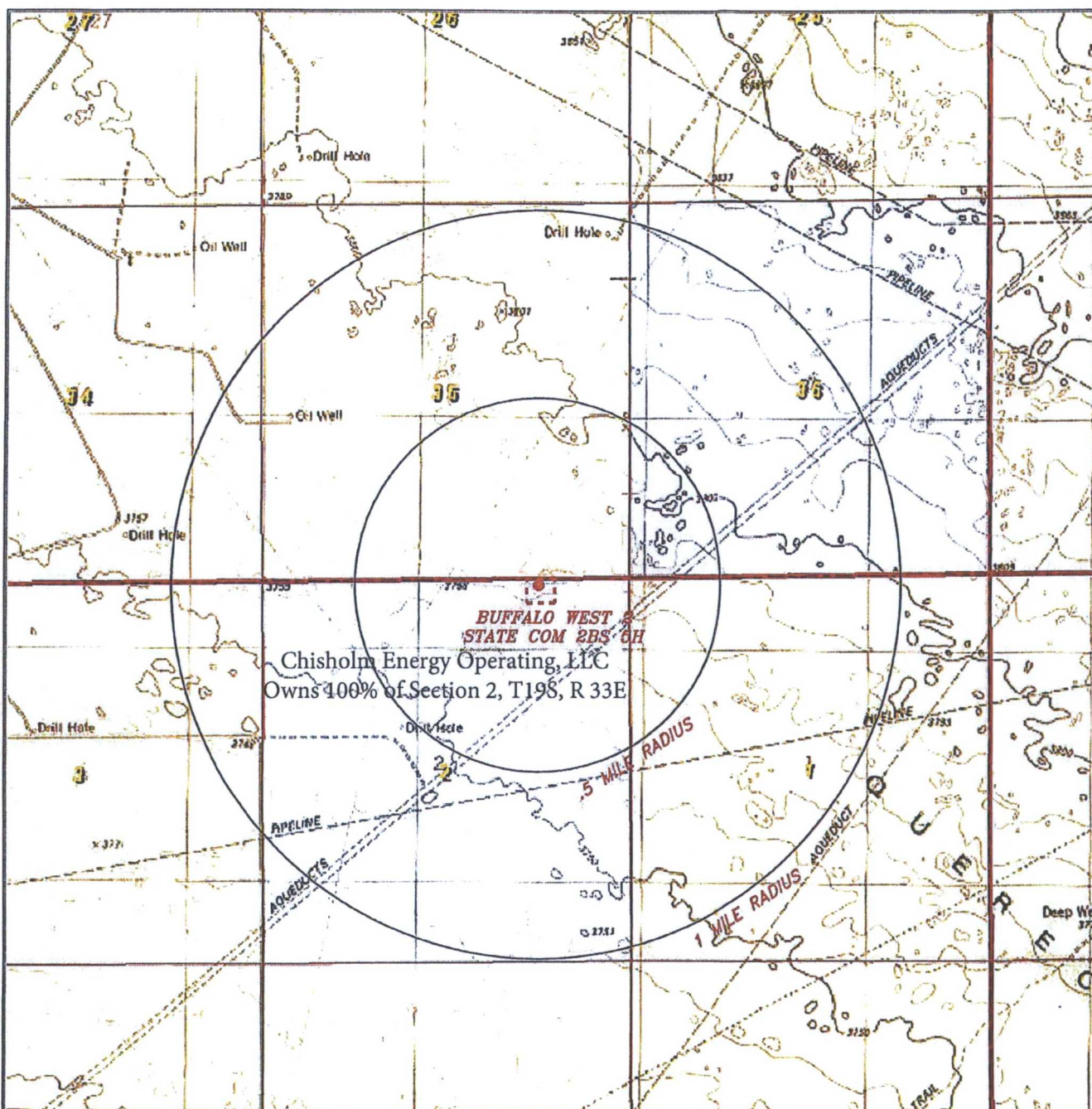

## BUFFALO WEST 2 STATE COM 2BS 5H

Located 125' FNL and 1325' FEL  
Section 2, Township 19 South, Range 33 East,  
N.M.P.M., Lea County, New Mexico.

**basin**  
**surveys**

focused on excellence  
in the oilfield

P.O. Box 1786  
1120 N. West County Rd.  
Hobbs, New Mexico 88241  
(575) 393-7316 - Office  
(575) 392-2206 - Fax  
basinsurveys.com

0' 1000' 2000' 3000' 4000'  
SCALE: 1" = 2000'  
W.O. Number: JG 32917  
Survey Date: 5-3-2017  
YELLOW TINT - USA LAND  
BLUE TINT - STATE LAND  
NATURAL COLOR - FEE LAND



**CHISHOLM**  
**ENERGY**  
**OPERATING,**  
**LLC**

**Lowe, Leonard, EMNRD**

---

**From:** Lowe, Leonard, EMNRD  
**Sent:** Tuesday, August 22, 2017 10:48 AM  
**To:** 'Bettie Watson'  
**Cc:** Brown, Maxey G, EMNRD; Kautz, Paul, EMNRD; McMillan, Michael, EMNRD; Goetze, Phillip, EMNRD; Jones, William V, EMNRD; 'lisa@rwbyram.com'; Holm, Anchor E.; Martin, Ed  
**Subject:** APPROVED NSL-7571\_Chisholm Energy Operating, LLC\_Buffalo West 2 State Com 2BS Well No. 5H\_SEC 2 19S 33E  
**Importance:** High

Ms. Bettie Watson,

The following administrative order has been issued and will soon be available on the Division's web site: <http://ocdimage.emnrd.state.nm.us/Imaging/Default.aspx>

**NSL-7571**

**Chisholm Energy Operating, LLC**

**WELL: API #: 30-025-43832**

**WELL NAME: Buffalo West 2 State Com 2BS Well No. 5H**

**Leonard Lowe**

Engineering Bureau

Oil Conservation Division

Energy Minerals and Natural Resources Department

1220 South St. Frances

Santa Fe, New Mexico 87004

Office: 505-476-3492

Cell: 505-930-6717

Fax: 505-476-3462

E-mail: [leonard.lowe@state.nm.us](mailto:leonard.lowe@state.nm.us)

Website: <http://www.emnrd.state.nm.us/ocd/>