

DATE IN <u>9/8/17</u>	SUSPENSE	ENGINEER <u>LRL</u>	LOGGED IN <u>9/8/17</u>	TYPE <u>NSL</u>	PLEL <u>1725150354</u>
-----------------------	----------	---------------------	-------------------------	-----------------	------------------------

ABOVE THIS LINE FOR DIVISION USE ONLY

NEW MEXICO OIL CONSERVATION DIVISION

- Engineering Bureau -

1220 South St. Francis Drive, Santa Fe, NM 87505



BRAINARD 12 M #2 30-015-44412

ADMINISTRATIVE APPLICATION CHECKLIST

THIS CHECKLIST IS MANDATORY FOR ALL ADMINISTRATIVE APPLICATIONS FOR EXCEPTIONS TO DIVISION RULES AND REGULATIONS WHICH REQUIRE PROCESSING AT THE DIVISION LEVEL IN SANTA FE

Application Acronyms:

[NSL-Non-Standard Location] [NSP-Non-Standard Proration Unit] [SD-Simultaneous Dedication]

[DHC-Downhole Commingling] [CTB-Lease Commingling] [PLC-Pool/Lease Commingling]

[PC-Pool Commingling] [OLS - Off-Lease Storage] [OLM-Off-Lease Measurement]

[WFX-Waterflood Expansion] [PMX-Pressure Maintenance Expansion]

[SWD-Salt Water Disposal] [IPI-Injection Pressure Increase]

[EOR-Qualified Enhanced Oil Recovery Certification] [PPR-Positive Production Response]

NSL-7582

[1] TYPE OF APPLICATION - Check Those Which Apply for [A]

[A] Location - Spacing Unit - Simultaneous Dedication

☒ NSL ☐ NSP ☐ SD

Check One Only for [B] or [C]

[B] Commingling - Storage - Measurement

☐ DHC ☐ CTB ☐ PLC ☐ PC ☐ OLS ☐ OLM

[C] Injection - Disposal - Pressure Increase - Enhanced Oil Recovery

☐ WFX ☐ PMX ☐ SWD ☐ IPI ☐ EOR ☐ PPR

[D] Other: Specify _____

[2] NOTIFICATION REQUIRED TO: - Check Those Which Apply, or ☐ Does Not Apply

[A] ☐ Working, Royalty or Overriding Royalty Interest Owners

[B] ☐ Offset Operators, Leaseholders or Surface Owner

[C] ☐ Application is One Which Requires Published Legal Notice

[D] ☐ Notification and/or Concurrent Approval by BLM or SLO

U.S. Bureau of Land Management - Commissioner of Public Lands, State Land Office

[E] ☐ For all of the above, Proof of Notification or Publication is Attached, and/or,

[F] ☐ Waivers are Attached

[3] SUBMIT ACCURATE AND COMPLETE INFORMATION REQUIRED TO PROCESS THE TYPE OF APPLICATION INDICATED ABOVE.

[4] **CERTIFICATION:** I hereby certify that the information submitted with this application for administrative approval is **accurate** and **complete** to the best of my knowledge. I also understand that **no action** will be taken on this application until the required information and notifications are submitted to the Division.

Note: Statement must be completed by an individual with managerial and/or supervisory capacity.

Mike Pippin
Print or Type Name

Mike Pippin
Signature

Petroleum Engineer
Title

September 6, 2017
Date

mike@pippinllc.com
e-mail Address

2011 SEP - 8 P 1:15
RECEIVED OGD

LIME ROCK RESOURCES 11-A, L.P.
WELL: BRAINARD 12M NO. 2
POOLS: RED LAKE; GLORIETA-YESD [#51120]
ATOKA, SAN ANDRES [#3610]

LIME ROCK RESOURCES II-A, L.P.

c/o Mike Pippin
3104 N. Sullivan Avenue
Farmington, NM 87401
505-327-4573 (phone) 505-564-8656 (fax)
Email: mike@pippinllc.com

September 6, 2017

Engineering Bureau
Phil Goetze
New Mexico Oil Conservation Division
1220 S. Saint Francis Drive
Santa Fe, New Mexico 87504

RE: Application for Administrative Approval for a Non-standard Location
BRAINARD 12M #2 - 30-015-44412
990' FSL & 1295' FWL (M). Sec. 12 T18S R26E, Eddy County, NM
Red Lake, Glorieta-Yeso (51120) and Atoka, San Andres (3610)

Dear Mr. Goetze:

Lime Rock Resources hereby requests administrative approval for a non-standard location for the above referenced well. Attached for your reference are the following exhibits:

1. C-102 for the State Pools
2. Operator/Well map
3. Location Map and Vicinity Map

The APD for the referenced well was approved on 8/24/17. The executor for the surface land owner, Mr. Rusty Smith whose address is P.O. Box 400, Ruidoso, NM 88355, has requested that Lime Rock not drill the well in the middle of his alfalfa field. However, in order to accommodate Mr. Smith, the well must be non-standard. The State rule is that a well must be at least 330' from a spacing unit line. We are submitting this NSL application in an effort to both produce the natural resource and accommodate Mr. Smith.

All the surrounding acreage is operated by Lime Rock Resources II-A, L.P. Therefore, there are no offset operators to notify of this NSL application. Lime Rock Resources requests your Administrative Approval for the non-standard location based on the above information. Should you need any additional information please feel free to contact me at (505) 327-4573.

Best Regards,



Mike Pippin
Petroleum Engineer

Enclosures

cc: Artesia District Office

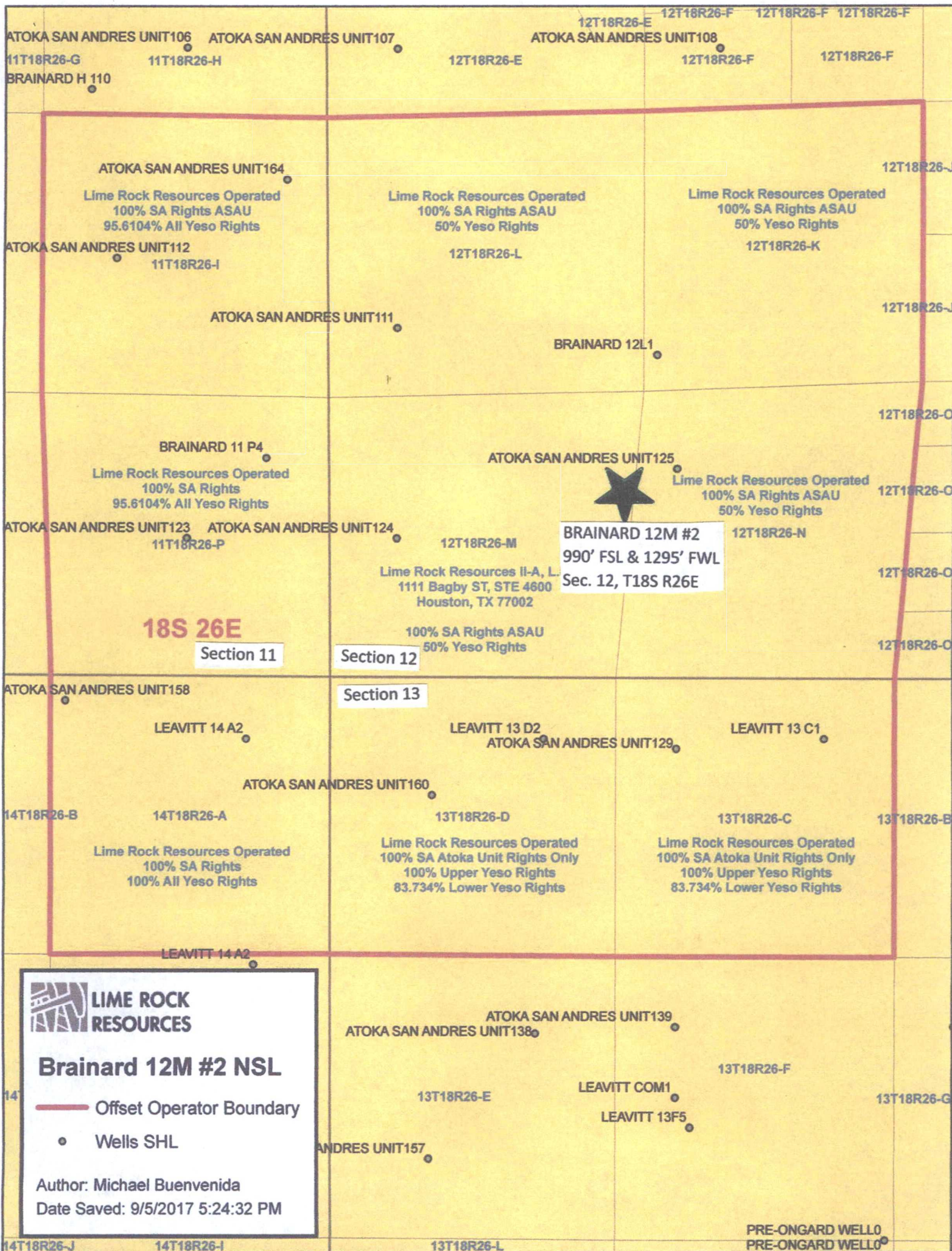

District I
1625 N. French Dr., Hobbs, NM 88240
District II
1301 W. Grand Avenue, Artesia, NM 88210
District III
1000 Rio Brazos Rd., Aztec, NM 87410
District IV
1220 S. St. Francis Dr., Santa Fe, NM 87505

State of New Mexico
Energy, Minerals & Natural Resources Department
OIL CONSERVATION DIVISION
1220 South St. Francis Dr.
Santa Fe, NM 87505

Form C-102
Revised October 12, 2005
Submit to Appropriate District Office
State Lease - 4 Copies
Fee Lease - 3 Copies

☐ AMENDED REPORT

WELL LOCATION AND ACREAGE DEDICATION PLAT **CORRECTED POOL**

¹ API Number 30-015-44412	² Pool Code 51120	³ Pool Name Red Lake, Glorieta-Yeso
⁴ Property Code 319465	⁵ Property Name BRAINARD 12M	⁶ Well Number 2
⁷ OGRID No. 277558	⁸ Operator Name LIME ROCK RESOURCES II-A, L.P.	⁹ Elevation 3298' GL

¹⁰ Surface Location

UL or lot no. M	Section 12	Township 18-S	Range 26-E	Lot Idn	Feet from the 990	North/South line SOUTH	Feet from the 1295	East/West line WEST	County EDDY
--------------------	---------------	------------------	---------------	---------	----------------------	---------------------------	-----------------------	------------------------	----------------

¹¹ Bottom Hole Location If Different From Surface

UL or lot no.	Section	Township	Range	Lot Idn	Feet from the	North/South line	Feet from the	East/West line	County
¹² Dedicated Acres 40	¹³ Joint or Infill	¹⁴ Consolidation Code	¹⁵ Order No.						

No allowable will be assigned to this completion until all interests have been consolidated or a non-standard unit has been approved by the division.

				¹⁷ OPERATOR CERTIFICATION <i>I hereby certify that the information contained herein is true and complete to the best of my knowledge and belief, and that this organization either owns a working interest or unleased mineral interest in the land including the proposed bottom hole location or has a right to drill this well at this location pursuant to a contract with an owner of such a mineral or working interest, or to a voluntary pooling agreement or a compulsory pooling order heretofore entered by the division.</i> Signature <u>Mike Pippin</u> Date <u>9/6/17</u> Mike Pippin Printed Name
				¹⁸ SURVEYOR CERTIFICATION <i>I hereby certify that the well location shown on this plat was plotted from field notes of actual surveys made by me or under my supervision, and that the same is true and correct to the best of my belief.</i> 7/6/17 Date of Survey Signature and Seal of Professional Surveyor: Filmon F. Jaramillo 12797 Certificate Number

2649.93'

1295'

990'

2692.32'

2692.32'

SECTION 12, TOWNSHIP 18 SOUTH, RANGE 26 EAST, N.M.P.M.
 EDDY COUNTY, STATE OF NEW MEXICO
 LOCATION VERIFICATION MAP

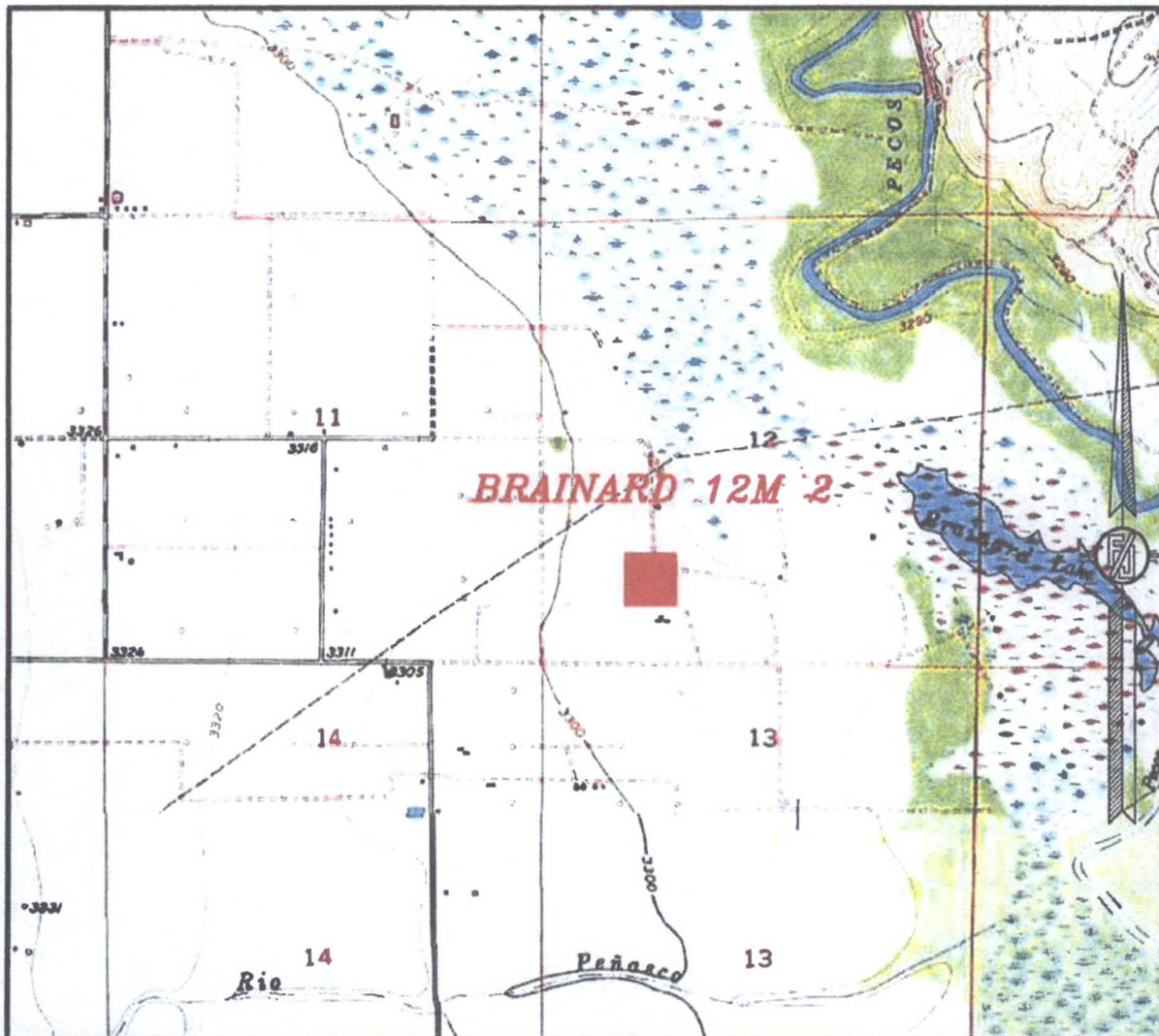

USGS QUAD MAP:
 SPRING LAKE

NOT TO SCALE

LIME ROCK RESOURCES II-A, L.P.
BRAINARD 12M 2
 LOCATED 990 FT. FROM THE SOUTH LINE
 AND 1295 FT. FROM THE WEST LINE OF
 SECTION 12, TOWNSHIP 18 SOUTH,
 RANGE 26 EAST, N.M.P.M.
 EDDY COUNTY, STATE OF NEW MEXICO

JULY 6, 2017

SURVEY NO. 5291

MADRON SURVEYING, INC. 301 SOUTH CANAL CARLSBAD, NEW MEXICO
 (575) 234-3341

SECTION 12, TOWNSHIP 18 SOUTH, RANGE 26 EAST, N.M.P.M.
EDDY COUNTY, STATE OF NEW MEXICO
VICINITY MAP

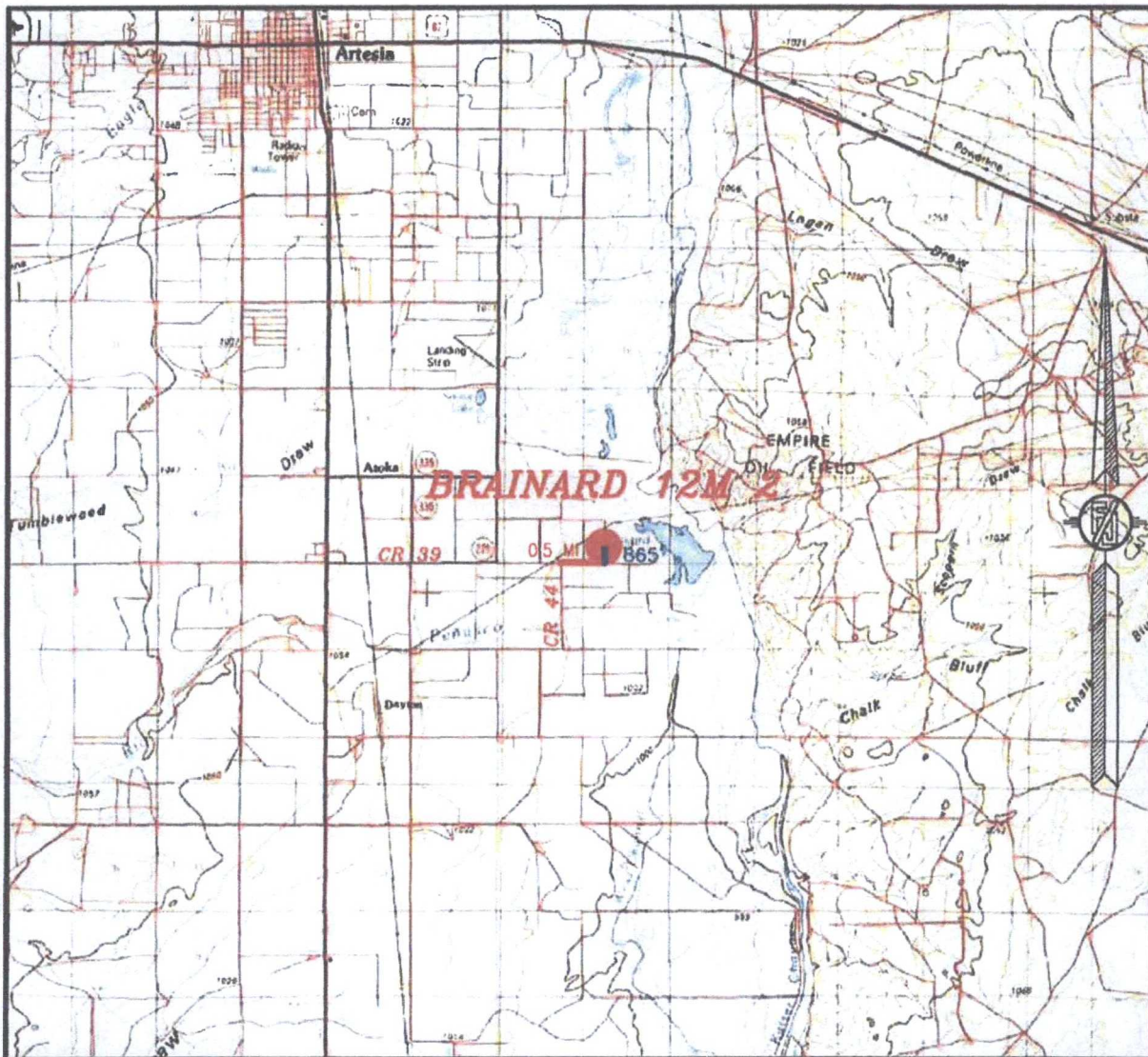

DISTANCES IN MILES

NOT TO SCALE

DIRECTIONS TO LOCATION

FROM CR 39 (FOUR DINKUS) AND CR 44 (FANNING) AND CALICHE LEASE ROAD, GO EAST ON CALICHE ROAD 0.5 OF A MILE, TURN LEFT AND GO NORTH 865' TO THE SOUTHEAST PAD CORNER FOR THIS LOCATION.

**LIME ROCK RESOURCES II-A, L.P.
BRAINARD 12M 2**

LOCATED 990 FT. FROM THE SOUTH LINE
AND 1295 FT. FROM THE WEST LINE OF
SECTION 12, TOWNSHIP 18 SOUTH,
RANGE 26 EAST, N.M.P.M.
EDDY COUNTY, STATE OF NEW MEXICO

JULY 6, 2017

SURVEY NO. 5291

MADRON SURVEYING, INC. 301 SOUTH CANAL CARLSBAD, NEW MEXICO
(575) 234-3341

Lowe, Leonard, EMNRD

From: Lowe, Leonard, EMNRD
Sent: Wednesday, September 13, 2017 8:30 AM
To: 'mike@pippinllc.com'
Cc: Sharp, Karen, EMNRD; Podany, Raymond, EMNRD; 'lisa@rwbyram.com'; Jones, William V, EMNRD; Goetze, Phillip, EMNRD; McMillan, Michael, EMNRD
Subject: APPROVED: NSL-7582 (SEC 12 18S 26E) & NSL-7583 (SEC 10 18S 26E)_LIME ROCK RESOURCES II-A, L.P.

Importance: High

Mr. Mike Pippin,

The following administrative orders have been issued and will soon be available on the Division's web site:

<http://ocdimage.emnrd.state.nm.us/Imaging/Default.aspx>

NSL – 7582

Lime Rock Resources II-A, L.P.

WELL: API #: 30-015-44412

NAME: Brainard 12M Well No. 2

NSL – 7583

Lime Rock Resources II-A, L.P.

WELL: API #: 30-015-44373

NAME: Holland 10 N Well No. 1

Leonard Lowe

Engineering Bureau

Oil Conservation Division

Energy Minerals and Natural Resources Department

1220 South St. Frances

Santa Fe, New Mexico 87004

Office: 505-476-3492

Cell: 505-930-6717

Fax: 505-476-3462

E-mail: leonard.lowe@state.nm.us

Website: <http://www.emnrd.state.nm.us/ocd/>