

RECEIVED: <u>9/17/2017</u>	REVIEWER: <u>NAM</u>	TYPE: <u>SWD</u>	APP NO: <u>PMAM1726254295</u>
-------------------------------	-------------------------	---------------------	----------------------------------

ABOVE THIS TABLE FOR OCD DIVISION USE ONLY

**NEW MEXICO OIL CONSERVATION DIVISION**  
 - Geological & Engineering Bureau -  
 1220 South St. Francis Drive, Santa Fe, NM 87505

**ADMINISTRATIVE APPLICATION CHECKLIST**

THIS CHECKLIST IS MANDATORY FOR ALL ADMINISTRATIVE APPLICATIONS FOR EXCEPTIONS TO DIVISION RULES AND  
 REGULATIONS WHICH REQUIRE PROCESSING AT THE DIVISION LEVEL IN SANTA FE

**Applicant:** Mesquite SWD, Inc.**OGRID Number:** 161968**Well Name:** Mesa Verde SWD#3**API:** 30-015-pending**Pool:** SWD Devonian-Silurian**Pool Code:** 97869

**SUBMIT ACCURATE AND COMPLETE INFORMATION REQUIRED TO PROCESS THE TYPE OF APPLICATION  
 INDICATED BELOW**

SWD - 1696**1) TYPE OF APPLICATION:** Check those which apply for [A]

A. Location - Spacing Unit - Simultaneous Dedication

☐ NSL☐ NSP (PROJECT AREA)☐ NSP (PRORATION UNIT)☐ SD

B. Check one only for [I] or [II]

[I] Commingling - Storage - Measurement

☐ DHC☐ CTB☐ PLC☐ PC☐ OLS☐ OLM

[II] Injection - Disposal - Pressure Increase - Enhanced Oil Recovery

☐ WFX☐ PMX☒ SWD☐ IPI☐ EOR☐ PPR**2) NOTIFICATION REQUIRED TO:** Check those which apply.A. ☐ Offset operators or lease holdersB. ☐ Royalty, overriding royalty owners, revenue ownersC. ☐ Application requires published noticeD. ☐ Notification and/or concurrent approval by SLOE. ☐ Notification and/or concurrent approval by BLMF. ☐ Surface ownerG. ☒ For all of the above, proof of notification or publication is attached, and/or,H. ☐ No notice required**FOR OCD ONLY**☐ Notice Complete☐ Application  
Content  
Complete

**3) CERTIFICATION:** I hereby certify that the information submitted with this application for  
 administrative approval is **accurate** and **complete** to the best of my knowledge. I also  
 understand that **no action** will be taken on this application until the required information and  
 notifications are submitted to the Division.

**Note: Statement must be completed by an individual with managerial and/or supervisory capacity.**

Kay Havenor

Print or Type Name

September 18, 2017

Date

575-626-4518

Phone Number

Sec Application

Signature

Kay.havenor@gmail.com

e-mail Address

**APPLICATION FOR AUTHORIZATION TO INJECT**

- I. PURPOSE: Secondary Recovery Pressure Maintenance X Disposal Storage  
Application qualifies for administrative approval? X Yes No
- II. OPERATOR: Mesquite SWD, Inc  
ADDRESS: P.O. Box 1478 Carlsbad, NM 88220  
CONTACT PARTY: Kay Havenor PHONE: 575-626-4518
- III. WELL DATA: Complete the data required on the reverse side of this form for each well proposed for injection.  
Additional sheets may be attached if necessary.
- IV. Is this an expansion of an existing project? Yes X No  
If yes, give the Division order number authorizing the project: \_\_\_\_\_
- V. Attach a map that identifies all wells and leases within two miles of any proposed injection well with a one-half mile radius circle drawn around each proposed injection well. This circle identifies the well's area of review.
- VI. Attach a tabulation of data on all wells of public record within the area of review which penetrate the proposed injection zone. Such data shall include a description of each well's type, construction, date drilled, location, depth, record of completion, and a schematic of any plugged well illustrating all plugging detail.
- VII. Attach data on the proposed operation, including:
1. Proposed average and maximum daily rate and volume of fluids to be injected;
  2. Whether the system is open or closed;
  3. Proposed average and maximum injection pressure;
  4. Sources and an appropriate analysis of injection fluid and compatibility with the receiving formation if other than reinjected produced water; and,
  5. If injection is for disposal purposes into a zone not productive of oil or gas at or within one mile of the proposed well, attach a chemical analysis of the disposal zone formation water (may be measured or inferred from existing literature, studies, nearby wells, etc.).
- \*VIII. Attach appropriate geologic data on the injection zone including appropriate lithologic detail, geologic name, thickness, and depth. Give the geologic name, and depth to bottom of all underground sources of drinking water (aquifers containing waters with total dissolved solids concentrations of 10,000 mg/l or less) overlying the proposed injection zone as well as any such sources known to be immediately underlying the injection interval.
- IX. Describe the proposed stimulation program, if any.
- \*X. Attach appropriate logging and test data on the well. (If well logs have been filed with the Division, they need not be resubmitted).
- \*XI. Attach a chemical analysis of fresh water from two or more fresh water wells (if available and producing) within one mile of any injection or disposal well showing location of wells and dates samples were taken.
- XII. Applicants for disposal wells must make an affirmative statement that they have examined available geologic and engineering data and find no evidence of open faults or any other hydrologic connection between the disposal zone and any underground sources of drinking water.
- XIII. Applicants must complete the "Proof of Notice" section on the reverse side of this form.
- XIV. Certification: I hereby certify that the information submitted with this application is true and correct to the best of my knowledge and belief.

NAME: Kay Havenor TITLE: Agent

SIGNATURE: Kay C Havenor DATE: 9/3/2017

E-MAIL ADDRESS: Kay.Havenor@Gmail.com Mesquite SWD, Inc contact: ClayL.Wilson@hotmail.com

\* If the information required under Sections VI, VIII, X, and XI above has been previously submitted, it need not be resubmitted. Please show the date and circumstances of the earlier submittal: \_\_\_\_\_

DISTRIBUTION: Original and one copy to Santa Fe with one copy to the appropriate District Office

### III. WELL DATA

A. The following well data must be submitted for each injection well covered by this application. The data must be both in tabular and schematic form and shall include:

- (1) Lease name; Well No.; Location by Section, Township and Range; and footage location within the section.
- (2) Each casing string used with its size, setting depth, sacks of cement used, hole size, top of cement, and how such top was determined.
- (3) A description of the tubing to be used including its size, lining material, and setting depth.
- (4) The name, model, and setting depth of the packer used or a description of any other seal system or assembly used.

Division District Offices have supplies of Well Data Sheets which may be used or which may be used as models for this purpose. Applicants for several identical wells may submit a "typical data sheet" rather than submitting the data for each well.

B. The following must be submitted for each injection well covered by this application. All items must be addressed for the initial well. Responses for additional wells need be shown only when different. Information shown on schematics need not be repeated.

- (1) The name of the injection formation and, if applicable, the field or pool name.
- (2) The injection interval and whether it is perforated or open-hole.
- (3) State if the well was drilled for injection or, if not, the original purpose of the well.
- (4) Give the depths of any other perforated intervals and detail on the sacks of cement or bridge plugs used to seal off such perforations.
- (5) Give the depth to and the name of the next higher and next lower oil or gas zone in the area of the well, if any.

### XIV. PROOF OF NOTICE

All applicants must furnish proof that a copy of the application has been furnished, by certified or registered mail, to the owner of the surface of the land on which the well is to be located and to each leasehold operator within one-half mile of the well location.

Where an application is subject to administrative approval, a proof of publication must be submitted. Such proof shall consist of a copy of the legal advertisement which was published in the county in which the well is located. The contents of such advertisement must include:

- (1) The name, address, phone number, and contact party for the applicant;
- (2) The intended purpose of the injection well; with the exact location of single wells or the Section, Township, and Range location of multiple wells;
- (3) The formation name and depth with expected maximum injection rates and pressures; and,
- (4) A notation that interested parties must file objections or requests for hearing with the Oil Conservation Division, 1220 South St. Francis Dr., Santa Fe, New Mexico 87505, within 15 days.

NO ACTION WILL BE TAKEN ON THE APPLICATION UNTIL PROPER PROOF OF NOTICE HAS BEEN SUBMITTED.

---

NOTICE: Surface owners or offset operators must file any objections or requests for hearing of administrative applications within 15 days from the date this application was mailed to them.

## INJECTION WELL DATA SHEET

OPERATOR: Mesquite SWD, Inc. (OGRID 161968)WELL NAME & NUMBER: Mesa Verde SWD #3 30-025-NA (New Drill)WELL LOCATION: 1030' FSL & 2635' FWL N 13 24S 31E  
FOOTAGE LOCATION UNIT LETTER SECTION TOWNSHIP RANGEWELLBORE SCHEMATIC

See attached diagram

PROPOSED WELL CONSTRUCTION DATASurface CasingHole Size: 26" Casing Size: 20" 133# J-55 BTCCemented with: 1980 sx. or                      ft<sup>3</sup>Top of Cement: Surface Method Determined: CirculateIntermediate-1 CasingHole Size: 17-1/2" Casing Size: 13-3/8" 68# HCN-80 LTCCemented with: 1000 sx. or                      ft<sup>3</sup>Top of Cement: Surface Method Determined: CirculateIntermediate-2 CasingHole Size: 12 1/4" Casing Size: 9 5/8" 47# HCLCemented with: 1800 sx. or                      ft<sup>3</sup>Top of Cement: Surface Method Determined: Opr

Liner

Hole Size 8½" Casing Size 7⅝" 39/42.8# P-110  
Cemented with: 2880 sx. or \_\_\_\_\_ ft<sup>3</sup>  
Top of Cement Surface Method Determined Opr  
Total Depth: Approx 17,820'

Injection Interval

Approximately 16,620' To Approximately 17,820'  
(Perforated or Open Hole; indicate which) Open Hole

## INJECTION WELL DATA SHEET

Tubing Size: 5.5" 0-11,650' 17/20#, 4.5" 11,650'-16,620' P-110/N80 Fiberglass coated

Type of Packer: Lok-Set or equivalent

Packer Setting Depth: Approx 16,620 ft

Other Type of Tubing/Casing Seal (if applicable): \_\_\_\_\_

### Additional Data

1. Is this a new well drilled for injection? X Yes        No

If no, for what purpose was the well originally drilled? \_\_\_\_\_

2. Name of the Injection Formation: Siluro-Devonian

3. Name of Field or Pool (if applicable): \_\_\_\_\_

4. Has the well ever been perforated in any other zone(s)? List all such perforated intervals and give plugging detail, i.e. sacks of cement or plug(s) used. New drill

5. Give the name and depths of any oil or gas zones underlying or overlying the proposed injection zone in this area: Delaware & Bone Springs horizons all above approximately 9,800'

Mesquite SWD, Inc.  
Mesa Verde SWD #3  
1030' FSL & 2635' FWL  
Sec. 13, T24S-R31E Eddy County, NM

API 30-025-NA

# PROPOSED NEW WELL DIAGRAM

API: 30025xxxx  
Operator: Mesquite SWD, Inc  
Lease: Mesa Verde SWD  
Location: Sec 13, T24S-R31E Eddy Co., NM  
Footage: 1030 FSL & 2635 FWL

Well No: 3

KB: 3621' est  
GL: 3601' (Google)  
MSL of TD: -14199' est  
32.21265N 103.735940W

## Surface Csg

Size: 20" 133# J-55 BTC  
Set @: 880  
Sxs cmt: 1980  
Circ: Yes  
TOC: Surf  
Hole Size: 26"

## Intermediate Csg

Size: 13-3/8" 68# HCN-80 LTC  
Set @: 4,400  
Sxs cmt: 1000  
Circ: Yes  
TOC: Surf  
Hole Size: 17-1/2"

## Intermediate-2 Csg

Size: 9-5/8" 47# HCL  
Set @: 11700  
Sxs cmt: 1800  
Circ: Yes  
Hole Size: 12-1/4"

## Liner

Size: 7-5/8" 39/42.8# P-110  
Top: 11650  
Set @: 16620  
Sx cmt: 2880  
Circ: Yes  
Hole Size: 8-1/2"

## Open Hole

Size:  
Interval: 16620-18010'  
Hole Size: 6-1/4"

Tubular requirements (made-up): 5-1/2"  
0-300' 17# N80 Butt, 330'-11,000' 17# N80 LTC,  
11,000'-11,650' 20# N80 LTC, 4.5" 11,650'-12,800'  
11.6# P110 LTC, 12,800'-14,400' 13.5# N80 LTC  
14,400'-16,620' 31.5# P110 LTC

Lok-Set or equivalent approx 16,620'

Open hole acid if required.  
Tubing annulus w/corrosion inhibitor  
Complete surface head for disposal

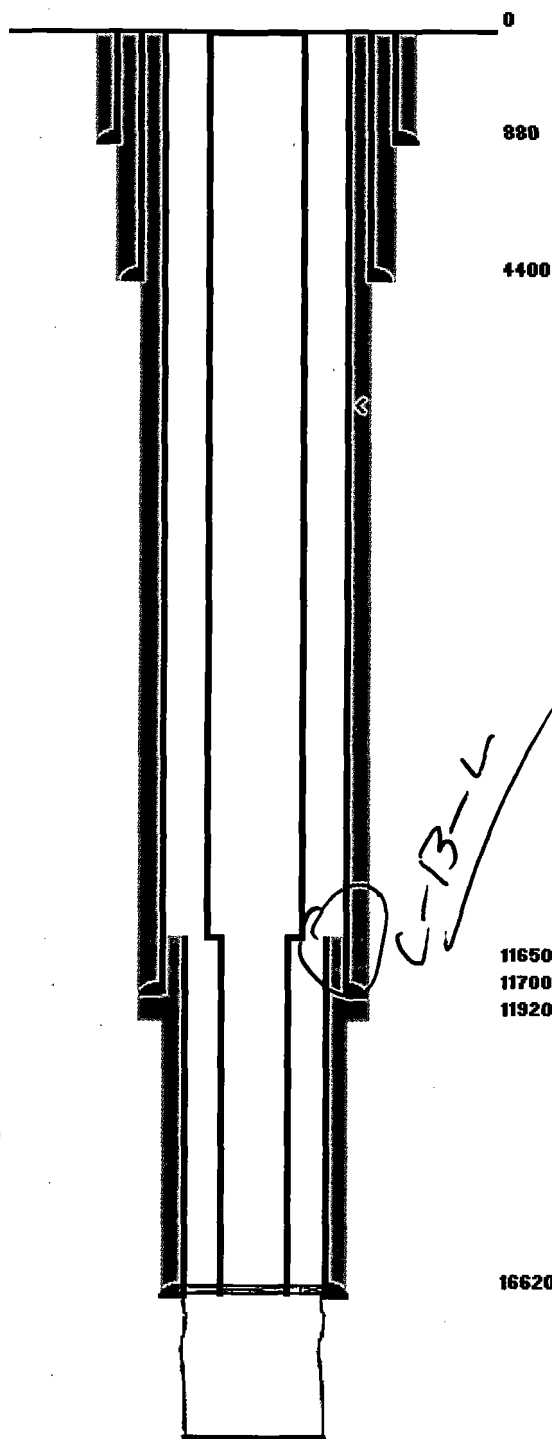

NOT TO SCALE

DISTRICT I  
1220 S. FRANCIS DR., SANTA FE, NM 87505  
Phone: (505) 426-6171 Fax: (505) 426-6170

DISTRICT II  
511 S. FIRST ST., ARTESIA, NM 80210  
Phone: (575) 748-1233 Fax: (575) 748-0780

DISTRICT III  
1000 RIO BRAZOS RD., ARTEC, NM 87410  
Phone: (505) 834-6170 Fax: (505) 834-6170

DISTRICT IV  
1220 S. ST. FRANCIS DR., SANTA FE, NM 87505  
Phone: (505) 426-6170 Fax: (505) 426-6170

State of New Mexico  
Energy, Minerals & Natural Resources Department  
**OIL CONSERVATION DIVISION**  
1220 SOUTH ST. FRANCIS DR.  
Santa Fe, New Mexico 87505

Form C-102  
Revised August 1, 2011  
Submit one copy to appropriate  
District Office

☐ AMENDED REPORT

**WELL LOCATION AND ACREAGE DEDICATION PLAT**

API Number	Pool Code	Pool Name
Property Code	Property Name <b>MESA VERDE SWD</b>	Well Number <b>3</b>
OGRID No.	Operator Name <b>MESQUITE SWD</b>	Elevation <b>3597.2'</b>

**Surface Location**

UL or lot No.	Section	Township	Range	Lot	Feet from the	North/South line	Feet from the	East/West line	County
N	13	24-S	31-E		1030	SOUTH	2635	WEST	EDDY

**Bottom Hole Location if Different From Surface**

UL or lot No.	Section	Township	Range	Lot	Feet from the	North/South line	Feet from the	East/West line	County
Dedicated Acres		Joint or Infill		Consolidation Code		Order No.			

**NO ALLOWABLE WILL BE ASSIGNED TO THIS COMPLETION UNTIL ALL INTERESTS HAVE BEEN CONSOLIDATED  
OR A NON-STANDARD UNIT HAS BEEN APPROVED BY THE DIVISION**

<p>NAD 83 NME SURFACE LOCATION Y=441725.2 N X=727453.9 E LAT.=32.212947° N LONG.=103.731544° W</p> <p>2635'</p> <p>1030'</p> <p>S.L.</p>					<p><b>OPERATOR CERTIFICATION</b></p> <p>I hereby certify that the information herein is true and complete to the best of my knowledge and belief, and that this organization either owns a working interest or unleased mineral interest in the land including the proposed bottom hole location or has a right to drill this well at this location pursuant to a contract with an owner of such mineral or working interest, or to a voluntary pooling agreement or a compulsory pooling order heretofore entered by the division.</p> <p>Signature _____ Date _____</p> <p>Printed Name _____</p> <p>E-mail Address _____</p>	
					<p><b>SURVEYOR CERTIFICATION</b></p> <p>I hereby certify that the well location shown on this plat was plotted from field notes of actual surveys made by me or under my supervision, and that the same is true and correct to the best of my belief.</p> <p>AUGUST 28, 2017</p> <p>Date of Survey _____</p> <p>Signature &amp; Seal of Professional Surveyor</p>	
					<p>CHAD L. HARCROW NEW MEXICO 17777 LICENSED PROFESSIONAL SURVEYOR</p> <p>Chad L. Harcrow 10/9/17</p> <p>Certificate No. CHAD HARCROW 17777</p> <p>W.O. # 17-1225 DRAWN BY: AJ</p>	



Mesquite SWD, Inc.  
PO Box 1479  
Carlsbad NM 88221

Michael,

Per my conversation with Ray Podany in the Artesia OCD office, the Mesa Verde SWD #3 on C-108 Mesquite SWD has submitted to the OCD.

Mesquite SWD, Inc. is requesting that the footage submitted on the C-108 stay as it is.

Mesquite SWD, Inc. worked with OXY on picking this location, so it wouldn't interfere with their future development plans in the Mesa Verde area, Sec 13 T24S R31E.

Mesquite SWD, Inc. is requesting that the footage submitted in the C-108 be approved.

2635' FWL & 1030' FSL Sec 13 T24S R31E.

Thank you for your help in this matter.

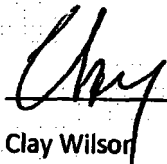
A handwritten signature in dark ink, appearing to read "Clay", is written over a horizontal line.

Clay Wilson  
President  
Mesquite SWD, Inc.

Mesquite SWD, Inc.  
Mesa Verde SWD #3  
1030' FSL & 2635' FWL  
Sec. 13, T24S-R31E Eddy County, NM

API 30-025-NA

Item V:

Area of Review  
 $\frac{1}{2}$  Mile and 2 Mile Radius

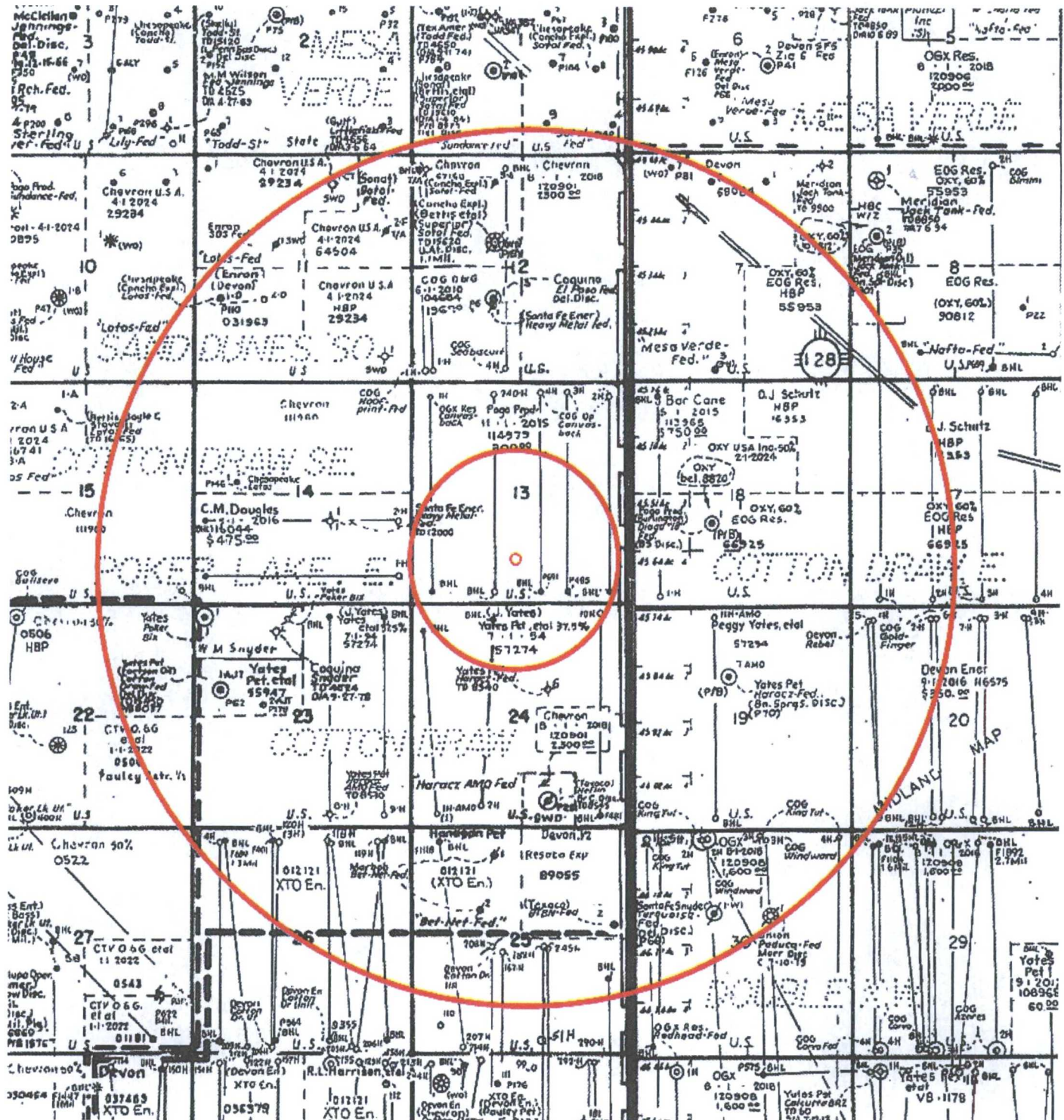

Some wells shown may not have been drilled.



Mesquite SWD, Inc.  
Mesa Verde SWD #3  
1030' FSL & 2635' FWL  
Sec. 13, T24S-R31E Eddy County, NM

API 30-025-NA

Item V (a):

AOR Half-Mile

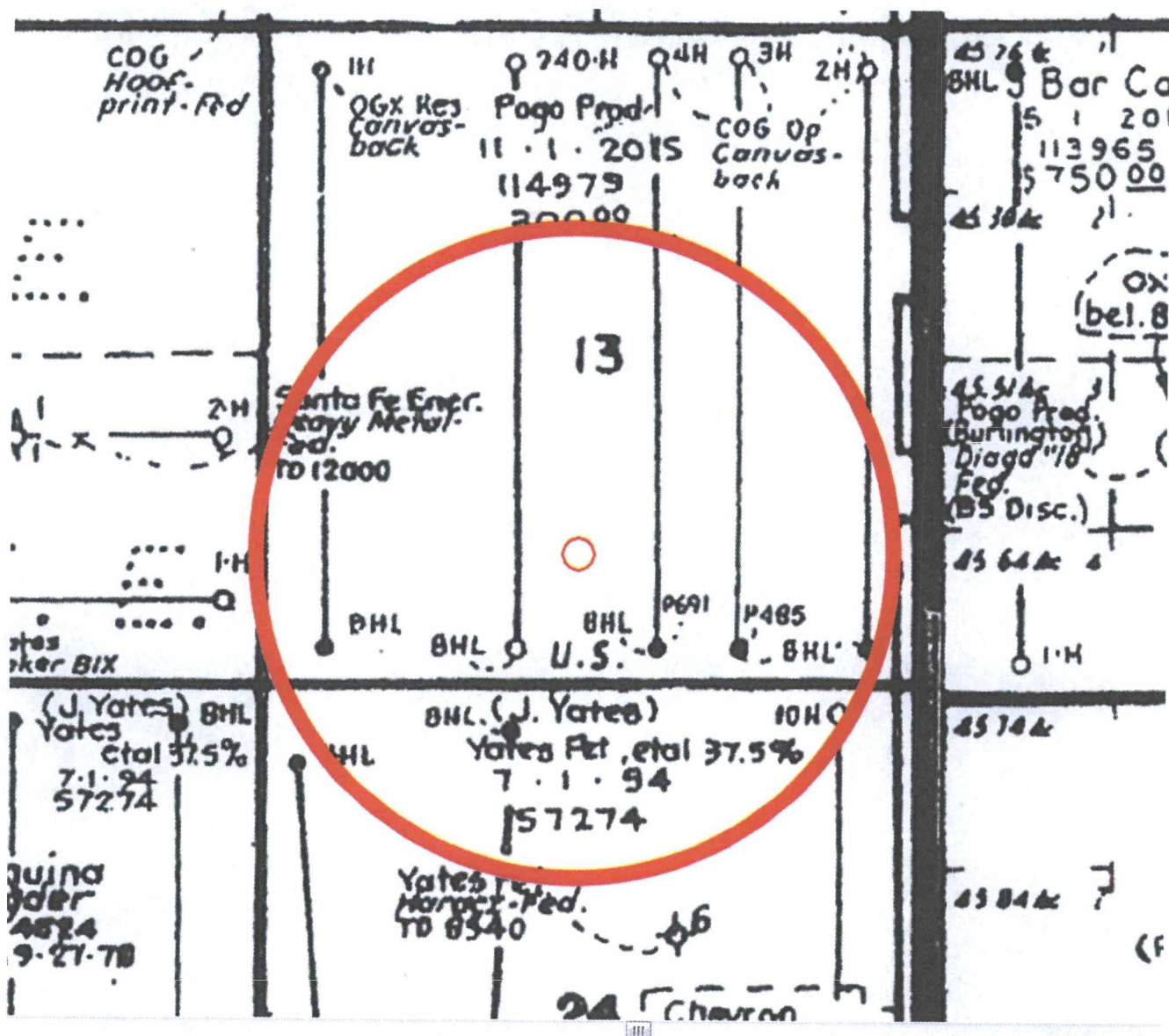

Some wells shown may not have been drilled.

Mesquite SWD, Inc.  
Mesa Verde SWD #3  
1030' FSL & 2635' FWL  
Sec. 13, T24S-R31E Eddy County, NM

API 30-025-NA

Wells in AOR:

API	WELL_NAME	STATUS	SDIV	SEC	TWN	RANGE	FTG	NS	FTG	EW	OCD	OPERATOR	WELL	LAND	PLUG_DATE	SPUD	ELEVGL	TVD_DEPTH
3001540538	CANVASBACK 13 FEDERAL 002H	drilled or	A	13	24.0S	31E	330 N		480 E	A		COG PRODUCTION, LLC	O	F		10-Aug-12	3580	8415
3001541529	CANVASBACK 13 FEDERAL 003H	drilled or	B	13	24.0S	31E	190 N		1470 E	B		COG PRODUCTION, LLC	O	F		21-Aug-13	3582	8409
3001541552	CANVASBACK 13 FEDERAL 004H	drilled or	B	13	24.0S	31E	190 N		2130 E	B		COG PRODUCTION, LLC	O	F		15-Sep-13	3582	8385
3001539191	CANVASBACK 13 FEDERAL 001H	drilled or	D	13	24.0S	31E	330 N		480 W	D		COG PRODUCTION, LLC	O	F		13-Jan-12	3569	8388

No known wells in the AOR penetrate pre-Pennsylvanian formations.

#### Item VII:

1. The maximum injected volume anticipated is 25,000 BWPD. Average anticipated is 18,000 BWPD.
2. Injection will be through a closed system.
3. Maximum injection pressure is expected to be 3,900 psi, or as controlled by depth.
4. Disposal sources will be produced waters that, based upon regional experience, are compatible with known waters in the disposal zone.
5. Water sample analysis from Sundown Ballard (SWD-354) Sec. 27, T20S-R34E Lea Co., Seven Rivers (4000') reports 18,665 mg/l TDS.

Mesquite SWD, Inc.  
Mesa Verde SWD #3  
1030' FSL & 2635' FWL  
Sec. 13, T24S-R31E Eddy County, NM

API 30-025-NA

**Item VIII:**

Disposal will be into Siluro-Devonian formations.

There is no known potable water within a 1-mile radius. Records from the New Mexico Office of the State Engineer on April 25, 2017 show no known water wells within a 1-mile radius of the proposed Mesquite SWD disposal well.



---

*New Mexico Office of the State Engineer*  
**Wells with Well Log Information**

---

No wells found.

**Basin/County Search:**

**Basin:** Lea County

**UTMNAD83 Radius Search (in meters):**

**Easting (X):** 621420

**Northing (Y):** 3564670

**Radius:** 3200

---

The data is furnished by the NMOSE/TSC and is accepted by the recipient with the expressed understanding that the OSE/TSC make no warranties, expressed or implied, concerning the accuracy, completeness, reliability, usability, or suitability for any particular purpose of the data.

---

3/25/17 5:39 PM

WELLS WITH WELL LOG INFORMATION

The surface geology of the greater area, including the 2-mile radius as shown in Item V above, is lower Pliocene to middle Miocene Ogallala Formation eolian and alluvial deposits. These are underlain by Permian formations and evaporites. Based upon surface geology the depth of potable water is expected to be less than 250'.

Mesquite SWD, Inc.  
Mesa Verde SWD #3  
1030' FSL & 2635' FWL  
Sec. 13, T24S-R31E Eddy County, NM

API 30-025-NA

**Item VIII: continued**

WELLNAME	API	TOWNSHIP	RANGE	SECTION	TDS(mg/L)	Chlorides(mg/L)
HEFLIN FED #001	3001505853	24S	31E	24	133002	82400
HEFLIN FED #001	3001505853	24S	31E	24	37824	13300
HEFLIN FED #001	3001505853	24S	31E	24	256580	158000

**Item IX:**

Acid may be applied after drilling compleed. No other formation stimulation is currently planned.

**Item X:**

Logs will be filed with the OCD upon completion of the well. Density-Neutron will cover open-hole.

**Item XI:**

Please note Item VIII discussion above.

**Item XII:**

There is no geological evidence of open faults or hydrologic connection between the disposal zone and any possible underground sources of protectable water.



Mesquite SWD, Inc.  
Mesa Verde SWD #3  
1030' FSL & 2635' FWL  
Sec. 13, T24S-R31E Eddy County, NM

API 30-025-NA

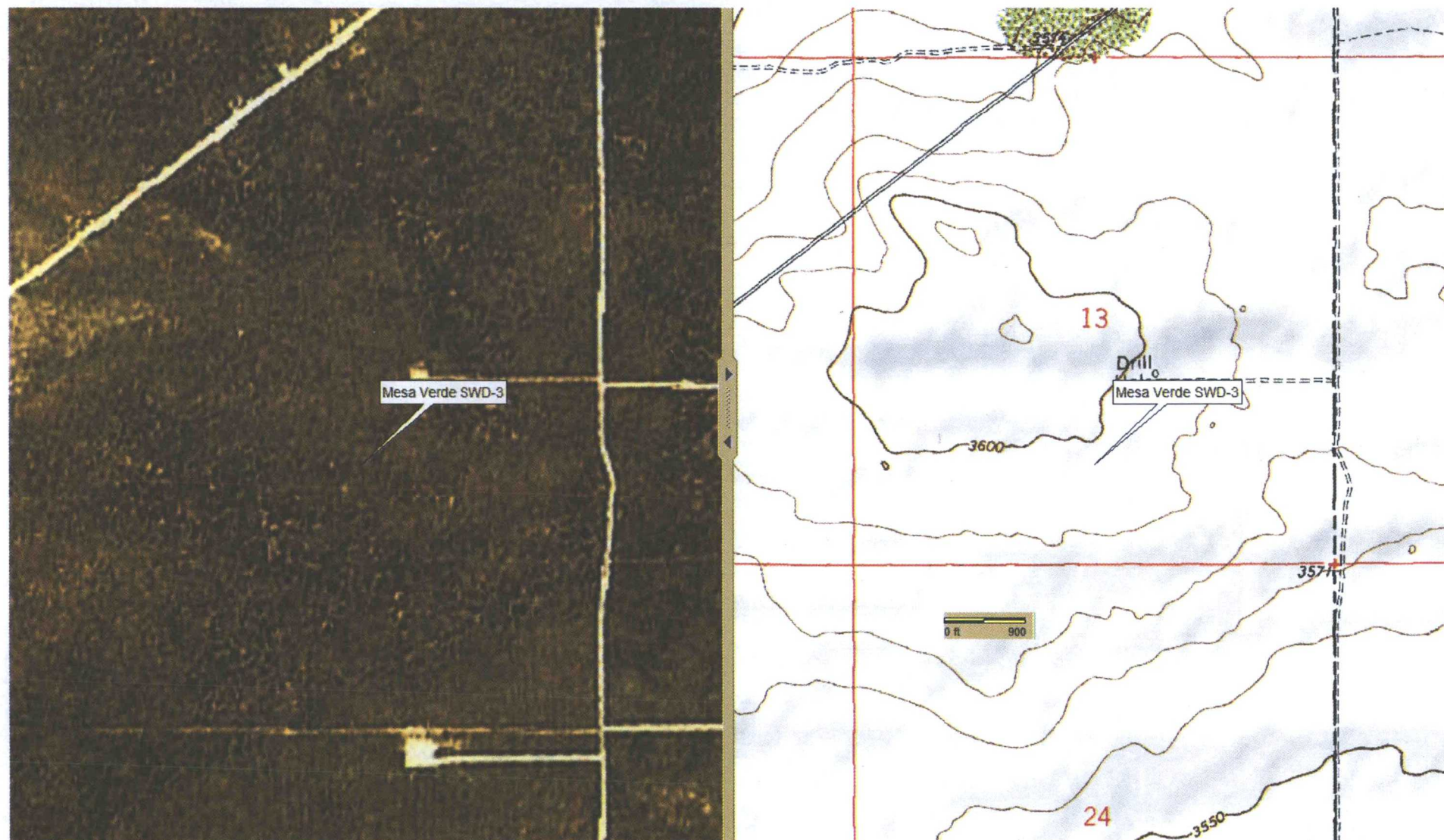

Delorme X-Map6 Pro  
Location approximately 32 miles west of Jal, NM, southwest on Buck Jackson Road approximately 2 miles off  
Mesquite SWD, Inc.

API 30-025-NA



Mesquite SWD, Inc.  
Mesa Verde SWD #3  
1030' FSL & 2635' FWL  
Sec. 13, T24S-R31E Eddy County, NM

API 30-025-NA

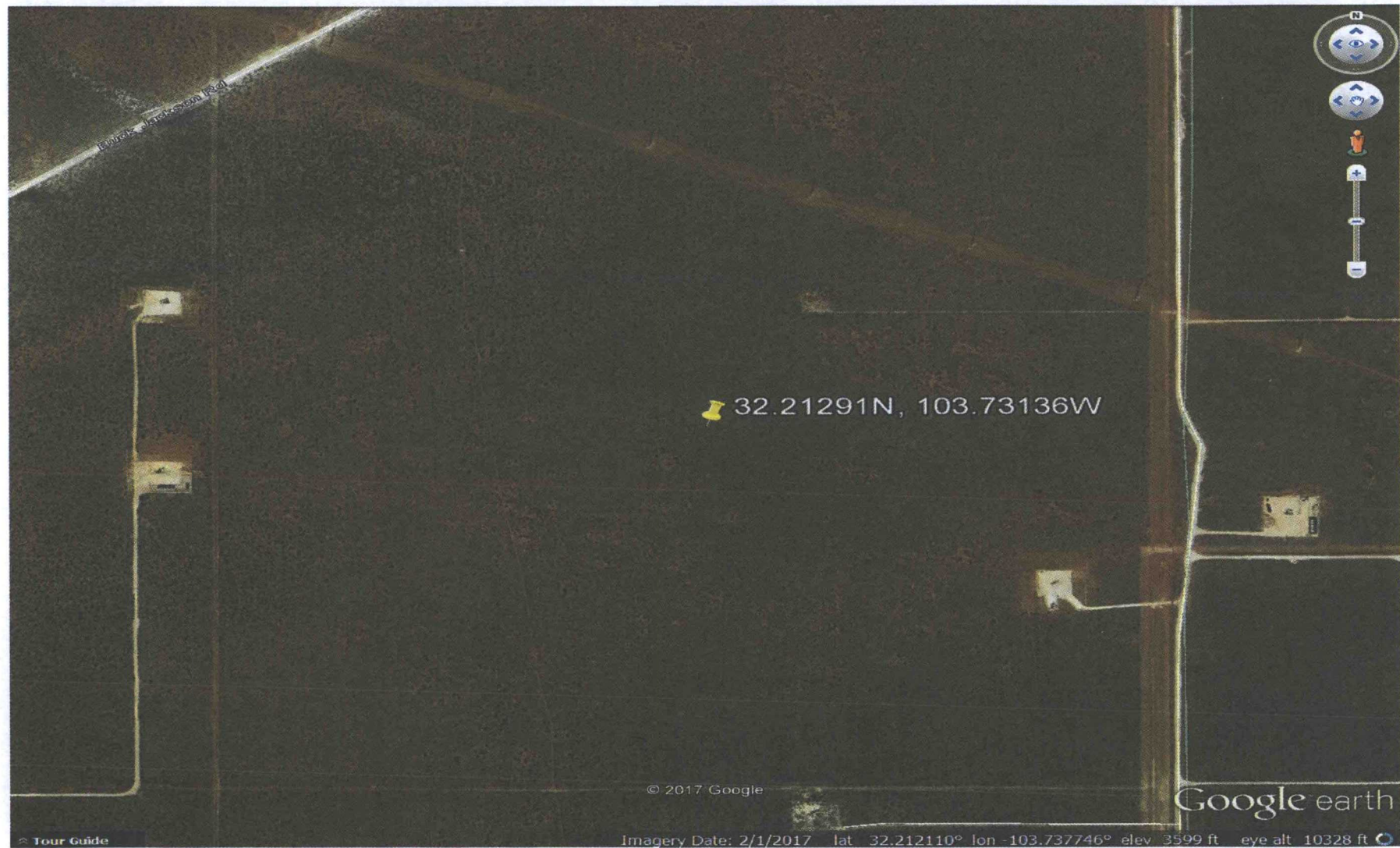

Google Earth Mesa Verde SWD-3  
Google Earth view of Mesa Verde SWD #3 proposed location.



Mesquite SWD, Inc.  
Mesa Verde SWD #3  
1030' FSL & 2635' FWL  
Sec. 13, T24S-R31E Eddy County, NM

API 30-025-NA

**Item XIII: Proof of Notice**

**Minerals Owner:**

Bureau of Land Management  
620 E. Greene St.  
Carlsbad, NM 88220

**Surface:**

BLM

**Operators in AOR:**

COG Operatinng, LLC  
600 W. Illinois Ave  
Midland, TX 79701

Sec. 13

EOG Y Resources, Inc.  
104 S. 4<sup>th</sup> St.  
Artesia, NM 88210

Sec 24

Mesquite SWD, Inc.  
Mesa Verde SWD #3  
1030' FSL & 2635' FWL  
Sec. 13, T24S-R31E Eddy County, NM

API 30-025-NA

Item XIII: Legal Publication

## Affidavit of Publication

No. 24405

State of New Mexico

County of Eddy:

**Danny Scott**

being duly sworn says that she is the

**Publisher**

of the Artesia Daily Press, a daily newspaper of General circulation, published in English at Artesia, said county and state, and that the hereto attached

### Legal Ad

was published in a regular and entire issue of the said Artesia Daily Press, a daily newspaper duly qualified for that purpose within the meaning of Chapter 167 of the 1937 Session Laws of the state of New Mexico for

1 Consecutive weeks/day on the same

day as follows:

First Publication September 8, 2017

Second Publication

Third Publication

Fourth Publication

Fifth Publication

Sixth Publication

Seventh Publication

Subscribed and sworn before me this

12th day of September 2017



OFFICIAL SEAL  
Latisha Romine  
NOTARY PUBLIC-STATE OF NEW MEXICO

My commission expires: 5/12/2019

*Latisha Romine*

Latisha Romine

Notary Public, Eddy County, New Mexico

## Copy of Publication:

### Legal Notice

Mesquite SWD, Inc., c/o Kay Havenor, 904 Moore Ave, Roswell, NM 88201-1144, (575) 626-4518, is seeking approval from the New Mexico Oil Conservation Division to drill and complete the Mesquite SWD, Inc., Mesa Verde SWD #3, well API: unassigned, to be located 1030' from the south line and 2635' from the west line of Section 13, Township 24 south and Range 31 east, Eddy County, NM for commercial produced water disposal. The proposed disposal interval is open-hole into the Siluro-Devonian formations approximately 16,633'-17,843'.

Mesquite SWD, Inc. plans to dispose a maximum of 35,000 BWPD with a maximum pressure of 3,569 psi.

Parties with questions regarding this proposal can contact Kay Havenor at the address or phone number above.

Interested parties must file objections or request for hearing within 15 days of publication to the Oil Conservation Division: 1220 South St. Francis Dr., Santa Fe, NM 87505.

Published in the Artesia Daily Press, Artesia, N.M., Sept. 8, 2017 Legal No. 24405.

Mesquite SWD, Inc.  
Mesa Verde SWD #3  
1030' FSL & 2635' FWL  
Sec. 13, T24S-R31E Eddy County, NM

API 30-025-NA

**Item XIII:  
Notification  
Receipts**

Page 1



September 12, 2017

Dear Customer:

The following is the proof-of-delivery for tracking number **770215146502**.

---

**Delivery Information:**

<b>Status:</b>	Delivered	<b>Delivered to:</b>	Receptionist/Front Desk
<b>Signed for by:</b>	T.NORRIS	<b>Delivery location:</b>	620 E GREENE ST CARLSBAD, NM 88220
<b>Service type:</b>	FedEx Express Saver	<b>Delivery date:</b>	Sep 11, 2017 12:41
<b>Special Handling:</b>	Deliver Weekday		

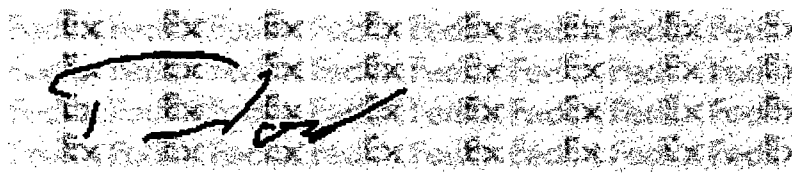

---

**Shipping Information:**

<b>Tracking number:</b>	770215146502	<b>Ship date:</b>	Sep 8, 2017
-------------------------	--------------	-------------------	-------------

**Recipient:**  
Bureau of Land Management  
620 E GREENE ST  
CARLSBAD, NM 88220 US

**Shipper:**  
Deborah Havenor  
904 Moore Ave  
Roswell, NM 88201 US

Thank you for choosing FedEx.

Mesquite SWD, Inc.  
Mesa Verde SWD #3  
1030' FSL & 2635' FWL  
Sec. 13, T24S-R31E Eddy County, NM

API 30-025-NA

Page 2



September 12, 2017

Dear Customer:

The following is the proof-of-delivery for tracking number 770215654905.

---

**Delivery Information:**

Status:	Delivered	Delivered to:	Receptionist/Front Desk
Signed for by:	R. PEREZ	Delivery location:	600 W ILLINOIS MIDLAND, TX 79701
Service type:	FedEx Express Saver	Delivery date:	Sep 12, 2017 10:22
Special Handling:	Deliver Weekday		

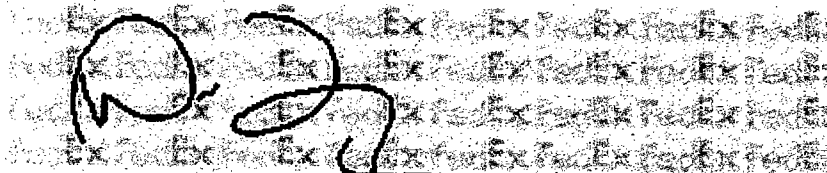

---

**Shipping Information:**

Tracking number:	770215654905	Ship date:	Sep 8, 2017
------------------	--------------	------------	-------------

Recipient:  
COG Operating, LLC  
600 W ILLINOIS AVE  
MIDLAND, TX 79701 US

Shipper:  
Deborah Havenor  
904 Moore Ave  
Roswell, NM 88201 US

Thank you for choosing FedEx.

Mesquite SWD, Inc.  
Mesa Verde SWD #3  
1030' FSL & 2635' FWL  
Sec. 13, T24S-R31E Eddy County, NM

API 30-025-NA

Page 3



September 12, 2017

Dear Customer:

The following is the proof-of-delivery for tracking number **770215694324**.

---

**Delivery Information:**

<b>Status:</b>	Delivered	<b>Delivered to:</b>	Receptionist/Front Desk
<b>Signed for by:</b>	N.ANDERSON	<b>Delivery location:</b>	105 S 4TH ST ARTESIA, NM 88210
<b>Service type:</b>	FedEx Express Saver	<b>Delivery date:</b>	Sep 11, 2017 09:52
<b>Special Handling:</b>	Deliver Weekday		

A handwritten signature in black ink, appearing to read "N. Anderson", is written over a background of repeating "FedEx" logos.

---

**Shipping Information:**

<b>Tracking number:</b>	770215694324	<b>Ship date:</b>	Sep 8, 2017
-------------------------	--------------	-------------------	-------------

**Recipient:**  
EOG-Y Resources, Inc.  
104 S 4TH ST  
ARTESIA, NM 88210 US

**Shipper:**  
Deborah Havenor  
904 Moore Ave  
Roswell, NM 88201 US

Thank you for choosing FedEx.



## *New Mexico Office of the State Engineer* **Water Column/Average Depth to Water**

(quarters are 1=NW 2=NE 3=SW 4=SE)

(quarters are smallest to largest) (NAD83 UTM in meters)

No records found.

**PLSS Search:**

Section(s): 13-14, 23-24 Township: 24S Range: 31E

The data is furnished by the NMOSE/ISC and is accepted by the recipient with the expressed understanding that the OSE/ISC make no warranties, expressed or implied, concerning the accuracy, completeness, reliability, usability, or suitability for any particular purpose of the data.

10/5/17 9:06 AM

WATER COLUMN/ AVERAGE  
DEPTH TO WATER



## *New Mexico Office of the State Engineer* **Water Column/Average Depth to Water**

(quarters are 1=NW 2=NE 3=SW 4=SE)

(quarters are smallest to largest) (NAD83 UTM in meters)

No records found.

### PLSS Search:

Section(s): 18

Township: 24S

Range: 32E

The data is furnished by the NMOSE/ISC and is accepted by the recipient with the expressed understanding that the OSE/ISC make no warranties, expressed or implied, concerning the accuracy, completeness, reliability, usability, or suitability for any particular purpose of the data.

10/5/17 9:07 AM

WATER COLUMN/ AVERAGE  
DEPTH TO WATER



C-108 Review Checklist: Received \_\_\_\_\_ Add. Request: \_\_\_\_\_ Reply Date: \_\_\_\_\_ Suspended: \_\_\_\_\_ [Ver 15]

ORDER TYPE: WFX / PMX / SWD Number: \_\_\_\_\_ Order Date: \_\_\_\_\_ Legacy Permits/Orders: \_\_\_\_\_

Well No. 3 Well Name(s): mesquite

API: 30-0 15-Pending Spud Date: 7/31/17 New or Old: \_\_\_\_\_ (UIC Class II Primacy 03/07/1982)

Footages 1030 FSL  
2635 FUL Lot \_\_\_\_\_ or Unit N Sec 13 Tsp 24S Rge 31E County Eddy

General Location: 230 miles N Pool: S&W DeLeonium-Silurian Pool No.: 97869

BLM 100K Map: JAI Operator: mesquite OGRID: 161418 Contact: KAY HAVENS

COMPLIANCE RULE 5.9: Total Wells: 26 Inactive: 2 Fincl Assur: OK Compl. Order? MA IS 5.9 OK? Y Date: 10-10-2017

WELL FILE REVIEWED ☐ Current Status: Proposed

WELL DIAGRAMS: NEW: Proposed ☐ or RE-ENTER: Before Conv. ☐ After Conv. ☐ Logs in Imaging: MA

Planned Rehab Work to Well: \_\_\_\_\_

Well Construction Details		Sizes (in) Borehole / Pipe	Setting Depths (ft)	Cement (Sx) or Cf	Cement Top and Determination Method
Planned ___ or Existing <u>Surface</u>		<u>26"/20"</u>	<u>580</u>	<u>1980</u>	<u>SURFACE / VISUAL</u>
Planned ___ or Existing <u>Interm/Prod</u>		<u>17 1/2"/13 3/4"</u>	<u>4400</u>	<u>1000</u>	<u>SURFACE / VISUAL</u>
Planned ___ or Existing <u>Interm/Prod</u>		<u>12 1/4"/9 5/8"</u>	<u>11700</u>	<u>1800</u>	<u>SURFACE / VISUAL</u>
Planned ___ or Existing <u>Prod/Liner</u>		<u>8 1/2"/7 5/8"</u>	<u>16620</u>	<u>2880</u>	<u>11650 / C-B-L</u>
Planned ___ or Existing <u>Liner</u>					
Planned ___ or Existing <u>OH / PERF</u>					

Injection Lithostratigraphic Units	Depths (ft)	Injection or Confining Units	Tops	Completion/Operation Details:
Adjacent Unit: Litho. Struc. Por.		<u>16620</u>	<u>DEV</u>	Drilled TD _____ PBTB _____
Confining Unit: Litho. Struc. Por.		<u>16152</u>	<u>MS</u>	NEW TD _____ NEW PBTB _____
Proposed Inj Interval TOP:				NEW Open Hole <input type="radio"/> or NEW Perfs <input type="radio"/>
Proposed Inj Interval BOTTOM:				Tubing Size <u>4</u> in. Inter Coated? _____
Confining Unit: Litho. Struc. Por.				Proposed Packer Depth _____ ft
Adjacent Unit: Litho. Struc. Por.				Min. Packer Depth _____ (100-ft limit)
				Proposed Max. Surface Press. _____ psi
				Admin. Inj. Press. _____ (0.2 psi per ft)

#### AOR: Hydrologic and Geologic Information

POTASH: R-111-P MA Noticed? \_\_\_\_\_ BLM Sec Ord ☒ WIPP ☐ Noticed? MA Salt/Salado T: 160 B: 4370 NW: Cliff House fm \_\_\_\_\_

FRESH WATER: Aquifer \_\_\_\_\_ Max Depth \_\_\_\_\_ HYDRO AFFIRM STATEMENT By Qualified Person ☐

NMOSE Basin: CARLSBAD CAPITAN REEF: thru adj NA No. Wells within 1-Mile Radius? 0 FW Analysis \_\_\_\_\_

Disposal Fluid: Formation Source(s) \_\_\_\_\_ Analysis? \_\_\_\_\_ On Lease ☐ Operator Only ☐ or Commercial ☐

Disposal Int: Inject Rate (Avg/Max BWPD): MA-254 B17D Protectable Waters? \_\_\_\_\_ Source: \_\_\_\_\_ System: Closed or Open

HC Potential: Producing Interval? MA Formerly Producing? \_\_\_\_\_ Method: Logs/DST/P&A/Other mesquite 2-Mile Radius Pool Map ☐

AOR Wells: 1/2-M Radius Map? Y Well List? X Total No. Wells Penetrating Interval: 0 Horizontals? \_\_\_\_\_

Penetrating Wells: No. Active Wells 0 Num Repairs? \_\_\_\_\_ on which well(s)? \_\_\_\_\_ Diagrams? \_\_\_\_\_

Penetrating Wells: No. P&A Wells 0 Num Repairs? \_\_\_\_\_ on which well(s)? \_\_\_\_\_ Diagrams? \_\_\_\_\_

NOTICE: Newspaper Date September 11 Mineral Owner BLM Surface Owner BLM N. Date Sept. 11

RULE 26.7(A): Identified Tracts? \_\_\_\_\_ Affected Persons: CUB, EOB N. Date Sept. 11, 2017

Order Conditions: Issues: C-B-L B1W Intermediate Gliner

dd Order Cond:



## Kay C. Havenor

Office: 575-626-4518  
e-mail: Kay.Havenor@Gmail.com  
904 Moore Ave  
Roswell, New Mexico 88201-1144

September 7, 2017

New Mexico OCD  
Attn: Mr. Michael McMillan  
1220 South St. Francis Dr.  
Santa Fe, NM 81505

Re: Mesquite SWD, Inc.  
Sand Dunes SWD #1  
Sec 5, T24S-R31E, Eddy Co., NM  
C-108 application

Dear Mr. McMillan:

The proposed well construction in the submitted application may have minor field changes due to actual joint lengths received on site. Casing depths in this well are planed to insure there will be no hydrologic connection between underground sources of drinking water and the injection zone.

Respectfully submitted,



Kay Havenor, PhD, PG  
Agent on behalf of Mesquite SWD, Inc.

## Kay C. Havenor

*Ph.D., Registered Geologist Arizona #30438  
Certified Professional Geologist*

**Environmental - Hydrogeology  
Remote Sensing - Resources**

Office: 505-624-4518

e-mail [kay.havenor@gmail.com](mailto:kay.havenor@gmail.com)  
904 Moore Avenue  
Roswell, New Mexico 88201

September 8, 2017

New Mexico OCD  
Attn: Mr. Michael McMillan  
1220 South St. Francis Dr.  
Santa Fe, NM 81505

Re: Mesquite SWD, Inc.  
Mesa Verde SWD #3  
Sec 13, T24S-R31E, Eddy Co.  
C-108 application

Dear Mr. McMillan:

Your request for notification to Potash is respectfully believed to not be required. The proposed location is 1030' FSL and 2635' FWL of section 13. This location is 2-1/4 miles from the closest edge of Potash property and therefore outside the 2-mile area of review. Additionally, to my understanding, it does not come under the Rule 5.9 notification requirements.

Should I be incorrect please so advise me.

Respectfully,

*Kay Havenor*

Water samples in Sand Dunes SWD #1 greater area

Sand Dunes SWD #1

Unit N, 260' FSL & 2053' FWL  
Sec 5, T24S-R31E, Eddy Co., NM

WELLNAME	API	TOWNSHIP	RANGE	SECTION	TDS(mg/L)	Chlorides(mg/L)
TODD 23 C FEDERAL #018	3001532629	23S	31E	23	277304.6	167584
TODD 23 C FEDERAL #018	3001532629	23S	31E	23	277467	167584
TODD 27 I FEDERAL #009	3001535521	23S	31E	27	183187.7	113568
TODD 27 I FEDERAL #009	3001535521	23S	31E	27	183536	113568
TODD 26 F FEDERAL #003	3001520302	23S	31E	26	248666.5	147008
TODD 36 B STATE #015	3001529102	23S	31E	36	277300.2	169386
TODD 14 K FEDERAL #001	3001520298	23S	31E	14	283352.3	179150
TODD 23 O FEDERAL #001	3001520796	23S	31E	23	259135.1	160870
TODD 23 J FEDERAL #002	3001522473	23S	31E	23	78713.6	45722
TODD 23 I FEDERAL #004	3001526928	23S	31E	23	281743.1	178230
GRAHAM AKB STATE #003	3001531604	22S	31E	02		164963
GRAHAM AKB STATE #009	3001531606	22S	31E	02		166962
ARK 36 STATE #001H	3001542082	22S	31E	36	146288.1	90420.2
GRAHAM AKB STATE #001	3001526875	22S	31E	02	295345	184958
GRAHAM AKB STATE #002	3001526876	22S	31E	02	301948	188957

Bine  
Spring

Devon Energy Corp

Water samples (commingled) from Bone Springs and Wolfcamp

WELLNAME	API	TOWNSHIP	RANGE	SECTION	TDS(mg/L)	Chlorides(mg/L)
TODD 14 K FEDERAL #001	3001520288	23S	31E	14	283352.3	178150
TODD 14 K FEDERAL #001	3001520298	23S	31E	14	301108.9	178934