

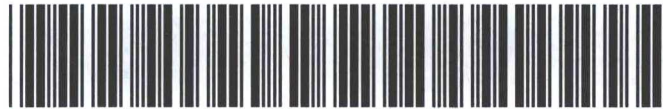

# AE Order Number Banner

## Report Description

This report shows an AE Order Number in Barcode format for purposes of scanning. The Barcode format is Code 39.



**App Number:** pCS1507831688

**3RP - 1024**

**ELM RIDGE EXPLORATION COMPANY LLC**

9/14/2017

District I  
1625 N. French Dr., Hobbs, NM 88240  
District II  
811 S. First St., Artesia, NM 88210  
District III  
1000 Rio Brazos Road, Aztec, NM 87410  
District IV  
1220 S. St. Francis Dr., Santa Fe, NM 87505

State of New Mexico  
Energy Minerals and Natural Resources

Oil Conservation Division  
1220 South St. Francis Dr.  
Santa Fe, NM 87505

Form C-141  
Revised August 8, 2011

Submit 1 Copy to appropriate District Office in  
accordance with 19.15.29 NMAC.

### Release Notification and Corrective Action

#### OPERATOR

☐ Initial Report ☒ Final Report

|  |                                   |         |
|--|-----------------------------------|---------|
| Name of Company: Elm Ridge Exploration Co.         | Contact: Dianna Hamilton 330-2736 |         |
| Address: 2001 E. Blanco Blvd. Bloomfield, NM 87413 | Telephone No. 634-1144            |         |
| Facility Name: Marcus Compressor Station           | Facility Type: Compressor Station |         |
| Surface Owner: BLM                                 | Mineral Owner:                    | API No. |

#### LOCATION OF RELEASE

|             |                |                  |              |               |                  |               |                |        |
|-------------|----------------|------------------|--------------|---------------|------------------|---------------|----------------|--------|
| Unit Letter | Section<br>S11 | Township<br>T23N | Range<br>R7W | Feet from the | North/South Line | Feet from the | East/West Line | County |
|-------------|----------------|------------------|--------------|---------------|------------------|---------------|----------------|--------|

Latitude 36.24568 Longitude -107.53751

#### NATURE OF RELEASE

|  |   |                               |
|--|---|-------------------------------|
| Type of Release: oil water emulsified liquid   | Volume of Release: ~40 bbl  | Volume Recovered: 21.46 bbls  |
| Source of Release: overflow from slop tank to pit.   | Date and Hour of Occurrence   | June 21, 2017 approx. 12:00pm |
| Was Immediate Notice Given?<br><input checked="" type="checkbox"/> Yes <input type="checkbox"/> No <input type="checkbox"/> Not Required | If YES, To Whom? NMOCD's Cory Smith and Vanessa Fields as well as BLM's Kenneth Kilness |                               |
| By Whom? Dianna Hamilton   | Date and Hour 6.21.17 3:00pm  | <b>OIL CONS. DIV DIST. 3</b>  |
| Was a Watercourse Reached?<br><input type="checkbox"/> Yes <input checked="" type="checkbox"/> No  | If YES, Volume Impacting the Watercourse.<br><b>AUG 1 1 2017</b>                        |                               |

If a Watercourse was Impacted, Describe Fully. \* N/A

Describe Cause of Problem and Remedial Action Taken. \* The cause of this release was human error. Operator was doing his routine drain from the slop tank to the pit and left the valve open. Operator called midstream regulatory contact to report and to begin remediation and clean up coordination.

Describe Area Affected and Cleanup Action Taken. \* The release was restricted to the containment area/berm. 21.46 bbls were recovered, however; there is no existing pit liner, which resulted in soil contamination. 3<sup>rd</sup> party contractor, Halo Construction will begin clean up on Monday June 26, 2017 at 8:00am. Plans to pull tank and excavate the contaminated area, hauling contaminated soil to land farm, followed by soil sampling, pit lining and resetting tank and containment area. Dianna Hamilton notified NMOCD and BLM of potential sampling date and time to allow NMOCD and BLM to witness however Vanessa was unable to attend and she advised me to go ahead and sample. See attached labs and report and labs for further detail. Site was ranked a "0" and with that, results were acceptable and we were given permission by Vanessa Fields to backfill.

I hereby certify that the information given above is true and complete to the best of my knowledge and understand that pursuant to NMOCD rules and regulations all operators are required to report and/or file certain release notifications and perform corrective actions for releases which may endanger public health or the environment. The acceptance of a C-141 report by the NMOCD marked as "Final Report" does not relieve the operator of liability should their operations have failed to adequately investigate and remediate contamination that pose a threat to ground water, surface water, human health or the environment. In addition, NMOCD acceptance of a C-141 report does not relieve the operator of responsibility for compliance with any other federal, state, or local laws and/or regulations.

|   |  |                                   |
|---|--|-----------------------------------|
| Signature: <i>Dianna Hamilton</i>       | <b>OIL CONSERVATION DIVISION</b>                         |                                   |
| Printed Name: Dianna Hamilton           | Approved by Environmental Specialist: <i>[Signature]</i> |                                   |
| Title: HSE Coordinator                  | Approval Date: 9/14/17                                   | Expiration Date:                  |
| E-mail Address: dhamilton@djrlc.com     | Conditions of Approval:                                  | Attached <input type="checkbox"/> |
| Date: July 26, 2017 Phone: 505-330-2736 |  |                                   |

\* Attach Additional Sheets If Necessary

#NUF 1718 155 633

52



August 8, 2017

New Mexico Oil Conservation Division  
1000 Rio Brazos Road  
Aztec, NM 87410

Return Receipt Requested 7015 0640 0005 8540 0526

Subject: Marcus Compressor Station Release

To whom it may concern,

DJR Operating (previously Elm Ridge Exploration dba Beeline Gas Systems) is submitting this packet which contains C-141 initial and final reports, lab results and reports, C-138.

If you have any questions or comments please feel free to contact me at the above number or by email at [dhamilton@djrlc.com](mailto:dhamilton@djrlc.com)

Sincerely,

Dianna Hamilton  
HSE Coordinator

OIL CONS. DIV DIST. 3  
AUG 11 2017

*Attachments:* C-141 Initial  
C-141 Final  
C-138  
Lab analysis report for soil samples  
Full report for release (Animas Environmental)

District I  
1625 N. French Dr., Hobbs, NM 88240  
District II  
811 S. First St., Artesia, NM 88210  
District III  
1000 Rio Brazos Road, Aztec, NM 87410  
District IV  
1220 S. St. Francis Dr., Santa Fe, NM 87505

State of New Mexico  
Energy Minerals and Natural Resources

**COPY**

Form C-141  
Revised August 8, 2011

Oil Conservation Division  
1220 South St. Francis Dr.  
Santa Fe, NM 87505

Submit 1 Copy to appropriate District Office in  
accordance with 19.15.29 NMAC.

**Release Notification and Corrective Action**

**OPERATOR**

☒ Initial Report ☐ Final Report

|  |                                   |         |
|--|-----------------------------------|---------|
| Name of Company: Elm Ridge Exploration Co.         | Contact: Dianna Hamilton 330-2736 |         |
| Address: 2001 E. Blanco Blvd. Bloomfield, NM 87413 | Telephone No. 634-1144            |         |
| Facility Name: Marcus Compressor Station           | Facility Type: Compressor Station |         |
| Surface Owner: BLM                                 | Mineral Owner:                    | API No. |

**LOCATION OF RELEASE**

| Unit Letter | Section<br>S11 | Township<br>T23N | Range<br>R7W | Feet from the | North/South Line | Feet from the | East/West Line | County |
|-------------|----------------|------------------|--------------|---------------|------------------|---------------|----------------|--------|
|-------------|----------------|------------------|--------------|---------------|------------------|---------------|----------------|--------|

Latitude 36.24568 Longitude -107.53751

**NATURE OF RELEASE**

|  |   |                               |
|--|---|-------------------------------|
| Type of Release: oil water emulsified liquid   | Volume of Release: ~40 bbl  | Volume Recovered: 21.46 bbls  |
| Source of Release: overflow from slop tank to pit.   | Date and Hour of Occurrence   | June 21, 2017 approx. 12:00pm |
| Was Immediate Notice Given?<br><input checked="" type="checkbox"/> Yes <input type="checkbox"/> No <input type="checkbox"/> Not Required | If YES, To Whom? NMOCD's Cory Smith and Vanessa Fields as well as BLM's Kenneth Kilness |                               |
| By Whom? Dianna Hamilton   | Date and Hour 6.21.17 3:00pm  |                               |
| Was a Watercourse Reached?<br><input type="checkbox"/> Yes <input checked="" type="checkbox"/> No  | If YES, Volume Impacting the Watercourse.   |                               |

**OIL CONS. DIV DIST. 3**

**AUG 1 1 2017**

If a Watercourse was Impacted, Describe Fully.\* N/A

Describe Cause of Problem and Remedial Action Taken.\* It appears that the cause of this release was human error. Operator was doing his routine drain from the slop tank to the pit and left the valve open. Operator called midstream regulatory contact to report and to begin remediation and clean up coordination.

Describe Area Affected and Cleanup Action Taken.\* The release was restricted to the containment area/berm. 21.46 bbls were recovered, however; there is no existing pit liner, which resulted in soil contamination. 3<sup>rd</sup> party contractor, Halo Construction will begin clean up on Monday June 26, 2017 at 8:00am. Plans to pull tank and excavate the contaminated area, hauling contaminated soil to land farm, followed by soil sampling, pit lining and resetting tank and containment area. Please note, Dianna Hamilton will notify NMOCD and BLM of potential sampling date and time to allow NMOCD and BLM to witness.

I hereby certify that the information given above is true and complete to the best of my knowledge and understand that pursuant to NMOCD rules and regulations all operators are required to report and/or file certain release notifications and perform corrective actions for releases which may endanger public health or the environment. The acceptance of a C-141 report by the NMOCD marked as "Final Report" does not relieve the operator of liability should their operations have failed to adequately investigate and remediate contamination that pose a threat to ground water, surface water, human health or the environment. In addition, NMOCD acceptance of a C-141 report does not relieve the operator of responsibility for compliance with any other federal, state, or local laws and/or regulations.

|                                     |                                       |                                   |
|-------------------------------------|---------------------------------------|-----------------------------------|
| Signature: <i>Dianna Hamilton</i>   | <b>OIL CONSERVATION DIVISION</b>      |                                   |
| Printed Name: Dianna Hamilton       | Approved by Environmental Specialist: |                                   |
| Title: HSE Coordinator              | Approval Date:                        | Expiration Date:                  |
| E-mail Address: dhamilton@djrlc.com | Conditions of Approval:               | Attached <input type="checkbox"/> |
| Date: 6.22.17 Phone: 505-330-2736   |                                       |                                   |

\* Attach Additional Sheets If Necessary

Mailed to Vanessa on 6/26/17

COLA

District I  
1625 N. French Dr., Hobbs, NM 88240  
District II  
811 S. First St., Artesia, NM 88210  
District III  
1000 Rio Brazos Road, Aztec, NM 87410  
District IV  
1220 S. St. Francis Dr., Santa Fe, NM 87505

State of New Mexico  
Energy Minerals and Natural Resources  
Oil Conservation Division  
1220 South St. Francis Dr.  
Santa Fe, NM 87505

17035-0003

Form C-138  
Revised August 1, 2011

\*Surface Waste Management Facility Operator  
and Generator shall maintain and make this  
documentation available for Division inspection.

REQUEST FOR APPROVAL TO ACCEPT SOLID WASTE

|  |
|--|
| 1. Generator Name and Address:<br>Elmridge Exploration CO, 2001 E. Blanco Blvd, PO Box 1280 Bloomfield NM 87413  |
| 2. Originating Site:<br>Marcus Compressor Station  |
| 3. Location of Material (Street Address, City, State or ULSTR):<br>S11 T23N R7W<br>June 2017   |
| 4. Source and Description of Waste:<br>Hydrocarbon impacted soil from the release of produced water and crude oil mixture due to tank overflow.<br>Estimated Volume 20 yd <sup>3</sup> / bbls Known Volume (to be entered by the operator at the end of the haul) 248 yd <sup>3</sup> / bbls   |
| 5. GENERATOR CERTIFICATION STATEMENT OF WASTE STATUS<br>I, Dianna Hamilton, representative or authorized agent for Elm Ridge Exploration do hereby<br>PRINT & SIGN NAME COMPANY NAME<br>certify that according to the Resource Conservation and Recovery Act (RCRA) and the US Environmental Protection Agency's July 1988<br>regulatory determination, the above described waste is: (Check the appropriate classification)<br><input checked="" type="checkbox"/> RCRA Exempt: Oil field wastes generated from oil and gas exploration and production operations and are not mixed with non-<br>exempt waste. Operator Use Only: Waste Acceptance Frequency <input type="checkbox"/> Monthly <input type="checkbox"/> Weekly <input type="checkbox"/> Per Load<br><input type="checkbox"/> RCRA Non-Exempt: Oil field waste which is non-hazardous that does not exceed the minimum standards for waste hazardous by<br>characteristics established in RCRA regulations, 40 CFR 261.21-261.24, or listed hazardous waste as defined in 40 CFR, part 261,<br>subpart D, as amended. The following documentation is attached to demonstrate the above-described waste is non-hazardous. (Check<br>the appropriate items)<br><input type="checkbox"/> MSDS Information <input type="checkbox"/> RCRA Hazardous Waste Analysis <input type="checkbox"/> Process Knowledge <input type="checkbox"/> Other (Provide description in Box 4)<br>GENERATOR 19.15.36.15 WASTE TESTING CERTIFICATION STATEMENT FOR LANDFARMS<br>I, Dianna R. Hamilton, representative for DJR Operating authorize Envirotech to<br>Generator Signature<br>complete the required testing/sign the Generator Waste Testing Certification.<br>I, Greg Crabtree, representative for Envirotech do hereby certify that<br>representative samples of the oil field waste have been subjected to the paint filter test and tested for chloride content and that the samples<br>have been found to conform to the specific requirements applicable to landfarms pursuant to Section 15 of 19.15.36 NMAC. The results<br>of the representative samples are attached to demonstrate the above-described waste conform to the requirements of Section 15 of<br>19.15.36 NMAC.<br>5. Transporter: Roberts Trucking, Teraco, Halo<br>OIL CONS. DIV DIST. 3<br>AUG 11 2017 |

OCD Permitted Surface Waste Management Facility

Name and Facility Permit #: Envirotech Permit # NM-01-0011

Address of Facility: #43 Road 7175 South of Bloomfield NM 87413

Method of Treatment and/or Disposal:

☐ Evaporation ☐ Injection ☐ Treating Plant ☒ Landfarm ☐ Landfill ☐ Other

Waste Acceptance Status:

☒ APPROVED

☐ DENIED (Must Be Maintained As Permanent Record)

PRINT NAME: Greg Crabtree

TITLE: Environmental Manager DATE: 6/26/17

SIGNATURE: Greg Crabtree  
Surface Waste Management Facility Authorized Agent

TELEPHONE NO.: (505) 632-0665



August 1, 2017

OIL CONS. DIV DIST. 3

AUG 1 1 2017

Dianna Hamilton  
DJ Resources, LLC  
2001 E. Blanco Blvd  
Bloomfield, New Mexico 87413

*Via electronic mail with delivery confirmation receipt to:  
[dhamilton@djrlc.com](mailto:dhamilton@djrlc.com)*

**RE: Excavation Clearance Report  
Marcus Compressor Station Release  
Rio Arriba County, New Mexico**

Dear Ms. Hamilton:

On July 11, 2017, Animas Environmental Services, LLC (AES) completed confirmation sampling of the excavation area associated with petroleum contaminated soils at the DJ Resources Marcus Compressor Station. According to the initial C-141, the release occurred on June 21, 2017, and consisted of approximately 40 bbls of oil/water emulsified liquids, of which approximately 21.46 bbls was recovered.

---

## 1.0 Site Information

### 1.1 Location

Legal Description – NE¼ NE¼, Section 11, T23N, R7W, Rio Arriba County, New Mexico

Release Latitude/Longitude – N36.24568 and W107.53751, respectively

Land Jurisdiction – Bureau of Land Management (BLM)

Figure 1. Topographic Site Location Map

Figure 2. Aerial Site Map, July 2017

### 1.2 NMOCD Ranking

In accordance with the New Mexico Oil Conservation Division (NMOCD) *Guidelines for Remediation of Leaks, Spills, and Releases* (August 1993), the location was given a ranking score of 0 based on the following factors:

604 W. Piñon St.  
Farmington, NM 87401  
505-564-2281

1911 Main, Ste 206  
Durango, CO 81301  
970-403-3084

- **Depth to Groundwater:** The location is approximately 210 feet higher than the nearest significant drainage 1,150 feet to the northwest. (0 points)
- **Wellhead Protection Area:** The tank location is not within a wellhead protection area. (0 points)
- **Distance to Surface Water Body:** There is an unnamed drainage 1,150 feet to the northwest that ultimately drains to Largo Canyon Wash. (0 points)

### *1.3 Excavation Clearance*

On July 11, 2017, DJ Resources contractors completed an excavation at the release location, and AES personnel collected a total of nine confirmation soil samples for laboratory analysis from the walls and base of the excavation. The final excavation measured approximately 25 feet by 45 feet by 4.5 to 9 feet deep. Sample locations and final excavation extents are presented on Figure 3.

---

## *2.0 Soil Sampling*

On July 11, 2017, nine soil samples (SC-1 through SC-9) were collected from the walls and base of the excavation. All samples were submitted for laboratory analysis.

### *2.1 Laboratory Analyses*

The samples collected for laboratory analysis (SC-1 through SC-9) were placed into new, clean, laboratory-supplied containers, which were then labeled, placed on ice, and logged onto sample chain of custody records. The samples were maintained on ice until delivery to the analytical laboratory, Hall Environmental Analysis Laboratory (Hall), in Albuquerque, New Mexico. The samples were laboratory analyzed for:

- Benzene, toluene, ethylbenzene, and xylenes (BTEX) per U.S. Environmental Protection Agency (USEPA) Method 8021B; and
- Total petroleum hydrocarbons (TPH) as gasoline, diesel range and motor oil range (GRO, DRO, and MRO) per USEPA Method 8015M/D.

### *2.2 Laboratory Analytical Results*

Laboratory analytical results are summarized in Table 1 and on Figure 3. The laboratory analytical report is attached.

Table 1. Soil Laboratory Analytical Results – Benzene, Total BTEX, and TPH  
 Marcus Compressor Station Release Excavation Clearance, July 2017

| <i>Sample ID</i>           | <i>Date Sampled</i> | <i>Depth (ft)</i> | <i>Benzene (mg/kg)</i> | <i>Total BTEX (mg/kg)</i> | <i>TPH – GRO (mg/kg)</i> | <i>TPH – DRO (mg/kg)</i> | <i>TPH – MRO (mg/kg)</i> |
|----------------------------|---------------------|-------------------|------------------------|---------------------------|--------------------------|--------------------------|--------------------------|
| <b>NMOCD Action Level*</b> |                     |                   | <b>10</b>              | <b>50</b>                 |                          | <b>5,000</b>             |                          |
| SC-1                       | 7/11/17             | 0 to 9            | <0.024                 | <0.216                    | <4.8                     | 72                       | 60                       |
| SC-2                       | 7/11/17             | 0 to 9            | <0.024                 | <0.217                    | <4.8                     | 200                      | 180                      |
| SC-3                       | 7/11/17             | 0 to 9            | <0.024                 | <0.220                    | <4.9                     | <10                      | <50                      |
| SC-4                       | 7/11/17             | 0 to 9            | <0.024                 | <0.216                    | <4.8                     | 20                       | <47                      |
| SC-5                       | 7/11/17             | 0 to 9            | <0.024                 | <0.213                    | <4.7                     | <9.9                     | <50                      |
| SC-6                       | 7/11/17             | 9                 | <0.023                 | <0.210                    | <4.7                     | <10                      | <50                      |
| SC-7                       | 7/11/17             | 0 to 4.5          | <0.024                 | <0.219                    | <4.9                     | 33                       | <48                      |
| SC-8                       | 7/11/17             | 0 to 4.5          | <0.024                 | <0.246                    | <4.8                     | <9.5                     | <48                      |
| SC-9                       | 7/11/17             | 4.5               | <0.12                  | <1.11                     | 30                       | 510                      | 400                      |

\*Action level determined by NMAC 19.15.17.13E

### 3.0 Conclusions and Recommendations

On July 11, 2017, AES completed confirmation sampling of the excavation area associated with petroleum contaminated soils at the DJ Resources Marcus Compressor Station release location. Action levels for releases are determined by the NMOCD ranking score per *NMOCD Guidelines for Remediation of Leaks, Spills, and Releases* (August 1993), and the site was assigned a rank of 0.

Soil laboratory analyses for SC-1 through SC-9 showed benzene and total BTEX concentrations below the NMOCD action levels of 10 mg/kg and 50 mg/kg, respectively, with all BTEX concentrations being below laboratory detection limits. In addition, TPH (GRO/DRO/MRO) concentrations were below the NMOCD action level of 5,000 mg/kg in all samples.

Based on the final laboratory analytical results of the excavation of petroleum contaminated soils at the Marcus Compressor Station release location, benzene, total BTEX, and TPH concentrations were below the applicable NMOCD action levels for the final base and sidewalls. No further work is recommended.

If you have any questions about this report or site conditions, please do not hesitate to contact Elizabeth McNally at (505) 564-2281.

Sincerely,



David J. Reese  
Environmental Scientist

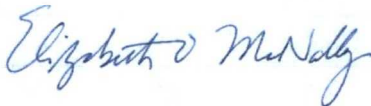

Elizabeth McNally, P.E.

Attachments:

- Figure 1. Topographic Site Location Map
- Figure 2. Aerial Site Map, July 2017
- Figure 3. Final Excavation Sample Locations and Results, July 2017
- Hall Analytical Report 1707627

\\SVRMAIN2\Shared\Animas 2000\Dropbox (Animas Environmental)\0000 AES Server Client Projects  
Dropbox\2017 Client Projects\DJ Resources (Bee Line)\Marcus Compressor Station\DJ Resources Marcus  
Compressor Station Release Final Excavation Report 080117.docx

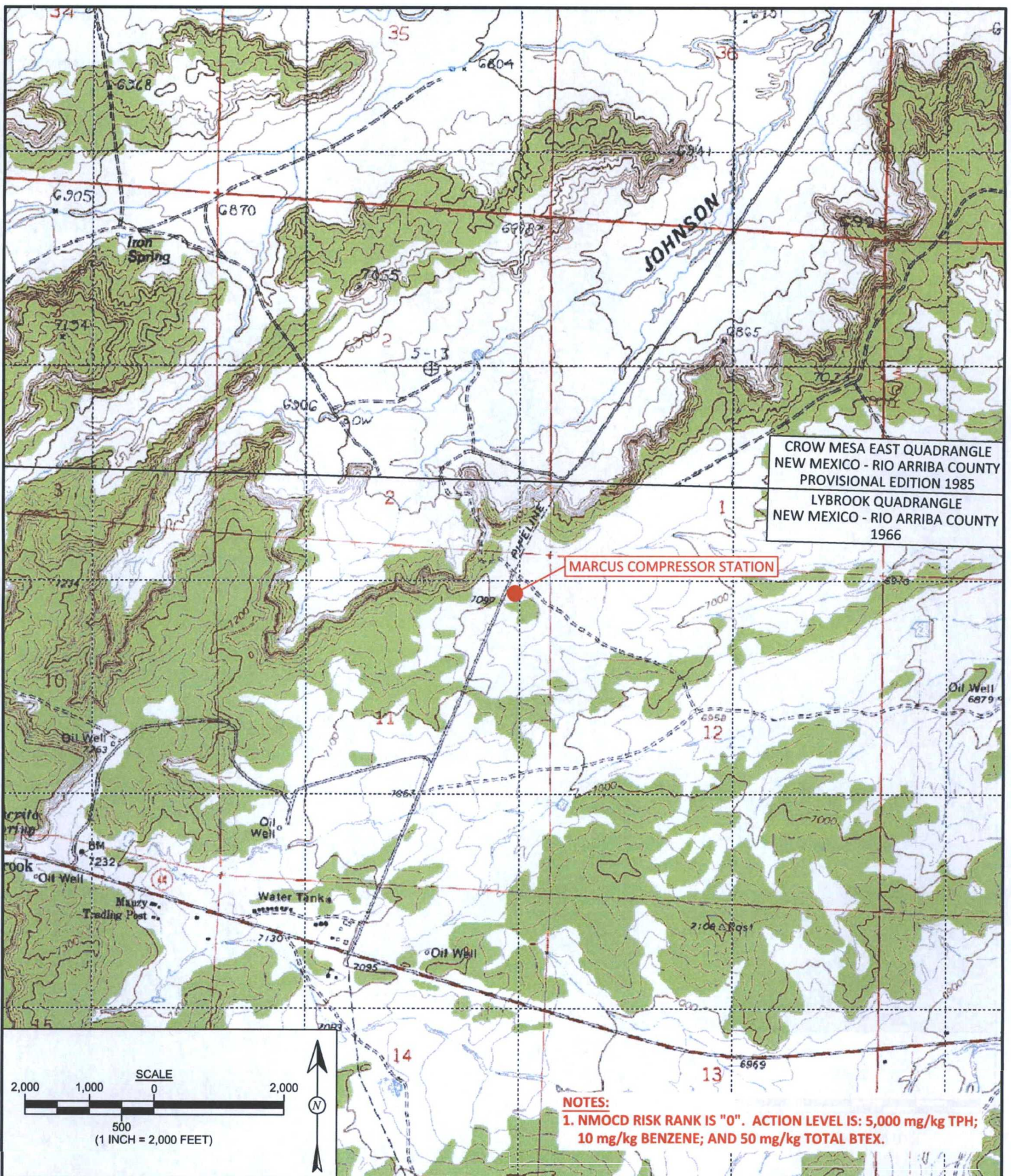

animas  
environmental  
services

Farmington, NM • Durango, CO  
animasenvironmental.com

|               |                |
|---------------|----------------|
| DRAWN BY:     | DATE DRAWN:    |
| C. Lameman    | July 5, 2017   |
| REVISIONS BY: | DATE REVISED:  |
| C. Lameman    | July 20, 2017  |
| CHECKED BY:   | DATE CHECKED:  |
| E. McNally    | July 20, 2017  |
| APPROVED BY:  | DATE APPROVED: |
| E. McNally    | July 20, 2017  |

## FIGURE 1

**TOPOGRAPHIC SITE LOCATION MAP**  
DJ RESOURCES  
MARCUS COMPRESSOR STATION  
NE¼ NE¼, SECTION 11, T23N, R7W  
RIO ARRIBA COUNTY, NEW MEXICO  
N36.24546, W107.53805



AERIAL SOURCE: © 2014 GOOGLE EARTH PRO, AERIAL DATE: JUNE 24, 2014.



**animas  
environmental  
services**  
Farmington, NM • Durango, CO  
animasenvironmental.com

**DRAWN BY:**  
C. Lameman

**DATE DRAWN:**  
July 5, 2017

**REVISIONS BY:**  
C. Lameman

**DATE REVISED:**  
July 5, 2017

**CHECKED BY:**  
E. McNally

**DATE CHECKED:**  
July 5, 2017

**APPROVED BY:**  
E. McNally

**DATE APPROVED:**  
July 5, 2017

## FIGURE 2

### AERIAL SITE MAP JULY 2017

DJ RESOURCES  
MARCUS COMPRESSOR STATION  
NE¼ NE¼, SECTION 11, T23N, R7W  
RIO ARriba COUNTY, NEW MEXICO  
N36.24546, W107.53805

| Laboratory Analytical Results |         |            |                 |                    |                   |                   |                   |
|-------------------------------|---------|------------|-----------------|--------------------|-------------------|-------------------|-------------------|
| Sample ID                     | Date    | Depth (ft) | Benzene (mg/kg) | Total BTEX (mg/kg) | TPH - GRO (mg/kg) | TPH - DRO (mg/kg) | TPH - MRO (mg/kg) |
| NMOCD ACTION LEVEL            |         |            | 10              | 50                 | 5,000             |                   |                   |
| SC-1                          | 7/11/17 | 0 to 9     | <0.024          | <0.216             | <4.8              | 72                | 60                |
| SC-2                          | 7/11/17 | 0 to 9     | <0.024          | <0.217             | <4.8              | 200               | 180               |
| SC-3                          | 7/11/17 | 0 to 9     | <0.024          | <0.220             | <4.9              | <10               | <50               |
| SC-4                          | 7/11/17 | 0 to 9     | <0.024          | <0.216             | <4.8              | 20                | <47               |
| SC-5                          | 7/11/17 | 0 to 9     | <0.024          | <0.213             | <4.7              | <9.9              | <50               |
| SC-6                          | 7/11/17 | 9          | <0.023          | <0.210             | <4.7              | <10               | <50               |
| SC-7                          | 7/11/17 | 0 to 4.5   | <0.024          | <0.219             | <4.9              | 33                | <48               |
| SC-8                          | 7/11/17 | 0 to 4.5   | <0.024          | <0.246             | <4.8              | <9.5              | <48               |
| SC-9                          | 7/11/17 | 4.5        | <0.12           | <1.11              | 30                | 510               | 400               |

ALL SOIL COMPOSITE SAMPLES WERE ANALYZED PER USEPA METHOD 8021B AND 8015D.

| LEGEND |                            |
|--------|----------------------------|
|        | SAMPLE LOCATIONS           |
|        | SECONDARY CONTAINMENT BERM |
|        | FENCE                      |

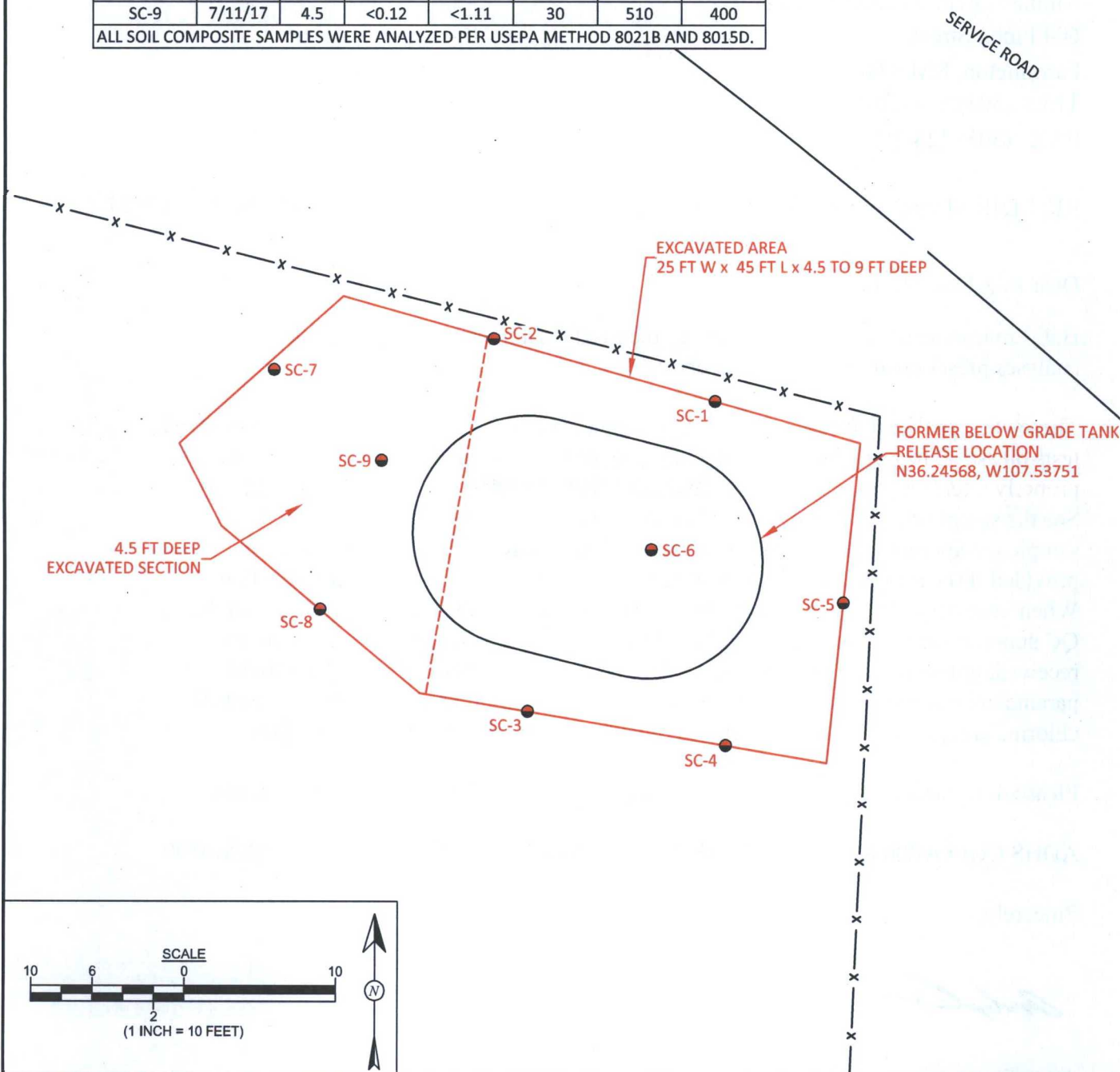

animas  
environmental  
services

Farmington, NM • Durango, CO  
animasenvironmental.com

DRAWN BY:  
S. Glasses

DATE DRAWN:  
July 12, 2017

REVISIONS BY:  
C. Lameman

DATE REVISED:  
July 20, 2017

CHECKED BY:  
E. McNally

DATE CHECKED:  
July 20, 2017

APPROVED BY:  
E. McNally

DATE APPROVED:  
July 20, 2017

## FIGURE 3

### FINAL EXCAVATION SAMPLE LOCATIONS AND RESULTS JULY 2017

DJ RESOURCES  
MARCUS COMPRESSOR STATION  
NE¼ NE¼, SECTION 11, T23N, R7W  
RIO ARriba COUNTY, NEW MEXICO  
N36.24546, W107.53805



Hall Environmental Analysis Laboratory  
4901 Hawkins NE  
Albuquerque, NM 87109  
TEL: 505-345-3975 FAX: 505-345-4107  
Website: [www.hallenvironmental.com](http://www.hallenvironmental.com)

July 19, 2017

Elizabeth McNally  
Animas Environmental Services  
604 Pinon Street  
Farmington, NM 87401  
TEL: (505) 564-2281  
FAX (505) 324-2022

RE: DJR Marus Compressor Station

OrderNo.: 1707627

Dear Elizabeth McNally:

Hall Environmental Analysis Laboratory received 9 sample(s) on 7/13/2017 for the analyses presented in the following report.

These were analyzed according to EPA procedures or equivalent. To access our accredited tests please go to [www.hallenvironmental.com](http://www.hallenvironmental.com) or the state specific web sites. In order to properly interpret your results, it is imperative that you review this report in its entirety. See the sample checklist and/or the Chain of Custody for information regarding the sample receipt temperature and preservation. Data qualifiers or a narrative will be provided if the sample analysis or analytical quality control parameters require a flag. When necessary, data qualifiers are provided on both the sample analysis report and the QC summary report, both sections should be reviewed. All samples are reported, as received, unless otherwise indicated. Lab measurement of analytes considered field parameters that require analysis within 15 minutes of sampling such as pH and residual chlorine are qualified as being analyzed outside of the recommended holding time.

Please don't hesitate to contact HEAL for any additional information or clarifications.

ADHS Cert #AZ0682 -- NMED-DWB Cert #NM9425 -- NMED-Micro Cert #NM0190

Sincerely,

Andy Freeman  
Laboratory Manager  
4901 Hawkins NE  
Albuquerque, NM 87109

# Analytical Report

Lab Order 1707627

Date Reported: 7/19/2017

## Hall Environmental Analysis Laboratory, Inc.

**CLIENT:** Animas Environmental Services

**Client Sample ID:** SC-1

**Project:** DJR Marus Compressor Station

**Collection Date:** 7/11/2017 11:01:00 AM

**Lab ID:** 1707627-001

**Matrix:** SOIL

**Received Date:** 7/13/2017 7:10:00 AM

| Analyses   | Result | PQL      | Qual | Units | DF | Date Analyzed         | Batch               |
|--|--------|----------|------|-------|----|-----------------------|---------------------|
| <b>EPA METHOD 8015M/D: DIESEL RANGE ORGANICS</b> |        |          |      |       |    |                       | Analyst: <b>MAB</b> |
| Diesel Range Organics (DRO)                      | 72     | 9.7      |      | mg/Kg | 1  | 7/18/2017 6:13:02 AM  | 32810               |
| Motor Oil Range Organics (MRO)                   | 60     | 49       |      | mg/Kg | 1  | 7/18/2017 6:13:02 AM  | 32810               |
| Surr: DNOP                                       | 71.8   | 70-130   |      | %Rec  | 1  | 7/18/2017 6:13:02 AM  | 32810               |
| <b>EPA METHOD 8015D: GASOLINE RANGE</b>          |        |          |      |       |    |                       | Analyst: <b>NSB</b> |
| Gasoline Range Organics (GRO)                    | ND     | 4.8      |      | mg/Kg | 1  | 7/18/2017 10:24:04 PM | 32814               |
| Surr: BFB  | 96.1   | 54-150   |      | %Rec  | 1  | 7/18/2017 10:24:04 PM | 32814               |
| <b>EPA METHOD 8021B: VOLATILES</b>               |        |          |      |       |    |                       | Analyst: <b>NSB</b> |
| Benzene  | ND     | 0.024    |      | mg/Kg | 1  | 7/18/2017 10:24:04 PM | 32814               |
| Toluene  | ND     | 0.048    |      | mg/Kg | 1  | 7/18/2017 10:24:04 PM | 32814               |
| Ethylbenzene                                     | ND     | 0.048    |      | mg/Kg | 1  | 7/18/2017 10:24:04 PM | 32814               |
| Xylenes, Total                                   | ND     | 0.096    |      | mg/Kg | 1  | 7/18/2017 10:24:04 PM | 32814               |
| Surr: 4-Bromofluorobenzene                       | 110    | 66.6-132 |      | %Rec  | 1  | 7/18/2017 10:24:04 PM | 32814               |

Refer to the QC Summary report and sample login checklist for flagged QC data and preservation information.

|                    |     |   |    |   |
|--------------------|-----|---|----|---|
| <b>Qualifiers:</b> | *   | Value exceeds Maximum Contaminant Level.              | B  | Analyte detected in the associated Method Blank           |
|                    | D   | Sample Diluted Due to Matrix                          | E  | Value above quantitation range                            |
|                    | H   | Holding times for preparation or analysis exceeded    | J  | Analyte detected below quantitation limits                |
|                    | ND  | Not Detected at the Reporting Limit                   | P  | Sample pH Not In Range                                    |
|                    | PQL | Practical Quantitative Limit                          | RL | Reporting Detection Limit                                 |
|                    | S   | % Recovery outside of range due to dilution or matrix | W  | Sample container temperature is out of limit as specified |

# Analytical Report

Lab Order 1707627

Date Reported: 7/19/2017

## Hall Environmental Analysis Laboratory, Inc.

CLIENT: Animas Environmental Services

Client Sample ID: SC-2

Project: DJR Marus Compressor Station

Collection Date: 7/11/2017 11:05:00 AM

Lab ID: 1707627-002

Matrix: SOIL

Received Date: 7/13/2017 7:10:00 AM

| Analyses   | Result | PQL      | Qual | Units | DF | Date Analyzed         | Batch               |
|--|--------|----------|------|-------|----|-----------------------|---------------------|
| <b>EPA METHOD 8015M/D: DIESEL RANGE ORGANICS</b> |        |          |      |       |    |                       | Analyst: <b>MAB</b> |
| Diesel Range Organics (DRO)                      | 200    | 10       |      | mg/Kg | 1  | 7/18/2017 6:37:36 AM  | 32810               |
| Motor Oil Range Organics (MRO)                   | 180    | 50       |      | mg/Kg | 1  | 7/18/2017 6:37:36 AM  | 32810               |
| Surr: DNOP                                       | 76.0   | 70-130   |      | %Rec  | 1  | 7/18/2017 6:37:36 AM  | 32810               |
| <b>EPA METHOD 8015D: GASOLINE RANGE</b>          |        |          |      |       |    |                       | Analyst: <b>NSB</b> |
| Gasoline Range Organics (GRO)                    | ND     | 4.8      |      | mg/Kg | 1  | 7/18/2017 10:47:33 PM | 32814               |
| Surr: BFB  | 124    | 54-150   |      | %Rec  | 1  | 7/18/2017 10:47:33 PM | 32814               |
| <b>EPA METHOD 8021B: VOLATILES</b>               |        |          |      |       |    |                       | Analyst: <b>NSB</b> |
| Benzene  | ND     | 0.024    |      | mg/Kg | 1  | 7/18/2017 10:47:33 PM | 32814               |
| Toluene  | ND     | 0.048    |      | mg/Kg | 1  | 7/18/2017 10:47:33 PM | 32814               |
| Ethylbenzene                                     | ND     | 0.048    |      | mg/Kg | 1  | 7/18/2017 10:47:33 PM | 32814               |
| Xylenes, Total                                   | ND     | 0.097    |      | mg/Kg | 1  | 7/18/2017 10:47:33 PM | 32814               |
| Surr: 4-Bromofluorobenzene                       | 111    | 66.6-132 |      | %Rec  | 1  | 7/18/2017 10:47:33 PM | 32814               |

Refer to the QC Summary report and sample login checklist for flagged QC data and preservation information.

|             |     |   |    |   |
|-------------|-----|---|----|---|
| Qualifiers: | *   | Value exceeds Maximum Contaminant Level.              | B  | Analyte detected in the associated Method Blank           |
|             | D   | Sample Diluted Due to Matrix                          | E  | Value above quantitation range                            |
|             | H   | Holding times for preparation or analysis exceeded    | J  | Analyte detected below quantitation limits                |
|             | ND  | Not Detected at the Reporting Limit                   | P  | Sample pH Not In Range                                    |
|             | PQL | Practical Quantitative Limit                          | RL | Reporting Detection Limit                                 |
|             | S   | % Recovery outside of range due to dilution or matrix | W  | Sample container temperature is out of limit as specified |

# Analytical Report

Lab Order 1707627

Date Reported: 7/19/2017

## Hall Environmental Analysis Laboratory, Inc.

**CLIENT:** Animas Environmental Services

**Client Sample ID:** SC-3

**Project:** DJR Marus Compressor Station

**Collection Date:** 7/11/2017 11:08:00 AM

**Lab ID:** 1707627-003

**Matrix:** SOIL

**Received Date:** 7/13/2017 7:10:00 AM

| Analyses   | Result | PQL      | Qual | Units | DF | Date Analyzed         | Batch               |
|--|--------|----------|------|-------|----|-----------------------|---------------------|
| <b>EPA METHOD 8015M/D: DIESEL RANGE ORGANICS</b> |        |          |      |       |    |                       | Analyst: <b>MAB</b> |
| Diesel Range Organics (DRO)                      | ND     | 10       |      | mg/Kg | 1  | 7/18/2017 7:02:19 AM  | 32810               |
| Motor Oil Range Organics (MRO)                   | ND     | 50       |      | mg/Kg | 1  | 7/18/2017 7:02:19 AM  | 32810               |
| Surr: DNOP                                       | 71.0   | 70-130   |      | %Rec  | 1  | 7/18/2017 7:02:19 AM  | 32810               |
| <b>EPA METHOD 8015D: GASOLINE RANGE</b>          |        |          |      |       |    |                       | Analyst: <b>NSB</b> |
| Gasoline Range Organics (GRO)                    | ND     | 4.9      |      | mg/Kg | 1  | 7/19/2017 12:21:36 AM | 32814               |
| Surr: BFB  | 95.6   | 54-150   |      | %Rec  | 1  | 7/19/2017 12:21:36 AM | 32814               |
| <b>EPA METHOD 8021B: VOLATILES</b>               |        |          |      |       |    |                       | Analyst: <b>NSB</b> |
| Benzene  | ND     | 0.024    |      | mg/Kg | 1  | 7/19/2017 12:21:36 AM | 32814               |
| Toluene  | ND     | 0.049    |      | mg/Kg | 1  | 7/19/2017 12:21:36 AM | 32814               |
| Ethylbenzene                                     | ND     | 0.049    |      | mg/Kg | 1  | 7/19/2017 12:21:36 AM | 32814               |
| Xylenes, Total                                   | ND     | 0.098    |      | mg/Kg | 1  | 7/19/2017 12:21:36 AM | 32814               |
| Surr: 4-Bromofluorobenzene                       | 110    | 66.6-132 |      | %Rec  | 1  | 7/19/2017 12:21:36 AM | 32814               |

Refer to the QC Summary report and sample login checklist for flagged QC data and preservation information.

|                    |     |   |    |   |
|--------------------|-----|---|----|---|
| <b>Qualifiers:</b> | *   | Value exceeds Maximum Contaminant Level.              | B  | Analyte detected in the associated Method Blank           |
|                    | D   | Sample Diluted Due to Matrix                          | E  | Value above quantitation range                            |
|                    | H   | Holding times for preparation or analysis exceeded    | J  | Analyte detected below quantitation limits                |
|                    | ND  | Not Detected at the Reporting Limit                   | P  | Sample pH Not In Range                                    |
|                    | PQL | Practical Quantitative Limit                          | RL | Reporting Detection Limit                                 |
|                    | S   | % Recovery outside of range due to dilution or matrix | W  | Sample container temperature is out of limit as specified |

# Analytical Report

Lab Order 1707627

Date Reported: 7/19/2017

## Hall Environmental Analysis Laboratory, Inc.

CLIENT: Animas Environmental Services

Client Sample ID: SC-4

Project: DJR Marus Compressor Station

Collection Date: 7/11/2017 11:12:00 AM

Lab ID: 1707627-004

Matrix: SOIL

Received Date: 7/13/2017 7:10:00 AM

| Analyses   | Result | PQL      | Qual | Units | DF | Date Analyzed         | Batch               |
|--|--------|----------|------|-------|----|-----------------------|---------------------|
| <b>EPA METHOD 8015M/D: DIESEL RANGE ORGANICS</b> |        |          |      |       |    |                       | Analyst: <b>MAB</b> |
| Diesel Range Organics (DRO)                      | 20     | 9.3      |      | mg/Kg | 1  | 7/18/2017 7:26:54 AM  | 32810               |
| Motor Oil Range Organics (MRO)                   | ND     | 47       |      | mg/Kg | 1  | 7/18/2017 7:26:54 AM  | 32810               |
| Surr: DNOP                                       | 76.2   | 70-130   |      | %Rec  | 1  | 7/18/2017 7:26:54 AM  | 32810               |
| <b>EPA METHOD 8015D: GASOLINE RANGE</b>          |        |          |      |       |    |                       | Analyst: <b>NSB</b> |
| Gasoline Range Organics (GRO)                    | ND     | 4.8      |      | mg/Kg | 1  | 7/19/2017 12:45:12 AM | 32814               |
| Surr: BFB  | 94.8   | 54-150   |      | %Rec  | 1  | 7/19/2017 12:45:12 AM | 32814               |
| <b>EPA METHOD 8021B: VOLATILES</b>               |        |          |      |       |    |                       | Analyst: <b>NSB</b> |
| Benzene  | ND     | 0.024    |      | mg/Kg | 1  | 7/19/2017 12:45:12 AM | 32814               |
| Toluene  | ND     | 0.048    |      | mg/Kg | 1  | 7/19/2017 12:45:12 AM | 32814               |
| Ethylbenzene                                     | ND     | 0.048    |      | mg/Kg | 1  | 7/19/2017 12:45:12 AM | 32814               |
| Xylenes, Total                                   | ND     | 0.096    |      | mg/Kg | 1  | 7/19/2017 12:45:12 AM | 32814               |
| Surr: 4-Bromofluorobenzene                       | 109    | 66.6-132 |      | %Rec  | 1  | 7/19/2017 12:45:12 AM | 32814               |

Refer to the QC Summary report and sample login checklist for flagged QC data and preservation information.

|             |     |   |    |   |
|-------------|-----|---|----|---|
| Qualifiers: | *   | Value exceeds Maximum Contaminant Level.              | B  | Analyte detected in the associated Method Blank           |
|             | D   | Sample Diluted Due to Matrix                          | E  | Value above quantitation range                            |
|             | H   | Holding times for preparation or analysis exceeded    | J  | Analyte detected below quantitation limits                |
|             | ND  | Not Detected at the Reporting Limit                   | P  | Sample pH Not In Range                                    |
|             | PQL | Practical Quantitative Limit                          | RL | Reporting Detection Limit                                 |
|             | S   | % Recovery outside of range due to dilution or matrix | W  | Sample container temperature is out of limit as specified |

# Hall Environmental Analysis Laboratory, Inc.

Analytical Report

Lab Order 1707627

Date Reported: 7/19/2017

**CLIENT:** Animas Environmental Services

**Client Sample ID:** SC-5

**Project:** DJR Marus Compressor Station

**Collection Date:** 7/11/2017 11:16:00 AM

**Lab ID:** 1707627-005

**Matrix:** SOIL

**Received Date:** 7/13/2017 7:10:00 AM

| Analyses   | Result | PQL      | Qual | Units | DF | Date Analyzed        | Batch               |
|--|--------|----------|------|-------|----|----------------------|---------------------|
| <b>EPA METHOD 8015M/D: DIESEL RANGE ORGANICS</b> |        |          |      |       |    |                      | Analyst: <b>MAB</b> |
| Diesel Range Organics (DRO)                      | ND     | 9.9      |      | mg/Kg | 1  | 7/18/2017 7:51:35 AM | 32810               |
| Motor Oil Range Organics (MRO)                   | ND     | 50       |      | mg/Kg | 1  | 7/18/2017 7:51:35 AM | 32810               |
| Surr: DNOP                                       | 71.4   | 70-130   |      | %Rec  | 1  | 7/18/2017 7:51:35 AM | 32810               |
| <b>EPA METHOD 8015D: GASOLINE RANGE</b>          |        |          |      |       |    |                      | Analyst: <b>NSB</b> |
| Gasoline Range Organics (GRO)                    | ND     | 4.7      |      | mg/Kg | 1  | 7/19/2017 1:08:41 AM | 32814               |
| Surr: BFB  | 94.8   | 54-150   |      | %Rec  | 1  | 7/19/2017 1:08:41 AM | 32814               |
| <b>EPA METHOD 8021B: VOLATILES</b>               |        |          |      |       |    |                      | Analyst: <b>NSB</b> |
| Benzene  | ND     | 0.024    |      | mg/Kg | 1  | 7/19/2017 1:08:41 AM | 32814               |
| Toluene  | ND     | 0.047    |      | mg/Kg | 1  | 7/19/2017 1:08:41 AM | 32814               |
| Ethylbenzene                                     | ND     | 0.047    |      | mg/Kg | 1  | 7/19/2017 1:08:41 AM | 32814               |
| Xylenes, Total                                   | ND     | 0.095    |      | mg/Kg | 1  | 7/19/2017 1:08:41 AM | 32814               |
| Surr: 4-Bromofluorobenzene                       | 108    | 66.6-132 |      | %Rec  | 1  | 7/19/2017 1:08:41 AM | 32814               |

Refer to the QC Summary report and sample login checklist for flagged QC data and preservation information.

|                    |     |   |    |   |
|--------------------|-----|---|----|---|
| <b>Qualifiers:</b> | *   | Value exceeds Maximum Contaminant Level.              | B  | Analyte detected in the associated Method Blank           |
|                    | D   | Sample Diluted Due to Matrix                          | E  | Value above quantitation range                            |
|                    | H   | Holding times for preparation or analysis exceeded    | J  | Analyte detected below quantitation limits                |
|                    | ND  | Not Detected at the Reporting Limit                   | P  | Sample pH Not In Range                                    |
|                    | PQL | Practical Quantitative Limit                          | RL | Reporting Detection Limit                                 |
|                    | S   | % Recovery outside of range due to dilution or matrix | W  | Sample container temperature is out of limit as specified |

## Analytical Report

Lab Order 1707627

Date Reported: 7/19/2017

## Hall Environmental Analysis Laboratory, Inc.

CLIENT: Animas Environmental Services

Client Sample ID: SC-6

Project: DJR Marus Compressor Station

Collection Date: 7/11/2017 11:20:00 AM

Lab ID: 1707627-006

Matrix: SOIL

Received Date: 7/13/2017 7:10:00 AM

| Analyses   | Result | PQL      | Qual | Units | DF | Date Analyzed        | Batch        |
|--|--------|----------|------|-------|----|----------------------|--------------|
| <b>EPA METHOD 8015M/D: DIESEL RANGE ORGANICS</b> |        |          |      |       |    |                      | Analyst: TOM |
| Diesel Range Organics (DRO)                      | ND     | 10       |      | mg/Kg | 1  | 7/18/2017 4:02:52 PM | 32836        |
| Motor Oil Range Organics (MRO)                   | ND     | 50       |      | mg/Kg | 1  | 7/18/2017 4:02:52 PM | 32836        |
| Surr: DNOP                                       | 84.6   | 70-130   |      | %Rec  | 1  | 7/18/2017 4:02:52 PM | 32836        |
| <b>EPA METHOD 8015D: GASOLINE RANGE</b>          |        |          |      |       |    |                      | Analyst: NSB |
| Gasoline Range Organics (GRO)                    | ND     | 4.7      |      | mg/Kg | 1  | 7/19/2017 1:32:10 AM | 32814        |
| Surr: BFB  | 94.9   | 54-150   |      | %Rec  | 1  | 7/19/2017 1:32:10 AM | 32814        |
| <b>EPA METHOD 8021B: VOLATILES</b>               |        |          |      |       |    |                      | Analyst: NSB |
| Benzene  | ND     | 0.023    |      | mg/Kg | 1  | 7/19/2017 1:32:10 AM | 32814        |
| Toluene  | ND     | 0.047    |      | mg/Kg | 1  | 7/19/2017 1:32:10 AM | 32814        |
| Ethylbenzene                                     | ND     | 0.047    |      | mg/Kg | 1  | 7/19/2017 1:32:10 AM | 32814        |
| Xylenes, Total                                   | ND     | 0.093    |      | mg/Kg | 1  | 7/19/2017 1:32:10 AM | 32814        |
| Surr: 4-Bromofluorobenzene                       | 108    | 66.6-132 |      | %Rec  | 1  | 7/19/2017 1:32:10 AM | 32814        |

Refer to the QC Summary report and sample login checklist for flagged QC data and preservation information.

|             |     |   |    |   |
|-------------|-----|---|----|---|
| Qualifiers: | *   | Value exceeds Maximum Contaminant Level.              | B  | Analyte detected in the associated Method Blank           |
|             | D   | Sample Diluted Due to Matrix                          | E  | Value above quantitation range                            |
|             | H   | Holding times for preparation or analysis exceeded    | J  | Analyte detected below quantitation limits                |
|             | ND  | Not Detected at the Reporting Limit                   | P  | Sample pH Not In Range                                    |
|             | PQL | Practical Quantitative Limit                          | RL | Reporting Detection Limit                                 |
|             | S   | % Recovery outside of range due to dilution or matrix | W  | Sample container temperature is out of limit as specified |

## Hall Environmental Analysis Laboratory, Inc.

CLIENT: Animas Environmental Services

Client Sample ID: SC-7

Project: DJR Marus Compressor Station

Collection Date: 7/11/2017 11:43:00 AM

Lab ID: 1707627-007

Matrix: SOIL

Received Date: 7/13/2017 7:10:00 AM

| Analyses   | Result | PQL      | Qual | Units | DF | Date Analyzed        | Batch        |
|--|--------|----------|------|-------|----|----------------------|--------------|
| <b>EPA METHOD 8015M/D: DIESEL RANGE ORGANICS</b> |        |          |      |       |    |                      | Analyst: TOM |
| Diesel Range Organics (DRO)                      | 33     | 9.5      |      | mg/Kg | 1  | 7/18/2017 5:28:10 PM | 32836        |
| Motor Oil Range Organics (MRO)                   | ND     | 48       |      | mg/Kg | 1  | 7/18/2017 5:28:10 PM | 32836        |
| Surr: DNOP                                       | 81.1   | 70-130   |      | %Rec  | 1  | 7/18/2017 5:28:10 PM | 32836        |
| <b>EPA METHOD 8015D: GASOLINE RANGE</b>          |        |          |      |       |    |                      | Analyst: NSB |
| Gasoline Range Organics (GRO)                    | ND     | 4.9      |      | mg/Kg | 1  | 7/19/2017 1:55:41 AM | 32814        |
| Surr: BFB  | 97.1   | 54-150   |      | %Rec  | 1  | 7/19/2017 1:55:41 AM | 32814        |
| <b>EPA METHOD 8021B: VOLATILES</b>               |        |          |      |       |    |                      | Analyst: NSB |
| Benzene  | ND     | 0.024    |      | mg/Kg | 1  | 7/19/2017 1:55:41 AM | 32814        |
| Toluene  | ND     | 0.049    |      | mg/Kg | 1  | 7/19/2017 1:55:41 AM | 32814        |
| Ethylbenzene                                     | ND     | 0.049    |      | mg/Kg | 1  | 7/19/2017 1:55:41 AM | 32814        |
| Xylenes, Total                                   | ND     | 0.097    |      | mg/Kg | 1  | 7/19/2017 1:55:41 AM | 32814        |
| Surr: 4-Bromofluorobenzene                       | 110    | 66.6-132 |      | %Rec  | 1  | 7/19/2017 1:55:41 AM | 32814        |

Refer to the QC Summary report and sample login checklist for flagged QC data and preservation information.

|                    |   |   |
|--------------------|---|---|
| <b>Qualifiers:</b> | * Value exceeds Maximum Contaminant Level.              | B Analyte detected in the associated Method Blank           |
|                    | D Sample Diluted Due to Matrix                          | E Value above quantitation range                            |
|                    | H Holding times for preparation or analysis exceeded    | J Analyte detected below quantitation limits                |
|                    | ND Not Detected at the Reporting Limit                  | P Sample pH Not In Range                                    |
|                    | PQL Practical Quantitative Limit                        | RL Reporting Detection Limit                                |
|                    | S % Recovery outside of range due to dilution or matrix | W Sample container temperature is out of limit as specified |

## Analytical Report

Lab Order 1707627

Date Reported: 7/19/2017

## Hall Environmental Analysis Laboratory, Inc.

CLIENT: Animas Environmental Services

Client Sample ID: SC-8

Project: DJR Marus Compressor Station

Collection Date: 7/11/2017 11:46:00 AM

Lab ID: 1707627-008

Matrix: SOIL

Received Date: 7/13/2017 7:10:00 AM

| Analyses   | Result | PQL      | Qual | Units | DF | Date Analyzed        | Batch               |
|--|--------|----------|------|-------|----|----------------------|---------------------|
| <b>EPA METHOD 8015M/D: DIESEL RANGE ORGANICS</b> |        |          |      |       |    |                      | Analyst: <b>TOM</b> |
| Diesel Range Organics (DRO)                      | ND     | 9.5      |      | mg/Kg | 1  | 7/18/2017 5:57:35 PM | 32836               |
| Motor Oil Range Organics (MRO)                   | ND     | 48       |      | mg/Kg | 1  | 7/18/2017 5:57:35 PM | 32836               |
| Surr: DNOP                                       | 71.6   | 70-130   |      | %Rec  | 1  | 7/18/2017 5:57:35 PM | 32836               |
| <b>EPA METHOD 8015D: GASOLINE RANGE</b>          |        |          |      |       |    |                      | Analyst: <b>NSB</b> |
| Gasoline Range Organics (GRO)                    | ND     | 4.8      |      | mg/Kg | 1  | 7/19/2017 2:19:08 AM | 32814               |
| Surr: BFB  | 98.1   | 54-150   |      | %Rec  | 1  | 7/19/2017 2:19:08 AM | 32814               |
| <b>EPA METHOD 8021B: VOLATILES</b>               |        |          |      |       |    |                      | Analyst: <b>NSB</b> |
| Benzene  | ND     | 0.024    |      | mg/Kg | 1  | 7/19/2017 2:19:08 AM | 32814               |
| Toluene  | ND     | 0.048    |      | mg/Kg | 1  | 7/19/2017 2:19:08 AM | 32814               |
| Ethylbenzene                                     | ND     | 0.048    |      | mg/Kg | 1  | 7/19/2017 2:19:08 AM | 32814               |
| Xylenes, Total                                   | ND     | 0.096    |      | mg/Kg | 1  | 7/19/2017 2:19:08 AM | 32814               |
| Surr: 4-Bromofluorobenzene                       | 109    | 66.6-132 |      | %Rec  | 1  | 7/19/2017 2:19:08 AM | 32814               |

Refer to the QC Summary report and sample login checklist for flagged QC data and preservation information.

|             |     |   |    |   |
|-------------|-----|---|----|---|
| Qualifiers: | *   | Value exceeds Maximum Contaminant Level.              | B  | Analyte detected in the associated Method Blank           |
|             | D   | Sample Diluted Due to Matrix                          | E  | Value above quantitation range                            |
|             | H   | Holding times for preparation or analysis exceeded    | J  | Analyte detected below quantitation limits                |
|             | ND  | Not Detected at the Reporting Limit                   | P  | Sample pH Not In Range                                    |
|             | PQL | Practical Quantitative Limit                          | RL | Reporting Detection Limit                                 |
|             | S   | % Recovery outside of range due to dilution or matrix | W  | Sample container temperature is out of limit as specified |

# Hall Environmental Analysis Laboratory, Inc.

## Analytical Report

Lab Order 1707627

Date Reported: 7/19/2017

**CLIENT:** Animas Environmental Services

**Client Sample ID:** SC-9

**Project:** DJR Marus Compressor Station

**Collection Date:** 7/11/2017 11:50:00 AM

**Lab ID:** 1707627-009

**Matrix:** SOIL

**Received Date:** 7/13/2017 7:10:00 AM

| Analyses   | Result | PQL      | Qual | Units | DF | Date Analyzed        | Batch               |
|--|--------|----------|------|-------|----|----------------------|---------------------|
| <b>EPA METHOD 8015M/D: DIESEL RANGE ORGANICS</b> |        |          |      |       |    |                      | Analyst: <b>TOM</b> |
| Diesel Range Organics (DRO)                      | 510    | 9.7      |      | mg/Kg | 1  | 7/18/2017 6:26:56 PM | 32836               |
| Motor Oil Range Organics (MRO)                   | 400    | 49       |      | mg/Kg | 1  | 7/18/2017 6:26:56 PM | 32836               |
| Surr: DNOP                                       | 88.7   | 70-130   |      | %Rec  | 1  | 7/18/2017 6:26:56 PM | 32836               |
| <b>EPA METHOD 8015D: GASOLINE RANGE</b>          |        |          |      |       |    |                      | Analyst: <b>NSB</b> |
| Gasoline Range Organics (GRO)                    | 30     | 25       |      | mg/Kg | 5  | 7/19/2017 2:42:40 AM | 32814               |
| Surr: BFB  | 151    | 54-150   | S    | %Rec  | 5  | 7/19/2017 2:42:40 AM | 32814               |
| <b>EPA METHOD 8021B: VOLATILES</b>               |        |          |      |       |    |                      | Analyst: <b>NSB</b> |
| Benzene  | ND     | 0.12     | D    | mg/Kg | 5  | 7/19/2017 2:42:40 AM | 32814               |
| Toluene  | ND     | 0.25     | D    | mg/Kg | 5  | 7/19/2017 2:42:40 AM | 32814               |
| Ethylbenzene                                     | ND     | 0.25     | D    | mg/Kg | 5  | 7/19/2017 2:42:40 AM | 32814               |
| Xylenes, Total                                   | ND     | 0.49     | D    | mg/Kg | 5  | 7/19/2017 2:42:40 AM | 32814               |
| Surr: 4-Bromofluorobenzene                       | 116    | 66.6-132 | D    | %Rec  | 5  | 7/19/2017 2:42:40 AM | 32814               |

Refer to the QC Summary report and sample login checklist for flagged QC data and preservation information.

|                    |     |   |    |   |
|--------------------|-----|---|----|---|
| <b>Qualifiers:</b> | *   | Value exceeds Maximum Contaminant Level.              | B  | Analyte detected in the associated Method Blank           |
|                    | D   | Sample Diluted Due to Matrix                          | E  | Value above quantitation range                            |
|                    | H   | Holding times for preparation or analysis exceeded    | J  | Analyte detected below quantitation limits                |
|                    | ND  | Not Detected at the Reporting Limit                   | P  | Sample pH Not In Range                                    |
|                    | PQL | Practical Quantitative Limit                          | RL | Reporting Detection Limit                                 |
|                    | S   | % Recovery outside of range due to dilution or matrix | W  | Sample container temperature is out of limit as specified |

# QC SUMMARY REPORT

## Hall Environmental Analysis Laboratory, Inc.

WO#: 1707627

19-Jul-17

Client: Animas Environmental Services

Project: DJR Marus Compressor Station

|            |           |     |                |             |      |           |   |      |             |      |  |
|------------|-----------|-----|----------------|-------------|------|-----------|---|------|-------------|------|--|
| Sample ID  | MB-32805  |     | SampType:      | MBLK        |      | TestCode: | EPA Method 8015M/D: Diesel Range Organics |      |             |      |  |
| Client ID: | PBS       |     | Batch ID:      | 32805       |      | RunNo:    | 44252                                     |      |             |      |  |
| Prep Date: | 7/14/2017 |     | Analysis Date: | 7/17/2017   |      | SeqNo:    | 1397598                                   |      | Units: %Rec |      |  |
| Analyte    | Result    | PQL | SPK value      | SPK Ref Val | %REC | LowLimit  | HighLimit                                 | %RPD | RPDLimit    | Qual |  |
| Surr: DNOP | 9.6       |     | 10.00          |             | 96.3 | 70        | 130                                       |      |             |      |  |

|            |           |     |                |             |      |           |   |      |             |      |  |
|------------|-----------|-----|----------------|-------------|------|-----------|---|------|-------------|------|--|
| Sample ID  | LCS-32805 |     | SampType:      | LCS         |      | TestCode: | EPA Method 8015M/D: Diesel Range Organics |      |             |      |  |
| Client ID: | LCSS      |     | Batch ID:      | 32805       |      | RunNo:    | 44252                                     |      |             |      |  |
| Prep Date: | 7/14/2017 |     | Analysis Date: | 7/17/2017   |      | SeqNo:    | 1397654                                   |      | Units: %Rec |      |  |
| Analyte    | Result    | PQL | SPK value      | SPK Ref Val | %REC | LowLimit  | HighLimit                                 | %RPD | RPDLimit    | Qual |  |
| Surr: DNOP | 5.0       |     | 5.000          |             | 100  | 70        | 130                                       |      |             |      |  |

|                             |           |     |                          |             |   |          |              |      |          |      |
|-----------------------------|-----------|-----|--------------------------|-------------|---|----------|--------------|------|----------|------|
| Sample ID                   | LCS-32810 |     | SampType: LCS            |             | TestCode: EPA Method 8015M/D: Diesel Range Organics |          |              |      |          |      |
| Client ID:                  | LCSS      |     | Batch ID: 32810          |             | RunNo: 44252  |          |              |      |          |      |
| Prep Date:                  | 7/14/2017 |     | Analysis Date: 7/17/2017 |             | SeqNo: 1397734                                      |          | Units: mg/Kg |      |          |      |
| Analyte                     | Result    | PQL | SPK value                | SPK Ref Val | %REC  | LowLimit | HighLimit    | %RPD | RPDLimit | Qual |
| Diesel Range Organics (DRO) | 47        | 10  | 50.00                    | 0           | 95.0  | 73.2     | 114          |      |          |      |
| Surr: DNOP                  | 4.5       |     | 5.000                    |             | 90.1  | 70       | 130          |      |          |      |

|                                |           |                |           |             |           |   |           |       |          |      |
|--------------------------------|-----------|----------------|-----------|-------------|-----------|---|-----------|-------|----------|------|
| Sample ID                      | MB-32810  | SampType:      | MBLK      |             | TestCode: | EPA Method 8015M/D: Diesel Range Organics |           |       |          |      |
| Client ID:                     | PBS       | Batch ID:      | 32810     |             | RunNo:    | 44252                                     |           |       |          |      |
| Prep Date:                     | 7/14/2017 | Analysis Date: | 7/17/2017 |             | SeqNo:    | 1397735                                   | Units:    | mg/Kg |          |      |
| Analyte                        | Result    | PQL            | SPK value | SPK Ref Val | %REC      | LowLimit                                  | HighLimit | %RPD  | RPDLimit | Qual |
| Diesel Range Organics (DRO)    | ND        | 10             |           |             |           |   |           |       |          |      |
| Motor Oil Range Organics (MRO) | ND        | 50             |           |             |           |   |           |       |          |      |
| Surr: DNOP                     | 9.3       |                | 10.00     |             | 93.0      | 70  | 130       |       |          |      |

|                             |                |     |                |             |      |           |   |      |              |      |  |
|-----------------------------|----------------|-----|----------------|-------------|------|-----------|---|------|--------------|------|--|
| Sample ID                   | 1707627-006AMS |     | SampType:      | MS          |      | TestCode: | EPA Method 8015M/D: Diesel Range Organics |      |              |      |  |
| Client ID:                  | SC-6           |     | Batch ID:      | 32836       |      | RunNo:    | 44282                                     |      |              |      |  |
| Prep Date:                  | 7/17/2017      |     | Analysis Date: | 7/18/2017   |      | SeqNo:    | 1399664                                   |      | Units: mg/Kg |      |  |
| Analyte                     | Result         | PQL | SPK value      | SPK Ref Val | %REC | LowLimit  | HighLimit                                 | %RPD | RPDLimit     | Qual |  |
| Diesel Range Organics (DRO) | 62             | 9.7 | 48.40          | 6.281       | 116  | 55.8      | 122                                       |      |              |      |  |
| Surr: DNOP                  | 4.4            |     | 4.840          |             | 91.8 | 70        | 130                                       |      |              |      |  |

|                             |                 |     |                |             |      |           |   |       |              |      |  |
|-----------------------------|-----------------|-----|----------------|-------------|------|-----------|---|-------|--------------|------|--|
| Sample ID                   | 1707627-006AMSD |     | SampType:      | MSD         |      | TestCode: | EPA Method 8015M/D: Diesel Range Organics |       |              |      |  |
| Client ID:                  | SC-6            |     | Batch ID:      | 32836       |      | RunNo:    | 44282                                     |       |              |      |  |
| Prep Date:                  | 7/17/2017       |     | Analysis Date: | 7/18/2017   |      | SeqNo:    | 1399665                                   |       | Units: mg/Kg |      |  |
| Analyte                     | Result          | PQL | SPK value      | SPK Ref Val | %REC | LowLimit  | HighLimit                                 | %RPD  | RPDLimit     | Qual |  |
| Diesel Range Organics (DRO) | 63              | 9.7 | 48.40          | 6.281       | 116  | 55.8      | 122                                       | 0.375 | 20           |      |  |

### Qualifiers:

\* Value exceeds Maximum Contaminant Level.  
D Sample Diluted Due to Matrix  
H Holding times for preparation or analysis exceeded  
ND Not Detected at the Reporting Limit  
PQL Practical Quantitative Limit  
S % Recovery outside of range due to dilution or matrix

B Analyte detected in the associated Method Blank  
E Value above quantitation range  
J Analyte detected below quantitation limits  
P Sample pH Not In Range  
RL Reporting Detection Limit  
W Sample container temperature is out of limit as specified

# QC SUMMARY REPORT

## Hall Environmental Analysis Laboratory, Inc.

WO#: 1707627

19-Jul-17

Client: Animas Environmental Services

Project: DJR Marus Compressor Station

|            |                 |                |           |             |   |          |           |      |          |      |
|------------|-----------------|----------------|-----------|-------------|---|----------|-----------|------|----------|------|
| Sample ID  | 1707627-006AMSD | SampType:      | MSD       | TestCode:   | EPA Method 8015M/D: Diesel Range Organics |          |           |      |          |      |
| Client ID: | SC-6            | Batch ID:      | 32836     | RunNo:      | 44282                                     |          |           |      |          |      |
| Prep Date: | 7/17/2017       | Analysis Date: | 7/18/2017 | SeqNo:      | 1399665                                   | Units:   | mg/Kg     |      |          |      |
| Analyte    | Result          | PQL            | SPK value | SPK Ref Val | %REC                                      | LowLimit | HighLimit | %RPD | RPDLimit | Qual |
| Surr: DNOP | 4.5             |                | 4.840     |             | 92.0                                      | 70       | 130       | 0    | 0        |      |

|                             |           |                |           |             |   |          |           |      |          |      |
|-----------------------------|-----------|----------------|-----------|-------------|---|----------|-----------|------|----------|------|
| Sample ID                   | LCS-32836 | SampType:      | LCS       | TestCode:   | EPA Method 8015M/D: Diesel Range Organics |          |           |      |          |      |
| Client ID:                  | LCSS      | Batch ID:      | 32836     | RunNo:      | 44282                                     |          |           |      |          |      |
| Prep Date:                  | 7/17/2017 | Analysis Date: | 7/18/2017 | SeqNo:      | 1399678                                   | Units:   | mg/Kg     |      |          |      |
| Analyte                     | Result    | PQL            | SPK value | SPK Ref Val | %REC                                      | LowLimit | HighLimit | %RPD | RPDLimit | Qual |
| Diesel Range Organics (DRO) | 54        | 10             | 50.00     | 0           | 107                                       | 73.2     | 114       |      |          |      |
| Surr: DNOP                  | 4.4       |                | 5.000     |             | 88.8                                      | 70       | 130       |      |          |      |

|                                |           |                |           |             |   |          |           |      |          |      |
|--------------------------------|-----------|----------------|-----------|-------------|---|----------|-----------|------|----------|------|
| Sample ID                      | MB-32836  | SampType:      | MBLK      | TestCode:   | EPA Method 8015M/D: Diesel Range Organics |          |           |      |          |      |
| Client ID:                     | PBS       | Batch ID:      | 32836     | RunNo:      | 44282                                     |          |           |      |          |      |
| Prep Date:                     | 7/17/2017 | Analysis Date: | 7/18/2017 | SeqNo:      | 1399679                                   | Units:   | mg/Kg     |      |          |      |
| Analyte                        | Result    | PQL            | SPK value | SPK Ref Val | %REC                                      | LowLimit | HighLimit | %RPD | RPDLimit | Qual |
| Diesel Range Organics (DRO)    | ND        | 10             |           |             |   |          |           |      |          |      |
| Motor Oil Range Organics (MRO) | ND        | 50             |           |             |   |          |           |      |          |      |
| Surr: DNOP                     | 8.4       |                | 10.00     |             | 84.4                                      | 70       | 130       |      |          |      |

### Qualifiers:

\* Value exceeds Maximum Contaminant Level.  
D Sample Diluted Due to Matrix  
H Holding times for preparation or analysis exceeded  
ND Not Detected at the Reporting Limit  
PQL Practical Quantitative Limit  
S % Recovery outside of range due to dilution or matrix

B Analyte detected in the associated Method Blank  
E Value above quantitation range  
J Analyte detected below quantitation limits  
P Sample pH Not In Range  
RL Reporting Detection Limit  
W Sample container temperature is out of limit as specified

# QC SUMMARY REPORT

## Hall Environmental Analysis Laboratory, Inc.

WO#: 1707627

19-Jul-17

Client: Animas Environmental Services

Project: DJR Marus Compressor Station

|            |           |     |                          |             |  |          |             |      |          |      |
|------------|-----------|-----|--------------------------|-------------|--|----------|-------------|------|----------|------|
| Sample ID  | MB-32828  |     | SampType: MBLK           |             | TestCode: EPA Method 8015D: Gasoline Range |          |             |      |          |      |
| Client ID: | PBS       |     | Batch ID: 32828          |             | RunNo: 44294                               |          |             |      |          |      |
| Prep Date: | 7/17/2017 |     | Analysis Date: 7/18/2017 |             | SeqNo: 1399599                             |          | Units: %Rec |      |          |      |
| Analyte    | Result    | PQL | SPK value                | SPK Ref Val | %REC                                       | LowLimit | HighLimit   | %RPD | RPDLimit | Qual |
| Surr: BFB  | 960       |     | 1000                     |             | 95.8                                       | 54       | 150         |      |          |      |

|            |           |     |                |             |      |           |                                  |      |             |      |  |
|------------|-----------|-----|----------------|-------------|------|-----------|----------------------------------|------|-------------|------|--|
| Sample ID  | LCS-32828 |     | SampType:      | LCS         |      | TestCode: | EPA Method 8015D: Gasoline Range |      |             |      |  |
| Client ID: | LCSS      |     | Batch ID:      | 32828       |      | RunNo:    | 44294                            |      |             |      |  |
| Prep Date: | 7/17/2017 |     | Analysis Date: | 7/18/2017   |      | SeqNo:    | 1399600                          |      | Units: %Rec |      |  |
| Analyte    | Result    | PQL | SPK value      | SPK Ref Val | %REC | LowLimit  | HighLimit                        | %RPD | RPDLimit    | Qual |  |
| Surr: BFB  | 1100      |     | 1000           |             | 105  | 54        | 150                              |      |             |      |  |

|            |            |     |                |             |      |           |                                  |      |             |      |  |
|------------|------------|-----|----------------|-------------|------|-----------|----------------------------------|------|-------------|------|--|
| Sample ID  | LCSD-32828 |     | SampType:      | LCSD        |      | TestCode: | EPA Method 8015D: Gasoline Range |      |             |      |  |
| Client ID: | LCSS02     |     | Batch ID:      | 32828       |      | RunNo:    | 44294                            |      |             |      |  |
| Prep Date: | 7/17/2017  |     | Analysis Date: | 7/18/2017   |      | SeqNo:    | 1399601                          |      | Units: %Rec |      |  |
| Analyte    | Result     | PQL | SPK value      | SPK Ref Val | %REC | LowLimit  | HighLimit                        | %RPD | RPDLimit    | Qual |  |
| Surr: BFB  | 1000       |     |                |             |      |           |                                  | 0    | 0           |      |  |

|                               |           |     |                |             |      |           |                                  |      |              |      |  |
|-------------------------------|-----------|-----|----------------|-------------|------|-----------|----------------------------------|------|--------------|------|--|
| Sample ID                     | MB-32814  |     | SampType:      | MBLK        |      | TestCode: | EPA Method 8015D: Gasoline Range |      |              |      |  |
| Client ID:                    | PBS       |     | Batch ID:      | 32814       |      | RunNo:    | 44294                            |      |              |      |  |
| Prep Date:                    | 7/14/2017 |     | Analysis Date: | 7/18/2017   |      | SeqNo:    | 1399613                          |      | Units: mg/Kg |      |  |
| Analyte                       | Result    | PQL | SPK value      | SPK Ref Val | %REC | LowLimit  | HighLimit                        | %RPD | RPDLimit     | Qual |  |
| Gasoline Range Organics (GRO) | ND        | 5.0 |                |             |      |           |                                  |      |              |      |  |
| Surr: BFB                     | 980       |     | 1000           |             | 98.2 | 54        | 150                              |      |              |      |  |

|                               |           |     |                |             |      |           |                                  |      |              |      |  |
|-------------------------------|-----------|-----|----------------|-------------|------|-----------|----------------------------------|------|--------------|------|--|
| Sample ID                     | LCS-32814 |     | SampType:      | LCS         |      | TestCode: | EPA Method 8015D: Gasoline Range |      |              |      |  |
| Client ID:                    | LCSS      |     | Batch ID:      | 32814       |      | RunNo:    | 44294                            |      |              |      |  |
| Prep Date:                    | 7/14/2017 |     | Analysis Date: | 7/18/2017   |      | SeqNo:    | 1399614                          |      | Units: mg/Kg |      |  |
| Analyte                       | Result    | PQL | SPK value      | SPK Ref Val | %REC | LowLimit  | HighLimit                        | %RPD | RPDLimit     | Qual |  |
| Gasoline Range Organics (GRO) | 24        | 5.0 | 25.00          | 0           | 96.6 | 76.4      | 125                              |      |              |      |  |
| Surr: BFB                     | 1100      |     | 1000           |             | 107  | 54        | 150                              |      |              |      |  |

|                               |                |     |                |             |      |           |                                  |      |              |      |  |
|-------------------------------|----------------|-----|----------------|-------------|------|-----------|----------------------------------|------|--------------|------|--|
| Sample ID                     | 1707627-002AMS |     | SampType:      | MS          |      | TestCode: | EPA Method 8015D: Gasoline Range |      |              |      |  |
| Client ID:                    | SC-2           |     | Batch ID:      | 32814       |      | RunNo:    | 44294                            |      |              |      |  |
| Prep Date:                    | 7/14/2017      |     | Analysis Date: | 7/18/2017   |      | SeqNo:    | 1399617                          |      | Units: mg/Kg |      |  |
| Analyte                       | Result         | PQL | SPK value      | SPK Ref Val | %REC | LowLimit  | HighLimit                        | %RPD | RPDLimit     | Qual |  |
| Gasoline Range Organics (GRO) | 23             | 4.9 | 24.63          | 2.963       | 80.9 | 77.8      | 128                              |      |              |      |  |
| Surr: BFB                     | 1200           |     | 985.2          |             | 126  | 54        | 150                              |      |              |      |  |

### Qualifiers:

\* Value exceeds Maximum Contaminant Level.  
D Sample Diluted Due to Matrix  
H Holding times for preparation or analysis exceeded  
ND Not Detected at the Reporting Limit  
PQL Practical Quantitative Limit  
S % Recovery outside of range due to dilution or matrix

B Analyte detected in the associated Method Blank  
E Value above quantitation range  
J Analyte detected below quantitation limits  
P Sample pH Not In Range  
RL Reporting Detection Limit  
W Sample container temperature is out of limit as specified

# QC SUMMARY REPORT

## Hall Environmental Analysis Laboratory, Inc.

WO#: 1707627

19-Jul-17

Client: Animas Environmental Services

Project: DJR Marus Compressor Station

|                               |                 |     |                          |             |  |          |              |      |          |      |
|-------------------------------|-----------------|-----|--------------------------|-------------|--|----------|--------------|------|----------|------|
| Sample ID                     | 1707627-002AMSD |     | SampType: MSD            |             | TestCode: EPA Method 8015D: Gasoline Range |          |              |      |          |      |
| Client ID:                    | SC-2            |     | Batch ID: 32814          |             | RunNo: 44294                               |          |              |      |          |      |
| Prep Date:                    | 7/14/2017       |     | Analysis Date: 7/18/2017 |             | SeqNo: 1399618                             |          | Units: mg/Kg |      |          |      |
| Analyte                       | Result          | PQL | SPK value                | SPK Ref Val | %REC                                       | LowLimit | HighLimit    | %RPD | RPDLimit | Qual |
| Gasoline Range Organics (GRO) | 26              | 5.0 | 24.85                    | 2.963       | 94.3                                       | 77.8     | 128          | 14.2 | 20       |      |
| Surr: BFB                     | 1200            |     | 994.0                    |             | 121  | 54       | 150          | 0    | 0        |      |

### Qualifiers:

\* Value exceeds Maximum Contaminant Level.  
D Sample Diluted Due to Matrix  
H Holding times for preparation or analysis exceeded  
ND Not Detected at the Reporting Limit  
PQL Practical Quantitative Limit  
S % Recovery outside of range due to dilution or matrix

B Analyte detected in the associated Method Blank  
E Value above quantitation range  
J Analyte detected below quantitation limits  
P Sample pH Not In Range  
RL Reporting Detection Limit  
W Sample container temperature is out of limit as specified

# QC SUMMARY REPORT

## Hall Environmental Analysis Laboratory, Inc.

WO#: 1707627

19-Jul-17

**Client:** Animas Environmental Services

**Project:** DJR Marus Compressor Station

| Sample ID <b>MB-32828</b>   | SampType: <b>MBLK</b>           |     | TestCode: <b>EPA Method 8021B: Volatiles</b> |             |                    |          |           |      |          |      |
|-----------------------------|---------------------------------|-----|--|-------------|--------------------|----------|-----------|------|----------|------|
| Client ID: <b>PBS</b>       | Batch ID: <b>32828</b>          |     | RunNo: <b>44294</b>                          |             |                    |          |           |      |          |      |
| Prep Date: <b>7/17/2017</b> | Analysis Date: <b>7/18/2017</b> |     | SeqNo: <b>1399633</b>                        |             | Units: <b>%Rec</b> |          |           |      |          |      |
| Analyte                     | Result                          | PQL | SPK value                                    | SPK Ref Val | %REC               | LowLimit | HighLimit | %RPD | RPDLimit | Qual |
| Surr: 4-Bromofluorobenzene  | 1.1                             |     | 1.000  |             | 108                | 66.6     | 132       |      |          |      |

| Sample ID <b>LCS-32828</b>  | SampType: <b>LCS</b>            |     | TestCode: <b>EPA Method 8021B: Volatiles</b> |             |                    |          |           |      |          |      |
|-----------------------------|---------------------------------|-----|--|-------------|--------------------|----------|-----------|------|----------|------|
| Client ID: <b>LCSS</b>      | Batch ID: <b>32828</b>          |     | RunNo: <b>44294</b>                          |             |                    |          |           |      |          |      |
| Prep Date: <b>7/17/2017</b> | Analysis Date: <b>7/18/2017</b> |     | SeqNo: <b>1399634</b>                        |             | Units: <b>%Rec</b> |          |           |      |          |      |
| Analyte                     | Result                          | PQL | SPK value                                    | SPK Ref Val | %REC               | LowLimit | HighLimit | %RPD | RPDLimit | Qual |
| Surr: 4-Bromofluorobenzene  | 1.1                             |     | 1.000  |             | 111                | 66.6     | 132       |      |          |      |

| Sample ID <b>LCSD-32828</b> | SampType: <b>LCSD</b>           |     | TestCode: <b>EPA Method 8021B: Volatiles</b> |             |                    |          |           |      |          |      |
|-----------------------------|---------------------------------|-----|--|-------------|--------------------|----------|-----------|------|----------|------|
| Client ID: <b>LCSS02</b>    | Batch ID: <b>32828</b>          |     | RunNo: <b>44294</b>                          |             |                    |          |           |      |          |      |
| Prep Date: <b>7/17/2017</b> | Analysis Date: <b>7/18/2017</b> |     | SeqNo: <b>1399635</b>                        |             | Units: <b>%Rec</b> |          |           |      |          |      |
| Analyte                     | Result                          | PQL | SPK value                                    | SPK Ref Val | %REC               | LowLimit | HighLimit | %RPD | RPDLimit | Qual |
| Surr: 4-Bromofluorobenzene  | 1.1                             |     | 1.000  |             | 111                | 66.6     | 132       | 0    |          |      |

| Sample ID <b>MB-32814</b>   | SampType: <b>MBLK</b>           |       | TestCode: <b>EPA Method 8021B: Volatiles</b> |             |                     |          |           |      |          |      |
|-----------------------------|---------------------------------|-------|--|-------------|---------------------|----------|-----------|------|----------|------|
| Client ID: <b>PBS</b>       | Batch ID: <b>32814</b>          |       | RunNo: <b>44294</b>                          |             |                     |          |           |      |          |      |
| Prep Date: <b>7/14/2017</b> | Analysis Date: <b>7/18/2017</b> |       | SeqNo: <b>1399647</b>                        |             | Units: <b>mg/Kg</b> |          |           |      |          |      |
| Analyte                     | Result                          | PQL   | SPK value                                    | SPK Ref Val | %REC                | LowLimit | HighLimit | %RPD | RPDLimit | Qual |
| Benzene                     | ND                              | 0.025 |  |             |                     |          |           |      |          |      |
| Toluene                     | ND                              | 0.050 |  |             |                     |          |           |      |          |      |
| Ethylbenzene                | ND                              | 0.050 |  |             |                     |          |           |      |          |      |
| Xylenes, Total              | ND                              | 0.10  |  |             |                     |          |           |      |          |      |
| Surr: 4-Bromofluorobenzene  | 1.1                             |       | 1.000  |             | 113                 | 66.6     | 132       |      |          |      |

| Sample ID <b>LCS-32814</b>  | SampType: <b>LCS</b>            |       | TestCode: <b>EPA Method 8021B: Volatiles</b> |             |                     |          |           |      |          |      |
|-----------------------------|---------------------------------|-------|--|-------------|---------------------|----------|-----------|------|----------|------|
| Client ID: <b>LCSS</b>      | Batch ID: <b>32814</b>          |       | RunNo: <b>44294</b>                          |             |                     |          |           |      |          |      |
| Prep Date: <b>7/14/2017</b> | Analysis Date: <b>7/18/2017</b> |       | SeqNo: <b>1399648</b>                        |             | Units: <b>mg/Kg</b> |          |           |      |          |      |
| Analyte                     | Result                          | PQL   | SPK value                                    | SPK Ref Val | %REC                | LowLimit | HighLimit | %RPD | RPDLimit | Qual |
| Benzene                     | 0.97                            | 0.025 | 1.000  | 0           | 97.5                | 80       | 120       |      |          |      |
| Toluene                     | 0.96                            | 0.050 | 1.000  | 0           | 96.2                | 80       | 120       |      |          |      |
| Ethylbenzene                | 0.98                            | 0.050 | 1.000  | 0           | 97.6                | 80       | 120       |      |          |      |
| Xylenes, Total              | 2.9                             | 0.10  | 3.000  | 0           | 98.2                | 80       | 120       |      |          |      |
| Surr: 4-Bromofluorobenzene  | 1.1                             |       | 1.000  |             | 113                 | 66.6     | 132       |      |          |      |

### Qualifiers:

\* Value exceeds Maximum Contaminant Level.  
D Sample Diluted Due to Matrix  
H Holding times for preparation or analysis exceeded  
ND Not Detected at the Reporting Limit  
PQL Practical Quantitative Limit  
S % Recovery outside of range due to dilution or matrix

B Analyte detected in the associated Method Blank  
E Value above quantitation range  
J Analyte detected below quantitation limits  
P Sample pH Not In Range  
RL Reporting Detection Limit  
W Sample container temperature is out of limit as specified

# QC SUMMARY REPORT

## Hall Environmental Analysis Laboratory, Inc.

WO#: 1707627

19-Jul-17

Client: Animas Environmental Services

Project: DJR Marus Compressor Station

|                            |                |                |           |             |                             |          |           |      |          |      |
|----------------------------|----------------|----------------|-----------|-------------|-----------------------------|----------|-----------|------|----------|------|
| Sample ID                  | 1707627-001AMS | SampType:      | MS        | TestCode:   | EPA Method 8021B: Volatiles |          |           |      |          |      |
| Client ID:                 | SC-1           | Batch ID:      | 32814     | RunNo:      | 44294                       |          |           |      |          |      |
| Prep Date:                 | 7/14/2017      | Analysis Date: | 7/18/2017 | SeqNo:      | 1399650                     | Units:   | mg/Kg     |      |          |      |
| Analyte                    | Result         | PQL            | SPK value | SPK Ref Val | %REC                        | LowLimit | HighLimit | %RPD | RPDLimit | Qual |
| Benzene                    | 0.97           | 0.024          | 0.9728    | 0           | 100                         | 80.9     | 132       |      |          |      |
| Toluene                    | 0.96           | 0.049          | 0.9728    | 0.01598     | 97.3                        | 79.8     | 136       |      |          |      |
| Ethylbenzene               | 0.98           | 0.049          | 0.9728    | 0.01601     | 99.2                        | 79.4     | 140       |      |          |      |
| Xylenes, Total             | 2.9            | 0.097          | 2.918     | 0.01861     | 100                         | 78.5     | 142       |      |          |      |
| Surr: 4-Bromofluorobenzene | 1.1            |                | 0.9728    |             | 116                         | 66.6     | 132       |      |          |      |

|                            |                 |                |           |             |                             |          |           |       |          |      |
|----------------------------|-----------------|----------------|-----------|-------------|-----------------------------|----------|-----------|-------|----------|------|
| Sample ID                  | 1707627-001AMSD | SampType:      | MSD       | TestCode:   | EPA Method 8021B: Volatiles |          |           |       |          |      |
| Client ID:                 | SC-1            | Batch ID:      | 32814     | RunNo:      | 44294                       |          |           |       |          |      |
| Prep Date:                 | 7/14/2017       | Analysis Date: | 7/18/2017 | SeqNo:      | 1399651                     | Units:   | mg/Kg     |       |          |      |
| Analyte                    | Result          | PQL            | SPK value | SPK Ref Val | %REC                        | LowLimit | HighLimit | %RPD  | RPDLimit | Qual |
| Benzene                    | 0.97            | 0.024          | 0.9597    | 0           | 101                         | 80.9     | 132       | 0.874 | 20       |      |
| Toluene                    | 0.94            | 0.048          | 0.9597    | 0.01598     | 96.8                        | 79.8     | 136       | 1.87  | 20       |      |
| Ethylbenzene               | 0.96            | 0.048          | 0.9597    | 0.01601     | 98.0                        | 79.4     | 140       | 2.56  | 20       |      |
| Xylenes, Total             | 2.9             | 0.096          | 2.879     | 0.01861     | 98.6                        | 78.5     | 142       | 3.14  | 20       |      |
| Surr: 4-Bromofluorobenzene | 1.1             |                | 0.9597    |             | 115                         | 66.6     | 132       | 0     | 0        |      |

### Qualifiers:

\* Value exceeds Maximum Contaminant Level.  
D Sample Diluted Due to Matrix  
H Holding times for preparation or analysis exceeded  
ND Not Detected at the Reporting Limit  
PQL Practical Quantitative Limit  
S % Recovery outside of range due to dilution or matrix

B Analyte detected in the associated Method Blank  
E Value above quantitation range  
J Analyte detected below quantitation limits  
P Sample pH Not In Range  
RL Reporting Detection Limit  
W Sample container temperature is out of limit as specified

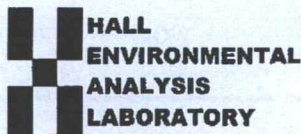

Hall Environmental Analysis Laboratory  
4901 Hawkins NE  
Albuquerque, NM 87109  
TEL: 505-345-3975 FAX: 505-345-4107  
Website: www.hallenvironmental.com

## Sample Log-In Check List

Client Name: Animas Environmental

Work Order Number: 1707627

ReptNo: 1

Received By: Anne Thorne

7/13/2017 7:10:00 AM

Completed By: Erin Melendrez

7/13/2017 11:53:15 AM

Reviewed By:

ENM/ML

7/14/17

*Anne Thorne*  
*Erin Melendrez*

### Chain of Custody

1. Custody seals intact on sample bottles? Yes ☐ No ☐ Not Present ☒
2. Is Chain of Custody complete? Yes ☒ No ☐ Not Present ☐
3. How was the sample delivered? Courier

### Log In

4. Was an attempt made to cool the samples? Yes ☒ No ☐ NA ☐
5. Were all samples received at a temperature of  $>0^{\circ}\text{C}$  to  $6.0^{\circ}\text{C}$ ? Yes ☒ No ☐ NA ☐
6. Sample(s) in proper container(s)? Yes ☒ No ☐
7. Sufficient sample volume for indicated test(s)? Yes ☒ No ☐
8. Are samples (except VOA and ONG) properly preserved? Yes ☒ No ☐
9. Was preservative added to bottles? Yes ☐ No ☒ NA ☐
10. VOA vials have zero headspace? Yes ☐ No ☐ No VOA Vials ☒
11. Were any sample containers received broken? Yes ☐ No ☒
12. Does paperwork match bottle labels?  
(Note discrepancies on chain of custody) Yes ☒ No ☐
13. Are matrices correctly identified on Chain of Custody? Yes ☒ No ☐
14. Is it clear what analyses were requested? Yes ☒ No ☐
15. Were all holding times able to be met?  
(If no, notify customer for authorization.) Yes ☒ No ☐
- # of preserved bottles checked for pH: \_\_\_\_\_  
( $<2$  or  $>12$  unless noted)  
Adjusted? \_\_\_\_\_  
Checked by: \_\_\_\_\_

### Special Handling (If applicable)

16. Was client notified of all discrepancies with this order? Yes ☐ No ☐ NA ☒

|                      |  |       |   |
|----------------------|--|-------|---|
| Person Notified:     |  | Date: |   |
| By Whom:             |  | Via:  | <input type="checkbox"/> eMail <input type="checkbox"/> Phone <input type="checkbox"/> Fax <input type="checkbox"/> In Person |
| Regarding:           |  |       |   |
| Client Instructions: |  |       |   |

17. Additional remarks:

### 18. Cooler Information

| Cooler No | Temp °C | Condition | Seal Intact | Seal No | Seal Date | Signed By |
|-----------|---------|-----------|-------------|---------|-----------|-----------|
| 1         | 2.5     | Good      | Yes         |         |           |           |

# Chain-of-Custody Record

Client: Animas Environmental Services, LLC

Turn-Around Time:

☒ Standard ☐ Rush

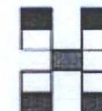

**HALL ENVIRONMENTAL  
ANALYSIS LABORATORY**

www.hallenvironmental.com

4901 Hawkins NE - Albuquerque, NM 87109

Tel. 505-345-3975 Fax 505-345-4107

Mailing Address:

604 W Pinon St.

Farmington, NM 87401

Phone #: 505-564-2281

Email or Fax#: emcnally@animasenvironmental.co

QA/QC Package:

☒ Standard

☐ Level 4 (Full Validation)

Accreditation:

☐ NELAP

☐ Other

☐ EDD (Type)

Project Name:

DJR Marus Compressor Station

Project #:

Project Manager:

E. McNally

Sampler: SG

On Ice: ☒ Yes ☐ No

Sample Temperature: 3.5 - 4.8 = 2.5

## Analysis Request

| Date    | Time  | Matrix | Sample Request ID | Container Type and # | Preservative Type | HEAL No.    | BTEX - 8021B | TPH (GRO/DRO/MRO) - 8015 |  |  |  |  |  |  |  |  |  |  |  |  | Air Bubbles (Y or N) |
|---------|-------|--------|-------------------|----------------------|-------------------|-------------|--------------|--------------------------|--|--|--|--|--|--|--|--|--|--|--|--|----------------------|
| 7/11/17 | 11:01 | SOIL   | SC-1              | 1 - 4 oz jar         | cool              | 1707627-001 | X            | X                        |  |  |  |  |  |  |  |  |  |  |  |  |                      |
| 7/11/17 | 11:05 | SOIL   | SC-2              | 1 - 4 oz jar         | cool              | -002        | X            | X                        |  |  |  |  |  |  |  |  |  |  |  |  |                      |
| 7/11/17 | 11:08 | SOIL   | SC-3              | 1 - 4 oz jar         | cool              | -003        | X            | X                        |  |  |  |  |  |  |  |  |  |  |  |  |                      |
| 7/11/17 | 11:12 | SOIL   | SC-4              | 1 - 4 oz jar         | cool              | -004        | X            | X                        |  |  |  |  |  |  |  |  |  |  |  |  |                      |
| 7/11/17 | 11:16 | SOIL   | SC-5              | 1 - 4 oz jar         | cool              | -005        | X            | X                        |  |  |  |  |  |  |  |  |  |  |  |  |                      |
| 7/11/17 | 11:20 | SOIL   | SC-6              | 1 - 4 oz jar         | cool              | -006        | X            | X                        |  |  |  |  |  |  |  |  |  |  |  |  |                      |
| 7/11/17 | 11:43 | SOIL   | SC-7              | 1 - 4 oz jar         | cool              | -007        | X            | X                        |  |  |  |  |  |  |  |  |  |  |  |  |                      |
| 7/11/17 | 11:46 | SOIL   | SC-8              | 1 - 4 oz jar         | cool              | -008        | X            | X                        |  |  |  |  |  |  |  |  |  |  |  |  |                      |
| 7/11/17 | 11:50 | SOIL   | SC-9              | 1 - 4 oz jar         | cool              | -009        | X            | X                        |  |  |  |  |  |  |  |  |  |  |  |  |                      |
|         |       |        |                   |                      |                   |             |              |                          |  |  |  |  |  |  |  |  |  |  |  |  |                      |
|         |       |        |                   |                      |                   |             |              |                          |  |  |  |  |  |  |  |  |  |  |  |  |                      |

|               |            |                              |                          |                |            |                                |
|---------------|------------|------------------------------|--------------------------|----------------|------------|--------------------------------|
| Date: 7/12/17 | Time: 1802 | Relinquished by: [Signature] | Received by: [Signature] | Date: 7/12/17  | Time: 1622 | Remarks: Bill to AES           |
| Date: 7/12/17 | Time: 1804 | Relinquished by: [Signature] | Received by: [Signature] | Date: 07/13/17 | Time: 0710 | Please call with any questions |

If necessary, samples submitted to Hall Environmental may be subcontracted to other accredited laboratories. This serves as notice of this possibility. Any sub-contracted data will be clearly notated on the analytical report.



Hall Environmental Analysis Laboratory  
4901 Hawkins NE  
Albuquerque, NM 87109  
TEL: 505-345-3975 FAX: 505-345-4107  
Website: [www.hallenvironmental.com](http://www.hallenvironmental.com)

July 19, 2017

Elizabeth McNally

Animas Environmental Services  
604 Pinon Street  
Farmington, NM 87401  
TEL: (505) 564-2281  
FAX (505) 324-2022

**OIL CONS. DIV DIST. 3**

**AUG 11 2017**

RE: DJR Marus Compressor Station

OrderNo.: 1707627

Dear Elizabeth McNally:

Hall Environmental Analysis Laboratory received 9 sample(s) on 7/13/2017 for the analyses presented in the following report.

These were analyzed according to EPA procedures or equivalent. To access our accredited tests please go to [www.hallenvironmental.com](http://www.hallenvironmental.com) or the state specific web sites. In order to properly interpret your results, it is imperative that you review this report in its entirety. See the sample checklist and/or the Chain of Custody for information regarding the sample receipt temperature and preservation. Data qualifiers or a narrative will be provided if the sample analysis or analytical quality control parameters require a flag. When necessary, data qualifiers are provided on both the sample analysis report and the QC summary report, both sections should be reviewed. All samples are reported, as received, unless otherwise indicated. Lab measurement of analytes considered field parameters that require analysis within 15 minutes of sampling such as pH and residual chlorine are qualified as being analyzed outside of the recommended holding time.

Please don't hesitate to contact HEAL for any additional information or clarifications.

ADHS Cert #AZ0682 -- NMED-DWB Cert #NM9425 -- NMED-Micro Cert #NM0190

Sincerely,

Andy Freeman  
Laboratory Manager  
4901 Hawkins NE  
Albuquerque, NM 87109

# Analytical Report

Lab Order 1707627

Date Reported: 7/19/2017

## Hall Environmental Analysis Laboratory, Inc.

CLIENT: Animas Environmental Services

Client Sample ID: SC-1

Project: DJR Marus Compressor Station

Collection Date: 7/11/2017 11:01:00 AM

Lab ID: 1707627-001

Matrix: SOIL

Received Date: 7/13/2017 7:10:00 AM

| Analyses   | Result | PQL      | Qual | Units | DF | Date Analyzed         | Batch               |
|--|--------|----------|------|-------|----|-----------------------|---------------------|
| <b>EPA METHOD 8015M/D: DIESEL RANGE ORGANICS</b> |        |          |      |       |    |                       | Analyst: <b>MAB</b> |
| Diesel Range Organics (DRO)                      | 72     | 9.7      |      | mg/Kg | 1  | 7/18/2017 6:13:02 AM  | 32810               |
| Motor Oil Range Organics (MRO)                   | 60     | 49       |      | mg/Kg | 1  | 7/18/2017 6:13:02 AM  | 32810               |
| Surr: DNOP                                       | 71.8   | 70-130   |      | %Rec  | 1  | 7/18/2017 6:13:02 AM  | 32810               |
| <b>EPA METHOD 8015D: GASOLINE RANGE</b>          |        |          |      |       |    |                       | Analyst: <b>NSB</b> |
| Gasoline Range Organics (GRO)                    | ND     | 4.8      |      | mg/Kg | 1  | 7/18/2017 10:24:04 PM | 32814               |
| Surr: BFB  | 96.1   | 54-150   |      | %Rec  | 1  | 7/18/2017 10:24:04 PM | 32814               |
| <b>EPA METHOD 8021B: VOLATILES</b>               |        |          |      |       |    |                       | Analyst: <b>NSB</b> |
| Benzene  | ND     | 0.024    |      | mg/Kg | 1  | 7/18/2017 10:24:04 PM | 32814               |
| Toluene  | ND     | 0.048    |      | mg/Kg | 1  | 7/18/2017 10:24:04 PM | 32814               |
| Ethylbenzene                                     | ND     | 0.048    |      | mg/Kg | 1  | 7/18/2017 10:24:04 PM | 32814               |
| Xylenes, Total                                   | ND     | 0.096    |      | mg/Kg | 1  | 7/18/2017 10:24:04 PM | 32814               |
| Surr: 4-Bromofluorobenzene                       | 110    | 66.6-132 |      | %Rec  | 1  | 7/18/2017 10:24:04 PM | 32814               |

Refer to the QC Summary report and sample login checklist for flagged QC data and preservation information.

|             |     |   |    |   |
|-------------|-----|---|----|---|
| Qualifiers: | *   | Value exceeds Maximum Contaminant Level.              | B  | Analyte detected in the associated Method Blank           |
|             | D   | Sample Diluted Due to Matrix                          | E  | Value above quantitation range                            |
|             | H   | Holding times for preparation or analysis exceeded    | J  | Analyte detected below quantitation limits                |
|             | ND  | Not Detected at the Reporting Limit                   | P  | Sample pH Not In Range                                    |
|             | PQL | Practical Quantitative Limit                          | RL | Reporting Detection Limit                                 |
|             | S   | % Recovery outside of range due to dilution or matrix | W  | Sample container temperature is out of limit as specified |

## Analytical Report

Lab Order 1707627

Date Reported: 7/19/2017

## Hall Environmental Analysis Laboratory, Inc.

CLIENT: Animas Environmental Services

Client Sample ID: SC-2

Project: DJR Marus Compressor Station

Collection Date: 7/11/2017 11:05:00 AM

Lab ID: 1707627-002

Matrix: SOIL

Received Date: 7/13/2017 7:10:00 AM

| Analyses   | Result | PQL      | Qual | Units | DF | Date Analyzed         | Batch               |
|--|--------|----------|------|-------|----|-----------------------|---------------------|
| <b>EPA METHOD 8015M/D: DIESEL RANGE ORGANICS</b> |        |          |      |       |    |                       | Analyst: <b>MAB</b> |
| Diesel Range Organics (DRO)                      | 200    | 10       |      | mg/Kg | 1  | 7/18/2017 6:37:36 AM  | 32810               |
| Motor Oil Range Organics (MRO)                   | 180    | 50       |      | mg/Kg | 1  | 7/18/2017 6:37:36 AM  | 32810               |
| Surr: DNOP                                       | 76.0   | 70-130   |      | %Rec  | 1  | 7/18/2017 6:37:36 AM  | 32810               |
| <b>EPA METHOD 8015D: GASOLINE RANGE</b>          |        |          |      |       |    |                       | Analyst: <b>NSB</b> |
| Gasoline Range Organics (GRO)                    | ND     | 4.8      |      | mg/Kg | 1  | 7/18/2017 10:47:33 PM | 32814               |
| Surr: BFB  | 124    | 54-150   |      | %Rec  | 1  | 7/18/2017 10:47:33 PM | 32814               |
| <b>EPA METHOD 8021B: VOLATILES</b>               |        |          |      |       |    |                       | Analyst: <b>NSB</b> |
| Benzene  | ND     | 0.024    |      | mg/Kg | 1  | 7/18/2017 10:47:33 PM | 32814               |
| Toluene  | ND     | 0.048    |      | mg/Kg | 1  | 7/18/2017 10:47:33 PM | 32814               |
| Ethylbenzene                                     | ND     | 0.048    |      | mg/Kg | 1  | 7/18/2017 10:47:33 PM | 32814               |
| Xylenes, Total                                   | ND     | 0.097    |      | mg/Kg | 1  | 7/18/2017 10:47:33 PM | 32814               |
| Surr: 4-Bromofluorobenzene                       | 111    | 66.6-132 |      | %Rec  | 1  | 7/18/2017 10:47:33 PM | 32814               |

Refer to the QC Summary report and sample login checklist for flagged QC data and preservation information.

|             |     |   |    |   |
|-------------|-----|---|----|---|
| Qualifiers: | *   | Value exceeds Maximum Contaminant Level.              | B  | Analyte detected in the associated Method Blank           |
|             | D   | Sample Diluted Due to Matrix                          | E  | Value above quantitation range                            |
|             | H   | Holding times for preparation or analysis exceeded    | J  | Analyte detected below quantitation limits                |
|             | ND  | Not Detected at the Reporting Limit                   | P  | Sample pH Not In Range                                    |
|             | PQL | Practical Quantitative Limit                          | RL | Reporting Detection Limit                                 |
|             | S   | % Recovery outside of range due to dilution or matrix | W  | Sample container temperature is out of limit as specified |
|             |     |   |    |   |

**Analytical Report**

Lab Order 1707627

Date Reported: 7/19/2017

**Hall Environmental Analysis Laboratory, Inc.****CLIENT:** Animas Environmental Services**Client Sample ID:** SC-3**Project:** DJR Marus Compressor Station**Collection Date:** 7/11/2017 11:08:00 AM**Lab ID:** 1707627-003**Matrix:** SOIL**Received Date:** 7/13/2017 7:10:00 AM

| Analyses   | Result | PQL      | Qual | Units | DF | Date Analyzed         | Batch               |
|--|--------|----------|------|-------|----|-----------------------|---------------------|
| <b>EPA METHOD 8015M/D: DIESEL RANGE ORGANICS</b> |        |          |      |       |    |                       | Analyst: <b>MAB</b> |
| Diesel Range Organics (DRO)                      | ND     | 10       |      | mg/Kg | 1  | 7/18/2017 7:02:19 AM  | 32810               |
| Motor Oil Range Organics (MRO)                   | ND     | 50       |      | mg/Kg | 1  | 7/18/2017 7:02:19 AM  | 32810               |
| Surr: DNOP                                       | 71.0   | 70-130   |      | %Rec  | 1  | 7/18/2017 7:02:19 AM  | 32810               |
| <b>EPA METHOD 8015D: GASOLINE RANGE</b>          |        |          |      |       |    |                       | Analyst: <b>NSB</b> |
| Gasoline Range Organics (GRO)                    | ND     | 4.9      |      | mg/Kg | 1  | 7/19/2017 12:21:36 AM | 32814               |
| Surr: BFB  | 95.6   | 54-150   |      | %Rec  | 1  | 7/19/2017 12:21:36 AM | 32814               |
| <b>EPA METHOD 8021B: VOLATILES</b>               |        |          |      |       |    |                       | Analyst: <b>NSB</b> |
| Benzene  | ND     | 0.024    |      | mg/Kg | 1  | 7/19/2017 12:21:36 AM | 32814               |
| Toluene  | ND     | 0.049    |      | mg/Kg | 1  | 7/19/2017 12:21:36 AM | 32814               |
| Ethylbenzene                                     | ND     | 0.049    |      | mg/Kg | 1  | 7/19/2017 12:21:36 AM | 32814               |
| Xylenes, Total                                   | ND     | 0.098    |      | mg/Kg | 1  | 7/19/2017 12:21:36 AM | 32814               |
| Surr: 4-Bromofluorobenzene                       | 110    | 66.6-132 |      | %Rec  | 1  | 7/19/2017 12:21:36 AM | 32814               |

Refer to the QC Summary report and sample login checklist for flagged QC data and preservation information.

|                    |     |   |    |   |
|--------------------|-----|---|----|---|
| <b>Qualifiers:</b> | *   | Value exceeds Maximum Contaminant Level.              | B  | Analyte detected in the associated Method Blank           |
|                    | D   | Sample Diluted Due to Matrix                          | E  | Value above quantitation range                            |
|                    | H   | Holding times for preparation or analysis exceeded    | J  | Analyte detected below quantitation limits                |
|                    | ND  | Not Detected at the Reporting Limit                   | P  | Sample pH Not In Range                                    |
|                    | PQL | Practical Quantitative Limit                          | RL | Reporting Detection Limit                                 |
|                    | S   | % Recovery outside of range due to dilution or matrix | W  | Sample container temperature is out of limit as specified |
|                    |     |   |    |   |

**Analytical Report**

Lab Order 1707627

Date Reported: 7/19/2017

**Hall Environmental Analysis Laboratory, Inc.****CLIENT:** Animas Environmental Services**Client Sample ID:** SC-4**Project:** DJR Marus Compressor Station**Collection Date:** 7/11/2017 11:12:00 AM**Lab ID:** 1707627-004**Matrix:** SOIL**Received Date:** 7/13/2017 7:10:00 AM

| Analyses   | Result | PQL      | Qual | Units | DF | Date Analyzed         | Batch               |
|--|--------|----------|------|-------|----|-----------------------|---------------------|
| <b>EPA METHOD 8015M/D: DIESEL RANGE ORGANICS</b> |        |          |      |       |    |                       | Analyst: <b>MAB</b> |
| Diesel Range Organics (DRO)                      | 20     | 9.3      |      | mg/Kg | 1  | 7/18/2017 7:26:54 AM  | 32810               |
| Motor Oil Range Organics (MRO)                   | ND     | 47       |      | mg/Kg | 1  | 7/18/2017 7:26:54 AM  | 32810               |
| Surr: DNOP                                       | 76.2   | 70-130   |      | %Rec  | 1  | 7/18/2017 7:26:54 AM  | 32810               |
| <b>EPA METHOD 8015D: GASOLINE RANGE</b>          |        |          |      |       |    |                       | Analyst: <b>NSB</b> |
| Gasoline Range Organics (GRO)                    | ND     | 4.8      |      | mg/Kg | 1  | 7/19/2017 12:45:12 AM | 32814               |
| Surr: BFB  | 94.8   | 54-150   |      | %Rec  | 1  | 7/19/2017 12:45:12 AM | 32814               |
| <b>EPA METHOD 8021B: VOLATILES</b>               |        |          |      |       |    |                       | Analyst: <b>NSB</b> |
| Benzene  | ND     | 0.024    |      | mg/Kg | 1  | 7/19/2017 12:45:12 AM | 32814               |
| Toluene  | ND     | 0.048    |      | mg/Kg | 1  | 7/19/2017 12:45:12 AM | 32814               |
| Ethylbenzene                                     | ND     | 0.048    |      | mg/Kg | 1  | 7/19/2017 12:45:12 AM | 32814               |
| Xylenes, Total                                   | ND     | 0.096    |      | mg/Kg | 1  | 7/19/2017 12:45:12 AM | 32814               |
| Surr: 4-Bromofluorobenzene                       | 109    | 66.6-132 |      | %Rec  | 1  | 7/19/2017 12:45:12 AM | 32814               |

Refer to the QC Summary report and sample login checklist for flagged QC data and preservation information.

|                    |     |   |    |   |
|--------------------|-----|---|----|---|
| <b>Qualifiers:</b> | *   | Value exceeds Maximum Contaminant Level.              | B  | Analyte detected in the associated Method Blank           |
|                    | D   | Sample Diluted Due to Matrix                          | E  | Value above quantitation range                            |
|                    | H   | Holding times for preparation or analysis exceeded    | J  | Analyte detected below quantitation limits                |
|                    | ND  | Not Detected at the Reporting Limit                   | P  | Sample pH Not In Range                                    |
|                    | PQL | Practical Quantitative Limit                          | RL | Reporting Detection Limit                                 |
|                    | S   | % Recovery outside of range due to dilution or matrix | W  | Sample container temperature is out of limit as specified |

# Hall Environmental Analysis Laboratory, Inc.

## Analytical Report

Lab Order 1707627

Date Reported: 7/19/2017

**CLIENT:** Animas Environmental Services

**Client Sample ID:** SC-5

**Project:** DJR Marus Compressor Station

**Collection Date:** 7/11/2017 11:16:00 AM

**Lab ID:** 1707627-005

**Matrix:** SOIL

**Received Date:** 7/13/2017 7:10:00 AM

| Analyses   | Result | PQL      | Qual | Units | DF | Date Analyzed        | Batch               |
|--|--------|----------|------|-------|----|----------------------|---------------------|
| <b>EPA METHOD 8015M/D: DIESEL RANGE ORGANICS</b> |        |          |      |       |    |                      | Analyst: <b>MAB</b> |
| Diesel Range Organics (DRO)                      | ND     | 9.9      |      | mg/Kg | 1  | 7/18/2017 7:51:35 AM | 32810               |
| Motor Oil Range Organics (MRO)                   | ND     | 50       |      | mg/Kg | 1  | 7/18/2017 7:51:35 AM | 32810               |
| Surr: DNOP                                       | 71.4   | 70-130   |      | %Rec  | 1  | 7/18/2017 7:51:35 AM | 32810               |
| <b>EPA METHOD 8015D: GASOLINE RANGE</b>          |        |          |      |       |    |                      | Analyst: <b>NSB</b> |
| Gasoline Range Organics (GRO)                    | ND     | 4.7      |      | mg/Kg | 1  | 7/19/2017 1:08:41 AM | 32814               |
| Surr: BFB  | 94.8   | 54-150   |      | %Rec  | 1  | 7/19/2017 1:08:41 AM | 32814               |
| <b>EPA METHOD 8021B: VOLATILES</b>               |        |          |      |       |    |                      | Analyst: <b>NSB</b> |
| Benzene  | ND     | 0.024    |      | mg/Kg | 1  | 7/19/2017 1:08:41 AM | 32814               |
| Toluene  | ND     | 0.047    |      | mg/Kg | 1  | 7/19/2017 1:08:41 AM | 32814               |
| Ethylbenzene                                     | ND     | 0.047    |      | mg/Kg | 1  | 7/19/2017 1:08:41 AM | 32814               |
| Xylenes, Total                                   | ND     | 0.095    |      | mg/Kg | 1  | 7/19/2017 1:08:41 AM | 32814               |
| Surr: 4-Bromofluorobenzene                       | 108    | 66.6-132 |      | %Rec  | 1  | 7/19/2017 1:08:41 AM | 32814               |

Refer to the QC Summary report and sample login checklist for flagged QC data and preservation information.

|                    |     |   |    |   |
|--------------------|-----|---|----|---|
| <b>Qualifiers:</b> | *   | Value exceeds Maximum Contaminant Level.              | B  | Analyte detected in the associated Method Blank           |
|                    | D   | Sample Diluted Due to Matrix                          | E  | Value above quantitation range                            |
|                    | H   | Holding times for preparation or analysis exceeded    | J  | Analyte detected below quantitation limits                |
|                    | ND  | Not Detected at the Reporting Limit                   | P  | Sample pH Not In Range                                    |
|                    | PQL | Practical Quantitative Limit                          | RL | Reporting Detection Limit                                 |
|                    | S   | % Recovery outside of range due to dilution or matrix | W  | Sample container temperature is out of limit as specified |
|                    |     |   |    |   |

**Analytical Report**

Lab Order 1707627

Date Reported: 7/19/2017

**Hall Environmental Analysis Laboratory, Inc.****CLIENT:** Animas Environmental Services**Client Sample ID:** SC-6**Project:** DJR Marus Compressor Station**Collection Date:** 7/11/2017 11:20:00 AM**Lab ID:** 1707627-006**Matrix:** SOIL**Received Date:** 7/13/2017 7:10:00 AM

| Analyses   | Result | PQL      | Qual | Units | DF | Date Analyzed        | Batch               |
|--|--------|----------|------|-------|----|----------------------|---------------------|
| <b>EPA METHOD 8015M/D: DIESEL RANGE ORGANICS</b> |        |          |      |       |    |                      | Analyst: <b>TOM</b> |
| Diesel Range Organics (DRO)                      | ND     | 10       |      | mg/Kg | 1  | 7/18/2017 4:02:52 PM | 32836               |
| Motor Oil Range Organics (MRO)                   | ND     | 50       |      | mg/Kg | 1  | 7/18/2017 4:02:52 PM | 32836               |
| Surr: DNOP                                       | 84.6   | 70-130   |      | %Rec  | 1  | 7/18/2017 4:02:52 PM | 32836               |
| <b>EPA METHOD 8015D: GASOLINE RANGE</b>          |        |          |      |       |    |                      | Analyst: <b>NSB</b> |
| Gasoline Range Organics (GRO)                    | ND     | 4.7      |      | mg/Kg | 1  | 7/19/2017 1:32:10 AM | 32814               |
| Surr: BFB  | 94.9   | 54-150   |      | %Rec  | 1  | 7/19/2017 1:32:10 AM | 32814               |
| <b>EPA METHOD 8021B: VOLATILES</b>               |        |          |      |       |    |                      | Analyst: <b>NSB</b> |
| Benzene  | ND     | 0.023    |      | mg/Kg | 1  | 7/19/2017 1:32:10 AM | 32814               |
| Toluene  | ND     | 0.047    |      | mg/Kg | 1  | 7/19/2017 1:32:10 AM | 32814               |
| Ethylbenzene                                     | ND     | 0.047    |      | mg/Kg | 1  | 7/19/2017 1:32:10 AM | 32814               |
| Xylenes, Total                                   | ND     | 0.093    |      | mg/Kg | 1  | 7/19/2017 1:32:10 AM | 32814               |
| Surr: 4-Bromofluorobenzene                       | 108    | 66.6-132 |      | %Rec  | 1  | 7/19/2017 1:32:10 AM | 32814               |

Refer to the QC Summary report and sample login checklist for flagged QC data and preservation information.

|                    |     |   |    |   |
|--------------------|-----|---|----|---|
| <b>Qualifiers:</b> | *   | Value exceeds Maximum Contaminant Level.              | B  | Analyte detected in the associated Method Blank           |
|                    | D   | Sample Diluted Due to Matrix                          | E  | Value above quantitation range                            |
|                    | H   | Holding times for preparation or analysis exceeded    | J  | Analyte detected below quantitation limits                |
|                    | ND  | Not Detected at the Reporting Limit                   | P  | Sample pH Not In Range                                    |
|                    | PQL | Practical Quantitative Limit                          | RL | Reporting Detection Limit                                 |
|                    | S   | % Recovery outside of range due to dilution or matrix | W  | Sample container temperature is out of limit as specified |

## Analytical Report

Lab Order 1707627

Date Reported: 7/19/2017

## Hall Environmental Analysis Laboratory, Inc.

CLIENT: Animas Environmental Services

Client Sample ID: SC-7

Project: DJR Marus Compressor Station

Collection Date: 7/11/2017 11:43:00 AM

Lab ID: 1707627-007

Matrix: SOIL

Received Date: 7/13/2017 7:10:00 AM

| Analyses   | Result | PQL      | Qual | Units | DF | Date Analyzed        | Batch               |
|--|--------|----------|------|-------|----|----------------------|---------------------|
| <b>EPA METHOD 8015M/D: DIESEL RANGE ORGANICS</b> |        |          |      |       |    |                      | Analyst: <b>TOM</b> |
| Diesel Range Organics (DRO)                      | 33     | 9.5      |      | mg/Kg | 1  | 7/18/2017 5:28:10 PM | 32836               |
| Motor Oil Range Organics (MRO)                   | ND     | 48       |      | mg/Kg | 1  | 7/18/2017 5:28:10 PM | 32836               |
| Surr: DNOP                                       | 81.1   | 70-130   |      | %Rec  | 1  | 7/18/2017 5:28:10 PM | 32836               |
| <b>EPA METHOD 8015D: GASOLINE RANGE</b>          |        |          |      |       |    |                      | Analyst: <b>NSB</b> |
| Gasoline Range Organics (GRO)                    | ND     | 4.9      |      | mg/Kg | 1  | 7/19/2017 1:55:41 AM | 32814               |
| Surr: BFB  | 97.1   | 54-150   |      | %Rec  | 1  | 7/19/2017 1:55:41 AM | 32814               |
| <b>EPA METHOD 8021B: VOLATILES</b>               |        |          |      |       |    |                      | Analyst: <b>NSB</b> |
| Benzene  | ND     | 0.024    |      | mg/Kg | 1  | 7/19/2017 1:55:41 AM | 32814               |
| Toluene  | ND     | 0.049    |      | mg/Kg | 1  | 7/19/2017 1:55:41 AM | 32814               |
| Ethylbenzene                                     | ND     | 0.049    |      | mg/Kg | 1  | 7/19/2017 1:55:41 AM | 32814               |
| Xylenes, Total                                   | ND     | 0.097    |      | mg/Kg | 1  | 7/19/2017 1:55:41 AM | 32814               |
| Surr: 4-Bromofluorobenzene                       | 110    | 66.6-132 |      | %Rec  | 1  | 7/19/2017 1:55:41 AM | 32814               |

Refer to the QC Summary report and sample login checklist for flagged QC data and preservation information.

|             |     |   |    |   |
|-------------|-----|---|----|---|
| Qualifiers: | *   | Value exceeds Maximum Contaminant Level.              | B  | Analyte detected in the associated Method Blank           |
|             | D   | Sample Diluted Due to Matrix                          | E  | Value above quantitation range                            |
|             | H   | Holding times for preparation or analysis exceeded    | J  | Analyte detected below quantitation limits                |
|             | ND  | Not Detected at the Reporting Limit                   | P  | Sample pH Not In Range                                    |
|             | PQL | Practical Quantitative Limit                          | RL | Reporting Detection Limit                                 |
|             | S   | % Recovery outside of range due to dilution or matrix | W  | Sample container temperature is out of limit as specified |
|             |     |   |    |   |

## Analytical Report

Lab Order 1707627

Date Reported: 7/19/2017

## Hall Environmental Analysis Laboratory, Inc.

CLIENT: Animas Environmental Services

Client Sample ID: SC-8

Project: DJR Marus Compressor Station

Collection Date: 7/11/2017 11:46:00 AM

Lab ID: 1707627-008

Matrix: SOIL

Received Date: 7/13/2017 7:10:00 AM

| Analyses   | Result | PQL      | Qual | Units | DF | Date Analyzed        | Batch               |
|--|--------|----------|------|-------|----|----------------------|---------------------|
| <b>EPA METHOD 8015M/D: DIESEL RANGE ORGANICS</b> |        |          |      |       |    |                      | Analyst: <b>TOM</b> |
| Diesel Range Organics (DRO)                      | ND     | 9.5      |      | mg/Kg | 1  | 7/18/2017 5:57:35 PM | 32836               |
| Motor Oil Range Organics (MRO)                   | ND     | 48       |      | mg/Kg | 1  | 7/18/2017 5:57:35 PM | 32836               |
| Surr: DNOP                                       | 71.6   | 70-130   |      | %Rec  | 1  | 7/18/2017 5:57:35 PM | 32836               |
| <b>EPA METHOD 8015D: GASOLINE RANGE</b>          |        |          |      |       |    |                      | Analyst: <b>NSB</b> |
| Gasoline Range Organics (GRO)                    | ND     | 4.8      |      | mg/Kg | 1  | 7/19/2017 2:19:08 AM | 32814               |
| Surr: BFB  | 98.1   | 54-150   |      | %Rec  | 1  | 7/19/2017 2:19:08 AM | 32814               |
| <b>EPA METHOD 8021B: VOLATILES</b>               |        |          |      |       |    |                      | Analyst: <b>NSB</b> |
| Benzene  | ND     | 0.024    |      | mg/Kg | 1  | 7/19/2017 2:19:08 AM | 32814               |
| Toluene  | ND     | 0.048    |      | mg/Kg | 1  | 7/19/2017 2:19:08 AM | 32814               |
| Ethylbenzene                                     | ND     | 0.048    |      | mg/Kg | 1  | 7/19/2017 2:19:08 AM | 32814               |
| Xylenes, Total                                   | ND     | 0.096    |      | mg/Kg | 1  | 7/19/2017 2:19:08 AM | 32814               |
| Surr: 4-Bromofluorobenzene                       | 109    | 66.6-132 |      | %Rec  | 1  | 7/19/2017 2:19:08 AM | 32814               |

Refer to the QC Summary report and sample login checklist for flagged QC data and preservation information.

|             |     |   |    |   |
|-------------|-----|---|----|---|
| Qualifiers: | *   | Value exceeds Maximum Contaminant Level.              | B  | Analyte detected in the associated Method Blank           |
|             | D   | Sample Diluted Due to Matrix                          | E  | Value above quantitation range                            |
|             | H   | Holding times for preparation or analysis exceeded    | J  | Analyte detected below quantitation limits                |
|             | ND  | Not Detected at the Reporting Limit                   | P  | Sample pH Not In Range                                    |
|             | PQL | Practical Quantitative Limit                          | RL | Reporting Detection Limit                                 |
|             | S   | % Recovery outside of range due to dilution or matrix | W  | Sample container temperature is out of limit as specified |
|             |     |   |    |   |

**Analytical Report**

Lab Order 1707627

Date Reported: 7/19/2017

**Hall Environmental Analysis Laboratory, Inc.****CLIENT:** Animas Environmental Services**Client Sample ID:** SC-9**Project:** DJR Marus Compressor Station**Collection Date:** 7/11/2017 11:50:00 AM**Lab ID:** 1707627-009**Matrix:** SOIL**Received Date:** 7/13/2017 7:10:00 AM

| Analyses   | Result | PQL      | Qual | Units | DF | Date Analyzed        | Batch               |
|--|--------|----------|------|-------|----|----------------------|---------------------|
| <b>EPA METHOD 8015M/D: DIESEL RANGE ORGANICS</b> |        |          |      |       |    |                      | Analyst: <b>TOM</b> |
| Diesel Range Organics (DRO)                      | 510    | 9.7      |      | mg/Kg | 1  | 7/18/2017 6:26:56 PM | 32836               |
| Motor Oil Range Organics (MRO)                   | 400    | 49       |      | mg/Kg | 1  | 7/18/2017 6:26:56 PM | 32836               |
| Surr: DNOP                                       | 88.7   | 70-130   |      | %Rec  | 1  | 7/18/2017 6:26:56 PM | 32836               |
| <b>EPA METHOD 8015D: GASOLINE RANGE</b>          |        |          |      |       |    |                      | Analyst: <b>NSB</b> |
| Gasoline Range Organics (GRO)                    | 30     | 25       |      | mg/Kg | 5  | 7/19/2017 2:42:40 AM | 32814               |
| Surr: BFB  | 151    | 54-150   | S    | %Rec  | 5  | 7/19/2017 2:42:40 AM | 32814               |
| <b>EPA METHOD 8021B: VOLATILES</b>               |        |          |      |       |    |                      | Analyst: <b>NSB</b> |
| Benzene  | ND     | 0.12     | D    | mg/Kg | 5  | 7/19/2017 2:42:40 AM | 32814               |
| Toluene  | ND     | 0.25     | D    | mg/Kg | 5  | 7/19/2017 2:42:40 AM | 32814               |
| Ethylbenzene                                     | ND     | 0.25     | D    | mg/Kg | 5  | 7/19/2017 2:42:40 AM | 32814               |
| Xylenes, Total                                   | ND     | 0.49     | D    | mg/Kg | 5  | 7/19/2017 2:42:40 AM | 32814               |
| Surr: 4-Bromofluorobenzene                       | 116    | 66.6-132 | D    | %Rec  | 5  | 7/19/2017 2:42:40 AM | 32814               |

Refer to the QC Summary report and sample login checklist for flagged QC data and preservation information.

|                    |     |   |    |   |
|--------------------|-----|---|----|---|
| <b>Qualifiers:</b> | *   | Value exceeds Maximum Contaminant Level.              | B  | Analyte detected in the associated Method Blank           |
|                    | D   | Sample Diluted Due to Matrix                          | E  | Value above quantitation range                            |
|                    | H   | Holding times for preparation or analysis exceeded    | J  | Analyte detected below quantitation limits                |
|                    | ND  | Not Detected at the Reporting Limit                   | P  | Sample pH Not In Range                                    |
|                    | PQL | Practical Quantitative Limit                          | RL | Reporting Detection Limit                                 |
|                    | S   | % Recovery outside of range due to dilution or matrix | W  | Sample container temperature is out of limit as specified |

# QC SUMMARY REPORT

## Hall Environmental Analysis Laboratory, Inc.

WO#: 1707627

19-Jul-17

Client: Animas Environmental Services

Project: DJR Marus Compressor Station

|            |           |     |                          |             |   |          |             |      |          |      |
|------------|-----------|-----|--------------------------|-------------|---|----------|-------------|------|----------|------|
| Sample ID  | MB-32805  |     | SampType: MBLK           |             | TestCode: EPA Method 8015M/D: Diesel Range Organics |          |             |      |          |      |
| Client ID: | PBS       |     | Batch ID: 32805          |             | RunNo: 44252  |          |             |      |          |      |
| Prep Date: | 7/14/2017 |     | Analysis Date: 7/17/2017 |             | SeqNo: 1397598                                      |          | Units: %Rec |      |          |      |
| Analyte    | Result    | PQL | SPK value                | SPK Ref Val | %REC  | LowLimit | HighLimit   | %RPD | RPDLimit | Qual |
| Surr: DNOP | 9.6       |     | 10.00                    |             | 96.3  | 70       | 130         |      |          |      |

|            |           |     |                          |             |   |          |             |      |          |      |
|------------|-----------|-----|--------------------------|-------------|---|----------|-------------|------|----------|------|
| Sample ID  | LCS-32805 |     | SampType: LCS            |             | TestCode: EPA Method 8015M/D: Diesel Range Organics |          |             |      |          |      |
| Client ID: | LCSS      |     | Batch ID: 32805          |             | RunNo: 44252  |          |             |      |          |      |
| Prep Date: | 7/14/2017 |     | Analysis Date: 7/17/2017 |             | SeqNo: 1397654                                      |          | Units: %Rec |      |          |      |
| Analyte    | Result    | PQL | SPK value                | SPK Ref Val | %REC  | LowLimit | HighLimit   | %RPD | RPDLimit | Qual |
| Surr: DNOP | 5.0       |     | 5.000                    |             | 100   | 70       | 130         |      |          |      |

|                             |           |     |                          |             |   |          |              |      |          |      |
|-----------------------------|-----------|-----|--------------------------|-------------|---|----------|--------------|------|----------|------|
| Sample ID                   | LCS-32810 |     | SampType: LCS            |             | TestCode: EPA Method 8015M/D: Diesel Range Organics |          |              |      |          |      |
| Client ID:                  | LCSS      |     | Batch ID: 32810          |             | RunNo: 44252  |          |              |      |          |      |
| Prep Date:                  | 7/14/2017 |     | Analysis Date: 7/17/2017 |             | SeqNo: 1397734                                      |          | Units: mg/Kg |      |          |      |
| Analyte                     | Result    | PQL | SPK value                | SPK Ref Val | %REC  | LowLimit | HighLimit    | %RPD | RPDLimit | Qual |
| Diesel Range Organics (DRO) | 47        | 10  | 50.00                    | 0           | 95.0  | 73.2     | 114          |      |          |      |
| Surr: DNOP                  | 4.5       |     | 5.000                    |             | 90.1  | 70       | 130          |      |          |      |

|                                |           |                |           |             |           |   |           |              |          |      |
|--------------------------------|-----------|----------------|-----------|-------------|-----------|---|-----------|--------------|----------|------|
| Sample ID                      | MB-32810  | SampType:      | MBLK      |             | TestCode: | EPA Method 8015M/D: Diesel Range Organics |           |              |          |      |
| Client ID:                     | PBS       | Batch ID:      | 32810     |             | RunNo:    | 44252                                     |           |              |          |      |
| Prep Date:                     | 7/14/2017 | Analysis Date: | 7/17/2017 |             | SeqNo:    | 1397735                                   |           | Units: mg/Kg |          |      |
| Analyte                        | Result    | PQL            | SPK value | SPK Ref Val | %REC      | LowLimit                                  | HighLimit | %RPD         | RPDLimit | Qual |
| Diesel Range Organics (DRO)    | ND        | 10             |           |             |           |   |           |              |          |      |
| Motor Oil Range Organics (MRO) | ND        | 50             |           |             |           |   |           |              |          |      |
| Surr: DNOP                     | 9.3       |                | 10.00     |             | 93.0      | 70  | 130       |              |          |      |

|                             |                |     |                          |             |   |          |              |      |          |      |
|-----------------------------|----------------|-----|--------------------------|-------------|---|----------|--------------|------|----------|------|
| Sample ID                   | 1707627-006AMS |     | SampType: MS             |             | TestCode: EPA Method 8015M/D: Diesel Range Organics |          |              |      |          |      |
| Client ID:                  | SC-6           |     | Batch ID: 32836          |             | RunNo: 44282  |          |              |      |          |      |
| Prep Date:                  | 7/17/2017      |     | Analysis Date: 7/18/2017 |             | SeqNo: 1399664                                      |          | Units: mg/Kg |      |          |      |
| Analyte                     | Result         | PQL | SPK value                | SPK Ref Val | %REC  | LowLimit | HighLimit    | %RPD | RPDLimit | Qual |
| Diesel Range Organics (DRO) | 62             | 9.7 | 48.40                    | 6.281       | 116   | 55.8     | 122          |      |          |      |
| Surr: DNOP                  | 4.4            |     | 4.840                    |             | 91.8  | 70       | 130          |      |          |      |

|                             |                 |     |                          |             |   |          |              |       |          |      |
|-----------------------------|-----------------|-----|--------------------------|-------------|---|----------|--------------|-------|----------|------|
| Sample ID                   | 1707627-006AMSD |     | SampType: MSD            |             | TestCode: EPA Method 8015M/D: Diesel Range Organics |          |              |       |          |      |
| Client ID:                  | SC-6            |     | Batch ID: 32836          |             | RunNo: 44282  |          |              |       |          |      |
| Prep Date:                  | 7/17/2017       |     | Analysis Date: 7/18/2017 |             | SeqNo: 1399665                                      |          | Units: mg/Kg |       |          |      |
| Analyte                     | Result          | PQL | SPK value                | SPK Ref Val | %REC  | LowLimit | HighLimit    | %RPD  | RPDLimit | Qual |
| Diesel Range Organics (DRO) | 63              | 9.7 | 48.40                    | 6.281       | 116   | 55.8     | 122          | 0.375 | 20       |      |

### Qualifiers:

\* Value exceeds Maximum Contaminant Level.  
D Sample Diluted Due to Matrix  
H Holding times for preparation or analysis exceeded  
ND Not Detected at the Reporting Limit  
PQL Practical Quantitative Limit  
S % Recovery outside of range due to dilution or matrix

B Analyte detected in the associated Method Blank  
E Value above quantitation range  
J Analyte detected below quantitation limits  
P Sample pH Not In Range  
RL Reporting Detection Limit  
W Sample container temperature is out of limit as specified

# QC SUMMARY REPORT

## Hall Environmental Analysis Laboratory, Inc.

WO#: 1707627

19-Jul-17

Client: Animas Environmental Services

Project: DJR Marus Compressor Station

|            |                 |                |           |             |   |          |           |      |          |      |
|------------|-----------------|----------------|-----------|-------------|---|----------|-----------|------|----------|------|
| Sample ID  | 1707627-006AMSD | SampType:      | MSD       | TestCode:   | EPA Method 8015M/D: Diesel Range Organics |          |           |      |          |      |
| Client ID: | SC-6            | Batch ID:      | 32836     | RunNo:      | 44282                                     |          |           |      |          |      |
| Prep Date: | 7/17/2017       | Analysis Date: | 7/18/2017 | SeqNo:      | 1399665                                   | Units:   | mg/Kg     |      |          |      |
| Analyte    | Result          | PQL            | SPK value | SPK Ref Val | %REC                                      | LowLimit | HighLimit | %RPD | RPDLimit | Qual |
| Surr: DNOP | 4.5             |                | 4.840     |             | 92.0                                      | 70       | 130       | 0    | 0        |      |

|                             |           |                |           |             |   |          |           |      |          |      |
|-----------------------------|-----------|----------------|-----------|-------------|---|----------|-----------|------|----------|------|
| Sample ID                   | LCS-32836 | SampType:      | LCS       | TestCode:   | EPA Method 8015M/D: Diesel Range Organics |          |           |      |          |      |
| Client ID:                  | LCSS      | Batch ID:      | 32836     | RunNo:      | 44282                                     |          |           |      |          |      |
| Prep Date:                  | 7/17/2017 | Analysis Date: | 7/18/2017 | SeqNo:      | 1399678                                   | Units:   | mg/Kg     |      |          |      |
| Analyte                     | Result    | PQL            | SPK value | SPK Ref Val | %REC                                      | LowLimit | HighLimit | %RPD | RPDLimit | Qual |
| Diesel Range Organics (DRO) | 54        | 10             | 50.00     | 0           | 107                                       | 73.2     | 114       |      |          |      |
| Surr: DNOP                  | 4.4       |                | 5.000     |             | 88.8                                      | 70       | 130       |      |          |      |

|                                |           |                |           |             |   |          |           |      |          |      |
|--------------------------------|-----------|----------------|-----------|-------------|---|----------|-----------|------|----------|------|
| Sample ID                      | MB-32836  | SampType:      | MBLK      | TestCode:   | EPA Method 8015M/D: Diesel Range Organics |          |           |      |          |      |
| Client ID:                     | PBS       | Batch ID:      | 32836     | RunNo:      | 44282                                     |          |           |      |          |      |
| Prep Date:                     | 7/17/2017 | Analysis Date: | 7/18/2017 | SeqNo:      | 1399679                                   | Units:   | mg/Kg     |      |          |      |
| Analyte                        | Result    | PQL            | SPK value | SPK Ref Val | %REC                                      | LowLimit | HighLimit | %RPD | RPDLimit | Qual |
| Diesel Range Organics (DRO)    | ND        | 10             |           |             |   |          |           |      |          |      |
| Motor Oil Range Organics (MRO) | ND        | 50             |           |             |   |          |           |      |          |      |
| Surr: DNOP                     | 8.4       |                | 10.00     |             | 84.4                                      | 70       | 130       |      |          |      |

### Qualifiers:

\* Value exceeds Maximum Contaminant Level.  
D Sample Diluted Due to Matrix  
H Holding times for preparation or analysis exceeded  
ND Not Detected at the Reporting Limit  
PQL Practical Quantitative Limit  
S % Recovery outside of range due to dilution or matrix

B Analyte detected in the associated Method Blank  
E Value above quantitation range  
J Analyte detected below quantitation limits  
P Sample pH Not In Range  
RL Reporting Detection Limit  
W Sample container temperature is out of limit as specified

# QC SUMMARY REPORT

## Hall Environmental Analysis Laboratory, Inc.

WO#: 1707627

19-Jul-17

Client: Animas Environmental Services

Project: DJR Marus Compressor Station

|            |           |     |                          |             |  |          |             |      |          |      |
|------------|-----------|-----|--------------------------|-------------|--|----------|-------------|------|----------|------|
| Sample ID  | MB-32828  |     | SampType: MBLK           |             | TestCode: EPA Method 8015D: Gasoline Range |          |             |      |          |      |
| Client ID: | PBS       |     | Batch ID: 32828          |             | RunNo: 44294                               |          |             |      |          |      |
| Prep Date: | 7/17/2017 |     | Analysis Date: 7/18/2017 |             | SeqNo: 1399599                             |          | Units: %Rec |      |          |      |
| Analyte    | Result    | PQL | SPK value                | SPK Ref Val | %REC                                       | LowLimit | HighLimit   | %RPD | RPDLimit | Qual |
| Surr: BFB  | 960       |     | 1000                     |             | 95.8                                       | 54       | 150         |      |          |      |

|            |           |     |                          |             |  |          |             |      |          |      |
|------------|-----------|-----|--------------------------|-------------|--|----------|-------------|------|----------|------|
| Sample ID  | LCS-32828 |     | SampType: LCS            |             | TestCode: EPA Method 8015D: Gasoline Range |          |             |      |          |      |
| Client ID: | LCSS      |     | Batch ID: 32828          |             | RunNo: 44294                               |          |             |      |          |      |
| Prep Date: | 7/17/2017 |     | Analysis Date: 7/18/2017 |             | SeqNo: 1399600                             |          | Units: %Rec |      |          |      |
| Analyte    | Result    | PQL | SPK value                | SPK Ref Val | %REC                                       | LowLimit | HighLimit   | %RPD | RPDLimit | Qual |
| Surr: BFB  | 1100      |     | 1000                     |             | 105  | 54       | 150         |      |          |      |

|            |            |                          |           |             |  |          |             |      |          |      |
|------------|------------|--------------------------|-----------|-------------|--|----------|-------------|------|----------|------|
| Sample ID  | LCSD-32828 | SampType: LCSD           |           |             | TestCode: EPA Method 8015D: Gasoline Range |          |             |      |          |      |
| Client ID: | LCSS02     | Batch ID: 32828          |           |             | RunNo: 44294                               |          |             |      |          |      |
| Prep Date: | 7/17/2017  | Analysis Date: 7/18/2017 |           |             | SeqNo: 1399601                             |          | Units: %Rec |      |          |      |
| Analyte    | Result     | PQL                      | SPK value | SPK Ref Val | %REC                                       | LowLimit | HighLimit   | %RPD | RPDLimit | Qual |
| Surr: BFB  | 1000       |                          |           |             |  |          |             | 0    | 0        |      |

|                               |           |     |                          |             |  |          |              |      |          |      |
|-------------------------------|-----------|-----|--------------------------|-------------|--|----------|--------------|------|----------|------|
| Sample ID                     | MB-32814  |     | SampType: MBLK           |             | TestCode: EPA Method 8015D: Gasoline Range |          |              |      |          |      |
| Client ID:                    | PBS       |     | Batch ID: 32814          |             | RunNo: 44294                               |          |              |      |          |      |
| Prep Date:                    | 7/14/2017 |     | Analysis Date: 7/18/2017 |             | SeqNo: 1399613                             |          | Units: mg/Kg |      |          |      |
| Analyte                       | Result    | PQL | SPK value                | SPK Ref Val | %REC                                       | LowLimit | HighLimit    | %RPD | RPDLimit | Qual |
| Gasoline Range Organics (GRO) | ND        | 5.0 |                          |             |  |          |              |      |          |      |
| Surr: BFB                     | 980       |     | 1000                     |             | 98.2                                       | 54       | 150          |      |          |      |

|                               |           |     |                          |             |  |          |              |      |          |      |
|-------------------------------|-----------|-----|--------------------------|-------------|--|----------|--------------|------|----------|------|
| Sample ID                     | LCS-32814 |     | SampType: LCS            |             | TestCode: EPA Method 8015D: Gasoline Range |          |              |      |          |      |
| Client ID:                    | LCSS      |     | Batch ID: 32814          |             | RunNo: 44294                               |          |              |      |          |      |
| Prep Date:                    | 7/14/2017 |     | Analysis Date: 7/18/2017 |             | SeqNo: 1399614                             |          | Units: mg/Kg |      |          |      |
| Analyte                       | Result    | PQL | SPK value                | SPK Ref Val | %REC                                       | LowLimit | HighLimit    | %RPD | RPDLimit | Qual |
| Gasoline Range Organics (GRO) | 24        | 5.0 | 25.00                    | 0           | 96.6                                       | 76.4     | 125          |      |          |      |
| Surr: BFB                     | 1100      |     | 1000                     |             | 107  | 54       | 150          |      |          |      |

|                               |                |     |                          |             |  |          |              |      |          |      |
|-------------------------------|----------------|-----|--------------------------|-------------|--|----------|--------------|------|----------|------|
| Sample ID                     | 1707627-002AMS |     | SampType: MS             |             | TestCode: EPA Method 8015D: Gasoline Range |          |              |      |          |      |
| Client ID:                    | SC-2           |     | Batch ID: 32814          |             | RunNo: 44294                               |          |              |      |          |      |
| Prep Date:                    | 7/14/2017      |     | Analysis Date: 7/18/2017 |             | SeqNo: 1399617                             |          | Units: mg/Kg |      |          |      |
| Analyte                       | Result         | PQL | SPK value                | SPK Ref Val | %REC                                       | LowLimit | HighLimit    | %RPD | RPDLimit | Qual |
| Gasoline Range Organics (GRO) | 23             | 4.9 | 24.63                    | 2.963       | 80.9                                       | 77.8     | 128          |      |          |      |
| Surr: BFB                     | 1200           |     | 985.2                    |             | 126  | 54       | 150          |      |          |      |

### Qualifiers:

|   |   |
|---|---|
| * Value exceeds Maximum Contaminant Level.              | B Analyte detected in the associated Method Blank           |
| D Sample Diluted Due to Matrix                          | E Value above quantitation range                            |
| H Holding times for preparation or analysis exceeded    | J Analyte detected below quantitation limits                |
| ND Not Detected at the Reporting Limit                  | P Sample pH Not In Range                                    |
| PQL Practical Quantitative Limit                        | RL Reporting Detection Limit                                |
| S % Recovery outside of range due to dilution or matrix | W Sample container temperature is out of limit as specified |

# QC SUMMARY REPORT

Hall Environmental Analysis Laboratory, Inc.

WO#: 1707627

19-Jul-17

Client: Animas Environmental Services

Project: DJR Marus Compressor Station

|                               |                 |                |           |             |                                  |          |           |      |          |      |
|-------------------------------|-----------------|----------------|-----------|-------------|----------------------------------|----------|-----------|------|----------|------|
| Sample ID                     | 1707627-002AMSD | SampType:      | MSD       | TestCode:   | EPA Method 8015D: Gasoline Range |          |           |      |          |      |
| Client ID:                    | SC-2            | Batch ID:      | 32814     | RunNo:      | 44294                            |          |           |      |          |      |
| Prep Date:                    | 7/14/2017       | Analysis Date: | 7/18/2017 | SeqNo:      | 1399618                          | Units:   | mg/Kg     |      |          |      |
| Analyte                       | Result          | PQL            | SPK value | SPK Ref Val | %REC                             | LowLimit | HighLimit | %RPD | RPDLimit | Qual |
| Gasoline Range Organics (GRO) | 26              | 5.0            | 24.85     | 2.963       | 94.3                             | 77.8     | 128       | 14.2 | 20       |      |
| Surr: BFB                     | 1200            |                | 994.0     |             | 121                              | 54       | 150       | 0    | 0        |      |

## Qualifiers:

|   |   |
|---|---|
| * Value exceeds Maximum Contaminant Level.              | B Analyte detected in the associated Method Blank           |
| D Sample Diluted Due to Matrix                          | E Value above quantitation range                            |
| H Holding times for preparation or analysis exceeded    | J Analyte detected below quantitation limits                |
| ND Not Detected at the Reporting Limit                  | P Sample pH Not In Range                                    |
| PQL Practical Quantitative Limit                        | RL Reporting Detection Limit                                |
| S % Recovery outside of range due to dilution or matrix | W Sample container temperature is out of limit as specified |

# QC SUMMARY REPORT

## Hall Environmental Analysis Laboratory, Inc.

WO#: 1707627

19-Jul-17

Client: Animas Environmental Services

Project: DJR Marus Compressor Station

|                            |           |     |                |             |      |           |                             |      |             |      |  |
|----------------------------|-----------|-----|----------------|-------------|------|-----------|-----------------------------|------|-------------|------|--|
| Sample ID                  | MB-32828  |     | SampType:      | MBLK        |      | TestCode: | EPA Method 8021B: Volatiles |      |             |      |  |
| Client ID:                 | PBS       |     | Batch ID:      | 32828       |      | RunNo:    | 44294                       |      |             |      |  |
| Prep Date:                 | 7/17/2017 |     | Analysis Date: | 7/18/2017   |      | SeqNo:    | 1399633                     |      | Units: %Rec |      |  |
| Analyte                    | Result    | PQL | SPK value      | SPK Ref Val | %REC | LowLimit  | HighLimit                   | %RPD | RPDLimit    | Qual |  |
| Surr: 4-Bromofluorobenzene | 1.1       |     | 1.000          |             | 108  | 66.6      | 132                         |      |             |      |  |

|                            |           |     |                          |             |                                       |          |             |      |          |      |
|----------------------------|-----------|-----|--------------------------|-------------|---------------------------------------|----------|-------------|------|----------|------|
| Sample ID                  | LCS-32828 |     | SampType: LCS            |             | TestCode: EPA Method 8021B: Volatiles |          |             |      |          |      |
| Client ID:                 | LCSS      |     | Batch ID: 32828          |             | RunNo: 44294                          |          |             |      |          |      |
| Prep Date:                 | 7/17/2017 |     | Analysis Date: 7/18/2017 |             | SeqNo: 1399634                        |          | Units: %Rec |      |          |      |
| Analyte                    | Result    | PQL | SPK value                | SPK Ref Val | %REC                                  | LowLimit | HighLimit   | %RPD | RPDLimit | Qual |
| Surr: 4-Bromofluorobenzene | 1.1       |     | 1.000                    |             | 111                                   | 66.6     | 132         |      |          |      |

|                            |            |                |           |             |                             |          |           |      |          |      |
|----------------------------|------------|----------------|-----------|-------------|-----------------------------|----------|-----------|------|----------|------|
| Sample ID                  | LCSD-32828 | SampType:      | LCSD      | TestCode:   | EPA Method 8021B: Volatiles |          |           |      |          |      |
| Client ID:                 | LCSS02     | Batch ID:      | 32828     | RunNo:      | 44294                       |          |           |      |          |      |
| Prep Date:                 | 7/17/2017  | Analysis Date: | 7/18/2017 | SeqNo:      | 1399635                     | Units:   | %Rec      |      |          |      |
| Analyte                    | Result     | PQL            | SPK value | SPK Ref Val | %REC                        | LowLimit | HighLimit | %RPD | RPDLimit | Qual |
| Surr: 4-Bromofluorobenzene | 1.1        |                | 1.000     |             | 111                         | 66.6     | 132       | 0    |          |      |

|                            |           |       |                          |             |                                       |          |              |      |          |      |
|----------------------------|-----------|-------|--------------------------|-------------|---------------------------------------|----------|--------------|------|----------|------|
| Sample ID                  | MB-32814  |       | SampType: MBLK           |             | TestCode: EPA Method 8021B: Volatiles |          |              |      |          |      |
| Client ID:                 | PBS       |       | Batch ID: 32814          |             | RunNo: 44294                          |          |              |      |          |      |
| Prep Date:                 | 7/14/2017 |       | Analysis Date: 7/18/2017 |             | SeqNo: 1399647                        |          | Units: mg/Kg |      |          |      |
| Analyte                    | Result    | PQL   | SPK value                | SPK Ref Val | %REC                                  | LowLimit | HighLimit    | %RPD | RPDLimit | Qual |
| Benzene                    | ND        | 0.025 |                          |             |                                       |          |              |      |          |      |
| Toluene                    | ND        | 0.050 |                          |             |                                       |          |              |      |          |      |
| Ethylbenzene               | ND        | 0.050 |                          |             |                                       |          |              |      |          |      |
| Xylenes, Total             | ND        | 0.10  |                          |             |                                       |          |              |      |          |      |
| Surr: 4-Bromofluorobenzene | 1.1       |       | 1.000                    |             | 113                                   | 66.6     | 132          |      |          |      |

|                            |           |       |                          |             |                                       |          |              |      |          |      |
|----------------------------|-----------|-------|--------------------------|-------------|---------------------------------------|----------|--------------|------|----------|------|
| Sample ID                  | LCS-32814 |       | SampType: LCS            |             | TestCode: EPA Method 8021B: Volatiles |          |              |      |          |      |
| Client ID:                 | LCSS      |       | Batch ID: 32814          |             | RunNo: 44294                          |          |              |      |          |      |
| Prep Date:                 | 7/14/2017 |       | Analysis Date: 7/18/2017 |             | SeqNo: 1399648                        |          | Units: mg/Kg |      |          |      |
| Analyte                    | Result    | PQL   | SPK value                | SPK Ref Val | %REC                                  | LowLimit | HighLimit    | %RPD | RPDLimit | Qual |
| Benzene                    | 0.97      | 0.025 | 1.000                    | 0           | 97.5                                  | 80       | 120          |      |          |      |
| Toluene                    | 0.96      | 0.050 | 1.000                    | 0           | 96.2                                  | 80       | 120          |      |          |      |
| Ethylbenzene               | 0.98      | 0.050 | 1.000                    | 0           | 97.6                                  | 80       | 120          |      |          |      |
| Xylenes, Total             | 2.9       | 0.10  | 3.000                    | 0           | 98.2                                  | 80       | 120          |      |          |      |
| Surr: 4-Bromofluorobenzene | 1.1       |       | 1.000                    |             | 113                                   | 66.6     | 132          |      |          |      |

### Qualifiers:

\* Value exceeds Maximum Contaminant Level.  
D Sample Diluted Due to Matrix  
H Holding times for preparation or analysis exceeded  
ND Not Detected at the Reporting Limit  
PQL Practical Quantitative Limit  
S % Recovery outside of range due to dilution or matrix

B Analyte detected in the associated Method Blank  
E Value above quantitation range  
J Analyte detected below quantitation limits  
P Sample pH Not In Range  
RL Reporting Detection Limit  
W Sample container temperature is out of limit as specified

# QC SUMMARY REPORT

Hall Environmental Analysis Laboratory, Inc.

WO#: 1707627

19-Jul-17

Client: Animas Environmental Services

Project: DJR Marus Compressor Station

|                            |                |                |           |             |                             |          |           |      |          |      |
|----------------------------|----------------|----------------|-----------|-------------|-----------------------------|----------|-----------|------|----------|------|
| Sample ID                  | 1707627-001AMS | SampType:      | MS        | TestCode:   | EPA Method 8021B: Volatiles |          |           |      |          |      |
| Client ID:                 | SC-1           | Batch ID:      | 32814     | RunNo:      | 44294                       |          |           |      |          |      |
| Prep Date:                 | 7/14/2017      | Analysis Date: | 7/18/2017 | SeqNo:      | 1399650                     | Units:   | mg/Kg     |      |          |      |
| Analyte                    | Result         | PQL            | SPK value | SPK Ref Val | %REC                        | LowLimit | HighLimit | %RPD | RPDLimit | Qual |
| Benzene                    | 0.97           | 0.024          | 0.9728    | 0           | 100                         | 80.9     | 132       |      |          |      |
| Toluene                    | 0.96           | 0.049          | 0.9728    | 0.01598     | 97.3                        | 79.8     | 136       |      |          |      |
| Ethylbenzene               | 0.98           | 0.049          | 0.9728    | 0.01601     | 99.2                        | 79.4     | 140       |      |          |      |
| Xylenes, Total             | 2.9            | 0.097          | 2.918     | 0.01861     | 100                         | 78.5     | 142       |      |          |      |
| Surr: 4-Bromofluorobenzene | 1.1            |                | 0.9728    |             | 116                         | 66.6     | 132       |      |          |      |

|                            |                 |                |           |             |                             |          |           |       |          |      |
|----------------------------|-----------------|----------------|-----------|-------------|-----------------------------|----------|-----------|-------|----------|------|
| Sample ID                  | 1707627-001AMSD | SampType:      | MSD       | TestCode:   | EPA Method 8021B: Volatiles |          |           |       |          |      |
| Client ID:                 | SC-1            | Batch ID:      | 32814     | RunNo:      | 44294                       |          |           |       |          |      |
| Prep Date:                 | 7/14/2017       | Analysis Date: | 7/18/2017 | SeqNo:      | 1399651                     | Units:   | mg/Kg     |       |          |      |
| Analyte                    | Result          | PQL            | SPK value | SPK Ref Val | %REC                        | LowLimit | HighLimit | %RPD  | RPDLimit | Qual |
| Benzene                    | 0.97            | 0.024          | 0.9597    | 0           | 101                         | 80.9     | 132       | 0.874 | 20       |      |
| Toluene                    | 0.94            | 0.048          | 0.9597    | 0.01598     | 96.8                        | 79.8     | 136       | 1.87  | 20       |      |
| Ethylbenzene               | 0.96            | 0.048          | 0.9597    | 0.01601     | 98.0                        | 79.4     | 140       | 2.56  | 20       |      |
| Xylenes, Total             | 2.9             | 0.096          | 2.879     | 0.01861     | 98.6                        | 78.5     | 142       | 3.14  | 20       |      |
| Surr: 4-Bromofluorobenzene | 1.1             |                | 0.9597    |             | 115                         | 66.6     | 132       | 0     | 0        |      |

## Qualifiers:

- |   |   |
|---|---|
| * Value exceeds Maximum Contaminant Level.              | B Analyte detected in the associated Method Blank           |
| D Sample Diluted Due to Matrix                          | E Value above quantitation range                            |
| H Holding times for preparation or analysis exceeded    | J Analyte detected below quantitation limits                |
| ND Not Detected at the Reporting Limit                  | P Sample pH Not In Range                                    |
| PQL Practical Quantitative Limit                        | RL Reporting Detection Limit                                |
| S % Recovery outside of range due to dilution or matrix | W Sample container temperature is out of limit as specified |

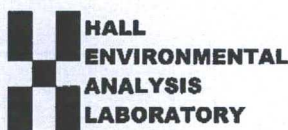

Hall Environmental Analysis Laboratory  
4901 Hawkins NE  
Albuquerque, NM 87109  
TEL: 505-345-3975 FAX: 505-345-4107  
Website: www.hallenvironmental.com

## Sample Log-In Check List

Client Name: Animas Environmental

Work Order Number: 1707627

ReptNo: 1

Received By: Anne Thorne

7/13/2017 7:10:00 AM

Completed By: Erin Melendrez

7/13/2017 11:53:15 AM

Reviewed By:

ENM/My

7/14/17

*Anne Thorne*  
*Erin Melendrez*

### Chain of Custody

1. Custody seals intact on sample bottles? Yes ☐ No ☐ Not Present ☒
2. Is Chain of Custody complete? Yes ☒ No ☐ Not Present ☐
3. How was the sample delivered? Courier

### Log In

4. Was an attempt made to cool the samples? Yes ☒ No ☐ NA ☐
5. Were all samples received at a temperature of  $>0^{\circ}\text{C}$  to  $6.0^{\circ}\text{C}$ ? Yes ☒ No ☐ NA ☐
6. Sample(s) in proper container(s)? Yes ☒ No ☐
7. Sufficient sample volume for indicated test(s)? Yes ☒ No ☐
8. Are samples (except VOA and ONG) properly preserved? Yes ☒ No ☐
9. Was preservative added to bottles? Yes ☐ No ☒ NA ☐
10. VOA vials have zero headspace? Yes ☐ No ☐ No VOA Vials ☒
11. Were any sample containers received broken? Yes ☐ No ☒
12. Does paperwork match bottle labels?  
(Note discrepancies on chain of custody) Yes ☒ No ☐
13. Are matrices correctly identified on Chain of Custody? Yes ☒ No ☐
14. Is it clear what analyses were requested? Yes ☒ No ☐
15. Were all holding times able to be met?  
(If no, notify customer for authorization.) Yes ☒ No ☐
- # of preserved bottles checked for pH: \_\_\_\_\_  
( $<2$  or  $>12$  unless noted)

Adjusted? \_\_\_\_\_

Checked by: \_\_\_\_\_

### Special Handling (If applicable)

16. Was client notified of all discrepancies with this order? Yes ☐ No ☐ NA ☒

|                      |  |       |   |
|----------------------|--|-------|---|
| Person Notified:     |  | Date: |   |
| By Whom:             |  | Via:  | <input type="checkbox"/> eMail <input type="checkbox"/> Phone <input type="checkbox"/> Fax <input type="checkbox"/> In Person |
| Regarding:           |  |       |   |
| Client Instructions: |  |       |   |

17. Additional remarks:

### 18. Cooler Information

| Cooler No | Temp °C | Condition | Seal Intact | Seal No | Seal Date | Signed By |
|-----------|---------|-----------|-------------|---------|-----------|-----------|
| 1         | 2.5     | Good      | Yes         |         |           |           |

# Chain-of-Custody Record

Client: Animas Environmental Services, LLC

Turn-Around Time:

☒ Standard ☐ Rush

Mailing Address: 604 W Pinon St.  
Farmington, NM 87401

Project Name:  
DJR Marus Compressor Station

Phone #: 505-564-2281

Project #:

Email or Fax#: emcnally@animasenvironmental.co

Project Manager:

QA/QC Package:

E. McNally

☒ Standard ☐ Level 4 (Full Validation)

Accreditation:

☐ NELAP ☐ Other

Sampler: SG

On Ice: ☒ Yes ☐ No

☐ EDD (Type)

Sample Temperature: 3.5 - CF - 1.0 = 2.5



**HALL ENVIRONMENTAL  
ANALYSIS LABORATORY**

www.hallenvironmental.com

4901 Hawkins NE - Albuquerque, NM 87109

Tel. 505-345-3975 Fax 505-345-4107

## Analysis Request

| Date    | Time  | Matrix | Sample Request ID | Container Type and # | Preservative Type | HEAL No. | BTEX - 8021B | TPH (GRO/DRO/MRO) - 8015 | Air Bubbles (Y or N) |
|---------|-------|--------|-------------------|----------------------|-------------------|----------|--------------|--------------------------|----------------------|
| 7/11/17 | 11:01 | SOIL   | SC-1              | 1 - 4 oz jar         | cool              | -001     | X            | X                        |                      |
| 7/11/17 | 11:05 | SOIL   | SC-2              | 1 - 4 oz jar         | cool              | -002     | X            | X                        |                      |
| 7/11/17 | 11:08 | SOIL   | SC-3              | 1 - 4 oz jar         | cool              | -003     | X            | X                        |                      |
| 7/11/17 | 11:12 | SOIL   | SC-4              | 1 - 4 oz jar         | cool              | -004     | X            | X                        |                      |
| 7/11/17 | 11:16 | SOIL   | SC-5              | 1 - 4 oz jar         | cool              | -005     | X            | X                        |                      |
| 7/11/17 | 11:20 | SOIL   | SC-6              | 1 - 4 oz jar         | cool              | -006     | X            | X                        |                      |
| 7/11/17 | 11:43 | SOIL   | SC-7              | 1 - 4 oz jar         | cool              | -007     | X            | X                        |                      |
| 7/11/17 | 11:46 | SOIL   | SC-8              | 1 - 4 oz jar         | cool              | -008     | X            | X                        |                      |
| 7/11/17 | 11:50 | SOIL   | SC-9              | 1 - 4 oz jar         | cool              | -009     | X            | X                        |                      |

Date: 7/12/17 Time: 11:22 Relinquished by: [Signature] Received by: [Signature] Date: 7/12/17 Time: 11:22

Date: 7/12/17 Time: 18:04 Relinquished by: [Signature] Received by: [Signature] Date: 07/13/17 Time: 07:00

Remarks: Bill to AES

Please call with any questions

If necessary, samples submitted to Hall Environmental may be subcontracted to other accredited laboratories. This serves as notice of this possibility. Any sub-contracted data will be clearly notated on the analytical report.

| Laboratory Analytical Results |         |            |                 |                    |                   |                   |                   |
|-------------------------------|---------|------------|-----------------|--------------------|-------------------|-------------------|-------------------|
| Sample ID                     | Date    | Depth (ft) | Benzene (mg/kg) | Total BTEX (mg/kg) | TPH - GRO (mg/kg) | TPH - DRO (mg/kg) | TPH - MRO (mg/kg) |
| NMOCD ACTION LEVEL            |         |            | 10              | 50                 | 5,000             |                   |                   |
| SC-1                          | 7/11/17 | 0 to 9     | <0.024          | <0.216             | <4.8              | 72                | 60                |
| SC-2                          | 7/11/17 | 0 to 9     | <0.024          | <0.217             | <4.8              | 200               | 180               |
| SC-3                          | 7/11/17 | 0 to 9     | <0.024          | <0.220             | <4.9              | <10               | <50               |
| SC-4                          | 7/11/17 | 0 to 9     | <0.024          | <0.216             | <4.8              | 20                | <47               |
| SC-5                          | 7/11/17 | 0 to 9     | <0.024          | <0.213             | <4.7              | <9.9              | <50               |
| SC-6                          | 7/11/17 | 9          | <0.023          | <0.210             | <4.7              | <10               | <50               |
| SC-7                          | 7/11/17 | 0 to 4.5   | <0.024          | <0.219             | <4.9              | 33                | <48               |
| SC-8                          | 7/11/17 | 0 to 4.5   | <0.024          | <0.246             | <4.8              | <9.5              | <48               |
| SC-9                          | 7/11/17 | 4.5        | <0.12           | <1.11              | 30                | 510               | 400               |

ALL SOIL COMPOSITE SAMPLES WERE ANALYZED PER USEPA METHOD 8021B AND 8015D.

| LEGEND  |                            |
|---|----------------------------|
|  | SAMPLE LOCATIONS           |
|  | SECONDARY CONTAINMENT BERM |
|  | FENCE                      |

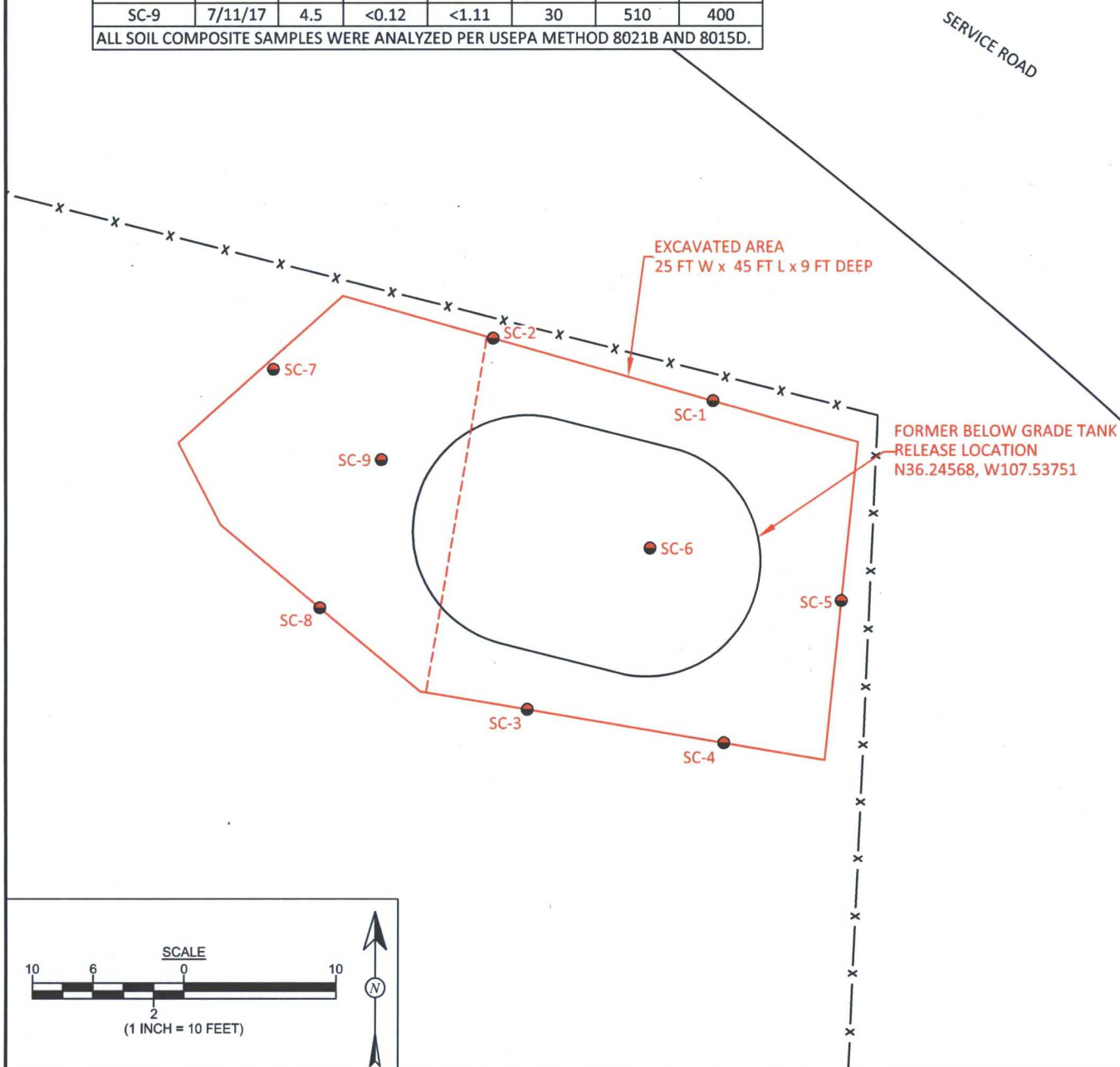

**FIGURE 3**

**FINAL EXCAVATION SAMPLE  
LOCATIONS AND RESULTS  
JULY 2017**

DJ RECSOURCES  
MARCUS COMPRESSOR STATION  
NE $\frac{1}{4}$  NE $\frac{1}{4}$ , SECTION 11, T23N, R7W  
RIO ARriba COUNTY, NEW MEXICO  
N36.24546, W107.53805



animas  
environmental  
services  
Farmington, NM • Durango, CO  
animasenvironmental.com

**DRAWN BY:**  
S. Glasses

**DATE DRAWN:**  
July 12, 2017

**REVISIONS BY:**  
C. Lameman

**DATE REVISED:**  
July 20, 2017

**CHECKED BY:**  
E. McNally

**DATE CHECKED:**  
July 20, 2017

**APPROVED BY:**  
E. McNally

**DATE APPROVED:**  
July 20, 2017

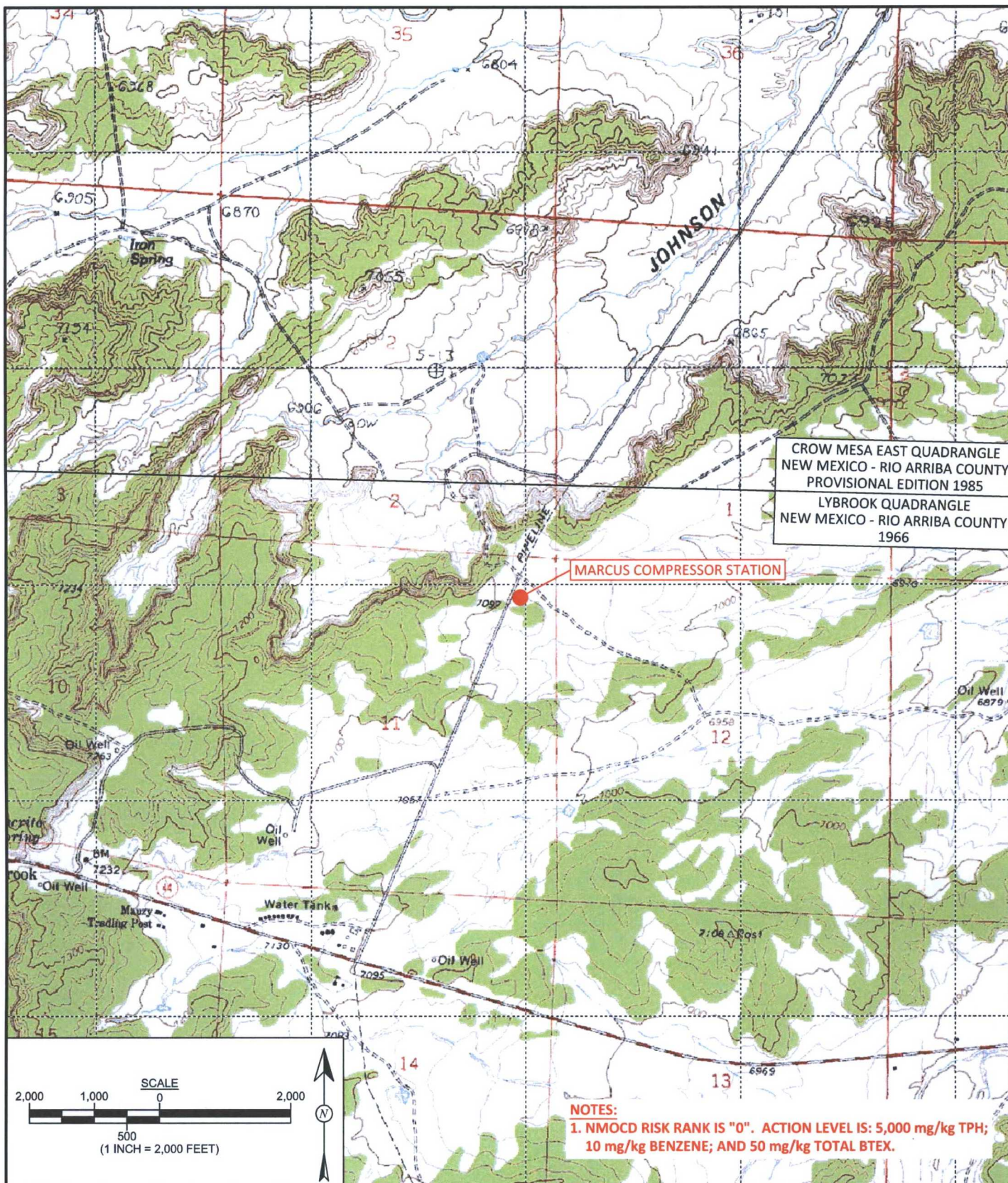

animas  
environmental  
services  
Farmington, NM • Durango, CO  
animasenvironmental.com

|                             |                                 |
|-----------------------------|---------------------------------|
| DRAWN BY:<br>C. Lameman     | DATE DRAWN:<br>July 5, 2017     |
| REVISIONS BY:<br>C. Lameman | DATE REVISED:<br>July 20, 2017  |
| CHECKED BY:<br>E. McNally   | DATE CHECKED:<br>July 20, 2017  |
| APPROVED BY:<br>E. McNally  | DATE APPROVED:<br>July 20, 2017 |

## FIGURE 1

**TOPOGRAPHIC SITE LOCATION MAP**  
DJ RESOURCES  
MARCUS COMPRESSOR STATION  
NE¼ NE¼, SECTION 11, T23N, R7W  
RIO ARRIBA COUNTY, NEW MEXICO  
N36.24546, W107.53805





