

DHC 11/13/99

November 13, 1998

DEC 24 1998

GOV-STATE AND LOCAL GOVERNMENTS

EXCEPTION to NMOCD Rule 303(A)

Application to DHC

Teague Tubb North (Assoc.) and Teague Drinkard-Abo North Assoc.

F.B. Davis #1

Unit Letter A, Sec.8, T23S, R37E

Lea County, NM

2176

State of New Mexico
Energy and Minerals Department
Oil Conservation Commission
2040 South Pacheco
Santa Fe, NM 87505

Attention: Mr. Ben Stone

Texaco Exploration and Production Inc., respectfully requests approval to downhole commingle the Teague Tubb North (Assoc.) and the Teague Drinkard-Abo North (Assoc.) pool within the subject wellbore. Currently the well is producing in the Tubb formation and the Drinkard and Abo are temporarily abandoned with a CIBP at 6340'. Offset operators have been notified by a copy of this application. The royalty is common in all zones.

The proposed downhole commingling will provide a more economical means of production. It will allow complete development of the productive capacity on the subject lease by allowing both intervals to be artificially lifted simultaneously. This will extend the productive life of both completions, thereby preventing waste.

The subject well meets all of the requirements as set forth by rule 303 (C). In addition, it should be noted that all produced fluids have entered a common production facility with no fluid compatibility problems.

It is requested that the allocation of production for each zone be based on tests obtained from the Teague Tubb Pool before the DHC, with any additional production after the DHC be allocated to the Teague Drinkard- Abo Pool.

If you have any questions concerning this application, please contact Mike Quintana at (505) 397-0451 or Denise Wann at (505)397-0425.

Yours truly,

A handwritten signature in black ink, appearing to read "Denise Wann". The signature is fluid and cursive, with a large initial "D" and a stylized "W".

Denise Wann
Production Engineer
Eunice FMT

DISTRICT I

P.O. Box 1980, Hobbs, NM 88241-1980

DISTRICT II

P.O. Box Drawer DD, Artesia, NM 88211-0719

DISTRICT III

1000 Rio Brazos Rd., Aztec, NM 87410

DISTRICT IV

P.O. Box 2088, Santa Fe, NM 87504-2088

State of New Mexico

Energy, Minerals and Natural Resources Department

OIL CONSERVATION DIVISION

P.O. Box 2088

Santa Fe, New Mexico 87504-2088

Form C-102

Revised February 10, 1994

Instructions on back

Submit to Appropriate District Office

State Lease - 4 Copies

Fee Lease - 3 Copies

☐ AMENDED REPORT

WELL LOCATION AND ACREAGE DEDICATION PLAT

¹ API Number 30 025 32226	² Pool Code 96315	³ Pool Name North Teague Tubb - Associated
⁴ Property Code 13195	⁵ Property Name DAVIS, F. B.	⁶ Well No. 1
⁷ OGRID Number 022351	⁸ Operator Name TEXACO EXPLORATION & PRODUCTION INC.	⁹ Elevation GR-3323', KB-3337'

¹⁰ Surface Location

Ul or lot no.	Section	Township	Range	Lot.Idn	Feet From The	North/South Line	Feet From The	East/West Line	County
A	8	23S	37E		660	North	500	East	Lea

¹¹ Bottom Hole Location If Different From Surface

Ul or lot no.	Section	Township	Range	Lot.Idn	Feet From The	North/South Line	Feet From The	East/West Line	County

¹² Dedicated Acres 40	¹³ Joint or Infill No	¹⁴ Consolidation Code	¹⁵ Order No.
-------------------------------------	-------------------------------------	----------------------------------	-------------------------

NO ALLOWABLE WILL BE ASSIGNED TO THIS COMPLETION UNTIL ALL INTERESTS HAVE BEEN CONSOLIDATED
OR A NON-STANDARD UNIT HAS BEEN APPROVED BY THE DIVISION

¹⁶	17 OPERATOR CERTIFICATION I hereby certify that the information contained herein is true and complete to the best of my knowledge and belief
	Signature <i>M. Quintana</i>
	Printed Name Mike Quintana
	Position Engineering Assistant
	Date 11/13/98
	18 SURVEYOR CERTIFICATION I hereby certify that the well location shown on this plat was plotted from field notes of actual surveys made by me or under my supervision, and that the same is true and correct to the best of my knowledge and belief.
	Date Surveyed
	Signature & Seal of Professional Surveyor
	Certificate No.

DISTRICT I

P.O. Box 1980, Hobbs, NM 88241-1980

DISTRICT II

P.O. Box Drawer DD, Artesia, NM 88211-0719

DISTRICT III

1000 Rio Brazos Rd., Aztec, NM 87410

DISTRICT IV

P.O. Box 2088, Santa Fe, NM 87504-2088

State of New Mexico**Energy, Minerals and Natural Resources Department****OIL CONSERVATION DIVISION**

P.O. Box 2088

Santa Fe, New Mexico 87504-2088

Form C-102

Revised February 10, 1994

Instructions on back

Submit to Appropriate District Office

State Lease - 4 Copies

Fee Lease - 3 Copies

☐ AMENDED REPORT**WELL LOCATION AND ACREAGE DEDICATION PLAT**

¹ API Number 30 025 32226	² Pool Code 96313	³ Pool Name Teague Drinkard Abo North Associated
⁴ Property Code 13195	⁵ Property Name DAVIS, F. B.	⁶ Well No. 1
⁷ OGRID Number 022351	⁸ Operator Name TEXACO EXPLORATION & PRODUCTION INC.	⁹ Elevation GR-3323', KB-3337'

¹⁰ Surface Location

Ul or lot no.	Section	Township	Range	Lot.Idn	Feet From The	North/South Line	Feet From The	East/West Line	County
A	8	23-S	37-E		660	NORTH	500	EAST	LEA

¹¹ Bottom Hole Location If Different From Surface

Ul or lot no.	Section	Township	Range	Lot.Idn	Feet From The	North/South Line	Feet From The	East/West Line	County

¹² Dedicated Acres 40	¹³ Joint or Infill No	¹⁴ Consolidation Code	¹⁵ Order No.
-------------------------------------	-------------------------------------	----------------------------------	-------------------------

NO ALLOWABLE WILL BE ASSIGNED TO THIS COMPLETION UNTIL ALL INTERESTS HAVE BEEN CONSOLIDATED
OR A NON-STANDARD UNIT HAS BEEN APPROVED BY THE DIVISION

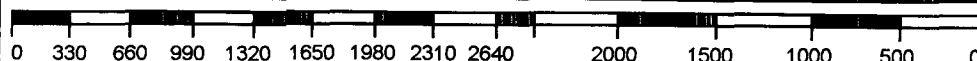
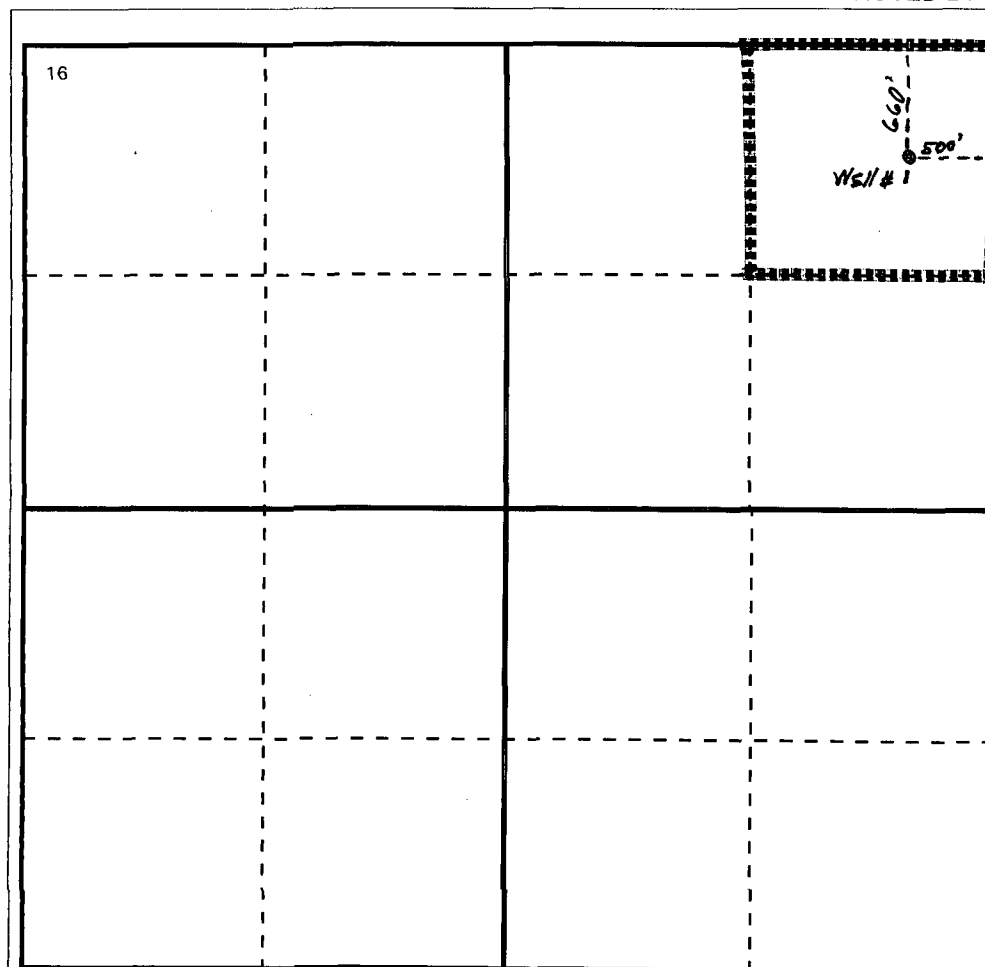
**¹⁷ OPERATOR CERTIFICATION**

I hereby certify that the information
contained herein is true and complete to the
best of my knowledge and belief

Signature

Printed Name

Mike Quintana

Position

Engineering Assistant

Date

11/13/98

¹⁸ SURVEYOR CERTIFICATION

I hereby certify that the well location shown
on this plat was plotted from field notes of
actual surveys made by me or under my
supervision, and that the same is true and
correct to the best of my knowledge and
belief.

Date Surveyed

Signature & Seal of

Professional Surveyor

Certificate No.

DAVIS, F. B. 1 TEAGUE TUBB, NORTH (ASSOC.)

TEPI NUL

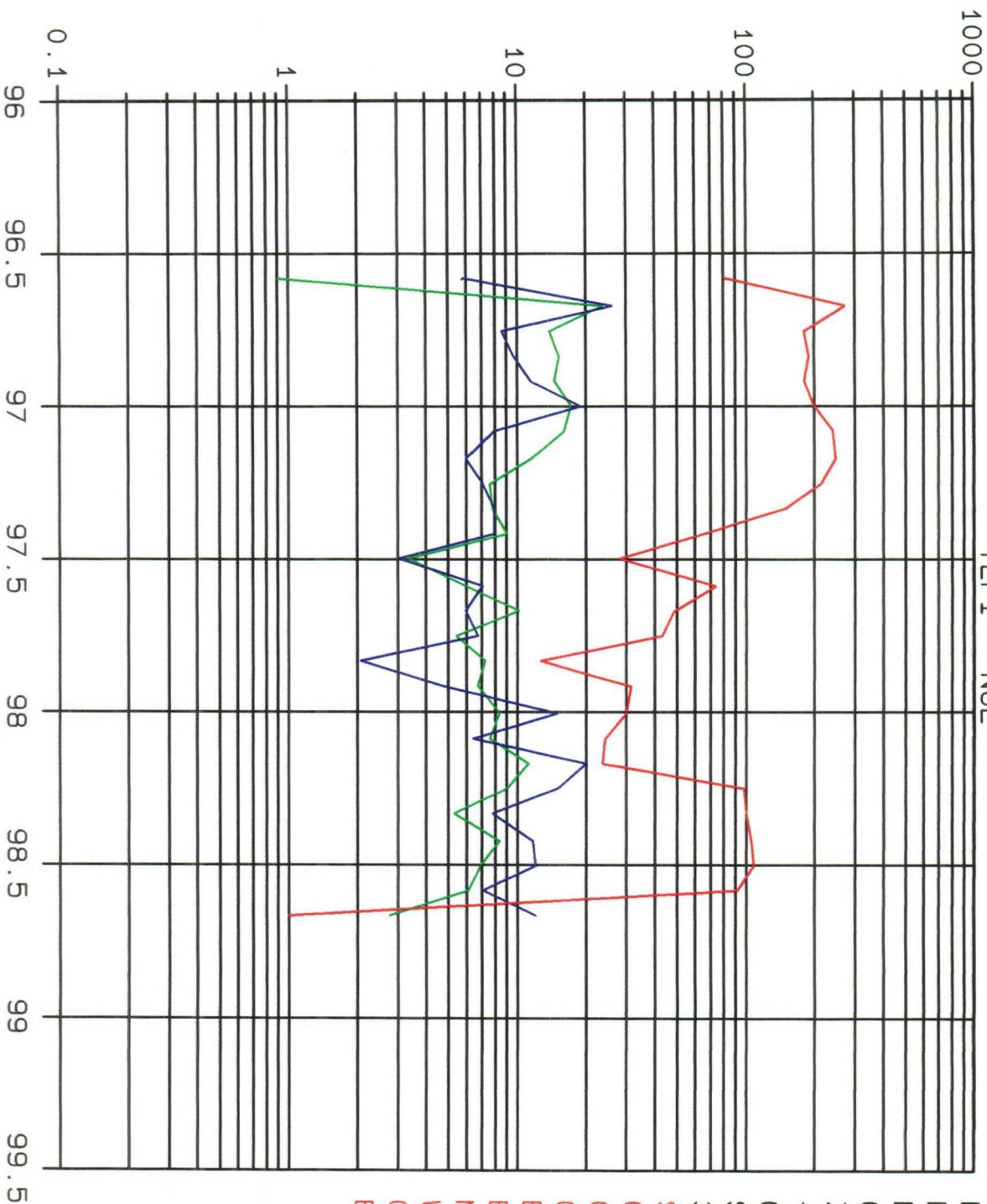

YEARS

LEASE DATA
 LSE 013195
 FLD 96315
 OPER TEPI
 ZONE NUL
 --
 COUNTY 025
 STATE 30
 30025322260004
 STATUS 8-98
 CO 7 MBO
 CG 86 MCF
 CW 8 MBW
 BOPD 3
 BWPD 12
 MCFPD 0
 WELLS 1
 CI 0 MBWI
 BWIPD 0

DAVIS, F. B. 1 TEAGUE DRINKARD-ABO, NORTH (ASSOC.)

TEPI NUL

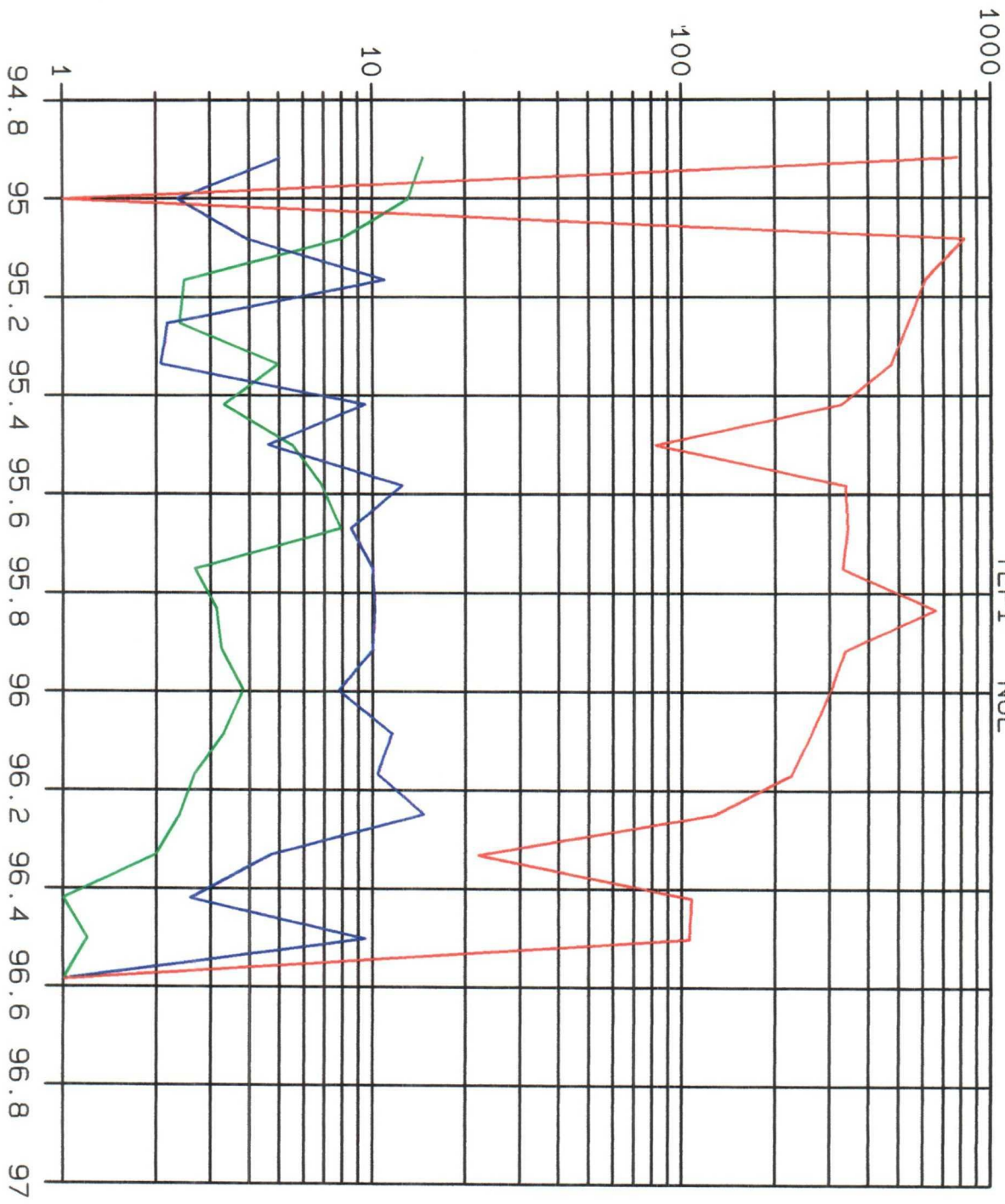

BOPD BWPD MCFPD

YEARS

LEASE DATA
 LSE 013195
 FLD 96313
 OPER TEPI
 ZONE NUL
 --
 COUNTY 025
 STATE 30
 30025322260003
 STATUS 7-96
 CO 3 MBO
 CG 206 MMCF
 CW 5 MBW
 BOPD 0
 BWPD 0
 MCFPD 0
 WELLS 1
 CI 0 MBWI
 BWIPD 0

EXHIBIT "B" - CASE NO. 11353, ORDER NO. R-10470-A

DISTRICT 1

P.O. Box 1980, Hobbs, NM 88240

DISTRICT II

811 South First St., Artesia, NM 88210

DISTRICT III

1000 Rio Brazos Rd, Aztec, NM 87410

**State of New Mexico
Energy, Minerals and Natural-Resources Department**

OIL CONSERVATION DIVISION

**2040 S. Pacheco
Santa Fe, New Mexico 87505-6429**

APPLICATION FOR DOWNHOLE COMMINGLING

Form C-107-A
New 3-12-96

APPROVAL PROCESS:

Administrative Hearing

EXISTING WELLBORE

☒ YES NO

Texaco Exploration & Producing Inc.	205 East Bender	Hobbs, New Mexico 88240
Operator	Address	

F.B. Davis	1	A-8-23S-37E	Lea
Lease	Well No.	Unit Ltr. - Sec - Tws - Rge	County

Spacing Unit Lease Types: (check 1 or more)

OGRID NO. 022351 Property Code 13195 API NO. 30-025-32226 Federal _____, State _____, (and/or) Fee X

The following facts are submitted in support of downhole commingling:	Lower Zone	Intermediate Zone	Upper Zone
1. Pool Name and Pool Code	Teague Drinkard-Abo, North Assoc. 96313		Teague Tubb, North Assoc. 96315
2. Top And Bottom of Pay Section (Perforations)	6357'-6437'		6086'-6286'
3. Type of production (Oil or Gas)	Oil		Oil
4. Method of Production (Flowing or Artificial Lift)	Rod-pump		Rod-pump
5. Bottomhole Pressure Oil Zones - Artificial Lift: Estimated Current	(Current) a. 200 psi (est. from FBDavis #5)	a.	a. 250 psi
Gas & Oil - Flowing: Measured Current	(Original) b.	b.	b.
All Gas Zones: Estimated Or Measured Original			
6. Oil Gravity (* API) or Gas BTU Content	40.5		39.7
7. Producing or Shut-In? Production Marginal? (yes or no)	Shut in Yes		Producing Yes
* If Shut-In, give date and oil/gas/ water rates of last production Note: For new zones with no production history, applicant shall be required to attach production estimates and supporting data	Date: 7/96 Rates: 1 oil 10 wtr 100 gas		
* If Producing, give date and oil/gas/ water rates of recent test (within 60 days)	Date: Rates:		10/98 4 oil, 7 wtr, 78 gas
8. Fixed Percentage Allocation Formula -% for each zone	Oil: Gas:	Oil: Gas: % %	Oil: Gas: % %

9. If allocation Formula is based upon something other than current or past production, or is based upon some other method, submit attachments with supporting data and/or explaining method and providing rate projections or other required data.

10. Are all working, overriding, and royalty interests identical in all commingled zones? X Yes No

If not, have all working, overriding, and royalty interests been notified by certified mail? Yes No

Have all offset operators been given written notice of the proposed downhole commingling?	X	Yes	No
---	---	-----	----

11. Will cross-flow occur? Yes X No If yes, are fluids compatible, will the Formations not be damaged, will any cross-flowed production be recovered, and will the allocation formula be reliable. Yes No (If No, attach explanation)

12. Are all produced fluids from all commingled zones compatible with other? X Yes No

13. Will the value of production be decreased by commingling? Yes X No (If Yes, attach explanation)

14. If this well is on, or communitized with, state or federal lands, either the Commissioner of Public Land or the

United States Bureau of Land Management has been notified in writing of this application. ☒ Yes ☐ No

15. NMOCD Reference Cases for Rule 303(C) Exceptions: ORDER NO(S).

16. ATTACHMENTS:

- * C-102 for each zone to be commingled showing its spacing unit and acreage dedication.
- * Production curve for each zone for at least one year. (If not available, attach explanation.)
- * For zones with no production history, estimated production rates and supporting data.
- * Notification list of all offset operators.
- * Notification list of working, overriding, and royalty interests for uncommon interest cases.
- * Any additional statements, data or documents required to support commingling.

I hereby certify that the information above is true and complete to the best of my knowledge and belief

SIGNATURE Dennis Wann TITLE Engineer DATE 11-13-98

TYPE OR PRINT NAME Denise Wann TELEPHONE NO. (505) 397-0425

November 13, 1998

Texaco Exploration and Production
205 E. Bender
Hobbs, NM 88240

Amerada Hess Corporation
1201 Louisiana St. 700
Houston, TX 77022

Re: F.B. Davis Well No. 1
Unit A, Section 8, Township 23South, Range 37 East, NMPM, Lea County, NM
North Teague Tubb Associated (Pool I.D.N. 96315) and North Teague Drinkard-
Abo (Pool I.D.N. 96313) Pools

Dear Sir,

Please be advised that Texaco Exploration and Production is seeking approval from the New Mexico Oil Conservation Division to DHC the F.B. Davis #1 in the North Teague Tubb and North Teague Drinkard-Abo Pools.

Sincerely,

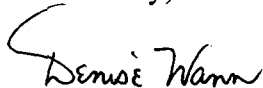
A handwritten signature in cursive script that reads "Denise Wann".

Denise Wann
Production Engineer
Eunice FMT

November 13, 1998

Texaco Exploration and Production
205 E. Bender
Hobbs, NM 88240

Arco Permain
P.O. Box 16101
Midland, Tx 79702

Re: F.B. Davis Well No. 1
Unit A, Section 8, Township 23 South, Range 37 East, NMPM, Lea County, NM
North Teague Tubb Associated (Pool I.D.N. 96315) and North Teague Drinkard-
Abo (Pool I.D.N. 96313) Pools

Dear Sir,

Please be advised that Texaco Exploration and Production is seeking approval from the New Mexico Oil Conservation Division to DHC the F.B. Davis #1 in the North Teague Tubb and North Teague Drinkard-Abo Pools.

Sincerely,

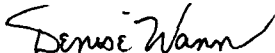
A handwritten signature in cursive script that reads "Denise Wann".

Denise Wann
Production Engineer
Eunice FMT