

DATE IN 2/10/99	SUSPENSE 3/2/99	ENGINEER DC	LOGGED BY W	TYPE DHC
-----------------	-----------------	-------------	-------------	----------

ABOVE THIS LINE FOR DIVISION USE ONLY

NEW MEXICO OIL CONSERVATION DIVISION  
- Engineering Bureau -  
2040 South Pacheco, Santa Fe, NM 87505



2227

**ADMINISTRATIVE APPLICATION COVERSHEET**

THIS COVERSHEET IS MANDATORY FOR ALL ADMINISTRATIVE APPLICATION FOR EXCEPTIONS TO DIVISION RULES AND REGULATIONS WHICH REQUIRE PROCESSING AT THE DIVISION LEVEL IN SANTA FE

**Application Acronyms:**

[NSP-Non-Standard Proration Unit] [NSL-Non-Standard Location]  
[DD-Directional Drilling] [SD-Simultaneous Dedication]  
[DHC-Downhole Commingling] [CTB-Lease Commingling] [PLC-Pool/Lease Commingling]  
[PC-Pool Commingling] [OLS - Off-Lease Storage] [OLM-Off-Lease Measurement]  
[WFX-Waterflood Expansion] [PMX-Pressure Maintenance Expansion]  
[SWD-Salt Water Disposal] [IPI-Injection Pressure Increase]  
[EOR-Qualified Enhanced Oil Recovery Certification] [PPR-Positive Production Response]

[1] **TYPE OF APPLICATION - Check Those Which Apply for [A]**

[A] Location - Spacing Unit - Directional Drilling

☐ NSL ☐ NSP ☐ DD ☐ SD

Check One Only for [B] or [C]

[B] Commingling - Storage - Measurement

☒ DHC ☐ CTB ☐ PLC ☐ PC ☐ OLS ☐ OLM

[C] Injection - Disposal - Pressure Increase - Enhanced Oil Recovery

☐ WFX ☐ PMX ☐ SWD ☐ IPI ☐ EOR ☐ PPR

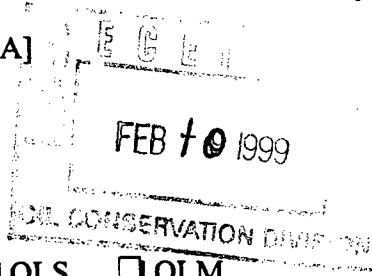

[2] **NOTIFICATION REQUIRED TO: - Check Those Which Apply, or ☐ Does Not Apply**

[A] ☒ Working, Royalty or Overriding Royalty Interest Owners

[B] ☐ Offset Operators, Leaseholders or Surface Owner

[C] ☐ Application is One Which Requires Published Legal Notice

[D] ☒ Notification and/or Concurrent Approval by BLM or SLO

U.S. Bureau of Land Management - Commissioner of Public Lands, State Land Office

[E] ☐ For all of the above, Proof of Notification or Publication is Attached, and/or,

[F] ☐ Waivers are Attached

[3] **INFORMATION / DATA SUBMITTED IS COMPLETE - Certification**

I hereby certify that I, or personnel under my supervision, have read and complied with all applicable Rules and Regulations of the Oil Conservation Division. Further, I assert that the attached application for administrative approval is accurate and complete to the best of my knowledge and where applicable, verify that all interest (WI, RI, ORRI) is common. I understand that any omission of data (including API numbers, pool codes, etc.), pertinent information and any required notification is cause to have the application package returned with no action taken.

Note: Statement must be completed by an individual with managerial and/or supervisory capacity.

Print or Type Name

Signature

Title

Date

DISTRICT I  
P.O. Box 1980, Hobbs, NM 88241-1980  
DISTRICT II  
811 South First St., Artesia, NM 88210-2835  
DISTRICT III  
1000 Rio Brazos Rd, Aztec, NM 87410-1693

State of New Mexico  
Energy, Minerals and Natural Resources Department  
OIL CONSERVATION DIVISION  
2040 S. Pacheco  
Santa Fe, New Mexico 87505-6429

Form C-107-A  
New 3-12-96

APPROVAL PROCESS :  
\_X\_ Administrative \_\_\_ Hearing  
EXISTING WELLBORE  
\_\_\_ YES \_\_\_X\_ NO

APPLICATION FOR DOWNHOLE COMMINGLING

Burlington Resources Oil & Gas Company

PO Box 4289, Farmington, NM 87499

Operator Address  
San Juan 27-4 Unit 52M 29-27N-04W Rio Arriba  
Lease Well No. Unit Ltr. - Sec - Twp - Rge County  
Spacing Unit Lease Types: (check 1 or more)  
OGRID NO. 14538 Property Code 7452 API NO. 30-039-not assigned Federal x State (and/or) Fee

The following facts are submitted in support of downhole commingling:	Upper Zone	Intermediate Zone	Lower Zone
1. Pool Name and Pool Code	Blanco Mesaverde - 72319		Basin Dakota - 71599
2. Top and Bottom of Pay Section (Perforations)	will be supplied upon completion		will be supplied upon completion
3. Type of production (Oil or Gas)	gas		gas
4. Method of Production (Flowing or Artificial Lift)	flowing		flowing
5. Bottomhole Pressure Oil Zones - Artificial Lift: Estimated Current Gas & Oil - Flowing: Measured Current All Gas Zones: Estimated or Measured Original	(Current) a. 617 psi (see attachment) (Original) b. 1303 psi (see attachment)	a.  b.	a. 1243 psi (see attachment)  b. 3173 psi (see attachment)
6. Oil Gravity (API) or Gas BTU Content	BTU 1159		BTU 1219
7. Producing or Shut-In?	shut in		shut in
Production Marginal? (yes or no)	no		yes
* If Shut-In and oil/gas/water rates of last production <small>Note: For new zones with no production history, applicant shall be required to attach production estimates and supporting data.</small>	Date: n/a Rates:	Date: Rates:	Date: n/a Rates:
* If Producing, give data and oil/gas/water water of recent test (within 60 days)	Date: n/a Rates:	Date: Rates:	Date: n/a Rates:
8. Fixed Percentage Allocation Formula -% for each zone (total of %'s to equal 100%)	Oil: % Gas: % will be supplied upon completion	Oil: % Gas: %	Oil: % Gas: % will be supplied upon completion

9. If allocation formula is based upon something other than current or past production, or is based upon some other method, submit attachments with supporting data and/or explaining method and providing rate projections or other required data.
10. Are all working, overriding, and royalty interests identical in all commingled zones? Yes \_x\_ No  
If not, have all working, overriding, and royalty interests been notified by certified mail? \_x\_ Yes \_\_\_ No  
Have all offset operators been given written notice of the proposed downhole commingling? \_x\_ Yes \_\_\_ No
11. Will cross-flow occur? \_x\_ Yes \_\_\_ No If yes, are fluids compatible, will the formations not be damaged, will any cross-flowed production be recovered, and will the allocation formula be reliable. \_x\_ Yes \_\_\_ No (If No, attach explanation)
12. Are all produced fluids from all commingled zones compatible with each other? \_\_\_x\_ Yes \_\_\_ No
13. Will the value of production be decreased by commingling? \_\_\_ Yes \_X\_ No (If Yes, attach explanation)
14. If this well is on, or communitized with, state or federal lands, either the Commissioner of Public Lands or the United States Bureau of Land Management has been notified in writing of this application. \_X\_ Yes \_\_\_ No
15. NMOCD Reference Cases for Rule 303(D) Exceptions: ORDER NO(S). \_\_\_ attached
16. ATTACHMENTS:  
\* C-102 for each zone to be commingled showing its spacing unit and acreage dedication.  
\* Production curve for each zone for at least one year. (If not available, attach explanation.)  
\* For zones with no production history, estimated production rates and supporting data.  
\* Data to support allocation method or formula.  
\* Notification list of all offset operators.  
\* Notification list of working, overriding, and royalty interests for uncommon interest cases.  
\* Any additional statements, data, or documents required to support commingling.

I hereby certify that the information above is true and complete to the best of my knowledge and belief.

SIGNATURE *Wayne Fletcher* TITLE: Production Engineer DATE: 02-04-99

TYPE OR PRINT NAME: Wayne Fletcher TELEPHONE NO.: (505) 326-9700

District I  
PO Box 1980, Hobbs NM 88241-1980  
District II  
PO Drawer KK, Artesia, NM 87211-0719  
District III  
1000 Rio Brazos Rd., Aztec, NM 87410  
District IV  
PO Box 2088, Santa Fe, NM 87504-2088

State of New Mexico  
Energy, Minerals & Natural Resources Department

OIL CONSERVATION DIVISION  
PO Box 2088  
Santa Fe, NM 87504-2088

Form C-102  
Revised February 21, 1994  
Instructions on back  
Submit to Appropriate District Office  
State Lease - 4 Copies  
Fee Lease - 3 Copies

☐ AMENDED REPORT

WELL LOCATION AND ACREAGE DEDICATION PLAT

1 API Number		2 Pool Code		3 Pool Name	
4 Property Code		5 Property Name			6 Well Number
		SAN JUAN 27-4 UNIT			# 52M
7 OGRID No.		8 Operator Name			9 Elevation
		BURLINGTON RESOURCES OIL & GAS COMPANY			7193

10 Surface Location

UL or Lot No.	Section	Township	Range	Lot Idn	Feet from the	North/South line	Feet from the	East/West line	County
C	29	27 N	4 W		1040	NORTH	1370	WEST	RIO ARriba

11 Bottom Hole Location If Different From Surface

UL or lot no.	Section	Township	Range	Lot Idn	Feet from the	North/South line	Feet from the	East/West line	County

12 Dedicated Acres	13 Joint or Infill	14 Consolidation Code	15 Order No.

NO ALLOWABLE WILL BE ASSIGNED TO THIS COMPLETION UNTIL ALL INTEREST HAVE BEEN CONSOLIDATED  
OR A NON-STANDARD UNIT HAS BEEN APPROVED BY THE DIVISION

		<p>17 OPERATOR CERTIFICATION</p> <p>I hereby certify that the information contained herein is true and complete to the best of my knowledge and belief.</p> <p>Signature _____</p> <p>Printed Name _____</p> <p>Title _____</p> <p>Date _____</p> <p>18 SURVEYOR CERTIFICATION</p> <p>I hereby certify that the well location shown on this plat was plotted from field notes of actual surveys made by me or under my supervision, and that the same is true and correct to the best of my belief.</p> <p>August 10, 1998</p> <p>Date of Survey _____</p> <p>Signature and Seal of Professional Surveyor _____</p> <p></p> <p>7016</p> <p>Certificate Number</p>
--	--	---

# San Juan 27-4 Unit #52M

Expected Production Curve

Mesaverde Formation

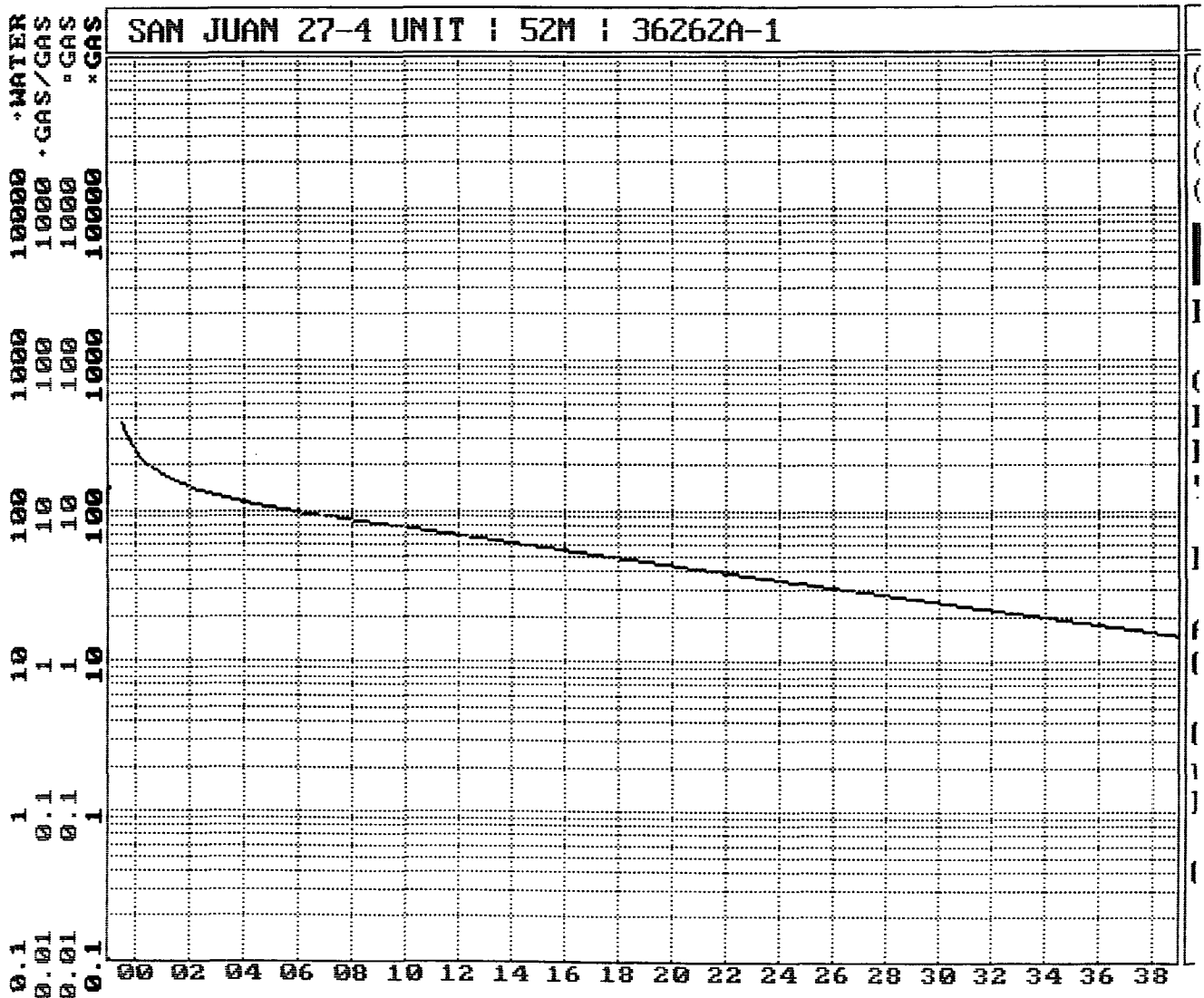

# San Juan 27-4 Unit #52M

Expected Production Curve

Dakota Formation

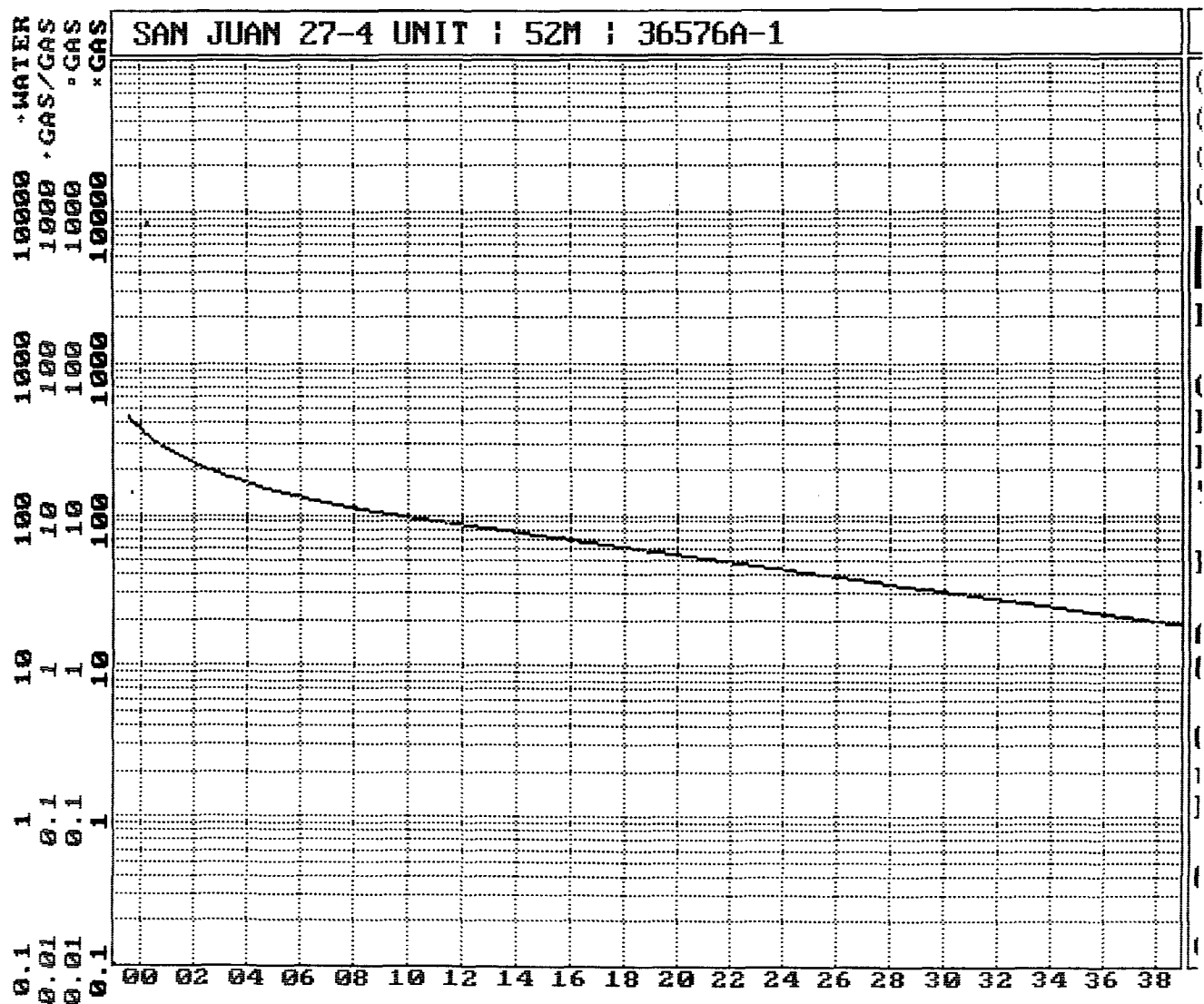

**San Juan 27-4 Unit #52M**

Bottom Hole Pressures  
Flowing and Static BHP  
Cullender and Smith Method  
Version 1.0 3/13/94

Mesaverde	Dakota
<u>MV-Current</u>	<u>DK-Current</u>
GAS GRAVITY 0.678	GAS GRAVITY 0.72
COND. OR MISC. (C/M) C	COND. OR MISC. (C/M) C
%N2 0.23	%N2 0.23
%CO2 0.98	%CO2 1.07
%H2S 0	%H2S 0
DIAMETER (IN) 2	DIAMETER (IN) 2.375
DEPTH (FT) 5865	DEPTH (FT) 8159
SURFACE TEMPERATURE (DEG F) 60	SURFACE TEMPERATURE (DEG F) 60
BOTTOMHOLE TEMPERATURE (DEG F) 137	BOTTOMHOLE TEMPERATURE (DEG F) 198
FLOWRATE (MCFPD) 0	FLOWRATE (MCFPD) 0
SURFACE PRESSURE (PSIA) 533	SURFACE PRESSURE (PSIA) 996
BOTTOMHOLE PRESSURE (PSIA) 617.1	BOTTOMHOLE PRESSURE (PSIA) 1242.7
<u>MV-Original</u>	<u>DK-Original</u>
GAS GRAVITY 0.678	GAS GRAVITY 0.72
COND. OR MISC. (C/M) C	COND. OR MISC. (C/M) C
%N2 0.23	%N2 0.23
%CO2 0.98	%CO2 1.07
%H2S 0	%H2S 0
DIAMETER (IN) 2	DIAMETER (IN) 2.375
DEPTH (FT) 5865	DEPTH (FT) 8159
SURFACE TEMPERATURE (DEG F) 60	SURFACE TEMPERATURE (DEG F) 60
BOTTOMHOLE TEMPERATURE (DEG F) 137	BOTTOMHOLE TEMPERATURE (DEG F) 198
FLOWRATE (MCFPD) 0	FLOWRATE (MCFPD) 0
SURFACE PRESSURE (PSIA) 1109	SURFACE PRESSURE (PSIA) 2503
BOTTOMHOLE PRESSURE (PSIA) 1303.2	BOTTOMHOLE PRESSURE (PSIA) 3173.2

Page No.: 1  
 Print Time: Wed Feb 03 15:59:33 1999  
 Property ID: 1393  
 Property Name: SAN JUAN 27-5 UNIT | 17 | 49641A-1  
 Table Name: Q:\PUBLIC\GENTITY\GDPNOS\TEST.DBF

--DATE-- ---CUM GAS-- M SIWHP  
 :::::McF:::::Psi:::::

09/24/56	0	1109.0	-original	<u>San Juan 27-4 Unit #52M</u>
10/09/56	0	1098.0		
07/30/57	184000	859.0		Mesaverde Offset
11/06/58	405000	861.0		
06/14/59	518000	822.0		
09/22/60	734000	791.0		
03/05/61	794000	799.0		
11/02/62	1001000	754.0		
04/19/63	1034000	795.0		
04/29/64	1146000	766.0		
05/10/65	1269000	740.0		
04/19/66	1411000	707.0		
05/16/67	1526000	701.0		
05/02/68	1635000	676.0		
06/30/69	1783710	606.0		
10/07/70	1940838	588.0		
07/22/71	2032607	541.0		
06/06/72	2134779	542.0		
07/19/73	2278884	467.0		
06/04/74	2395047	462.0		
06/25/76	2581220	476.0		
08/02/78	2754975	494.0		
05/01/80	2910206	444.0		
05/31/82	3064582	466.0		
06/05/84	3157829	507.0		
04/21/86	3247353	514.0		
11/27/89	3381042	520.0		
03/05/91	3405491	511.0		
11/18/91	3416757	499.0		
05/31/93	3450562	533.0	-current	

Page No.: 1

Print Time: Wed Feb 03 15:59:21 1999

Property ID: 1265

Property Name: SAN JUAN 27-4 UNIT | 52 | 51795A-1

Table Name: Q:\PUBLIC\GENTITY\GDPNOS\TEST.DBF

--DATE-- ---CUM GAS-- M SIWHP  
Mcf Psi

10/29/68	0	2503.0	-original	<u>San Juan 27-4 Unit #52M</u>
06/13/69	34028	1505.0		
09/28/70	149909	1013.0		DAKOTA Offset
05/18/71	192839	992.0		
06/13/72	256353	777.0		
06/24/75	383450	854.0		
07/06/77	462861	954.0		
05/29/80	548698	1132.0		
11/03/81	596873	1222.0		
09/19/83	635261	1370.0		
05/20/85	699826	910.0		
10/16/88	819555	992.0		
06/06/90	883715	795.0		
11/16/92	954671	996.0	-current	



# San Juan 27-4 Unit #52M

## Blanco Mesaverde / Basin Dakota

### 27N - 4W - 29

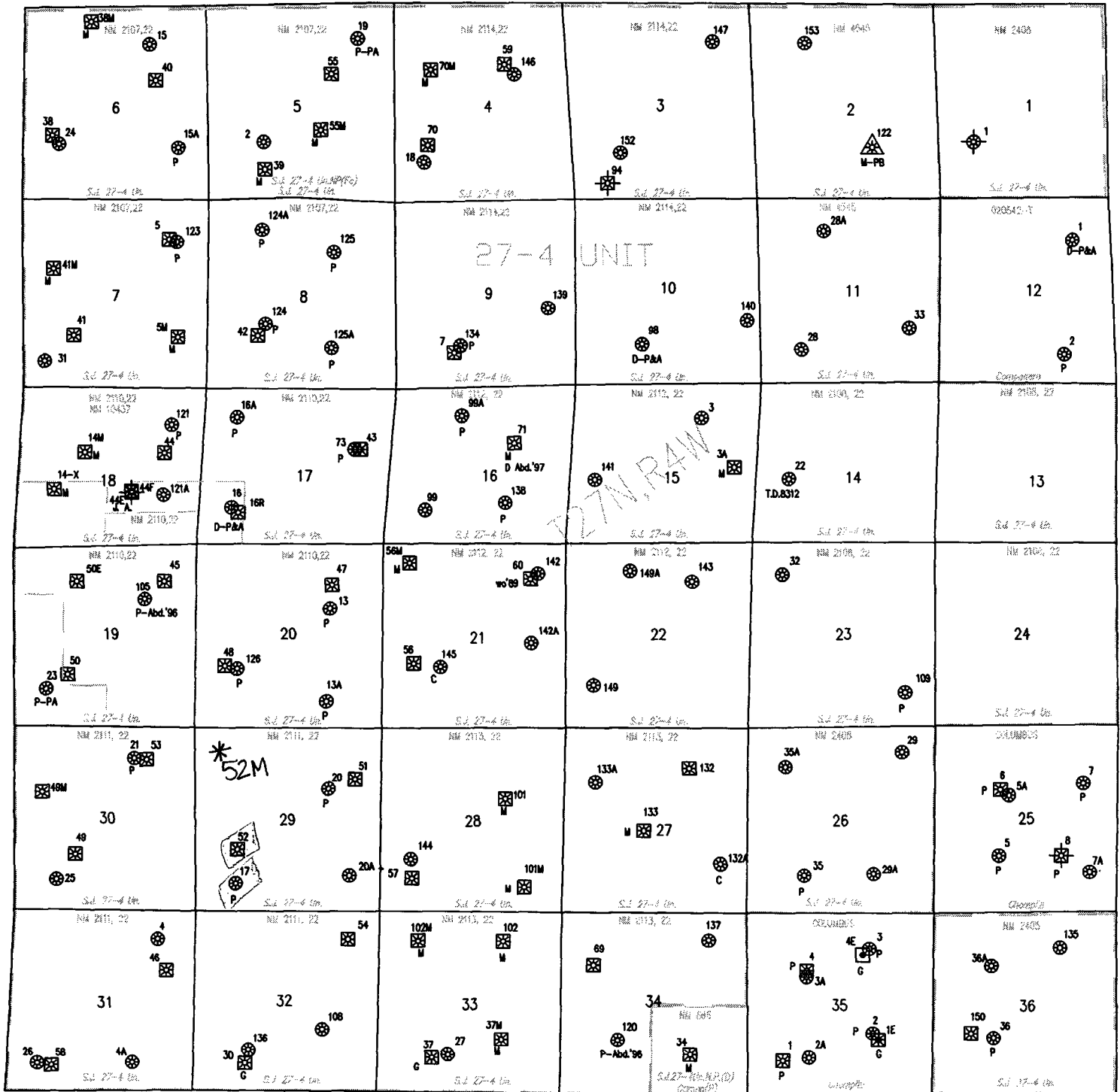

***BURLINGTON RESOURCES OIL AND GAS COMPANY***

**San Juan 27-4 Unit #52M**

**OFFSET OPERATOR/OWNER PLAT**

**Mesaverde/Dakota Formations**

**Down-hole Commingle**

**Township 27 North, Range 4 West**

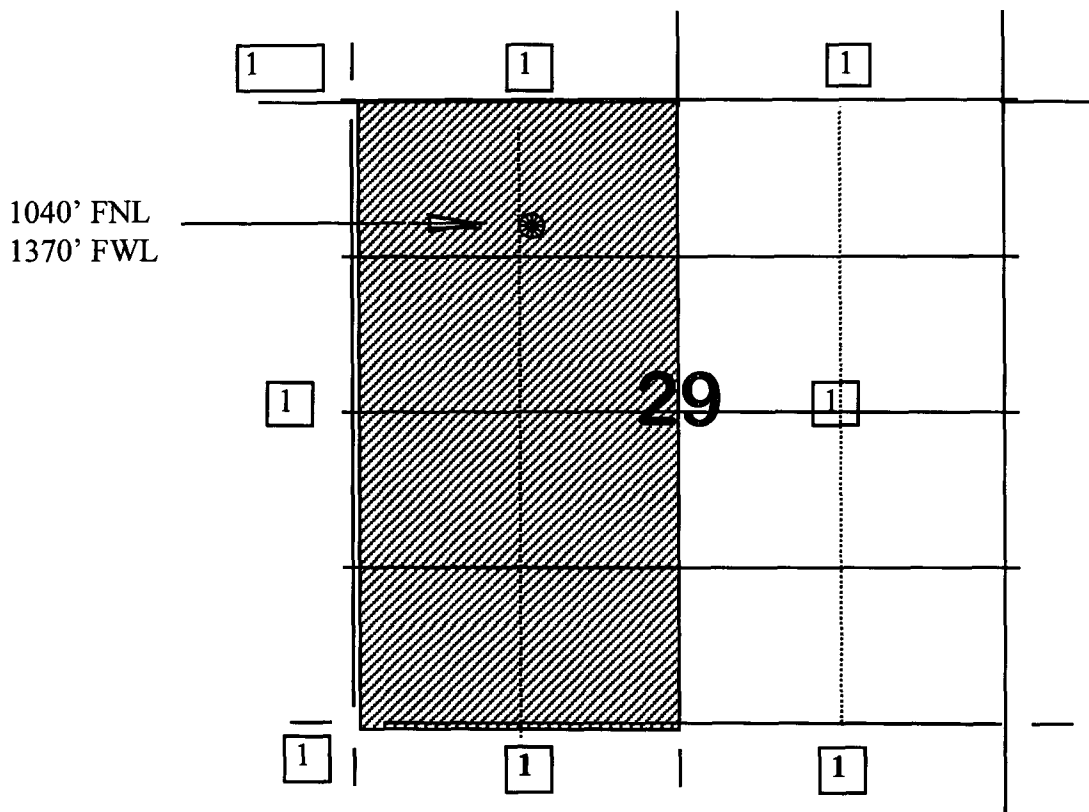

**1) Burlington Resources**

**BURLINGTON**  
**RESOURCES**

SAN JUAN DIVISION  
3535 East 30th Street: (87402-8801)  
P.O. BOX 4289  
Farmington, New Mexico 87499-4289

**BURLINGTON**  
**RESOURCES**

SAN JUAN DIVISION  
3535 East 30th Street: (87402-8801)  
P.O. BOX 4289  
Farmington, New Mexico 87499-4289

Bedrock Limited Partners  
PO Box 36480  
Albuquerque, NM 87176

x

Mary Jone Chappell  
PO Box 1865  
Corrales, NM 87048

**BURLINGTON**  
**RESOURCES**

SAN JUAN DIVISION  
3535 East 30th Street: (87402-8801)  
P.O. BOX 4289  
Farmington, New Mexico 87499-4289

**BURLINGTON**  
**RESOURCES**

SAN JUAN DIVISION  
3535 East 30th Street: (87402-8801)  
P.O. BOX 4289  
Farmington, New Mexico 87499-4289

Cinco General Partnership  
PO Box 451  
Albuquerque, NM 87103-0451

x

Harco LTD Partnership  
PO Box 216  
Roswell, NM 88202

**BURLINGTON**  
**RESOURCES**

SAN JUAN DIVISION  
3535 East 30th Street: (87402-8801)  
P.O. BOX 4289  
Farmington, New Mexico 87499-4289

**BURLINGTON**  
**RESOURCES**

SAN JUAN DIVISION  
3535 East 30th Street: (87402-8801)  
P.O. BOX 4289  
Farmington, New Mexico 87499-4289

James V. Harrington  
PO Box 13535  
Albuquerque, NM 87192

x

Tempe LTD Partnership  
c/o F.E. & M.K. Harrington  
652 Fearrington Post  
Pittsboro, NC 27312