

ABOVE THIS TABLE FOR OCD DIVISION USE ONLY

**NEW MEXICO OIL CONSERVATION DIVISION**  
 - Geological & Engineering Bureau -  
 1220 South St. Francis Drive, Santa Fe, NM 87505



**ADMINISTRATIVE APPLICATION CHECKLIST**

THIS CHECKLIST IS MANDATORY FOR ALL ADMINISTRATIVE APPLICATIONS FOR EXCEPTIONS TO DIVISION RULES AND REGULATIONS WHICH REQUIRE PROCESSING AT THE DIVISION LEVEL IN SANTA FE

**Applicant:** Strata Production Company **OGRID Number:** 21712  
**Well Name:** Sandy Federal SWD #10 **API:** \_\_\_\_\_  
**Pool:** Forty Niner Ridge, Devonian SWD **Pool Code:** 96100

**SUBMIT ACCURATE AND COMPLETE INFORMATION REQUIRED TO PROCESS THE TYPE OF APPLICATION INDICATED BELOW**

SEP 18 2018 AM 09:30

**1) TYPE OF APPLICATION:** Check those which apply for [A]

A. Location - Spacing Unit - Simultaneous Dedication

☐ NSL

☐ NSP (PROJECT AREA)

☐ NSP (PRORATION UNIT)

☐ SD

SWD-1784

B. Check one only for [I] or [II]

[I] Commingling - Storage - Measurement

☐ DHC

☐ CTB

☐ PLC

☐ PC

☐ OLS

☐ OLM

[II] Injection - Disposal - Pressure Increase - Enhanced Oil Recovery

☐ WFX

☐ PMX

☒ SWD

☐ IPI

☐ EOR

☐ PPR

**2) NOTIFICATION REQUIRED TO:** Check those which apply.

A. ☒ Offset operators or lease holders

B. ☐ Royalty, overriding royalty owners, revenue owners

C. ☒ Application requires published notice

D. ☐ Notification and/or concurrent approval by SLO

E. ☒ Notification and/or concurrent approval by BLM

F. ☒ Surface owner

G. ☒ For all of the above, proof of notification or publication is attached, and/or,

H. ☐ No notice required

**FOR OCD ONLY**

☐

Notice Complete

☐

Application  
Content  
Complete

**3) CERTIFICATION:** I hereby certify that the information submitted with this application for administrative approval is **accurate** and **complete** to the best of my knowledge. I also understand that **no action** will be taken on this application until the required information and notifications are submitted to the Division.

**Note: Statement must be completed by an individual with managerial and/or supervisory capacity.**

Paul Ragsdale

Print Name

9-13-18

Date

575-622-1127 ext. 18

Phone Number

pragsdale@stratanm.com

E-mail Address



DATE RECORD: First Rec: 9/18/2018 Admin Complete: 9/18/2018 or Suspended: 10/18/2018 Add. Request/Reply: suspension

ORDER TYPE: WFX / PMX / SWD Number: \_\_\_\_\_ Order Date: \_\_\_\_\_ Legacy Permits/Orders: \_\_\_\_\_

Well No. 10 Well Name(s): Sandy Federal SWD  
API: 30-0 15-Pending Spud Date: TBD New or Old (EPA): N (UIC Class II Primacy 03/07/1982)  
Footages 2430 FNL 460 FWL Lot \_\_\_\_\_ or Unit E Sec 24 Tsp 23S Rge 30E County Eddy

General Location: 215 miles E/MAlaga Pool: SWD, Devonian Pool No.: 9610/  
BLM 100K Map: JAI Operator: Strata Production Co OGRID: 21712 Contact: regsdale,

COMPLIANCE RULE 5.9: Total Wells: \_\_\_\_\_ Inactive: \_\_\_\_\_ Fincl Assur: \_\_\_\_\_ Compl. Order? \_\_\_\_\_ IS 5.9 OK? \_\_\_\_\_ Date: \_\_\_\_\_

WELL FILE REVIEWED ☐ Current Status: Proposed

WELL DIAGRAMS: NEW: Proposed ☐ or RE-ENTER: Before Conv. ☐ After Conv. ☐ Logs in Imaging: N/A

Planned Rehab Work to Well: \_\_\_\_\_

Well Construction Details		Sizes (in) Borehole / Pipe	Setting Depths (ft)	Cement Sx or Cf	Cement Top and Determination Method
Planned ___ or Existing ___	Surface	<u>26" / 20"</u>	<u>385'</u>	<u>1000</u>	<u>Surface / Visual</u>
Planned ___ or Existing ___	Interm/Prod	<u>17 1/2" / 13 3/8"</u>	<u>3800'</u>	<u>1850</u>	<u>Surface / Visual</u>
Planned ___ or Existing ___	Interm/Prod	<u>12 1/4" / 9 5/8"</u>	<u>12000</u>	<u>2100</u>	<u>Surface / Visual</u>
Planned ___ or Existing ___	Prod/Liner	<u>8 1/2" / 7"</u>	<u>16500</u>	<u>600</u>	<u>Surface / Visual</u>
Planned ___ or Existing ___	Liner				
Planned ___ or Existing ___	<input checked="" type="radio"/> OH PERF	<u>15580 / 16500</u>			

Injection Lithostratigraphic Units	Depths (ft)	Injection or Confining Units	Tops
Adjacent Unit: Litho. Struc. Por.			
Confining Unit: Litho. Struc. Por.			
Proposed Inj Interval TOP:			
Proposed Inj Interval BOTTOM:			
Confining Unit: Litho. Struc. Por.			
Adjacent Unit: Litho. Struc. Por.			

Completion/Operation Details:	
Drilled TD	<u>16500</u> PBTD _____
NEW TD	_____ NEW PBTD _____
NEW Open Hole	<input checked="" type="radio"/> or NEW Perfs <input type="radio"/>
Tubing Size	<u>4 1/2</u> in. Inter Coated? _____
Proposed Packer Depth	<u>15500</u> ft
Min. Packer Depth	<u>15400</u> (100-ft limit)
Proposed Max. Surface Press.	<u>3120</u> psi
Admin. Inj. Press.	<u>3116</u> (0.2 psi per ft)

**AOR: Hydrologic and Geologic Information**

POTASH: R-111-P ☒ Noticed? \_\_\_\_\_ BLM Sec Ord ☐ WIPP ☐ Noticed? \_\_\_\_\_ Salt/Salado 2430 NW: Cliff House fm \_\_\_\_\_

USDW: Aquifer(s) Triassic? Max Depth 440 HYDRO AFFIRM STATEMENT By Qualified Person ☐

NMOSE Basin: \_\_\_\_\_ CAPITAN REEF: thru \_\_\_\_\_ adj NA No. GW Wells in 1-Mile Radius? 0 FW Analysis? N/A

Disposal Fluid: Formation Source(s) \_\_\_\_\_ Analysis? \_\_\_\_\_ On Lease ☐ Operator Only ☒ or Commercial ☐

Disposal Interval: Inject Rate (Avg/Max BWPD): 3K / 15K Protectable Waters? MA Source: \_\_\_\_\_ System Closed or Open

HC Potential: Producing Interval? N/A Formerly Producing? \_\_\_\_\_ Method: Logs/DST/P&A/Other rcgim 2-Mi Radius Pool Map ☐

AOR Wells: 1/2-M \_\_\_\_\_ or ONE-M ☒ RADIUS MAP/WELL LIST: Total Penetrating Wells: N/A [AOR Hor: \_\_\_\_\_ AOR SWDs: \_\_\_\_\_]

Penetrating Wells: No. Active Wells 0 No. Corrective? \_\_\_\_\_ on which well(s)? \_\_\_\_\_ Diagrams? \_\_\_\_\_

Penetrating Wells: No. P&A Wells \_\_\_\_\_ No. Corrective? \_\_\_\_\_ on which well(s)? \_\_\_\_\_ Diagrams? \_\_\_\_\_

Induced-Seismicity Risk Assess: analysis submitted \_\_\_\_\_ historical/catalog review \_\_\_\_\_ fault-slip model \_\_\_\_\_ probability \_\_\_\_\_

NOTICE: 1/2-M ☒ or ONE-M \_\_\_\_\_ : Newspaper Date Aug 26 Mineral Owner BLM Surface Owner BLM N. Date Aug 26, 2018

RULE 26.7(A): Identified Tracts? Y Affected Persons\*: Cimrex, ConocoPhillips, Oxy N. Date \_\_\_\_\_

\* new definition as of 12/28/2018 [any the mineral estate of United States or state of New Mexico; SWD operators within the notice radius]

Order Conditional: Approved Initial island



1301 NORTH SYCAMORE AVENUE  
ROSWELL, NEW MEXICO 88201  
www.stratanm.com

SEP 18 2018 AM 09:30

September 13, 2018

**VIA CERTIFIED MAIL**

New Mexico Oil Conservation Division  
Attn: Phillip Goetze  
1220 South St. Francis Drive  
Santa Fe, NM 87505

**Re:** Application for Salt Water Disposal  
Sandy Federal SWD #10  
Devonian Formation  
2430' FNL & 460' FWL  
Unit Letter E, Sec 24-T23S-R30E  
Eddy County, NM

Dear Mr. Goetze:

Strata Production Company requests administrative approval for the enclosed C-108 Form with the requested documentation, to drill the Sandy Federal #10 salt water disposal well, down to the non-commercial Devonian formation, at 16,500' located 2430' FNL & 460' FWL Unit E, Section 24-T23S-R30E, Eddy County, New Mexico. The purpose of the project is to allow Strata to dispose of produced fluids from the Sandy and Roadrunner Delaware wells, as well as produced fluids from other producing wells in the area, and the anticipated continual development of the Forty Niner Ridge field.

As you know, any interested party may file an objection of the Application or may request a public hearing. Any objection or request for hearing must be filed with the Oil Conservation Division, PO Box 2088, Santa Fe, NM 87504-2088 within 15 days from the date of publication.

Sincerely,

A handwritten signature in black ink, appearing to read "Paul Ragsdale".

Paul Ragsdale  
Operations Manager  
Strata Production Company

**Enclosure:** Application for Authorization to Inject

**APPLICATION FOR AUTHORIZATION TO INJECT**

- I. PURPOSE: Secondary Recovery Pressure Maintenance X Disposal Storage  
Application qualifies for administrative approval? Yes No
- II. OPERATOR: Strata Production Company  
ADDRESS: PO Box 1030, Roswell, NM 88202  
CONTACT PARTY: Paul Ragsdale, Operations Manager PHONE: 575-622-1127 ext. 18
- III. WELL DATA: Complete the data required on the reverse side of this form for each well proposed for injection.  
Additional sheets may be attached if necessary.
- IV. Is this an expansion of an existing project? Yes X No  
If yes, give the Division order number authorizing the project: \_\_\_\_\_
- V. Attach a map that identifies all wells and leases within two miles of any proposed injection well with a one-half mile radius circle drawn around each proposed injection well. This circle identifies the well's area of review.
- VI. Attach a tabulation of data on all wells of public record within the area of review which penetrate the proposed injection zone. Such data shall include a description of each well's type, construction, date drilled, location, depth, record of completion, and a schematic of any plugged well illustrating all plugging detail.
- VII. Attach data on the proposed operation, including:
1. Proposed average and maximum daily rate and volume of fluids to be injected;
  2. Whether the system is open or closed;
  3. Proposed average and maximum injection pressure;
  4. Sources and an appropriate analysis of injection fluid and compatibility with the receiving formation if other than reinjected produced water; and,
  5. If injection is for disposal purposes into a zone not productive of oil or gas at or within one mile of the proposed well, attach a chemical analysis of the disposal zone formation water (may be measured or inferred from existing literature, studies, nearby wells, etc.).
- \*VIII. Attach appropriate geologic data on the injection zone including appropriate lithologic detail, geologic name, thickness, and depth. Give the geologic name, and depth to bottom of all underground sources of drinking water (aquifers containing waters with total dissolved solids concentrations of 10,000 mg/l or less) overlying the proposed injection zone as well as any such sources known to be immediately underlying the injection interval.
- IX. Describe the proposed stimulation program, if any.
- \*X. Attach appropriate logging and test data on the well. (If well logs have been filed with the Division, they need not be resubmitted).
- \*XI. Attach a chemical analysis of fresh water from two or more fresh water wells (if available and producing) within one mile of any injection or disposal well showing location of wells and dates samples were taken.
- XII. Applicants for disposal wells must make an affirmative statement that they have examined available geologic and engineering data and find no evidence of open faults or any other hydrologic connection between the disposal zone and any underground sources of drinking water.
- XIII. Applicants must complete the "Proof of Notice" section on the reverse side of this form.
- XIV. Certification: I hereby certify that the information submitted with this application is true and correct to the best of my knowledge and belief.

NAME: Shammy DennisTITLE: Admin SupportSIGNATURE: Shammy DennisDATE: 8/22/18E-MAIL ADDRESS: sdennis@stratanm.com

\* If the information required under Sections VI, VIII, X, and XI above has been previously submitted, it need not be resubmitted.

### III. WELL DATA

A. The following well data must be submitted for each injection well covered by this application. The data must be both in tabular and schematic form and shall include:

- (1) Lease name; Well No.; Location by Section, Township and Range; and footage location within the section.
- (2) Each casing string used with its size, setting depth, sacks of cement used, hole size, top of cement, and how such top was determined.
- (3) A description of the tubing to be used including its size, lining material, and setting depth.
- (4) The name, model, and setting depth of the packer used or a description of any other seal system or assembly used.

Division District Offices have supplies of Well Data Sheets which may be used or which may be used as models for this purpose. Applicants for several identical wells may submit a "typical data sheet" rather than submitting the data for each well.

B. The following must be submitted for each injection well covered by this application. All items must be addressed for the initial well. Responses for additional wells need be shown only when different. Information shown on schematics need not be repeated.

- (1) The name of the injection formation and, if applicable, the field or pool name.
- (2) The injection interval and whether it is perforated or open-hole.
- (3) State if the well was drilled for injection or, if not, the original purpose of the well.
- (4) Give the depths of any other perforated intervals and detail on the sacks of cement or bridge plugs used to seal off such perforations.
- (5) Give the depth to and the name of the next higher and next lower oil or gas zone in the area of the well, if any.

### XIV. PROOF OF NOTICE

All applicants must furnish proof that a copy of the application has been furnished, by certified or registered mail, to the owner of the surface of the land on which the well is to be located and to each leasehold operator within one-half mile of the well location.

Where an application is subject to administrative approval, a proof of publication must be submitted. Such proof shall consist of a copy of the legal advertisement which was published in the county in which the well is located. The contents of such advertisement must include:

- (1) The name, address, phone number, and contact party for the applicant;
- (2) The intended purpose of the injection well; with the exact location of single wells or the Section, Township, and Range location of multiple wells;
- (3) The formation name and depth with expected maximum injection rates and pressures; and,
- (4) A notation that interested parties must file objections or requests for hearing with the Oil Conservation Division, 1220 South St. Francis Dr., Santa Fe, New Mexico 87505, within 15 days.

NO ACTION WILL BE TAKEN ON THE APPLICATION UNTIL PROPER PROOF OF NOTICE HAS BEEN SUBMITTED.

---

NOTICE: Surface owners or offset operators must file any objections or requests for hearing of administrative applications within 15 days from the date this application was mailed to them.

**APPLICATION FOR AUTHORIZATION TO INJECT****III. WELL DATA SHEETS*****SEE ATTACHMENT 1***

- V. *Included is a map of the subject area that identifies all wells and leases within a two-mile radius circle and the area of review in a one-half mile radius circle.*

***SEE ATTACHMENT 2***

- VI. *Included is a tabulation of data on all wells of public record within the area of review of the proposed salt water disposal. Please note that none of the wells penetrate the proposed injection zone. SEE ATTACHMENT 3*

VII. ***SEE ATTACHMENT 1 - data on the proposed operation INCLUDING THE FOLLOWING:***

1. **Proposed average and maximum daily rate and volume of fluids to be injected:** *Between 10,000 to 15,000 bwpd.*
2. **Whether the system is open or closed:** *The system is a closed system.*
3. **Proposed average and maximum injection pressure:** *Average – 2000 psi and the maximum injection pressure is estimated at 3120 psi (0.2 psi/ft x 15,600 ft).*
4. *Injection fluid will be produced water from Strata Production Company as well as other operated Delaware and Bone Spring wells in the area.*
5. **If injection is for disposal purposes into a zone not productive of oil or gas at or within one mile of the proposed well, attach a chemical analysis of the disposal zone formation water (may be measured or inferred from existing literature, studies, nearby wells, etc.).** *We will be injecting into the Devonian formation. Devonian formation water is known to be compatible with the formation water of the Delaware and Bone Spring, however, a Devonian water analysis is unavailable.*

- \*VIII. Geologic data on the injection zone including appropriate lithologic detail, geologic name, thickness, and depth:** *The proposed injection interval is within the Devonian formation which is porous dolomite limestone from 15,600' to 16,500'.*

**Give the geologic name, and depth to bottom of all underground sources of drinking water (aquifers containing waters with total dissolved solids concentrations of 10,000 mg/l or less) overlying the proposed injection zone as well as any such sources known to be immediately underlying the injection interval:** *The underground fresh water aquifers (unnamed) are present at shallow depths <375'. There are no known fresh water intervals underlying the injecting formation.*

- IX.** Describe the proposed stimulation program, if any: *The proposed stimulation is an open-hole acid treatment of 20,000 gallons of 15% HCL.*
- X.** Attach appropriate logging and test data on the well. (If well logs have been filed with the Division, they need not be resubmitted): *No logs are currently on file with the Division. The appropriate log data will be filed upon drilling and completion of proposed well.*
- XI.** A chemical analysis of fresh water from two or more fresh water wells:  
**Water Analysis:** *Resistivity 4.18, Specific Gravity 1.0016, Temperature 70°, pH 7.0, Calcium 2,478, Magnesium 902, Chlorides 600, Sulfates 200, Bicarbonates 153, Soluble Iron 0.*
- XII.** Applicants for disposal wells must make an affirmative statement that they have examined available geologic and engineering data and find no evidence of open faults or any other hydrologic connection between the disposal zone and any underground sources of drinking water.  
**SEE ATTACHMENT 4**
- XIII.** "Proof of Notice" section: *Included is a list of notified persons as well as the letters of public notice. SEE ATTACHMENT 5*

# INJECTION WELL DATA SHEET

RATOR: Strata Production Company

IL NAME & NUMBER: Sandy Federal #10 SWD

IL LOCATION:	<u>2430 FNL &amp; 460 FWL</u>	<u>E</u>	<u>24</u>	<u>23S</u>	<u>30E</u>
	FOOTAGE LOCATION	UNIT LETTER	SECTION	TOWNSHIP	RANGE

## WELLBORE SCHEMATIC

## WELL CONSTRUCTION DATA

### Surface Casing

Hole Size: 26" Casing Size: 20" @385'

Cemented with: 1000 sx. or \_\_\_\_\_ ft<sup>3</sup>

Top of Cement: Surface Method Determined: Circulated

### Intermediate Casing

Hole Size: 17 1/2" Casing Size 13 3/8" @ 3800'

Cemented with: 1850 sx. or \_\_\_\_\_ ft<sup>3</sup>

Top of Cement: Surface Method Determined: Circulated

### Intermediate Casing 2

Hole Size: 12 1/4" Casing Size: 9 5/8" @ 12,000'

Cemented with: 2100 sx. or \_\_\_\_\_ ft<sup>3</sup>

Top of Cement: Surface Method Determined: Circulated



Production Casing

Hole Size: 8 1/2"

Casing Size: 7" 26#

Cemented with: 1000 sx.

*or* \_\_\_\_\_ ft<sup>3</sup>

Top of Cement: Surface

Method Determined: Circulated

Total Depth: 16,500'

Injection Interval

15,545' feet to 16,500'

(Perforated or Open Hole; indicate which)

Open Hole

## INJECTION WELL DATA SHEET

**Tubing Size:** 4 1/2" 13.5# **Lining Material:** TK99 IPC

Type of Packer: Arrowset 1X (nickel plated)

Packer Setting Depth: +/- 15,500

Other Type of Tubing/Casing Seal (if applicable): External Casing Packer @ 15,580'

### Additional Data

1. Is this a new well drilled for injection?   X   Yes        No

If no, for what purpose was the well originally drilled? \_\_\_\_\_

\_\_\_\_\_

2. Name of the Injection Formation: Devonian

3. Name of Field or Pool (if applicable): Forty Niner Ridge

4. Has the well ever been perforated in any other zone(s)? List all such perforated intervals and give plugging detail, i.e. sacks of cement or plug(s) used. **N/A**

---

5. Give the name and depths of any oil or gas zones underlying or overlying the proposed injection zone in this area: Morrow, 13,960' - 14,727'

**No underlying producing zone**

\_\_\_\_\_



Eddy County, NM





### AREA OF REVIEW

Sandy Federal #10 SWD  
2430' FNL & 460' FWL  
Unit E, Section 24 - T23S - R30E  
Eddy County, NM

PRODUCING										
API	Well Name	Well #	Section	Township	Range	Quarter Quarter	Operator Alias	Producing Reservoir	TVD	Well Status
30015406150000	FORTY NINER RIDGE 23 FEDERAL	001H	23	23S	30E	A	CIMAREX	BONE SPRING	9924.33	ACTIVE
30015413880000	FORTY NINER RIDGE 25 FEDERAL	001H	25	23S	30E	M	CIMAREX	BONE SPRING	9918.16	ACTIVE
30015414260000	SANDY FEDERAL	020H	24	23S	30E	A	CIMAREX	BONE SPRING	9891.59	ACTIVE
30015417920000	SANDY FEDERAL	022H	24	23S	30E	A	CIMAREX	BONE SPRING		ACTIVE
30015417930000	FORTY NINER RIDGE 25 FEDERAL	222H	25	23S	30E	H	CIMAREX	BONE SPRING	9864.5	ACTIVE
30015393610000	ROADRUNNER FEDERAL	001H	25	23S	30E	A	STRATA PROD	DELAWARE		ACTIVE
30015400550000	SANDY FEDERAL	003	24	23S	30E	P	STRATA PROD	DELAWARE	7736.55	ACTIVE
P/A										
30015413880100	FORTY NINER RIDGE 25 FEDERAL	001H	25	23S	30E	M	CIMAREX		9816.39	P & A

*Please note that none of the wells penetrate the proposed injection zone.*

ATTACHMENT 3

POST OFFICE DRAWER 1030  
ROSWELL, NM 88202-1030

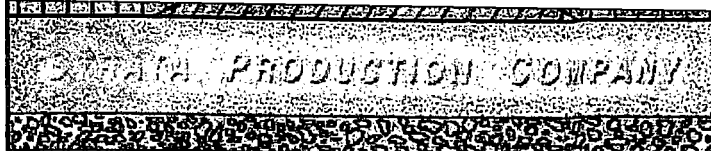

TELEPHONE (575) 622-1127  
FACSIMILE (575) 623-3533

1301 NORTH SYCAMORE AVENUE  
ROSWELL, NEW MEXICO 88201  
[www.stratanm.com](http://www.stratanm.com)

August 21, 2018

New Mexico Energy, Minerals and Natural Resources Department  
Engineering Bureau, Oil Conservation Division  
1220 South St. Francis Drive  
Santa Fe, NM 87505

Re: Application for Authorization to Inject  
Strata Production Co Sandy Federal #10 SWD

To whom it may concern:

This letter is in regard to the Strata Production Company "Application for Authorization to Inject," into the Sandy Federal #10 SWD, located 2430' FNL & 460' FWL, Unit E, Section 24 - T23S - R30E, Eddy County, New Mexico.

Available geologic and engineering data has been examined and no evidence of open faults or any other hydrological connection between the proposed injection-disposal zone and any underground sources of drinking water has been found.

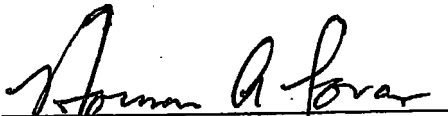
  
Norman A. Lovan, PhD.  
Consulting Geologist

ATTACHMENT 4

**Surface Owner:**

Carlsbad Field Office  
Bureau of Land Management  
620 E. Greene St.  
Carlsbad, NM 88220

**Offset Operators/Working Interest Owners:**

SW/4 Section 23 & NE/4 and SE/4 Section 24  
Strata Production Company

SW/4 Section 23 & NE/4 Section 24  
Cimarex Energy  
600 N Marienfield St # 600  
Midland, TX 79701

N/2 Section 14  
ConocoPhillips  
Mid-America – Permian Basin  
600 N. Dairy Ashford, P10-5046  
Houston, TX 77079

Section 13  
OXY USA Inc.  
5 Greenway Plaza, STE 110  
Houston, TX 77046

Percheron Pro Services, LLC  
1904 W. Grand Parkway N #200  
Katy, TX 77449

NW/4 Section 23  
Rubicon Oil & Gas II LP  
508 West Wall Avenue, Suite 500  
Midland, TX 79701



1301 NORTH SYCAMORE AVENUE  
ROSWELL, NEW MEXICO 88201  
[www.stratanm.com](http://www.stratanm.com)

August 23, 2018

VIA CERTIFIED MAIL

Carlsbad Field Office  
Bureau of Land Management  
620 E. Greene St.  
Carlsbad, NM 88220

Re: Application for Salt Water Disposal  
Sandy Federal #10 SWD  
Devonian Formation  
2430' FNL & 460' FWL  
Unit Letter E, Sec 24-T23S-R30E  
Eddy County, NM

Ladies and Gentlemen:

Enclosed, please find an Application that has been filed with the New Mexico Oil Conservation Division requesting approval to drill the Sandy Federal #10 salt water disposal well to dispose of produced water in the non-commercial Devonian formation at 16,500' located 2430' FNL & 460' FWL Unit E-Section 24-T23S-R30E, Eddy County, New Mexico.

As you know, any interested party may file an objection of the Application or may request a public hearing. Any objection or request for hearing must be filed with the Oil Conservation Division, PO Box 2088, Santa Fe, NM 87504-2088 within 15 days from the date of publication. Failure to object will preclude you from contesting this matter at a later date.

Sincerely yours,

Paul Ragsdale  
Operations Manager  
Strata Production Company

Enclosure: APPLICATION FOR AUTHORIZATION TO INJECT



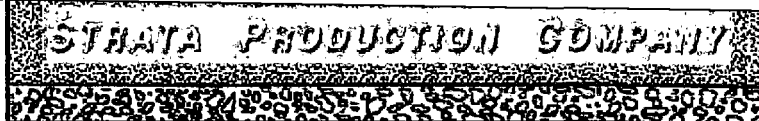

1301 NORTH SYCAMORE AVENUE  
ROSWELL, NEW MEXICO 88201  
[www.stratanm.com](http://www.stratanm.com)

August 23, 2018

VIA CERTIFIED MAIL

Cimarex Energy  
600 N Marienfield St # 600  
Midland, TX 79701

Re: Application for Salt Water Disposal  
Sandy Federal #10 SWD  
Devonian Formation  
2430' FNL & 460' FWL  
Unit Letter E, Sec 24-T23S-R30E  
Eddy County, NM

Ladies and Gentlemen:

Enclosed, please find an Application that has been filed with the New Mexico Oil Conservation Division requesting approval to drill the Sandy Federal #10 salt water disposal well to dispose of produced water in the non-commercial Devonian formation at 16,500' located 2430' FNL & 460' FWL Unit E, Section 24-T23S-R30E, Eddy County, New Mexico.

As you know, any interested party may file an objection of the Application or may request a public hearing. Any objection or request for hearing must be filed with the Oil Conservation Division, PO Box 2088, Santa Fe, NM 87504-2088 within 15 days from the date of publication. Failure to object will preclude you from contesting this matter at a later date.

Sincerely yours,

Paul Ragsdale  
Operations Manager  
Strata Production Company

Enclosure: APPLICATION FOR AUTHORIZATION TO INJECT



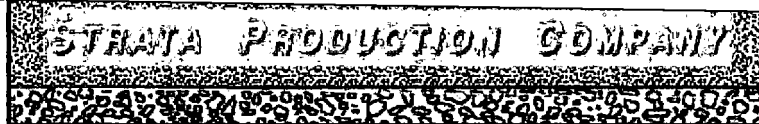

1301 NORTH SYCAMORE AVENUE  
ROSWELL, NEW MEXICO 88201  
[www.stratanm.com](http://www.stratanm.com)

August 23, 2018

VIA CERTIFIED MAIL

ConocoPhillips  
Mid-America – Permian Basin  
600 N. Dairy Ashford, P10-5046  
Houston, TX 77079

Re: Application for Salt Water Disposal  
Sandy Federal #10 SWD  
Devonian Formation  
2430' FNL & 460' FWL  
Unit Letter E, Sec 24-T23S-R30E  
Eddy County, NM

Ladies and Gentlemen:

Enclosed, please find an Application that has been filed with the New Mexico Oil Conservation Division requesting approval to drill the Sandy Federal #10 salt water disposal well to dispose of produced water in the non-commercial Devonian formation at 16,500' located 2430' FNL & 460' FWL Unit E-Section 24-T23S-R30E, Eddy County, New Mexico.

As you know, any interested party may file an objection of the Application or may request a public hearing. Any objection or request for hearing must be filed with the Oil Conservation Division, PO Box 2088, Santa Fe, NM 87504-2088 within 15 days from the date of publication. Failure to object will preclude you from contesting this matter at a later date.

Sincerely yours,

Paul Ragsdale  
Operations Manager  
Strata Production Company

Enclosure: APPLICATION FOR AUTHORIZATION TO INJECT

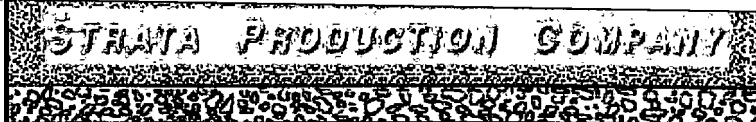

1301 NORTH SYCAMORE AVENUE  
ROSWELL, NEW MEXICO 88201  
[www.stratanm.com](http://www.stratanm.com)

August 23, 2018

VIA CERTIFIED MAIL

OXY USA Inc.  
5 Greenway Plaza, STE 110  
Houston, TX 77046

Re: Application for Salt Water Disposal  
Sandy Federal #10 SWD  
Devonian Formation  
2430' FNL & 460' FWL  
Unit Letter E, Sec 24-T23S-R30E  
Eddy County, NM

Ladies and Gentlemen:

Enclosed, please find an Application that has been filed with the New Mexico Oil Conservation Division requesting approval to drill the Sandy Federal #10 salt water disposal well to dispose of produced water in the non-commercial Devonian formation at 16,500' located 2430' FNL & 460' FWL Unit E-Section 24-T23S-R30E, Eddy County, New Mexico.

As you know, any interested party may file an objection of the Application or may request a public hearing. Any objection or request for hearing must be filed with the Oil Conservation Division, PO Box 2088, Santa Fe, NM 87504-2088 within 15 days from the date of publication. Failure to object will preclude you from contesting this matter at a later date.

Sincerely yours,

Paul Ragsdale  
Operations Manager  
Strata Production Company

Enclosure: APPLICATION FOR AUTHORIZATION TO INJECT

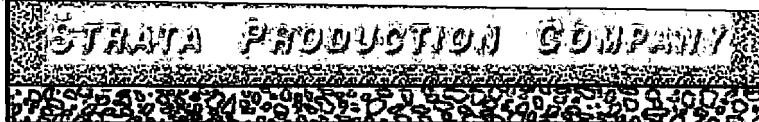

1301 NORTH SYCAMORE AVENUE  
ROSWELL, NEW MEXICO 88201  
[www.stratanm.com](http://www.stratanm.com)

August 23, 2018

VIA CERTIFIED MAIL

Percheron Pro Services, LLC  
1904 W. Grand Parkway N #200  
Katy, TX 77449

Re: Application for Salt Water Disposal  
Sandy Federal #10 SWD  
Devonian Formation  
2430' FNL & 460' FWL  
Unit Letter E, Sec 24-T23S-R30E  
Eddy County, NM

Ladies and Gentlemen:

Enclosed, please find an Application that has been filed with the New Mexico Oil Conservation Division requesting approval to drill the Sandy Federal #10 salt water disposal well to dispose of produced water in the non-commercial Devonian formation at 16,500' located 2430' FNL & 460' FWL Unit E-Section 24-T23S-R30E, Eddy County, New Mexico.

As you know, any interested party may file an objection of the Application or may request a public hearing. Any objection or request for hearing must be filed with the Oil Conservation Division, PO Box 2088, Santa Fe, NM 87504-2088 within 15 days from the date of publication. Failure to object will preclude you from contesting this matter at a later date.

Sincerely yours,

Paul Ragsdale  
Operations Manager  
Strata Production Company

Enclosure: APPLICATION FOR AUTHORIZATION TO INJECT

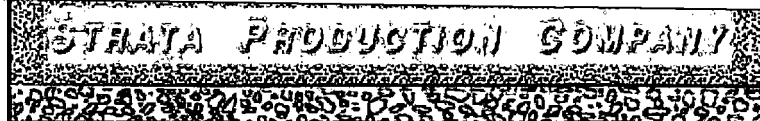

1301 NORTH SYCAMORE AVENUE  
ROSWELL, NEW MEXICO 88201  
[www.stratanm.com](http://www.stratanm.com)

August 23, 2018

VIA CERTIFIED MAIL

Rubicon Oil & Gas II LP  
508 West Wall Avenue, Suite 500  
Midland, TX 79701

Re: Application for Salt Water Disposal  
Sandy Federal #10 SWD  
Devonian Formation  
2430' FNL & 460' FWL  
Unit Letter E, Sec 24-T23S-R30E  
Eddy County, NM

Ladies and Gentlemen:

Enclosed, please find an Application that has been filed with the New Mexico Oil Conservation Division requesting approval to drill the Sandy Federal #10 salt water disposal well to dispose of produced water in the non-commercial Devonian formation at 16,500' located 2430' FNL & 460' FWL Unit E-Section 24-T23S-R30E, Eddy County, New Mexico.

As you know, any interested party may file an objection of the Application or may request a public hearing. Any objection or request for hearing must be filed with the Oil Conservation Division, PO Box 2088, Santa Fe, NM 87504-2088 within 15 days from the date of publication. Failure to object will preclude you from contesting this matter at a later date.

Sincerely yours,

Paul Ragsdale  
Operations Manager  
Strata Production Company

Enclosure: APPLICATION FOR AUTHORIZATION TO INJECT

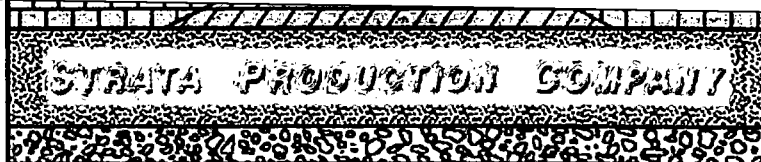

## LEGAL NOTICE

### APPLICATION FOR WATER DISPOSAL

Strata Production Company, PO Box 1030, Roswell, NM 88202-1030, has filed Application with the Oil Conservation Division, Energy, Minerals and Natural Resources Department, State of New Mexico for Administrative Approval and authority to drill the Sandy Federal #10 a salt water disposal well in the non-commercial Devonian formation at 16,500' located 2430' FNL & 460' FWL Unit E-Section 24-T23S-R30E, Eddy County, New Mexico.

The purpose of the water injection well is to dispose of salt water produced from the Sandy and Roadrunner Delaware wells and other wells in the area as designated by the Oil Conservation Division and as may be extended by additional drilling.

Water to be disposed will be injected into the Devonian formation at a depth of 15,580' to 16,500'.

The minimum injection rate is expected to be 3000 barrels of water per day. The maximum injection rate is expected to be between 10,000 to 15,000 barrels per day.

Minimum injection pressure is 2000 psig and maximum injection pressure is estimated at 3120 psig.

Any interested party may file an objection to the Application or may request a public hearing. Any objection or request for hearing must be filed with the Oil Conservation Division, PO Box 2088, Santa Fe, NM 87504-2088 within 15 days from the date of publication. Failure to object will preclude you from contesting this matter at a later date.

Paul Ragsdale, Operations Manager  
Strata Production Company  
Post Office Box 1030  
Roswell, NM 88202-1030  
575-622-1127 ext. 18.

**AFFIDAVIT OF PUBLICATION**

**Ad No.  
0001258867**

STRATA PRODUCTION COMPANY  
PO DRAWER 1030

ROSWELL NM 88202

I, a legal clerk of the **Carlsbad Current-Argus**, a newspaper published daily at the City of Carlsbad, in said county of Eddy, state of New Mexico and of general paid circulation in said county; that the same is a duly qualified newspaper under the laws of the State wherein legal notices and advertisements may be published; that the printed notice attached hereto was published in the regular and entire edition of said newspaper and not in supplement thereof on the date as follows, to wit:

08/26/18

  
Legal Clerk

Subscribed and sworn before me this  
27th of August 2018.

  
State of WI, County of Brown  
NOTARY PUBLIC

9-19-21  
My Commission Expires

**APPLICATION FOR  
WATER DISPOSAL**

Strata Production Company, PO Box 1030, Roswell, NM 88202-1030, has filed Application with the Oil Conservation Division, Energy, Minerals and Natural Resources Department, State of New Mexico for Administrative Approval and authority to drill the Sandy Federal #10 a salt water disposal well in the non-commercial Devonian formation at 16,500' located 2430' FNL & 460' FWL Unit E-Section 24-T23S-R30E, Eddy County, New Mexico.

The purpose of the water injection well is to dispose of salt water produced from the Sandy and Roadrunner Delaware wells and other wells in the area as designated by the Oil Conservation Division and as may be extended by additional drilling.

Water to be disposed will be injected into the Devonian formation at a depth of 15,580' to 16,500'.

The minimum injection rate is expected to be 3000 barrels of water per day. The maximum injection rate is expected to be between 10,000 to 15,000 barrels per day.

Minimum injection pressure is 2000 psig and maximum injection pressure is estimated at 3120 psig.

Any interested party may file an objection to the Application or may request a public hearing. Any objection or request for hearing must be filed

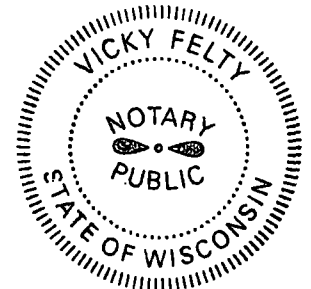

object will preclude  
you from contesting  
this matter at a later  
date.

Paul Ragsdale, Opera-  
tions Manager

Strata Production  
Company

Post Office Box 1030  
Roswell, NM 88202-  
1030

575-622-1127 ext. 18.

August 26, 2018

# My Services

[Profile](#)
[Print](#)
[Guide](#)
[Export](#)

Equipment

Reports

Tracking

Supplies

[Home](#) > 
 [Tracking](#) > 
 Status History

## Status History ?

### Tracking Number Information

<b>Meter:</b>	11288732	<b>Mailing Date:</b>	08/24/18 02:47 PM
<b>Tracking Number:</b>	9171969009350184396026	<b>Sender:</b>	
<b>Current Status:</b>	OK : Delivered	<b>Recipient:</b>	
<b>Class of Mail</b>	FC	<b>Zip Code:</b>	88220
<b>Service:</b>	ERR	<b>City:</b>	HAPPY VALLEY
<b>Value</b>	\$0.890	<b>State:</b>	NM

[Proof of Delivery](#)

*J. L. E. Green*

*T. J. [Signature]*

### Status Details

▼ Status Date	Status
Tue, 08/28/18, 12:12:00 PM	OK : Delivered
Tue, 08/28/18, 07:58:00 AM	Out for Delivery
Tue, 08/28/18, 07:48:00 AM	Sorting / Processing Complete
Tue, 08/28/18, 06:34:00 AM	Arrival at Unit
Mon, 08/27/18, 10:25:00 PM	Processed (processing scan)
Mon, 08/27/18, 02:36:00 PM	Dispatched to Sort Facility
Mon, 08/27/18, 11:12:00 AM	Accept/pick-up
Mon, 08/27/18, 06:00:00 AM	Arrival at Unit
Sat, 08/25/18, 04:26:00 AM	OK: USPS acknowledges reception of info
Fri, 08/24/18, 10:49:00 PM	Dispatched from Sort Facility
Fri, 08/24/18, 10:32:00 PM	Processed (processing scan)
Fri, 08/24/18, 09:17:00 PM	Origin Acceptance
Note: Delivery status updates are processed throughout the day and posted upon receipt from the Postal Service.	

Carlsbad Field Office  
 Bureau of Land Management  
 620 E. Greene St.  
 Carlsbad, NM 88220

Mailed : Aug. 24, 2018  
 Delivered: Aug. 28, 2018



[Home](#) > [Tracking](#) > Status History

## Status History ?

## Tracking Number Information

<b>Meter:</b>	11288732	<b>Mailing Date:</b>	08/24/18 02:46 PM
<b>Tracking Number:</b>	9171969009350184396002	<b>Sender:</b>	
<b>Current Status:</b>	Delivery Status Not Updated	<b>Recipient:</b>	
<b>Class of Mail</b>	FC	<b>Zip Code:</b>	77079
<b>Service:</b>	ERR	<b>City:</b>	HOUSTON
<b>Value</b>	\$0.890	<b>State:</b>	TX

Proof of Delivery

## Status Details

▼ Status Date	Status
Wed, 08/29/18, 11:27:00 PM	Delivery Status Not Updated
Wed, 08/29/18, 09:27:00 AM	Out for Delivery
Wed, 08/29/18, 09:17:00 AM	Sorting / Processing Complete
Wed, 08/29/18, 08:47:00 AM	Arrival at Unit
Wed, 08/29/18, 07:40:00 AM	Arrival at Unit
Mon, 08/27/18, 04:13:00 AM	Processed (processing scan)
Sat, 08/25/18, 09:11:00 PM	Processed (processing scan)
Sat, 08/25/18, 04:26:00 AM	OK: USPS acknowledges reception of info
Fri, 08/24/18, 10:49:00 PM	Dispatched from Sort Facility
Fri, 08/24/18, 10:32:00 PM	Processed (processing scan)
Fri, 08/24/18, 09:17:00 PM	Origin Acceptance
Note: Delivery status updates are processed throughout the day and posted upon receipt from the Postal Service.	

ConocoPhillips  
Mid-America – Permian Basin  
600 N. Dairy Ashford, P10-5046  
Houston, TX 77079

Mailed: Aug. 24, 2018  
Delivered: Aug 29, 2018

COMPLETE THIS SECTION	COMPLETE THIS SECTION ON DELIVERY
<p>te items 1, 2, and 3.</p> <p>ur name and address on the reverse we can return the card to you.</p> <p>his card to the back of the mailpiece, e front if space permits.</p> <p>ddressed to:</p> <p>Field Office of Land Management reene St. NM 88220</p>	<p>A. Signature <input checked="" type="checkbox"/> Agent <input checked="" type="checkbox"/> Addressee</p> <p>B. Received by (Printed Name)</p> <p>C. Date of Delivery 8/29/18</p> <p>D. Is delivery address different from item 1? <input type="checkbox"/> Yes If YES, enter delivery address below: <input type="checkbox"/> No</p> <p><b>STRATA</b></p> <p><b>AUG 31 2018</b></p> <p><b>PRODUCTION COMPANY</b></p>
<p>90 9402 2907 7094 1454 22</p>	<p><input type="checkbox"/> Service Type</p> <p><input type="checkbox"/> Adult Signature</p> <p><input type="checkbox"/> Adult Signature Restricted Delivery</p> <p><input type="checkbox"/> Certified Mail®</p> <p><input type="checkbox"/> Certified Mail Restricted Delivery</p> <p><input type="checkbox"/> Collect on Delivery</p> <p><input type="checkbox"/> Priority Mail Express®</p> <p><input type="checkbox"/> Registered Mail™</p> <p><input type="checkbox"/> Registered Mail Restricted Delivery</p> <p><input type="checkbox"/> Return Receipt for Merchandise</p> <p><input type="checkbox"/> Signature Confirmation™</p> <p><input type="checkbox"/> Signature Confirmation Restricted Delivery</p>
<p>9171 9690 0935 0184 3960 26</p>	<p>811, July 2015 PSN 7530-02-000-9053 SF#10SWL PON Domestic Return Receipt</p>

COMPLETE THIS SECTION	COMPLETE THIS SECTION ON DELIVERY
<p>te items 1, 2, and 3.</p> <p>ur name and address on the reverse we can return the card to you.</p> <p>this card to the back of the mailpiece, e front if space permits.</p> <p>ddressed to:</p> <p>Phillips nerica – Permian Basin Dairy Ashford, P10-5046 TX 77079</p>	<p>A. Signature <input checked="" type="checkbox"/> Agent <input type="checkbox"/> Addressee</p> <p>B. Received by (Printed Name)</p> <p>C. Date of Delivery 8-29-18</p> <p>D. Is delivery address different from item 1? <input type="checkbox"/> Yes If YES, enter delivery address below: <input type="checkbox"/> No</p>
<p>90 9402 2907 7094 1454 60</p>	<p>3. Service Type SF#10SWL PON</p> <p><input type="checkbox"/> Adult Signature</p> <p><input type="checkbox"/> Adult Signature Restricted Delivery</p> <p><input type="checkbox"/> Certified Mail®</p> <p><input type="checkbox"/> Certified Mail Restricted Delivery</p> <p><input type="checkbox"/> Collect on Delivery</p> <p><input type="checkbox"/> Priority Mail Express®</p> <p><input type="checkbox"/> Registered Mail™</p> <p><input type="checkbox"/> Registered Mail Restricted Delivery</p> <p><input type="checkbox"/> Return Receipt for Merchandise</p> <p><input type="checkbox"/> Signature Confirmation™</p> <p><input type="checkbox"/> Signature Confirmation Restricted Delivery</p>
<p>1 9690 0935 0184 3960 02</p>	<p>811, July 2015 PSN 7530-02-000-9053 Domestic Return Receipt</p>



PLACE STICKER AT TOP OF ENVELOPE TO THE RIGHT

**SENDER: COMPLETE THIS SECTION**

- Complete items 1, 2, and 3.
- Print your name and address on the reverse so that we can return the card to you.
- Attach this card to the back of the mailpiece, or on the front if space permits.

**1. Article Addressed to:**

ConocoPhillips  
Mid-America – Permian Basin  
600 N. Dairy Ashford, P10-5046  
Houston, TX 77079

9590 9402 2907 7094 1454 60

9171 9690 0935 0184 3960 02

**COMPLETE THIS SECTION ON DELIVERY**

**A. Signature**

**X**

- ☐ Agent  
☐ Addressee

**B. Received by (Printed Name)**

**C. Date of Delivery**

- D. Is delivery address different from item 1?** ☐ Yes  
If YES, enter delivery address below: ☐ No

**3. Service Type** **5F #10300 Pen**

- |  |   |
|--|---|
| <input type="checkbox"/> Adult Signature                         | <input type="checkbox"/> Priority Mail Express®                     |
| <input type="checkbox"/> Adult Signature Restricted Delivery     | <input type="checkbox"/> Registered Mail™                           |
| <input type="checkbox"/> Certified Mail®                         | <input type="checkbox"/> Registered Mail Restricted Delivery        |
| <input type="checkbox"/> Certified Mail Restricted Delivery      | <input type="checkbox"/> Return Receipt for Merchandise             |
| <input type="checkbox"/> Collect on Delivery                     | <input type="checkbox"/> Signature Confirmation™                    |
| <input type="checkbox"/> Collect on Delivery Restricted Delivery | <input type="checkbox"/> Signature Confirmation Restricted Delivery |
| <input type="checkbox"/> Insured Mail                            |   |
| <input type="checkbox"/> Insured Mail Restricted Delivery (500)  |   |

PS Form 3811, July 2015 PSN 7530-02-000-9053

Domestic Return Receipt

## SENDER: COMPLETE THIS SECTION

- Complete items 1, 2, and 3.
- Print your name and address on the reverse so that we can return the card to you.
- Attach this card to the back of the mailpiece, or on the front if space permits.

## 1. Article Addressed to:

Carlsbad Field Office  
Bureau of Land Management  
620 E. Greene St.  
Carlsbad, NM 88220

9590 9402 2907 7094 1454 22

9171 9690 0935 0184 3960 26

## COMPLETE THIS SECTION ON DELIVERY

## A. Signature

X

- ☐ Agent  
☐ Addressee

## B. Received by (Printed Name)

## C. Date of Delivery

- D. Is delivery address different from item 1? ☐ Yes  
If YES, enter delivery address below: ☐ No

## 3. Service Type

- |  |   |
|--|---|
| <input type="checkbox"/> Adult Signature                     | <input type="checkbox"/> Priority Mail Express®                     |
| <input type="checkbox"/> Adult Signature Restricted Delivery | <input type="checkbox"/> Registered Mail™                           |
| <input type="checkbox"/> Certified Mail®                     | <input type="checkbox"/> Registered Mail Restricted Delivery        |
| <input type="checkbox"/> Certified Mail Restricted Delivery  | <input type="checkbox"/> Return Receipt for Merchandise             |
| <input type="checkbox"/> Collect on Delivery                 | <input type="checkbox"/> Signature Confirmation™                    |
| <input type="checkbox"/> Restricted Delivery                 | <input type="checkbox"/> Signature Confirmation Restricted Delivery |

PS Form 3811, July 2015 PSN 7630-02-000-9053

SF#10SW0 PON

Domestic Return Receipt

[Home](#) > [Tracking](#) > Status History

## Status History ?

## Tracking Number Information

Meter:	11288732	Mailing Date:	08/24/18 02:47 PM
Tracking Number:	9171969009350184396019	Sender:	
Current Status:	OK : Delivered	Recipient:	
Class of Mail	FC	Zip Code:	79701
Service:	ERR	City:	MIDLAND
Value	\$0.890	State:	TX

## Proof of Delivery

5 Pae 2  
600 - 4

## Status Details

▼ Status Date	Status
Mon, 08/27/18, 01:41:00 PM	OK : Delivered
Mon, 08/27/18, 01:35:00 PM	OK : Delivered
Sun, 08/26/18, 10:30:00 PM	Processed (processing scan)
Sat, 08/25/18, 08:59:00 PM	Dispatched from Sort Facility
Sat, 08/25/18, 08:25:00 PM	Processed (processing scan)
Sat, 08/25/18, 04:26:00 AM	OK: USPS acknowledges reception of info
Fri, 08/24/18, 10:49:00 PM	Dispatched from Sort Facility
Fri, 08/24/18, 10:32:00 PM	Processed (processing scan)
Fri, 08/24/18, 09:17:00 PM	Origin Acceptance
Note: Delivery status updates are processed throughout the day and posted upon receipt from the Postal Service.	

Cimarex Energy  
600 N Marienfield St # 600  
Midland, TX 79701

Mailed: Aug. 24, 2018  
Delivered: Aug. 27, 2018

[Equipment](#)[Reports](#)[Tracking](#)[Supplies](#)[Home](#) > [Tracking](#) > [Status History](#)

## Status History ?

## Tracking Number Information

<b>Meter:</b>	11288732	<b>Mailing Date:</b>	08/24/18 02:44 PM
<b>Tracking Number:</b>	9171969009350177580999	<b>Sender:</b>	
<b>Current Status:</b>	OK : Delivered	<b>Recipient:</b>	
<b>Class of Mail</b>	FC	<b>Zip Code:</b>	77449
<b>Service:</b>	ERR	<b>City:</b>	PARK ROW
<b>Value</b>	\$0.890	<b>State:</b>	TX

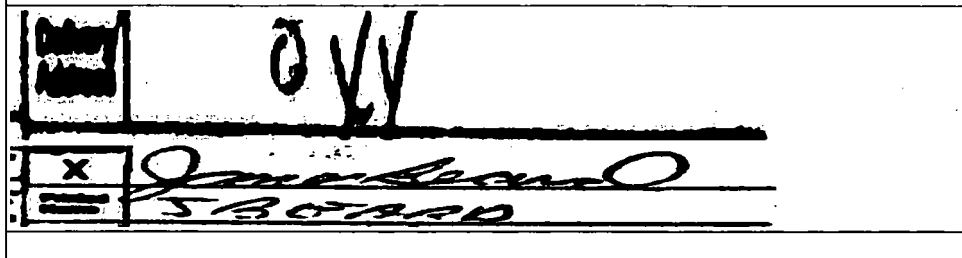
[Proof of Delivery](#)

## Status Details

▼ Status Date

Status

Wed, 08/29/18, 11:13:00 AM

OK : Delivered

Sat, 08/25/18, 04:26:00 AM

OK: USPS acknowledges reception of info

Note: Delivery status updates are processed throughout the day and posted upon receipt from the Postal Service.

OXY USA Inc.  
5 Greenway Plaza, STE 110  
Houston, TX 77046

Mailed: Aug. 24, 2018  
Delivered: Aug. 29, 2018

COMPLETE THIS SECTION	COMPLETE THIS SECTION ON DELIVERY
<p>Items 1, 2, and 3.</p> <p>Name and address on the reverse We can return the card to you.</p> <p>is card to the back of the mailpiece, front if space permits.</p> <p>Addressed to:</p> <p>Energy Marionfield St # 600 TX 79701</p>	<p>A. Signature <i>[Signature]</i> <input type="checkbox"/> Agent <input checked="" type="checkbox"/> Addressee</p> <p>B. Received by (Printed Name)</p> <p>C. Date of Delivery 8-27-15</p> <p>D. Is delivery address different from item 1? <input type="checkbox"/> Yes If YES, enter delivery address below: <input checked="" type="checkbox"/> No</p>
<p>0 9402 2907 7094 1454 39</p> <p>9690 0935 0184 3960 19</p>	<p>3. Service Type <i>FF#105WD PON</i></p> <p><input type="checkbox"/> Adult Signature <input type="checkbox"/> Priority Mail Express®  <input type="checkbox"/> Adult Signature Restricted Delivery <input type="checkbox"/> Registered Mail™  <input type="checkbox"/> Certified Mail® <input type="checkbox"/> Registered Mail Restricted Delivery  <input type="checkbox"/> Certified Mail Restricted Delivery <input type="checkbox"/> Return Receipt for Merchandise  <input type="checkbox"/> Collect on Delivery <input type="checkbox"/> Signature Confirmation™  <input type="checkbox"/> Collect on Delivery Restricted Delivery <input type="checkbox"/> Signature Confirmation Restricted Delivery  <input type="checkbox"/> Registered Mail Restricted Delivery (\$500)</p>
<p>811, July 2015 PSN 7530-02-000-9053</p> <p>Domestic Return Receipt</p>	

COMPLETE THIS SECTION	COMPLETE THIS SECTION ON DELIVERY
<p>Items 1, 2, and 3.</p> <p>Name and address on the reverse We can return the card to you.</p> <p>his card to the back of the mailpiece, front if space permits.</p> <p>Addressed to:</p> <p>SA Inc. Way Plaza, STE 110 TX 77046</p>	<p>A. Signature <i>X</i> <input type="checkbox"/> Agent <input checked="" type="checkbox"/> Addressee</p> <p>B. Received by (Printed Name)</p> <p>C. Date of Delivery 8-29-18</p> <p>D. Is delivery address different from item 1? <input type="checkbox"/> Yes If YES, enter delivery address below: <input checked="" type="checkbox"/> No</p> <p><i>James E Beard</i> JAMES BEARD</p>
<p>0 9402 2907 7094 1454 46</p> <p>71 9690 0935 0177 5809 99</p>	<p>3. Service Type <i>FF#105WD PON</i></p> <p><input type="checkbox"/> Adult Signature <input type="checkbox"/> Priority Mail Express®  <input type="checkbox"/> Adult Signature Restricted Delivery <input type="checkbox"/> Registered Mail™  <input type="checkbox"/> Certified Mail® <input type="checkbox"/> Registered Mail Restricted Delivery  <input type="checkbox"/> Certified Mail Restricted Delivery <input type="checkbox"/> Return Receipt for Merchandise  <input type="checkbox"/> Collect on Delivery <input type="checkbox"/> Signature Confirmation™  <input type="checkbox"/> Collect on Delivery Restricted Delivery <input type="checkbox"/> Signature Confirmation Restricted Delivery  <input type="checkbox"/> Registered Mail Restricted Delivery (\$500)</p>
<p>811, July 2015 PSN 7530-02-000-9053</p> <p>Domestic Return Receipt</p>	



[illegible]

**SENDER: COMPLETE THIS SECTION**

- Complete items 1, 2, and 3.
- Print your name and address on the reverse so that we can return the card to you.
- Attach this card to the back of the mailpiece, or on the front if space permits.

**1. Article Addressed to:**

Cimarex Energy  
600 N Marienfield St # 600  
Midland, TX 79701

9590 9402 2907 7094 1454 39

9171 9690 0935 0184 3960 19

**COMPLETE THIS SECTION ON DELIVERY**

**A. Signature**

**X**

- ☐ Agent  
☐ Addressee

**B. Received by (Printed Name)**

**C. Date of Delivery**

- D. Is delivery address different from item 1? ☐ Yes**  
**If YES, enter delivery address below: ☐ No**

**3. Service Type**

- |  |   |
|--|---|
| <input type="checkbox"/> Adult Signature                             | <input type="checkbox"/> Priority Mail Express®                     |
| <input type="checkbox"/> Adult Signature Restricted Delivery         | <input type="checkbox"/> Registered Mail™                           |
| <input type="checkbox"/> Certified Mail®                             | <input type="checkbox"/> Registered Mail Restricted Delivery        |
| <input type="checkbox"/> Certified Mail Restricted Delivery          | <input type="checkbox"/> Return Receipt for Merchandise             |
| <input type="checkbox"/> Collect on Delivery                         | <input type="checkbox"/> Signature Confirmation™                    |
| <input type="checkbox"/> Collect on Delivery Restricted Delivery     | <input type="checkbox"/> Signature Confirmation Restricted Delivery |
| <input type="checkbox"/> Registered Mail                             |   |
| <input type="checkbox"/> Registered Mail Restricted Delivery (\$500) |   |

PS Form 3811, July 2015 PSN 7530-02-000-9053

Domestic Return Receipt

## SENDER: COMPLETE THIS SECTION

- Complete items 1, 2, and 3.
- Print your name and address on the reverse so that we can return the card to you.
- Attach this card to the back of the mailpiece, or on the front if space permits.

## 1. Article Addressed to:

OXY USA Inc.  
5 Greenway Plaza, STE 110  
Houston, TX 77046

9590 9402 2907 7094 1454 46

9171 9690 0935 0177 5809 99

PS Form 3811, July 2015 PSN 7530-02-000-9053

## COMPLETE THIS SECTION ON DELIVERY

## A. Signature

X

☐ Agent☐ Addressee

## B. Received by (Printed Name)

## C. Date of Delivery

D. Is delivery address different from item 1? ☐ YesIf YES, enter delivery address below: ☐ No

## 3. Service Type SF#10-SLDDPAN

☐ Adult Signature☐ Adult Signature Restricted Delivery☐ Certified Mail®☐ Certified Mail Restricted Delivery☐ Collect on Delivery☐ Collect on Delivery Restricted Delivery☐ Insured Mail☐ Insured Mail Restricted Delivery☐ Priority Mail Express®☐ Registered Mail™☐ Registered Mail Restricted Delivery☐ Return Receipt for Merchandise☐ Signature Confirmation™☐ Signature Confirmation Restricted Delivery

Domestic Return Receipt

## Goetze, Phillip, EMNRD

---

**From:** Michael Feldewert <MFeldewert@hollandhart.com>  
**Sent:** Tuesday, February 5, 2019 2:07 PM  
**To:** Goetze, Phillip, EMNRD  
**Cc:** Sharon T. Shaheen; Brooks, David K, EMNRD  
**Subject:** [EXT] Case No. 20209: Withdrawal of Mewbourne's Protest of Strata Production Sandy Federal SWD #10 Application (Application No. pMAM1826228780)  
**Attachments:** STRATA SANDY FEDERAL PROTEST LETTER.PDF

Mr. Goetze: Mewbourne hereby withdraws its protest of the application filed by Strata Production for the Sandy Federal SWD #10 set for hearing under Case No. 20209 and also specifically withdraws the attached October 4, 2018, Objection Letter pertaining to this well. Counsel for Strata Production has been copied with this notice. Thank you for your attention to this matter.

---

**Michael H. Feldewert**

Partner, Holland & Hart LLP  
110 N Guadalupe St, Suite A, Santa Fe, NM 87501  
T 505.988.4421

**HOLLAND&HART**



CONFIDENTIALITY NOTICE: This message is confidential and may be privileged. If you believe that this email has been sent to you in error, please reply to the sender that you received the message in error; then please delete this e-mail.

---

**From:** Michael Feldewert  
**Sent:** Monday, October 8, 2018 10:20 AM  
**To:** 'Goetze, Phillip, EMNRD' <Phillip.Goetze@state.nm.us>  
**Cc:** Brooks, David K; EMNRD <DavidK.Brooks@state.nm.us>; Riley, Heather, EMNRD <Heather.Riley@state.nm.us>; Tim Harrington (tharrington@mewbourne.com) <tharrington@mewbourne.com>  
**Subject:** Protest of Strata Production Sandy Federal SWD #10 Application (Application No. pMAM1826228780)

Mr. Goetze: Mewbourne Oil Company hereby protests the administrative application filed Strata Production for the Sandy Federal SWD #10 to be located 460' FWL and 2340' FNL in Unit E, Section 24, Township 23 South, Range 30 East in Eddy County, New Mexico.

---

**Michael H. Feldewert**

Partner, Holland & Hart LLP  
110 N Guadalupe St, Suite A, Santa Fe, NM 87501  
T 505.988.4421

**HOLLAND&HART**



CONFIDENTIALITY NOTICE: This message is confidential and may be privileged. If you believe that this email has been sent to you in error, please reply to the sender that you received the message in error; then please delete this e-mail.

## Goetze, Phillip, EMNRD

---

**From:** Michael Feldewert <MFeldewert@hollandhart.com>  
**Sent:** Monday, October 8, 2018 10:20 AM  
**To:** Goetze, Phillip, EMNRD  
**Cc:** Brooks, David K, EMNRD; Riley, Heather, EMNRD; Tim Harrington (tharrington@mewbourne.com)  
**Subject:** [EXT] Protest of Strata Production Sandy Federal SWD #10 Application (Application No. pMAM1826228780)

Mr. Goetze: Mewbourne Oil Company hereby protests the administrative application filed Strata Production for the Sandy Federal SWD #10 to be located 460' FWL and 2340' FNL in Unit E, Section 24, Township 23 South, Range 30 East in Eddy County, New Mexico.

---

**Michael H. Feldewert**

Partner, Holland & Hart LLP  
110 N Guadalupe St, Suite A, Santa Fe, NM 87501  
T 505.988.4421

**HOLLAND&HART**



CONFIDENTIALITY NOTICE: This message is confidential and may be privileged. If you believe that this email has been sent to you in error, please reply to the sender that you received the message in error; then please delete this e-mail.

## Shammy Dennis

---

**From:** Shammy Dennis <sdennis@stratanm.com>  
**Sent:** Thursday, September 13, 2018 1:35 PM  
**To:** 'mintra.rickelman@percheronllc.com'  
**Subject:** Notice of Application for a salt water disposal  
**Attachments:** Notice of filed application.pdf

Good Afternoon Mintra,

Per our conversation, attached is a copy of the Application to drill a salt water disposal that was sent via certified return receipt on August 23, 2018 to your company. As of today we have not received confirmation whether or not it was received. If at all possible can you send an email confirming that you received the application for verification for our records as well as the New Mexico OCD.

Thank you so much for taking the time to assist me with this matter.

Sincerely,

*Shammy Dennis*

Administrative Support

1301 N. Sycamore Ave.

PO Box 1030

Roswell, NM 88202

Phone: (575) 622-1127 ext. 13

Fax: (575) 623-3533

Email: sdennis@stratanm.com



## SENDER: COMPLETE THIS SECTION

- Complete items 1, 2, and 3.
- Print your name and address on the reverse so that we can return the card to you.
- Attach this card to the back of the mailpiece, or on the front if space permits.

## 1. Article Addressed to:

Percheron Pro Services, LLC  
1904 W. Grand Parkway N #200  
Katy, TX 77449

9590 9402 2907 7094 1454 53

9171 9690 0935 0177 5809 82

## COMPLETE THIS SECTION ON DELIVERY

## A. Signature

X

- ☐ Agent  
☐ Addressee

## B. Received by (Printed Name)

## C. Date of Delivery

- D. Is delivery address different from item 1? ☐ Yes  
If YES, enter delivery address below: ☐ No

3. Service Type *SP #10 3430 P0N*

- |  |   |
|--|---|
| <input type="checkbox"/> Adult Signature                     | <input type="checkbox"/> Priority Mail Express®                     |
| <input type="checkbox"/> Adult Signature Restricted Delivery | <input type="checkbox"/> Registered Mail™                           |
| <input type="checkbox"/> Certified Mail®                     | <input type="checkbox"/> Registered Mail Restricted Delivery        |
| <input type="checkbox"/> Certified Mail Restricted Delivery  | <input type="checkbox"/> Return Receipt for Merchandise             |
| <input type="checkbox"/> Collect on Delivery                 | <input type="checkbox"/> Signature Confirmation™                    |
| <input type="checkbox"/> Delivery Restricted Delivery        | <input type="checkbox"/> Signature Confirmation Restricted Delivery |
| <input type="checkbox"/> Restricted Delivery                 |   |

PS Form 3811, July 2015 PSN 7530-02-000-9053

Domestic Return Receipt

[Home](#) > [Tracking](#) > Status History

## Status History ?

## Tracking Number Information

Meter:	11288732	Mailing Date:	08/24/18 02:42 PM
Tracking Number:	9171969009350177580975	Sender:	
Current Status:	OK : Delivered	Recipient:	
Class of Mail	FC	Zip Code:	79701
Service:	ERR	City:	MIDLAND
Value	\$0.890	State:	TX

## Proof of Delivery



## Status Details

## ▼ Status Date

## Status

Mon, 08/27/18, 02:57:00 PM

OK : Delivered

Sat, 08/25/18, 04:26:00 AM

OK: USPS acknowledges reception of info

Note: Delivery status updates are processed throughout the day and posted upon receipt from the Postal Service.

Rubicon Oil & Gas II LP  
508 West Wall Avenue, Suite 500  
Midland, TX 79701

Mailed: Aug. 24, 2018  
Delivered: Aug. 27, 2018



**SENDER: COMPLETE THIS SECTION**

- Complete items 1, 2, and 3.
- Print your name and address on the reverse so that we can return the card to you.
- Attach this card to the back of the mailpiece, or on the front if space permits.

**1. Article Addressed to:**

Rubicon Oil & Gas II LP  
508 West Wall Avenue, Suite 500  
Midland, TX 79701



9590 9402 2907 7094 1454 77

9171 9690 0935 0177 5809 75

**COMPLETE THIS SECTION ON DELIVERY**

**A. Signature**

X

☐ Agent

☐ Addressee

**B. Received by (Printed Name)**

**C. Date of Delivery**

**D. Is delivery address different from item 1?** ☐ Yes  
If YES, enter delivery address below: ☐ No

**3. Service Type**

- ☐ Adult Signature
- ☐ Adult Signature Restricted Delivery
- ☐ Certified Mail®
- ☐ Certified Mail Restricted Delivery
- ☐ Collect on Delivery

- ☐ Priority Mail Express®
- ☐ Registered Mail™
- ☐ Registered Mail Restricted Delivery
- ☐ Return Receipt for Merchandise
- ☐ Signature Confirmation™
- ☐ Signature Confirmation Restricted Delivery

PS Form 3811, July 2015 PSN 7530-02-000-9053

Domestic Return Receipt

## **McMillan, Michael, EMNRD**

---

**From:** McMillan, Michael, EMNRD  
**Sent:** Wednesday, September 19, 2018 8:34 AM  
**To:** sdennis@stratanm.com  
**Subject:** Sandy Federal SWD Well No. 10

Shammy:

Tell Paul that the OCD will require a produced water sample from the expected injection formations.

Thanks

Mike

Michael McMillan  
1220 South St. Francis  
Santa Fe, New Mexico  
505-476-3448  
Michael.mcmillan@state.nm.us

Sandy Federal SWD #10 - Water Analysis

Well Name	API	Section	Township	Range	Unit	Formation	TDS_mgL
Forty Niner Ridge SWD #6	3001533637	22	23S	30E	O	Delaware	198654.5
Forty Niner Ridge SWD #1	3001520899	16	23S	30E	J	Bone Springs	141674.9
Belloq 2 State #002H	3001542895	2	23S	31E	C	Wolfcamp	119471.8
Todd 26 G Federal #001	3001520242	26	23S	31E	G	Atoka	202478
Midwest L Federal Gas Com #001	3001520828	34	22S	26E	K	Morrow	179513



# APPLICATION PROTESTED

**APPLICANT:** Strata Production Company

**APPLICATION TYPE:** SUD

**WELL NAME:** Sandy Federal SUD #10

**API NUMBER:** 30-015-Pending

**ADMIN. APPL. NO.:** PMAN 18262 28780

**UL-S-T-R:** E-24-235-30E

**PROTESTANT:** Mewbourne Oil Company

**DATE PROTEST RECEIVED:** 10/8/2018

**DATE AND METHOD OF NOTIFICATION OF APPLICANT:**

E-mail 12-10-2018

**RESOLUTION:**

☐ Hearing

☐ Negotiated/Withdrawn

☐ Denied/Cancelled by Division

**NOTES/COMMENTS:**

**From:** Goetze, Phillip, EMNRD  
**Sent:** Monday, December 10, 2018 1:09 PM  
**To:** Shammy Dennis  
**Cc:** Paul Ragsdale; Michael Feldewert (mfeldewert@hollandhart.com); McMillan, Michael, EMNRD  
**Subject:** RE: [EXT] RE: Sandy Federal SWD #\$10 - Application  
**Attachments:** [EXT] Protest of Strata Production Sandy Federal SWD #10 Application (Application No. pMAM1826228780)

Ms. Dennis:

Mewbourne filed a protest of this application on October 8, 2018. Based on the e-mail record, a notice of protest was prepared but not forwarded. Attached is the record of notice from counsel that is representing Mewbourne in this matter. If Strata wishes for this application to be considered, they must either go to hearing or may be reviewed administratively if the protest is withdrawn as a result of a negotiated resolution with this party. The application will be retained pending resolution of the protest. Please continue to provide OCD with information regarding the standing of this application. Please me call with any questions on this matter and my apologies for any inconvenience the delay in notice has produced. PRG

Contact Information:

Mr. Michael Feldewert  
Attorney  
Holland and Hart LLP  
110 N. Guadalupe Street, Suite A  
Santa Fe NM  
505-988-1845-4421 (phone)

e-mail: Michael Feldewert [mfeldewert@hollandhart.com](mailto:mfeldewert@hollandhart.com)

Phillip Goetze, PG  
Engineering Bureau, Oil Conservation Division, NM EMNRD  
1220 South St. Francis Drive, Santa Fe, NM 87505  
Direct: 505.476.3466  
E-mail: [phillip.goetze@state.nm.us](mailto:phillip.goetze@state.nm.us)

---

**From:** Shammy Dennis <[sdennis@stratanm.com](mailto:sdennis@stratanm.com)>  
**Sent:** Friday, December 7, 2018 10:33 AM  
**To:** Goetze, Phillip, EMNRD <[Phillip.Goetze@state.nm.us](mailto:Phillip.Goetze@state.nm.us)>  
**Cc:** Paul Ragsdale <[pragsdale@stratanm.com](mailto:pragsdale@stratanm.com)>  
**Subject:** [EXT] RE: Sandy Federal SWD #\$10 - Application

Good Morning Mr. Goetze,

I just want to follow-up on the inquiry below.

Thanks

*Shammy Dennis*

Administrative Support

1301 N. Sycamore Ave.

PO Box 1030

Roswell, NM 88202

Phone: (575) 622-1127 ext. 13

Fax: (575) 623-3533

Email: [sdennis@stratanm.com](mailto:sdennis@stratanm.com)

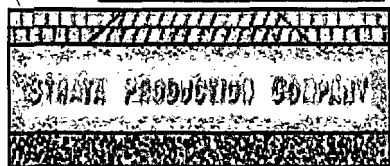

---

**From:** Shammy Dennis <[sdennis@stratanm.com](mailto:sdennis@stratanm.com)>

**Sent:** Wednesday, November 28, 2018 1:32 PM

**To:** 'phillip.goetze@state.nm.us' <[phillip.goetze@state.nm.us](mailto:phillip.goetze@state.nm.us)>

**Subject:** Sandy Federal SWD #\$10 - Application

Good Afternoon Mr. Goetze,

I hope you had a wonderful Thanksgiving Holiday.

I am just doing a follow-up to see where our C-108 application is in your process and if it will be approved within the next 2 weeks?

Thank you in advance for your timely response.

Sincerely,

*Shammy Dennis*

Administrative Support

1301 N. Sycamore Ave.

PO Box 1030

Roswell, NM 88202

Phone: (575) 622-1127 ext. 13

Fax: (575) 623-3533

Email: [sdennis@stratanm.com](mailto:sdennis@stratanm.com)

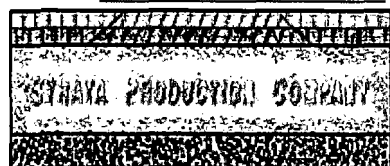

**From:** Michael Feldewert <MFeldewert@hollandhart.com>  
**Sent:** Monday, October 8, 2018 10:20 AM  
**To:** Goetze, Phillip, EMNRD  
**Cc:** Brooks, David K, EMNRD; Riley, Heather, EMNRD; Tim Harrington (tharrington@mewbourne.com)  
**Subject:** [EXT] Protest of Strata Production Sandy Federal SWD #10 Application (Application No. pMAM1826228780)

Mr. Goetze: Mewbourne Oil Company hereby protests the administrative application filed Strata Production for the Sandy Federal SWD #10 to be located 460' FWL and 2340' FNL in Unit E, Section 24, Township 23 South, Range 30 East in Eddy County, New Mexico.

---

**Michael H. Feldewert**  
Partner, Holland & Hart LLP  
110 N Guadalupe St, Suite A, Santa Fe, NM 87501  
T 505.988.4421

**HOLLAND&HART** 



**CONFIDENTIALITY NOTICE:** This message is confidential and may be privileged. If you believe that this email has been sent to you in error, please reply to the sender that you received the message in error; then please delete this e-mail.

## **Goetze, Phillip, EMNRD**

---

**From:** Sharon T. Shaheen <sshhaheen@montand.com>  
**Sent:** Wednesday, February 6, 2019 1:41 PM  
**To:** Michael Feldewert; Goetze, Phillip, EMNRD  
**Cc:** Brooks, David K, EMNRD  
**Subject:** [EXT] RE: Case No. 20209: Withdrawal of Mewbourne's Protest of Strata Production Sandy Federal SWD #10 Application (Application No. pMAM1826228780)

Mr. Goetze,

In light of Mr. Feldewert's email withdrawal of Mewbourne's application below, Strata asks that Case No. 20209 be dismissed and recommends that the application be remanded back to the administrative process for review under Rule 19.15.26.8(C). Thank you for your consideration of this matter.

**Sharon T. Shaheen**  
**Montgomery & Andrews, P.A.**  
**P. O. Box 2307**  
**Santa Fe, NM 87504-2307**  
**sshhaheen@montand.com**  
**(505) 986-2678 (direct)**  
**(505) 603-8307 (cell)**



**THIS MESSAGE CONTAINS INFORMATION WHICH MAY BE CONFIDENTIAL AND PRIVILEGED. UNLESS YOU ARE THE ADDRESSEE (OR AUTHORIZED TO RECEIVE FOR THE ADDRESSEE), YOU MAY NOT USE, COPY OR DISCLOSE TO ANYONE THE MESSAGE OR ANY INFORMATION CONTAINED IN THE MESSAGE. IF YOU HAVE RECEIVED THIS MESSAGE IN ERROR, PLEASE ADVISE THE SENDER BY REPLY E-MAIL TO sshhaheen@montand.com AND DELETE THE MESSAGE. THANK YOU.**

---

**From:** Michael Feldewert [mailto:MFeldewert@hollandhart.com]  
**Sent:** Tuesday, February 5, 2019 2:07 PM  
**To:** Goetze, Phillip, EMNRD <Phillip.Goetze@state.nm.us>  
**Cc:** Sharon T. Shaheen <sshhaheen@montand.com>; Brooks, David K, EMNRD <DavidK.Brooks@state.nm.us>  
**Subject:** Case No. 20209: Withdrawal of Mewbourne's Protest of Strata Production Sandy Federal SWD #10 Application (Application No. pMAM1826228780)

Mr. Goetze: Mewbourne hereby withdraws its protest of the application filed by Strata Production for the Sandy Federal SWD #10 set for hearing under Case No. 20209 and also specifically withdraws the attached October 4, 2018, Objection Letter pertaining to this well. Counsel for Strata Production has been copied with this notice. Thank you for your attention to this matter.

---

**Michael H. Feldewert**  
Partner, Holland & Hart LLP  
110 N Guadalupe St, Suite A, Santa Fe, NM 87501  
T 505.988.4421





CONFIDENTIALITY NOTICE: This message is confidential and may be privileged. If you believe that this email has been sent to you in error, please reply to the sender that you received the message in error; then please delete this e-mail.

---

**From:** Michael Feldewert

**Sent:** Monday, October 8, 2018 10:20 AM

**To:** 'Goetze, Phillip, EMNRD' <Phillip.Goetze@state.nm.us>

**Cc:** Brooks, David K, EMNRD <DavidK.Brooks@state.nm.us>; Riley, Heather, EMNRD <Heather.Riley@state.nm.us>; Tim Harrington (tharrington@mewbourne.com) <tharrington@mewbourne.com>

**Subject:** Protest of Strata Production Sandy Federal SWD #10 Application (Application No. pMAM1826228780)

Mr. Goetze: Mewbourne Oil Company hereby protests the administrative application filed Strata Production for the Sandy Federal SWD #10 to be located 460' FWL and 2340' FNL in Unit E, Section 24, Township 23 South, Range 30 East in Eddy County, New Mexico.

---

**Michael H. Feldewert**

Partner, Holland & Hart LLP

110 N Guadalupe St, Suite A, Santa Fe, NM 87501

T 505.988.4421

**HOLLAND&HART** 



CONFIDENTIALITY NOTICE: This message is confidential and may be privileged. If you believe that this email has been sent to you in error, please reply to the sender that you received the message in error; then please delete this e-mail.

## Goetze, Phillip, EMNRD

---

**From:** Michael Feldewert <MFeldewert@hollandhart.com>  
**Sent:** Tuesday, February 5, 2019 2:07 PM  
**To:** Goetze, Phillip, EMNRD  
**Cc:** Sharon T. Shaheen; Brooks, David K, EMNRD  
**Subject:** [EXT] Case No. 20209: Withdrawal of Mewbourne's Protest of Strata Production Sandy Federal SWD #10 Application (Application No. pMAM1826228780)  
**Attachments:** STRATA SANDY FEDERAL PROTEST LETTER.PDF

Mr. Goetze: Mewbourne hereby withdraws its protest of the application filed by Strata Production for the Sandy Federal SWD #10 set for hearing under Case No. 20209 and also specifically withdraws the attached October 4, 2018, Objection Letter pertaining to this well. Counsel for Strata Production has been copied with this notice. Thank you for your attention to this matter.

---

**Michael H. Feldewert**

Partner, Holland & Hart LLP  
110 N Guadalupe St, Suite A, Santa Fe, NM 87501  
T 505.988.4421

**HOLLAND&HART**



CONFIDENTIALITY NOTICE: This message is confidential and may be privileged. If you believe that this email has been sent to you in error, please reply to the sender that you received the message in error; then please delete this e-mail.

---

**From:** Michael Feldewert  
**Sent:** Monday, October 8, 2018 10:20 AM  
**To:** 'Goetze, Phillip, EMNRD' <Phillip.Goetze@state.nm.us>  
**Cc:** Brooks, David K, EMNRD <DavidK.Brooks@state.nm.us>; Riley, Heather, EMNRD <Heather.Riley@state.nm.us>; Tim Harrington (tharrington@mewbourne.com) <tharrington@mewbourne.com>  
**Subject:** Protest of Strata Production Sandy Federal SWD #10 Application (Application No. pMAM1826228780)

Mr. Goetze: Mewbourne Oil Company hereby protests the administrative application filed Strata Production for the Sandy Federal SWD #10 to be located 460' FWL and 2340' FNL in Unit E, Section 24, Township 23 South, Range 30 East in Eddy County, New Mexico.

---

**Michael H. Feldewert**

Partner, Holland & Hart LLP  
110 N Guadalupe St, Suite A, Santa Fe, NM 87501  
T 505.988.4421

**HOLLAND&HART**



CONFIDENTIALITY NOTICE: This message is confidential and may be privileged. If you believe that this email has been sent to you in error, please reply to the sender that you received the message in error; then please delete this e-mail.

**From:** Shammy Dennis <sdennis@stratanm.com>  
**Sent:** Thursday, April 18, 2019 8:57 AM  
**To:** McMillan, Michael, EMNRD  
**Cc:** Paul Ragsdale  
**Subject:** [EXT] FW: Strata Production Sandy Federal SWD Well No. 10  
**Attachments:** Sandy Federal SWD #10-Water Analysis spreadsheet.pdf

Good Morning Mr. McMillan,

Attached, please find the requested water analysis and the projected tops below.

Please let us know if any other information is needed.

Projected tops for the Lower Ms.: **14,900'**

Projected tops for the Based of Woodford/top of Devonian: **15,500'**

Projected tops for the Montoya: **16,640'**

Have a Wonderful Resurrection weekend.

Thanks

*Shammy Dennis*

Administrative Support

1301 N. Sycamore Ave.

PO Box 1030

Roswell, NM 88202

Phone: (575) 622-1127 ext. 13

Fax: (575) 623-3533

Email: [sdennis@stratanm.com](mailto:sdennis@stratanm.com)



---

**From:** Paul Ragsdale <pragsdale@stratanm.com>  
**Sent:** Tuesday, April 16, 2019 3:11 PM  
**To:** sdennis@stratanm.com  
**Subject:** Fwd: Strata Production Sandy Federal SWD Well No. 10

Sent from my iPhone

Begin forwarded message:

**Date:** April 16, 2019 at 3:06:16 PM MDT  
**To:** Paul Ragsdale <[pragsdale@stratanm.com](mailto:pragsdale@stratanm.com)>  
**Subject:** Strata Production Sandy Federal SWD Well No. 10

Paul:

Hope things are going good.

I am working on the Sandy Federal SWD Well No. 10.

I need the projected tops for the Lower Ms.

I need the projected tops for the Based of Woodford/top of Devonian

I need the projected tops for the Montoya

Thanks

Mike

Michael McMillan  
1220 South St. Francis  
Santa Fe, New Mexico  
505-476-3448  
[Michael.mcmillan@state.nm.us](mailto:Michael.mcmillan@state.nm.us)



**Pending Application for High-Volume Devonian Disposal Well  
C-108 Application for the Sandy Federal SWD No. 10 – Strata Production Company**

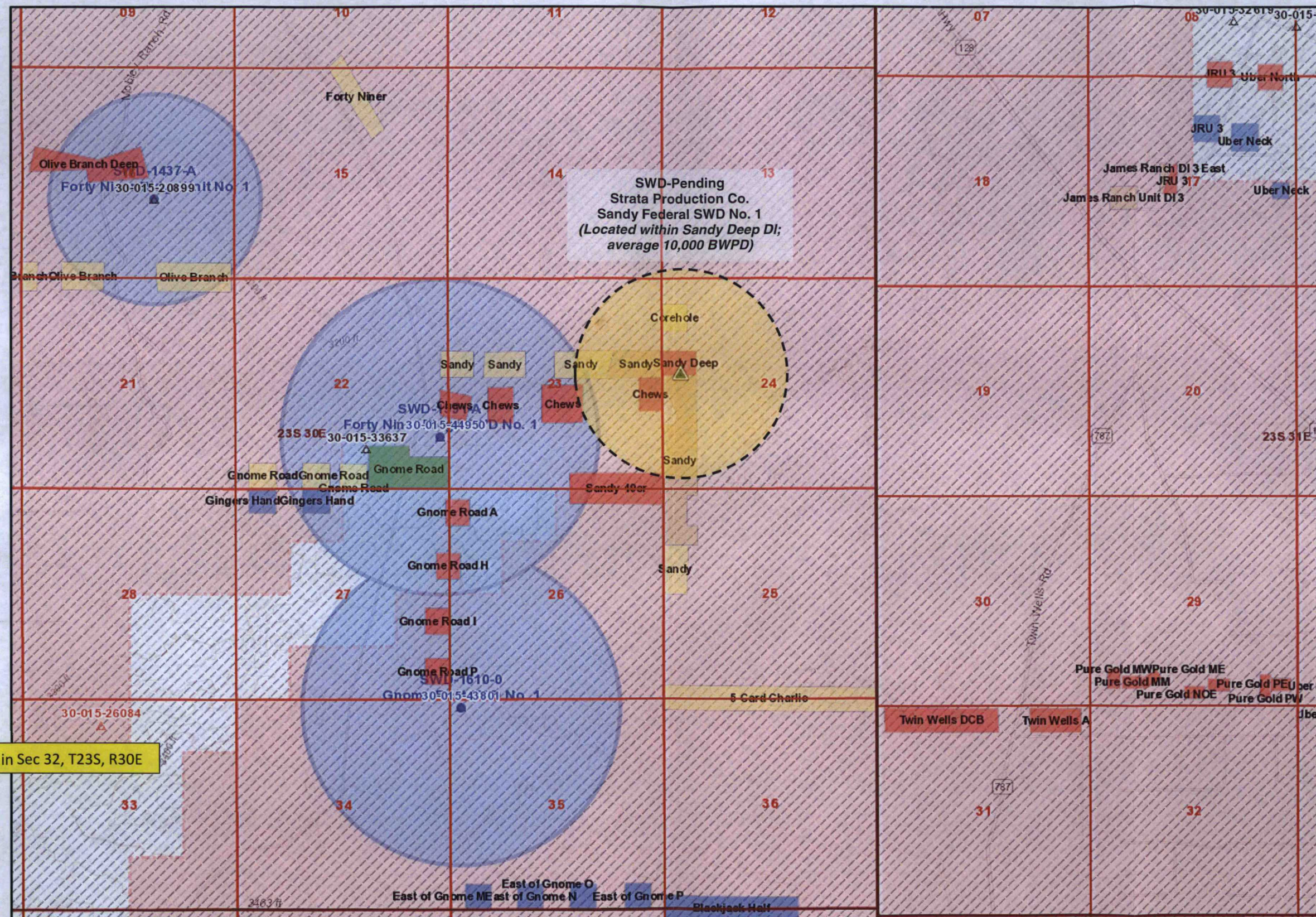

**Sandy Federal SWD No. 10; Strata Production Co.** [Case No. 20209; remanded to admin. review] API 30-015-pending; Application No. pMAM1826228780; Proposed interval: 15,450' to 16,500'

**Closest Large-Volume, Devonian Disposal Wells** Drilled, but not injecting: Gnome East SWD No. 1 (30-015-43801) Mesquite SWD Inc.; Approved permit/not drilled: Forty-Niner Ridge SWD No. 1 (30-015-44950) Mewbourne Oil Co.





**MEWBOURNE**  
**OIL COMPANY**

---

October 4, 2018

Oil Conservation Division  
Attn: Mr. Phillip Goetz  
1220 South St. Francis Drive  
Santa Fe, NM 87505

RE: Application of Strata Production for a Disposal Well Permit  
Sandy Federal SWD #10  
460' FWL, 2340' FNL, Unit Letter E  
Section 24, Township 23S, Range 30E  
Eddy County, TX

Dear Mr. Goetz:

Mewbourne Oil Company hereby protests the above referenced application of Strata Production for a Devonian salt water disposal permit. Attached is a map that highlights the location of this SWD application in respect to active, permitted and pending applications in the same formation. Mewbourne currently has an approved Devonian SWD permit (SWD: 1591A) that is located approximately 1.2 miles away from the subject well. The permitting and operation of the Sandy Federal SWD, at the current surface location, would create waste and endanger Mewbourne's correlative rights.

Please contact me if you have any questions.

Very truly yours,

Tim Harrington  
903-561-2900  
tharrington@mewbourne.com

Devonian / Silurian SWD Map With 1 Mile Radius Circles:

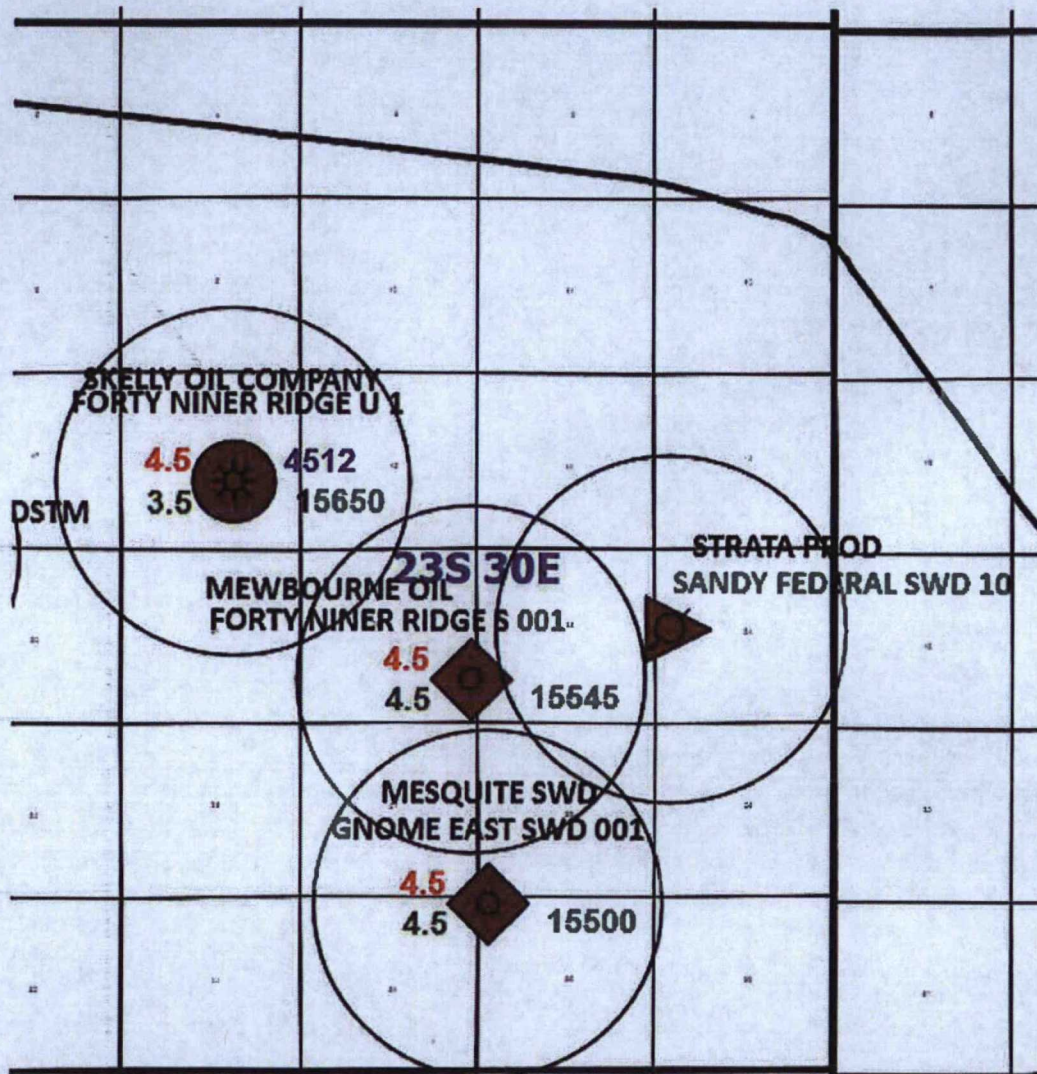

KEY

Circle = Active SWD

Triangle = SWD Application

Diamond = Approved SWD Permit

**STATE OF NEW MEXICO  
DEPARTMENT OF ENERGY, MINERALS AND NATURAL RESOURCES  
OIL CONSERVATION DIVISION**

**IN THE MATTER OF THE APPLICATION  
OF STRATA PRODUCTION COMPANY FOR  
AUTHORIZATION TO INJECT, EDDY  
COUNTY, NEW MEXICO.**

**CASE NO.** 20209

**APPLICATION**

Strata Production Company ("Strata" or "Applicant"), through its undersigned counsel, Montgomery & Andrews, P.A., applies pursuant to 19.15.26.8 NMAC for an order authorizing injection of oil field produced water for disposal into the Devonian formation, Forty Niner Ridge, Devonian SWD pool (96100), in Eddy County, New Mexico. In support of its Application, Strata states as follows:

1. Applicant is the operator of the Sandy Federal SWD #10 well at a surface location 2,430 feet from the North line and 460 feet from the West line of Section 24, Unit E, Township 23 South, Range 30 East, Eddy County, New Mexico
2. Applicant proposes to drill the Sandy Federal SWD #10 to a depth of approximately 16,500 feet. Strata proposes to complete the well for injection of oil field produced water into the non-commercial Devonian formation at depths between 15,545 and 16,500 feet.
3. Applicant proposes to conduct injection operations through the well at an anticipated average injection pressure of 2,000 psi and maximum injection pressure of 3,120 psi. Applicant proposes injection volumes between 3,000 and 15,000 barrels per day with an average volume of 10,000 barrels per day. The source of injected fluids will be from Strata wells in the area as well as other operated Delaware and Bone Spring wells in the area.



4. Applicant's proposed injection operation can be conducted in a safe and responsible manner without causing waste, impairing correlative rights, or endangering fresh water, public health, or the environment.

5. Applicant filed its original request for administrative approval with the Oil Conservation Division on September 13, 2018. The Oil Conservation Division received a written objection, so the matter must be set for hearing pursuant to 19.15.26.8(D) NMAC, with notice given by the Oil Conservation Division.

6. Attached hereto as Exhibit A is the original application.

WHEREFORE, Strata requests that this Application be set for hearing before a duly appointed examiner of the Oil Conservation Division on January 24, 2019, and that after notice and hearing as required by law, the Oil Conservation Division enter its Order approving the utilization of the Sandy Federal SWD #10 for injection of oil field produced water into the Devonian formation at the intervals, pressures, volumes, and rates indicated, and making such other and further provisions as the Division determines is appropriate.

Respectfully submitted,

MONTGOMERY & ANDREWS, P.A.

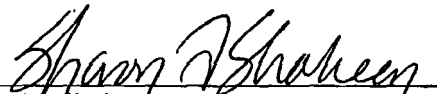
By:   
Sharon T. Shaheen  
Kaleb W. Brooks  
P.O. Box 2307  
Santa Fe, New Mexico 87504  
(505) 982-3873  
[sshaheen@montand.com](mailto:sshaheen@montand.com)  
[kwbrooks@montand.com](mailto:kwbrooks@montand.com)

*Attorneys for Strata Production Company*