

INFILL DRILLING FINDINGS PURSUANT TO
SECTION 271.305(b) OF THE FEDERAL ENERGY REGULATORY
COMMISSION REGULATIONS, NATURAL GAS POLICY ACT OF 1978
AND OIL CONSERVATION DIVISION ORDER NO. R-6013-A

I.

Operator Doyle Hartman Well Name and No. State "A" 20 Well No. 4
Location: Unit J Sec. 20 Twp. 20-S Rng. 37-E Cty. Lea

II.

THE DIVISION FINDS:

- (1) That Section 271.305(b) of the Federal Energy Regulatory Commission Regulations promulgated pursuant to the Natural Gas Policy Act of 1978 provides that, in order for an infill well to qualify as a new onshore production well under Section 103 of said Act, the Division must find that the infill well is necessary to effectively and efficiently drain a portion of the reservoir covered by the proration unit which cannot be so drained by any existing well within that unit.
- (2) That by Order No. R-6013-A, dated February 8, 1980, the Division established an administrative procedure whereby the Division Director and the Division Examiners are empowered to act for the Division and find that an infill well is necessary.
- (3) That the well for which a finding is sought is completed in the Eumont Yates Seven Rivers Queen (Gas) Pool, and the standard spacing unit in said pool is 640 acres.
- (4) That a 160 -acre proration unit comprising the SE/4 of Sec. 20, Twp. 20S, Rng. 37E, is currently dedicated to the Doyle Hartman State "A" 20 Well No. 1 located in Unit I of said section.
- (5) That this proration unit is () standard (X) nonstandard; if nonstandard, said unit was previously approved by Order No. NSP-75.
- (6) That said proration unit is not being effectively and efficiently drained by the existing well(s) on the unit.
- (7) That the drilling and completion of the well for which a finding is sought should result in the production of an additional 384,700 MCF of gas from the proration unit which would not otherwise be recovered.
- (8) That all the requirements of Order No. R-6013-A have been complied with, and that the well for which a finding is sought is necessary to effectively and efficiently drain a portion of the reservoir covered by said proration unit which cannot be so drained by any existing well within the unit.
- (9) That in order to permit effective and efficient drainage of said proration unit, the subject application should be approved.

IT IS THEREFORE ORDERED:

- (1) That the applicant is hereby authorized to drill the well described in Section I above as an infill well on the existing proration unit described in Section II(4) above. The authorization for infill drilling granted by this order is necessary to permit the drainage of a portion of the reservoir covered by said proration unit which cannot be effectively and efficiently drained by any existing well thereon.
- (2) That jurisdiction of this cause is retained for the entry of such further orders as the Division may deem necessary.

DONE at Santa Fe, New Mexico, on this 5th day of August, 19 82.



DIVISION DIRECTOR

EXAMINER

DOYLE HARTMAN

Oil Operator
500 N. MAIN
P. O. BOX 10426
MIDLAND, TEXAS 79702
(915) 684-4011

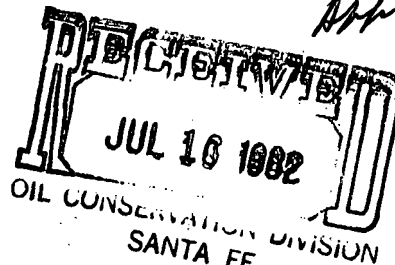
July 13, 1982



State of New Mexico
Energy and Minerals Department
Oil Conservation Division
Post Office Box 2088
Santa Fe, New Mexico 87501

Attention: Mr. R. L. Stamets

*Bill Carr called
7/21/82, held application
til advised.*

*NSP
75*

-7041-

Re: Administrative Procedure
Infill Finding
State "A" 20 No. 4
Section 20, T-20-S, R-37-E
at 1450' FSL & 1980' FEL
Lea County, New Mexico

Gentlemen:

Pursuant to Section 271.305 of the Final Rules and Regulations of the Federal Energy Regulatory Commission relating to Section 103 of the Natural Gas Policy Act of 1978, and to Order R-6013-A of the New Mexico Oil Conservation Division, we hereby request an infill finding (NFL) for the above captioned State "A" 20 No. 4 located 1450' FSL & 1980' FEL Section 20, T-20-S, R-37-E, Lea County, New Mexico.

With regard to our request, and in accordance with Order R-6013-A, we submit the following:

- Rule 5 A copy of approved Form C-101 for the infill well and Form C-102 showing the proration unit dedicated to the well are enclosed.
- Rule 6 The name of the pool in which the infill well has been drilled is Eumont Pool, and the standard spacing unit therefor is 640 acres.
- Rule 7 The number of the Division order approving the non-standard proration unit dedicated to the well is SD-82-2. *NSP #75*
- Rule 8 Table 1 attached to William P. Aycock's letter dated July 13, 1982 shows the following:
- lease name and well location;
 - spud date;
 - completion date;

- d. a description of any mechanical problems experienced along with a summary of remedial action(s) taken and the results obtained;
- e. the current rate of production, and;
- f. date of plug and abandonment, if any, and;
- g. a clear and concise statement indicating why the existing well(s) on the proration unit cannot effectively and efficiently drain the portion of the reservoir covered by the proration unit.

Rule 9

Letter dated July 13, 1982 from William P. Aycock submits geological and engineering information sufficient to support a finding as to the necessity for an infill including:

- a. formation structure map;
- b. the volume of increased ultimate recovery expected to be obtained and a narrative describing how the increase was determined;
- c. any other supporting data which the applicant deems to be relevant which may include:
 - 1. porosity and permeability factors
 - 2. production/pressure decline curve
 - 3. effects of secondary recovery or pressure maintenance operations
 - 4. C-104 and C-105 (including Inclination Report)
 - 5. Completion Report and Well Log for State "A-20" No. 4 (Infill Well)
 - 6. Completion Report and Well Log for State "A-20" No. 1 (Original Well)
 - 7. Proof of casing leak for State "A-20" No. 3
 - 8. Proof of casing leak for State "A-20" No. 2
 - 9. Lease plat describing location of wells with casing leaks.

Rule 10

This application for infill finding is being filed in duplicate with the Santa Fe office of the Division.

Rule 11

All operators of proration or spacing units offsetting the unit for which an infill finding is sought have been notified of this application by certified or registered mail.

We respectfully request that the Commission grant our request for an infill finding pursuant to Order R-6013-A.

Very truly yours,

DOYLE HARTMAN

Becky Eichinger,
Administrative Assistant

/be
Enclosures as above

WILLIAM P. AYCOCK & ASSOCIATES, INC.

Petroleum Engineering Consultants
308 WALL TOWERS WEST
MIDLAND, TEXAS 79701
PHONE 915/683-5721

July 13, 1982

New Mexico Department of Energy and Minerals,
Oil Conservation Division
P. O. Box 2088
Santa Fe, New Mexico 87501

Attention Mr. R. L. Stamets, Technical Support Chief

Subject: Administrative Application for
Infill Well Finding, Doyle
Hartman St. "A" 20 No. 4 Well,
Section 20, Twp. 20 South,
Range 37 East @ 1450' FSL &
1980' FEL, Eumont (Gas) Pool
Lea County, New Mexico

Gentlemen:

Application is hereby made for an administrative infill well finding effective with initial gas deliveries for the described well in accordance with Exhibit "A", Order R-6013-A. The following are the requirements of this order:

- Rule 5: Attached are copies of Forms C-101 and C-102
- Rule 6: The name of the pool in which the infill well has been drilled is the Eumont Pool, and the standard spacing therefor is 640 acres.
- Rule 7: This lease was acquired by Doyle Hartman on April 20, 1982. The 160-acre non-standard proration unit already existed when the lease was acquired by Mr. Hartman, and the Eumont Pool rights were assigned to the Doyle Hartman (BWP, Inc.) St. "A" 20, No. 1 well. This well is located in Unit I at 1980' FSL and 660' FEL of Section 20, Twp. 20 South, Range 37 East. By letter dated April 29, 1982, Mr. Hartman applied for administrative approval to drill the well at the location 1450' FSL and 1980' FEL and to simultaneously dedicate the 160 acre proration unit to the existing St. "A" 20 No. 1 well and the proposed St. "A" 20 No. 4 well. This request was granted by Administrative Order No. SD-82-2, dated May 6, 1982, a copy of which is attached

hereto; however, it was subsequently realized that the proposed location was unorthodox by virtue of Rule 104B, II(a). Accordingly, Case No. 7618 was held on June 23, 1982, but the advertisement for Case 7618 included only the unorthodox well location and omitted the simultaneous dedication. Case No. 7618 has been readvertised for the July 21, 1982, docket to include simultaneous dedication; and, since there was no opposition at the June 23, 1982, hearing and all of the affected offsetting operators waived opposition to the administrative application, it is anticipated that the application of Case 7618 will be approved. In order to facilitate consideration of this request, it is being submitted without the approving order. As soon as the order has been rendered, a copy of the order will be then attached to this application.

Rule 8: See attached Table No. 1, "Summary of Required Information, Rule 8, Exhibit "A", Order No. R-6013-A" for requirements "a." through "f." Section "g." requires "a clear and concise statement indicating why the existing well(s) on the proration unit cannot effectively and efficiently drain the portion of the reservoir covered by the proration unit". Analysis of the available data for the preexisting Doyle Hartman (BWP, Inc.) St. "A" 20 No. 1 indicates that, as of May 1, 1982, the remaining estimated gas recovery to an economic limit of production of 500 MCF per month, was 235 MMCF, while the remaining gas in place for the effective drainage area was 791 MMCF. The remaining gas recovery factor of $235/791$ (0.297) is substantially lower than expected for the Eumont Pool, Queen/Penrose, gas reservoirs, indicating that the existing well cannot drain the remaining gas reserves either efficiently or effectively. The degree of ineffective drainage for the Doyle Hartman St. "A" 20 No. 1 can be illustrated by comparing the estimated remaining gas recovery factor of 0.297 to the estimated gas recovery factor of 0.866 for the new Doyle Hartman St. "A" 20 No. 4. There are two probable reasons for the estimated inefficient and ineffective drainage of the remaining gas reserves by the Hartman St. "A" 20 No. 1; these reasons are:

1. Failure of the Doyle Hartman St. "A" 20 No. 1 well to complete through the entire Penrose sand vertical section, and
2. Stimulation of the Doyle Hartman St. "A" 20 No. 1 well with only 500 gallons of acid, rather than with a hydraulic fracture treatment of manyfold larger volume.

The Hartman St. "A" 20 No. 1 well was perforated from 3415 to 3510 feet, of which 95-foot thick interval only the lower 90 feet is probably within the Penrose sand; the Hartman St. "A" 20 No. 4 well was perforated from 3426 to 3503 feet with 21 jets, and all of this 157-foot interval is within the vertical Penrose sand interval. While the Hartman St. "A" 20 No. 1 well was stimulated with only 500 gallons of acid, the Hartman St. "A" 20 No. 4 well was stimulated with 5600 gallons and 88,200 gallons of fracture fluid containing 179,000 pounds of sand. Since both the BWP, Inc. St. "A" 20 No. 2 (abandoned Eunice Monument Pool producer in Unit J of Section 20, Twp. 20 South, Range 37 East) and the BWP, Inc. St. "A" No. 3 (abandoned Eunice Monument Pool producer located in Unit O of Section 20, Twp. 20 South, Range 37 East) were prematurely abandoned due to the occurrence of casing leaks that occurred at depths of 634 feet and 280 feet, respectively, the risk associated with attempted workover and restimulation of the St. "A" 20 No. 1 is substantial that the well would be lost after expenditures of as much as one-third of the cost of a new well. Accordingly, the drilling and completion of a new well is a more prudent and risk- and cost-effective method of efficiently and effectively draining the remaining gas reserves than would be a workover attempt on the St. "A" 20 No. 1.

Rule 9: Sec. a. Requires that a formation structure map be submitted; attached is a formation structure map of the Penrose formation for a portion of the Eumont Pool that includes the Doyle Hartman St. "A" 20 lease.

Sec. b. Requires that the "volume of increased ultimate recovery expected to be obtained and a narrative describing how the increase was

determined" be submitted. The increased ultimate recovery for the Doyle Hartman St. "A" 20 No. 4 is estimated to be between 450 and 310 MMCF.

The Hartman St. "A" 20 No. 1 well had produced 3109.9 MMCF of gas as of May 1, 1982, and extrapolation of this well's production performance to an experience dictated economic limit of production of 500 MCF/month indicates that the estimated ultimate gas recovery for this well is 3351.3 MMCF. As of June 19, 1982, (the completion date of the Hartman St. "A" 20 No. 4) the Hartman St. "A" 20 No. 1 should have produced an estimated accumulative gas volume of 3116.6 MMCF, so the remaining gas-in-place within the effective drainage area on June 19, 1982, is 3908 MMCF less 3116.6 MMCF, or 791.4 MMCF. The estimated remaining gas recovery for the Hartman St. "A" 20 No. 1 on June 19, 1982, is 3351.3 MMCF less 3116.6 MMCF, or 234.7 MMCF. The gas recovery factor for the Hartman St. "A" 20 No. 1 for the remaining reserves is then the ratio of 234.7 MMCF and 791.4 MMCF, or 0.297. Analysis of the C-105 test for the Hartman St. "A" 20 No. 4 yields the following:

Stabilized Deliverability Coefficient, MCF/day/psia ²	0.011863
Initial Stabilized Shut-in Pressures, psia	
Wellhead	322.4
Subsurface @ 3500-ft. Depth	350.2
Estimated Stabilized Shut-in Pressure for Economic Limit of 500 MCF/ Month Deliverd @ 25.0 psia, psia	44.8
Estimated Gas Recovery Factor, Fraction of Gas-in-Place at June 19, 1982, to Estimated Economic Limit of 500 MCF/Month @ 25 psia	0.866
Estimated Increased Ultimate Gas Recovery: (0.866 - 0.297)(791.4)	450.3 MMCF

Alternately, the well logs for the Hartman St. "A" 20, No. 4 were analyzed, yielding the following results:

Mean Porosity, Fcn of Bulk Vol.	0.140
Mean Connate Water Saturation, Fcn of Net Effective Pore Vol.	0.286
Net Effective Pay Thickness, Feet	46
Gross Pay Thickness, Feet	128
Ratio, Net Effective Pay to Gross Pay	0.359
Original Gas-in-Place, MMCF/Acre	4.47
MMCF/80 Acres	357.6
MMCF/160 Acres	715.2
Estimated Gas Recovery Factor, Fcn of Original Gas-in-Place	0.866
Estimated Ultimate Recovery MMCF/80 Acres	309.7
MMCF/160 Acres	619.4

Assuming that the Hartman St. "A" 20 No. 1 and the Hartman St. "A" 20 No. 4 each effectively and efficiently drain one-half of the 160-acre proration unit, the increased ultimate recovery is then 309.7 MMCF; if the assumption is made that both wells jointly efficiently and effectively drain the 160-acre proration unit, the increased ultimate recovery is the difference in 619.4 MMCF and 234.7 MMCF, which is 384.7 MMCF.

Sec. c. Other supporting data submitted, some of which were presented as exhibits in Case No. 7618 on June 23, 1982:

Gas Production History Tabulation and Graph for the Preexisting Hartman St. "A" 20 No. 1 Well

Complete O.C.D. Forms on File for Both the Hartman St. "A" 20 Nos. 1 and 4 wells

New Mexico Oil Conservation Division Order
No. SD-82-2

New Mexico Department of Energy and Minerals,
July 13, 1982
Page 6

Well Log Inserts with Completion Information
for Both the Hartman St. "A" 20 Nos. 1 and 4

We believe that the above adequately documents this application,
but we should be pleased to furnish anything else which you might
require in this connection.

Very truly yours,

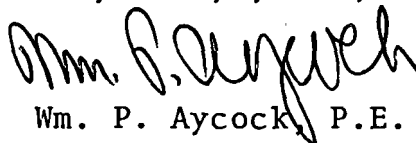
Wm. P. Aycock, P.E.

WPA/bw

Attachments

TABLE NO. 1.

SUMMARY OF REQUIRED INFORMATION, RULE 8, EXHIBIT "A", ORDER R-6013-A,
(SECTIONS "a." THROUGH "f.")

NATURAL GAS POLICY ACT INFILL FINDINGS, ADMINISTRATIVE PROCEDURE

<u>SECTION OF RULE 8</u>	<u>RULE 8 REQUIREMENT</u>	<u>PREEXISTING WELL DOYLE HARTMAN (BWP, INC.), OPERATOR</u>	<u>INFILL APPLICATION WELL DOYLE HARTMAN, OPERATOR</u>
a.	Lease Name and Well Location	St. "A" 20, No. 1 1980' FSL & 660' FEL	St. "A" 20, No. 4 1450' FSL & 1980' FEL
b.	Spud Date	July 15, 1937	June 5, 1982
c.	Completion Date	November 15, 1954	June 19, 1982
d.	Mechanical Problems	None; however, BWP, Inc. St. "A" 20 Nos. 2 & 3 pre- maturely abandoned due to casing leaks	None
e.	Current Rate of Production	125 MCF/day in Jan. 1982	C-105: 234 MCF/day
f.	Date of Plug and Abandonment	Not Plugged	Not Plugged

NO. OF COPIES RECEIVED	
DISTRIBUTION	
SANTA FE	
FILE	
U.S.G.S.	
LAND OFFICE	
OPERATOR	

NEW MEXICO OIL CONSERVATION COMMISSION

30-025-27816

Form C-101
Revised 1-1-65

5A. Indicate Type of Lease STATE <input checked="" type="checkbox"/> FEE <input type="checkbox"/>
5. State Oil & Gas Lease No. B-2656
7. Unit Agreement Name
6. Farm or Lease Name State A-20
9. Well No. 4
10. Field and Pool, or Wildcat Eumont (Gas)
12. County Lea

APPLICATION FOR PERMIT TO DRILL, DEEPEN, OR PLUG BACK					
1. Type of Work Type of Well DRILL <input checked="" type="checkbox"/> DEEPEN <input type="checkbox"/> PLUG BACK <input type="checkbox"/> GIL WELL <input type="checkbox"/> GAS WELL <input checked="" type="checkbox"/> OTHER <input type="checkbox"/> SINGLE ZONE <input checked="" type="checkbox"/> MULTIPLE ZONE <input type="checkbox"/>					
2. Name of Operator Doyle Hartman					
3. Address of Operator P. O. Box 10426 Midland, Texas 79702					
4. Location of Well UNIT LETTER J LOCATED 1450 FEET FROM THE South LINE 1980 FEET FROM THE East LINE OF SEC. 20 TWP. 20S RGE. 37E NMPM					

15. Proposed Depth 4000	19A. Formation Queen (Penrose)	20. Rotary or P.T. Rotary
21A. Rind & Status Plug. Bond Multi-Approved	21B. Drilling Contractor Kenai	22. Approx. Date Work will start May 1982

PROPOSED CASING AND CEMENT PROGRAM

SIZE OF HOLE	SIZE OF CASING	WEIGHT PER FOOT	SETTING DEPTH	SACKS OF CEMENT	EST. TOP
12 1/4	9 5/8	36.0	400	300	Surface
8 3/4	7	23.0	4000	800	Surface

The proposed well will be drilled to a total depth of 4000 feet and will be completed as a Eumont (Queen-Penrose) gas producer. From the base of the surface pipe through the running of the production casing, the well will be equipped with a 3000-psi double ram BOP system.

NOTE: Any gas produced from the proposed well has previously been dedicated to El Paso Natural Gas Company.

* Survey of location has not been completed.

APPROVAL VALID FOR 180 DAYS
PERMIT EXPIRES 12/4/82
UNLESS DRILLING UNDERWAY

ABOVE SPACE DESCRIBE PROPOSED PROGRAM: IF PROPOSAL IS TO DEEPEN OR PLUG BACK, GIVE DATA ON PRESENT PRODUCTIVE ZONE AND PROPOSED NEW PRODU-
C ZONE. GIVE BLOWOUT PREVENTER PROGRAM, IF ANY.

hereby certify that the information above is true and complete to the best of my knowledge and belief.

and Jerry G. Sexton Title Engineer Date April 13, 1982

(This space for State Use)

ORIGINAL SIGNED BY

JERRY SEXTON

PROVED BY _____ TITLE _____ DATE JUN 4 1982

CONDITIONS OF APPROVAL, IF ANY:

No allowable will be assigned for this well until approval is obtained for the unorthodox location.

NEW MEXICO OIL CONSERVATION COMMISSION
WELL LOCATION AND ACREAGE DEDICATION PLAT

Form O-102
 Superseded L-128
 Effective 1-1-65

All distances must be from the outer boundaries of the Section

Operator Dolye Hartman			Lease State A-20		Well No. 4
Unit J	Section 20	Township 20 South	Range 37east	County Lea	
Actual Footage Location of Well: 1450 feet from the South line and 1980 feet from the East line					
Ground Level Elev. 3515.0	Producing Formation Queen-Penrose		Pool Eumont (Gas)	Dedicated Acreage 160	

1. Outline the acreage dedicated to the subject well by colored pencil or hachure marks on the plat below.
2. If more than one lease is dedicated to the well, outline each and identify the ownership thereof (both as to working interest and royalty).
3. If more than one lease of different ownership is dedicated to the well, have the interests of all owners been consolidated by communitization, unitization, force-pooling, etc?

☐ Yes ☐ No If answer is "yes," type of consolidation _____

If answer is "no," list the owners and tract descriptions which have actually been consolidated. (Use reverse side of this form if necessary.) _____

No allowable will be assigned to the well until all interests have been consolidated (by communitization, unitization, forced-pooling, or otherwise) or until a non-standard unit, eliminating such interests, has been approved by the Commission.

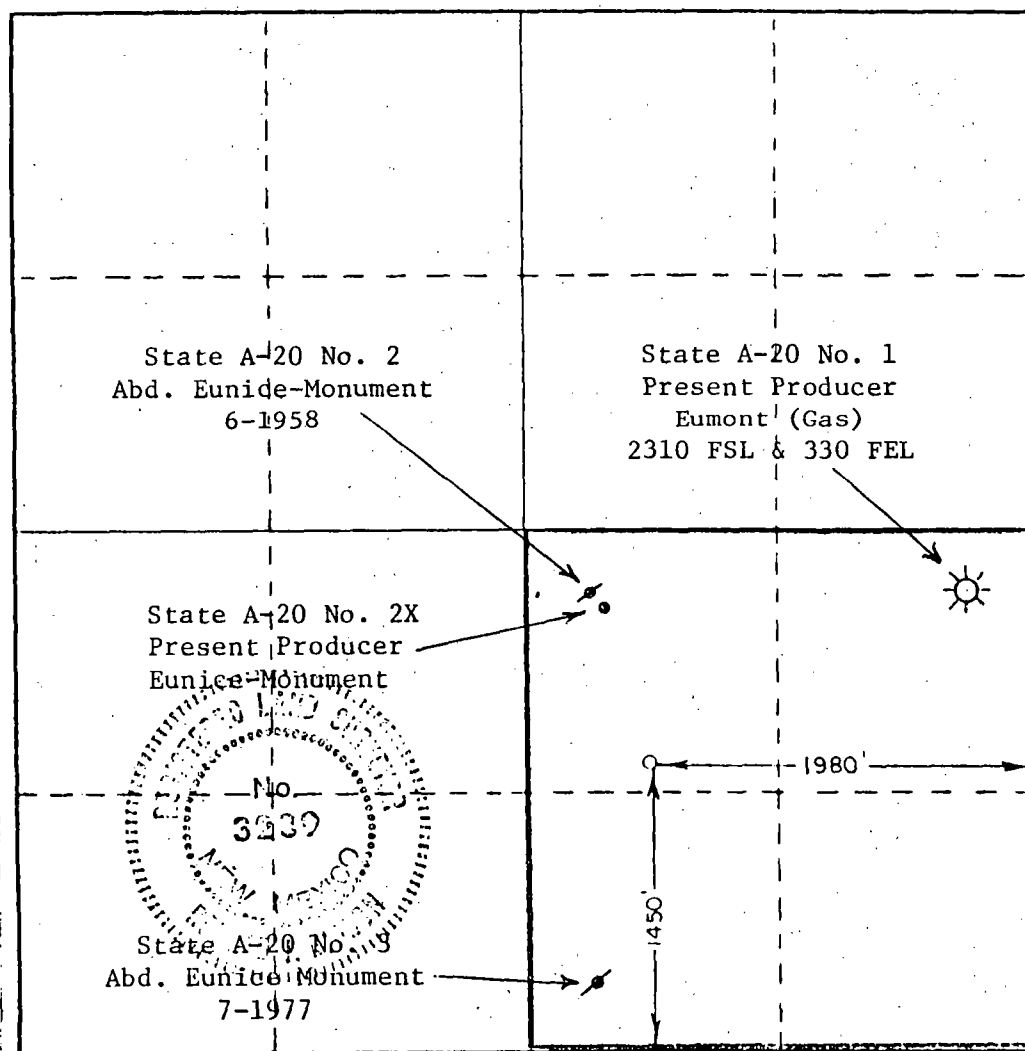

CERTIFICATION

I hereby certify that the information contained herein is true and complete to the best of my knowledge and belief.

Larry A. Nermyr

Name

Larry A. Nermyr

Position

Engineer

Company

Doyle Hartman

Date

April 30, 1982

I hereby certify that the well location shown on this plat was plotted from field notes of actual surveys made by me or under my supervision, and that the same is true and correct to the best of my knowledge and belief.

Date Surveyed

5 - 1 - 82

Registered Professional Engineer and/or Land Surveyor

Ronald J. Eidson

Certificate No. **JOHN V. WEST 678**
PATRICK A. ROMERO 6665
Ronald J. Eidson 3239



STATE OF NEW MEXICO
ENERGY AND MINERALS DEPARTMENT
OIL CONSERVATION DIVISION

BRUCE KING
GOVERNOR

LARRY KEHOE
SECRETARY

May 6, 1982

POST OFFICE BOX 2088
STATE LAND OFFICE BUILDING
SANTA FE, NEW MEXICO 87501
(505) 827-2434

Doyle Hartman
P. O. Box 10426
Midland, Texas 79702

Attention: Larry A. Nermyr

Administrative Order SD-82-2

Gentlemen:

You are hereby authorized to simultaneously dedicate a previously approved 160-acre proration unit comprising the SE/4 of Section 20, Township 20 South, Range 37 East, NMPM, to your State A-20 Well No. 1 located in Unit I and your State A-20 Well No. 4 located in Unit J of said Section 20, both in Township 20 South, Range 37 East, NMPM, Lea County, New Mexico.

Further, you are hereby permitted to produce the allowable from any of the wells on the proration unit in any proportion.

Sincerely,

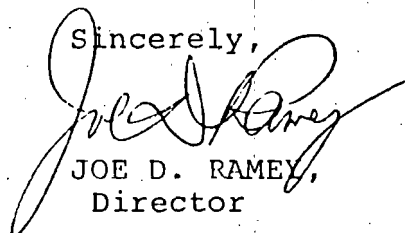

JOE D. RAMEY,
Director

JDR/RLS/dr

cc: Oil Conservation Division - Hobbs
Oil & Gas Engineering Committee - Hobbs
Oil & Gas Division - State Land Office - Santa Fe

Application for Non-Standard
location on the State "A" 20 #4
was covered under NMOCD Case No.
7618 which was held before Daniel
S. Nutter on Wednesday, June 23,
1982, Case #7618 is presently being
re-advertised in the Notice for
Docket 24-82

MAY 13 1982

Dockets Nos. 25-82 and 26-82 are tentatively set for August 4 and August 18, 1982. Applications for hearing must be filed at least 22 days in advance of hearing date.

DOCKET: EXAMINER HEARING - WEDNESDAY - JULY 21, 1982

9 A.M. - MORGAN HALL, OIL CONSERVATION DIVISION,
STATE LAND OFFICE BUILDING, SANTA FE, NEW MEXICO.

The following cases will be heard before Daniel S. Nutter, Examiner, or Richard L. Stamets, Alternate Examiner.

ALLOWABLE: (1) Consideration of the allowable production of gas for August, 1982, from fifteen prorated pools in Lea, Eddy, and Chaves Counties, New Mexico.

(2) Consideration of the allowable production of gas for August, 1982, from four prorated pools in San Juan, Rio Arriba, and Sandoval Counties, New Mexico.

CASE 7560: (Continued from July 7, 1982, Examiner Hearing)

In the matter of the hearing called by the Oil Conservation Division on its own motion to permit Charles H. Heisen, Fidelity and Deposit Company of Maryland, Surety, and all other interested parties to appear and show cause why the Crownpoint Well No. 1, located in Unit F, Section 18, Township 18 North, Range 13 West, McKinley County, should not be plugged and abandoned in accordance with a Division-approved plugging program.

CASE 7599: (Continued from June 9, 1982, Examiner Hearing)

Application of Barber Oil Inc. for an Exception to Rule 705-A Eddy County, New Mexico. Applicant, in the above-styled cause, seeks an exception to the provisions of Rule 705-A of the Division Rules and Regulations to permit 37 temporarily abandoned injection wells in its Russell Pool waterflood project to remain inactive for a period of up to three years without the required cement or bridge plugs being installed therein to isolate the injection zone.

CASE 7622: Application of El Ran, Inc. for a waterflood project, Chaves County, New Mexico.

Applicant, in the above-styled cause, seeks authority to institute a waterflood project in the Chaveroo-San Andres Pool by the injection of water into the perforated interval from 4169 feet to 4276 feet in its U. S. Well No. 1, located in Unit N of Section 34, Township 7 South, Range 32 East.

CASE 7516: (Continued from May 12, 1982, Examiner Hearing)

Application of Benson-Montin-Greer for a unit agreement, Rio Arriba County, New Mexico. Applicant, in the above-styled cause, seeks approval for the North Canada Ojitos Unit Area, comprising 12,361 acres, more or less, of Jicarilla Apache Indian lands in Township 27 North, Range 1 West.

CASE 7623: Application of C & K Petroleum, Inc. for compulsory pooling, Lea County, New Mexico.

Applicant, in the above-styled cause, seeks an order pooling all mineral interests in the Abo formation underlying the SE/4 SE/4 of Section 28, Township 16 South, Range 37 East, to be dedicated to a well to be drilled at a standard location thereon. Also to be considered will be the cost of drilling and completing said well and the allocation of the cost thereof as well as actual operating costs and charges for supervision, designation of the applicant as operator of the well, and a charge for risk involved in drilling said well.

CASE 7620: (Continued from July 7, 1982, Examiner Hearing)

Application of Mesa Petroleum Company for compulsory pooling, Chaves County, New Mexico. Applicant, in the above-styled cause, seeks an order pooling all mineral interests in all formations from the surface through the base of the Abo formation underlying the SW/4 of Section 8, Township 5 South, Range 25 East, to be dedicated to a well to be drilled at a standard location thereon. Also to be considered will be the cost of drilling and completing said well and the allocation of the cost thereof as well as actual operating costs and charges for supervision, designation of applicant as operator of the well and a charge for risk involved in drilling said well.

JUL 12 1982

CASE 7624: Application of John Yuronka for an unorthodox gas well location and compulsory pooling, Lea County, New Mexico. Applicant, in the above-styled cause, seeks an order pooling all mineral interests in the Jalma Gas Pool underlying the SW/4 of Section 31, Township 22 South, Range 37 East, to form a non-standard gas proration unit to be dedicated to a well to be drilled at an unorthodox location 990 feet from the South line and 330 feet from the West line of said Section 31. Also to be considered will be the cost of drilling and completing said well and the allocation of the cost thereof as well as actual operating costs and charges for supervision, designation of applicant as operator of the well, and a charge for risk involved in drilling said well.

CASE 7618: (Readvertised)

Application of Doyle Hartman for an unorthodox gas well location and simultaneous dedication, Lea County, New Mexico. Applicant, in the above-styled cause, seeks approval for the unorthodox location of a gas well to be drilled 1450 feet from the South line and 1980 feet from the East line of Section 20, Township 20 South, Range 37 East, Eumont Gas Pool, the SE/4 of said Section 20 to be simultaneously dedicated to said well and to the State A-20 Well No. 1 located in Unit I of said Section 20.

CASE 7625: Application of GMW Corp. for designation of a tight formation, Lea County, New Mexico. Applicant, in the above-styled cause, seeks the designation of the Pawnee Strawn Reservoir underlying Sections 9 and 10, 14 thru 16, 21 thru 24, and 26 and 27, Township 26 South, Range 36 East, containing 7,040 acres, more or less, as a tight formation pursuant to Section 107 of the Natural Gas Policy Act and 18 CFR Section 271. 701-705.

CASE 7626: In the matter of the hearing called by the Oil Conservation Division on its own motion for an order creating, contracting, and extending certain pools in Rio Arriba, San Juan, McKinley, and Sandoval Counties, New Mexico.

- (a) That the Otero-Gallup Oil Pool in Rio Arriba County, New Mexico, as heretofore classified, defined and described, is hereby contracted by excluding:

TOWNSHIP 25 NORTH, RANGE 5 WEST, NMPM
Section 35: W/2 SW/4

- (b) That a new pool in Rio Arriba County, New Mexico, classified as a Chacra Pool for gas production, is hereby created and designated the Adobe-Chacra Pool, comprising the following described area:

TOWNSHIP 24 NORTH, RANGE 4 WEST, NMPM
Section 13: S/2
24: E/2

- (c) That a new pool in San Juan County, New Mexico, classified as a Gallup Pool for oil production, is hereby created and designated the Armenta-Gallup Oil Pool, comprising the following described area:

TOWNSHIP 29 NORTH, RANGE 10 WEST, NMPM
Sections 26: SW/4
27: S/2
28: E/2 SW/4 and SE/4
33: E/2 NW/4 and NE/4
34: N/2
35: N/2 and N/2 SE/4

- (d) That a new pool in San Juan County, New Mexico, classified as a gas pool for Fruitland production, is hereby created and designated the Glades-Fruitland Pool, comprising the following described area:

TOWNSHIP 32 NORTH, RANGE 11 WEST, NMPM
Section 31: NW/4

TOWNSHIP 32 NORTH, RANGE 12 WEST, NMPM
Sections 35: N/2 and SE/4
36: N/2 and SW/4

- (e) That a new pool in Sandoval County, New Mexico, classified as a Mancos pool for oil production, is hereby created and designated the San Ysidro-Mancos Oil Pool, comprising the following described area:

TOWNSHIP 21 NORTH, RANGE 3 WEST, NMPM
Section 29: S/2 SW/4
30: E/2 E/2 and SW/4 SE/4

- (f) That the Albino-Pictured Cliffs Pool in San Juan County, New Mexico, as heretofore classified, defined and described, is hereby extended to include:

TOWNSHIP 32 NORTH, RANGE 8 WEST, NMPM
Sections 11: S/2
13: W/2 and NE/4
14: E/2 and SW/4
26: NE/4

TOWNSHIP 32 NORTH, RANGE 7 WEST, NMPM
Section 18: NW/4

- (g) That the Angel Peak-Gallup Associated Pool in San Juan County, New Mexico, as heretofore classified, defined and described, is hereby extended to include:

TOWNSHIP 27 NORTH, RANGE 10 WEST, NMPM
Sections All

DOYLE HARTMAN

Oil Operator

500 N. MAIN

P. O. BOX 10426

MIDLAND, TEXAS 79702

(915) 684.4011

April 29, 1982

Mr. R. L. Stamets
State of New Mexico
Energy and Mineral Department
Oil Conservation Division
P. O. Box 2088
Santa Fe, New Mexico 87501

Re: Request and Notice for:
1. Simultaneous Dedication
2. Infill Drilling
State A-20 Lease
SE/4 Section 20
T-20-S, R-37-E
Lea County, New Mexico

Gentlemen:

We are currently in the process of filing a C-101 and C-102 with the New Mexico Oil Conservation Division's District Office in Hobbs for permission to drill a second Eumont (Gas) well as an infill well to the same producing interval on an existing 160-acre non-standard proration unit comprised of the SE/4 Section 20, T-20-S, R-37-E, Lea County, New Mexico. The subject non-standard proration unit is currently dedicated to our State A-20 well No. 1, located in I-20-20S-37E. The proposed well will be drilled at an orthodox location 1450 FSL and 1980 FEL of Section 20, T-20-S, R-37-E.

I hereby file for administrative approval to drill the proposed well at the orthodox location of 1450 FSL and 1980 FEL of Section 20, and to simultaneously dedicate the 160 acre non-standard proration unit comprised of the SE/4 Section 20, T-20-S, R-37-E to both our existing well (State A-20 No. 1 located in I-20-20S-37E) and to our proposed well (State A-20 No. 4 located in J-20-20S-37E).

Furthermore, if the proposed well is completed as a commercial producer, and in compliance with the Natural Gas Policy Act of 1978, an application will also be submitted to the New Mexico Oil Conservation Division to obtain administrative approval for the well as a Section 103 infill well located on a previously existing proration unit.

Mr. R. L. Stamets
April 29, 1982
Page 2

Three copies of a plat showing the location of the original well on the existing 160-acre proration unit plus the location of the proposed well are enclosed.

Copies of this plat and application have also been sent by certified mail to all offsetting parties owning Eumont (Gas) rights. The following is a list of the offset Eumont owners:

ARCO Oil and Gas Company
P. O. Box 1610
Midland, Texas 79702
Attention: Huan Pham, Area Engineer

Gulf Oil Exploration and Production Company
P. O. Box 1150
Midland, Texas 79702
Attention: C. F. Kalteyer, Chief Proration Engineer

Sun-Texas
P. O. Box 4067
Midland, Texas 79702
Attention: J. T. Power, Manager Conservation

Texaco Inc.
P. O. Box 3109
Midland, Texas 79702
Attention: R. D. Tomberlin, Division Petroleum Engineer

Thank you for your consideration.

Very truly yours,

DOYLE HARTMAN, OIL OPERATOR

Larry A. Nermyr

Larry A. Nermyr
Engineer

LAN/lr

enclosures as above

cc: New Mexico Oil Conservation Division
District I Office
P. O. Box 1980
Hobbs, New Mexico 88240
Attention: Jerry Sexton

Mr. R. L. Stamets

April 29, 1982

Page 3

cc: William P. Aycock
308 Wall Towers West
Midland, Texas 79701

Campbell, Byrd, Black, P.A.
P. O. Box 2208
Santa Fe, New Mexico 87501
Attention: William F. Carr

DOYLE HARTMAN

Oil Operator

500 N. MAIN

P. O. BOX 10428

MIDLAND, TEXAS 79702

(915) 684-4011

April 30, 1982

To All Off-Setting Eumont Dry Gas Owners
State A-20 No. 4
SE/4 Section 20
T-20-S, R-37-E
Lea County, New Mexico

We would be very appreciative if you would indicate your approval of our request of simultaneous dedication of the SE/4 Section 20, T-20-S, R-37-E, Lea County, New Mexico to our State A-20 No. 1 and to our State A-20 No. 4, and indicate your approval of our intention to qualify the State A-20 No. 4 as a Section 103 (Infill) well by signing one copy of this request and returning it in the enclosed stamped, self-addressed envelope.

We appreciate your consideration in this matter.

Very truly yours,

DOYLE HARTMAN, OIL OPERATOR

Larry A. Nermyr

Larry A. Nermyr
Engineer

Agreed to this 5 day of May, 1982

VARCO Oil and Gas Company

By Huan Pham

Title Area Engineer

Gulf Oil Exploration and Production Company

By _____

Title _____

Sun-Texas

By _____

Title _____

Texaco Inc.

By _____

Title _____

MAY 7 1982

DOYLE HARTMAN

Oil Operator

500 N MAIN

P. O. BOX 10426

MIDLAND, TEXAS 79702

(915) 684-4011

April 30, 1982

To All Off-Setting Eumont Dry Gas Owners
State A-20 No. 4
SE/4 Section 20
T-20-S, R-37-E
Lea County, New Mexico

We would be very appreciative if you would indicate your approval of our request of simultaneous dedication of the SE/4 Section 20, T-20-S, R-37-E, Lea County, New Mexico to our State A-20 No. 1 and to our State A-20 No. 4, and indicate your approval of our intention to qualify the State A-20 No. 4 as a Section 103 (Infill) well by signing one copy of this request and returning it in the enclosed stamped, self-addressed envelope.

We appreciate your consideration in this matter.

Location:
State A-20 No. 1
2310' FSL & 330' FEL (I)
State A-20 No. 4
1450' FSL & 1980' FEL (J)

Very truly yours,

DOYLE HARTMAN, OIL OPERATOR

Larry A. Nermyr

Larry A. Nermyr
Engineer

Agreed to this 11 day of May, 1982

ARCO Oil and Gas Company

By _____

Title _____

✓ Gulf Oil Corporation

By *C. F. Kalteyer*

C. F. Kalteyer

Title Chief Proration Engineer

Sun-Texas

By _____

Title _____

Texaco Inc.

By _____

Title _____

MAY 12 1982

DOYLE HARTMAN

Oil Operator

500 N. MAIN

P. O. BOX 10428

MIDLAND, TEXAS 79702

(915) 684.4011

April 30, 1982

To All Off-Setting Eumont Dry Gas Owners
State A-20 No. 4
SE/4 Section 20
T-20-S, R-37-E
Lea County, New Mexico

We would be very appreciative if you would indicate your approval of our request of simultaneous dedication of the SE/4 Section 20, T-20-S, R-37-E, Lea County, New Mexico to our State A-20 No. 1 and to our State A-20 No. 4, and indicate your approval of our intention to qualify the State A-20 No. 4 as a Section 103 (Infill) well by signing one copy of this request and returning it in the enclosed stamped, self-addressed envelope.

We appreciate your consideration in this matter.

Very truly yours,

DOYLE HARTMAN, OIL OPERATOR

Larry A. Nermyr

Larry A. Nermyr
Engineer

Agreed to this 24TH day of MAY, 1982

ARCO Oil and Gas Company

By _____

Title _____

Gulf Oil Exploration and Production Company

By _____

Title _____

Sun-Texas SUN EXPLORATION & PRODUCTION CO.

By *J. Z. Power*

Title *MANAGER CONSERVATION*

Texaco Inc.

By _____

Title _____

MAY 26 1982

PS Form 3811, Jan. 1979

SENDER: Complete items 1, 2, and 3.
Add your address in the "RETURN TO" space on reverse.

1. The following service is requested (check one.)
☒ Show to whom and date delivered..... 60¢
☐ Show to whom, date and address of delivery.....
☐ RESTRICTED DELIVERY
 Show to whom and date delivered.....
☐ RESTRICTED DELIVERY
 Show to whom, date, and address of delivery \$ _____

(CONSULT POSTMASTER FOR FEES)

2. ARTICLE ADDRESSED TO:
 Gulf Oil Exploration & Production Co.
 P. O. Box 1150
 Midland, Texas 79702

3. ARTICLE DESCRIPTION:

REGISTERED NO.	CERTIFIED NO.	INSURED NO.
	0869111	

 (Always obtain signature of addressee or agent)

I have received the article described above.
 SIGNATURE ☐ Addressee ☐ Authorized agent
[Signature]

4. DATE OF DELIVERY
 5-4-82

5. ADDRESS (Complete only if requested)
 MIDLAND, TEXAS
 MAY 4 1982

6. UNABLE TO DELIVER BECAUSE:
 CLERK'S INITIALS
[Initials]

RETURN RECEIPT, REGISTERED, INSURED AND CERTIFIED MAIL

State A-20

☆ GPO : 1979-288-848

P20 0869111

RECEIPT FOR CERTIFIED MAIL

NO INSURANCE COVERAGE PROVIDED—
 NOT FOR INTERNATIONAL MAIL
 (See Reverse)

TO: Gulf Oil Exploration & Prod.
 STREET ADDRESS
 P. O. Box 1150
 MIDLAND, TEXAS 79702

POSTAGE

CERTIFIED FEE	SPECIAL DELIVERY	RESTRICTED DELIVERY	SHOW TO WHOM AND DATE DELIVERED	SHOW TO WHOM, DATE AND ADDRESS OF DELIVERY	SHOW TO WHOM AND DATE DELIVERED WITH RESTRICTED DELIVERY	SHOW TO WHOM, DATE AND ADDRESS OF DELIVERY WITH RESTRICTED DELIVERY
.54	.75			.60		

 TOTAL POSTAGE AND FEES \$1.89

POSTMARK OR DATE
 5-3-82
 State A-20

PS Form 3800, Nov. 1976

P20 0869112

RECEIPT FOR CERTIFIED MAIL

NO INSURANCE COVERAGE PROVIDED—
 NOT FOR INTERNATIONAL MAIL
 (See Reverse)

Sun-Texas
 P. O. Box 4067
 Midland, Texas 79702

POSTAGE

CERTIFIED FEE	SPECIAL DELIVERY	RESTRICTED DELIVERY	SHOW TO WHOM AND DATE DELIVERED	SHOW TO WHOM, DATE AND ADDRESS OF DELIVERY	SHOW TO WHOM AND DATE DELIVERED WITH RESTRICTED DELIVERY	SHOW TO WHOM, DATE AND ADDRESS OF DELIVERY WITH RESTRICTED DELIVERY
.54	.75			.60		

 TOTAL POSTAGE AND FEES \$1.89

POSTMARK OR DATE
 5-3-82
 State A-20

PS Form 3800, Nov. 1976

PS Form 3811, Jan. 1979

SENDER: Complete items 1, 2, and 3.
Add your address in the "RETURN TO" space on reverse.

1. The following service is requested (check one.)
☒ Show to whom and date delivered..... 60¢
☐ Show to whom, date and address of delivery.....
☐ RESTRICTED DELIVERY
 Show to whom and date delivered.....
☐ RESTRICTED DELIVERY
 Show to whom, date, and address of delivery \$ _____

(CONSULT POSTMASTER FOR FEES)

2. ARTICLE ADDRESSED TO:
 Sun-Texas
 P. O. Box 4067
 Midland, Texas 79702

3. ARTICLE DESCRIPTION:

REGISTERED NO.	CERTIFIED NO.	INSURED NO.
	0869112	

 (Always obtain signature of addressee or agent)

I have received the article described above.
 SIGNATURE ☐ Addressee ☐ Authorized agent
[Signature]

4. DATE OF DELIVERY
 MAY 10 1982

5. ADDRESS (Complete only if requested)
 MIDLAND, TEXAS

6. UNABLE TO DELIVER BECAUSE:
 CLERK'S INITIALS
[Initials]

RETURN RECEIPT, REGISTERED, INSURED AND CERTIFIED MAIL

State A-20

☆ GPO : 1979-288-848

PS Form 3811, Jan. 1979

SENDER: Complete items 1, 2, and 3.
Add your address in the "RETURN TO" space on reverse.

1. The following service is requested (check one.)
☒ Show to whom and date delivered.....60¢
☐ Show to whom, date and address of delivery.....¢
☐ RESTRICTED DELIVERY
 Show to whom and date delivered.....¢
☐ RESTRICTED DELIVERY.
 Show to whom, date, and address of delivery.\$ ____
 (CONSULT POSTMASTER FOR FEES)

2. ARTICLE ADDRESSED TO:
 Arco Oil and Gas Company
 P. O. Box 1610
 Midland, Texas 79702

3. ARTICLE DESCRIPTION:

REGISTERED NO.	CERTIFIED NO.	INSURED NO.
	0869110	

 (Always obtain signature of addressee or agent)
 I have received the article described above.
 SIGNATURE ☐ Addressee ☐ Authorized agent
R. J. Warr

4. DATE OF DELIVERY *MAY 6 1982* POSTMARK *MAY 6 1982*

5. ADDRESS (Complete only if requested)

6. UNABLE TO DELIVER BECAUSE: CLERK'S INITIALS *[Signature]*

State A-20

☆ GPO : 1979-288-848

P20 0869110

RECEIPT FOR CERTIFIED MAIL

NO INSURANCE COVERAGE PROVIDED—
NOT FOR INTERNATIONAL MAIL
(See Reverse)

SENT TO
 Arco Oil and Gas Company
 P. O. Box 1610
 Midland, Texas 79702

POSTAGE \$ *1.24*

CONSULT POSTMASTER FOR FEES		
OPTIONAL SERVICES	CERTIFIED FEE	.75
	SPECIAL DELIVERY	
	RESTRICTED DELIVERY	
	RETURN RECEIPT SERVICE	.60
TOTAL POSTAGE AND FEES		<i>1.89</i>
POSTMARK OR DATE		5-3-82
		State A-20

PS Form 3800, Apr. 1976

PS Form 3811, Jan. 1979

SENDER: Complete items 1, 2, and 3.
Add your address in the "RETURN TO" space on reverse.

1. The following service is requested (check one.)
☒ Show to whom and date delivered.....60¢
☐ Show to whom, date and address of delivery.....¢
☐ RESTRICTED DELIVERY
 Show to whom and date delivered.....¢
☐ RESTRICTED DELIVERY.
 Show to whom, date, and address of delivery.\$ ____
 (CONSULT POSTMASTER FOR FEES)

2. ARTICLE ADDRESSED TO:
 Texaco Inc.
 P. O. Box 3109
 Midland, Texas 79702

3. ARTICLE DESCRIPTION:

REGISTERED NO.	CERTIFIED NO.	INSURED NO.
	0869113	

 (Always obtain signature of addressee or agent)
 I have received the article described above.
 SIGNATURE ☐ Addressee ☐ Authorized agent
[Signature]

4. DATE OF DELIVERY *5-4-82* POSTMARK *MAY 4 1982*

5. ADDRESS (Complete only if requested)

6. UNABLE TO DELIVER BECAUSE: CLERK'S INITIALS *[Signature]*

State A-20

☆ GPO : 1979-288-848

P20 0869113

RECEIPT FOR CERTIFIED MAIL

NO INSURANCE COVERAGE PROVIDED—
NOT FOR INTERNATIONAL MAIL
(See Reverse)

SENT TO
 Texaco Inc.
 P. O. Box 3109
 Midland, Texas 79702

POSTAGE \$ *1.54*

CONSULT POSTMASTER FOR FEES		
OPTIONAL SERVICES	CERTIFIED FEE	.75
	SPECIAL DELIVERY	
	RESTRICTED DELIVERY	
	RETURN RECEIPT SERVICE	.60
TOTAL POSTAGE AND FEES		<i>1.89</i>
POSTMARK OR DATE		5-3-82
		State A-20

PS Form 3800, Apr. 1976

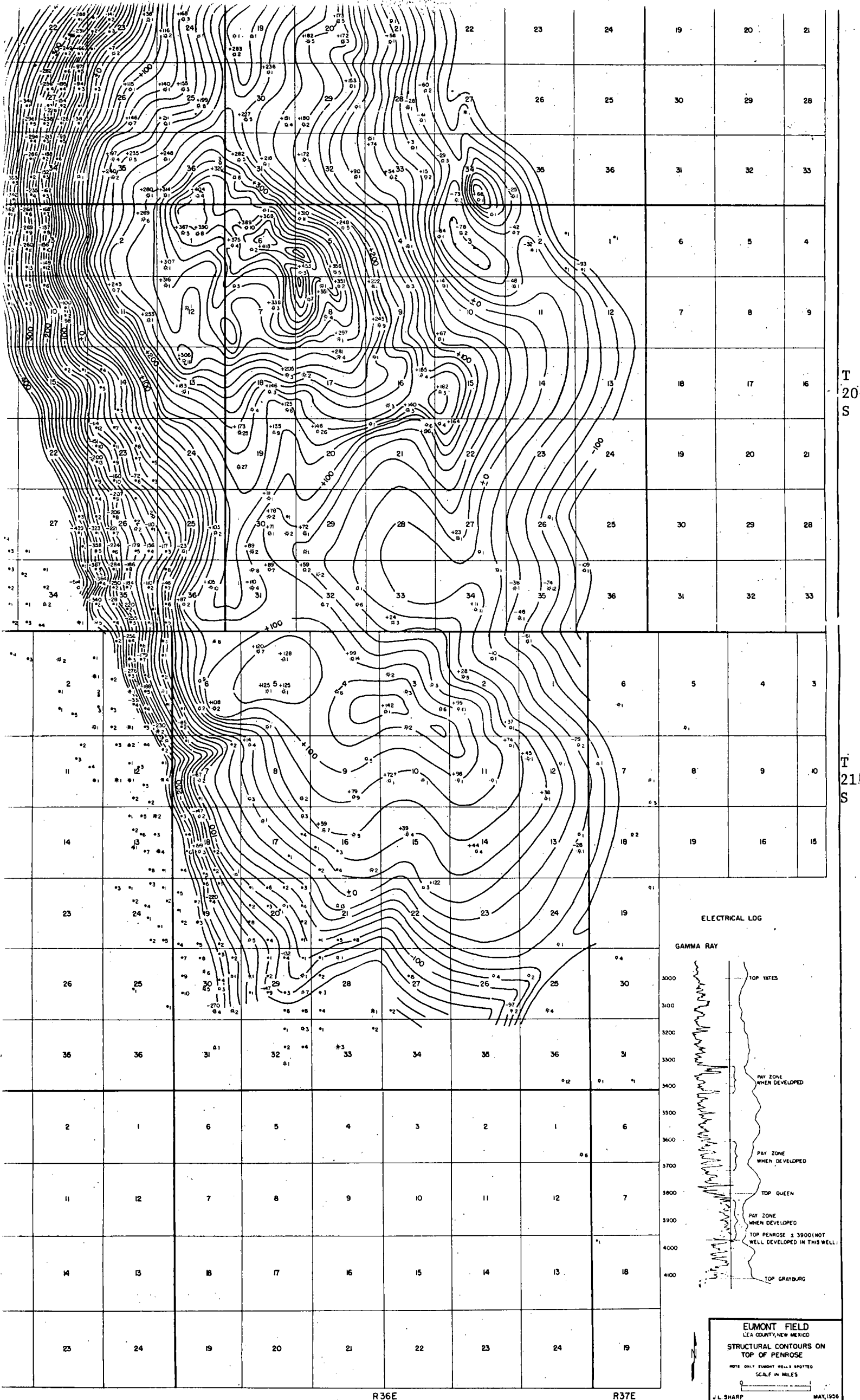
T
20
ST
21
S

GAS PRODUCTION HISTORY

Date 7-16-80

Page 1 of 2

Operator: BWP (Doyle Hartman)

Well: State "A-20" No. 1

Location: I-20-20-37

Pool: Eumont (Gas)

Spud Date: _____ Original Completion Date: _____

Completion Interval (Gas): _____

Completion Date (Gas): _____ First Production (Gas): _____

Remarks: _____

Year	No. of Mos.	Annual Gas Production (MCF)	Avg. Gas Rate (MCF/mo.)	Cum. Gas Production (MMCF)	Annual SIP (psia)	P/Z
1980	12	54668	4556	3044.4	339.2	355
1979	11	57724	5248	2989.7	351.2	370
1978	12	72463	6039	2931.9	385.2	410
1977	12	96824	8069	2859.5	403.2	430
1976	12	146898	12241	2762.7	423.2	455
1975	12	192156	16013	2615.8	451.2	485
1974	12	178349	14862	2423.6	508.2	555
1973	12	220883	18407	2245.3	554.2	615
1972	12	168194	14016	2024.4	597.2	670
1971	12	158842	13237	1856.2	608.2	685
1970	12	140158	11680	1697.3	649.2	735
1969	11	115362	10487	1557.2	655.2	745
1968	12	141411	11784	1441.8	657.2	745
1967	11	53417	4856	1300.4	763.2	875
1966	12	75074	6256	1247.0	N/A	N/A
1965	12	106268	8856	1171.9	N/A	N/A
1964	11	98615	8965	1065.6	N/A	N/A
1963	12	83742	6978	967.0	N/A	N/A
1962	12	76492	6374	883.3	N/A	N/A

1979 Detail Summary

Jan.	5160	July	5341
Feb.	5160	Aug.	5006
March	5705	Sept.	5349
April	4758	Oct.	-0-
May	5078	Nov.	5452
June	5004	Dec.	5711

1980 Detail Summary

Jan.	5567	July	4941
Feb.	4993	Aug.	4277
March	4944	Sept.	4009
April	4009	Oct.	4311
May	4311	Nov.	4079
June	4421	Dec.	4806

Production (Y-T-D) 15109 MCF

Avg. Rate (Y-T-D) 3777 MCF/mo.

Days or Months (Y-T-D) 4 months(1982)

I-20-20-37

GAS PRODUCTION HISTORY

Date 5-15-81

Page 2 of 2

Operator: BWP (Doyle Hartman)

Well: _____ State "A-20" No. 1 _____

Location: I-20-20-37

Pool: Eumont (Gas)

Spud Date: _____ Original Completion Date: _____

Completion Interval (Gas): _____

Completion Date (Gas): _____ First Production (Gas): _____

Remarks: _____

[illegible]

19 81		Detail Summary	
Jan.	4764	July	3511
Feb.	4122	Aug.	4375
March	4142	Sept.	3655
April	2749	Oct.	3925
May	3123	Nov.	4238
June	3329	Dec.	3979

19 <u>82</u>		Detail Summary	
Jan.	<u>3878</u>	July	_____
Feb.	<u>3366</u>	Aug.	_____
March	<u>3884</u>	Sept.	_____
April	<u>3981</u>	Oct.	_____
May	_____	Nov.	_____
June	_____	Dec.	_____

Production (Y-T-D) 15109 MCF

Avg. Rate (Y-T-D) 3777 MCF/mo.

Days or Months (Y-T-D) 4 months

I-20-20-37

100.000

Acres:

1	2	3	4	5	6	7	8	9	10
11	12	13	14	15	16	17	18	19	20
21	22	23	24	25	26	27	28	29	30
31	32	33	34	35	36	37	38	39	40
41	42	43	44	45	46	47	48	49	50
51	52	53	54	55	56	57	58	59	60
61	62	63	64	65	66	67	68	69	70
71	72	73	74	75	76	77	78	79	80
81	82	83	84	85	86	87	88	89	90
91	92	93	94	95	96	97	98	99	100

1	2	3	4	5	6	7	8	9	10	11	12	13	14	15	16	17	18	19	20	21	22	23	24	25	26	27	28	29	30	31	32	33	34	35	36	37	38	39	40	41	42	43	44	45	46	47	48	49	50	51	52	53	54	55	56	57	58	59	60	61	62	63	64	65	66	67	68	69	70	71	72	73	74	75	76	77	78	79	80	81	82	83	84	85	86	87	88	89	90	91	92	93	94	95	96	97	98	99	100	101	102	103	104	105	106	107	108	109	110	111	112	113	114	115	116	117	118	119	120	121	122	123	124	125	126	127	128	129	130	131	132	133	134	135	136	137	138	139	140	141	142	143	144	145	146	147	148	149	150	151	152	153	154	155	156	157	158	159	160	161	162	163	164	165	166	167	168	169	170	171	172	173	174	175	176	177	178	179	180	181	182	183	184	185	186	187	188	189	190	191	192	193	194	195	196	197	198	199	200	201	202	203	204	205	206	207	208	209	210	211	212	213	214	215	216	217	218	219	220	221	222	223	224	225	226	227	228	229	230	231	232	233	234	235	236	237	238	239	240	241	242	243	244	245	246	247	248	249	250	251	252	253	254	255	256	257	258	259	260	261	262	263	264	265	266	267	268	269	270	271	272	273	274	275	276	277	278	279	280	281	282	283	284	285	286	287	288	289	290	291	292	293	294	295	296	297	298	299	300	301	302	303	304	305	306	307	308	309	310	311	312	313	314	315	316	317	318	319	320	321	322	323	324	325	326	327	328	329	330	331	332	333	334	335	336	337	338	339	340	341	342	343	344	345	346	347	348	349	350	351	352	353	354	355	356	357	358	359	360	361	362	363	364	365	366	367	368	369	370	371	372	373	374	375	376	377	378	379	380	381	382	383	384	385	386	387	388	389	390	391	392	393	394	395	396	397	398	399	400	401	402	403	404	405	406	407	408	409	410	411	412	413	414	415	416	417	418	419	420	421	422	423	424	425	426	427	428	429	430	431	432	433	434	435	436	437	438	439	440	441	442	443	444	445	446	447	448	449	450	451	452	453	454	455	456	457	458	459	460	461	462	463	464	465	466	467	468	469	470	471	472	473	474	475	476	477	478	479	480	481	482	483	484	485	486	487	488	489	490	491	492	493	494	495	496	497	498	499	500	501	502	503	504	505	506	507	508	509	510	511	512	513	514	515	516	517	518	519	520	521	522	523	524	5
---	---	---	---	---	---	---	---	---	----	----	----	----	----	----	----	----	----	----	----	----	----	----	----	----	----	----	----	----	----	----	----	----	----	----	----	----	----	----	----	----	----	----	----	----	----	----	----	----	----	----	----	----	----	----	----	----	----	----	----	----	----	----	----	----	----	----	----	----	----	----	----	----	----	----	----	----	----	----	----	----	----	----	----	----	----	----	----	----	----	----	----	----	----	----	----	----	----	----	-----	-----	-----	-----	-----	-----	-----	-----	-----	-----	-----	-----	-----	-----	-----	-----	-----	-----	-----	-----	-----	-----	-----	-----	-----	-----	-----	-----	-----	-----	-----	-----	-----	-----	-----	-----	-----	-----	-----	-----	-----	-----	-----	-----	-----	-----	-----	-----	-----	-----	-----	-----	-----	-----	-----	-----	-----	-----	-----	-----	-----	-----	-----	-----	-----	-----	-----	-----	-----	-----	-----	-----	-----	-----	-----	-----	-----	-----	-----	-----	-----	-----	-----	-----	-----	-----	-----	-----	-----	-----	-----	-----	-----	-----	-----	-----	-----	-----	-----	-----	-----	-----	-----	-----	-----	-----	-----	-----	-----	-----	-----	-----	-----	-----	-----	-----	-----	-----	-----	-----	-----	-----	-----	-----	-----	-----	-----	-----	-----	-----	-----	-----	-----	-----	-----	-----	-----	-----	-----	-----	-----	-----	-----	-----	-----	-----	-----	-----	-----	-----	-----	-----	-----	-----	-----	-----	-----	-----	-----	-----	-----	-----	-----	-----	-----	-----	-----	-----	-----	-----	-----	-----	-----	-----	-----	-----	-----	-----	-----	-----	-----	-----	-----	-----	-----	-----	-----	-----	-----	-----	-----	-----	-----	-----	-----	-----	-----	-----	-----	-----	-----	-----	-----	-----	-----	-----	-----	-----	-----	-----	-----	-----	-----	-----	-----	-----	-----	-----	-----	-----	-----	-----	-----	-----	-----	-----	-----	-----	-----	-----	-----	-----	-----	-----	-----	-----	-----	-----	-----	-----	-----	-----	-----	-----	-----	-----	-----	-----	-----	-----	-----	-----	-----	-----	-----	-----	-----	-----	-----	-----	-----	-----	-----	-----	-----	-----	-----	-----	-----	-----	-----	-----	-----	-----	-----	-----	-----	-----	-----	-----	-----	-----	-----	-----	-----	-----	-----	-----	-----	-----	-----	-----	-----	-----	-----	-----	-----	-----	-----	-----	-----	-----	-----	-----	-----	-----	-----	-----	-----	-----	-----	-----	-----	-----	-----	-----	-----	-----	-----	-----	-----	-----	-----	-----	-----	-----	-----	-----	-----	-----	-----	-----	-----	-----	-----	-----	-----	-----	-----	-----	-----	-----	-----	-----	-----	-----	-----	-----	-----	-----	-----	-----	-----	-----	-----	-----	-----	-----	-----	-----	-----	-----	-----	-----	-----	-----	-----	-----	-----	-----	-----	-----	-----	-----	-----	-----	-----	-----	-----	-----	-----	-----	-----	-----	-----	-----	-----	-----	-----	-----	-----	-----	-----	-----	-----	-----	-----	-----	-----	-----	-----	-----	-----	-----	-----	-----	-----	-----	-----	-----	-----	-----	-----	-----	-----	-----	-----	-----	-----	-----	-----	-----	-----	-----	-----	---

1	2	3	4	5	6	7	8	9	10	11	12	13	14	15	16	17	18	19	20	21	22	23	24	25	26	27	28	29	30	31	32	33	34	35	36	37	38	39	40	41	42	43	44	45	46	47	48	49	50	51	52	53	54	55	56	57	58	59	60	61	62	63	64	65	66	67	68	69	70	71	72	73	74	75	76	77	78	79	80	81	82	83	84	85	86	87	88	89	90	91	92	93	94	95	96	97	98	99	100	101	102	103	104	105	106	107	108	109	110	111	112	113	114	115	116	117	118	119	120	121	122	123	124	125	126	127	128	129	130	131	132	133	134	135	136	137	138	139	140	141	142	143	144	145	146	147	148	149	150	151	152	153	154	155	156	157	158	159	160	161	162	163	164	165	166	167	168	169	170	171	172	173	174	175	176	177	178	179	180	181	182	183	184	185	186	187	188	189	190	191	192	193	194	195	196	197	198	199	200	201	202	203	204	205	206	207	208	209	210	211	212	213	214	215	216	217	218	219	220	221	222	223	224	225	226	227	228	229	230	231	232	233	234	235	236	237	238	239	240	241	242	243	244	245	246	247	248	249	250	251	252	253	254	255	256	257	258	259	260	261	262	263	264	265	266	267	268	269	270	271	272	273	274	275	276	277	278	279	280	281	282	283	284	285	286	287	288	289	290	291	292	293	294	295	296	297	298	299	300	301	302	303	304	305	306	307	308	309	310	311	312	313	314	315	316	317	318	319	320	321	322	323	324	325	326	327	328	329	330	331	332	333	334	335	336	337	338	339	340	341	342	343	344	345	346	347	348	349	350	351	352	353	354	355	356	357	358	359	360	361	362	363	364	365	366	367	368	369	370	371	372	373	374	375	376	377	378	379	380	381	382	383	384	385	386	387	388	389	390	391	392	393	394	395	396	397	398	399	400	401	402	403	404	405	406	407	408	409	410	411	412	413	414	415	416	417	418	419	420	421	422	423	424	425	426	427	428	429	430	431	432	433	434	435	436	437	438	439	440	441	442	443	444	445	446	447	448	449	450	451	452	453	454	455	456	457	458	459	460	461	462	463	464	465	466
---	---	---	---	---	---	---	---	---	----	----	----	----	----	----	----	----	----	----	----	----	----	----	----	----	----	----	----	----	----	----	----	----	----	----	----	----	----	----	----	----	----	----	----	----	----	----	----	----	----	----	----	----	----	----	----	----	----	----	----	----	----	----	----	----	----	----	----	----	----	----	----	----	----	----	----	----	----	----	----	----	----	----	----	----	----	----	----	----	----	----	----	----	----	----	----	----	----	----	-----	-----	-----	-----	-----	-----	-----	-----	-----	-----	-----	-----	-----	-----	-----	-----	-----	-----	-----	-----	-----	-----	-----	-----	-----	-----	-----	-----	-----	-----	-----	-----	-----	-----	-----	-----	-----	-----	-----	-----	-----	-----	-----	-----	-----	-----	-----	-----	-----	-----	-----	-----	-----	-----	-----	-----	-----	-----	-----	-----	-----	-----	-----	-----	-----	-----	-----	-----	-----	-----	-----	-----	-----	-----	-----	-----	-----	-----	-----	-----	-----	-----	-----	-----	-----	-----	-----	-----	-----	-----	-----	-----	-----	-----	-----	-----	-----	-----	-----	-----	-----	-----	-----	-----	-----	-----	-----	-----	-----	-----	-----	-----	-----	-----	-----	-----	-----	-----	-----	-----	-----	-----	-----	-----	-----	-----	-----	-----	-----	-----	-----	-----	-----	-----	-----	-----	-----	-----	-----	-----	-----	-----	-----	-----	-----	-----	-----	-----	-----	-----	-----	-----	-----	-----	-----	-----	-----	-----	-----	-----	-----	-----	-----	-----	-----	-----	-----	-----	-----	-----	-----	-----	-----	-----	-----	-----	-----	-----	-----	-----	-----	-----	-----	-----	-----	-----	-----	-----	-----	-----	-----	-----	-----	-----	-----	-----	-----	-----	-----	-----	-----	-----	-----	-----	-----	-----	-----	-----	-----	-----	-----	-----	-----	-----	-----	-----	-----	-----	-----	-----	-----	-----	-----	-----	-----	-----	-----	-----	-----	-----	-----	-----	-----	-----	-----	-----	-----	-----	-----	-----	-----	-----	-----	-----	-----	-----	-----	-----	-----	-----	-----	-----	-----	-----	-----	-----	-----	-----	-----	-----	-----	-----	-----	-----	-----	-----	-----	-----	-----	-----	-----	-----	-----	-----	-----	-----	-----	-----	-----	-----	-----	-----	-----	-----	-----	-----	-----	-----	-----	-----	-----	-----	-----	-----	-----	-----	-----	-----	-----	-----	-----	-----	-----	-----	-----	-----	-----	-----	-----	-----	-----	-----	-----	-----	-----	-----	-----	-----	-----	-----	-----	-----	-----	-----	-----	-----	-----	-----	-----	-----	-----	-----	-----	-----	-----	-----	-----	-----	-----	-----	-----	-----	-----	-----	-----	-----	-----	-----	-----	-----	-----	-----	-----	-----	-----	-----	-----	-----	-----	-----	-----	-----	-----	-----	-----	-----	-----

1	2	3	4	5	6	7	8	9	10	11	12	13	14	15	16	17	18	19	20	21	22	23	24	25	26	27	28	29	30	31	32	33	34	35	36	37	38	39	40	41	42	43	44	45	46	47	48	49	50	51	52	53	54	55	56	57	58	59	60	61	62	63	64	65	66	67	68	69	70	71	72	73	74	75	76	77	78	79	80	81	82	83	84	85	86	87	88	89	90	91	92	93	94	95	96	97	98	99	100	101	102	103	104	105	106	107	108	109	110	111	112	113	114	115	116	117	118	119	120	121	122	123	124	125	126	127	128	129	130	131	132	133	134	135	136	137	138	139	140	141	142	143	144	145	146	147	148	149	150	151	152	153	154	155	156	157	158	159	160	161	162	163	164	165	166	167	168	169	170	171	172	173	174	175	176	177	178	179	180	181	182	183	184	185	186	187	188	189	190	191	192	193	194	195	196	197	198	199	200	201	202	203	204	205	206	207	208	209	210	211	212	213	214	215	216	217	218	219	220	221	222	223	224	225	226	227	228	229	230	231	232	233	234	235	236	237	238	239	240	241	242	243	244	245	246	247	248	249	250	251	252	253	254	255	256	257	258	259	260	261	262	263	264	265	266	267	268	269	270	271	272	273	274	275	276	277	278	279	280	281	282	283	284	285	286	287	288	289	290	291	292	293	294	295	296	297	298	299	300	301	302	303	304	305	306	307	308	309	310	311	312	313	314	315	316	317	318	319	320	321	322	323	324	325	326	327	328	329	330	331	332	333	334	335	336	337	338	339	340	341	342	343	344	345	346	347	348	349	350	351	352	353	354	355	356	357	358	359	360	361	362	363	364	365	366	367	368	369	370	371	372	373	374	375	376	377	378	379	380	381	382	383	384	385	386	387	388	389	390	391	392	393	394	395	396	397	398	399	400	401	402	403	404	405	406	407	408	409	410	411	412	413	414	415	416	417	418	419	420	421	422	423	424	425	426	427	428	429	430	431	432	433	434	435	436	437	438	439	440	441	442	443	444	445	446	447	448	449	450	451	452	453	454	455	456	457	458	459	460	461	462	463	464	465	466	467	468	469	470	471	472	473	474	475	476	477	478	479	480	481	482	483	484	485	486	487	488	489	490	491	492	493	494	495	496	497	498	499	500	501	502	503	504	505	506	507	508	509	510	511	512	513	514	515	516	517	518	519	520	521	522	523	524	5
---	---	---	---	---	---	---	---	---	----	----	----	----	----	----	----	----	----	----	----	----	----	----	----	----	----	----	----	----	----	----	----	----	----	----	----	----	----	----	----	----	----	----	----	----	----	----	----	----	----	----	----	----	----	----	----	----	----	----	----	----	----	----	----	----	----	----	----	----	----	----	----	----	----	----	----	----	----	----	----	----	----	----	----	----	----	----	----	----	----	----	----	----	----	----	----	----	----	----	-----	-----	-----	-----	-----	-----	-----	-----	-----	-----	-----	-----	-----	-----	-----	-----	-----	-----	-----	-----	-----	-----	-----	-----	-----	-----	-----	-----	-----	-----	-----	-----	-----	-----	-----	-----	-----	-----	-----	-----	-----	-----	-----	-----	-----	-----	-----	-----	-----	-----	-----	-----	-----	-----	-----	-----	-----	-----	-----	-----	-----	-----	-----	-----	-----	-----	-----	-----	-----	-----	-----	-----	-----	-----	-----	-----	-----	-----	-----	-----	-----	-----	-----	-----	-----	-----	-----	-----	-----	-----	-----	-----	-----	-----	-----	-----	-----	-----	-----	-----	-----	-----	-----	-----	-----	-----	-----	-----	-----	-----	-----	-----	-----	-----	-----	-----	-----	-----	-----	-----	-----	-----	-----	-----	-----	-----	-----	-----	-----	-----	-----	-----	-----	-----	-----	-----	-----	-----	-----	-----	-----	-----	-----	-----	-----	-----	-----	-----	-----	-----	-----	-----	-----	-----	-----	-----	-----	-----	-----	-----	-----	-----	-----	-----	-----	-----	-----	-----	-----	-----	-----	-----	-----	-----	-----	-----	-----	-----	-----	-----	-----	-----	-----	-----	-----	-----	-----	-----	-----	-----	-----	-----	-----	-----	-----	-----	-----	-----	-----	-----	-----	-----	-----	-----	-----	-----	-----	-----	-----	-----	-----	-----	-----	-----	-----	-----	-----	-----	-----	-----	-----	-----	-----	-----	-----	-----	-----	-----	-----	-----	-----	-----	-----	-----	-----	-----	-----	-----	-----	-----	-----	-----	-----	-----	-----	-----	-----	-----	-----	-----	-----	-----	-----	-----	-----	-----	-----	-----	-----	-----	-----	-----	-----	-----	-----	-----	-----	-----	-----	-----	-----	-----	-----	-----	-----	-----	-----	-----	-----	-----	-----	-----	-----	-----	-----	-----	-----	-----	-----	-----	-----	-----	-----	-----	-----	-----	-----	-----	-----	-----	-----	-----	-----	-----	-----	-----	-----	-----	-----	-----	-----	-----	-----	-----	-----	-----	-----	-----	-----	-----	-----	-----	-----	-----	-----	-----	-----	-----	-----	-----	-----	-----	-----	-----	-----	-----	-----	-----	-----	-----	-----	-----	-----	-----	-----	-----	-----	-----	-----	-----	-----	-----	-----	-----	-----	-----	-----	-----	-----	-----	-----	-----	-----	-----	-----	-----	-----	-----	-----	-----	-----	-----	-----	-----	-----	-----	-----	-----	-----	-----	-----	-----	-----	-----	-----	-----	-----	-----	-----	-----	-----	-----	-----	-----	-----	-----	-----	-----	-----	-----	-----	-----	-----	-----	-----	-----	-----	-----	-----	-----	-----	-----	-----	-----	-----	-----	-----	-----	-----	-----	-----	-----	-----	-----	-----	---

[illegible][illegible]

19 ⁸⁵	19 ⁸⁶	19 ⁸⁷	19 ⁸⁸
------------------	------------------	------------------	------------------

Gas Production - MCF/month

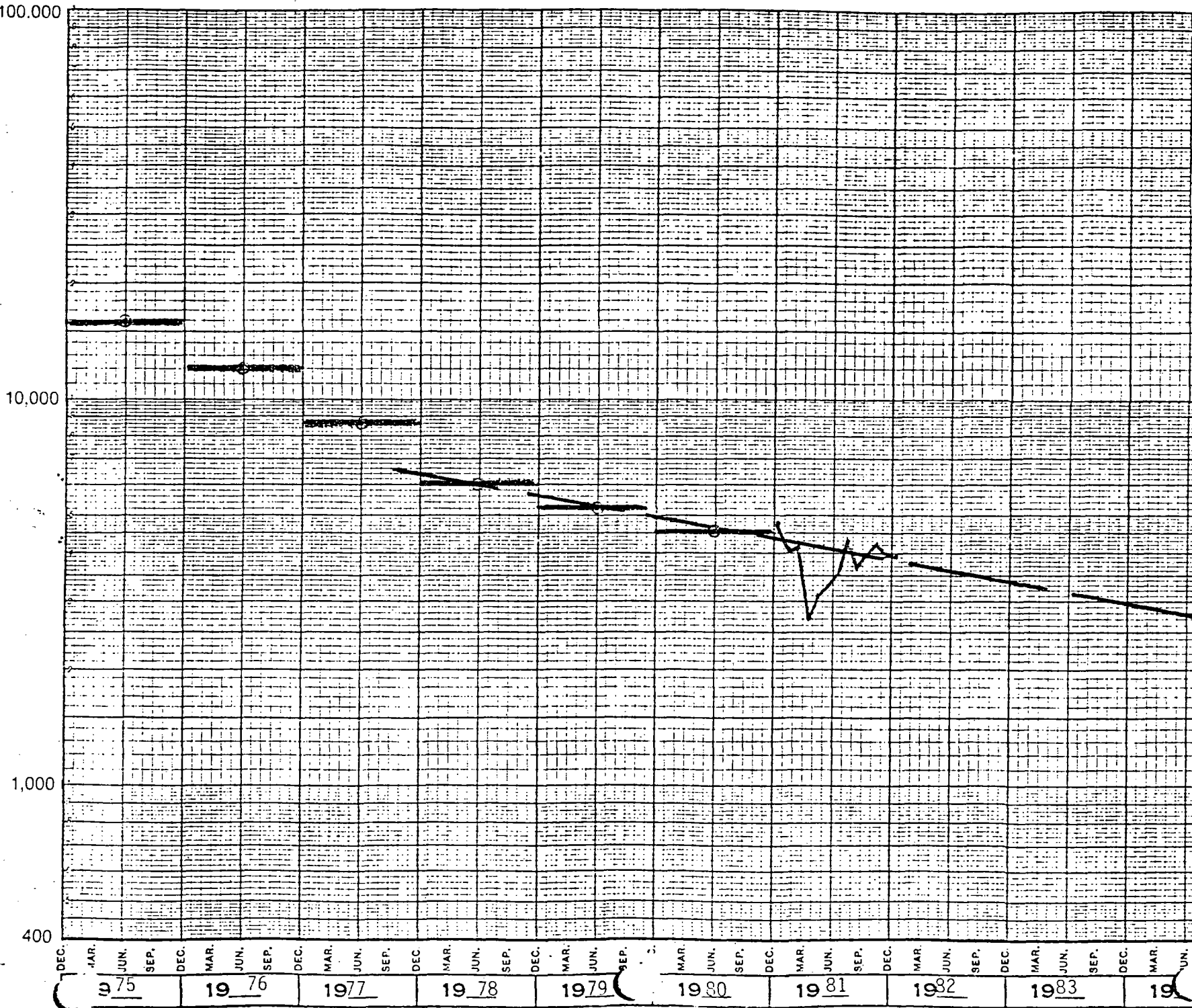

Pressure or P/Z - (psia)

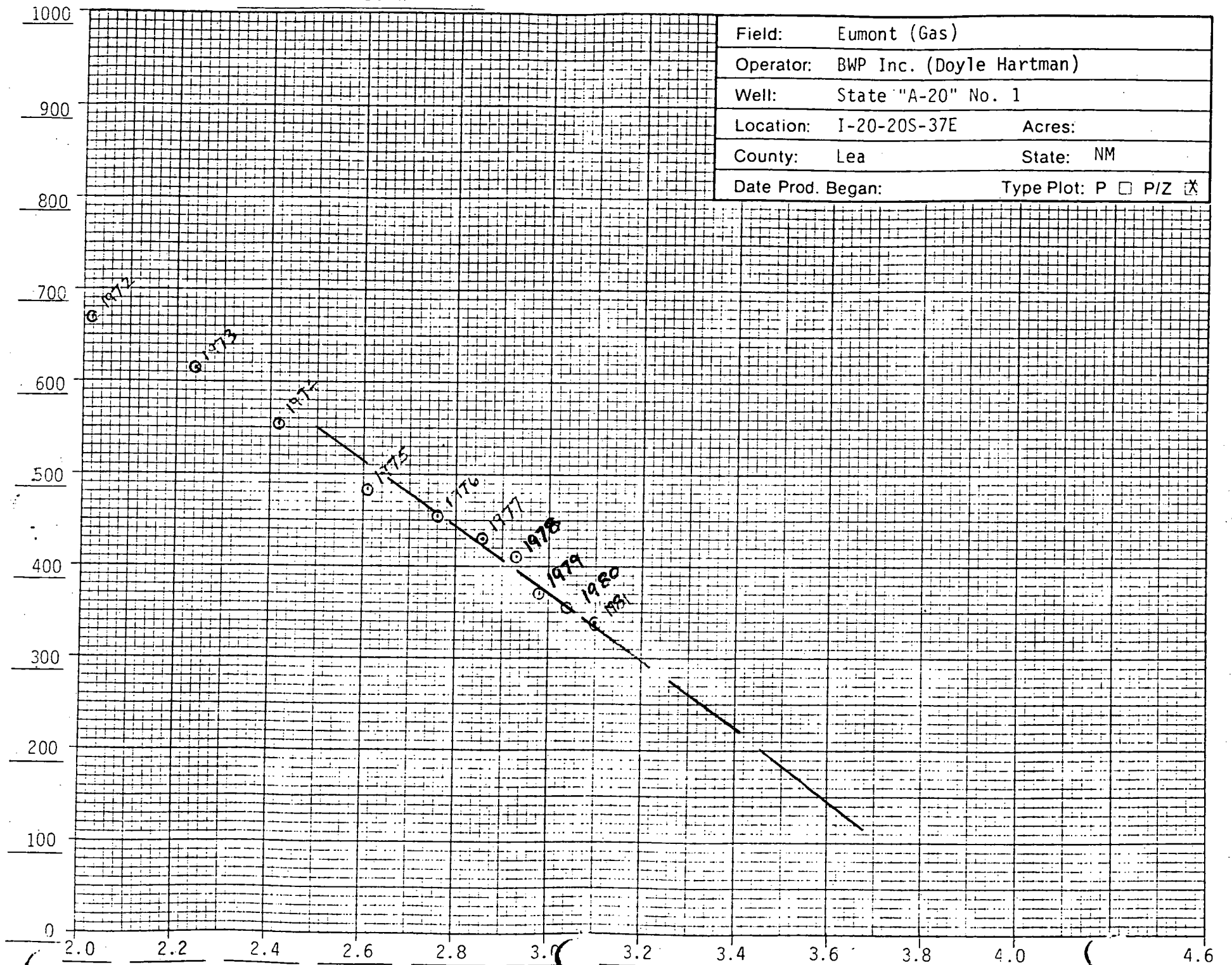

NO. OF COPIES RECEIVED	
DISTRIBUTION	
SANTA FE	
FILE	
U.S.G.S.	
LAND OFFICE	
OPERATOR	

**NEW MEXICO OIL CONSERVATION COMMISSION
WELL COMPLETION OR RECOMPLETION REPORT AND LOG**

Form C-105
Revised 11-81

5a. Indicate Type of Lease
State <input checked="" type="checkbox"/> Fee <input type="checkbox"/>
5. State Oil & Gas Lease No.
B-2656

1a. TYPE OF WELL	OIL WELL <input type="checkbox"/>	GAS WELL <input checked="" type="checkbox"/>	DRY <input type="checkbox"/>	OTHER <input type="checkbox"/>
b. TYPE OF COMPLETION	NEW WELL <input checked="" type="checkbox"/>	WORK OVER <input type="checkbox"/>	DEEPEN <input type="checkbox"/>	PLUG BACK <input type="checkbox"/>
		DIFF. RESVR. <input type="checkbox"/>	OTHER <input type="checkbox"/>	

7. Unit Agreement Name
8. Farm or Lease Name
State A-20
9. Well No.
4
10. Field and Pool, or Wildcat
Eumont (Gas)

2. Name of Operator
Doyle Hartman
3. Address of Operator
P. O. Box 10426 Midland, Texas 79702

4. Location of Well
UNIT LETTER J LOCATED 1450 FEET FROM THE South LINE AND 1980 FEET FROM THE East LINE OF SEC. 20 TWP. 20-S RGE. 37-E NMPM

12. County
Lea

15. Date Spudded	16. Date T.D. Reached	17. Date Compl. (Ready to Prod.)	18. Elevations (DF, RKB, RT, GR, etc.)	19. Elev. Casinghead
6-5-82	6-13-82	6-19-82	3515 GL	3515
20. Total Depth	21. Plug Back T.D.	22. If Multiple Compl., How Many	23. Intervals Drilled By Rotary Tools	Cable Tools
4000	3986	--	0-4000	--

24. Producing Interval(s), of this completion - Top, Bottom, Name	25. Was Directional Survey Made
3426-3583 w/21 Holes (Queen)	Deviation Survey Was Made

26. Type Electric and Other Logs Run	27. Was Well Cored
CDN-DSN-GR and Guard-Forxo	No

28. CASING RECORD (Report all strings set in well)					
CASING SIZE	WEIGHT LB./FT.	DEPTH SET	HOLE SIZE	CEMENTING RECORD	AMOUNT PULLED
9 5/8	36.0	424'	12 1/4	225 sx (circ)	None
7	23.0	3998'	8 3/4	900 sx (circ)	None

29. LINER RECORD					30. TUBING RECORD		
SIZE	TOP	BOTTOM	SACKS CEMENT	SCREEN	SIZE	DEPTH SET	PACKER SET
					2 3/8	3791	--

31. Perforation Record (Interval, size and number) 21 Holes with one hole each at: 3426; 3439; 3447; 3451; 3458; 3462; 3467; 3474; 3477; 3479; 3490; 3503; 3515; 3519; 3526; 3531; 3537; 3547; 3561; 3581; 3583.	32. ACID, SHOT, FRACTURE, CEMENT SQUEEZE, ETC.	
	DEPTH INTERVAL	AMOUNT AND KIND MATERIAL USED
	3426-3583	A/5600 15% MCA
		SWF 88,200 + 179,000

33. PRODUCTION							
Date First Production	Production Method (Flowing, gas lift, pumping - Size and type pump)					Well Status (Prod. or Shut-in)	
6-19-82	Pumping - Flowing (8 1/2 X 64 X 1 1/4)					Shut-In	
Date of Test	Hours Tested	Choke Size	Prod'n. Per Test Period	Oil - Bbl.	Gas - MCF	Water - Bbl.	Gas - Oil Ratio
6-19-82	24	13/64	→	--	234	--	--
Flow Tubing Press.	Casing Pressure	Calculated 24-Hour Rate	Oil - Bbl.	Gas - MCF	Water - Bbl.	Oil Gravity - API (Corr.)	
--	PCP=277	→	--	234	--	align="center"> --	

34. Disposition of Gas (Sold, used for fuel, vented, etc.)	Test Witnessed By
Vented	Harold Swain

35. List of Attachments
36. I hereby certify that the information shown on both sides of this form is true and complete to the best of my knowledge and belief.
SIGNED <u>Larry G. Newmyer</u> TITLE <u>Engineer</u> DATE <u>6-21-82</u>

INSTRUCTIONS

This form is to be filed with the appropriate District Office of the Commission not later than 20 days after the completion of any newly-drilled or deepened well. It shall be accompanied by one copy of all electrical and radio-activity logs run on the well and a summary of all special tests conducted, including drill stem tests. All depths reported shall be measured depths. In the case of direction ally drilled wells, true vertical depths shall also be reported. For multiple completions, Items 30 through 34 shall be reported for each zone. The form is to be filed in quintuplicate except on state land, where six copies are required. See Rule 1105.

INDICATE FORMATION TOPS IN CONFORMANCE WITH GEOGRAPHICAL SECTION OF STATE

Southeastern New Mexico

Northwestern New Mexico

T. Anhy <u>1124</u>	T. Canyon _____	T. Ojo Alamo _____	T. Penn. "B" _____
T. Salt <u>1212</u>	T. Strawn _____	T. Kirtland-Fruitland _____	T. Penn. "C" _____
B. Salt <u>2423</u>	T. Atoka _____	T. Pictured Cliffs _____	T. Penn. "D" _____
T. Yates <u>2570</u>	T. Miss _____	T. Cliff House _____	T. Leadville _____
T. 7 Rivers <u>2835</u>	T. Devonian _____	T. Menefee _____	T. Madison _____
T. Queen <u>3299</u>	T. Silurian _____	T. Point Lookout _____	T. Elbert _____
T. Grayburg <u>3613</u>	T. Montoya _____	T. Mancos _____	T. McCracken _____
T. San Andres _____	T. Simpson _____	T. Gallup _____	T. Ignacio Qtzite _____
T. Glorieta _____	T. McKee _____	Base Greenhorn _____	T. Granite _____
T. Paddock _____	T. Ellenburger _____	T. Dakota _____	T. _____
T. Blinbry _____	T. Gr. Wash _____	T. Morrison _____	T. _____
T. Tubb _____	T. Granite _____	T. Todilto _____	T. _____
T. Drinkard _____	T. Delaware Sand _____	T. Entrada _____	T. _____
T. Abo _____	T. Bone Springs _____	T. Wingate _____	T. _____
T. Wolfcamp _____	T. _____	T. Chinle _____	T. _____
T. Penn. _____	T. _____	T. Permian _____	T. _____
T. Cisco (Bough C) _____	T. _____	T. Penn. "A" _____	T. _____

OIL OR GAS SANDS OR ZONES

No. 1, from 3426 to 3583 No. 4, from _____ to _____
 No. 2, from _____ to _____ No. 5, from _____ to _____
 No. 3, from _____ to _____ No. 6, from _____ to _____

IMPORTANT WATER SANDS

Include data on rate of water inflow and elevation to which water rose in hole.

No. 1, from _____ to _____ feet
 No. 2, from _____ to _____ feet
 No. 3, from _____ to _____ feet
 No. 4, from _____ to _____ feet

FORMATION RECORD (Attach additional sheets if necessary)

From	To	Thickness in Feet	Formation	From	To	Thickness in Feet	Formation
1124	1212	88	Anhydrite				
1212	2423	1211	Salt and Anhydrite				
2423	2570	147	Dolomite and Anhydrite				
2570	2835	265	Dolomite and Sand				
2835	3299	464	Dolomite and Sand				
3299	3423	124	Dolomite and Sand				
3423	3613	190	Dolomite and Sand				
3613	4000	387	Dolomite and Sand				

INCLINATION REPORT

OPERATOR DOYLE HARTMAN ADDRESS 500 NORTH MAIN, MIDLAND, TX 79702LEASE NAME STATE A20 WELL NO. #4 FIELD LOCATION

DEPTH	ANGLE INCLINATION DEGREES	DISPLACEMENT	DISPLACEMENT ACCUMULATED
442	1/4	1.9448	1.9448
917	1/2	4.1325	6.0773
1441	1/2	4.5588	10.6361
1965	3/4	6.8644	17.5005
2555	1	10.3250	27.8255
3051	1	8.6800	36.5055
3548	1 1/4	10.8346	47.3401
4000	1 1/2	11.8424	59.1825

I hereby certify that the above data as set forth is true and correct to the best of my knowledge and belief.

CACTUS DRILLING COMPANY

Denise Leake
TITLE OFFICE MANAGER

AFFIDAVIT:

Before me, the undersigned authority, appeared DENISE LEAKE known to me to be the person whose name is subscribed herebelow, who, on making deposition, under oath states that he is acting for and in behalf of the operator of the well identified above, and that to the best of his knowledge and belief such well was not intentionally deviated from the true vertical whatsoever.

Denise Leake JUN 16 1982
AFFIANT'S SIGNATURE

Sworn and subscribed to in my presence on this the 14 day of JUNE, 1982

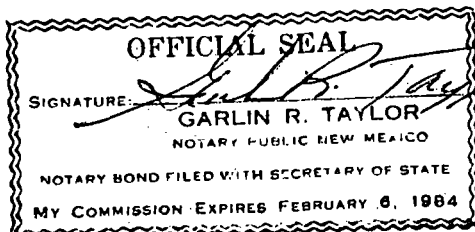

SEAL

Notary Public in and for the County
of Lea, State of New Mexico

NO. OF COPIES RECEIVED	
DISTRIBUTION	
SANITARY	
FILE	
U.S.G.S.	
LAND OFFICE	
TRANSPORTER	OIL
	GAS
OPERATOR	
PRODUCTION OFFICE	

NEW MEXICO OIL CONSERVATION COMMISSION
REQUEST FOR ALLOWABLE
(AND)
AUTHORIZATION TO TRANSPORT OIL AND NATURAL GAS

Form C-104
Supersedes Old C-104 and C-1
Effective 1-1-65

I.

Operator DOYLE HARTMAN	
Address P. O. Box 10426, Midland, Texas 79702	
Reason(s) for filing (Check proper box)	
New Well <input checked="" type="checkbox"/>	Change in Transporter of:
Recompletion <input type="checkbox"/>	Oil <input type="checkbox"/> Dry Gas <input type="checkbox"/>
Change in Ownership <input type="checkbox"/>	Casinghead Gas <input type="checkbox"/> Condensate <input type="checkbox"/>

If change of ownership give name
and address of previous owner

II. DESCRIPTION OF WELL AND LEASE

Lease Name State A-20	Well No. 4	Pool Name, including Formation Eumont (Queen)	Kind of Lease State, Federal or Fee	State	Lease No. B-2656
Location					
Unit Letter J	1450	Feet From The South	Line and 1980	Feet From The East	
Line of Section 20	Township 20-S	Range 37-E	NMPM,	Lea	County

III. DESIGNATION OF TRANSPORTER OF OIL AND NATURAL GAS

Name of Authorized Transporter of Oil <input type="checkbox"/> or Condensate <input type="checkbox"/>	Address (Give address to which approved copy of this form is to be sent)					
Name of Authorized Transporter of Casinghead Gas <input type="checkbox"/> or Dry Gas <input checked="" type="checkbox"/>	Address (Give address to which approved copy of this form is to be sent)					
El Paso Natural Gas	P. O. Box 1384 Jal, New Mexico 88252					
If well produces oil or liquids, give location of tanks.	Unit	Sec.	Twp.	Pge.	Is gas actually connected?	When
					No	June 28, 1982

If this production is commingled with that from any other lease or pool, give commingling order number:

IV. COMPLETION DATA

Designate Type of Completion - (X)	Oil Well	Gas Well	New Well	Workover	Deepen	Plug Back	Same Res'v.	Diff. Res'v.
		X	X					
Date Spudded 6-5-82	Date Compl. Ready to Prod. 6-19-82	Total Depth 4000	P.B.T.D. 3986					
Elevations (DF, RKB, RT, GR, etc.) 3515 GL	Name of Producing Formation (Queen)	Top Oil/Gas Pay 3426	Tubing Depth 3791					
Perforations 3426-3583 w/21 Shots (Queen)			Depth Casing Shoe 3998					
TUBING, CASING, AND CEMENTING RECORD								
HOLE SIZE	CASING & TUBING SIZE		DEPTH SET		SACKS CEMENT			
12 1/4	9 5/8" 36.0 lb/ft		424'		225 (circ)			
8 3/4	7" 23.0 lb/ft		3998'		900 (circ)			

V. TEST DATA AND REQUEST FOR ALLOWABLE OIL WELL (Test must be after recovery of total volume of load oil and must be equal to or exceed top allowable for this depth or be for full 24 hours)

Date First New Oil Run To Tanks	Date of Test	Producing Method (Flow, pump, gas lift, etc.)	
Length of Test	Tubing Pressure	Casing Pressure	Choke Size
Actual Prod. During Test	Oil-Bbls.	Water-Bbls.	Gas-MCF

GAS WELL

Actual Prod. Test-MCF/D 234	Length of Test 24 hours	Bbls. Condensate/MMCF --	Gravity of Condensate --
Testing Method (pilot, back pr.) Office Tester	Tubing Pressure (Shut-in) --	Casing Pressure (Shut-in) PCP=277	Choke Size 13/64

VI. CERTIFICATE OF COMPLIANCE

I hereby certify that the rules and regulations of the Oil Conservation Commission have been complied with and that the information given above is true and complete to the best of my knowledge and belief.

Larry G. Nemy
(Signature)

Engineer

(Title)

6-21-82

(Date)

OIL CONSERVATION COMMISSION

APPROVED _____, 19__

BY _____

TITLE _____

This form is to be filed in compliance with RULE 1104.

If this is a request for allowable for a newly drilled or deepened well, this form must be accompanied by a tabulation of the deviate tests taken on the well in accordance with RULE 111.

All sections of this form must be filled out completely for allowable on new and recompleted wells.

Fill out only Sections I, II, III, and VI for changes of owner, well name or number, or transporter, or other such change of condition.

Separate Forms C-104 must be filed for each pool in multiple completed wells.

DOYLE HARTMAN
State "A-20" No. 4
J-20-20S-37E

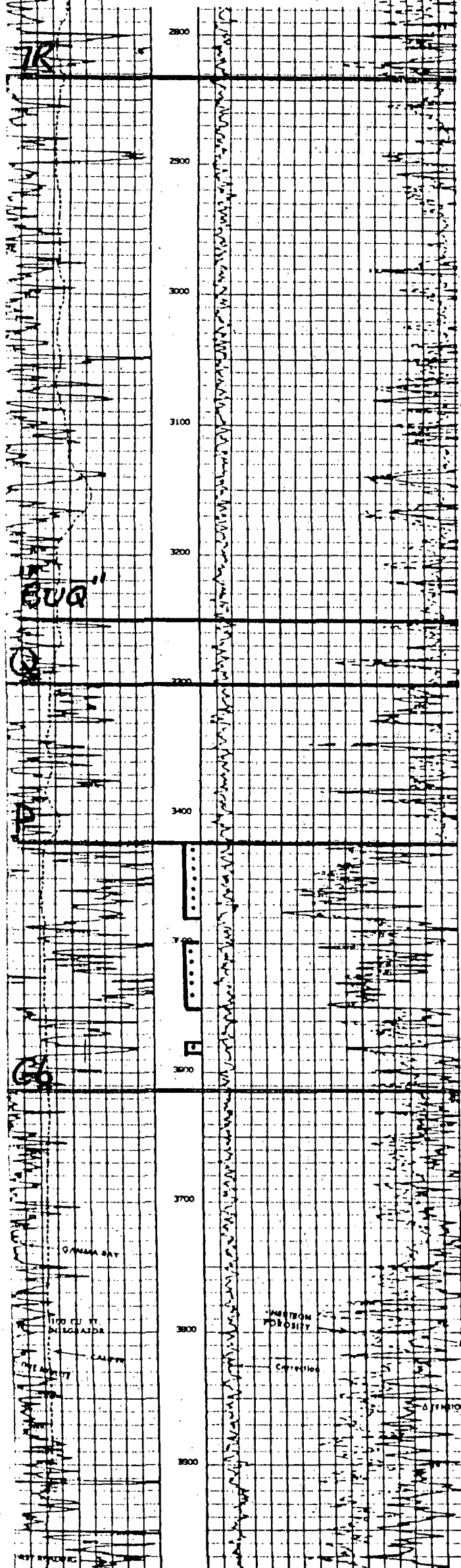

COMPANY	Doyle Hartman		
WELL	State "A-20" No. 4		
FIELD	Eumont (Gas)		
LOCATION	1450 FSL & 1980 FEL (J)		
	Section 20, T-20-S, R-37-E		
COUNTY	Lea		
STATE	New Mexico		
ELEVATIONS:	KB	3525	
	DF		
	GL	3515	

COMPLETION RECORD

SPUD DATE	6-5-82	COMP. DATE	6-19-82
TD	4000	PBTD	3986
CASING RECORD	9 5/8 @ 424 w/225		
	7 @ 4000 w/900		
PERFORATING RECORD	Perf: 3426-3583 w/21		
STIMULATION	A/5600		
	SWF/88,200 + 179,000		
IP	IP= 234 MCFPD		
GOR	GR		
TP	(8½ x 64 x 1½)	CP	277
CHOKE	13/64 TUBING	2 3/8 @	3791
DST RECORD			
REMARKS			

DOYLE HARTMAN
(BWP, INC)
State "A-20" No. 1
I-20-20S-37E

COMPANY	Doyle Hartman (BWP)
WELL	State "A-20" No. 1
FIELD	Eumont/Eunice-Monument
LOCATION	2310 FSL & 330 FEL (I) Section 20, T-20-S, R-37-E
COUNTY	Lea
STATE	New Mexico
ELEVATIONS:	KB DF 3523 GL

COMPLETION RECORD			
SPUD DATE	7-15-37	COMP. DATE	8-19-37
TD	3840	PBTD	3840
CASING RECORD	7 5/8 @ 1197 w/325 5 1/2 @ 3633 w/425		
PERFORATING RECORD	OH: 3633-3840 (Grayburg)		
STIMULATION	Natural		
IP	IPF= 240 BOPD		
GOR	GR		
TP	CP		
CHOKE	TUBING @		
DST RECORD	11-15-54 Set Model "D" packer @ 3612. Perf 3415-3510 w/50. A/500. CAOF 2700 MCFPD from upper Penrose. Well dually complet from Eumont gas and Eunice-Monument Oil. 8-31-66 T&A Eunice-Monument.		
REMARKS	Well singularly completed from Eumont gas.		
	4-82 Eumont Cum= 3110 MMCF		

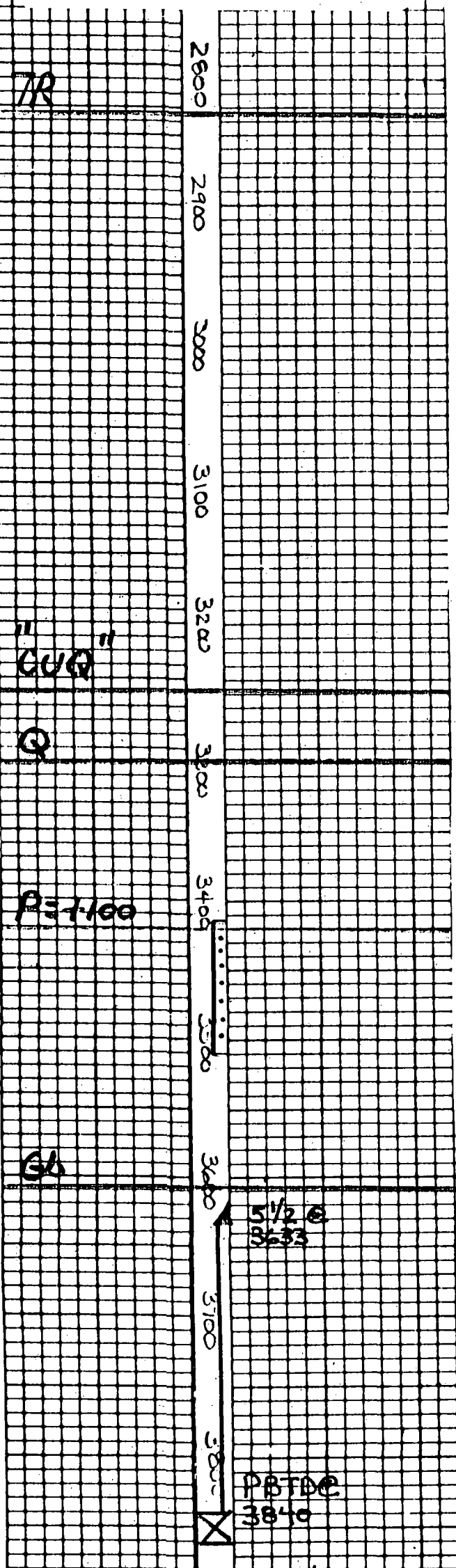

NO. OF COPIES RECEIVED	
DISTRIBUTION	
AREA	
FILE	
DATE	
AND OFFICE	
OPERATOR	

NEW MEXICO OIL CONSERVATION COMMISSION

Form C-103
Supersedes Old
C-102 and C-103
Effective 1-1-65

5a. Indicate Type of Lease
State ☒ Fee ☐
5. State Oil & Gas Lease No.
B 2656

SUNDRY NOTICES AND REPORTS ON WELLS

DO NOT USE THIS FORM FOR NOTICES TO DRILLER TO CEMENT OR PLUG BACK TO A DIFFERENT RESERVOIR.
USE "APPLICATION FOR PERMIT TO DRILL" (FORM C-101, FOR SUCH PROPOSALS.)

6. Well ☒ GAS WELL ☐ OTHER ☐
Name of Operator
B. W. P., Inc.
Address of Operator
1012 Alpine, Midland, Texas 79703
Location of Well
UNIT LETTER **0** **990** FEET FROM THE **South** LINE AND **2310** FEET FROM
East THE **20** LINE, SECTION **20S** TOWNSHIP **37E** RANGE **37E** RANGE
M.P.M.

7. Unit Agreement No.
8. Form or Lease Name
State A-20
9. Well No.
3
10. Field and Pool, or Willam
Eunice (GB-SA) Oil
12. County
Lea

11. Elevation (Show whether DF, RT, GR, etc.)
3520 GR

Check Appropriate Box To Indicate Nature of Notice, Report or Other Data
NOTICE OF INTENTION TO: SUBSEQUENT REPORT OF:

REPAIR REMEDIAL WORK <input type="checkbox"/> PERMANENTLY ABANDON <input type="checkbox"/> PLUG OR ALTER CASING <input type="checkbox"/> OTHER <input type="checkbox"/>	PLUG AND ABANDON <input type="checkbox"/> CHANGE PLANS <input type="checkbox"/>	REMEDIAL WORK <input type="checkbox"/> COMMENCE DRILLING OPS. <input type="checkbox"/> CASING TEST AND CEMENT JOB <input type="checkbox"/> OTHER <input type="checkbox"/>	ALTERING CASING <input type="checkbox"/> PLUG AND ABANDONMENT <input type="checkbox"/>
--	--	--	---

Describe Proposed or Completed Operations (Clearly state all pertinent details, and give pertinent dates, including estimated date of starting any proposed work) SEE RULE 1103.

7-13-77 Started checking well to install pumping equipment.
7-13-77 thru 7-18-77 Fished corroded 2 3/8 tubing string. Circulated cavings out of open hole from 3604 to 3670 GLM. Hole broke out in 5 1/2.
7-19-77 Permission to P&A granted. Spotted 35sx plug from 3670' to 3550'.
7-20-77 Tagged up on bottom plug at 3550' (54' above casing shoe). Mixed ten pound Brine and Salt Gel Mud. Spotted 25sx (270ft) cement plug in 5 1/2" casing at 1200'. Ran Halliburton packer, located hole in 5 1/2" at approximately 280'. Circulated cement through hole at 280' outside 5 1/2" back to surface.
7-21-77 Set surface marker and broke out all connection.
7-25-77 Cleaned up location.

Report of casing leak on the
State "A"-20 #3 in Section 20,
T-20-S, R-37-E, Unit 0

I hereby certify that the information above is true and complete to the best of my knowledge and belief.

SIGNED *W. H. Haller* TITLE Owner and Manager DATE 8-6-77
APPROVED BY *Don W. Penyan* TITLE Commissioner DATE MAR 6 1978
CONDITIONS OF APPROVAL, IF ANY:

0-20-20 37

MISCELLANEOUS REPORTS ON WELLS

COMPANY VEM OIL CO. BOX 3985 ODESSA, TEXAS²
(Address)

This is a Report of: (Check appropriate block)

<input type="checkbox"/> Beginning Drilling Operations	<input type="checkbox"/> Results of Test of Casing Shut-off
<input type="checkbox"/> Plugging	<input checked="" type="checkbox"/> Remedial Work
	<input type="checkbox"/> Other

Found leak at 634' - Went in hole with tubeing - Set retainer and Bridge Plug at 2800' - Tested casing at 500' intervals to 634'; and squeezed 400 sacks of cement at 800# p.s.i. . Leak repaired and drilled out cement and bridge plug and tested casing at 700# with Halliburton Pump. Test Okay. Cleaned out to TD and acidized with 1000 gal. MCA. Well now pumping approximately 95% water. Will continue to test-pump well.

Original Well Data:

DF Elev. _____ TD _____ PBD _____ Prod. Int. _____ Compl Date _____
Tbng. Dia _____ Tbng Depth _____ Oil String Dia _____ Oil String Depth _____
Perf Interval (s) _____
Open Hole Interval _____ Producing Formation (s) _____

BEFORE

AFTER

Date of Test	_____	_____
Oil Production, bbls. per day	_____	_____
Gas Production, Mcf per day	_____	_____
Water Production, bbls. per day	_____	_____
Gas-Oil Ratio, cu. ft. per bbl.	_____	_____
Gas Well Potential, Mcf per day	_____	_____
Witnessed by	_____	_____

(Company)

I hereby certify that the information given above is true and complete to the best of my knowledge.

Name Don Hough
 Title Mr. Hough
 Date Jan 1 1958

Name F. L. Wilson F. L. Wilson
Position Member of Firm
Company VEM OIL COMPANY

Report of casing leak on the
State "A" 20 #2 in Section 20,
T-20-S, R-37-E, Unit J

J-20-20-37

NEW MEXICO OIL CONSERVATION COMMISSION
MISCELLANEOUS REPORTS ON WELLS
(Submit to appropriate District Office as per Commission Rule 1106)

COMPANY VEM OIL COMPANY BOX 3985, ODESSA TEXAS
(Address)

LEASE STATE "A" 20 WELL NO. 2 UNIT J S 20 T 20 R 37
DATE WORK PERFORMED 6-27-58 POOL EUNICE

This is a Report of: (Check appropriate block) ☐ Results of Test of Casing Shut-off
☐ Beginning Drilling Operations ☐ Remedial Work
☒ Plugging ☐ Other _____

Detailed account of work done, nature and quantity of materials used and results obtained.

TD 3835'

Production string cemented from top to bottom. Unable to recover any casing.

Squeezed open hole 3800 to 3835 w/100 sacks. Pressured up to 600#.

No drop in pressure.

Set plug at 634' w/50 sacks.

10 sacks at surface w/ regulation marker.

*Verbal approval to plug
recd. from Mr. Fischer.*

FILL IN BELOW FOR REMEDIAL WORK REPORTS ONLY

Original Well Data:

DF Elev. _____ TD _____ PBD _____ Prod. Int. _____ Compl Date _____
Tbng. Dia _____ Tbng Depth _____ Oil String Dia _____ Oil String Depth _____
Perf Interval (s) _____
Open Hole Interval _____ Producing Formation (s) _____

RESULTS OF WORKOVER:

BEFORE

AFTER

Date of Test

Oil Production, bbls. per day

Gas Production, Mcf per day

Water Production, bbls. per day

Gas-Oil Ratio, cu. ft. per bbl.

Gas Well Potential, Mcf per day

Witnessed by _____

(Company)

OIL CONSERVATION COMMISSION

I hereby certify that the information given above is true and complete to the best of my knowledge.

Name

John W. Runyon

Title

Date

Name

F.L. Wilson

Position

F.L. Wilson - Partner

Company

VEM OIL COMPANY

J-20-20-37

**NEW MEXICO OIL CONSERVATION COMMISSION
WELL LOCATION AND ACREAGE DEDICATION PLAT**

Form C-122
Supersedes C-128
Effective 1-1-65

All distances must be from the outer boundaries of the Section

Owner Doyle Hartman			Lease State A-20		Well No. 4
Unit Letter J	Section 20	Township 20 South	Range 37 East	County Lea	
Actual Well Location of Well: 1450 feet from the south line and 1980 feet from the east line					
Ground Level Elev. 3515⁰	Producing Formation Queen-Penrose		Pool Eumont (Gas)		Dedicated Acreage: 160 Acres

1. Outline the acreage dedicated to the subject well by colored pencil or hatchure marks on the plat below.
2. If more than one lease is dedicated to the well, outline each and identify the ownership thereof (both as to working interest and royalty).
3. If more than one lease of different ownership is dedicated to the well, have the interests of all owners been consolidated by communitization, unitization, force-pooling, etc?

☐ Yes ☐ No If answer is "yes," type of consolidation _____

If answer is "no" list the owners and tract descriptions which have actually been consolidated. (Use reverse side of this form if necessary.) _____

No allowable will be assigned to the well until all interests have been consolidated (by communitization, unitization, forced-pooling, or otherwise) or until a non-standard unit, eliminating such interests, has been approved by the Commission.

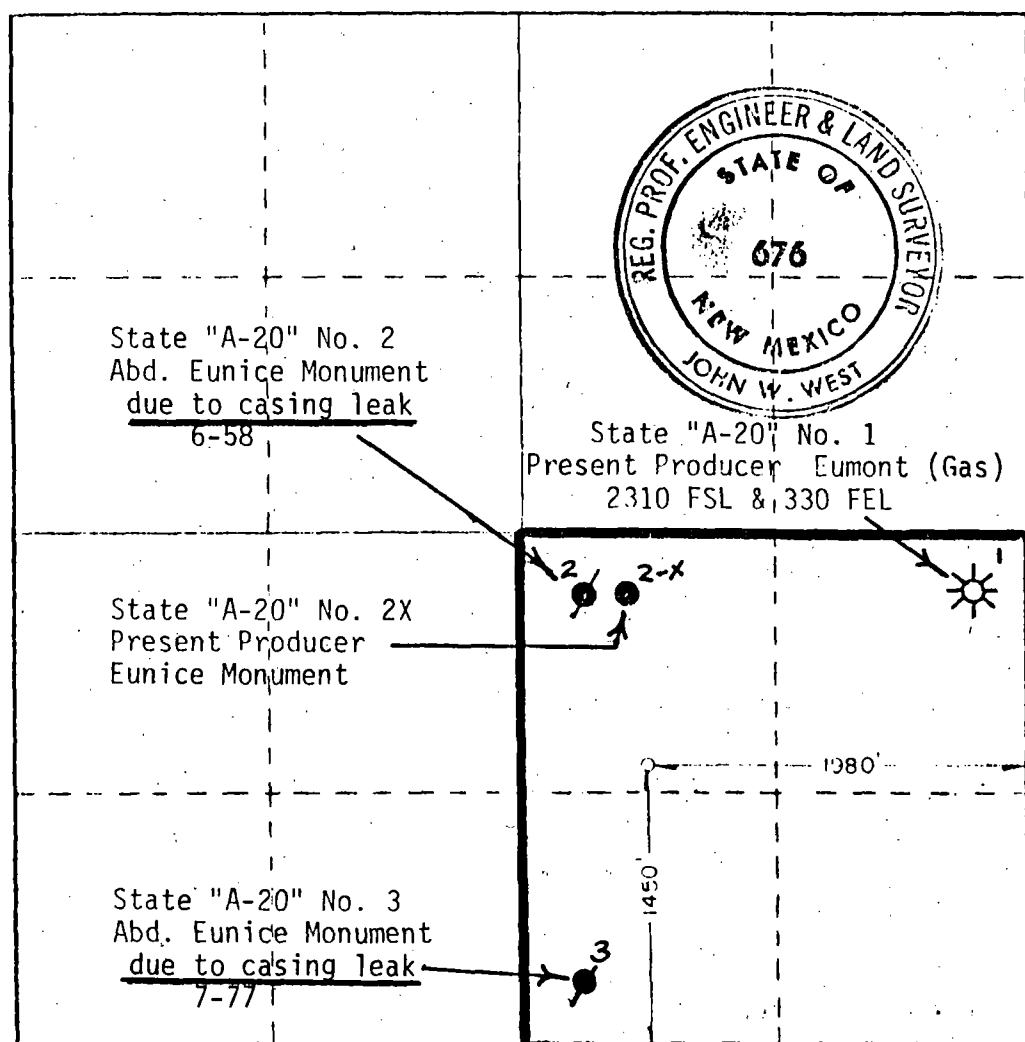

CERTIFICATION

I hereby certify that the information contained herein is true and complete to the best of my knowledge and belief.

Name
Larry A. Nermyr

Position
Engineer

Company
Doyle Hartman

Date
April 30, 1982

I hereby certify that the well location shown on this plat was plotted from field notes of actual surveys made by me or under my supervision, and that the same is true and correct to the best of my knowledge and belief.

Date Surveyed
5-1-82

Registered Professional Engineer
and/or Land Surveyor

Certificate No. **JOHN W. WEST 676**
PATRICK A. ROMERO 6665
Ronald J. Edison 3239

STATE OF NEW MEXICO
ENERGY AND MINERALS DEPARTMENT
OIL CONSERVATION DIVISION

IN THE MATTER OF THE HEARING
CALLED BY THE OIL CONSERVATION
DIVISION FOR THE PURPOSE OF
CONSIDERING:

CASE NO. 7618
Order No. R-7041

APPLICATION OF DOYLE HARTMAN FOR
AN UNORTHODOX GAS WELL LOCATION AND
SIMULTANEOUS DEDICATION, LEA COUNTY,
NEW MEXICO.

ORDER OF THE DIVISION

BY THE DIVISION:

This cause came on for hearing at 9 a.m. on July 21, 1982, at Santa Fe, New Mexico, before Examiner Daniel S. Nutter.

NOW, on this 28th day of July, 1982, the Division Director, having considered the testimony, the record, and the recommendations of the Examiner, and being fully advised in the premises,

FINDS:

- (1) That due public notice having been given as required by law, the Division has jurisdiction of this cause and the subject matter thereof.
- (2) That the applicant, Doyle Hartman, seeks approval of an unorthodox gas well location 1450 feet from the South line and 1980 feet from the East line of Section 20, Township 20 South, Range 37 East, NMPM, Eumont Gas Pool, Lea County, New Mexico.
- (3) That the SE/4 of said Section 20 is to be simultaneously dedicated to said well and to applicant's State A-20 Well No. 1 located in Unit I, 2310 feet from the South line and 330 feet from the East line of said Section 20.
- (4) That a well at said unorthodox location will better enable applicant to produce the gas underlying the proration unit.
- (5) That no offset operator objected to the proposed unorthodox location.

Case No. 7618
Order No. R-7041

(6) That approval of the subject application will afford the applicant the opportunity to produce its just and equitable share of the gas in the subject pool, will prevent the economic loss caused by the drilling of unnecessary wells, avoid the augmentation of risk arising from the drilling of an excessive number of wells, and will otherwise prevent waste and protect correlative rights.

IT IS THEREFORE ORDERED:

(1) That the application of Doyle Hartman for an unorthodox gas well location for the Eumont Gas Pool is hereby approved for a well to be located at a point 1450 feet from the South line and 1980 feet from the East line of Section 20, Township 20 South, Range 37 East, NMPM, Lea County, New Mexico.

(2) That the SE/4 of said Section 20 shall be simultaneously dedicated to the above-described well and to applicant's State A-20 Well No. 1 located in Unit I, 2310 feet from the South line and 330 feet from the East line of said Section 20.

(3) That jurisdiction of this cause is retained for the entry of such further orders as the Division may deem necessary.

DONE at Santa Fe, New Mexico, on the day and year hereinabove designated.

STATE OF NEW MEXICO
OIL CONSERVATION DIVISION

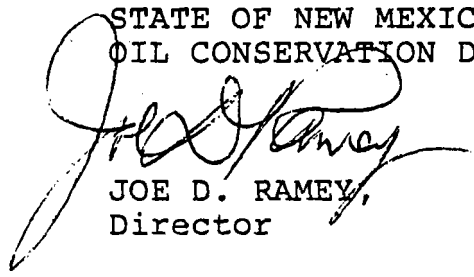
JOE D. RAMEY,
Director

S E A L

OIL CONSERVATION COMMISSION

P. O. BOX-871

SANTA FE, NEW MEXICO

January 20, 1955

C
Vem Oil Company
P. O. Box 3985
Odessa, Texas

O
Attention: Mr. F. L. Wilson

Administrative Order NSP-75

Gentlemen:

P
Reference is made to your application for approval of a 160-acre non-standard gas proration unit in the Eumont Gas Pool consisting of the following acreage:

Twp. 20 South, Rge. 37 East, NMPM
SE/4 of Section 20

Common School

Y
It is understood that this unit is to be ascribed to your State A-20 well No. 1, located in the NE/4 SE/4 of Section 20, Township 20 South, Range 37 East, NMPM, Lea County, New Mexico.

By authority granted me under provisions of Rule 5, Section (b)-6 of the Special Rules and Regulations for the Eumont Gas Pool, as set forth in Order R-520, you are hereby authorized to operate the above described acreage as a non-standard gas proration unit, with allowable to be assigned thereto in accordance with pool rules, based upon the unit size of 160 acres.

Very truly yours,

W. B. Macey
Secretary - Director

WBM:jh

cc: Oil Conservation Commission, Hobbs

N. M. Oil & Gas Engineering Committee, Hobbs

Immediate
8/5/82

STATE OF NEW MEXICO
ENERGY AND MINERALS DEPARTMENT

OIL CONSERVATION DIVISION
P. O. Box 2088
SANTA FE, NEW MEXICO
87501

ADMINISTRATIVE ORDER
NFL 55

Approved
8/5/82

INFILL DRILLING FINDINGS PURSUANT TO
SECTION 271.305(b) OF THE FEDERAL ENERGY REGULATORY
COMMISSION REGULATIONS, NATURAL GAS POLICY ACT OF 1978
AND OIL CONSERVATION DIVISION ORDER NO. R-6013-A

I.

Operator Doyle Hartman Well Name and No. State "A" 20 Well No. 4
Location: Unit J Sec. 20 Twp. 20S Rng. 37E Cty. Lea

II.

THE DIVISION FINDS:

- (1) That Section 271.305(b) of the Federal Energy Regulatory Commission Regulations promulgated pursuant to the Natural Gas Policy Act of 1978 provides that, in order for an infill well to qualify as a new onshore production well under Section 103 of said Act, the Division must find that the infill well is necessary to effectively and efficiently drain a portion of the reservoir covered by the proration unit which cannot be so drained by any existing well within that unit.
- (2) That by Order No. R-6013-A, dated February 8, 1980, the Division established an administrative procedure whereby the Division Director and the Division Examiners are empowered to act for the Division and find that an infill well is necessary.
- (3) That the well for which a finding is sought is completed in the Eumont Yale Seven Rivers Queen (Gas) Pool, and the standard spacing unit in said pool is 640 acres.
- (4) That a 160-acre proration unit comprising the SE 1/4 of Sec. 20, Twp. 20S, Rng. 37E, is currently dedicated to the Doyle Hartman State "A" 20 Well No. 1 located in Unit I of said section.
- (5) That this proration unit is () standard ☒ nonstandard; if nonstandard, said unit was previously approved by Order No. NSP-75.
- (6) That said proration unit is not being effectively and efficiently drained by the existing well(s) on the unit.
- (7) That the drilling and completion of the well for which a finding is sought should result in the production of an additional 384,700 MCF of gas from the proration unit which would not otherwise be recovered.
- (8) That all the requirements of Order No. R-6013-A have been complied with, and that the well for which a finding is sought is necessary to effectively and efficiently drain a portion of the reservoir covered by said proration unit which cannot be so drained by any existing well within the unit.
- (9) That in order to permit effective and efficient drainage of said proration unit, the subject application should be approved.

IT IS THEREFORE ORDERED:

- (1) That the applicant is hereby authorized to drill the well described in Section I above as an infill well on the existing proration unit described in Section II(4) above. The authorization for infill drilling granted by this order is necessary to permit the drainage of a portion of the reservoir covered by said proration unit which cannot be effectively and efficiently drained by any existing well thereon.
- (2) That jurisdiction of this cause is retained for the entry of such further orders as the Division may deem necessary.

DONE at Santa Fe, New Mexico, on this _____ day of _____, 19____.

cc - OGD Hobbs
NM O & E C - Hobbs
OGD Machine Sect. S.F.
N.M. Land Office

DIVISION DIRECTOR _____ EXAMINER _____