

INFILL DRILLING FINDINGS PURSUANT TO  
SECTION 271.305(b) OF THE FEDERAL ENERGY REGULATORY  
COMMISSION REGULATIONS, NATURAL GAS POLICY ACT OF 1978  
AND OIL CONSERVATION DIVISION ORDER NO. R-6013-A

I.  
Operator Doyle Hartman Well Name and No. Munn-Harrison "B" Well No. 1  
Location: Unit C Sec. 7 Twp. 25S Rng. 37E Cty. Lea

II.  
THE DIVISION FINDS:

- (1) That Section 271.305(b) of the Federal Energy Regulatory Commission Regulations promulgated pursuant to the Natural Gas Policy Act of 1978 provides that, in order for an infill well to qualify as a new onshore production well under Section 103 of said Act, the Division must find that the infill well is necessary to effectively and efficiently drain a portion of the reservoir covered by the proration unit which cannot be so drained by any existing well within that unit.
- (2) That by Order No. R-6013-A, dated February 8, 1980, the Division established an administrative procedure whereby the Division Director and the Division Examiners are empowered to act for the Division and find that an infill well is necessary.
- (3) That the well for which a finding is sought is completed in the Jalmat Pool, and the standard spacing unit in said pool is 640 acres.
- (4) That a 80-acre proration unit comprising the E/2 NW/4 of Sec. 7, Twp. 25S, Rng. 37E, is currently dedicated to the Judy Well No. 2 located in Unit F of said section.
- (5) That this proration unit is ( ) standard (X) nonstandard; if nonstandard, said unit was previously approved by Order No. NSP-1304(L).
- (6) That said proration unit is not being effectively and efficiently drained by the existing well(s) on the unit.
- (7) That the drilling and completion of the well for which a finding is sought should result in the production of an additional 346,000 MCF of gas from the proration unit which would not otherwise be recovered.
- (8) That all the requirements of Order No. R-6013-A have been complied with, and that the well for which a finding is sought is necessary to effectively and efficiently drain a portion of the reservoir covered by said proration unit which cannot be so drained by any existing well within the unit.
- (9) That in order to permit effective and efficient drainage of said proration unit, the subject application should be approved.

IT IS THEREFORE ORDERED:

(1) That the applicant is hereby authorized to drill the well described in Section I above as an infill well on the existing proration unit described in Section II(4) above. The authorization for infill drilling granted by this order is necessary to permit the drainage of a portion of the reservoir covered by said proration unit which cannot be effectively and efficiently drained by any existing well thereon.

(2) That jurisdiction of this cause is retained for the entry of such further orders as the Division may deem necessary.

DONE at Santa Fe, New Mexico, on this 17th day of August, 19 82.

  
DIVISION DIRECTOR EXAMINER

**DOYLE HARTMAN**

*Oil Operator*

500 N. MAIN

P. O. BOX 10426

MIDLAND, TEXAS 79702

(915) 684-4011

June 16, 1982

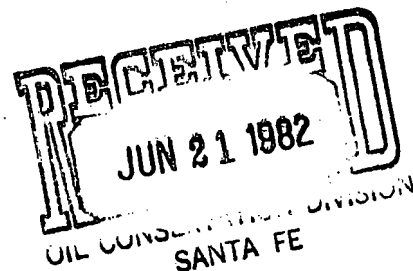

State of New Mexico  
Energy and Minerals Department  
Oil Conservation Division  
P. O. Box 2088  
Santa Fe, New Mexico 87501

Attention: Mr. R. L. Stamets

Re: Administrative Procedure  
Infill Finding  
Munn-Harrison "B" No. 1  
E/2-NW/4 Section 7  
T-25-S, R-37-E  
Lea County, New Mexico

Gentlemen:

Pursuant to Section 271.305 of the Final Rules and Regulations of the Federal Energy Regulatory Commission relating to Section 103 of the Natural Gas Policy Act of 1978, and to Order R-6013-A of the New Mexico Oil Conservation Division, we hereby request an infill finding (NFL) for the above captioned Munn-Harrison "B" No. 1 Jalmat (Gas) well located 660' FNL & 2256' FWL Section 7, T-25-S, R-37-E, Lea County, New Mexico.

With regard to our request, and in accordance with Order R-6013-A, we submit the following:

- Rule 5      A copy of approved Form C-101 for the infill well and Form C-102 showing the proration unit dedicated to the well are enclosed.
- Rule 6      The name of the pool in which the infill well has been drilled is Jalmat, and the standard spacing unit therefor is 640 acres.
- Rule 7      The number of the Division order approving the non-standard proration unit dedicated to the well is NSP-1304(L).
- Rule 8      Form entitled CERTIFICATION OF WELL DATA ON PRORATION UNIT PLAT describes all wells drilled on the proration unit (including the completed infill well) which are or have been completed in the same pool or reservoir as the proposed infill well showing:
- a.    lease name and well location;

- b. spud date;
- c. completion date;
- d. a description of any mechanical problems experienced along with a summary of remedial action(s) taken and the results obtained;
- e. the current rate of production, and;
- f. date of plug and abandonment, if any; and
- g. a clear and concise statement indicating why the existing well(s) on the proration unit cannot effectively and efficiently drain the portion of the reservoir covered by the proration unit.

Rule 9 Letter dated June 16, 1982, from William P. Aycock submits geological and engineering information sufficient to support a finding as to the necessity for an infill including:

- a. formation structure map;
- b. the volume of increased ultimate recovery expected to be obtained and a narrative describing how the increase was determined;
- c. any other supporting data which the applicant deems to be relevant which may include:
  - 1. porosity and permeability factors
  - 2. production/pressure decline curve
  - 3. effects of secondary recovery or pressure maintenance operations.

Rule 10 This application for infill finding is being filed in duplicate with the Santa Fe office of the Division.

Rule 11 All operators of proration or spacing units offsetting the unit for which an infill finding is sought have been notified of this application by certified or registered mail.

We respectfully that the Commission grant our request for an infill finding pursuant to Order R-6013-A.

Very truly yours,

DOYLE HARTMAN

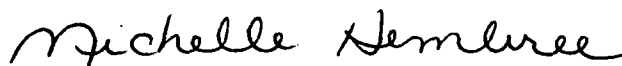

Michelle Hembree  
Administrative Assistant

/mh

Enclosures as above

WILLIAM P. AYCOCK & ASSOCIATES, INC.

Petroleum Engineering Consultants  
308 WALL TOWERS WEST  
MIDLAND, TEXAS 79701  
PHONE 915/683-5721

June 16, 1982

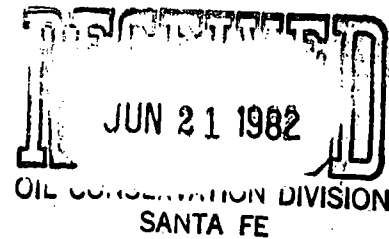

New Mexico Department of Energy and Minerals,  
Oil Conservation Division  
P. O. Box 2088  
Santa Fe, New Mexico 87501

Attention Mr. R. L. Stamets, Technical Support Chief

Subject: Administrative Application for  
Infill Well Finding for Doyle  
Hartman's Munn-Harrison "B"-1 Well,  
Section 7, Twp. 25 South, Range 37  
East @ 660' FNL & 2256' FWL,  
Jalmat Pool, Lea County, New Mexico

Gentlemen:

Application is hereby made for an administrative infill well finding effective with initial gas deliveries for the described well, in accordance with Exhibit "A", Order R-6013A. The following constitute compliance with said order:

Rule 5: Attached are copies of Forms C-101 and C-102.

Rule 6: The name of the pool in which the infill well has been drilled is the Jalmat Pool. Standard well spacing in the Jalmat Pool is 640 acres.

Rule 7: The non-standard 80-acre proration unit assigned to the application well was approved administratively by Order NSP-1304(L), dated May 3, 1982, a copy of which is attached hereto.

Rule 8: The requirements of Sections "a." through "f." are included on the attached Table No. 1, "Summary of Required Information, Rule 8, Exhibit "A", Order No. R-6013-A". Section "g." of Rule 8 requires "a clear and concise statement indicating why the existing well(s) on the proration unit cannot effectively and efficiently drain the portion of the reservoir covered by the proration unit." The Jalmat Pool proration unit dedicated to the application well is the E/2 NW/4 Section 7, Twp. 25 South, Range 37 East. The north 40 acres (NE/4 NW/4) of the non-standard proration unit was not dedicated to a Jalmat Pool well prior to its dedication to the application well, the south 40 acres (SE/4 NW/4) of the non-standard proration unit was and is

dedicated to the Tahoe Oil & Cattle Co. Judy No. 2 Well (located 1980' FNL & 1980' FWL, 7-25S-37E), so that, until the Doyle Hartman Munn-Harrison "B"-1 has been connected to the gas transportation facilities of El Paso Natural Gas Co. and gas deliveries have begun, the 80-acre non-standard proration unit will be simultaneously dedicated. At such time as gas sales from the Doyle Hartman Munn-Harrison "B"-1 commence, the Tahoe Oil & Cattle Co. Judy No. 2 well will be plugged and abandoned. The Tahoe Oil & Cattle Co. Judy No. 2 was completed on October 15, 1979, from ten perforations between well depths of 2801' and 3254' flowing gas on the tubing-casing annulus at a rate of 55 MCF per day. As of April 1, 1982, this well had produced an accumulated gas volume of 5201 MCF, and the mean gas production rate of this well was 65 MCF per month for the months of January through March 1982. The gas production rate for the Tahoe Oil & Cattle Co. Judy No. 2 was below the experience derived Jalmat Pool economic limit of production for January through March 1982, so that no economical gas reserves remain to be produced from this well. Accordingly, the Tahoe Oil & Cattle Co. Judy No. 2 Well cannot and could not drain the remaining Jalmat Pool gas reserves located beneath the SE/4 NW/4 7-25S-37E either efficiently or effectively.

Rule 9: Sec. a. Requires that a formation structure map be submitted; attached is a Yates formation structure map of that portion of the Jalmat Pool area that includes 7-25S-37E.

Sec. b. Requires that the "volume of increased ultimate recovery expected to be obtained and a narrative describing how the increase was determined" be submitted. The estimated ultimate gas recovery for the Doyle Hartman Munn-Harrison "B"-1 is 346 MMCF. Since there are no other economically recoverable gas reserves to be derived from the proration unit assigned to the Doyle Hartman Munn-Harrison "B"-1, the entire 346 MMCF of anticipated ultimate gas recovery constitutes "increased ultimate recovery". This estimate of ultimate recovery was derived as follows:

- (1) Well logs for the Doyle Hartman Munn-Harrison "B"-1 were analyzed, with results that can be summarized as follows:

Mean Porosity, Fcn. of Bulk Volume 0.21

Mean Connate Water Saturation,  
Fcn. of Net Effective Pore Space 0.12

Net Effective Pay Thickness, Feet 58.

Since the gross pay thickness constituting potential gas reservoir for the Hartman Munn-Harrison "B"-1 is 156 feet, the above estimate represents a net effective pay to gross pay ratio of approximately 37.2 percent.

- (2) The June 4, 1982, well test reported on Form C-103 for the Hartman Munn-Harrison "B"-1 was analyzed, with results as follows:

Stabilized Deliverability Coef-  
ficient, MCF/day per psia<sup>2</sup> 0.009127

Initial Stabilized Wellhead Shut-  
in Pressure, psia 193.2

Initial Gas Formation Volume  
Factor, scf/rcf 13.26

- (3) The results of steps (1) and (2) above were combined, resulting in the following:

Original Gas-in-Place  
MMCF/Acre 6.11  
MCF/80 Acres 489.03

Estimated Gas Recovery Factor,  
Fcn. of Orig. Gas-in-Place 0.708

Estimated Ultimate Gas Recovery,  
MCF per 80 acres 346.

Sec. c. Other supporting data submitted include the following:

N.M.O.C.D. Form C-105 for the Doyle Hartman Munn-Harrison "B"-1

All N.M.O.C.D. Forms on file for the Tahoe Oil & Cattle Co. Judy No. 2 Well.

New Mexico Department of Energy and Minerals  
June 16, 1982  
Page 4

Gas Production History Tabulation and Graph for  
the Tahoe Oil & Cattle Co. Judy No. 2 Well.

New Mexico Oil Conservation Division Order  
No. NSP-1304(L).

We believe that the above documents this application as you require;  
however, we should be pleased to furnish you with anything else you  
might require if it is available to us.

Very truly yours,

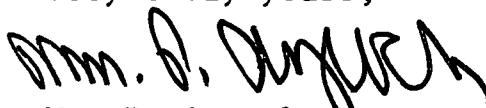
  
Wm. P. Aycock, E.E.

WPA/bw

Attachments

TABLE NO. 1

SUMMARY OF REQUIRED INFORMATION, RULE 8, EXHIBIT "A", ORDER R-6013-A,  
(SECTIONS "a." THROUGH "f.")

NATURAL GAS POLICY ACT INFILL FINDINGS, ADMINISTRATIVE PROCEDURE

<u>SECTION OF RULE 8</u>	<u>RULE 8 REQUIREMENT</u>	<u>PRE-EXISTING WELL TAHOE OIL &amp; CATTLE CO., OPERATOR</u>	<u>INFILL APPLICATION WELL DOYLE HARTMAN, OPERATOR</u>
a.	Lease Name and Well Location	Judy No. 2 1980' FN&WLS 7-25S-37E	Munn-Harrison No. "B"-1 660' FNL & 2256' FWL 7-25S-37E
b.	Spud Date	June 5, 1974	May 20, 1982
c.	Completion Date	September 14, 1974	June 4, 1982
d.	Mechanical Problems	-	None
e.	Current Rate of Production	Approx. 2 MCF/day	Not Yet Connected
f.	Date of Plug and Abandonment	To be Plugged & Abandoned as soon as Application Well is connected, as it is uneconomical to produce	Just Completed

NO. OF COPIES RECEIVED	
DISTRIBUTION	
SANTA FE	
FILE	
U.S.G.S.	
LAND OFFICE	
OPERATOR	

# NEW MEXICO OIL CONSERVATION COMMISSION

Form C-101  
Revised 1-1-65

**RECEIVED**  
JUN 21 1982

5A. Indicate Type of Lease  
☐ Fee ☒ Fee  
 5. State Oil & Gas Lease No.

## APPLICATION FOR PERMIT TO DRILL, DEEPEN, OR PLUG BACK

a. Type of Work " DRILL <input checked="" type="checkbox"/> DEEPEN <input type="checkbox"/> PLUG BACK <input type="checkbox"/>		7. Unit Agreement Name MUNN-HARRISON "B"	
b. Type of Well OIL WELL <input type="checkbox"/> GAS WELL <input checked="" type="checkbox"/> OTHER <input type="checkbox"/>		8. Name of Lease Owner Munn-Harrison "B"	
c. Name of Operator Doyle Hartman		9. Well No. 1	
d. Address of Operator P. O. Box 10426 Midland, Texas 79702		10. Field and Pool, or Wildcat Jalmat (Gas)	
e. Location of Well UNIT LETTER C LOCATED 660 FEET FROM THE North LINE AND 2256 FEET FROM THE West LINE OF SEC. 7 TWP. 25S RGE. 37E		11. County Lea	
12. Elevation (Show whether D.R., etc.) 3169.5 G.L.		13. Proposed Depth 3200	
14. Kind & Status Plan. Bond Multi-Well Approved		15. Formation Yates-7 Rivers	
16. Drilling Contractor Kenai		17. Rotary or C.T. Rotary	
18. Approx. Date Work will start April 1982			

### PROPOSED CASING AND CEMENT PROGRAM

SIZE OF HOLE	SIZE OF CASING	WEIGHT PER FOOT	SETTING DEPTH	SACKS OF CEMENT	EST. TOP
12 1/4	9 5/8	40.5	400	300	Surface
8 3/4	7	23.0	3200	600	Surface

The proposed well will be drilled to at total depth of 3200 feet and will be completed as a Jalmat (Yates) gas producer. From the base of the surface pipe through the running of the production casing, the well will be equipped with a 3000-psi double ram BOP system.

Note: Any gas produced from the proposed well has previously been dedicated to El Paso Natural Gas Company.

APPROVAL VALID FOR 180 DAYS  
 EXPIRES 11/10/83  
 UNLESS CANCELLED OTHERWISE

ABOVE SPACE DESCRIBE PROPOSED PROGRAM; IF PROPOSAL IS TO DEEPEN OR PLUG BACK, GIVE DATA ON PRESENT PRODUCTIVE ZONE AND PROPOSED NEW PRODUCTIVE ZONE. GIVE BLOWOUT PREVENTER PROGRAM, IF ANY.

I hereby certify that the information above is true and complete to the best of my knowledge and belief.

Signed Larry A. Nunn Title Engineer Date March 24, 1982

(This space for State Use)  
 ORIGINAL SIGNED BY  
 JERRY SEXTON

APPROVED BY DISTRICT 1 SUPR. TITLE  DATE MAY 11 1982  
 CONDITIONS OF APPROVAL, IF ANY:

NEW MEXICO OIL CONSERVATION COMMISSION  
WELL LOCATION AND ACREAGE DEDICATION PLAT

Form C-101  
Supersedes C-128  
Effective 1-1-65

All distances must be from the outer boundaries of the Section

Owner <b>DOYLE HARTMAN</b>			Lease <b>MUNN-HARRISON</b>		
Unit Letter <b>C</b>	Section <b>7</b>	Township <b>25 SOUTH</b>	Range <b>37 EAST</b>	County <b>LEA</b>	
Actual Well Location of Well: <b>2256</b> feet from the <b>WEST</b> line and <b>660</b> feet from the <b>NORTH</b> line					
Ground Level Elev. <b>3169.5</b>	Producing Formation <b>YATES-SEVEN RIVERS</b>		Pool <b>JALMAT (GAS)</b>		Dedication Acreage <b>80</b>

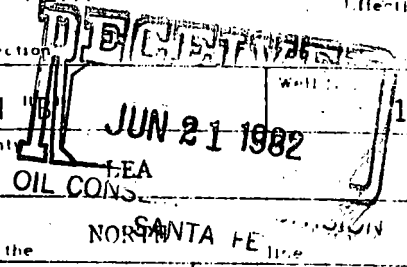

1. Outline the acreage dedicated to the subject well by colored pencil or hachure marks on the plat below.
2. If more than one lease is dedicated to the well, outline each and identify the ownership thereof (both as to working interest and royalty).
3. If more than one lease of different ownership is dedicated to the well, have the interests of all owners been consolidated by communitization, unitization, force-pooling, etc?

☐ Yes ☐ No If answer is "yes," type of consolidation \_\_\_\_\_

If answer is "no," list the owners and tract descriptions which have actually been consolidated (Use reverse side of this form if necessary.) \_\_\_\_\_

No allowable will be assigned to the well until all interests have been consolidated (by communitization, unitization, forced-pooling, or otherwise) or until a non-standard unit, eliminating such interests, has been approved by the Commission.

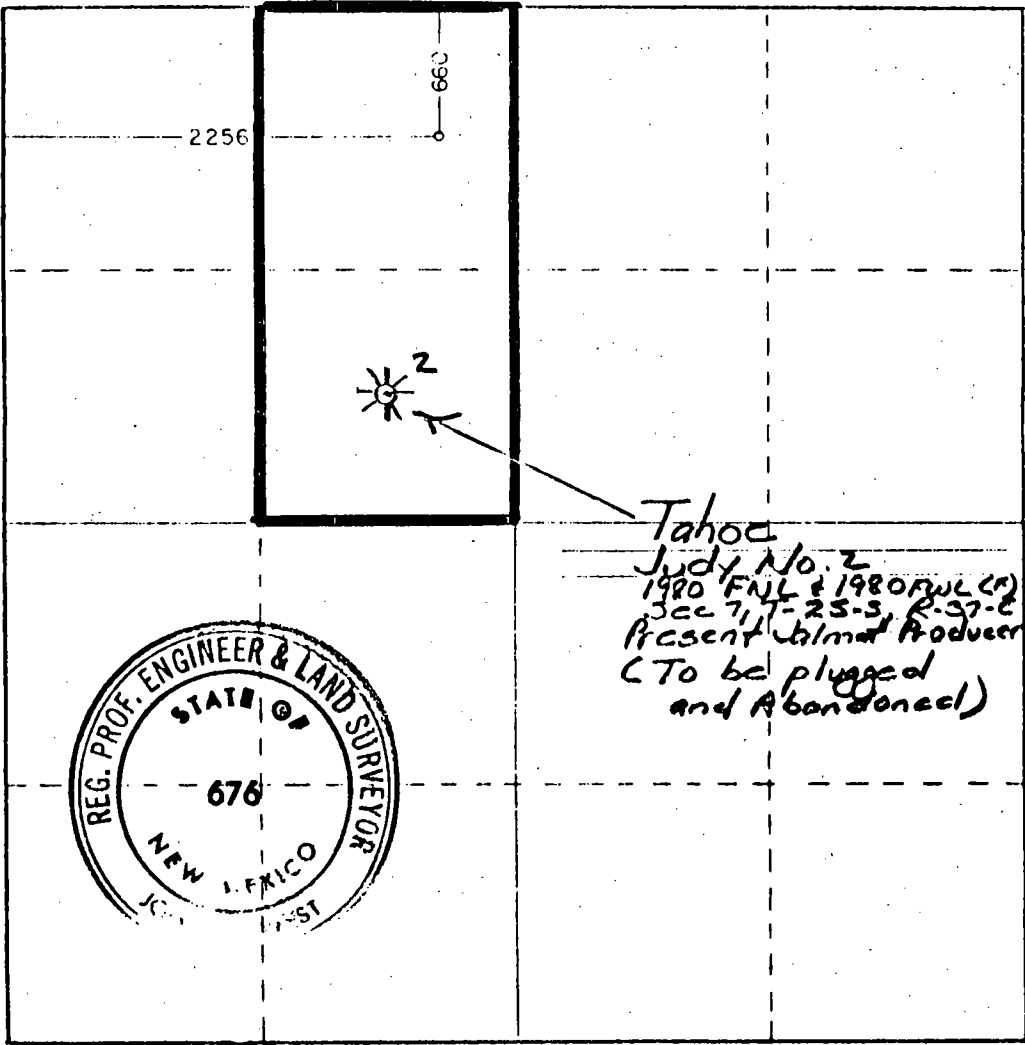

*Tahoe Judy No. 2  
1980 ENL 2 1980 FUL (C)  
Sec 7, T-25-S, R-37-E  
Present Jalmat Producer  
(To be plugged and Abandoned)*

CERTIFICATION

I hereby certify that the information contained herein is true and complete to the best of my knowledge and belief.

*Larry A. Nunn*  
\_\_\_\_\_  
ENGINEER

DOYLE HARTMAN

MARCH 24, 1982

I hereby certify that the well location shown on this plat was plotted from field notes of actual surveys made by me or under my supervision and that the same is true and correct to the best of my knowledge and belief.

Date Surveyed: 2-1-82

Registered Professional Engineer and/or Land Surveyor

*John W. West*  
\_\_\_\_\_  
Certificate No. **JOHN W. WEST 676**  
**PATRICK A. ROMERO 6663**  
**Ronald J. Eldon 3239**



CERTIFICATION OF WELL  
DATA ON PRORATION  
PLAT (NMOCD Form C-102)

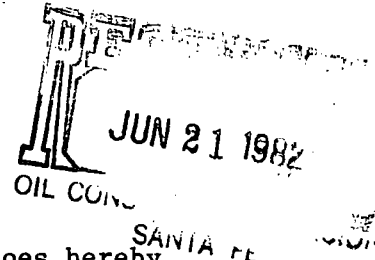

DOYLE HARTMAN, as Operator the herein designated well does hereby  
certify as required under OCD Order R-5878 Rule 15.4:

- (A) The location plat (C-102) corresponding to the herein designated well depicts all current producing wells or previously abandoned wells located on the subject acreage.
- (B) A description of any applicable well(s) that are located on the subject proration unit and that are presently producing or have previously produced from the same reservoir for which this Infill Filing is being made is as follows:

Operator: Doyle Hartman (Tahoe Oil and Cattle Company)  
Well: Judy No. 2  
Location: 1980 FNL & 1980 FWL (F)  
Section 7, T-25-S, R-37-E  
Lea County, New Mexico  
Spud Date: June 5, 1974  
Reservoir: Jalmat (Gas)  
Production Period: 12-79 to date [as Jalmat (Gas)]  
Cumulative Gas Production: 5.2 mmcf  
Abandonment Date: Immediately  
Remarks: The Judy No. 2 was initially completed as a Langlie Mattix Seven Rivers Queen Oil well, but was recompleted to Jalmat (gas) in December, 1979. This well is to be plugged and abandoned in the very near future so that the application well will be the only producing Jalmat (gas) well on the proration unit.

Michelle Hembree  
Michelle Hembree  
Administrative Assistant



STATE OF NEW MEXICO  
ENERGY AND MINERALS DEPARTMENT  
OIL CONSERVATION DIVISION

BRUCE KING  
GOVERNOR

LARRY KEHOE  
SECRETARY

May 3, 1982

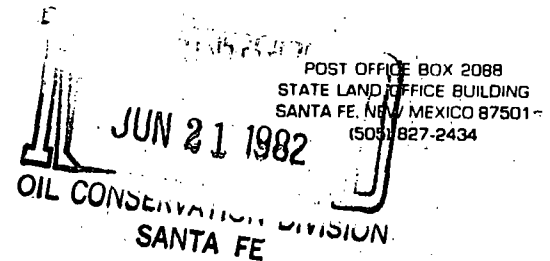

Doyle Hartman  
P. O. Box 10426  
Midland, Texas 79702

Attention: Larry A. Nermyr

Administrative Order NSP-1304(L)

Gentlemen:

Reference is made to your application for an 80-acre non-standard proration unit consisting of the following acreage in the Jalmat Gas Pool:

LEA COUNTY, NEW MEXICO  
TOWNSHIP 25 SOUTH, RANGE 37 EAST, NMPM  
Section 7: E/2 NW/4

It is my understanding that this unit is to be simultaneously dedicated to your Munn-Harrison "B" Well No. 1 located at an unorthodox location 660 feet from the North line and 2256 feet from the West line of said Section 7, hereby approved under provisions of Rule 104 F, and your Judy Well No. 2 in Unit F, which will be plugged and abandoned if the proposed Munn-Harrison "B" Well No. 1 should be a producer.

By authority granted me under the provisions of Rule 5(c)(3) of Order No. R-1670, the above non-standard proration unit is hereby approved.

Additionally, NSP-1161 is hereby superseded.

Sincerely,

JOE D. RAMEY  
Director

JDR/RLS/dr

cc: Oil Conservation Division - Hobbs  
Oil & Gas Engineering Committee - Hobbs

MAY 10 1982

Munn-Harrison "B" No. 1  
located E/2 NW/4 Section 7  
T-25-S, R-37-E  
Lea County, New Mexico

STATE LINE, 65

FOWLER, 49

DOLLARHIDE, 51

JUSTIS N, 61

JUSTIS, 46

STRUCTURE CONTOUR MAP ON  
TOP YATES TOP DELAWARE LIME  
Contour Interval 50'  
Posted to April 1, 1982  
Scale 1"= 8,000'

IRRHODES  
STORAGE  
AREA, 57)

SCARBOROUGH, 6

LEONARD S, 50

T  
26  
S

ANDERSON

LEA

WINKLER

NO. OF COPIES RECEIVED	
DISTRIBUTION	
SANTA FE	
FILE	
U.S.G.A.	
LAND OFFICE	
OPERATOR	

NEW MEXICO OIL CONSERVATION COMMISSION  
WELL COMPLETION OR RECOMPLETION REPORT

Form C-105  
Revised 11-81

5a. Indicate Type of Lease  
State ☐ Fee ☒  
Gas Lease No.

JUN 8 1982

10. TYPE OF WELL OIL WELL <input type="checkbox"/> GAS WELL <input checked="" type="checkbox"/> DRY <input type="checkbox"/> OTHER <input type="checkbox"/>		11. TYPE OF COMPLETION NEW WELL <input checked="" type="checkbox"/> WORK OVER <input type="checkbox"/> DEEPEN <input type="checkbox"/> PLUG BACK <input type="checkbox"/> DIFF. RESVR. <input type="checkbox"/> OTHER <input type="checkbox"/>		5b. Indicate Type of Lease State <input type="checkbox"/> Fee <input checked="" type="checkbox"/> Gas Lease No.	
2. Name of Operator Doyle Hartman				8. Name of Land Owner Munn-Harrison "B"	
3. Address of Operator P. O. Box 10426 Midland, Texas 79702				9. Well No. 1	
4. Location of Well UNIT LETTER <u>C</u> LOCATED <u>660</u> FEET FROM THE <u>North</u> LINE AND <u>2256</u> FEET FROM THE <u>West</u> LINE OF SEC. <u>7</u> TWP. <u>25-S</u> RGE. <u>37-E</u> NEAR <u>Lea</u>				10. Field and Pool, or Wildcat Jalmat (Gas)	
15. Date Drilled 5-20-82	16. Date T.D. Reached 5-26-82	17. Date Comp. (Ready to Prod.) 6-4-82	18. Elevations (DF, RKB, RT, GR, etc.) 3169.5 GL	19. Elev. Casinghead 3169.5	
20. Total Depth 3200	21. Plug Back T.D. 3188	22. If Multiple Compl., How Many --	23. Intervals Drilled By 0-3200	24. Retary Tools Cable Tools	
24. Producing Interval(s), of this completion - Top, Bottom, Name 2808-2939 w/19 Holes				25. Was Directional Survey Made Yes	
26. Type Electric and Other Logs Run CDN-DSN-GR and Guard Forxo				27. Was Well Cored No	

28. CASING RECORD (Report all strings set in well)					
CASING SIZE	WEIGHT LB./FT.	DEPTH SET	HOLE SIZE	CEMENTING RECORD	AMOUNT PULLED
9 5/8	36.0	425	12 1/4	250 sx (circ)	None
7	23.0	3188	8 3/4	700 sx (circ)	None

29. LINER RECORD					30. TUBING RECORD		
SIZE	TOP	BOTTOM	SACKS CEMENT	SCREEN	SIZE	DEPTH SET	PACKER SET
					2 3/8	3045	--

31. Perforation Record (Interval, size and number)		32. ACID, SHOT, FRACTURE, CEMENT SQUEEZE, ETC.	
19 Holes with one hole each at: 2808, 2814, 2820, 2828, 2832, 2835, 2851, 2858, 2862, 2866, 2870, 2874, 2888, 2892, 2896, 2900, 2904, 2935, 2939		DEPTH INTERVAL	AMOUNT AND KIND MATERIAL USED
		2808-2939	A/5200 15% MCA
			SWF 76,400 + 173,000

33. PRODUCTION		Date First Production 6-4-82		Production Method (Flowing, gas lift, pumping - Size and type pump) Pumping		Well Status (Prod. or Shut-in) Shut-in	
Date of Test 6-4-82	Hours Tested 24	Choke Size 19/64	Prod'n. For Test Period --	Oil - Bbl. 211	Gas - MCF 211	Water - Bbl. --	Gas - Oil Ratio --
Flow Tubing Press. --	Casing Pressure PCP=106	Calculated 24-Hour Rate --	Oil - Bbl. --	Gas - MCF 211	Water - Bbl. --	Oil Gravity - API (Corr.) --	

34. Disposition of Gas (Sold, used for fuel, vented, etc.) Vented	Test Witnessed By Harold Swain
--	-----------------------------------

35. List of Attachments		
36. I hereby certify that the information shown on both sides of this form is true and complete to the best of my knowledge and belief.		
SIGNED <u>Larry G. Nunn</u>	TITLE <u>Engineer</u>	DATE <u>6-8-82</u>



This form is to be filed with the appropriate District Office of the Commission not later than 30 days after the completion of any newly-drilled or re-completed well. It shall be accompanied by one copy of all electric log and radioactivity logs from the well and a summary of all special tests conducted, including drill-stem tests. All electric logs reported shall be measured in feet. In the case of directionally drilled wells, true vertical depths shall also be reported. For multiple completions, items 10 through 34 shall be reported for each zone. The form is to be filed in triplicate except on state land, where six copies are required. See Rule 1105.

### Southeastern New Mexico

T. Anhy	1050
T. Salt	1145
B. Salt	2658
T. Yates	2804
T. 7 Rivers	3021
T. Queen	
T. Grayburg	
T. San Andres	
T. Glerieta	
T. Paddock	
T. Blinebry	
T. Tubb	
T. Drinkard	
T. Abo	
T. Wolfcamp	
T. Penn.	
T. Cisco (Bough C)	

T. Canyon \_\_\_\_\_  
T. Strawn \_\_\_\_\_  
T. Atoka \_\_\_\_\_  
T. Miss \_\_\_\_\_  
T. Devonian \_\_\_\_\_  
T. Silurian \_\_\_\_\_  
T. Montevia \_\_\_\_\_  
T. Simpson \_\_\_\_\_  
T. McKee \_\_\_\_\_  
T. Ellenburger \_\_\_\_\_  
T. Gr. Wash \_\_\_\_\_  
T. Granite \_\_\_\_\_  
T. Delaware Sand \_\_\_\_\_  
T. Bone Springs \_\_\_\_\_  
T. \_\_\_\_\_  
T. \_\_\_\_\_  
T. \_\_\_\_\_

### Northwestern New Mexico

T. Ojo Alamo _____	T. Penn. "B" _____
T. Kirtland-Fruitland _____	T. Penn. "C" _____
T. Pictured Cliffs _____	T. Penn. "D" _____
T. Cliff House _____	T. Leadville _____
T. Menefee _____	T. Madison _____
T. Point Lookout _____	T. Elbert _____
T. Mancos _____	T. McCracken _____
T. Gallup _____	T. Ignacio Qtzte _____
Base Greenhorn _____	T. Granite _____
T. Dakota _____	T. _____
T. Morrison _____	T. _____
T. Todilto _____	T. _____
T. Entrada _____	T. _____
T. Wingate _____	T. _____
T. Chinle _____	T. _____
T. Permian _____	T. _____
T. Penn. "A" _____	T. _____

No. 1, from 2808 to 2939 No. 4, from to  
No. 2, from to No. 5, from to  
No. 3, from to No. 6, from to

Include data on rate of water inflow and elevation to which water rose in hole.

No. 1, from ..... to ..... feet. ....

No. 2, from ..... to ..... feet. ....

No. 3, from ..... to ..... feet. ....

No. 4, from ..... to ..... feet. ....

From	To	Thickness in Feet	Formation	From	To	Thickness in Feet	Formation
1050	1145	95	Anhydrite				
1145	2658	1513	Salt and Anhydrite				
2658	2804	146	Dolomite and Anhydrite				
2804	3021	217	Dolomite and Sand				
3021	3191	170	Sand and Dolomite				

NO. OF COPIES RECEIVED	
DISTRIBUTION	
SANTA FE	
FILE	
U.S.G.S.	
LAND OFFICE	
TRANSPORTER	OIL
	GAS
OPERATOR	
PRODUCTION OFFICE	

NEW MEXICO OIL CONSERVATION COMMISSION  
REQUEST FOR ALLOWABLE  
AND  
AUTHORIZATION TO TRANSPORT OIL AND NATURAL GAS

Form C-104  
Supersedes Old C-104 and C-  
Effective 1-1-65

**RECEIVED**  
JUN 21 1982

I. Operator  
Doyle Hartman  
Address  
P. O. Box 10426 Midland, Texas 79702  
Reason(s) for filing (check proper box)  
New Well ☐ Change in Transporter of:  
Recompletion ☐ Oil ☐ Dry Gas ☐  
Change in Ownership ☒ Casinghead Gas ☐ Condensate ☐  
Other (Please explain)

If change of ownership give name and address of previous owner Tahoe Oil & Cattle Co., P. O. Box 3084, Midland, Texas 79702

II. DESCRIPTION OF WELL AND LEASE  
Lease Name Judy Well No. 2 Pool Name, Including Formation Jalpat (Gas) Kind of Lease State, Federal or Fee Fee Fee Lease No.  
Location  
Unit Letter F : 1980 Feet From The North Line and 1980 Feet From The West  
Line of Section 7 Township 25-S Range 37-E , NMPM, Lea County

III. DESIGNATION OF TRANSPORTER OF OIL AND NATURAL GAS  
Name of Authorized Transporter of Oil ☒ or Condensate ☐  
The Permian Corporation Address (Give address to which approved copy of this form is to be sent)  
Box 1183, Houston, Texas 77001  
Name of Authorized Transporter of Casinghead Gas ☒ or Dry Gas ☐  
El Paso Natural Gas Company Address (Give address to which approved copy of this form is to be sent)  
P. O. Box 1384, Jal, New Mexico 88252  
If well produces oil or liquids, give location of tanks. Unit C Sec. 7 Twp. 25 Rge. 37 Is gas actually connected? Yes When December 1979

If this production is commingled with that from any other lease or pool, give commingling order number:

IV. COMPLETION DATA  
Designate Type of Completion - (X) ☒ Oil Well ☐ Gas Well ☐ New Well ☐ Workover ☐ Deepen ☐ Plug Back ☐ Same Res't. ☐ Diff. Res't.  
Date Spudded Date Compl. Ready to Prod. Total Depth P.B.T.D.  
Elevations (DF, RAB, RT, GR, etc.) Name of Producing Formation Top Oil/Gas Pay Tubing Depth  
Perforations Depth Casing Shoe  
TUBING, CASING, AND CEMENTING RECORD  
HOLE SIZE CASING & TUBING SIZE DEPTH SET SACKS CEMENT

V. TEST DATA AND REQUEST FOR ALLOWABLE OIL WELL (Test must be after recovery of total volume of load oil and must be equal to or exceed top all able for this depth or be for full 24 hours)  
Date First New Oil Run To Tanks Date of Test Producing Method (Flow, pump, gas lift, etc.)  
Length of Test Tubing Pressure Casing Pressure Choke Size  
Actual Prod. During Test Oil-Bbls. Water-Bbls. Gas-MCF

GAS WELL  
Actual Prod. Test-MCF/D Length of Test Bbls. Condensate/MCF Gravity of Condensate  
Testing Method (pilot, back pr.) Tubing Pressure (Shut-in) Casing Pressure (Shut-in) Choke Size

1. CERTIFICATE OF COMPLIANCE  
I hereby certify that the rules and regulations of the Oil Conservation Commission have been complied with and that the information given above is true and complete to the best of my knowledge and belief.  
Larry C. N...  
(Signature)  
Engineer  
(Title)  
April 30, 1982  
(Date)  
OIL CONSERVATION COMMISSION  
APPROVED MAY 3 1982, 19  
BY JERRY SEXTON  
ORIGINAL SIGNED BY  
TITLE DISTRICT 1 SUPR.  
This form is to be filed in compliance with RULE 1104.  
If this is a request for allowable for a newly drilled open well, this form must be accompanied by a tabulation of the tests taken on the well in accordance with RULE 111.  
All sections of this form must be filled out completely for allowable on new and recompleted wells.  
Fill out only Sections I, II, III, and VI for changes of well name or number, or transporter, or other such change of condition.  
Separate Forms C-104 must be filed for each pool in multi-completed wells.

**OIL & CATTLE CO.**

PHONE 915-683-8009 • P. O. BOX 3084 • MIDLAND TEXAS 79701

October 22 1979  
JUN 21 1982  
OIL CON  
SANTA FE

New Mexico Oil Conservation Commission  
P. O. Box 2088  
Santa Fe, New Mexico 87501

Re: Tahoe Oil & Cattle Co.  
Judy #2  
Unit F, Section 7  
T-25-S, R-37-E  
Lea County, New Mexico

Gentlemen:

We hereby make application for an exception to Rule 104 for a  
Non-Standard Proration unit on the above captioned well.

Attached is a plat showing the acreage dedicated to this well.  
All offset operators are shown on this plat and have been  
notified by copy of this application.

Very truly yours,

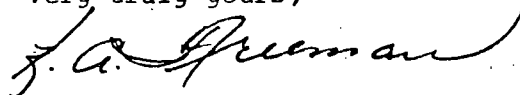

K. A. Freeman  
Petroleum Engineer

cc: Doyle Hartman  
Reserve Oil  
Dalport

Attachment

RECEIVED OCT 23 1979

**NEW MEXICO OIL CONSERVATION COMMISSION  
WELL LOCATION AND ACREAGE DEDICATION PLAT**

Form C-102  
Supersedes C-128  
Effective 1-1-65

All distances must be from the outer boundaries of the Section.

Amended

Operator <b>Tahoe Oil &amp; Cattle Co.</b>			Lease <b>Judy</b>		Well No. <b>2</b>
Unit Letter <b>F</b>	Section <b>7</b>	Township <b>25-S</b>	Range <b>37-E</b>	County <b>Lea</b>	
Actual Footage Location of Well: <div style="display: flex; justify-content: space-between;"> <span><b>1980</b> feet from the <b>North</b> line and</span> <span><b>1980</b> feet from the <b>West</b> line</span> </div>					
Ground Level Elev: <b>3152' GL</b>	Producing Formation <b>Yates</b>	Pool <b>Jalmat</b>		Dedicated Acreage: <b>SE NW 40</b> Acres	

1. Outline the acreage dedicated to the subject well by colored pencil or hachure marks on the plat below.
2. If more than one lease is dedicated to the well, outline each and identify the ownership thereof (both as to working interest and royalty).
3. If more than one lease of different ownership is dedicated to the well, have the interests of all owners been consolidated by communization, unitization, force-pooling, etc?

☐ Yes   ☐ No   If answer is "yes," type of consolidation \_\_\_\_\_

If answer is "no," list the owners and tract descriptions which have actually been consolidated. (Use reverse side of this form if necessary.) \_\_\_\_\_

No allowable will be assigned to the well until all interests have been consolidated (by communization, unitization, forced-pooling, or otherwise) or until a non-standard unit, eliminating such interests, has been approved by the Commission.

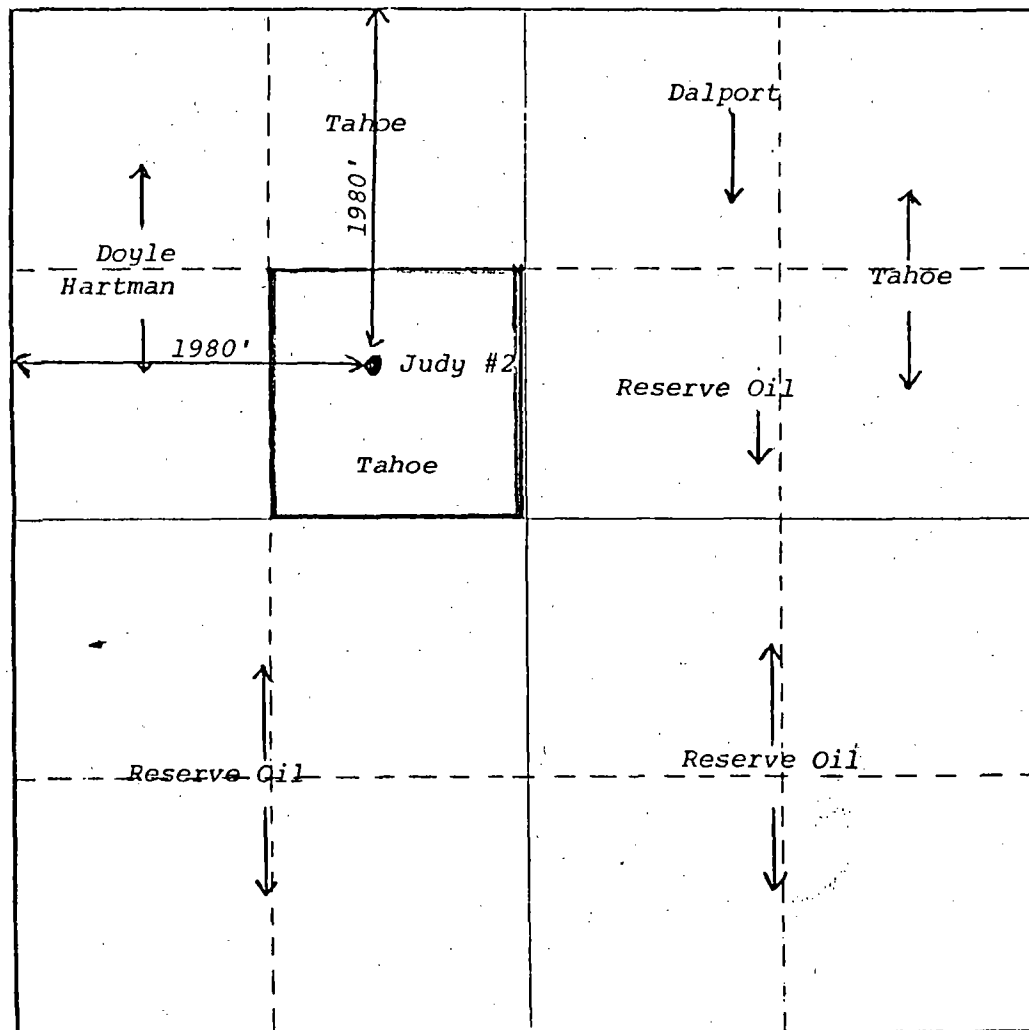

**CERTIFICATION**

I hereby certify that the information contained herein is true and complete to the best of my knowledge and belief.

*J. G. Freeman*

Name  
**Petroleum Engineer**  
Position  
**Tahoe Oil & Cattle Co.**  
Company  
**October 22, 1979**  
Date

I hereby certify that the well location shown on this plat was plotted from field notes of actual surveys made by me or under my supervision, and that the same is true and correct to the best of my knowledge and belief.

Date Surveyed \_\_\_\_\_  
Registered Professional Engineer  
and/or Land Surveyor

Certificate No. \_\_\_\_\_

NO. OF COPIES RECEIVED		
DISTRIBUTION		
SANTA FE		
FILE		
U.S.G.S.		
LAND OFFICE		
TRANSPORTER	OIL	
	GAS	
OPERATOR		
PRORATION OFFICE		

NEW MEXICO OIL CONSERVATION COMMISSION  
REQUEST FOR ALLOWABLE  
AND  
AUTHORIZATION TO TRANSPORT OIL AND NATURAL GAS

Form C-104  
Supersedes Old C-104 and C-105  
Effective 1-1-81

JUN 21 1982

Operator

Tahoe Oil & Cattle Co.

Address

P. O. Box 3084, Midland, Texas 79702

Reason(s) for filing (Check proper box)

New Well	<input type="checkbox"/>	Change in Transporter of:	
Recompletion	<input checked="" type="checkbox"/>	Oil	<input type="checkbox"/>
Change in Ownership	<input type="checkbox"/>	Casinghead Gas	<input type="checkbox"/>
		Dry Gas	<input type="checkbox"/>
		Condensate	<input type="checkbox"/>

Other (Please explain)

If change of ownership give name  
and address of previous owner

DESCRIPTION OF WELL AND LEASE

Lease Name	Well No.	Pool Name, Including Formation	Kind of Lease	Lease No.
Judy	2	Jalmat	State, Federal or Fee	Fee
Location				
Unit Letter	F	1980	Feet From The	North
			Line and	1980
			Feet From The	West
Line of Section	7	Township	25-S	Range
			37-E	, NMPM, Lea
				County

DESIGNATION OF TRANSPORTER OF OIL AND NATURAL GAS

Name of Authorized Transporter of Oil <input checked="" type="checkbox"/> or Condensate <input type="checkbox"/>	Address (Give address to which approved copy of this form is to be sent)					
The Permian Corporation	Box 1183, Houston, Texas 77001					
Name of Authorized Transporter of Casinghead Gas <input checked="" type="checkbox"/> or Dry Gas <input type="checkbox"/>	Address (Give address to which approved copy of this form is to be sent)					
El Paso Natural Gas Company	Box 1492, El Paso, Texas					
If well produces oil or liquids, give location of tanks.	Unit	Sec.	Twp.	Rge.	Is gas actually connected?	When
	C	7	25	37	No	

If this production is commingled with that from any other lease or pool, give commingling order number:

COMPLETION DATA

Designate Type of Completion - (X)	Oil Well	Gas Well	New Well	Workover	Deepen	Plug Back	Same Res'v.	Diff. Res'v.
		X		X		X		X
Date Spudded	Date Compl. Ready to Prod.		Total Depth		P.B.T.D.			
6/5/74	10/12/79		3520'		3300'			
Elevations (DF, RKB, RT, GR, etc.)	Name of Producing Formation		Top Oil/Gas Pay		Tubing Depth			
3152' GL	Jalmat		2800		3221			
Perforations	Depth Casing Shoe							
2801, 2815, 2855, 2860, 2864, 2892, 2931, 3142, 3227 & 3254	3520							

TUBING, CASING, AND CEMENTING RECORD

HOLE SIZE	CASING & TUBING SIZE	DEPTH SET	SACKS CEMENT
12-1/4	8-5/8	317'	175 sx
7-7/8	4-1/2	3520'	325 sx
	2-7/8	2159'	50 sx

TEST DATA AND REQUEST FOR ALLOWABLE OIL WELL (Test must be after recovery of total volume of load oil and must be equal to or exceed top allowable for this depth or be for full 24 hours)

Date First New Oil Run To Tanks	Date of Test	Producing Method (Flow, pump, gas lift, etc.)	
--	10/15/79	pumping	
Length of Test	Tubing Pressure	Casing Pressure	Choke Size
Actual Prod. During Test	Oil - Bbls.	Water - Bbls.	Gas - MCF

GAS WELL

Actual Prod. Test-MCF/D	Length of Test	Bbls. Condensate/MMCF	Gravity of Condensate
55 MCFD	24		
Testing Method (pitot, back pr.)	Tubing Pressure (Shut-in)	Casing Pressure (Shut-in)	Choke Size
pitot tube	25#	25#	none

CERTIFICATE OF COMPLIANCE

I hereby certify that the rules and regulations of the Oil Conservation Commission have been complied with and that the information given above is true and complete to the best of my knowledge and belief.

*K.A. Praman*  
(Signature)

Petroleum Engineer

10-16-79

(Title)

(Date)

OIL CONSERVATION COMMISSION

APPROVED

DEC 10 1979

BY

TITLE

*John W. Runyan*  
Geologist

This form is to be filed in compliance with RULE 1104.

If this is a request for allowable for a newly drilled or deepened well, this form must be accompanied by a tabulation of the deviated tests taken on the well in accordance with RULE 111.

All sections of this form must be filled out completely for allowable on new and recompleted wells.

Fill out only Sections I, II, III, and VI for changes of owner well name or number, or transporter, or other such change of condition. Separate Forms C-104 must be filed for each pool in multiple.

COPIES RECEIVED		
DISTRIBUTION		
DATE		
S.		
OFFICE		
ATOR		

# NEW MEXICO OIL CONSERVATION COMMISSION

Form C-103  
Supersedes Old  
C-102 and C-103  
Effective 1-1-65

JUN 21 1980  
OIL CON.

5a. Indicate Type of Lease	
State <input type="checkbox"/>	Fee <input checked="" type="checkbox"/>
5. State Oil & Gas Lease No.	

## SUNDRY NOTICES AND REPORTS ON WELLS

(DO NOT USE THIS FORM FOR PROPOSALS TO DRILL OR TO DEEPEN OR PLUG BACK TO A DIFFERENT RESERVOIR. USE "APPLICATION FOR PERMIT" (FORM C-101) FOR SUCH PROPOSALS.)

<input type="checkbox"/> WELL <input checked="" type="checkbox"/> CAS <input type="checkbox"/> OTHER	7. Unit Agreement Name 8. Farm or Lease Name 9. Well No. 10. Field and Pool, or Wildcat 11. Elevation (Show whether DF, RT, GR, etc.)
of Operator Tahoe Oil & Cattle Co. of Operator P. O. Box 3084, Midland, Texas 79701 of Well F 1980 North 1980 FEET FROM THE LINE AND FEET FROM West 7 25-S 37-E LINE, SECTION TOWNSHIP RANGE NMPM.	Judy 2 Jalmat 3152' GL

12. County	Lea
------------	-----

Check Appropriate Box To Indicate Nature of Notice, Report or Other Data

NOTICE OF INTENTION TO:		SUBSEQUENT REPORT OF:	
<input type="checkbox"/> REMEDIAL WORK <input type="checkbox"/> PLUG AND ABANDON <input type="checkbox"/> CHANGE PLANS <input type="checkbox"/> OTHER	<input type="checkbox"/> PLUG AND ABANDON <input type="checkbox"/> CHANGE PLANS <input type="checkbox"/> OTHER	<input checked="" type="checkbox"/> REMEDIAL WORK <input type="checkbox"/> COMMENCE DRILLING OPNS. <input type="checkbox"/> CASING TEST AND CEMENT JOBS <input type="checkbox"/> OTHER	<input type="checkbox"/> ALTERING CASING <input type="checkbox"/> PLUG AND ABANDONMENT <input type="checkbox"/> OTHER

File Proposed or Completed Operations (Clearly state all pertinent details, and give pertinent dates, including estimated date of starting any proposed) SEE RULE 1703.

1. Ran Gr/ Collar Log 3348' to 2600'.
2. Set CIBP @ 3300', placed 1 sx cmt w/dump bailer on top of CIBP.
3. Perforate 2931', 2892', 2864', 2860', 2855, 2815' & 2801' w/ 1 SPF total of (7 holes).
4. Ran ret bridge plug & RTTS pkr, spot acid across perms, set RTTS packer, broke down perforations @ 1200#, Acidize with 1750 gal 15% + 15 ball sealers. Ball out all perforations to 2600#, drop balls, formation treated at 900#. ISDP 500#.
5. Pull out of hole. Ran 2-7/8" tubing w/Double E packer set @ 2159' or 70 joints. Halliburton cemented 4-1/2" - 2-7/8" casing-tubing annulus with 50 sx Class "C" cmt.
6. Ran 100 jts 3,221' of 2-1/16 IJ tubing. Ran 2" x 1-1/16 x 16' pump and 3/4" rods slim hole cpls.
7. Set Parkersburg D-114 pumping unit
8. Put on pump 10-12-79 and tested 10-15-79. 55 MCFD + 54 Bbls water.

by certify that the information above is true and complete to the best of my knowledge and belief. J. A. Freeman TITLE Petroleum Engineer DATE 10-15-79	Orig. Signed by Jerry Sexton Dist. 1, Supv. TITLE DATE OCT 19 1979
--	--

COPIES RECEIVED	
DISTRIBUTION	
STATE	
F	
G.S.	
AD OFFICE	
ATOR	

# NEW MEXICO OIL CONSERVATION COMMISSION

Form C-101

Revised 1-1-65

5A. Indicate Type of Lease

STATE ☐

SEE ☒

5B. Surface Oil & Gas Lease No.

OIL CONSERVATION

SANTA FE COUNTY

## APPLICATION FOR PERMIT TO DRILL, DEEPEN, OR PLUG BACK

Type of Work		7. Unit Agreement Name	
DRILL <input type="checkbox"/>	DEEPEN <input type="checkbox"/>	8. Firm or Lease Name	
PLUG BACK <input checked="" type="checkbox"/>		Judy	
9. Well No.	2		
10. Field and Pool, or Wildcat	Jalmat		
11. County	Lea		
12. Section	7		
13. Township	25-S		
14. Range	37-E		
15. Proposed Length	16A. Formation	17. Rotary or C.T.	
3230	Jalmat	---	
18. Estimated when drilled (DE, RT, etc.)	21A. Kind & States Plug. Bond	21B. Drilling Contractor	22. Approx. Date Work will start
3152' GL	Blanket	Gene's Well Service	3-20-1979

### PROPOSED CASING AND CEMENT PROGRAM

SIZE OF HOLE	SIZE OF CASING	WEIGHT PER FOOT	SETTING DEPTH	SACKS OF CEMENT	EST. TOP
12-1/4"	8-5/8"	24	317	175	Circ.
7-7/8"	4-1/2"	9.5	3520	325	2500
4-1/2" Csg.	2-7/8"	6.5	2100	100	Circ.

1. Set cast iron bridge plug @ 3200'; place 35 sack cement with dump bailer on top of bridge plug.
2. Run 2-7/8" 6.5# tubing to 2100' and cement with 100 sacks.
3. Perforate Yates 2863'-73' & 2900' -03', Seven Rivers 3142', & 3227'.
4. Run 2-1/16" I. J. tubing to 2800'.
5. Acidize with 1,000 gal 15% mud acid.
6. Frac with 25,000 gal. gel water & 30,000# sand plus CO<sub>2</sub>.
7. Flow back to clean up & run potential test.

WE SPACE DESCRIBE PROPOSED PROGRAM; IF PROPOSAL IS TO DEEPEN OR PLUG BACK, GIVE DATA ON PRESENT PRODUCTIVE ZONE AND PROPOSED NEW PRODUCTION. GIVE FLOW-OUT INVENTOR PROGRAM, IF ANY.

Certify that the information above is true and complete to the best of my knowledge and belief.

*John W. Rump* Title Petroleum Engineer Date 2/28/79

(This space for State Use)

APPROVED BY *John W. Rump* TITLE Geologist DATE MAR 5 1979

AGENTS OF APPROVAL, IF ANY:

RECEIVED		
CONTRIBUTION		
DATE		
OFFICE		
FOR		

# NEW MEXICO OIL CONSERVATION COMMISSION

Form C-103  
Supersedes Old  
C-102 and C-103  
Effective 1-1-65

**JUN 21 1980**  
OIL CON.

## SUNDRY NOTICES AND REPORTS ON WELLS

DO NOT USE THIS FORM FOR PROPOSALS TO DRILL OR TO DEEPEN OR PLUG BACK TO A DIFFERENT DEPTH OR FOR APPLICATION FOR PERMIT - " (FORM C-101) FOR SUCH PROPOSALS.

☒ CAS WELL ☐ OTHER

Operator  
Tahoe Oil & Cattle Company  
Box 7032, Midland, Texas 79703

Well No.  
F 1980 North 1980  
West 7 25S 37E

15. Elevation (Show whether DF, RT, CR, etc.)  
3152 GR

5a. Indicate Type of Lease  
State ☐ Free ☒

5. State Oil & Gas Lease No.

7. Unit Agreement Name

8. Name of Lease Name  
Judy

9. Well No.  
#2

10. Field and Pool, or Wildcat  
Langlie-Mattix

12. County  
Lea

Check Appropriate Box To Indicate Nature of Notice, Report or Other Data

NOTICE OF INTENTION TO:

INITIAL WORK ☐  
EXPLORATION ☐  
RE-EVALUATION ☐

PLUG AND ABANDON ☐  
CHANGE PLANS ☐

REMEDIAL WORK ☐  
RECOMMENCE DRILLING OPER. ☐  
CASING TEST AND CEMENT JOB ☐  
OTHER ☒ Change Braden Head

ALTERING CASING ☐  
PLUG AND ABANDONMENT ☐

Proposed or Completed Operations (Clearly state all pertinent details, and give pertinent dates, including estimated date of starting any proposed operations.)

1. Came off the existing Braden Head and brought to ground level with a 2" surface line.
2. Tested for Pressure, No pressure.
3. Left hooked up for pressure gauge readings for future inspections.
4. Inspected by Eddy Seay with New Mexico Oil Conservation Commission on September 15, 1977.

I certify that the information above is true and complete to the best of my knowledge and belief.

*A. Freeman*

TITLE Petroleum Engineer

DATE 9/13/78

OIL & GAS INSPECTOR

SEP 24 1978

DISTRIBUTION	
SA	TA FE
FI	E
G.S.	
ID OFFICE	
TRANSPORTER	OIL
	GAS
OPERATOR	
PRORATION OFFICE	

NEW MEXICO OIL CONSERVATION COMMISSION  
REQUEST FOR ALLOWABLE  
AND  
AUTHORIZATION TO TRANSPORT OIL AND NATURAL GAS

Form C-104  
Supersedes Old C-104 and  
Effective 1-1-65

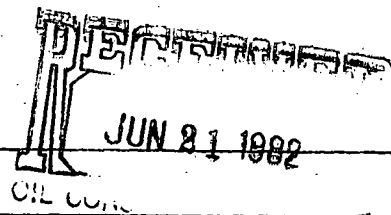

Operator  
Tahoe Oil and Cattle Company  
Address  
P.O. Box 7032 Midland, Texas 79701  
Reason(s) for filing (Check proper box)  
New Well ☐ Change in Transporter of:  
Recompletion ☒ Oil ☐ Dry Gas ☐  
Change in Ownership ☒ Casinghead Gas ☐ Condensate ☐

If change of ownership give name John H. Hill Suite 140 Campbell Center 8350 North Central Expressway  
and address of previous owner Dallas, Texas 752 06

II. DESCRIPTION OF WELL AND LEASE

Lease Name JUDY	Well No. 2	Pool Name, including Formation Langlie Mattix-7Rivers Queen	Kind of Lease State, Federal or Fee Fee	Lease No.
Location Unit Letter F ; 1980 Feet From The North Line and 1980 Feet From The West Line of Section 7 Township 25-S Range 37-E , NMPM, Lea County				

III. DESIGNATION OF TRANSPORTER OF OIL AND NATURAL GAS

Name of Authorized Transporter of Oil <input checked="" type="checkbox"/> or Condensate <input type="checkbox"/> Cities Service Oil Company	Address (Give address to which approved copy of this form is to be sent) Box 300 Tulsa, Oklahoma 74102					
Name of Authorized Transporter of Casinghead Gas <input type="checkbox"/> or Dry Gas <input type="checkbox"/> El Paso Natural Gas Co.	Address (Give address to which approved copy of this form is to be sent) P.O. Box 1492 El Paso, Texas					
If well produces oil or liquids, give location of tanks.	Unit C	Sec. 7	Twp. 25	Rge. 37	Is gas actually connected? Yes	When 7-24-74

If this production is commingled with that from any other lease or pool, give commingling order number:

No

IV. COMPLETION DATA

Designate Type of Completion - (X)	Oil Well X	Gas Well	New Well	Workover	Deepen	Plug Back	Same Res'v.	Diff. Res'v.
Date Spudded 6-5-74	Date Compl. Ready to Prod. 9-14-74	Total Depth 3520	P.B.T.D. 3500					
Elevations (DF, RKB, RT, CR, etc.) 3152 GL	Name of Producing Formation Langlie Mattix	Top Oil/Gas Pay 3075	Tubing Depth 3495					
Perforations 3075 - 3469 w/ 12 shots (overall)			Depth Casing Shoe					

TUBING, CASING, AND CEMENTING RECORD

HOLE SIZE	CASING & TUBING SIZE	DEPTH SET	SACKS CEMENT
12 1/4 "	8 5/8 "	317'	175
7 7/8 "	4 1/2 "	3520'	325

TEST DATA AND REQUEST FOR ALLOWABLE OIL WELL (Test must be after recovery of total volume of load oil and must be equal to or exceed top allowable for this depth or be for full 24 hours)

Date First New Oil Run To Tanks	Date of Test	Producing Method (Flow, pump, gas lift, etc.)	
Length of Test	Tubing Pressure	Casing Pressure	Choke Size
Actual Prod. During Test	Oil-Bbls.	Water-Bbls.	Gas-MCF

GAS WELL

Actual Prod. Test-MCF/D	Length of Test	Bbls. Condensate/MMCF	Gravity of Condensate
Testing Method (pitot, back pr.)	Tubing Pressure (Shut-in)	Casing Pressure (Shut-in)	Choke Size

CERTIFICATE OF COMPLIANCE

I hereby certify that the rules and regulations of the Oil Conservation Commission have been complied with and that the information given above is true and complete to the best of my knowledge and belief.

K.A. Freeman  
(Signature)  
Petroleum Engineer  
(Title)  
April 10, 1975  
(Date)

OIL CONSERVATION COMMISSION  
APR 11 1975

APPROVED \_\_\_\_\_, 19\_\_\_\_  
BY \_\_\_\_\_ (Orig. Signed by)  
Joe D. Ramsey  
TITLE \_\_\_\_\_ Dist. I. Supv.

This form is to be filed in compliance with RULE 1104.

If this is a request for allowable for a newly drilled or deepened well, this form must be accompanied by a tabulation of the deviation tests taken on the well in accordance with RULE 111.

All sections of this form must be filled out completely for allowable on new and recompleted wells.

Fill out only Sections I, II, III, and VI for changes of owner, well name or number, or transporter, or other such change of condition.

NO. OF COPIES RECEIVED	
DISTRIBUTION	
SANTA FE	
FILE	
U.S.G.S.	
LAND OFFICE	
OPERATOR	

Form C-105  
Revised 1-1-65

# NEW MEXICO OIL CONSERVATION COMMISSION WELL COMPLETION OR RECOMPLETION REPORT AND LOG

5a. Indicate Type of Lease  
State ☐ Fee ☒  
5. State Oil & Gas Lease No.

1a. TYPE OF WELL  
OIL WELL ☒ GAS WELL ☐ DRY ☐ OTHER ☐  
b. TYPE OF COMPLETION  
NEW WELL ☒ WORK OVER ☐ DEEPEN ☐ PLUG BACK ☐ DIFF. RESVR. ☐ OTHER ☐

7. Unit Agreement Name

2. Name of Operator  
**John H. Hill**  
3. Address of Operator  
**313 E. Anderson Lane - Suite 332, Austin, Texas**

8. Farm or Lease Name  
**Judy**

4. Location of Well  
**313 E. Anderson Lane - Suite 332, Austin, Texas**

9. Well No.  
**2**

UNIT LETTER **F** LOCATED **1980** FEET FROM THE **North** LINE AND **1980** FEET FROM

10. Field and Pool, or Wildcat  
**Langlie Mattix 7 Rivers**

THE **West** LINE OF SEC. **7** TWP. **25S** RGE. **37E** NMPM

12. County

15. Date Spudded <b>6-5-74</b>	16. Date T.D. Reached <b>6-13-74</b>	17. Date Compl. (Ready to Prod.) <b>9-13-74</b>	18. Elevations (DF, RKB, RT, GR, etc.) <b>3152Gr, 3161 KB</b>	19. Elev. Casinghead <b>3152</b>
-----------------------------------	---	--	--	-------------------------------------

20. Total Depth <b>3520</b>	21. Plug Back T.D. <b>3488</b>	22. If Multiple Compl., How Many	23. Intervals Drilled By <b>0-3520</b>	Rotary Tools	Cable Tools
--------------------------------	-----------------------------------	----------------------------------	---	--------------	-------------

24. Producing Interval(s), of this completion - Top, Bottom, Name  
**3075-3469 Seven Rivers - Queen**

25. Was Directional Survey Made  
**No**

26. Type Electric and Other Logs Run  
**Dual laterolog, Gamma Ray Density**

27. Was Well Cored  
**No**

28. CASING RECORD (Report all strings set in well)

CASING SIZE	WEIGHT LB./FT.	DEPTH SET	HOLE SIZE	CEMENTING RECORD	AMOUNT PULLED
<b>8-5/8</b>	<b>32</b>	<b>317</b>	<b>11</b>	<b>175 sks Class C</b>	<b>None</b>
<b>4-1/2</b>	<b>9.5</b>	<b>3520</b>	<b>7-7/8</b>	<b>325 sks 50/50 Pos &amp; Class C</b>	<b>None</b>

29. LINER RECORD				30. TUBING RECORD			
SIZE	TOP	BOTTOM	SACKS CEMENT	SCREEN	SIZE	DEPTH SET	PACKER SET
					<b>2-3/8</b>	<b>3450</b>	

31. Perforation Record (Interval, size and number)  
**3075-3469 3/8" 13 holes**

32. ACID, SHOT, FRACTURE, CEMENT SQUEEZE, ETC.

DEPTH INTERVAL	AMOUNT AND KIND MATERIAL USED
<b>3075-3469</b>	<b>1500 gals. 15% NE acid</b>
	<b>40,000# sand, 26,300 gals. gelled fresh water</b>

33. PRODUCTION

Date First Production <b>7-24-74</b>	Production Method (Flowing, gas lift, pumping - Size and type pump) <b>Pumping, 1-1/2" x 16' Insert</b>	Well Status (Prod. or Shut-in) <b>Producing</b>					
Date of Test <b>9-14-74</b>	Hours Tested <b>24</b>	Choke Size	Prod'n. For Test Period	Oil - Bbl. <b>5</b>	Gas - MCF <b>15</b>	Water - Bbl. <b>85</b>	Gas - Oil Ratio <b>3000:1</b>
Flow Tubing Press.	Casing Pressure	Calculated 24-Hour Rate	Oil - Bbl. <b>5</b>	Gas - MCF <b>15</b>	Water - Bbl. <b>85</b>	Oil Gravity - API (Corr.) <b>30.6°</b>	

4. Disposition of Gas (Sold, used for fuel, vented, etc.)  
**Sold**

Test Witnessed By  
**G. F. Phillips**

5. List of Attachments  
**Logs**

6. I hereby certify that the information shown on both sides of this form is true and complete to the best of my knowledge and belief.

SIGNED **V. L. Wiederkehr** TITLE **Superintendent** DATE **9-16-74**

# INSTRUCTIONS

This form is to be filed with the appropriate District Office of the Commission not later than 20 days after the completion of any newly-drilled or deepened well. It shall be accompanied by one copy of all electrical and radio-activity logs run on the well and a summary of all special tests conducted, including drill stem tests. All depths reported shall be measured depths. In the case of directionally drilled wells, true vertical depths shall also be reported. For multiple completions, items 30 through 34 shall be reported for each zone. The form is to be filed in quintuplicate except on state land, where six copies are required. See Rule 1105.

## INDICATE FORMATION TOPS IN CONFORMANCE WITH GEOGRAPHICAL SECTION OF STATE

### Southeastern New Mexico

T. Anhy 1032  
T. Salt 1125  
B. Salt 2660  
T. Yates 2808  
T. 7 Rivers 3026  
T. Queen 3346  
T. Grayburg \_\_\_\_\_  
T. San Andres \_\_\_\_\_  
T. Glorieta \_\_\_\_\_  
T. Paddock \_\_\_\_\_  
T. Blinbry \_\_\_\_\_  
T. Tubb \_\_\_\_\_  
T. Drinkard \_\_\_\_\_  
T. Abo \_\_\_\_\_  
T. Wolfcamp \_\_\_\_\_  
T. Penn \_\_\_\_\_  
T. Cisco (Bough C) \_\_\_\_\_

### Northwestern New Mexico

T. Ojo Alamo \_\_\_\_\_  
T. Kirtland-Fruitland \_\_\_\_\_  
T. Pictured Cliffs \_\_\_\_\_  
T. Cliff House \_\_\_\_\_  
T. Menefee \_\_\_\_\_  
T. Point Lookout \_\_\_\_\_  
T. Mancos \_\_\_\_\_  
T. Gallup \_\_\_\_\_  
Base Greenhorn \_\_\_\_\_  
T. Dakota \_\_\_\_\_  
T. Morrison \_\_\_\_\_  
T. Todilto \_\_\_\_\_  
T. Entrada \_\_\_\_\_  
T. Wingate \_\_\_\_\_  
T. Chinle \_\_\_\_\_  
T. Permian \_\_\_\_\_  
T. Penn. "A" \_\_\_\_\_

## FORMATION RECORD (Attach additional sheets if necessary)

From	To	Thickness in Feet	Formation	From	To	Thickness in Feet	Formation
0	1032	1032	Sand, caliche, redbeds	DST#1	Yates 2852-2916'		
1032	1125	93	Anhydride	15 min. preflow, 1 hr. ISI, 1 hr. flow,			
1125	1300	175	Salt	2 hr. FSI. Gas to surface in 15 min.,			
1300	2500	1200	Anhydride and salt	rate 34 mcf/day. Preflow 140#, ISI 145#,			
2500	2660	160	Salt	IF 135#, FF 135#, FSI 145#. Recovered			
2660	2808	148	Dolomite	200' mud and filtrate water.			
2808	3026	218	Sand and dolomite				
3026	3520	494	Dolomite and lime w/sand stringers				

RECEIVED  
OCT 1 1964  
OIL & GAS COMMISSION  
ALBUQUERQUE, N.M.

NEW MEXICO OIL CONSERVATION COMMISSION  
WELL LOCATION AND ACREAGE DEDICATION PLAT

All distances must be from the outer boundaries of the Section

JOHN H. HILL

Judy

2

F 7 25 South 37 East Lea

1980 North 1980 West  
3152.09 Seven Rivers-Queen Langlie Mattix SE NW 40

1. Outline the acreage dedicated to the subject well by colored pencil or hatchure marks on the plat below.

2. If more than one lease is dedicated to the well, outline each and identify the ownership thereof (share interest and royalty).

3. If more than one lease of different ownership is dedicated to the well, have the interests of all owners been dated by communitization, unitization, force-pooling etc?

Yes No If answer is "yes" type of consolidation

If answer is "no" list the owners and tract descriptions which have actually been consolidated (attach separate sheet to this form if necessary)

No allowable will be assigned to the well until all interests have been consolidated (by communitization, unitization, force-pooling, or otherwise) or until a non-standard unit, eliminating such interests, has been approved by the Commission.

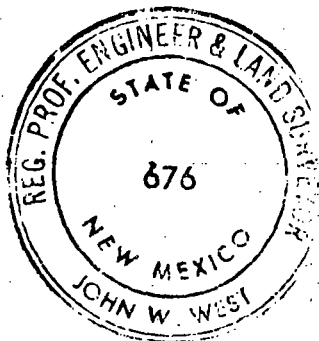
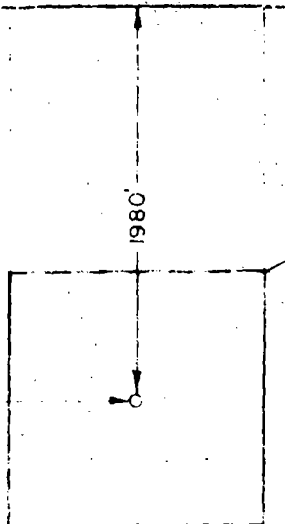

I hereby certify that the information furnished hereon is true and correct to the best of my knowledge and belief.

*V. L. Wiederkehr*

V. L. Wiederkehr

Superintendent

John H. Hill

May 6, 1974

I hereby certify that the information furnished hereon is true and correct to the best of my knowledge and belief.

November 21, 1973

*John W. West*

676

## GAS PRODUCTION HISTORY

Date 5-12-82

Page 1 of 1

Operator: Tahoe Oil & Cattle Company (Doyle Hartman)

Well: Judy No. 2

Location: F-7-25S-37E

Pool: Jalmat (Gas)

Spud Date: \_\_\_\_\_ Original Completion Date: \_\_\_\_\_

Completion Interval (Gas): \_\_\_\_\_

Completion Date (Gas): \_\_\_\_\_ First Production (Gas): 12-79

Remarks: \_\_\_\_\_

[illegible]

**19 81 Detail Summary**

Jan.	158	July	101
Feb.	61	Aug.	109
March	56	Sept.	63
April	67	Oct.	91
May	88	Nov.	85
June	361	Dec.	54

1982 Detail Summary

Jan.	77	July	
Feb.	68	Aug.	
March	51	Sept.	
April	20	Oct.	
May		Nov.	
June		Dec.	

Production (Y-T-D) 214 MCF

Days or Months (Y-T-D) 4 mos.

Avg. Rate (Y-T-D) 54 MCF/mo.

F-7-25S-37E



Gas Production - MCF/month

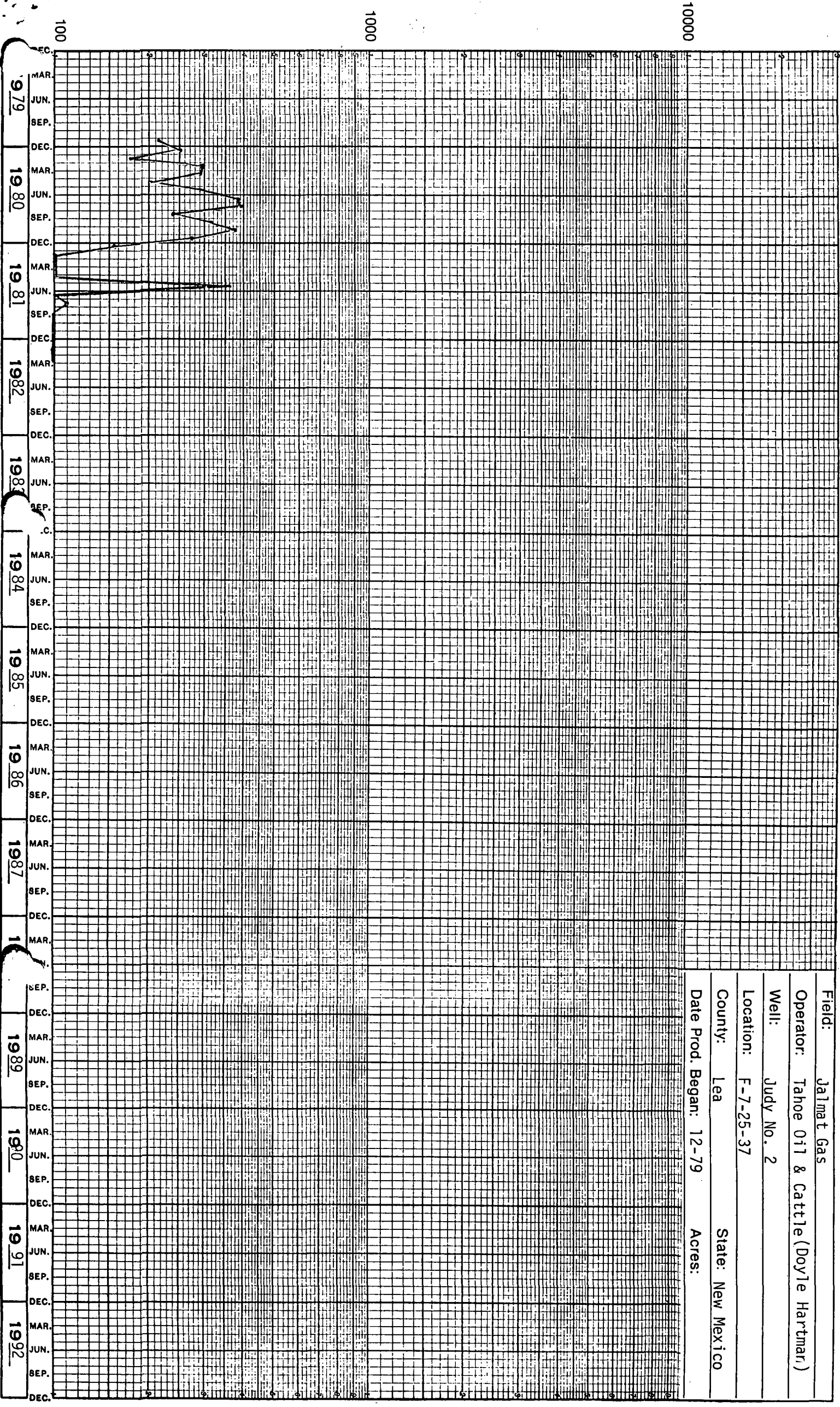

Field: Jalmat Gas  
Operator: Tahoe Oil & Cattle (Doyle Hartman)  
Well: Judy No. 2  
Location: F-7-25-37  
County: Lea State: New Mexico  
Date Prod. Began: 12-79 Acres:

## OIL PRODUCTION HISTORY

Date 12-7-81

Page 1 of 1

Operator: Tahoe Oil and Cattle Company (Doyle Hartman)

Well: Judy No. 2

Location: F-7-25S-37E

Pool: Langlie Mattix

Spud Date: \_\_\_\_\_ Original Completion Date: \_\_\_\_\_

Completion Interval (Oil): \_\_\_\_\_

Completion Date (Oil): \_\_\_\_\_ First Production (Oil): \_\_\_\_\_

Remarks: First Production 9-74

\* Re-completed to Jalmat (Gas)

[illegible]

## 19\_\_\_\_\_ Detail Summary

Jan. \_\_\_\_\_ July \_\_\_\_\_

Feb. \_\_\_\_\_ Aug. \_\_\_\_\_

March. \_\_\_\_\_ Sept. \_\_\_\_\_

April \_\_\_\_\_ Oct. \_\_\_\_\_

May \_\_\_\_\_ Nov. \_\_\_\_\_

June \_\_\_\_\_ Dec. \_\_\_\_\_

19\_\_\_\_\_ Detail Summary

Jan. \_\_\_\_\_ July \_\_\_\_\_

Feb. \_\_\_\_\_ Aug. \_\_\_\_\_

March \_\_\_\_\_ Sept. \_\_\_\_\_

April \_\_\_\_\_ Oct. \_\_\_\_\_

May \_\_\_\_\_ Nov. \_\_\_\_\_

June \_\_\_\_\_ Dec. \_\_\_\_\_

Production (Y-T-D) \_\_\_\_\_

Avg. Rate (Y-T-D) \_\_\_\_\_

Days or Months (Y-T-D) \_\_\_\_\_



Oil Production - BBL/Month

4-1-79

Cum:

10.2 MBO

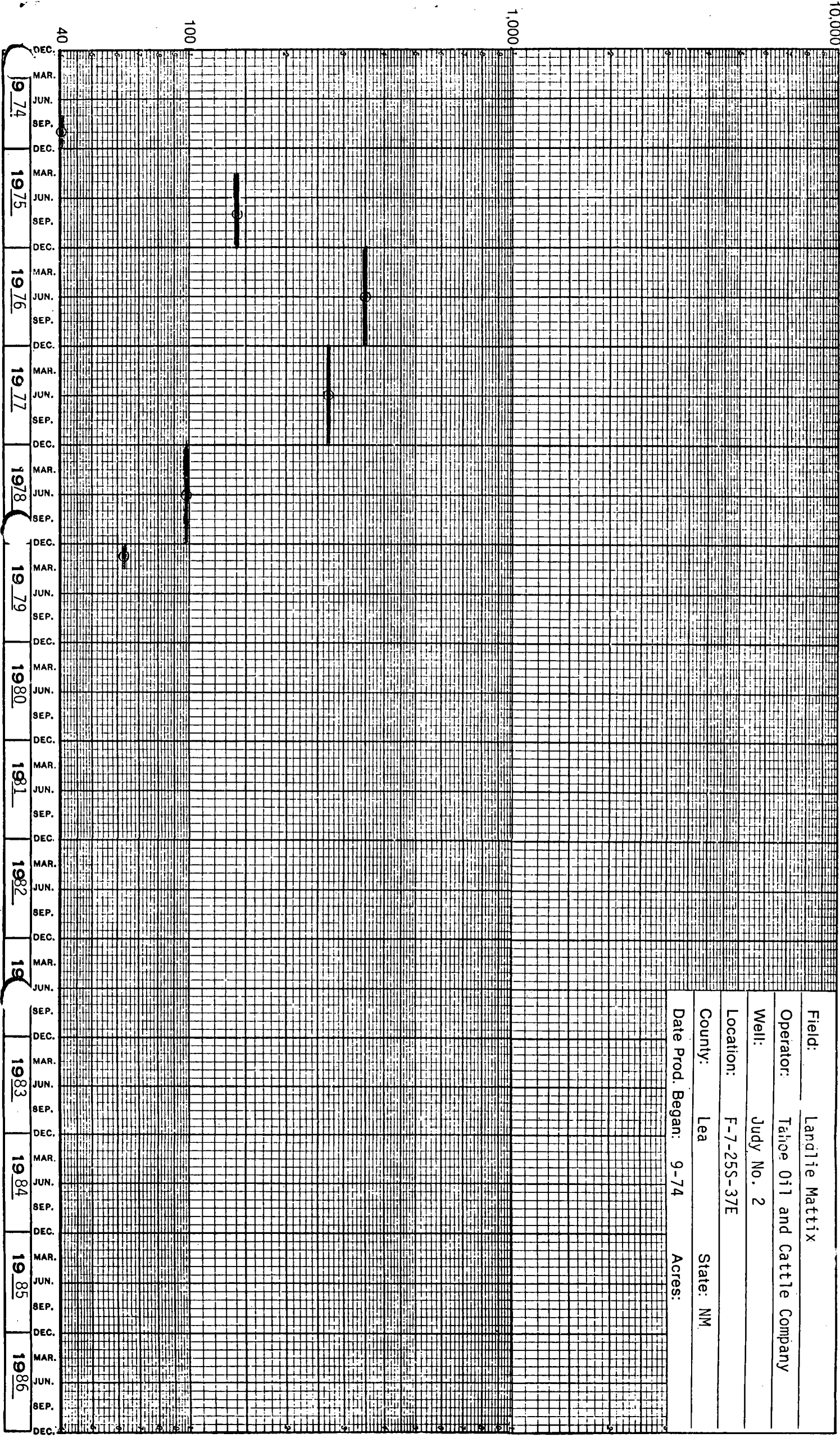

Field: Landlie Mattix

Operator: Tahoe Oil and Cattle Company

Well: Judy No. 2

Location: F-7-25S-37E

County: Lea State: NM

Date Prod. Began: 9-74 Acres:

Offset Jalmat (Dry Gas) Owners  
Munn-Harrison "B" No. 1  
E/2 NW/4 Section 7, T-25-S, R-37-E  
Lea County, New Mexico

<u>Jalmat Dry Gas Owner</u>	<u>Date Notification Mailed</u>	<u>Date Notification Received</u>	<u>Date Notification Acknowledged</u>
Getty Oil Company	March 24, 1982	March 25, 1982	March 29, 1982
Dalport Oil Corporation	March 24, 1982	March 29, 1982	March 29, 1982
Phillips Petroleum Corp.	March 24, 1982	March 26, 1982	March 22, 1982 (April 22, 1982?)

**DOYLE HARTMAN**

*Oil Operator*

500 N. MAIN

P. O. BOX 10426

MIDLAND, TEXAS 79702

(915) 684-4011

March 24, 1982

Offset Jalmat (Dry Gas) Owners  
Proposed Munn-Harrison "B" No. 1  
E/2 NW/4 Section 7  
T-25-S, R-37-E  
Lea County, New Mexico

We would be very appreciative if you would indicate your approval of our request for non-standard proration unit and non-standard location to be dedicated to the above-captioned well and our intention to qualify the Munn-Harrison "B" No. 1 as a Section 103 (Infill) well by signing one copy of this request and returning it in the enclosed self-addressed, stamped envelope.

We have a rig available which we would like to use in the drilling of this well, so your prompt attention in this matter would be very much appreciated.

Very truly yours,

DOYLE HARTMAN

Larry A. Nermyr  
Engineer

Approved this 29th day of March, 1982.

✓ Getty Oil Company

By J. B. Howard

Dalport Oil Corporation

By \_\_\_\_\_

Phillips Petroleum Company

By \_\_\_\_\_

MAR 30 1982

**DOYLE HARTMAN**

Oil Operator

500 N MAIN

P. O. BOX 10426

MIDLAND, TEXAS 79702

(915) 684-4011

March 24, 1982

Offset Jalmat (Dry Gas) Owners  
Proposed Munn-Harrison "B" No. 1  
E/2 NW/4 Section 7  
T-25-S, R-37-E  
Lea County, New Mexico

We would be very appreciative if you would indicate your approval of our request for non-standard proration unit and non-standard location to be dedicated to the above-captioned well and our intention to qualify the Munn-Harrison "B" No. 1 as a Section 103 (Infill) well by signing one copy of this request and returning it in the enclosed self-addressed, stamped envelope.

We have a rig available which we would like to use in the drilling of this well, so your prompt attention in this matter would be very much appreciated.

Very truly yours,

DOYLE HARTMAN

Larry A. Nermyr  
Engineer

Approved this 29<sup>th</sup> day of March, 1982.

Getty Oil Company

By \_\_\_\_\_

✓ Dalport Oil Corporation

By *W. P. T. [Signature]*

Phillips Petroleum Company

By \_\_\_\_\_

MAR 31 1982

**DOYLE HARTMAN**

Oil Operator

500 N. MAIN

P. O. BOX 10426

MIDLAND, TEXAS 79702

(815) 684-4011

March 24, 1982

Offset Jalmat (Dry Gas) Owners  
Proposed Munn-Harrison "B" No. 1  
E/2 NW/4 Section 7  
T-25-S, R-37-E  
Lea County, New Mexico

We would be very appreciative if you would indicate your approval of our request for non-standard proration unit and non-standard location to be dedicated to the above-captioned well and our intention to qualify the Munn-Harrison "B" No. 1 as a Section 103 (Infill) well by signing one copy of this request and returning it in the enclosed self-addressed, stamped envelope.

We have a rig available which we would like to use in the drilling of this well, so your prompt attention in this matter would be very much appreciated.

Very truly yours,

DOYLE HARTMAN

Larry A. Nermyr  
Engineer

Approved this 22nd day of March, 1982.

Getty Oil Company

By \_\_\_\_\_

Dalport Oil Corporation

By \_\_\_\_\_

Phillips Petroleum Company

By G. R. Smith

G. R. Smith, Director - Reservoir Engineering

APR 27 1982

PS Form 3811, Jan. 1976

**SENDER:** Complete Items 1, 2, and 3. Add your address in the "RETURN TO" space on reverse.

1. The following service is requested (check one.)  
☒ Show to whom and date delivered..... 60¢  
☐ Show to whom, date and address of delivery..... ¢  
☐ RESTRICTED DELIVERY  
 Show to whom and date delivered..... ¢  
☐ RESTRICTED DELIVERY.  
 Show to whom, date, and address of delivery \$ \_\_\_\_

(CONSULT POSTMASTER FOR FEES)

2. ARTICLE ADDRESSED TO:  
 NMOCD  
 P. O. Box 2088  
 Santa Fe, New Mexico 87501

3. ARTICLE DESCRIPTION:  

REGISTERED NO.	CERTIFIED NO.	INSURED NO.
	1964406	

 (Always obtain signature of addressee or agent)

I have received the article described above.  
 SIGNATURE ☐ Addressee ☒ Authorized agent

4. DATE OF DELIVERY 3-24-82 POSTMARK 3-24-82

5. ADDRESS (Complete only if requested)

6. UNABLE TO DELIVER BECAUSE: CLERK'S INITIALS

RETURN RECEIPT, REGISTERED, INSURED AND CERTIFIED MAIL

Munn-Harrison B NSPU

PI 1964406

RECEIPT FOR CERTIFIED MAIL

NO INSURANCE COVERAGE PROVIDED  
 NOT FOR INTERNATIONAL MAIL  
 (See Reverse)

NMOCD  
 STREET AND NO.  
 P. O. Box 2088  
 Santa Fe, NM 87501

POSTAGE

CONSULT POSTMASTER FOR FEES	OPTIONAL SERVICES	RETURN RECEIPT SERVICE	POSTAGE
			58 75
			60
			2.23

TOTAL POSTAGE AND FEES 2.23

POSTMARK OR DATE 3-24-82

Munn-Harrison B NSPU

PS Form 3800, Apr. 1976

PI 1964404

RECEIPT FOR CERTIFIED MAIL

NO INSURANCE COVERAGE PROVIDED  
 NOT FOR INTERNATIONAL MAIL  
 (See Reverse)

Phillips Petroleum Co.  
 4001 Penbrooke  
 Odessa, Texas 79762

POSTAGE

CONSULT POSTMASTER FOR FEES	OPTIONAL SERVICES	RETURN RECEIPT SERVICE	POSTAGE
			54 75
			60
			1.89

TOTAL POSTAGE AND FEES 1.89

POSTMARK OR DATE 3-24-82

NSPU Munn-Harrison B

PS Form 3800, Apr. 1976

PS Form 3811, Jan. 1976

**SENDER:** Complete Items 1, 2, and 3. Add your address in the "RETURN TO" space on reverse.

1. The following service is requested (check one.)  
☒ Show to whom and date delivered..... 60¢  
☐ Show to whom, date and address of delivery..... ¢  
☐ RESTRICTED DELIVERY  
 Show to whom and date delivered..... ¢  
☐ RESTRICTED DELIVERY.  
 Show to whom, date, and address of delivery \$ \_\_\_\_

(CONSULT POSTMASTER FOR FEES)

2. ARTICLE ADDRESSED TO:  
 Phillips Petroleum Company  
 4001 Penbrooke  
 Odessa, Texas 79762

3. ARTICLE DESCRIPTION:  

REGISTERED NO.	CERTIFIED NO.	INSURED NO.
	1964404	

 (Always obtain signature of addressee or agent)

I have received the article described above.  
 SIGNATURE ☐ Addressee ☒ Authorized agent

4. DATE OF DELIVERY 3/26/82 POSTMARK 3-26-82

5. ADDRESS (Complete only if requested)

6. UNABLE TO DELIVER BECAUSE: CLERK'S INITIALS

RETURN RECEIPT, REGISTERED, INSURED AND CERTIFIED MAIL

☆ GPO : 1979-298-849

PS Form 3811, Jan. 1979

**SENDER:** Complete items 1, 2, and 3. Add your address in the "RETURN TO" space on reverse.

1. The following service is requested (check one.)

☒ Show to whom and date delivered.....60¢

☐ Show to whom, date and address of delivery.....¢

☐ RESTRICTED DELIVERY

Show to whom and date delivered.....¢

☐ RESTRICTED DELIVERY.

Show to whom, date, and address of delivery.\$\_\_\_\_

(CONSULT POSTMASTER FOR FEES)

2. ARTICLE ADDRESSED TO:

NMOCD  
District I Office P.O. Box 1980  
Hobbs, New Mexico 88240

3. ARTICLE DESCRIPTION:

REGISTERED NO.	CERTIFIED NO.	INSURED NO.
	1964397	

(Always obtain signature of addressee or agent)

I have received the article described above.

SIGNATURE ☐ Addressee ☐ Authorized agent

4. DATE OF DELIVERY POSTMARK

5. ADDRESS (Complete only if requested)

6. UNABLE TO DELIVER BECAUSE: CLERK'S INITIALS

☆ GPO : 1979-243 248

PS Form 3811, Jan. 1979

**SENDER:** Complete items 1, 2, and 3. Add your address in the "RETURN TO" space on reverse.

1. The following service is requested (check one.)

☒ Show to whom and date delivered.....60¢

☐ Show to whom, date and address of delivery.....¢

☐ RESTRICTED DELIVERY

Show to whom and date delivered.....¢

☐ RESTRICTED DELIVERY.

Show to whom, date, and address of delivery.\$\_\_\_\_

(CONSULT POSTMASTER FOR FEES)

2. ARTICLE ADDRESSED TO:

NMOCD  
P.O. Box 1980  
Hobbs, NM 88240

3. ARTICLE DESCRIPTION:

REGISTERED NO.	CERTIFIED NO.	INSURED NO.
	1964397	

(Always obtain signature of addressee or agent)

I have received the article described above.

SIGNATURE ☐ Addressee ☐ Authorized agent

4. DATE OF DELIVERY POSTMARK

5. ADDRESS (Complete only if requested)

6. UNABLE TO DELIVER BECAUSE: CLERK'S INITIALS

☆ GPO : 1979-243 248

PS Form 3811, Jan. 1979

**SENDER:** Complete items 1, 2, and 3. Add your address in the "RETURN TO" space on reverse.

1. The following service is requested (check one.)

☒ Show to whom and date delivered.....60¢

☐ Show to whom, date and address of delivery.....¢

☐ RESTRICTED DELIVERY

Show to whom and date delivered.....¢

☐ RESTRICTED DELIVERY.

Show to whom, date, and address of delivery.\$\_\_\_\_

(CONSULT POSTMASTER FOR FEES)

2. ARTICLE ADDRESSED TO:

Getty Oil Company  
P. O. Box 1231  
Midland, Texas 79702

3. ARTICLE DESCRIPTION:

REGISTERED NO.	CERTIFIED NO.	INSURED NO.
	1964405	

(Always obtain signature of addressee or agent)

I have received the article described above.

SIGNATURE ☐ Addressee ☐ Authorized agent

4. DATE OF DELIVERY POSTMARK

5. ADDRESS (Complete only if requested)

6. UNABLE TO DELIVER BECAUSE: CLERK'S INITIALS

☆ GPO : 1979-243 248

PS Form 3811, Jan. 1979

**SENDER:** Complete items 1, 2, and 3. Add your address in the "RETURN TO" space on reverse.

1. The following service is requested (check one.)

☒ Show to whom and date delivered.....60¢

☐ Show to whom, date and address of delivery.....¢

☐ RESTRICTED DELIVERY

Show to whom and date delivered.....¢

☐ RESTRICTED DELIVERY.

Show to whom, date, and address of delivery.\$\_\_\_\_

(CONSULT POSTMASTER FOR FEES)

2. ARTICLE ADDRESSED TO:

Getty Oil Company  
P. O. Box 1231  
Midland, Texas 79702

3. ARTICLE DESCRIPTION:

REGISTERED NO.	CERTIFIED NO.	INSURED NO.
	1964405	

(Always obtain signature of addressee or agent)

I have received the article described above.

SIGNATURE ☐ Addressee ☐ Authorized agent

4. DATE OF DELIVERY POSTMARK

5. ADDRESS (Complete only if requested)

6. UNABLE TO DELIVER BECAUSE: CLERK'S INITIALS

☆ GPO : 1979-243 248

PS Form 3811, Jan. 1979

**SENDER:** Complete items 1, 2, and 3.  
Add your address in the "RETURN TO" space on reverse.

1. The following service is requested (check one.)  
☒ Show to whom and date delivered..... 60 ¢  
☐ Show to whom, date and address of delivery..... ¢  
☐ RESTRICTED DELIVERY  
 Show to whom and date delivered..... ¢  
☐ RESTRICTED DELIVERY.  
 Show to whom, date, and address of delivery \$ \_\_\_\_\_

(CONSULT POSTMASTER FOR FEES)

2. ARTICLE ADDRESSED TO:  
 Dalport Oil Corporation  
 3471 First National Bank Bldg.  
 Dallas, Texas 75202

3. ARTICLE DESCRIPTION:  

REGISTERED NO.	CERTIFIED NO.	INSURED NO.
	1964403	

 (Always obtain signature of addressee or agent)

I have received the article described above.  
 SIGNATURE ☐ Addressee ☐ Authorized agent  
*E. Munn-Harrison*

4. DATE OF DELIVERY **MAR 29 1982** POSTMARK

5. ADDRESS (Complete only if requested)

6. UNABLE TO DELIVER BECAUSE: CLERK'S INITIALS

RETURN RECEIPT, REGISTERED, INSURED AND CERTIFIED MAIL

☆ GPO : 1979 298-448

POST OFFICE BOX 10000 DALLAS, TEXAS 75202

**Dalport Oil Corporation**  
 3471 FNB Bldg.  
 Dallas, TX 75202

54  
75

60

1.89

3-24-82

Munn-Harrison "B" No. 1

PS Form 3800, Apr. 1979

Received 6/21/82

Immediately

STATE OF NEW MEXICO  
ENERGY AND MINERALS DEPARTMENTOIL CONSERVATION DIVISION  
P. O. Box 2088  
SANTA FE, NEW MEXICO  
87501

ADMINISTRATIVE ORDER

NFL 51INFILL DRILLING FINDINGS PURSUANT TO  
SECTION 271.305(b) OF THE FEDERAL ENERGY REGULATORY  
COMMISSION REGULATIONS, NATURAL GAS POLICY ACT OF 1978  
AND OIL CONSERVATION DIVISION ORDER NO. R-6013-A

I.

Operator Doyle Hartman Well Name and No. Munn - Harrison "B" Well No. 1  
Location: Unit C Sec. 7 Twp. 25S Rng. 37E Cty. Lea

II.

## THE DIVISION FINDS:

- (1) That Section 271.305(b) of the Federal Energy Regulatory Commission Regulations promulgated pursuant to the Natural Gas Policy Act of 1978 provides that, in order for an infill well to qualify as a new onshore production well under Section 103 of said Act, the Division must find that the infill well is necessary to effectively and efficiently drain a portion of the reservoir covered by the proration unit which cannot be so drained by any existing well within that unit.
- (2) That by Order No. R-6013-A, dated February 8, 1980, the Division established an administrative procedure whereby the Division Director and the Division Examiners are empowered to act for the Division and find that an infill well is necessary.
- (3) That the well for which a finding is sought is completed in the Jalmat Pool, and the standard spacing unit in said pool is 640 acres.
- (4) That a 80-acre proration unit comprising the E/2 NW/4 of Sec. 7, Twp. 25S, Rng. 37E, is currently dedicated to the Jalmat Oilfield Judy Well No. 2 located in Unit F of said section.
- (5) That this proration unit is ( ) standard (X) nonstandard; if nonstandard, said unit was previously approved by Order No. NSP-1304(L).
- (6) That said proration unit is not being effectively and efficiently drained by the existing well(s) on the unit.
- (7) That the drilling and completion of the well for which a finding is sought should result in the production of an additional 346,000 MCF of gas from the proration unit which would not otherwise be recovered.
- (8) That all the requirements of Order No. R-6013-A have been complied with, and that the well for which a finding is sought is necessary to effectively and efficiently drain a portion of the reservoir covered by said proration unit which cannot be so drained by any existing well within the unit.
- (9) That in order to permit effective and efficient drainage of said proration unit, the subject application should be approved.

## IT IS THEREFORE ORDERED:

- (1) That the applicant is hereby authorized to drill the well described in Section I above as an infill well on the existing proration unit described in Section II(4) above. The authorization for infill drilling granted by this order is necessary to permit the drainage of a portion of the reservoir covered by said proration unit which cannot be effectively and efficiently drained by any existing well thereon.
- (2) That jurisdiction of this cause is retained for the entry of such further orders as the Division may deem necessary.

DONE at Santa Fe, New Mexico, on this \_\_\_\_\_ day of \_\_\_\_\_, 19\_\_\_\_.

DIVISION DIRECTOR \_\_\_\_\_

EXAMINER \_\_\_\_\_

OCD-Hobbs  
Minerals Manag. - Hobbs  
Eng. Committee