



STATE OF NEW MEXICO
ENERGY, MINERALS AND NATURAL RESOURCES DEPARTMENT

OIL CONSERVATION DIVISION

2040 S. PACHECO
SANTA FE, NEW MEXICO 87505
(505) 827-7131

March 27, 1996

Amoco Production Company
Southern Rockies Business Unit
P. O. Box 800
Denver, Colorado 80201
Attention: J. W. Hawkins

Administrative Order DD-136

Dear Mr. Hawkins:

Reference is made to Amoco Production Company's application dated February 7, 1996 for authorization to recomplete the existing Atlantic A "LS" Well No. 3 (API No. 30-045-10242) by side tracking off of the vertical portion of the wellbore and drill a high angle slant hole to a pre-determined bottom-hole location in order to further develop the Blanco-Mesaverde Pool underlying its existing 317.80-acre non-standard gas spacing and proration unit ("GPU") comprising Lots 3, 4, 5, 6, 11, 12, 13, and 14 (W/2 equivalent) of Section 28, Township 31 North, Range 10 West, NMPM, San Juan County, New Mexico.

The Division Director Finds That:

- (1) The application has been duly filed under the provisions of Rule 111(D) and (E) of the General Rules and Regulations of the New Mexico Oil Conservation Division ("Division"), revised by Division Order No. R-10388, issued by the Oil Conservation Commission in Case 11,274 on June 13, 1995;
- (2) The Atlantic A "LS" Well No. 3, located at a standard gas well location 790 feet from the South line and 990 feet from the West line (Lot 13/Unit M) of said Section 28, was originally drilled and completed in 1953 as an initial Blanco-Mesaverde gas well, and was assigned the above-described 317.80-acre GPU;
- (3) By Order No. R-8170, as amended, the Division promulgated the "*General Rules For The Prorated Gas Pools of New Mexico/Special Rules and Regulations For The Blanco-Mesaverde Pool*", which includes provisions for 320-acre gas spacing and proration units and well location requirements whereby the initial well drilled on a GPU shall be located be no closer than 790 feet to the outer boundary of the quarter section on which the well is located and not closer than 130 feet to any quarter-quarter section line or subdivision inner boundary and the infill well drilled on an existing GPU shall be in the quarter section not containing a Mesaverde gas well and shall be located with respect to the restrictions as previously described;

- (4) Within this GPU Amoco is also producing Blanco-Mesaverde gas from its Atlantic A "LS" Well No. 3-A (API No. 30-045-22507), located at a standard infill gas well location 1150 feet from the North line and 1500 feet from the West line (Lot 3\Unit C) of said Section 28;
- (5) A high angle slant hole drilled off of the existing vertical wellbore in the Atlantic A "LS" Well No. 3 as proposed should provide Amoco a better opportunity to encounter the naturally occurring fracture system in the Mesaverde formation, which should result in a higher production rate and an increased ultimate recovery of gas from this well;
- (6) The applicant/operator proposes to kick-off from vertical at a depth of approximately 3,400 feet by milling a window in the existing production casing, drill in a northeasterly direction, build to an angle of approximately 27 degrees and continue drilling in such a manner as to bottom back into the Blanco-Mesaverde Pool, with total horizontal displacement of said wellbore to be approximately 750 feet;
- (7) The applicable drilling window or "producing area" for said wellbore should include that area within the SW/4 equivalent of said Section 28 that is no closer than 790 feet to the quarter section lines; and,
- (8) It appearing the applicant has satisfied all of the appropriate requirements prescribed in said Rule 111.D and E, the subject application should be approved and the well should be governed by the provisions contained within this order and all other applicable provisions of Division General Rule 111.

IT IS THEREFORE ORDERED THAT:

(1) The applicant, Amoco Production Company, is hereby authorized to recomplete its existing Atlantic A "LS" Well No. 3 (API No. 30-045-10242), located at a standard gas well location 790 feet from the South line and 990 feet from the West line (Lot 13/Unit M) of Section 28, Township 31 North, Range 10 West, NMPM, San Juan County, New Mexico, by milling a window in the existing production casing at a depth of approximately 3,400 feet, kick-off from vertical in a northeasterly direction, build to an angle of approximately 27 degrees and continue drilling in such a manner as to bottom back into the Blanco-Mesaverde Pool (total horizontal displacement of said wellbore to be approximately 750 feet) within a drilling window or "producing area" comprising the SW/4 equivalent of said Section 28 that is no closer than 790 feet to the quarter section lines.

PROVIDED HOWEVER THAT prior to commencing directional drilling operations in said wellbore, the applicant shall establish the location of the kick-off point by means of a directional survey acceptable to the Division.

PROVIDED FURTHER THAT during or upon completion of directional drilling operations, the applicant shall conduct an accurate wellbore survey from the kick-off point to total depth in order that the subsurface bottomhole location, as well as the wellbore's true depth and course, may be determined.

(2) The applicant shall notify the supervisor of the Aztec district office of the Division of the date and time said wellbore surveys are to be conducted so that they may be witnessed. The applicant shall further provide a copy of said wellbore surveys to the Santa Fe and Aztec offices of the Division upon completion.

(3) Blanco-Mesaverde gas production from both the existing Atlantic A "LS" Well No. 3-A (API No. 30-045-22507), located at a standard infill gas well location 1150 feet from the North line and 1500 feet from the West line (Lot 3/Unit C) of said Section 28, and Atlantic A "LS" Well No. 3, as described above, shall be attributed to the existing 317.80-acre non-standard gas spacing and proration unit ("GPU") comprising Lots 3, 4, 5, 6, 11, 12, 13, and 14 (W/2 equivalent) of said Section 28.

(4) The operator shall comply with all requirements and conditions set forth in Division General Rule 111.E(2) and any applicable requirements in 111.D and F and Order No. R-8170, as amended.

(5) Form C-105 shall be filed in accordance with Division Rule 1105 and the operator shall indicate thereon true vertical depth in addition to measured depths.

(6) Jurisdiction of this cause is retained for the entry of such further orders as the Division may deem necessary.

DONE at Santa Fe, New Mexico, on the day and year hereinabove designated.

STATE OF NEW MEXICO
OIL CONSERVATION DIVISION

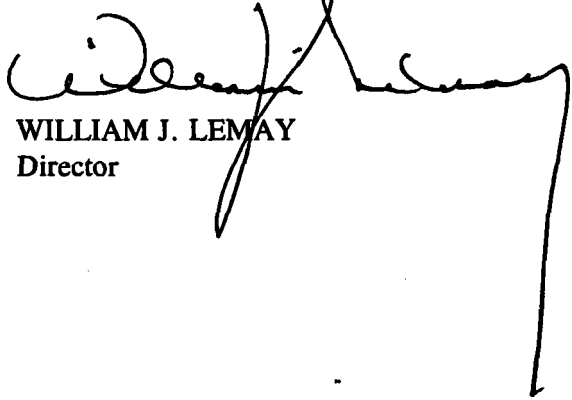
WILLIAM J. LEMAY
Director

S E A L

WJL/MES/kv

cc: Oil Conservation Division - Aztec
U. S. Bureau of Land Management - Farmington

DD-AMOC 10

Rec. 2-12-96
Sup. 3-4-96
Released 3-26-96

March 26, 1996

Amoco Production Company
Southern Rockies Business Unit
P. O. Box 800
Denver, Colorado 80201

Attention: J. W. Hawkins

136
Administrative Order DD-*****

Dear Mr. Hawkins:

Reference is made to Amoco Production Company's application dated February 7, 1996 for authorization to recomplete the existing Atlantic A "LS" Well No. 3 (API No. 30-045-10242) by side tracking off of the vertical portion of the wellbore and drill a high angle slant hole to a pre-determined bottom-hole location in order to further develop the Blanco-Mesaverde Pool underlying its existing 317.80-acre non-standard gas spacing and proration unit ("GPU") comprising Lots 3, 4, 5, 6, 11, 12, 13, and 14 (W/2 equivalent) of Section 28, Township 31 North, Range 10 West, NMPM, San Juan County, New Mexico.

The Division Director Finds That:

- (1) The application has been duly filed under the provisions of Rule 111(D) and (E) of the General Rules and Regulations of the New Mexico Oil Conservation Division ("Division"), revised by Division Order No. R-10388, issued by the Oil Conservation Commission in Case 11,274 on June 13, 1995;
- (2) The Atlantic A "LS" Well No. 3, located at a standard gas well location 790 feet from the South line and 990 feet from the West line (Lot 13/Unit M) of said Section 28, was originally drilled and completed in 1953 as an initial Blanco-Mesaverde gas well, and was assigned the above-described 317.80-acre GPU;
- (3) By Order No. R-8170, as amended, the Division promulgated the "*General Rules For The Prorated Gas Pools of New Mexico/Special Rules and Regulations For The Blanco-Mesaverde Pool*", which includes provisions for 320-acre gas spacing and proration units and well location requirements whereby the initial well drilled on a GPU shall be located be no closer than 790 feet to the outer boundary of the quarter section on which the well is located and not closer than 130 feet to any quarter-quarter section line or subdivision inner boundary and the infill well drilled on an existing GPU shall be in the quarter section not containing a Mesaverde gas well and shall be located with respect to the restrictions as previously described;

- (4) Within this GPU Amoco is also producing Blanco-Mesaverde gas from its Atlantic A "LS" Well No. 3-A (API No. 30-045-22507), located at a standard infill gas well location 1150 feet from the North line and 1500 feet from the West line (Lot 3\Unit C) of said Section 28;
- (5) A high angle slant hole drilled off of the existing vertical wellbore in the Atlantic A "LS" Well No. 3 as proposed should provide Amoco a better opportunity to encounter the naturally occurring fracture system in the Mesaverde formation, which should result in a higher production rate and an increased ultimate recovery of gas from this well;
- (6) The applicant/operator proposes to kick-off from vertical at a depth of approximately 3,400 feet by milling a window in the existing production casing, drill in a northeasterly direction, build to an angle of approximately 27 degrees and continue drilling in such a manner as to bottom back into the Blanco-Mesaverde Pool, with total horizontal displacement of said wellbore to be approximately 750 feet;
- (7) The applicable drilling window or "producing area" for said wellbore should include that area within the SW/4 equivalent of said Section 28 that is no closer than 790 feet to the quarter section lines; and,
- (8) It appearing the applicant has satisfied all of the appropriate requirements prescribed in said Rule 111.D and E, the subject application should be approved and the well should be governed by the provisions contained within this order and all other applicable provisions of Division General Rule 111.

IT IS THEREFORE ORDERED THAT:

(1) The applicant, Amoco Production Company, is hereby authorized to recomplete its existing Atlantic A "LS" Well No. 3 (API No. 30-045-10242), located at a standard gas well location 790 feet from the South line and 990 feet from the West line (Lot 13/Unit M) of Section 28, Township 31 North, Range 10 West, NMPM, San Juan County, New Mexico, by milling a window in the existing production casing at a depth of approximately 3,400 feet, kick-off from vertical in a northeasterly direction, build to an angle of approximately 27 degrees and continue drilling in such a manner as to bottom back into the Blanco-Mesaverde Pool (total horizontal displacement of said wellbore to be approximately 750 feet) within a drilling window or "producing area" comprising the SW/4 equivalent of said Section 28 that is no closer than 790 feet to the quarter section lines.

PROVIDED HOWEVER THAT prior to commencing directional drilling operations in said wellbore, the applicant shall establish the location of the kick-off point by means of a directional survey acceptable to the Division.

PROVIDED FURTHER THAT during or upon completion of directional drilling operations, the applicant shall conduct an accurate wellbore survey from the kick-off point to total depth in order that the subsurface bottomhole location, as well as the wellbore's true depth and course, may be determined.

(2) The applicant shall notify the supervisor of the Aztec district office of the Division of the date and time said wellbore surveys are to be conducted so that they may be witnessed. The applicant shall further provide a copy of said wellbore surveys to the Santa Fe and Aztec offices of the Division upon completion.

(3) Blanco-Mesaverde gas production from both the existing Atlantic A "LS" Well No. 3-A (API No. 30-045-22507), located at a standard infill gas well location 1150 feet from the North line and 1500 feet from the West line (Lot 3/Unit C) of said Section 28, and Atlantic A "LS" Well No. 3, as described above, shall be attributed to the existing 317.80-acre non-standard gas spacing and proration unit ("GPU") comprising Lots 3, 4, 5, 6, 11, 12, 13, and 14 (W/2 equivalent) of said Section 28.

(4) The operator shall comply with all requirements and conditions set forth in Division General Rule 111.E(2) and any applicable requirements in 111.D and F and Order No. R-8170, as amended.

(5) Form C-105 shall be filed in accordance with Division Rule 1105 and the operator shall indicate thereon true vertical depth in addition to measured depths.

(6) Jurisdiction of this cause is retained for the entry of such further orders as the Division may deem necessary.

DONE at Santa Fe, New Mexico, on the day and year hereinabove designated.

STATE OF NEW MEXICO
OIL CONSERVATION DIVISION

WILLIAM J. LEMAY
Director

S E A L

*Administrative Order DD-*****

Amoco Production Company

March 26, 1996

Page No. 4

WJL/MES/kv

cc: Oil Conservation Division - Aztec
U. S. Bureau of Land Management - Farmington



STATE OF NEW MEXICO
ENERGY, MINERALS AND NATURAL RESOURCES DEPARTMENT

OIL CONSERVATION DIVISION
2040 S. PACHECO
SANTA FE, NEW MEXICO 87505
(505) 827-7131

July 30, 1996

Amoco Production Company
P. O. Box 800
Denver, Colorado 80201
Attention: J. W. Hawkins

AMENDED Administrative Order DD-136(NSBHL)

Dear Mr. Hawkins:

By Division Administrative Order DD-136, dated March 27, 1996, authorization was given Amoco Production Company ("Amoco") to directionally drill its Atlantic A "LS" Well No. 3 (API No. 30-045-10242) from a standard surface gas well location 790 feet from the South line and 990 feet from the West line (Lot 13/Unit M) of said Section 28, Township 31 North, Range 10 West, NMPM, San Juan County, New Mexico, to a standard bottom-hole gas well location in the Blanco-Mesaverde Pool within a drilling window or "producing area" comprising the SW/4 equivalent of said Section 28 that is no closer than 790 feet to the quarter section lines.

Reference is now made to your letter with attachments dated July 1, 1996, whereby an amendment should be issued in this order to accurately reflect the actual bottom-hole location of this wellbore as being unorthodox.

The Division Director Finds That:

- (1) This application was originally approved under the provisions of General Rule 111.D and Rule 2(c) of the "*General Rules For The Prorated Gas Pools of New Mexico/Special Rules and Regulations For The Blanco-Mesaverde Pool*";;
- (2) This amendment has been duly filed under the provisions of Division General Rules 111.D and 111.E and said Special Rule 2(c); and,
- (3) Amoco owns all affected offsetting 320-acre, more or less, tracts to the captioned well, no notification was therefore required.

AMENDED Administrative Order DD-136(NSBHL)

Amoco Production Company

July 30, 1996

Page No. 2

IT IS THEREFORE ORDERED THAT:

(1) Division Administrative Order DD-136 is hereby amended to properly reflect the actual bottomhole location for said Atlantic A "LS" Well No. 3 within the Blanco-Mesaverde Pool to be, more or less, 682 feet from the South line and 1534 feet from the West line (Lot 14/Unit N) of Section 28, Township 31 North, Range 10 West, NMPM, San Juan County, New Mexico.

(2) All other provisions of said Order DD-136, dated March 27, 1996, not in conflict with this change shall remain in full force and effect until further notice.

(3) Jurisdiction of this cause is retained for the entry of such further orders as the Division may deem necessary.

DONE at Santa Fe, New Mexico, on the day and year hereinabove designated.

STATE OF NEW MEXICO
OIL CONSERVATION DIVISION

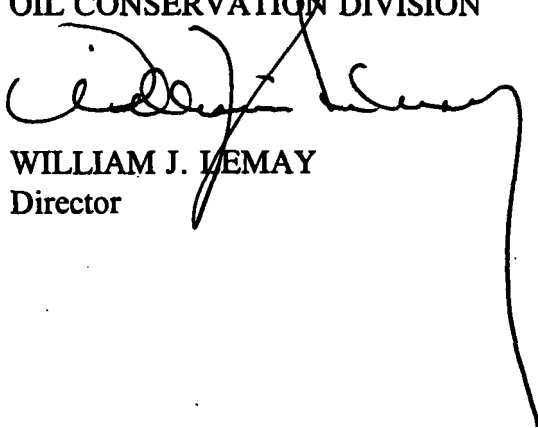
WILLIAM J. LEMAY
Director

SEAL

WJL/MES/kv

cc: Oil Conservation Division - Aztec
U. S. Bureau of Land Management - Farmington
File: DD-136

DD - 136. AMD

Rec. 7-3-96

Susp: NA

Released: 7-30-96

July 30, 1996

Amoco Production Company
P. O. Box 800
Denver, Colorado 80201

Attention: J. W. Hawkins

AMENDED Administrative Order DD-136(NSBHL)

Dear Mr. Hawkins:

By Division Administrative Order DD-136, dated March 27, 1996, authorization was given Amoco Production Company ("Amoco") to directionally drill its Atlantic A "LS" Well No. 3 (API No. 30-045-10242) from a standard surface gas well location 790 feet from the South line and 990 feet from the West line (Lot 13/Unit M) of said Section 28, Township 31 North, Range 10 West, NMPM, San Juan County, New Mexico, to a standard bottom-hole gas well location in the Blanco-Mesaverde Pool within a drilling window or "producing area" comprising the SW/4 equivalent of said Section 28 that is no closer than 790 feet to the quarter section lines.

Reference is now made to your letter with attachments dated July 1, 1996, whereby an amendment should be issued in this order to accurately reflect the actual bottom-hole location of this wellbore *as being unorthodox.*

The Division Director Finds That:

- (1) This application was originally approved under the provisions of General Rule 111.D and Rule 2(c) of the "General Rules For The Prorated Gas Pools of New Mexico/Special Rules and Regulations For The Blanco-Mesaverde Pool",;
- (2) This amendment has been duly filed under the provisions of Division General Rules 111.D and 111.E and said Special Rule 2(c); and,
- (3) Amoco owns all affected offsetting 320-acre, more or less, tracts to the captioned well, no notification was therefore required.



AMENDED Administrative Order DD-136(NSBHL)
Amoco Production Company
July 30, 1996
Page No. 2

IT IS THEREFORE ORDERED THAT:

(1) Division Administrative Order DD-136 is hereby amended to properly reflect the actual bottomhole location for said Atlantic A "LS" Well No. 3 within the Blanco-Mesaverde Pool to be, more or less, 682 feet from the South line and 1534 feet from the West line (Lot 14/Unit N) of Section 28, Township 31 North, Range 10 West, NMPM, San Juan County, New Mexico.

(2) All other provisions of said Order DD-136, dated March 27, 1996, not in conflict with this change shall remain in full force and effect until further notice.

(3) Jurisdiction of this cause is retained for the entry of such further orders as the Division may deem necessary.

DONE at Santa Fe, New Mexico, on the day and year hereinabove designated.

STATE OF NEW MEXICO
OIL CONSERVATION DIVISION

WILLIAM J. LEMAY
Director

S E A L

WJL/MES/kv

cc: Oil Conservation Division - Aztec
U. S. Bureau of Land Management - Farmington
File: DD-136



OIL CONSERVATION DIVISION
RECEIVED

'96 JUL 3 AM 8 52

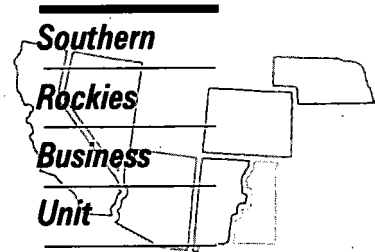

July 1, 1996

Mr. William J. LeMay, Director
New Mexico Oil Conservation Division
2040 S. Pacheco Street
Santa Fe, NM 87505

Application for Unorthodox Location
Atlantic A LS #3 Well
W/2 Section 28-T31N-R10W
Blanco Mesaverde Pool
San Juan County, New Mexico

Amoco Production Company hereby requests administrative approval for an unorthodox location for the Atlantic A LS #3 well. This well was recently directionally drilled as a high angle well in the Blanco Mesaverde Pool as approved under NMOCD Administrative Order DD-136. The Atlantic A LS #3 well was drilled from a surface location of 790' FSL and 990' FWL of Section 28, T31N-R10W to a bottomhole location of 682' FSL and 1534 FWL. The Project Area for this well is the Blanco Mesaverde gas proration unit consisting of W/2 Section 28-T31N-R10W with the Producing Area for the well to consist of a rectangle in the SW/4 equivalent of Section 28 that is not closer than 790' from the outer boundaries of the quarter section. Since the bottom portion of the wellbore is closer than 790' to the boundary of the quarter section, approval for the unorthodox location is required.

To aid in your review are:

- 1) a plat showing the well location, project area and producing area for the project well and the offset spacing units, their wells and operators;
- 2) a form C-102 showing surface and bottomhole locations of the well;
- 3) a direction survey for the wellbore.

Amoco is the only affected offset operator, therefore, no additional notice will be required.

Sincerely,

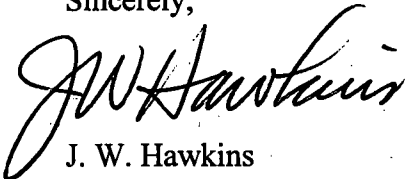
J. W. Hawkins

cc: Mike Kutas
Patty Haefe

Frank Chavez, Supervisor
NMOCD District III
1000 Rio Brazos Road
Aztec, NM 87410

13,399,673.12 FT. N
36° 53' 28" N

13,399,673.12 FT. N
36° 53' 28" N

992,075.92 FT. E
107° 51' 37" W

1,007,924.08 FT. E
107° 51' 37" W

992,071.45 FT. E
107° 51' 52" W

1,007,928.54 FT. E
107° 51' 37" W

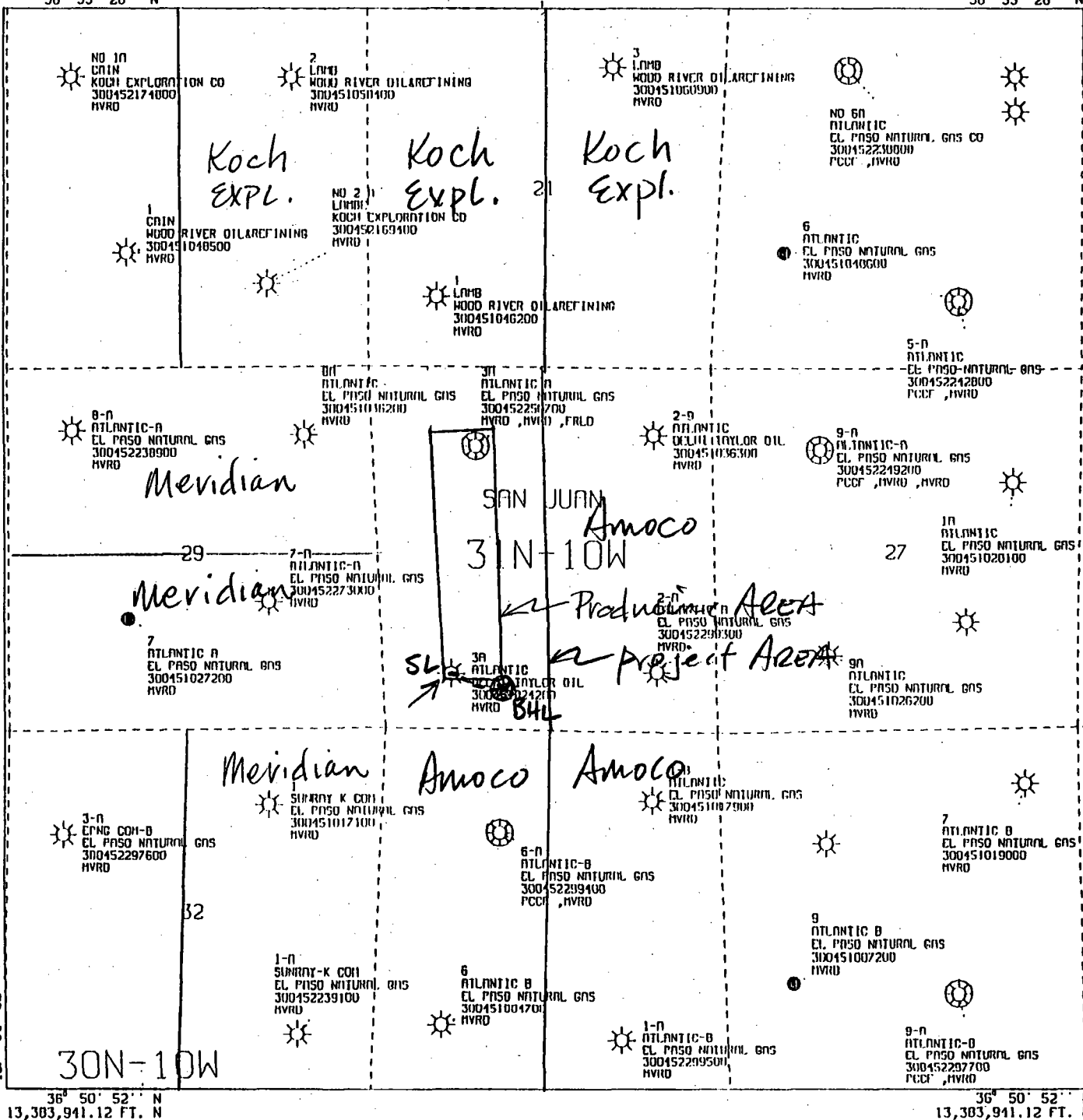

All geological and geophysical data, including the interpretation thereof, appearing on this map is the private and confidential property of Amoco Production Company. The publication or reproduction thereof without the written permission of said Company is strictly prohibited.

POLYCONIC CENTRAL MERIDIAN - 107° 53' 15" W LOW SPHEROID - 6

AMOCO PRODUCTION COMPANY
PLAT MAP
Atlantic A LS 3
Mesaverde
SCALE 1 IN. = 2,000 FT. FEB 7, 1996

HORIZONTAL DATUM NAD27

P. 007 124 - RUN 65099124217

District I
PO Box 1980, Hobbs, NM 88241-1980

District II
811 South First, Artesia, NM 88210

District III
1600 Rio Brazos Rd., Aztec, NM 87410

District IV
2040 South Pacheco, Santa Fe, NM 87505

State of New Mexico
Energy, Minerals & Natural Resources Department

OIL CONSERVATION DIVISION
2040 South Pacheco
Santa Fe, NM 87505

Form C-102

Revised October 18, 1994

Instructions on back

Submit to Appropriate District Office

State Lease - 4 Copies

Fee Lease - 3 Copies

☐ AMENDED REPORT

WELL LOCATION AND ACREAGE DEDICATION PLAT

API Number	Pool Code	Pool Name
30-045-10242	72319	Blanco Mesaverde
Property Code	Property Name	Well Number
000281	Atlantic A LS	3
OGRID No.	Operator Name	Elevation
000778	Amoco Production Company	

10 Surface Location

UL or lot no.	Section	Township	Range	Lot Idn	Feet from the	North/South line	Feet from the	East/West line	County
M	28	31N	10W		790	South	990	West	San Juan

11 Bottom Hole Location If Different From Surface

UL or lot no.	Section	Township	Range	Lot Idn	Feet from the	North/South line	Feet from the	East/West line	County
N	28	31N	10W		682	South	1534	West	San Juan

Dedicated Acres	Joint or Infill	Consolidation Code	Order No.
320			

NO ALLOWABLE WILL BE ASSIGNED TO THIS COMPLETION UNTIL ALL INTERESTS HAVE BEEN CONSOLIDATED
OR A NON-STANDARD UNIT HAS BEEN APPROVED BY THE DIVISION

16					17 OPERATOR CERTIFICATION
				I hereby certify that the information contained herein is true and complete to the best of my knowledge and belief	
				Signature <u>Patty Haefele</u>	
				Printed Name <u>Patty Haefele</u>	
				Title <u>Staff Assistant</u>	
				Date <u>5/17/96</u>	
				18 SURVEYOR CERTIFICATION	
				I hereby certify that the well location shown on this plat was plotted from field notes of actual surveys made by me or under my supervision, and that the same is true and correct to the best of my belief.	
				Date of Survey	
				Signature and Seal of Professional Surveyer:	
				on file	
				Certificate Number	

990' 1534' 790' 682' BHL

Atlantic A LS #3 - Sidetrack

Section 2, T31N, R10W

Calculated Survey Data

M. Depth	Angle	Azimuth	TVD	N/S	E/W	VSECT	DIST	DIR	DOG LEG
0	0	0	0	0	0	0	0	0	0
100	0.72	160.48	100	-0.59	0.21	0.32	1	160	0.7
200	0.36	148.65	199.99	-1.44	0.61	0.88	2	157	0.4
300	0.42	165.94	299.99	-2.07	0.88	1.26	2	157	0.1
400	0.31	162.53	399.99	-2.68	1.05	1.54	3	159	0.1
500	0.4	149.63	499.99	-3.25	1.3	1.9	3	158	0.1
600	0.32	161.54	599.98	-3.82	1.56	2.26	4	158	0.1
700	0.31	145.08	699.98	-4.3	1.8	2.59	5	157	0.1
800	0.29	145.21	799.98	-4.74	2.11	2.97	5	156	0
900	0.24	146.38	899.98	-5.12	2.37	3.3	6	155	0.1
1000	0.25	170.39	999.98	-5.53	2.53	3.54	6	155	0.1
1100	0.14	166.18	1099.98	-5.87	2.6	3.67	6	156	0.1
1200	0.31	168.2	1199.98	-6.25	2.69	3.83	7	157	0.2
1300	0.3	175.06	1299.98	-6.79	2.77	4.01	7	158	0
1400	0.25	173.33	1399.98	-7.27	2.81	4.15	8	159	0.1
1500	0.11	113.31	1499.98	-7.51	2.99	4.37	8	158	0.2
1600	0.15	91.17	1599.97	-7.55	3.21	4.59	8	157	0.1
1700	0.23	60.35	1699.97	-7.47	3.53	4.89	8	155	0.1
1800	0.05	198.13	1799.97	-7.59	3.67	5.06	8	154	0.3
1900	0.08	334.88	1899.97	-7.6	3.59	4.97	8	155	0.1
2000	0.18	280.27	1999.97	-7.46	3.41	4.77	8	155	0.1
2100	0.29	253.88	2099.97	-7.48	3.01	4.38	8	158	0.2
2200	0.32	239.04	2199.97	-7.7	2.52	3.94	8	162	0.1
2300	0.53	240.33	2299.97	-8.07	1.88	3.38	8	167	0.2
2400	0.34	261.51	2399.97	-8.32	1.16	2.73	8	172	0.2
2500	0.29	220.18	2499.96	-8.58	0.7	2.32	9	175	0.2
2600	0.19	172.52	2599.96	-8.97	0.58	2.28	9	176	0.2
2700	0.47	221.99	2699.96	-9.5	0.42	2.22	10	177	0.4
2800	0.63	229.92	2799.96	-10.17	-0.27	1.67	10	182	0.2
2900	0.75	237.05	2899.95	-10.89	-1.24	0.86	11	187	0.1
3000	0.5	214.15	2999.94	-11.64	-2.02	0.24	12	190	0.3
3100	0.63	240.94	3099.94	-12.3	-2.74	-0.34	13	193	0.3
3200	0.42	248.95	3199.93	-12.69	-3.56	-1.08	13	196	0.2
3300	0.56	243.53	3299.93	-13.04	-4.35	-1.78	14	198	0.1
3400	0.53	231.85	3399.93	-13.54	-5.14	-2.46	14	201	0.1
3450	4.54	102.2	3449.87	-15.26	-4.75	-1.75	16	197	9.8
3500	6.88	110.78	3499.62	-16.67	0.02	3.2	17	180	5
3550	8.7	128.19	3549.15	-20	5.9	9.6	21	164	5.9

				N/S	E/W	V-Sect	Dist	Dir	Dof/ky
3600	10.02	116.78	3598.49	-24.36	12.74	17.16	27	152	4.5
3650	10.42	105.26	3647.69	-27.53	21.01	25.88	35	143	4.2
3700	12.03	96.95	3696.73	-29.41	30.55	35.6	42	134	4.6
3750	13.25	98.67	3745.52	-30.89	41.39	46.53	52	127	2.6
3800	14.64	94.24	3794.05	-32.25	53.36	58.54	62	121	3.5
3844	15.61	98.78	3836.52	-33.55	64.77	69.98	73	117	3.5
* 4032	17.5	98.78	4016.72	-41.73	117.7	123.5	125	110	1
* 4186	18.25	98.78	4163.29	-48.94	164.42	170.74	172	107	0.5
* 4343	19	98.78	4312.06	-56.59	213.97	220.84	221	105	0.5
* 4497	20.75	98.78	4456.88	-64.59	265.71	273.15	273	104	1.1
* 4780	20	98.78	4722.18	-79.63	363.09	371.61	372	102	0.3
* 5089	16	98.78	5015.99	-94.2	457.43	467	467	102	1.3
* 5465	11	98.78	5381.49	-107.59	544.15	554.68	555	101	1.3

Note: * These surveys were Totco's where only inclination is measured. The last recorded azimuth is assumed for these surveys.

Surf. ~~790'~~ FSL = 682' FSL

990' FWL = 1534' FWL

790'	990'
108'	544'
<u>682'</u>	<u>1534'</u>

Atlantic A LS #3 - Sidetrack Section View
Vertical Section - 101 degrees

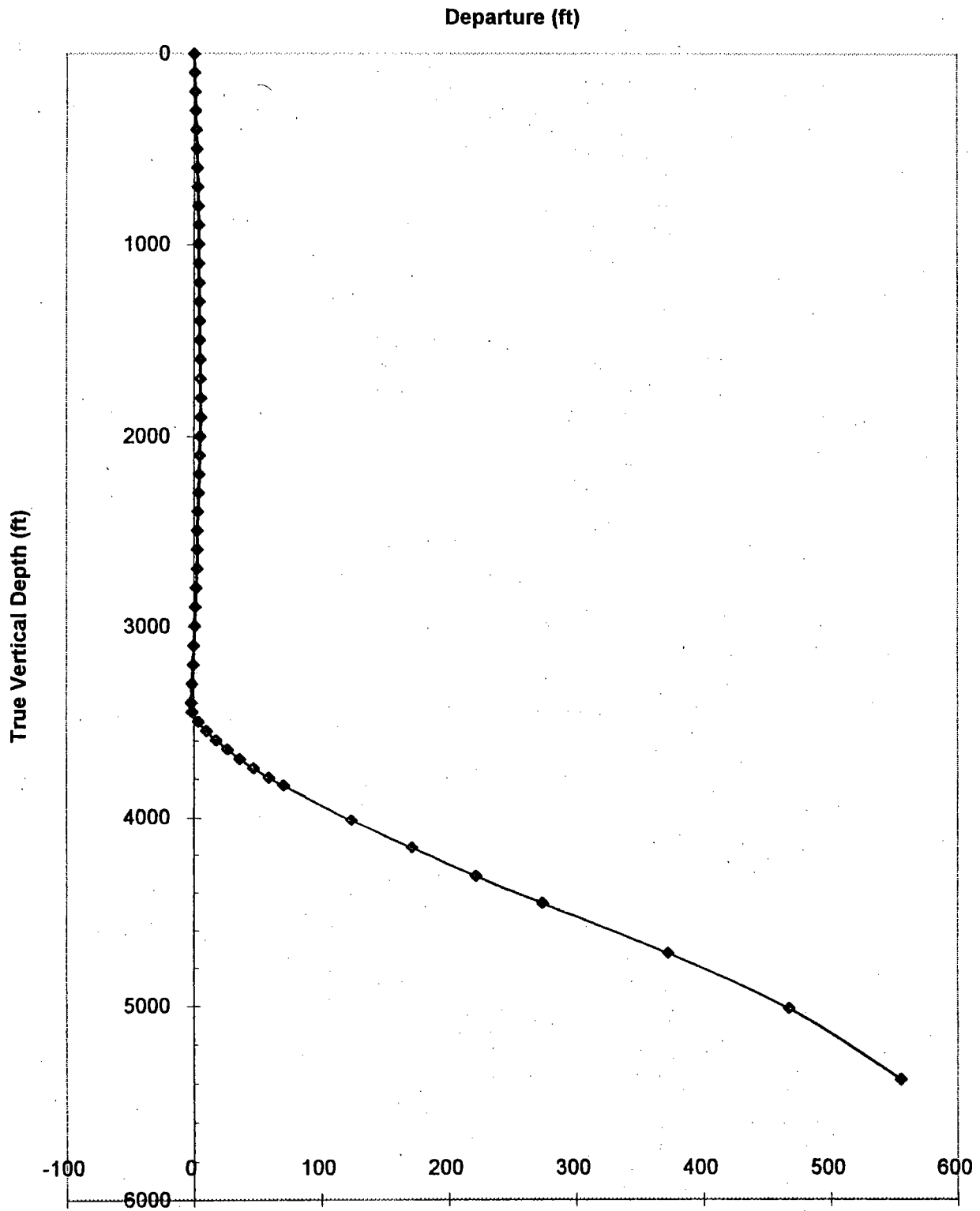

6/3/96

Atlantic A LS #3 - Sidetrack Plan View

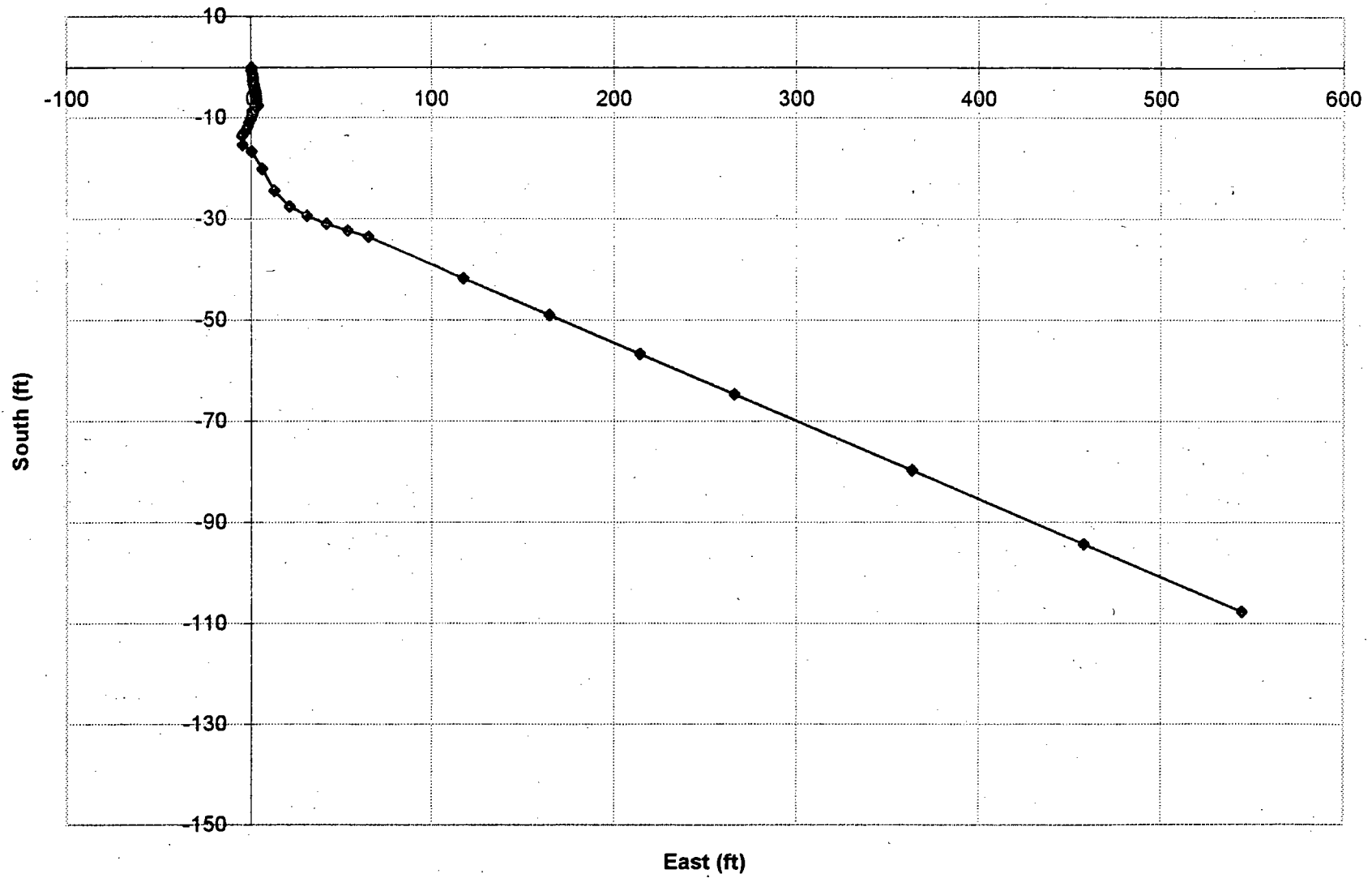

6/3/96



SEAPORT90

Begin New File

SEAPORT IMAGING

EnsignTM

Scanner Type: ALL

Function: Begin New File

This is used only with multi-image file formats.





February 7, 1996

Mr. William J. LeMay, Director
New Mexico Oil Conservation Division
2040 S. Pacheco Street
P.O. Box 6429
Santa Fe, NM 87505

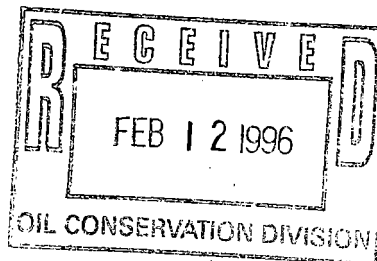
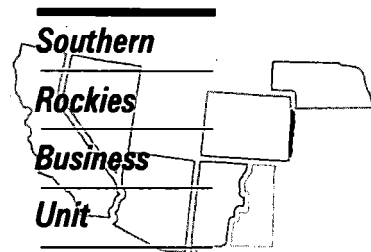

Application to Drill a Directional Well
Atlantic A LS #3 Well
790' FSL, 990' FWL, Section 28-T31N-R10W
Blanco Mesaverde Pool
San Juan County, New Mexico

Amoco Production Company hereby requests administrative approval to enter the existing wellbore in the Atlantic A LS #3 well referenced above and directionally drill the well in the Blanco Mesaverde Pool. The well is currently completed as a producing well in the Blanco Mesaverde Pool. Amoco believes that directionally drilling the well will help place the wellbore away from the original openhole completion and provide a better opportunity to encounter the naturally occurring fracture system in the Mesaverde formation which will increase the producing rate and ultimate recovery of gas for this well. We are requesting the Project Area for this well to be the Blanco Mesaverde gas proration unit consisting of W/2 Section 28, T31N-R10W with the Producing Area for the well to consist of a rectangle inside the gas proration unit that is not closer than 790' from the outer boundaries of the gas proration unit.

In accordance with Rule 111-D.(2), attached to aid in your review are:

- 1) a plat showing the well location, project area and producing area for the project well and the offset spacing units, their wells and operators;
- 2) a vertically oriented plan view for the project well showing top and bottom of the pool, degree of angle to be built, kickoff point, penetration point and lateral length;
- 3) a horizontal plan view for the project well showing the project area, producing area, estimated azimuth and maximum length of the lateral;
- 4) a type log section identifying the top and bottom of the pool.

As notification, a copy of this application will be sent by certified mail return receipt requested to the offset operators shown on the attached list advising them that if they have any objection, it must be filed in writing within twenty (20) days of the date notice was sent.

Sincerely,

J. W. Hawkins

cc: Mike Kutas
Patty Haefele

Frank Chavez, Supervisor
NMOCD District III
1000 Rio Brazos Road
Aztec, NM 87410

OFFSET OWNERS

Meridian Oil Inc.
Attn: Alan Alexander
PO Box 4289
Farmington NM 87499

Koch Exploration Co.
PO Box 2256
Wichita KS 67201

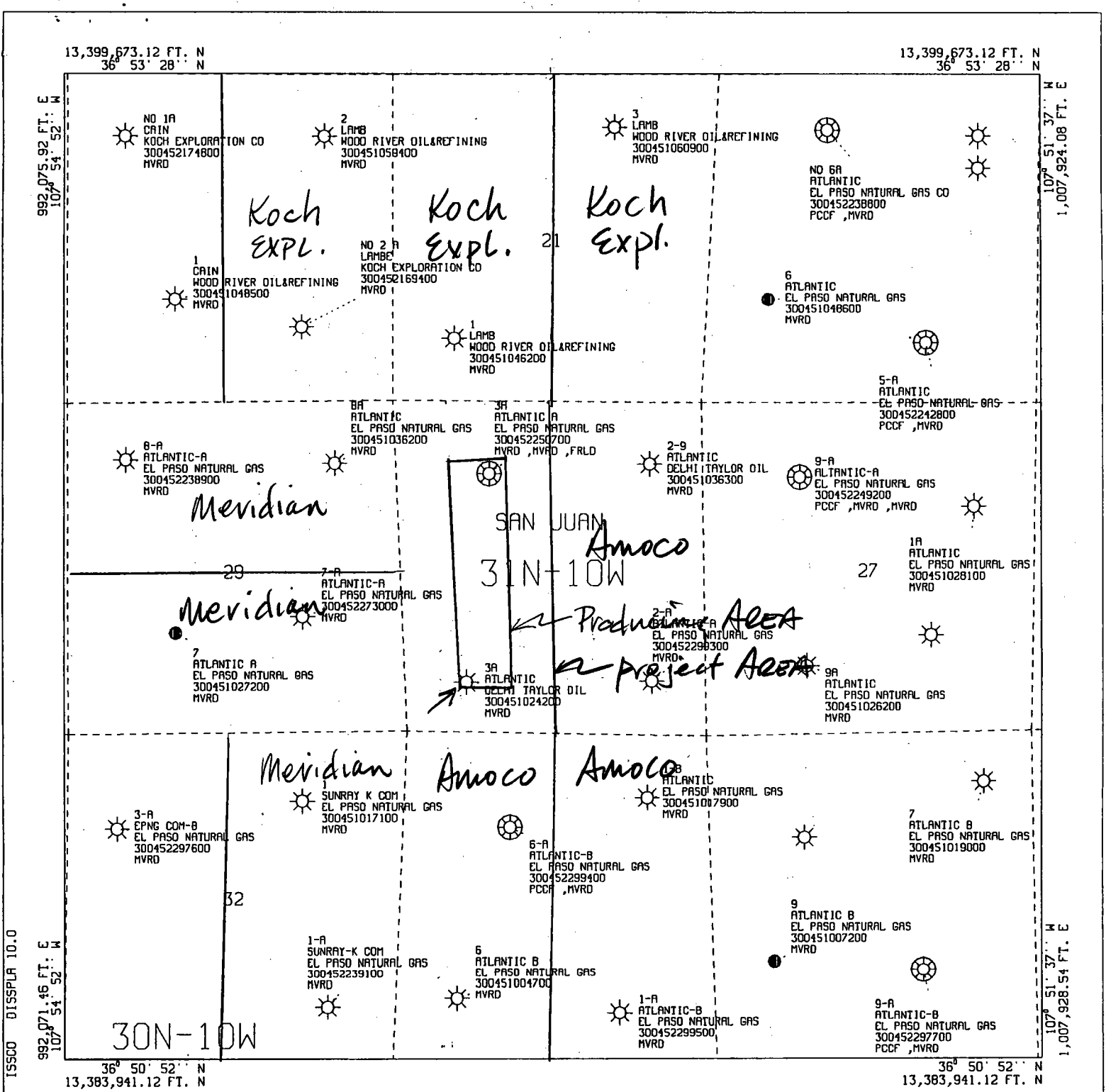

All geological and geophysical data, including the interpretation thereof, appearing on this map is the private and confidential property of Amoco Production Company. The publication or reproduction thereof without the written permission of said Company is strictly prohibited.

AMOCO PRODUCTION COMPANY
PLAT MAP
Atlantic A LS 3
Mesaverde
SCALE 1 IN. = 2,000 FT. FEB 7, 1996

POLYCONIC CENTRAL MERIDIAN - 107° 53' 15" W LONG
SPHEROID - 6

HORIZONTAL DATUM NAD27

JOB-P0743402, ISSCO DISPLA 10.0
12.57.39 WED 7 FEB, 1996
JOB-P0743402, ISSCO DISPLA 10.0

JHD7434--RUN#96038124217

lock 1001
Amoco Production Company
ENGINEERING CHART

Sheet No. _____ of _____

File _____

Appn _____

Date 02/05/56

By F. J. [Signature]

SUBJECT Atlantic A" LS #3
790' FSL, 990' FWL Sect 28, 31N, 10W
San Juan County, New Mexico

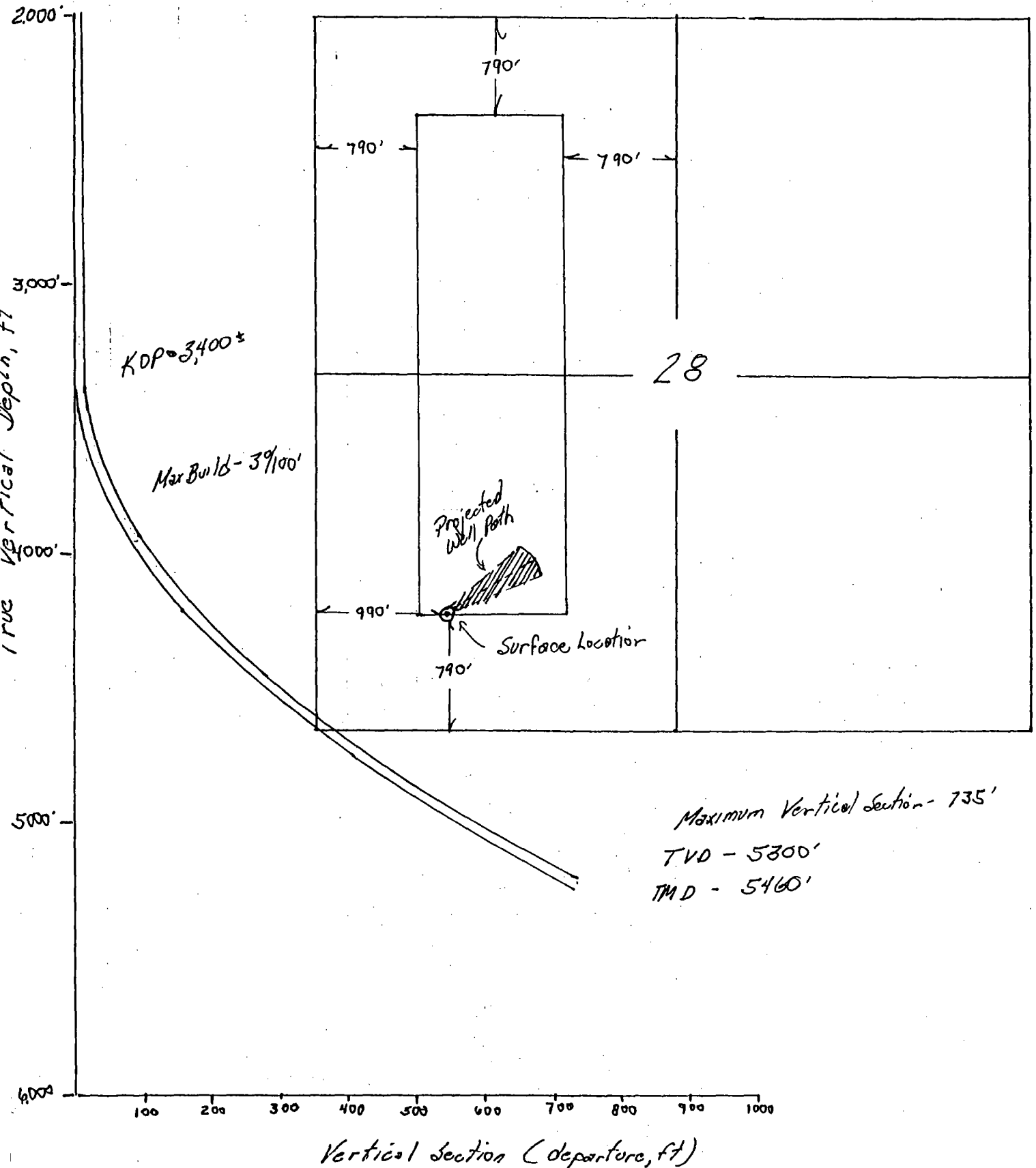

Atlantic A¹LS #3
790' FSL, 990' FNL
Section 28N, 31N, 10W
San Juan County, New Mexico

Core # Date
1001 6/2/01

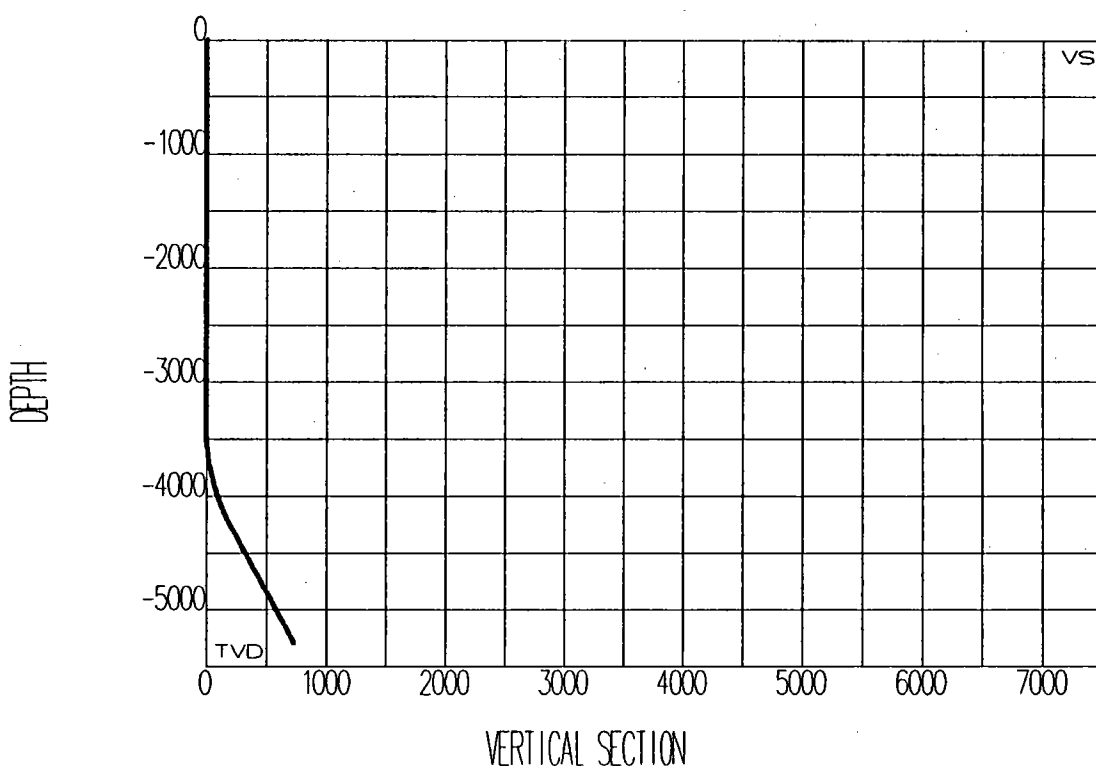

Units are FEET

Atlantic "A" LS¹⁰ 3
790' FSL, 990' FWL
Sect 28M, 31N, 10W
San Juan County, New Mexico

T	Meas.	Survey		Depth	North	East	Vert.	Closure		Dog
I	Depth	Incl	Dir	(TVD)	-South	-West	Section	Dist	Dir	Leg
	.00	.00	60.00	.00	.00	.00	.00	0	0	.0
	3400.00	.00	60.00	3400.00	.00	.00	.00	0	0	.0
	3500.00	3.00	60.00	3499.95	1.31	2.27	2.62	3	60	3.0
	3600.00	6.00	60.00	3599.63	5.23	9.06	10.46	10	60	3.0
	3700.00	9.00	60.00	3698.77	11.76	20.36	23.51	24	60	3.0
	3800.00	12.00	60.00	3797.08	20.87	36.14	41.74	42	60	3.0
	3900.00	15.00	60.00	3894.31	32.54	56.36	65.08	65	60	3.0
	4000.00	18.00	60.00	3990.18	46.74	80.95	93.48	93	60	3.0
	4100.00	21.00	60.00	4084.43	63.43	109.86	126.85	127	60	3.0
	4200.00	24.00	60.00	4176.81	82.56	142.99	165.12	165	60	3.0
	4300.00	27.00	60.00	4267.06	104.08	180.27	208.16	208	60	3.0
	4400.00	27.00	60.00	4356.16	126.78	219.59	253.56	254	60	.0
	4500.00	27.00	60.00	4445.26	149.48	258.91	298.96	299	60	.0
	4600.00	27.00	60.00	4534.36	172.18	298.22	344.36	344	60	.0
	4700.00	27.00	60.00	4623.46	194.88	337.54	389.76	390	60	.0
	4800.00	27.00	60.00	4712.56	217.58	376.86	435.16	435	60	.0
	4900.00	27.00	60.00	4801.66	240.28	416.17	480.56	481	60	.0
	5000.00	27.00	60.00	4890.76	262.98	455.49	525.96	526	60	.0
	5100.00	27.00	60.00	4979.86	285.68	494.81	571.35	571	60	.0
	5200.00	27.00	60.00	5068.96	308.38	534.12	616.75	617	60	.0
	5300.00	27.00	60.00	5158.06	331.08	573.44	662.15	662	60	.0
	5400.00	27.00	60.00	5247.16	353.78	612.76	707.55	708	60	.0
	5460.00	27.00	60.00	5300.62	367.40	636.35	734.79	735	60	.0

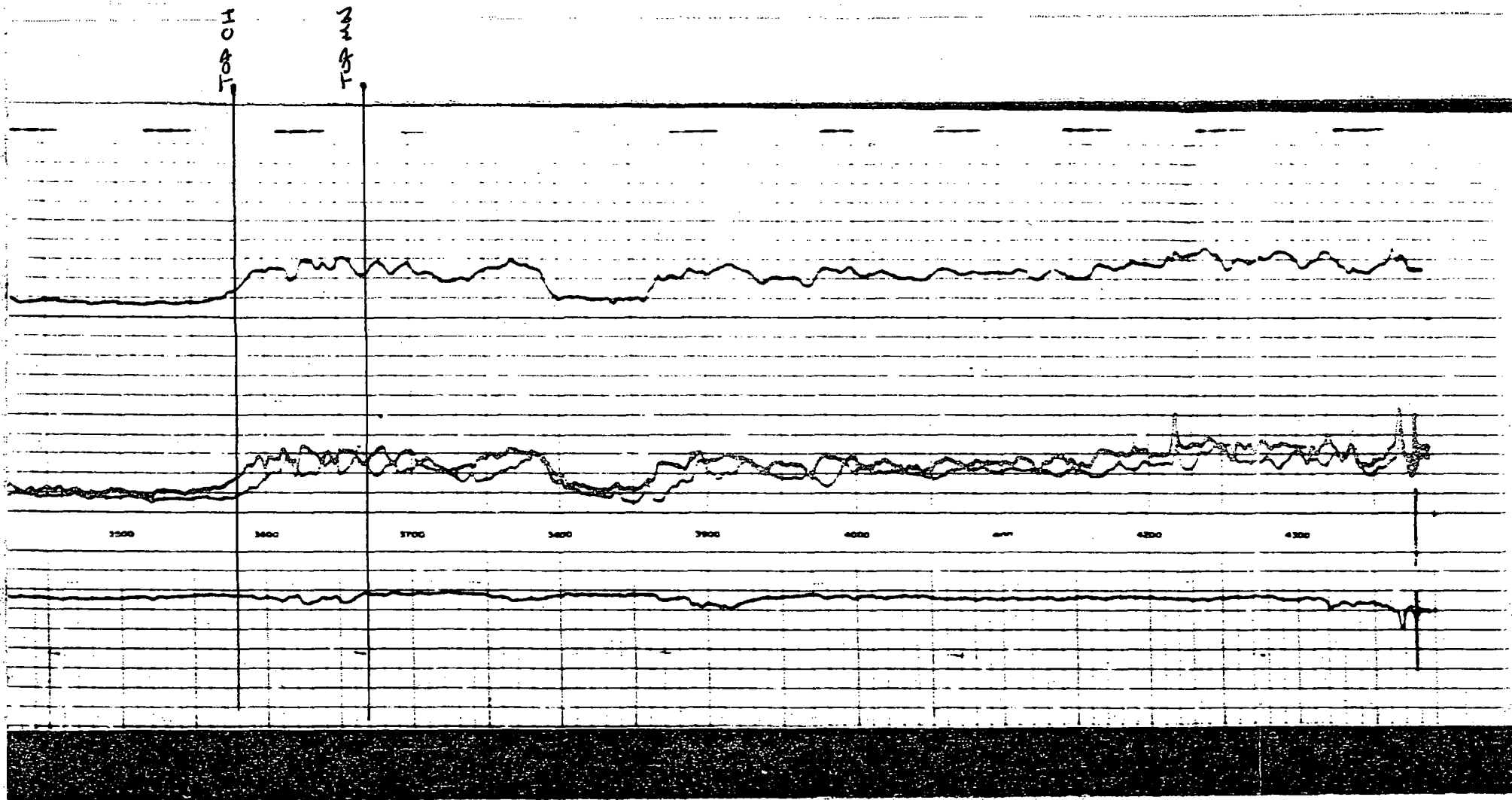

CMD :
OG5SECT

ONGARD
INQUIRE LAND BY SECTION

03/26/96 10:21:00
OGOMES -EMFB
PAGE NO: 1

Sec : 28 Twp : 31N Rng : 10W Section Type : NORMAL

4 40.28 Federal owned	3 40.91 Federal owned A	2 39.17 Federal owned	1 39.15 Federal owned A A A
5 39.73 Federal owned	6 40.36 Federal owned	7 37.79 Federal owned	8 37.77 Federal owned

PF01 HELP
PF07 BKWD

PF02
PF08 FWD

PF03 EXIT
PF09 PRINT

PF04 GoTo
PF10 SDIV

PF05
PF11

PF06
PF12

80.01

81.27
80.01

161.28
156.52

317.80

CMD :
OG5SECT

ONGARD
INQUIRE LAND BY SECTION

03/26/96 10:21:07
OGOMES -EMFB
PAGE NO: 2

Sec : 28 Twp : 31N Rng : 10W Section Type : NORMAL

12 39.50 Federal owned	11 39.22 Federal owned	10 36.56 Federal owned	9 36.30 Federal owned
13 39.04 Federal owned A A	14 38.76 Federal owned	15 37.69 Federal owned	16 37.43 Federal owned A

PF01 HELP
PF07 BKWD

PF02
PF08 FWD

PF03 EXIT
PF09 PRINT

PF04 GoTo
PF10 SDIV

PF05
PF11

PF06
PF12

78.54

77.98
78.54
<hr/>
156.52