



STATE OF NEW MEXICO
ENERGY, MINERALS AND NATURAL RESOURCES DEPARTMENT

OIL CONSERVATION DIVISION
2040 S. PACHECO
SANTA FE, NEW MEXICO 87505
(505) 827-7131

July 14, 1997

Phillips Petroleum Company
5525 Highway 64 - NBU 3004
Farmington, New Mexico 87401
Attention: Patrick H. Noah

Administrative Order DD-184

Dear Mr. Noah:

Reference is made to your application dated November 6, 1996 authorizing Phillips Petroleum Company's ("Phillips") recent recompletion of its San Juan "32-8" Unit Well No. 10 (API No. 30-045-10562) by side tracking off of the existing vertical wellbore and directionally drilling to a pre-determined bottomhole location in order to further develop the Blanco-Mesaverde Pool underlying the existing standard 320-acre, more or less, gas spacing and proration unit ("GPU") comprising the E/2 equivalent of Section 24, Township 31 North, Range 8 West, NMPM, San Juan County, New Mexico.

The Division Director Finds That:

- (1) By Order No. R-8170, as amended, the Division promulgated the "*General Rules For The Prorated Gas Pools of New Mexico/Special Rules and Regulations For The Blanco-Mesaverde Pool*", which includes provisions for 320-acre gas spacing and proration units ("GPU") and well location requirements whereby the initial well drilled on a GPU shall be located be no closer than 790 feet to the outer boundary of the quarter section on which the well is located and not closer than 130 feet to any quarter-quarter section line or subdivision inner boundary and the infill well drilled on an existing GPU shall be in the quarter section not containing a Mesaverde gas well and shall be located with respect to the restrictions as previously described;
- (2) The San Juan "32-8" Unit Well No. 10, located at a standard surface gas well location 1800 feet from the North line and 952 feet from the East line (Unit H) of said Section 24, was originally drilled to and completed in the Blanco-Mesaverde Pool in 1955;
- (3) This application has been duly filed by Phillips under the provisions **Rules 111.D and E** of the General Rules and Regulations of the New Mexico Oil Conservation Division ("Division"), revised by Division Order No. R-10388, issued by the New Mexico Oil Conservation Commission in Case 11,274 on June 13, 1995;
- (4) As indicated by the directional survey, dated October 21, 1996, on file with the Division, the actual bottomhole location for this well within the Blanco-Mesaverde is now 1587 feet from the North line and 1172 feet from the East line (Unit H) of said Section 24; and,

- (5) It appearing the applicant has satisfied all of the appropriate requirements prescribed in said Rule 111.D and E, the subject application should be approved.

IT IS THEREFORE ORDERED THAT:

(1) The recompletion by Phillips Petroleum Company of its San Juan "32-8" Unit Well No. 10 (API No. 30-045-10562), located at a standard surface gas well location 1800 feet from the North line and 952 feet from the East line (Unit H) of Section 24, Township 31 North, Range 8 West, NMPM, San Juan County, New Mexico, by side tracking off of the existing vertical wellbore and directionally drilling to its present standard bottomhole gas well location within the Blanco-Mesaverde Pool 1587 feet from the North line and 1172 feet from the East line (Unit H) of said Section 24, is hereby approved.

(2) The existing 320-acre, more or less, standard gas spacing and proration unit ("GPU") comprising the E/2 equivalent of said Section 24 shall be dedicated to said well.

(3) Jurisdiction of this cause is retained for the entry of such further orders as the Division may deem necessary.

DONE at Santa Fe, New Mexico, on the day and year hereinabove designated.

STATE OF NEW MEXICO
OIL CONSERVATION DIVISION

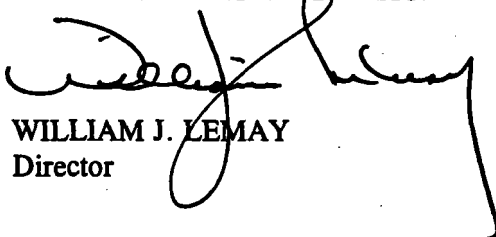
WILLIAM J. LEMAY
Director

S E A L

WJL/MES/kv

cc: Oil Conservation Division - Aztec
U. S. Bureau of Land Management - Farmington

Phillips - 4

8
Rec: 11-12-96
SOS: 12-2-96

Released: 7-14-97

July 14, 1997

**Phillips Petroleum Company
5525 Highway 64 - NBU 3004
Farmington, New Mexico 87401**

Attention: Patrick H. Noah

184
Administrative Order DD-*****

Dear Mr. Noah:

Reference is made to your application dated November 6, 1996 authorizing Phillips Petroleum Company's ("Phillips") recent recompletion of its San Juan "32-8" Unit Well No. 10 (API No. 30-045-10562) by side tracking off of the existing vertical wellbore and directionally drilling to a pre-determined bottomhole location in order to further develop the Blanco-Mesaverde Pool underlying the existing standard 320-acre, more or less, gas spacing and proration unit ("GPU") comprising the E/2 equivalent of Section 24, Township 31 North, Range 8 West, NMPM, San Juan County, New Mexico.

The Division Director Finds That:

- (1) By Order No. R-8170, as amended, the Division promulgated the "*General Rules For The Prorated Gas Pools of New Mexico/Special Rules and Regulations For The Blanco-Mesaverde Pool*", which includes provisions for 320-acre gas spacing and proration units ("GPU") and well location requirements whereby the initial well drilled on a GPU shall be located be no closer than 790 feet to the outer boundary of the quarter section on which the well is located and not closer than 130 feet to any quarter-quarter section line or subdivision inner boundary and the infill well drilled on an existing GPU shall be in the quarter section not containing a Mesaverde gas well and shall be located with respect to the restrictions as previously described;
- (2) The San Juan "32-8" Unit Well No. 10, located at a standard surface gas well location 1800 feet from the North line and 952 feet from the East line (Unit H) of said Section 24, was originally drilled to and completed in the Blanco-Mesaverde Pool in 1955;
- (3) This application has been duly filed by Phillips under the provisions **Rules 111.D and E** of the General Rules and Regulations of the New Mexico Oil Conservation Division ("Division"), revised by Division Order No. R-10388, issued by the

New Mexico Oil Conservation Commission in Case 11,274 on June 13, 1995;

- (4) As indicated by the directional survey, dated October 21, 1996, on file with the Division, the actual bottomhole location for this well within the Blanco-Mesaverde is now 1587 feet from the North line and 1172 feet from the East line (Unit H) of said Section 24; and,
- (5) It appearing the applicant has satisfied all of the appropriate requirements prescribed in said Rule 111.D and E, the subject application should be approved.

IT IS THEREFORE ORDERED THAT:

(1) The recompletion by Phillips Petroleum Company of its San Juan "32-8" Unit Well No. 10 (API No. 30-045-10562), located at a standard surface gas well location 1800 feet from the North line and 952 feet from the East line (Unit H) of Section 24, Township 31 North, Range 8 West, NMPM, San Juan County, New Mexico, by side tracking off of the existing vertical wellbore and directionally drilling to its present standard bottomhole gas well location within the Blanco-Mesaverde Pool 1587 feet from the North line and 1172 feet from the East line (Unit H) of said Section 24, is hereby approved.

(2) The existing 320-acre, more or less, standard gas spacing and proration unit ("GPU") comprising the E/2 equivalent of said Section 24 shall be dedicated to said well.

(3) Jurisdiction of this cause is retained for the entry of such further orders as the Division may deem necessary.

DONE at Santa Fe, New Mexico, on the day and year hereinabove designated.

STATE OF NEW MEXICO
OIL CONSERVATION DIVISION

WILLIAM J. LEMAY
Director

S E A L

WJL/MES/kv

cc: Oil Conservation Division - Aztec
U. S. Bureau of Land Management - Farmington



PHILLIPS PETROLEUM COMPANY

FARMINGTON, NEW MEXICO 87401
5525 HWY. 64 NBU 3004

OIL CONSERVATION DIVISION
RECEIVED

NOV 8 1996

November 6, 1996

State of New Mexico
Oil Conservation Division
204 South Pacheco
Santa Fe, New Mexico 87505

ATTN: MR. WILLIAM J. LEMAY

**RE: ADMINISTRATIVE APPROVAL OF INTENTIONAL WELL DEVIATION
SAN JUAN 32-8 UNIT #10 WELL,
NE/4 SECTION 24-T31N-R8W,
SAN JUAN COUNTY, NEW MEXICO
PHILLIPS' G.F.-5465, LCN 650117**

Gentlemen:

Phillips Petroleum Company ("Phillips"), as Operator of the San Juan 32-8 Unit, requests administrative approval of the intentional deviation of the above-described well.

The San Juan 32-8 Unit #10 Well was originally drilled in 1955 and completed as a Blanco Mesaverde Pool well. Enclosed is a copy of the original plat for this well which indicates the original location of 1800' FNL and 952' FEL.

Phillips has abandoned the existing Blanco Mesaverde interval in this well, sidetracked and completed in the Blanco Mesaverde at a bottom-hole location of 1587' FNL and 1172' FEL, Section 24-T31N-R8W. Enclosed are three copies of a new well location and acreage dedication plat and sub-surface directional survey confirming the well's bottom-hole location.

A copy of this notice has been furnished to Devon Energy Corp, the offsetting Blanco Mesaverde Pool operator.

Please advise if additional information is required.

Very truly yours,

Patrick H. Noah

Patrick H. Noah
Senior Land Specialist
San Juan Basin
(505) 599-3410

cc: J.L. Mathis (r) G.F. 5465
Ernie Busch-OCD, Aztec

Case 446

1-4. P. Johnston
1-4. G. Hickey

NEW MEXICO OIL CONSERVATION COMMISSION
SANTA FE, NEW MEXICO

(File the original and 4 copies with the appropriate district office)

CERTIFICATE OF COMPLIANCE AND AUTHORIZATION
TO TRANSPORT OIL AND NATURAL GAS

Company or Operator PACIFIC NORTHWEST PIPELINE CORP. Lease San Juan 12-8

Well No. 10-24 Unit Letter N S 24 T 118 R 21 Pool Flamingo

County San Juan Kind of Lease (State, Fed. or Patented) State

If well produces oil or condensate, give location of tanks: Unit S T R

Authorized Transporter of Oil or Condensate El Paso Natural Gas Co. Malet

Address Farmington, New Mexico

(Give address to which approved copy of this form is to be sent)

Authorized Transporter of Gas El Paso Natural Gas Co.

Address Farmington, New Mexico

(Give address to which approved copy of this form is to be sent)

If Gas is not being sold, give reasons and also explain its present disposition:

Reasons for Filing: (Please check proper box) New Well (X)

Change in Transporter of (Check One): Oil () Dry Gas () C'head () Condensate ()

Change in Ownership (X) Other ()

Remarks: (Give explanation below)

Drilled by El Paso Natural Gas Co., admitted to San Juan 12-8 Unit November 8, 1955.
Pacific Northwest assumed operations November 8, 1955.

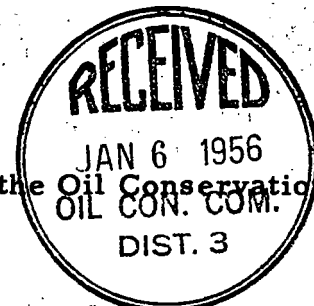

The undersigned certifies that the Rules and Regulations of the Oil Conservation Commission have been complied with.

Executed this the 20th day of December 19 55

By Original signed by T. A. Dugan

Approved 1-6 19 56

Title District Engineer

OIL CONSERVATION COMMISSION

Company PACIFIC NORTHWEST PIPELINE CORP.

By Ernest T. Hickey

Address 411 1/2 West Main Street

Title Oil and Gas Inspector Dist. #3.

Farmington, New Mexico

COMPANY EL PASO NATURAL GAS COMPANY

Well Name & No. SAN JUAN 32-8 UNIT # 10-24 Lease No. SF-079-351

Location 1800 FEET FROM THE NORTH LINE AND 952 FEET FROM THE EAST LINE.

Being in NW-SE-NE

Sec. 24, T 31 N., R 8 W., N.M.P.M., SAN JUAN CO.

Ground Elevation 6491.00 UNGRADED GROUND

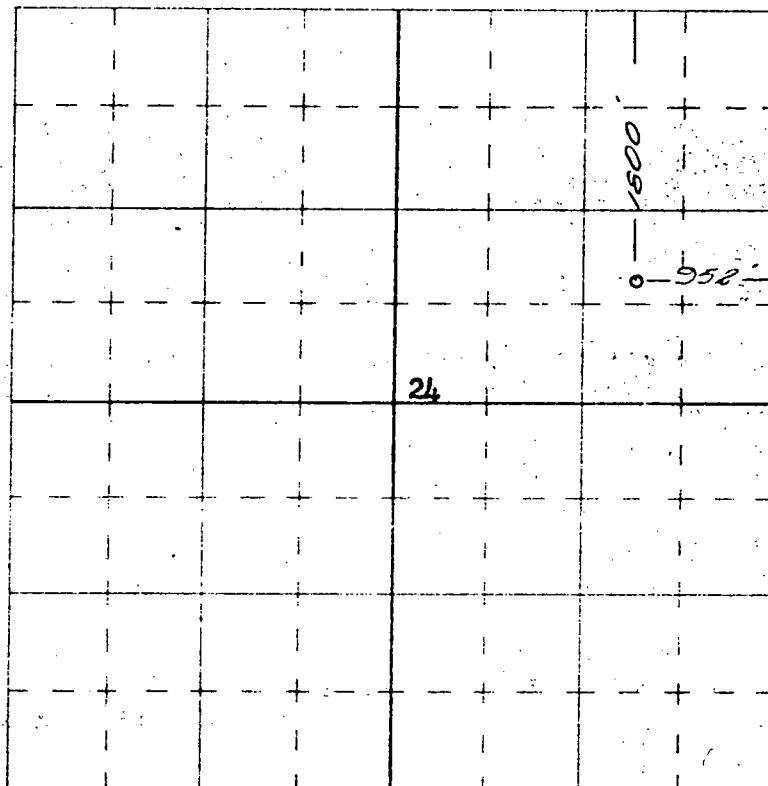

Scale -- 4 inches equals 1 mile

Surveyed JUNE 22, 1955

This is to certify that the above plat was prepared from field notes of actual surveys made by me or under my supervision and that the same are true and correct to the best of my knowledge and belief.

Seal:

Farmington, New Mexico

RECEIVED
JUL 5 1955
U. S. GEOLOGICAL SURVEY
FARMINGTON, NEW MEXICO

James P. Leese
JAMES P. LEESE
N. MEX. REG. NO. 1463
REG. LAND SURVEYOR

320 ACRES, E/2 SECTION (PLAT)

District I
PO Box 1980, Hobbs, NM 88241-1980
District II
811 South First, Artesia, NM 88210
District III
1000 Rio Brazos Rd., Aztec, NM 87410
District IV
2040 South Pacheco, Santa Fe, NM 87505

State of New Mexico
Energy, Minerals & Natural Resources Department

OIL CONSERVATION DIVISION
2040 South Pacheco
Santa Fe, NM 87505

Form C-102
Revised October 18, 1994
Instructions on back
Submit to Appropriate District Office
State Lease - 4 Copies
Fee Lease - 3 Copies

☐ AMENDED REPORT

WELL LOCATION AND ACREAGE DEDICATION PLAT

¹ API Number 30-045-10562	² Pool Code 72319	³ Pool Name Blanco Mesaverde
⁴ Property Code 009261	⁵ Property Name San Juan 32-8 Unit	⁶ Well Number #10
⁷ OGRID No. 017654	⁸ Operator Name Phillips Petroleum Company	⁹ Elevation 6501

¹⁰ Surface Location

UL or lot no. H	Section 24	Township 31N	Range 8W	Lot Idn	Feet from the 1800	North/South line North	Feet from the 952	East/West line East	County San Juan
--------------------	---------------	-----------------	-------------	---------	-----------------------	---------------------------	----------------------	------------------------	--------------------

¹¹ Bottom Hole Location If Different From Surface

UL or lot no. H	Section 24	Township 31N	Range 8W	Lot Idn	Feet from the 1587	North/South line North	Feet from the 1172	East/West line East	County San Juan
--------------------	---------------	-----------------	-------------	---------	-----------------------	---------------------------	-----------------------	------------------------	--------------------

¹² Dedicated Acres 320 ac	¹³ Joint or Infill N	¹⁴ Consolidation Code U	¹⁵ Order No.
---	------------------------------------	---------------------------------------	-------------------------

NO ALLOWABLE WILL BE ASSIGNED TO THIS COMPLETION UNTIL ALL INTERESTS HAVE BEEN CONSOLIDATED
OR A NON-STANDARD UNIT HAS BEEN APPROVED BY THE DIVISION

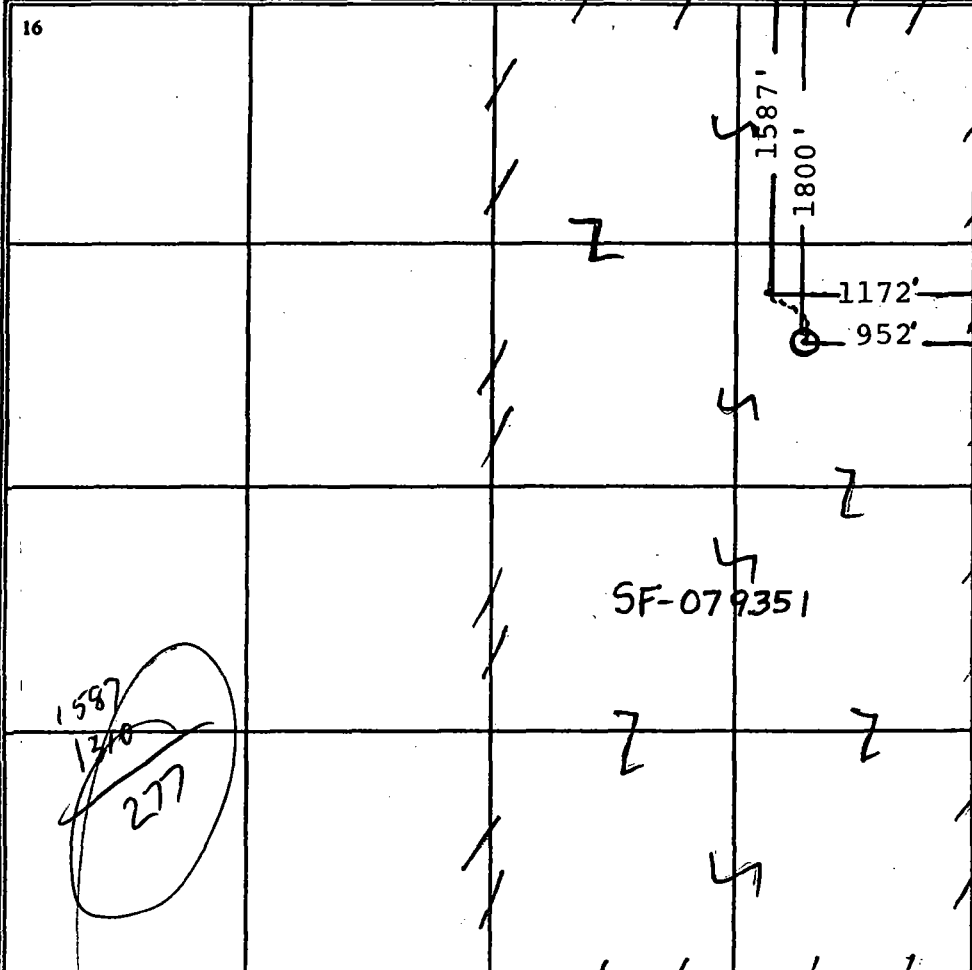
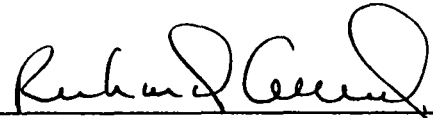
<div>16</div> 	<div>17 OPERATOR CERTIFICATION</div> <p>I hereby certify that the information contained herein is true and complete to the best of my knowledge and belief</p> <p> Signature Richard A. Allred Printed Name Production Superintendent Title 11-4-96 Date</p> <div>18 SURVEYOR CERTIFICATION</div> <p>I hereby certify that the well location shown on this plat was plotted from field notes of actual surveys made by me or under my supervision, and that the same is true and correct to the best of my belief.</p> <p>Date of Survey Signature and Seal of Professional Surveyer: Certificate Number</p>
---	---

**New Mexico Oil Conservation Division
C-102 Instructions**

IF THIS IS AN AMENDED REPORT, CHECK THE BOX LABELED "AMENDED REPORT" AT THE TOP OF THIS DOCUMENT.

Surveyors shall use the latest United States government survey or dependent resurvey. Well locations will be in reference to the New Mexico Principal Meridian. If the land is not surveyed contact the appropriate OCD district office. Independent subdivision surveys will not be acceptable.

(Note: A legal location is determined from the perpendicular distance to the edge of the tract.) If this is a high angle or horizontal hole show that portion of the well bore that is open within this pool.

Show all lots, lot numbers, and their respective acreage.

If more than one lease has been dedicated to this completion, outline each one and identify the ownership as to both working interest and royalty.

1. The OCD assigned API number for this well
2. The pool code for this (proposed) completion
3. The pool name for this (proposed) completion
4. The property code for this (proposed) completion
5. The property name (well name) for this (proposed) completion
6. The well number for this (proposed) completion
7. Operator's OGRID number
8. The operator's name
9. The ground level elevation of this well
10. The surveyed surface location of this well measured from the section lines **NOTE: If the United States government survey designates a Lot Number for this location use that number in the "UL or lot no." box. Otherwise use the OCD unit letter.**
11. Proposed bottom hole location. If this is a horizontal hole indicate the location of the end of the hole.
12. The calculated acreage dedicated to this completion to the nearest hundredth of an acre
13. Put a Y if more than one completion will be sharing this same acreage or N if this is the only completion on this acreage
14. If more than one lease of different ownership has been dedicated to the well show the consolidation code from the following table:

C	Communitization
U	Unitization
F	Forced pooling
O	Other
P	Consolidation pending
17. The signature, printed name, and title of the person authorized to make this report, and the date this document was signed.
18. The registered surveyors certification. This section does not have to be completed if this form has been previously accepted by the OCD and is being filed for a change of pool or dedicated acreage.

NO ALLOWABLE WILL BE ASSIGNED TO THIS COMPLETION UNTIL ALL INTERESTS HAVE BEEN CONSOLIDATED OR A NON-STANDARD UNIT HAS BEEN APPROVED BY THE DIVISION!

15. Write in the OCD order(s) approving a non-standard location, non-standard spacing, or directional or horizontal drilling
16. This grid represents a standard section. You may superimpose a non-standard section over this grid. Outline the dedicated acreage and the separate leases within that dedicated acreage. Show the well surface location and bottom hole location, if it is directionally drilled, with the dimensions from the section lines in the cardinal directions.



1700 Broadway Suite 1450 Denver Colorado 80290
(303) 860-0509 Fax (303) 830-2546

REPORT OF SUB-SURFACE DIRECTIONAL SURVEY

Phillips Petroleum
COMPANY

San Juan Unit 32-8 #10
WELL NAME

San Juan County, New Mexico
LOCATION

JOB NUMBER
410-80536

TYPE OF SURVEY
MSS

DATE
October 21, 1996

SURVEYED BY
Max Lund

OFFICE
DENVER



1700 Broadway Suite 1450 Denver Colorado 80290
(303) 860-0509 Fax (303) 830-2546

SURVEY CERTIFICATION SHEET

Phillips Petroleum

Company

Sec-24-T31N-R8W

Lease

410-80536

Job #

San Juan Unit 32-8 #10

Well #

October 21, 1996

Date

San Juan County, New Mexico

County and State

Surveyed from a depth of 3,900 feet to 4,358 feet MD

Type of Survey MSS

Directional Supervisor/Surveyor Max Lund

The data and calculations for this survey have been checked by me and conform to the standards and procedures set forth by Baker Hughes INTEQ. This report represents a true and correct Directional Survey of this well based on the original data obtained at the well site. Wellbore Coordinates are calculated using minimum curvature.

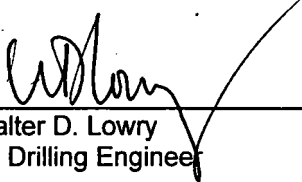
Walter D. Lowry
Sr. Drilling Engineer

This document has been subscribed and affirmed, or sworn to before me in the county of Denver, state of Colorado, this 24th day of October, 1996.

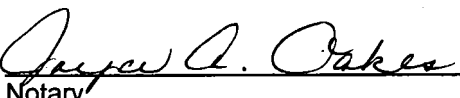
Notary My commission expires August 4, 2000

Certification Number: 432
Certification Date: October 23, 1996

Field : SAN JUAN COUNTY Location : NEW MEXICO

Tie on - 0.00 Inc, 0.00 Md, 0.00 Tvd, 0.00 Vs

<- West (feet)

<- North (feet)

Total Depth
1587.1' FNL & 1172.4' FEL
of Sec.24

Projection to T.D.

FINAL SURVEY

LAST BHI SURVEY

CLIFF HOUSE - 5312.00 Tvd, 124.41 N, 215.49 W

LEWIS - 3490.00 Tvd, 0.00 S, 0.00 W

FRUITLAND - 0.00 Inc, 2975.00 Md, 2975.00 Tvd, 0.00 Vs

PICTURED CLIFFS - 0.00 Inc, 3408.00 Md, 3408.00 Tvd, 0.00 Vs

Kick off Point - 0.00 Inc, 4000.00 Md, 4000.00 Tvd, 0.00 Vs

DLS: 5.00 deg per 100 ft

Last BHI Survey

End of Build - 20.00 Inc, 4400.00 Md, 4391.93 Tvd, 69.11 Vs

End of Hold - 20.00 Inc, 4423.76 Md, 4414.25 Tvd, 77.23 Vs

DLS: 2.00 deg per 100 ft

CLIFF HOUSE - 1.64 Inc, 5341.68 Md, 5312.00 Tvd, 248.82 Vs

Target - 0.00 Inc, 5423.76 Md, 5394.06 Tvd, 250.00 Vs

POINT LOOKOUT - 0.00 Inc, 5702.69 Md, 5673.00 Tvd, 250.00 Vs

Projection to T.D.

FINAL SURVEY

Azimuth 300.00 with reference 0.00 N, 0.00 E from SLOT #1

--- WELL PROFILE DATA ---

Point	MD	Inc	Dir	TVD	North	East	V. Sect	Deg/100
Tie on	0.00	0.00	300.00	0.00	0.00	0.00	0.00	0.00
KOP	4000.00	0.00	300.00	4000.00	0.00	0.00	0.00	0.00
End of Build	4400.00	20.00	300.00	4391.93	34.55	-59.85	69.11	5.00
End of Hold	4423.76	20.00	300.00	4414.25	38.62	-66.88	77.23	0.00
Target	5423.76	0.00	300.00	5394.06	125.00	-216.51	250.00	2.00
T.D. & End of Hold	5864.69	0.00	300.00	5835.00	125.00	-216.51	250.00	0.00

N
TRUE
Mag
E
W

16-Aug-96

Magnetic North is 11.57 degrees East of TRUE North
To correct azimuth from Magnetic to TRUE add 11.57 deg

-- Baker Hughes INTEQ --
DRAWN BY: WALLY HOLBROOK
DATE: OCT. 23, 1996
TVD REFERENCED RKB
DENVER, COLORADO
PHONE: (303) 860-0509

PHILLIPS PETROLEUM
SEC.24-T31N-R8W

SAN JUAN UNIT 32-8 #10
SLOT #1
SAN JUAN COUNTY
NEW MEXICO

S U R V E Y L I S T I N G

by
Baker Hughes INTEQ

Your ref : Single Shot Survey
Our ref : svy3760
License :

Date printed : 23-Oct-96
Date created : 21-Oct-96
Last revised : 23-Oct-96

Field is centred on n36 50 0.000,w107 30 0
Structure is centred on n36 53 13.005,w107 36 45.004

Slot location is n36 52 55.207,w107 36 56.721
Slot Grid coordinates are N 2140384.186, E 563634.003
Slot local coordinates are 1800.00 S 952.00 W

Projection type: mercator - New Mexico West (3003), Spheroid: Clarke - 1866

Reference North is True North

PHILLIPS PETROLEUM
SEC.24-T31N-R8W,SAN JUAN UNIT 32-8 #10
SAN JUAN COUNTY,NEW MEXICO

SURVEY LISTING Page 1
Your ref : Single Shot Survey
Last revised : 23-Oct-96

Measured Depth	Inclin. Degrees	Azimuth Degrees	True Vert Depth	R E C T A N G U L A R C O O R D I N A T E S		Dogleg Deg/100ft	Vert Sect	
0.00	0.00	0.00	0.00	0.00 N	0.00 E	0.00	0.00	
3900.00	0.00	0.00	3900.00	0.00 N	0.00 E	0.00	0.00	
3987.00	3.13	321.40	3986.96	1.86 N	1.48 W	3.60	2.21	
4049.00	8.78	323.70	4048.60	7.00 N	5.34 W	9.12	8.13	
4079.00	10.75	326.60	4078.16	11.18 N	8.24 W	6.77	12.72	
4141.00	14.75	326.50	4138.62	22.59 N	15.78 W	6.45	24.96	
4173.00	17.50	325.50	4169.36	29.96 N	20.76 W	8.64	32.95	
4204.00	20.00	325.50	4198.71	38.17 N	26.40 W	8.06	41.95	
4267.00	21.50	314.50	4257.65	55.15 N	40.74 W	6.62	62.86	
4358.00	20.00	300.50	4342.79	74.75 N	66.06 W	5.68	94.58	Last BHI Survey
4498.00	17.50	298.50	4475.35	96.94 N	105.20 W	1.84	139.57	
4623.00	15.50	303.50	4595.21	115.13 N	135.64 W	1.96	175.04	
4931.00	7.25	317.50	4896.95	152.25 N	183.18 W	2.81	234.76	
5238.00	4.75	324.60	5202.24	176.89 N	203.64 W	0.85	264.80	
5517.00	3.00	340.00	5480.60	193.17 N	212.83 W	0.72	280.90	
5885.00	3.50	338.40	5848.01	212.67 N	220.26 W	0.14	297.08	Projection to T.D. is
5890.00	3.50	338.40	5853.00	212.95 N	220.37 W	0.00	297.32	1587.1' FNL & 1172.4' FEL

All data is in feet unless otherwise stated.
Coordinates from SLOT #1 and TVD from RKB (6501.00 Ft above mean sea level).
Bottom hole distance is 306.45 on azimuth 314.02 degrees from wellhead.
Vertical section is from wellhead on azimuth 300.00 degrees.
Calculation uses the minimum curvature method.
Presented by Baker Hughes INTEQ

PHILLIPS PETROLEUM
 SEC.24-T31N-R8W,SAN JUAN UNIT 32-8 #10
 SAN JUAN COUNTY,NEW MEXICO

SURVEY LISTING Page 2
 Your ref : Single Shot Survey
 Last revised : 23-Oct-96

				Comments in wellpath
				=====
MD	TVD	Rectangular Coords.		Comment

4358.00	4342.79	74.75 N	66.06 W	Last BHI Survey
5885.00	5848.01	212.67 N	220.26 W	Projection to T.D. is
5890.00	5853.00	212.95 N	220.37 W	1587.1' FNL & 1172.4' FEL

Targets associated with this wellpath				
=====				
Target name	Geographic Location	T.V.D.	Rectangular Coordinates	Revised

TGT 32-8 #10		5312.00	125.00N 216.51W	16-Aug-96

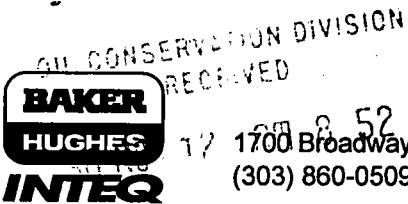

17 288 52 1700 Broadway Suite 1450 Denver Colorado 80290
(303) 860-0509 Fax (303) 830-2546

REPORT OF SUB-SURFACE DIRECTIONAL SURVEY

RECEIVED
NOV - 5 1996
OIL CON. DIV.
DIST. 3

Phillips Petroleum
COMPANY

San Juan Unit 32-8 #10
WELL NAME

San Juan County, New Mexico
LOCATION

JOB NUMBER
410-80536

TYPE OF SURVEY
MSS

DATE
October 21, 1996

SURVEYED BY
Max Lund

OFFICE
DENVER



1700 Broadway Suite 1450 Denver Colorado 80290
(303) 860-0509 Fax (303) 830-2546

SURVEY CERTIFICATION SHEET

Phillips Petroleum

Company

Sec-24-T31N-R8W

Lease

410-80536

Job #

San Juan Unit 32-8 #10

Well #

October 21, 1996

Date

San Juan County, New Mexico

County and State

Surveyed from a depth of 3,900 feet to 4,358 feet MD

Type of Survey MSS

Directional Supervisor/Surveyor Max Lund

The data and calculations for this survey have been checked by me and conform to the standards and procedures set forth by Baker Hughes INTEQ. This report represents a true and correct Directional Survey of this well based on the original data obtained at the well site. Wellbore Coordinates are calculated using minimum curvature.

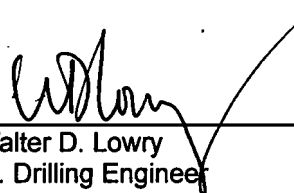

Walter D. Lowry
Sr. Drilling Engineer

This document has been subscribed and affirmed, or sworn to before me in the county of Denver, state of Colorado, this 24th day of October, 1996.

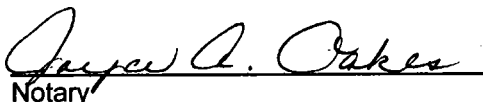

Notary My commission expires August 4, 2000

Certification Number: 432
Certification Date: October 23, 1996

PHILLIPS PETROLEUM
SEC.24-T31N-R8W

SAN JUAN UNIT 32-8 #10
SLOT #1
SAN JUAN COUNTY
NEW MEXICO

S U R V E Y L I S T I N G

by
Baker Hughes INTEQ

Your ref : Single Shot Survey
Our ref : svy3760
License :

Date printed : 23-Oct-96
Date created : 21-Oct-96
Last revised : 23-Oct-96

Field is centred on n36 50 0.000,w107 30 0
Structure is centred on n36 53 13.005,w107 36 45.004

Slot location is n36 52 55.207,w107 36 56.721
Slot Grid coordinates are N 2140384.186, E 563634.003
Slot local coordinates are 1800.00 S 952.00 W

Projection type: mercator - New Mexico West (3003), Spheroid: Clarke - 1866

Reference North is True North

PHILLIPS PETROLEUM
SEC.24-T31N-R8W,SAN JUAN UNIT 32-8 #10
SAN JUAN COUNTY,NEW MEXICO

SURVEY LISTING Page 1
Your ref : Single Shot Survey
Last revised : 23-Oct-96

Measured Depth	Inclin. Degrees	Azimuth Degrees	True Vert Depth	R E C T A N G U L A R C O O R D I N A T E S		Dogleg Deg/100ft	Vert Sect	
0.00	0.00	0.00	0.00	0.00 N	0.00 E	0.00	0.00	
3900.00	0.00	0.00	3900.00	0.00 N	0.00 E	0.00	0.00	
3987.00	3.13	321.40	3986.96	1.86 N	1.48 W	3.60	2.21	
4049.00	8.78	323.70	4048.60	7.00 N	5.34 W	9.12	8.13	
4079.00	10.75	326.60	4078.16	11.18 N	8.24 W	6.77	12.72	
4141.00	14.75	326.50	4138.62	22.59 N	15.78 W	6.45	24.96	
4173.00	17.50	325.50	4169.36	29.96 N	20.76 W	8.64	32.95	
4204.00	20.00	325.50	4198.71	38.17 N	26.40 W	8.06	41.95	
4267.00	21.50	314.50	4257.65	55.15 N	40.74 W	6.62	62.86	
4358.00	20.00	300.50	4342.79	74.75 N	66.06 W	5.68	94.58	Last BHI Survey
4498.00	17.50	298.50	4475.35	96.94 N	105.20 W	1.84	139.57	
4623.00	15.50	303.50	4595.21	115.13 N	135.64 W	1.96	175.04	
4931.00	7.25	317.50	4896.95	152.25 N	183.18 W	2.81	234.76	
5238.00	4.75	324.60	5202.24	176.89 N	203.64 W	0.85	264.80	
5517.00	3.00	340.00	5480.60	193.17 N	212.83 W	0.72	280.90	
5885.00	3.50	338.40	5848.01	212.67 N	220.26 W	0.14	297.08	Projection to T.D. is
5890.00	3.50	338.40	5853.00	212.95 N	220.37 W	0.00	297.32	1587.1' FNL & 1172.4' FEL

All data is in feet unless otherwise stated.
Coordinates from SLOT #1 and TVD from RKB (6501.00 Ft above mean sea level).
Bottom hole distance is 306.45 on azimuth 314.02 degrees from wellhead.
Vertical section is from wellhead on azimuth 300.00 degrees.
Calculation uses the minimum curvature method.
Presented by Baker Hughes INTEQ

PHILLIPS PETROLEUM
 SEC.24-T31N-R8W,SAN JUAN UNIT 32-8 #10
 SAN JUAN COUNTY,NEW MEXICO

SURVEY LISTING Page 2
 Your ref : Single Shot Survey
 Last revised : 23-Oct-96

				Comments in wellpath
				=====
MD	TVD	Rectangular Coords.		Comment
4358.00	4342.79	74.75 N	66.06 W	Last BHI Survey
5885.00	5848.01	212.67 N	220.26 W	Projection to T.D. is
5890.00	5853.00	212.95 N	220.37 W	1587.1' FNL & 1172.4' FEL

Targets associated with this wellpath				
=====				
Target name	Geographic Location	T.V.D.	Rectangular Coordinates	Revised
TGT 32-8 #10		5312.00	125.00N 216.51W	16-Aug-96

OIL CONSERVATION DIVISION
RECEIVED



AM 8 52

1700 Broadway Suite 1450 Denver Colorado 80290
(303) 860-0509 Fax (303) 830-2546

REPORT OF SUB-SURFACE DIRECTIONAL SURVEY

RECEIVED
NOV - 5 1996
OIL CON. DIV.
DIST. 3

Phillips Petroleum
COMPANY

San Juan Unit 32-8 #5
WELL NAME

San Juan County, New Mexico
LOCATION

JOB NUMBER
410-80548

TYPE OF SURVEY
MSS

DATE
October 13, 1996

SURVEYED BY
Max Lund

OFFICE
DENVER



1700 Broadway Suite 1450 Denver Colorado 80290
(303) 860-0509 Fax (303) 830-2546

SURVEY CERTIFICATION SHEET

Phillips Petroleum

Company

Sec-10-T32N-R8W

Lease

410-80548

Job #

San Juan Unit 32-8 #5

Well #

October 13, 1996

Date

San Juan County, New Mexico

County and State

Surveyed from a depth of 4,003 feet to 4,359 feet MD

Type of Survey MSS

Directional Supervisor/Surveyor Max Lund

The data and calculations for this survey have been checked by me and conform to the standards and procedures set forth by Baker Hughes INTEQ. This report represents a true and correct Directional Survey of this well based on the original data obtained at the well site. Wellbore Coordinates are calculated using minimum curvature.

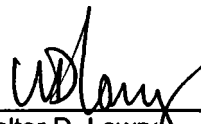

Walter D. Lowry
Sr. Drilling Engineer

This document has been subscribed and affirmed, or sworn to before me in the county of Denver, state of Colorado, this 22nd day of October, 1996.

 My commission expires August 4, 2000

Notary

Certification Number: 431
Certification Date: October 22, 1996

-- Baker Hughes INTEQ --
DRAWN BY: WALLY HOLBROOK
DATE: OCT. 22, 1996
TVD REFERENCED RKB
DENVER, COLORADO
PHONE: (303) 860-0509

PHILLIPS PETROLEUM
SEC.10-T32N-R8W

SAN JUAN UNIT 32-8 #5
SLOT #1
SAN JUAN COUNTY
NEW MEXICO

S U R V E Y L I S T I N G

by
Baker Hughes INTEQ

Your ref : Single Shot Survey
Our ref : svy3753
License :

Date printed : 22-Oct-96
Date created : 14-Oct-96
Last revised : 22-Oct-96

Field is centred on n36 50 0.000,w107 30 0
Structure is centred on n36 58 22.005,w107 39 54.002

Slot location is n36 58 33.474,w107 39 33.053
Slot Grid coordinates are N 2174566.023, E 550871.083
Slot local coordinates are 1160.00 N 1700.00 E

Projection type: mercator - New Mexico West (3003), Spheroid: Clarke - 1866

Reference North is True North

PHILLIPS PETROLEUM
SEC.10-T32N-R8W,SAN JUAN UNIT 32-8 #5
SAN JUAN COUNTY,NEW MEXICO

SURVEY LISTING Page 1
Your ref : Single Shot Survey
Last revised : 22-Oct-96

Measured Depth	Inclin. Degrees	Azimuth Degrees	True Vert Depth	R E C T A N G U L A R C O O R D I N A T E S		Dogleg Deg/100ft	Vert Sect	
0.00	0.00	0.00	0.00	0.00 N	0.00 E	0.00	0.00	
4000.00	0.00	0.00	4000.00	0.00 N	0.00 E	0.00	0.00	
4052.00	1.21	269.30	4052.00	0.01 S	0.55 W	2.33	0.47	
4114.00	3.74	305.10	4113.94	1.15 N	2.86 W	4.59	3.05	
4173.00	7.00	304.60	4172.67	4.30 N	7.39 W	5.53	8.55	
4235.00	10.50	282.60	4233.95	7.68 N	16.02 W	7.71	17.71	
4297.00	14.75	286.60	4294.44	11.17 N	29.10 W	6.99	30.79	
4359.00	19.00	291.60	4353.76	17.14 N	46.06 W	7.24	48.46	Last BHI Survey
4553.00	17.50	293.60	4538.00	40.44 N	102.16 W	0.84	108.69	
4708.00	12.50	307.60	4687.72	60.03 N	136.83 W	3.96	148.52	
4832.00	8.75	321.60	4809.59	75.61 N	153.33 W	3.65	170.60	
5047.00	5.25	343.60	5022.99	97.88 N	166.27 W	2.02	192.94	
5359.00	2.75	359.40	5334.22	119.06 N	170.38 W	0.87	207.09	
5979.00	0.75	359.40	5953.90	137.99 N	170.58 W	0.32	216.72	Total Depth is
6020.00	0.75	359.40	5994.89	138.53 N	170.59 W	0.00	217.00	1298.5' FSL & 1529.4' FWL

All data is in feet unless otherwise stated.
Coordinates from SLOT #1 and TVD from RKB (6650.00 Ft above mean sea level).
Bottom hole distance is 219.75 on azimuth 309.08 degrees from wellhead.
Vertical section is from wellhead on azimuth 300.00 degrees.
Calculation uses the minimum curvature method.
Presented by Baker Hughes INTEQ

PHILLIPS PETROLEUM
SEC.10-T32N-R8W,SAN JUAN UNIT 32-8 #5
SAN JUAN COUNTY,NEW MEXICO

SURVEY LISTING Page 2
Your ref : Single Shot Survey
Last revised : 22-Oct-96

				Comments in wellpath
				=====
MD	TVD	Rectangular Coords.		Comment
4359.00	4353.76	17.14 N	46.06 W	Last BHI Survey
5979.00	5953.90	137.99 N	170.58 W	Total Depth is
6020.00	5994.89	138.53 N	170.59 W	1298.5' FSL & 1529.4' FWL

Targets associated with this wellpath				
=====				
Target name	Geographic Location	T.V.D.	Rectangular Coordinates	Revised
CLIFF HOUSE 32-8 #5		5480.00	125.00N 216.51W	16-Aug-96



OIL CONSERVATION DIVISION

RECEIVED

1700 Broadway Suite 1450 Denver Colorado 80290
(303) 860-0509 Fax (303) 830-2546

REPORT OF SUB-SURFACE DIRECTIONAL SURVEY

RECEIVED
NOV - 5 1996
OIL CON. DIV.
DIST. 3

Phillips Petroleum
COMPANY

San Juan Unit 32-8 #20
WELL NAME

San Juan County, New Mexico
LOCATION

JOB NUMBER
410-80532

TYPE OF SURVEY
MSS

DATE
October 3, 1996

SURVEYED BY
Butch Judge

OFFICE
DENVER



1700 Broadway Suite 1450 Denver Colorado 80290
(303) 860-0509 Fax (303) 830-2546

SURVEY CERTIFICATION SHEET

Phillips Petroleum

Company

Sec-4-T31N-R8W

Lease

410-80532

Job #

San Juan Unit 32-8 #20

Well #

October 3, 1996

Date

San Juan County, New Mexico

County and State

Surveyed from a depth of 3,503 feet to 3,736 feet MD

Type of Survey MSS

Directional Supervisor/Surveyor Butch Judge

The data and calculations for this survey have been checked by me and conform to the standards and procedures set forth by Baker Hughes INTEQ. This report represents a true and correct Directional Survey of this well based on the original data obtained at the well site. Wellbore Coordinates are calculated using minimum curvature.

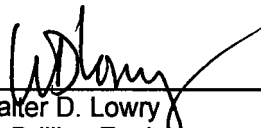
Walter D. Lowry
Sr. Drilling Engineer

This document has been subscribed and affirmed, or sworn to before me in the county of Denver, state of Colorado, this 22nd day of October, 1996.

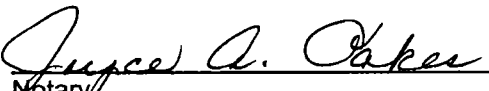
Notary My commission expires August 4, 2000

Certification Number: 430
Certification Date: October 22, 1996

PHILLIPS PETROLEUM

Structure : SEC.4-T31N-R8W Well : SAN JUAN UNIT 32-8 #20

Field : SAN JUAN COUNTY

Location : NEW MEXICO



WELL PROFILE DATA

Point	MD	Inc	Dir	TVD	North	East	V. Sect	Deg/100
Tie on	0.00	0.00	120.00	0.00	0.00	0.00	0.00	0.00
KOP	3475.00	0.00	120.00	3475.00	0.00	0.00	0.00	0.00
End of Build	3875.00	20.00	120.00	3866.93	-34.55	59.85	69.11	5.00
End of Hold	3898.76	20.00	120.00	3889.25	-38.62	66.88	77.23	0.00
Target	4898.76	0.00	120.00	4869.06	-125.00	216.51	250.00	2.00
T.D. & End of Hold	5854.69	0.00	120.00	5825.00	-125.00	216.51	250.00	0.00

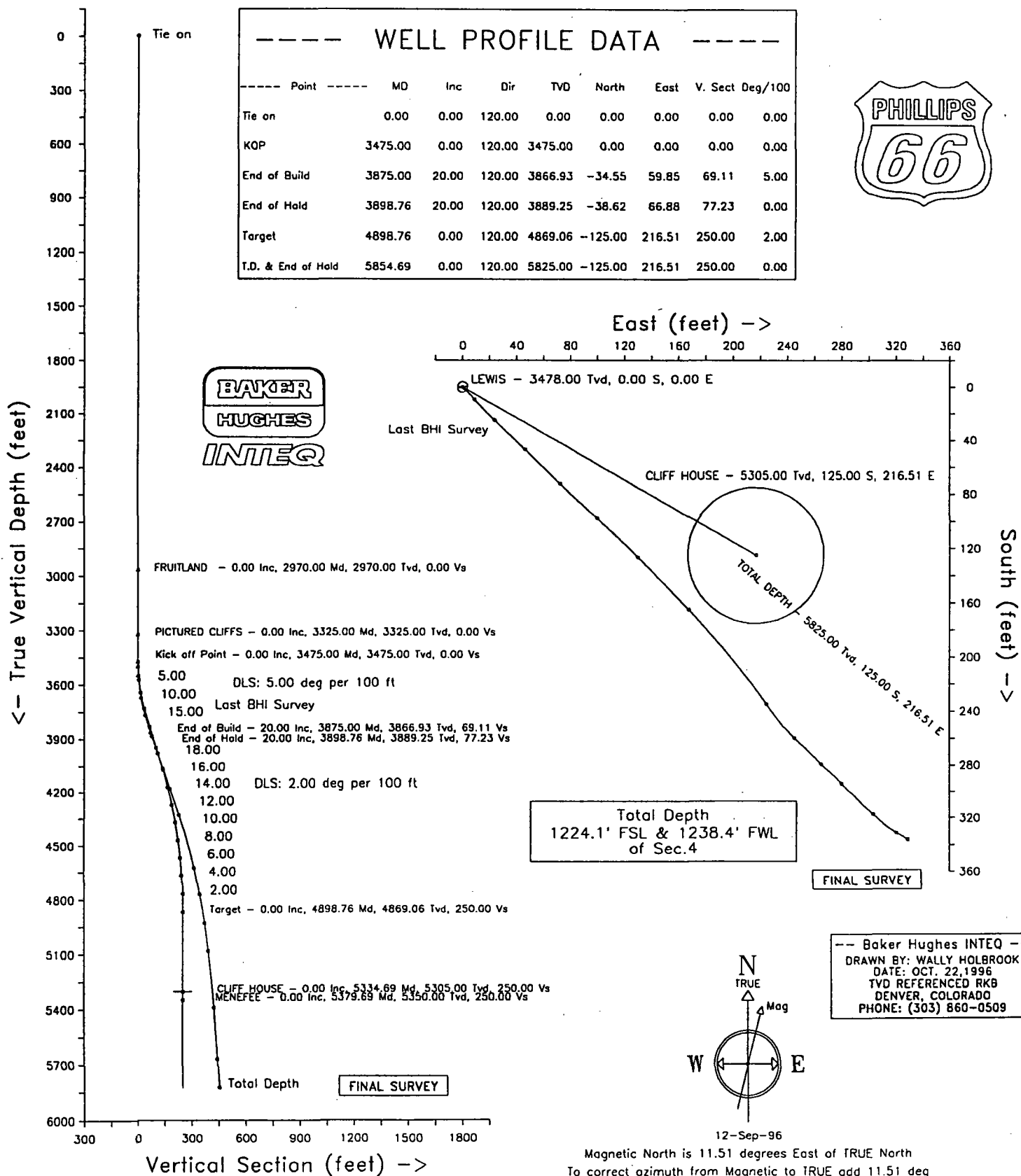

Azimuth 120.00 with reference 0.00 N, 0.00 E from SLOT #1

-- Baker Hughes INTEQ --
DRAWN BY: WALLY HOLBROOK
DATE: OCT. 22, 1996
TVD REFERENCED RKB
DENVER, COLORADO
PHONE: (303) 860-0509

PHILLIPS PETROLEUM
SEC.4-T31N-R8W

SAN JUAN UNIT 32-8 #20
SLOT #1
SAN JUAN COUNTY
NEW MEXICO

S U R V E Y L I S T I N G

by
Baker Hughes INTEQ

Your ref : Single Shot Surveys
Our ref : svy3746
License :

Date printed : 22-Oct-96
Date created : 3-Oct-96
Last revised : 22-Oct-96

Field is centred on n36 50 0.000,w107 30 0
Structure is centred on n36 50 0.000,w107 30 0

Slot location is n36 50 15.425,w107 29 48.806
Slot Grid coordinates are N 2124326.988, E 598455.086
Slot local coordinates are 1560.00 N 910.00 E

Projection type: mercator - New Mexico West (3003), Spheroid: Clarke - 1866

Reference North is True North

PHILLIPS PETROLEUM
SEC.4-T31N-R8W,SAN JUAN UNIT 32-8 #20
SAN JUAN COUNTY,NEW MEXICO

SURVEY LISTING Page 1
Your ref : Single Shot Surveys
Last revised : 22-Oct-96

Measured Depth	Inclin. Degrees	Azimuth Degrees	True Vert Depth	R E C T A N G U L A R C O O R D I N A T E S		Dogleg Deg/100ft	Vert Sect	
0.00	0.00	0.00	0.00	0.00 N	0.00 E	0.00	0.00	
3503.00	0.00	120.00	3503.00	0.00 N	0.00 E	0.00	0.00	
3553.00	4.00	130.00	3552.96	1.12 S	1.34 E	8.00	1.72	
3646.00	10.50	140.00	3645.17	9.71 S	9.28 E	7.09	12.89	
3736.00	17.00	134.00	3732.55	25.15 S	24.03 E	7.38	33.38	Last BHI Survey
3842.00	17.50	134.50	3833.78	47.08 S	46.54 E	0.49	63.85	
3965.00	17.00	133.50	3951.25	72.42 S	72.78 E	0.47	99.24	
4086.00	19.00	132.50	4066.32	97.91 S	100.13 E	1.67	135.67	
4210.00	20.00	134.50	4183.21	126.41 S	130.14 E	0.97	175.91	
4367.00	20.00	137.50	4330.74	165.02 S	167.43 E	0.65	227.51	
4676.00	14.00	145.50	4626.15	234.86 S	224.36 E	2.08	311.73	
4826.00	11.00	133.50	4772.60	259.67 S	245.03 E	2.64	342.03	
4985.00	9.00	135.50	4929.17	278.99 S	264.75 E	1.28	368.77	
5140.00	7.00	135.50	5082.66	294.37 S	279.87 E	1.29	389.56	
5451.00	5.00	133.50	5391.94	317.22 S	302.98 E	0.65	421.00	
5730.00	4.00	122.50	5670.08	330.82 S	320.01 E	0.47	442.54	Total Depth is
5885.00	3.25	119.50	5824.77	335.89 S	328.39 E	0.50	452.34	1224.1' FSL & 1238.4' FWL

All data is in feet unless otherwise stated.
Coordinates from SLOT #1 and TVD from RKB (6458.00 Ft above mean sea level).
Bottom hole distance is 469.75 on azimuth 135.65 degrees from wellhead.
Vertical section is from wellhead on azimuth 120.00 degrees.
Calculation uses the minimum curvature method.
Presented by Baker Hughes INTEQ

PHILLIPS PETROLEUM
 SEC.4-T31N-R8W,SAN JUAN UNIT 32-8 #20
 SAN JUAN COUNTY,NEW MEXICO

SURVEY LISTING Page 2
 Your ref : Single Shot Surveys
 Last revised : 22-Oct-96

				Comments in wellpath
				=====
MD	TVD	Rectangular Coords.		Comment
3736.00	3732.55	25.15 S	24.03 E	Last BHI Survey
5730.00	5670.08	330.82 S	320.01 E	Total Depth is
5885.00	5824.77	335.89 S	328.39 E	1224.1' FSL & 1238.4' FWL

Targets associated with this wellpath				
=====				
Target name	Geographic Location	T.V.D.	Rectangular Coordinates	Revised
TGT 32-8 #20		5305.00	125.00S 216.51E	16-Aug-96

CMD :
OG5SECT

ONGARD
INQUIRE LAND BY SECTION

07/12/97 12:08:24
OGOMES -EMGB
PAGE NO: 1

Sec : 24 Twp : 31N Rng : 08W Section Type : NORMAL

4 38.78 Federal owned U	3 38.78 Federal owned U	2 38.21 Federal owned U	1 38.21 Federal owned U
5 38.77 Federal owned U	6 38.77 Federal owned U	7 38.21 Federal owned U A	8 38.20 Federal owned U A

PF01 HELP PF02 PF03 EXIT PF04 GoTo PF05 PF06
PF07 BKWD PF08 FWD PF09 PRINT PF10 SDIV PF11 PF12

CMD :
OG5SECT

ONGARD
INQUIRE LAND BY SECTION

07/12/97 12:08:29
OGOMES -EMGB
PAGE NO: 2

Sec : 24 Twp : 31N Rng : 08W Section Type : NORMAL

21 22 23 2.42 0000 0000 0000 Federal owned U U A	17 18 19 000 Federal owned U U	13 14 15 2.38 2.39 2.39 Federal owned U U	10 11 12 2.38 2.38 2.38 Federal owned U U
117 118 119 2.42 0000 0000 0000 Federal owned U U A	113 114 115 000 Federal owned U U	100 109 110 2.40 2.41 2.41 Federal owned U U	101 102 103 2.40 2.40 2.40 Federal owned U U

PF01 HELP PF02 PF03 EXIT PF04 GoTo PF05 PF06
PF07 BKWD PF08 FWD PF09 PRINT PF10 SDIV PF11 PF12

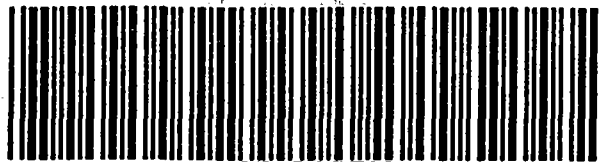

SEAPORT90

Begin New File

SEAPORT IMAGING

EnsignTM

Scanner Type: ALL

Function: Begin New File

This is used only with multi-image file formats.





PHILLIPS PETROLEUM COMPANY

FARMINGTON, NEW MEXICO 87401
5525 HWY. 64 NBU 3004

November 6, 1996

State of New Mexico
Oil Conservation Division
204 South Pacheco
Santa Fe, New Mexico 87505

ATTN: MR. WILLIAM J. LEMAY

**RE: ADMINISTRATIVE APPROVAL OF INTENTIONAL WELL DEVIATION
SAN JUAN 32-8 UNIT #10 WELL
NE/4 SECTION 24-T31N-R8W,
SAN JUAN COUNTY, NEW MEXICO
PHILLIPS' G.F.-5465, LCN 650117**

Gentlemen:

Phillips Petroleum Company ("Phillips"), as Operator of the San Juan 32-8 Unit, requests administrative approval of the intentional deviation of the above-described well.

The San Juan 32-8 Unit #10 Well was originally drilled in 1955 and completed as a Blanco Mesaverde Pool well. Enclosed is a copy of the original plat for this well which indicates the original location of 1800' FNL and 952' FEL.

Phillips has abandoned the existing Blanco Mesaverde interval in this well, sidetracked and completed in the Blanco Mesaverde at a bottom-hole location of 1587' FNL and 1172' FEL Section 24-T31N-R8W. Enclosed are three copies of a new well location and acreage dedication plat and sub-surface directional survey confirming the well's bottom-hole location.

A copy of this notice has been furnished to Devon Energy Corp, the offsetting Blanco Mesaverde Pool operator.

Please advise if additional information is required.

Very truly yours,

Patrick H. Noah
Senior Land Specialist
San Juan Basin
(505) 599-3410

cc: J.L. Mathis (r) G.F. 5465
Ernie Busch-OCD, Aztec

3-2000 & B

L. H. P. Johnston

L. H. S. Richey

NEW MEXICO OIL CONSERVATION COMMISSION

SANTA FE, NEW MEXICO

(File the original and 4 copies with the appropriate district office)

CERTIFICATE OF COMPLIANCE AND AUTHORIZATION
TO TRANSPORT OIL AND NATURAL GASCompany or Operator PACIFIC NORTHWEST PIPELINE CORP. Lease San Juan 12-8Well No 10-24 Unit Letter N S 24 T 118 R 61 Pool Flaming NVCounty San Juan Kind of Lease (State, Fed. or Patented) StateIf well produces oil or condensate, give location of tanks: Unit S T RAuthorized Transporter of Oil or Condensate El Paso Natural Gas Co. MaulesAddress Farmington, New Mexico

(Give address to which approved copy of this form is to be sent)

Authorized Transporter of Gas El Paso Natural Gas Co.Address Farmington, New Mexico

(Give address to which approved copy of this form is to be sent)

If Gas is not being sold, give reasons and also explain its present disposition:

Reasons for Filing: (Please check proper box) New Well (X)

Change in Transporter of (Check One): Oil () Dry Gas () C'head () Condensate ()

Change in Ownership (X) Other ()

Remarks: (Give explanation below)

Drilled by El Paso Natural Gas Co., admitted to San Juan 12-8 Unit November 4, 1955.
Pacific Northwest assumed operations November 8, 1955.

The undersigned certifies that the Rules and Regulations of the Oil Conservation Commission have been complied with.

Executed this the 20th day of December 19 55Approved 1-6 19 56

OIL CONSERVATION COMMISSION

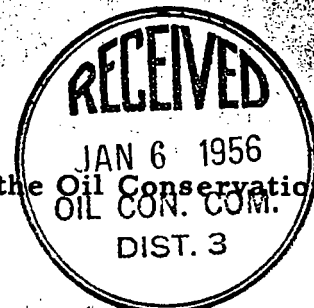
By Ernest T. CurryTitle Oil and Gas Inspector Dist. #3.By Original signed by T. A. DuganTitle District EngineerCompany PACIFIC NORTHWEST PIPELINE CORP.Address 411 1/2 West Main StreetFarmington, New Mexico

COMPANY EL PASO NATURAL GAS COMPANY

Well Name & No. SAN JUAN 32-8 UNIT # 10-24 Lease No. SF-079-351

Location 1800 FEET FROM THE NORTH LINE AND 952 FEET FROM THE EAST LINE.

Being in NW-SE-NE

Sec. 24, T 31 N., R 8 W., N.M.P.M., SAN JUAN CO.

Ground Elevation 6491.00 UNGRADED GROUND

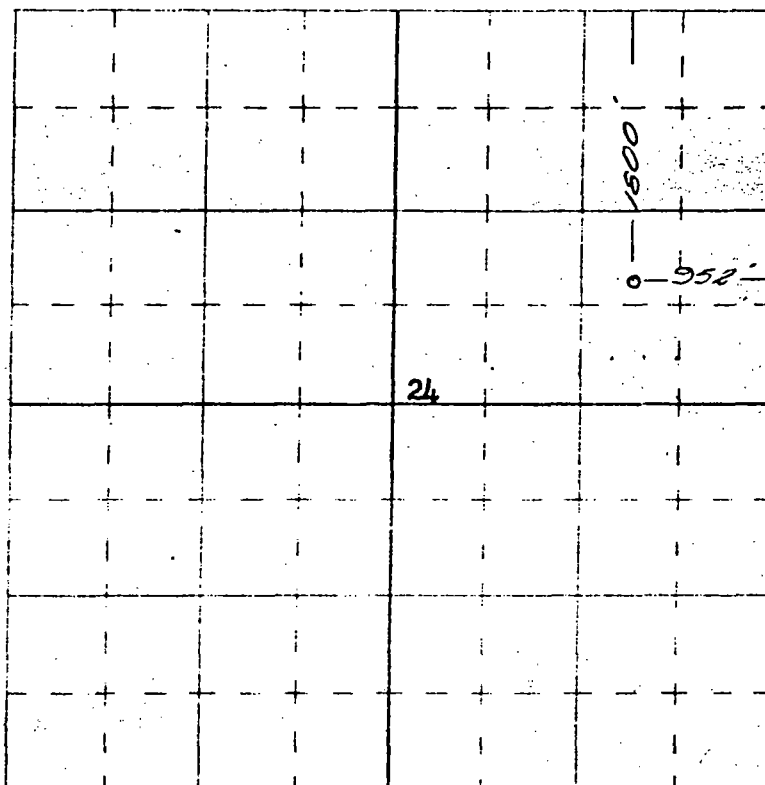

Scale -- 4 inches equals 1 mile

Surveyed JUNE 22, 1955

This is to certify that the above plat was prepared from field notes of actual surveys made by me or under my supervision and that the same are true and correct to the best of my knowledge and belief.

Seal:

Farmington, New Mexico

James P. Leese
JAMES P. LEESE
N. MEX. REG. NO. 1463
REG. LAND SURVEYOR

320 ACRES, E/2 SECTION (PLAT)

RECEIVED
JUL 5 1955
U. S. GEOLOGICAL SURVEY
FARMINGTON, NEW MEXICO

District I
PO Box 1980, Hobbs, NM 88241-1980
District II
811 South First, Artesia, NM 88210
District III
1000 Rio Brazos Rd., Aztec, NM 87410
District IV
2040 South Pacheco, Santa Fe, NM 87505

State of New Mexico
Energy, Minerals & Natural Resources Department

OIL CONSERVATION DIVISION
2040 South Pacheco
Santa Fe, NM 87505

Form C-102
Revised October 18, 1994
Instructions on back
Submit to Appropriate District Office
State Lease - 4 Copies
Fee Lease - 3 Copies

☐ AMENDED REPORT

WELL LOCATION AND ACREAGE DEDICATION PLAT

¹ APT Number 30-045-10562	¹ Pool Code 72319	¹ Pool Name Blanco Mesaverde
⁴ Property Code 009261	⁴ Property Name San Juan 32-8 Unit	⁴ Well Number #10
⁷ OGRID No. 017654	⁷ Operator Name Phillips Petroleum Company	⁷ Elevation 6501

¹⁰ Surface Location

UL or lot no.	Section	Township	Range	Lot Idn	Feet from the	North/South line	Feet from the	East/West line	County
H	24	31N	8W		1800	North	952	East	San Juan

¹¹ Bottom Hole Location If Different From Surface

UL or lot no.	Section	Township	Range	Lot Idn	Feet from the	North/South line	Feet from the	East/West line	County
H	24	31N	8W		1587	North	1172	East	San Juan

¹² Dedicated Acres 320 ac	¹² Joint or Infill N	¹² Consolidation Code U	¹² Order No.
---	------------------------------------	---------------------------------------	-------------------------

NO ALLOWABLE WILL BE ASSIGNED TO THIS COMPLETION UNTIL ALL INTERESTS HAVE BEEN CONSOLIDATED
OR A NON-STANDARD UNIT HAS BEEN APPROVED BY THE DIVISION

<p>16</p>	<p>¹⁷ OPERATOR CERTIFICATION</p> <p>I hereby certify that the information contained herein is true and complete to the best of my knowledge and belief</p> <p><i>Richard A. Allred</i></p> <p>Signature Richard A. Allred</p> <p>Printed Name Production Superintendent</p> <p>Title 11-4-96</p> <p>Date</p>
	<p>¹⁸ SURVEYOR CERTIFICATION</p> <p>I hereby certify that the well location shown on this plat was plotted from field notes of actual surveys made by me or under my supervision, and that the same is true and correct to the best of my belief.</p> <p>Date of Survey</p> <p>Signature and Seal of Professional Surveyor:</p> <p>Certificate Number</p>



1700 Broadway Suite 1450 Denver Colorado 80290
(303) 860-0509 Fax (303) 830-2546

REPORT OF SUB-SURFACE DIRECTIONAL SURVEY

Phillips Petroleum
COMPANY

San Juan Unit 32-8 #10
WELL NAME

San Juan County, New Mexico
LOCATION

JOB NUMBER
410-80536

TYPE OF SURVEY
MSS

DATE
October 21, 1996

SURVEYED BY
Max Lund

OFFICE
DENVER



1700 Broadway Suite 1450 Denver Colorado 80290
(303) 860-0509 Fax (303) 830-2546

SURVEY CERTIFICATION SHEET

Phillips Petroleum

Company

Sec-24-T31N-R8W

Lease

410-80536

Job #

San Juan Unit 32-8 #10

Well #

October 21, 1996

Date

San Juan County, New Mexico

County and State

Surveyed from a depth of 3,900 feet to 4,358 feet MD

Type of Survey MSS

Directional Supervisor/Surveyor Max Lund

The data and calculations for this survey have been checked by me and conform to the standards and procedures set forth by Baker Hughes INTEQ. This report represents a true and correct Directional Survey of this well based on the original data obtained at the well site. Wellbore Coordinates are calculated using minimum curvature.

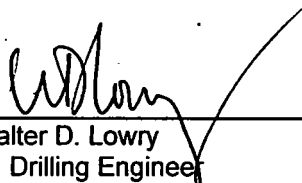
Walter D. Lowry
Sr. Drilling Engineer

This document has been subscribed and affirmed, or sworn to before me in the county of Denver, state of Colorado, this 24th day of October, 1996.

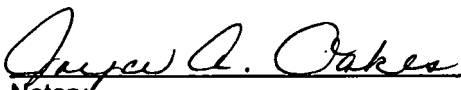
Notary My commission expires August 4, 2000

Certification Number: 432
Certification Date: October 23, 1996

PHILLIPS PETROLEUM

Structure : SEC.24-T31N-R8W Well : SAN JUAN UNIT 32-8 #10

Field : SAN JUAN COUNTY

Location : NEW MEXICO

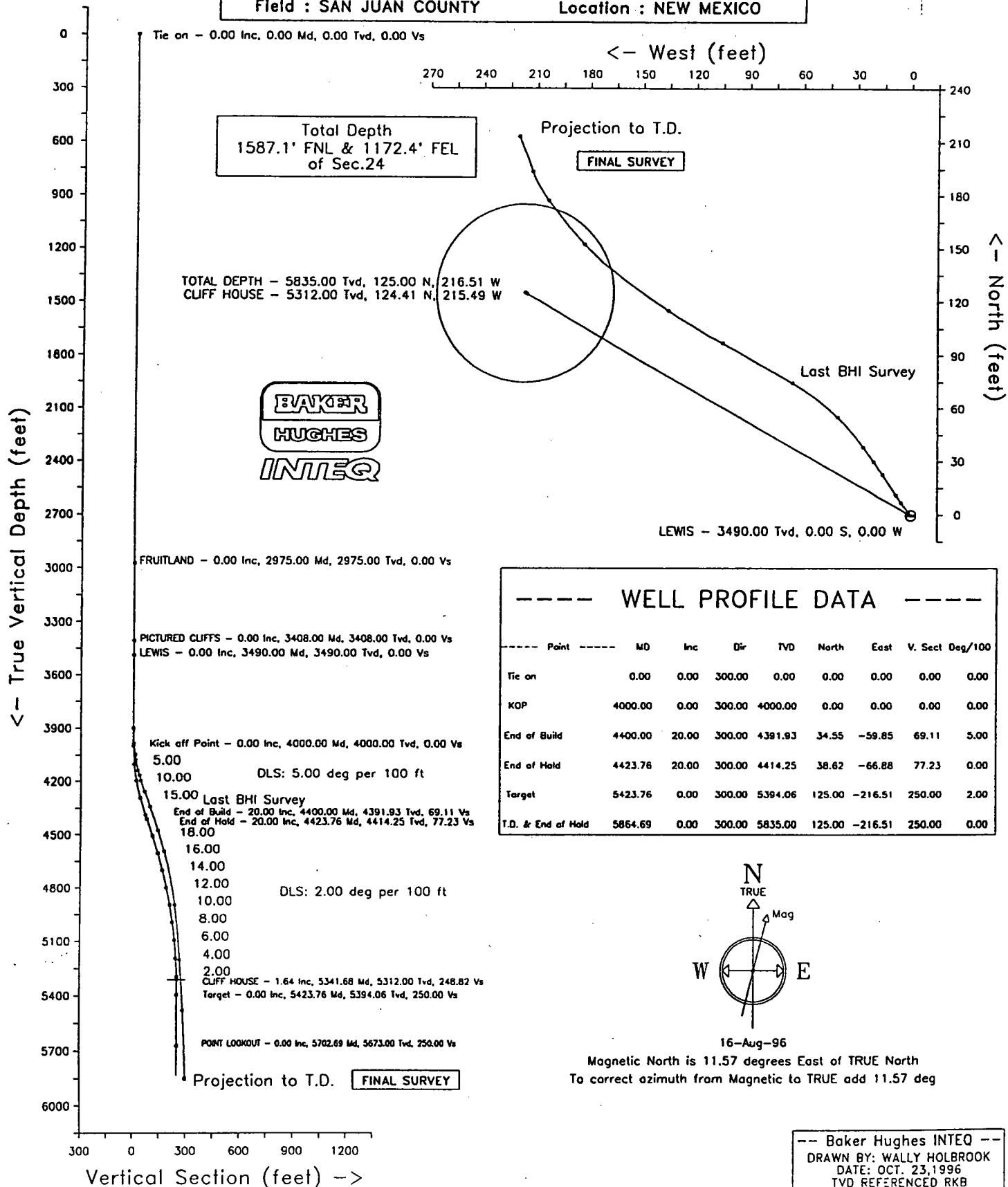

Azimuth 300.00 with reference 0.00 N, 0.00 E from SLOT #1

PHILLIPS PETROLEUM
SEC.24-T31N-R8W

SAN JUAN UNIT 32-8 #10
SLOT #1
SAN JUAN COUNTY
NEW MEXICO

S U R V E Y L I S T I N G

by
Baker Hughes INTEQ

Your ref : Single Shot Survey
Our ref : svy3760
License :

Date printed : 23-Oct-96
Date created : 21-Oct-96
Last revised : 23-Oct-96

Field is centred on n36 50 0.000,w107 30 0
Structure is centred on n36 53 13.005,w107 36 45.004

Slot location is n36 52 55.207,w107 36 56.721
Slot Grid coordinates are N 2140384.186, E 563634.003
Slot local coordinates are 1800.00 S 952.00 W

Projection type: mercator - New Mexico West (3003), Spheroid: Clarke - 1866

Reference North is True North

PHILLIPS PETROLEUM
SEC.24-T31N-R8W,SAN JUAN UNIT 32-8 #10
SAN JUAN COUNTY,NEW MEXICO

SURVEY LISTING Page 1
Your ref : Single Shot Survey
Last revised : 23-Oct-96

Measured Depth	Inclin. Degrees	Azimuth Degrees	True Vert Depth	R E C T A N G U L A R C O O R D I N A T E S		Dogleg Deg/100ft	Vert Sect	
0.00	0.00	0.00	0.00	0.00 N	0.00 E	0.00	0.00	
3900.00	0.00	0.00	3900.00	0.00 N	0.00 E	0.00	0.00	
3987.00	3.13	321.40	3986.96	1.86 N	1.48 W	3.60	2.21	
4049.00	8.78	323.70	4048.60	7.00 N	5.34 W	9.12	8.13	
4079.00	10.75	326.60	4078.16	11.18 N	8.24 W	6.77	12.72	
4141.00	14.75	326.50	4138.62	22.59 N	15.78 W	6.45	24.96	
4173.00	17.50	325.50	4169.36	29.96 N	20.76 W	8.64	32.95	
4204.00	20.00	325.50	4198.71	38.17 N	26.40 W	8.06	41.95	
4267.00	21.50	314.50	4257.65	55.15 N	40.74 W	6.62	62.86	
4358.00	20.00	300.50	4342.79	74.75 N	66.06 W	5.68	94.58	Last BHI Survey
4498.00	17.50	298.50	4475.35	96.94 N	105.20 W	1.84	139.57	
4623.00	15.50	303.50	4595.21	115.13 N	135.64 W	1.96	175.04	
4931.00	7.25	317.50	4896.95	152.25 N	183.18 W	2.81	234.76	
5238.00	4.75	324.60	5202.24	176.89 N	203.64 W	0.85	264.80	
5517.00	3.00	340.00	5480.60	193.17 N	212.83 W	0.72	280.90	
5885.00	3.50	338.40	5848.01	212.67 N	220.26 W	0.14	297.08	Projection to T.D. is
5890.00	3.50	338.40	5853.00	212.95 N	220.37 W	0.00	297.32	1587.1' FNL & 1172.4' FEL

All data is in feet unless otherwise stated.
Coordinates from SLOT #1 and TVD from RKB (6501.00 Ft above mean sea level).
Bottom hole distance is 306.45 on azimuth 314.02 degrees from wellhead.
Vertical section is from wellhead on azimuth 300.00 degrees.
Calculation uses the minimum curvature method.
Presented by Baker Hughes INTEQ

PHILLIPS PETROLEUM
 SEC.24-T31N-R8W,SAN JUAN UNIT 32-8 #10
 SAN JUAN COUNTY,NEW MEXICO

SURVEY LISTING Page 2
 Your ref : Single Shot Survey
 Last revised : 23-Oct-96

				Comments in wellpath
				=====
MD	TVD	Rectangular Coords.		Comment

4358.00	4342.79	74.75 N	66.06 W	Last BHI Survey
5885.00	5848.01	212.67 N	220.26 W	Projection to T.D. is
5890.00	5853.00	212.95 N	220.37 W	1587.1' FNL & 1172.4' FEL

Targets associated with this wellpath				
=====				
Target name	Geographic Location	T.V.D.	Rectangular Coordinates	Revised

TGT 32-8 #10		5312.00	125.00N 216.51W	16-Aug-96



PHILLIPS PETROLEUM COMPANY

FARMINGTON, NEW MEXICO 87401
5525 HWY. 64 NBU 3004

November 6, 1996

State of New Mexico
Oil Conservation Division
204 South Pacheco
Santa Fe, New Mexico 87505

ATTN: MR. WILLIAM J. LEMAY

**RE: ADMINISTRATIVE APPROVAL OF INTENTIONAL WELL DEVIATION
SAN JUAN 32-8 UNIT #10 WELL
NE/4 SECTION 24-T31N-R8W,
SAN JUAN COUNTY, NEW MEXICO
PHILLIPS' G.F.-5465, LCN 650117**

Gentlemen:

Phillips Petroleum Company ("Phillips"), as Operator of the San Juan 32-8 Unit, requests administrative approval of the intentional deviation of the above-described well.

The San Juan 32-8 Unit #10 Well was originally drilled in 1955 and completed as a Blanco Mesaverde Pool well. Enclosed is a copy of the original plat for this well which indicates the original location of 1800' FNL and 952' FEL.

Phillips has abandoned the existing Blanco Mesaverde interval in this well, sidetracked and completed in the Blanco Mesaverde at a bottom-hole location of 1587' FNL and 1172' FEL Section 24-T31N-R8W. Enclosed are three copies of a new well location and acreage dedication plat and sub-surface directional survey confirming the well's bottom-hole location.

A copy of this notice has been furnished to Devon Energy Corp, the offsetting Blanco Mesaverde Pool operator.

Please advise if additional information is required.

Very truly yours,

Patrick H. Noah
Senior Land Specialist
San Juan Basin
(505) 599-3410

cc: J.L. Mathis (r) G.F. 5465
Ernie Busch-OCD, Aztec

Revised 7/1/55

5-220 & 2

L. H. P. Johnston

L. H. S. Hickey

NEW MEXICO OIL CONSERVATION COMMISSION

SANTA FE, NEW MEXICO

(File the original and 4 copies with the appropriate district office)

CERTIFICATE OF COMPLIANCE AND AUTHORIZATION
TO TRANSPORT OIL AND NATURAL GASCompany or Operator PACIFIC NORTHWEST PIPELINE CORP. Lease San Juan 12-2Well No. 10-24 Unit Letter N S 24 T 10N R 2W Pool Flanco NWCounty San Juan Kind of Lease (State, Fed. or Patented) StateIf well produces oil or condensate, give location of tanks: Unit S T RAuthorized Transporter of Oil or Condensate El Paso Natural Gas Co. MaletAddress Farmington, New Mexico

(Give address to which approved copy of this form is to be sent)

Authorized Transporter of Gas El Paso Natural Gas Co.Address Farmington, New Mexico

(Give address to which approved copy of this form is to be sent)

If Gas is not being sold, give reasons and also explain its present disposition:

Reasons for Filing: (Please check proper box) New Well ☒ (X)

Change in Transporter of (Check One): Oil () Dry Gas () C'head () Condensate ()

Change in Ownership ☒ (X) Other ()

Remarks: (Give explanation below)

Drilled by El Paso Natural Gas Co., admitted to San Juan 12-2 Unit November 8, 1955.
Pacific Northwest assumed operations November 8, 1955.

The undersigned certifies that the Rules and Regulations of the Oil Conservation Commission have been complied with.

Executed this the 20th day of December 19 55By Original signed by T. A. DuganApproved 1-6 19 56Title District Engineer

OIL CONSERVATION COMMISSION

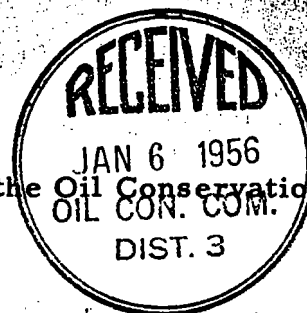
By Ernest T. DuganTitle Oil and Gas Inspector Dist. #3.Company PACIFIC NORTHWEST PIPELINE CORP.Address 411 1/2 West Main StreetFarmington, New Mexico

COMPANY EL PASO NATURAL GAS COMPANY

Well Name & No. SAN JUAN 32-8 UNIT # 10-24 Lease No. SF-079-351

Location 1800 FEET FROM THE NORTH LINE AND 952 FEET FROM THE EAST LINE.

Being in NW-SE-NE

Sec. 24, T 31N., R 8 W., N.M.P.M., SAN JUAN CO.

Ground Elevation 6491.00 UNGRADED GROUND

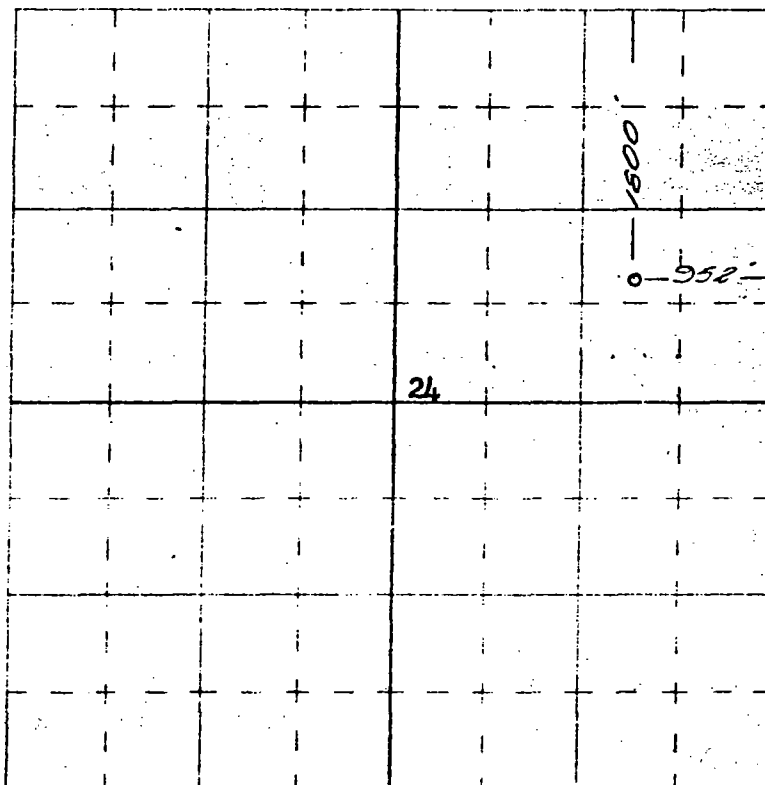

Scale -- 4 inches equals 1 mile

Surveyed JUNE 22, 1955

This is to certify that the above plat was prepared from field notes of actual surveys made by me or under my supervision and that the same are true and correct to the best of my knowledge and belief.

Seal:

Farmington, New Mexico

James P. Leese
JAMES P. LEESE
N. MEX. REG. NO. 1463
REG. LAND SURVEYOR

320 ACRES, E/2 SECTION (PLAT)

RECEIVED
JUL 5 1955
U. S. GEOLOGICAL SURVEY
FARMINGTON, NEW MEXICO

District I
PO Box 1980, Hobbs, NM 88241-1980

District II

811 South First, Artesia, NM 88210

District III

1000 Rio Brazos Rd., Aztec, NM 87410

District IV

2040 South Pacheco, Santa Fe, NM 87505

State of New Mexico
Energy, Minerals & Natural Resources Department

OIL CONSERVATION DIVISION
2040 South Pacheco
Santa Fe, NM 87505

Form C-102

Revised October 18, 1994

Instructions on back

Submit to Appropriate District Office

State Lease - 4 Copies

Fee Lease - 3 Copies

☐ AMENDED REPORT

WELL LOCATION AND ACREAGE DEDICATION PLAT

¹ API Number 30-045-10562	¹ Pool Code 72319	¹ Pool Name Blanco Mesaverde
⁴ Property Code 009261	⁵ Property Name San Juan 32-8 Unit	⁶ Well Number #10
⁷ OGRID No. 017654	⁸ Operator Name Phillips Petroleum Company	⁹ Elevation 6501

¹⁰ Surface Location

UL or lot no.	Section	Township	Range	Lot Idn	Feet from the	North/South line	Feet from the	East/West line	County
H	24	31N	8W		1800	North	952	East	San Juan

¹¹ Bottom Hole Location If Different From Surface

UL or lot no.	Section	Township	Range	Lot Idn	Feet from the	North/South line	Feet from the	East/West line	County
H	24	31N	8W		1587	North	1172	East	San Juan

¹² Dedicated Acres 320 ac	¹³ Joint or Infill N	¹⁴ Consolidation Code U	¹⁵ Order No.
---	------------------------------------	---------------------------------------	-------------------------

NO ALLOWABLE WILL BE ASSIGNED TO THIS COMPLETION UNTIL ALL INTERESTS HAVE BEEN CONSOLIDATED
OR A NON-STANDARD UNIT HAS BEEN APPROVED BY THE DIVISION

16		¹⁷ OPERATOR CERTIFICATION I hereby certify that the information contained herein is true and complete to the best of my knowledge and belief Signature: Printed Name: Richard A. Allred Title: Production Superintendent Date: 11-4-96
		¹⁸ SURVEYOR CERTIFICATION I hereby certify that the well location shown on this plat was plotted from field notes of actual surveys made by me or under my supervision, and that the same is true and correct to the best of my belief. Date of Survey: Signature and Seal of Professional Surveyer: Certificate Number:



1700 Broadway Suite 1450 Denver Colorado 80290
(303) 860-0509 Fax (303) 830-2546

REPORT OF SUB-SURFACE DIRECTIONAL SURVEY

Phillips Petroleum
COMPANY

San Juan Unit 32-8 #10
WELL NAME

San Juan County, New Mexico
LOCATION

JOB NUMBER
410-80536

TYPE OF SURVEY
MSS

DATE
October 21, 1996

SURVEYED BY
Max Lund

OFFICE
DENVER



1700 Broadway Suite 1450 Denver Colorado 80290
(303) 860-0509 Fax (303) 830-2546

SURVEY CERTIFICATION SHEET

Phillips Petroleum

Company

Sec-24-T31N-R8W

Lease

410-80536

Job #

San Juan Unit 32-8 #10

Well #

October 21, 1996

Date

San Juan County, New Mexico

County and State

Surveyed from a depth of 3,900 feet to 4,358 feet MD

Type of Survey MSS

Directional Supervisor/Surveyor Max Lund

The data and calculations for this survey have been checked by me and conform to the standards and procedures set forth by Baker Hughes INTEQ. This report represents a true and correct Directional Survey of this well based on the original data obtained at the well site. Wellbore Coordinates are calculated using minimum curvature.

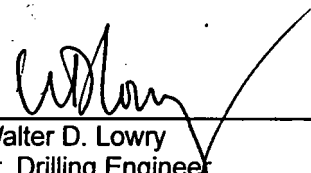
Walter D. Lowry
Sr. Drilling Engineer

This document has been subscribed and affirmed, or sworn to before me in the county of Denver, state of Colorado, this 24th day of October, 1996.

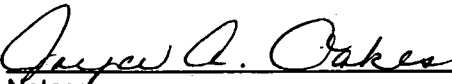
Notary

My commission expires August 4, 2000

Certification Number: 432
Certification Date: October 23, 1996

PHILLIPS PETROLEUM

Structure : SEC.24-T31N-R8W Well : SAN JUAN UNIT 32-8 #10

Field : SAN JUAN COUNTY

Location : NEW MEXICO

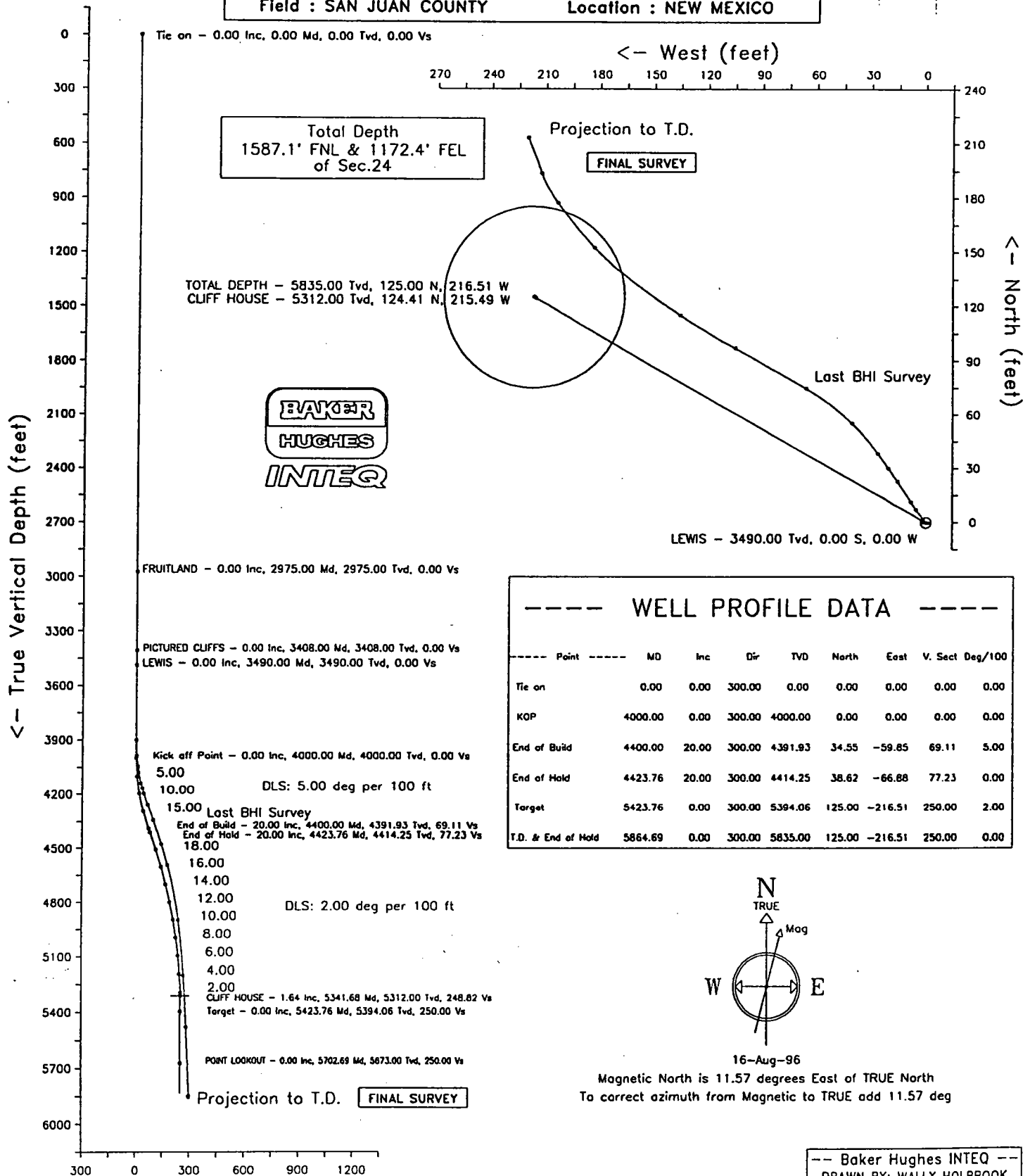

WELL PROFILE DATA

Point	MD	Inc	Dir	TVD	North	East	V. Sect	Deg/100
Tie on	0.00	0.00	300.00	0.00	0.00	0.00	0.00	0.00
KOP	4000.00	0.00	300.00	4000.00	0.00	0.00	0.00	0.00
End of Build	4400.00	20.00	300.00	4391.93	34.55	-59.85	69.11	5.00
End of Hold	4423.76	20.00	300.00	4414.25	38.62	-66.88	77.23	0.00
Target	5423.76	0.00	300.00	5394.06	125.00	-216.51	250.00	2.00
T.D. & End of Hold	5864.69	0.00	300.00	5835.00	125.00	-216.51	250.00	0.00

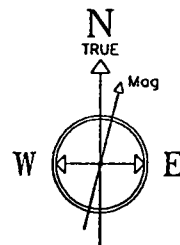

16-Aug-96

Magnetic North is 11.57 degrees East of TRUE North
To correct azimuth from Magnetic to TRUE add 11.57 deg

-- Baker Hughes INTEQ --
DRAWN BY: WALLY HOLBROOK
DATE: OCT. 23, 1996
TVD REFERENCED RKB
DENVER, COLORADO
PHONE: (303) 860-0509

PHILLIPS PETROLEUM
SEC.24-T31N-R8W

SAN JUAN UNIT 32-8 #10
SLOT #1
SAN JUAN COUNTY
NEW MEXICO

S U R V E Y L I S T I N G

by
Baker Hughes INTEQ

Your ref : Single Shot Survey
Our ref : svy3760
License :

Date printed : 23-Oct-96
Date created : 21-Oct-96
Last revised : 23-Oct-96

Field is centred on n36 50 0.000,w107 30 0
Structure is centred on n36 53 13.005,w107 36 45.004

Slot location is n36 52 55.207,w107 36 56.721
Slot Grid coordinates are N 2140384.186, E 563634.003
Slot local coordinates are 1800.00 S 952.00 W

Projection type: mercator - New Mexico West (3003), Spheroid: Clarke - 1866

Reference North is True North

PHILLIPS PETROLEUM
SEC.24-T31N-R8W,SAN JUAN UNIT 32-8 #10
SAN JUAN COUNTY,NEW MEXICO

SURVEY LISTING Page 1
Your ref : Single Shot Survey
Last revised : 23-Oct-96

Measured Depth	Inclin. Degrees	Azimuth Degrees	True Vert Depth	R E C T A N G U L A R C O O R D I N A T E S		Dogleg Deg/100ft	Vert Sect	
0.00	0.00	0.00	0.00	0.00 N	0.00 E	0.00	0.00	
3900.00	0.00	0.00	3900.00	0.00 N	0.00 E	0.00	0.00	
3987.00	3.13	321.40	3986.96	1.86 N	1.48 W	3.60	2.21	
4049.00	8.78	323.70	4048.60	7.00 N	5.34 W	9.12	8.13	
4079.00	10.75	326.60	4078.16	11.18 N	8.24 W	6.77	12.72	
4141.00	14.75	326.50	4138.62	22.59 N	15.78 W	6.45	24.96	
4173.00	17.50	325.50	4169.36	29.96 N	20.76 W	8.64	32.95	
4204.00	20.00	325.50	4198.71	38.17 N	26.40 W	8.06	41.95	
4267.00	21.50	314.50	4257.65	55.15 N	40.74 W	6.62	62.86	
4358.00	20.00	300.50	4342.79	74.75 N	66.06 W	5.68	94.58	Last BHI Survey
4498.00	17.50	298.50	4475.35	96.94 N	105.20 W	1.84	139.57	
4623.00	15.50	303.50	4595.21	115.13 N	135.64 W	1.96	175.04	
4931.00	7.25	317.50	4896.95	152.25 N	183.18 W	2.81	234.76	
5238.00	4.75	324.60	5202.24	176.89 N	203.64 W	0.85	264.80	
5517.00	3.00	340.00	5480.60	193.17 N	212.83 W	0.72	280.90	
5885.00	3.50	338.40	5848.01	212.67 N	220.26 W	0.14	297.08	Projection to T.D. is
5890.00	3.50	338.40	5853.00	212.95 N	220.37 W	0.00	297.32	1587.1' FNL & 1172.4' FEL

All data is in feet unless otherwise stated.
Coordinates from SLOT #1 and TVD from RKB (6501.00 Ft above mean sea level).
Bottom hole distance is 306.45 on azimuth 314.02 degrees from wellhead.
Vertical section is from wellhead on azimuth 300.00 degrees.
Calculation uses the minimum curvature method.
Presented by Baker Hughes INTEQ

PHILLIPS PETROLEUM
 SEC.24-T31N-R8W,SAN JUAN UNIT 32-8 #10
 SAN JUAN COUNTY,NEW MEXICO

SURVEY LISTING Page 2
 Your ref : Single Shot Survey
 Last revised : 23-Oct-96

				Comments in wellpath
				=====
MD	TVD	Rectangular Coords.		Comment

4358.00	4342.79	74.75 N	66.06 W	Last BHI Survey
5885.00	5848.01	212.67 N	220.26 W	Projection to T.D. is
5890.00	5853.00	212.95 N	220.37 W	1587.1' FNL & 1172.4' FEL

Targets associated with this wellpath				
=====				
Target name	Geographic Location	T.V.D.	Rectangular Coordinates	Revised

TGT 32-8 #10		5312.00	125.00N 216.51W	16-Aug-96