

Rec: 11-5-91
Sup. Rec: 11-25-96
Released: 7-14-97

Phillips 5

July 14, 1997

**Phillips Petroleum Company
5525 Highway 64 - NBU 3004
Farmington, New Mexico 87401**

Attention: Patrick H. Noah

Administrative Order DD-183***(NSBHL)**

Dear Mr. Noah:

Reference is made to your application dated November 1, 1996 authorizing Phillips Petroleum Company's ("Phillips") recent recompletion of its San Juan "32-8" Unit Well No. 20 (API No. 30-045-11025) by side tracking off of the existing vertical wellbore and directionally drilling to a pre-determined unorthodox bottomhole gas well location in order to further develop the Blanco-Mesaverde Pool underlying the existing standard 320.57-acre gas spacing and proration unit ("GPU") comprising Lots 3 and 4, the S/2 NW/4, and the SW/4 (W/2 equivalent) of Section 4, Township 31 North, Range 8 West, NMPM, San Juan County, New Mexico.

The Division Director Finds That:

- (1) By Order No. R-8170, as amended, the Division promulgated the "*General Rules For The Prorated Gas Pools of New Mexico/Special Rules and Regulations For The Blanco-Mesaverde Pool*", which includes provisions for 320-acre gas spacing and proration units ("GPU") and well location requirements whereby the initial well drilled on a GPU shall be located be no closer than 790 feet to the outer boundary of the quarter section on which the well is located and not closer than 130 feet to any quarter-quarter section line or subdivision inner boundary and the infill well drilled on an existing GPU shall be in the quarter section not containing a Mesaverde gas well and shall be located with respect to the restrictions as previously described;
- (2) The San Juan "32-8" Unit Well No. 20, located at a standard surface gas well location 1560 feet from the South line and 910 feet from the West line (Unit L) of said Section 4, was originally drilled to and completed in the Blanco-Mesaverde Pool in 1957;
- (3) The infill well for the subject GPU is the San Juan "32-8" Unit Well No. 20-A (API No. 30-045-24499), located at a standard gas well location 1560 feet from the North line and 820 feet from the West line (Unit E) of said Section 4;

- (4) This application has been duly filed under the applicable provisions of said special pool rules and **Rules 111.D and E** of the General Rules and Regulations of the New Mexico Oil Conservation Division ("Division"), revised by Division Order No. R-10388, issued by the New Mexico Oil Conservation Commission in Case 11,274 on June 13, 1995;
- (5) As indicated by the directional survey, dated October 3, 1996, on file with the Division, the actual bottomhole location for this well within the Blanco-Mesaverde is now 1224 feet from the South line and 1238 feet from the West line (Unit L) of said Section 4; and,
- (6) It appearing the applicant has satisfied all of the appropriate requirements prescribed in said Rule 111.D and E and **Rule 2(d)** of said special pool rules, the subject application should be approved.

IT IS THEREFORE ORDERED THAT:

(1) The recompletion by Phillips Petroleum Company of its San Juan "32-8" Unit Well No. 20 (**API No. 30-045-11025**), located at a standard surface gas well location 1560 feet from the South line and 910 feet from the West line (Unit L) of Section 4, Township 31 North, Range 8 West, NMPM, San Juan County, New Mexico, by side tracking off of the existing vertical wellbore and directionally drilling to its present unorthodox bottomhole gas well location within the Blanco-Mesaverde Pool 1224 feet from the South line and 1238 feet from the West line (Unit L) of said Section 4, is hereby approved.

(2) Blanco-Mesaverde gas production from both the existing San Juan "32-8" Unit Well No. 20-A (**API No. 30-045-24499**), located at a standard infill gas well location 1560 feet from the North line and 820 feet from the West line (Unit E) of said Section 4, and said San Juan "32-8" Unit Well No. 20, as described above, shall be attributed to the existing 320.57-acre standard gas spacing and proration unit ("GPU") comprising Lots 3 and 4, the S/2 NW/4, and the SW/4 (W/2 equivalent) of said Section 4.

(3) Jurisdiction of this cause is retained for the entry of such further orders as the Division may deem necessary.

DONE at Santa Fe, New Mexico, on the day and year hereinabove designated.

STATE OF NEW MEXICO
OIL CONSERVATION DIVISION

WILLIAM J. LEMAY

Director

S E A L

WJL/MES/kv

**cc: Oil Conservation Division - Aztec
U. S. Bureau of Land Management - Farmington**

the New Mexico Oil Conservation Commission in Case 11,274 on June 13, 1995;

- (5) As indicated by the directional survey, dated October 3, 1996, on file with the Division, the actual bottomhole location for this well within the Blanco-Mesaverde is now 1224 feet from the South line and 1238 feet from the West line (Unit L) of said Section 4; and,
- (6) It appearing the applicant has satisfied all of the appropriate requirements prescribed in said Rule 111.D and E and Rule 2(d) of said special pool rules, the subject application should be approved.

IT IS THEREFORE ORDERED THAT:

(1) The recompletion by Phillips Petroleum Company of its San Juan "32-8" Unit Well No. 20 (API No. 30-045-11025), located at a standard surface gas well location 1560 feet from the South line and 910 feet from the West line (Unit L) of Section 4, Township 31 North, Range 8 West, NMPM, San Juan County, New Mexico, by side tracking off of the existing vertical wellbore and directionally drilling to its present unorthodox bottomhole gas well location within the Blanco-Mesaverde Pool 1224 feet from the South line and 1238 feet from the West line (Unit L) of said Section 4, is hereby approved.

(2) Blanco-Mesaverde gas production from both the existing San Juan "32-8" Unit Well No. 20-A (API No. 30-045-24499), located at a standard infill gas well location 1560 feet from the North line and 820 feet from the West line (Unit E) of said Section 4, and said San Juan "32-8" Unit Well No. 20, as described above, shall be attributed to the existing 320.57-acre standard gas spacing and proration unit ("GPU") comprising Lots 3 and 4, the S/2 NW/4, and the SW/4 (W/2 equivalent) of said Section 4.

(3) Jurisdiction of this cause is retained for the entry of such further orders as the Division may deem necessary.

DONE at Santa Fe, New Mexico, on the day and year hereinabove designated.

STATE OF NEW MEXICO
OIL CONSERVATION DIVISION

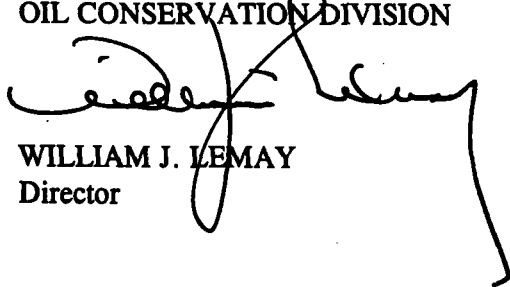
WILLIAM J. LEMAY
Director

S E A L

WJL/MES/kv

cc: Oil Conservation Division - Aztec
U. S. Bureau of Land Management - Farmington



STATE OF NEW MEXICO
ENERGY, MINERALS AND NATURAL RESOURCES DEPARTMENT

OIL CONSERVATION DIVISION
2040 S. PACHECO
SANTA FE, NEW MEXICO 87505
(505) 827-7131

July 14, 1997

Phillips Petroleum Company
5525 Highway 64 - NBU 3004
Farmington, New Mexico 87401
Attention: Patrick H. Noah

Administrative Order DD-183(NSBHL)

Dear Mr. Noah:

Reference is made to your application dated November 1, 1996 authorizing Phillips Petroleum Company's ("Phillips") recent recompletion of its San Juan "32-8" Unit Well No. 20 (API No. 30-045-11025) by side tracking off of the existing vertical wellbore and directionally drilling to a pre-determined unorthodox bottomhole gas well location in order to further develop the Blanco-Mesaverde Pool underlying the existing standard 320.57-acre gas spacing and proration unit ("GPU") comprising Lots 3 and 4, the S/2 NW/4, and the SW/4 (W/2 equivalent) of Section 4, Township 31 North, Range 8 West, NMPM, San Juan County, New Mexico.

The Division Director Finds That:

- (1) By Order No. R-8170, as amended, the Division promulgated the "*General Rules For The Prorated Gas Pools of New Mexico/Special Rules and Regulations For The Blanco-Mesaverde Pool*", which includes provisions for 320-acre gas spacing and proration units ("GPU") and well location requirements whereby the initial well drilled on a GPU shall be located be no closer than 790 feet to the outer boundary of the quarter section on which the well is located and not closer than 130 feet to any quarter-quarter section line or subdivision inner boundary and the infill well drilled on an existing GPU shall be in the quarter section not containing a Mesaverde gas well and shall be located with respect to the restrictions as previously described;
- (2) The San Juan "32-8" Unit Well No. 20, located at a standard surface gas well location 1560 feet from the South line and 910 feet from the West line (Unit L) of said Section 4, was originally drilled to and completed in the Blanco-Mesaverde Pool in 1957;
- (3) The infill well for the subject GPU is the San Juan "32-8" Unit Well No. 20-A (API No. 30-045-24499), located at a standard gas well location 1560 feet from the North line and 820 feet from the West line (Unit E) of said Section 4;
- (4) This application has been duly filed under the applicable provisions of said special pool rules and **Rules 111.D and E** of the General Rules and Regulations of the New Mexico Oil Conservation Division ("Division"), revised by Division Order No. R-10388, issued by



PHILLIPS PETROLEUM COMPANY

FARMINGTON, NEW MEXICO 87401
5525 HWY. 64 NBU 3004

November 1, 1996

State of New Mexico
Oil Conservation Division
204 South Pacheco
Santa Fe, New Mexico 87505

ATTN: MR. WILLIAM J. LEMAY

**RE: EXCEPTION FOR UNORTHODOX LOCATION AND FIELD RULES AND
ADMINISTRATIVE APPROVAL OF INTENTIONAL WELL DEVIATION
SAN JUAN 32-8 UNIT #20 WELL
SW/4 SECTION 4-T31N-R8W,
SAN JUAN COUNTY, NEW MEXICO
PHILLIPS' G.F.-5465, LCN 650120**

Gentlemen:

Phillips Petroleum Company ("Phillips"), as Operator of the San Juan 32-8 Unit, requests administrative approval of the unorthodox location of the above-described #20 Well due to intentional deviation of the well.

The San Juan 32-8 Unit #20 Well was originally drilled in 1957 and completed as a Blanco Mesaverde Pool well. Enclosed is a copy of the original plat for this well which indicates the original location of 1560' FSL and 910' FWL.

Phillips has abandoned the existing Blanco Mesaverde interval in this well, sidetracked and completed in the Blanco Mesaverde at a bottom-hole location of 1224' FSL and 1238' FWL Section 10-T31N-R8W. Enclosed are three copies of a new well location and acreage dedication plat and sub-surface directional survey confirming the well's bottom-hole location.

Copies of this request are being sent to the following offset owners:

<u>Operator Name</u>	<u>Offsetting Well</u>	<u>Location</u>
Burlington Resources	Rattlesnake Canyon #1A	E/2 Section 32-T32N-R8W
Vastar Resources Inc.	Blanco #1, #1A	E/2 Section 5-T31N-R8W
Burlington Resources	Oxnard #3	E/2 Section 8-T31N-R8W

No additional offset notifications of this request are required, as all other offset Blanco Mesaverde spacing units are within the boundaries of the San Juan 32-8 Unit.

Please advise if additional information is required.

Very truly yours,

Patrick H. Noah

Patrick H. Noah
Senior Land Specialist
San Juan Basin
(505) 599-3410

cc: J.L. Mathis (r) G.F. 5465
Ernie Busch-OC, Aztec
Vastar Resources, Inc.
Burlington Resources

NSC
DD
11/25/96

BHL-NSC

OIL CONSERVATION DIVISION
RECEIVED

NOV 5 AM 8 52

NEW MEXICO
OIL CONSERVATION COMMISSION

Form C-128

Well Location and/or Gas Proration Plat

Date April 22, 1957

Operator Pacific Northwest Pipeline Corporation Lease 32-8

Well No. 20-4 Section 4 Township 31 North Range 8 West NMPM

Located 1560 Feet From South Line, 910 Feet From West Line,

San Juan County, New Mexico. G. L. Elevation 6446

Name of Producing Formation Mesa Verde Pool Blanco Dedicated Acreage 320.57

(Note: All distances must be from outer boundaries of Section)

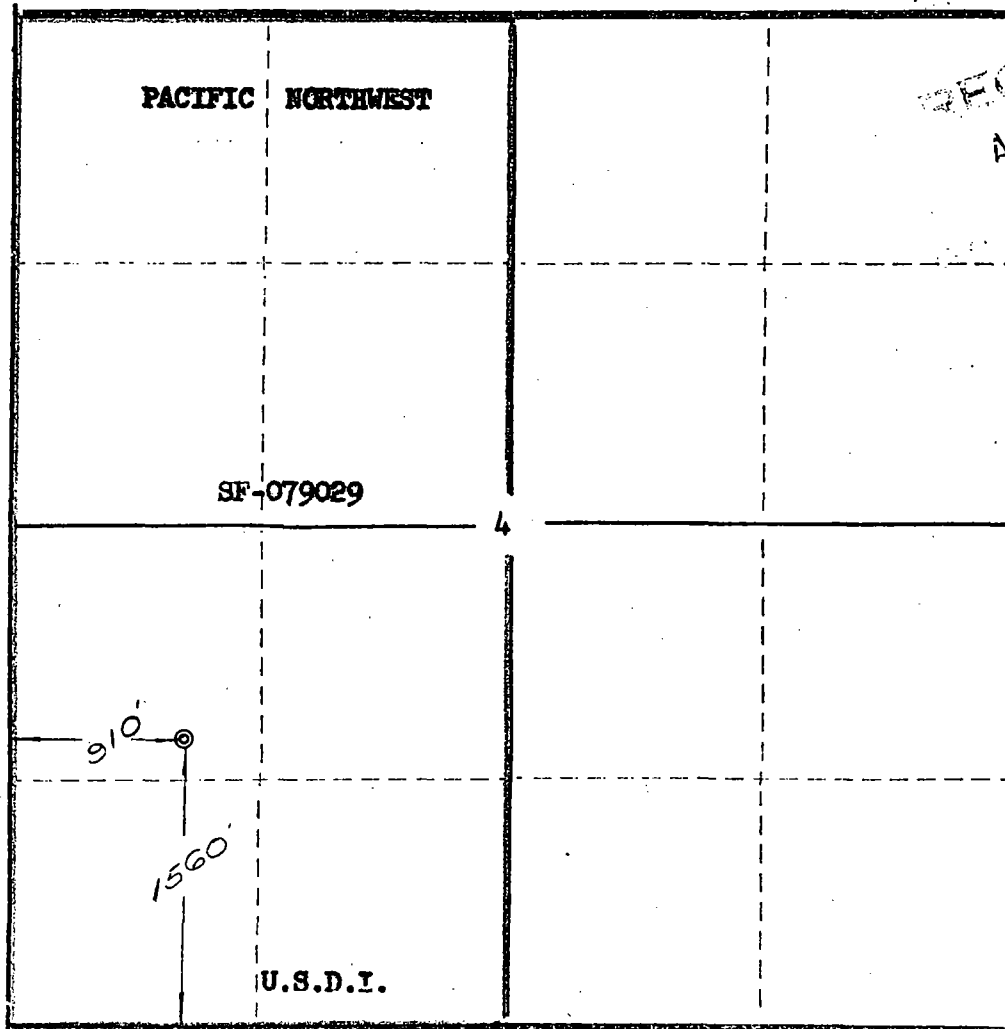

SCALE: 1" = 1000'

1. Is this Well a Dual Comp. ? Yes No
2. If the answer to Question 1 is yes, are there any other dually completed wells within the dedicated acreage?
Yes No

Name Original signed by T. A. Dugan

Position Assistant Division Manager

Representing PACIFIC NORTHWEST PIPELINE CORP.

Address 405 1/2 W. Broadway, Farmington, N.M.

This is to certify that the above plat was prepared from field notes of actual surveys made by me or under my supervision and that the same are true and correct to the best of my knowledge and belief.

Date Surveyed December 18, 1956

Ernest V. Echohawk
Reg. Land Surveyor, N. Mex., Reg. No. 1545

District I
PO Box 1980, Hobbs, NM 88241-1980
District II
811 South First, Artesia, NM 88210
District III
1000 Rio Brazos Rd., Aztec, NM 87410
District IV
2040 South Pacheco, Santa Fe, NM 87505

State of New Mexico
Energy, Minerals & Natural Resources Department

OIL CONSERVATION DIVISION
2040 South Pacheco
Santa Fe, NM 87505

Form C-102
Revised October 18, 1994
Instructions on back
Submit to Appropriate District Office
State Lease - 4 Copies
Fee Lease - 3 Copies

☐ AMENDED REPORT

WELL LOCATION AND ACREAGE DEDICATION PLAT

API Number 30-045-11025		Pool Code 72319	Pool Name Blanco Mesaverde
Property Code 009261	Property Name San Juan 32-8 Unit		Well Number #20
OGRID No. 017654	Operator Name Phillips Petroleum Company		Elevation 6446'

¹⁰ Surface Location

UL or lot no.	Section	Township	Range	Lot Idn	Feet from the	North/South line	Feet from the	East/West line	County
L	4	31N	8W		1560	South	910	West	San Juan

¹¹ Bottom Hole Location If Different From Surface

UL or lot no.	Section	Township	Range	Lot Idn	Feet from the	North/South line	Feet from the	East/West line	County
L	4	31N	8W		1224	South	1238	West	San Juan

¹² Dedicated Acres 320 acr	¹³ Joint or Infill Y	¹⁴ Consolidation Code U	¹⁵ Order No.
--	------------------------------------	---------------------------------------	-------------------------

NO ALLOWABLE WILL BE ASSIGNED TO THIS COMPLETION UNTIL ALL INTERESTS HAVE BEEN CONSOLIDATED
OR A NON-STANDARD UNIT HAS BEEN APPROVED BY THE DIVISION.

	<p>¹⁷ OPERATOR CERTIFICATION</p> <p>I hereby certify that the information contained herein is true and complete to the best of my knowledge and belief</p> <p><i>Richard Allred</i></p> <p>Signature Richard Allred</p> <p>Printed Name Prod. Superintendent</p> <p>Title 11-4-96</p> <p>Date</p>
	<p>¹⁸ SURVEYOR CERTIFICATION</p> <p>I hereby certify that the well location shown on this plat was plotted from field notes of actual surveys made by me or under my supervision, and that the same is true and correct to the best of my belief.</p> <p>October 3, 1996</p> <p>Date of Survey</p> <p>Signature and Seal of Professional Surveyer:</p> <p>Certificate Number</p>

**New Mexico Oil Conservation Division
C-102 Instructions**

IF THIS IS AN AMENDED REPORT, CHECK THE BOX LABELED "AMENDED REPORT" AT THE TOP OF THIS DOCUMENT.

Surveyors shall use the latest United States government survey or dependent resurvey. Well locations will be in reference to the New Mexico Principal Meridian. If the land is not surveyed contact the appropriate OCD district office. Independent subdivision surveys will not be acceptable.

(Note: A legal location is determined from the perpendicular distance to the edge of the tract.) If this is a high angle or horizontal hole show that portion of the well bore that is open within this pool.

Show all lots, lot numbers, and their respective acreage.

If more than one lease has been dedicated to this completion, outline each one and identify the ownership as to both working interest and royalty.

1. The OCD assigned API number for this well
2. The pool code for this (proposed) completion
3. The pool name for this (proposed) completion
4. The property code for this (proposed) completion
5. The property name (well name) for this (proposed) completion
6. The well number for this (proposed) completion
7. Operator's OGRID number
8. The operator's name
9. The ground level elevation of this well
10. The surveyed surface location of this well measured from the section lines NOTE: If the United States government survey designates a Lot Number for this location use that number in the 'UL or lot no.' box. Otherwise use the OCD unit letter.
11. Proposed bottom hole location. If this is a horizontal hole indicate the location of the end of the hole.
12. The calculated acreage dedicated to this completion to the nearest hundredth of an acre
13. Put a Y if more than one completion will be sharing this same acreage or N if this is the only completion on this acreage
14. If more than one lease of different ownership has been dedicated to the well show the consolidation code from the following table:

C	Communitization
U	Unitization
F	Forced pooling
O	Other
P	Consolidation pending

NO ALLOWABLE WILL BE ASSIGNED TO THIS COMPLETION UNTIL ALL INTERESTS HAVE BEEN CONSOLIDATED OR A NON-STANDARD UNIT HAS BEEN APPROVED BY THE DIVISION!

15. Write in the OCD order(s) approving a non-standard location, non-standard spacing, or directional or horizontal drilling
16. This grid represents a standard section. You may superimpose a non-standard section over this grid. Outline the dedicated acreage and the separate leases within that dedicated acreage. Show the well surface location and bottom hole location, if it is directionally drilled, with the dimensions from the section lines in the cardinal directions.

17. The signature, printed name, and title of the person authorized to make this report, and the date this document was signed.

18. The registered surveyors certification. This section does not have to be completed if this form has been previously accepted by the OCD and is being filed for a change of pool or dedicated acreage.



1700 Broadway Suite 1450 Denver Colorado 80290
(303) 860-0509 Fax (303) 830-2546

REPORT OF SUB-SURFACE DIRECTIONAL SURVEY

Phillips Petroleum
COMPANY

San Juan Unit 32-8 #20
WELL NAME

San Juan County, New Mexico
LOCATION

JOB NUMBER
410-80532

TYPE OF SURVEY
MSS

DATE
October 3, 1996

SURVEYED BY
Butch Judge

OFFICE
DENVER



1700 Broadway Suite 1450 Denver Colorado 80290
(303) 860-0509 Fax (303) 830-2546

SURVEY CERTIFICATION SHEET

Phillips Petroleum

410-80532

October 3, 1996

Company

Job #

Date

Sec-4-T31N-R8W

San Juan Unit 32-8 #20

San Juan County, New Mexico

Lease

Well #

County and State

Surveyed from a depth of 3,503 feet to 3,736 feet MD

Type of Survey MSS

Directional Supervisor/Surveyor Butch Judge

The data and calculations for this survey have been checked by me and conform to the standards and procedures set forth by Baker Hughes INTEQ. This report represents a true and correct Directional Survey of this well based on the original data obtained at the well site. Wellbore Coordinates are calculated using minimum curvature.

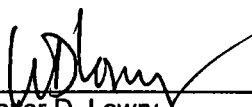

Walter D. Lowry
Sr. Drilling Engineer

This document has been subscribed and affirmed, or sworn to before me in the county of Denver, state of Colorado, this 22nd day of October, 1996.

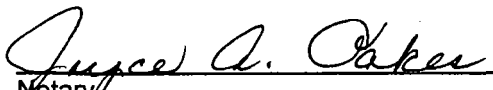
 My commission expires August 4, 2000

Notary

Certification Number: 430
Certification Date: October 22, 1996

PHILLIPS PETROLEUM

Structure : SEC.4-T31N-R8W Well : SAN JUAN UNIT 32-8 #20

Field : SAN JUAN COUNTY

Location : NEW MEXICO



WELL PROFILE DATA								
Point	MD	Inc	Dir	TVD	North	East	V. Sect	Deg/100
Tie on	0.00	0.00	120.00	0.00	0.00	0.00	0.00	0.00
KOP	3475.00	0.00	120.00	3475.00	0.00	0.00	0.00	0.00
End of Build	3875.00	20.00	120.00	3866.93	-34.55	59.85	69.11	5.00
End of Hold	3898.76	20.00	120.00	3889.25	-38.62	66.88	77.23	0.00
Target	4898.76	0.00	120.00	4869.06	-125.00	216.51	250.00	2.00
T.D. & End of Hold	5854.69	0.00	120.00	5825.00	-125.00	216.51	250.00	0.00

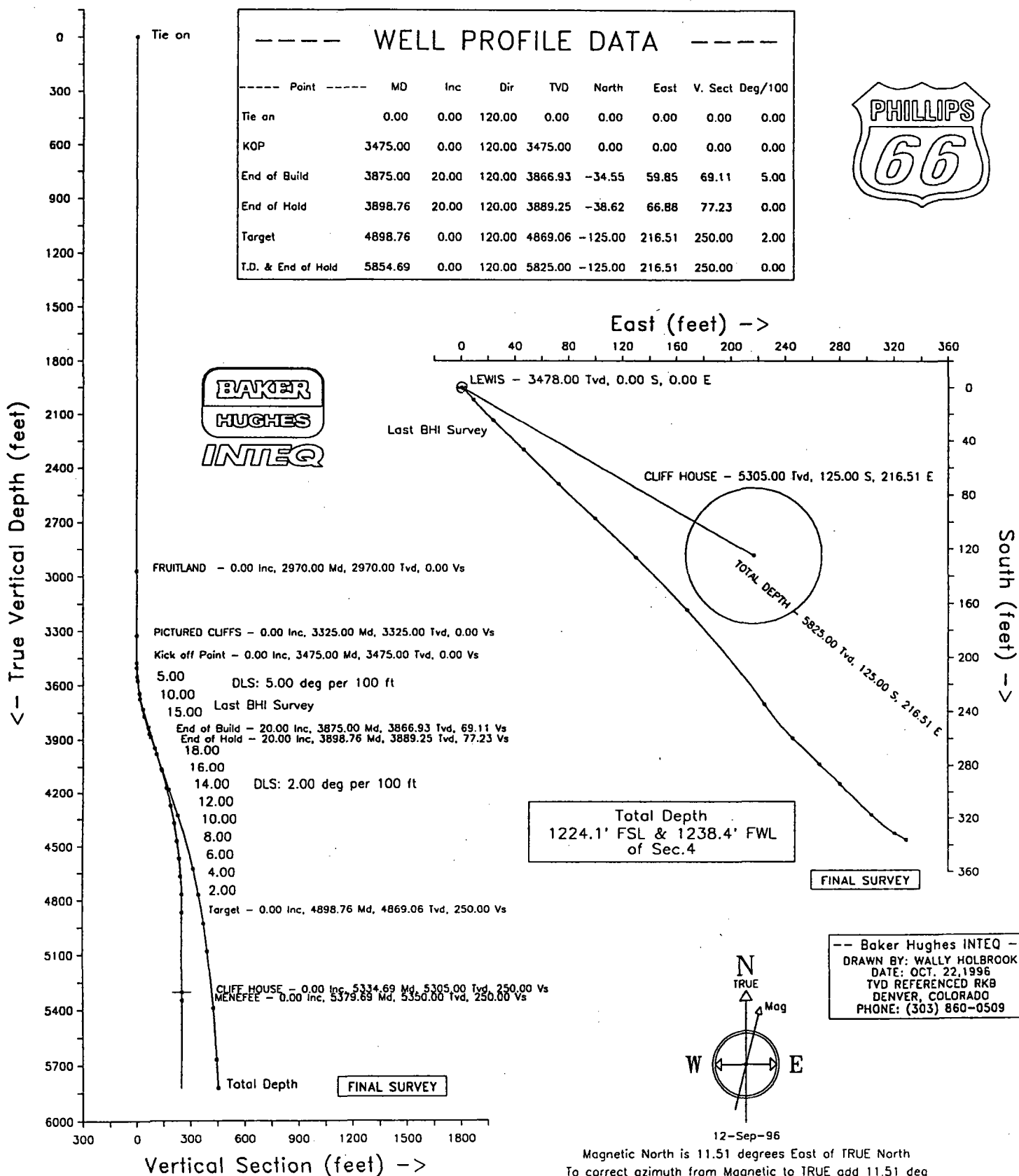

BAKER
HUGHES
INTEQ

-- Baker Hughes INTEQ --
DRAWN BY: WALLY HOLBROOK
DATE: OCT. 22, 1996
TVD REFERENCED RKB
DENVER, COLORADO
PHONE: (303) 860-0509

Azimuth 120.00 with reference 0.00 N, 0.00 E from SLOT #1

PHILLIPS PETROLEUM
SEC.4-T31N-R8W

SAN JUAN UNIT 32-8 #20
SLOT #1
SAN JUAN COUNTY
NEW MEXICO

S U R V E Y L I S T I N G

by
Baker Hughes INTEQ

Your ref : Single Shot Surveys
Our ref : svy3746
License :

Date printed : 22-Oct-96
Date created : 3-Oct-96
Last revised : 22-Oct-96

Field is centred on n36 50 0.000,w107 30 0
Structure is centred on n36 50 0.000,w107 30 0

Slot location is n36 50 15.425,w107 29 48.806
Slot Grid coordinates are N 2124326.988, E 598455.086
Slot local coordinates are 1560.00 N 910.00 E

Projection type: mercator - New Mexico West (3003), Spheroid: Clarke - 1866

Reference North is True North

PHILLIPS PETROLEUM
SEC.4-T31N-R8W,SAN JUAN UNIT 32-8 #20
SAN JUAN COUNTY,NEW MEXICO

SURVEY LISTING Page 1
Your ref : Single Shot Surveys
Last revised : 22-Oct-96

Measured Depth	Inclin. Degrees	Azimuth Degrees	True Vert Depth	R E C T A N G U L A R C O O R D I N A T E S		Dogleg Deg/100ft	Vert Sect	
0.00	0.00	0.00	0.00	0.00 N	0.00 E	0.00	0.00	
3503.00	0.00	120.00	3503.00	0.00 N	0.00 E	0.00	0.00	
3553.00	4.00	130.00	3552.96	1.12 S	1.34 E	8.00	1.72	
3646.00	10.50	140.00	3645.17	9.71 S	9.28 E	7.09	12.89	
3736.00	17.00	134.00	3732.55	25.15 S	24.03 E	7.38	33.38	Last BHI Survey
3842.00	17.50	134.50	3833.78	47.08 S	46.54 E	0.49	63.85	
3965.00	17.00	133.50	3951.25	72.42 S	72.78 E	0.47	99.24	
4086.00	19.00	132.50	4066.32	97.91 S	100.13 E	1.67	135.67	
4210.00	20.00	134.50	4183.21	126.41 S	130.14 E	0.97	175.91	
4367.00	20.00	137.50	4330.74	165.02 S	167.43 E	0.65	227.51	
4676.00	14.00	145.50	4626.15	234.86 S	224.36 E	2.08	311.73	
4826.00	11.00	133.50	4772.60	259.67 S	245.03 E	2.64	342.03	
4985.00	9.00	135.50	4929.17	278.99 S	264.75 E	1.28	368.77	
5140.00	7.00	135.50	5082.66	294.37 S	279.87 E	1.29	389.56	
5451.00	5.00	133.50	5391.94	317.22 S	302.98 E	0.65	421.00	
5730.00	4.00	122.50	5670.08	330.82 S	320.01 E	0.47	442.54	Total Depth is
5885.00	3.25	119.50	5824.77	335.89 S	328.39 E	0.50	452.34	1224.1' FSL & 1238.4' FWL

All data is in feet unless otherwise stated.
Coordinates from SLOT #1 and TVD from RKB (6458.00 Ft above mean sea level).
Bottom hole distance is 469.75 on azimuth 135.65 degrees from wellhead.
Vertical section is from wellhead on azimuth 120.00 degrees.
Calculation uses the minimum curvature method.
Presented by Baker Hughes INTEQ

PHILLIPS PETROLEUM
 SEC.4-T31N-R8W,SAN JUAN UNIT 32-8 #20
 SAN JUAN COUNTY,NEW MEXICO

SURVEY LISTING Page 2
 Your ref : Single Shot Surveys
 Last revised : 22-Oct-96

				Comments in wellpath
				=====
MD	TVD	Rectangular Coords.		Comment
3736.00	3732.55	25.15 S	24.03 E	Last BHI Survey
5730.00	5670.08	330.82 S	320.01 E	Total Depth is
5885.00	5824.77	335.89 S	328.39 E	1224.1' FSL & 1238.4' FWL

Targets associated with this wellpath				
=====				
Target name	Geographic Location	T.V.D.	Rectangular Coordinates	Revised
TGT 32-8 #20		5305.00	125.00S 216.51E	16-Aug-96

CMD :
OG5SECT

ONGARD
INQUIRE LAND BY SECTION

07/12/97 15:05:35
OGOMES -EMGB
PAGE NO: 1

Sec : 04 Twp : 31N Rng : 08W Section Type : NORMAL

4 40.30 Federal owned U	3 40.27 Federal owned U	2 40.25 Federal owned U	1 40.22 Federal owned U A A
E 40.00 Federal owned U A	F 40.00 Federal owned U	G 40.00 Federal owned U	H 40.00 Federal owned U

PF01 HELP PF02 PF03 EXIT PF04 GoTo PF05 PF06
PF07 BKWD PF08 FWD PF09 PRINT PF10 SDIV PF11 PF12

CMD :
OG5SECT

ONGARD
INQUIRE LAND BY SECTION

07/12/97 15:05:41
OGOMES -EMGB
PAGE NO: 2

Sec : 04 Twp : 31N Rng : 08W Section Type : NORMAL

L 40.00 Federal owned U A A	K 40.00 Federal owned U	J 40.00 Federal owned U	I 40.00 Federal owned U
M 40.00 Federal owned U	N 40.00 Federal owned U	O 40.00 Federal owned U	P 40.00 Federal owned U

PF01 HELP PF02 PF03 EXIT PF04 GoTo PF05 PF06
PF07 BKWD PF08 FWD PF09 PRINT PF10 SDIV PF11 PF12



PHILLIPS PETROLEUM COMPANY

FARMINGTON, NEW MEXICO 87401
5525 HWY. 64 NBU 3004

November 1, 1996

State of New Mexico
Oil Conservation Division
204 South Pacheco
Santa Fe, New Mexico 87505

ATTN: MR. WILLIAM J. LEMAY

**RE: EXCEPTION FOR UNORTHODOX LOCATION AND FIELD RULES AND
ADMINISTRATIVE APPROVAL OF INTENTIONAL WELL DEVIATION
SAN JUAN 32-8 UNIT #20 WELL
SW/4 SECTION 4-T31N-R8W,
SAN JUAN COUNTY, NEW MEXICO
PHILLIPS' G.F.-5465, LCN 650120**

Gentlemen:

Phillips Petroleum Company ("Phillips"), as Operator of the San Juan 32-8 Unit, requests administrative approval of the unorthodox location of the above-described #20 Well due to intentional deviation of the well.

The San Juan 32-8 Unit #20 Well was originally drilled in 1957 and completed as a Blanco Mesaverde Pool well. Enclosed is a copy of the original plat for this well which indicates the original location of 1560' FSL and 910' FWL.

Phillips has abandoned the existing Blanco Mesaverde interval in this well, sidetracked and completed in the Blanco Mesaverde at a bottom-hole location of 1224' FSL and 1238' FWL Section 10-T31N-R8W. Enclosed are three copies of a new well location and acreage dedication plat and sub-surface directional survey confirming the well's bottom-hole location.

Copies of this request are being sent to the following offset owners:

<u>Operator Name</u>	<u>Offsetting Well</u>	<u>Location</u>
Burlington Resources	Rattlesnake Canyon #1A	E/2 Section 32-T32N-R8W
Vastar Resources Inc.	Blanco #1, #1A	E/2 Section 5-T31N-R8W
Burlington Resources	Oxnard #3	E/2 Section 8-T31N-R8W

No additional offset notifications of this request are required, as all other offset Blanco Mesaverde spacing units are within the boundaries of the San Juan 32-8 Unit.

Please advise if additional information is required.

Very truly yours,

Patrick H. Noah
Senior Land Specialist
San Juan Basin
(505) 599-3410

cc: J.L. Mathis (r) G.F. 5465
Ernie Busch-OCD, Aztec
Vastar Resources, Inc.
Burlington Resources

NEW MEXICO
OIL CONSERVATION COMMISSION

Form C-128

Well Location and/or Gas Proration Plat

Date April 22, 1957

Operator Pacific Northwest Pipeline Corporation Lease 32-8

Well No. 20-4 Section 4 Township 31 North Range 8 West NMPM

located 1560 Feet From South Line, 910 Feet From West Line,

San Juan County, New Mexico. G. L. Elevation 6446

Name of Producing Formation Mesa Verde Pool Blanco Dedicated Acreage 320.57

(Note: All distances must be from outer boundaries of Section)

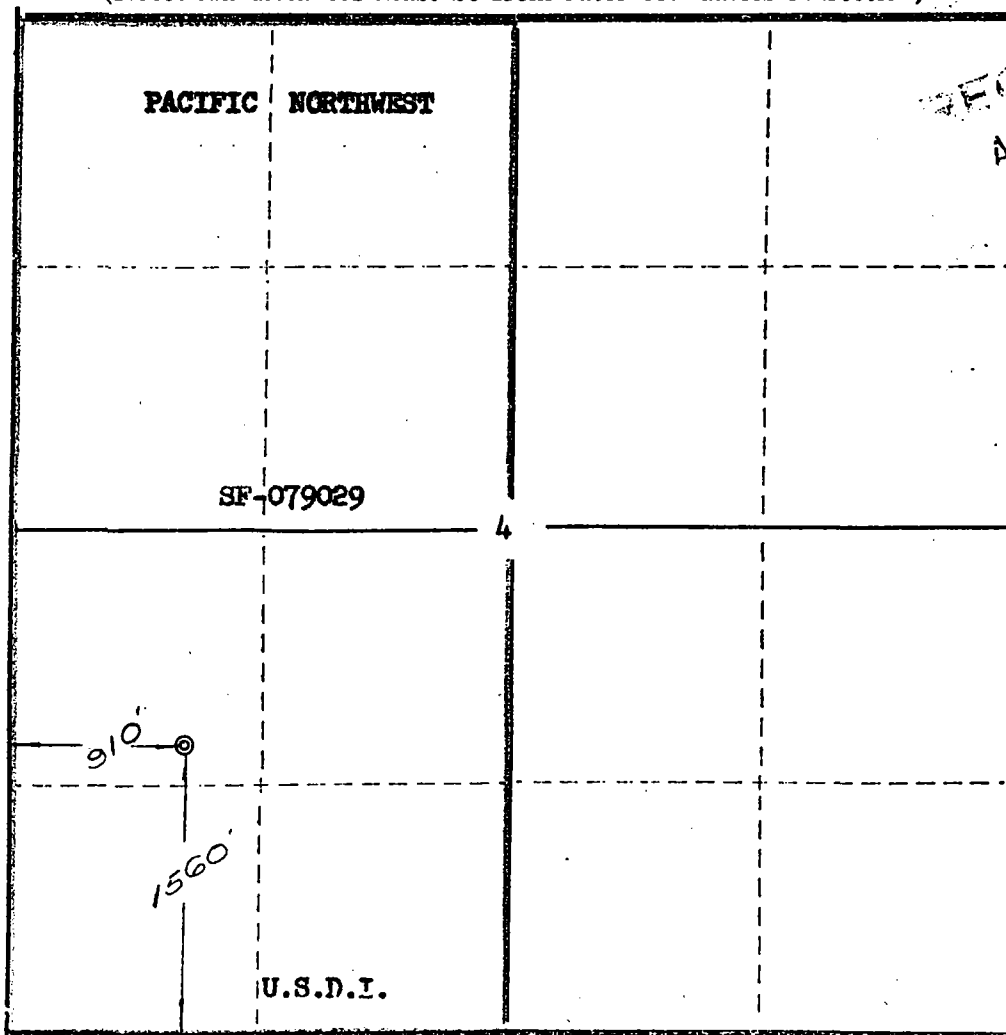

NOTE

This section of
form is to be
used for gas
wells only.

SCALE: 1" = 1000'

1. Is this Well a Dual Comp. ? Yes No
2. If the answer to Question 1 is yes, are there any other
dually completed wells within the dedicated acreage?
Yes No

Name Original signed by T. A. Dugan
Position Assistant Division Manager
Representing PACIFIC NORTHWEST PIPELINE CORP.
Address 405 1/2 W. Broadway, Farmington, N.M.

This is to certify that the above plat was prepared
from field notes of actual surveys made by me or
under my supervision and that the same are true and
correct to the best of my knowledge and belief.

Date Surveyed December 18, 1956

Ernest V. Echoshawk
Ernest V. Echoshawk
Reg. Land Surveyor, N. Mex., Reg. No. 1545

District I
PO Box 1980, Hobbs, NM 88241-1980
District II
811 South First, Artesia, NM 88210
District III
1000 Rio Brazos Rd., Aztec, NM 87410
District IV
2040 South Pacheco, Santa Fe, NM 87505

State of New Mexico
Energy, Minerals & Natural Resources Department

OIL CONSERVATION DIVISION
2040 South Pacheco
Santa Fe, NM 87505

Form C-102
Revised October 18, 1994
Instructions on back
Submit to Appropriate District Office
State Lease - 4 Copies
Fee Lease - 3 Copies

☐ AMENDED REPORT

WELL LOCATION AND ACREAGE DEDICATION PLAT

1 API Number 30-045-11025		2 Pool Code 72319		3 Pool Name Blanco Mesaverde	
4 Property Code 009261		5 Property Name San Juan 32-8 Unit			6 Well Number #20
7 OGRID No. 017654		8 Operator Name Phillips Petroleum Company			9 Elevation 6446'

10 Surface Location

UL or lot no.	Section	Township	Range	Lot Idn	Feet from the	North/South line	Feet from the	East/West line	County
L	4	31N	8W		1560	South	910	West	San Juan

11 Bottom Hole Location If Different From Surface

UL or lot no.	Section	Township	Range	Lot Idn	Feet from the	North/South line	Feet from the	East/West line	County
L	4	31N	8W		1224	South	1238	West	San Juan

12 Dedicated Acres 320 acr	13 Joint or Infill Y	14 Consolidation Code U	15 Order No.
-------------------------------	-------------------------	----------------------------	--------------

NO ALLOWABLE WILL BE ASSIGNED TO THIS COMPLETION UNTIL ALL INTERESTS HAVE BEEN CONSOLIDATED
OR A NON-STANDARD UNIT HAS BEEN APPROVED BY THE DIVISION.

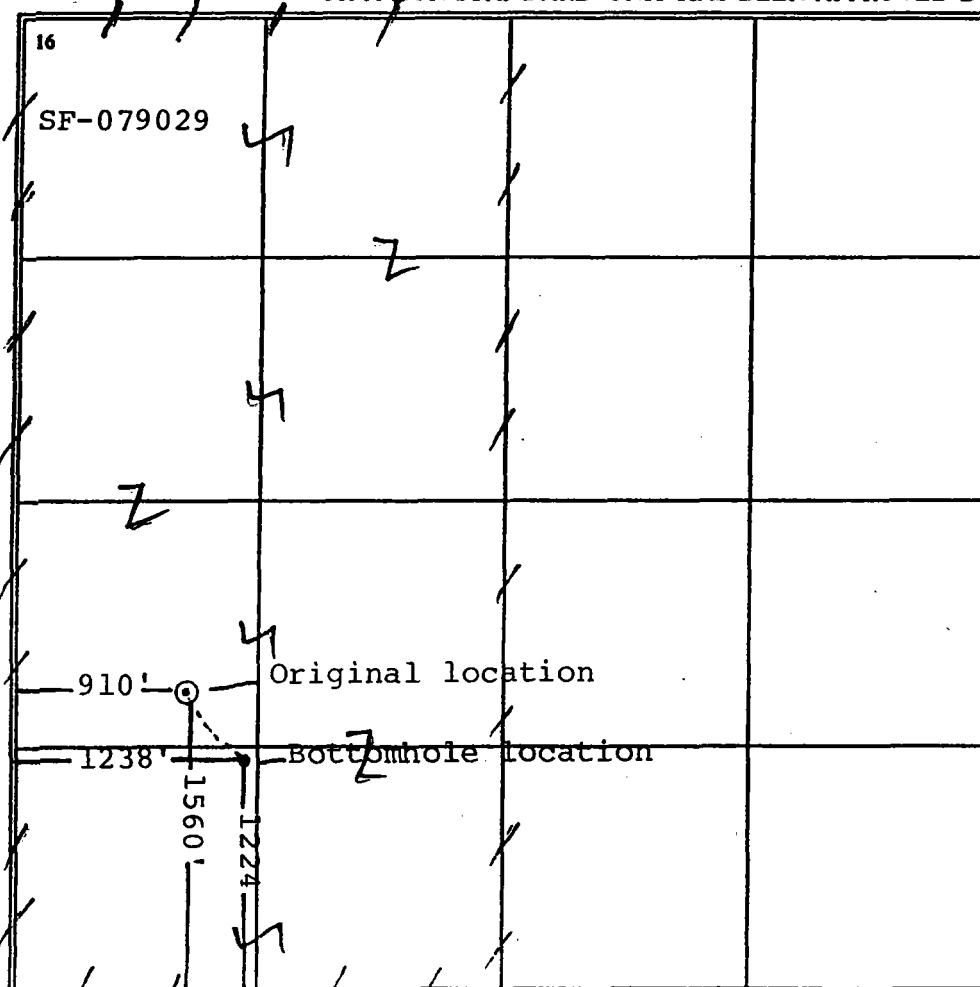

17 OPERATOR CERTIFICATION

I hereby certify that the information contained herein is true and complete to the best of my knowledge and belief

Richard Allred
Signature
Richard Allred
Printed Name
Prod. Superintendent
Title
11-4-96
Date

18 SURVEYOR CERTIFICATION

I hereby certify that the well location shown on this plat was plotted from field notes of actual surveys made by me or under my supervision, and that the same is true and correct to the best of my belief.

October 3, 1996

Date of Survey

Signature and Seal of Professional Surveyer:

Certificate Number



1700 Broadway Suite 1450 Denver Colorado 80290
(303) 860-0509 Fax (303) 830-2546

REPORT OF SUB-SURFACE DIRECTIONAL SURVEY

Phillips Petroleum
COMPANY

San Juan Unit 32-8 #20
WELL NAME

San Juan County, New Mexico
LOCATION

JOB NUMBER
410-80532

TYPE OF SURVEY
MSS

DATE
October 3, 1996

SURVEYED BY
Butch Judge

OFFICE
DENVER



1700 Broadway Suite 1450 Denver Colorado 80290
(303) 860-0509 Fax (303) 830-2546

SURVEY CERTIFICATION SHEET

Phillips Petroleum

Company

Sec-4-T31N-R8W

Lease

410-80532

Job #

San Juan Unit 32-8 #20

Well #

October 3, 1996

Date

San Juan County, New Mexico

County and State

Surveyed from a depth of 3,503 feet to 3,736 feet MD

Type of Survey MSS

Directional Supervisor/Surveyor Butch Judge

The data and calculations for this survey have been checked by me and conform to the standards and procedures set forth by Baker Hughes INTEQ. This report represents a true and correct Directional Survey of this well based on the original data obtained at the well site. Wellbore Coordinates are calculated using minimum curvature.

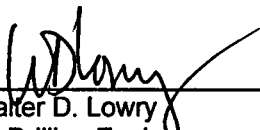

Walter D. Lowry
Sr. Drilling Engineer

This document has been subscribed and affirmed, or sworn to before me in the county of Denver, state of Colorado, this 22nd day of October, 1996.

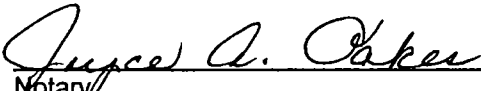

Notary My commission expires August 4, 2000

Certification Number: 430
Certification Date: October 22, 1996

PHILLIPS PETROLEUM
SEC.4-T31N-R8W

SAN JUAN UNIT 32-8 #20
SLOT #1
SAN JUAN COUNTY
NEW MEXICO

S U R V E Y L I S T I N G

by
Baker Hughes INTEQ

Your ref : Single Shot Surveys
Our ref : svy3746
License :

Date printed : 22-Oct-96
Date created : 3-Oct-96
Last revised : 22-Oct-96

Field is centred on n36 50 0.000,w107 30 0
Structure is centred on n36 50 0.000,w107 30 0

Slot location is n36 50 15.425,w107 29 48.806
Slot Grid coordinates are N 2124326.988, E 598455.086
Slot local coordinates are 1560.00 N 910.00 E

Projection type: mercator - New Mexico West (3003), Spheroid: Clarke - 1866

Reference North is True North

PHILLIPS PETROLEUM
SEC.4-T31N-R8W,SAN JUAN UNIT 32-8 #20
SAN JUAN COUNTY,NEW MEXICO

SURVEY LISTING Page 1
Your ref : Single Shot Surveys
Last revised : 22-Oct-96

Measured Depth	Inclin. Degrees	Azimuth Degrees	True Vert Depth	R E C T A N G U L A R C O O R D I N A T E S		Dogleg Deg/100ft	Vert Sect	
0.00	0.00	0.00	0.00	0.00 N	0.00 E	0.00	0.00	
3503.00	0.00	120.00	3503.00	0.00 N	0.00 E	0.00	0.00	
3553.00	4.00	130.00	3552.96	1.12 S	1.34 E	8.00	1.72	
3646.00	10.50	140.00	3645.17	9.71 S	9.28 E	7.09	12.89	
3736.00	17.00	134.00	3732.55	25.15 S	24.03 E	7.38	33.38	Last BHI Survey
3842.00	17.50	134.50	3833.78	47.08 S	46.54 E	0.49	63.85	
3965.00	17.00	133.50	3951.25	72.42 S	72.78 E	0.47	99.24	
4086.00	19.00	132.50	4066.32	97.91 S	100.13 E	1.67	135.67	
4210.00	20.00	134.50	4183.21	126.41 S	130.14 E	0.97	175.91	
4367.00	20.00	137.50	4330.74	165.02 S	167.43 E	0.65	227.51	
4676.00	14.00	145.50	4626.15	234.86 S	224.36 E	2.08	311.73	
4826.00	11.00	133.50	4772.60	259.67 S	245.03 E	2.64	342.03	
4985.00	9.00	135.50	4929.17	278.99 S	264.75 E	1.28	368.77	
5140.00	7.00	135.50	5082.66	294.37 S	279.87 E	1.29	389.56	
5451.00	5.00	133.50	5391.94	317.22 S	302.98 E	0.65	421.00	
5730.00	4.00	122.50	5670.08	330.82 S	320.01 E	0.47	442.54	Total Depth is
5885.00	3.25	119.50	5824.77	335.89 S	328.39 E	0.50	452.34	1224.1' FSL & 1238.4' FWL

All data is in feet unless otherwise stated.
Coordinates from SLOT #1 and TVD from RKB (6458.00 Ft above mean sea level).
Bottom hole distance is 469.75 on azimuth 135.65 degrees from wellhead.
Vertical section is from wellhead on azimuth 120.00 degrees.
Calculation uses the minimum curvature method.
Presented by Baker Hughes INTEQ

PHILLIPS PETROLEUM
 SEC.4-T31N-R8W,SAN JUAN UNIT 32-8 #20
 SAN JUAN COUNTY,NEW MEXICO

SURVEY LISTING Page 2
 Your ref : Single Shot Surveys
 Last revised : 22-Oct-96

				Comments in wellpath
				=====
MD	TVD	Rectangular Coords.		Comment

3736.00	3732.55	25.15 S	24.03 E	Last BHI Survey
5730.00	5670.08	330.82 S	320.01 E	Total Depth is
5885.00	5824.77	335.89 S	328.39 E	1224.1' FSL & 1238.4' FWL

Targets associated with this wellpath				
=====				
Target name	Geographic Location	T.V.D.	Rectangular Coordinates	Revised

TGT 32-8 #20		5305.00	125.00S 216.51E	16-Aug-96



PHILLIPS PETROLEUM COMPANY

FARMINGTON, NEW MEXICO 87401
5525 HWY. 64 NBU 3004

November 1, 1996

State of New Mexico
Oil Conservation Division
204 South Pacheco
Santa Fe, New Mexico 87505

ATTN: MR. WILLIAM J. LEMAY

**RE: EXCEPTION FOR UNORTHODOX LOCATION AND FIELD RULES AND
ADMINISTRATIVE APPROVAL OF INTENTIONAL WELL DEVIATION
SAN JUAN 32-8 UNIT #20 WELL
SW/4 SECTION 4-T31N-R8W,
SAN JUAN COUNTY, NEW MEXICO
PHILLIPS' G.F.-5465, LCN 650120**

Gentlemen:

Phillips Petroleum Company ("Phillips"), as Operator of the San Juan 32-8 Unit, requests administrative approval of the unorthodox location of the above-described #20 Well due to intentional deviation of the well.

The San Juan 32-8 Unit #20 Well was originally drilled in 1957 and completed as a Blanco Mesaverde Pool well. Enclosed is a copy of the original plat for this well which indicates the original location of 1560' FSL and 910' FWL.

Phillips has abandoned the existing Blanco Mesaverde interval in this well, sidetracked and completed in the Blanco Mesaverde at a bottom-hole location of 1224' FSL and 1238' FWL Section 10-T31N-R8W. Enclosed are three copies of a new well location and acreage dedication plat and sub-surface directional survey confirming the well's bottom-hole location.

Copies of this request are being sent to the following offset owners:

<u>Operator Name</u>	<u>Offsetting Well</u>	<u>Location</u>
Burlington Resources	Rattlesnake Canyon #1A	E/2 Section 32-T32N-R8W
Vastar Resources Inc.	Blanco #1, #1A	E/2 Section 5-T31N-R8W
Burlington Resources	Oxnard #3	E/2 Section 8-T31N-R8W

No additional offset notifications of this request are required, as all other offset Blanco Mesaverde spacing units are within the boundaries of the San Juan 32-8 Unit.

Please advise if additional information is required.

Very truly yours,

Patrick H. Noah
Senior Land Specialist
San Juan Basin
(505) 599-3410

cc: J.L. Mathis (r) G.F. 5465
Ernie Busch-OCD, Aztec
Vastar Resources, Inc.
Burlington Resources

NEW MEXICO
OIL CONSERVATION COMMISSION

Form C-128

Well Location and/or Gas Proration Plat

Date April 22, 1957

Operator Pacific Northwest Pipeline Corporation Lease 32-8

Well No. 20-4 Section 4 Township 31 North Range 8 West NMPM

located 1560 Feet From South Line, 910 Feet From West Line,

San Juan County, New Mexico. G. L. Elevation 6446

Name of Producing Formation Mesa Verde Pool Blanco Dedicated Acreage 320.57

(Note: All distances must be from outer boundaries of Section)

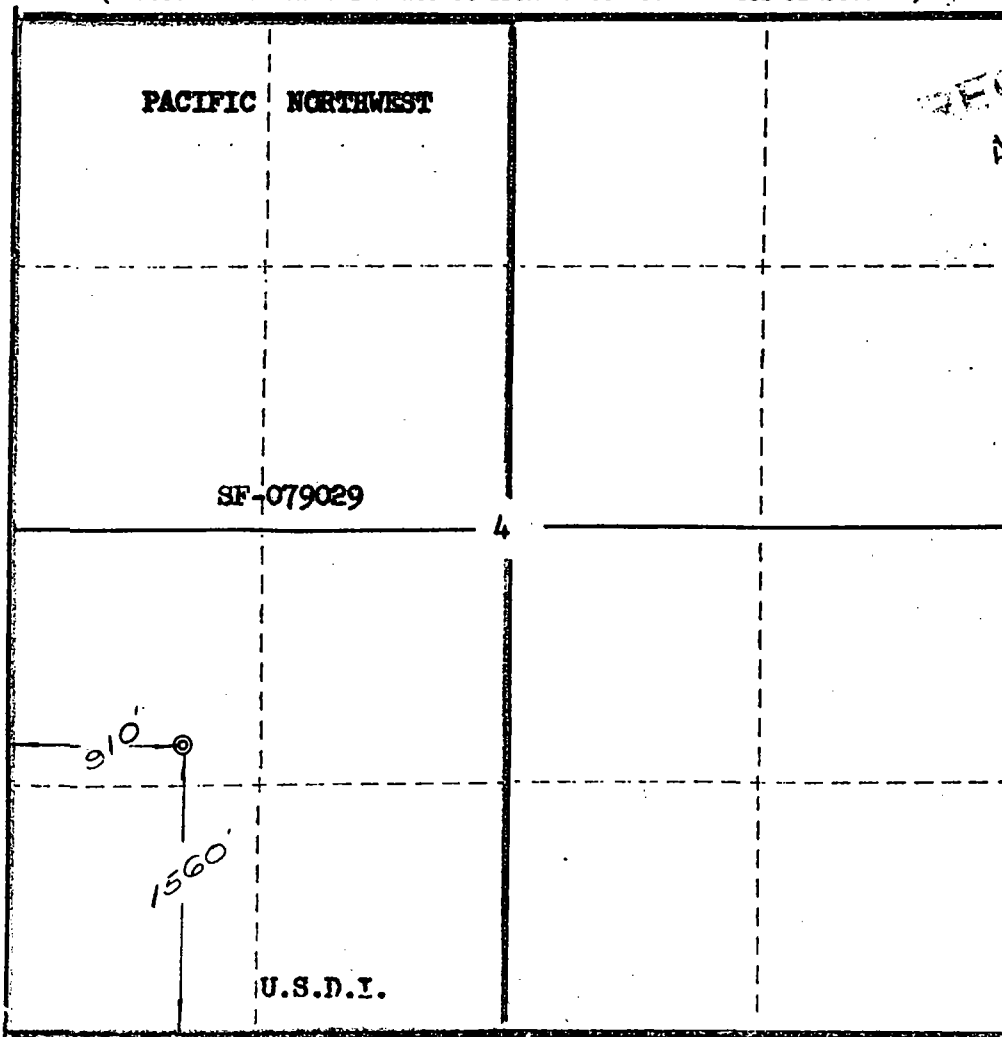

NOTE

This section of
form is to be
used for gas
wells only.

SCALE: 1" = 1000'

1. Is this Well a Dual Comp. ? Yes No
2. If the answer to Question 1 is yes, are there any other
dually completed wells within the dedicated acreage?
Yes No

Name Original signed by T. A. Dugan
Position Assistant Division Manager
Representing PACIFIC NORTHWEST PIPELINE CORP.
Address 405 1/2 W. Broadway, Farmington, N.M.

This is to certify that the above plat was prepared
from field notes of actual surveys made by me or
under my supervision and that the same are true and
correct to the best of my knowledge and belief.

Date Surveyed December 18, 1956

Ernest V. Echohawk
Reg. Land Surveyor, N. Mex., Reg. No. 1545

District I
PO Box 1980, Hobbs, NM 88241-1980
District II
811 South First, Artesia, NM 88210
District III
1000 Rio Brazos Rd., Aztec, NM 87410
District IV
2040 South Pacheco, Santa Fe, NM 87505

State of New Mexico
Energy, Minerals & Natural Resources Department

OIL CONSERVATION DIVISION
2040 South Pacheco
Santa Fe, NM 87505

Form C-102
Revised October 18, 1994
Instructions on back
Submit to Appropriate District Office
State Lease - 4 Copies
Fee Lease - 3 Copies

☐ AMENDED REPORT

WELL LOCATION AND ACREAGE DEDICATION PLAT

1 API Number 30-045-11025		2 Pool Code 72319		3 Pool Name Blanco Mesaverde	
4 Property Code 009261		5 Property Name San Juan 32-8 Unit			6 Well Number #20
7 OGRID No. 017654		8 Operator Name Phillips Petroleum Company			9 Elevation 6446'

10 Surface Location

UL or lot no.	Section	Township	Range	Lot Idn	Feet from the	North/South line	Feet from the	East/West line	County
L	4	31N	8W		1560	South	910	West	San Juan

11 Bottom Hole Location If Different From Surface

UL or lot no.	Section	Township	Range	Lot Idn	Feet from the	North/South line	Feet from the	East/West line	County
L	4	31N	8W		1224	South	1238	West	San Juan

12 Dedicated Acres 320 acr	13 Joint or Infill Y	14 Consolidation Code U	15 Order No.
-------------------------------	-------------------------	----------------------------	--------------

NO ALLOWABLE WILL BE ASSIGNED TO THIS COMPLETION UNTIL ALL INTERESTS HAVE BEEN CONSOLIDATED
OR A NON-STANDARD UNIT HAS BEEN APPROVED BY THE DIVISION.

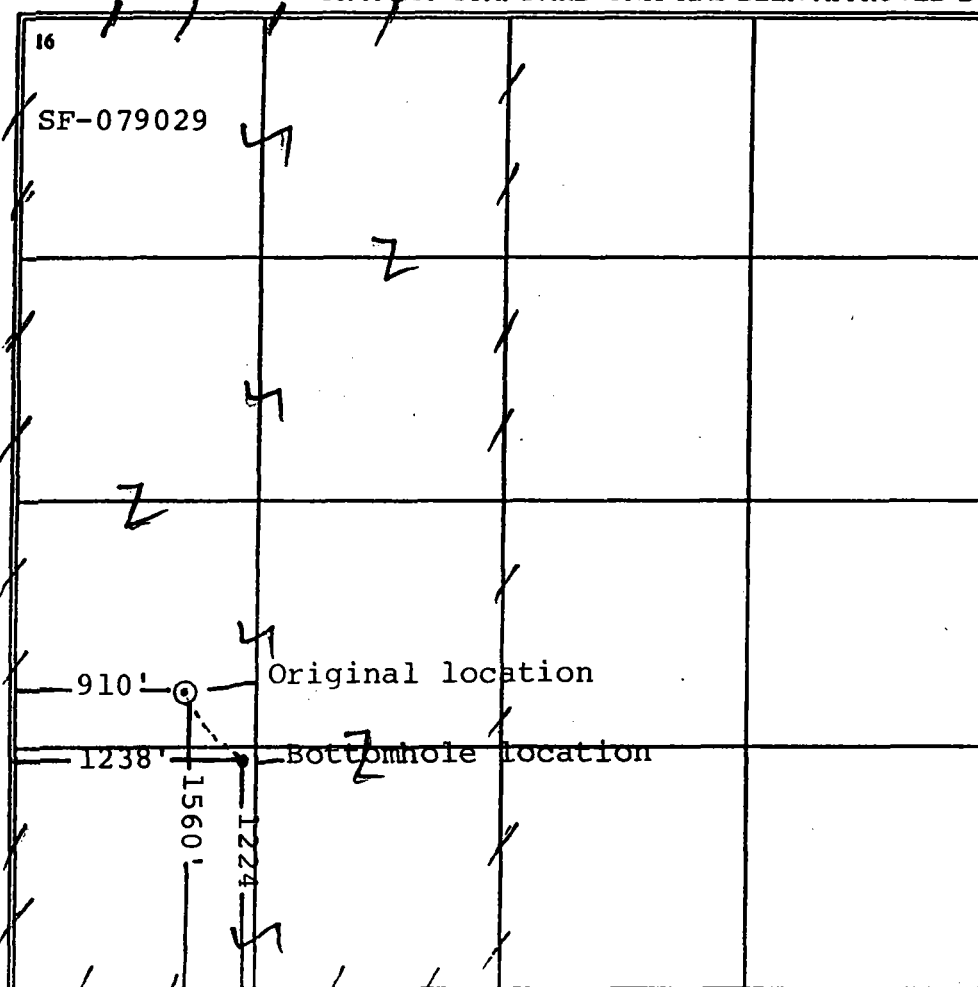

17 OPERATOR CERTIFICATION

I hereby certify that the information contained herein is true and complete to the best of my knowledge and belief

Richard Allred
Signature
Richard Allred
Printed Name
Prod. Superintendent
Title
11-4-96
Date

18 SURVEYOR CERTIFICATION

I hereby certify that the well location shown on this plat was plotted from field notes of actual surveys made by me or under my supervision, and that the same is true and correct to the best of my belief.

October 3, 1996

Date of Survey
Signature and Seal of Professional Surveyer:

Certificate Number



1700 Broadway Suite 1450 Denver Colorado 80290
(303) 860-0509 Fax (303) 830-2546

REPORT OF SUB-SURFACE DIRECTIONAL SURVEY

Phillips Petroleum
COMPANY

San Juan Unit 32-8 #20
WELL NAME

San Juan County, New Mexico
LOCATION

JOB NUMBER
410-80532

TYPE OF SURVEY
MSS

DATE
October 3, 1996

SURVEYED BY
Butch Judge

OFFICE
DENVER



1700 Broadway Suite 1450 Denver Colorado 80290
(303) 860-0509 Fax (303) 830-2546

SURVEY CERTIFICATION SHEET

Phillips Petroleum

Company

Sec-4-T31N-R8W

Lease

410-80532

Job #

San Juan Unit 32-8 #20

Well #

October 3, 1996

Date

San Juan County, New Mexico

County and State

Surveyed from a depth of 3,503 feet to 3,736 feet MD

Type of Survey MSS

Directional Supervisor/Surveyor Butch Judge

The data and calculations for this survey have been checked by me and conform to the standards and procedures set forth by Baker Hughes INTEQ. This report represents a true and correct Directional Survey of this well based on the original data obtained at the well site. Wellbore Coordinates are calculated using minimum curvature.



Walter D. Lowry
Sr. Drilling Engineer

This document has been subscribed and affirmed, or sworn to before me in the county of Denver, state of Colorado, this 22nd day of October, 1996.



Notary My commission expires August 4, 2000

Certification Number: 430
Certification Date: October 22, 1996

PHILLIPS PETROLEUM
SEC.4-T31N-R8W

SAN JUAN UNIT 32-8 #20
SLOT #1
SAN JUAN COUNTY
NEW MEXICO

S U R V E Y L I S T I N G

by
Baker Hughes INTEQ

Your ref : Single Shot Surveys
Our ref : svy3746
License :

Date printed : 22-Oct-96
Date created : 3-Oct-96
Last revised : 22-Oct-96

Field is centred on n36 50 0.000,w107 30 0
Structure is centred on n36 50 0.000,w107 30 0

Slot location is n36 50 15.425,w107 29 48.806
Slot Grid coordinates are N 2124326.988, E 598455.086
Slot local coordinates are 1560.00 N 910.00 E

Projection type: mercator - New Mexico West (3003), Spheroid: Clarke - 1866

Reference North is True North

PHILLIPS PETROLEUM
SEC.4-T31N-R8W,SAN JUAN UNIT 32-8 #20
SAN JUAN COUNTY,NEW MEXICO

SURVEY LISTING Page 1
Your ref : Single Shot Surveys
Last revised : 22-Oct-96

Measured Depth	Inclin. Degrees	Azimuth Degrees	True Vert Depth	R E C T A N G U L A R C O O R D I N A T E S		Dogleg Deg/100ft	Vert Sect
0.00	0.00	0.00	0.00	0.00 N	0.00 E	0.00	0.00
3503.00	0.00	120.00	3503.00	0.00 N	0.00 E	0.00	0.00
3553.00	4.00	130.00	3552.96	1.12 S	1.34 E	8.00	1.72
3646.00	10.50	140.00	3645.17	9.71 S	9.28 E	7.09	12.89
3736.00	17.00	134.00	3732.55	25.15 S	24.03 E	7.38	33.38 Last BHI Survey
3842.00	17.50	134.50	3833.78	47.08 S	46.54 E	0.49	63.85
3965.00	17.00	133.50	3951.25	72.42 S	72.78 E	0.47	99.24
4086.00	19.00	132.50	4066.32	97.91 S	100.13 E	1.67	135.67
4210.00	20.00	134.50	4183.21	126.41 S	130.14 E	0.97	175.91
4367.00	20.00	137.50	4330.74	165.02 S	167.43 E	0.65	227.51
4676.00	14.00	145.50	4626.15	234.86 S	224.36 E	2.08	311.73
4826.00	11.00	133.50	4772.60	259.67 S	245.03 E	2.64	342.03
4985.00	9.00	135.50	4929.17	278.99 S	264.75 E	1.28	368.77
5140.00	7.00	135.50	5082.66	294.37 S	279.87 E	1.29	389.56
5451.00	5.00	133.50	5391.94	317.22 S	302.98 E	0.65	421.00
5730.00	4.00	122.50	5670.08	330.82 S	320.01 E	0.47	442.54 Total Depth is
5885.00	3.25	119.50	5824.77	335.89 S	328.39 E	0.50	452.34 1224.1' FSL & 1238.4' FWL

All data is in feet unless otherwise stated.
Coordinates from SLOT #1 and TVD from RKB (6458.00 Ft above mean sea level).
Bottom hole distance is 469.75 on azimuth 135.65 degrees from wellhead.
Vertical section is from wellhead on azimuth 120.00 degrees.
Calculation uses the minimum curvature method.
Presented by Baker Hughes INTEQ

PHILLIPS PETROLEUM
 SEC.4-T31N-R8W,SAN JUAN UNIT 32-8 #20
 SAN JUAN COUNTY,NEW MEXICO

SURVEY LISTING Page 2
 Your ref : Single Shot Surveys
 Last revised : 22-Oct-96

				Comments in wellpath =====
MD	TVD	Rectangular Coords.		Comment
3736.00	3732.55	25.15 S	24.03 E	Last BHI Survey
5730.00	5670.08	330.82 S	320.01 E	Total Depth is
5885.00	5824.77	335.89 S	328.39 E	1224.1' FSL & 1238.4' FWL

Targets associated with this wellpath =====				
Target name	Geographic Location	T.V.D.	Rectangular Coordinates	Revised
TGT 32-8 #20		5305.00	125.00S 216.51E	16-Aug-96