

NEW MEXICO OIL CONSERVATION DIVISION

P. O. BOX 2088

SANTA FE, NEW MEXICO 87501

ADMINISTRATIVE ORDER

NGPA- 26

EXEMPTION FROM THE NATURAL GAS PRICING ACT
PURSUANT TO SECTION 62-7-5, NMSA 1978, AND
DIVISION ORDER NO. R-5436

OPERATOR Supron Energy Corp. WELL NAME AND NO. Jicarilla "G" Well No. 4-E
LOCATION: UNIT E SEC. 11 TWP. 26N RNG. 5W COUNTY Rio Arriba

THE DIRECTOR OF THE DIVISION FINDS:

- (1) That Section 5 of the Natural Gas Pricing Act (being Secs. 62-7-1 to 62-7-10, NMSA 1978) provides that the Natural Gas Pricing Act shall not apply to the production and sale of natural gas in intrastate commerce from a well the drilling of or first intrastate sale of which commenced on or after January 1, 1975, provided however, that the Act shall apply to such a well if it is drilled within an established proration unit which was producing or capable of producing natural gas prior to January 1, 1975, from the same reservoir unless the Oil Conservation Division exempts such well upon a finding that such new well was justified for reasons other than avoiding the application to the Natural Gas Pricing Act.
- (2) That by Order No. R-5436, dated June 8, 1977, the Division established an administrative procedure whereby the Director of the Division is empowered to act for the Division and exempt gas wells from the provisions of Section 5 of the Natural Gas Pricing Act provided said wells were drilled on or after January 1, 1975, within established proration units which were producing or capable of producing natural gas from the same reservoir prior to January 1, 1975.
- (3) That to qualify for such exemption, under said Order No. R-5436, a gas well must be classified either as a replacement well or as an infill well.
- (4) That pursuant to Order No. R-5436, the Director of the Division may find that a replacement well is justified for reasons other than avoiding the pricing provisions of the Natural Gas Pricing Act upon a showing by the operator that:
- (a) The well was necessary to replace a well lost due to economically irreparable down-hole mechanical failure or formation damage; or that
 - (b) the well was necessary to replace a well producing at non-commercial rates; or that
 - (c) the drilling of the well commenced prior to January 18, 1977.
- (5) That pursuant to Order No. R-5436, the Director of the Division may find that an infill well is justified for reasons other than avoiding the pricing provisions of the Natural Gas Pricing Act upon a showing by the operator that:
- (a) the well was drilled in a pool where the Division, after notice and hearing, has issued an order finding that infill drilling in such pool will increase the recoverable reserves under the various proration units in such pool, will result in more efficient use of reservoir energy, and will tend to ensure greater ultimate recovery of gas from the pool; or that
 - (b) the well is necessary to protect the proration unit from uncompensated drainage or to protect correlative rights; or that
 - (c) the drilling of the well commenced prior to January 18, 1977.
- (6) That the applicant herein Supron Energy Corp. has requested exemption from the provisions of the Natural Gas Pricing Act pursuant to Section 62-7-5, NMSA 1978, and Division Order No. R-5436 for the above-named well.
- (7) That all the requirements of said Order No. R-5436 have been complied with, and that said well is justified for exemption from the provisions of the Natural Gas Pricing Act inasmuch as said well was not drilled for the purpose of avoiding the application of said act, but was in fact:
- () A Replacement Well
 - () necessary to replace a well lost due to economically irreparable down-hole mechanical failure or formation damage.
 - () necessary to replace a well producing at non-commercial rates.
 - () a well the drilling of which commenced prior to January 18, 1977.
 - (X) An Infill Well
 - (X) drilled in a pool where the Division, after notice and hearing, has issued an order finding that infill drilling in such pool will increase the recoverable reserves under the various proration units in the pool, will result in more efficient use of reservoir energy, and will tend to ensure greater ultimate recovery of gas from the pool, said pool being the Basin Dakota Gas Pool and the order being Division Order No. R- 1670-V.
 - () necessary to protect the proration unit from uncompensated drainage or to protect correlative rights.
 - () a well the drilling of which commenced prior to January 18, 1977.

IT IS THEREFORE ORDERED:

- (1) That the above-named well is hereby exempted from Section 5 of the Natural Gas Pricing Act (Secs. 62-7-1 to 62-7-10, NMSA 1978).
- (2) That jurisdiction of this cause is hereby retained, and that this exemption is subject to rescission upon failure to comply with the provisions of Rule 6(d) or Rule 7(c) of Division Order No. R-5436 or for other good cause shown.
- DONE at Santa Fe, New Mexico on this 14th day of April, 1981.

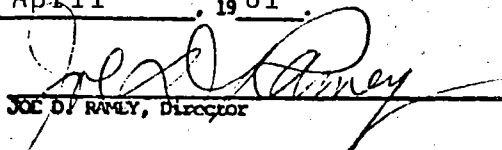
JOE D. RAMEY, Director

NEW MEXICO OIL CONSERVATION DIVISION

P. O. BOX 2088

SANTA FE, NEW MEXICO 87501

ADMINISTRATIVE ORDER

NGPA- 26

EXEMPTION FROM THE NATURAL GAS PRICING ACT
PURSUANT TO SECTION 62-7-5, NMSA 1978, AND
DIVISION ORDER NO. R-5436

OPERATOR Supron Energy Corp WELL NAME AND NO. Jicarilla "G" No 4-E
 LOCATION: UNIT E SEC. 11 TWP. 26 N RGE. 5 W COUNTY B. o. Arriba

THE DIRECTOR OF THE DIVISION FINDS:

(1) That Section 5 of the Natural Gas Pricing Act (being Secs. 62-7-1 to 62-7-10, NMSA 1978) provides that the Natural Gas Pricing Act shall not apply to the production and sale of natural gas in intrastate commerce from a well the drilling of or first intrastate sale of which commenced on or after January 1, 1975, provided however, that the Act shall apply to such a well if it is drilled within an established proration unit which was producing or capable of producing natural gas prior to January 1, 1975, from the same reservoir unless the Oil Conservation Division exempts such well upon a finding that such new well was justified for reasons other than avoiding the application to the Natural Gas Pricing Act.

(2) That by Order No. R-5436, dated June 8, 1977, the Division established an administrative procedure whereby the Director of the Division is empowered to act for the Division and exempt gas wells from the provisions of Section 5 of the Natural Gas Pricing Act provided said wells were drilled on or after January 1, 1975, within established proration units which were producing or capable of producing natural gas from the same reservoir prior to January 1, 1975.

(3) That to qualify for such exemption, under said Order No. R-5436, a gas well must be classified either as a replacement well or as an infill well.

(4) That pursuant to Order No. R-5436, the Director of the Division may find that a replacement well is justified for reasons other than avoiding the pricing provisions of the Natural Gas Pricing Act upon a showing by the operator that:

- (a) The well was necessary to replace a well lost due to economically irreparable down-hole mechanical failure or formation damage; or that
- (b) the well was necessary to replace a well producing at non-commercial rates; or that
- (c) the drilling of the well commenced prior to January 18, 1977.

(5) That pursuant to Order No. R-5436, the Director of the Division may find that an infill well is justified for reasons other than avoiding the pricing provisions of the Natural Gas Pricing Act upon a showing by the operator that:

- (a) the well was drilled in a pool where the Division, after notice and hearing, has issued an order finding that infill drilling in such pool will increase the recoverable reserves under the various proration units in such pool, will result in more efficient use of reservoir energy, and will tend to ensure greater ultimate recovery of gas from the pool; or that
- (b) the well is necessary to protect the proration unit from uncompensated drainage or to protect correlative rights; or that
- (c) the drilling of the well commenced prior to January 18, 1977.

(6) That the applicant herein Supron Energy Corp has requested exemption from the provisions of the Natural Gas Pricing Act pursuant to Section 62-7-5, NMSA 1978, and Division Order No. R-5436 for the above-named well.

(7) That all the requirements of said Order No. R-5436 have been complied with, and that said well is justified for exemption from the provisions of the Natural Gas Pricing Act inasmuch as said well was not drilled for the purpose of avoiding the application of said act, but was in fact:

() A Replacement Well

- () necessary to replace a well lost due to economically irreparable down-hole mechanical failure or formation damage.
- () necessary to replace a well producing at non-commercial rates.
- () a well the drilling of which commenced prior to January 18, 1977.

(X) An Infill Well

- (X) drilled in a pool where the Division, after notice and hearing, has issued an order finding that infill drilling in such pool will increase the recoverable reserves under the various proration units in the pool, will result in more efficient use of reservoir energy, and will tend to ensure greater ultimate recovery of gas from the pool, said pool being the Basin Dakota Gas Pool and the order being Division Order No. R- 1620-V.

- () necessary to protect the proration unit from uncompensated drainage or to protect correlative rights.
- () a well the drilling of which commenced prior to January 18, 1977.

IT IS THEREFORE ORDERED:

(1) That the above-named well is hereby exempted from Section 5 of the Natural Gas Pricing Act (Secs. 62-7-1 to 62-7-10, NMSA 1978).

(2) That jurisdiction of this cause is hereby retained, and that this exemption is subject to rescission upon failure to comply with the provisions of Rule 6(d) or Rule 7(c) of Division Order No. R-5436 or for other good cause shown.

DONE at Santa Fe, New Mexico on this _____ day of _____, 19 ____.

JOE D. RAMLEY, Director

SUPRON ENERGY CORPORATION

Bldg. V, Fifth Floor
10300 North Central Expressway
Dallas, Texas 75231

WILLIAM S. JAMESON
SENIOR VICE PRESIDENT
GENERAL COUNSEL & SECRETARY

April 2, 1981

TELEPHONE (214) 691-9141
TWX: (910) 861-9117
SUPCO-DAL

Director
New Mexico Oil Conservation Division
P. O. Box 2088
Santa Fe, New Mexico 87501

Re: Application for Exemption from the Provisions
of Section 6 of the Natural Gas Pricing Act
Supron Energy Corporation's Jicarilla "G" 4-E
(Basin Dakota), Sec. 11, T26N, R5W,
Rio Arriba County, New Mexico

Dear Sir:

Pursuant to the provisions of the New Mexico Oil Conservation Division Order No. R-5436, Supron Energy Corporation hereby submits its application for a determination under Section 6 of the New Mexico Gas Pricing Act that the above well is justified for reasons other than avoiding the application of the New Mexico Gas Pricing Act.

The above captioned well was located and drilled as an "infill" well in a particular gas pool pursuant to an Oil Conservation Division order finding that such well will increase the recoverable reserves under the applicable proration unit and will result in more efficient use of reservoir energy and will tend to ensure greater ultimate recovery of gas from the pool. The applicable Division Order No. for the Dakota pool is R1670-V.

Transmitted herewith in support of the application is a plat of the area showing the proration unit in question, the location of the above referenced well and the ownership and location of all wells on direct or diagonally offsetting proration units.

Submitted herewith is a copy of the following data which shows the date on which the drilling of the captioned well was commenced:

1. Application for Permit to Drill;
2. Sundry Notices with respect to the captioned well; and
3. Well Completion Report.

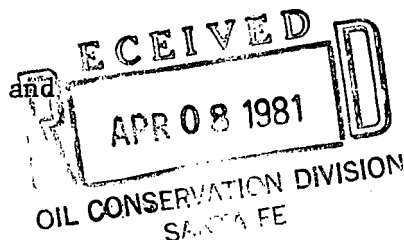

New Mexico Oil Conservation Division
April 2, 1981
Page 2

Supron Energy Corporation hereby certifies that the pre-existing well on the Dakota formation proration unit applicable to the captioned well will not have its ability to produce into the pipeline restricted in any manner.

A copy of this application and the related material submitted in support thereof has this day been forwarded to the District Office of the New Mexico Oil Conservation Division in Aztec, New Mexico.

Very truly yours,

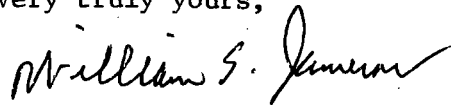

William S. Jameson
Senior Vice President,
General Counsel & Secretary

WSJ:cb

Enclosures

cc: New Mexico Oil Conservation Division
1000 Rio Brazos Road
Aztec, New Mexico 87410

Gas Company of New Mexico
First International Building
Suite 1800
Dallas, Texas 75270
(w/copy of encls.)

Southland Royalty Company
1000 Fort Worth Club Tower
Fort Worth, Texas 76102
(w/copy of encls.)

OFFICE OF THE ATTORNEY GENERAL

WELL: JICARILLA "G" No. 4-E

LOCATION: 1800 feet from the North line and 630 feet from the West line of Section 11, Township 26 North, Range 5 West, N.M.P.M., Rio Arriba County, New Mexico.

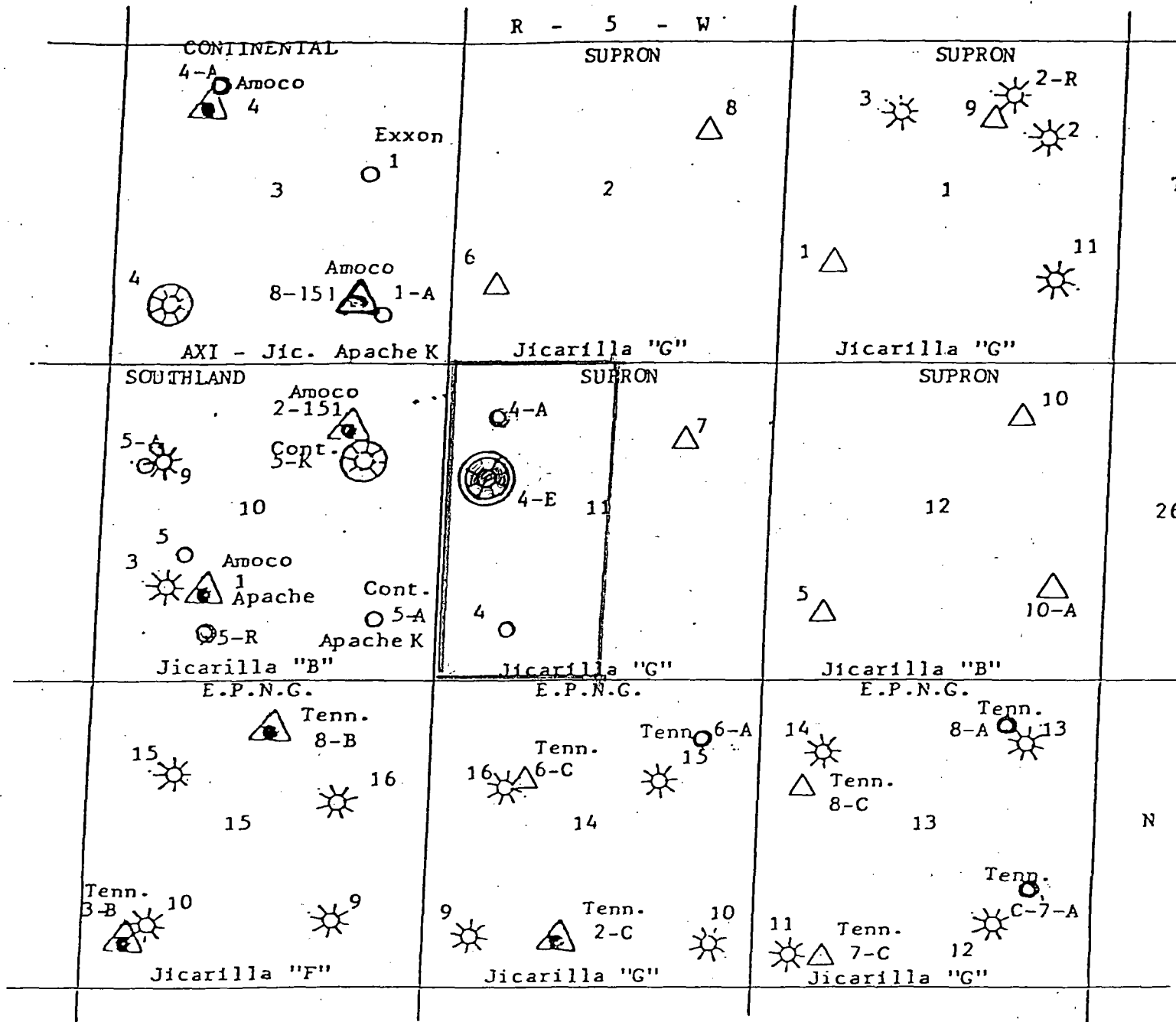

Proposed Dakota



Mesaverde.



Pictured Cliffs



Dakota



Dakota - Mesaverde Dual



Pictured Cliffs - Mesaverde Dual

All distances must be from the outer boundaries of the Section.

Operator SUPRON ENERGY CORPORATION			Lease JICARILLA G		Well No. #4-E
Unit Letter E	Section 11	Township 26 NORTH	Range 5 WEST	County RIO ARriba	
Actual Postage Location of Well:					
1800 feet from the NORTH line and		630 feet from the WEST line			
Ground Level Elev. 7256	Producing Formation DAKOTA		Pool BASIN	Dedicated Acreage W/2 320 Acres	

1. Outline the acreage dedicated to the subject well by colored pencil or hatchure marks on the plat below.
2. If more than one lease is dedicated to the well, outline each and identify the ownership thereof (both as to working interest and royalty).
3. If more than one lease of different ownership is dedicated to the well, have the interests of all owners been consolidated by communitization, unitization, force-pooling, etc?

☐ Yes ☐ No If answer is "yes," type of consolidation _____

If answer is "no," list the owners and tract descriptions which have actually been consolidated. (Use reverse side of this form if necessary.) _____

No allowable will be assigned to the well until all interests have been consolidated (by communitization, unitization, forced-pooling, or otherwise) or until a non-standard unit, eliminating such interests, has been approved by the Division.

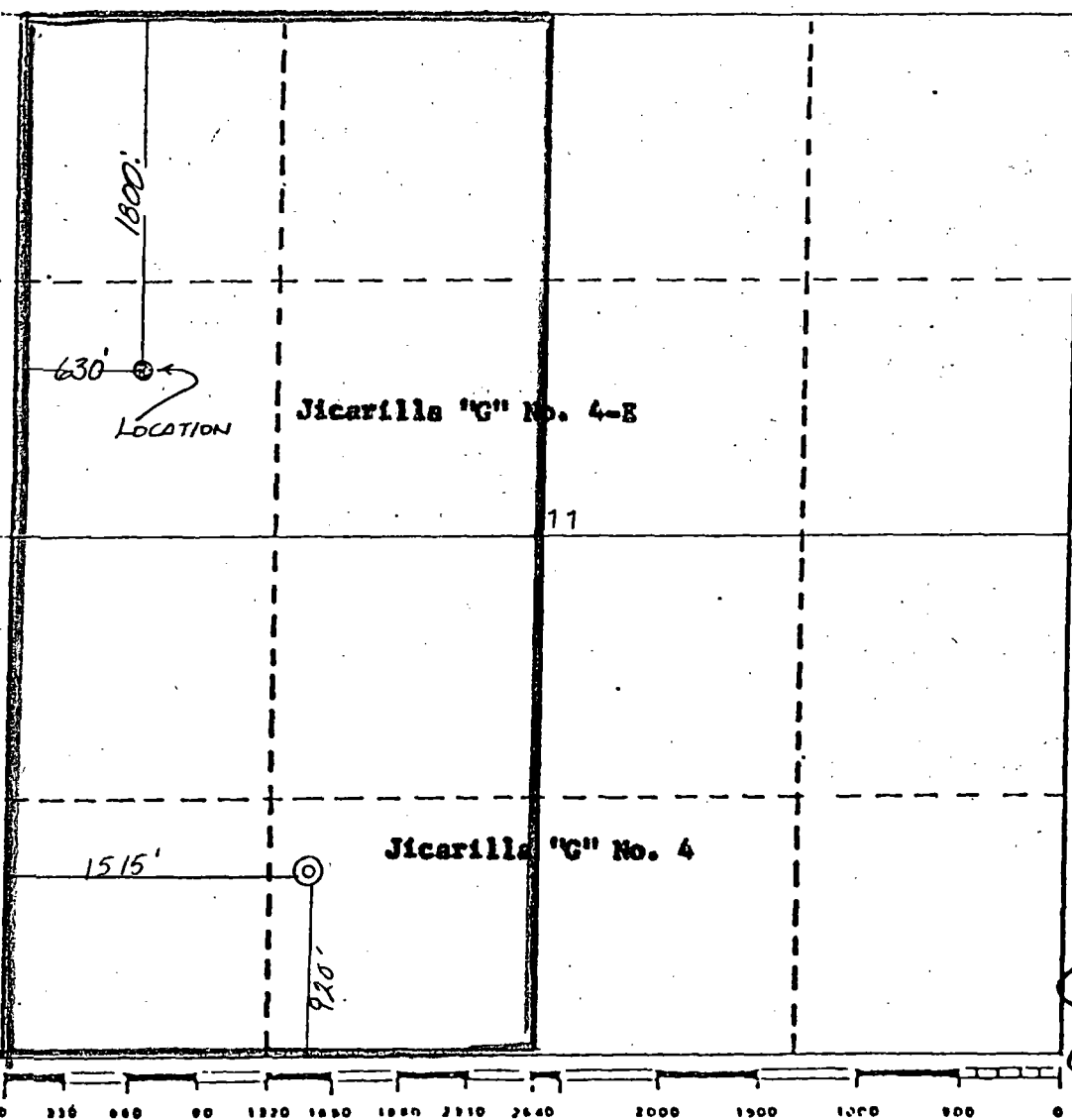

CERTIFICATION

I hereby certify that the information contained herein is true and complete to the best of my knowledge and belief.

Kenneth E. Roddy

Name

Kenneth E. Roddy

Position

Production Superintendent

Company

SUPRON ENERGY CORPORATION

Date

June 23, 1980

I hereby certify that the location shown on this plat was plotted from field notes and actual surveys made by me or under my supervision and that the same is true and correct to the best of my knowledge and belief.

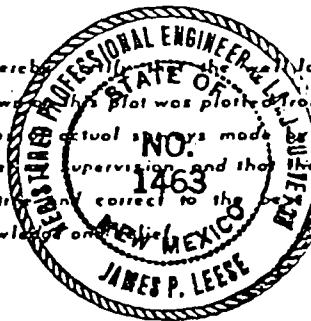

Date Surveyed

May 9, 1980

Registered Professional Engineer

and/or Land Surveyor

James P. Lease
James P. Lease

Certificate No.

1463

UNITED STATES
DEPARTMENT OF THE INTERIOR
GEOLOGICAL SURVEY

APPLICATION FOR PERMIT TO DRILL, DEEPEN, OR PLUG BACK

1a. TYPE OF WORK

DRILL ☒DEEPEN ☐PLUG BACK ☐

b. TYPE OF WELL

OIL
WELL ☐GAS
WELL ☒

OTHER

SINGLE
ZONE ☒MULTIPLE
ZONE ☐

2. NAME OF OPERATOR

Supron Energy Corporation

3. ADDRESS OF OPERATOR

P.O. Box 808, Farmington, New Mexico 87401

4. LOCATION OF WELL (Report location clearly and in accordance with any State requirements.)*

At surface

1800 Ft./North line and 630 Ft./West line

At proposed prod. zone Same as above

14. DISTANCE IN MILES AND DIRECTION FROM NEAREST TOWN OR POST OFFICE*

20 Northwest Lindrith, New Mexico

10. DISTANCE FROM PROPOSED*
LOCATION TO NEAREST
PROPERTY OR LEASE LINE, FT.
(Also to nearest drlg. unit line, if any) 630 Ft.16. NO. OF ACRES IN LEASE
256017. NO. OF ACRES ASSIGNED
TO THIS WELL
320 W/218. DISTANCE FROM PROPOSED LOCATION*
TO NEAREST WELL, DRILLING, COMPLETED,
OR APPLIED FOR, ON THIS LEASE, FT. 133019. PROPOSED DEPTH
834020. ROTARY OR CABLE TOOLS
Rotary

21. ELEVATIONS (Show whether DF, RT, GR, etc.)

7256 GR

22. APPROX. DATE WORK WILL START*

September 1, 1980

23.

PROPOSED CASING AND CEMENTING PROGRAM

SIZE OF HOLE	SIZE OF CASING	WEIGHT PER FOOT	SETTING DEPTH	QUANTITY OF CEMENT
13-3/4	9-5/8"	32.3	300'	Circ.
8-3/4	7"	23	4050'	175 sx. H-L + 6% w/12-1/2# Gil. & 50 sx. class "B" T.C. - 2000'
6-1/4	4-1/2"	10.5 & 11.6	8040	500 Sx. 50-50 poz w/4% gel & 0.6% F.L.A.

Drill 13-3/4" surface hole to approx. 300 ft. Run 9-5/8" surface pipe. Cmt. pipe and circulate cmt. to the surface. Pressure test surface pipe. Drill 8-3/4" hole to intermediate T.D. of approx. 4050 ft. Run 7" casing and cmt. Test Intermediate casing. Drill 6-1/4" hole with gas or air to T.D. of approximately 8340 ft. Run pipe and hang with a liner hanger. Top of liner hanger at approx. 3900 ft. Cmt. liner. Pressure test pipe string. Perforate and fracture the Dakota zone clean well up. Run tubing to the top of the Dakota zone. Shut well in and nipple down well head. Test well and connect to Gathering system.

This gas has been previously contracted for.

IN ABOVE SPACE DESCRIBE PROPOSED PROGRAM: If proposal is to deepen or plug back, give data on present productive zone and proposed new productive zone. If proposal is to drill or deepen directionally, give pertinent data on subsurface locations and measured and true vertical depths. Give blowout preventer program, if any.

24.

SIGNED

Rudy D. Morfo

TITLE

Area Superintendent

DATE

July 10, 1980

(This space for Federal or State office use)

PERMIT NO.

APPROVAL DATE

APPROVED BY

TITLE

DATE

CONDITIONS OF APPROVAL, IF ANY:

UNITED STATES
DEPARTMENT OF THE INTERIOR
GEOLOGICAL SURVEY

SUNDRY NOTICES AND REPORTS ON WELLS

(Do not use this form for proposals to drill or to deepen or plug back to a different reservoir. Use Form 9-331-C for such proposals.)

1. oil ☐ well gas ☒ well other ☐
2. NAME OF OPERATOR
Supron Energy Corporation
3. ADDRESS OF OPERATOR
P.O. Box 808, Farmington, New Mexico 87401
4. LOCATION OF WELL (REPORT LOCATION CLEARLY. See space 17 below.)
AT SURFACE: 1800 Ft./N; 630 Ft./W line
AT TOP PROD. INTERVAL: Same as above
AT TOTAL DEPTH: Same as above
16. CHECK APPROPRIATE BOX TO INDICATE NATURE OF NOTICE, REPORT, OR OTHER DATA

- | REQUEST FOR APPROVAL TO: | | SUBSEQUENT REPORT OF: |
|------------------------------|--------------------------|--------------------------|
| TEST WATER SHUT-OFF | <input type="checkbox"/> | <input type="checkbox"/> |
| FRACTURE TREAT | <input type="checkbox"/> | <input type="checkbox"/> |
| SHOOT OR ACIDIZE | <input type="checkbox"/> | <input type="checkbox"/> |
| REPAIR WELL | <input type="checkbox"/> | <input type="checkbox"/> |
| PULL OR ALTER CASING | <input type="checkbox"/> | <input type="checkbox"/> |
| MULTIPLE COMPLETE | <input type="checkbox"/> | <input type="checkbox"/> |
| CHANGE ZONES | <input type="checkbox"/> | <input type="checkbox"/> |
| ABANDON* | <input type="checkbox"/> | <input type="checkbox"/> |
| (other) <u>Ran 7" Casing</u> | | |

17. DESCRIBE PROPOSED OR COMPLETED OPERATIONS (Clearly state all pertinent details, and give pertinent dates, including estimated date of starting any proposed work. If well is directionally drilled, give subsurface locations and measured and true vertical depths for all markers and zones pertinent to this work.)*

1. Drilled 8-3/4" hole with mud to intermediate total depth of 4197 ft. R.K.B.
2. Ran 96 joints of 7" O.D., 23.00#, J-55 casing. Landed at 4165 ft. R.K.B.
3. Cemented with 150 sacks of 65-35-6 with 12-1/2 lb. of gilsonite per sack and 100 sacks of class "B" with 2% calcium chloride.
Plug down at 8:00 A.M. 10/16/80.
4. Ran temperature survey and found cement top at 2300 ft.

Subsurface Safety Valve: Manu. and Type _____ Set @ _____ Ft.

18. I hereby certify that the foregoing is true and correct

SIGNED Kenneth E. Roddy TITLE Production Supt. DATE October 20, 1980

(This space for Federal or State office use)

APPROVED BY _____ TITLE _____ DATE _____
CONDITIONS OF APPROVAL, IF ANY:

5. LEASE Contract No. 150
6. IF INDIAN, ALLOTTEE OR TRIBE NAME Jicarilla Apache
7. UNIT AGREEMENT NAME
8. FARM OR LEASE NAME Jicarilla "G"
9. WELL NO. 4-E
10. FIELD OR WILDCAT NAME Basin Dakota
11. SEC., T., R., M., OR BLK. AND SURVEY OR AREA Sec. 11, T-26N, R-5W, N.M.P.M.
12. COUNTY OR PARISH Rio Arriba
13. STATE New Mexico
14. API NO.
15. ELEVATIONS (SHOW DF, KDB, AND WD) 7267 R.K.B.

(NOTE: Report results of multiple completion or zone change on Form 9-330.)

UNITED STATES
DEPARTMENT OF THE INTERIOR
GEOLOGICAL SURVEY

SUNDRY NOTICES AND REPORTS ON WELLS

(Do not use this form for proposals to drill or to deepen or plug back to a different reservoir. Use Form 9-331-C for such proposals.)

1. oil well ☐ gas well ☒ other ☐
2. NAME OF OPERATOR
Supron Energy Corporation
3. ADDRESS OF OPERATOR
P.O. Box 808, Farmington, New Mexico 87401
4. LOCATION OF WELL (REPORT LOCATION CLEARLY. See space 17 below.)
AT SURFACE: 1800 Ft./N; 630 Ft./W line
AT TOP PROD. INTERVAL: Same as above
AT TOTAL DEPTH: Same as above
16. CHECK APPROPRIATE BOX TO INDICATE NATURE OF NOTICE, REPORT, OR OTHER DATA

- | REQUEST FOR APPROVAL TO: | | SUBSEQUENT REPORT OF: |
|----------------------------------|--------------------------|--------------------------|
| TEST WATER SHUT-OFF | <input type="checkbox"/> | <input type="checkbox"/> |
| FRACTURE TREAT | <input type="checkbox"/> | <input type="checkbox"/> |
| SHOOT OR ACIDIZE | <input type="checkbox"/> | <input type="checkbox"/> |
| REPAIR WELL | <input type="checkbox"/> | <input type="checkbox"/> |
| PULL OR ALTER CASING | <input type="checkbox"/> | <input type="checkbox"/> |
| MULTIPLE COMPLETE | <input type="checkbox"/> | <input type="checkbox"/> |
| CHANGE ZONES | <input type="checkbox"/> | <input type="checkbox"/> |
| ABANDON* | <input type="checkbox"/> | <input type="checkbox"/> |
| (other) <u>Ran 4-1/2" Casing</u> | | |

5. LEASE
Contract No. 150
6. IF INDIAN, ALLOTTEE OR TRIBE NAME
Jicarilla Apache
7. UNIT AGREEMENT NAME
8. FARM OR LEASE NAME
Jicarilla "G"
9. WELL NO.
4-E
10. FIELD OR WILDCAT NAME
Basin Dakota
11. SEC., T., R., M., OR BLK. AND SURVEY OR AREA
Sec. 11, T-26N, R-5W, N.M.P.M.
12. COUNTY OR PARISH
Rio Arriba
13. STATE
New Mexico
14. API NO.
15. ELEVATIONS (SHOW DF, KDB, AND WD)
7267 R.K.B.

(NOTE: Report results of multiple completion or zone change on Form 9-330.)

17. DESCRIBE PROPOSED OR COMPLETED OPERATIONS (Clearly state all pertinent details, and give pertinent dates, including estimated date of starting any proposed work. If well is directionally drilled, give subsurface locations and measured and true vertical depths for all markers and zones pertinent to this work.)*

1. Drilled 6-1/4" hole with gas to total depth of 8340 ft. R.K.B. Reached total depth on 10/24/80.
2. Ran 118 joints of 4-1/2", 11.6# & 10.5#, K-55 casing as a liner. Bottom of liner at 8334 ft. R.K.B. Top of liner at 4012 ft. R.K.B. Float collar at 8318 ft. R.K.B.
3. Cemented liner with 550 sacks of 50-50 poz with 2% gel. Plug down at 1:30 P.M. 10/25/80. Reversed out 5 bbl. cement from liner top.

Subsurface Safety Valve: Manu. and Type _____ Set @ _____ Ft.

18. I hereby certify that the foregoing is true and correct

SIGNED Kenneth E. Roddy TITLE Production Supt. DATE October 27, 1980

(This space for Federal or State office use)

APPROVED BY _____ TITLE _____ DATE _____
CONDITIONS OF APPROVAL, IF ANY:

UNITED STATES
DEPARTMENT OF THE INTERIOR
GEOLOGICAL SURVEY

SUBMIT IN DUPLICATE*

(See other in-
structions on
reverse side)Form approved.
Budget Bureau No. 42-R355.5.

WELL COMPLETION OR RECOMPLETION REPORT AND LOG *

1a. TYPE OF WELL: OIL WELL <input type="checkbox"/> GAS WELL <input checked="" type="checkbox"/> DRY <input type="checkbox"/> Other _____						5. LEASE DESIGNATION AND SERIAL NO. Contract No. 150									
b. TYPE OF COMPLETION: NEW WELL <input checked="" type="checkbox"/> WORK OVER <input type="checkbox"/> DEEP-EN <input type="checkbox"/> PLUG BACK <input type="checkbox"/> DIFF. RESVR. <input type="checkbox"/> Other _____						6. IF INDIAN, ALLOTTEE OR TRIBE NAME Jicarilla Apache									
2. NAME OF OPERATOR Supron Energy Corporation						7. UNIT AGREEMENT NAME									
3. ADDRESS OF OPERATOR P.O. Box 808, Farmington, New Mexico 87401						8. FARM OR LEASE NAME Jicarilla "G"									
4. LOCATION OF WELL (Report location clearly and in accordance with any State requirements)* At surface 1800 Ft./North; 630 Ft./West line At top prod. interval reported below Same as above At total depth Same as above						9. WELL NO. 4-E									
14. PERMIT NO. _____ DATE ISSUED _____						10. FIELD AND POOL, OR WILDCAT Basin Dakota									
15. DATE SPUDDED 10/8/80						11. SEC., T., R., N., OR BLOCK AND SURVEY OR AREA Sec. 11, T-26N, R-5W N.M.P.M.									
16. DATE T.D. REACHED 10/24/80						12. COUNTY OR PARISH Rio Arriba									
17. DATE COMPL. (Ready to prod.) 12/3/80						13. STATE New Mexico									
18. ELEVATIONS (DF, REB, RT, OR, ETC.)* 7267 R.K.B.						19. ELEV. CASINGHEAD 7256									
20. TOTAL DEPTH, MD & TVD 8340 MD & TBD		21. PLUG, BACK T.D., MD & TVD 8318 MD & TVD		22. IF MULTIPLE COMPL., HOW MANY* - - -		23. INTERVALS DRILLED BY ROTARY TOOLS 0 - 8340 CABLE TOOLS - - -									
24. PRODUCING INTERVAL(S), OF THIS COMPLETION—TOP, BOTTOM, NAME (MD AND TVD)* 8132 - 8282 Dakota MD & TVD						25. WAS DIRECTIONAL SURVEY MADE No									
26. TYPE ELECTRIC AND OTHER LOGS RUN Induction Electric and Compensated Density						27. WAS WELL CORED No									
28. CASING RECORD (Report all strings set in well)															
CASINO SIZE		WEIGHT, LB./FT.		DEPTH SET (MD)		HOLE SIZE		CEMENTING RECORD		AMOUNT PULLED					
9-5/8"		32.30		318		12-1/4"		200 Sacks							
7"		23.00		4165		8-3/4"		250 Sacks							
4-1/2"		10.50 & 11.60		4012-8334		6-1/4"		550 Sacks							
29. LINER RECORD								30. TUBING RECORD							
SIZE		TOP (MD)		BOTTOM (MD)		SACKS CEMENT*		SCREEN (MD)		SIZE		DEPTH SET (MD)		PACKER SET (MD)	
4-1/2"		4012		8318		550				2-3/8"EUE		8218			
31. PERFORATION RECORD (Interval, size and number) 1 - 0.42" hole at each of the following depths 8132, 33, 34, 35, 36, 37, 38, 39, 8233, 34, 8235, 36, 38, 39, 40, 41, 42, 44, 79, 80, 81, 8282. Total of 22 holes.								32. ACID, SHOT, FRACTURE, CEMENT SQUEEZE, ETC.							
								DEPTH INTERVAL (MD)		AMOUNT AND KIND OF MATERIAL USED					
								8132 - 8282		2000 gal. 7-1/2% HCL, 77,000 1 20-40 sand, & 66,000 gal. 2% KCL water					
33.* PRODUCTION															
DATE FIRST PRODUCTION		PRODUCTION METHOD (Flowing, gas lift, pumping—size and type of pump) Flowing						WELL STATUS (Producing or shut-in) Shut-In							
DATE OF TEST 12/3/80		HOURS TESTED 3		CHOKE SIZE 3/4"		PROD'N. FOR TEST PERIOD →		OIL—BBL. 324		GAS—MCF. 324		WATER—BBL.		GAS-OIL RATIO	
FLOW. TUBING PRESS. 208		CASING PRESSURE 343		CALCULATED 24-HOUR RATE →		OIL—BBL.		GAS—MCF. 2591		WATER—BBL.		OIL GRAVITY-API (CORR.)			
34. DISPOSITION OF GAS (Sold, used for fuel, vented, etc.) Vented										TEST WITNESSED BY Leroy Tafoya					
35. LIST OF ATTACHMENTS															
36. I hereby certify that the foregoing and attached information is complete and correct as determined from all available records															
SIGNED Kenneth E. Roddy		TITLE Production Superintendent						DATE Dec. 4, 1980							

*(See Instructions and Spaces for Additional Data on Reverse Side)

INSTRUCTIONS

General: This form is designed for submitting a complete and correct well completion report and log on all types of lands and leases to either a Federal agency or a State agency, or both, pursuant to applicable Federal and/or State laws and regulations. Any necessary special instructions concerning the use of this form and the number of copies to be submitted, particularly with regard to local, area, or regional procedures and practices, either are shown below or will be issued by, or may be obtained from, the local Federal and/or State office. See instructions on Items 22 and 24, and 33, below regarding separate reports for separate completions.

If not filed prior to the time this summary record is submitted, copies of all currently available logs (drillers, geologists, sample and core analysis, all types electric, etc.), formation and pressure tests, and directional surveys, should be attached hereto, to the extent required by applicable Federal and/or State laws and regulations. All attachments should be listed on this form, see Item 35.

Item 4: If there are no applicable State requirements, locations on Federal or Indian land should be described in accordance with Federal requirements. Consult local State or Federal office for specific instructions.

Item 18: Indicate which elevation is used as reference (where not otherwise shown) for depth measurements given in other spaces on this form and in any attachments.

Items 22 and 24: If this well is completed for separate production from more than one interval zone (multiple completion), so state in Item 22, and in Item 24 show the producing interval, or intervals, top(s), bottom(s) and name(s) (if any) for only the interval reported in Item 33. Submit a separate report (page) on this form, adequately identified, for each additional interval to be separately produced, showing the additional data pertinent to such interval.

Item 29: "Sacks Cement": Attached supplemental records for this well should show the details of any multiple stage cementing and the location of the cementing tool.

Item 33: Submit a separate completion report on this form for each interval to be separately produced. (See instruction for Items 22 and 24 above.)

37. SUMMARY OF POROUS ZONES:

SHOW ALL IMPORTANT ZONES OF POROSITY AND CONTENTS THEREOF; CORED INTERVALS; AND ALL DRILL-STEM TESTS, INCLUDING DEPTH INTERVAL TESTED, CURSION USED, TIME TOOL OPEN, FLOWING AND SHUT-IN PRESSURES, AND RECOVERIES

38. GEOLOGIC MARKERS

FORMATION	TOP	BOTTOM	DESCRIPTION, CONTENTS, ETC.	TOP		
				NAME	MEAS. DEPTH	TRUE VERT. DEPTH
				Ojo Alamo (Base)	3500	
				Fruitland	3500	
				Pictured Cliffs	3900	
				Cliff House	5552	
				Point Lookout	6096	
				Gallup	7622	
				Greenhorn (Base)	8079	
				Dakota	8126	