

DHC 10/4/99

DISTRICT I
P.O. Box 1980, Hobbs, NM 88241-1980
DISTRICT II
811 South First St., Artesia, NM 88210-2835
DISTRICT III
1000 Rio Brazos Rd., Aztec, NM 87410

State of New Mexico
Energy, Minerals and Natural Resources Department
OIL CONSERVATION DIVISION
2040 S. Pacheco
Santa Fe, New Mexico 87505-6429

Form C-107-A
New 3-12-96

APPROVAL PROCESS:
Administrative _____ Hearing _____
EXISTING WELLBORE
☒ YES ☐ NO

APPLICATION FOR DOWNHOLE COMMINGLING

FOUR STAR OIL AND GAS COMPANY	3300 N. Butler Ave, Ste100	Farmington	NM	87401
Operator PAUL WILLIAMS	3	F	35	T26N R06W
Lease	Well No.	Unit Ltr. - Sec - Twp - Rge	County	
OGRID No. 131994	Property Code	API No. 3003921079	Federal <input type="checkbox"/> State <input type="checkbox"/> (and/or) Fee <input checked="" type="checkbox"/>	

The following facts are submitted in support of downhole commingling:	Upper Zone	Intermediate Zone	Lower Zone
1. Pool Name and Pool Code	BLANCO MESA VERDE		BASIN DAKOTA
2. Top and Bottom of Pay Section (Perforations)	4698-4948		6939-7019
3. Type of Production (Oil or Gas)	GAS		GAS
4. Method of Production (Flowing or Artificial Lift)	flowing		flowing
5. Bottomhole Pressure Oil Zones - Artificial Lift: Gas .Oil - Flowing: Measured Current All Gas Zones: Estimated Or Measured Original	a. (Current) 440 calculated b. (Original)	a. b.	a. 485 calculated b.
6. Oil Gravity (*API) or Gas BTU Content	1289		1131
7. Producing or Shut-in ?	PRODUCING		PRODUCING
Production Marginal? (yes or no)	YES		YES
* If Shut-in, give date and oil/gas/ water rates of last production Note: For new zones with no production history applicant shall be required to attach production estimates and supporting data	Date: Rates:	Date: Rates:	Date: Rates:
* If Producing, give date and oil/gas/ water rates of recent test (ithin 60 days)	Date: 06/01/1999 Rates: OIL .16BBL GAS-116MCF WATER-1BBL	Date: Rates:	Date: 06/01/1999 Rates: OIL-O GAS-100MCF WTR-50BBL
8. Fixed Percentage Allocation Formula - % for each zone	Oil: % 60 Gas: %	Oil: % Gas: %	Oil: % 40 Gas: %

9. If allocation formula is based upon something other than current or past production, or is based on some other method, submit attachments with supporting data and/or explaining mmethod and providing rate projections or other required data.
10. Are all working, overriding, and royalty interests identical in all commingled zones? ☒ Yes ☐ No
If not, have all working, overriding, and royalty interests been notified by certified mail? ☐ Yes ☐ No
Have all offset operators been given written notice of the proposed downhole commingling ☐ Yes ☒ No
11. Will cross-flow occur? ☐ Yes ☒ No If yes, are fluids compayible, will formations not be damaged, will any cros flowed production be recovered, and will the allocation formula be reliable. ☒ Yes ☐ No (If No, attach explanation)
12. Are all produced fluids from all commingled zones compatible with each other ☒ Yes ☐ No
13. Will the value of production be decreased by commingling? ☐ Yes ☒ No (If Yes, attach explanation)
14. If this well is on, or communitized with, state or federal lands, either the Commissioner of Public Lands or the United States Bureau of Land Management has been notified in writing of this application ☒ Yes ☐ No
15. NMOCD Reference Cases for Rule 303(D) Exceptions: ORDER NO(S). _____
16. ATTACHMENTS:
*C-102 for each zone to be commingled showing its spacing unit and acreage dedication.
*Production curve for each zone for at least one year. (If not available, attach explanation.)
*For zones with no production history, estimated production rates and supporting data.
*Data to support allocation method or formula.
*Notification list of all offset, operators.
*Notification list of all working, overriding, and royalty interest for uncommon interest cases.
*Any additional statements, data, or documents required to support commingling.

I hereby certify that the information above is true and complete to the best of my knowledge and belief.

Signature Rached Hindi Title Senior Engineer Date 9/9/99

DISTRICT I

P.O. Box 1980, Hobbs, NM 88240

DISTRICT II

P.O. Box Drawer DD, Artesia, NM 88210

DISTRICT III

1000 Rio Brazos Rd., Aztec, NM 87410

OIL CONSERVATION DIVISION

2040 S. Pacheco
Santa Fe, New Mexico 87505-6429

WELL API NO.	3003921079
5. Indicate Type of Lease	STATE <input type="checkbox"/> FEE <input checked="" type="checkbox"/>
6. State Oil / Gas Lease No.	897620
7. Lease Name or Unit Agreement Name	PAUL WILLIAMS
8. Well No.	3
9. Pool Name or Wildcat	BLANCO MESAVERDE (PRORATED GAS)
10. Elevation (Show whether DF, RKB, RT, GR, etc.)	6338 GR

SUNDRY NOTICES AND REPORTS ON WELLS
(DO NOT USE THIS FORM FOR PROPOSALS TO DRILL OR TO DEEPEN OR PLUG BACK TO
DIFFERENT RESERVOIR. USE "APPLICATION FOR PERMI
(FORM C-101) FOR SUCH PROPOSALS.

1. Type of Well:	OIL WELL <input type="checkbox"/> GAS WELL <input type="checkbox"/> OTHER <input type="checkbox"/>
2. Name of Operator	FOUR STAR OIL AND GAS COMPANY
3. Address of Operator	3300 N. Butler Ave, Ste100 Farmington NM 87401
4. Well Location	Unit Letter <u>F</u> : <u>1575</u> Feet From The <u>NORTH</u> Line and <u>1555</u> Feet From The <u>WEST</u> Line Section <u>35</u> Township <u>T26N</u> Range <u>R06W</u> NMPM <u>RIO ARRIBA</u> COUNTY
10. Elevation (Show whether DF, RKB, RT, GR, etc.)	6338 GR

11. Check Appropriate Box to Indicate Nature of Notice, Report, or Other Data

NOTICE OF INTENTION TO:

PERFORM REMEDIAL WORK ☐ PLUG AND ABANDON ☐
TEMPORARILY ABANDON ☐ CHANGE PLANS ☐
PULL OR ALTER CASING ☐
OTHER: DOWN HOLE COMMINGLE ☒

SUBSEQUENT REPORT OF:

REMEDIAL WORK ☐ ALTERING CASING ☐
COMMENCE DRILLING OPERATION ☐ PLUG AND ABANDONMENT ☐
CASING TEST AND CEMENT JOB ☐
OTHER: ☐

12. Describe Proposed or Completed Operations (Clearly state all pertinent details, and give pertinent dates, including estimated date of starting any proposed work) SEE RULE 1103.

FOUR STAR OIL AND GAS REQUESTS APPROVAL TO DOWNHOLE COMMINGLE PRODUCTION FROM THE SUBJECT ZONE.

ZONES TO BE COMMINGLED

PERFORATIONS MESA VERDE
PRODUCTION 4698'-4948'
GAS BTU 150 MCF
1289

PERFORATIONS DAKOTA
PRODUCTION 6938'-7019'
GAS BTU 80 MCF
1131

THE DAKOTA ZONE IS CURRENTLY PRODUCING THROUGH 1 1/4" COILED TUBING AND THE MESAVERDE UP THE ANNULUS. THE TWO ZONES WILL BE COMMINGLED AND PRODUCED BY MEANS OF ARTIFICIAL LIFT TO MAINTAIN A LOW FLUID LEVEL TO ENSURE MAXIMUM PRODUCTION.

I hereby certify that the information above is true and complete to the best of my knowledge and belief.

SIGNATURE Rached Hindi TITLE Senior Engineer

DATE 9/9/99

TYPE OR PRINT NAME Rached Hindi

Telephone No. 325-4397

(This space for State Use)

APPROVED

BY _____ TITLE _____ DATE _____

CONDITIONS OF APPROVAL, IF ANY:

DISTRICT I

P.O. Box 1980, Hobbs, NM 88241-1980

DISTRICT II

P.O. Box Drawer DD, Artesia, NM 88211-0719

DISTRICT III

1000 Rio Brazos Rd., Aztec, NM 87410

DISTRICT IV

P.O. Box 2088, Santa Fe, NM 87504-2088

State of New Mexico**Energy, Minerals and Natural Resources Department****OIL CONSERVATION DIVISION**

P.O. Box 2088

Santa Fe, New Mexico 87504-2088

Form C-102

Revised February 10, 1999

Instructions on back

Submit to Appropriate District Office

State Lease - 4 Copie

Fee Lease - 3 Copie

☐ AMENDED REPORT**WELL LOCATION AND ACREAGE DEDICATION PLAT**

¹ API Number 3003921079	² Pool Code 71599	³ Pool Name BASIN DAKOTA (PRORATED GAS)
⁴ Property Code	⁵ Property Name PAUL WILLIAMS	⁶ Well No. 3
⁷ OGRID Number 131994	⁸ Operator Name FOUR STAR OIL AND GAS COMPANY	⁹ Elevation 6228'

¹⁰ Surface Location

UI or lot no	Section	Township	Range	Lot.Idn	Feet From The	North/South Line	Feet From The	East/West Line	County
F	35	T26N	R06W		1575	NORTH	1555	WEST	RIO ARRIBA

¹¹ Bottom Hole Location If Different From Surface

UI or lot no.	Section	Township	Range	Lot.Idn	Feet From The	North/South Line	Feet From The	East/West Line	County

¹² Dedicated Acre	¹³ Joint or Infill No	¹⁴ Consolidation Code	¹⁵ Order No.
------------------------------	-------------------------------------	----------------------------------	-------------------------

NO ALLOWABLE WILL BE ASSIGNED TO THIS COMPLETION UNTIL ALL INTERESTS HAVE BEEN CONSOLIDATED
OR A NON-STANDARD UNIT HAS BEEN APPROVED BY THE DIVISION

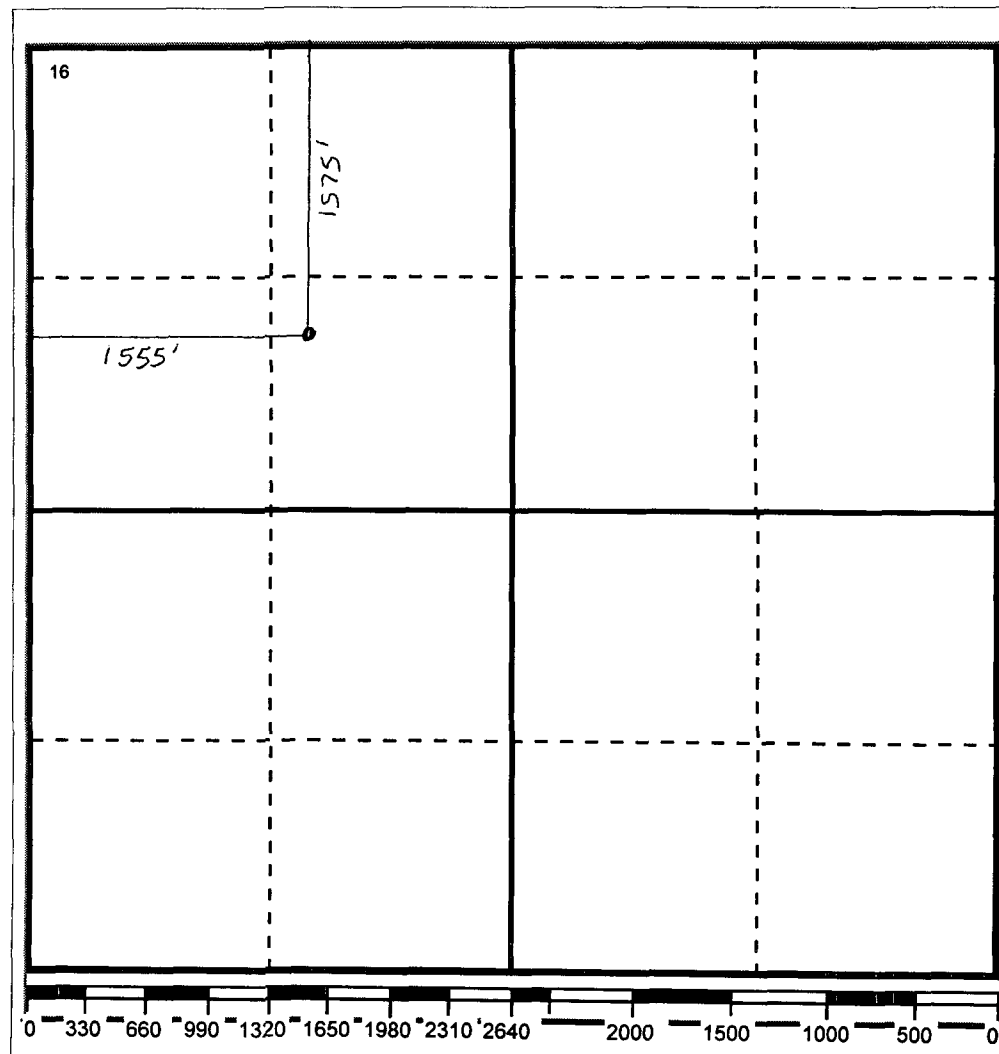
**17 OPERATOR CERTIFICATION**

I hereby certify that the information contained herein is true and complete to the best of my knowledge and belief

Signature

Rached Hindi

Printed Name

Rached Hindi

Positio

Senior Engineer

Date

8/31/99

18 SURVEYOR CERTIFICATION

I hereby certify that the well location shown on this plat was plotted from field notes of actual surveys made by me or under my supervision, and that the same is true and correct to the best of my knowledge and belief.

Date Surveyed

Signature & Seal of

Professional Surveyor

Certificate No.

DISTRICT I

P.O. Box 1980, Hobbs, NM 88241-1980

DISTRICT II

P.O. Box Drawer DD, Artesia, NM 88211-0719

DISTRICT III

1000 Rio Brazos Rd., Aztec, NM 87410

DISTRICT IV

P.O. Box 2088, Santa Fe, NM 87504-2088

State of New Mexico**Energy, Minerals and Natural Resources Department****OIL CONSERVATION DIVISION**

P.O. Box 2088

Santa Fe, New Mexico 87504-2088

Form C-102

Revised February 10, 1999

Instructions on back

Submit to Appropriate District Office

State Lease - 4 Copie

Fee Lease - 3 Copie

☐ AMENDED REPORT**WELL LOCATION AND ACREAGE DEDICATION PLAT**

¹ API Number 3003921079	² Pool Code 72319	³ Pool Name BLANCO MESAVERDE (PRORATED GAS)
⁴ Property Code	⁵ Property Name PAUL WILLIAMS	⁶ Well No. 3
⁷ OGRID Number 131994	⁸ Operator Name FOUR STAR OIL AND GAS COMPANY	⁹ Elevation 6338 GR

¹⁰ Surface Location

UI or lot no	Section	Township	Range	Lot.Idn	Feet From The	North/South Line	Feet From The	East/West Line	County
F	35	T26N	R06W		1575	NORTH	1555	WEST	RIO ARRIBA

¹¹ Bottom Hole Location If Different From Surface

UI or lot no.	Section	Township	Range	Lot.Idn	Feet From The	North/South Line	Feet From The	East/West Line	County

¹² Dedicated Acre	¹³ Joint or Infill No	¹⁴ Consolidation Code	¹⁵ Order No.
------------------------------	-------------------------------------	----------------------------------	-------------------------

NO ALLOWABLE WILL BE ASSIGNED TO THIS COMPLETION UNTIL ALL INTERESTS HAVE BEEN CONSOLIDATED
OR A NON-STANDARD UNIT HAS BEEN APPROVED BY THE DIVISION

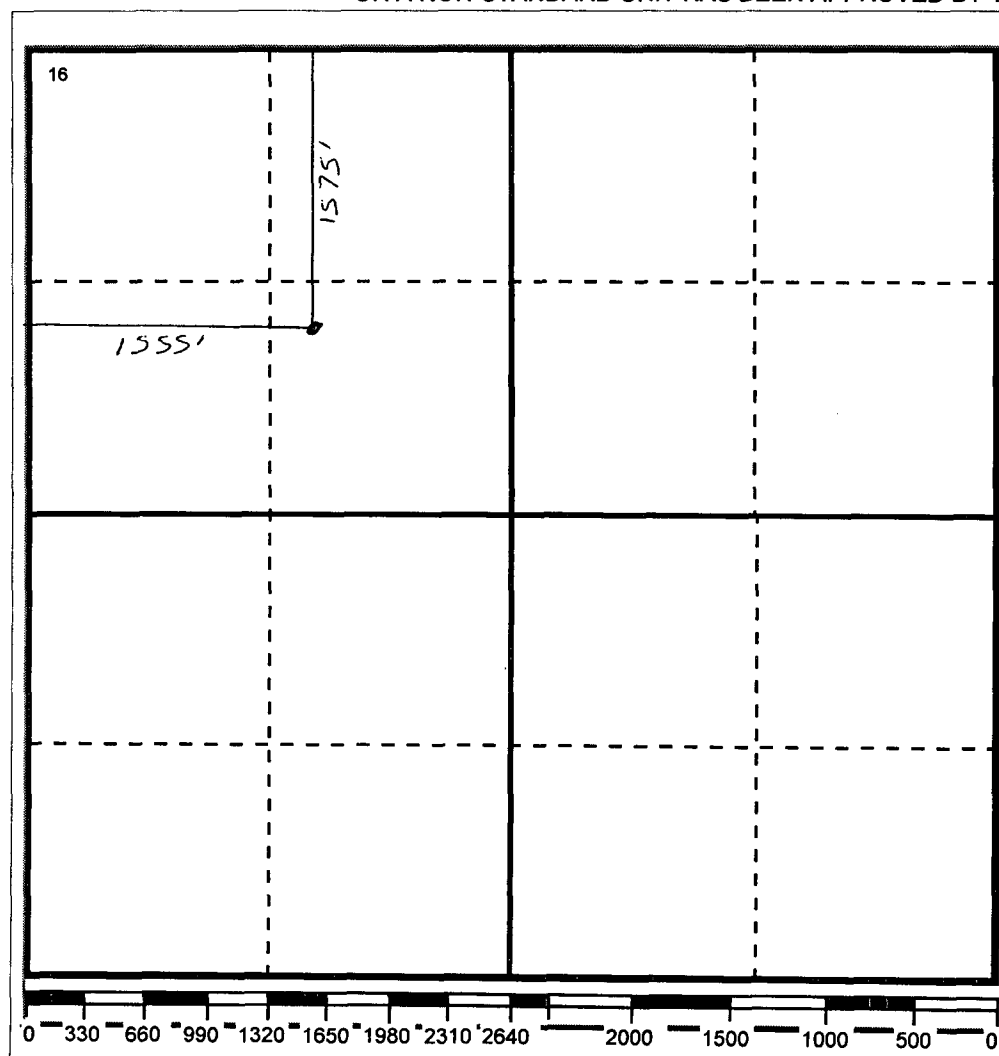
¹⁷ OPERATOR CERTIFICATION

I hereby certify that the information
contained herein is true and complete to the
best of my knowledge and belief

Signature

Rached Hindi

Printed Name

Rached Hindi

Position

Senior Engineer

Date

8/31/99

¹⁸ SURVEYOR CERTIFICATION

I hereby certify that the well location shown
on this plat was plotted from field notes of
actual surveys made by me or under my
supervision, and that the same is true and
correct to the best of my knowledge and
belief.

Date Surveyed

Signature & Seal of
Professional Surveyor

Certificate No.

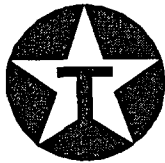

PAUL WILLIAMS No. 3 CURRENT COMPLETION

WELL:

Paul Williams No. 3

LOCATION:

Unit F, 1575' FNL & 1555' FWL
Sec. 35, T26N, R6W
Rio Arriba County

SPUD DATE: 5/15/75

COMPL. DATE: 5/22/75

FORMATION TOPS:

Pictured Cliffs 1505'

Mesa Verde 3070'

Mancos 4240'

Gallup 5137'

Greenhorn 5874'

Dakota 5970'

MESA VERDE PERFS:

4698' - 4948'

DAKOTA PERFS:

6938' - 7019'

PBTD - 7144'
TD - 7177'

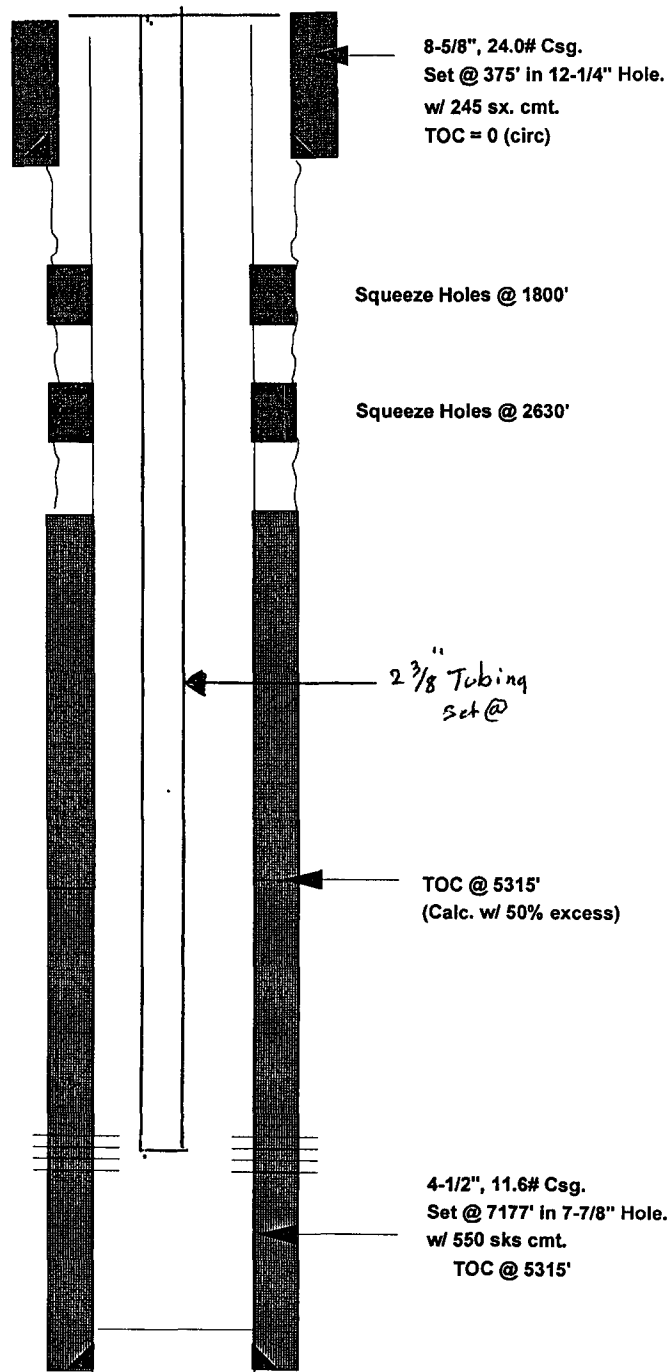



PAUL WILLIAMS No. 3 CURRENT COMPLETION

WELL:

Paul Williams No. 3

LOCATION:

Unit F, 1575' FNL & 1555' FWL
Sec. 35, T26N, R6W
Rio Arriba County

SPUD DATE: 5/15/75

COMPL. DATE: 5/22/75

FORMATION TOPS:

Pictured Cliffs 1505'
Mesa Verde 3070'
Mancos 4240'
Gallup 5137'
Greenhorn 5874'
Dakota 5970'

MESA VERDE PERFS:

4698' - 4948'

DAKOTA PERFS:

6938' - 7019'

PBTD - 7144'
TD - 7177'

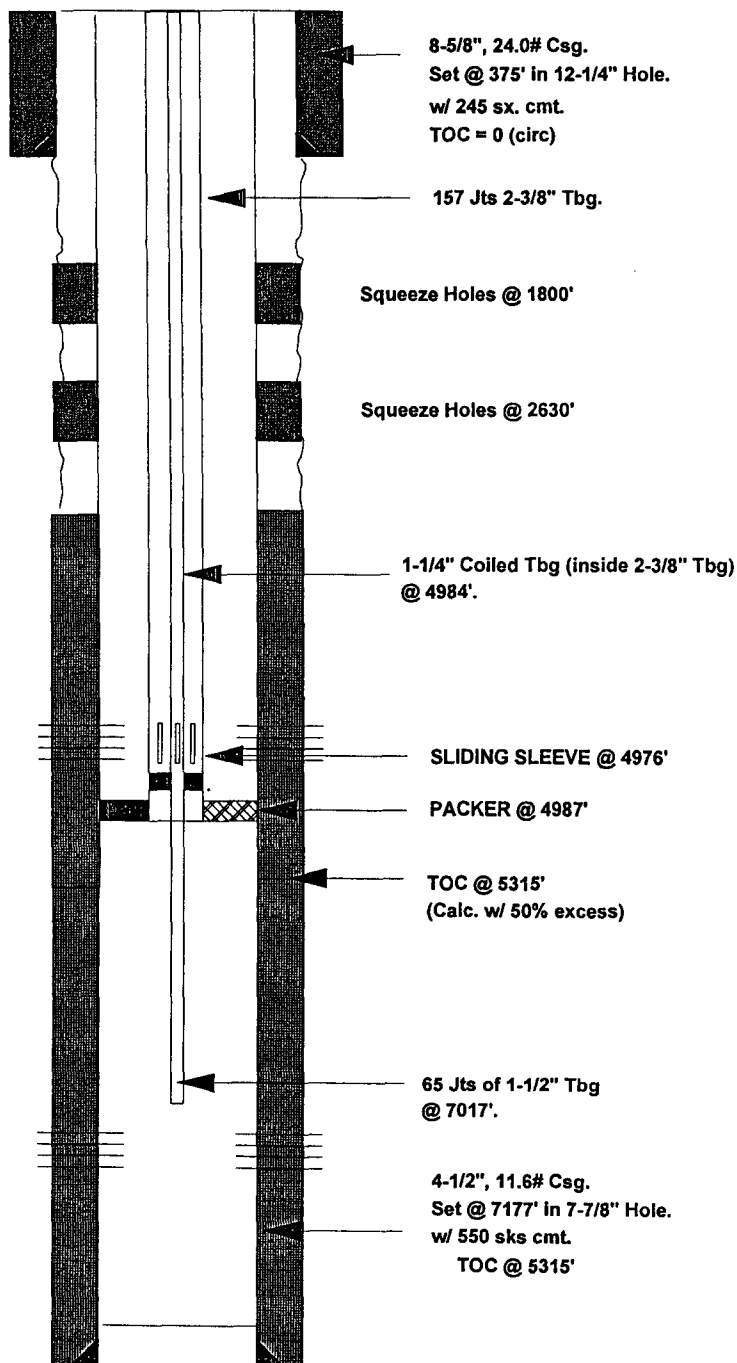

LEASE NAME: WILLIAMS, PAUL
 TEX WELL NO: 3
 CURR_LSE_NO: 017725

RSVR: DAKOTA
 REG_FLD: 71599

73 74 75 76 77 78 79 80 81 82 83 84 85 86 87 88 89 90 91 92 93 94 95 96 97 98 99

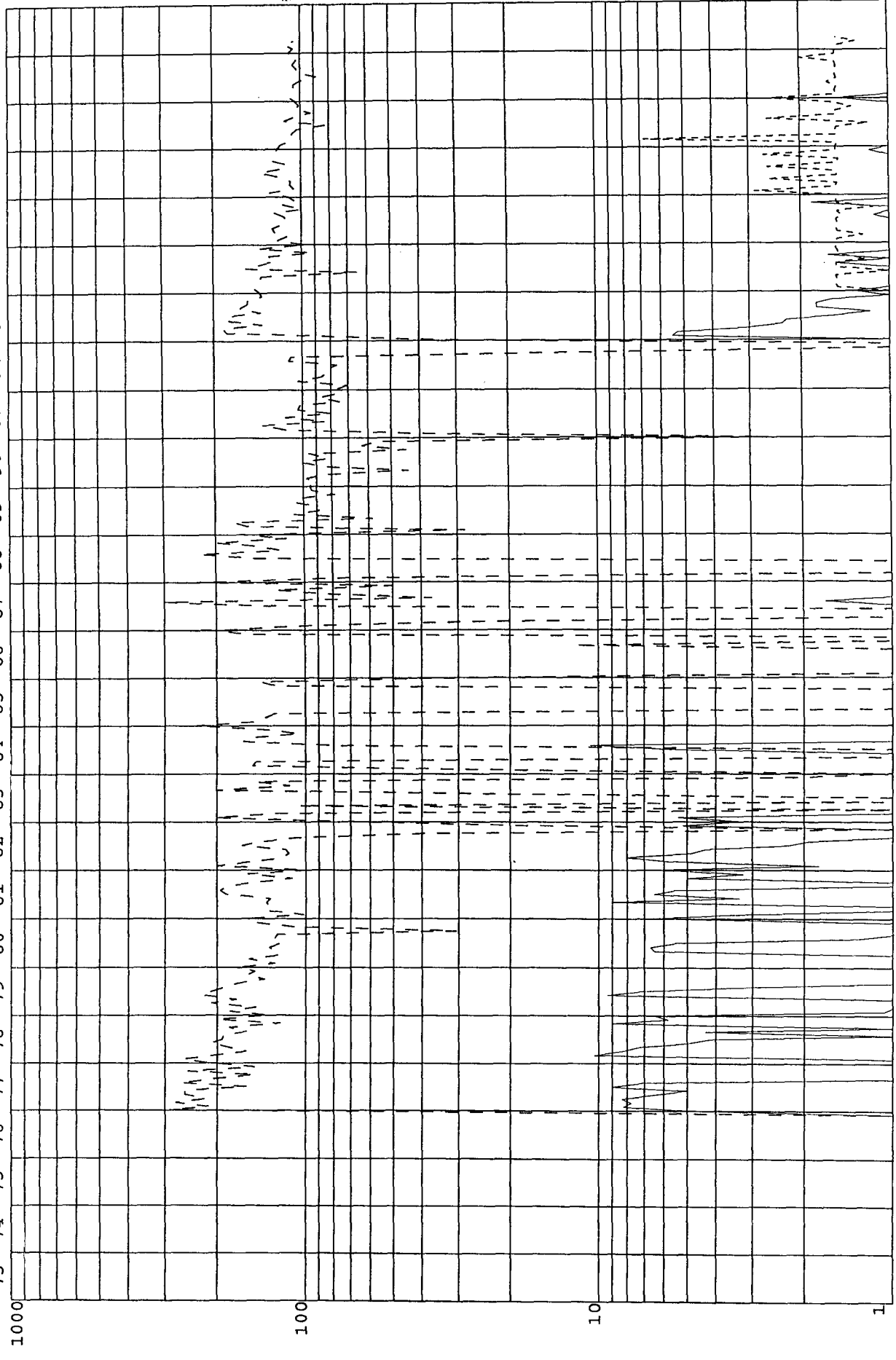

--- BOPD --- MCFFD --- BWPD --- AVG INJ PRES / 1
 CURRENT CUMS: OIL: 10,355 bbl GAS: 1,054,180 mcf WTR: 3,254 bbl WINJ: 0 bbl

D A I L Y R A T E

LEASE NAME: WILLIAMS, PAUL
 TEX_WELL_NO: 3
 CURR_LSE_NO: 017725

RSVR: REG_FLD: 72319

MV

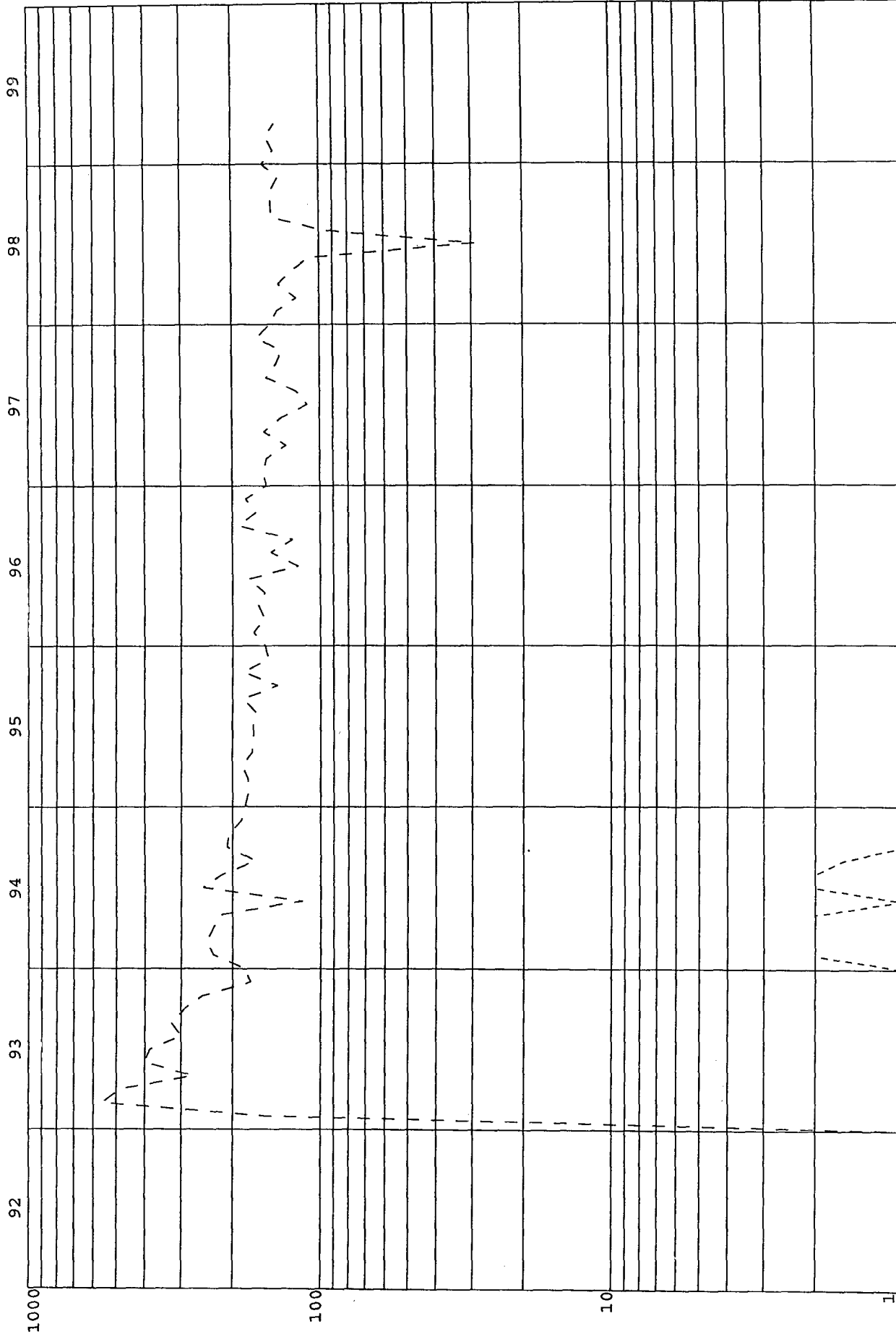

--- BOPD --- MCFPD --- BWPD --- AVG INJ PRES / 1
 CURRENT CUMS: OIL: 0 bbl GAS: 418,827 mcf WTR: 432 bbl WINJ: 0 bbl

Begin New File

SEAPORT IMAGING

EnsignTM

Scanner Type: ALL

Function: Begin New File

This is used only with multi-image file formats.
