

6/19/06 DATE IN	P-TO-05 SUSPENSE	MIKE STIGNER ENGINEER	LOGGED IN 6/20/06	TYPE SD	APP NO. PDS0617137365
--------------------	---------------------	--------------------------	-------------------	---------	-----------------------

ABOVE THIS LINE FOR DIVISION USE ONLY

NEW MEXICO OIL CONSERVATION DIVISION

- Engineering Bureau -

1220 South St. Francis Drive, Santa Fe, NM 87505



ADMINISTRATIVE APPLICATION CHECKLIST

THIS CHECKLIST IS MANDATORY FOR ALL ADMINISTRATIVE APPLICATIONS FOR EXCEPTIONS TO DIVISION RULES AND REGULATIONS WHICH REQUIRE PROCESSING AT THE DIVISION LEVEL IN SANTA FE

Application Acronyms:

[NSL-Non-Standard Location] [NSP-Non-Standard Proration Unit] [SD-Simultaneous Dedication]
 [DHC-Downhole Commingling] [CTB-Lease Commingling] [PLC-Pool/Lease Commingling]
 [PC-Pool Commingling] [OLS - Off-Lease Storage] [OLM-Off-Lease Measurement]
 [WFX-Waterflood Expansion] [PMX-Pressure Maintenance Expansion]
 [SWD-Salt Water Disposal] [IPI-Injection Pressure Increase]
 [EOR-Qualified Enhanced Oil Recovery Certification] [PPR-Positive Production Response]

[1] TYPE OF APPLICATION - Check Those Which Apply for [A]

[A] Location - Spacing Unit - Simultaneous Dedication
☐ NSL ☐ NSP ☒ SD

Check One Only for [B] or [C]

[B] Commingling - Storage - Measurement
☐ DHC ☐ CTB ☐ PLC ☐ PC ☐ OLS ☐ OLM

[C] Injection - Disposal - Pressure Increase - Enhanced Oil Recovery
☐ WFX ☐ PMX ☐ SWD ☐ IPI ☐ EOR ☐ PPR

[D] Other: Specify _____

[2] NOTIFICATION REQUIRED TO: - Check Those Which Apply, or Does Not Apply

[A] ☐ Working, Royalty or Overriding Royalty Interest Owners
 [B] ☐ Offset Operators, Leaseholders or Surface Owner
 [C] ☐ Application is One Which Requires Published Legal Notice
 [D] ☐ Notification and/or Concurrent Approval by BLM or SLO
U.S. Bureau of Land Management - Commissioner of Public Lands, State Land Office
 [E] ☐ For all of the above, Proof of Notification or Publication is Attached, and/or,
 [F] ☐ Waivers are Attached

[3] SUBMIT ACCURATE AND COMPLETE INFORMATION REQUIRED TO PROCESS THE TYPE OF APPLICATION INDICATED ABOVE.

[4] **CERTIFICATION:** I hereby certify that the information submitted with this application for administrative approval is **accurate** and **complete** to the best of my knowledge. I also understand that **no action** will be taken on this application until the required information and notifications are submitted to the Division.

Note: Statement must be completed by an individual with managerial and/or supervisory capacity.

Print or Type Name

Signature

Title

Date

e-mail Address



PLANTATION PETROLEUM COMPANIES

PLANTATION PETROLEUM HOLDINGS III, LLC; PLANTATION OPERATING, LLC

2203 Timberloch Place, Ste. 229
The Woodlands, TX 77380
Tel: (281) 296-7222
Fax: (281) 298-2333

June 16, 2006

FEDERAL EXPRESS

Michael E. Stogner, Chief Hearing Officer
New Mexico Oil Conservation Division
1220 So. St. Francis Drive
Santa Fe, NM 87505

**RE: Myer B Federal No. 34 - Proposed Drilling to Jalmat Pool
1980' FNL & 990' FEL
Unit H, Sec 6, T-24S, R-37E
Lea County, New Mexico
Administrative Application for Simultaneous Dedication,
Non-Standard Location, in Existing Non-Standard Proration Unit
Administrative Order No. NSP-1076**

2006 JUN 19 AM 10 33

Dear Mr. Stogner,

Please find enclosed a copy of previously approved **Administrative Order No. NSP-1076** to simultaneously dedicate two Jalmat gas wells, to the subject existing 160 acre Jalmat (Gas) proration unit, the **Myers B Federal No. 11 & 31** in the NSP approved December 16, 1977 consisting of NE/4 Section 6 T-24S, R-37E Lea County, New Mexico. These two wells were later recompleted as 40 acre Jalmat oil wells in December 2000 and December 1996, respectively by the previous operator. Subsequently we would like to add an additional well to the existing 160 acre NSP.

We hereby ask your approval to drill corresponding to the new drilling application for **Myer B Federal No. 34**, 1980' FNL and 990' FEL, Sec. 6, T-24S, R-37E, Lea County, New Mexico. Approval of the simultaneous dedication application will prevent waste, by allowing for the optimal recovery of remaining gas reserves while protecting our mineral rights, (including gas reserves from tighter Jalmat strata, within the Jalmat interval).

Also, please find enclosed an original of the new BLM Form 3160-3 and C-102 corresponding to the new drilling application for the **Myer B Federal No. 34** along with the C-144 and BOP diagram.

Notice of this administrative application has been sent by Federal Express to the applicable diagonal and adjacent offset Jalmat operators, as well as, the NMOCD in Hobbs, NM.

We thank you for your thoughtful review of this matter as we expect a drilling rig in the next few weeks.

Very truly yours,

PLANTATION OPERATING, LLC



John Allred, P.E.
Engineer

cc:

Chris Williams
District Supervisor – District 1
1625 N. French Drive
Hobbs, New Mexico 88240

Donna Mull
APD Permitting – District 1
1625 N. French Drive
Hobbs, New Mexico 88240

Gruy Petroleum Management Company
600 E. Colinas Blvd., Ste 1100
Irving, TX 75014-0907

XTO Energy Incorporated
200 N. Loraine, Suite 800
Midland, TX 79701

Oxy USA WTP LP
6 Desta Dr., Ste 6000
Midland, TX 79710

23S-36E

23S-37E

24S-36E

24S-37E

Acreage Ownership Plat
T-23-S & T-24-S, R-36-E & R-37-E
Lea County, New Mexico
Scale: 1" = 2000'

LIST OF OFFSET JALMAT OPERATORS

Plantation Operating, LLC
Myer B Federal # 34
H-6-T24S-R37E
Unit H, Sec. 6, T-24S, R37E
Lea County, New Mexico

Tract No.	Operator	Lease and Well Name(s)	Well Locations	PU Description	No. of Acres	ACT/INA
1 (Orange)	Gruy Petroleum Management Company	Courtland Myers #10	K-5-24S-37E	SW/4 Section 5, T-24-S, R-37-E	160	ACT
2 (Green)	Plantation Operating, LLC	Myers B Federal RA B #30	E-5-24S-37E	NW/4 Section 5, T-24-S, R-37-E	160	INA
3 (Light Blue)	XTO Energy Incorporated	E E Blinbry A Federal NCT-1 Com #5	N-31-23S-37E	SW/4, N/2 SE/4, SE/4 SE/4 Section 31 and S/2 SW/4 Section 32, T-23-S, R-37-E	355.96	ACT
4 (Pink)	Oxy USA WTP LP	Myers Langlie Mattix Unit #107	O-31-23S-37E	SW/4, SE/4 Section 31, T-23-S, R-37-E	40	INA
5 (Brown)	Plantation Operating, LLC	Carter Eaves NCT A #1	N-6-24S-37E	E/2 NW/4, E/2 SW/4 Section 6, T-24-S, R-37-E	159.8	ACT
6 (Dark Blue)	Gruy Petroleum Management Company	Courtland Myers #9	P-6-24S-37E	SE/4 Section 6, T-24-S, R-37-E	160	ACT

UNITED STATES
DEPARTMENT OF THE INTERIOR
BUREAU OF LAND MANAGEMENT

APPLICATION FOR PERMIT TO DRILL OR REENTER

FORM APPROVED
OMB No. 1004-0137
Expires March 31, 2007

1a. Type of work: <input checked="" type="checkbox"/> DRILL <input type="checkbox"/> REENTER		5. Lease Serial No. NM-7488
1b. Type of Well: <input checked="" type="checkbox"/> Oil Well <input type="checkbox"/> Gas Well <input type="checkbox"/> Other <input checked="" type="checkbox"/> Single Zone <input type="checkbox"/> Multiple Zone		6. If Indian, Allottee or Tribe Name
2. Name of Operator Plantation Operating, LLC		7. If Unit or CA Agreement, Name and No.
3a. Address 2203 Timberloch Place, Suite 229 The Woodlands, Texas 77380	3b. Phone No. (include area code) 281-296-7222	8. Lease Name and Well No. Myer B Federal # 34
4. Location of Well (Report location clearly and in accordance with any State requirements.)* At surface 1980' FNL and 990' FEL At proposed prod. zone		9. API Well No. 30-025-
10. Field and Pool, or Exploratory Jalmat (T-Y-7R) Oil		11. Sec., T. R. M. or Blk. and Survey or Area H-6, T-24-S, R-37-E
14. Distance in miles and direction from nearest town or post office* Jal, NM - South approximately 8 miles		12. County or Parish Lea
13. State NM		
15. Distance from proposed* location to nearest property or lease line, ft. (Also to nearest drig. unit line, if any) 990'	16. No. of acres in lease 40	17. Spacing Unit dedicated to this well 40
18. Distance from proposed location* to nearest well, drilling, completed, applied for, on this lease, ft. 1200'	19. Proposed Depth 3550'	20. BLM/BIA Bond No. on file NMB000344
21. Elevations (Show whether DF, KDB, RT, GL, etc.) 3313' GL	22. Approximate date work will start*	23. Estimated duration 10 Days

24. Attachments

The following, completed in accordance with the requirements of Onshore Oil and Gas Order No.1, shall be attached to this form:

- | | |
|---|--|
| 1. Well plat certified by a registered surveyor. | 4. Bond to cover the operations unless covered by an existing bond on file (see Item 20 above). |
| 2. A Drilling Plan. | 5. Operator certification |
| 3. A Surface Use Plan (if the location is on National Forest System Lands, the SUPO shall be filed with the appropriate Forest Service Office). | 6. Such other site specific information and/or plans as may be required by the authorized officer. |

25. Signature 	Name (Printed/Typed) Donald P. Dotson, P.E.	Date 06/16/2006
---	--	--------------------

Title
COO

Approved by (Signature)	Name (Printed/Typed)	Date
-------------------------	----------------------	------

Title	Office
-------	--------

Application approval does not warrant or certify that the applicant holds legal or equitable title to those rights in the subject lease which would entitle the applicant to conduct operations thereon.
Conditions of approval, if any, are attached.

Title 18 U.S.C. Section 1001 and Title 43 U.S.C. Section 1212, make it a crime for any person knowingly and willfully to make to any department or agency of the United States any false, fictitious or fraudulent statements or representations as to any matter within its jurisdiction.

*(Instructions on page 2)

DISTRICT I
1625 N. FRENCH DR., HOBBES, NM 88240

DISTRICT II
1301 W. GRAND AVENUE, ARTESIA, NM 88210

DISTRICT III
1000 Rio Brazos Rd., Aztec, NM 87410

DISTRICT IV
1220 S. ST. FRANCIS DR., SANTA FE, NM 87505

State of New Mexico
Energy, Minerals and Natural Resources Department

OIL CONSERVATION DIVISION
1220 SOUTH ST. FRANCIS DR.
Santa Fe, New Mexico 87505

Form C-102
Revised October 12, 2005
Submit to Appropriate District Office
State Lease - 4 Copies
Fee Lease - 3 Copies

WELL LOCATION AND ACREAGE DEDICATION PLAT

☐ AMENDED REPORT

API Number	Pool Code	Pool Name
Property Code	Property Name MYERS B FEDERAL	Well Number 34
OGRID No.	Operator Name PLANTATION OPERATING, LLC	Elevation 3313'

Surface Location

UL or lot No.	Section	Township	Range	Lot Idn	Feet from the	North/South line	Feet from the	East/West line	County
H	6	24-S	37-E		1980	NORTH	990	EAST	LEA

Bottom Hole Location If Different From Surface

UL or lot No.	Section	Township	Range	Lot Idn	Feet from the	North/South line	Feet from the	East/West line	County
Dedicated Acres	Joint or Infill	Consolidation Code	Order No.						

NO ALLOWABLE WILL BE ASSIGNED TO THIS COMPLETION UNTIL ALL INTERESTS HAVE BEEN CONSOLIDATED
OR A NON-STANDARD UNIT HAS BEEN APPROVED BY THE DIVISION

LOT 4 37.95 AC LOT 5	LOT 3 39.80 AC	LOT 2 39.65 AC	LOT 1 39.51 AC
38.04 AC LOT 6	GEODETIC COORDINATES NAD 27 NME Y=455836.7 N X=851558.2 E LAT.=32°14'53.14" N LONG.=103°11'46.37" W		
38.08 AC LOT 7			
38.10 AC			

OPERATOR CERTIFICATION

I hereby certify that the information herein is true and complete to the best of my knowledge and belief, and that this organization either owns a working interest or unleased mineral interest in the land including the proposed bottom hole location or has a right to drill this well at this location pursuant to a contract with an owner of such mineral or working interest, or to a voluntary pooling agreement or a compulsory pooling order heretofore entered by the division.

John Allred 6/15/06
Signature Date
JOHN ALLRED
Printed Name

SURVEYOR CERTIFICATION

I hereby certify that the well location shown on this plat was plotted from field notes of actual surveys made by me or under my supervision, and that the same is true and correct to the best of my belief.

MAY 17, 2006

Date Surveyed MR
Signature & Seal of Professional Surveyor
Gary Eidson 5/26/06
06.11.0848
Certificate No. GARY EIDSON 12841
RONALD J. EIDSON 3239

Survey Date: 05/17/06		Sheet 1 of 1 Sheets	
W.O. Number: 06.11.0848		Dr By: M.R.	Rev 1:N/A
Date: 05/22/06	Disk: CD#6	06110848	Scale: 1"=100'

LOCATION VERIFICATION MAP

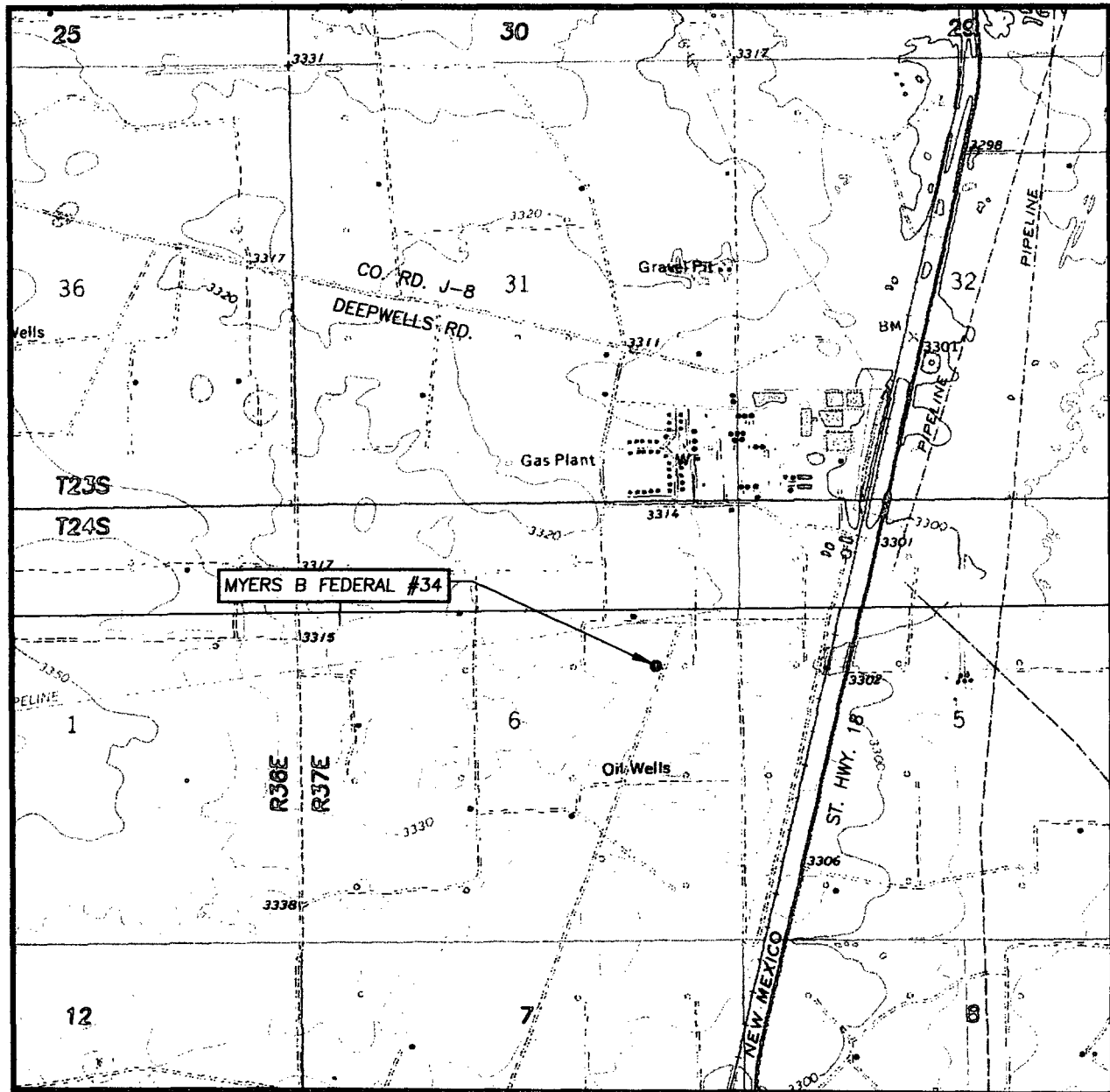

SCALE: 1" = 2000'

CONTOUR INTERVAL:
JAL NW, N.M. - 10'
RATTLESNAKE CANYON, N.M. - 10'

SEC. 6 TWP. 24-S RGE. 37-E

SURVEY N.M.P.M.

COUNTY LEA STATE NEW MEXICO

DESCRIPTION 1980' FNL & 990' FEL

ELEVATION 3313'

OPERATOR PLANTATION
OPERATING, LLC

LEASE MYERS B FEDERAL

U.S.G.S. TOPOGRAPHIC MAP
JAL NW, N.M.

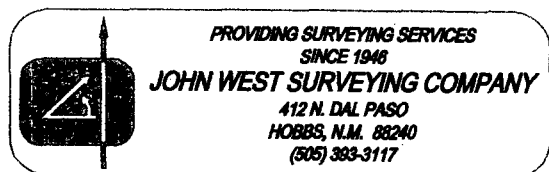

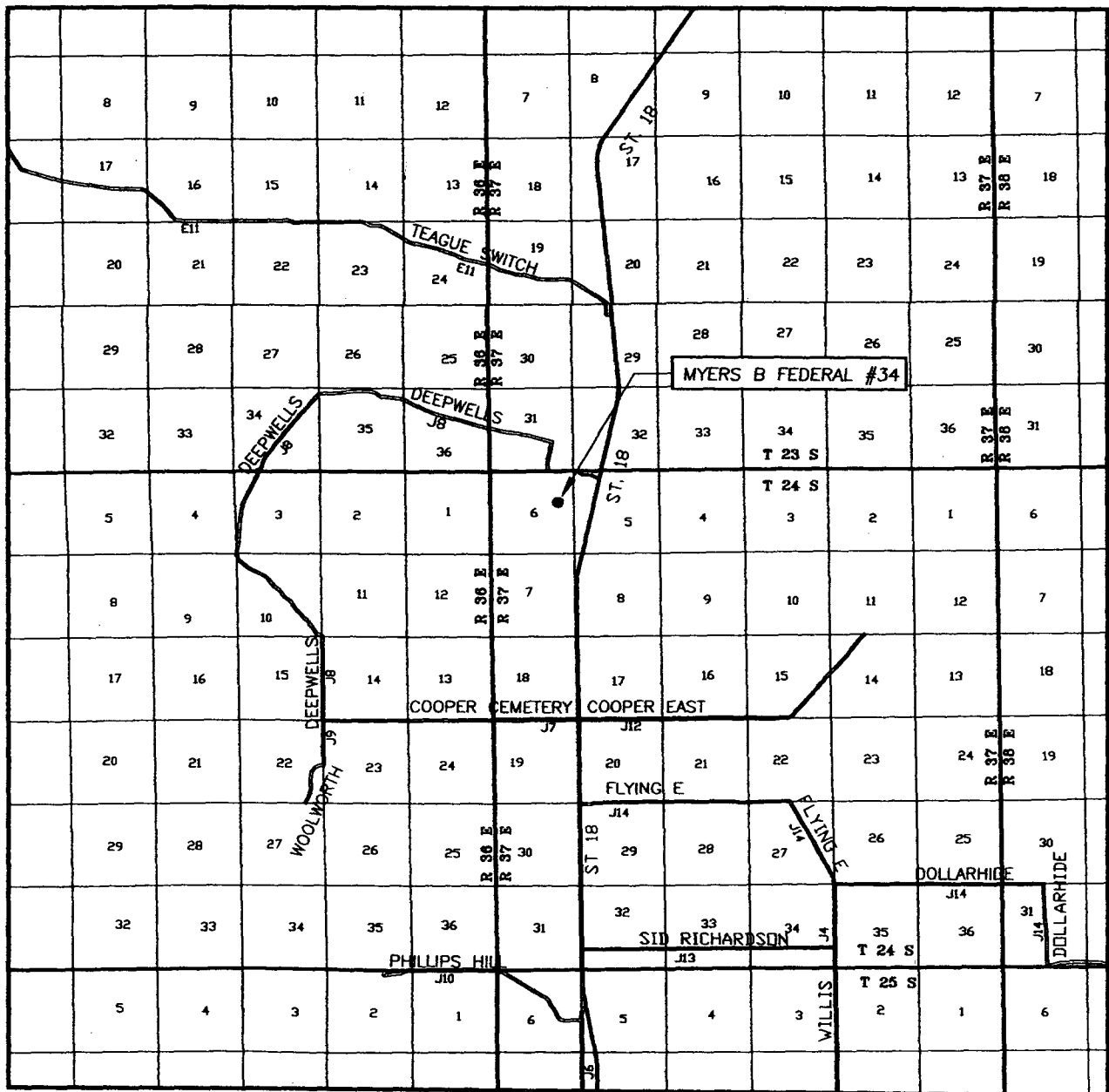

SEC. 6 TWP. 24-S RGE. 37-E
SURVEY N.M.P.M.
COUNTY LEA STATE NEW MEXICO
DESCRIPTION 1980' FNL & 990' FEL
ELEVATION 3313'
OPERATOR PLANTATION
OPERATING, LLC
LEASE MYERS B FEDERAL

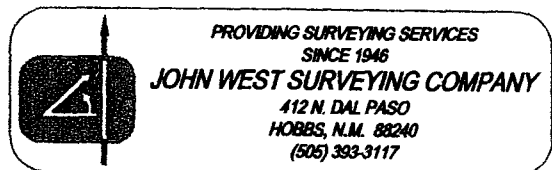

District I
1625 N. French Dr., Hobbs, NM 88240
District II
1301 W. Grand Avenue, Artesia, NM 88210
District III
1000 Rio Brazos Road, Aztec, NM 87410
District IV
1220 S. St. Francis Dr., Santa Fe, NM 87505

State of New Mexico
Energy Minerals and Natural Resources

Form C-144
June 1, 2004

Oil Conservation Division
1220 South St. Francis Dr.
Santa Fe, NM 87505

For drilling and production facilities, submit to appropriate NMOCD District Office.
For downstream facilities, submit to Santa Fe office

Pit or Below-Grade Tank Registration or Closure

Is pit or below-grade tank covered by a "general plan"? Yes ☒ No ☐

Type of action: Registration of a pit or below-grade tank ☒ Closure of a pit or below-grade tank ☐

Operator: <u>Plantation Operating, LLC</u> Telephone: <u>281-296-7222</u> e-mail address: <u>ddotson@plantationpetro.com</u>		
Address: <u>2203 Timberloch Place, Suite 229, The Woodlands, Texas 77380</u>		
Facility or well name: <u>Myer B Federal # 34</u>	API #: <u>30-025-</u>	U/L or Qtr/Qtr Unit H <u>Sec 6 T 24S R 37E</u>
County: <u>Lea</u>	Latitude <u>32° 14' 53.14" N</u>	Longitude <u>103° 11' 46.37" W</u> NAD: 1927 <input type="checkbox"/> 1983 <input type="checkbox"/>
Surface Owner: Federal <input checked="" type="checkbox"/> State <input type="checkbox"/> Private <input type="checkbox"/> Indian <input type="checkbox"/>		
Pit Type: Drilling <input type="checkbox"/> Production <input type="checkbox"/> Disposal <input type="checkbox"/> Workover <input type="checkbox"/> Emergency <input type="checkbox"/> Lined <input type="checkbox"/> Unlined <input type="checkbox"/> Liner type: Synthetic <input type="checkbox"/> Thickness <u> </u> mil Clay <input type="checkbox"/> Pit Volume <u> </u> bbl	Below-grade tank Volume: <u> </u> bbl Type of fluid: <u> </u> Construction material: <u> </u> Double-walled, with leak detection? Yes <input type="checkbox"/> If not, explain why not. <u> </u>	
Depth to ground water (vertical distance from bottom of pit to seasonal high water elevation of ground water.) <u>>100'</u>	Less than 50 feet 50 feet or more, but less than 100 feet 100 feet or more	(20 points) (10 points) <u>0</u> (0 points)
Wellhead protection area: (Less than 200 feet from a private domestic water source, or less than 1000 feet from all other water sources.)	Yes No <u> </u> No	(20 points) (0 points) <u>0</u>
Distance to surface water: (horizontal distance to all wetlands, playas, irrigation canals, ditches, and perennial and ephemeral watercourses.)	Less than 200 feet 200 feet or more, but less than 1000 feet 1000 feet or more	(20 points) (10 points) (0 points) <u>0</u>
Ranking Score (Total Points)		<u>0</u>

If this is a pit closure: (1) Attach a diagram of the facility showing the pit's relationship to other equipment and tanks. (2) Indicate disposal location: (check the onsite box if you are burying in place) onsite ☐ offsite ☐ If offsite, name of facility . (3) Attach a general description of remedial action taken including remediation start date and end date. (4) Groundwater encountered: No ☐ Yes ☐ If yes, show depth below ground surface ft. and attach sample results. (5) Attach soil sample results and a diagram of sample locations and excavations.

Additional Comments:
<u>Closed Loop System.</u>

I hereby certify that the information above is true and complete to the best of my knowledge and belief. I further certify that the above-described pit or below-grade tank has been/will be constructed or closed according to NMOCD guidelines ☐, a general permit ☐, or an (attached) alternative OCD-approved plan ☐.

Date: 6/16/2006

Printed Name/Title Donald P. Dotson / COO

Signature 

Your certification and NMOCD approval of this application/closure does not relieve the operator of liability should the contents of the pit or tank contaminate ground water or otherwise endanger public health or the environment. Nor does it relieve the operator of its responsibility for compliance with any other federal, state, or local laws and/or regulations.

Approval:

Printed Name/Title

Signature

Date:

Plantation Operating, LLC
BOP Schematic for 8-3/4 or- 7-7/8" Hole

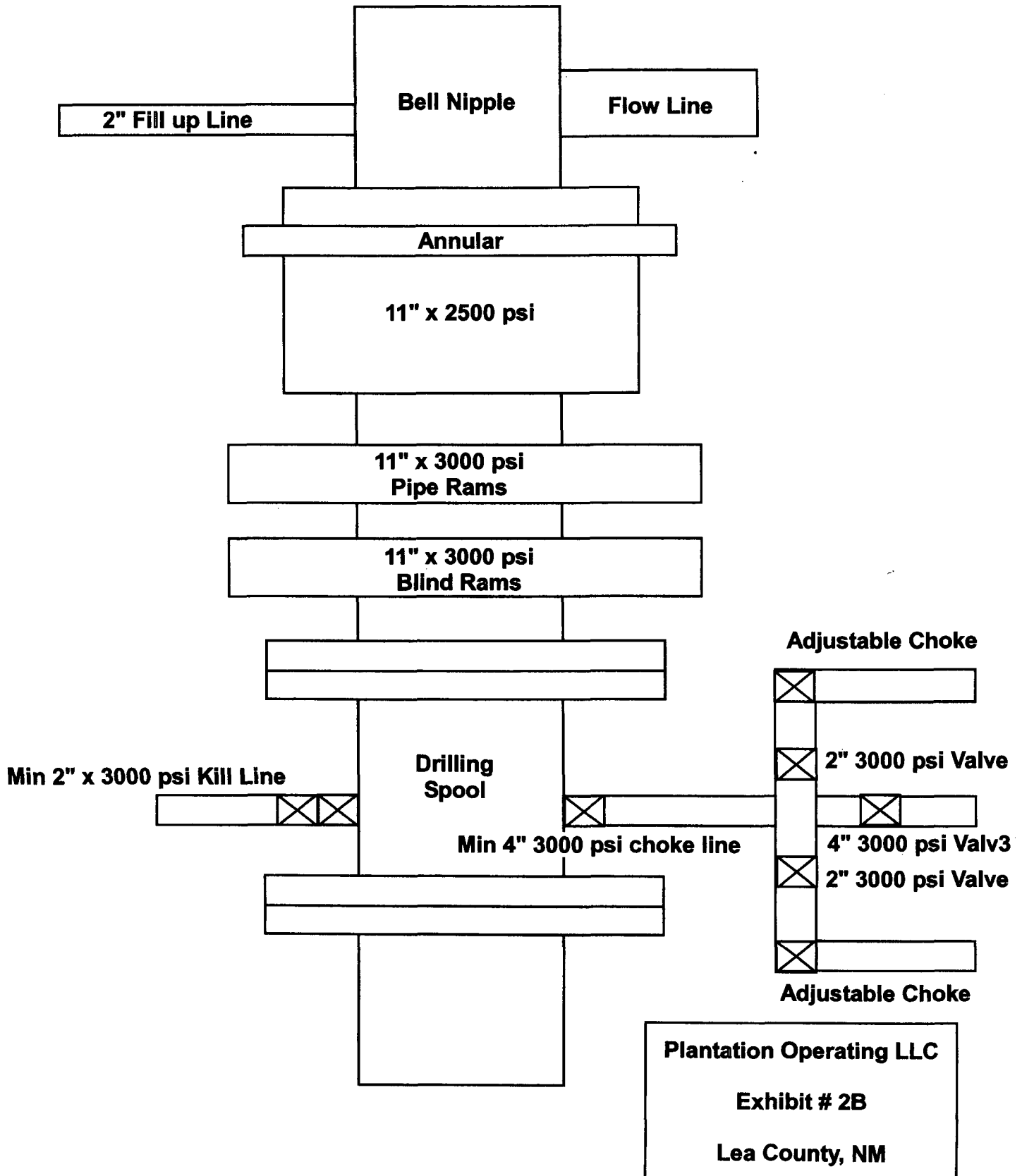

Plantation Operating, LLC
BOP Schematic for 6-1/8" or- 7-7/8" Hole

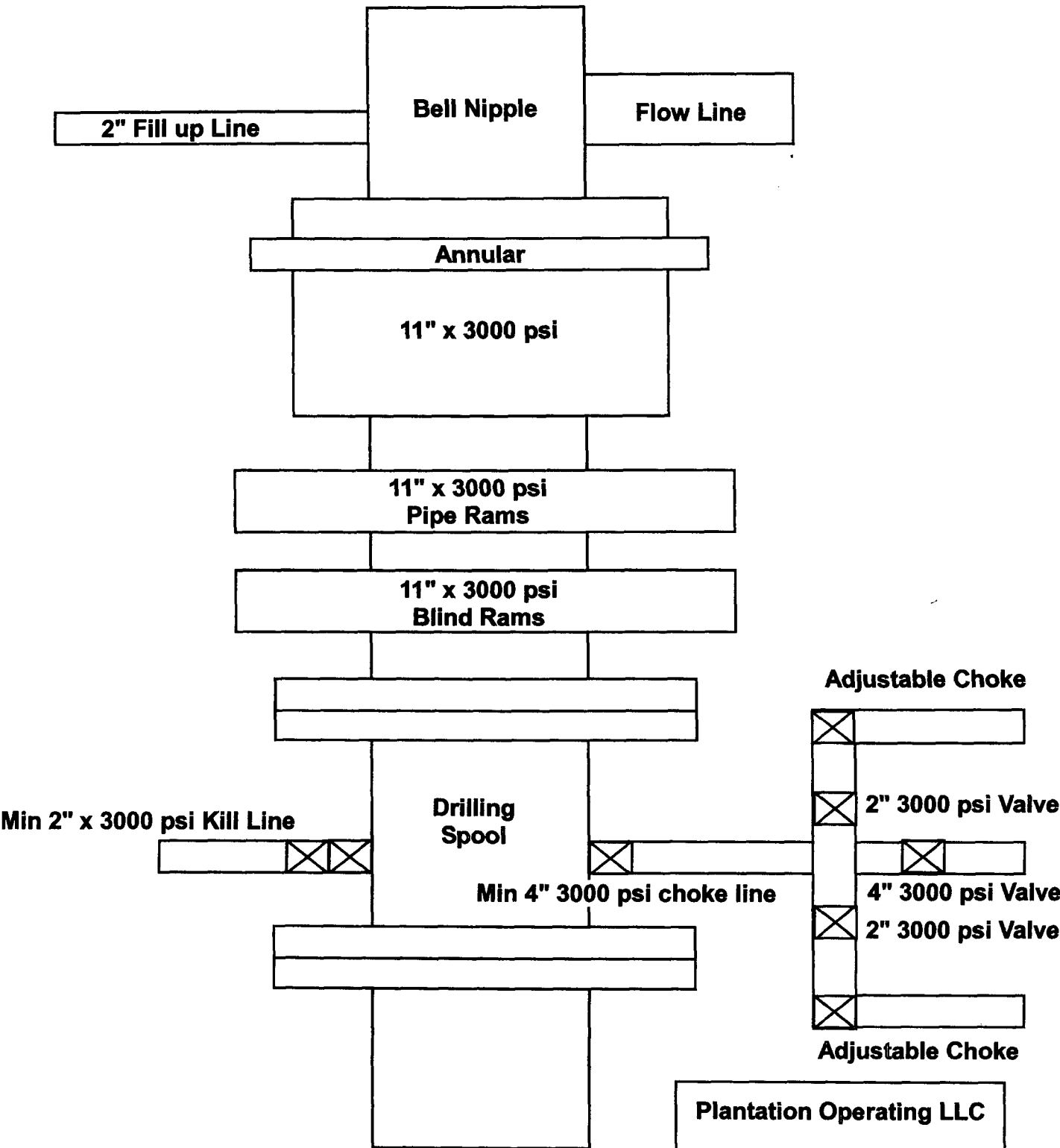





Amoco Production Company

Post Office Box 68
Hobbs, New Mexico 88240

S. J. Okerson
District Superintendent

June 18, 1980

File: EDR-986.51 X WF-762

Re: Application for Administrative Approval
for Simultaneous Dedication in the
Jalmat Gas Pool
Lea County, New Mexico

Mr. Joe D. Ramey
New Mexico Oil Conservation Division
P. O. Box 2088
Santa Fe, NM 87501

Dear Sir:

Amoco Production Company requests administrative approval for simultaneous dedication of a 160 acre non-standard proration unit for the Myers "B" Federal RA/B Well Nos. 11 and 31 located in Units B and G, respectively, Section 6, T-24-S, R-37-E, Lea County, New Mexico. Both wells are in the Jalmat Gas Pool.

Administrative Order No. NSP-1076 dated December 16, 1977 approved a 160 acre non-standard gas proration unit in the Jalmat Gas Pool consisting of the NE/4 of Section 6, T-24-S, R-37-E, Lea County, New Mexico for our Myers "B" Federal RA/B Well No. 31.

Our well No. 11 is located in Unit B, 660' FNL and 1980' FEL, Section 6, T-24-S, R-37-E, Lea County, New Mexico.

Attached are revised copies of Form C102 for the Myers "B" RA/B Federal Well Nos. 11 and 31.

Yours very truly,

Original Signed by:
S. J. OKERSON

Attachments

cc: New Mexico Oil Conservation Division
Hobbs, NM

THIS COPY
FOR

bn: New Mexico Oil Conservation Division, Hobbs, NM.
Attached are extra copies of revised C-102 Forms
for your files on our Myers "B" Federal RA/B Well
Nos. 11 and 31. These new forms supercede the
forms you now have on file.

NDE/LTH

Admn Open

2/2/80

June 10, 1980

Myers "B" Fed RA/B Well No. 31

File: ELK-906.51 * WF-762

Re: Application for Administrative Approval
for Simultaneous Dedication in the
Jalmat Gas Pool
Lea County, New Mexico

Mr. Joe D. Raney
New Mexico Oil Conservation Division
P. O. Box 2093
Santa Fe, NM 87501

Dear Sir:

Arco Production Company requests administrative approval for simultaneous dedication of a 160 acre non-standard proration unit for the Myers "B" Federal RA/B Well Nos. 11 and 31 located in Units 2 and 6, respectively, Section 6, T-24-S, R-37-E, Lea County, New Mexico. Both wells are in the Jalmat Gas Pool.

Administrative Order No. NSP-1076 dated December 16, 1977 approved a 160 acre non-standard gas proration unit in the Jalmat Gas Pool consisting of the NE/4 of Section 6, T-24-S, R-37-E, Lea County, New Mexico for our Myers "B" Federal RA/B Well No. 31.

Our well No. 11 is located in Unit 2, 560' FUL and 1780' FEL, Section 6, T-24-S, R-37-E, Lea County, New Mexico.

Attached are revised copies of Form C102 for the Myers "B" RA/B Federal Well Nos. 11 and 31.

Yours very truly,

Original Signed by:
S. J. OKERSON

Attachments

cc: New Mexico Oil Conservation Division
Hobbs, NM

enc: New Mexico Oil Conservation Division, Hobbs, NM.
Attached are extra copies of revised C-102 Forms
for your files on our Myers "B" Federal RA/B Well
Nos. 11 and 31. These new forms supercede the
forms you now have on file.

DRF/RLN

MEXICO OIL CONSERVATION COMMISSION
WELL LOCATION AND ACREAGE DEDICATION PLAT

Form C-102
 Supersedes C-128
 Effective 1-1-65

All distances must be from the outer boundaries of the Section

Operator Amoco Production Company			Lease Myers "B" Federal RA/B		Well No. 31
Unit Letter G	Section 6	Township 24 South	Range 37 East	County Lea	
Actual Footage Location of Well:					
1650	feet from the	North	line and	1830	feet from the East line
Ground Level Elev. 3324.7	Producing Formation Yates-Seven Rivers		Pool Jalmat	Dedicated Acreage: 160 Acres	

1. Outline the acreage dedicated to the subject well by colored pencil or hatchure marks on the plat below.
2. If more than one lease is dedicated to the well, outline each and identify the ownership thereof (both as to working interest and royalty).
3. If more than one lease of different ownership is dedicated to the well, have the interests of all owners been consolidated by communitization, unitization, force-pooling, etc?

☒ Yes ☐ No If answer is "yes," type of consolidation _____

If answer is "no," list the owners and tract descriptions which have actually been consolidated. (Use reverse side of this form if necessary.) _____

No allowable will be assigned to the well until all interests have been consolidated (by communitization, unitization, forced-pooling, or otherwise) or until a non-standard unit, eliminating such interests, has been approved by the Commission.

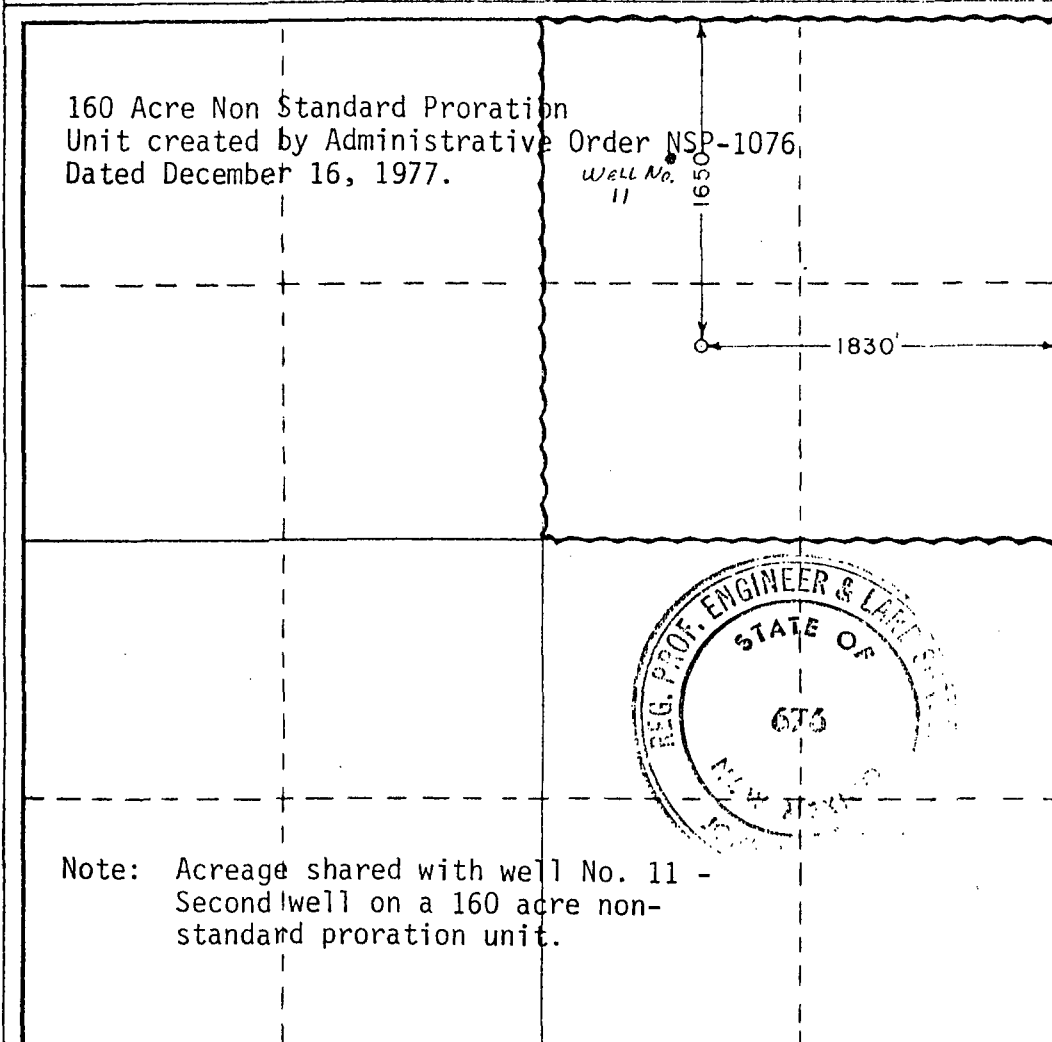

CERTIFICATION

I hereby certify that the information contained herein is true and complete to the best of my knowledge and belief.

Dennis Evans

Name

Position

Administrative Analyst

Company

Amoco Production Co.

Date

6/18/80

I hereby certify that the well location shown on this plat was plotted from field notes of actual surveys made by me or under my supervision, and that the same is true and correct to the best of my knowledge and belief.

Date Surveyed

October 15, 1977

Registered Professional Engineer and/or Land Surveyor

John W. West

Certificate No.

676

0 330 660 990 1320 1650 1980 2310 2640 2000 1800 1600 1400 1200 1000 800

NEW MEXICO OIL CONSERVATION COMMISSION
WELL LOCATION AND ACREAGE DEDICATION AT

Form C-102
Supersedes C-128
Effective 1-1-65

All distances must be from the original boundaries of the Section.

Operator Amoco Production Company			Lease Myers "B" Federal RA/B			Well No. 11		
Unit Letter B	Section 6	Township 24 South	Range 37 East	County Lea				
Actual Footage Location of Well: 660 feet from the North line and 1980 feet from the East line								
Ground Level Elev. 3325 RDB	Producing Formation Yates-Seven Rivers		Pool Jalmat			Dedicated Acreage: 160 Acres		

1. Outline the acreage dedicated to the subject well by colored pencil or hatchure marks on the plat below.
2. If more than one lease is dedicated to the well, outline each and identify the ownership thereof (both as to working interest and royalty).
3. If more than one lease of different ownership is dedicated to the well, have the interests of all owners been consolidated by communitization, unitization, force-pooling, etc?

☒ Yes ☐ No If answer is "yes," type of consolidation _____

If answer is "no," list the owners and tract descriptions which have actually been consolidated. (Use reverse side of this form if necessary.) _____

No allowable will be assigned to the well until all interests have been consolidated (by communitization, unitization, forced-pooling, or otherwise) or until a non-standard unit, eliminating such interests, has been approved by the Commission.

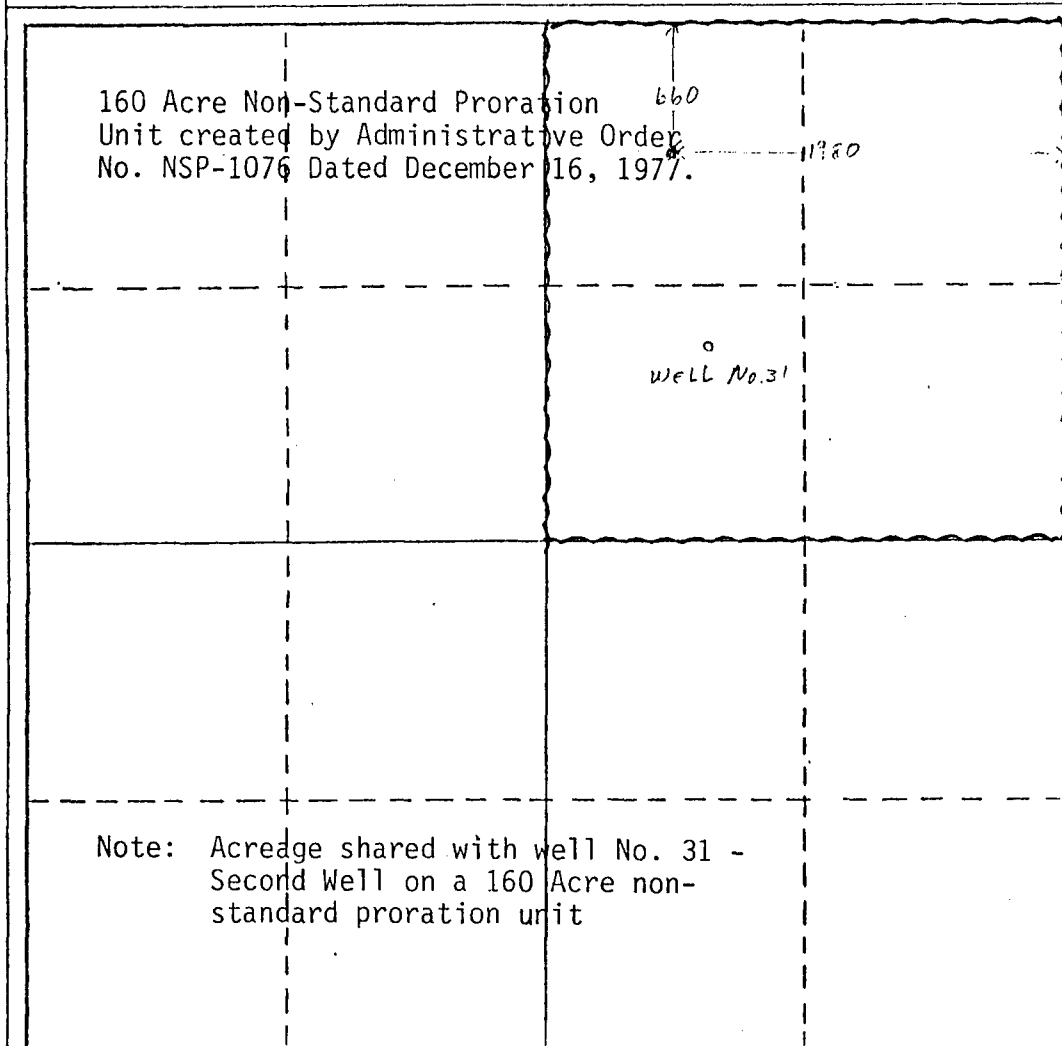

CERTIFICATION

I hereby certify that the information contained herein is true and complete to the best of my knowledge and belief.

Name **Dennis Evans**
Position **Administrative Analyst**
Company **Amoco Production Co.**
Date **6/18/80**

I hereby certify that the well location shown on this plat was plotted from field notes of actual surveys made by me or under my supervision, and that the same is true and correct to the best of my knowledge and belief.

Date Surveyed _____
Registered Professional Engineer and/or Land Surveyor _____

Certificate No. _____

0 330 660 990 1320 1650 1980 2310 2640 2970 3300 3630 3960 4290 4620 4950 5280 5610 5940 6270 6600

Well List

237788 PLANTATION OPERATING LLC

TOTAL WELL COUNT:131

PRINTED ON:FRIDAY, JUNE 16, 2006

Property	Well Name	Lease Type	ULSTR	OCD UL	API	Well Type	Pool	Last Prod/Inj	Oil POD	Gas POD	In A Bor
	#001						RVRS (GAS)				
302114	MCKINNEY #001	S	A-36-24S-36E	A	30-025-09709	S	96132 SWD;SEVEN RIVERS-QUEEN	3/2006			4/1/2
302115	MEXICO E COM #001	S	O-2 -23S-36E	O	30-025-09224	G	79240 JALMAT;TAN-YATES-7 RVRS (GAS)	2/2004		2806193	3/1/2
	MEXICO E COM #002	S	N-2 -23S-36E	N	30-025-09225	O	79240 JALMAT;TAN-YATES-7 RVRS (GAS)	3/2006	2806342	2806323	4/1/2
	MEXICO E COM #002	S	N-2 -23S-36E	N	30-025-09225	O	37240 LANGLIE MATTIX;7 RVRS-Q-GRAYBURG	3/2006	2474010	2490930	4/1/2
	MEXICO E COM #003	S	M-2 -23S-36E	M	30-025-09226	O	79240 JALMAT;TAN-YATES-7 RVRS (GAS)	3/2006	2474010	2474030	4/1/2
	MEXICO E COM #003	S	M-2 -23S-36E	M	30-025-09226	O	37240 LANGLIE MATTIX;7 RVRS-Q-GRAYBURG	3/2006	2474010	2474030	4/1/2
	MEXICO E COM #004	S	P-2 -23S-36E	P	30-025-09227	G	79240 JALMAT;TAN-YATES-7 RVRS (GAS)	3/2006	2806342	2806323	4/1/2
	MEXICO E COM #005	S	O-2 -23S-36E	O	30-025-09228	O	79240 JALMAT;TAN-YATES-7 RVRS (GAS)	3/2006	2474010	2474030	4/1/2
	MEXICO E COM #005	S	O-2 -23S-36E	O	30-025-09228	O	37240 LANGLIE MATTIX;7 RVRS-Q-GRAYBURG	3/2006	2474010	2474030	4/1/2
302116	MEXICO G #001	S	D-16-24S-37E	D	30-025-11122	G	79240 JALMAT;TAN-YATES-7 RVRS (GAS)	3/2006		2806324	4/1/2
	MEXICO G #002	S	F-16-24S-37E	F	30-025-11123	O	37240 LANGLIE MATTIX;7 RVRS-Q-GRAYBURG	3/2006	4007457	4007456	4/1/2
	MEXICO G #003	S	E-16-24S-37E	E	30-025-32683	O	79240 JALMAT;TAN-YATES-7 RVRS (GAS)	3/2006		2814319	4/1/2
302117	MEYER B 27 #001	F	E-27-20S-37E	E	30-025-06271	G	76480 EUMONT;YATES-7 RVRS-QUEEN (GAS)	3/2006	2804588	1069230	
302118	MEYER B 28 A COM AC2 #002	F	O-28-20S-37E	O	30-025-06273	G	76480 EUMONT;YATES-7 RVRS-QUEEN (GAS)	3/2006	1069310	1069330	
302119	MYERS B FEDERAL #001	F	1-7 -24S-37E	D	30-025-11037	G	79240 JALMAT;TAN-YATES-7 RVRS (GAS)	3/2006	77810	77831	
	MYERS B FEDERAL #010	F	G-7 -24S-37E	G	30-025-11047	G	79240 JALMAT;TAN-YATES-7 RVRS (GAS)	3/2006		2827212	
	MYERS B FEDERAL #011	F	2-6 -24S-37E	B	30-025-11024	O	33820 JALMAT;TAN-YATES-7 RVRS (OIL)	3/2006	4001232	4001231	
	MYERS B FEDERAL #013	F	L-9 -24S-37E	L	30-025-11073	G	79240 JALMAT;TAN-YATES-7 RVRS (GAS)	3/2006	77910	77931	
	MYERS B FEDERAL #029	F	O-9 -24S-37E	O	30-025-26455	G	37240 LANGLIE MATTIX;7 RVRS-Q-GRAYBURG	1/2004	401810	401830	
	MYERS B FEDERAL #031	F	G-6 -24S-37E	G	30-025-25766	O	33820 JALMAT;TAN-YATES-7 RVRS (OIL)	3/2006	4001234	4001233	
	MYERS B FEDERAL #033	F	B-7 -24S-37E	B	30-025-25973	G	79240 JALMAT;TAN-YATES-7 RVRS (GAS)	3/2006		2828702	
302120	NEW MEXICO AA STATE #001	S	H-22-23S-36E	H	30-025-09374	G	79240 JALMAT;TAN-YATES-7 RVRS (GAS)	3/2006	2828652	1072430	4/1/2

Lease Name: MYERS B FEDERAL
County, State: LEA, NM
Operator: HARTMAN DOYLE
Field: JALMAT
Reservoir: TANSILL-YATES-SEVEN
Location: 6 24S 37E

MYERS B FEDERAL 11 6 24S 37E JALMAT Inactive

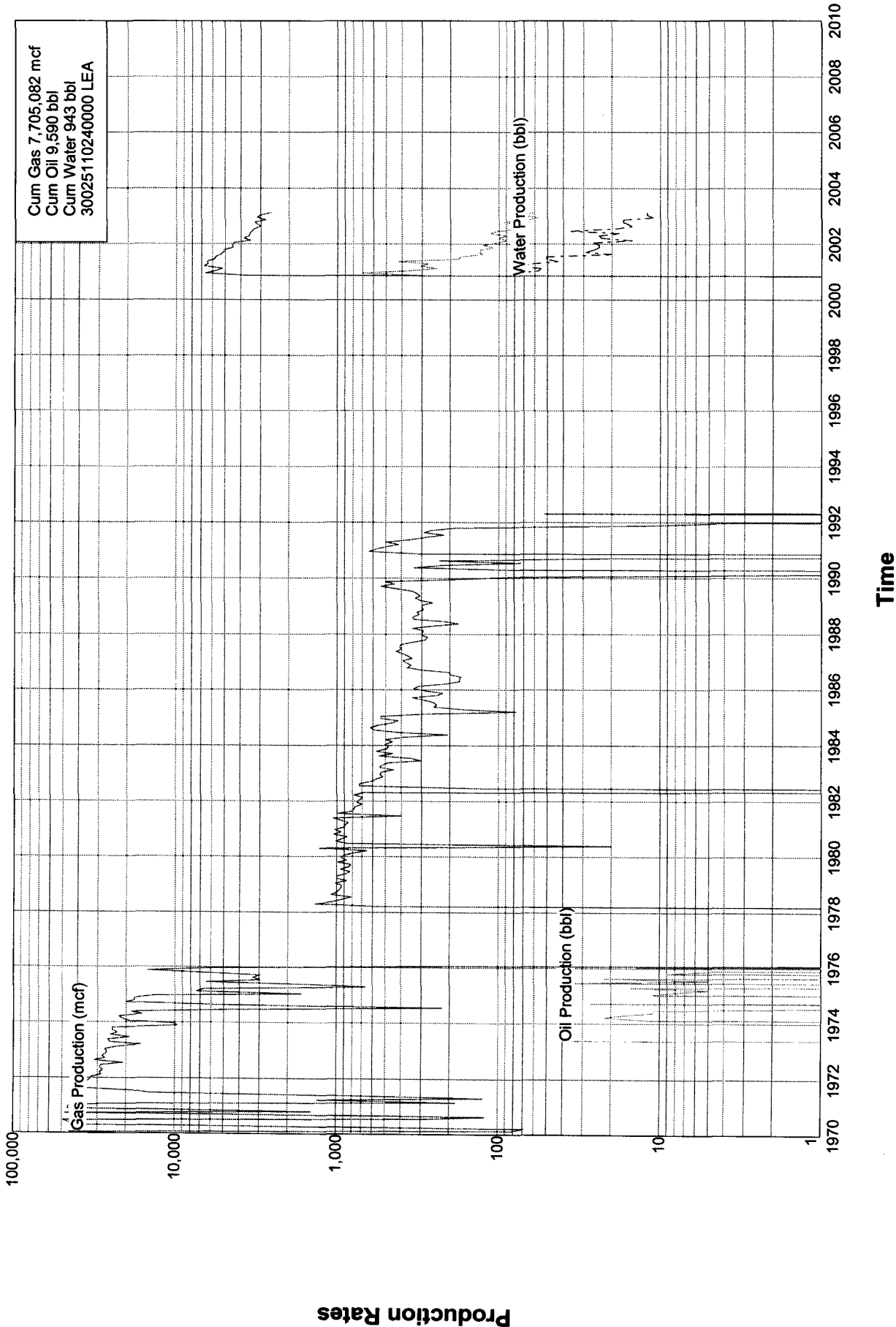

District I
PO Box 1980, Hobbs, NM 88241-1980

District II
811 South First, Artesia, NM 88210

District III
1000 Rio Brazos Rd., Aztec, NM 87410

District IV
2040 South Pacheco, Santa Fe, NM 87505

State of New Mexico
Energy, Minerals & Natural Resources Department

OIL CONSERVATION DIVISION
2040 South Pacheco
Santa Fe, NM 87505

Form C-102
Revised October 18, 1994
Instructions on back
Submit to Appropriate District Office
State Lease - 4 Copies
Fee Lease - 3 Copies

☐ AMENDED REPORT

WELL LOCATION AND ACREAGE DEDICATION PLAT

API Number 30-025-11024	Pool Code 33820	Pool Name Jalmat (T-Y-7R) Oil
Property Code 19388	Property Name Myers "B" Federal	Well Number 11
OGRID No. 6473	Operator Name Doyle Hartman	Elevation 3324' GR

Surface Location

UL or lot no. B	Section 6	Township 24S	Range 37E	Lot Idn	Feet from the 660'	North/South line North	Feet from the 1980'	East/West Line East	County Lea
--------------------	--------------	-----------------	--------------	---------	-----------------------	---------------------------	------------------------	------------------------	---------------

Bottom Hole Location If Different From Surface

UL or lot no.	Section	Township	Range	Lot Idn	Feet from the	North/South line	Feet from the	East/West Line	County
Dedicated Acres 40	Joint or Infill N	Consolidation Code	Order No.						

NO ALLOWABLE WILL BE ASSIGNED TO THIS COMPLETION UNTIL ALL INTERESTS HAVE BEEN CONSOLIDATED
OR A NON-STANDARD UNIT HAS BEEN APPROVED BY THE DIVISION

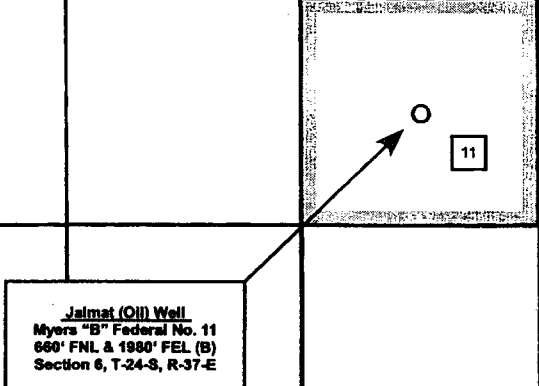
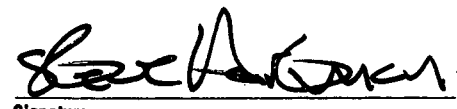
16		17 OPERATOR CERTIFICATION <i>I hereby certify that the information contained herein is true and complete to the best of my knowledge and belief.</i>  Signature Steve Hartman Printed Name Engineer Title 04/13/2004 Date
		18 SURVEYOR CERTIFICATION <i>I hereby certify that the well location shown on this plat was plotted from field notes of actual surveys made by me or under my supervision, and that the same is true and correct to the best of my belief.</i> Date of Survey Signature and Seal of Professional Surveyer: Certificate Number

Lease Name: MYERS B FEDERAL
County, State: LEA, NM
Operator: HARTMAN DOYLE
Field: JALMAT
Reservoir: TANSILL-YATES-SEVEN
Location: 6 24S 37E

MYERS B FEDERAL 31 6 24S 37E JALMAT Inactive

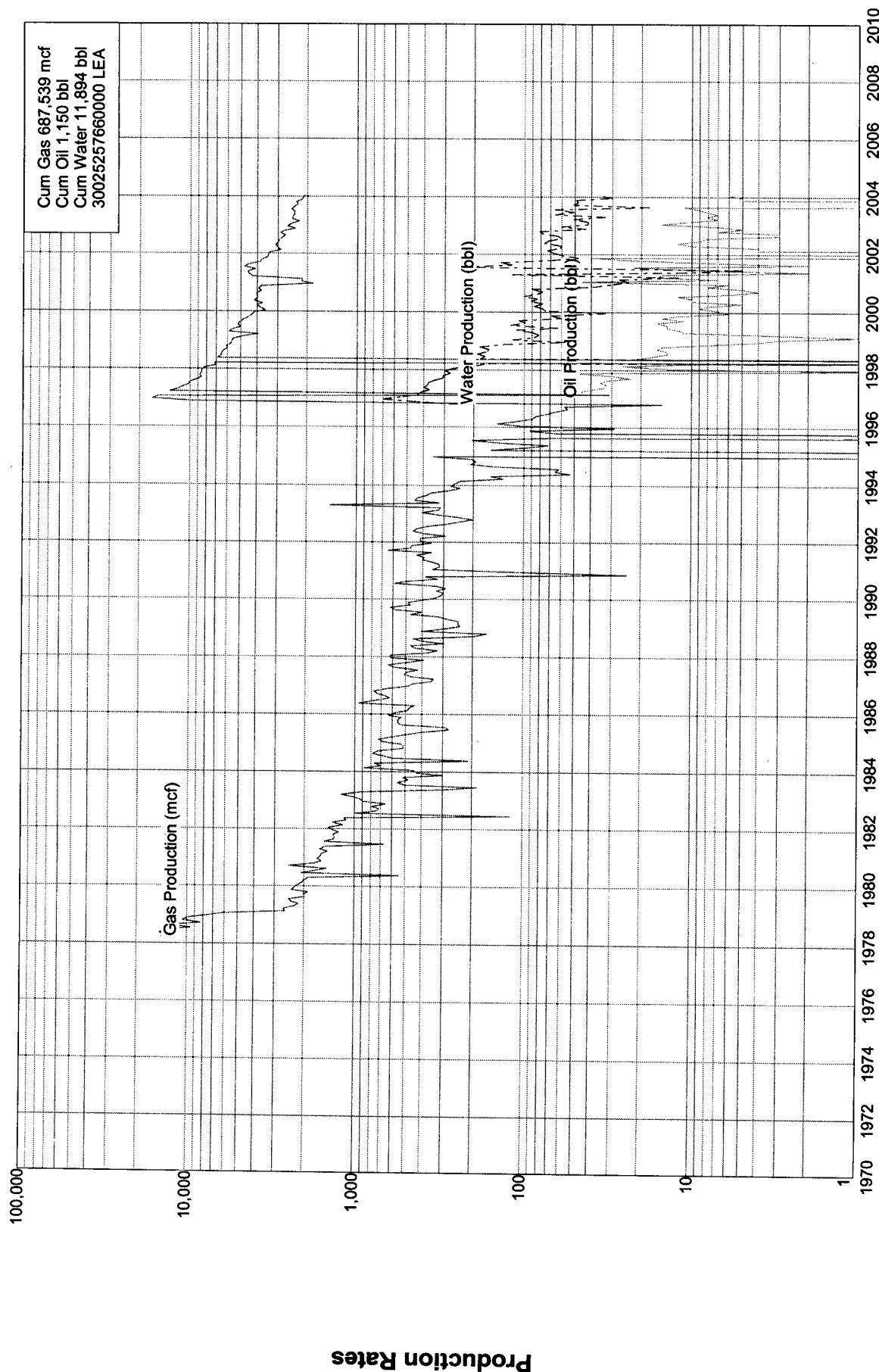

District IV
2040 South Pacheco, Santa Fe, NM 87505

OIL CONSERVATION DIVISION
2040 South Pacheco
Santa Fe, NM 87505

Fee Lease - 3 Copies

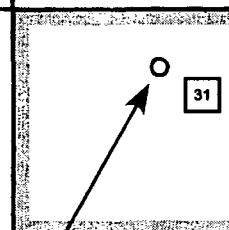
16				17 OPERATOR CERTIFICATION <i>I hereby certify that the information contained herein is true and complete to the best of my knowledge and belief.</i>  _____ Signature Steve Hartman _____ Printed Name Engineer _____ Title 04/22/2004 _____ Date
				18 SURVEYOR CERTIFICATION <i>I hereby certify that the well location shown on this plat was plotted from field notes of actual surveys made by me or under my supervision, and that the same is true and correct to the best of my belief.</i> _____ Date of Survey _____ Signature and Seal of Professional Surveyer:
	<div data-bbox="267 1666 509 1785"><u>Jalmat (Oil) Well</u> Myers "B" Federal No. 31 1650' FNL & 1830' FEL (G) Section 6, T-24-S, R-37-E</div>			_____ Certificate Number

August 3, 2006

~ 4:00 PM

- talked w/ John Allred

* Both the Meyers "B" Fed. #

Wells No. 31 and 11 are
classified oil wells w/ 40-acre
units dedicated to each.

* application is amended to create
an 80-acre NSP comprising the
 $E\frac{1}{2}$ NE $\frac{1}{4}$ of Sec. 6 for Plantation's
proposed Meyer "B" Fed. #34

Stogner, Michael, EMNRD

From: John Allred [jallred@plantationpetro.com]
To: Stogner, Michael, EMNRD
Cc:
Subject: RE: Myers B Federal # 34
Attachments:

Sent: Wed 8/2/2006 2:57 PM

- 1.) Is yes, via previous operator (Hartman).
- 2.) The GOR will dictate gas or oil well. We talked about this before, and you said we would file the C-116 GOR Test and classify the well accordingly.

-----Original Message-----

From: Stogner, Michael, EMNRD [mailto:michael.stogner@state.nm.us]
Sent: Wednesday, August 02, 2006 3:42 PM
To: John Allred
Subject: RE: Myers B Federal # 34

I'm a little confused with your Mayers "B" Federal Well No. 34 application (*pTDS0-617137365*). Let me make sure I have the facts straight:

- (1) Both the existing Mayers "B" Federal Wells No. 11 and 31 are Jalmat oil wells with 40-acre dedications each?
Yes/No
- (2) Your C-101 for the proposed #34 well indicates this to be a Jalmat oil well also? Yes/No

From: John Allred [mailto:jallred@plantationpetro.com]
Sent: Wed 7/26/2006 12:16 PM
To: Stogner, Michael, EMNRD
Subject: Re: Myers B Federal # 34

Michael:

Re: Myers B Federal # 34

Just wanted to check on the Myers B Federal # 34 approval, since we sent it June 16, 2006.

Also, the State H-17 # 2 was sent in July 13, 2006, still awaiting the 20 days.

Regards,

John Allred, P.E.
Plantation Petroleum Companies
2203 Timberloch Place, Suite 229
The Woodlands, Texas 77380
(281) 296-7222 w
(281) 389-8832 m
(281) 298-2333 Fax

Confidentiality Notice: This e-mail, including all attachments is for the sole use of the intended recipient(s) and may contain confidential and privileged information. Any unauthorized review, use, disclosure or distribution is prohibited unless specifically provided under the New Mexico Inspection of Public Records Act. If you are not the intended recipient, please contact the sender and destroy all copies of this message. -- This email has been scanned by the Sybari - Antigen Email System.