

District I
1625 N. French Drive, Hobbs, NM 88240

District II
811 South First Street, Artesia, NM 88210

District III
1000 Rio Brazos Road, Aztec, NM 87410

District IV
2040 South Pacheco, Santa Fe, NM 87505

State of New Mexico
Energy, Minerals and Natural Resources Department

OIL CONSERVATION DIVISION

2040 South Pacheco
Santa Fe, New Mexico 87505

Form C-107A
Revised May 15, 2000

APPLICATION TYPE

☒ Single Well

☐ Establish Pre-Approved Pools

EXISTING WELLBORE

☒ Yes ☐ No

APPLICATION FOR DOWNHOLE COMMINGLING
AMENDMENT

Yates Petroleum Corporation 105 South Fourth Street Artesia, New Mexico 88210
Operator Address

Huckabay TJ Federal Com 8 D 23 8S 26E Chaves
Lease Well No. Unit Letter-Section-Township-Range County

OGRID No. 025575 Property Code API No. 30-005-63504 Lease Type: ☒ Federal ☐ State ☐ Fee

DATA ELEMENT	UPPER ZONE	INTERMEDIATE ZONE	LOWER ZONE
Pool Name	Pecos Slope Abo		Foor Ranch Pre-Permian North
Pool Code	22730		97094
Top and Bottom of Pay Section (Perforated or Open-Hole Interval)	4498-4878'		5858-5878' 6118-6170'
Method of Production (Flowing or Artificial Lift)	Flowing		Flowing
Bottomhole Pressure (Note: Pressure data will not be required if the bottom perforation in the lower zone is within 150% of the depth of the top perforation in the upper zone)	N/A		N/A
Oil Gravity or Gas BTU (Degree API or Gas BTU)			
Producing, Shut-In or New Zone	New Zone		New Zone
Date and Oil/Gas/Water Rates of Last Production. (Note: For new zones with no production history, applicant shall be required to attach production estimates and supporting data.)	Date: Rates :Est. 500 mcf 0 bopd 0 bwpd		Date: 7/4/03 Rates: 397 mcf 15 bopd 0 bwpd
Fixed Allocation Percentage (Note: If allocation is based upon something other than current or past production, supporting data or explanation will be required.)	Oil Gas 56%		Oil Gas 100% 44%

ADDITIONAL DATA

Are all working, royalty and overriding royalty interests identical in all commingled zones? Yes ☐ No ☒
If not, have all working, royalty and overriding royalty interest owners been notified by certified mail? Yes ☒ No ☐

Are all produced fluids from all commingled zones compatible with each other? Yes ☒ No ☐

Will commingling decrease the value of production? Yes ☐ No ☒

If this well is on, or communitized with, state or federal lands, has either the Commissioner of Public Lands
or the United States Bureau of Land Management been notified in writing of this application? Yes ☐ No ☐

NMOCD Reference Case No. applicable to this well: _____

Attachments:

- C-102 for each zone to be commingled showing its spacing unit and acreage dedication.
- Production curve for each zone for at least one year. (If not available, attach explanation.)
- For zones with no production history, estimated production rates and supporting data.
- Data to support allocation method or formula.
- Notification list of working, royalty and overriding royalty interests for uncommon interest cases.
- Any additional statements, data or documents required to support commingling.

PRE-APPROVED POOLS

If application is to establish Pre-Approved Pools, the following additional information will be required:

- List of other orders approving downhole commingling within the proposed Pre-Approved Pools
- List of all operators within the proposed Pre-Approved Pools
- Proof that all operators within the proposed Pre-Approved Pools were provided notice of this application.
- Bottomhole pressure data.

I hereby certify that the information above is true and complete to the best of my knowledge and belief.

SIGNATURE James W. Pringle TITLE Operations Engineer DATE 7/24/03
TYPE OR PRINT NAME James W. Pringle TELEPHONE NO. (505)-748-4182

8/11/03

David C. Orig

DATE IN 7/23/03	7/23/03 SUSPENSE	DRC ENGINEER	7/24/03 LOGGED IN	DHC TYPE	P.D.R.C 0320526008 APP NO
--------------------	--------------------------------	-----------------	----------------------	-------------	------------------------------

ABOVE THIS LINE FOR DIVISION USE ONLY

NEW MEXICO OIL CONSERVATION DIVISION

- Engineering Bureau -

1220 South St. Francis Drive, Santa Fe, NM 87505



JUL 23 2003

ADMINISTRATIVE APPLICATION CHECKLIST

THIS CHECKLIST IS MANDATORY FOR ALL ADMINISTRATIVE APPLICATIONS FOR EXCEPTIONS TO DIVISION RULES AND REGULATIONS WHICH REQUIRE PROCESSING AT THE DIVISION LEVEL IN SANTA FE

Application Acronyms:

[NSL-Non-Standard Location] [NSP-Non-Standard Proration Unit] [SD-Simultaneous Dedication]
 [DHC-Downhole Commingling] [CTB-Lease Commingling] [PLC-Pool/Lease Commingling]
 [PC-Pool Commingling] [OLS - Off-Lease Storage] [OLM-Off-Lease Measurement]
 [WFX-Waterflood Expansion] [PMX-Pressure Maintenance Expansion]
 [SWD-Salt Water Disposal] [IPI-Injection Pressure Increase]
 [EOR-Qualified Enhanced Oil Recovery Certification] [PPR-Positive Production Response]

[1] TYPE OF APPLICATION - Check Those Which Apply for [A]

[A] Location - Spacing Unit - Simultaneous Dedication
☐ NSL ☐ NSP ☐ SD

Check One Only for [B] or [C]

[B] Commingling - Storage - Measurement
☒ DHC ☐ CTB ☐ PLC ☐ PC ☐ OLS ☐ OLM

[C] Injection - Disposal - Pressure Increase - Enhanced Oil Recovery
☐ WFX ☐ PMX ☐ SWD ☐ IPI ☐ EOR ☐ PPR

[D] Other: Specify _____

[2] NOTIFICATION REQUIRED TO: - Check Those Which Apply, or Does Not Apply

- [A] ☐ Working, Royalty or Overriding Royalty Interest Owners
- [B] ☐ Offset Operators, Leaseholders or Surface Owner
- [C] ☐ Application is One Which Requires Published Legal Notice
- [D] ☐ Notification and/or Concurrent Approval by BLM or SLO
 U.S. Bureau of Land Management - Commissioner of Public Lands, State Land Office
- [E] ☐ For all of the above, Proof of Notification or Publication is Attached, and/or,
- [F] ☐ Waivers are Attached

[3] SUBMIT ACCURATE AND COMPLETE INFORMATION REQUIRED TO PROCESS THE TYPE OF APPLICATION INDICATED ABOVE.

[4] CERTIFICATION: I hereby certify that the information submitted with this application for administrative approval is accurate and complete to the best of my knowledge. I also understand that no action will be taken on this application until the required information and notifications are submitted to the Division.

Note: Statement must be completed by an individual with managerial and/or supervisory capacity.

James W. Pringle
 Print or Type Name

James W. Pringle
 Signature

Operations Engineer
 Title

7-21-03
 Date

e-mail Address

District I
1625 N. French Drive, Hobbs, NM 88240

District II
811 South First Street, Artesia, NM 88210

District III
1000 Rio Brazos Road, Aztec, NM 87410

District IV
2040 South Pacheco, Santa Fe, NM 87505

State of New Mexico
Energy, Minerals and Natural Resources Department

Form C-107A
Revised May 15, 2000

OIL CONSERVATION DIVISION

2040 South Pacheco
Santa Fe, New Mexico 87505

APPLICATION TYPE

☒ Single Well

☐ Establish Pre-Approved Pools

EXISTING WELLBORE

☒ Yes ☐ No

APPLICATION FOR DOWNHOLE COMMINGLING

Yates Petroleum Corporation 105 South Fourth Street Artesia, New Mexico 88210
Operator Address

Huckabay TJ Federal Com 8 D 23 8S 26E Chaves
Lease Well No. Unit Letter-Section-Township-Range County

OGRID No. 025575 Property Code API No. 30-005-63504 Lease Type: ☒ Federal ☐ State ☐ Fee

DATA ELEMENT	UPPER ZONE	INTERMEDIATE ZONE	LOWER ZONE
Pool Name	Pecos Slope Abo		Foor Ranch Pre-Permian North (Cisco)
Pool Code			
Top and Bottom of Pay Section (Perforated or Open-Hole Interval)	4498-4878'		5858-5878'
Method of Production (Flowing or Artificial Lift)	Flowing		Flowing
Bottomhole Pressure (Note: Pressure data will not be required if the bottom perforation in the lower zone is within 150% of the depth of the top perforation in the upper zone)	N/A		N/A
Oil Gravity or Gas BTU (Degree API or Gas BTU)			
Producing, Shut-In or New Zone	New Zone		New Zone
Date and Oil/Gas/Water Rates of Last Production. (Note: For new zones with no production history, applicant shall be required to attach production estimates and supporting data.)	Date: Rates :Est. 500 mcf/d 0 bopd 0 bwpd	Date: Rates:	Date: 7/4/03 Rates: 234 mcf/d 14 bopd 0 bwpd
Fixed Allocation Percentage (Note: If allocation is based upon something other than current or past production, supporting data or explanation will be required.)	Oil Gas 68 %	Oil Gas % %	Oil Gas 100% 32%

ADDITIONAL DATA

Are all working, royalty and overriding royalty interests identical in all commingled zones? Yes ☒ No ☐
If not, have all working, royalty and overriding royalty interest owners been notified by certified mail? Yes ☐ No ☐

Are all produced fluids from all commingled zones compatible with each other? Yes ☒ No ☐

Will commingling decrease the value of production? Yes ☐ No ☒

If this well is on, or communitized with, state or federal lands, has either the Commissioner of Public Lands or the United States Bureau of Land Management been notified in writing of this application? Yes ☐ No ☐

NMOCD Reference Case No. applicable to this well: _____

Attachments:

- C-102 for each zone to be commingled showing its spacing unit and acreage dedication.
- Production curve for each zone for at least one year. (If not available, attach explanation.)
- For zones with no production history, estimated production rates and supporting data.
- Data to support allocation method or formula.
- Notification list of working, royalty and overriding royalty interests for uncommon interest cases.
- Any additional statements, data or documents required to support commingling.

PRE-APPROVED POOLS

If application is to establish Pre-Approved Pools, the following additional information will be required:

- List of other orders approving downhole commingling within the proposed Pre-Approved Pools
- List of all operators within the proposed Pre-Approved Pools
- Proof that all operators within the proposed Pre-Approved Pools were provided notice of this application.
- Bottomhole pressure data.

I hereby certify that the information above is true and complete to the best of my knowledge and belief.

SIGNATURE James W. Pringle TITLE Operations Engineer DATE 7/21/03
TYPE OR PRINT NAME James W. Pringle TELEPHONE NO. (505)-748-4182

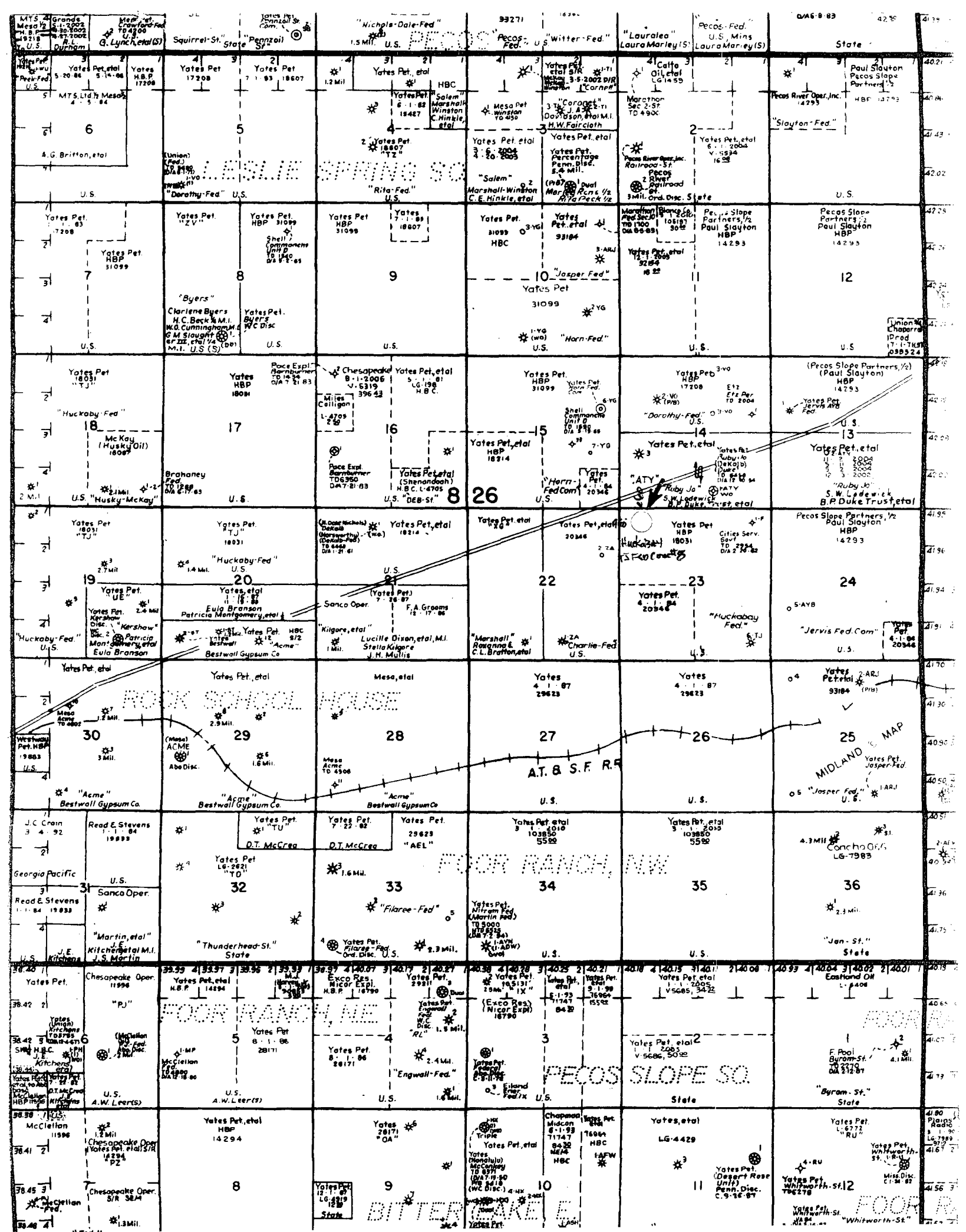

MARTIN YATES, III
1912 - 1985
FRANK W. YATES
1936 - 1986



105 SOUTH FOURTH STREET
ARTESIA, NEW MEXICO 88210-2118
TELEPHONE (505) 748-1471

S. P. YATES
CHAIRMAN OF THE BOARD
JOHN A. YATES
PRESIDENT
PEYTON YATES
EXECUTIVE VICE PRESIDENT
RANDY G. PATTERSON
SECRETARY
DENNIS G. KINSEY
TREASURER

July 21, 2003

David Catanach
State of New Mexico
OIL CONSERVATION DIVISION
1220 South Saint Francis Drive
Santa Fe, NM 87505

Dear Mr. Catanach,

Yates Petroleum Corporation hereby seeks administrative approval to downhole commingle the production from Pecos Slope Abo and the Foor Ranch Pre-Permian North (Cisco) pools in our Huckabay "TJ" Federal Com #8 located in Unit D of Section 23, Township 8 South, Range 26 East, Chaves County.

If you have any questions or need additional information, please call me at (505) 748-4182.

Sincerely,

A handwritten signature in cursive script that reads 'James W. Pringle'.

James W. Pringle
Operations Engineer

JWP/cm

Enclosures

MARTIN YATES, III
1912 - 1985
FRANK W. YATES
1936 - 1986



105 SOUTH FOURTH STREET
ARTESIA, NEW MEXICO 88210-2118
TELEPHONE (505) 748-1471

S. P. YATES
CHAIRMAN OF THE BOARD
JOHN A. YATES
PRESIDENT
PEYTON YATES
EXECUTIVE VICE PRESIDENT
RANDY G. PATTERSON
SECRETARY
DENNIS G. KINSEY
TREASURER

July 21, 2003

Tim Gum
State of New Mexico
OIL CONSERVATION DIVISION
811 S. First Street
Artesia, NM 88210

Dear Mr. Gum,

Yates Petroleum Corporation hereby seeks administrative approval to downhole commingle the production from Pecos Slope Abo and the Foor Ranch Pre-Permian North (Cisco) pools in our Huckabay "TJ" Federal Com #8 located in Unit D of Section 23, Township 8 South, Range 26 East, Chaves County.

If you have any questions or need additional information, please call me at (505) 748-4182.

Thank you.

Sincerely,

A handwritten signature in cursive script that reads 'James W. Pringle'.

James W. Pringle
Operations Engineer

JWP/cm

Enclosures

MARTIN YATES, III
1912 - 1985
FRANK W. YATES
1936 - 1986



105 SOUTH FOURTH STREET
ARTESIA, NEW MEXICO 88210-2118
TELEPHONE (505) 748-1471

S. P. YATES
CHAIRMAN OF THE BOARD
JOHN A. YATES
PRESIDENT
PEYTON YATES
EXECUTIVE VICE PRESIDENT
RANDY G. PATTERSON
SECRETARY
DENNIS G. KINSEY
TREASURER

July 21, 2003

Armando Lopez
Bureau of Land Management
2909 2nd Street
Roswell, New Mexico 88201

Dear Mr. Lopez

Yates Petroleum Corporation hereby seeks administrative approval to downhole commingle the production from Pecos Slope Abo and the Foor Ranch Pre-Permian North (Cisco) pools in our Huckabay "TJ" Federal Com #8 located in Unit D of Section 23, Township 8 South, Range 26 East, Chaves County.

If you have any questions or need additional information, please call me at (505) 748-4182

Sincerely,

James W. Pringle
Operations Engineer

JWP/cm

Enclosure

District I
1625 N. French Dr., Hobbs, NM 88240

State of New Mexico
Energy, Minerals & Natural Resources Department

Form C-102
Revised August 15, 2000

District II
811 South First, Artesia, NM 88210

OIL CONSERVATION DIVISION
1220 South St. Francis Dr.
Santa Fe, NM 87505

Submit to Appropriate District Office
State Lease - 4 Copies
Fee Lease - 3 Copies

District III
1000 Rio Brazos Rd., Aztec, NM 87410

District IV
1220 S. St. Francis Dr., Santa Fe, NM 87505

☐ AMENDED REPORT

WELL LOCATION AND ACREAGE DEDICATION PLAT

¹ API Number 30-005-63504	³ Pool Name Pecos Slope Abo	
⁴ Property Code 12385	⁵ Property Name Huckabay "TJ" Federal Com	⁶ Well Number 8
⁷ OGRID No. 025575	⁸ Operator Name Yates Petroleum Corporation	⁹ Elevation 3850'

¹⁰ Surface Location

UL or lot no. D	Section 23	Township 8S	Range 26E	Lot Idn	Feet from the 660	North/South line North	Feet from the 990	East/West line West	County Chaves
---------------------------	----------------------	-----------------------	---------------------	---------	-----------------------------	----------------------------------	-----------------------------	-------------------------------	-------------------------

¹¹ Bottom Hole Location If Different From Surface

UL or lot no.	Section	Township	Range	Lot Idn	Feet from the	North/South line	Feet from the	East/West line	County
---------------	---------	----------	-------	---------	---------------	------------------	---------------	----------------	--------

¹² Dedicated Acres 160	¹³ Joint or Infill	¹⁴ Consolidation Code	¹⁵ Order No.
---	-------------------------------	----------------------------------	-------------------------

NO ALLOWABLE WILL BE ASSIGNED TO THIS COMPLETION UNTIL ALL INTERESTS HAVE BEEN CONSOLIDATED OR A NON-STANDARD UNIT HAS BEEN APPROVED BY THE DIVISION

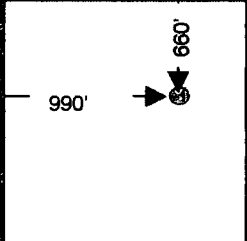
				¹⁷ OPERATOR CERTIFICATION I hereby certify that the information contained herein is true and complete to the best of my knowledge and belief. Signature <u>Cherry Marchus</u> <u>Cherry Marchus</u> Printed Name Engineering Technician Title Date: <u>7/21/03</u>
				¹⁸ SURVEYOR CERTIFICATION I hereby certify that the well location shown on this plat was plotted from field notes of actual surveys made by me or under my supervision, and that the same is true and correct to the best of my belief. Date of Survey Signature and Seal of Professional Surveyor: Certificate Number

The Pecos Slope Abo is a new zone and production curves are not available.

District I
1625 N. French Dr., Hobbs, NM 88240

State of New Mexico
Energy, Minerals & Natural Resources Department

Form C-102
Revised August 15, 2000

District II
811 South First, Artesia, NM 88210

OIL CONSERVATION DIVISION
1220 South St. Francis Dr.
Santa Fe, NM 87505

Submit to Appropriate District Office

State Lease - 4 Copies

Fee Lease - 3 Copies

District III
1000 Rio Brazos Rd., Aztec, NM 87410

District IV
1220 S. St. Francis Dr., Santa Fe, NM 87505

☐ AMENDED REPORT

WELL LOCATION AND ACREAGE DEDICATION PLAT

¹ API Number 30-005-63504	³ Pool Name Foor Ranch Pre-Permian North (Cisco)	
⁴ Property Code 12385	⁵ Property Name Huckabay "TJ" Federal Com	⁶ Well Number 8
⁷ OGRID No. 025575	⁸ Operator Name Yates Petroleum Corporation	⁹ Elevation 3850'

¹⁰ Surface Location

UL or lot no. D	Section 23	Township 8S	Range 26E	Lot Idn	Feet from the 660	North/South line North	Feet from the 990	East/West line West	County Chaves
---------------------------	----------------------	-----------------------	---------------------	---------	-----------------------------	----------------------------------	-----------------------------	-------------------------------	-------------------------

¹¹ Bottom Hole Location If Different From Surface

UL or lot no.	Section	Township	Range	Lot Idn	Feet from the	North/South line	Feet from the	East/West line	County
¹² Dedicated Acres 320	¹³ Joint or Infill	¹⁴ Consolidation Code	¹⁵ Order No.						

NO ALLOWABLE WILL BE ASSIGNED TO THIS COMPLETION UNTIL ALL INTERESTS HAVE BEEN CONSOLIDATED OR A NON-STANDARD UNIT HAS BEEN APPROVED BY THE DIVISION

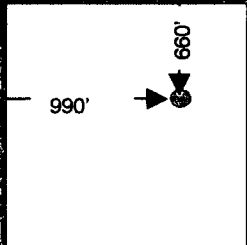
				<p>¹⁷ OPERATOR CERTIFICATION</p> <p>I hereby certify that the information contained herein is true and complete to the best of my knowledge and belief.</p> <p>Signature <u>Cherry Matchus</u></p> <p><u>Cherry Matchus</u></p> <p>Printed Name</p> <p>Engineering Technician</p> <p>Title</p> <p>Date: <u>7/21/03</u></p>
				<p>¹⁸ SURVEYOR CERTIFICATION</p> <p>I hereby certify that the well location shown on this plat was plotted from field notes of actual surveys made by me or under my supervision, and that the same is true and correct to the best of my belief.</p> <p>Date of Survey</p> <p>Signature and Seal of Professional Surveyor:</p> <p>Certificate Number</p>

Huckabay TJ Federal Com #8
Foor Ranch Pre-Permian North (Cisco)
Daily Production



MARTIN YATES, III
1912 - 1985
FRANK W. YATES
1936 - 1986



105 SOUTH FOURTH STREET
ARTESIA, NEW MEXICO 88210-2008
TELEPHONE (505) 748-1471

S. P. YATES
CHAIRMAN OF THE BOARD
JOHN A. YATES
PRESIDENT
PEYTON YATES
EXECUTIVE VICE PRESIDENT
RANDY G. PATTERSON
SECRETARY
DENNIS G. KINSEY
TREASURER

July 22, 2003

David Catanach
Oil Conservation Division
1220 South Saint Francis Drive
Santa Fe, NM 87505

Dear Mr. Catanach;

Please find enclosed the copies of the proof of notification to all the interest owners in our Huckabay "TJ" Fed Com #8 located in Unit D, Section 23, T8S-R26E, Chaves County, New Mexico. I apologize for this oversight. On the Administrative Application Checklist and the C-107A I marked that the Working, Royalty and overriding royalty interests were identical in all commingled zones. If you have any questions please feel free to contact me at 505-748-4164.

Thank you,
Sincerely,

Cherry Matchus
Engineering Technician

Enclosure

RECEIVED
JUL 25 2003
Oil Conservation Division
RECEIVED
JUL 25 2003
Oil Conservation Division

7002 2030 0001 8269 5379

U.S. Postal ServiceTM
CERTIFIED MAILTM RECEIPT
(Domestic Mail Only; No Insurance Coverage Provided)
For delivery information visit our website at www.usps.com

OFFICIAL USE

Postage	\$
Certified Fee	
Return Receipt Fee (Endorsement Required)	
Restricted Delivery Fee (Endorsement Required)	

T
Se
Si
or
Ci

Logan Travis Capps
P.O. Box 804
Midland, TX 79702

PS Form 3800, June 2002 See Reverse for Instructions

Stamp: NM 88210 JUL 22 2003 CHERRY MATCHUS Huckabay #9

7002 2030 0001 8269 5393

U.S. Postal ServiceTM
CERTIFIED MAILTM RECEIPT
(Domestic Mail Only; No Insurance Coverage Provided)
For delivery information visit our website at www.usps.com

OFFICIAL USE

Postage	\$
Certified Fee	
Return Receipt Fee (Endorsement Required)	
Restricted Delivery Fee (Endorsement Required)	

Total F

Sent To

Street, Apt. # or PO Box N
City, State, Z

Nelda Northern Wellborn
409 N. Sixth Street
St. Charles, MO 63301

PS Form 3800, June 2002 See Reverse for Instructions

Stamp: NM 88210 JUL 22 2003 Postmark Here CHERRY MATCHUS Huckabay #9 Cherry Norton

7002 2030 0001 8269 5416

U.S. Postal ServiceTM
CERTIFIED MAILTM RECEIPT
(Domestic Mail Only; No Insurance Coverage Provided)
For delivery information visit our website at www.usps.com

OFFICIAL USE

Postage	\$
Certified Fee	
Return Receipt Fee (Endorsement Required)	
Restricted Delivery Fee (Endorsement Required)	

Total

Sent

Street, Apt. # or PO Box N
City, State, Z

PJC Limited Partnership
Contact: Patricia J. Cooper
P.O. Box 1713
Roswell, NM 88201

PS Form 3800, June 2002 See Reverse for Instructions

Stamp: NM 88210 JUL 22 2003 Postmark Here CHERRY MATCHUS Huckabay #9 Cherry Norton

7002 2030 0001 8269 5423

U.S. Postal ServiceTM
CERTIFIED MAILTM RECEIPT
(Domestic Mail Only; No Insurance Coverage Provided)
For delivery information visit our website at www.usps.com

OFFICIAL USE

Postage	\$
Certified Fee	
Return Receipt Fee (Endorsement Required)	
Restricted Delivery Fee (Endorsement Required)	

T

Se

Si
or
Ci

S.P. Johnson III
and Barbara Jo Johnson
P.O. Box 1713
Roswell, NM 88201

PS Form 3800, June 2002 See Reverse for Instructions

Stamp: NM 88210 JUL 22 2003 Postmark Here CHERRY MATCHUS Huckabay #9 Cherry Norton

7002 2030 0001 8269 5386

U.S. Postal ServiceTM
CERTIFIED MAILTM RECEIPT
(Domestic Mail Only; No Insurance Coverage Provided)
For delivery information visit our website at www.usps.com

OFFICIAL USE

Postage	\$
Certified Fee	
Return Receipt Fee (Endorsement Required)	
Restricted Delivery Fee (Endorsement Required)	

Tot

Sent

Street, Apt. # or PO Box N
City, State, Z

Susan D. Wellborn
2 Clary Sage Court
The Woodlands, TX 77382

PS Form 3800, June 2002 See Reverse for Instructions

Stamp: NM 88210 JUL 22 2003 CHERRY MATCHUS Huckabay #9

7002 2030 0001 8269 5409

U.S. Postal ServiceTM
CERTIFIED MAILTM RECEIPT
(Domestic Mail Only; No Insurance Coverage Provided)
For delivery information visit our website at www.usps.com

OFFICIAL USE

Postage	\$
Certified Fee	
Return Receipt Fee (Endorsement Required)	
Restricted Delivery Fee (Endorsement Required)	

Total Posta

Sent To

Street, Apt. # or PO Box N
City, State, Z

Bobby Unser, Jr.
7626 Edith Blvd., NE
Albuquerque, NM 87113-1206

PS Form 3800, June 2002 See Reverse for Instructions

Stamp: NM 88210 JUL 22 2003 Postmark Here CHERRY MATCHUS Huckabay #9

7002 2030 0001 8269 5430

U.S. Postal ServiceTM
CERTIFIED MAILTM RECEIPT
(Domestic Mail Only; No Insurance Coverage Provided)
For delivery information visit our website at www.usps.com

OFFICIAL USE

Postage	\$
Certified Fee	
Return Receipt Fee (Endorsement Required)	
Restricted Delivery Fee (Endorsement Required)	

Total F

Sent To

Street, Apt. # or PO Box N
City, State, Z

George Globe Trust Trustee
P.O. Box 11171
Bakersfield, CA 93389

PS Form 3800, June 2002 See Reverse for Instructions

Stamp: NM 88210 JUL 22 2003 Postmark Here CHERRY MATCHUS Huckabay #9

7002 2030 0001 8269 5447

U.S. Postal ServiceTM
CERTIFIED MAILTM RECEIPT
(Domestic Mail Only; No Insurance Coverage Provided)
For delivery information visit our website at www.usps.com

OFFICIAL USE

Postage	\$
Certified Fee	
Return Receipt Fee (Endorsement Required)	
Restricted Delivery Fee (Endorsement Required)	

Total

Sent

Street, Apt. # or PO Box N
City, State, Z

W.B. Strange
P.O. Box 1210
Inverness, FL 34451-1210

PS Form 3800, June 2002 See Reverse for Instructions

Stamp: NM 88210 JUL 22 2003 Postmark Here CHERRY MATCHUS Huckabay #9

7002 2030 0001 8269 5348

U.S. Postal Service™
CERTIFIED MAIL™ RECEIPT
 (Domestic Mail Only; No Insurance Coverage Provided)

For delivery information visit our website at www.usps.com

OFFICIAL USE

Postage	\$
Certified Fee	
Return Receipt Fee (Endorsement Required)	
Restricted Delivery Fee (Endorsement Required)	

To:
 Dan Peoples
 1517 Cottonwood Valley
 Circle South
 Irving, TX 75038

PS Form 3800, June 2002 See Reverse for Instructions

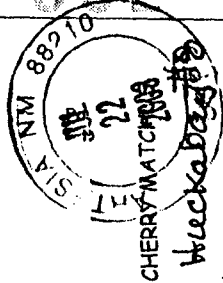

7002 2030 0001 8269 5355

U.S. Postal Service™
CERTIFIED MAIL™ RECEIPT
 (Domestic Mail Only; No Insurance Coverage Provided)

For delivery information visit our website at www.usps.com

OFFICIAL USE

Postage	\$
Certified Fee	
Return Receipt Fee (Endorsement Required)	
Restricted Delivery Fee (Endorsement Required)	

To:
 David Morrow and Laura Florey Morrow
 P.O. Box 60480
 Midland, TX 79711

PS Form 3800, June 2002 See Reverse for Instructions

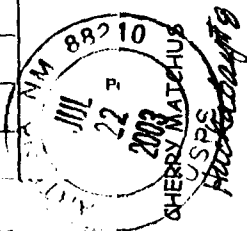

7002 2030 0001 8269 5324

U.S. Postal Service™
CERTIFIED MAIL™ RECEIPT
 (Domestic Mail Only; No Insurance Coverage Provided)

For delivery information visit our website at www.usps.com

OFFICIAL USE

Postage	\$
Certified Fee	
Return Receipt Fee (Endorsement Required)	
Restricted Delivery Fee (Endorsement Required)	

Total Postage & Fees: \$

Sent To:
 Jerry Carson and Sheila B. Carson
 #2 Hummingbird Place
 Odessa, TX 79762

PS Form 3800, June 2002 See Reverse for Instructions

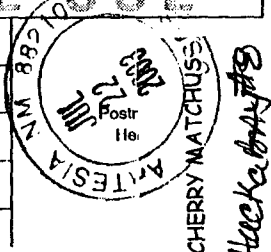

7002 2030 0001 8269 5362

U.S. Postal Service™
CERTIFIED MAIL™ RECEIPT
 (Domestic Mail Only; No Insurance Coverage Provided)

For delivery information visit our website at www.usps.com

OFFICIAL USE

Postage	\$
Certified Fee	
Return Receipt Fee (Endorsement Required)	
Restricted Delivery Fee (Endorsement Required)	

Total:
 Robert C. Fair and Debra Fair
 P.O. Box 60047
 Midland, TX 79711

PS Form 3800, June 2002 See Reverse for Instructions

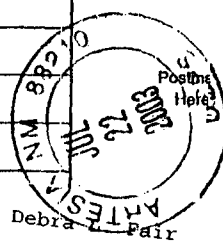

7002 2030 0001 8269 5317

U.S. Postal Service™
CERTIFIED MAIL™ RECEIPT
 (Domestic Mail Only; No Insurance Coverage Provided)

For delivery information visit our website at www.usps.com

OFFICIAL USE

Postage	\$
Certified Fee	
Return Receipt Fee (Endorsement Required)	
Restricted Delivery Fee (Endorsement Required)	

Total Postage & Fees: \$

To:
 Minerals Management Service
 P.O. Drawer 1857
 Roswell, NM 88201

PS Form 3800, June 2002 See Reverse for Instructions

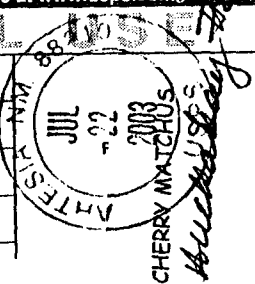

7002 2030 0001 8269 5331

U.S. Postal Service™
CERTIFIED MAIL™ RECEIPT
 (Domestic Mail Only; No Insurance Coverage Provided)

For delivery information visit our website at www.usps.com

OFFICIAL USE

Postage	\$
Certified Fee	
Return Receipt Fee (Endorsement Required)	
Restricted Delivery Fee (Endorsement Required)	

To:
 Willie M. Carson
 #2 Hummingbird Place
 Odessa, TX 79762

PS Form 3800, June 2002 See Reverse for Instructions

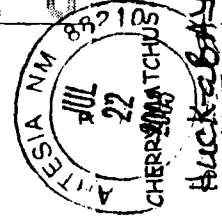

MARTIN YATES, III
1912 - 1985
FRANK W. YATES
1936 - 1986



105 SOUTH FOURTH STREET
ARTESIA, NEW MEXICO 88210-2118
TELEPHONE (505) 748-1471

S. P. YATES
CHAIRMAN OF THE BOARD
JOHN A. YATES
PRESIDENT
PEYTON YATES
EXECUTIVE VICE PRESIDENT
RANDY G. PATTERSON
SECRETARY
DENNIS G. KINSEY
TREASURER

RECEIVED

JUL 28 2003

**OIL CONSERVATION
DIVISION**

July 25, 2003

David Catanach
State of New Mexico
OIL CONSERVATION DIVISION
1220 South Saint Francis Drive
Santa Fe, NM 87505

Dear Mr. Catanach,

Please find enclosed an amended C-107A on Yates Petroleum Corporation's Huckabay "TJ" Federal Com #8 located in Unit D of Section 23, Township 8 South, Range 26 East, Chaves County. We have included Mississippian Lime perf's and production in the Foor Ranch Pre-Permian North Pool.

If you have any questions or need additional information, please call me at (505) 748-4164.

Sincerely,

Cherry Matchus
Engineering Technician

Enclosure