



ConocoPhillips
Fumar

Permian Basin
4001 Penbrook Street
Odessa, TX 79762

PMESD-624457437

May 11, 2006

Mr. Michael Stogner
New Mexico Oil Conservation Division
2040 Pacheo
Santa Fe, New Mexico 87504

Re: Application to Reassign Acreage
Lockhart A 30 #5
Section 30, T-21-S R-36-E, K
API #30-025-04836

2006 JUN 2 PM 12 03

Dear Mr. Stogner,

Please see attached form C-102 filed to amend the acreage assignment for the previous approved application. Previously the Lockhart A 30 #5 was assigned 80 acres which included the acreage assigned to the Lockhart A 30 #10. Consequently the well needs to be reassigned the 80 acres due to the Lockhart A 30 #10 has been reactivated as a Eumont oil well. The Lockhart A 30 #6 is a plugged and abandon well.

If there are any further questions concerning this application please call me at (432) 368-1665.

Sincerely,

Alva Franco
Alva Franco
Regulatory Specialist

Cc: Oil Conservation Division – Hobbs
Bureau of Land Management - Carlsbad

District I

1625 N. French Dr., Hobbs, NM 88240

District II

1301 W. Grand Avenue, Artesia, NM 88210

District III

1000 Rio Brazos Rd., Aztec, NM 87410

District IV

1220 S. St. Francis Dr., Santa Fe, NM 87505

State of New Mexico

Energy, Minerals & Natural Resources Department

OIL CONSERVATION DIVISION

1220 South St. Francis Dr.

Santa Fe, NM 87505

Form C-102

Revised October 12, 2005

Submit to Appropriate District Office

State Lease - 4 Copies

Fee Lease - 3 Copies

☒ AMENDED REPORT

WELL LOCATION AND ACREAGE DEDICATION PLAT

'API Number 30-025-04836		'Pool Code 76480		'Pool Name Eumont; Yates-7 RVRS-Queen	
'Property Code 003040		'Property Name Lockhart A-30			'Well Number 5
'OGRID No. 217817		'Operator Name ConocoPhillips Company			'Elevation

¹⁰ Surface Location

UL or lot no.	Section	Township	Range	Lot Idn	Feet from the	North/South line	Feet from the	East/West line	County
K	30	21	37		2310'	South	2310'	West	Lea

¹¹ Bottom Hole Location If Different From Surface

UL or lot no.	Section	Township	Range	Lot Idn	Feet from the	North/South line	Feet from the	East/West line	County

"Dedicated Acres 80	"Joint or Infill	"Consolidation Code	"Order No.
------------------------	------------------	---------------------	------------

No allowable will be assigned to this completion until all interests have been consolidated or a non-standard unit has been approved by the division.

	¹⁷ OPERATOR CERTIFICATION <i>I hereby certify that the information contained herein is true and complete to the best of my knowledge and belief, and that this organization either owns a working interest or unleased mineral interest in the land including the proposed bottom hole location or has a right to drill this well at this location pursuant to a contract with an owner of such a mineral or working interest, or to a voluntary pooling agreement or a compulsory pooling order heretofore entered by the division.</i> <div style="display: flex; justify-content: space-between;"> <div> </div> <div>05/11/2006</div> </div> <div style="display: flex; justify-content: space-between;"> <div>Signature</div> <div>Date</div> </div> <div> Alva Franco Printed Name </div>
	¹⁸ SURVEYOR CERTIFICATION <i>I hereby certify that the well location shown on this plat was plotted from field notes of actual surveys made by me or under my supervision, and that the same is true and correct to the best of my belief.</i>
	Date of Survey Signature and Seal of Professional Surveyor: Certificate Number

Selected Features

General Permian AOs

Nitroview

Dora Roberts

Gomez, Puckett, V. al Verde

Haley, China

Draw

Hobbs Maljamer

Vinegarone

West Texas

P2000 WELL HEADERS

OIL

GAS

OIL & GAS

LOC

START

INJ & SERVICE

DA: ABAND

JA

SUS

Sections

Counties

COP Lease Tract

COP Lease Tract Inactive

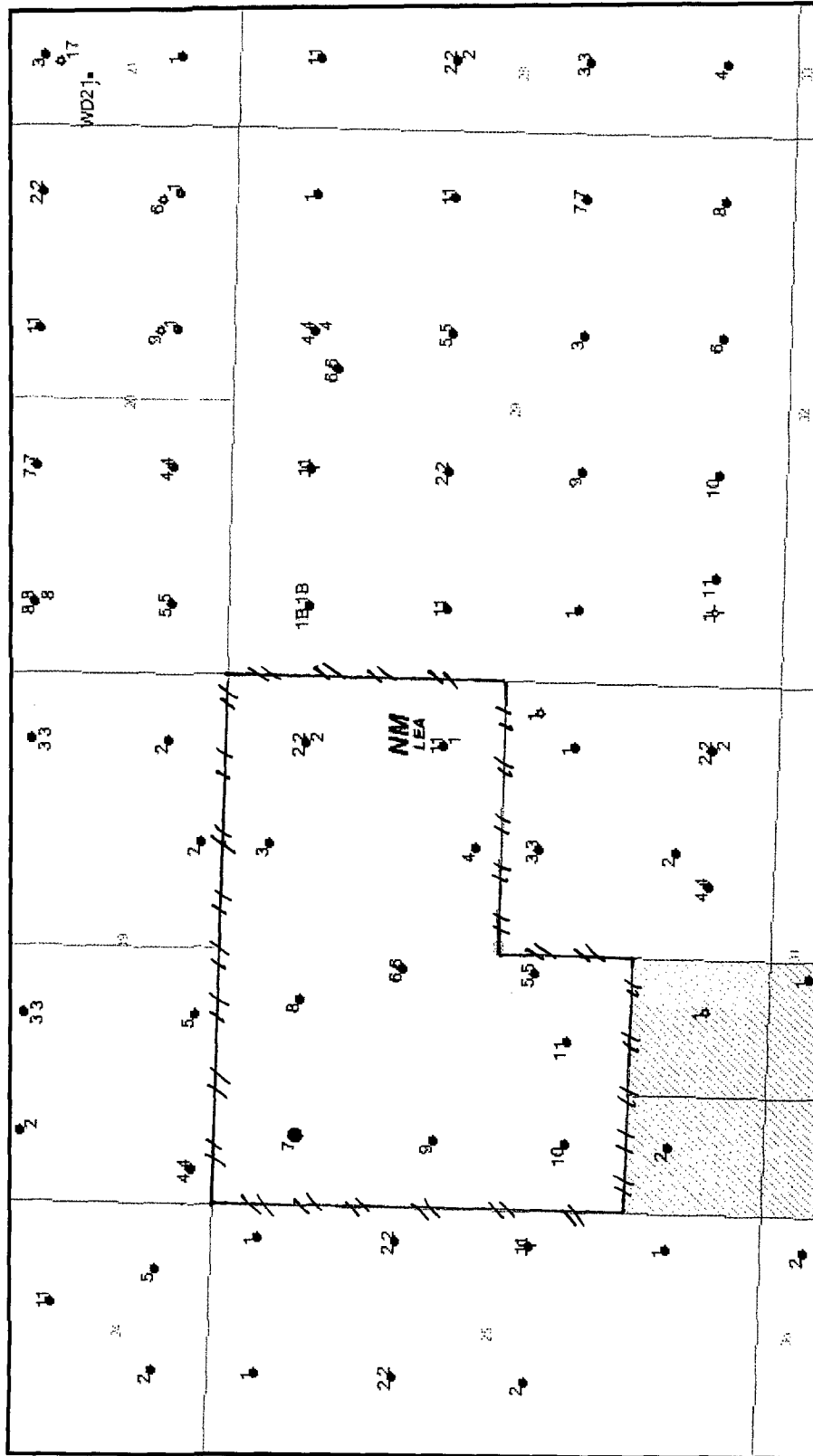

Lockhart A 30 #7
 Scale - 1:20000
 Projection: NAD 1927 SPCS Zone
 Texas Central
 Drawn by: DGU
 Date: Wed May 10 08:01:20 2006

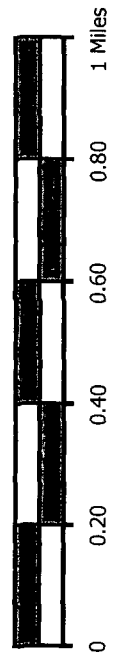



NEW MEXICO ENERGY, MINERALS
& NATURAL RESOURCES DEPARTMENT

OIL CONSERVATION DIVISION
2040 South Pacheco Street
Santa Fe, New Mexico 87505
(505) 827-7131

December 2, 1998

Conoco, Inc.
10 Desta Drive - Suite 100 W
Midland, Texas 79705-4500
Attention: Kay Maddox

Administrative Order NSP-1797(L)

Dear Ms. Maddox:

Reference is made to the following: (i) your application submitted to the Division on November 12, 1998; and, (ii) the records of the Division in Santa Fe including well files, all orders related to the Eumont Gas Pool, and the files on Division Administrative Orders NSP-4 and NSP-279: all concerning Conoco, Inc.'s request for a 75.12-acre non-standard gas spacing and proration unit consisting of the following acreage in the Eumont Gas Pool:

LEA COUNTY, NEW MEXICO
TOWNSHIP 21 SOUTH, RANGE 36 EAST, NMPM
Section 30: Lot 3 and the NE/4 SW/4.

This unit is to be dedicated to the existing Lockhart "A-30" Well No. 5 (API No. 30-025-04836), located at an unorthodox gas well location 2310 feet from the South and West lines (Unit K) of Section 30.

The subject application has been duly filed under the provisions of Rule 104.F of the General Rules and Regulations of the New Mexico Oil Conservation Division.

By the authority granted me under the provisions of Rule 2(d) of the "General Rules for the Prorated Gas Pools of New Mexico/Special Rules and Regulations for the Eumont Gas Pool," as promulgated by Division Order No. R-8170, as amended, and Division General Rule 104.F(2): (i) the unorthodox gas well location of the Lockhart "A-30" Well No. 5 is hereby approved; and, (ii) Conoco, Inc. is permitted to produce the allowable assigned the above-described 75.12-acre non-standard gas spacing and proration unit in accordance with Rule 5 of the Eumont special pool rules from this well.

Sincerely,

Lori Wrotenbery
Director

cc: New Mexico Oil Conservation Division - Hobbs
File: NSP-4
NSP-279

REMARKS: The two previous administrative orders authorizing non-standard gas spacing and proration units for Eumont gas production from this well, NSP-4, dated August 17, 1954, and NSP-279, dated July 11, 1956, are hereby placed in abeyance until further notice.



Mid-Continent Region
Exploration/Production

Conoco Inc.
10 Desta Drive, Suite 100W
Midland, TX 79705-4500
(915) 686-5400

Mr. Michael Stogner
New Mexico Oil Conservation Division
2040 Pacheo
Santa Fe, New Mexico 87504

RE: Application for Non-standard Proration Unit
Lockhart A 30 #5
Section 30, T-21-S, R-36-E, K
API # 30-025-04836
Lea County, New Mexico

Dear Mr. Stogner,

The Lockhart A30 #5 was recompleted in the Eumont Oil Pool in 1996 and has produced as an oil well for two years. Current production tests indicate that the gas-oil ratio has risen above 100,000 and will likely remain above the GOR cutoff. Consequently, the well needs to be reassigned to the prorated Eumont Yates 7 Rvrs Queen (Pro Gas) pool (76480). To facilitate this we would like to apply for the creation of a non-standard 80-acre proration unit comprising the N/2 of the SW/4 of Section 30, T-21-S, R-36-E. At 2310' FSL and 2310' FWL, the Lockhart A 30 #5 well is at a non-standard location and will be the sole well assigned to the new proration unit.

The offset operator plat shows that Ralph C. Bruton, Chevron, Texaco, and Gruy Petroleum are the offset operators that could be affected by this unorthodox location. Please find enclosed evidence that they have been notified of this application.

Conoco, Inc respectfully requests that an unorthodox location order be issued based on the reasons given in the preceding paragraphs. If there are any further questions concerning this application please call me at (915) 686-5798.

Sincerely,

Kay Maddox 11/10/98
Kay Maddox
Regulatory Agent – Conoco, Inc.

Cc: Oil Conservation Division – Hobbs
Bureau of Land Management - Roswell

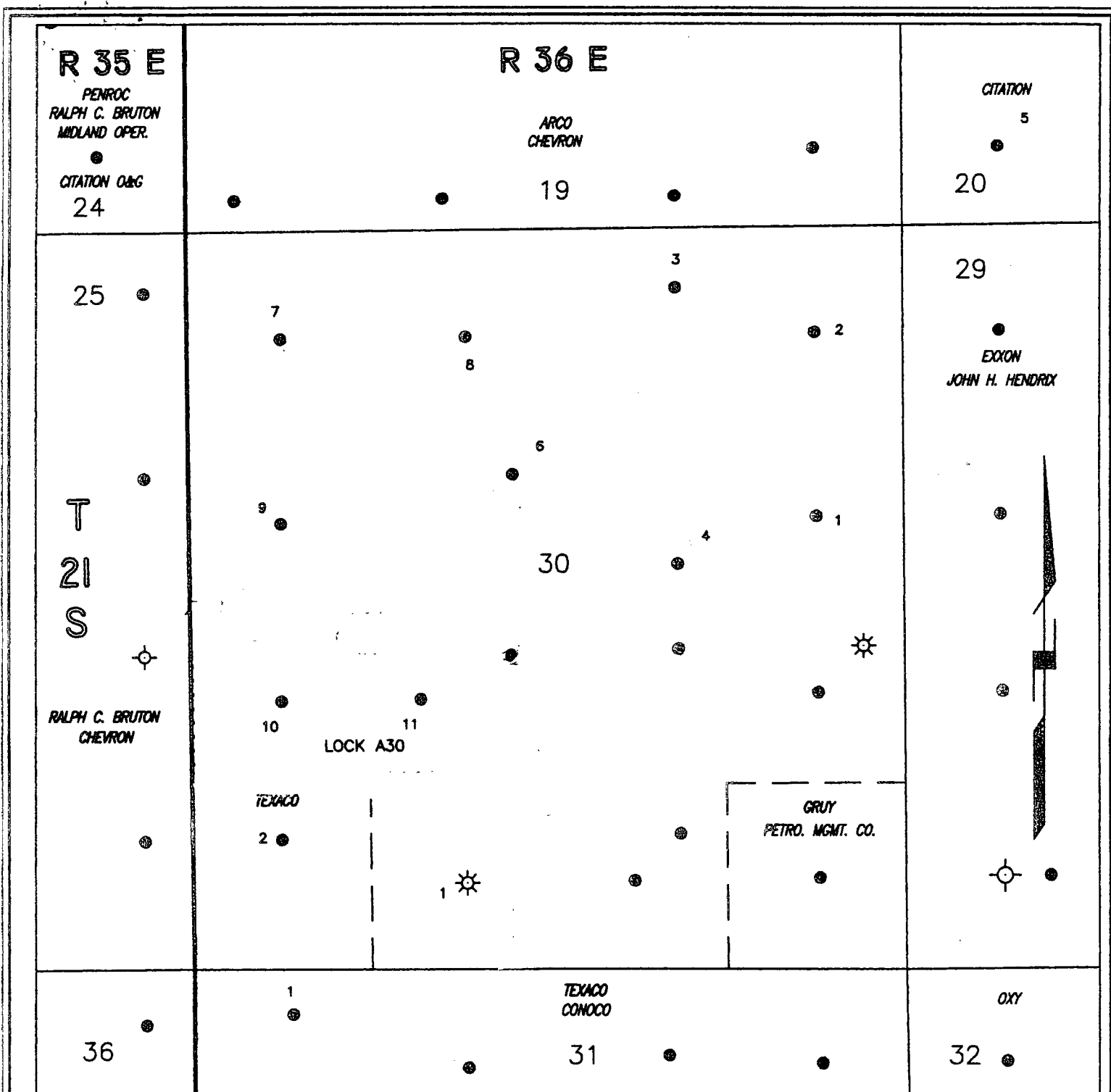

NOTES The Conoco Lock A30 #5 location will be non-standard with respect to internal spacing boundaries in Sec. 30, T21S, R36E.	DATE: 11/07/98 DRAWN BY: GLG CHECKED BY: APPROVED BY: SCALE: 1" = 1000' STATE PLANE COORDINATES REFERRED TO NAD27 - N.M. EAST STATE PLANE COORDINATES ZONE - 3001	<div style="text-align: center;"> EPNGNA MIDLAND DIVISION </div> <div style="text-align: center;"> CONOCO Lock A30 #5 Sec. 30, T21S, R36E Lea County, New Mexico Non-Standard Location </div> <table border="1" style="width: 100%; border-collapse: collapse; margin-top: 5px;"> <tr> <td style="width: 33%; font-size: small;">STATE</td> <td style="width: 33%; font-size: small;">API COUNTY</td> <td style="width: 34%; font-size: small;">DRAWING</td> </tr> <tr> <td>025</td> <td>30</td> <td>locka305</td> </tr> </table> <div style="text-align: center; margin-top: 5px;"> CONOCO INC. OFFICE 10 DESTA DRIVE WEST MIDLAND, TEXAS 79705 </div>	STATE	API COUNTY	DRAWING	025	30	locka305
STATE	API COUNTY	DRAWING						
025	30	locka305						

District I
PO Box 1980, Hobbs, NM 88241-1980

District II
PO Drawer DD, Artesia, NM 88211-0719

District III
1000 Rio Brazos Rd. Aztec, NM 87410

District IV
PO Box 2088, Santa Fe. NM 87504-2088

State of New Mexico
Energy, Minerals & Natural Resources Department

OIL CONSERVATION DIVISION

PO Box 2088
Santa Fe, NM 87504-2088

Revised February 21, 1994

instructions on back

Submit to Appropriate District Office

State Lease - 4 Copies

Free Lease - 3 Copies

☐ AMENDED REPORT

WELL LOCATION AND ACREAGE DEDICATION PLAT

API Number 30-025-04836		2 Pool Code 76480		3 Pool Name Eumont Yates 7 Rvrs Queen (Pro Gas)	
4 Property Code 003040		5 Property Name Lockhart A 30			6 Well Number #5
7 OGRID No. 005073		8 Operator Name Conoco Inc., 10 Desta Drive, Ste. 100W, Midland, TX 79705-4500			9 Elevation

10 Surface Location

UL or lot no.	Section	Township	Range	Lot Idn	Feet from the	North/South line	Feet from the	East/West line	County
K	30	21S	36E		2310'	South	2310'	West	Lea

11 Bottom Hole Location If Different From Surface

UL or lot no.	Section	Township	Range	Lot Idn	Feet from the	North/South line	Feet from the	East/West line	County
12 Dedicated Acres	13 Joint or Infill	14 Consolidation Code		15 Order No.					
80									

NO ALLOWABLE WILL BE ASSIGNED TO THIS COMPLETION UNTIL ALL INTERESTS HAVE BEEN CONSOLIDATED
OR A NON-STANDARD UNIT HAS BEEN APPROVED BY THE DIVISION

16

2310'

2310'

17 OPERATOR CERTIFICATION

I hereby certify that the information contained herein is true and complete to the best of my knowledge and belief

Kay Maddox
Signature

Signature _____

Kay Maddox

Printed Name _____

Regulatory Agent

Title	Author	Date	Page	Page	Page	Page	Page	Page	Page	Page	Page	Page	Page	Page
Title	Author	Date	Page	Page	Page	Page	Page	Page	Page	Page	Page	Page	Page	Page

November 9, 1998

Date _____

18 SURVEYOR CERTIFICATION

I hereby certify that the well location shown on this plat was plotted from field notes of actual surveys made by me or under my supervision, and that the same is true and correct to the best of my belief.

Date of Survey

Signature and Seal of Professional Surveyor:

Certificate Number

**Lockhart A 30 #5
Section 30, T-21-S, R-36-E, K
API # 30-025-04836
Lea County, New Mexico**

RE: Application for Unorthodox Location

Notification of Offset Operators:

Ralph C. Bruton
3500 Ocmoa
Hobbs, NM 88240

Gruy Petroleum Management Corporation
600 Las Colinas Blvd E STE 1200
Irving, TX 75039-5611

Chevron USA
PO Box 1635
Houston, TX 77251

Texaco Inc
Heriatge Center
Midland, TX 79701

Please find attached evidence that the above listed companies have been sent copies of the Non-standard location request.

Z 137 529 925

US Postal Service

Receipt for Certified Mail

No Insurance Coverage Provided.

Do not use for International Mail (See reverse)

Sent to	
Ralph C. Britton	
Street & Number	
3500 Ocmoo	
Post Office, State, & ZIP Code	
Hobbs, Nm 88240	
Postage	\$
Certified Fee	
Special Delivery Fee	
Restricted Delivery Fee	
Return Receipt Showing to Whom & Date Delivered	
Return Receipt Showing to Whom, Date, & Addressee's Address	
TOTAL Postage & Fees	\$
Postmark or Date	

PS Form 3800, April 1995

Z 137 529 923

US Postal Service

Receipt for Certified Mail

No Insurance Coverage Provided.

Do not use for International Mail (See reverse)

Sent to	
Chevron USA	
Street & Number	
PO Box 1635	
Post Office, State, & ZIP Code	
Houston, TX 77251	
Postage	\$
Certified Fee	
Special Delivery Fee	
Restricted Delivery Fee	
Return Receipt Showing to Whom & Date Delivered	
Return Receipt Showing to Whom, Date, & Addressee's Address	
TOTAL Postage & Fees	\$
Postmark or Date	

PS Form 3800, April 1995

Z 137 529 922

US Postal Service

Receipt for Certified Mail

No Insurance Coverage Provided.

Do not use for International Mail (See reverse)

Sent to	
Texaco	
Street & Number	
Heritage Center	
Post Office, State, & ZIP Code	
Midland, TX 79701	
Postage	\$
Certified Fee	
Special Delivery Fee	
Restricted Delivery Fee	
Return Receipt Showing to Whom & Date Delivered	
Return Receipt Showing to Whom, Date, & Addressee's Address	
TOTAL Postage & Fees	\$
Postmark or Date	

PS Form 3800, April 1995

Z 137 529 924

US Postal Service

Receipt for Certified Mail

No Insurance Coverage Provided.

Do not use for International Mail (See reverse)

Sent to	
Gray Pet. Maint. Corp	
Street & Number	
1600 Las Colinas Blvd STE 1200	
Post Office, State, & ZIP Code	
Irving, TX 75039-5611	
Postage	\$
Certified Fee	
Special Delivery Fee	
Restricted Delivery Fee	
Return Receipt Showing to Whom & Date Delivered	
Return Receipt Showing to Whom, Date, & Addressee's Address	
TOTAL Postage & Fees	\$
Postmark or Date	

PS Form 3800, April 1995

Lease: LOCKHART A 30	Well #: 5	FP Date: N/A
Field: EUMONT (YATES SEVEN RIVERS QUEEN) YS	Location: 30K 21S 36E	LP Date: 98-05
Operator: CONOCO INC	Liquid Cum: 36,798 bbls	Liq Since: N/A
RCI #: 250,025,21S36E30K00QN	Gas Cum: 2,291,686 mcf	Gas Since: N/A
API #: 30-025-04836-00	Status: ACT GAS	

DATE	OIL, BBLs	GAS, MCF	WATER, BBLs	WELLS
06/1997	0	11,876	60	1
07/1997	0	9,660	62	1
08/1997	0	11,333	558	1
09/1997	40	10,234	320	1
10/1997	48	9,375	384	1
11/1997	13	8,521	104	1
12/1997	14	7,682	112	1
01/1998	0	7,595	0	1
02/1998	0	6,498	0	1
03/1998	27	7,028	243	1
04/1998	28	6,755	252	1
05/1998	28	6,985	252	1
Total	198	103,542	2,347	

