

Stogner, Michael, EMNRD

From: Stogner, Michael, EMNRD
To: bsulres@rangeresources.com
Cc:
Subject: proposed Brunson Well No. 8
Attachments:

Sent: Tue 8/29/2006 4:31 PM

RE: pTDSO-623348486

The Division received your letter of application dated August 17, 2006 absent attachments. Please submit the referenced plats and any other information to support your application so that I might process your request in a timely fashion. Thank you.

Stogner, Michael, EMNRD

 Attachments can contain viruses that may harm your computer. Attachments may not display correctly.

From: System Administrator **Sent:** Tue 8/29/2006 4:31 PM
To: Stogner, Michael, EMNRD
Subject: Undeliverable:proposed Brunson Well No. 8
Attachments:  proposed Brunson Well No. 8(2KB)

Your message did not reach some or all of the intended recipients.

Subject: proposed Brunson Well No. 8
Sent: 8/29/2006 4:31 PM

The following recipient(s) could not be reached:

bsulres@rangeresources.com on 8/29/2006 4:31 PM
The e-mail account does not exist at the organization this message was sent to. Check the e-mail address, or contact the recipient directly to find out the correct address.
<CEXFES.nmes.lcl #5.1.1 smtp;550 5.1.1 User unknown>

Stogner, Michael, EMNRD

From: Stogner, Michael, EMNRD

Sent: Tue 8/29/2006 4:32 PM

To: Bryan Surles

Cc:

Subject: RE: proposed Brunson Well No. 8



Attachments:

RE: pTDS0-623348486

The Division received your letter of application dated August 17, 2006 absent attachments. Please submit the referenced plats and any other information to support your application so that I might process your request in a timely fashion. Thank you.

 Attachments can contain viruses that may harm your computer. Attachments may not display correctly.

Stogner, Michael, EMNRD

From: Paula Hale [PHale@rangeresources.com] **Sent:** Wed 8/30/2006 7:52 AM
To: Stogner, Michael, EMNRD
Cc:
Subject: Proposed Brunson Well No 8
Attachments:  Location Plat Pkg - Brunson #8.pdf(473KB)  Location Plat Pkg - Brunson #8.tif(5MB)

Dear Mr. Stogner:

I apologize. I thought we had attached the plat with the letter of application. I have attached the plat pkg to this e-mail. Please let me know if anything else is required.

Thank you,

Paula Hale

Range Operating New Mexico Inc.

227588

From: Stogner, Michael, EMNRD [mailto:michael.stogner@state.nm.us]
Sent: Tuesday, August 29, 2006 5:32 PM
To: Bryan Surles
Subject: RE: proposed Brunson Well No. 8

RE: pTDS0-623348486

The Division received your letter of application dated August 17, 2006 absent attachments. Please submit the referenced plats and any other information to support your application so that I might process your request in a timely fashion. Thank you.

Thank you.

Paula Hale

State of New Mexico

Energy, Minerals and Natural Resources Department

DISTRICT I

1225 N. FRENCH DR., HOBBES, NM 88240

DISTRICT II

1301 W. GRAND AVENUE, ARTESIA, NM 88210

DISTRICT III

1000 Rio Brazos Rd., Artec, NM 87410

DISTRICT IV

1225 S. ST. FRANCIS DR., SANTA FE, NM 87505

OIL CONSERVATION DIVISION

1220 SOUTH ST. FRANCIS DR.
Santa Fe, New Mexico 87505

Form C-102
Revised October 12, 2005
Submit to Appropriate District Office
State Lease - 4 Copies
Fee Lease - 3 Copies

WELL LOCATION AND ACREAGE DEDICATION PLAT

☐ AMENDED REPORT

API Number	Pool Code 24150	Pool Name Eunice San Andres
Property Code 301542	Property Name BRUNSON	Well Number 8
OGRID No. 227588	Operator Name RANGE OPERATING NEW MEXICO, INC.	Elevation 3442'

Surface Location

UL or lot No.	Section	Township	Range	Lot Idn	Feet from the	North/South line	Feet from the	East/West line	County
J	4	22-S	37-E		2200	SOUTH	1585	EAST	LEA

Bottom Hole Location If Different From Surface

UL or lot No.	Section	Township	Range	Lot Idn	Feet from the	North/South line	Feet from the	East/West line	County

Dedicated Acres 40	Joint or Infill	Consolidation Code	Order No.
-----------------------	-----------------	--------------------	-----------

NO ALLOWABLE WILL BE ASSIGNED TO THIS COMPLETION UNTIL ALL INTERESTS HAVE BEEN CONSOLIDATED
OR A NON-STANDARD UNIT HAS BEEN APPROVED BY THE DIVISION

<p>GEODETIC COORDINATES NAD 27 NME</p> <p>Y=518329.5 N X=860792.4 E</p> <p>LAT.=32°25'10.47" N LONG.=103°09'50.93" W</p>	<p>1585'</p>	
	<p>2200'</p>	
	<p>OPERATOR CERTIFICATION</p> <p>I hereby certify that the information herein is true and complete to the best of my knowledge and belief, and that this organization either owns a working interest or unleased mineral interest in the land including the proposed bottom hole location or has a right to drill this well at this location pursuant to a contract with an owner of such mineral or working interest, or to a voluntary pooling agreement or a compulsory pooling order heretofore entered by this division.</p> <p><i>Paula Hale</i> 8/30/06 Signature Date</p> <p>Paula Hale Printed Name</p>	
	<p>SURVEYOR CERTIFICATION</p> <p>I hereby certify that the well location shown on this plat was plotted from field notes of actual surveys made by me or under my supervision, and that the same is true and correct to the best of my belief.</p> <p>APRIL 21, 2006</p> <p>Date Surveyed MR</p> <p>Signature & Seal of Professional Surveyor</p> <p><i>Gary E. Edson</i> 5/8/06 06.11.0688</p> <p>Certificate No. GARY EDSON 12841</p>	

LEA COUNTY,

NEW MEXICO



FROM THE INTERSECTION OF CO. RD. E-21
(DELAWARE BASIN) AND CO. RD. E-33
(S. LEGION) GO NORTH ON S. LEGION APPROX.
1.5 MILES. TURN RIGHT AND GO WEST APPROX.
0.3 MILES. TURN RIGHT AND GO SOUTH APPROX.
300 FEET. THIS LOCATION IS APPROX. 120 FEET
EAST.

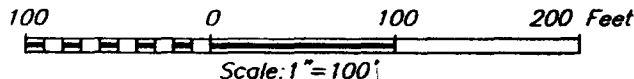

BRUNSON #8
LOCATED 2200 FEET FROM THE SOUTH LINE
AND 1585 FEET FROM THE EAST LINE OF SECTION 4,
TOWNSHIP 22 SOUTH, RANGE 37 EAST, N.M.P.M.,
LEA COUNTY, NEW MEXICO.

W.O. Number: 06.11.0688	Dr By: M.R.	Rev 1:N/A
-------------------------	-------------	-----------

Date: 04/27/06	Disk: CD#6	06110688	Scale: 1"=100'
----------------	------------	----------	----------------



**PROVIDING SURVEYING SERVICES
SINCE 1946**

JOHN WEST SURVEYING COMPANY

412 N. DAL PASO
HOBBBS, N.M. 88240
(505) 393-3117

VICINITY MAP

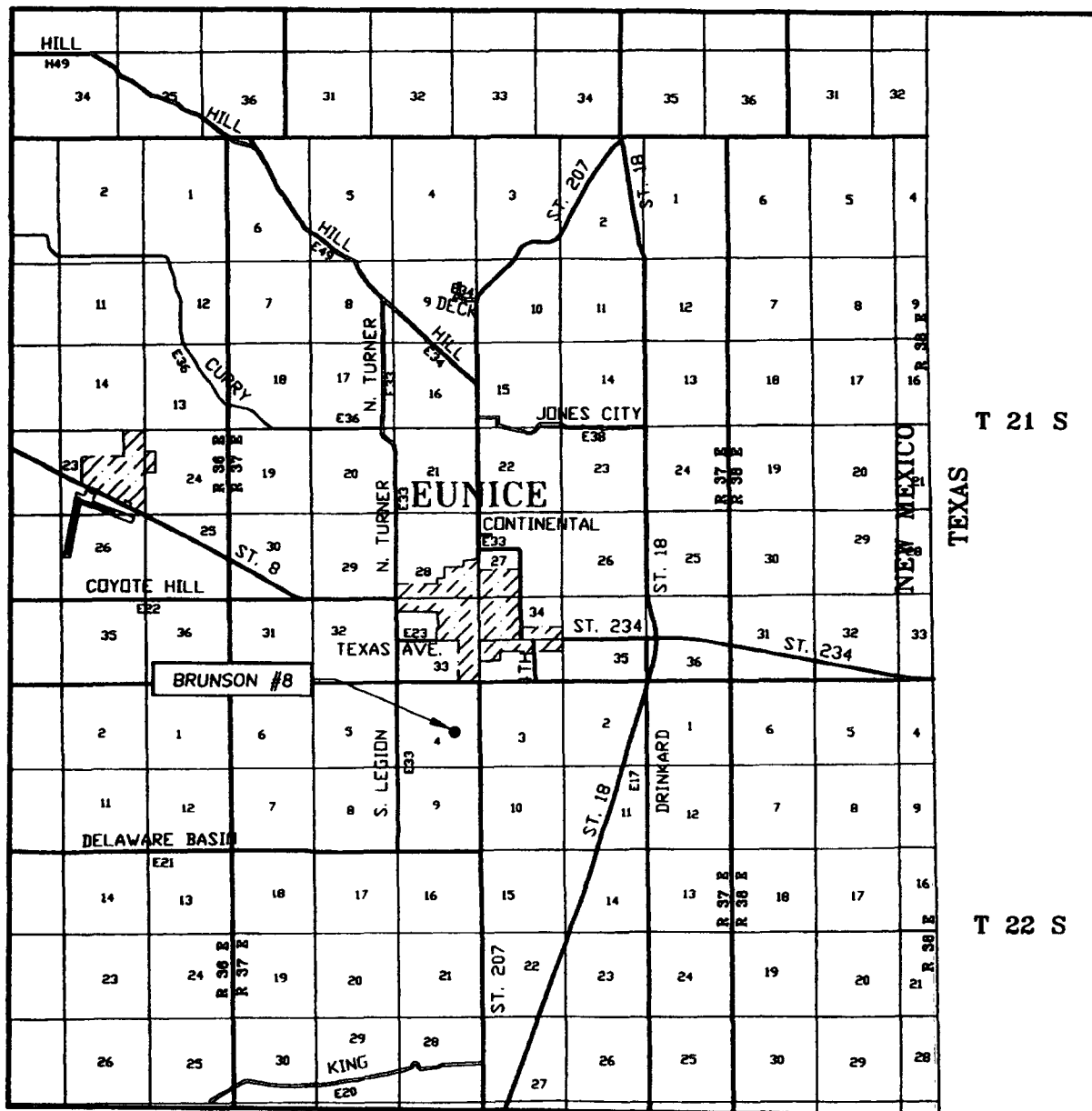

SCALE: 1" = 2 MILES

SEC. 4 TWP. 22-S RGE. 37-E
 SURVEY N.M.P.M.
 COUNTY LEA STATE NEW MEXICO
 DESCRIPTION 2200' FSL & 1585' FEL
 ELEVATION 3442'
 OPERATOR RANGE OPERATING
 NEW MEXICO, INC.
 LEASE BRUNSON

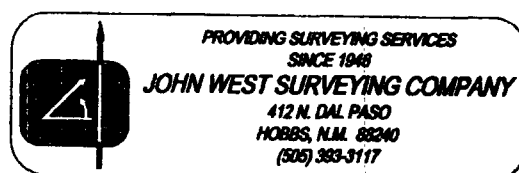

LOCATION VERIFICATION MAP

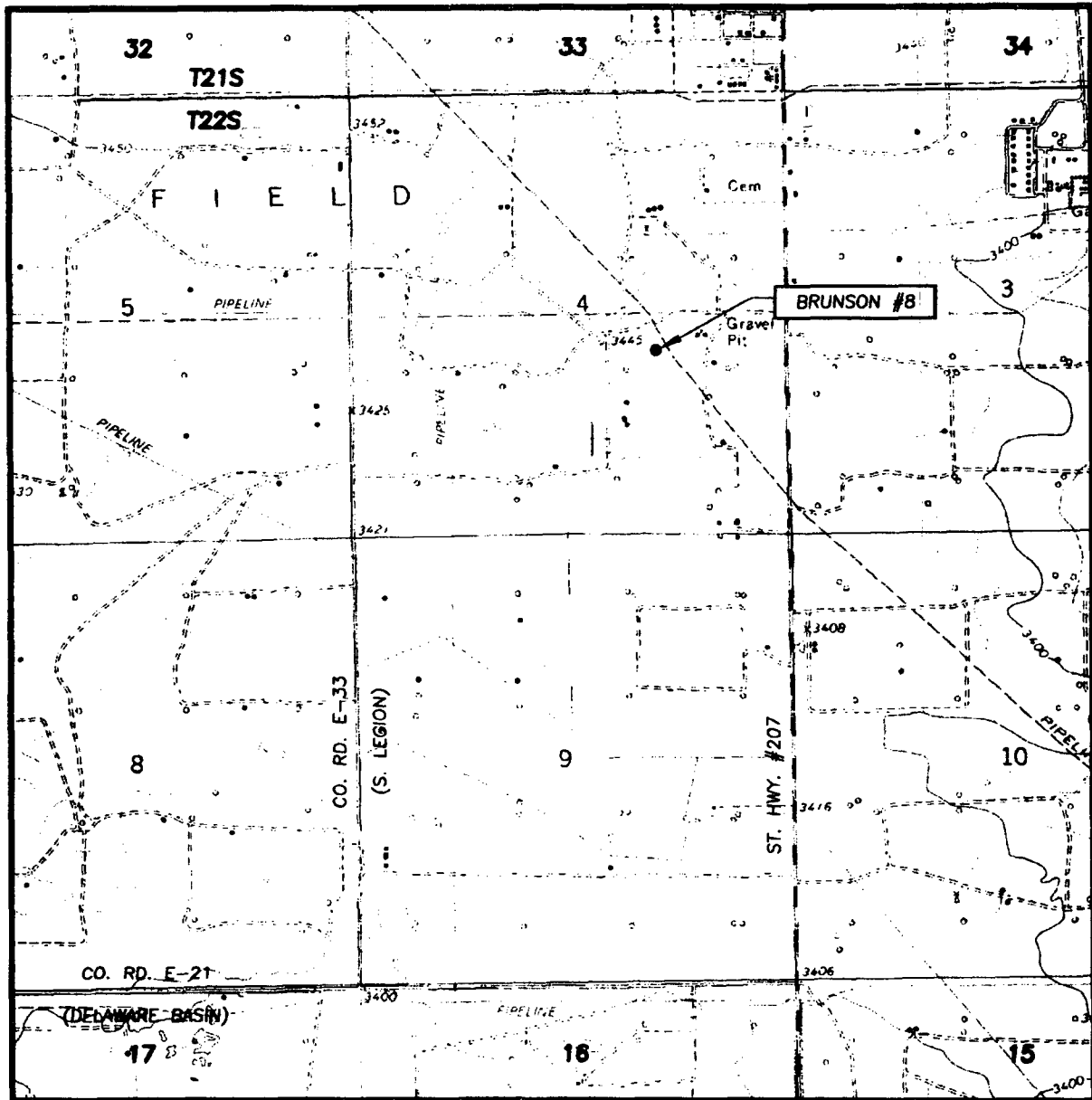

SCALE: 1" = 2000'

CONTOUR INTERVAL:
EUNICE, N.M. - 10'

SEC. 4 TWP. 22-S RGE. 37-E

SURVEY N.M.P.M.

COUNTY LEA STATE NEW MEXICO

DESCRIPTION 2200' FSL & 1585' FEL

ELEVATION 3442'

OPERATOR RANGE OPERATING
NEW MEXICO, INC.

LEASE BRUNSON

U.S.G.S. TOPOGRAPHIC MAP
EUNICE, N.M.

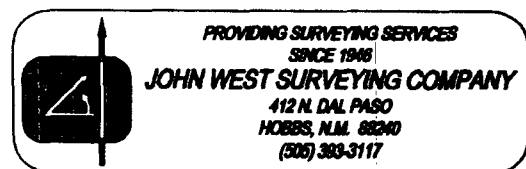

State of New Mexico

DISTRICT I

1625 N. FRENCH DR., ROSA, NM 88240

Energy, Minerals and Natural Resources Department

Form C-102

DISTRICT II

1301 W. GRAND AVENUE, ARTESIA, NM 88210

OIL CONSERVATION DIVISION

1220 SOUTH ST. FRANCIS DR.
Santa Fe, New Mexico 87505

Revised October 12, 2005
Submit to Appropriate District Office
State Lease - 4 Copies
Fee Lease - 3 Copies

DISTRICT III

1000 Rio Brazos Rd., Astec, NM 87410

DISTRICT IV

1220 S. ST. FRANCIS DR., SANTA FE, NM 87505

WELL LOCATION AND ACREAGE DEDICATION PLAT

☐ AMENDED REPORT

API Number	Pool Code 24150	Pool Name Eunice San Andres
Property Code 301542	Property Name BRUNSON	Well Number 8
OGRID No. 227588	Operator Name RANGE OPERATING NEW MEXICO, INC.	Elevation 3442'

Surface Location

UL or lot No.	Section	Township	Range	Lot Idn	Feet from the	North/South line	Feet from the	East/West line	County
J	4	22-S	37-E		2200	SOUTH	1585	EAST	LEA

Bottom Hole Location If Different From Surface

UL or lot No.	Section	Township	Range	Lot Idn	Feet from the	North/South line	Feet from the	East/West line	County

Dedicated Acres	Joint or Infill	Consolidation Code	Order No.
40			

NO ALLOWABLE WILL BE ASSIGNED TO THIS COMPLETION UNTIL ALL INTERESTS HAVE BEEN CONSOLIDATED
OR A NON-STANDARD UNIT HAS BEEN APPROVED BY THE DIVISION

<p>GEODETIC COORDINATES NAD 27 NME</p> <p>Y=518329.5 N X=860792.4 E</p> <p>LAT.=32°25'10.47" N LONG.=103°09'50.93" W</p>	<p>1585'</p>		<p>OPERATOR CERTIFICATION</p> <p>I hereby certify that the information herein is true and complete to the best of my knowledge and belief, and that this organization either owns a working interest or unleased mineral interest in the land including the proposed bottom hole location or has a right to drill this well at this location pursuant to a contract with an owner of such mineral or working interest, or to a voluntary pooling agreement or a compulsory pooling order heretofore entered by the division.</p> <p><i>Paula Hale</i> 8/30/06 Signature Date</p> <p>Paula Hale Printed Name</p>	
	<p>2200'</p>			<p>SURVEYOR CERTIFICATION</p> <p>I hereby certify that the well location shown on this plat was plotted from field notes of actual surveys made by me or under my supervision, and that the same is true and correct to the best of my belief.</p> <p>APRIL 21, 2006</p> <p>Date Surveyed MR</p> <p>Signature & Seal of Professional Surveyor</p> <p><i>Gary B. Edmon</i> 5/2/06 06.11.0688</p> <p>Certificate No. GARY EDMON 12841</p>

SECTION 4, TOWNSHIP 22 SOUTH, RANGE 37 EAST, N.M.P.M.,
LEA COUNTY, NEW MEXICO

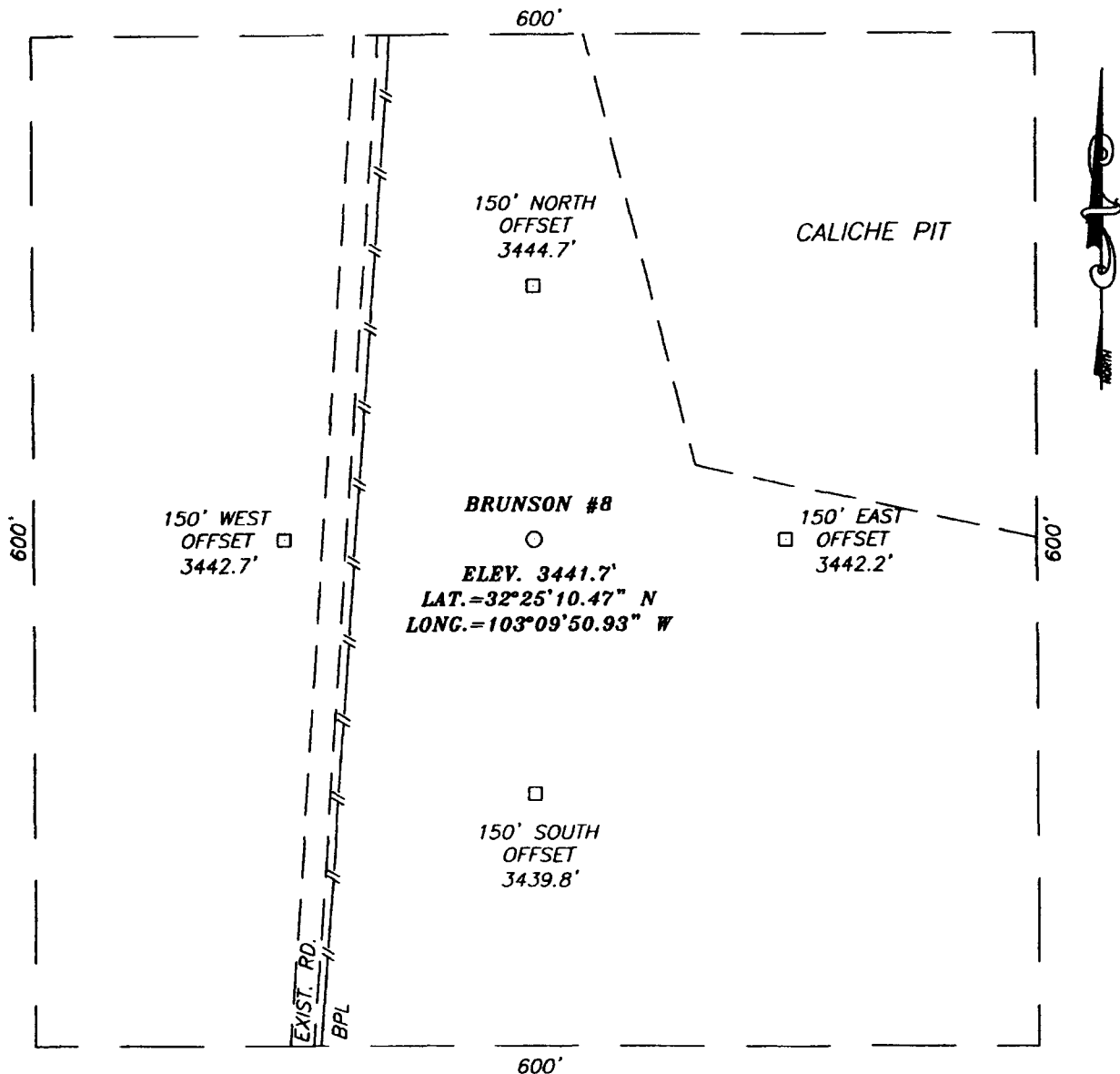

DIRECTIONS TO LOCATION

FROM THE INTERSECTION OF CO. RD. E-21
(DELAWARE BASIN) AND CO. RD. E-33
(S. LEGION) GO NORTH ON S. LEGION APPROX.
1.5 MILES. TURN RIGHT AND GO WEST APPROX.
0.3 MILES. TURN RIGHT AND GO SOUTH APPROX.
300 FEET. THIS LOCATION IS APPROX. 120 FEET
EAST.

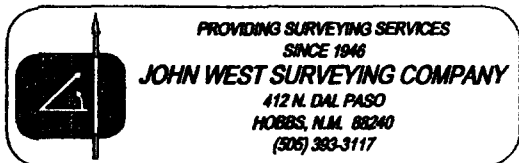
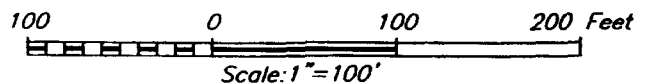

RANGE OPERATING NEW MEXICO, INC.

BRUNSON #8
LOCATED 2200 FEET FROM THE SOUTH LINE
AND 1585 FEET FROM THE EAST LINE OF SECTION 4,
TOWNSHIP 22 SOUTH, RANGE 37 EAST, N.M.P.M.,
LEA COUNTY, NEW MEXICO.

Survey Date: 04/21/06	Sheet 1 of 1 Sheets
W.O. Number: 06.11.0688	Dr By: M.R. Rev 1:N/A
Date: 04/27/06	Disk: CD#6 06110688 Scale: 1"=100'

VICINITY MAP

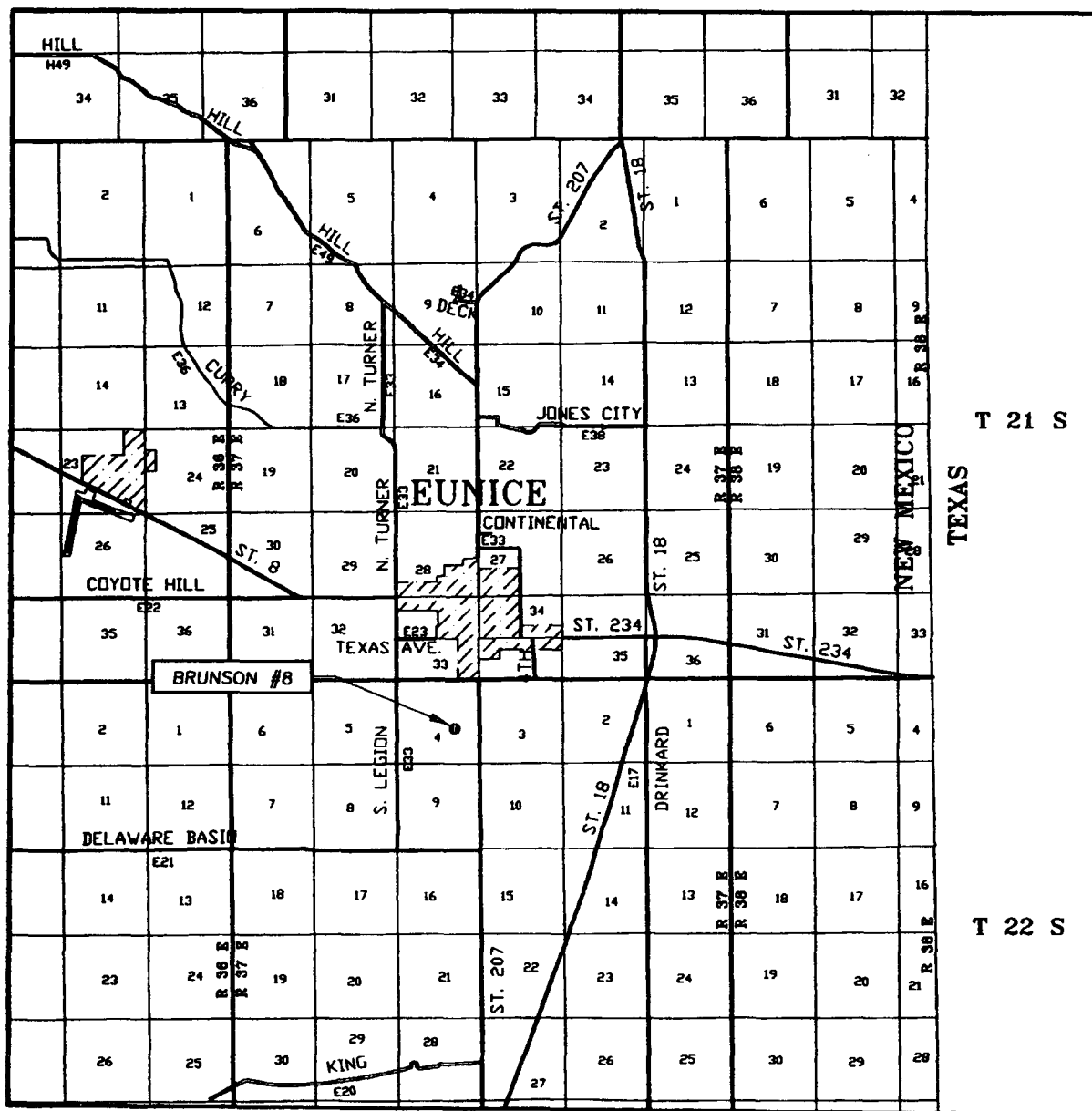

SCALE: 1" = 2 MILES

SEC. 4 TWP. 22-S RGE. 37-E

SURVEY _____ N.M.P.M.

COUNTY LEA STATE NEW MEXICO

DESCRIPTION 2200' FSL & 1585' FEL

ELEVATION 3442'

OPERATOR RANGE OPERATING
NEW MEXICO, INC.

LEASE BRUNSON

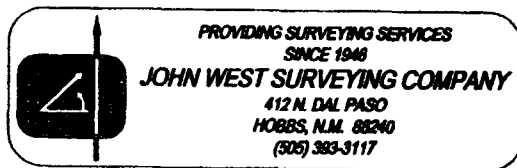

LOCATION VERIFICATION MAP

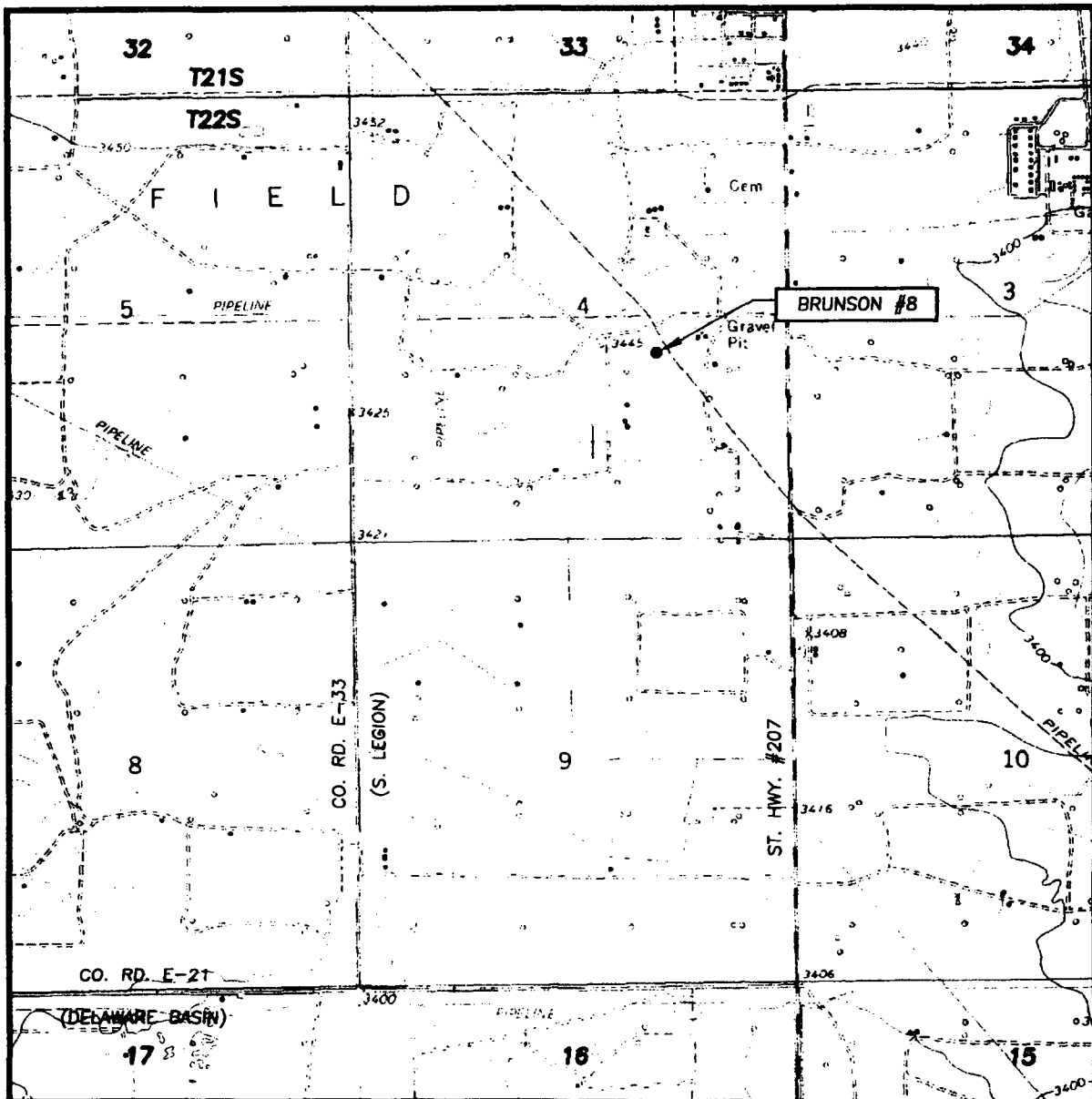

SCALE: 1" = 2000'

CONTOUR INTERVAL:
EUNICE, N.M. - 10'

SEC. 4 TWP. 22-S RGE. 37-E

SURVEY _____ N.M.P.M.

COUNTY LEA STATE NEW MEXICO

DESCRIPTION 2200' FSL & 1585' FEL

ELEVATION 3442'

OPERATOR RANGE OPERATING
NEW MEXICO, INC.

LEASE BRUNSON

U.S.G.S. TOPOGRAPHIC MAP
EUNICE, N.M.

