

9/22/06

ABOVE THIS LINE FOR DIVISION USE ONLY

NEW MEXICO OIL CONSERVATION DIVISION

- Engineering Bureau -

1220 South St. Francis Drive, Santa Fe, NM 87505



ADMINISTRATIVE APPLICATION CHECKLIST

THIS CHECKLIST IS MANDATORY FOR ALL ADMINISTRATIVE APPLICATIONS FOR EXCEPTIONS TO DIVISION RULES AND REGULATIONS WHICH REQUIRE PROCESSING AT THE DIVISION LEVEL IN SANTA FE

Application Acronyms:

- [NSL-Non-Standard Location] [NSP-Non-Standard Proration Unit] [SD-Simultaneous Dedication]
 [DHC-Downhole Commingling] [CTB-Lease Commingling] [PLC-Pool/Lease Commingling]
 [PC-Pool Commingling] [OLS - Off-Lease Storage] [OLM-Off-Lease Measurement]
 [WFX-Waterflood Expansion] [PMX-Pressure Maintenance Expansion]
 [SWD-Salt Water Disposal] [IPI-Injection Pressure Increase]
 [EOR-Enhanced Oil Recovery Certification] [PPR-Positive Production Response]

[1] TYPE OF APPLICATION - Check Those Which Apply for [A]

[A] Location - Spacing Unit - Simultaneous Dedication

☒ NSL ☐ NSP ☐ SD

Check One Only for [B] or [C]

[B] Commingling - Storage - Measurement

☐ DHC ☐ CTB ☐ PLC ☐ PC ☐ OLS ☐ OLM

[C] Injection - Disposal - Pressure Increase - Enhanced Oil Recovery

☐ WFX ☐ PMX ☐ SWD ☐ IPI ☐ EOR ☐ PPR

[D] Other: Specify _____

[2] NOTIFICATION REQUIRED TO: - Check Those Which Apply, or Does Not Apply

[A] ☒ Working, Royalty or Overriding Royalty Interest Owners

[B] ☐ Offset Operators, Leaseholders or Surface Owner

[C] ☐ Application is One Which Requires Published Legal Notice

[D] ☐ Notification and/or Concurrent Approval by BLM or SLO
 U.S. Bureau of Land Management - Commissioner of Public Lands, State Land Office

[E] ☐ For all of the above, Proof of Notification or Publication is Attached, and/or,

[F] ☐ Waivers are Attached

[3] SUBMIT ACCURATE AND COMPLETE INFORMATION REQUIRED TO PROCESS THE TYPE OF APPLICATION INDICATED ABOVE.

[4] **CERTIFICATION:** I hereby certify that the information submitted with this application for administrative approval is accurate and complete to the best of my knowledge. I also understand that no action will be taken on this application until the required information and notifications are submitted to the Division.

Note: Statement must be completed by an individual with managerial and/or supervisory capacity.

Print or Type Name

Signature

KELLAMIN & KELLAMIN

Attorneys At Law

P.O. Box 2265

Santa Fe, NM 87504-2265

Date

8/15/06

2006 AUG 15 PM 10 22

KELLAHIN & KELLAHIN
Attorney at Law

W. THOMAS KELLAHIN
706 GONZALES ROAD
SANTA FE, NEW MEXICO 87501

TELEPHONE 505-982-4285
FACSIMILE 505-982-2047
KELLAHIN@EARTHLINK.NET

August 15, 2006

HAND DELIVERED

Mr. Mark E. Fesmire, Director
Oil Conservation Division
1220 South Saint Francis Drive
Santa Fe, New Mexico 87505

Re: Administrative Application of OGX Resources LLC
for approval of an unorthodox gas well location
Malaga-Morrow Gas Pool,
Eddy County, New Mexico
Vasquez Well No. 1(API#30-015-23850)
2310 feet FSL and 1980 feet FEL (Unit J)
Section 11, T22S, R26E
24

Dear Mr. Fesmire:

On behalf of OGX Resources LLC, please find enclosed our referenced administrative application.

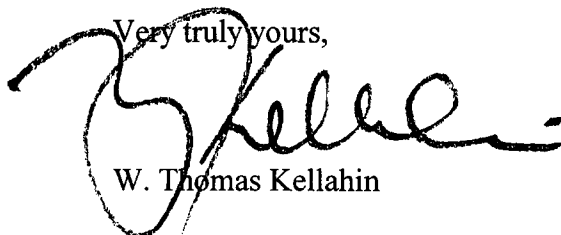
Very truly yours,

W. Thomas Kellahin

cc: OGX Resources LLC
Attn: Brian Ramey

2006 AUG 15 AM 10 22

**STATE OF NEW MEXICO
ENERGY, MINERALS AND NATURAL RESOURCES DEPARTMENT
OIL CONSERVATION DIVISION**

**ADMINISTRATIVE APPLICATION OF
OGX RESOURCES LLC FOR APPROVAL
OF AN UNORTHODOX GAS WELL LOCATION
EDDY COUNTY, NEW MEXICO**

ADMINISTRATIVE APPLICATION

Comes now OGX RESOURCES LLC ("OGX") and by and through its attorneys, Kellahin & Kellahin, and in accordance with Division General Rule 104.F, applies to the New Mexico Oil Conservation Division ("Division") for approval of an unorthodox gas well location for its Vasquez Well No. 1 (**API# 30-015-23850**) an existing Atoka gas well located 2310 feet FSL and 1980 feet FEL (Unit J) of Section 11, T22S, R26E, Eddy County, New Mexico concurrently dedicated to a standard 320-acre gas spacing unit ("GPU") consisting of the E/2 of this section to be recompleated in the Malaga-Morrow Gas Pool.

In support, OGX states:

1. OGX is the operator of the Vasquez Well No. 1, (API # 30-015-23850) an existing gas well, located 2310 feet FSL and 19080 feet FEL of this section that is dedicated to a standard 320-acre gas spacing unit consisting of the E/2 of this section. **See copies of Division Form C-145 attached as Exhibit "A" and C-102 attached as Exhibit "B"**
2. This well was spudded on June 29, 1981, drilled through the Morrow Formation to a total depth of 12,900, but plugged back and completed February 18, 1982 in the Malaga-Atoka Gas Pool. **See form C-104, dated 3/5/82, attached as Exhibit "C"**
3. At the time this well was spudded, it was located at a standard well location. Rule 104 then provided that wells located not closer than 1980 feet to the ends of the 320-acre spacing unit nor closer than 660 feet to the side boundary nor closer than 330 feet to a quarter-quarter section were "standard."
4. As a result of changes to Rule 104, adopted in Order R-11231, dated August 31, 1999, if recompleated in the Morrow Formation this well will be at an unorthodox location ("NSL").

5. The Division Rule 104.C now requires wells, dedicated to 320-acre gas spacing unit, to be drilled no closer than 660 feet to the outer boundary of the quarter section on which that well is located and no closer than 10 feet to any quarter-quarter lines or subdivision inner boundary.
6. This location is 330 feet south of the line dividing the NE/4 from the SE/4 and therefore is to be located at an unorthodox gas well location. **See Exhibit "B"**
7. OGX intends to recomplete this wellbore in the Morrow formation. **See Form C-103, approved July 14, 2006, attached as Exhibit "D"**
8. OGX has a 70.87502% interest in the E/2 and is the operator pursuant to a Joint Operating Agreement ("JOA").

TECHNICAL EVIDENCE

9. OGX's geologic data demonstrates that the proposed unorthodox gas well location is equivalent to the closest standard location. **Exhibit "E" (Morrow Net Pay Isopach map) attached.**
10. The cost comparison between a "new drill" at a standard location will cost \$2,700,000 while the recompilation of this existing wellbore will cost \$600,000 demonstrates that the recompletion should result of an estimated economic saving of \$2,100,000.

AFFECTED PARTIES

11. The east half of Section 11 consists of 6 separate fee tracts and is subdivided as set forth on **Exhibit "B"** attached.
12. All of the E/2 of Section 11 remains subject to the JOA for this wellbore

NOTIFICATION AND WAIVERS

14. Because OGX is the operator, notice has been sent to all of the interest owners in the GPU as required by Division Rule 1207 (2) (a) (iii). **See list attached as Exhibit "F" pages 1 thru 3.**

REQUEST

15. Approval of this application will afford the owners and the applicant the opportunity to produce their just and equitable share of the gas in the Morrow formation, will promote the orderly development in this area, will prevent the economic loss caused by the drilling of unnecessary wells, avoid the augmentation of risk arising from the drilling of an excessive number of wells and will otherwise prevent waste and protect correlative rights.

WHEREFORE, Applicant requests that this application be approved by the Division.

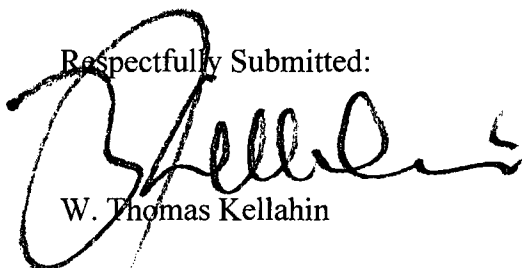

Respectfully Submitted:

A handwritten signature in black ink, appearing to read 'W. Thomas Kellahin', written over the printed name.

W. Thomas Kellahin

District II1301 W. Grand Ave., Artesia, NM 88210
Phone: (505) 748-1283 Fax: (505) 748-9720**State of New Mexico**
Energy, Minerals and Natural ResourcesForm C-145
Permit 26295**Oil Conservation Division****1220 S. St Francis Dr.****Santa Fe, NM 87505****Change of Operator****Previous Operator Information**OGRID: 148394
Name: VERNON E. FAULCONER, INC.
Address: PO BOX 7995
Address:
City, State, Zip: TYLER, TX 75711**New Operator Information**Effective Date: 4/1/2006
OGRID: 217955
Name: OGX RESOURCES, LLC
Address: P. O. BOX 2064
Address:
City, State, Zip: MIDLAND, TX 79702

I hereby certify that the rules of the Oil Conservation Division have been complied with and that the information on this form and the certified list of wells is true to the best of my knowledge and belief.

Previous OperatorSignature: 
Printed Name: Roy Sloan Jr.
Title: Engineer
Date: 3/30/06 Phone: 903-581-4382**New Operator**Signature: 
Printed Name: FRANK M. AGAR, JR.
Title: MEMBER
Date: 3-29-2006 Phone: 432-685-1287**NMOCD Approval**

Electronic Signature: Carmen Reno, District 2

Date: April 11, 2006



NEW MEXICO OIL CONSERVATION COMMISSION
WELL LOCATION AND ACREAGE DEDICATION PLAT

Form C-102
Supersedes C-128
Effective 1-1-65

All distances must be from the outer boundaries of the Section.

Operator COQUINA OIL CORPORATION			Lease VASQUEZ			Well No. 1
Unit Letter J	Section 11	Township 24-S	Range 28-E	County EDDY		
Actual Footage Location of Well: 2310 feet from the SOUTH line and 1980 feet from the EAST line						
Ground Level Elev. 2984	Producing Formation Morrow		Pool Malaga Morrow		Dedicated Acreage: 320 Acres	

1. Outline the acreage dedicated to the subject well by colored pencil or hatchure marks on the plat below.
2. If more than one lease is dedicated to the well, outline each and identify the ownership thereof (both as to working interest and royalty).
3. If more than one lease of different ownership is dedicated to the well, have the interests of all owners been consolidated by communitization, unitization, force-pooling, etc?

☒ Yes ☐ No If answer is "yes" type of consolidation Unitization

If answer is "no," list the owners and tract descriptions which have actually been consolidated. (Use reverse side of this form if necessary.)

No allowable will be assigned to the well until all interests have been consolidated (by communitization, unitization, forced-pooling, or otherwise) or until a non-standard unit, eliminating such interests, has been approved by the Commission.

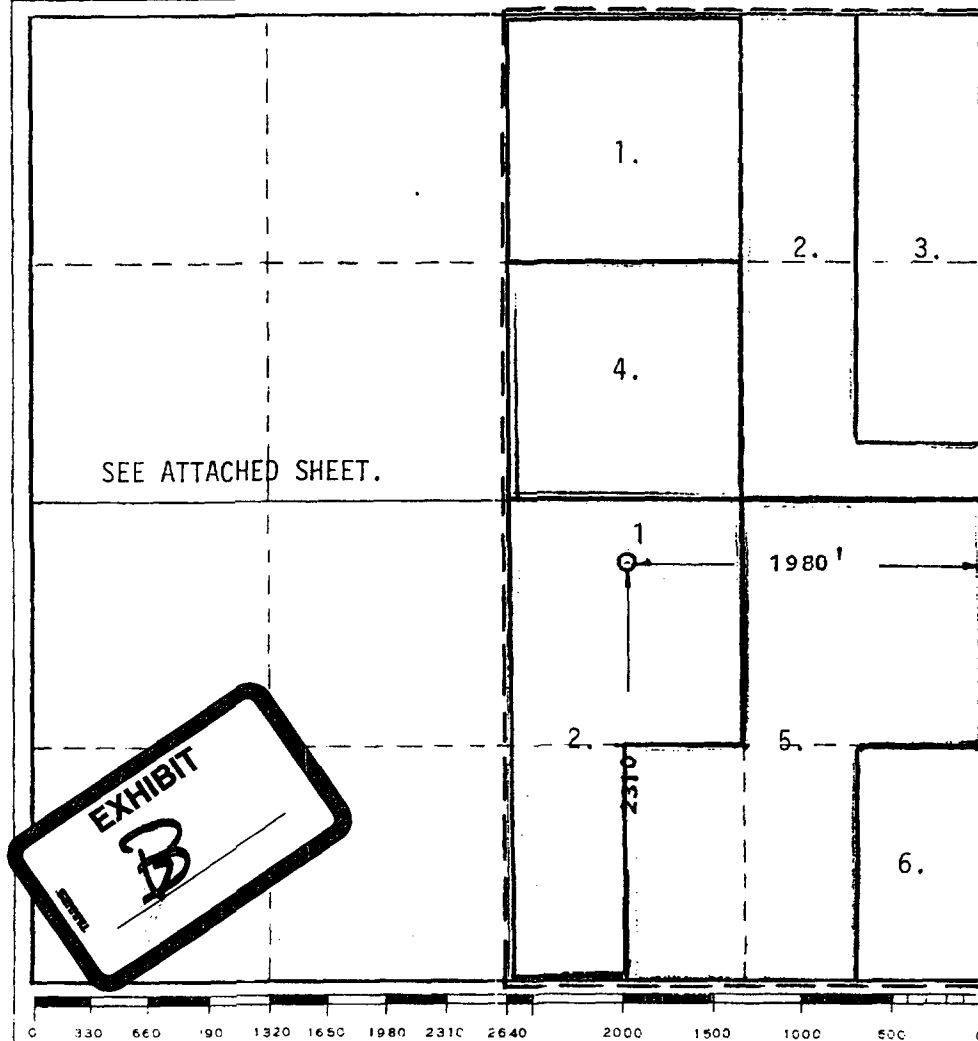

CERTIFICATION

I hereby certify that the information contained herein is true and complete to the best of my knowledge and belief.

Billy M. Priebe

Name
Billy M. Priebe

Position
Drilling Manager

Company
Coquina Oil Corporation

Date
June 30, 1981

I hereby certify that the well location shown on this plat was plotted from field notes of actual surveys made by me or under my supervision, and that the same is true and correct to the best of my knowledge and belief.

Date Surveyed
JUNE 10, 1981

Registered Professional Engineer and/or Land Surveyor

Maule E. Shaw
Certificate No.

2189

Standard 640-acre Section

OIL CONSERVATION DIVISION

RECEIVED
Form C-104
Revised 10-1-78P. O. BOX 2088
SANTA FE, NEW MEXICO 87501

MAR 10 1982

REQUEST FOR ALLOWABLE
AND
AUTHORIZATION TO TRANSPORT OIL AND NATURAL GASO. C. D.
ARTESIA OFFICE

REASON(S) FOR REQUEST	
TRANSPORTATION	
LAND OFFICE	
OPERATION	
PRODUCTION OFFICE	
OPERATOR	

Coquina Oil Corporation /

Address
P. O. Drawer 2960, Midland, Texas 79702

Reason(s) for (Using) (Check proper box)	Other (Please explain)
New Well <input checked="" type="checkbox"/>	Change in Transporter of:
Recompletion <input type="checkbox"/>	Oil <input type="checkbox"/> Dry Gas <input type="checkbox"/>
Change in Ownership <input type="checkbox"/>	Coalinghead Gas <input type="checkbox"/> Condensate <input type="checkbox"/>

If change of ownership give name
and address of previous owner

DESCRIPTION OF WELL AND LEASE

Lease Name	Well No. Pool Name, including formation	Kind of Lease	Lease To
Vasquez	1 Malaga Atoka	State, Federal or Fee	Fee
Location			
Unit Letter J	2310 Feet From The South	Line and 1980	Feet From The East
Line of Section 11	Township 24S	Range 28E	County Eddy

DESIGNATION OF TRANSPORTER OF OIL AND NATURAL GAS

Name of Authorized Transporter of Oil <input type="checkbox"/> or Condensate <input checked="" type="checkbox"/>	Address (Give address to which approved copy of this form is to be sent)
Basin, Inc.	P. O. Box 2297, Midland, Texas 79702
Name of Authorized Transporter of Coalinghead Gas <input type="checkbox"/> or Dry Gas <input checked="" type="checkbox"/>	Address (Give address to which approved copy of this form is to be sent)
El Paso Natural Gas Company	P. O. Box 1492, El Paso, Texas 79702
If well produces oil or liquids, give location of tanks.	Unit Sec. Twp. Rge. Is gas actually connected? When
J 11 24S 28E	No Yes 3/2/82

If this production is commingling with that from any other lease or pool, give commingling order number:

COMINGLING DATA

Designate Type of Completion - (X)	Oil Well <input checked="" type="checkbox"/> Gas Well <input type="checkbox"/> New Well <input checked="" type="checkbox"/> Workover <input type="checkbox"/> Deepen <input type="checkbox"/> Plug block <input type="checkbox"/> Sand Screen <input type="checkbox"/> Test Well <input type="checkbox"/>		
Date Spudded 6/29/81	Date Comp. Ready to Prod. 2/18/82	Total Depth 12,900'	F.B.T.D. 11,850'
Elevations (D.F., R.R., RT, GR, etc.,) 2984' GL	Name of Producing Formation Atoka	Top Oil/Gas Key 11,758'	Tubing Depth 2 3/8" 11,613'
Perforations 11,805-817', 11,758-765'			Depth Casing Shoe 12,898'

TUBING, CASING, AND CEMENTING RECORD

HOLE SIZE	CASING & TUBING SIZE	DEPTH SET	SACKS CEMENT
26"	20"	349'	950
17 1/2"	13-3/8"	2596'	2300
12 1/4"	9-5/8"	9906'	1st Stg: 800; 2nd 600
	2 3/8" liner	9452 - 12137	500
	2 1/8" liner	11853 - 12295	150

TEST DATA AND REQUEST FOR ALLOWABLE
OIL WELL (Test must be after 48 hours of shut-in of lead oil and must be equal to or exceed top oil
60% for this depth or be for full 72 hours)

Date First New Oil Run To Tanks	Date of Test	Producing method (Pump, pump, gas lift, etc.)
Length of Test	Testing Pressure	Casing Pressure
Actual Prod. During Test	Oil-Info.	Water-Info.

GAS WELL

Actual First Test-MCF/D	Length of Test	Bbls. Condensate/MCF	Gravity of Condensate
6561 CAOF	4 1/2 hours	0	--
Testing Method (pistol, back pt.)	Testing Pressure (lb./sq. in.)	Casing Pressure (lb./sq. in.)	Choke Size
Orifice Meter	Various	0	Various

CERTIFICATE OF COMPLIANCE

I hereby certify that the rules and regulations of the Oil Conservation
Division have been complied with and that the information given
above is true and complete to the best of my knowledge and belief.

OIL CONSERVATION DIVISION

APPROVED
MAR 2 1982BY
W. A. LussattTITLE
SUPERVISOR, DISTRICT II

This form is to be used in compliance with rules and regulations.

If this is a request for allowable for a newly drilled or deepened
well, this form is to be accompanied by a certificate of the division
taken on the well in accordance with rules and regulations.All violations of this form shall be considered a violation of the
oil conservation rules and regulations.This certificate is valid for 12 months from the date of issuance
and is not to be used for any other purpose.Violations of this form shall be considered a violation of the
oil conservation rules and regulations.

Billy M. Pender

Drilling Manager

March 5, 1982



Submit 3 Copies To Appropriate District Office
District I
1625 N. French Dr., Hobbs, NM 88240
District II
1301 W. Grand Ave., Artesia, NM 88210
District III
1000 Rio Brazos Rd., Aztec, NM 87410
District IV
1220 S. St. Francis Dr., Santa Fe, NM 87505

State of New Mexico
Energy, Minerals and Natural Resources

Form C-103
May 27, 2004

OIL CONSERVATION DIVISION
1220 South St. Francis Dr.
Santa Fe, NM 87505

WELL API NO.
30-015-23850

5. Indicate Type of Lease
STATE ☐ FEE ☒

6. State Oil & Gas Lease No.

7. Lease Name or Unit Agreement Name

VASQUEZ

8. Well Number 1

9. OGRID Number
217955

10. Pool name or Wildcat

SUNDRY NOTICES AND REPORTS ON WELLS
(DO NOT USE THIS FORM FOR PROPOSALS TO DRILL OR TO DEEPEN OR PLUG BACK TO A DIFFERENT RESERVOIR. USE "APPLICATION FOR PERMIT" (FORM C-101) FOR SUCH PROPOSALS.)

1. Type of Well: Oil Well ☐ Gas Well ☒ Other

2. Name of Operator
OGX RESOURCES LLC

3. Address of Operator
P.O. BOX 2064, MIDLAND, TEXAS 79702

4. Well Location

Unit Letter J : 2310 feet from the SOUTH line and 1980 feet from the EAST line

Section II Township 24-S Range 28-E NMPM EDDY County

11. Elevation (Show whether DR, RKB, RT, GR, etc.)
2984'

Pit or Below-grade Tank/Application ☐ or Closure ☐

Pit type _____ Depth to Groundwater _____ Distance from nearest fresh water well _____ Distance from nearest surface water _____

Pit Liner Thickness: _____ mil Below-Grade Tank: Volume _____ bbls; Construction Material _____

12. Check Appropriate Box to Indicate Nature of Notice, Report or Other Data

NOTICE OF INTENTION TO:

PERFORM REMEDIAL WORK ☒ PLUG AND ABANDON ☐
TEMPORARILY ABANDON ☐ CHANGE PLANS ☐
PULL OR ALTER CASING ☐ MULTIPLE COMPL ☐

OTHER: ☐

SUBSEQUENT REPORT OF:

REMEDIAL WORK ☐ ALTERING CASING ☐
COMMENCE DRILLING OPNS. ☐ P AND A ☐
CASING/CEMENT JOB ☐

OTHER: ☐

13. Describe proposed or completed operations. (Clearly state all pertinent details, and give pertinent dates, including estimated date of starting any proposed work). SEE RULE 1103. For Multiple Completions: Attach wellbore diagram of proposed completion or recompletion.

OGX RESOURCES LLC PROPOSES TO RE-COMplete THIS WELL IN A MORROW ZONE. WE PLAN TO PERFORATE 12,718'-38' & 12,750'-54' UNDER A PACKER USING TUBING COVERED GUNS & TO PERFORATE 12,586'-90'; 12,610'-18' & 12,628'-44' UNDER A PACKER W/ THROUGH TUBING GUNS. THE WELL WILL BE FLOW TESTED DOWN THE SALES LINE & EVALUATED FOR FURTHER STIMULATION.

IN ADDITION, OGX PLANS TO USE STEEL TANKS FOR ANY CIRCULATION NEEDS VERSUS ANY PIT CONSTRUCTION. THEREFORE, WE REQUEST EXEMPTION FROM C-144 OR PIT RESTRICTION FOR THIS WELL WORK.

A 11" X 3000 PSI HYDRAULIC BOP INSTALLED DURING THIS OPERATION.

I hereby certify that the information above is true and complete to the best of my knowledge and belief. I further certify that any pit or below-grade tank has been/will be constructed or closed according to NMOC guidelines ☐, a general permit ☐ or an (attached) alternative OCD-approved plan ☐.

SIGNATURE Brian Ramey TITLE OPERATIONS MANAGER DATE 6/28/2006

Type or print name BRIAN RAMEY E-mail address: brian@ogxresources.com Telephone No. 432-685-1739 ext. 234
For State Use Only

APPROVED BY: FOR RECORDS ONLY TITLE _____ DATE JUL 14 2006
Conditions of Approval (if any):

Re-Submit on C101; C102.
NSL is Required

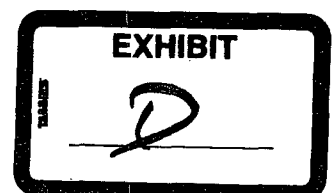

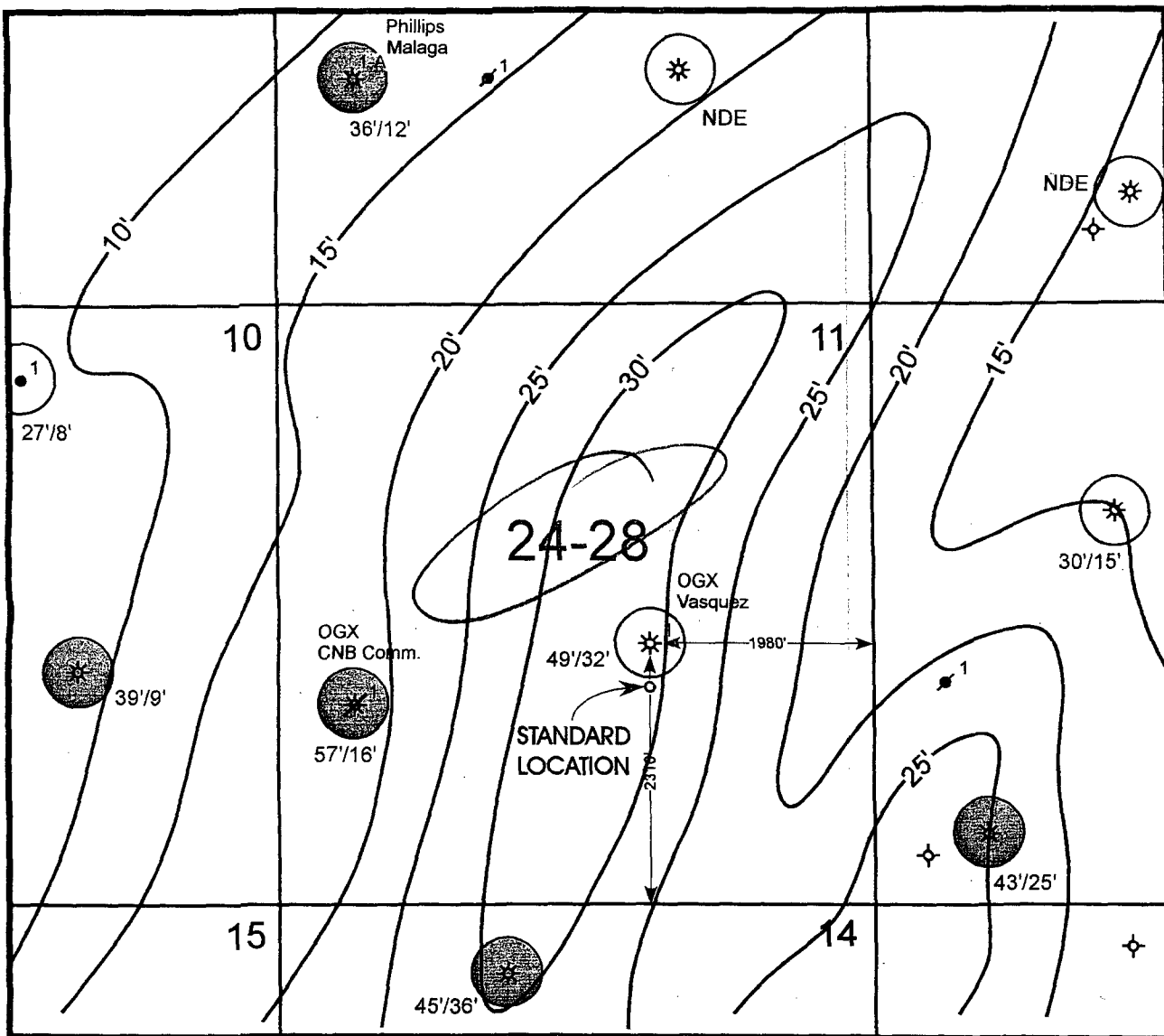

● Morrow Producer

Scale: 1"=1000'
7/28/06

OGX RESOURCES LLC **MORROW NET SAND ISOPACH**

GROSS CLEAN SAND ^{49'/32'} **NET SAND (>7% POROSITY CUT OFF)**

C.I.=5'



KELLAHIN & KELLAHIN
Attorney at Law

W. THOMAS KELLAHIN
706 GONZALES ROAD
SANTA FE, NEW MEXICO 87501

TELEPHONE 505-982-4285
FACSIMILE 505-982-2047
KELLAHIN@EARTHLINK.NET

August 15, 2006

CERTIFIED MAIL-RETURN RECEIPT REQUESTED

**NOTICE OF THE FOLLOWING NEW MEXICO OIL CONSERVATION DIVISION
ADMINISTRATIVE CASE:**

TO ALL PARTIES ON NOTICE LIST

*Re: Administrative Application of OGX Resources LLC for approval of an unorthodox well
location for it Vasquez Well No. 1, Unit J of Section 11, T22S, R326E, Eddy County, New Mexico*

Dear Party:

On behalf of OGX Resources, LLC please find enclosed a copy of its referenced administrative application. If you have no objection, then there is nothing for you to do. If you are willing to waive objection, please sign this letter as indicated and return it to me. However, should you have any objection to the Division approving this application, then it will be necessary for you to file a written objection with the New Mexico Oil Conservation Division, 1220 South Saint Francis Drive, Santa Fe, New Mexico 87505 within twenty (20) days of the date of this letter. Failure to file a timely objection will preclude you from objecting at a later date. If you have any questions, please contact OGX at 432-684-5824

Very truly yours,

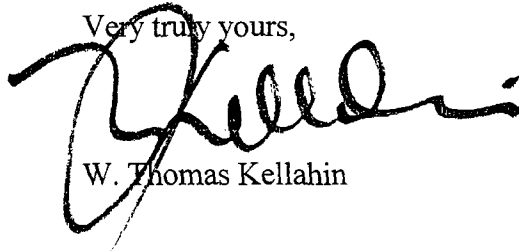

W. Thomas Kellahin

WAIVER OF OBJECTION:

By: _____ with authority for
and on behalf of _____

Dated: _____



LJ675 85-0426997
LJR RESOURCES LTD CO
P.O. BOX 2527
ROSWELL, NM 88202

MA991 118-22-4302
DONALD J. MAYHEW
4810 SURREY DRIVE
ROSWELL, GA 30075-1633

MC090 525-92-8583
WILLIAM J. MCCAUGHY
P.O. BOX 376
ARTESIA, NM 88211-0376

MC586 455-98-9725
MONTY MCLANE
P.O. BOX 9451
MIDLAND, TX 79708-9451

MC592 461-78-1056
DOUGLAS V. MCNEEL
P.O. BOX 1025
HELOTES, TX 78023-1025

MC595 452-66-2800
WILLIAM H. MCNUTT
HC 2 BOX 137
MOUNTAIN HOME, TX 78058-9320

NO586 451-82-8009
SARAH MCNUTT NORTON
8081 CR 500
BLUE RIDGE, TX 75424

OG955 20-1195302
OGX PRODUCTION LTD.
P.O. BOX 2064
MIDLAND, TX 79702

PA213 95-6649784
LUCILLE A. PAINE TRUST
1734 ANTELOPE AVENUE
VENTURA, CA 93003

PI598 85-0381470
PITCH ENERGY CORPORATION
P.O. BOX 304
ARTESIA, NM 88211

PO160 74-1659398
POGO PRODUCING COMPANY
P.O. BOX 840502
DALLAS, TX 75284-0502

RN287 85-0443044
R-N LIMITED PARTNERSHIP
3755 E GRAND PLAINS RD
ROSWELL, NM 88203

RO510 464-96-4471
DEBRA H. ROLAND
P.O. BOX 456
GARDENDALE, TX 79758

SC391 461-78-2082
NEEL ANN MCNEEL SCOTT
P.O. BOX 514
FLAUFURRIAS, TX 78355-0514

SH680 48-1240932
SHRADER ENTERPRISES LP
3349 SOUTH ST PAUL
WICHITA, KS 67217

SM280 449-84-7206
BARBARA E. SMITH
1808 LINCOLNSHIRE DR
BEDFORD, TX 76021

SM337 449-57-3275
KEVIN MARK SMITH
1502 N BROADWAY ST
WICHITA, KS 67214-1106

SM338 446-58-4493
JANET ANN SMITH
8321 NE 122ND ST
JONES, OK 73049

ST093 86-1065241
STATES ROYALTY LTD PARTNERSHIP
P.O. BOX 911
BRECKENRIDGE, TX 76424-0911

ST634 265-11-0211
SAMUEL C. STOIA
P.O. BOX 888
KEY LARGO, FL 33037

VA877 585-24-9693
OSCAR F & GLORIA G VASQUEZ
P.O. BOX 98
MALAGA, NM 88263

WA570 462-62-0567
RONNIE WARD
BOX 303
IRAAN, TX 79744

WI366 525-76-0029
GLEN B & VIVIAN WILLIAMS
3166 COUNTY LINE ROAD
MOUNTAIN GROVE, NM 65711

WI381 525-86-7980
JAMES W & TROYCE WILLIAMS
BOX 7985 HIGHWAY 38
MOUNTAIN GROVE, MO 65711

WI382 525-64-2365
L D & SHIRLEY A WILLIAMS
2236 E FAIRFIELD
MESA, AZ 85213

Damon & Maria Bond Family LLC
P. O. Box 2397
Mesilla Park NM 88047
Attn: Bobby Rankin, manager

BA650 525-94-8962
GILBERT M & SONJA L BARNES
1321 HILDAGO RD BOX 14
CARLSBAD, NM 88220

BE159 525-62-4997
FRANCIS F BEEMAN
BETTYE J BEEMAN
1405 W URAL DRIVE
CARLSBAD, NM 88220-4064

BE578 438-68-1550
M BRAD & LINDA BENNETT
P.O. BOX 51510
MIDLAND, TX 79710-1510

BE627 461-04-4393
THERESE JAMES BERRY
205 CHINKAPIN DRIVE
PANGBURN, AR 72121

BL180 449-50-4907
DICK A BLENDEEN
P.O. BOX 1446
CARLSBAD, NM 88220

CA557 85-6013513
CARMEX, INC.
P.O. BOX 1718
CARLSBAD, NM 88221

CR220 472-12-1869
CRESS FAMILY TRUST
P.O. BOX 37
ROSWELL, NM 88201-0037

DU095 585-88-5395
TOMMY & CARLA DUARTE
P.O. BOX 71
MALAGA, NM 88263

FA520 75-2799807
FAULCONER RES 1999 LTD PARTNS
P.O. BOX 7995
TYLER, TX 75711

FO743 434-76-2114
ROBERT L & EVA FOREMAN
4387 ARNOLD WHITE RD
LAKE CHARLES, LA 70611

FR960 525-96-3394
ANDREW DON FRY
P.O. BOX 6447
SANTA FE, NM 87502

GA118 454-01-0271
ALMA D. GRANBERRY
1923 33RD STREET
LUBBOCK, TX 79411

GA170 451-19-9199
RICHARD MICHAEL GADDY
P.O. BOX 51611
MIDLAND, TX 79710

GR119 455-84-5451
WALTER E. GRANBERRY, JR
4811 14TH STREET
LUBBOCK, TX 79416

HA726 85-0345963
HARVARD ENERGY PARTNERSHIP
P.O. BOX 936
ROSWELL, NM 88201

HA954 458-92-8199
ELIZABETH ANN HAYNES
P.O. BOX 574
STORY, WY 82842-0574

HE226 20-6527692
ESTATE OF JANE R. HEINSCH
1309 DELTA
CARLSBAD, NM 88220

HS205 74-2805282
H & S OIL LLC
P.O. BOX 186
ARTESIA, NM 88211-0186

HU136 525-70-3670
J. R. HUFF
2012 S. MAIN ST
ROSWELL, NM 88210

HU141 452-46-0279
JEANETTE HUGHEN
2200 W PIERCE #2C
CARLSBAD, NM 88220

JA436 525-74-3485
DONALD MYERS JAMES
1513 COUNTY ROAD 132A
KINGSLAND, TX 78639

JA440 452-06-6712
LAURA CLAIRE JAMES
50 TNT LANE
HEBER SPRINGS, AR 72543

JA444 585-10-1961
PATRICIA ANN JAMES
1330 LAKEHURST DRIVE
ADA, OK 74820

JA450 458-98-3918
ROBERT L. JAMES III
50 TNT LANE
HEBER SPRINGS, AR 72543

JO122 453-80-4034
ALAN JOCHIMSEN
4209 CARDINAL LANE
MIDLAND, TX 79707

JO386 444-58-6481
LENORE MARGARET JOHNSON
1146 ROBINHOOD LN
NORMAN, OK 73072

KE136 148-28-3818
TAMMY W & THOMAS E KEARNS
74 GRAVEY POND LANE
SOUTHERN SHORES, NC 27949

KI415 448-52-5972
KATHLEEN SUE KING
7702 HEATHER RIDGE COURT
IRVING, TX 75063

KI560 74-6000089
COMPTROLLER OF PUBLIC ACCOU
UNCLAIMED PROPERTY
P.O. BOX 12019
AUSTIN, TX 78711

KO165 451-12-9421
FRANCIS & MILDRED KOEHLER
404 N 21ST STREET
LAMESA, TX 79331

COUNTY Eddy

FOOL Malaga - Morrow Gas

80920

TOWNSHIP 24 South

RANGE 28 East

NMPM

Description: $\frac{W}{2}$ Sec 2 (R-4821, 8-1-74)Ext: $\frac{W}{2}$ Sec 11 (R-5334, 12-1-76) Ext: $\frac{W}{2}$ Sec 14, $\frac{S}{2}$ Sec 15 (R-5754, 7-1-78)Ext: $\frac{N}{2}$ Sec 15 (R-6499, 11-1-80) Ext: $\frac{S}{2}$ Sec 10, $\frac{N}{2}$ Sec 23 (R-6698, 6-2-84)Ext: All Sec. 22 (R-7419, 12-21-83) Ext: $\frac{E}{2}$ Sec. 11, $\frac{S}{2}$ Sec 12 (R-7875, 4-16-85)Ext: $\frac{E}{2}$ Sec. 21 (R-12288, 2-23-05) Ext: $\frac{W}{2}$ Sec. 21 (R-12548, 5-8-86)