

MAIN OFFICE OCC

1955 AUG 15 AM 8:31

# El Paso Natural Gas Company

El Paso, Texas  
August 11, 1955

NSL-16  
Unrecorded

DIRECT REPLY TO:  
P. O. BOX 997  
FARMINGTON, NEW MEXICO

Mr. W. B. Macey, Secretary and Director  
Oil Conservation Commission  
Box 871  
Santa Fe, New Mexico

Dear Mr. Macey:

This is to request the approval of an unorthodox location in the South Blanco-Pictured Cliff Field, San Juan County, New Mexico.

This well, the Schwerdtfeger #2-A is to be located 800 feet from the North line and 2200 feet from the East line of Section 21, T27N, R8W, N.M.P.M. A high mesa covers the NE/4 of Section 21 making an orthodox location impossible.

This acreage is offset by Frank A. Schultz, by Western Natural Gas Company, by Great Lakes Oil and Chemical Company, and by El Paso Natural Gas Company. Approval from all the offset operators has been obtained.

I am enclosing two copies of the certified well location plats sketching terrain conditions, well survey plat showing offset acreage, letters of approval from Frank A. Schultz, Western Natural Gas Company and Great Lakes Oil and Chemical Company and two copies of our Intention to Drill.

Thank you for your consideration of this matter.

Very truly yours,

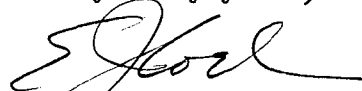

E. J. Coel  
Senior Petroleum Engineer

EJC:ajh

Enc.

cc: Emery Arnold  
P. T. McGrath

# El Paso Natural Gas Company

El Paso, Texas

July 27, 1955

DIRECT REPLY TO:  
P. O. BOX 897  
FARMINGTON, NEW MEXICO

Great Lakes Oil and Chemical Company  
502 Michigan National Bank Building  
Grand Rapids, Michigan

Dear Sir:

El Paso Natural Gas Company intends to drill the Schwerdtfeger #2-A in the NE/4 of Sec. 21, T27N, R8W, N.M.P.M., San Juan County, New Mexico, thru the Pictured Cliff formation.

This well will be located 800' from the North line and 2200' from the East line of Section 21. The well is offset by acreage operated by you as shown on the accompanying acreage plats. A high very steep mesa located in the NE/4 would make an access road to an orthodox location impractical.

The Oil Conservation Commission of New Mexico requires that all unorthodox locations receive the approval of the offset operator. We therefore request your approval of this unorthodox location in the space provided below.

I am enclosing a well survey plat sketching terrain conditions, a plat showing well location and position of offset acreage and an extra copy of this letter for your files.

If this meets with your approval please keep a copy of this letter and the plats and return the other copies signed to me.

Thank you for your consideration of this matter.

Yours very truly,  
El Paso Natural Gas Company



E. J. Coel  
Senior Petroleum Engineer

EJC:ajh

Approved:

GREAT LAKES OIL & CHEMICAL COMPANY

  
Charles, S. Hale, President

RECEIVED

AUG 4 1955

GREAT LAKES OIL & CHEMICAL CO.  
LOS ANGELES

COPY

# El Paso Natural Gas Company

El Paso, Texas

July 27, 1955

DIRECT REPLY TO:  
P. O. BOX 997  
FARMINGTON, NEW MEXICO

Western Natural Gas Company  
1006 Main Street  
Houston, Texas

Attention: Mr. Paul Wright

Dear Sir:

El Paso Natural Gas Company intends to drill the Schwerdtfeger #2-A in the NE/4 of Sec. 21, T27N, R8W, N.M.P.M., San Juan County, New Mexico, thru the Pictured Cliff formation.

This well will be located 300' from the North line and 2200' from the East line of Section 21. The well is offset by acreage operated by you as shown on the accompanying acreage plats. A high very steep mesa located in the NE/4 would make an access road to an orthodox location impractical.

The Oil Conservation Commission of New Mexico requires that all unorthodox locations receive the approval of the offset operator. We therefore request your approval of this unorthodox location in the space provided below.

I am enclosing a well survey plat sketching terrain conditions, a plat showing well location and position of offset acreage and an extra copy of this letter for your files.

If this meets with your approval please keep a copy of this letter and the plats and return the other copies signed to me.

Thank you for your consideration of this matter.

Yours very truly,  
El Paso Natural Gas Company

*E. J. Coel*  
E. J. Coel  
Senior Petroleum Engineer

EJC:ajh

Approved:

*Western Natural Gas Co*  
*Paul C. Wright*

COPY

# El Paso Natural Gas Company

El Paso, Texas  
July 27, 1955

DIRECT REPLY TO:  
P. O. BOX 897  
FARMINGTON, NEW MEXICO

Mr. Frank A. Schultz  
c/o Delhi-Taylor Oil Corporation  
Corrigan Tower  
St. Paul and Pacific  
Dallas, Texas

Dear Sir:

El Paso Natural Gas Company intends to drill the Schwerdtfeger #2-A in the NE/4 of Sec. 21, T27N, R8W, N.M.P.M., San Juan County, New Mexico, thru the Pictured Cliff formation.

This well will be located 800' from the North line and 2200' from the East line of Section 21. The well is offset by acreage operated by you as shown on the accompanying acreage plats. A high very steep mesa located in the NE/4 would make an access road to an orthodox location impractical.

The Oil Conservation Commission of New Mexico requires that all unorthodox locations receive the approval of the offset operator. We therefore request your approval of this unorthodox location in the space provided below.

I am enclosing a well survey plat sketching terrain conditions, a plat showing well location and position of offset acreage and an extra copy of this letter for your files.

If this meets with your approval please keep a copy of this letter and the plats and return the other copies signed to me.

Thank you for your consideration of this matter.

Yours very truly,  
El Paso Natural Gas Company

  
E. J. Coel  
Senior Petroleum Engineer

EJC:ajh

Approved:

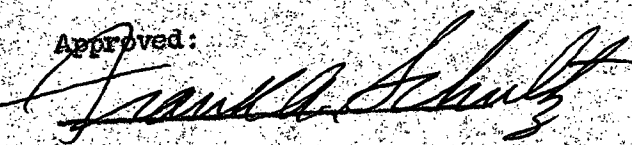
  
\_\_\_\_\_

COPY

COMPANY EL PASO NATURAL GAS COMPANY

Well Name & No. SCHWERTFEGER NO. 2-A

Lease No. SF 079319

Location 800 FEET FROM THE NORTH LINE, 2200 FEET FROM THE EAST LINE

Being in NW/4 OF THE NE/4

Sec. 21, T 27N., R 8 W., N.M.P.M.,

SAN JUAN COUNTY, NEW MEXICO

Ground Elevation 6306<sup>1</sup>/<sub>2</sub>

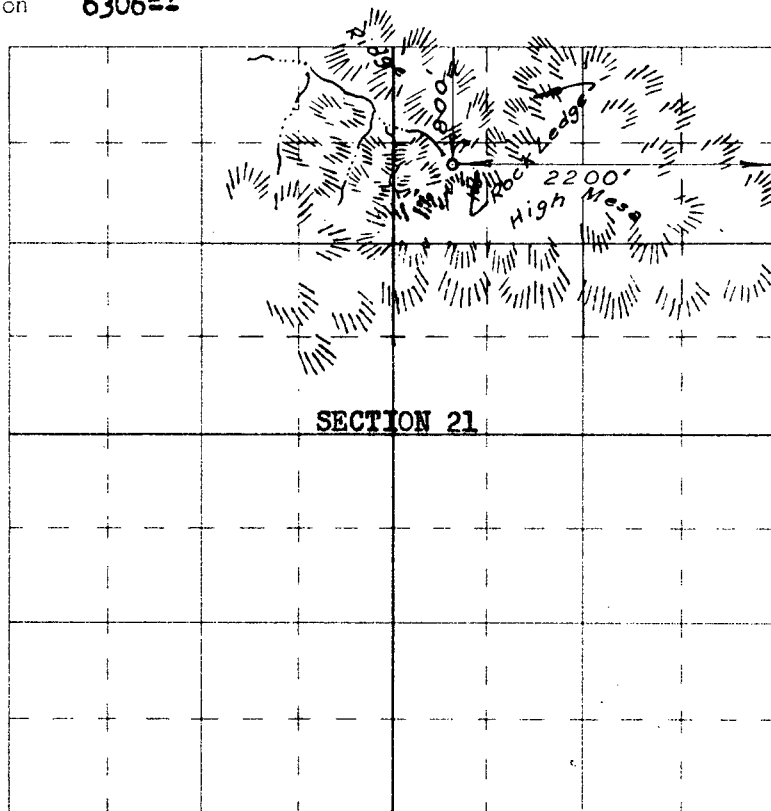

Scale -- 4 inches equals 1 mile

Surveyed JULY 22, 19 55

This is to certify that the above plat was prepared from field notes of actual surveys made by me or under my supervision and that the same are true and correct to the best of my knowledge and belief.

Seal:

*E. O. Walker*  
Registered Professional  
Engineer and Land Surveyor.

Farmington, New Mexico

160 ACRES, NE/4 SECTION (PLAT)

PLAT SHOWING LOCATION OF OFFSET ACREAGE OF  
 EPNG SCHWERTFEGER NO. 2-A  
 800 FEET FROM THE NORTH LINE, 2200 FEET  
 FROM THE EAST LINE, SECTION 21, T27N, R8W  
 N.M.P.M., SAN JUAN COUNTY, NEW MEXICO.

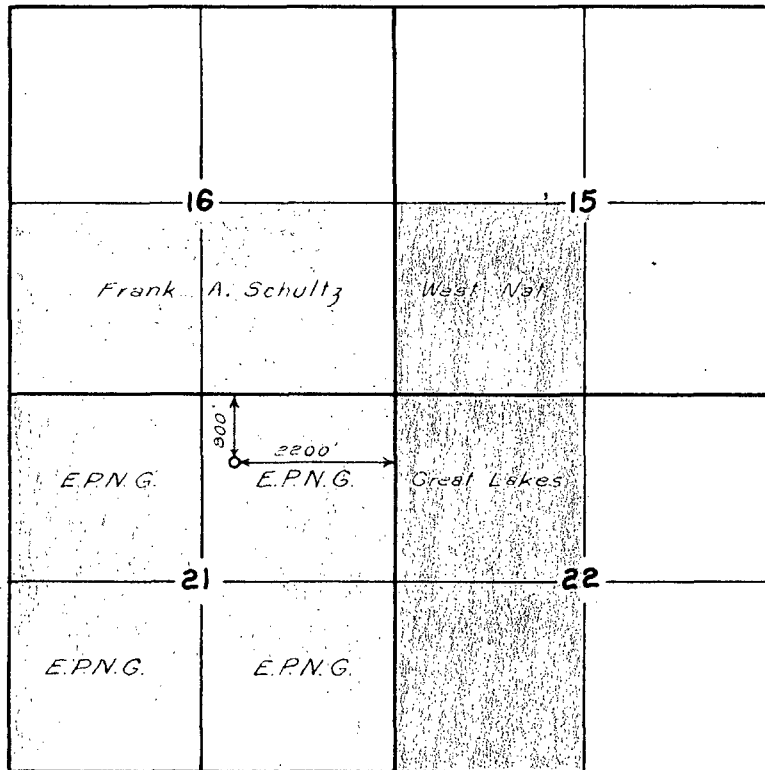

Form 9-331a  
(Feb. 1951)

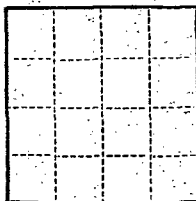

(SUBMIT IN TRIPLICATE)

UNITED STATES  
DEPARTMENT OF THE INTERIOR  
GEOLOGICAL SURVEY

Land Office Santa Fe  
Lease No. 079319  
Unit Schwerdtfeger

## SUNDRY NOTICES AND REPORTS ON WELLS

NOTICE OF INTENTION TO DRILL.....	<input checked="" type="checkbox"/>	SUBSEQUENT REPORT OF WATER SHUT-OFF.....	
NOTICE OF INTENTION TO CHANGE PLANS.....		SUBSEQUENT REPORT OF SHOOTING OR ACIDIZING.....	
NOTICE OF INTENTION TO TEST WATER SHUT-OFF.....		SUBSEQUENT REPORT OF ALTERING CASING.....	
NOTICE OF INTENTION TO RE-DRILL OR REPAIR WELL.....		SUBSEQUENT REPORT OF RE-DRILLING OR REPAIR.....	
NOTICE OF INTENTION TO SHOOT OR ACIDIZE.....		SUBSEQUENT REPORT OF ABANDONMENT.....	
NOTICE OF INTENTION TO PULL OR ALTER CASING.....		SUPPLEMENTARY WELL HISTORY.....	
NOTICE OF INTENTION TO ABANDON WELL.....			

(INDICATE ABOVE BY CHECK MARK NATURE OF REPORT, NOTICE, OR OTHER DATA)

August 11, 1955

Well No. 2-A is located 600 ft. from [N] line and 2200 ft. from [E] line of sec. 21

NE Section 21  
(¼ Sec. and Sec. No.)

27N  
(Twp.)

3N  
(Range)

R4W  
(Meridian)

So. Blaine P. Co.  
(Field)

Santa Fe  
(County or Subdivision)

New Mexico  
(State or Territory)

The elevation of the derrick floor above sea level is 636 ft.

### DETAILS OF WORK

(State names of and expected depths to objective sands; show sizes, weights, and lengths of proposed casings; indicate mudding jobs, cementing points, and all other important proposed work)

It is intended to drill a well thru the Pictured Cliff formation using rotary tools to the casing point and to drill the pay section with cable tools and to sandoil fracture the entire pay section. T.S. 2400'.

#### Casing Program:

9 5/8" at 120' with 125 sacks regular cement circulated to surface.

5 1/2" at 2430' with 75 sacks regular cement, 75 sacks Pozmix.

The NE/4 of Section 21 is dedicated to this well.  
(NE/4) SF 079319.

I understand that this plan of work must receive approval in writing by the Geological Survey before operations may be commenced.

Company El Paso Natural Gas Company

Address Box 917  
Peru, New Mexico

By Original Signed D. L. Ellsworth  
Title Petroleum Engineer