

MAIN OFFICE OCC

BLACKWOOD & NICHOLS COMPANY

Box 1237

DURANGO, COLORADO

1956 JUN 20 PM 1:31

June 15, 1956

New Mexico Oil Conservation Commission
P. O. Box 871
Sante Fe, New Mexico

Attention: Mr. W. B. Macey

Dear Mr. Macey:

As operator of the Northeast Blanco Unit, we request permission to drill an unorthodox well, to be located 1720' from the North line and 1940' from the East line of Section 36, T 31 N, R 8 W, San Juan County, New Mexico.

The difficult topography prevents a normal well location for this well and it is, therefore, necessary to select a more suitable location for a drilling site.

Section 36, T 31 N, R 8 W, is a part of the Northeast Blanco Unit and the new location, as requested, will present no drainage problem to offset operations.

We enclose a location plat for the requested new location.

Very truly yours,

BLACKWOOD & NICHOLS COMPANY



DeLasso Loos
Field Superintendent

DL: bc
Encl: 1

CC: Blackwood & Nichols Company
Oklahoma City, Oklahoma

NEW MEXICO
OIL CONSERVATION COMMISSION

Form C-128

40-36
MAIN OFFICE OCC Well Location and/or Gas Proration Plat

Date June 15, 1956

Operator Blackwood and Nichols Company

Lease Northeast Blanco Unit

Well No. 40-36 Section 36 Township 31 North Range 8 West NMPM

Located 1720 Feet From North Line, 1940 Feet From East Line,

San Juan County, New Mexico. G. L. Elevation 6445

Name of Producing Formation Mesaverde Pool Blanco Mesaverde Dedicated Acreage _____

(Note: All distances must be from outer boundaries of Section)

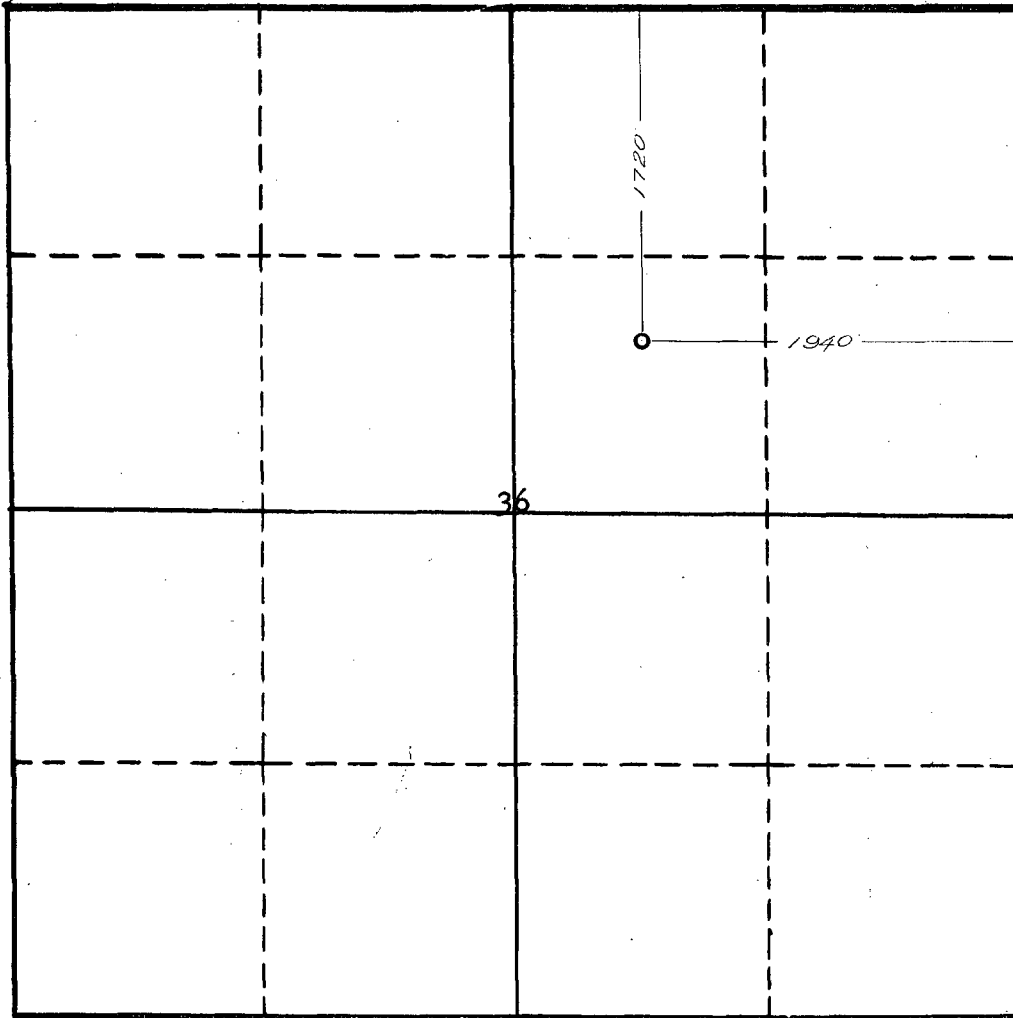

NOTE

This section of form is to be used for gas wells only.

SCALE: 1" = 1000'

1. Is this Well a Dual Comp.? Yes No.
2. If the answer to Question 1 is yes, are there any other dually completed wells within the dedicated acreage? Yes No.

Name Delasso Loos DELASSO LOOS

Position Field Superintendent

Representing Blackwood & Nichols Company

Address P. O. Box 1237, Durango, Colorado

This is to certify that the above plat was prepared from field notes of actual surveys made by me or under my supervision and that the same are true and correct to the best of my knowledge and belief.

Date Surveyed February 27, 1956

Ernest V. Cook
Registered Professional Engineer and/or Land Surveyor