

El Paso Natural Gas Company

1956 JUN 23 AM 8:10 El Paso, Texas  
June 25, 1956

NSL-52  
Recd 6/28/56

DIRECT REPLY TO:  
P. O. BOX 997  
FARMINGTON, NEW MEXICO

Mr. A. L. Porter, Secretary & Director  
Oil Conservation Commission  
Box 871  
Santa Fe, New Mexico

Dear Mr. Porter:

This is to request administrative approval of an unorthodox location to be located in the West Kutz Pictured Cliffs Pool, San Juan County, New Mexico.

This well our Huerfano Unit, Well No. 65 is to be located 1185' from the West line and 1975' from the North line of Section 5, Township 26 North, Range 10 West, N.M.P.M., San Juan County, New Mexico. The southwestern portion of this 1/4 Section consists of the edge of a mesa with the remaining portion of the 1/4 Section consisting of ridges and dry washes which would make the cost of roads and location extremely expensive.

This well is to be a Pictured Cliffs test in the Huerfano Unit and since the offsets are in the Huerfano Unit, which El Paso Natural Gas Company is the operator, the approval of other operators has not been sought.

I am enclosing two copies of the Certified Well Location Plat sketching terrain conditions and two copies of our Intention to Drill.

Thank you for your attention in this matter.

Yours very truly,

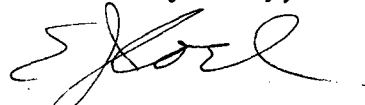

E. J. Coel  
Senior Petroleum Engineer

EJC:ajh

Enc.

cc: R. L. Hamblin  
Emery Arnold  
P. T. McGrath

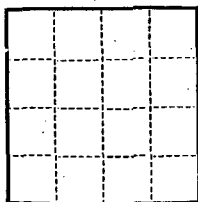
Form 9-331a  
(Feb. 1951)

(SUBMIT IN TRIPLICATE)

UNITED STATES  
DEPARTMENT OF THE INTERIOR  
GEOLOGICAL SURVEY

Land Office Santa Fe  
Lease No. 080895  
Unit Huerfano Unit  
I-Sec. 731

## SUNDRY NOTICES AND REPORTS ON WELLS

NOTICE OF INTENTION TO DRILL	<input checked="" type="checkbox"/>	SUBSEQUENT REPORT OF WATER SHUT-OFF	
NOTICE OF INTENTION TO CHANGE PLANS		SUBSEQUENT REPORT OF SHOOTING OR ACIDIZING	
NOTICE OF INTENTION TO TEST WATER SHUT-OFF		SUBSEQUENT REPORT OF ALTERING CASING	
NOTICE OF INTENTION TO RE-DRILL OR REPAIR WELL		SUBSEQUENT REPORT OF RE-DRILLING OR REPAIR	
NOTICE OF INTENTION TO SHOOT OR ACIDIZE		SUBSEQUENT REPORT OF ABANDONMENT	
NOTICE OF INTENTION TO PULL OR ALTER CASING		SUPPLEMENTARY WELL HISTORY	
NOTICE OF INTENTION TO ABANDON WELL			

(INDICATE ABOVE BY CHECK MARK NATURE OF REPORT, NOTICE, OR OTHER DATA)

June 25, 1956

Well No. 65 is located 1975 ft. from N line and 1185 ft. from W line of sec. 5

NW Section 5 26N 10W NMPM  
(¼ Sec. and Sec. No.) (Twp.) (Range) (Meridian)  
W. Kutz P.C. San Juan New Mexico  
(Field) (County or Subdivision) (State or Territory)

The elevation of the derrick floor above sea level is 6625 ft.

## DETAILS OF WORK

(State names of and expected depths to objective sands; show sizes, weights, and lengths of proposed casings; indicate mudding jobs, cementing points, and all other important proposed work)

It is intended to drill a well thru the Pictured Cliff formation using rotary tools and to perforate and water fracture possible producing zones. Estimated total Depth 2240'.

## Casing Program:

9 5/8" at 120' with 125 sacks regular cement circulated to surface.  
5 1/2" at 2240' with 75 sacks regular cement 75 sacks Pozmix.

The NW/4 of Section 5 is dedicated to this well.  
NW/4, SF 080895.

I understand that this plan of work must receive approval in writing by the Geological Survey before operations may be commenced.

Company El Paso Natural Gas CompanyAddress Box 997Farmington, New MexicoBy Original Signed EWELL N. WALSHTitle Petroleum Engineer

NEW MEXICO  
OIL CONSERVATION COMMISSION

Form C-128

4440

WELL LOCATION AND/OR GAS PRORATION PLAT

DATE JUNE 19, 1956

OPERATOR EL PASO NATURAL GAS COMPANY LEASE HUERFANO UNIT SF 080895

WELL NO. 65 SECTION 5 T. 26-N RANGE 10-W NMPM

LOCATED 1975 FEET FROM NORTH 1185 FEET FROM WEST LINE

SAN JUAN

COUNTY, NEW MEXICO

OIL ELEVATION

6615

NAME OF PRODUCING FORMATION PICTURED CLIFF FOOT W. KUTZ DEDICATED ACREAGE 160 ACRES  
(1933 PLAT)

Note: All distances must be from outer boundaries of section.

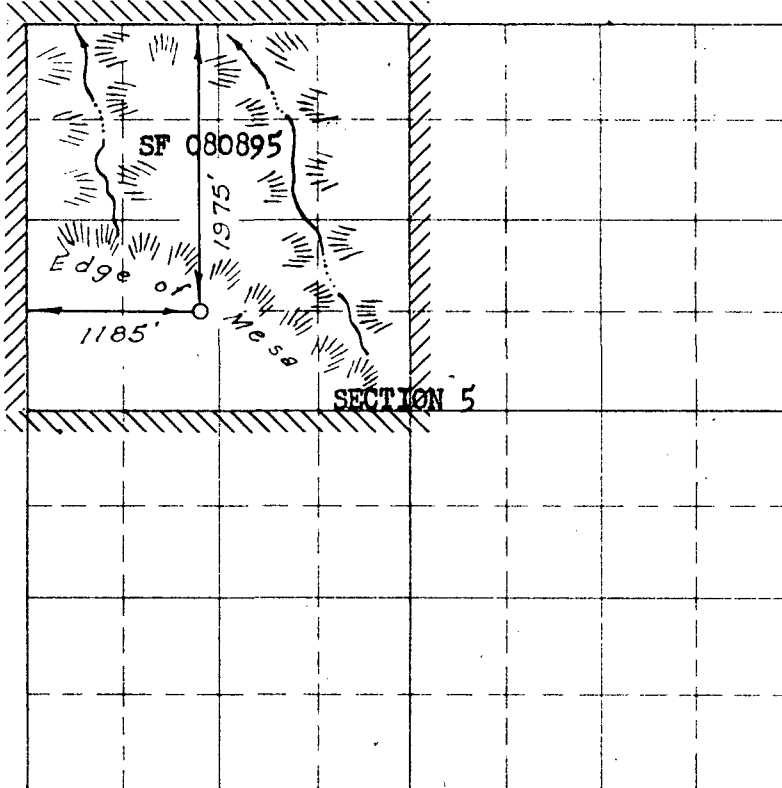

Scale 4 inches equal 1 mile

NOTE

This section of  
form is to be used  
for gas wells only

This is to certify that the above plat was prepared from  
field notes of actual surveys made by me or under my  
supervision and that the same are true and correct to the  
best of my knowledge and belief.

Date Surveyed JUNE 18, 1956

E. O. Walker  
Registered Professional Engineer and/or Land Surveyor

1. Is this well a Dual Comp.

Yes \_\_\_\_\_ No X

2. If the answer to Question 1

is yes, are there any other dually  
completed wells within the  
dedicated acreage.

Yes \_\_\_\_\_ No \_\_\_\_\_

Original Signed EWELL N. WALSH  
Name

Position Petroleum Engineer

Representing El Paso Natural Gas Co.

Address Box 997, Farmington, N.M.

(Send)

Farmington, New Mexico