

NSL-54
El Paso Natural Gas Company

1956 JUL 5 AM 8:23
El Paso, Texas
July 5, 1956

Dec 7/10/56

DIRECT REPLY TO:
P. O. BOX 897
FARMINGTON, NEW MEXICO

Exc. to Rule 3 R-565C
by Rule 4

Mr. A. L. Porter, Secretary & Director
Oil Conservation Commission
Box 871
Santa Fe, New Mexico

Dear Mr. Porter:

This is to request administrative approval of an unorthodox location to be located in the South Blanco Extension Pictured Cliffs Pool, San Juan County, New Mexico.

This well, out Schwerdtfeger No. 7-A is to be located 680' from the South line and 852' from the East line of Section 31, Township 28 North, Range 8 West, N.M.P.M., San Juan County, New Mexico. The southeastern portion of this 1/4 section consists of the edge of a mesa with the remaining portion of the 1/4 section consisting of a high mesa bench and ridges with dry washes which would make the cost of roads and location extremely expensive.

The well is to be a Pictured Cliffs test and since El Paso Natural Gas Company holds the lease in the NE/4 of Section 6, Township 27 North, Range 8 West the approval of other operators has not been sought.

I am enclosing two copies of the Certified Well Location . Plat sketching terrain conditions and two copies of our Intention to Drill.

Thank you for your attention to this matter.

Sincerely yours,

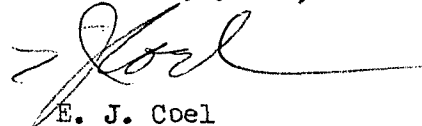

E. J. Coel
Senior Petroleum Engineer

EJC:ajh
cc: R. L. Hamblin
Phil McGrath
Emery Arnold

(SUBMIT IN TRIPLICATE)
UNITED STATES
DEPARTMENT OF THE INTERIOR
GEOLOGICAL SURVEY

Land Office

079319

Lease No.

Schwerdtfeger

Unit

SUNDRY NOTICES AND REPORTS ON WELLS

NOTICE OF INTENTION TO DRILL
NOTICE OF INTENTION TO CHANGE PLANS
NOTICE OF INTENTION TO TEST WATER SHUT-OFF
NOTICE OF INTENTION TO RE-DRILL OR REPAIR WELL
NOTICE OF INTENTION TO SHOOT OR ACIDIZE
NOTICE OF INTENTION TO PULL OR ALTER CASING
NOTICE OF INTENTION TO ABANDON WELL

SUBSEQUENT REPORT OF WATER SHUT-OFF
SUBSEQUENT REPORT OF SHOOTING OR ACIDIZING
SUBSEQUENT REPORT OF ALTERING CASING
SUBSEQUENT REPORT OF RE-DRILLING OR REPAIR
SUBSEQUENT REPORT OF ABANDONMENT
SUPPLEMENTARY WELL HISTORY

(INDICATE ABOVE BY CHECK MARK NATURE OF REPORT, NOTICE, OR OTHER DATA)

July 5,

1956

Well No. 7-A is located 690 ft. from S line and 652 ft. from E line of sec. 31
33 1/4 (Range)
235 (Twp.)
23 1/4 (County or Subdivision)
23 1/4 (Meridian)
New Mexico (State or Territory)

33 1/4 Section 31
(1/4 Sec. and Sec. No.)

So. Elmore P.C. Extension
(Field)

The elevation of the derrick floor above sea level is 6722 ft.

DETAILS OF WORK

(State names of and expected depths to objective sands; show sizes, weights, and lengths of proposed casings; indicate mudding jobs, cementing points, and all other important proposed work)

It is intended to drill a well thru the Pictured Cliff formation using rotary tools and to perforate and water fracture possible producing zones. Estimated total depth 2970'.

Casing Program:

9 5/8" at 120' with 125 sacks regular cement circulated to surface.
5 1/2" at 2970' with 75 sacks regular cement, 75 sacks Pozmix.

The 33 1/4 of Section 31 is dedicated to this well.
33 1/4 Section 31 of 079319.

I understand that this plan of work must receive approval in writing by the Geological Survey before operations may be commenced.

Company

El Paso Natural Gas Company

Address

Box 957
Paradise, New Mexico

By

ORIGINAL SIGNED F. W. BO

Title

Petroleum Engineer

NEW MEXICO
OIL CONSERVATION COMMISSION

Form C-128

WELL LOCATION AND/OR GAS PRORATION PLAT

DATE JULY 2, 1956

OPERATOR EL PASO NATURAL GAS COMPANY LEASE SCHWERTFEGER "A" SF 079319

WELL NO. 7 SECTION 31 TOWNSHIP 28-N RANGE 8-W NMPM

LOCATED 680 FEET FROM SOUTH LINE 852 FEET FROM EAST LINE

SAN JUAN COUNTY, NEW MEXICO G.L. ELEVATION 6712

NAME OF PRODUCING FORMATION SO. BLANCO POOL EXTENSION DEDICATED ACREAGE 144² ACRES
(1916 PLAT)

Note: All distances must be from outer boundaries of section.

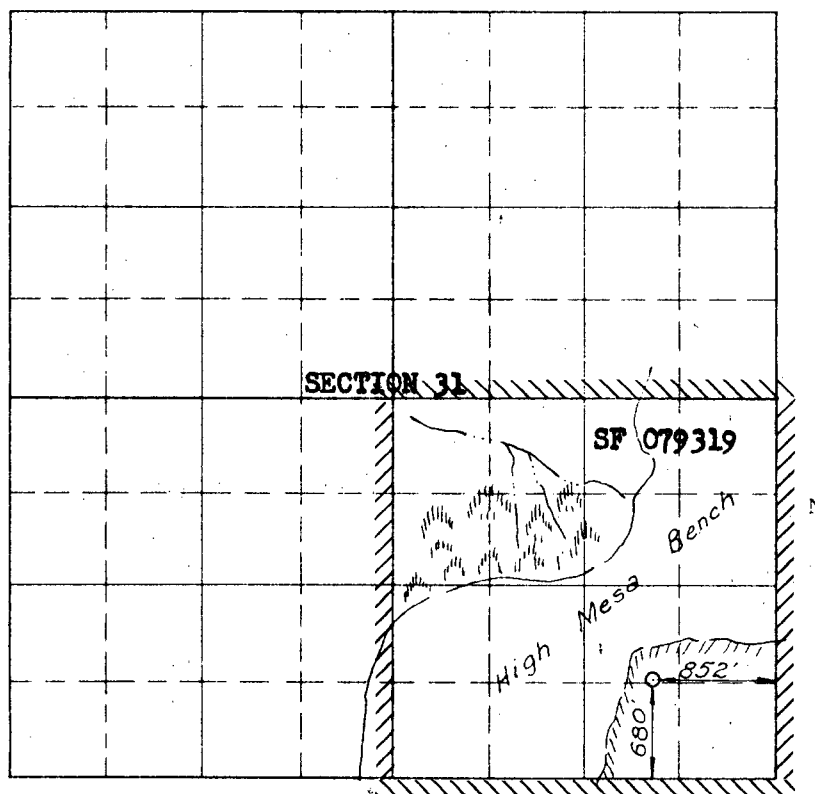

Scale 4 inches equal 1 mile

NOTE

This section of
form is to be used
for gas wells only

This is to certify that the above plat was prepared from
field notes of actual surveys made by me or under my
supervision and that the same are true and correct to the
best of my knowledge and belief.

Date Surveyed JUNE 25, 1956

E. O. Walker
Registered Professional Engineer and/or Land Surveyor

1. Is this well a Dual Comp.
Yes _____ No X
2. If the answer to Question 1
is yes, are there any other dually
completed wells within the
dedicated acreage.
Yes _____ No _____

Name ORIGINAL SIGNED F. W. BOYD
Position Petroleum Engineer

Representing El Paso Natural Gas Co.

Address Box 997, Farmington, N.M.

(Seal)

Farmington, New Mexico