

PACIFIC NORTHWEST PIPELINE CORPORATION

MAIN OFFICE Broadway

~~413 1/2 West Main~~

FARMINGTON, NEW MEXICO

1956 SEP 21 AM 8:12
September 19, 1956

NSL-69

10/10/56

Mr. A. L. Porter
New Mexico Oil Conservation Commission
Santa Fe, New Mexico

Dear Mr. Porter:

Pacific Northwest Pipeline Corporation requests administrative approval to take exception to Rule 104, and drill Indian "P" #1, an unorthodox location, located 1386 FNL, and 1236 FEL, Sec. 16, T27N, R3W, Rio Arriba County, New Mexico.

We are requesting this unorthodox location because of the severe topography in this area.

Respectfully submitted,

T. A. Dugan
T. A. Dugan

Enc. 1
TAD:ihr
cc: P. T. McGrath
L. G. Truby
Emery Arnold
W. R. Johnston

NEW MEXICO
OIL CONSERVATION COMMISSION

Form C-128

Well Location and/or Gas Proration Plat

Operator Pacific Northwest Pipeline Corporation Lease Indian "P" Date _____
Well No. Indian, "P" #1 Section 16 Township 27 North Range 3 West NMPM
Located 1386 Feet From North Line, 1236 Feet From East Line,

Rio Arriba

County, New Mexico.

G. L. Elevation 7078, UNGRADED

Name of Producing Formation MV Pool Blanco MV Dedicated Acreage PC
Underlying PC

(Note: All distances must be from outer boundaries of Section)

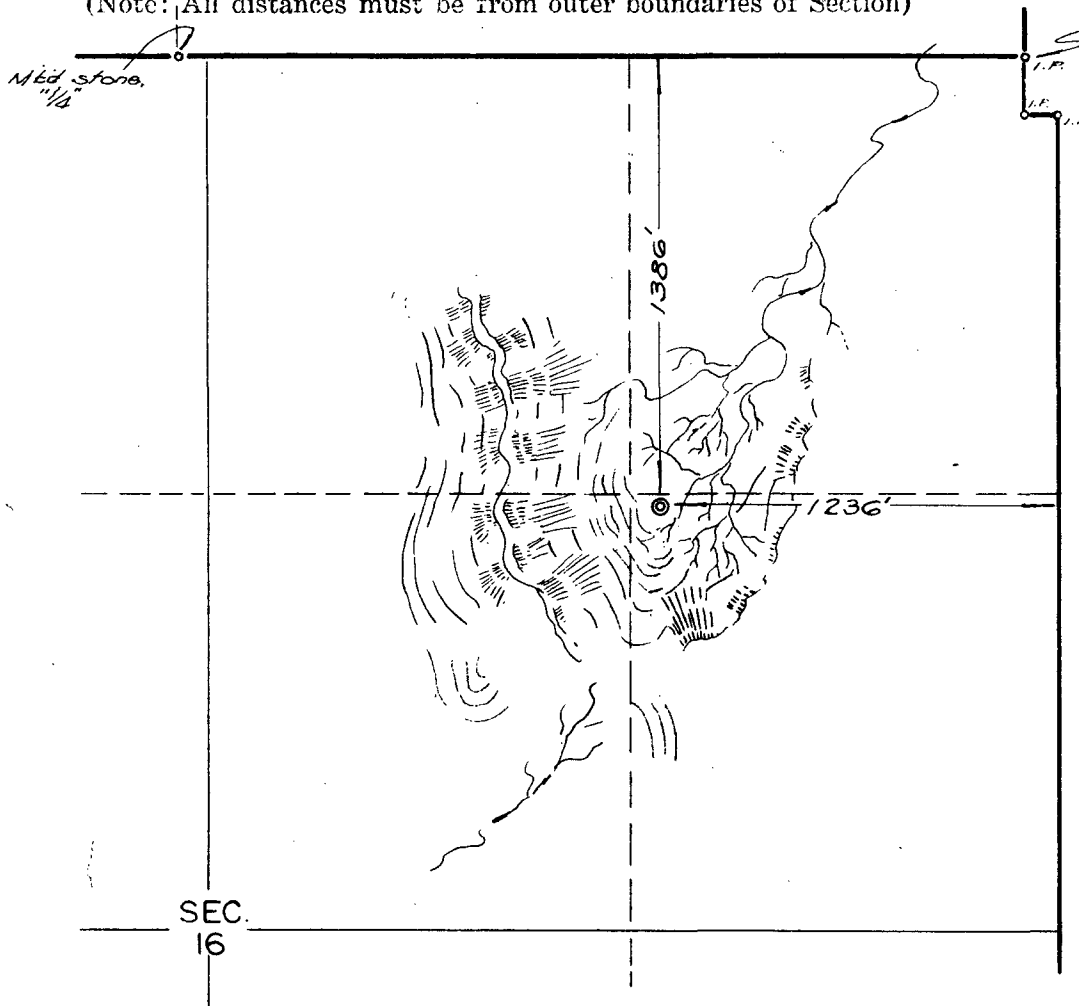

NOTE

This section of form is to be used for gas wells only.

SCALE: 1" = ~~1000~~ 600'

1. Is this Well a Dual Comp. ? Yes___ No___.
2. If the answer to Question 1 is yes, are there any other dually completed wells within the dedicated acreage?
Yes___ No___.

Name _____

Position _____

Representing _____

Address _____

This is to certify that the above plat was prepared from field notes of actual surveys made by me or under my supervision and that the same are true and correct to the best of my knowledge and belief.

Date Surveyed September 17, 1956

Ernest V. Echhawk

Ernest V. Echhawk
Reg. Land Surveyor, N. Mex., Reg. No. 1545