

1141  
OFFICE 000  
EL PASO NATURAL GAS PRODUCTS COMPANY

POST OFFICE BOX 1161, EL PASO, TEXAS

8:12  
February 3, 1958

ADDRESS REPLY TO:  
POST OFFICE BOX 1565  
FARMINGTON, NEW MEXICO

copy  
OK  
2-5

NSL  
waiver 132

Mr. A. L. Porter  
Secretary & Director  
Oil Conservation Commission  
Post Office Box 871  
Santa Fe, New Mexico

Dear Mr. Porter:

This is a request for Administrative Approval of an Unorthodox Location in the Horseshoe Canyon-Gallup Pool. This location, our Horseshoe Canyon No. 9, is located 2310' from the North line and 1640' from the West line, Section 3, Township 30-N, Range 16-W, NMPM, San Juan County, New Mexico. This well is to be drilled through the Gallup Formation and then all possible producing zones will be perforated and sandoil fractured.

This location is on a rock ledge on a steep slope of the side of a canyon. It would be extremely hard and expensive to make an Orthodox Location and your approval of this request would be greatly appreciated. Since El Paso Natural Gas Products Company owns the Lease in the SW NW/4 of Section 3, the approval of offset operators has not been sought. Attached you will find two copies each of the Intention to Drill, Well Location and Acreage Dedication Plat. } topographical

Very truly yours,

Ewell N. Walsh

Ewell N. Walsh  
Division Petroleum Engineer

ENW:EW  
Enc. - 4

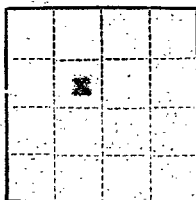

(SUBMIT IN TRIPLICATE)

UNITED STATES  
DEPARTMENT OF THE INTERIOR  
GEOLOGICAL SURVEY

Land Office **SP**  
Lease No. **079439**  
Unit **Horseshoe Canyon**

## SUNDRY NOTICES AND REPORTS ON WELLS

NOTICE OF INTENTION TO DRILL.....	<input checked="" type="checkbox"/>	SUBSEQUENT REPORT OF WATER SHUT-OFF.....	
NOTICE OF INTENTION TO CHANGE PLANS.....		SUBSEQUENT REPORT OF SHOOTING OR ACIDIZING.....	
NOTICE OF INTENTION TO TEST WATER SHUT-OFF.....		SUBSEQUENT REPORT OF ALTERING CASING.....	
NOTICE OF INTENTION TO RE-DRILL OR REPAIR WELL.....		SUBSEQUENT REPORT OF RE-DRILLING OR REPAIR.....	
NOTICE OF INTENTION TO SHOOT OR ACIDIZE.....		SUBSEQUENT REPORT OF ABANDONMENT.....	
NOTICE OF INTENTION TO PULL OR ALTER CASING.....		SUPPLEMENTARY WELL HISTORY.....	
NOTICE OF INTENTION TO ABANDON WELL.....			

(INDICATE ABOVE BY CHECK MARK NATURE OF REPORT, NOTICE, OR OTHER DATA)

February 3, 19 58

Well No. **9** is located **2310** ft. from **[N]** line and **1640** ft. from **[E]** line of sec. **3**  
**SE NW/4 Sec. 3** **30-N** **16-W** **NMPM**  
 (1/4 Sec. and Sec. No.) (Twp.) (Range) (Meridian)  
**Horseshoe Canyon** **San Juan** **New Mexico**  
 (Field) (County or Subdivision) (State or Territory)

The elevation of the derrick floor above sea level is **8570** ft.

## DETAILS OF WORK

(State names of and expected depths to objective sands; show sizes, weights, and lengths of proposed casings; indicate mudding jobs, cementing points, and all other important proposed work)

It is intended to drill a well using rotary tools and mud circulation through the Canyon Formation. Production casing will be set and possible productive intervals will be perforated and fractured.

Estimated Total Depth 1600'.

## Casing Program:

8-5/8" at 100' with 125 sacks cement circulated to surface.

5-1/2" at 1600' with 100 sacks cement.

The SE NW/4 of Section 3 is dedicated to this well.

SE NW/4 Section 3 SF 079439

I understand that this plan of work must receive approval in writing by the Geological Survey before operations may be commenced.

Company **El Paso Natural Gas Products Company**

Address **Post Office Box 1565**  
**Farmington, New Mexico**

ORIGINAL SIGNED BY: JOSEPH E. KREGER

By \_\_\_\_\_

Title **Petroleum Engineer**

NEW MEXICO OIL CONSERVATION COMMISSION

Well Location and Acreage Dedication Plat

Section A.

Date February 3, 1958

Operator El Paso Natural Gas Products Company Lease Horseshoe Canyon SF-079439  
Well No. 9 Unit Letter F Section 3 Township 30 North Range 16 West NMPM  
Located 2310 Feet From North Line, 1640 Feet From West Line  
County San Juan G. L. Elevation 5560 Dedicated Acreage 40 Acres  
Name of Producing Formation Gallup Pool Horseshoe-Gallup

1. Is the Operator the only owner\* in the dedicated acreage outlined on the plat below?  
Yes x No
2. If the answer to question one is "no," have the interests of all the owners been consolidated by communitization agreement or otherwise? Yes        No       . If answer is "yes,"  
Type of Consolidation
3. If the answer to question two is "no," list all the owners and their respective interests below:

Owner

Land Description

Section. B

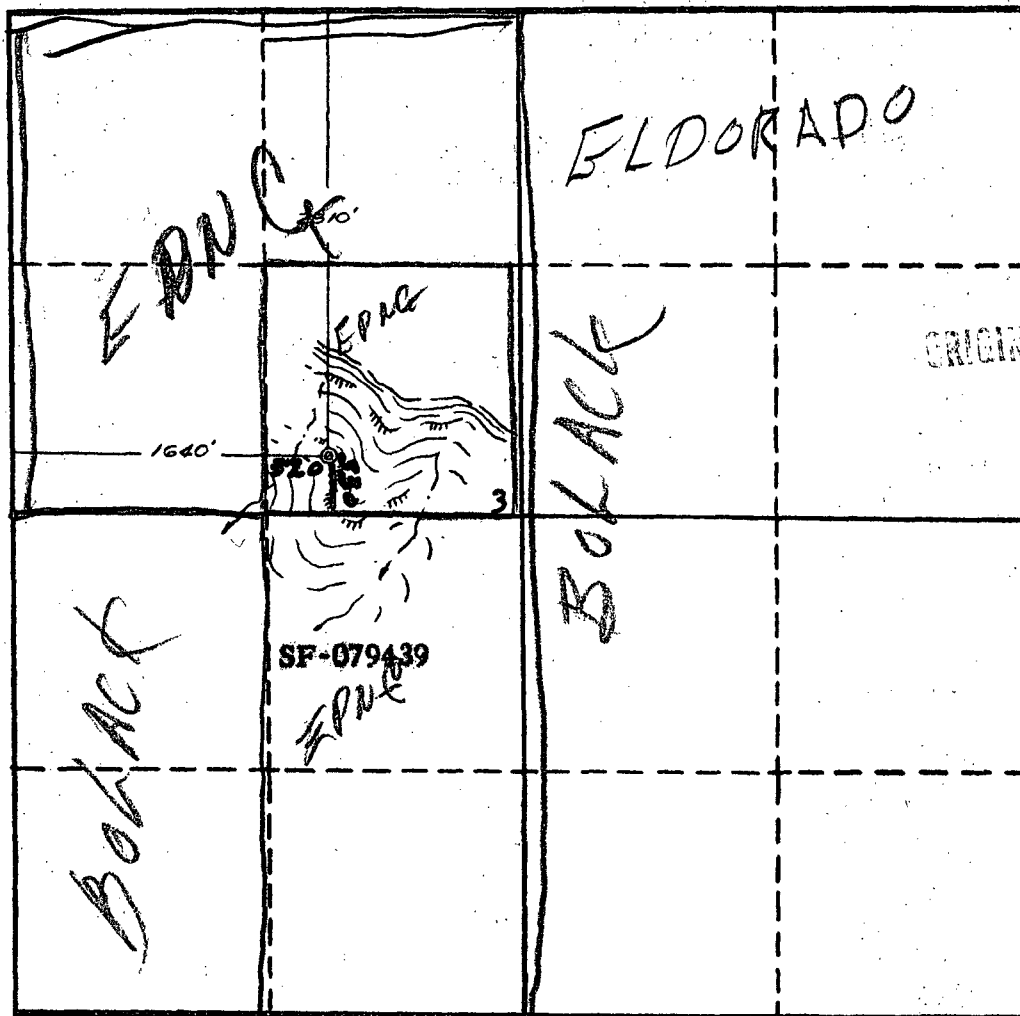

This is to certify that the information in Section A above is true and complete to the best of my knowledge and belief.

El Paso Natural Gas Products Co.  
(Operator)  
ORIGINAL SIGNED BY: J. SEPH E. KREGER  
(Representative)

Box 1565, Farmington, New Mexico  
Address

This is to certify that the well location shown on the plat in Section B was plotted from field notes or actual surveys made by me or under my supervision and that the same is true and correct to the best of my knowledge and belief.

Date Surveyed Jan. 28, 1958

Ernest V. Echohawk  
Registered Land Surveyor.

Certificate No. 1545



PLAT SHOWING UNORTHODOX LOCATION OF THE  
EL PASO NATURAL GAS PRODUCTS COMPANY  
HORSESHOE CANYON WELL NO. 9  
SE NW/4 SECTION 3, TOWNSHIP 30 NORTH, RANGE 16 WEST

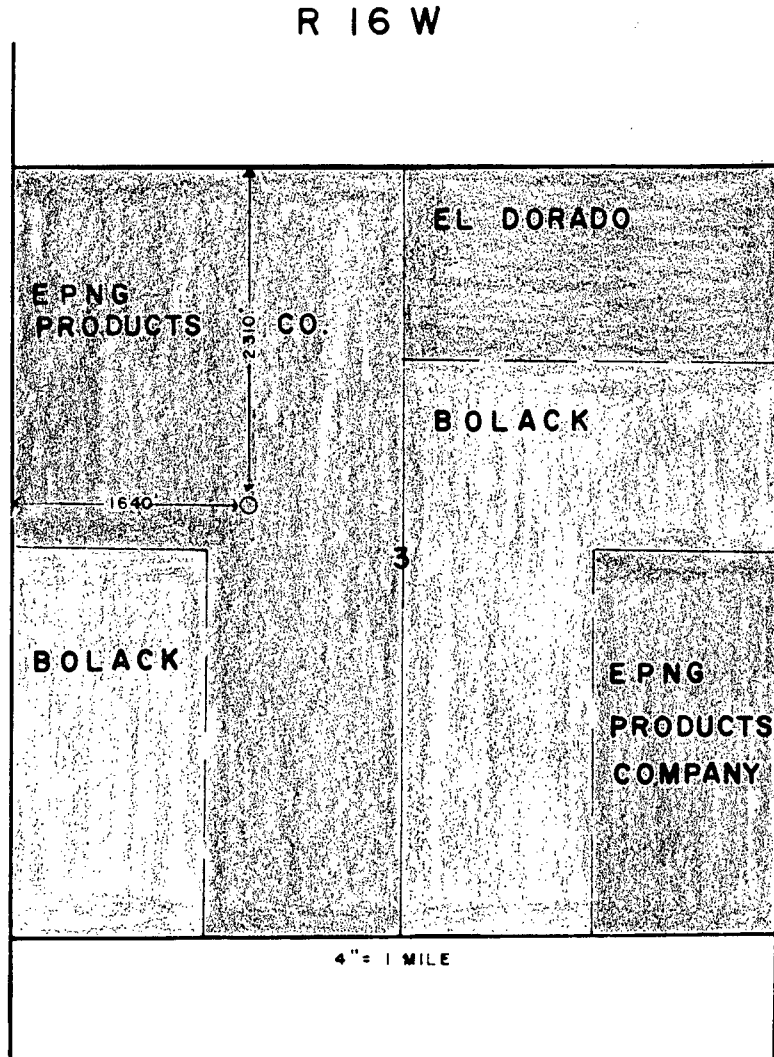

T  
30  
N