

DATE IN 12/5/06	SUSPENSE 12/25/06	ENGINEER CATHACH	LOGGED IN 12/8/06	TYPE NSL	APP NO. p TD50634232471
-----------------	-------------------	------------------	-------------------	----------	-------------------------

ABOVE THIS LINE FOR DIVISION USE ONLY

NEW MEXICO OIL CONSERVATION DIVISION

- Engineering Bureau -

1220 South St. Francis Drive, Santa Fe, NM 87505

2006 DEC 5 AM 10 07



ADMINISTRATIVE APPLICATION CHECKLIST

THIS CHECKLIST IS MANDATORY FOR ALL ADMINISTRATIVE APPLICATIONS FOR EXCEPTIONS TO DIVISION RULES AND REGULATIONS WHICH REQUIRE PROCESSING AT THE DIVISION LEVEL IN SANTA FE

Application Acronyms:

[NSL-Non-Standard Location] [NSP-Non-Standard Proration Unit] [SD-Simultaneous Dedication]
[DHC-Downhole Commingling] [CTB-Lease Commingling] [PLC-Pool/Lease Commingling]
[PC-Pool Commingling] [OLS - Off-Lease Storage] [OLM-Off-Lease Measurement]
[WFX-Waterflood Expansion] [PMX-Pressure Maintenance Expansion]
[SWD-Salt Water Disposal] [IPI-Injection Pressure Increase]
[EOR-Qualified Enhanced Oil Recovery Certification] [PPR-Positive Production Response]

[1] TYPE OF APPLICATION - Check Those Which Apply for [A]

[A] Location - Spacing Unit - Simultaneous Dedication
☒ NSL ☐ NSP ☐ SD

Check One Only for [B] or [C]

[B] Commingling - Storage - Measurement
☐ DHC ☐ CTB ☐ PLC ☐ PC ☐ OLS ☐ OLM

[C] Injection - Disposal - Pressure Increase - Enhanced Oil Recovery
☐ WFX ☐ PMX ☐ SWD ☐ IPI ☐ EOR ☐ PPR

[D] Other: Specify _____

[2] NOTIFICATION REQUIRED TO: - Check Those Which Apply, or Does Not Apply

[A] ☒ Working, Royalty or Overriding Royalty Interest Owners
[B] ☐ Offset Operators, Leaseholders or Surface Owner
[C] ☐ Application is One Which Requires Published Legal Notice
[D] ☐ Notification and/or Concurrent Approval by BLM or SLO
U.S. Bureau of Land Management - Commissioner of Public Lands, State Land Office
[E] ☐ For all of the above, Proof of Notification or Publication is Attached, and/or,
[F] ☐ Waivers are Attached

[3] SUBMIT ACCURATE AND COMPLETE INFORMATION REQUIRED TO PROCESS THE TYPE OF APPLICATION INDICATED ABOVE.

[4] **CERTIFICATION:** I hereby certify that the information submitted with this application for administrative approval is **accurate** and **complete** to the best of my knowledge. I also understand that **no action** will be taken on this application until the required information and notifications are submitted to the Division.

Note: Statement must be completed by an individual with managerial and/or supervisory capacity.

Patsy Clugston

Print or Type Name

Patsy Clugston
Signature

Sr. Regulatory Specialist

Title

12/4/06

Date

clugspl@conocophillips.com

e-mail Address

BURLINGTON RESOURCES

San Juan Division

December 4, 2006

Sent Overnight UPS

New Mexico Oil Conservation Division
NSL Examiner
1220 South St. Francis Drive
Santa Fe, New Mexico 87505

Re: San Juan 29-7 Unit #62C
Unit G (SWNE), 1955' FNL & 2620' FEL
Section 14, T29N, R7W, Rio Arriba County, New Mexico
API # - 30-039-29991

Dear Sir:

This is a request for administrative approval for a non-standard gas well location in the Basin Dakota pool.

The proposed San Juan 29-7 Unit #62C was staked as a single Mesaverde formation (MV) well in 2005. The location was placed in a standard location for the MV which is located in the MV Participating Area. The well was placed at the base of the hill rather than on the top at the surface owner's request and to utilize existing infrastructure. To the surface owner it made it less visually intrusive at its current placement and would avoid surface disturbance on Romine Mesa.

After the acquisition of ConocoPhillips, it was decided that we would also add the Dakota interval. The Dakota is not in the Participating Area (PA) and the placement of the well is non-standard for the Dakota as per Order 10987-B (2). Consequently, this location was staked non-standard for the Basin Dakota formation, to best fit the terrain and the surface owner's request. See the attached topo and aerial map for further clarification.

Production from the Basin Dakota and Blanco Mesaverde is included in the 320 acre gas spacing unit on the E/2 of Section 14, T29N, R7W.

To comply with the New Mexico Oil Conservation Division rules, we are submitting the following for your approval of this non-standard location:

1. Approved APD cover page and C102 plat showing location of the well
2. 9 Section Plan showing wells in the area
3. Offset Operator Plat for Section 14.
4. Certification of Working Interest Owner notification (BP America and Williams)

There are no Dakota wells in the west half of section 14, therefore copies of this application are being sent to the working interest owners by certified mail. Please let me know if you have any questions about this application at 505-326-9518.

Sincerely,



Patsy Clugston
Sr. Regulatory Specialist

Re: San Juan 29-7 Unit #62C
Unit G (SWNE), 1955' FNL & 2620' FEL,
Section 14, T29N, R7W, Rio Arriba County, New Mexico
30-039-29991

I hereby certify that the following offset owners/operators have been notified by certified mail of our application for administrative approval for non-standard well location of the above well.



Patsy Clugston 12/4/06

BP America Production Company
Attn: Karen Clay - SJBU
West Lake 1 Rm 19.179
501 Westlake Park Blvd
Houston, TX 77079

Williams Production
One Williams Center
P.O. Box 3102 MD25-1
Tulsa, OK 74101

UNITED STATES
DEPARTMENT OF THE INTERIOR
BUREAU OF LAND MANAGEMENT

APPLICATION FOR PERMIT TO DRILL, DEEPEN, OR PLUG BACK

1a. Type of Work DRILL	5. Lease Number NMNM-05219 Unit Reporting Number MV-NMNM-078474	
1b. Type of Well GAS	6. If Indian, All. or Tribe	
2. Operator BURLINGTON RESOURCES Oil & Gas Company	7. Unit Agreement Name San Juan 29-7 Unit	
3. Address & Phone No. of Operator PO Box 4289, Farmington, NM 87499 (505) 326-9700	8. Farm or Lease Name San Juan 29-7 Unit 9. Well Number #62C	
4. Location of Well 1955' FNL, 2620' FEL Latitude 36° 44.2363'N, Longitude 107° 33.4092'W	10. Field, Pool, Wildcat Blanco Mesaverde, Basin Dakota 11. Sec., Twn, Rge, Mer. (NMPM) Sec. 14, T29N, R07W API # 30-045-039-29991	
14. Distance in Miles from Nearest Town 19 miles to Blanco, NM Post Office	12. County Rio Arriba	13. State NM
15. Distance from Proposed Location to Nearest Property or Lease Line 1955'	17. Acres Assigned to Well DK 320 E/2 MV 320 E/2	
16. Acres in Lease		
18. Distance from Proposed Location to Nearest Well, Drlg, Compl, or Applied for on this Lease 1171'		
19. Proposed Depth 7545'	20. Rotary or Cable Tools Rotary	
21. Elevations (DF, FT, GR, Etc.) 6253' GR	22. Approx. Date Work will Start	
23. Proposed Casing and Cementing Program See Operations Plan attached		
24. Authorized by: <u>[Signature]</u> Sr. Regulatory Specialist	Date <u>7/11/06</u>	

PERMIT NO. _____ APPROVAL DATE _____
APPROVED BY [Signature] TITLE AFM DATE 8/31/06

Archaeological Report attached

Threatened and Endangered Species Report attached

NOTE: This format is issued in lieu of U.S. BLM Form 3160-3

Title 18 U.S.C. Section 1001, makes it a crime for any person knowingly and willfully to make to any department or agency of the United States any false, fictitious or fraudulent statements or presentations as to any matter within its jurisdiction.

<all other values>

FRUITLAND COAL

PICTURED CLIFFS

MESAVERDE

DAKOTA

●

▲

★

⊗

⊕

N

▲

BURLINGTON

RESOURCES

PLAT

© Unpublished Work, Burlington Resources, Inc.

0

500

1,000

3,600

5,400

7,200

Feet

1:40,086

- 1" equals 3,340'

GCS North American 1927

BURLINGTON RESOURCES

San Juan

SAN JUAN 29-7 UNIT 62C - NSL

9 SECTION PLAT

NE SECTION 14, T29N, R7W

RIO ARriba COUNTY, NEW MEXICO

Prepared By: mti

Date: 11/29/2006

File Number: 11/29/2006

File Path: \\mti\Projects\SJ-29-7 UNIT 62C - NSL\SJ-29-7 UNIT 62C - NSL.dwg

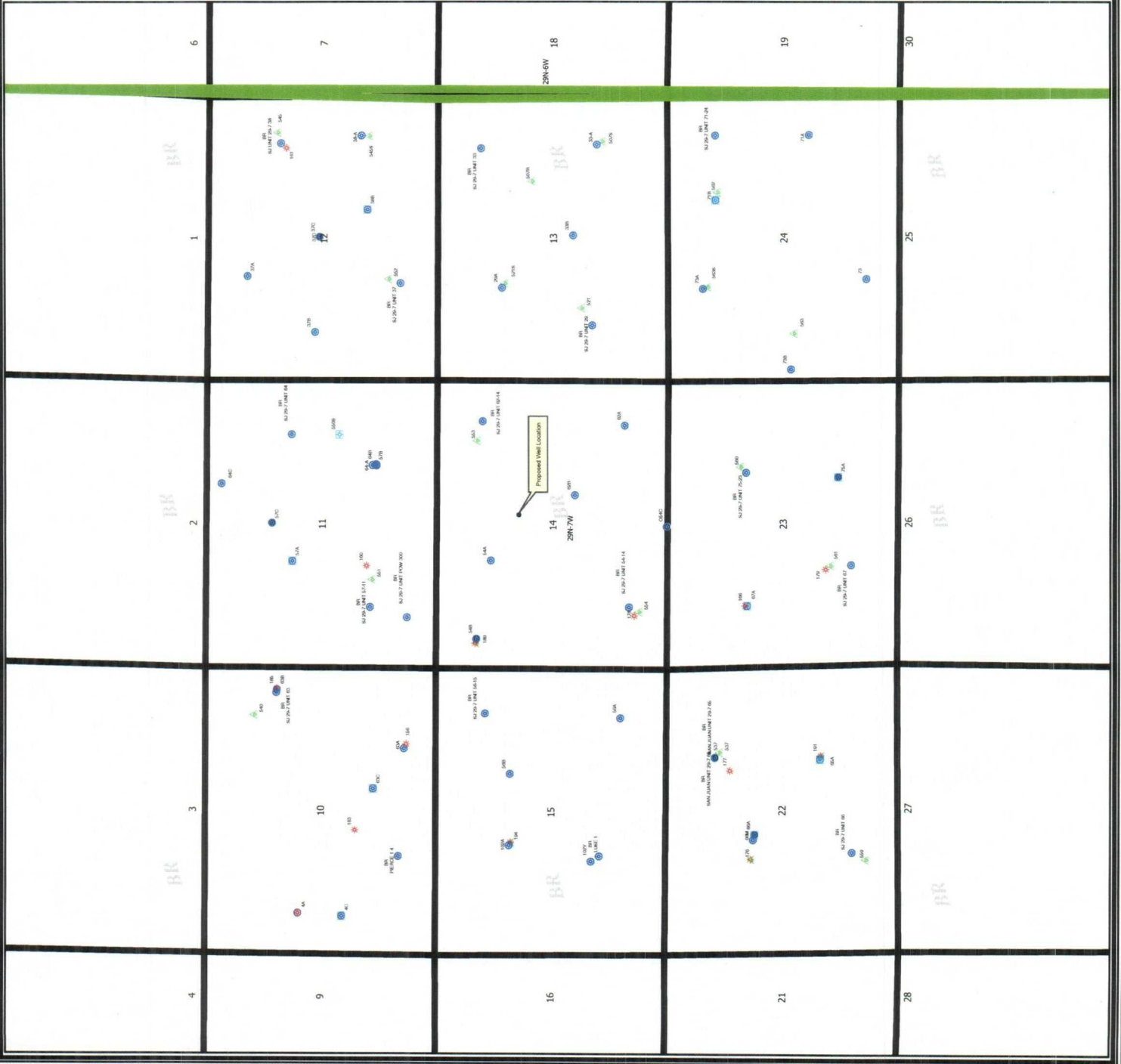

BR
SJ 29-7 UNIT POW 300



56-15

54B



189

54A



BR
SJ 29-7 UNIT 62-14

553



Proposed Well Location



14

29N-7W

62B



BR
SJ 29-7 UNIT 54-14

178



554



Q54C



62A



<all other values>
FRUITLAND COAL
PICTURED CLIFFS
MESAVEDE
DAKOTA



OFFSET WIO
BP America
Burlington Resources
Williams Production



**BURLINGTON
RESOURCES**

© Unpublished Work, Burlington Resources, Inc.



Feet

1:12,420 - 1" equals 1,035'

GCS North American 1927

BURLINGTON RESOURCES

San Juan

SAN JUAN 29-7 UNIT 62C - NSL

OFFSET OPERATOR PLAT
NE SECTION 14, T29N, R7W
RIO ARriba COUNTY, NEW MEXICO

Prepared By: mtt Date: 11/29/2006
File Number: 11/29/2006
File Name: mtt\Projects\SJ 29-7 UNIT 62C - NSL\SJ 29-7 UNIT 62C - NSL.dwg



- <all other values>
- ▲ FRUITLAND COAL
- ★ PICTURED CLIFFS
- ⊙ MESAVERDE
- ⊞ DAKOTA



**BURLINGTON
RESOURCES**

© Unpublished Work, Burlington Resources, Inc.



PLAT

N





0 262.5 525 1,050 1,575 2,100 Feet

1:11,562 - 1" equals 964'

GCS North American 1927

BURLINGTON RESOURCES
San Juan

SAN JUAN 29-7 UNIT 62C - NSL
 AERIAL PHOTOGRAPHY
 NE SECTION 14, T29N, R7W
 RIO ARriba COUNTY, NEW MEXICO

Prepared By: mtt	Date: 11/29/2006
File Number:	Revised Date: 11/29/2006

File Path: \\mtt\Projects\SJ 29-7 UNIT 62C - NSL\SJ 29-7 UNIT 62C - NSL.dwg

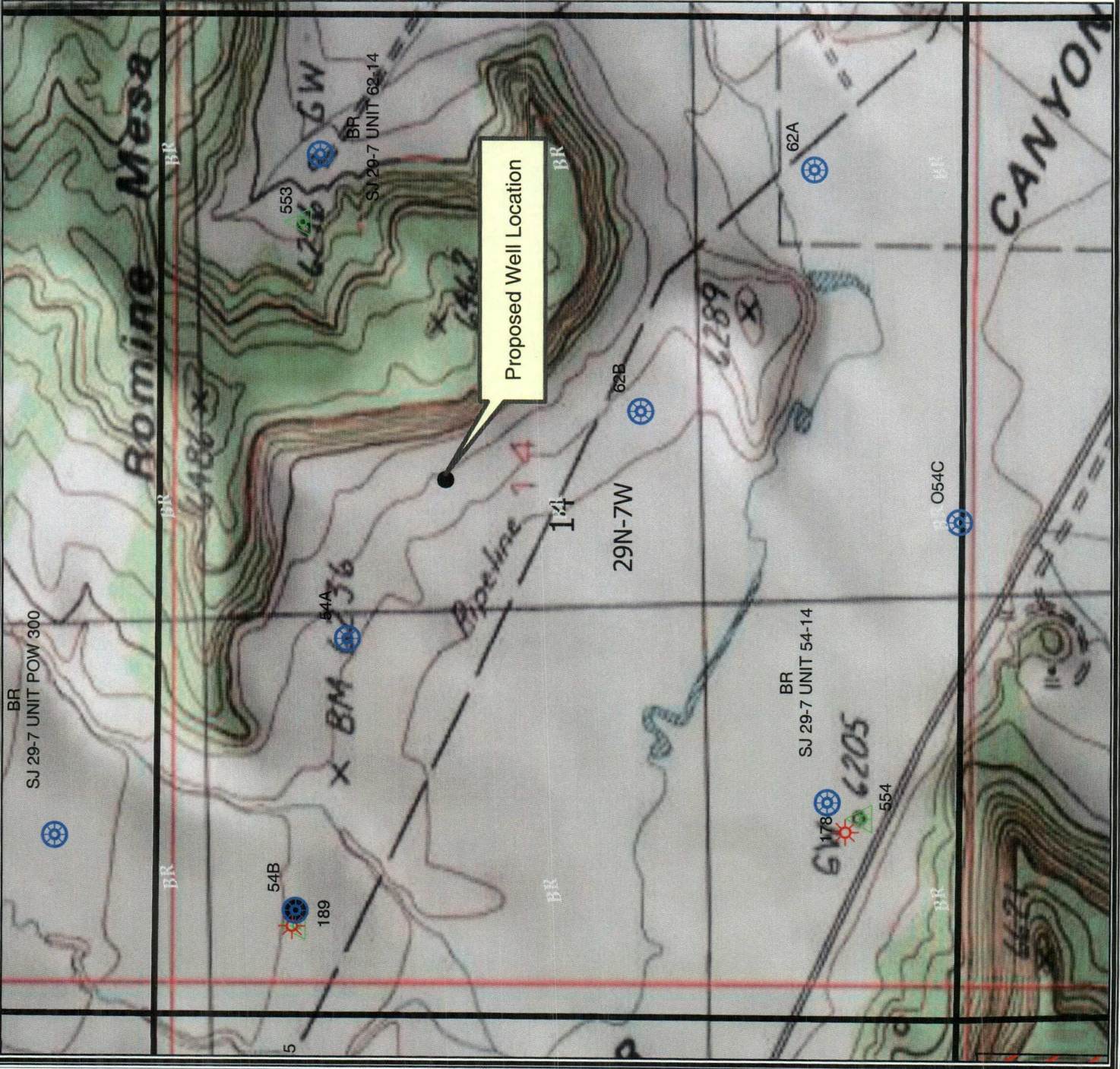

- <all other values>
- ▲ FRUITLAND COAL
- ✱ PICTURED CLIFFS
- ⊗ MESAVERDE
- ⊞ DAKOTA



**BURLINGTON
RESOURCES**

© Unpublished Work, Burlington Resources, Inc.



PLAT

N



0 262.5 525 1,050 1,575 2,100



Feet

1:11,562 - 1" equals 964'

GCS North American 1927

BURLINGTON RESOURCES	
San Juan	
SAN JUAN 29-7 UNIT 62C - NSL	
TOPO MAP	
NE SECTION 14, T29N, R7W	
RIO ARriba COUNTY, NEW MEXICO	
Prepared By: mit	Date: 11/29/2006
File Number: NSL/SJ 29-7 UNIT 62C - NSL	Revised Date: 11/29/2006

Catanach, David, EMNRD

From: Clugston, Patricia L [Patsy.L.Clugston@conocophillips.com]
Sent: Tuesday, January 09, 2007 7:10 AM
To: Catanach, David, EMNRD
Subject: RE: San Juan 29-7 Unit No. 62C

Thank you so much. Patsy

From: Catanach, David, EMNRD [mailto:david.catanach@state.nm.us]
Sent: Tuesday, January 09, 2007 6:39 AM
To: Clugston, Patricia L
Subject: RE: San Juan 29-7 Unit No. 62C

I'll get this out today.

DRC

From: Clugston, Patricia L [mailto:Patsy.L.Clugston@conocophillips.com]
Sent: Monday, January 08, 2007 4:32 PM
To: Catanach, David, EMNRD
Subject: RE: San Juan 29-7 Unit No. 62C

Hi David,

I sent the PA maps to you. Can you tell me the status of this NSL?

From: Catanach, David, EMNRD [mailto:david.catanach@state.nm.us]
Sent: Tuesday, January 02, 2007 9:23 AM
To: Clugston, Patricia L
Subject: RE: San Juan 29-7 Unit No. 62C

Patsy,

I haven't received anything yet.

DRC

From: Clugston, Patricia L [mailto:Patsy.L.Clugston@conocophillips.com]
Sent: Friday, December 29, 2006 12:26 PM
To: Catanach, David, EMNRD
Subject: RE: San Juan 29-7 Unit No. 62C

Did our land department send you electronic copies of our 29-7 PA maps, yet? If they didn't, please let me know and I will try to just make copies and then overnight them to you. I know with the holidays, I'm not sure who is in and not.

From: Catanach, David, EMNRD [mailto:david.catanach@state.nm.us]

1/9/2007

Sent: Tuesday, December 19, 2006 9:25 AM

To: Clugston, Patricia L

Subject: San Juan 29-7 Unit No. 62C

Hi Patty,

I am currently reviewing your application for a non-standard Dakota well location for the San Juan 29-7 Unit No. 62C. Could you please send me a map that shows the Mesaverde and Dakota PA for this unit?

Thanks,

David Catanach
Engineer

Confidentiality Notice: This e-mail, including all attachments is for the sole use of the intended recipient (s) and may contain confidential and privileged information. Any unauthorized review, use, disclosure or distribution is prohibited unless specifically provided under the New Mexico Inspection of Public Records Act. If you are not the intended recipient, please contact the sender and destroy all copies of this message. -- This email has been scanned by the Sybari - Antigen Email System.

1/2/07

Hi Dave,

Here is the copies of the PA for the 29-7 Unit for MV & DK. Let me know if you need anything else to approve the NSL for the SJ 29-7 #62C.

Thanks for your help.

Patsy Clugston
505-326-9518

A handwritten signature in cursive script, appearing to read "Patsy".

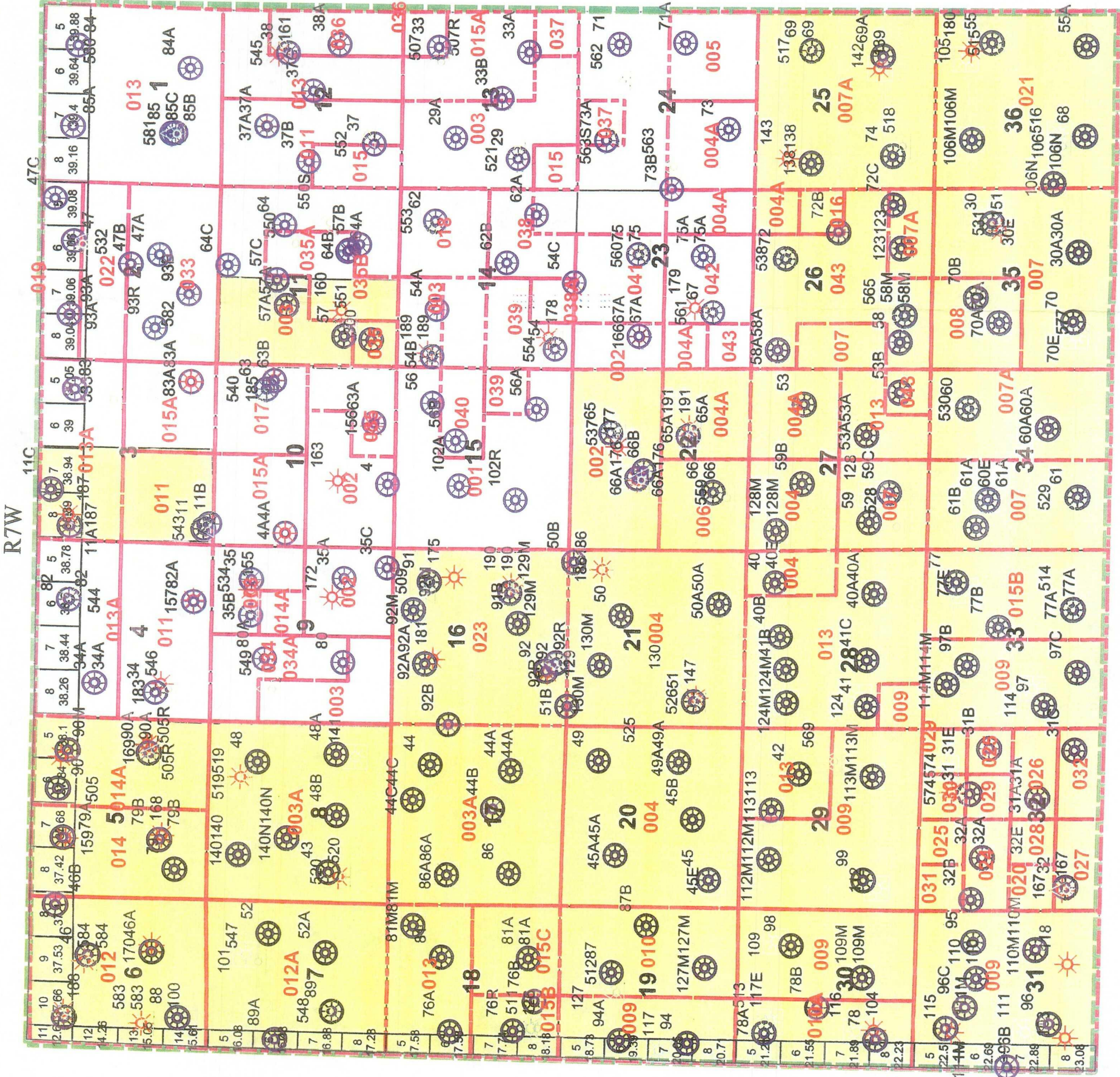

R7W

11C

47C

T 29 N

Well Formation

- FRUITLAND COAL
- PICTURED CLIFFS
- MESAVERDE
- DAKOTA

San Juan 29-7 Unit

Mesaverde PA

Expan. 13, Effective 10/1/1959

BURLINGTON
RESOURCES
Inventory Management
San Juan Division
Farmington, New Mexico
January 14, 2004

