

Log in, assign no. & do order

El Paso Natural Gas Company

El Paso, Texas

February 15, 1960

ADDRESS REPLY TO:
POST OFFICE BOX 997
FARMINGTON, NEW MEXICO

Mr. A. L. Porter, Secretary and Director
Oil Conservation Commission
Box 871
Santa Fe, New Mexico

Dear Mr. Porter:

This is a request for administrative approval for an unorthodox gas well location in the Blanco Mesa Verde Pool and Wildcat Dakota.

It is intended to locate the well, El Paso Natural Gas Co. San Juan 28-5 Unit No. 40 (MD), 1150 feet from the North line, and 2000 feet from the East line of Section 27, T-28-N, R-5-W, N.M.P.M., Rio Arriba County, New Mexico. The N/2 of Section 27 is dedicated to the well.

As shown on the enclosed plat, the NE/4 consists of steep slopes and high narrow ledges. The only accessible land for a well in the NE/4 is that which makes the location unorthodox. It is, therefore planned to make the location unorthodox in order that the extremely high cost of constructing an orthodox location be avoided.

Since El Paso Natural Gas Co. has control of the offset leases, approval for an unorthodox location has not been sought from other operators.

I am enclosing two copies of the certified well location plat and two copies of the intention to drill.

Yours very truly,

E. S. Oberly

E. S. Oberly,
Division Petroleum Engineer

ESO:MJJ:dgb

cc: Sam Smith
O.C.C. (Emery Arnold)
U.S.G.S. (Phil McGrath)

(SUBMIT IN TRIPLICATE)

Land Office Santa Fe
Lease No. 079520
Unit San Juan 28-5 Unit
14-03-001-949

UNITED STATES
DEPARTMENT OF THE INTERIOR
GEOLOGICAL SURVEY

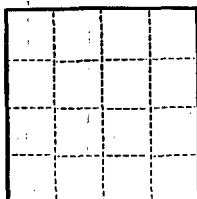

SUNDRY NOTICES AND REPORTS ON WELLS

NOTICE OF INTENTION TO DRILL.....	<input checked="" type="checkbox"/>	SUBSEQUENT REPORT OF WATER SHUT-OFF.....	
NOTICE OF INTENTION TO CHANGE PLANS.....		SUBSEQUENT REPORT OF SHOOTING OR ACIDIZING.....	
NOTICE OF INTENTION TO TEST WATER SHUT-OFF.....		SUBSEQUENT REPORT OF ALTERING CASING.....	
NOTICE OF INTENTION TO RE-DRILL OR REPAIR WELL.....		SUBSEQUENT REPORT OF RE-DRILLING OR REPAIR.....	
NOTICE OF INTENTION TO SHOOT OR ACIDIZE.....		SUBSEQUENT REPORT OF ABANDONMENT.....	
NOTICE OF INTENTION TO PULL OR ALTER CASING.....		SUPPLEMENTARY WELL HISTORY.....	
NOTICE OF INTENTION TO ABANDON WELL.....			

(INDICATE ABOVE BY CHECK MARK NATURE OF REPORT, NOTICE, OR OTHER DATA)

February 15, 19 60

Well No. 40(MD) is located 1150 ft. from [N] line and 2000 ft. from [E] line of sec. 27

NE/4 Sec. 27
(1/4 Sec. and Sec. No.)

26N
(Twp.)

5W
(Range)

N.M.P.M.
(Meridian)

Blanco M. V. & Wildcat Dak.
(Field)

Rio Arriba
(County or Subdivision)

New Mexico
(State or Territory)

The elevation of the derrick floor above sea level is 6929 ft.

DETAILS OF WORK

(State names of and expected depths to objective sands; show sizes, weights, and lengths of proposed casings; indicate mudding jobs, cementing points, and all other important proposed work)

It is intended to drill & dually complete a well in the Dakota formation & Mesa Verde formation. Mud circulation will be used thru the Pictured Cliffs & set intermediate casing. Gas circulation will be used thru the middle of the Greenhorn formation & 7" liner will be set. Mud circulation will be used thru the Dakota formation & production liner will be set. Possible productive intervals will be perforated & fractured. Est. T. D. 8350'.

Casing Program:

- 13 3/8" at 300' w/350 sks. cement circulated to surface.
- 9 5/8" at 3975' w/200 sks. cement circulated to surface.
- 7" at 7950' w/800 sks. cement.
- 5" at 8350' w/100 sks. cement.

The N/2 of Section 27 is dedicated to the Mesa Verde formation.
The S/2 of Section 27 is dedicated to the Dakota formation.

I understand that this plan of work must receive approval in writing by the Geological Survey before operations may be commenced.

Company El Paso Natural Gas Company

Address Box 997

Farmington, New Mexico

By Original Signed C. D. COX

Title Petroleum Engineer

NEW MEXICO OIL CONSERVATION COMMISSION

Well Location and Acreage Dedication Plat

Section A.

Date **FEBRUARY 11, 1960**

Operator **EL PASO NATURAL GAS COMPANY** Lease **SAN JUAN 28-5 UNIT** **SF-079520**
 Well No. **40 (MD)** Unit Letter **B** Section **27** Township **28 N** Range **5 W** NMPM
 Located **1150** Feet From **NORTH** Line, **2000** Feet From **EAST** Line
 County **RIO ARriba** G. L. Elevation **6919** Dedicated Acreage **320 & 320** Acres
 Name of Producing Formation **MESA VERDE & DAKOTA** Pool **BLANCO M. V. & WILDCAT DAKOTA**

1. Is the Operator the only owner in the dedicated acreage outlined on the plat below?
 Yes ☒ No ☐
2. If the answer to question one is "no", have the interests of all the owners been consolidated by communitization agreement or otherwise? Yes ☐ No ☐. If answer is "yes", Type of Consolidation.
3. If the answer to question two is "no", list all the owners and their respective interests below:

Owner

Land Description

Section B.

This is to certify that the information in Section A above is true and complete to the best of my knowledge and belief.

El Paso Natural Gas Company
 (Operator)

Original Signed C. D. COX
 (Representative)
 Box 997

(Address)

Farmington, New Mexico

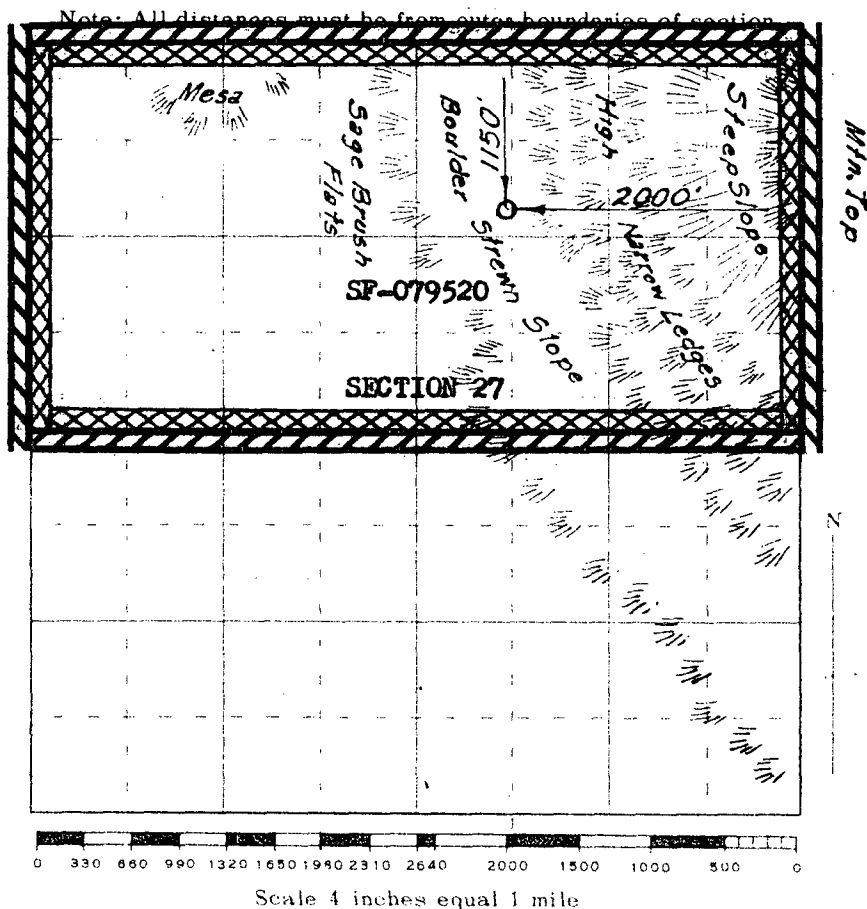

This is to certify that the above plat was prepared from field notes of actual surveys made by me or under my supervision and that the same are true and correct to the best of my knowledge and belief.

(Seal)

Date Surveyed **FEBRUARY 4, 1960**

Farmington, New Mexico

Paul C. Kilner
 Registered Professional Engineer and/or Land Surveyor