

login & type order

LA PLATA GATHERING SYSTEM, INC.

1940 MERCANTILE DALLAS BUILDING

DALLAS 1, TEXAS

May 12, 1960

NSL - 2/15
(Wanted)

Mr. A. L. Porter, Jr., Secretary
Oil Conservation Commission of the
State of New Mexico
Post Office Box 871
Santa Fe, New Mexico

Dear Mr. Porter:

Please find enclosed herewith Application of La Plata Gathering System, Inc., for an exception to Commission Rule Number 104(d)(2). We have attached to such Application, as Exhibit "C", consents executed by Frank A. Schultz, J. Glenn Turner, William G. Webb, and Benson-Montin-Greer Drilling Corp. It is our understanding that the only other affected offset operator, Pan American Petroleum Corporation, mailed its consent to such unorthodox location directly to you under date of May 10, 1960.

Thanking you in advance for your expeditious attention to this Application and with best wishes, I am

Yours very truly,

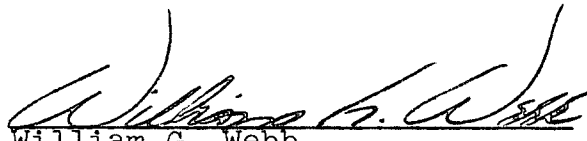
William G. Webb,
Vice President

WGW:mch

Enclosure

cc: Pan American Petroleum Corporation
Benson-Montin-Greer Drilling Corp.
Mr. Frank A. Schultz
Mr. C. Beeson Neal

BEFORE THE OIL CONSERVATION COMMISSION
OF THE STATE OF NEW MEXICO

IN THE MATTER OF THE APPLICATION OF
LA PLATA GATHERING SYSTEM, INC.,
FOR AN EXCEPTION TO RULE 104(d)(2)
FOR AN UNORTHODOX LOCATION FOR A
WELL TO BE DRILLED TO THE DAKOTA
FORMATION IN THE EAST HALF OF
SECTION 26, TOWNSHIP 32 NORTH,
RANGE 6 WEST, RIO ARriba COUNTY,
NEW MEXICO

CASE NUMBER _____

TO THE HONORABLE OIL CONSERVATION COMMISSION
OF THE STATE OF NEW MEXICO:

Comes now LA PLATA GATHERING SYSTEM, INC., as Unit Operator of the San Juan 32-5 Unit Area, and respectfully requests an exception to Rule 104(d)(2) for an unorthodox location for a well to be drilled to the Dakota Formation at a location six hundred and sixty feet (660') from the East line and eighteen hundred and fifty feet (1850') from the North line of Section 26, Township 32 North, Range 6 West, N.M.P.M., Rio Arriba County, New Mexico, and, for cause, would show as follows:

I

As the Commission may be advised, a substantial portion of the SE/4 of Section 26, Township 32 North, Range 6 West, lies below an elevation of sixty-one hundred feet (6100') and will be inundated or subject to inundation by the waters of the Navajo Dam on the San Juan River. Accordingly, in order to drill a well in the E/2 of said section, the same must be located in the NE/4 of said section. Due to topographic conditions in the NE/4 of said section, a location at least seven hundred and ninety feet (790') from the East line of said Section 26 would necessitate an

unconscionable expenditure of money in order to prepare the necessary location. A plat of the proposed location is attached hereto as Exhibit "A". A plat of the area showing the topographic conditions present is attached hereto as Exhibit "B".

II

Attached hereto as Exhibit "C" is a consent in writing from all owners of oil and gas leases lying within a radius of seven hundred and ninety feet (790') from the proposed location, said owners being J. Glenn Turner, Frank A. Schultz, William G. Webb, Benson-Montin-Greer Drilling Corp., and Pan American Petroleum Corporation.

Premises considered, the undersigned, as Operator of the San Juan 32-5 Unit Area, respectfully requests the Secretary of the Commission to grant an exception to the well location requirement of Rule 104(d)(2) without notice or hearing pursuant to the authority granted by the Commission's Rule 104(f).

Respectfully submitted,

LA PLATA GATHERING SYSTEM, INC.

By

Vice President

EXHIBIT "A"

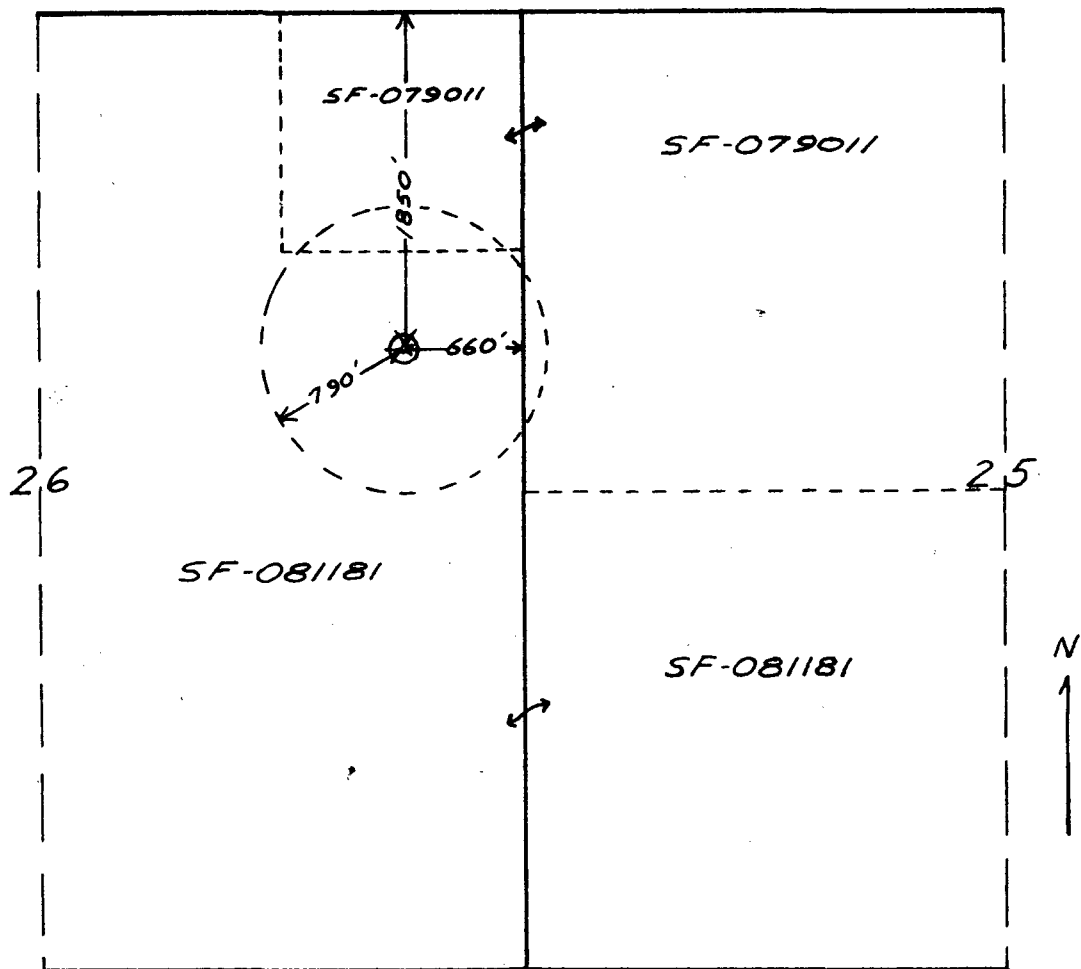

Scale: 5" = 1 mile

Location: Section 26, T32N, R6W

Rio Arriba County, New Mexico

NEW MEXICO OIL CONSERVATION COMMISSION

Well Location and Acreage Dedication Plat

Section A.

Date _____

Operator LA PLATA GATHERING SYSTEM Lease _____
 Well No. 2-26 Unit Letter H Section 26 Township 32 NORTH Range 6 WEST, NMPM
 Located 1850 Feet From the NORTH Line, 660 Feet From the EAST Line
 County RIO ARriba G. L. Elevation 6348.0 Dedicated Acreage _____ Acres
 Name of Producing Formation _____ Pool _____

1. Is the Operator the only owner in the dedicated acreage outlined on the plat below?
 Yes _____ No _____
2. If the answer to question one is "no", have the interests of all the owners been consolidated by communitization agreement or otherwise? Yes _____ No _____. If answer is "yes", Type of Consolidation.
3. If the answer to question two is "no", list all the owners and their respective interests below:

OwnerLand Description

Section B.

This is to certify that the information in Section A above is true and complete to the best of my knowledge and belief.

(Operator)

(Representative)

(Address)

Note: All distances must be from outer boundaries of section.

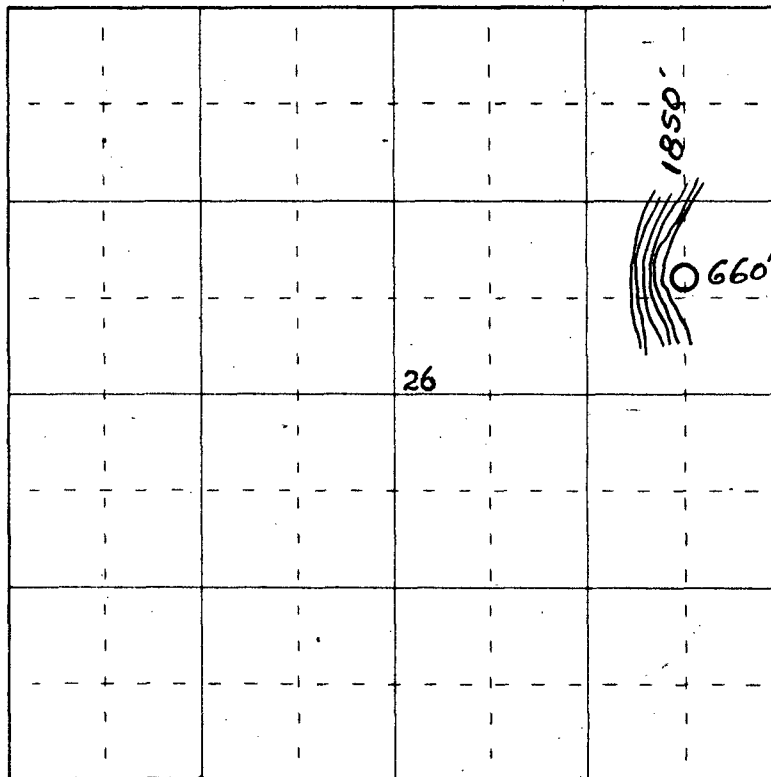

0 330 660 990 1320 1650 1980 2310 2640 2000 1500 1000 500 0

Scale 4 inches equal 1 mile

This is to certify that the above plat was prepared from field notes of actual surveys made by me or under my supervision and that the same are true and correct to the best of my knowledge and belief.

Date Surveyed 29 AUGUST 1959

James P. Leese
 Registered Professional Engineer and/or Land Surveyor
 James P. Leese N. Mex. Reg. No. 1463

Farmington, New Mexico

EXHIBIT "B"

April 28, 1960

Oil Conservation Commission
of the State of New Mexico
State Land Office
Post Office Box 871
Santa Fe, New Mexico

Gentlemen:

I have been furnished with a copy of La Plata Gathering System, Inc.'s application for an exception to Rule 104(d)(2) for an unorthodox location for a well to be drilled to the Dakota Formation at a location six hundred and sixty feet from the East line and eight hundred and fifty feet from the North line of Section 26, Township 32 North, Range 6 West, N.M.P.M., Rio Arriba County, New Mexico.

This letter will evidence the consent to such location by me as the owner of an interest in the oil and gas lease covering the W/2 of Section 25 and an interest in the oil and gas lease covering the E/2 of Section 26, Township 32 North, Range 6 West, notwithstanding the fact that same lies only six hundred and sixty feet from the East line of said section.

Yours very truly,



Frank A. Schultz

EXHIBIT "C"

April 28, 1960

Oil Conservation Commission
of the State of New Mexico
State Land Office
Post Office Box 871
Santa Fe, New Mexico

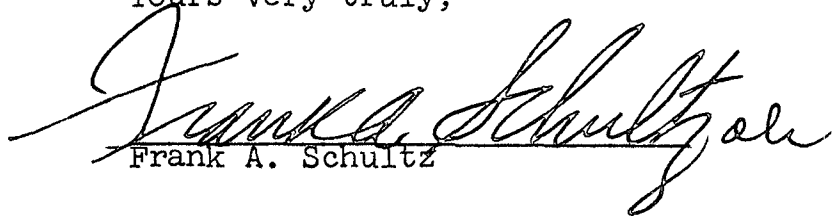
Gentlemen:

I have been furnished with a copy of La Plata Gathering System, Inc.'s application for an exception to Rule 104(d)(2) for an unorthodox location for a well to be drilled to the Dakota Formation at a location six hundred and sixty feet from the East line and eight hundred and fifty feet from the North line of Section 26, Township 32 North, Range 6 West, N.M.P.M., Rio Arriba County, New Mexico.

This letter will evidence the consent to such location by me as the owner of an interest in the oil and gas lease covering the W/2 of Section 25 and an interest in the oil and gas lease covering the E/2 of Section 26, Township 32 North, Range 6 West, notwithstanding the fact that same lies only six hundred and sixty feet from the East line of said section.

Yours very truly,



J. Glenn Turner

EXHIBIT "C"

April 28, 1960

Oil Conservation Commission
of the State of New Mexico
State Land Office
Post Office Box 871
Santa Fe, New Mexico

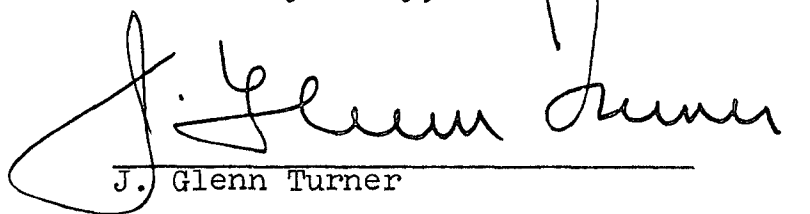
Gentlemen:

I have been furnished with a copy of La Plata Gathering System, Inc.'s application for an exception to Rule 104(d)(2) for an unorthodox location for a well to be drilled to the Dakota Formation at a location six hundred and sixty feet from the East line and eight hundred and fifty feet from the North line of Section 26, Township 32 North, Range 6 West, N.M.P.M., Rio Arriba County, New Mexico.

This letter will evidence the consent to such location by me as the owner of an interest in the oil and gas lease covering the W/2 of Section 25 and an interest in the oil and gas lease covering the E/2 of Section 26, Township 32 North, Range 6 West, notwithstanding the fact that same lies only six hundred and sixty feet from the East line of said section.

Yours very truly,



William G. Webb

EXHIBIT "C"

April 28, 1960

Oil Conservation Commission
of the State of New Mexico
State Land Office
Post Office Box 871
Santa Fe, New Mexico

Gentlemen:

We have been furnished with a copy of La Plata Gathering System, Inc.'s application for an exception to Rule 104(d)(2) for an unorthodox location for a well to be drilled to the Dakota Formation at a location six hundred and sixty feet from the East line and eight hundred and fifty feet from the North line of Section 26, Township 32 North, Range 6 West, N.M.P.M., Rio Arriba County, New Mexico.

This letter will evidence the consent to such location by Benson-Montin-Greer Drilling Corp. as the owner of an interest in the oil and gas lease covering the W/2 of Section 25 and an interest in the oil and gas lease covering the E/2 of Section 26, Township 32 North, Range 6 West, notwithstanding the fact that same lies only six hundred and sixty feet from the East line of said section.

Yours very truly,

BENSON-MONTIN-GREER DRILLING CORP.

By



Jack London, Jr., President

EXHIBIT "C"

PAN AMERICAN PETROLEUM CORPORATION

OIL AND GAS BUILDING

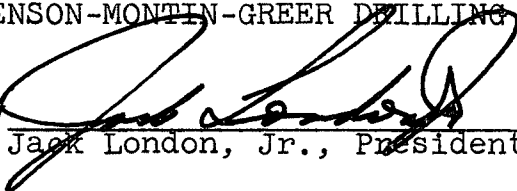
FORT WORTH, TEXAS

ALEX CLARKE, JR.
DIVISION ENGINEER

May 10, 1960

File: GWK-284-986.510.1

Subject: Waiver of Objection
LaPlata Gathering System, Inc.'s
Unorthodox Location for
Dakota Well, Section 26,
Rio Arriba County, New MexicoMr. A. L. Porter
New Mexico Oil Conservation Commission
Capitol Annex Building
Santa Fe, New Mexico

Dear Sir:

The undersigned, being an authorized representative of the offset operator, has been duly informed by LaPlata Gathering System, Inc. of their application to drill unorthodox location to the Dakota Formation, Section 26, Rio Arriba County, New Mexico, and hereby waives objection to the granting of a permit for this purpose.

It is our understanding that the well will be located 660' from the east line and 1850' from the north line, Section 26, T-32-N, R-6-W, N.M.P.M., Rio Arriba County, New Mexico.

Very truly yours,



GWK:lj

cc: LaPlata Gathering System, Inc.