

log in, assign no. & do over

El Paso Natural Gas Company
MAIN OFFICE OCC

1960 JUN 21 AM 8:14 El Paso, Texas
June 20, 1960

ADDRESS REPLY TO:
POST OFFICE BOX 997
FARMINGTON, NEW MEXICO

NSL-220
(waiver)

Mr. A. L. Porter, Secretary & Director
Oil Conservation Commission
Box 871
Santa Fe, New Mexico

Dear Mr. Porter:

This is a request for administrative approval for an unorthodox gas well location in the Blanco Mesa Verde Pool.

It is intended to locate the well, El Paso Natural Gas Co. San Juan 32-9 Unit No. 79, 1227 feet from the North line and 1090 feet from the East line of Section 17, Township 32 North, Range 9 West, N.M.P.M., San Juan County, New Mexico. The E/2 of Section 17 is dedicated to the well.

As shown on the enclosed plat, the NE/4 of Section 17 consists of high bluffs and a canyon. The only accessible land for a well in the NE/4 is that which makes the location unorthodox. It is, therefore planned to make the location unorthodox in order that the extremely high cost of constructing an orthodox location be avoided.

Since El Paso Natural Gas Company has control of offset leases, approval for an unorthodox location has not been sought from other operators.

I am enclosing two copies of the certified well location plat, and two copies of the notice of intention to drill.

Yours very truly,

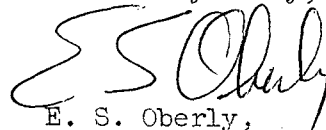

E. S. Oberly,
Division Petroleum Engineer

ESO:dgb

cc: Emery Arnold
Sam Smith
Phil McGrath

NEW MEXICO OIL CONSERVATION COMMISSION

Well Location and Acreage Dedication Plat

Section A.

Date **MAY 27, 1960**

Operator **EL PASO NATURAL GAS COMPANY** Lease **SAN JUAN 32-9 UNIT** SF **078513**
 Well No. **79** Unit Letter **A** Section **17** Township **32-N** Range **9-W** NMIM
 Located **1227** Feet From **NORTH** Line, **1090** Feet From **EAST** Line
 County **SAN JUAN** G. L. Elevation **6912** Dedicated Acreage **320** Acres
 Name of Producing Formation **MESA VERDE** Pool **BLANCO MESA VERDE**

1. Is the Operator the only owner in the dedicated acreage outlined on the plat below?
 Yes ☒ No ☐
2. If the answer to question one is "no", have the interests of all the owners been consolidated by communitization agreement or otherwise? Yes ☐ No ☐ If answer is "yes", Type of Consolidation.
3. If the answer to question two is "no", list all the owners and their respective interests below:

Owner

Land Description

Section B.

This is to certify that the information in Section A above is true and complete to the best of my knowledge and belief.

El Paso Natural Gas Company
 (Operator)
OR G NAL SIGNED E. S. OBERLY
 (Representative)

El Paso
 (Address)
Farmington, New Mexico

NOTE: THIS PLAT IS RE-ISSUED TO SHOW CORRECTED LOCATION. 6 18 60

Note: All distances must be from outer boundary of section.

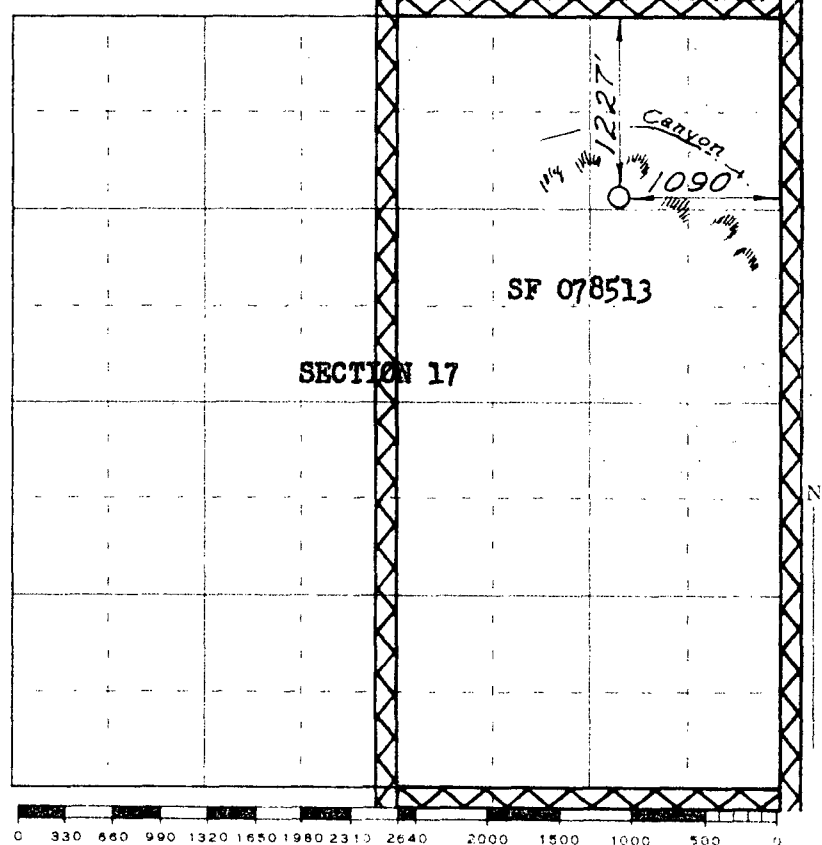

Scale 4 inches equal 1 mile

This is to certify that the above plat was prepared from field notes of actual surveys made by me or under my supervision and that the same are true and correct to the best of my knowledge and belief.

(Seal)

Date Surveyed **MAY 24, 1960**

E. O. Walker
 Registered Professional Engineer and/or Land Surveyor

Farmington, New Mexico

Santa Fe

(SUBMIT IN TRIPLICATE)

Land Office
078513

Lease No.
San Juan 32-9 Unit
14-08-001-569

UNITED STATES
DEPARTMENT OF THE INTERIOR
GEOLOGICAL SURVEY

1960 JUN 21 AM 8:14

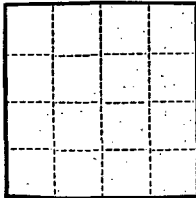

THIS INTENTION RE-ISSUED TO SHOW CORRECTED LOCATION
SUNDRY NOTICES AND REPORTS ON WELLS

NOTICE OF INTENTION TO DRILL.....	X	SUBSEQUENT REPORT OF WATER SHUT-OFF.....
NOTICE OF INTENTION TO CHANGE PLANS.....		SUBSEQUENT REPORT OF SHOOTING OR ACIDIZING.....
NOTICE OF INTENTION TO TEST WATER SHUT-OFF.....		SUBSEQUENT REPORT OF ALTERING CASING.....
NOTICE OF INTENTION TO RE-DRILL OR REPAIR WELL.....		SUBSEQUENT REPORT OF RE-DRILLING OR REPAIR.....
NOTICE OF INTENTION TO SHOOT OR ACIDIZE.....		SUBSEQUENT REPORT OF ABANDONMENT.....
NOTICE OF INTENTION TO PULL OR ALTER CASING.....		SUPPLEMENTARY WELL HISTORY.....
NOTICE OF INTENTION TO ABANDON WELL.....		

(INDICATE ABOVE BY CHECK MARK NATURE OF REPORT, NOTICE, OR OTHER DATA)

June 20, 19 60

Well No. 79 is located 1227 ft. from [N] line and 1090 ft. from [E] line of sec. 17
[S] [W]
NE/4 Sec. 17 32N 9W N.M.P.M.
(1/4 Sec. and Sec. No.) (Twp.) (Range) (Meridian)
Blanco Mesa Verde San Juan New Mexico
(Field) (County or Subdivision) (State or Territory)

The elevation of the derrick floor above sea level is 6922 ft.

DETAILS OF WORK

(State names of and expected depths to objective sands; show sizes, weights, and lengths of proposed casings; indicate mudding jobs, cementing points, and all other important proposed work)

It is intended to drill a well with rotary tools thru the Mesa Verde formation. Mud circulation will be used thru the Pictured Cliffs and set intermediate casing. Gas circulation will be used thru the Mesa Verde and production liner will be set. Possible productive intervals will be perforated and fractured. Est. T. D. 6320'.

Casing Program:

10 3/4" at 170' with 150 sacks cement circulated to the surface.
7 5/8" at 3990' with 250 sacks cement.
5 1/2" at 6320' with 300 sacks cement.

The E/2 of Section 17 is dedicated to this well.
E/2: SF 078513

I understand that this plan of work must receive approval in writing by the Geological Survey before operations may be commenced.

Company El Paso Natural Gas Company

Address Box 997

Farmington, New Mexico

OR G NAL SIGNED E. S. OBERLY
By

Title Petroleum Engineer