

Handwritten notes: *452*, *NSL*, *issue*, *Jan 12, 1970*



SHELL OIL COMPANY

PETROLEUM BUILDING
P.O. BOX 1509
MIDLAND, TEXAS 79701

DEC 16 1969

December 18, 1969

Oil Conservation Commission
State of New Mexico
P. O. Box 2088
Santa Fe, New Mexico 87501

Attention Mr. A. L. Porter, Jr.

Gentlemen:

Shell Oil Company requests administrative approval for an unorthodox location for its Sanger Well No. 6 in the Hobbs, Grayburg-San Andres pool in Lea County, New Mexico under Rule 104 Section F of the Rules and Regulations of the Commission. Attached is the required form C-101 and certified plats. The proposed location is 1200 feet from the north line and 470 feet from the west line of Section 27, Township 18 South, Range 38 East, Lea County, New Mexico.

Administrative approval of this unorthodox location is requested as a special case of topographical conditions affecting the standard location. The standard location places the well immediately in front of the entrance to the main structure of a large shopping center planned at this site.

Proration Unit D, Section 27 which is to be dedicated to this well is within the city limits of the City of Hobbs and is crossed on the southwest corner by Turner Boulevard. The Northgate Development Company of Hobbs has completed the basic plans to utilize approximately 14 acres of this Unit D area fronting Turner Boulevard as the site of their new multi-million dollar mall-type shopping center. To avoid interference with this project and still take advantage of an optimum location for the No. 6 well, we request approval to move the location parallel to Turner Boulevard approximately 252 feet south-east. This is a nonstandard location in that it is 120 feet from the proration unit boundary on the south but is 470 feet from the nearest lease line.

Further, the remainder of the surface of the 40-acre proration Unit D of Section 27 is a developed residential area with private homes, commercial structures, and necessary utility installations. Therefore, in the interests of the public and the owners of the surface acreage, we request your administrative approval of the proposed unorthodox location.

Offset operators to this proration unit have been sent copies of this application.

Yours very truly,

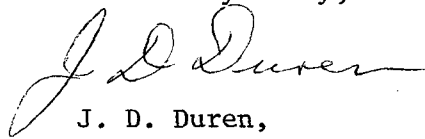
A handwritten signature in cursive script, appearing to read "J. D. Duren".

J. D. Duren,
Staff Operations Engineer
Production Department - West
Midland Division

JDD:lb

Attachment



SHELL OIL COMPANY

PETROLEUM BUILDING

P.O. BOX 1509

MIDLAND, TEXAS 79701

DEC 22 1969

Subject: Unorthodox Well Location

Southern Petroleum Exploration, Inc.

P. O. Box 1434

Roswell, New Mexico

Gentlemen:

Shell Oil Company is filing Form C-101 Permit to Drill on an unorthodox location for the following well:

Sanger #6, Hobbs Grayburg - San Andres

470' FWL & 1200' FNL

Section 27, T-18-S, R-38-E, Lea County,
New Mexico

If you as operator of a proration unit offsetting this unorthodox location have no objection, please sign all copies of the waiver. Please mail the original to New Mexico Oil Conservation Commission, P. O. Box 2088, Santa Fe, New Mexico 87501. Return one copy to us and retain one copy for your file. Enclosed are stamped, addressed envelopes for your convenience. We have attached a copy of Form C-101 and Form C-102 for your information.

Yours very truly,

J. L. Mahaffey, Manager
Production Department-West
Midland Division

DC:BW

Attachments

We as offset operator of a proration unit waive objection to the application of Shell Oil Company to drill the above-described well.

SOUTHERN PETROLEUM EXPLORATION, INC.
BOX 1434

BY

DATE Dec. 19, 1969



SHELL OIL COMPANY

PETROLEUM BUILDING

P.O. BOX 1509

MIDLAND, TEXAS 79701

DEC 29 1969

Subject: Unorthodox Well Location

Samedan Oil Corporation
2207 Wilco Bldg.
Midland, Texas 79701

Gentlemen:

Shell Oil Company is filing Form C-101 Permit to Drill on an unorthodox location for the following well:

Sanger #6, Hobbs Grayburg - San Andres
470' FWL & 1200' FNL
Section 27, T-18-S, R-38-E, Lea County,
New Mexico

If you as operator of a proration unit offsetting this unorthodox location have no objection, please sign all copies of the waiver. Please mail the original to New Mexico Oil Conservation Commission, P. O. Box 2088, Santa Fe, New Mexico 87501. Return one copy to us and retain one copy for your file. Enclosed are stamped, addressed envelopes for your convenience. We have attached a copy of Form C-101 and Form C-102 for your information.

Yours very truly,

J. L. Mahaffey, Manager
Production Department-West
Midland Division

DC:BW

Attachments

We as offset operator of a proration unit waive objection to the application of Shell Oil Company to drill the above-described well.

DATE December 24, 1969

SAMEDAN OIL CORPORATION

BY

1
2
3
4
5

NEW MEXICO OIL CONSERVATION COMMISSION
WELL LOCATION AND ACREAGE DEDICATION PLAT

RECEIVED OFFICE O. C. C. DEC 31 1969
DEC 22 10 36 AM '69

Form C-102
Supersedes C-128
Effective 1-1-65

All distances must be from the outer boundaries of the Section.

Operator SHELL OIL COMPANY			Lease SANGER		Well No. 6
Unit Letter D	Section 27	Township 18 SOUTH	Range 38 EAST	County LEA	
Actual Footage Location of Well: 1200 feet from the NORTH line and 470 feet from the WEST line					
Ground Level Elev. Not Available	Producing Formation Grayburg-San Andres		Pool Hobbs Grayburg-San Andres	Dedicated Acreage: 40 Acres	

1. Outline the acreage dedicated to the subject well by colored pencil or hatchure marks on the plat below.
2. If more than one lease is dedicated to the well, outline each and identify the ownership thereof (both as to working interest and royalty).
3. If more than one lease of different ownership is dedicated to the well, have the interests of all owners been consolidated by communitization, unitization, force-pooling, etc?

☐ Yes ☐ No If answer is "yes," type of consolidation _____

If answer is "no," list the owners and tract descriptions which have actually been consolidated. (Use reverse side of this form if necessary.) _____

No allowable will be assigned to the well until all interests have been consolidated (by communitization, unitization, forced-pooling, or otherwise) or until a non-standard unit, eliminating such interests, has been approved by the Commission.

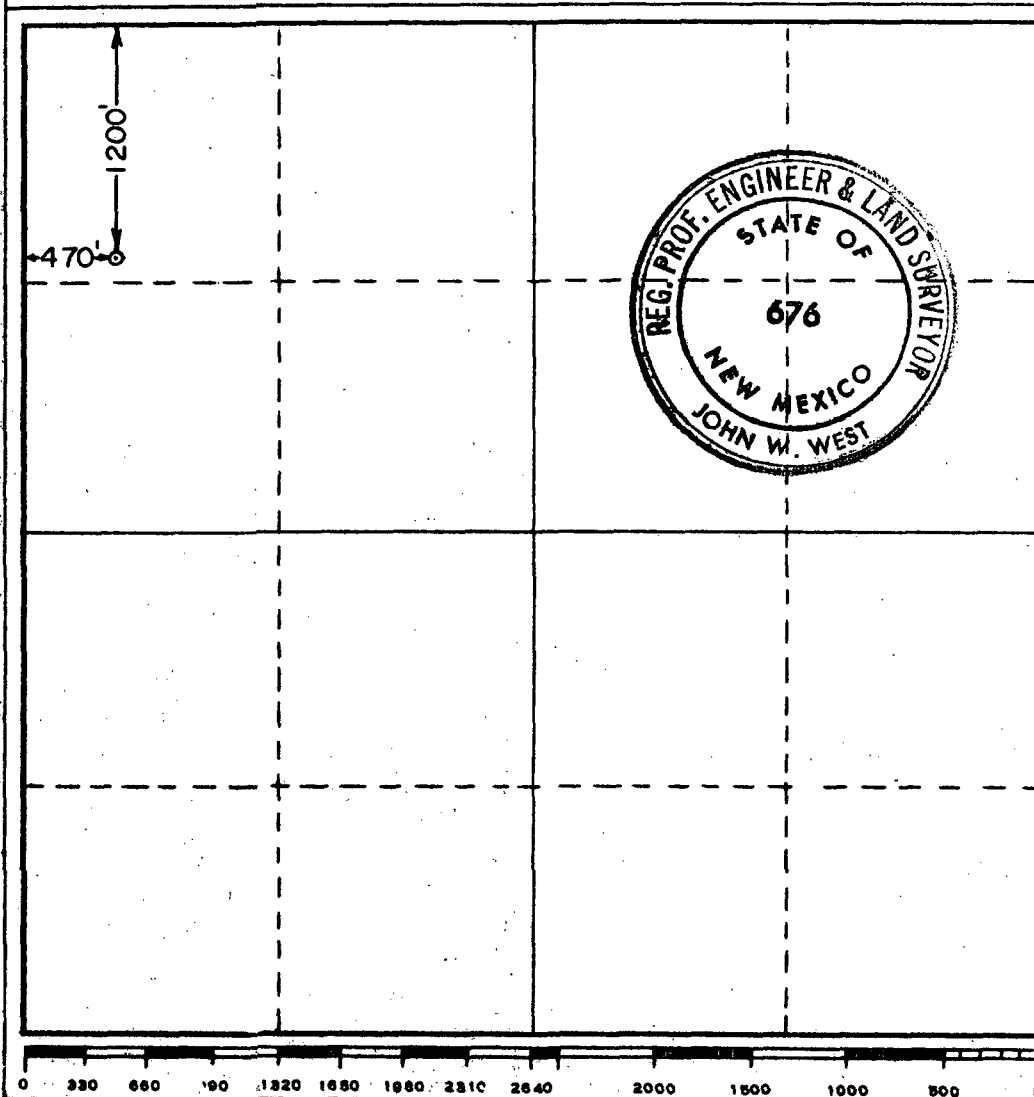

CERTIFICATION

I hereby certify that the information contained herein is true and complete to the best of my knowledge and belief.

J. D. Duran **J. D. Duran**
Name

Staff Operations Engineer
Position

Shell Oil Company
Company

December 17, 1969
Date

I hereby certify that the well location shown on this plat was plotted from field notes of actual surveys made by me or under my supervision, and that the same is true and correct to the best of my knowledge and belief.

Date Surveyed
DECEMBER 11, 1969

Registered Professional Engineer
and/or Land Surveyor

John W. West
Certificate No. **676**

JAMES W. H. 72
 C. R. Turner
 10-24-71

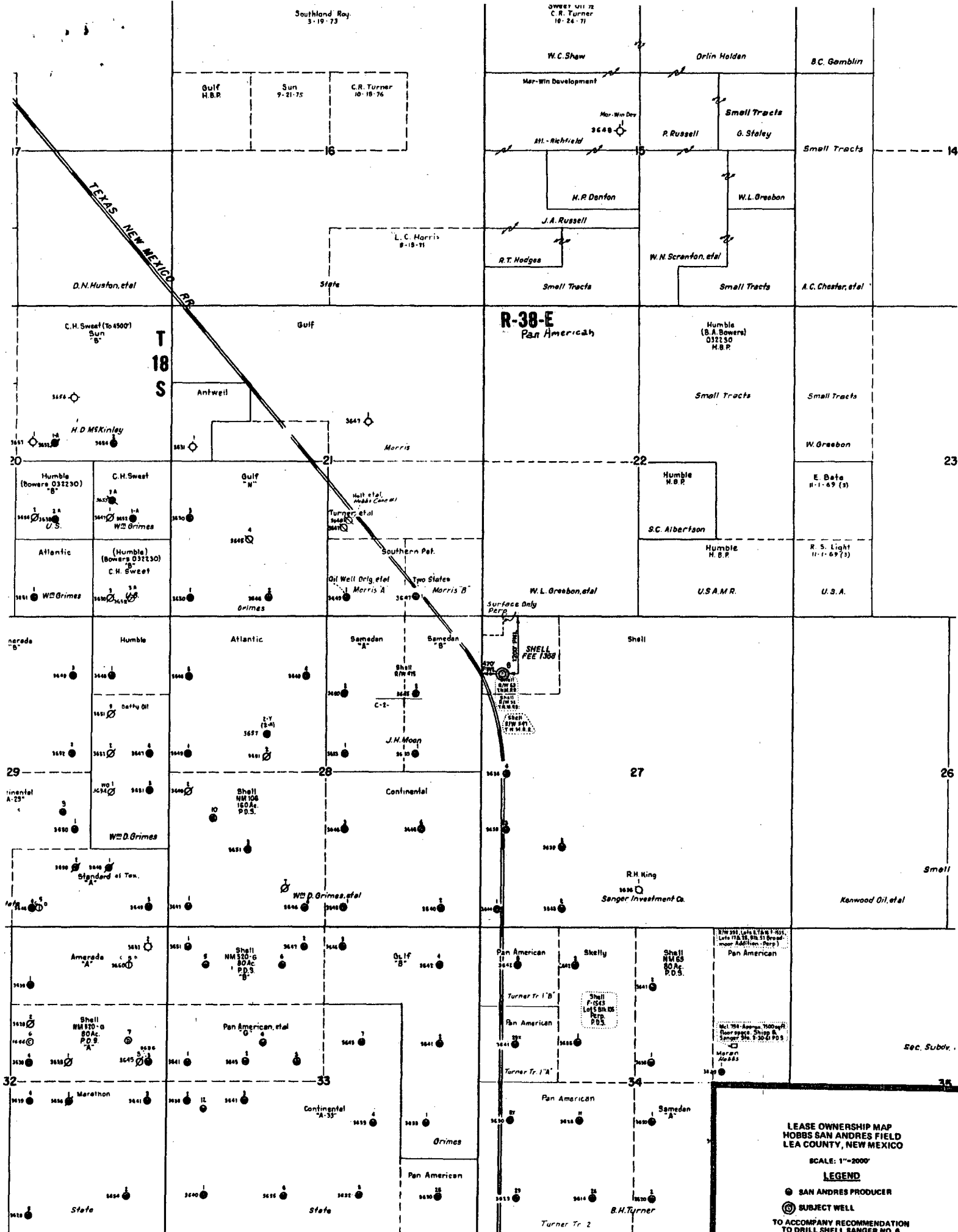

OIL CONSERVATION COMMISSION

P. O. BOX 2088

SANTA FE, NEW MEXICO 87501

December 23, 1969

*Wainer from
offsets have been
received to issue
NSA 12-31-69*

C
O
P
Y

Shell Oil Company
P. O. Box 1509
Midland, Texas 79701

Attention: Mr. J. D. Duren

Re: Request for administrative approval
for unorthodox location for Sanger
Well No. 6, Section 27, Township 18
South, Range 38 East, Hobbs Grayburg-
San Andres Pool, Lea County, New
Mexico

Gentlemen:

Your application for the above did not have
attached thereto the Form C-101 and certified plats.
Please forward them to this office.

Very truly yours,

GEORGE M. HATCH
Attorney

GMH/esr