

NSL 495  
JWA  
issue day OK for  
top. received from  
office  
Rule 39 R-1670 as amended  
El Paso, Texas 79999  
March 29, 1971  
issue 4-12-71 as per office OK  
Top - JWA  
11 8 11

# El Paso Natural Gas Company

ADDRESS REPLY TO  
POST OFFICE BOX 990  
FARMINGTON, NEW MEXICO 87401

Mr. A. L. Porter, Secretary & Director  
New Mexico Oil Conservation Commission  
Box 2088  
Santa Fe, New Mexico 87501

Dear Mr. Porter:

This is a request for administrative approval for an unorthodox gas well location which will be in the Ballard Pictured Cliffs Pool.

It is intended to locate this well, El Paso Natural Gas Company Ka-Des-Pah No. 1-Y, 1850' from the south line and 250' from the west line of Sec. 18, T-26-N, R-8-W, N. M. P. M., San Juan County, New Mexico. The SW/4 of Section 18 is dedicated to this well.

It is desired to drill the Ka-Des-Pah No. 1-Y to replace Well No. 1 which is in poor mechanical condition. Due to severely corroded casing this well is not considered to be in suitable condition for workover or for continued production. It now has a production packer set above the pay to protect the pay sand from water entering the wellbore through casing leaks. The well is currently produced through tubing which is landed in the production packer. This is considered a temporary measure since it is expected that corrosion will eventually attack the tubing.

Blanco Canyon cuts through the SW/4 of Section 18 in such a manner that a well site cannot be constructed at an orthodox location for a reasonable cost. (See the attached plat).

Southern Union Production is the only offsetting operator to this well. Southern Union has been notified of this request by telephone and has signed a waiver so that approval of this request may be granted as early as possible. This signed waiver is attached.

Plats showing ownership of offsetting leases and well location and acreage plats for the subject well are attached.

Yours very truly,

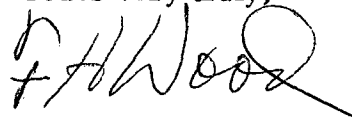

F. H. Wood,  
Division Petroleum Engineer

FHW:dgb

cc: Emery Arnold w/Attch.  
Chuck Higgins w/Attach.  
P. T. McGrath w/Attch.

NEW MEXICO OIL CONSERVATION COMMISSION  
WELL LOCATION AND ACREAGE DEDICATION PLAT

Form 7-12-1  
Supersedes C-128  
Effective 1-1-55

All distances must be from the outer boundaries of the Section

Operator <b>EL PASO NATURAL GAS COMPANY</b>		Lease <b>KAH DES PAH (NAVAJO CONT. 14-20-603-771)</b>		Well No. <b>1-Y</b>
Grid Letter <b>L</b>	Section <b>18</b>	Township <b>26-N</b>	Range <b>8-W</b>	County <b>SAN JUAN</b>
Actual Well Location of Well:				
<b>1850</b>	feet from the <b>SOUTH</b>	<b>250</b>	feet from the <b>WEST</b>	
Ground Level Elev. <b>6183</b>	Producing Formation <b>PICTURED CLIFFS</b>	Depth <b>BALLARD PICTURED CLIFFS</b>	Test Report Number <b>159.87</b>	Notes

1. Outline the acreage dedicated to the subject well by colored pencil or hatchure marks on the plat below.
2. If more than one lease is dedicated to the well, outline each and identify the ownership thereof (both as to working interest and royalty).
3. If more than one lease of different ownership is dedicated to the well, have the interests of all owners been consolidated by communitization, unitization, force-pooling, etc?

☐ Yes ☐ No If answer is "yes" type of consolidation \_\_\_\_\_

If answer is "no" list the owners and tract descriptions which have actually been consolidated. (Use reverse side of this form if necessary.) \_\_\_\_\_

No allowable will be assigned to the well until all interests have been consolidated (by communitization, unitization, forced-pooling, or otherwise) or until a non-standard unit, eliminating such interests, has been approved by the Commission.

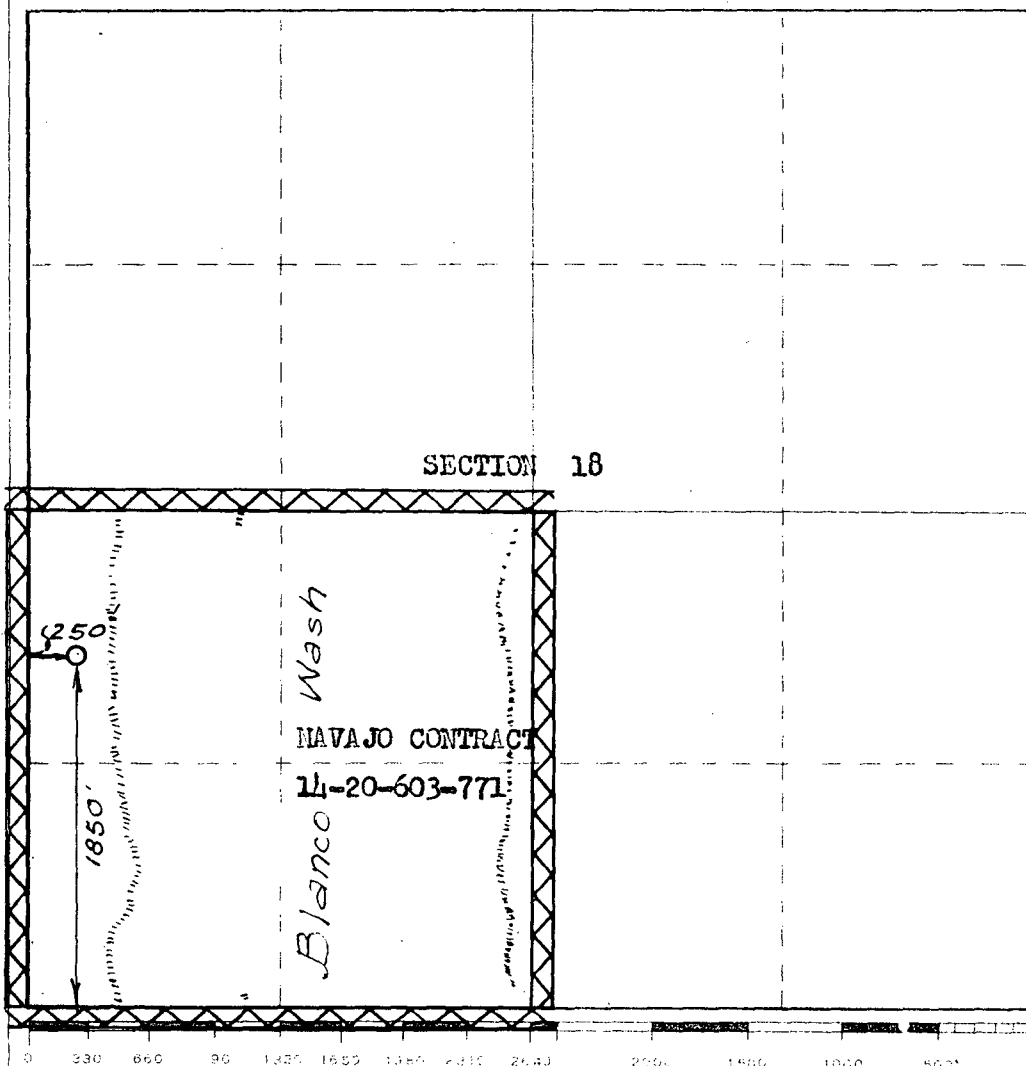

CERTIFICATION

I hereby certify that the information contained herein is true and complete to the best of my knowledge and belief.

Original Signed F. H. WOOD

Name	
Position	
Company	
Date	

I hereby certify that the well location shown on this plat was plotted from field notes of actual surveys made by me or under my supervision, and that the same is true and correct to the best of my knowledge and belief.

MARCH 24, 1971

*[Signature]*  
1760

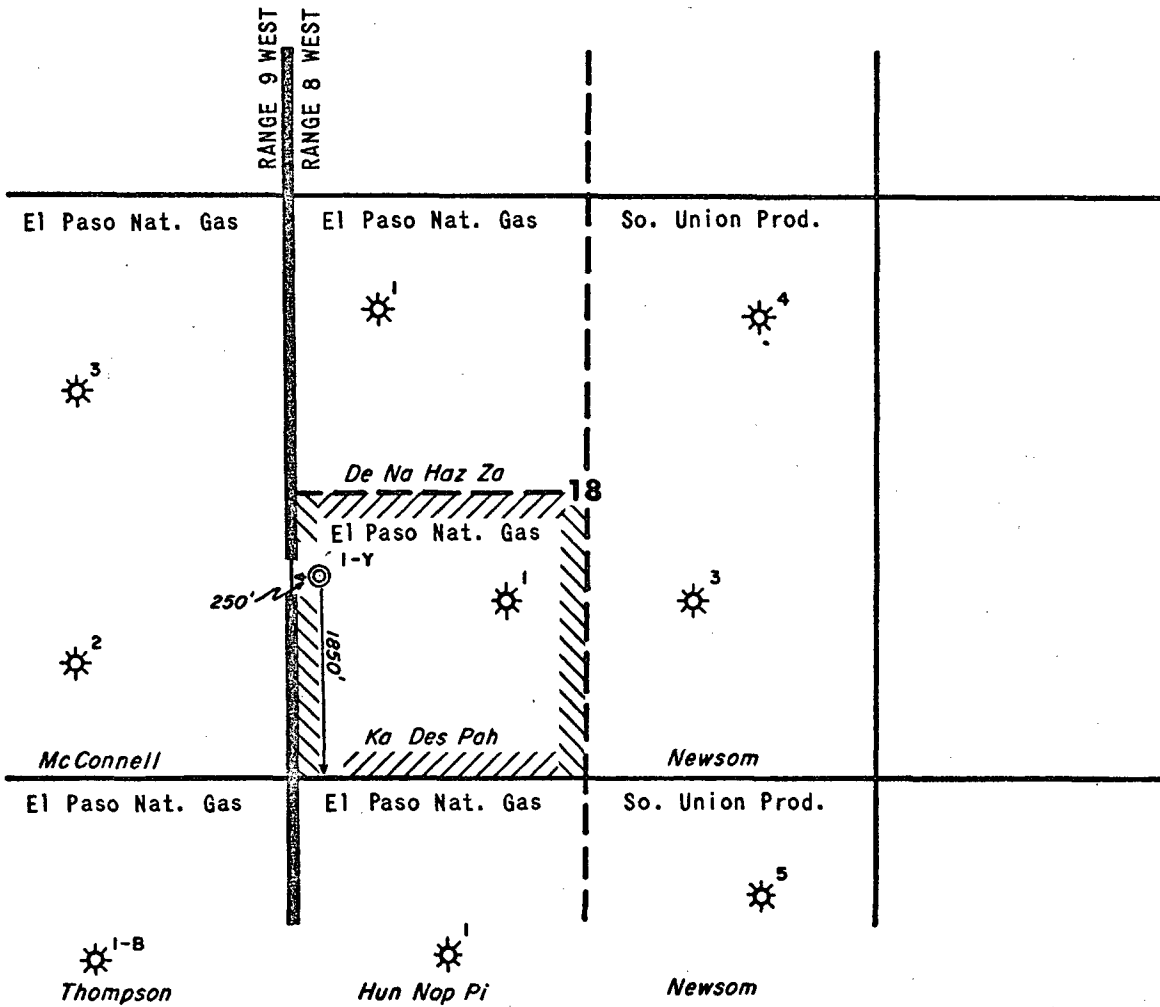

OWNERSHIP OF LEASES ( Pictured Cliffs Fm.)  
 OFFSETTING EL PASO NATURAL GAS COMPANY  
 KA DES PAH No. 1-Y WELL , IN SAN JUAN,  
 COUNTY NEW MEXICO.

DATE: 3 / 25 / 71

# El Paso Natural Gas Company

El Paso, Texas 79999

March 29, 1971

ADDRESS REPLY TO  
POST OFFICE BOX 990  
FARMINGTON, NEW MEXICO 87401

New Mexico Oil Conservation Commission  
P. O. Box 2088  
Santa Fe, New Mexico 87501

Re: Unorthodox Location  
Ka Des Pah No. 1-Y  
1850' FSL & 250' FWL  
Section 18, T-26-N, R-8-W  
San Juan County, New Mexico  
Ballard Pictured Cliffs Field

Gentlemen:

El Paso Natural Gas Company is applying for administrative approval of captioned unorthodox location since topographical conditions prevent staking a standard location.

Southern Union Production Company, which owns offsetting acreage, has no objection to the drilling of this well.

Yours very truly,

By B. R. Vanderslice  
Southern Union Production Company

FHW:dgb

OIL CONSERVATION COMMISSION  
Aztec DISTRICT

APR 15 AM 8 18  
1971

*[Handwritten signature]*

OIL CONSERVATION COMMISSION  
BOX 2088  
SANTA FE, NEW MEXICO

DATE 4/12/71

Re: Proposed NSP \_\_\_\_\_

Proposed NWU \_\_\_\_\_

Proposed NSL XXX

Proposed NFO \_\_\_\_\_

Proposed MC \_\_\_\_\_

*George Hatch*

Gentlemen:

I have examined the application dated March 29, 1971

for the El Paso Natural Gas Co. M Kah Des Pah #1-Y L-18-26N-8W  
Operator Lease and Well No. S-T-R

and my recommendations are as follows:

Approve  
\_\_\_\_\_  
\_\_\_\_\_  
\_\_\_\_\_  
\_\_\_\_\_  
\_\_\_\_\_

Yours very truly,

*A. R. Kendrick*  
A. R. Kendrick