



L. P. Thompson  
Division Manager  
Production Department  
Hobbs Division

Western Hemisphere Petroleum Division  
Continental Oil Company  
P. O. 460  
1001 North Turner  
Hobbs, New Mexico 88240  
(505) 393-4141

RECEIVED

OCT 12 1971

OIL CONSERVATION COMM.  
SANTA FE

October 6, 1971

New Mexico Oil Conservation Commission  
P. O. Box 2088  
Santa Fe, New Mexico 87501

Attention Mr. A. L. Porter, Jr.  
Secretary Director

Gentlemen:

Application for Approval of Unorthodox Location for our MCA Unit No. 292

On April 22, 1971, we asked for an unorthodox location approval for the MCA Unit No. 292, located 2615' FSL and 1295' FEL of Section 29, Unit Letter "I", T-17S, R-32E, Lea County, New Mexico. We received approval for this unorthodox location by Administrative Order No. NSL-498, dated April 23, 1971. It is necessary that we move this location to 1295' FNL & 1295' FWL of Section 27, Unit Letter "D", T-17S, R-32E, Lea County, New Mexico. It is respectfully requested that immediate approval of this revised location be given.

Yours very truly,

rw

Copies to:  
New Mexico Oil Conservation Commission  
P. O. Box 1980  
Hobbs, New Mexico 88240

United States Geological Survey (2)  
P. O. Box 1157  
Hobbs, New Mexico 88240

RLA: JJB: JWK:

*Sent  
NSK  
issue upon  
receipt of plat*

**OIL CONSERVATION COMMISSION**

P. O. BOX 2088

SANTA FE, NEW MEXICO 87501

October 12, 1971

C  
O  
P  
Y

Continental Oil Company  
P. O. Box 460  
Hobbs, New Mexico 88240

Attention: Mr. L. P. Thompson

Re: Administrative Approval  
for MCA Unit Well No. 292  
to be located 1295 feet from  
the North Line and 1295 feet  
from the West line of Sec-  
tion 27, Township 17 South,  
Range 32 East, Lea County,  
New Mexico

Gentlemen:

In order to permit the above-described request  
to be granted administratively, this office will  
need a plat showing the well to be located no  
nearer than 330 feet to the outer boundary of the  
MCA Unit Area.

Very truly yours,

GEORGE M. HATCH  
Attorney

GMH/dr



L. P. Thompson  
Division Manager  
Production Department  
Hobbs Division

RECEIVED

OCT 14 1971

OIL CONSERVATION COMM.  
SANTA FE

Western Hemisphere Petroleum Division  
Continental Oil Company  
P. O. 460  
1001 North Turner  
Hobbs, New Mexico 88240  
(505) 393-4141

October 13, 1971

New Mexico Oil Conservation Commission  
P. O. Box 2088  
Santa Fe, New Mexico 87501

Attention Mr. G. M. Hatch

Gentlemen:

Administrative Approval for Unorthodox Location - MCA Unit No. 292

Attached is a plat showing our MCA Unit boundary and the location of MCA Unit No. 292. It is respectfully requested that immediate approval of this unorthodox location be given.

Yours very truly,

dw  
Enc.

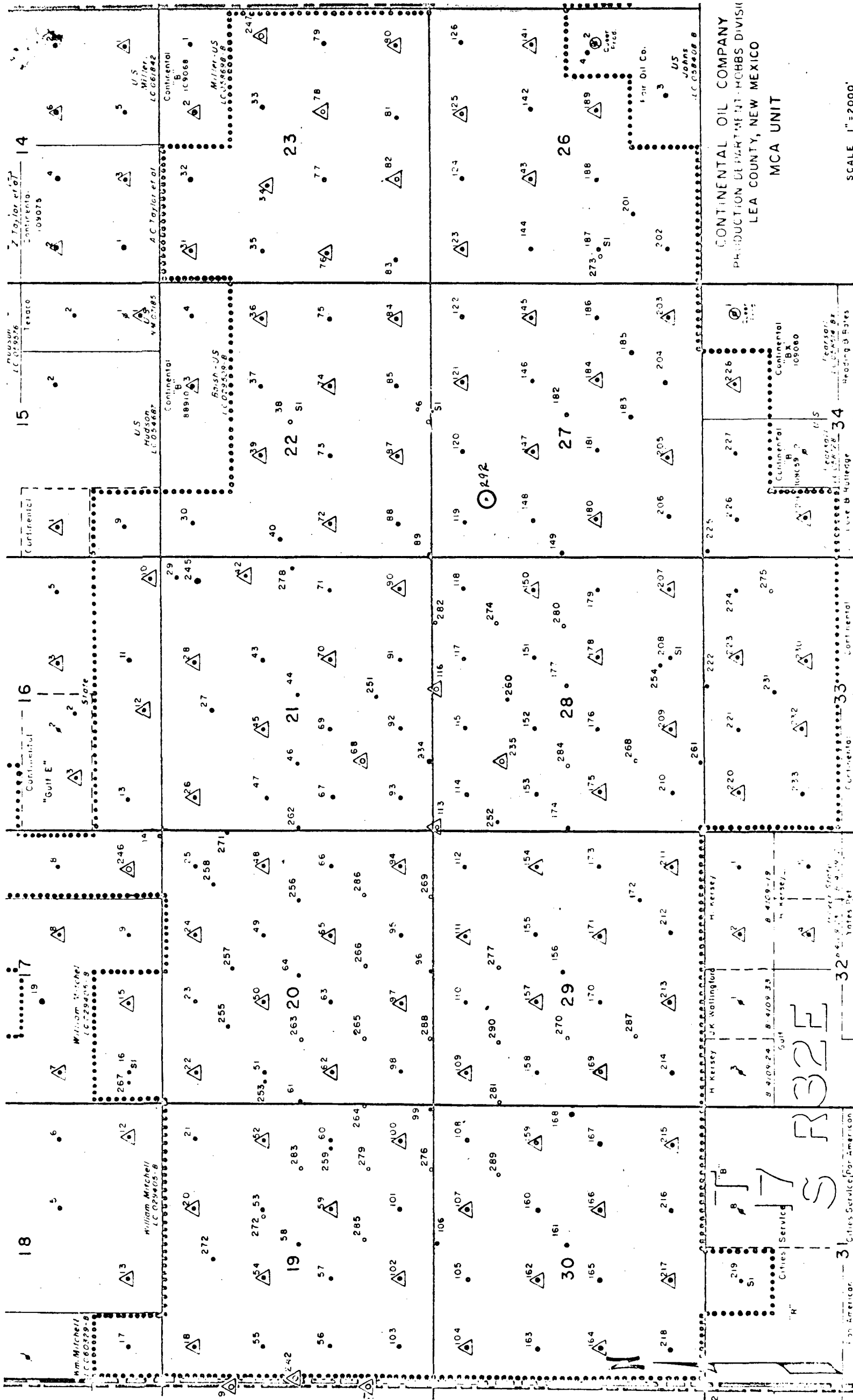

CONTINENTAL OIL COMPANY  
PRODUCTION DEPARTMENT - ROADS DIVISION  
LEA COUNTY, NEW MEXICO  
MCA UNIT

SCALE 1" = 2000'