

Handwritten:
NSL (two)
issue upon receipt of
warrant from
Shelly or Shelly was notified
15 day from
day

Handwritten: producing oil wells

WOOD-McSHANE, INC.

MANAGEMENT AND OPERATIONS

TELEPHONE 915 - 943-3092

P. O. BOX 968

MONAHANS, TEXAS 79756

November 26, 1971

RECEIVED

NOV 29 1971

OIL CONSERVATION COMM.
SANTA FE

New Mexico Oil Conservation Commission
Secretary-Director
P. O. Box 2088
Santa Fe, New Mexico 87501

Attention: Mr. A. L. Porter, Jr.

Re: Wood, McShane & Thams-692, Ltd.
Application to Drill
"M" State Nos. 60 & 75
Langlie Mattix Pool
Lea County, New Mexico

Gentlemen:

Wood, McShane & Thams request approval to drill New Mexico "M" State Nos. 60 and 75 on unorthodox locations in the Langlie Mattix Pool. Commission Order No. R-3910, dated January 14, 1970, provides for administrative approval of wells to be drilled at orthodox and unorthodox locations within the "M" State Lease Waterflood Project, provided said wells are drilled no closer than 330 feet to the outer boundary of the subject lease nor closer than 10 feet to any quarter-quarter section or subdivision inner boundary.

Copies of Forms C-101 and C-102 are attached for your inspection. Wood, McShane & Thams will appreciate very much your prompt approval of these locations.

Yours very truly,

WOOD-McSHANE, INC., For
Wood, McShane & Thams-692, Ltd.



K. D. Myrick

KDM:vc
Attachments
cc: Mr. Joe D. Ramey

RECEIVED
DEC - 3 1971
OIL CONSERVATION COMM.

November 30, 1971

New Mexico Oil Conservation Commission
General Counsel
P. O. Box 2088
Santa Fe, New Mexico 87501

Attention: Mr. George M. Hatch

Re: Wood, McShane & Thams-692, Ltd.
Application to Drill
New Mexico "M" State No. 75
Langlie Mattix Pool
Lea County, New Mexico

Gentlemen:

The subject operator has made application to drill and complete New Mexico "M" State No. 75 in the Langlie Mattix Pool and will be located 990 feet from the south line and 1305 feet from the west line of Section 20, T-22-S, R-37-E, Lea County, New Mexico. A copy of the Form C-101 and 102 have been furnished and received in this office.

We hereby waive objection to the granting of a permit for the drilling and completion of the above mentioned well.

Yours very truly,

By: C. J. Love
C. J. Love, District Production Manager

Company: Skelly Oil Company

Date: December 2, 1971

1st
issue
Dec
(15 day waiting period)
11/6/1971

RECEIVED
- 1 1971
OIL CONSERVATION COM.
SANTA FE

WOOD-McSHANE, INC.
MANAGEMENT AND OPERATIONS
TELEPHONE 915 - 943-3092
P. O. BOX 968
MONAHANS, TEXAS 79756

November 30, 1971

Skelly Oil Company
P. O. Box 1351
Midland, Texas 79701

Re: Request for Waiver
Wood, McShane & Thams-692, Ltd.
New Mexico "M" State No. 75
Langlie Mattix Field
Lea County, New Mexico

Gentlemen:

Wood, McShane & Thams have made application to drill and complete New Mexico "M" State No. 75, which will be located 990 feet from the south line and 1305 feet from the west line of Section 20, T-22-S, R-37-E, Lea County, New Mexico. Copies of Oil Conservation Commission Forms C-101 and 102 are attached for your information.

If you have no objection to our application, it would be appreciated if you would forward a waiver to the Oil Conservation Commission, along with a copy to this office. For your convenience, a waiver letter has been prepared and three copies are attached. The third copy can be retained for your files.

We trust that you will give this notification and request for waiver your prompt consideration. If you have any question or desire additional information, please feel free to contact this office.

Yours very truly,

WOOD-McSHANE, INC., For
Wood, McShane & Thams



K. D. Myrick

KDM:vc
Attachments
cc: New Mexico Oil Conservation Commission ✓

NO. OF COPIES RECEIVED	
DISTRIBUTION	
SANTA FE	
FILE	
U.S.G.S.	
LAND OFFICE	
OPERATOR	

NEW MEXICO OIL CONSERVATION COMMISSION

RECEIVED

NOV 29 1971

Form C-101
Revised 1-1-65

5A. Indicate Type of Lease

STATE ☒ FEE ☐

5. State Oil & Gas Lease No.

B-934

APPLICATION FOR PERMIT TO DRILL, DEEPEN, OR PLUG BACK

1a. Type of Work

b. Type of Well DRILL ☒ DEEPEN ☐ PLUG BACK ☐
OIL WELL ☒ GAS WELL ☐ OTHER ☐ SINGLE ZONE ☐ MULTIPLE ZONE ☐

2. Name of Operator

Wood, McShane & Thams-692, Ltd.

3. Address of Operator

P. O. Box 968, Monahans, Texas 79756

4. Location of Well

UNIT LETTER M LOCATED 990 FEET FROM THE South LINE
AND 1305 FEET FROM THE West LINE OF SEC. 20 TWP. 22-S RGE. 37-E NMPM

7. Unit Agreement Name

8. Farm or Lease Name

New Mexico "M" State

9. Well No.

75

10. Field and Pool, or Wildcat

Langlie Mattix

12. County

Lea

19. Proposed Depth

3900

19A. Formation

Queen

20. Rotary or C.T.

Rotary

21. Elevations (Show whether DF, RT, etc.)

3376 (GL)

21A. Kind & Status Plug. Bond

Blanket on File

21B. Drilling Contractor

Leatherwood

22. Approx. Date Work will start

Dec. 10, 1971

23.

PROPOSED CASING AND CEMENT PROGRAM

SIZE OF HOLE	SIZE OF CASING	WEIGHT PER FOOT	SETTING DEPTH	SACKS OF CEMENT	EST. TOP
12 1/4"	8 5/8"	20#	330'	200 Sx.	Surface
7 7/8"	5 1/2"	14 & 15.5#	3900'	300 Sx.	2600

1. Drill 12 1/4" hole and cement 330' of 8 5/8" casing with 200 sacks.
2. Drill 7 7/8" hole 330'-3900'.
3. Run 3900' of 5 1/2" casing and cement with 300 sacks.
4. Log and perforate Queen zone.
5. Acidize and frac.

IN ABOVE SPACE DESCRIBE PROPOSED PROGRAM: IF PROPOSAL IS TO DEEPEN OR PLUG BACK, GIVE DATA ON PRESENT PRODUCTIVE ZONE AND PROPOSED NEW PRODUCTIVE ZONE. GIVE BLOWOUT PREVENTER PROGRAM, IF ANY.

I hereby certify that the information above is true and complete to the best of my knowledge and belief.

Signed B. D. M. J. J. J. Title Petroleum Engineer

Date 11-26-71

(This space for State Use)

APPROVED BY _____ TITLE _____ DATE _____

CONDITIONS OF APPROVAL, IF ANY:

NEW MEXICO OIL CONSERVATION COMMISSION
WELL LOCATION AND ACREAGE DEDICATION PLAT

RECEIVED

NOV 29 1971

Form C-102
Supersedes C-128
Effective 1-1-65

All distances must be from the outer boundaries of the Section.

Operator WOOD, McSHANE & THAMS -692, Ltd.		Lease NEW MEXICO STATE "M"		OIL CONSERVATION COMMISSION Well No. 75
Unit Letter M	Section 20	Township 22 SOUTH	Range 37 EAST	County LEA
Actual Footage Location of Well: 990 feet from the SOUTH line and 1305 feet from the WEST line				
Ground Level Elev. 3375.7	Producing Formation Queen	Pool Langlie Mattix	Dedicated Acreage: Acres	

1. Outline the acreage dedicated to the subject well by colored pencil or hachure marks on the plat below.
2. If more than one lease is dedicated to the well, outline each and identify the ownership thereof (both as to working interest and royalty).
3. If more than one lease of different ownership is dedicated to the well, have the interests of all owners been consolidated by communitization, unitization, force-pooling, etc?

☐ Yes ☐ No If answer is "yes," type of consolidation _____

If answer is "no," list the owners and tract descriptions which have actually been consolidated. (Use reverse side of this form if necessary.) _____

No allowable will be assigned to the well until all interests have been consolidated (by communitization, unitization, forced-pooling, or otherwise) or until a non-standard unit, eliminating such interests, has been approved by the Commission.

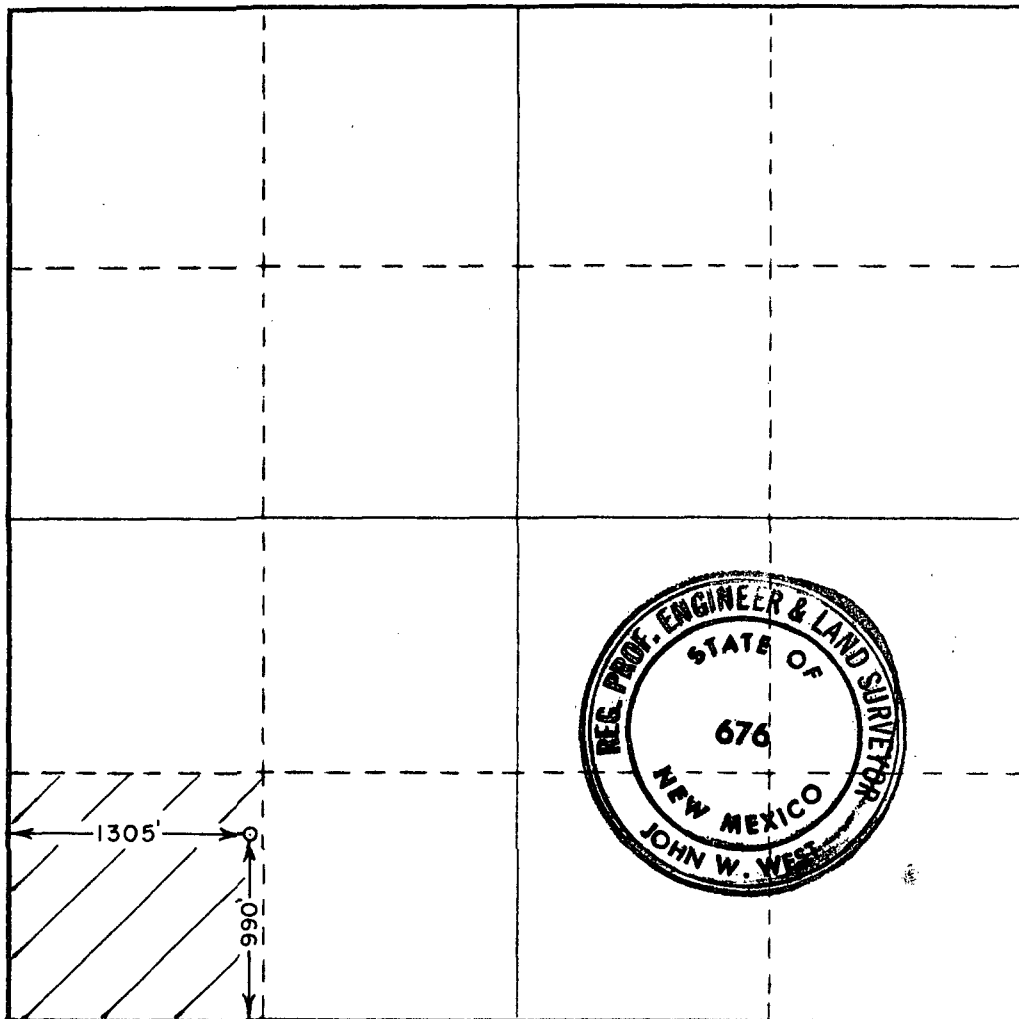

CERTIFICATION

I hereby certify that the information contained herein is true and complete to the best of my knowledge and belief.

K. D. Myrick

Name

K. D. Myrick

Position

Petroleum Engineer

Company

Wood, McShane & Thams

Date

11-26-71

I hereby certify that the well location shown on this plat was plotted from field notes of actual surveys made by me or under my supervision, and that the same is true and correct to the best of my knowledge and belief.

Date Surveyed

NOVEMBER 19, 1971

Registered Professional Engineer and/or Land Surveyor

John W. West

Certificate No.

676